

(19) World Intellectual Property Organization
International Bureau



(43) International Publication Date
2 March 2006 (02.03.2006)

PCT

(10) International Publication Number
WO 2006/021021 A1

(51) International Patent Classification⁷: **B41J 2/175**

(21) International Application Number:
PCT/AU2004/001144

(22) International Filing Date: 26 August 2004 (26.08.2004)

(25) Filing Language: English

(26) Publication Language: English

(71) Applicant (for all designated States except US): **SILVERBROOK RESEARCH PTY LTD** [AU/AU]; 393 Darling Street, Balmain, New South Wales 2041 (AU).

(72) Inventors; and

(75) Inventors/Applicants (for US only): **SILVERBROOK, Kia** [AU/AU]; Silverbrook Research Pty Ltd, 393 Darling Street, Balmain, New South Wales 2041 (AU). **LAPSTUN, Paul** [NO/AU]; Silverbrook Research Pty Ltd, 393 Darling Street, Balmain, New South Wales 2041 (AU).

(81) Designated States (unless otherwise indicated, for every kind of national protection available): AE, AG, AL, AM,

AT, AU, AZ, BA, BB, BG, BR, BW, BY, BZ, CA, CH, CN, CO, CR, CU, CZ, DE, DK, DM, DZ, EC, EE, EG, ES, FI, GB, GD, GE, GH, GM, HR, HU, ID, IL, IN, IS, JP, KE, KG, KP, KR, KZ, LC, LK, LR, LS, LT, LU, LV, MA, MD, MG, MK, MN, MW, MX, MZ, NA, NI, NO, NZ, OM, PG, PH, PL, PT, RO, RU, SC, SD, SE, SG, SK, SL, SY, TJ, TM, TN, TR, TT, TZ, UA, UG, US, UZ, VC, VN, YU, ZA, ZM, ZW.

(84) Designated States (unless otherwise indicated, for every kind of regional protection available): ARIPO (BW, GH, GM, KE, LS, MW, MZ, NA, SD, SL, SZ, TZ, UG, ZM, ZW), Eurasian (AM, AZ, BY, KG, KZ, MD, RU, TJ, TM), European (AT, BE, BG, CH, CY, CZ, DE, DK, EE, ES, FI, FR, GB, GR, HU, IE, IT, LU, MC, NL, PL, PT, RO, SE, SI, SK, TR), OAPI (BF, BJ, CF, CG, CI, CM, GA, GN, GQ, GW, ML, MR, NE, SN, TD, TG).

Published:
— with international search report

For two-letter codes and other abbreviations, refer to the "Guidance Notes on Codes and Abbreviations" appearing at the beginning of each regular issue of the PCT Gazette.

(54) Title: CARTRIDGE WITH IDENTIFIERS

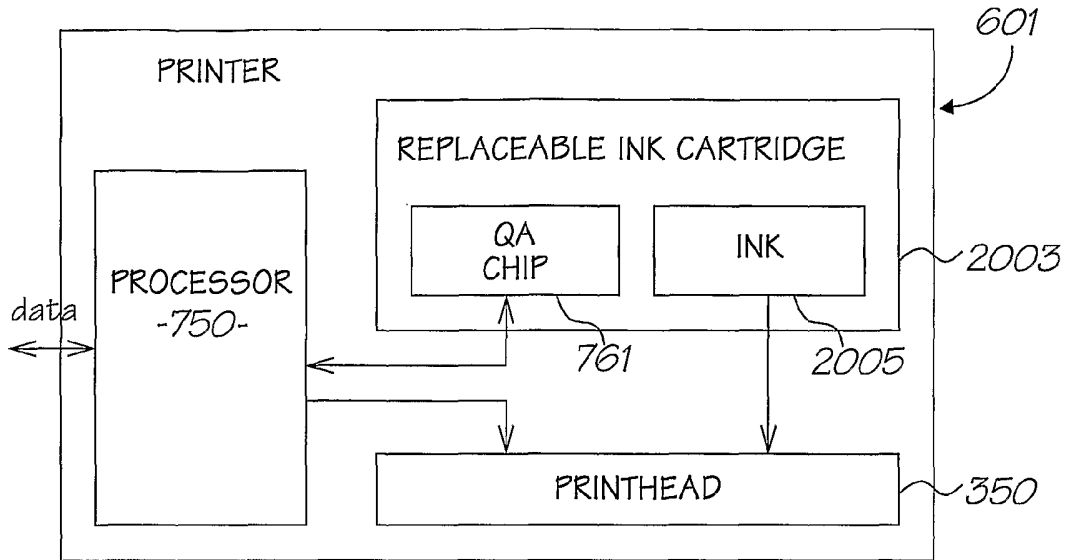

(57) Abstract: The invention relates to cartridges containing identifiers, and in particular to printer consumable cartridges containing identifiers which may be applied to printed media.

WO 2006/021021 A1

CARTRIDGE WITH IDENTIFIERS

FIELD OF THE INVENTION

The present invention relates to cartridges containing identifiers, and in particular to printer consumable cartridges containing identifiers which may be applied to printed media.

CROSS REFERENCE APPLICATIONS

Various methods, systems and apparatus relating to the present invention are disclosed in the following granted US patents and co-pending US applications filed by the applicant or assignee of the present application: The disclosures of all of these granted US patents and co-pending US applications are incorporated herein by reference.

6,374,354	PLT034US	09/575,108	09/575,109	09/575,110
09/607,985	6,398,332	6,394,573	6,622,923	6,747,760
10/189,459	PEC011US	10/815,621	10/815,612	10/815,630
10/815,637	10/815,638	10/815,640	10/815,642	10/815,643
10/815,644	10/815,618	10/815,639	10/815,635	10/815,647
10/815,634	10/815,632	10/815,631	10/815,648	10/815,614
10/815,645	10/815,646	HYG008US	HYG009US	10/815,620
10/815,615	HYG012US	10/815,633	10/815,619	HYG015US
10/815,614	10/815,636	10/815,649	10/815,609	10/815,627
10/815,626	10/815,610	10/815,611	10/815,623	10/815,622
10/815,629	10/815,625	10/815,624	10/815,628	10/409,876
10/409,848	10/409,845	09/575,197	09/575,195	09/575,159
09/575,132	09/575,123	09/575,148	09/575,130	09/575,165
09/575,153	09/693,415	09/575,118	09/609,139	09/608,970
09/575,131	09/575,116	09/575,144	09/575,139	NPA019US
09/575,186	6,681,045	6,678,499	6,679,420	09/663,599
09/607,852	6,728,000	09/693,219	09/575,145	09/607,656
09/693,280	6,766,942	09/693,515	09/663,701	09/575,192
6,720,985	09/609,303	09/610,095	09/609,596	09/693,705

	09/693,647	09/721,895	09/721,894	09/607,843	09/693,690
	09/607,605	09/608,178	09/609,553	09/609,233	09/609,149
	09/608,022	09/575,181	09/722,174	09/721,896	10/291,522
	6,718,061	10/291,523	10/291,471	10/291,470	10/291,819
5	10/291,481	10/291,509	10/291,825	10/291,519	10/291,575
	10/291,557	10/291,661	10/291,558	10/291,587	10/291,818
	10/291,576	10/291,589	6,714,678	6,644,545	10/291,379
	6,609,653	6,651,879	10/291,555	10/291,510	10/291,592
	10/291,542	10/291,820	10/291,516	NPA111US	10/291,487
10	10/291,520	10/291,521	10/291,556	10/291,821	10/291,525
	10/291,586	10/291,822	10/291,524	10/291,553	10/291,511
	10/291,585	10/291,374	10/685,523	10/685,583	10/685,455
	10/685,584	10/757,600	10/804,034	10/793,933	10/853,356
	10/831,232	NPA150US	09/575,193	09/575,156	09/609,232
15	09/607,844	6,457,883	09/693,593	10/743,671	09/928,055
	09/927,684	09/927,685	09/928,108	09/927,809	09/575,183
	09/575,160	09/575,150	09/575,169	NPK006US	NPK007US
	NPK008US	NPK009US	6,644,642	6,502,614	6,622,999
	6,669,385	10/322,450	6,549,935	NPN004US	09/575,187
20	6,727,996	6,591,884	6,439,706	6,760,119	09/575,198
	09/722,148	09/722,146	09/721,861	6,290,349	6,428,155
	09/575,146	09/608,920	6,741,871	09/722,171	09/721,858
	09/722,142	10/171,987	10/202,021	10/291,724	10/291,512
	10/291,554	10/659,027	10/659,026	10/831,242	NPP040US
25	NPP043US	NPP047US	10/659,027	09/693,301	09/575,174
	09/575,163	6,474,888	6,627,870	6,724,374	09/722,087
	09/722,141	09/722,175	09/722,147	6,737,591	09/722,172
	09/693,514	09/721,893	09/722,088	10/291,578	10/291,823
	6,768,821	10/291,366	10/291,503	10/291,469	10/274,817
30	10/782,894	10/782,895	10/778,056	10/778,058	10/778,060
	10/778,059	10/778,063	10/778,062	10/778,061	10/778,057
	10/846,895	NPS066US	NPS067US	NPS069US	NPS070US

	NPS076US	NPS079US	09/575,154	09/575,129	09/575,124
	09/575,188	09/721,862	10/120,441	10/473,747	10/291,577
	10/291,718	10/291,719	10/291,543	6,766,944	6,766,945
	10/291,715	10/291,559	10/291,660	10/409,864	10/309,358
5	NPT022US	10/410,484	NPT024US	10/853,379	10/786,631
	10/853,782	NPT040US	NPT041US	NPT042US	NPT043US
	NPT044US	NPW001US	NPW002US	NPW003US	NPW004US
	NPW005US	NPW008US	10/683,151	10/683,040	NPW012US
	NPW013US	10/778,090	09/575,189	09/575,162	09/575,172
10	09/575,170	09/575,171	09/575,161	10/291,716	10/291,547
	10/291,538	10/291,717	10/291,827	10/291,548	10/291,714
	10/291,544	10/291,541	10/291,584	10/291,579	10/291,824
	10/291,713	10/291,545	10/291,546	NPX038US	NPX039US
	6,593,166	10/428,823	10/849,931	NWA001US	NWA002US
15	NWA003US	NWA004US	NWA005US	6,454,482	09/693,704
	6,527,365	6,474,773	6,550,997	10/181,496	10/274,119
	10/309,185	10/309,066	6,416,167	6,746,105	10/728,970
	10/728,784	10/728,783	6,536,874	6,666,544	

- 20 Some applications have been listed by their docket numbers, these will be replaced when application numbers are known.

BACKGROUND OF THE INVENTION

25 A number of systems have been proposed in which a printed medium is imbued with an ability to support user interactions with a computer system. Such systems typically rely on coded data placed on or in the medium, ideally in inconspicuous or invisible form. The interactions are then typically mediated by a device capable of sensing and decoding the coded data and communicating the interactions to the computer system. The coded data can consist of one or more discrete barcodes, with each barcode identifying a hyperlink to related information. For example, the barcode can be a UPC barcode as described in US 30 Patent 5,978,773 "System and method for using an ordinary article of commerce to access a remote computer" (F.C. Hudetz et al); it can also consist of a coded coordinate grid which

allows the sensing device to generate position information relative to the medium, as variously described in US Patent 5,051,736 "Optical stylus and passive digitizing tablet data input system" (W.E. Bennett et al), US Patent 5,477,012 "Optical position determination" (O.F.Sekendur), US Patent 6,330,976 "Marking medium area with encoded
5 identifier for producing action through network" (M. Dymetman et al), and US Patent 6,502,756 "Recording of information" (C. Faahraeus), as well as in the present applicant's granted and co-pending applications listed above.

As described in the present applicant's US Patent 6,457,883, it is advantageous to include unique identifiers in the coded data, since this allows user interactions with different
10 instances of the printed medium to be distinguished. This is true whether the coded data directly identifies one or more hyperlinks (or functions), or whether the coded data identifies one or more regions of the medium (or the entire medium). When the coded data includes a coordinate grid, it may include one or more separate identifiers to identify one or more regions of the medium to which the coordinate grid applies, or the coordinate grid
15 may be a fragment of a larger coordinate grid, thus implicitly identifying one or more regions of the medium, e.g. as described in US Patent 6,502,756.

When the coded data is printed onto the medium on demand, there exists the problem of allocating one or more unique identifiers to be included in the coded data. This is particularly a problem when the identifiers are required to be globally unique but the printer
20 does not have online access to a source of globally unique identifiers.

SUMMARY OF THE INVENTION

In a first aspect the present invention provides a cartridge including identifier data that is indicative of at least one identifier, the cartridge being configured for use in a printer
25 capable of printing machine-readable coded data onto a surface, the printer including:

an interface for receiving the cartridge;

a reader for reading the identifier data;

a coded data generator for determining the at least one identifier from the identifier data and for generating coded data on the basis of the at least one identifier; and

30 at least one printing mechanism for printing the coded data onto a substrate.

Preferably the identifier data is indicative of a range of identifiers.

Preferably in the range is defined by a base identifier and a count.

Preferably the cartridge is configured to record consumption of identifiers as they are used by the printer.

- 5 Preferably the identifier data is indicative of a range of identifiers defined by a base identifier and a count, consumption of the identifiers being recorded by reducing the count.

Preferably the cartridge further includes one or more reservoirs containing one or more of the following substances:

black ink

10 coloured ink;

infrared ink;

fixative; and

adhesive.

- 15 Preferably the identifier data is indicative of sufficient identifiers to identify at least as many pages are as printable, on average, using at least one of the substances in the one or more reservoirs.

Preferably the reader is an optical reader and the identifier data is disposed on or in the cartridge in an optically readable form.

Preferably the identifier data is encoded in any of the following forms:

20 bar code;

CD-ROM;

DVD-ROM; and

optically-readable data card.

Preferably the reader is a magnetic reader and the identifier data is disposed on or in the cartridge in a magnetically readable form.

Preferably the reader is a magnetic reader and the identifier data is disposed on or in the cartridge in a magnetically readable form, and wherein the printer includes a magnetic
5 writer for magnetically writing or rewriting the count on or in the cartridge.

Preferably the reader is electronic reading circuitry, and the identifier data is incorporated in memory associated with the cartridge.

Preferably the memory is non-volatile magnetic or solid-state memory

Preferably the reader is electronic reading circuitry, the identifier data is incorporated in
10 memory associated with the cartridge, and wherein the printer includes an electronic writer for electronically writing or rewriting the count in the memory.

Preferably the identifiers are encrypted in the identifier data using an encryption key.

In another aspect the present invention provides a method of using a printer to print machine-readable coded data, the method including the steps of:

15 in the printer, obtaining identifier data from a cartridge operatively positioned in relation to the printer, the identifier data being indicative of identifiers;

encoding the identifiers in coded data; and

printing the coded data

Preferably the method further includes the step of recording, in or on the cartridge,
20 consumption of the identifiers.

Preferably the method further includes the step of reporting, to a computer system, consumption of the identifiers.

Preferably the method further includes the step of reporting, to the computer system, which identifier or identifiers have been used in relation to some or all of a print job processed by
25 the printer.

Preferably the method further includes the step of receiving an identifier from the computer system as part of the print job.

Preferably the method further includes the step of sending, to a computer system, some or all of the identifiers obtained from the identifier data.

- 5 Preferably the method further includes the step of recording, in a computer system, that one or more of the identifiers have been used.

Preferably the method further includes the step of recording, in a computer system, an association between one or more of the identifiers and content of a page or document printed by the printer.

- 10 In another aspect the present invention provides a printer for printing machine-readable coded data onto a surface, the printer including:

an interface for receiving a cartridge, the cartridge having identifier data that is indicative of one or more identifiers; and

a reader for reading the identifier data;

- 15 a coded data generator for determining at least one identifier from the identifier data and generating coded data on the basis of the at least one identifier; and

at least one printing mechanism for printing the coded data onto a substrate.

Preferably the printer is configured to report, to a computer system, consumption of the identifiers.

- 20 Preferably the printer is configured to report, to the computer system, which identifier or identifiers have been used in relation to some or all of a print job processed by the printer.

Preferably the printer is configured to receive an identifier from the computer system as part of the print job.

- 25 Preferably the printer is configured to send, to a computer system, some or all of the identifiers obtained from the identifier data.

Preferably the printer includes writing means for recording, in or on the cartridge, consumption of the identifiers.

Preferably the printer is configured to report, to a computer system, consumption of the identifiers.

- 5 Preferably the printer is configured to report, to the computer system, which identifier or identifiers have been used in relation to some or all of a print job processed by the printer.

Preferably the printer is configured receive an identifier from the computer system as part of the print job.

- 10 Preferably the printer is configured to send, to a computer system, some or all of the identifiers obtained from the identifier data.

Preferably the coded data includes the identifiers.

Preferably the cartridge includes at least one coded data ink reservoir containing coded data ink, the printing mechanism being configured to use the coded data ink to print the coded data.

- 15 Preferably the identifier data is indicative of a predetermined amount of the coded data.

Preferably the predetermined amount is of an order of the amount of coded data the printer is capable of printing using the ink in the cartridge.

Preferably the coded data ink is substantially invisible to an unaided human.

Preferably the coded data ink is absorptive in the infrared spectrum.

- 20 Preferably the cartridge includes at least one visible ink reservoir containing visible ink, the printing mechanism being configured to use the visible ink to print visibly on the substrate.

Preferably the printing mechanism is configured to print the coded data ink and the visible ink substantially simultaneously.

Preferably the coded data includes one or more tags.

- 25 Preferably each tag is indicative of an identity of a document with which it is printed.

Preferably each tag is indicative of a location of that tag in relation to a document with which it is printed.

Preferably the reader is an optical scanner and the identifier data takes the form of optically scannable information on the cartridge.

- 5 Preferably the identifier data takes the form of a bar code.

Preferably the reader is a magnetic scanner and the identifier data is a magnetic pattern on the cartridge.

Preferably the reader is electronic reading circuitry, and the identifier data is incorporated in memory associated with the cartridge.

- 10 Preferably the coded data is encrypted into the identifier data using an encryption key, to impede extraction of the coded data from the identity data.

Preferably the coded data is indicative of an identity of at least a region of the surface.

Preferably the coded data is also indicative of at least one reference point of the surface.

- 15 Preferably the base identifier is an initial value to be used by the printer in an algorithm for generating the coded data.

Preferably the identifier data includes a base identifier, the printer being configured to use the base identifier in an algorithm for generating further identifiers for the coded data.

Preferably the algorithm is a recursive algorithm and the initial identifier is used as a seed value for the algorithm.

- 20 Preferably the recursive algorithm outputs a sequence of identifiers upon which the coded data is based.

Preferably the sequence is pseudo-random.

Preferably the base identifier is a seed value for a linear feedback shift register (LFSR), the method including the steps of:

- 25 loading the LFSR with initial data based on the initial identifier; and

generating identifiers based on the contents of the LFSR as it is clocked.

Preferably the printer is configured to record usage of ink, new identifiers only being generated until a predetermined amount of the ink is determined to have been used by the printer.

- 5 Preferably the ink is provided in one or more reservoirs of the cartridge.

Preferably the method includes the steps of:

determining a base identifier based on the identifier data and generating some of the coded data based on the base identifier;

- 10 determining subsequent identifiers by incrementing or decrementing the current identifier, and generating further coded data based on the subsequent identifiers.

Preferably the method includes the step of recording usage of ink by the printer, new coded data only being generated until a predetermined amount of the ink is determined to have been used by the printer.

Preferably the ink is provided in one or more reservoirs of the cartridge.

- 15 Preferably the method includes the step of overwriting each current identifier with the next subsequent identifier.

Preferably the cartridge includes non-volatile memory and the overwriting step includes overwriting the current identifier stored in the memory.

20 **BRIEF DESCRIPTION OF THE DRAWINGS**

Figure 1 shows a perspective view of a wall-mounted printer;

Figure 2 shows a section through the length of the printer of Figure 1;

Figure 2a shows an enlarged portion of Figure 2 showing a section of the duplexed print engines and glue wheel assembly;

- 25 Figure 3 shows a detailed view of the ink cartridge, ink, air and glue paths, and print engines of the printer of Figures 1 and 2;

Figure 4 shows a schematic block diagram of a printer controller for the printer shown in Figures 1 and 2;

Figure 5 shows a schematic block diagram of duplexed print engine controllers and printheads associated with the printer controller shown in Figure 4;

Figure 6 shows a schematic block diagram of a printer with ID data stored in the ink cartridge;

5 Figure 7 shows a schematic block diagram of a printer with ID data encoded on the surface of the ink cartridge;

Figure 8 shows a flowchart of a printer allocating the next ID from the ink cartridge, on receipt of print data;

Figure 9 shows a flowchart of a computer requesting the ID from the printer prior to
10 sending print data;

Figure 10 shows a flowchart of a printer reading ID data from the ink cartridge and maintaining the ID allocation internally;

Figure 11 shows a flowchart of a computer maintaining ID allocation after obtaining the ID data from the printer;

15 Figure 12 shows a flowchart of a computer maintaining ID allocation after obtaining the ID data from the printer; and

Figure 13 shows a class diagram of an object ID.

DETAILED DESCRIPTION OF PREFERRED AND OTHER EMBODIMENTS

20 Note: Memjet™ is the trademark of Silverbrook Research Pty Ltd, Australia.

In the preferred embodiment, the invention is configured to work with the netpage system, as described in the present applicant's granted and co-pending applications listed above.

A netpage printer 601, an example of which is described in more detail below, prints interactive pages 2014 with visible graphic data and invisible coded data. The coded data
25 for a region of a surface (e.g. the surface of a printed page) includes one or more identifiers 210 for each region and a coordinate grid for each region. A coordinate grid may be a fragment of a larger coordinate grid, and may thus implicitly identify its corresponding region (or page), i.e. without an explicit region (or page) identifier. A description of the contents of the page 2010, corresponding to at least some of the graphic data, is stored on a
30 computer system, indexed by the corresponding region identifiers (or the page identifier).

A user typically interacts with the page using a hand-held device, such as a pen device, which is capable of sensing and decoding the coded data, and transmitting, to the computer

system, data representing movement of the device relative to the coordinate grid. The computer system interprets the movement data in relation to the stored description of the page, retrieved using the region (or page) identifier accompanying the movement data. For example, the computer system may interpret the movement data as a click of a button, a check of a box, handwriting in a text field, drawing in a drawing field, or a signature in a signature field. Alternatively or additionally, the coded data may identify interactive objects, such as buttons, hyperlinks and fields, directly, allowing the computer system to interpret the movement data without reference to a stored page description.

As shown in Figure 13, the identifier 210 can be considered as a general object identifier, whether it identifies a page, a region of a page, a specific object, or a specific item. In the latter case, the item identifier 215 may correspond to an electronic product code (EPC), consisting of a product identifier 214 and a serial number 213. The product identifier may correspond to a Universal Product Code (UPC). The product identifier may consist of a manufacturer number 211 and a product class number 212.

A netpage printer 601 comprises a controller 656, a printhead 350, and one or more replaceable ink cartridges 2003. A netpage printer 601 utilizes one or more print cartridges 2003 which may contain black ink, colored ink (e.g. cyan, magenta, yellow), fixative, and adhesive 2005. Each cartridge 2003 typically incorporates a quality assurance (QA) chip 761 which contains information about ink characteristics and available ink volume, and which is used to record ink consumption during printing to prevent printheads 350 from running dry and being damaged.

The netpage printer 601 typically utilizes invisible ink for printing coded data, in which case at least one cartridge 2003 includes invisible ink. The invisible ink may be a near-infrared-absorptive ink.

It is advantageous for a netpage system to use unique identifiers for identifying regions (or pages), to allow user interactions with different regions (or pages) to be distinguished by the system. This may apply to regions (or pages) with different descriptions, or to different instances of the same regions (or pages), or to different object (or function) identifiers, or to different instances of the same object (or function) identifiers.

When all the participants of a netpage system are connected, it is a trivial matter to allocate identifiers in such a way as to guarantee global uniqueness. For example, a central database

of identifiers may be used. However, when all the participants of a netpage system are not connected, the allocation of unique identifiers presents a problem. For example, when netpage systems are deployed on multiple networks, it is desirable for identifiers allocated within any network to be unique across all networks to prevent accidental misinterpretation
5 by a computer on one network of input received via a page printed on another network.

As shown in Figure 6, to allow allocation of globally unique identifiers, identifiers can be centrally allocated and stored in netpage cartridges 2003 during or after the cartridge manufacturing process. The QA chip 761 in a netpage printer cartridge 2003 provides a convenient non-volatile memory (in the form of a flash memory) capable of holding a range
10 of unique identifiers (examples of the QA chip are the subject of granted US 6374354 and pending US patent application ___/_____ filed May 27, 2004 entitled "Use of variant base keys with two entities (docket number: PLT034)"). Ideally, the cartridge 2003 which contains the machine-readable ink 2005 used for printing coded data also holds the identifier range. This allows the size of the pre-allocated identifier range (or set) to be tuned
15 to the maximum number of pages printable using the available volume of machine-readable ink. Another non-volatile memory in the cartridge can be used in place of the QA chip's memory.

As an alternative, a pre-allocated identifier range (or set) can be provided to the printer separately from other consumables, e.g. in the form of a flash memory card, read-only
20 memory (ROM) card, optical card, magnetic stripe card, smart card, or any combination of these. Such a card may of course come in any number of form factors, including a chip, a card, and cartridge. It is then practical to have a computer system 2009 on the network 2012, rather than a printer, manage identifier allocation from the card.

It will be appreciated that the term "cartridge" is meant to encompass all conceivable form
25 factors, and is not intended in a limiting sense except as to indicate an object which can be inserted into a computer system 2009 or printer 601 for the purposes of being read (and possibly written), possibly but not necessarily in conjunction with the extraction of other consumable materials.

As shown in Figure 8, each time the netpage printer 601 requires a unique identifier, e.g.
30 when it prints a page in response to print data received from a computer system, it reads the next available identifier from the cartridge 2003, and increments the next available

identifier. This ensures that the same identifier is only used once. In practice, this is advantageously done by way of decrementing a count of available identifiers relative to a static base identifier. In the preferred embodiment, the printer 601 then communicates the identifier to the computer system 2009 to allow the computer system to record an association between the page description 2010 and the identifier in an index 2011. If region (or page) identification is implicit via a unique fragment of a larger coordinate grid, then the allocated (and communicated) "identifier" consists of a range of two-dimensional addresses, where the range identifies the coordinate grid fragment and thus the region (or page).

10 A number of schemes may be used to represent a collection of identifiers. A range may be represented by a base identifier and a count. The count may be omitted and the range may instead be limited by the physical ink capacity of the cartridge. A range or set of identifiers may be represented explicitly.

The identifiers may also be generated algorithmically. For example, successive identifiers may be generated recursively, by feeding back at least a portion of a current identifier into an algorithm to generate the next identifier.

One way of implementing recursive generation is by using a linear feedback shift register (LFSR). An LFSR of length k consists of k 1-bit stages numbered 0 to $k-1$. On each clock the content of stage 0 forms the next bit of the output sequence, the content of stage i is moved to stage $i-1$, and the new content of stage i is a feedback bit calculated by adding together modulo 2 the previous contents of a fixed subset of the stages of the register (see Menezes, A.J., P.C. van Oorschot and S.A. Vanstone, *Handbook of Applied Cryptography*, 1997, CRC Press).

A maximal-length LFSR produces as output a so-called m-sequence with a length of $(2^k)-1$, in which every possible non-zero register value appears once before the sequence repeats. M-sequences are also known as pseudo-noise (PN) or pseudo-random sequences, since they exhibit many of the general characteristics of noise without actually being random. The characteristics and construction of PN sequences are discussed extensively in Golomb, S.W., *Shift Register Sequences*, Aegean Park Press, 1982. In practice, a collection of identifiers can be represented by a base identifier and optionally a count. The base identifier then forms the initial contents of the LFSR.

A number of schemes may also be used to record the consumption of identifiers. The base identifier may simply be incremented, decremented or re-written. The associated count, if present, may be decremented. Alternatively a usage count may be incremented. If the identifier information is recorded in a read-only medium, then a separate usage count is useful. Usage consumption may also be physically recorded, e.g. by the length of a line or of a collection of marks incrementally recorded on the cartridge.

The allocation of an identifier from the cartridge 2003 may, from the printer's point of view, be decoupled from printing. The printer 601 may, for example, respond to a request from a computer system 2009 for one or more identifiers, which the computer system then allocates to one or more regions (or pages) 2010 prior to sending print data to the printer, as shown in Figure 9. The print data may then include the identifiers. Identifiers allocated from a cartridge 2003 may include identifiers which are used by the computer system 2009 to index document, page, region and object data, but which are never included in coded data printed by the (or any other) printer.

The netpage print cartridge 2003 may provide identifiers 2015 in another machine-readable form, such as in the form of an optical or magnetic encoding which can be sensed and decoded by the printer. For example, the identifier data 2015 may be coded in a linear or two-dimensional barcode 2007 on the surface of the cartridge, which is read by a barcode reader 2008 embedded in the printer 601, as shown in Figure 7. If the cartridge lacks rewritable memory entirely (e.g. in the absence of QA-chip flash memory), then the printer 601 can maintain identifier consumption data in its own memory 2006, or on its own disk 2013, as shown in Figure 10, or on a computer system 2009 to which it has access, or a computer system can maintain identifier consumption data 2013 for a cartridge 2003 to which the printer 601 provides it with access, as shown in Figure 11. Although largely practical, these approaches have the disadvantage that if a partially-used cartridge is moved from one netpage network to another (or even from one printer to another on the same network), then duplicate identifier usage may result. Alternatively, the printer 601 can maintain identifier consumption data on the cartridge, but recorded in a different manner to the identifier data itself. For example, the identifier data may be recorded in read-only form using any of the approaches described above, and the printer may read and write (or rewrite) identifier consumption data separately, e.g. via an optical reader for reading consumption-indicative marks or data on the cartridge and a printer (or other marking

device) for printing (or otherwise placing) consumption-indicating marks or data onto the cartridge, or via a magnetic reader and writer for reading consumption-indicating data from and writing consumption-indicating data to a magnetic medium on the cartridge.

However the identifiers are stored in or on the cartridge, it is preferred that some form of encryption be used. Encryption prevents unauthorized tampering with the information stored on the cartridge, which is important if it is desirable to keep the identifiers globally unique across many printers and computer systems. Where the identifiers have commercial value, encryption impedes unauthorized generation of unpaid-for identifiers by end users.

A suitable encryption scheme is a public-private key arrangement, whereby the identifier information on or in the cartridge is encrypted at some point during manufacture or distribution using a private key. The printer (or computer system) is provided with the public key corresponding to the private key, enabling it to decrypt the identifier information from the cartridge prior to use. Alternatively, the identifier information may be encrypted using a secret key also known to the printer.

Rather than being encrypted, the identifier information may be stored in the clear but may have an associated digital signature. The printer can verify the digital signature with respect to the identifiers to thereby authenticate the identifier information. The digital signature may have been generated during manufacture or distribution using a secret key or a private key, and the printer may verify the digital signature using respectively the same secret key or a public key associated with the private key.

Whether the identifier information is encrypted or digitally signed using a secret key, the secret key may be securely stored in a master QA chip embedded in the printer.

An example of a netpage printer 601 is described in more detail below.

Netpage Printer Description

25 *Printer Mechanics*

The vertically-mounted netpage wallprinter 601 is shown fully assembled in Figure 1. It prints netpages on Letter/A4 sized media using duplexed 8 1/2" Memjet™ print engines 602 and 603, as shown in Figures 2 and 2a. It uses a straight paper path with the paper 604 passing through the duplexed print engines 602 and 603 which print both sides of a sheet simultaneously, in full color and with full bleed.

An integral binding assembly 605 applies a strip of glue along one edge of each printed sheet, allowing it to adhere to the previous sheet when pressed against it. This creates a final bound document 618 which can range in thickness from one sheet to several hundred sheets.

- 5 The replaceable ink cartridge 627, shown in Figure 3 coupled with the duplexed print engines, has bladders or chambers for storing fixative, adhesive, and cyan, magenta, yellow, black and infrared inks. The cartridge also contains a micro air filter in a base molding.

Referring to Figure 2, the motorized media pick-up roller assembly 626 pushes the top sheet directly from the media tray past a paper sensor on the first print engine 602 into the
10 duplexed Memjet™ printhead assembly. The two Memjet™ print engines 602 and 603 are mounted in an opposing in-line sequential configuration along the straight paper path. The paper 604 is drawn into the first print engine 602 by integral, powered pick-up rollers 626. The position and size of the paper 604 is sensed and full bleed printing commences. Fixative is printed simultaneously to aid drying in the shortest possible time.

- 15 The paper exits the first Memjet™ print engine 602 through a set of powered exit spike wheels (aligned along the straight paper path), which act against a rubberized roller. These spike wheels contact the printed surface and continue to feed the sheet 604 into the second Memjet™ print engine 603.

Referring to Figures 2 and 2a, the paper 604 passes from the duplexed print engines 602
20 and 603 into the binder assembly 605. The printed page passes between a powered spike wheel axle 670 with a fibrous support roller and another movable axle with spike wheels and a momentary action glue wheel. The movable axle/glue assembly 673 is mounted to a metal support bracket and it is transported forward to interface with the powered axle 670 via gears by action of a camshaft. A separate motor powers this camshaft.

- 25 The glue wheel assembly 673 consists of a partially hollow axle 679 with a rotating coupling for the glue supply hose 641 from the ink cartridge 627. This axle 679 connects to a glue wheel, which absorbs adhesive by capillary action through radial holes. A molded housing 682 surrounds the glue wheel, with an opening at the front. Pivoting side moldings and sprung outer doors are attached to the metal bracket and hinge out sideways when the
30 rest of the assembly 673 is thrust forward. This action exposes the glue wheel through the front of the molded housing 682. Tension springs close the assembly and effectively cap the

glue wheel during periods of inactivity.

As the sheet 604 passes into the glue wheel assembly 673, adhesive is applied to one vertical edge on the front side (apart from the first sheet of a document) as it is transported down into the binding assembly 605.

5 *Printer Controller Architecture*

The netpage printer controller consists of a controlling processor 750, a factory-installed or field-installed network interface module 625, a radio transceiver (transceiver controller 753, baseband circuit 754, RF circuit 755, and RF resonators and inductors 756), dual raster image processor (RIP) DSPs 757, duplexed print engine controllers 760a and 760b, flash
10 memory 658, and 64 MB of DRAM 657, as illustrated in Figure 4.

The controlling processor handles communication with the network 19 and with local wireless netpage pens 101, senses the help button 617, controls the user interface LEDs 613-616, and feeds and synchronizes the RIP DSPs 757 and print engine controllers 760. It consists of a medium-performance general-purpose microprocessor. The controlling
15 processor 750 communicates with the print engine controllers 760 via a high-speed serial bus 659.

The RIP DSPs rasterize and compress page descriptions to the netpage printer's compressed page format. Each print engine controller expands, dithers and prints page images to its associated Memjet™ printhead 350 in real time (i.e. at over 30 pages per minute). The
20 duplexed print engine controllers print both sides of a sheet simultaneously.

The master print engine controller 760a controls the paper transport and monitors ink usage in conjunction with the master QA chip 665 and the ink cartridge QA chip 761, as shown in Figure 5.

The printer controller's flash memory 658 holds the software for both the processor 750 and
25 the DSPs 757, as well as configuration data. This is copied to main memory 657 at boot time.

The processor 750, DSPs 757, and digital transceiver components (transceiver controller 753 and baseband circuit 754) are integrated in a single controller ASIC 656. Analog RF components (RF circuit 755 and RF resonators and inductors 756) are provided in a
30 separate RF chip 762. The network interface module 625 is separate, since netpage printers

allow the network connection to be factory-selected or field-selected. Flash memory 658 and the 2 x 256 Mbit (64 MB) DRAM 657 is also off-chip. The print engine controllers 760 are provided in separate ASICs.

A variety of network interface modules 625 are provided, each providing a netpage network interface 751 and optionally a local computer or network interface 752. Netpage network
5 Internet interfaces include POTS modems, Hybrid Fiber-Coax (HFC) cable modems, ISDN modems, DSL modems, satellite transceivers, current and next-generation cellular telephone transceivers, and wireless local loop (WLL) transceivers. Local interfaces include
10 IEEE 1284 (parallel port), 10Base-T and 100Base-T Ethernet, USB and USB 2.0, IEEE 1394 (Firewire), and various emerging home networking interfaces. If an Internet connection is available on the local network, then the local network interface can be used as the netpage network interface.

The radio transceiver 753 communicates in the unlicensed 900 MHz band normally used by cordless telephones, or alternatively in the unlicensed 2.4 GHz industrial, scientific and
15 medical (ISM) band, and uses frequency hopping and collision detection to provide interference-free communication.

The printer controller optionally incorporates an Infrared Data Association (IrDA) interface for receiving data "squirted" from devices such as netpage cameras. In an alternative embodiment, the printer uses the IrDA interface for short-range communication with
20 suitably configured netpage pens.

Rasterization and Printing

Once the main processor 750 has received and verified the document's page layouts and page objects, it runs the appropriate RIP software on the DSPs 757.

The DSPs 757 rasterize each page description and compress the rasterized page image. The
25 main processor stores each compressed page image in memory. The simplest way to load-balance multiple DSPs is to let each DSP rasterize a separate page. The DSPs can always be kept busy since an arbitrary number of rasterized pages can, in general, be stored in memory. This strategy only leads to potentially poor DSP utilization when rasterizing short documents.

30 The infrared (IR) layer of the printed page contains coded netpage tags at a density of about

six per inch. Each tag encodes the page ID, tag ID, and control bits, and the data content of each tag is generated during rasterization and stored in the compressed page image.

The main processor 750 passes back-to-back page images to the duplexed print engine controllers 760. Each print engine controller 760 stores the compressed page image in its local memory, and starts the page expansion and printing pipeline. Page expansion and printing is pipelined because it is impractical to store an entire 114 MB bi-level CMYK+IR page image in memory.

Print Engine Controller

The page expansion and printing pipeline of the print engine controller 760 consists of a high speed IEEE 1394 serial interface 659, a standard JPEG decoder 763, a standard Group 4 Fax decoder 764, a custom halftoner/compositor unit 765, a custom tag encoder 766, a line loader/formatter unit 767, and a custom interface 768 to the Memjet™ printhead 350.

The print engine controller 360 operates in a double buffered manner. While one page is loaded into DRAM 769 via the high speed serial interface 659, the previously loaded page is read from DRAM 769 and passed through the print engine controller pipeline. Once the page has finished printing, the page just loaded is printed while another page is loaded.

The first stage of the pipeline expands (at 763) the JPEG-compressed contone CMYK layer, expands (at 764) the Group 4 Fax-compressed bi-level black layer, and renders (at 766) the bi-level netpage tag layer according to the tag format defined in section 1.2, all in parallel. The second stage dithers (at 765) the contone CMYK layer and composites (at 765) the bi-level black layer over the resulting bi-level CMYK layer. The resultant bi-level CMYK+IR dot data is buffered and formatted (at 767) for printing on the Memjet™ printhead 350 via a set of line buffers. Most of these line buffers are stored in the off-chip DRAM. The final stage prints the six channels of bi-level dot data (including fixative) to the Memjet™ printhead 350 via the printhead interface 768.

When several print engine controllers 760 are used in unison, such as in a duplexed configuration, they are synchronized via a shared line sync signal 770. Only one print engine 760, selected via the external master/slave pin 771, generates the line sync signal 770 onto the shared line.

The print engine controller 760 contains a low-speed processor 772 for synchronizing the

page expansion and rendering pipeline, configuring the printhead 350 via a low-speed serial bus 773, and controlling the stepper motors 675, 676.

In the 8 1/2" versions of the netpage printer, the two print engines each prints 30 Letter pages per minute along the long dimension of the page (11"), giving a line rate of 8.8 kHz
5 at 1600 dpi. In the 12" versions of the netpage printer, the two print engines each prints 45 Letter pages per minute along the short dimension of the page (8 1/2"), giving a line rate of 10.2 kHz. These line rates are well within the operating frequency of the Memjet™ printhead; which in the current design exceeds 30 kHz.

Printing Product Labels and Packaging

10 The printer 601, or a variant thereof, may be used to print product codes, product information and product graphics onto the label, packaging or actual surface of a product before, during or after its manufacture and/or assembly.

The printer may be an add-on infrared printer which prints barcodes and/or netpage tags after text and graphics have been printed by other means, or an integrated color and infrared
15 printer which prints the omnitags, text and graphics simultaneously. Digitally-printed text and graphics may include everything on the label or packaging, or may consist only of the variable portions, with other portions still printed by other means. Thus the printer with an infrared and black printing capability can displace an existing digital printer used for variable data printing, such as a conventional thermal transfer or inkjet printer.

20 The printer is typically controlled by a host computer, which supplies the printer with fixed and/or variable text and graphics as well as item ids for inclusion in the omnitags. The host may provide real-time control over the printer, whereby it provides the printer with data in real time as printing proceeds. As an optimisation, the host may provide the printer with fixed data before printing begins, and only provide variable data in real time. The printer
25 may also be capable of generating per-item variable data based on parameters provided by the host. For example, the host may provide the printer with a base item ID prior to printing, and the printer may simply increment the base item ID to generate successive item ids. Alternatively, memory in the ink cartridge or other storage medium inserted into the printer may provide a source of unique item ids, in which case the printer reports the
30 assignment of items ids to the host computer for recording by the host.

Alternatively still, the printer may be capable of reading a pre-existing item ID from the

label onto which the omnitags are being printed, assuming the unique ID has been applied in some form to the label during a previous manufacturing step. For example, the item ID may already be present in the form of a visible 2D bar code, or encoded in an RFID tag. In the former case the printer can include an optical bar code scanner. In the latter case it can
5 include an RFID reader.

The printer may also be capable of rendering the item ID in other forms. For example, it may be capable of printing the item ID in the form of a 2D bar code, or of printing the product ID component of the item ID in the form of a linear bar code, or of writing the item ID to a writable or write-once RFID tag.

10 **Conclusion**

The invention has been described herein with reference to the specific examples only. Skilled workers in this field will readily recognize many variations and modifications, which do not depart from the spirit and scope of the broad inventive concept.

15 Furthermore, it will be appreciated by a person skilled in the art that the cartridge disclosed in the present application may be implemented or used in any printing device where the printing device uses a cartridge. For example, the printing device may be a desktop printer, a workgroup printer, a network printer, a short-run digital printer, or a printer integrated in a mobile device such as a personal digital assistant or a mobile or
20 cellular phone. Such devices and printers are the subject of granted US patents and co-pending US patent applications, details of which are provided in the cross reference section of the present specification.

CLAIMS:

1. A cartridge including identifier data that is indicative of at least one identifier, the cartridge being configured for use in a printer capable of printing machine-readable coded data onto a surface, the printer including:
 - 5 an interface for receiving the cartridge;
 - a reader for reading the identifier data;
 - a coded data generator for determining the at least one identifier from the identifier data and for generating coded data on the basis of the at least one identifier; and
 - at least one printing mechanism for printing the coded data onto a substrate.
- 10 2. A cartridge according to claim 1, wherein the identifier data is indicative of a range of identifiers.
3. A cartridge according to claim 2, wherein in the range is defined by a base identifier
15 and a count.
4. A cartridge according to claim 1, configured to record consumption of identifiers as they are used by the printer.
- 20 5. A cartridge according to claim 4, wherein the identifier data is indicative of a range of identifiers defined by a base identifier and a count, consumption of the identifiers being recorded by reducing the count.
6. A cartridge according to claim 1, further including one or more reservoirs
25 containing one or more of the following substances:
 - black ink
 - coloured ink;
 - infrared ink;
 - fixative; and
 - 30 adhesive.

7. A cartridge according to claim 6, wherein the identifier data is indicative of sufficient identifiers to identify at least as many pages as printable, on average, using at least one of the substances in the one or more reservoirs.
- 5 8. A cartridge according to any one of the preceding claims, wherein the reader is an optical reader and the identifier data is disposed on or in the cartridge in an optically readable form.
9. A cartridge according to claim 8, where the identifier data is encoded in any of the
10 following forms:
bar code;
CD-ROM;
DVD-ROM; and
optically-readable data card.
- 15
10. A cartridge according to any one of claims 1 to 7, wherein the reader is a magnetic reader and the identifier data is disposed on or in the cartridge in a magnetically readable form.
- 20 11. A cartridge according to claim 5, wherein the reader is a magnetic reader and the identifier data is disposed on or in the cartridge in a magnetically readable form, and wherein the printer includes a magnetic writer for magnetically writing or rewriting the count on or in the cartridge.
- 25 12. A cartridge according to any one of claims 1 to 7, wherein the reader is electronic reading circuitry, and the identifier data is incorporated in memory associated with the cartridge.
13. A cartridge according to claim 12, wherein the memory is non-volatile magnetic or
30 solid-state memory

14. A cartridge according to claim 5, wherein the reader is electronic reading circuitry, the identifier data is incorporated in memory associated with the cartridge, and wherein the printer includes an electronic writer for electronically writing or rewriting the count in the memory.

5

15. A cartridge according to any one of the preceding claims, wherein the identifiers are encrypted in the identifier data using an encryption key.

16. A method of using a printer to print machine-readable coded data, the method
10 including the steps of:

in the printer, obtaining identifier data from a cartridge operatively positioned in relation to the printer, the identifier data being indicative of identifiers;

encoding the identifiers in coded data; and

printing the coded data

15

17. A method according to claim 16, further including the step of recording, in or on the cartridge, consumption of the identifiers.

18. A method according to claim 16 or 17, including the step of reporting, to a computer
20 system, consumption of the identifiers.

19. A method according to claim 18, further including the step of reporting, to the computer system, which identifier or identifiers have been used in relation to some or all of a print job processed by the printer.

25

20. A method according to claim 19, further including the step of receiving an identifier from the computer system as part of the print job.

21. A method according to claim 16, including the step of sending, to a computer
30 system, some or all of the identifiers obtained from the identifier data.

22. A method according to claim 16, including the step of recording, in a computer system, that one or more of the identifiers have been used.

23. A method according to claim 16 or 17 or 18, including the step of recording, in a computer system, an association between one or more of the identifiers and content of a page or document printed by the printer.

24. A printer for printing machine-readable coded data onto a surface, the printer including:

10 an interface for receiving a cartridge, the cartridge having identifier data that is indicative of one or more identifiers; and

a reader for reading the identifier data;

a coded data generator for determining at least one identifier from the identifier data and generating coded data on the basis of the at least one identifier; and

15 at least one printing mechanism for printing the coded data onto a substrate.

25. A printer according to claim 24, configured to report, to a computer system, consumption of the identifiers.

20 26. A printer according to claim 25, configured to report, to the computer system, which identifier or identifiers have been used in relation to some or all of a print job processed by the printer.

27. A printer according to claim 26, configured to receive an identifier from the computer system as part of the print job.

28. A printer according to claim 24, configured to send, to a computer system, some or all of the identifiers obtained from the identifier data.

30 29. A printer according to claim 24, including writing means for recording, in or on the cartridge, consumption of the identifiers.

30. A printer according to claim 28, configured to report, to a computer system, consumption of the identifiers.

31. A printer according to claim 30, configured to report, to the computer system, which
5 identifier or identifiers have been used in relation to some or all of a print job processed by the printer.

32. A printer according to claim 30, configured receive an identifier from the computer system as part of the print job.

10

33. A printer according to claim 28, configured to send, to a computer system, some or all of the identifiers obtained from the identifier data.

34. A printer according to claim 24, wherein the coded data includes the identifiers.

15

37. A printer according to claim 34, wherein the cartridge includes at least one coded data ink reservoir containing coded data ink, the printing mechanism being configured to use the coded data ink to print the coded data.

20 38. A printer according to claim 37, wherein the identifier data is indicative of a predetermined amount of the coded data.

39. A printer according to claim 38, wherein the predetermined amount is of an order of the amount of coded data the printer is capable of printing using the ink in the cartridge.

25

40. A printer according to any one of claims 37 to 39, wherein the coded data ink is substantially invisible to an unaided human.

41. A printer according to claim 40, wherein the coded data ink is absorptive in the
30 infrared spectrum.

42. A printer according to any one of the claims 24 to 41, wherein the cartridge includes at least one visible ink reservoir containing visible ink, the printing mechanism being configured to use the visible ink to print visibly on the substrate.

5 43. A printer according to claim 42, the printing mechanism being configured to print the coded data ink and the visible ink substantially simultaneously.

44. A printer according to any one of claims 24 to 43, wherein the coded data includes one or more tags.

10

45. A printer according to claim 44, wherein each tag is indicative of an identity of a document with which it is printed.

46. A printer according to claim 44 or 45, wherein each tag is indicative of a location of
15 that tag in relation to a document with which it is printed.

47. A printer according to any one of claims 24 to 46, wherein the reader is an optical scanner and the identifier data takes the form of optically scannable information on the cartridge.

20

48. A printer according to claim 46, wherein the identifier data takes the form of a bar code.

49. A printer according to any one of claims 24 to 46, wherein the reader is a magnetic
25 scanner and the identifier data is a magnetic pattern on the cartridge.

50. A printer according to any one of claims 24 to 46, wherein the reader is electronic reading circuitry, and the identifier data is incorporated in memory associated with the cartridge.

30

51. A printer according to claim 50, wherein the coded data is encrypted into the identifier data using an encryption key, to impede extraction of the coded data from the identity data.

5 52. A cartridge according to claim 1, wherein the coded data is indicative of an identity of at least a region of the surface.

53. A cartridge according to claim 52, wherein the coded data is also indicative of at least one reference point of the surface.

10

54. A cartridge according to claim 1, wherein the base identifier is an initial value to be used by the printer in an algorithm for generating the coded data.

15 55. A method according to claim 16, wherein the identifier data includes a base identifier, the printer being configured to use the base identifier in an algorithm for generating further identifiers for the coded data.

56. A method according to claim 55, wherein the algorithm is a recursive algorithm and the initial identifier is used as a seed value for the algorithm.

20

57. A method according to claim 56, wherein the recursive algorithm outputs a sequence of identifiers upon which the coded data is based.

58. A method according to claim 57, wherein the sequence is pseudo-random.

25

59. A method according to claim 58, wherein the base identifier is a seed value for a linear feedback shift register (LFSR), the method including the steps of:

loading the LFSR with initial data based on the initial identifier; and

generating identifiers based on the contents of the LFSR as it is clocked.

30

60. A method according to claim 54, wherein the printer is configured to record usage of ink, new identifiers only being generated until a predetermined amount of the ink is determined to have been used by the printer.
- 5 61. A method according to claim 60, wherein the ink is provided in one or more reservoirs of the cartridge.
62. A method according to claim 16, including the steps of:
determining a base identifier based on the identifier data and generating some of the
10 coded data based on the base identifier;
determining subsequent identifiers by incrementing or decrementing the current identifier, and generating further coded data based on the subsequent identifiers.
63. A method according to claim 62, including the step of recording usage of ink by the
15 printer, new coded data only being generated until a predetermined amount of the ink is determined to have been used by the printer.
64. A method according to claim 63, wherein the ink is provided in one or more reservoirs of the cartridge.
- 20 65. A method according to claim 63, including overwriting each current identifier with the next subsequent identifier.
66. A method according to claim 65, wherein the cartridge includes non-volatile
25 memory and the overwriting step includes overwriting the current identifier stored in the memory.

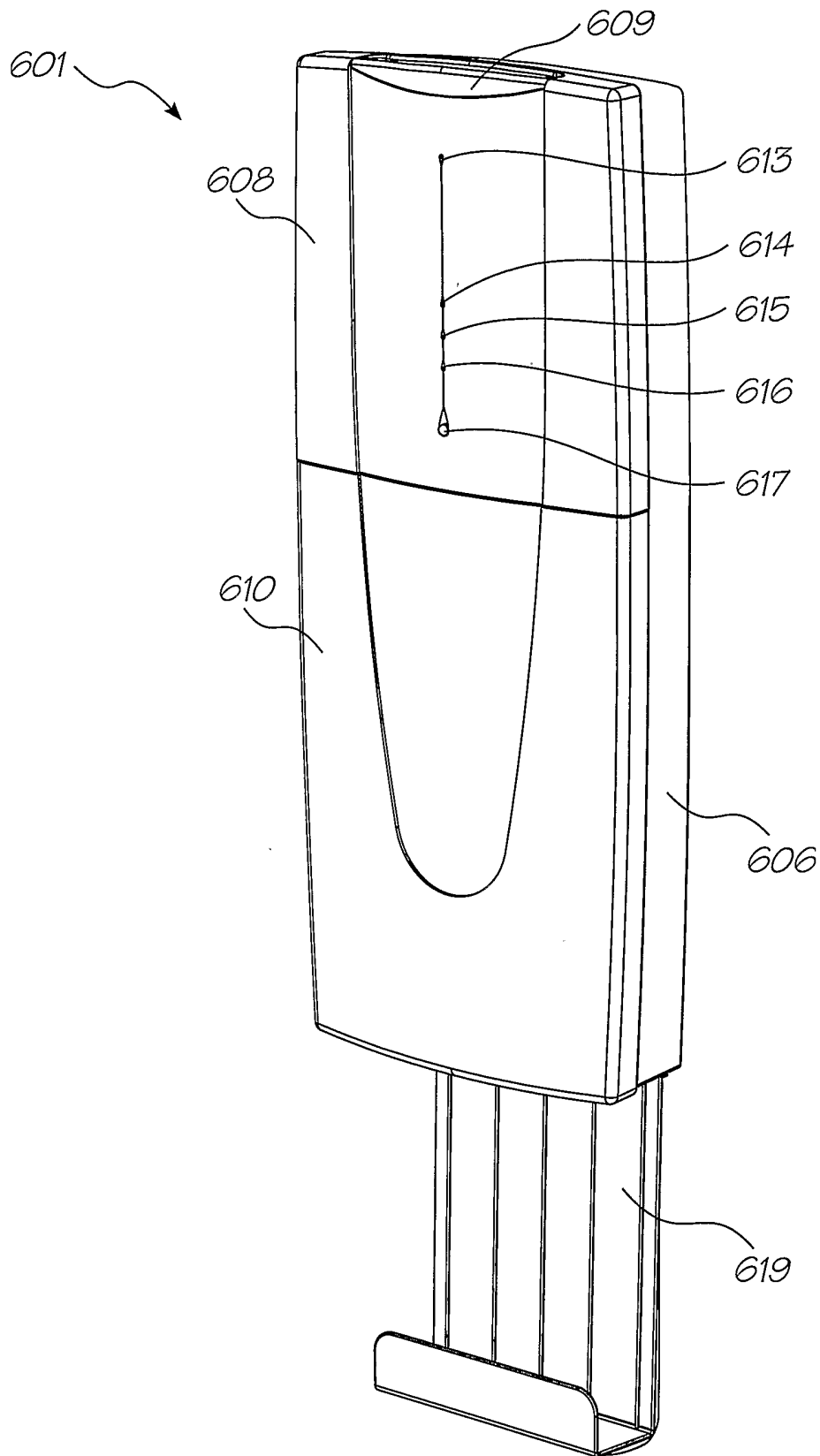

FIG. 1

2/13

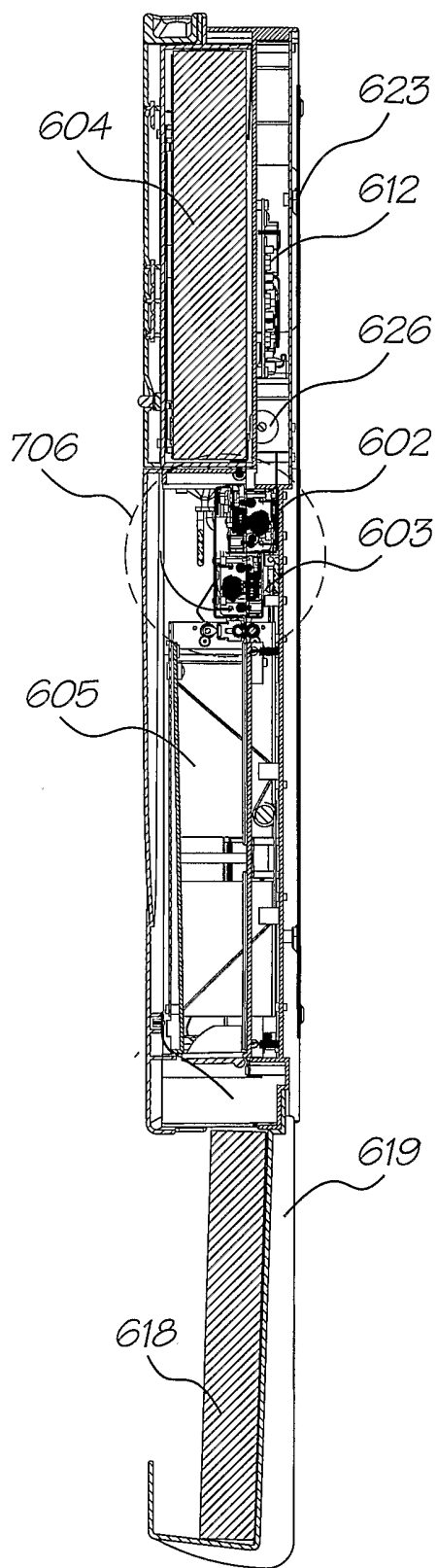

FIG. 2

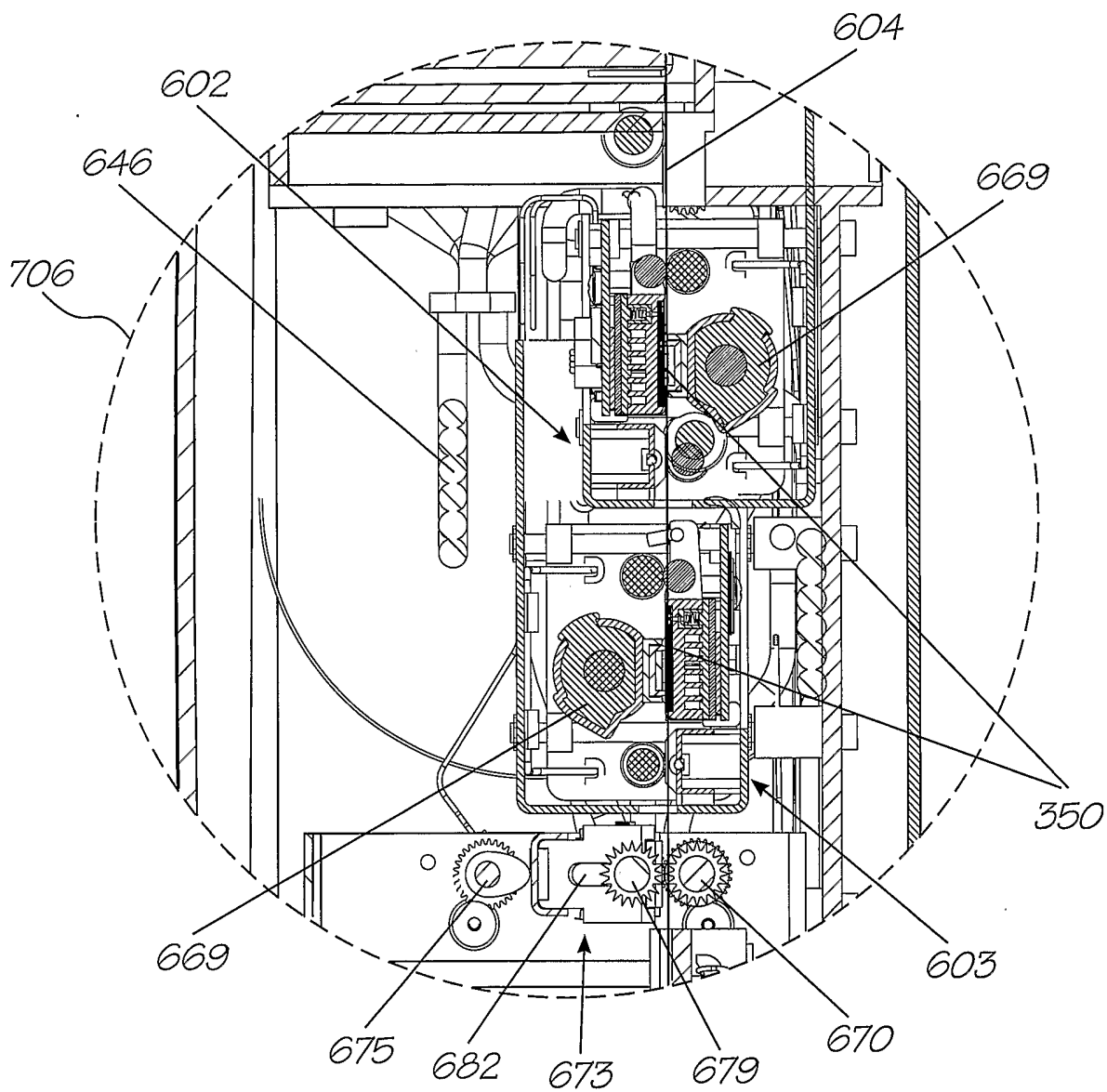

FIG. 2a

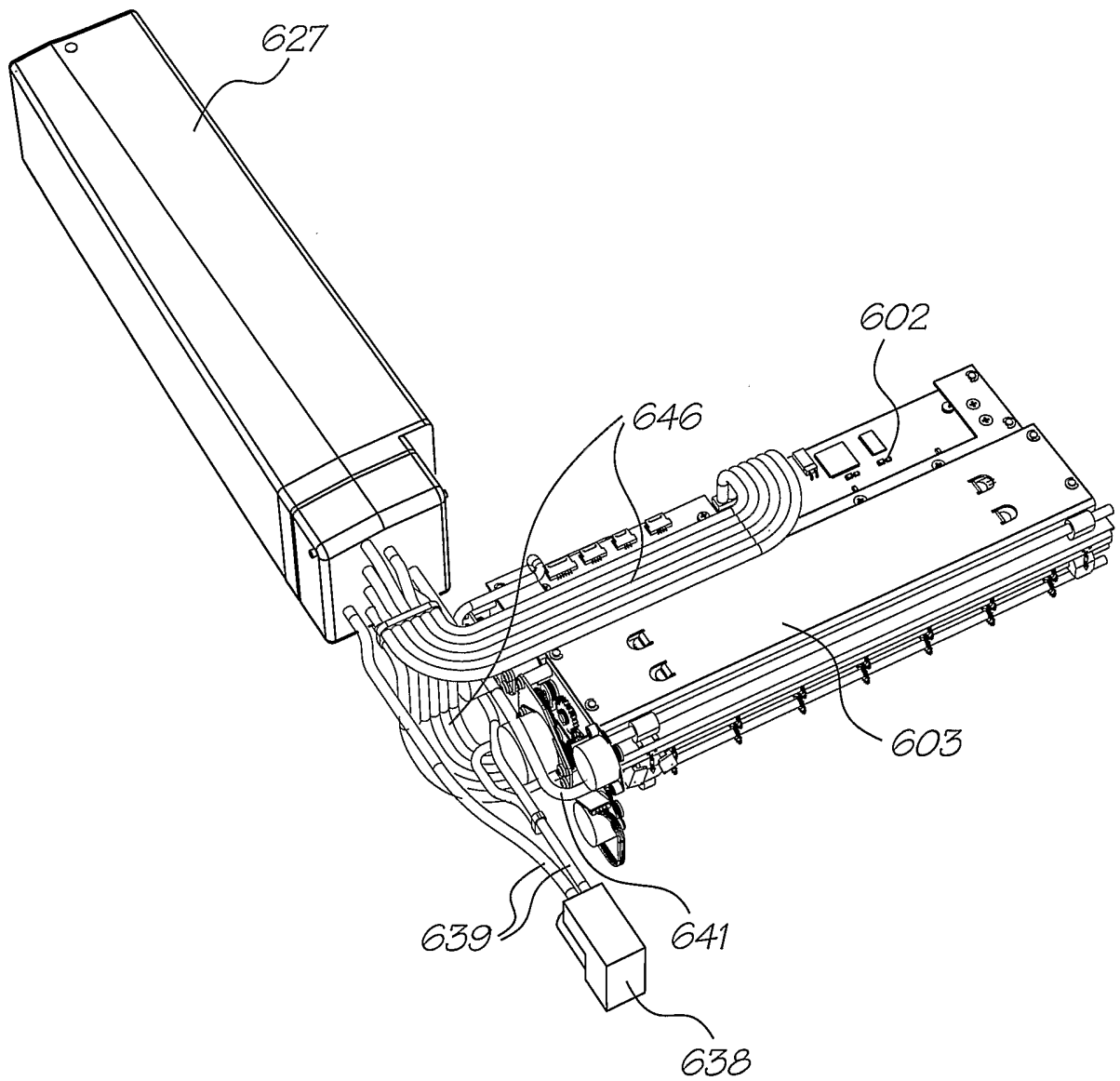

FIG. 3

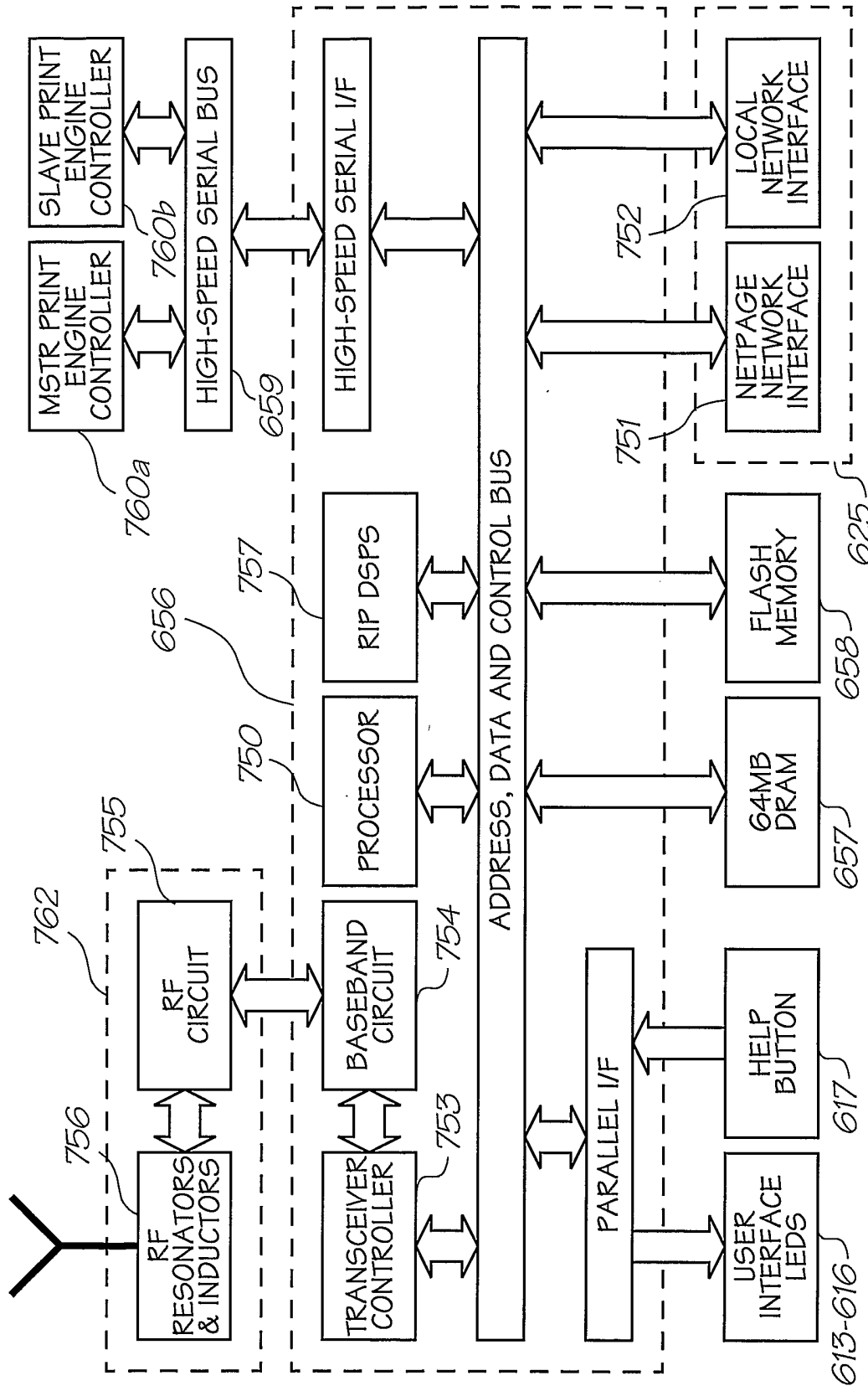

FIG. 4

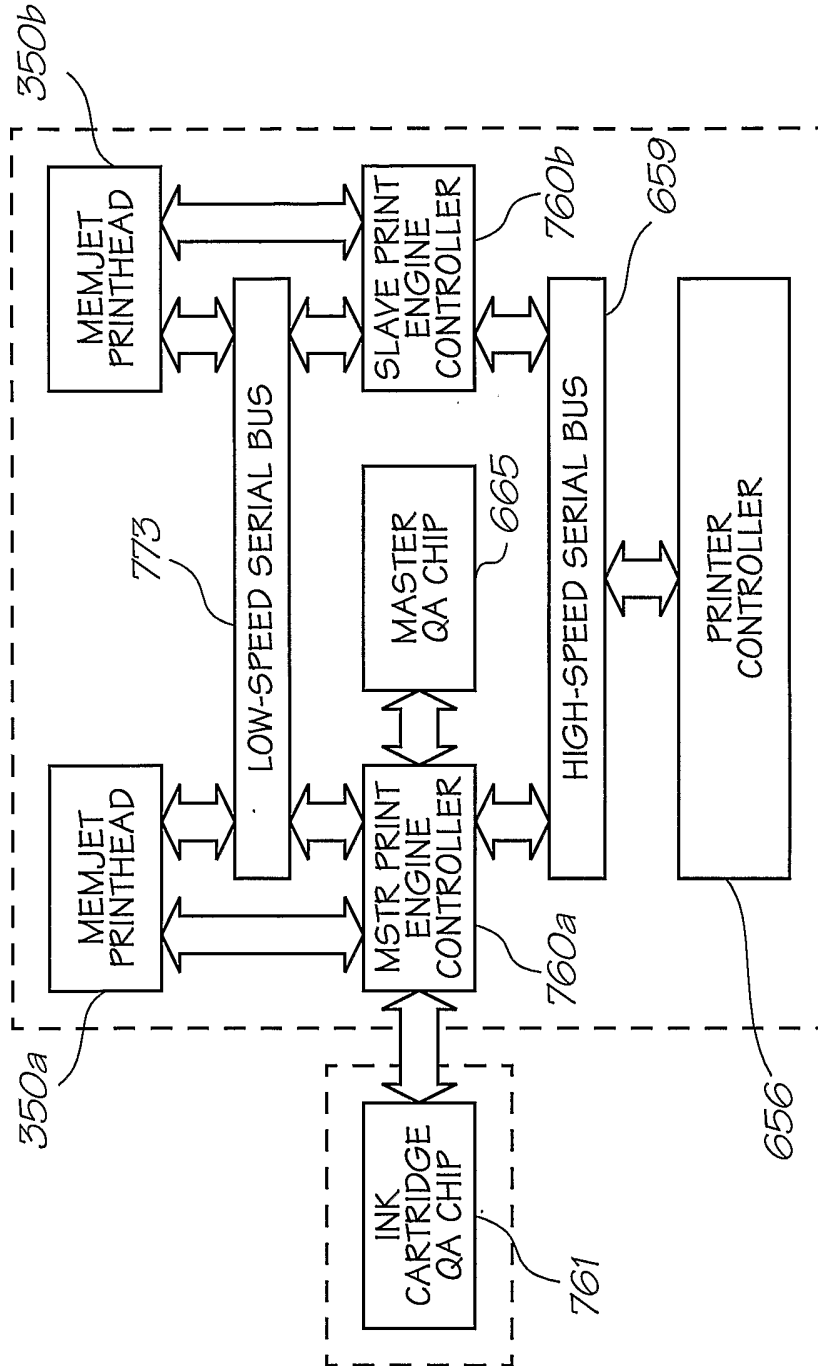

FIG. 5

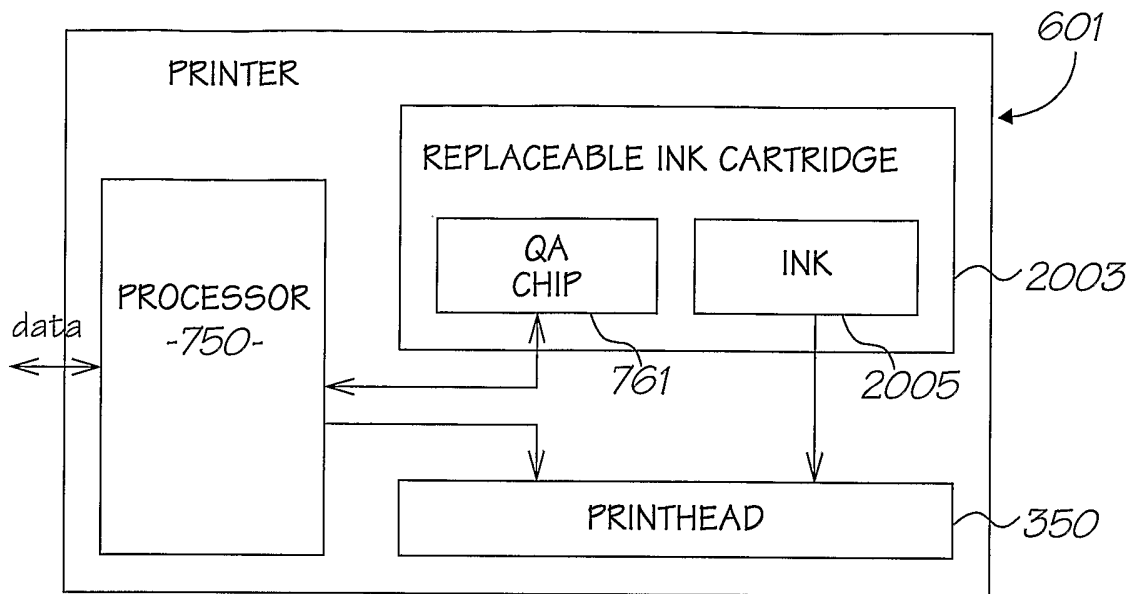

FIG. 6

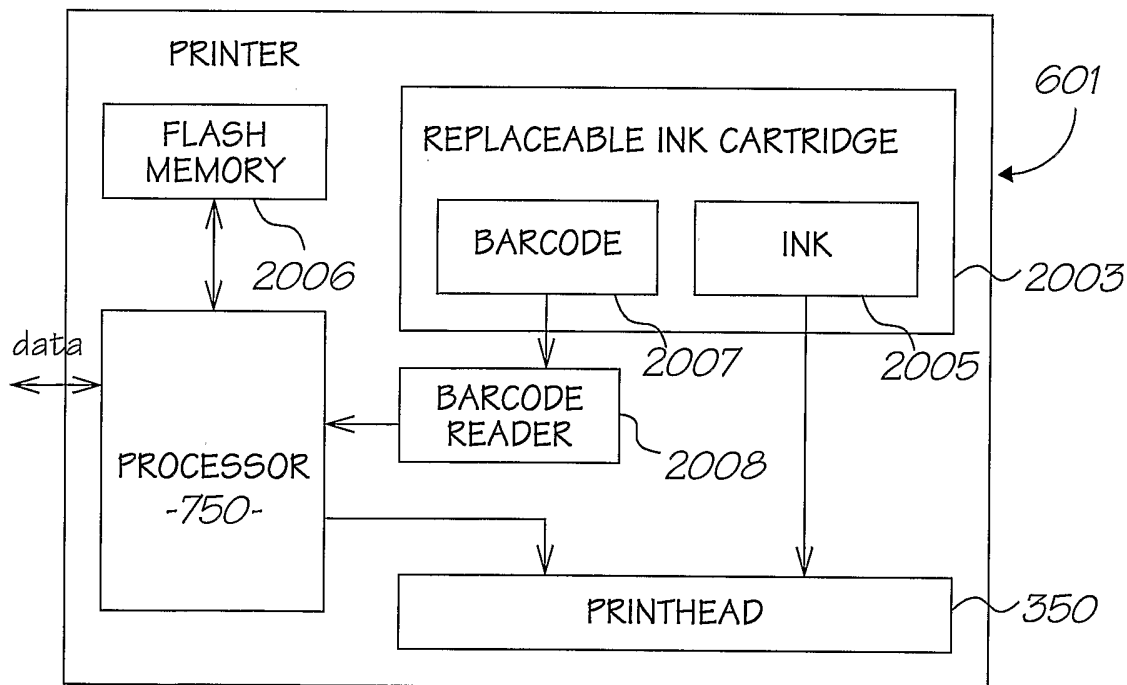

FIG. 7

8/13

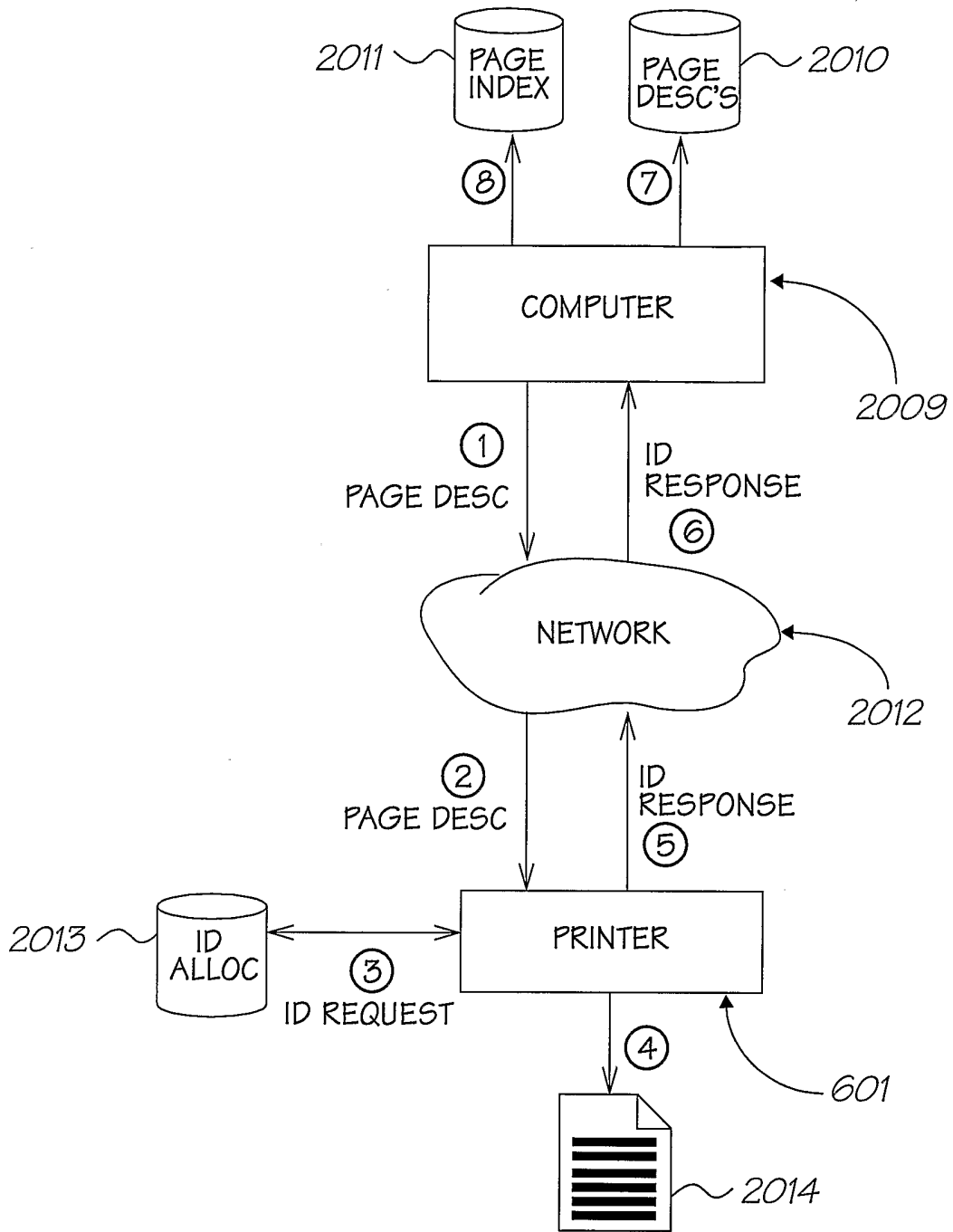

FIG. 8

9/13

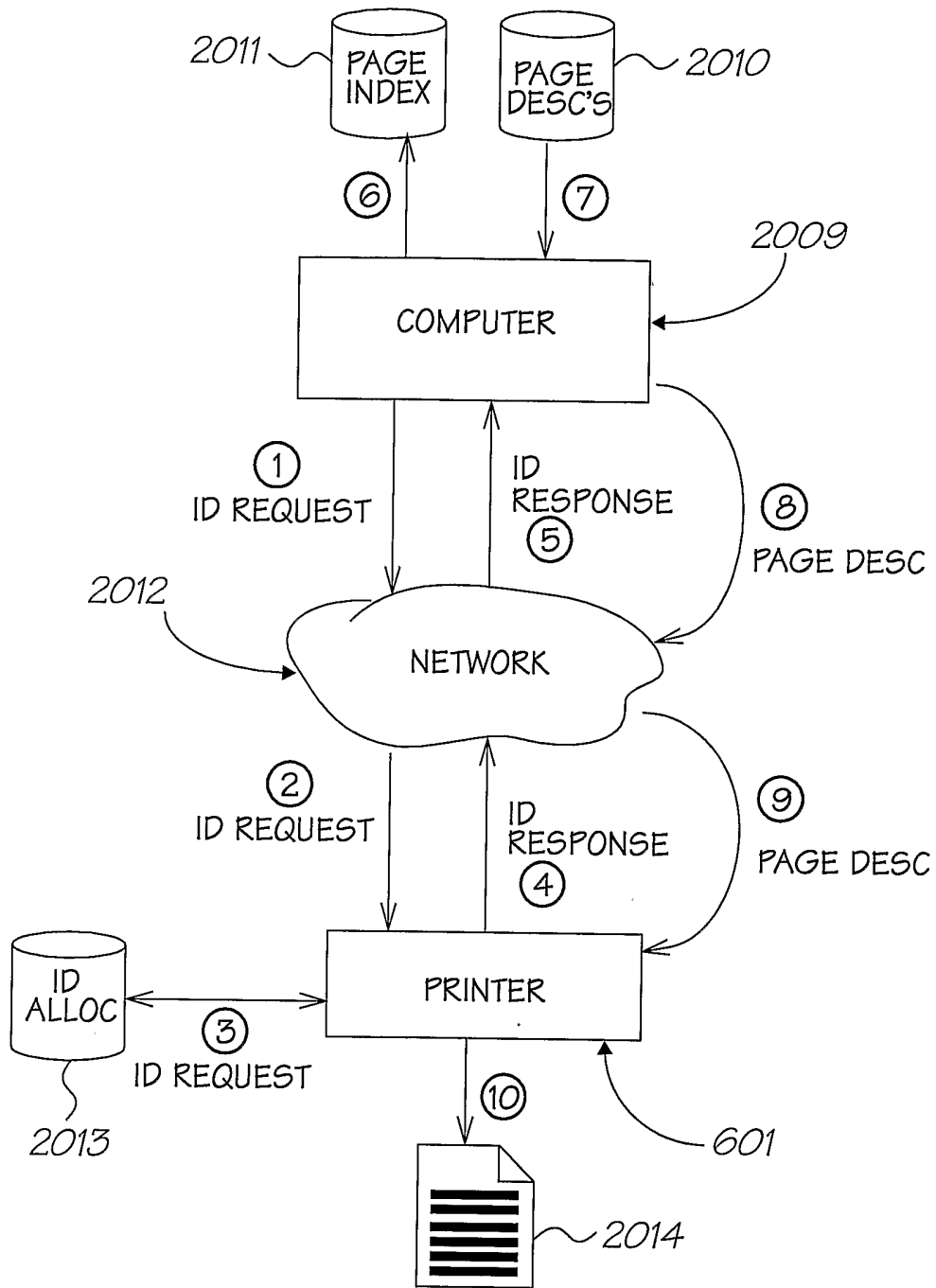

FIG. 9

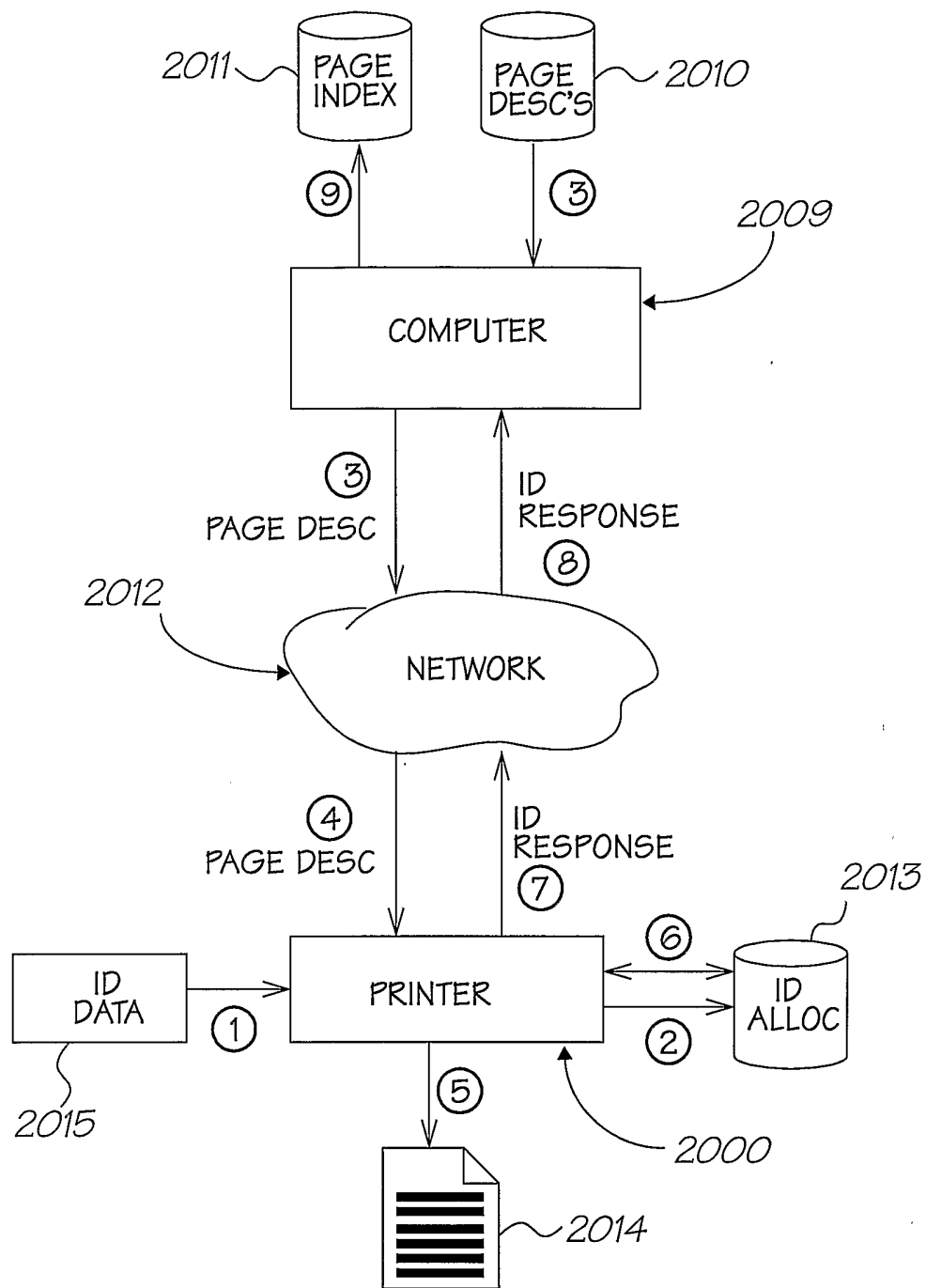

FIG. 10

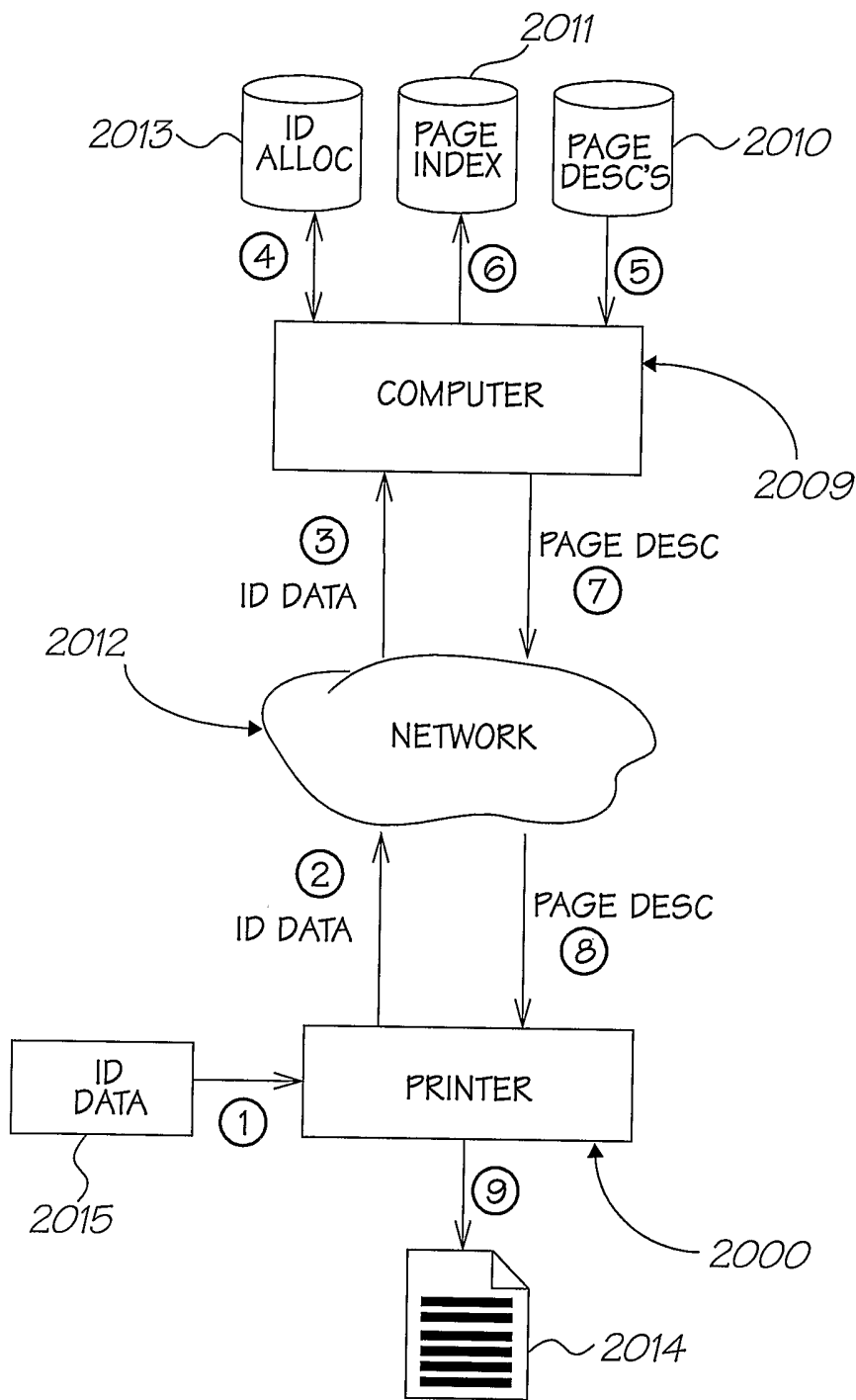

FIG. 11

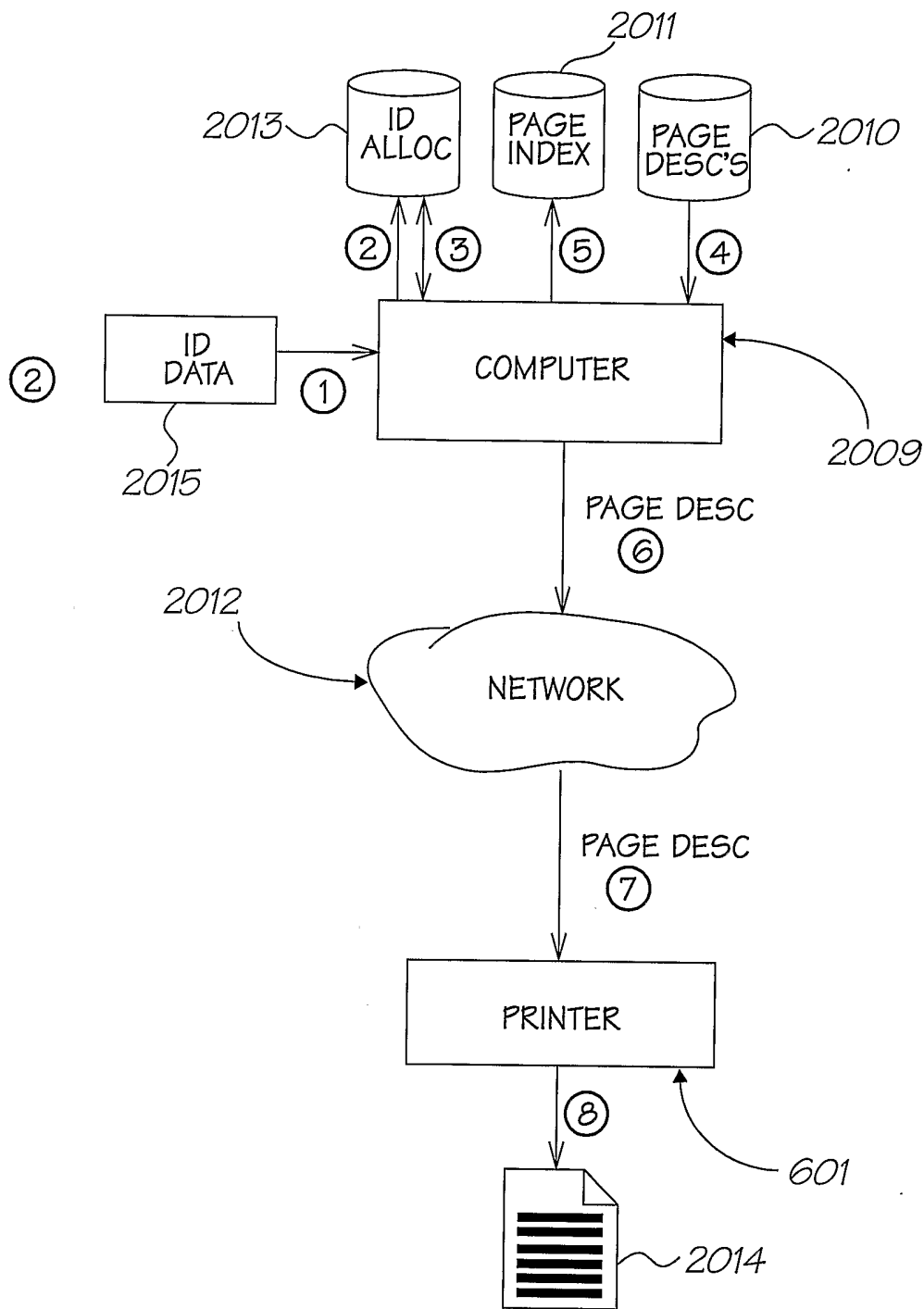

FIG. 12

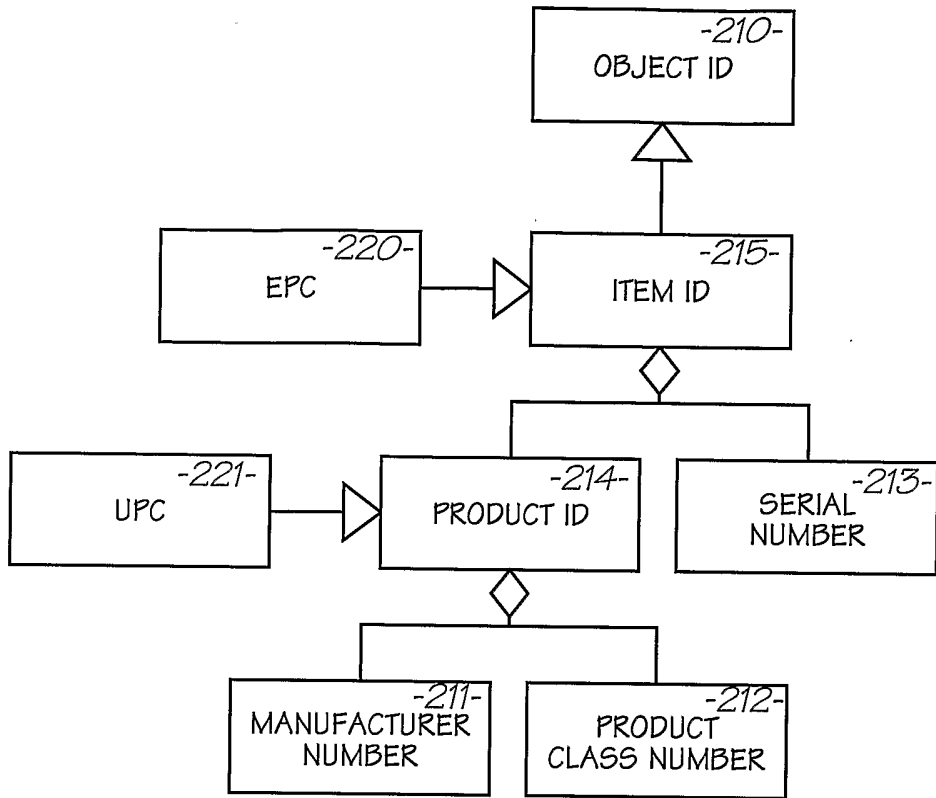

FIG. 13

INTERNATIONAL SEARCH REPORT

International application No.

PCT/AU2004/001144

A. CLASSIFICATION OF SUBJECT MATTER		
Int. Cl. ⁷ : B41J 2/175		
According to International Patent Classification (IPC) or to both national classification and IPC		
B. FIELDS SEARCHED		
Minimum documentation searched (classification system followed by classification symbols)		
Documentation searched other than minimum documentation to the extent that such documents are included in the fields searched		
Electronic data base consulted during the international search (name of data base and, where practicable, search terms used)		
DWPI: IPC B41J & keywords: print, cartridge, code, identifies, ID, tag, data, machine-readable, interface and similar terms.		
C. DOCUMENTS CONSIDERED TO BE RELEVANT		
Category*	Citation of document, with indication, where appropriate, of the relevant passages	Relevant to claim No.
A	WO 2003/013869 A2 (SILVERBROOK RESEARCH PTY LTD) 20 February 2003 Whole document	1-66
A	WO 2003/013866 A1 (SILVERBROOK RESEARCH PTY LTD) 20 February 2003 Whole document	1-66
A	US 2003/0059246 A1 (CLAYVON ET AL) 27 March 2003 Whole document	1-66
A	Derwent Abstract Accession No 2001-252418/26, Class P75;T04, JP 2001047638 A (XEROX CORP) 20 February 2001 Abstract	1-66
<input type="checkbox"/> Further documents are listed in the continuation of Box C <input checked="" type="checkbox"/> See patent family annex		
* Special categories of cited documents: "A" document defining the general state of the art which is not considered to be of particular relevance "E" earlier application or patent but published on or after the international filing date "L" document which may throw doubts on priority claim(s) or which is cited to establish the publication date of another citation or other special reason (as specified) "O" document referring to an oral disclosure, use, exhibition or other means "P" document published prior to the international filing date but later than the priority date claimed "T" later document published after the international filing date or priority date and not in conflict with the application but cited to understand the principle or theory underlying the invention "X" document of particular relevance; the claimed invention cannot be considered novel or cannot be considered to involve an inventive step when the document is taken alone "Y" document of particular relevance; the claimed invention cannot be considered to involve an inventive step when the document is combined with one or more other such documents, such combination being obvious to a person skilled in the art "&" document member of the same patent family		
Date of the actual completion of the international search 5 October 2004		Date of mailing of the international search report 8 OCT 2004
Name and mailing address of the ISA/AU AUSTRALIAN PATENT OFFICE PO BOX 200, WODEN ACT 2606, AUSTRALIA E-mail address: pct@ipaustalia.gov.au Facsimile No. (02) 6285 3929		Authorized officer KAREN VIOLANTE Telephone No : (02) 6283 7933

INTERNATIONAL SEARCH REPORT

Information on patent family members

International application No.

PCT/AU2004/001144

This Annex lists the known "A" publication level patent family members relating to the patent documents cited in the above-mentioned international search report. The Australian Patent Office is in no way liable for these particulars which are merely given for the purpose of information.

Patent Document Cited in Search Report		Patent Family Member					
WO	2003/013869	AU	83227/98	AU	83235/98	CA	2296385
		CA	2296439	CA	2399470	CA	2456652
		CA	2456692	CA	2456707	CA	2456714
		CA	2456728	CA	2456729	CA	2456735
		CA	2456739	CA	2456778	CA	2456779
		EP	0997033	EP	1021794	EP	1303413
		EP	1414650	EP	1425175	EP	1425178
		EP	1425179	EP	1425180	EP	1425181
		EP	1425182	EP	1444822	US	6071750
		US	6087638	US	6106147	US	6110754
		US	6137500	US	6152619	US	6171875
		US	6180427	US	6188415	US	6190931
		US	6195150	US	6196541	US	6196739
		US	6213588	US	6213589	US	6214244
		US	6217153	US	6217165	US	6220694
		US	6224780	US	6225138	US	6227648
		US	6227653	US	6227654	US	6228668
		US	6231163	US	6231772	US	6231773
		US	6234609	US	6235211	US	6235212
		US	6238040	US	6238044	US	6239821
		US	6241342	US	6241904	US	6241905
		US	6241906	US	6245246	US	6247792
		US	6247796	US	6248248	US	6248249
		US	6251298	US	6254220	US	6254793
		US	6257704	US	6258284	US	6258285
		US	6260953	US	6264306	US	6264307
		US	6264849	US	6264850	US	6267904
		US	6267905	US	6270182	US	6271931
		US	6283582	US	6284147	US	6286935
		US	6287028	US	6289262	US	6290861
		US	6290862	US	6293658	US	6294101
		US	6299300	US	6299786	US	6302528

INTERNATIONAL SEARCH REPORT

Information on patent family members

International application No.

PCT/AU2004/001144

US	6304291	US	6305770	US	6312070
US	6312615	US	6315200	US	6317192
US	6318849	US	6322181	US	6329990
US	6331258	US	6331946	US	6334190
US	6336710	US	6338547	US	6340222
US	6350023	US	6353772	US	6356715
US	6357135	US	6362868	US	6362869
US	6366693	US	6374354	US	6381361
US	6382769	US	6398328	US	6402300
US	6412914	US	6412993	US	6415054
US	6416154	US	6416167	US	6416679
US	6425651	US	6431669	US	6431704
US	6439694	US	6442525	US	6451216
US	6472052	US	6476863	US	6486886
US	6491833	US	6542645	US	6557977
US	6565762	US	6597817	US	6614560
US	6624848	US	6636216	US	6644771
US	6646757	US	6665008	US	6665454
US	6690416	US	6690419	US	6727948
US	6727951	US	6750901	US	6788336
US	2001006394	US	2001008406	US	2001008408
US	2001009430	US	2001012035	US	2001022599
US	2001022600	US	2001026302	US	2001028377
US	2001038403	US	2001040602	US	2001040604
US	2001040605	US	2001040607	US	2001043253
US	2001045969	US	2001048509	US	2001050701
US	2002030712	US	2002030713	US	2002033854
US	2002041309	US	2002044814	US	2002051037
US	2002060714	US	2002060719	US	2002071066
US	2002071104	US	2002080335	US	2002149647
US	2002149648	US	2002154184	US	2002154189
US	2002154193	US	2002154194	US	2002158924
US	2002163559	US	2002180834	US	2002180857
US	2003056668	US	2003058418	US	2003063159
US	2003063160	US	2003068185	US	2003071012
US	2003071875	US	2003076383	US	2003085954
US	2003090542	US	2003090543	US	2003101559

INTERNATIONAL SEARCH REPORT

Information on patent family members

International application No.

PCT/AU2004/001144

US	2003103097	US	2003103109	US	2003112419
US	2003117460	US	2003117496	US	2003118387
US	2003142220	US	2003169344	US	2003174241
US	2003189620	US	2003202048	US	2003207478
US	2003210300	US	2004004129	US	2004004651
US	2004004698	US	2004008237	US	2004008261
US	2004008262	US	2004008327	US	2004031773
US	2004032512	US	2004032514	US	2004032515
US	2004032524	US	2004032526	US	2004041018
US	2004049468	US	2004051753	US	2004056105
US	2004056959	US	2004061734	US	2004062588
US	2004062590	US	2004065738	US	2004069743
US	2004070648	US	2004075747	US	2004075821
US	2004080575	US	2004080581	US	2004080620
US	2004084405	US	2004085402	US	2004085403
US	2004090493	US	2004090494	US	2004090553
US	2004095361	US	2004095431	US	2004095435
US	2004095436	US	2004100518	US	2004104971
US	2004104972	US	2004113986	US	2004119775
US	2004119827	US	2004119828	US	2004119829
US	2004125209	US	2004125212	US	2004129789
US	2004130599	US	2004135848	US	2004141061
US	2004145630	US	2004145662	US	2004145756
US	2004159710	US	2004160524	US	2004165034
US	2004168071	US	2004172532	US	2004174432
US	2004179068	US	2004179072	US	2004183914
WO	2002/02333	WO	1999/04368	WO	1999/04551
WO	2003/013858	WO	2003/013860	WO	2003/013861
WO	2003/013862	WO	2003/013863	WO	2003/013864
WO	2003/013865	WO	2003/013866	WO	2003/015395
WO	2003/013866	AS ABOVE			
US	2003005924	CA	2446904	CA	2446916
		CA	2446990	CA	2447081
		CA	2447166	CA	2447210
		CA	2447519	CA	2447521
		CA	2462576	CZ	20033223
		EP	1389094	EP	1389095
				CA	2446917
				CA	2447099
				CA	2447354
				CA	2460343
				CZ	20033249
				EP	1389096

INTERNATIONAL SEARCH REPORT

Information on patent family members

International application No.

PCT/AU2004/001144

EP	1389097	EP	1389098	EP	1389099
EP	1390021	EP	1392242	EP	1392257
EP	1392258	EP	1392259	EP	1392260
EP	1392261	EP	1392262	EP	1392263
EP	1392264	EP	1392381	EP	1446102
EP	1455875	HU	0401008	US	6744322
US	2003000518	US	2003005925	US	2003007933
US	2003007934	US	2003012737	US	2003012738
US	2003012740	US	2003015189	US	2003015190
US	2003015196	US	2003015197	US	2003017114
US	2003017115	US	2003017116	US	2003017117
US	2003017118	US	2003017119	US	2003017120
US	2003021753	US	2003021754	US	2003021755
US	2003032638	US	2003035776	US	2003051728
US	2003062042	US	2003091511	US	2003118512
US	2003131843	US	2003138382	US	2003138508
US	2003206869	US	2003209240	US	2004096402
US	2004099269	US	2004126326	US	2004126327
US	2004126328	US	2004126329	US	2004127481
US	2004127490	US	2004156788	US	2004156789
US	2004156790	US	2004156791	US	2004161385
US	2004167228	US	2004170569	US	2004170570
US	2004170571	US	2004170572	US	2004170573
US	2004171609	US	2004184996	US	2004184997
US	2004184998	US	2004184999	US	2004185000
US	2004185001	US	2004185002	US	2004185003
US	2004185004	US	2004185005	US	2004185006
US	2004185007	US	2004185008	US	2004186130
US	2004191179	US	2004191180	US	2004191181
US	2004191182	US	2004191183	US	2004191184
US	2004191185	WO	2002/094216	WO	2002/094218
WO	2002/094219	WO	2002/094229	WO	2002/094230
WO	2002/094231	WO	2002/094232	WO	2002/094233
WO	2002/094234	WO	2002/094235	WO	2002/094236
WO	2002/094237	WO	2002/094238	WO	2002/094239
WO	2002/094240	WO	2002/094241	WO	2002/094242
WO	2002/094243	WO	2002/094244	WO	2002/094245

INTERNATIONAL SEARCH REPORT

Information on patent family members

International application No.

PCT/AU2004/001144

	WO	2002/094246	WO	2002/098389	WO	2002/098390
	WO	2002/098496	WO	2003/026631	WO	2003/037307
	WO	2003/041693	WO	2003/045484	WO	2003/051367
	WO	2003/057188	WO	2003/063339	WO	2003/095012
JP	2001047638	NONE				
Due to data integration issues this family listing may not include 10 digit Australian applications filed since May 2001.						
END OF ANNEX						