

(12) STANDARD PATENT
(19) AUSTRALIAN PATENT OFFICE

(11) Application No. **AU 2011207974 B2**

(54) Title
Disposable pants-type wearing article

(51) International Patent Classification(s)
A61F 13/496 (2006.01) **A61F 13/49** (2006.01)
A61F 13/15 (2006.01)

(21) Application No: **2011207974** (22) Date of Filing: **2011.01.21**

(87) WIPO No: **WO11/090170**

(30) Priority Data

(31)	Number	(32)	Date	(33)	Country
	2010-011403		2010.01.21		JP

(43) Publication Date: **2011.07.28**

(44) Accepted Journal Date: **2015.04.09**

(71) Applicant(s)
Unicharm Corporation

(72) Inventor(s)
Otsubo, Toshifumi; Hashimoto, Tatsuya; Yamashita, Mariko

(74) Agent / Attorney
Phillips Ormonde Fitzpatrick, 367 Collins Street, Melbourne, VIC, 3000

(56) Related Art
JP 9-313531 A
JP 2009-61052 A

(12) 特許協力条約に基づいて公開された国際出願

(19) 世界知的所有権機関
国際事務局



(10) 国際公開番号

WO 2011/090170 A1

(43) 国際公開日
2011 年 7 月 28 日(28.07.2011)

- (51) 国際特許分類:
A61F 13/496 (2006.01) A61F 13/49 (2006.01)
A61F 13/15 (2006.01)
- (21) 国際出願番号: PCT/JP2011/051124
- (22) 国際出願日: 2011 年 1 月 21 日(21.01.2011)
- (25) 国際出願の言語: 日本語
- (26) 国際公開の言語: 日本語
- (30) 優先権データ:
特願 2010-011403 2010 年 1 月 21 日(21.01.2010) JP
- (71) 出願人 (米国を除く全ての指定国について): ユニ・チャーム株式会社 (Unicharm Corporation) [JP/JP]; 〒7990111 愛媛県四国中央市金生町下分 1 8 2 番地 Ehime (JP).
- (72) 発明者; および
- (75) 発明者/出願人 (米国についてのみ): 大坪 俊文 (OTSUBO, Toshifumi) [JP/JP]; 〒7691602 香川県観音寺市豊浜町和田浜 1 5 3 1-7 ユニ・チャーム株式会社テクニカルセンター内 Kagawa (JP). 橋本 達也 (HASHIMOTO, Tatsuya)

[JP/JP]; 〒7691602 香川県観音寺市豊浜町和田浜 1 5 3 1-7 ユニ・チャーム株式会社テクニカルセンター内 Kagawa (JP). 山下 まり子 (YAMASHITA, Mariko) [JP/JP]; 〒7691602 香川県観音寺市豊浜町和田浜 1 5 3 1-7 ユニ・チャーム株式会社テクニカルセンター内 Kagawa (JP).

(74) 代理人: 白浜 吉治, 外(SHIRAHAMA, Yoshiharu et al.); 〒1050004 東京都港区新橋 2 丁目 1 3 番 8 号 新橋東和ビル Tokyo (JP).

(81) 指定国 (表示のない限り、全ての種類の国内保護が可能): AE, AG, AL, AM, AO, AT, AU, AZ, BA, BB, BG, BH, BR, BW, BY, BZ, CA, CH, CL, CN, CO, CR, CU, CZ, DE, DK, DM, DO, DZ, EC, EE, EG, ES, FI, GB, GD, GE, GH, GM, GT, HN, HR, HU, ID, IL, IN, IS, KE, KG, KM, KN, KP, KR, KZ, LA, LC, LK, LR, LS, LT, LU, LY, MA, MD, ME, MG, MK, MN, MW, MX, MY, MZ, NA, NG, NI, NO, NZ, OM, PE, PG, PH, PL, PT, RO, RS, RU, SC, SD, SE, SG, SK, SL, SM, ST, SV, SY, TH, TJ, TM, TN, TR, TT, TZ, UA, UG, US, UZ, VC, VN, ZA, ZM, ZW.

[続葉有]

(54) Title: DISPOSABLE PANTS-TYPE ITEM OF CLOTHING

(54) 発明の名称: 使い捨てのパンツ型着用物品

[図4]

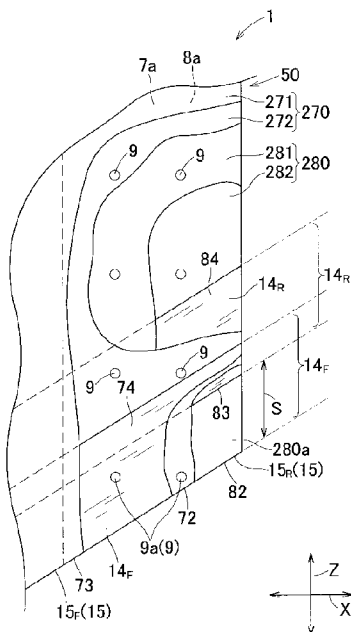

(57) Abstract: Disclosed is a disposable pants-type item of clothing which uses band-shaped leg-surrounding elastic members. The side edge sections (7a, 8a) of front and rear waist-surrounding regions (7, 8) of a disposable pants-type item of clothing (1) together form a clasped-hand style joining region (50). Band-shaped leg-surrounding elastic members (14r, 14f) in the item of clothing (1) comprise a front upper-end section (74) which is included in the clasped-hand style joining region (50) and is in the front waist-surrounding region (7), and a rear upper-end section (84) which is included in the clasped-hand style joining region (50) and is in the rear waist-surrounding region (8). A lower edge section (73) of the front upper-end section (74) and a lower edge section (83) of the rear upper-end section (84), all in the clasped-hand style joining region (50), are staggered so that the one lower edge section (73) is positioned lower than the other lower edge section (83). The one lower edge section (73) is adhered to either a sheet member (282) and/or another sheet member (281) covering the other lower edge section (83), so as to be lower than the other lower edge section (83).

(57) 要約: 带状の脚周り弾性部材が使用されている使い捨てのパンツ型着用物品。使い捨てのパンツ型着用物品 1 の前後胴周り域 7、8 の側縁部 7a、8a とうしが合掌状接合域 50 を形成する。着用物品 1 における带状の脚周り弾性部材 14r、14f は、前胴周り域 7 にあって合掌状接合域 50 に含まれている前方上端部 74 と、後胴周り域 8 にあって合掌状接合域 50 に含まれている後方上端部 84 とを有する。前記合掌状接合域 50 において上端部 74 の下方縁部 73 と後方上端部 84 の下方縁部 83 とは、下方縁部 73 がもう一方の下方縁部 83 よりも下方に位置するようにずれている。下方縁部 73 は、もう一方の下方縁部 83 を被覆しているシート状部材 281 およびシート状部材 282 の少なくとも一つに対してもう一方の下方縁部 283 よりも下方において溶着する。

WO 2011/090170 A1



(84) 指定国 (表示のない限り、全ての種類の広域保護が可能): ARIPO (BW, GH, GM, KE, LR, LS, MW, MZ, NA, SD, SL, SZ, TZ, UG, ZM, ZW), ユーラシア (AM, AZ, BY, KG, KZ, MD, RU, TJ, TM), ヨーロッパ (AL, AT, BE, BG, CH, CY, CZ, DE, DK, EE, ES, FI, FR, GB, GR, HR, HU, IE, IS, IT, LT, LU, LV, MC, MK, MT, NL, NO, PL, PT, RO, RS, SE, SI, SK, SM, TR), OAPI

(BF, BJ, CF, CG, CI, CM, GA, GN, GQ, GW, ML, MR, NE, SN, TD, TG).

添付公開書類:

— 国際調査報告 (条約第 21 条(3))

DISPOSABLE PANTS-TYPE WEARING ARTICLE

{Technical Field}

5 {0001}

The present invention relates to disposable pants-type wearing articles suitable for use as disposable diapers or the like.

10 {Background}

{0002}

15 The following discussion of the background to the invention is intended to facilitate an understanding of the invention. However, it should be appreciated that the discussion is not an acknowledgement or admission that any aspect of the discussion was part of the common general knowledge as at the priority date of the application.

20 {0002a}

Throughout the description and claims of this specification the word "comprise" and variations of that word, such as "comprises" and "comprising", are not intended to exclude other additives, components, integers or steps.

25

{0002b}

Conventionally, disposable pants-type diapers exist which are formed by putting respective opposite side edges of front and rear waist regions flat together and bonding them together.

30

{0003}

For example, in disposable absorbent pants disclosed in JP S62-243806 A (PTL 1), front and rear waist regions are put flat and joined together by sealing treatments under pressure along

respective opposite side edges of these front and rear waist regions. Belt-like leg elastic members extending in a transverse direction or belt-like leg elastic members extending in a longitudinal direction are bonded to the front and rear waist regions, respectively. These leg elastic members are formed, for example, by urethane foams or the like and have a relatively large width dimension of about 10 to about 45mm.

{0004}

In the disposable diaper disclosed in JP 3488506 B2 (PTL 2), belt-like leg elastic sheet members are attached under even tension in a longitudinal direction thereof to a base material sheet forming the diaper. On the base material sheet cut in an hourglass-shape, the leg elastic sheet members respectively draw concave curved lines in a crotch region.

{0005}

In the pants-type absorbent article disclosed in JP 2008-173285 A (PTL 3), a front waist region and a rear waist region are and joined together along side seal arrays by a sealing treatment such as a heat-sealing or ultrasonic sealing treatment. A plurality of straight belt-like leg-gather strips are attached to peripheral edges of respective leg-openings in a manner that these leg-gather strips may be obliquely crossed so as to draw curved lines along the peripheral edges of the respective leg-openings.

{Citation List}

{0006}

{PTL 1} JP S62-243806 A

{PTL 2} JP 3488506 B2

{PTL 3} JP 2008-173285 A

{0007}

As one example of methods to make pants-type wearing articles such as disposable pants-type diapers, the opposite side edges of the front waist region and the opposite side edges of the rear waist region may be put flat together and thermoplastic synthetic resin contained by these side edges in the form of fiber or film may be fusion-bonded under pressure by an ultrasonic sealer or the like to form put flat and joined together regions. However, the inventors found that, if belt-like elastic members made of natural or synthetic rubber are included by those side edges, these elastic members may make it difficult to fusion bond those side edges at least in regions of these side edges occupied by the elastic members. In consequence, there is possibility that the respective side edges of the front and rear waist regions certainly having been fusion-bonded together might be broken during use of the wearing article. If fibrous nonwoven fabrics or plastic films forming the respective side edges of the front and rear waist regions contain thermoplastic synthetic resins when it is desired to fusion-bond the respective side edges of the front and rear waist regions using the ultrasonic sealer, it will be easy to join the respective side edges of the front and rear waist regions so that these side edges once having been joined can not be readily broken. However, in a region wherein the belt-like leg elastic members included in the front waist region overlap the belt-like leg elastic members, respectively, it is not easy to join the respective side edges of the front and rear waist regions together so that these side edges once having been joined can not be readily broken. The problem is serious particularly when the respective belt-like leg elastic

members overlap with each other in the put flat and joined together regions in the vicinity of the peripheral edges of the respective leg-opening. Specifically, vigorous movement of the wearer's legs may cause the front and rear waist regions to be separated from each other along the put flat and joined together regions.

{0008}

It is therefore desirable to provide an improved disposable pants-type wearing article so that, even when the belt-like leg elastic members are provided along the peripheral edges of the leg-openings, the front and rear waist regions are not readily separated from each other along the put flat and joined together regions defined by the respective opposite side edges of the front and rear waist regions.

{Summary of the Invention}

{0009}

Some embodiments of the present invention provide a disposable pants-type wearing article described as follows.

{0010}

A disposable pants-type wearing article having a front-back direction, a vertical direction and a transverse direction being orthogonal to one another, the article comprising: a front waist region and a rear waist region opposed to each other in the front-back direction and a crotch region extending between the front and rear waist regions; joined regions formed by putting flat and joining together the front and rear waist regions along respective side edges of

the front and rear waist regions respectively opposed in the transverse direction and extending in the vertical direction; a waist-opening and a pair of leg-openings formed by the front and rear waist regions with the crotch region; and belt-shaped leg elastic members extending under tension along respective peripheral edges of the leg-openings; wherein the belt-shaped leg elastic members include at least one of natural rubber and synthetic rubber so as to be provided with stretch property and have a skin-facing side covered with a sheet member formed of at least one of a nonwoven fabric and a plastic film, the belt-shaped leg elastic members further include front side upper ends lying in the joined regions at the front waist region and rear side upper ends lying in the joined regions at the rear waist region, the front side upper ends include, in the joined regions, a first pair of lower edges of the belt-shape leg elastic members, the rear side upper ends include, in the joined regions, a second pair of lower edges of the belt-shape leg elastic members, and the lower edges in the second pair extending in parallel to the lower edges in the first pair, the lower edges of the belt-shaped leg elastic members at the front side upper ends and the lower edges of the belt-shaped leg elastic members at the rear side upper ends in the joined regions are displaced from each other in the vertical direction so that one of the first pair and the second pair of the lower edges lies below the other pair of the lower edges, and the one pair of the lower edges that lies below is fusion-bonded to the sheet member covering the other pair of the lower edges at a level lower than the other pair of the lower edges.

{0011}

According to one embodiment of the present invention, a pair of the lower edges is contiguous to edges of the crotch region, and the edges of the crotch region are configured to extend circumferentially around wearer's legs, respectively, and define parts of entire peripheral edges of the leg-openings.

{0012}

According to another embodiment of the present invention, the one pair of the lower edges is contiguous to edges of the crotch region, and the edges of the crotch region configured to extend circumferentially about wearer's legs respectively cause, upon contraction of the belt-shaped leg elastic members, the sheet member to be formed along parts of entire peripheral edges of the leg-openings with frills.

{0013}

According to another embodiment of the present invention, the one pair of the lower edges are included in the front side upper ends and the other pair of the lower edges are included in the rear side upper ends.

{0014}

Another aspect of the invention provides a disposable pants-type wearing article having a front-back direction, a vertical direction and a transverse direction being orthogonal to one another, the article comprising: a front waist region and a rear waist region opposed to each other in the front-back direction and a crotch region extending between the front and rear waist regions; joined regions

formed by putting flat and joining together the front and rear waist regions along respective side edges of the front and rear waist regions respectively opposed in the transverse direction and extending in the vertical direction; a waist-opening and a pair of leg-openings formed by the front and rear waist regions with the crotch region; and belt-shaped leg elastic members extending under tension along respective peripheral edges of the leg-openings; wherein each of the belt-shaped leg elastic members includes at least one of natural rubber and synthetic rubber so as to be stretchable, and has a skin-facing side covered with a sheet member formed of at least one of a nonwoven fabric and a plastic film, and for each of the leg openings, the belt-shaped leg elastic members include a front side leg elastic member having a front side upper end lying in the joined region at the front waist region, and a rear side leg elastic member having a rear side upper end lying in the joined region at the rear waist region, the front side upper end includes, in the joined region, a first lower edge of the front side leg elastic member, the rear side upper end includes, in the joined region, a second lower edge of the rear side leg elastic member, the first and second lower edges extend in parallel to each other and are displaced from each other in the vertical direction so that one of the first and second lower edges lies below the other lower edge, and the one lower edge that lies below is fusion bonded to the sheet

member covering the other lower edge at a level lower than the other lower edge.

{0015}

5 As used herein, the term "belt-like leg elastic members" means the elastic members each having the dimension in the

transverse direction at least 1.5 times the dimension in the thickness direction.

{0016}

As used herein, the description "the sheet-like member
5 is formed with frills" means that, upon contraction of the belt-like leg elastic members attached under tension to the sheet-like member, the edge of the sheet-like member spaced from the belt-like leg elastic members and extending in parallel to these belt-like leg elastic members is deformed so as to be
10 undulated. The undulation is repeated in the direction in which the belt-like leg elastic members contract.

{Advantageous Effects of Invention}

{0017}

In the disposable pants-type wearing article according
15 to the present invention, the lower edges included by the front side upper ends of the belt-like leg elastic members and the other lower edges included by the rear side upper ends are displaced from each other in the vertical direction in the put flat and joined together regions so that the one pair of the
20 lower edges lie below the other pair of the lower edges. The one pair of the lower edges are fusion-bonded to the sheet-like member covering the other pair of the lower edges at a level lower than the other pair of the lower edges. With such

arrangement, there is no possibility that the belt-like leg elastic members for the respective leg-openings might overlap each other and be bonded together along the peripheral edges of the respective leg-openings. In consequence, the side edges of the front and rear waist regions put flat and joined together should readily begin to be peeled off one from another from the peripheral edges of the respective leg-openings.

{Brief Description of Drawings}

{0018}

10 {Fig. 1} Fig. 1 is a partially cutaway perspective view of a disposable pants-type wearing article (pants-type diaper).

{Fig. 2} Fig. 2 is a partially cutaway plan view of the flatly developed diaper.

15 {Fig. 3} Fig. 3 is an exploded perspective view of the flatly developed diaper.

{Fig. 4} Fig. 4 is a partially cutaway plan view of a region IV in Fig. 1.

{Fig. 5} Fig. 5 is a schematic side view of a main equipment used in a process for making a composite web.

20 {Fig. 6} Fig. 6 is a schematic overhead view illustrating a part of Fig. 5.

{Fig. 7} Fig. 7 is a diagram illustrating a pattern in which the composite web is bonded to a fibrous nonwoven fabric web.

{Fig. 8} Fig. 8 is a view similar to Fig. 2, exemplarily showing one embodiment of the present invention.

{Description of Embodiments}

{0019}

5 Details of a disposable pants-type wearing article according to the present invention will be more fully understood from the description given hereunder with reference to the accompanying drawings.

{0020}

10 Fig. 1 a partially cutaway perspective view of a pants-type diaper 1 as one example of the disposable pants-type wearing articles according to the present invention wherein a transverse direction, a front-back direction and a vertical direction are denoted by double-headed arrows X, Y and Z, respectively. The diaper 1 includes a pants-shaped chassis 1A and a bodily fluid-absorbent structure 1B attached to an inner surface of the chassis 1A. The chassis 1A includes a crotch region 6, a front waist region 7 extending forward with respect to the crotch region 6 and a rear waist region 8 extending rearward with respect to the crotch region 6. The front and rear waist regions 7, 8 are put flat and joined together along respective opposite edges 7a8a thereof by sealing spots 9 arranged intermittently in the vertical direction Z to form put

15

20

flat and joined together regions 50. In the diaper 1, the front and rear waist regions 7, 8 cooperate with the crotch region 6 to form a waist-opening 11 and a pair of leg-openings 12. The chassis 1A further includes a front sheet assembly 270 extending
5 over a whole area of the front waist region 7 and additionally over an upper half of the crotch region 6 on its front side and a rear sheet assembly 280 extending over a whole area of the rear waist region 8 and additionally over a upper half of the crotch region 6 on its rear side (See Figs. 2 and 3). The front
10 sheet assembly 270 is provided with a belt-like front waist-elastic member 13_F extending along a peripheral edge 10 of the waist-opening 11 and belt-like front side leg elastic members 14_F extending along front halves 15_F of the peripheral edges 15 of the respective leg-openings 12 are attached under
15 tension to the front sheet assembly 270. The rear sheet assembly 280 is provided with a belt-like rear waist-elastic member 13_R extending along a peripheral edge 10 of the waist-opening 11 and belt-like rear side leg elastic members 14_R extending along rear side peripheral edges 15_R of the respective leg-openings
20 12 as shown in Fig. 2 are attached under tension to the front sheet assembly 270. It should be appreciated that these elastic or elastic members, 13_F, 13_R, 14_F and 14_R are in a contracted state in the diaper 1 shown in Fig. 1.

{0021}

Fig. 2 is a partially cutaway plan view of the diaper 1a having the front and rear waist regions 7, 8 peeled off from each other along the put flat and joined together regions 50 and flatly developed in the transverse direction X and the front-back direction Y, and Fig. 3 is an exploded perspective view of the flatly developed diaper 1a. The respective regions extending in the vertical direction Z in Fig. 1 extend in the front-back direction Y in Figs. 2 and 3. In Fig. 2, a front-back center line C-C and a transverse center line D-D extending orthogonally to the front-back center line C-C to bisect a dimension of the developed diaper 1a in the front-back direction Y are indicated. The developed diaper 1a is shaped symmetrically about the front-back center line C-C.

{0022}

Referring to Figs. 2 and 3, the chassis 1A includes a substantially hexagonal front sheet assembly 270 defining the front waist region 7, a substantially hexagonal rear sheet assembly 280 defining the rear waist region 8 and part of the crotch region 6 and a rectangular central sheet assembly 260 defining part of the crotch region 6.

{0023}

The front sheet assembly 270 includes an inner sheet 271

and an outer sheet 272 which are the same in shape as well as in size. Between these sheets 271, 272, the single belt-like front waist-elastic member 13_F and a pair of front side leg-elastic members 14_F are sandwiched and attached under
5 tension to at least one of these inner and outer sheets 271, 272 with hot melt adhesives (not shown). The respective inner surfaces of the elastic or elastic members 13_F, 14_F facing the wearer's skin (not shown) is covered with the inner sheet 271.
{0024}

10 The rear sheet assembly 280 includes an inner sheet 281 and an outer sheet 282 which are the same in shape as well as in size. Between these sheets 281, 282, the single belt-like rear waist-elastic member 13_R and a pair of front side leg-elastic members 14_R are sandwiched and attached under
15 tension to at least one of these inner sheet 281 and outer sheet 282 with hot melt adhesives (not shown). The respective inner surfaces of the elastic members 13_R, 14_R facing the wearer's skin (not shown) is covered with the inner sheet 281.
{0025}

20 The central sheet 260 includes a rectangular leakage-barrier plastic film 261 sandwiched between a pair of cover sheets 262 wherein these film and sheets are bonded one to another with hot melt adhesives (not shown). The preferred

leakage-barrier plastic film 261 is formed of moisture-permeable but liquid-impervious plastic film and the preferred cover sheet 262 is formed of a fibrous nonwoven fabric. Front and rear ends of the central sheet assembly 260
5 respectively extend onto respective inner surfaces (i.e., upper surfaces as viewed in Fig. 3) of the front sheet assembly 270 and the rear sheet assembly 280 and are respectively bonded to these inner surfaces with hot melt adhesives 264 (See Fig. 2) so as to connect the front sheet assembly 270 with the rear sheet
10 assembly 280. The bodily fluid-absorbent structure 1B is bonded to the inner surface of the central sheet assembly 260 with hot melt adhesives 263 applied to the inner surface of the central sheet assembly 260.

{0026}

15 Referring to Fig. 2, the bodily fluid-absorbent structure 1B has a rectangular shape which is relatively long in the front-back direction and this shape is contoured by a pair of opposite side edges 333 extending in parallel to the center line C-C and front and rear ends 331, 332 extending in parallel to
20 the center line D-D. The respective side edges 333 are formed with leakage-barriers 360 of in the name of the three dimensional gather in the art. In such bodily fluid-absorbent structure 1B, an assembly of bodily fluid absorbent material

4a such as fluff pulp and super-absorbent polymer particles is covered with a wrapping sheet 4b formed of a liquid-pervious tissue paper or a fibrous nonwoven fabric and the side of this wrapping sheet 4b facing the wearer's skin is covered with a liquid-pervious skin-contact sheet 4c. The leakage-barriers 360 are preferably formed of a liquid-impervious sheet. High leakage-barrier effect of the bodily fluid-absorbent structure 1B is assured by the leakage-barriers 360 and indirect back up of the liquid-impervious inner sheet 261 constituting the central sheet assembly 260.

{0027}

Rubber threads 371, 372 extending in the front-back direction Y as viewed in Fig. 2 are bonded under tension to the liquid-impervious sheet forming the leakage-barriers 360 of the bodily fluid-absorbent structure 1B with means of hot melt adhesives (not shown). While the liquid-impervious sheet is folded in a Z-shape or in an inverted Z-shape in the developed diaper 1a of Fig. 2, the leakage-barriers 360 raise themselves on the inner surface of the skin-contact sheet 4c along the side edges 333 of the bodily fluid-absorbent structure 1B under contraction of the rubber threads 371, 372.

{0028}

In the diaper 1 as has been described above, the inner

5 sheets 271, 281 and the outer sheets 272, 282 may be formed of sheet-like members such as fibrous nonwoven fabrics containing thermoplastic synthetic fibers, plastic films formed from thermoplastic synthetic resins or a laminated of these nonwoven fabric and plastic film. More preferably, these inner and outer sheets 271, 281; 272, 282 may be formed of spun bonded nonwoven fabrics, melt blown nonwoven fabrics or SMS nonwoven fabrics as a laminate of spun bonded nonwoven fabrics, melt blown nonwoven fabrics and spun bonded nonwoven fabrics. In every case, 10 a mass per unit area thereof is about 10 to about 100g/m². The front side belt-like leg elastic members 14_F and the rear side belt-like leg elastic members 14_R may be formed of belt-like sheets containing at least one of natural rubber and synthetic rubber as rubber ingredients. These belt-like leg elastic 15 members 14_F, 14_R may be preferably formed of elastically stretchable fibrous nonwoven fabrics made of elastic yarns or threads containing urethane rubber or the like as rubbers ingredients or plastic films having a mass per unit area ranging from about 20 to 100g/m². More preferably, these belt-like leg 20 elastic members 14_F, 14_R may be formed of the elasticized fibrous nonwoven fabrics made of elastic yarns or threads containing the rubber ingredients such as urethane rubbers or the elasticized fibrous nonwoven fabrics including elastic yarns

or threads and inelastic thermoplastic synthetic fibers wherein the elastic yarns or threads of at least about 30% by mass are contained therein. Referring to Fig. 2, both a width dimension W_F of the front side leg elastic member 14_F and a width dimension W_R of the rear side leg elastic member 14_R are the dimensions measured in the direction which is orthogonal to the direction in which these elastic members extend. These width dimensions W_F and W_R are preferably at least about 5mm and more preferably ranging from about 7 to about 40mm. Thickness dimension of these elastic members 14_F, 14_R is preferably about 0.2 to about 1.5mm. Thickness dimensions of the fibrous nonwoven fabrics, the plastic films, the belt-like waist-elastic members 13_F, 13_R and the belt-like leg elastic members 14_F, 14_R as have been indicated were values measured using Automatic Compression Tester "KES-FB3-AUTO-A" (manufactured by KATO TECH CO., LTD. in Japan) when compression force of about 0.5g/cm² was exerted on the respective test pieces.

{0029}

While the front waist-elastic member 13_F and the rear waist-elastic member 13_R in the developed diaper 1a are preferably belt-like elastic members each having a width dimension ranging from about 10 to about 40mm, it is also possible to use a plurality of rubber threads each having a

diameter or a width dimension ranging from about 0.3 to about 3mm as the front waist-elastic member 13_F and the rear waist-elastic member 13_R. In the developed diaper 1a, the front waist-elastic member 13_F and the front side leg elastic members 14_F are in a state appropriately stretched in the longitudinal direction, for example, at a ratio of about 1.5 to about 4.0 and the rear waist-elastic member 13_R and the rear side leg members 14_R are also in a state appropriately stretched in the longitudinal direction, for example, at a ratio of about 1.5 to about 4.0.

{0030}

Fig. 4 is a partially cutaway plan view of a region enclosed by an imaginary line IV in Fig. 1. The developed diaper 1a of Fig. 2 is folded back along the center line D-D with the bodily fluid-absorbent structure 1B inside and thereby the respective side edges 7a; 8a of the front and rear waist regions 7, 8 are put flat together. The side edges 7a; 8a put flat together in this manner may be set between horns and anvils of an ultrasonic sealer and ultrasonic treated to form a plurality of sealing spots 9 in which the respective side edges 7a; 8a of the front and rear waist regions 7, 8 are joined and these sealing spots 9 form the respective put flat and joined together regions 50. Now the developed diaper 1a is converted to the flat

diaper 1 under tension in the transverse direction X as well as in the longitudinal direction Y. In the developed diaper 1a, a dimension of the side edge 7a in the front-back direction Y is same as that of the side edge 8a in the front-back direction Y and upper and lower ends 71, 72 of the side edge 7a in the put flat and joined together regions 50 (See Fig. 1) of the diaper 1 coincide with upper and lower ends 81, 82 of the side edge 8a, respectively.

{0031}

As will be apparent from Fig. 4 in combination with Figs. 1 and 2, the front side leg elastic elements 14_F respectively include lower edges 73 extending in accordance with the front side peripheral edges 15_F of the respective leg-openings 12 and front upper ends 74 overlapping the side edges 7a of the front waist region 7 and included in the put flat and joined together regions 50. The rear side leg elastic elements 14_R respectively include lower edges 83 extending in parallel to the rear side peripheral edges 15_R at a distance S from the rear side peripheral edges 15_R and rear side upper ends 84 overlapping the side edges 8a of the rear waist region 8 and included in the put flat and joined together regions 50. Of the rear side peripheral edges 15_R, segments 280a defined between the lower edges 83 of the rear side leg elastic members 14_R and the rear

side peripheral edges 15_R each spaced from the associated lower edge 83 by a distance S are respectively formed of the inner sheet 281 and the outer sheet 282 and include none of the rear side leg elastic members 14_R. It should be noted here that the distance S indicates a dimension measured in parallel to the center line C-C.

{0032}

In the put flat and joined together regions 50 each including the front side upper end 74 and the rear side upper end 84 as have been described just above, the side edges 7a; 8a are fusion-bonding treated under pressure by an ultrasonic sealer or the like and thereby thermoplastic synthetic resins contained in the side edges 7a; 8a are fusion-bonded together. During this treatment, the front upper ends 72 and/or the inner sheet 271 covering these front upper ends 72 may be fusion-bonded to at least one of the inner sheet 281 and the outer sheet 282 in the side edges 8a, more preferably to both the inner sheet 281 and the outer sheet 282 to form the sealing spots 9 including none of the rear side leg elastic members 14_R and thereby to join the side edges 7a to the side edges 8a. When the side edges 7a are joined to the side edges 8a, in regions wherein the front side leg elastic members 14_F overlap the rear side leg elastic members 14_R, the presence of ingredients having

rubber elasticity contained in the front side leg members 14_f and the rear side leg members 14_r would otherwise make it difficult to join the side edges 7a to the side edges 8a so surely that these side edges once having been joined together might
5 be unintentionally peeled off one another. However, in the diaper 1 according to the present invention, even if the front upper ends 74 of the front side leg elastic members 14_f are included in the lower edges 72 of the side edges 7a, the thermoplastic synthetic resins contained in the front side
10 upper end 74 and the inner sheet 281 covering this front side upper end 74 may be fusion-bonded to the thermoplastic synthetic resins contained in the inner sheet 281 and the outer sheet 282 in the segments 280a in the side edges 8a under pressure. In this way, the side edges 7a can be firmly joined to the side
15 edges 8a in the vicinity of the peripheral edges 16 of the respective leg-openings 12. The segments 280a of the inner sheet 281 and the outer sheet 282 used in this manner may have a dimension S sufficient to form several sealing spots 9, specifically, each of the segments 280a preferably has at least
20 about 3mm and more preferably has at least about 5mm. If the value of the dimension S is at least about 5mm, portions of the rear sheet assembly 280 which are contiguous to the segments 280a and extend along the respective rear side peripheral edges

15_R can be easily formed with frills 80 (See Fig. 1) adapted to be visually recognized from behind the diaper 1. However, in the front sheet assembly 270, the front side leg elastic members 14_F define the front side peripheral edges 15_F. In consequence, small wrinkles 60 may be formed but the frills 80 is formed in the front sheet assembly 270. Depending on the dimension S, it is possible to design the diaper 1 in the manner that the front side peripheral edges 15_F of the complete peripheral edges 15 of the respective leg-openings 12 have no frills 80 but the rear side peripheral edges are formed with the frills 80. It is also possible by reducing the value of the dimension S to design the diaper 1 in the manner that not only the front side peripheral edges 15_F but also the rear side peripheral edges 15_R are not formed with the frills 80. It should be noted here that the planar shape of the individual sealing spots 9 is not specified but an appropriate planar shape may be selected from various shapes such as a dot geometry, a rectilinear shape and a curved line shape and the sealing spots may be appropriately distributed in the put flat and joined together regions 50. In the dot geometry, an area of the individual sealing spot preferably ranges from about 2 to about 5mm².

{0033}

Fig. 5 is a schematic side view of main equipment used in a process for making the front sheet assembly 270 and the rear sheet assembly 280 exemplarily shown in Figs. 2 and 3 and Fig. 6 is a schematic overhead view illustrating part of the main equipment. The method for making the sheet assembly is basically common to the front sheet assembly 270 and the rear sheet assembly 280 and, in view of this, description of the method will be made hereunder with respect to the front sheet assembly 270. Referring to Fig. 5, an elastic web 501 as material webs for the front side leg elastic member 14_F is continuously fed from above as viewed in Fig. 5 and coated by a first coater 571 with hot melt adhesives (not shown). The elastic web 501 corresponds to a raw fabric 500 having stretch properties and having been elastically stretched at a desired ratio. The elastic web 501 is guided by guide rolls 564, 565 mounted on a rocking arm 561 and fed in a machine direction MD indicated by an arrow to a joining roll 550 on which the elastic web 501 comes in contact with and bonded under a pressure to second nonwoven fabric web 522 continuously fed from the left-hand as viewed in Fig. 5. The second nonwoven fabric web 522 further runs in the direction indicated by an arrow and converges with first nonwoven fabric web 521 which is, in turn, fed from above as viewed in Fig. 5 and coated by a second coater 572 with hot

melt adhesives (not shown). In this way, the second nonwoven fabric web 522 is bonded to the first nonwoven fabric web 521 to form a composite web 523 sandwiching the elastic web 501 between these first nonwoven fabric web 521 and the second nonwoven fabric web 522. The first nonwoven fabric web 521 in the composite web 523 is used as one of the inner sheet 271 and the outer sheet 272 and the second nonwoven fabric web 522 in the composite web 523 is used as the other of the inner sheet 271 and the outer sheet 272. The rocking arm 561 is rocked to and from around a pivot shaft 563 by a driving unit 562 in a predetermined range of movement indicated by a double-headed arrow M in Fig. 6. In Fig. 6, the elastic web 501 and the second nonwoven fabric web 522 are indicated by imaginary lines.

{0034}

Fig. 7 is a partial plan view of the second nonwoven fabric web 522 to which the elastic web 501 has been bonded. On the left-hand in Fig. 7, the first nonwoven fabric web 521 and the composite web 523 also are shown. An imaginary line 528 on the second nonwoven fabric web 522 indicates a line along which the front sheet assembly 270 is to be cut off from the composite web 523 (See Fig. 5). While illustration of the front side waist-elastic member 13_F to be attached to the front sheet assembly 270 is eliminated from the composite web 523 in Fig.

7, the front side leg members 13_F or the elastic web (not shown) formed by such members 13_F continuously arranged in the machine direction MD may have been attached under tension in the machine direction MD to the first nonwoven fabric web 522.

5 {0035}

According to one embodiment of the method using the steps as illustrated in Figs. 5 and 6 to obtain the composite web 523 shown by Fig. 7, the second nonwoven fabric web 522 corresponds to the outer sheet 272 in the diaper 1. As this second nonwoven
10 fabric web 522, spun bonded nonwoven fabric made of polypropylene fibers and having a mass per unit area of about 25g/m² is used and fed in the machine direction MD at a rate of about 70m/min. As the raw fabric 500 for the elastic web 501, spun bonded nonwoven fabrics including, for example,
15 polyurethane fibers of about 47% by mass and polypropylene fibers of about 53% by mass is used. The spun bonded nonwoven fabrics have a mass per unit area of about 30g/m² and a width dimension of 80mm. Such raw fabric 500 is elastically stretched at a ratio of about 3.0 in the machine direction MD and fed in
20 the form of the elastic web 501 to the guide roll 564 as illustrated in Fig. 5. This elastic web 501 has been coated with hot melt adhesives about at a rate of about 3g/m². The rocking arm 561 has its amplitude set to 166mm and is rocked in such

a mode that the second nonwoven fabric web 522 runs by a length L of about 340mm in the machine direction MD for each cycle of the rocking arm's movement. The elastic web 501 guided by the rocking arm 561 is fed, in a generally sine-wave pattern, onto the second nonwoven fabric web 522. Under the rocking operation of the arm 561, the elastic web 501 has its width dimension enlarged along crest segments 531 and the trough segments 532. Along intermediate segments 533 each defined between a pair of the adjacent crest segment 531 and the trough segment 532, a plurality of gathers (not shown) undulating in the transverse direction and the width dimension of the elastic web 501 correspondingly reduced as illustrated. Depending on the operating condition of the equipment of Figs. 5 and 6 as well as the stretch property of the raw fabric 500, the elastic web 501 obtained by stretching the raw fabric 500 having a width dimension of 80mm before it is stretched has its stretch ratio and width dimension varied in the course of being fed onto the second nonwoven fabric web 522 via the rocking arm 561. Specifically, the stretch ratio along the crest segment 531 and the trough segment 532 of the curve becomes lower than the stretch ratio along the intermediate segment 533. More specifically, the width dimension of the raw fabric 500 is reduced to about 32mm along the crest segment 531 and the trough

segment 532 and to about 21mm at the narrowest portion along the intermediate segment 533. While the elastic web 501 is formed along the intermediate segment 533 with a plurality of gathers (not shown) extending in the length direction, the crest segment 531 and the trough segment 532 are substantially free from such gathers. The first nonwoven fabric web 521 lapped on the second nonwoven fabric web 522 corresponds to the inner sheet 271 in the diaper 1. Spun bonded/melt blown/spun bonded nonwoven fabrics (SMS nonwoven fabrics) made of polypropylene fibers having a mass per unit area of about 15g/m^2 and width dimension of about 200mm used as this first nonwoven fabric web 521 has been coated with hot melt adhesives at a rate of about 3g/m^2 . The composite web 523 formed of these first and second nonwoven fabric webs 521, 522 and the elastic web 500 is cut out in a shape as illustrated by the imaginary line 528 and used as the front sheet assembly 270 of Fig. 2. The intermediate segments 533 of the elastic web 501 are laid on the front sheet assembly to form the belt-like front leg elastic members 14_F.
{0036}

An imaginary line 628 in Fig. 7 is a predetermined line along which the rear sheet assembly 280 (See Figs. 2 and 3) will be cut out from the composite web 523. The imaginary line 628 is coincident with the imaginary line 528 in the machine

direction MD but displaced downward from the imaginary line 528 in the cross direction CD. Specifically, regions 628a of the imaginary line 628 predetermined to define the rear side peripheral edges 15_R of the leg-openings 12 lie below lower edges of the intermediate segments 533 of the elastic web 501. The rear sheet assembly 280 may be cut out in accordance with the imaginary line 628 to obtain the segments 280a of the rear side peripheral edges 15_R defined between the lower edges 83 of the rear side leg elastic members 14_R and the rear side peripheral edges 15_R each spaced from the associated lower edge 83 by the distance S as will be apparent from Figs. 2 and 3. When the first nonwoven fabric web 521 and the second nonwoven fabric web 522 are used to form the rear sheet assembly 280, the first nonwoven fabric web 521 may be used as one of the inner and outer sheets 281, 282 and the second nonwoven fabric web 522 may be used as the other of the inner and outer sheets 281, 282. While the rear sheet assembly 280 obtained by the method as illustrated by Fig. 7 is the same as the front sheet assembly 270 so far as the shape and the component webs are concerned, it is possible to implement the present invention so that the front sheet assembly 270 and the rear sheet assembly 280 are different from each other in view of the shape or the component webs.

{0037}

Fig. 8 is a partially cutaway plan view similar to Fig. 2, showing another embodiment of the present invention. From the developed diaper 1a shown in Fig. 8 also, it is possible to obtain a diaper (not shown) having the same outer shape as the diaper 1 of Fig. 1. In the developed diaper 1a shown in Fig. 8, the regions similar to those shown in Figs. 1 and 2 are designated by the reference numerals similar to those in Figs. 1 and 2. It should be noted here that respective planar shapes of the front sheet assembly 270, the rear sheet assembly 280, the front side leg elastic members 14_F and the rear side leg elastic members 14_R are different from those in Fig. 2. It should be also noted that the general shapes of the belt-like front side leg elastic members 14_F and the belt-like rear side leg elastic members 14_R are indicated by solid lines and chain lines in Fig. 8. In the developed diaper 1a of Fig. 8, the front sheet assembly 270 and the rear sheet assembly 280 are bonded to a sheet strip 290 of nonwoven fabric with hot melt adhesives 291 to form an hourglass-shaped chassis 300. To this chassis 300, the central sheet 260 and the bodily fluid-absorbent structure 1B are attached. The front side leg elastic members 14_F included by the front sheet assembly 270 of the developed diaper 1a shown by Fig. 8 is sandwiched between inner sheet 271 and the outer sheet 272 wherein the front side upper ends 74 and the vicinity

thereof are spaced from the front side peripheral edges 15_F as a part of the peripheral edges 15 of the leg-openings 12 (See Fig. 1). In consequence, regions 270a constituting a part of the front sheet assembly 270 and including none of the front side leg elastic members 14_F are defined between the respective lower edges 73 of the front side upper ends 74 and the front side peripheral edges 15_F. The rear side leg elastic members 14_R included by the rear sheet assembly 280 as shown in Fig. 8 are sandwiched between the inner sheet 281 and the outer sheet 282 and cooperate with these inner and outer sheets 281, 282 to form the rear side peripheral edges 15_R constituting part of the peripheral edges 15 of the leg-openings 12 (See Fig. 1).
{0038}

Such developed diaper 1a of Fig. 8 may be folded back along the central line D-D and then the respective opposite side edges 7a; 8a which are the same in a dimension in the front-back direction Y may be subjected to the ultrasonic sealing treatment or the hot embossing treatment to obtain the diaper having substantially the same shape as the diaper 1 of Fig. 1. In the diaper obtained in this manner, each of the put flat and joined together regions 50 (See Fig. 1) includes the segment 280b defined by the lower end of the side edge 8a and containing the rear side leg elastic member 14_R and the segment 270a

corresponding to the lower end of the side edge 7a. This unique arrangement makes it possible to prevent the side edges 7a; 8a might readily begin at the peripheral edges of the respective leg-openings to be peeled off from each other. The segments 280b
5 are fusion-bonded preferably to at least one of the inner sheet 271 and the outer sheet 272 in the segments 270a and more preferably to both the inner sheet 271 and the outer sheet 272. In the diaper obtained from the developed diaper 1a as shown in Fig. 8 in this manner, depending on the size of the respective
10 segments 270a, these segments 270a may be formed with the frills adapted to be visually recognized from the front side of the diaper as the front side leg elastic members 14_F contract in the length direction thereof. On the other hand, contraction of the rear side leg elastic members 14_R may cause the inner
15 sheet 281 and the outer sheet 282 to get finely wrinkled but may not cause the inner sheet 281 and the outer sheet 282 to be formed with the frills adapted to be visually recognized from the rear side of the diaper. Referring to Fig. 8, the manner in which the front side leg elastic members 14_F extend along
20 the respective front side peripheral edges 15_F of the peripheral edges 15 and the manner in which the rear side leg elastic members 14_R extend along the rear side peripheral edges 15_R of the peripheral edges 15 may be adjusted by appropriately adjusting

the operation mode of the rocking arm 561 in the equipment exemplarily illustrated in Figs. 5 and 6.

{0039}

Placement mode of the front side leg elastic members 14_F and the rear side leg elastic members 14_R relative to the diaper 1 is not limited to the exemplarily illustrated placement. For example, it is possible without departing from the scope of the present invention to apply the placement mode of the front side leg elastic members 14_F in the illustrated embodiment to the rear side leg elastic members 14_R and to apply the placement mode of the rear side leg elastic members 14_R in the illustrated embodiment to the front side leg elastic members 14_F. The present invention having been described on the basis of the pants-type disposable diaper may be applicable also to the other pants-type wearing articles such as disposable pants, disposable pants for incontinent patient and toilet-training pants.

{Reference Signs List}

{0040}

- 1 wearing article (diaper)
- 6 crotch region
- 7 front waist region
- 7a side edges
- 8 rear waist region

- 8a side edges
- 9a (sealing) spots
- 12 leg-openings
- 14_F belt-like leg elastic member
- 5 14_R belt-like leg elastic member
- 15 peripheral edges
- 15_F peripheral edge (front side peripheral edge)
- 15_R peripheral edge (rear side peripheral edge)
- 50 put flat and joined together regions
- 10 73 lower edge
- 74 front upper edge
- 80 frill
- 83 lower edge
- 84 rear upper edge
- 15 271 sheet-like member
- 272 sheet-like member
- 281 sheet-like member
- 282 sheet-like member
- X transverse direction
- 20 Y front-back direction
- Z vertical direction

{Claims}

The claims defining the invention are as follows:

1. A disposable pants-type wearing article having a front-back direction, a vertical direction and a transverse direction being orthogonal to one another, the article comprising: a front waist region and a rear waist region opposed to each other in the front-back direction and a crotch region extending between the front and rear waist regions; joined regions formed by putting flat and joining together the front and rear waist regions along respective side edges of the front and rear waist regions respectively opposed in the transverse direction and extending in the vertical direction; a waist-opening and a pair of leg-openings formed by the front and rear waist regions with the crotch region; and belt-shaped leg elastic members extending under tension along respective peripheral edges of the leg-openings; wherein the belt-shaped leg elastic members include at least one of natural rubber and synthetic rubber so as to be provided with stretch property and have a skin-facing side covered with a sheet member formed of at least one of a nonwoven fabric and a plastic film, the belt-shaped leg elastic members further include front side upper ends lying in the joined regions at the front waist region and rear side upper ends lying in the joined regions at the rear waist region, the front side upper ends include, in the joined regions, a first pair of lower edges of the belt-shape leg elastic members, the rear side upper ends include, in the joined regions, a second pair of lower edges of the belt-shape leg elastic members,

and the lower edges in the second pair extending in parallel to the lower edges in the first pair, the lower edges of the belt-shaped leg elastic members at the front side upper ends and the lower edges of the belt-shaped leg elastic members at the rear side upper ends in the joined regions are displaced from each other in the vertical direction so that one of the first pair and the second pair of the lower edges lies below the other pair of the lower edges, and the one pair of the lower edges that lies below is fusion-bonded to the sheet member covering the other pair of the lower edges at a level lower than the other pair of the lower edges.

2. The wearing article defined by claim 1, wherein the one pair of the lower edges is contiguous to edges of the crotch region, and the edges of the crotch region are configured to extend circumferentially around wearer's legs, respectively, and define parts of entire peripheral edges of the leg-openings.

3. The wearing article defined by claim 1 or 2, wherein the one pair of the lower edges is contiguous to edges of the crotch region, and the edges of the crotch region configured to extend circumferentially about wearer's legs respectively cause, upon contraction of the belt-shaped leg elastic members, the sheet member to be formed along parts of entire peripheral edges of the leg-openings with frills.

4. The wearing article defined by any one of claims 1 to 3, wherein the one pair of the lower edges are

included in the front side upper ends and the other pair of the lower edges are included in the rear side upper ends.

- 5 5. A disposable pants-type wearing article having a front-back direction, a vertical direction and a transverse direction being orthogonal to one another, the article comprising: a front waist region and a rear waist region opposed to each other in the front-back direction and a crotch region extending between the front and rear waist regions; joined regions formed by putting flat and joining together the front and rear waist regions along respective side edges of the front and rear waist regions respectively opposed in the transverse direction and extending in the vertical direction; a waist-opening and a pair of leg-openings formed by the front and rear waist regions with the crotch region; and belt-shaped leg elastic members extending under tension along respective peripheral edges of the leg-openings; wherein each of the belt-shaped leg elastic members includes at least one of natural rubber and synthetic rubber so as to be stretchable, and has a skin-facing side covered with a sheet member formed of at least one of a nonwoven fabric and a plastic film, and for each of the leg openings, the belt-shaped leg elastic members include a front side leg elastic member having a front side upper end lying in the joined region at the front waist region, and a rear side leg elastic member having a rear side upper end lying in the joined region at the rear waist region, the front side upper end includes, in the joined region, a
- 10
- 15
- 20
- 25
- 30

first lower edge of the front side leg elastic member, the rear side upper end includes, in the joined region, a second lower edge of the rear side leg elastic member, the first and second lower edges extend in parallel to each other and are displaced from each other in the vertical direction so that one of the first and second lower edges lies below the other lower edge, and the one lower edge that lies below is fusion bonded to the sheet member covering the other lower edge at a level lower than the other lower edge.

5

10

FIG. 1

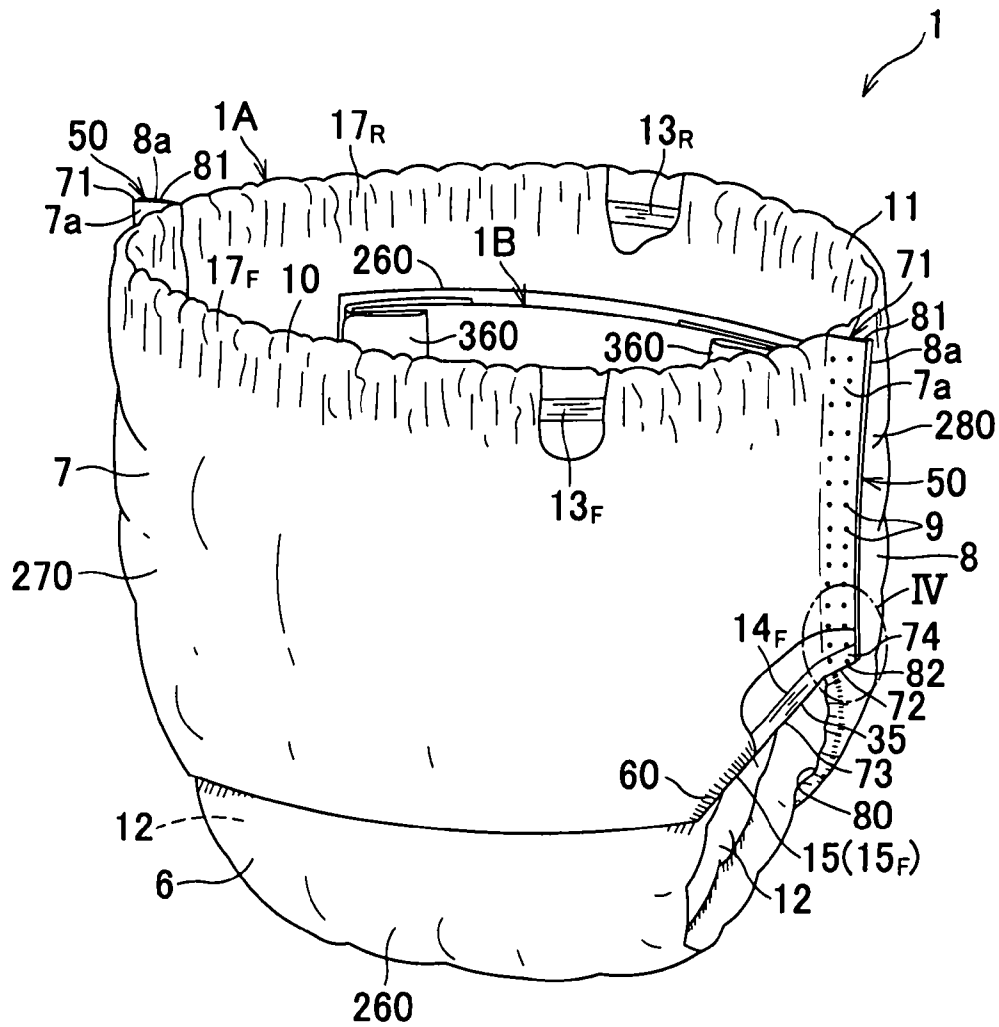

FIG.2

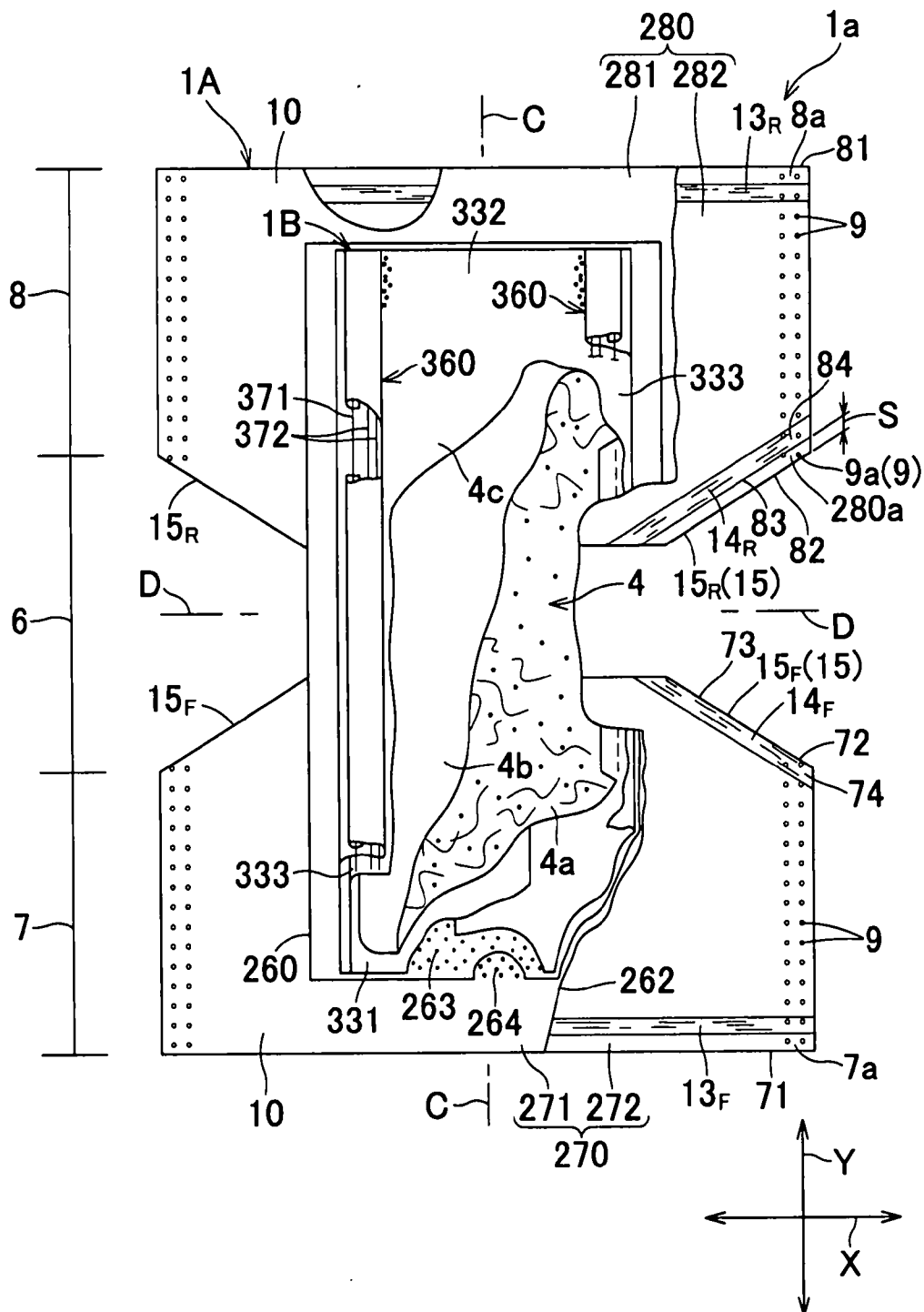

FIG. 3

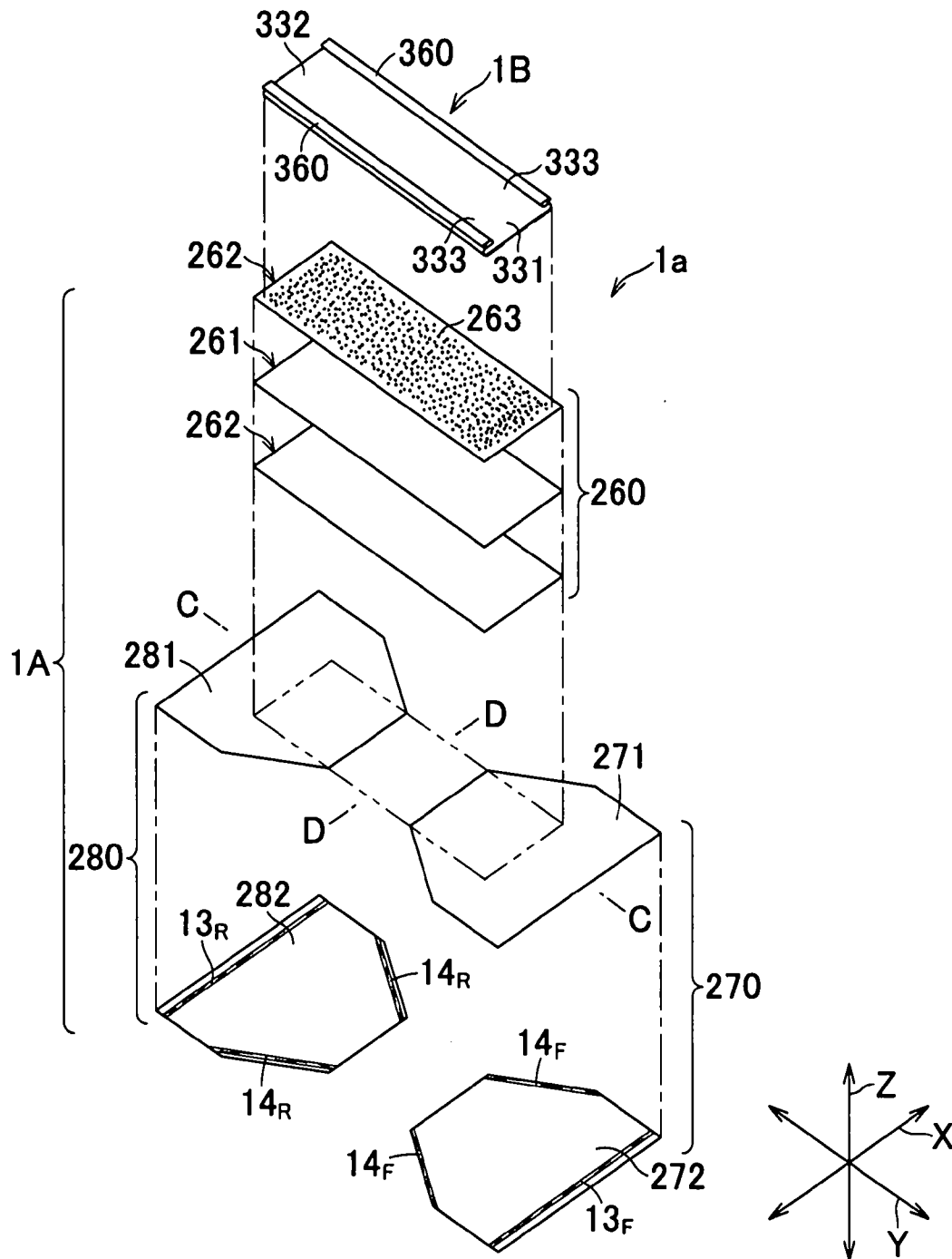

FIG. 5

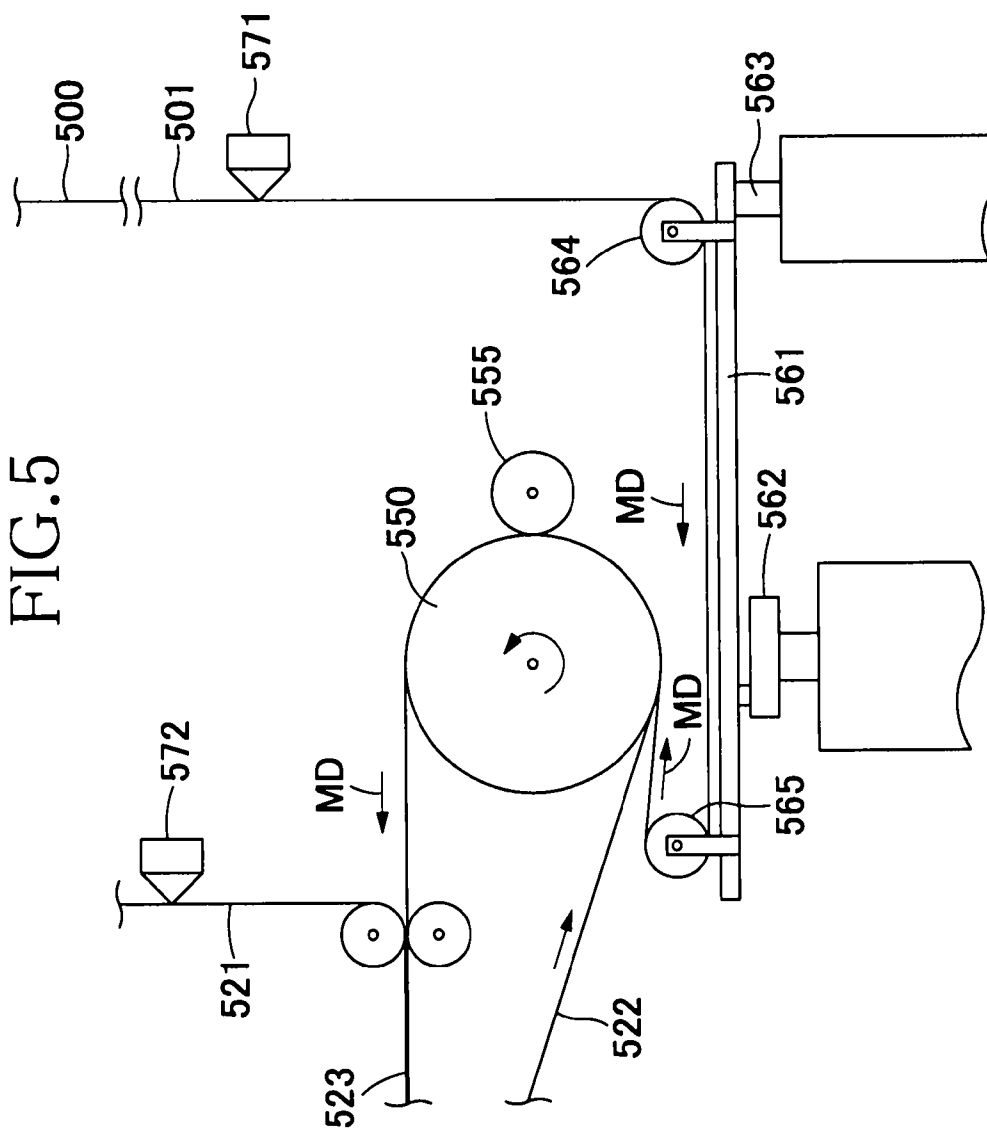
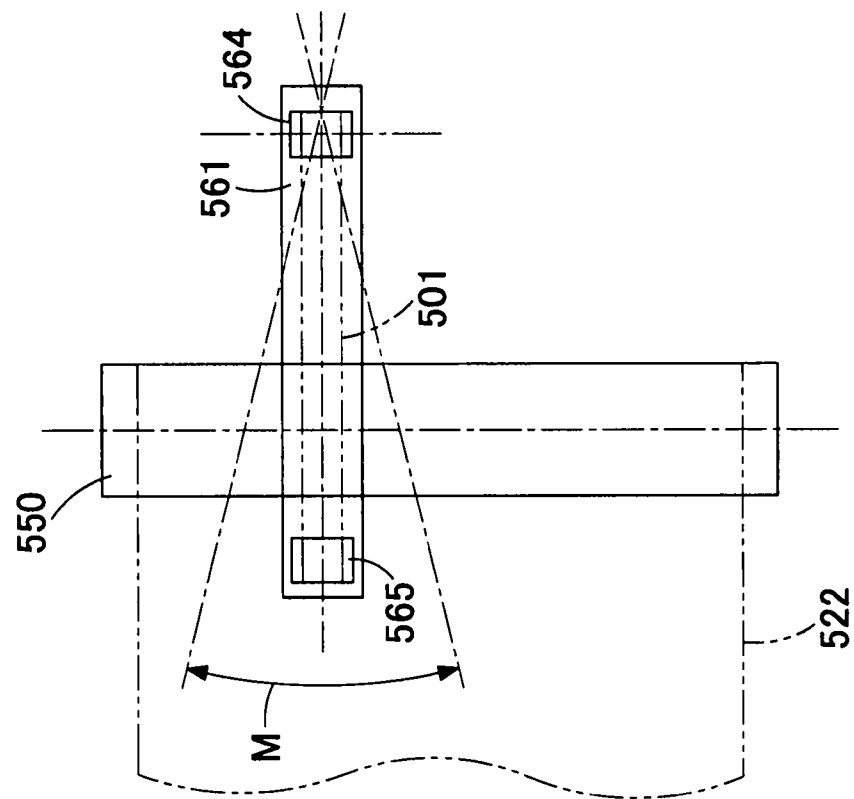

FIG. 6



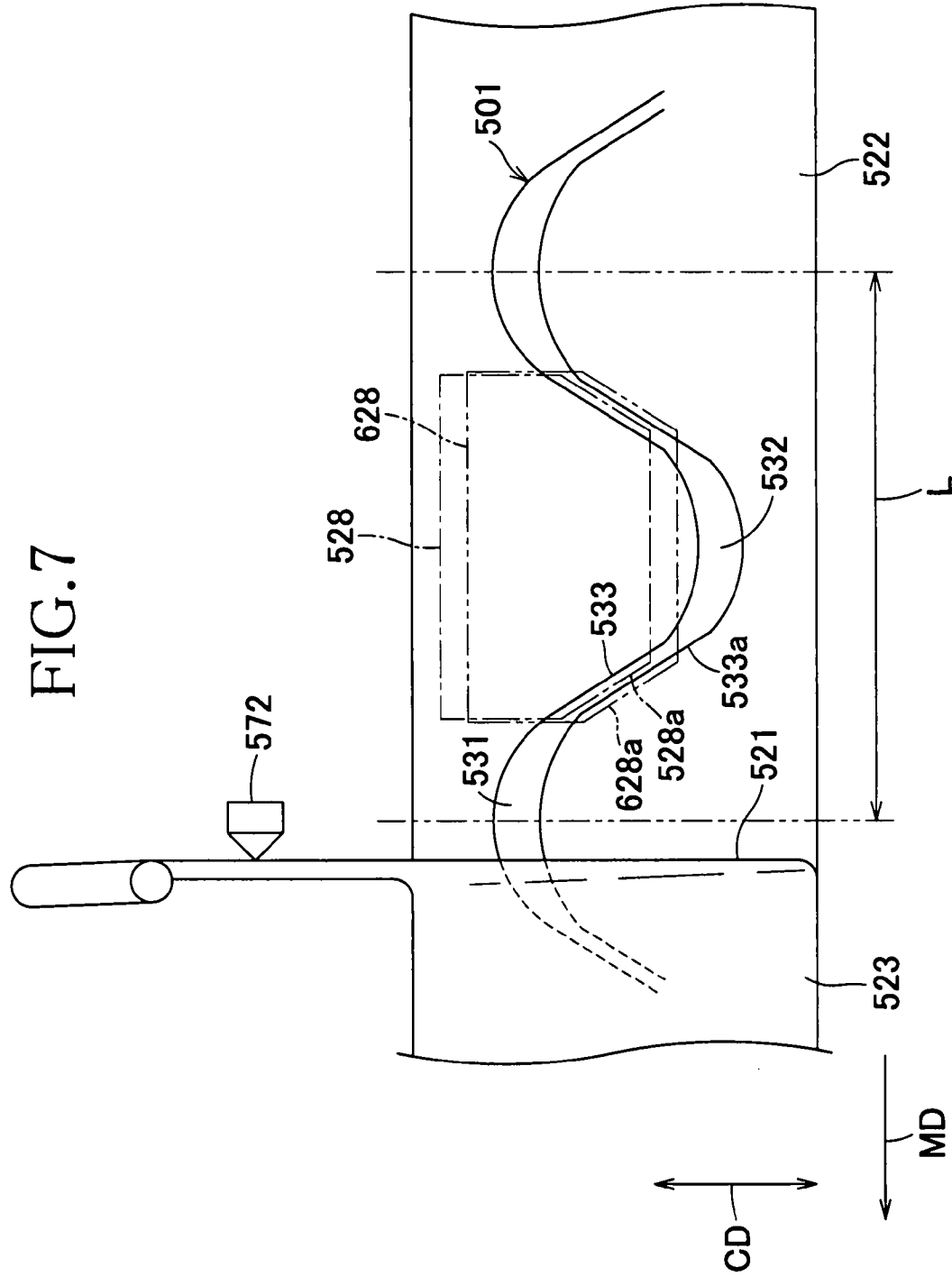

FIG. 8

