

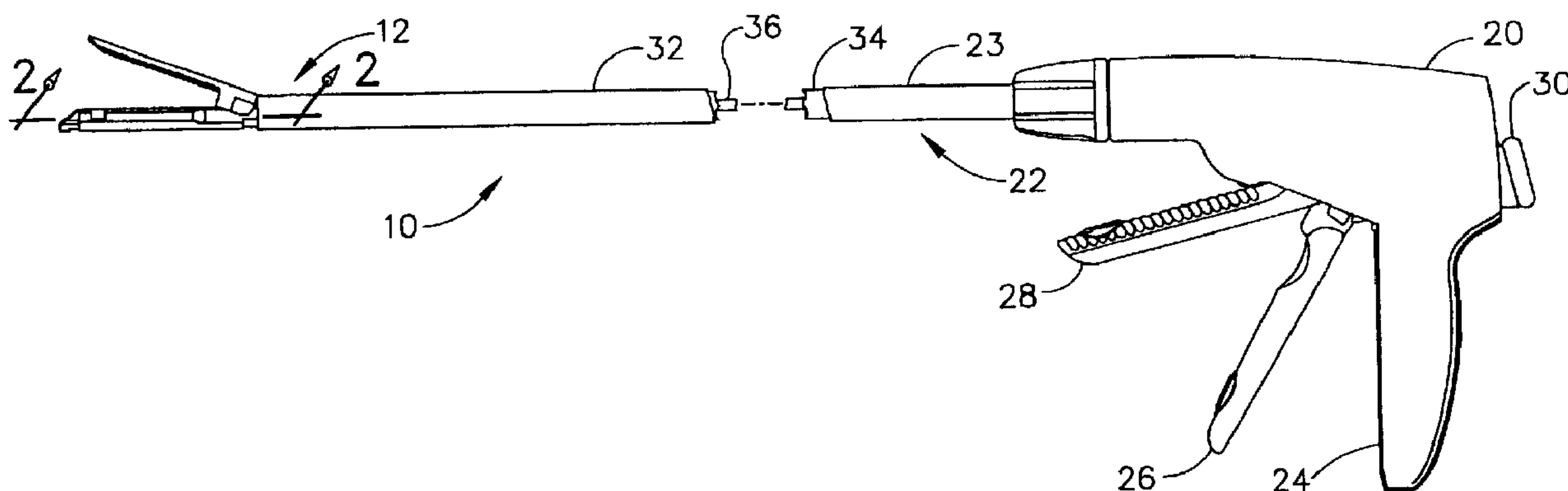

(22) Date de dépôt/Filing Date: 2004/05/20
 (41) Mise à la disp. pub./Open to Public Insp.: 2004/11/20
 (45) Date de délivrance/Issue Date: 2012/02/14
 (30) Priorité/Priority: 2003/05/20 (US10/441,632)

(51) Cl.Int./Int.Cl. *A61B 17/072* (2006.01),
A61B 17/068 (2006.01)
 (72) Inventeurs/Inventors:
SHELTON, FREDERICK E., IV, US;
SETSER, MICHAEL E., US;
HEMMELGARN, BRIAN J., US
 (73) Propriétaire/Owner:
ETHICON ENDO-SURGERY, INC., US
 (74) Agent: NORTON ROSE CANADA
S.E.N.C.R.L.,S.R.L./LLP

(54) Titre : INSTRUMENT D'AGRAFAGE CHIRURGICAL MUNI DE DISPOSITIFS DE FERMETURE ET DE
DECLENCHEMENT DISTINCTS
 (54) Title: SURGICAL STAPLING INSTRUMENT HAVING SEPARATE DISTINCT CLOSING AND FIRING SYSTEMS



(57) **Abrégé/Abstract:**

A surgical severing and stapling instrument clamps tissue within an end effector of an elongate channel pivotally opposed by an anvil. An E-beam firing bar affirmatively maintains a desired spacing while severing and stapling tissue by longitudinally engaging the anvil and elongate channel. Separate closing action and firing (i.e., severing and stapling) action of the end effector allows a clinician to selectively position and clamp tissue. The end effector enables this advantageous separate firing while affirmatively spacing the end effector by having an upper pin of the firing bar reside within an anvil pocket before firing. When the anvil is closed and clamped, the upper pin of the E-beam firing bar may move longitudinally and distally from the anvil pocket to an anvil slot thereby engaging the anvil.

SURGICAL STAPLING INSTRUMENT HAVING SEPARATE DISTINCT CLOSING AND FIRING SYSTEMS

Abstract of the Invention

A surgical severing and stapling instrument clamps tissue within an end effector of an elongate channel pivotally opposed by an anvil. An E-beam firing bar affirmatively maintains a desired spacing while severing and stapling tissue by longitudinally engaging the anvil and elongate channel. Separate closing action and firing (i.e., severing and stapling) action of the end effector allows a clinician to selectively position and clamp tissue. The end effector enables this advantageous separate firing while affirmatively spacing the end effector by having an upper pin of the firing bar reside within an anvil pocket before firing. When the anvil is closed and clamped, the upper pin of the E-beam firing bar may move longitudinally and distally from the anvil pocket to an anvil slot thereby engaging the anvil.

SURGICAL STAPLING INSTRUMENT HAVING SEPARATE DISTINCT CLOSING AND FIRING SYSTEMS

Field of the Invention

The present invention relates in general to surgical stapler instruments that are capable of applying lines of staples to tissue while cutting the tissue between those staple lines and, more particularly, to improvements relating to stapler instruments and improvements in processes for forming various components of such stapler instruments.

Background of the Invention

Surgical staplers have been used in the prior art to simultaneously make a longitudinal incision in tissue and apply lines of staples on opposing sides of the incision. Such instruments commonly include a pair of cooperating jaw members that, if the instrument is intended for endoscopic or laparoscopic applications, are

capable of passing through a cannula passageway. One of the jaw members receives a staple cartridge having at least two laterally spaced rows of staples. The other jaw member defines an anvil having staple-forming pockets aligned with the rows of staples in the cartridge. The instrument includes a plurality of reciprocating wedges that, when driven distally, pass through openings in the staple cartridge and engage drivers supporting the staples to effect the firing of the staples toward the anvil.

[0004] An example of a surgical stapler suitable for endoscopic applications is described in U.S. Pat. No. 5,465,895, which advantageously provides distinct closing and firing actions. Thereby, a clinician is able to close the jaw members upon tissue to position the tissue prior to firing. Once the clinician has determined that the jaw members are properly gripping tissue, the clinician can then fire the surgical stapler, thereby severing and stapling the tissue. The simultaneous severing and stapling avoids complications that may arise when performing such actions sequentially with different surgical tools that respectively only sever or staple.

[0005] One specific advantage of being able to close upon tissue before firing is that the clinician is able to verify via an endoscope that a sufficient amount of tissue has been captured between opposing jaws. Otherwise, opposing jaws may be drawn too close together, especially pinching at their distal ends, and thus not effectively forming closed staples in the severed tissue. Moreover, a firing bar that traverses between opposing jaws to sever the tissue and to drive the wedges that drive the staples may encounter resistance due to the pinched opposing jaws.

[0006] Thus, while such surgical staplers have been a significant advance in surgical procedures, an opportunity has been recognized for enhancing their effectiveness. In particular, it would be desirable to affirmatively maintain proper spacing between the opposing jaws during firing, yet have the advantageous of separate and distinct closure and firing.

[0007] Consequently, a significant need exists for an improved surgical stapling and severing instrument that maintains proper spacing in its end effector to achieve proper stapling of the severed tissue yet allows opening and closing of the end effector without firing.

Brief Summary of the Invention

The invention overcomes the above-noted and other deficiencies of the prior art by providing a surgical instrument with an end effector for clamping upon tissue, and then simultaneously severing and stapling the tissue. The clinical flexibility of separately closing and clamping upon tissue followed by the firing operation of the end effector (i.e., severing and stapling) is retained while incorporating an affirmative spacing of the end effector so that effective severing and staple forming is achieved.

In one aspect of the invention, a surgical instrument has a handle portion operable to separately produce a firing motion and a closing motion. An implement portion is responsive to the separate firing and closing motions from the handle portion. In particular, the firing device affirmatively spaces an elongate channel and a pivotally coupled anvil that form an end effector with a firing mechanism that engages the elongate channel and selectively engages the anvil. In particular, an upper device on the firing mechanism does not impede movement of the anvil when the firing mechanism is in its proximal, unfired position. Yet, the upper device engages the anvil when fired to ensure spacing of the anvil and the elongate channel.

In another aspect of the invention, the implement portion of an end effector and a shaft is sized for endo-surgical use through a cannula passageway. The shaft separately transfers the closing and firing motions from the handle portion to the end effector that performs repeated closings, clamping of tissue, and then firing. The end effector facilitates this clinical flexibility with the firing device that is engageable to an anvil of the end effector during firing.

These and other objects and advantages of the present invention shall be made apparent from the accompanying drawings and the description thereof.

Brief Description of the Figures

The accompanying drawings, which are incorporated in and constitute a part of this specification, illustrate embodiments of the invention, and, together with the general description of the invention given above, and the detailed description of the embodiments given below, serve to explain the principles of the present invention.

More particularly, there is disclosed a surgical instrument, comprising: a handle portion operable to separately produce a firing motion and a closing motion; and an implement portion responsive to the separate firing and closing motions from the handle portion, the implement portion comprising: an elongate channel coupled to the handle portion, an anvil pivotally coupled to the elongate channel, comprising a vertical anvil slot inwardly open along a longitudinal axis of the anvil and comprising left and right longitudinal recesses communicating with, bisected by, and transverse to the vertical slot, and a firing device including a distally presented cutting edge longitudinally received between the elongate channel and the anvil, an upper member comprising left and right engagement members each sized to have upper and lower surfaces that slidably engage inner surfaces of the respective left and right longitudinal recesses in the anvil, and a lower portion longitudinally engaging the elongate channel, wherein the upper member remains retracted and disengaged from the anvil during closing thereof and wherein engagement of the firing device during firing maintains vertical spacing between the elongate channel and the anvil resisting both pinching due to inadequately clamped tissue and partial opening due to an excessive amount of clamped tissue.

a surgical instrument, comprising: a handle portion operable to separately produce a firing motion in response to actuating a firing trigger and a closing motion in response to actuating a closure trigger; and an implement portion responsive to the separate firing and closing motions from the handle portion, the implement portion comprising: an end effector comprising a lower jaw and a pivoting anvil for repeatedly closing upon and clamping tissue, a closing means for pivoting the anvil toward the lower jaw of the end effector in response to the closure motion from the handle portion; and a firing means for remaining retracted, stationary, and disengaged from the anvil of the end effector allowing repeated closing upon tissue and for distally advancing in response to the firing motion from the handle portion to engage two opposing surfaces of the anvil of the end effector during firing for severing tissue and for maintaining spacing between the opposing jaws against pinching or partial opening.

Another feature of this disclosure is a surgical instrument, comprising: a handle portion operable to separately produce a firing motion in response to actuating a firing trigger and a closing motion in response to actuating a closure trigger; and an implement portion responsive to the separate firing and closing motions from the handle portion, the implement portion comprising: an end effector comprising a lower jaw and a pivoting anvil for repeatedly closing upon and clamping tissue, a closing means for pivoting the anvil toward the lower jaw of the end effector in response to the closure motion from the handle portion; and a firing means for remaining retracted, stationary, and disengaged from the anvil of the end effector allowing repeated closing upon tissue and for distally advancing in response to the firing motion from the handle portion to engage two opposing surfaces of the anvil of the end effector during firing for severing tissue and for maintaining spacing between the opposing jaws against pinching or partial opening.

A further feature of this disclosure is an endo-surgical instrument, comprising: a handle portion operable to separately produce a firing motion and a closing motion; an end effector sized for insertion through an endo-surgical cannula passageway; and a shaft attached between the handle portion and the end effector and operably configured to separately transfer the firing and closing motions therebetween; the end effector further comprising: an elongate channel coupled to the shaft, an anvil pivotally coupled to the elongate channel including an anvil slot that proximally communicates with a downwardly open anvil pocket, and a firing device longitudinally received between the elongate channel and the anvil and including an upper member engageable to the anvil slot wherein the anvil slot communicates to an upward surface and a downward surface of the anvil both slidably contacted by the upper member during distal movement for firing and wherein engagement of the firing device during firing maintains vertical spacing between the elongate channel and the anvil resisting both pinching due to inadequately clamped tissue and partial opening due to an excessive amount of clamped tissue, and wherein the upper member resides disengaged within the downwardly open anvil pocket when retracted.

- [0013] FIG. 1 depicts a partially cut-away side elevation view of a surgical stapling and severing instrument in an open position.
- [0014] FIG. 2 depicts a cross-sectional side elevation detail view along the line 2-2 of FIG. 1 of an end effector of the surgical stapling and severing instrument.
- [0015] FIG. 3 depicts an enlarged side elevation view of the firing bar of the surgical stapling and severing instrument of FIG. 2.
- [0016] FIG. 4 depicts an enlarged front view of the firing bar of the surgical stapling and severing instrument of FIG. 2.
- [0017] FIG. 5 depicts a cross-sectional side elevation detail view of an alternative end effector for the surgical stapling and severing instrument of FIG. 1, incorporating a firing bar that lacks a middle pin for preventing pinching of the end effector.
- [0018] FIG. 6 depicts a side elevational view of a handle portion of a proximal end of the surgical stapling and severing instrument of FIG. 1 with a left side removed to expose interior parts in an unclamped, unfired (“start”) position.
- [0019] FIG. 7 depicts a perspective, exploded view of the handle portion of the proximal end of the surgical stapling and severing instrument of FIG. 1.
- [0020] FIG. 8 depicts a side elevational view of the handle portion of the proximal end of the surgical stapling and severing instrument of FIG. 1 with the left side removed to expose interior parts in the closed (“clamped”) position.
- [0021] FIG. 9 depicts a side elevational view of the handle portion of proximal end of surgical stapling and severing instrument of FIG. 1 with the left side removed to expose interior parts in the stapled and severed (“fired”) position.
- [0022] FIG. 10 depicts an isometric view of the end effector at the distal end of the surgical stapling and severing instrument of FIG. 1 with the anvil in the up or open position exposing the staple cartridge and cutting edge of the firing bar.
- [0023] FIG. 11 depicts an isometric, exploded view of the implement portion of the surgical stapling and severing instrument of FIG. 1.

[0024] FIG. 12 depicts an isometric view of the end effector at the distal end of the surgical stapling and severing instrument of FIG. 1 with the anvil in the up or open position with the cartridge largely removed exposing a single staple driver and a double staple driver as exemplary and the wedge sled in its start position against a middle pin of the firing bar.

[0025] FIG 13 depicts an isometric view of the distal end of the surgical stapling and severing instrument of FIG. 1 with the anvil in the up or open position with the staple cartridge completely removed and a portion of an elongate channel removed to expose a lowermost pin of the firing bar.

[0026] FIG. 14 depicts a side elevation view in section showing a mechanical relationship between the anvil, elongate channel, and staple cartridge in the closed position of the surgical stapling and severing instrument of FIG. 1, the section generally taken along lines 14-14 of FIG. 10 to expose wedge sled, staple drivers and staples but also depicting the firing bar along the longitudinal centerline.

[0027] FIG. 15 depicts a section view of the end effector of the surgical stapling and severing instrument with the cartridge and firing bar in the start position taken along line 15-15 of FIG. 10.

[0028] FIG. 16 depicts a section view taken along line 16-16 of Fig. 15 showing the cross-sectional relationship between the firing bar, elongate channel, wedge sled, staple drivers, staples and staple cartridge.

[0029] FIG. 17 depicts a side elevation section view of the surgical stapling and severing instrument of FIG. 1 taken along the longitudinal centerline of the end effector in a partially closed but unclamped position gripping tissue.

[0030] FIG. 18 depicts a partially cut-away side elevational view of the surgical stapling and severing instrument of FIG. 1 in the closed or clamped position.

[0031] FIG. 19 depicts a side elevation view in centerline section of the distal end of the surgical stapling and severing instrument of FIG. 1 in the closed or clamped position with tissue properly compressed.

[0032] FIG. 20 depicts a partially cut-away side elevation view of the surgical stapling and severing instrument of FIG. 1 in a partially fired position.

[0033] FIG. 21 depicts a view in centerline section of the distal end of the surgical stapling and severing instrument of FIG. 1 in a partially fired position.

[0034] FIG. 22 depicts a partially cut-away side elevation view of the surgical stapling and severing instrument of FIG. 1 in a fully fired position.

[0035] FIG. 23 depicts a view in centerline section of the distal end of the surgical stapling and severing instrument of FIG. 1 in a fully fired position.

Detailed Description of the Invention

[0036] Turning to the Drawings, wherein like numerals denote like components throughout the several views, FIG. 1 and 2 depict a surgical stapling and severing instrument 10 that is capable of practicing the unique benefits of the present invention. The surgical stapling and severing instrument 10 incorporates an end effector 12 having an E-beam firing mechanism (“firing bar”) 14 that advantageously controls the spacing of the end effector 12. In particular, an elongate channel 16 and a pivotally translatable anvil 18 are maintained at a spacing that assures effective stapling and severing. The problems are avoided associated with varying amounts of tissue being captured in the end effector 12.

[0037] It will be appreciated that the terms “proximal” and “distal” are used herein with reference to a clinician gripping a handle of an instrument. Thus, the end effector 12 is distal with respect to the more proximal handle portion 20. It will be further appreciated that for convenience and clarity, spatial terms such as “vertical” and “horizontal” are used herein with respect to the drawings. However, surgical instruments are used in many orientations and positions, and these terms are not intended to be limiting and absolute.

[0038] The surgical and stapling and severing instrument 10 includes a handle portion 20 connected to an implement portion 22, the latter further comprising a shaft 23 distally terminating in the end effector 12. The handle portion 20 includes a pistol grip 24 toward which a closure trigger 26 is pivotally drawn by the clinician to cause

clamping, or closing, of the anvil 18 toward the elongate channel 16 of the end effector 12. A firing trigger 28 is farther outboard of the closure trigger 26 and is pivotally drawn by the clinician to cause the stapling and severing of clamped tissue in the end effector 12.

[0039] Closure trigger 26 is actuated first. Once the clinician is satisfied with the positioning of the end effector 12, the clinician may draw back the closure trigger 26 to its fully closed, locked position proximate to the pistol grip 24. Then, the firing trigger 28 is actuated. The firing trigger 28 springedly returns when the clinician removes pressure. A release button 30 when depressed on the proximal end of the handle portion 20 releases any locked closure trigger 26.

[0040] A closure sleeve 32 encloses a frame 34, which in turn encloses a firing drive member 36 that is positioned by the firing trigger 28. The frame 34 connects the handle portion 20 to the end effector 12. With the closure sleeve 32 withdrawn proximally by the closure trigger 26 as depicted, the anvil 18 springedly opens, pivoting away from the elongate channel 16 and translating proximally with the closure sleeve 32. The elongate channel 16 receives a staple cartridge 37.

[0041] E-BEAM FIRING MECHANISM

[0042] With particular reference to FIGS. 2-4, the firing bar 14 includes three vertically spaced pins that control the spacing of the end effector 12 during firing. In particular, an upper pin 38 is staged to enter an anvil pocket 40 near the pivot between the anvil 18 and elongate channel 16. When fired with the anvil 18 closed, the upper pin 38 advances distally within a longitudinal anvil slot 42 extending distally through anvil 18. Any minor upward deflection in the anvil 18 is overcome by a downward force imparted by the upper pin 38.

[0043] Firing bar 14 also includes a lower most pin, or firing bar cap, 44 that upwardly engages a channel slot 45 in the elongate channel 16, thereby cooperating with the upper pin 38 to draw the anvil 18 and the elongate channel 16 slightly closer together in the event of excess tissue clamped therebetween.

[0044] The firing bar 14 advantageously includes a middle pin 46 that passes through a firing drive slot 47 formed in a lower surface of the cartridge 37 and an upward

surface of the elongate channel 16, thereby driving the staples therein as described below. The middle pin 46, by sliding against the elongate channel 16, advantageously resists any tendency for the end effector 12 to be pinched shut at its distal end. To illustrate an advantage of the middle pin 46, FIG. 5 depicts an alternative end effector 12' that lacks a middle pin on a firing bar 14'. In this depiction, the end effector 12' is allowed to pinch shut at its distal end, which tends to impair desired staple formation.

[0045] Returning to FIGS. 2-4, a distally presented cutting edge 48 between the upper and middle pins 38, 46 on the firing bar 14 traverses through a proximally presented, vertical slot 49 in the cartridge 37 to sever clamped tissue. The affirmative positioning of the firing bar 14 with regard to the elongate channel 16 and anvil 18 assure that an effective cut is performed.

[0046] CAMBERED ANVIL WITH SELECTED CARTRIDGE GAP

[0047] The affirmative vertical spacing provided by the E-Beam firing bar 14 is suitable for the limited size available for endoscopic devices. Moreover, the E-Beam firing bar 14 enables fabrication of an anvil 16 with a camber imparting a vertical deflection at its distal end, similar to the position depicted in FIG. 5. This cambered anvil 16 advantageously assists in achieving the desired gap in the end effector 12 even with an anvil 16 reduced thickness, which is thus more suited to the size limitations of an endoscopic device.

[0048] The E-Beam firing bar 14 further enables increased applications, especially in combination with a range of configurations of staple cartridges. For instance, a clinician may select a gray staple cartridge yielding a 0.02 mm tissue gap, a white staple cartridge yielding a 0.04 mm tissue gap, a blue cartridge yielding a 0.06 mm tissue gap, or a green cartridge yielding a 0.10 mm tissue gap. The vertical height of each respective staple cartridge in combination with the length of staples and an integral wedge sled (described in more detail below) predetermines this desired tissue thickness with the anvil 18 appropriately vertically spaced by the E-Beam firing bar 14.

[0049] TWO-AXIS HANDLE

[0050] With reference to FIGS. 6-9, the handle portion 20 is comprised of first and second base sections 50 and 52, which are molded from a polymeric material such as a glass-filled polycarbonate. The first base section 50 is provided with a plurality of cylindrical-shaped pins 54. The second base section 52 includes a plurality of extending members 56, each having a hexagonal-shaped opening 58. The cylindrical-shaped pins 54 are received within the hexagonal-shaped openings 58 and are frictionally held therein for maintaining the first and second base sections 50 and 52 in assembly.

[0051] A rotating knob 60 has a bore 62 extending completely through it for engaging and rotating the implement portion 22 about its longitudinal axis. The rotating knob 60 includes an inwardly protruding boss 64 extending along at least a portion of the bore 62. The protruding boss 64 is received within a longitudinal slot 66 formed at a proximal portion of the closure sleeve 32 such that rotation of the rotating knob 60 effects rotation of the closure sleeve 32. It will be appreciated that the boss 64 further extends through frame 34 and into contact with a portion of the firing drive member 36 to effect their rotation as well. Thus, the end effector 12 (not shown in FIGS. 6-9) rotates with the rotating knob 60.

[0052] A proximal end 68 of the frame 34 passes proximally through the rotating knob 60 and is provided with a circumferential notch 70 that is engaged by opposing channel securement members 72 extending respectively from the base sections 50 and 52. Only the channel securement member 72 of the second base section 52 is shown. The channel securement members 72 extending from the base sections 50, 52 serve to secure the frame 34 to the handle portion 20 such that the frame 34 does not move longitudinally relative to the handle portion 20.

[0053] The closure trigger 26 has a handle section 74, a gear segment section 76, and an intermediate section 78. A bore 80 extends through the intermediate section 78. A cylindrical support member 82 extending from the second base section 52 passes through the bore 80 for pivotably mounting the closure trigger 26 on the handle portion 20. A second cylindrical support member 83 extending from the second base section 52 passes through a bore 81 of firing trigger 28 for pivotally mounting on the

handle portion 20. A hexagonal opening 84 is provided in the cylindrical support member 83 for receiving a securement pin (not shown) extending from the first base section 50.

[0054] A closure yoke 86 is housed within the handle portion 20 for reciprocating movement therein and serves to transfer motion from the closure trigger 26 to the closure sleeve 32. Support members 88 extending from the second base section 52 and securement member 72, which extends through a recess 89 in the yoke 86, support the yoke 86 within the handle portion 20.

[0055] A proximal end 90 of the closure sleeve 32 is provided with a flange 92 that is snap-fitted into a receiving recess 94 formed in a distal end 96 of the yoke 86. A proximal end 98 of the yoke 86 has a gear rack 100 that is engaged by the gear segment section 76 of the closure trigger 26. When the closure trigger 26 is moved toward the pistol grip 24 of the handle portion 20, the yoke 86 and, hence, the closure sleeve 32 move distally, compressing a spring 102 that biases the yoke 86 proximally. Distal movement of the closure sleeve 32 effects pivotal translation movement of the anvil 18 distally and toward the elongate channel 16 of the end effector 12 and proximal movement effects closing, as discussed below.

[0056] The closure trigger 26 is forward biased to an open position by a front surface 130 interacting with an engaging surface 128 of the firing trigger 28. Clamp first hook 104 that pivots top to rear in the handle portion 20 about a pin 106 restrains movement of the firing trigger 28 toward the pistol grip 24 until the closure trigger 26 is clamped to its closed position. Hook 104 restrains firing trigger 28 motion by engaging a lockout pin 107 in firing trigger 28. The hook 104 is also in contact with the closure trigger 26. In particular, a forward projection 108 of the hook 104 engages a member 110 on the intermediate section 78 of the closure trigger 26, the member 110 being outward of the bore 80 toward the handle section 74. Hook 104 is biased toward contact with member 110 of the closure trigger 26 and engagement with lockout pin 107 in firing trigger 28 by a release spring 112. As the closure trigger 26 is depressed, the hook 104 is moved top to rear, compressing the release spring 112 that is captured between a rearward projection 114 on the hook 104 and a forward projection 116 on the release button 30.

- [0057] As the yoke 86 moves distally in response to proximal movement of the closure trigger 26, an upper latch arm 118 of the release button 30 moves along an upper surface 120 on the yoke 86 until dropping into an upwardly presented recess 122 in a proximal, lower portion of the yoke 86. The release spring 112 urges the release button 30 outward, which pivots the upper latch arm 118 downwardly into engagement with the upwardly presented recess 122, thereby locking the closure trigger 26 in a tissue clamping position, such as depicted in FIG. 8.
- [0058] The latch arm 118 can be moved out of the recess 122 to release the anvil 18 by pushing the release button 30 inward. Specifically, the upper latch arm 118 pivots upward about pin 123 of the second base section 52. The yoke 86 is then permitted to move proximally in response to return movement of the closure trigger 26.
- [0059] A firing trigger return spring 124 is located within the handle portion 20 with one end attached to pin 106 of the second base section 52 and the other end attached to a pin 126 on the firing trigger 28. The firing return spring 124 applies a return force to the pin 126 for biasing the firing trigger 28 in a direction away from the pistol grip 24 of the handle portion 20. The closure trigger 26 is also biased away from pistol grip 24 by engaging surface 128 of firing trigger 28 biasing front surface 130 of closure trigger 26.
- [0060] As the closure trigger 26 is moved toward the pistol grip 24, its front surface 130 engages with the engaging surface 128 on the firing trigger 28 causing the firing trigger 28 to move to its "firing" position. When in its firing position, the firing trigger 28 is located at an angle of approximately 45° to the pistol grip 24. After staple firing, the spring 124 causes the firing trigger 28 to return to its initial position. During the return movement of the firing trigger 28, its engaging surface 128 pushes against the front surface 130 of the closure trigger 26 causing the closure trigger 26 to return to its initial position. A stop member 132 extends from the second base section 52 to prevent the closure trigger 26 from rotating beyond its initial position.
- [0061] The surgical stapling and severing instrument 10 additionally includes a reciprocating section 134, a multiplier 136 and a drive member 138. The reciprocating section 134 comprises a wedge sled in the implement portion 22 (not shown in FIG. 6-9) and a metal drive rod 140.

- [0062] The drive member 138 includes first and second gear racks 141 and 142. A first notch 144 is provided on the drive member 138 intermediate the first and second gear racks 141, 142. During return movement of the firing trigger 28, a tooth 146 on the firing trigger 28 engages with the first notch 144 for returning the drive member 138 to its initial position after staple firing. A second notch 148 is located at a proximal end of the metal drive rod 140 for locking the metal drive rod 140 to the upper latch arm 118 of the release button 30 in its unfired position.
- [0063] The multiplier 136 comprises first and second integral pinion gears 150 and 152. The first integral pinion gear 150 is engaged with a first gear rack 154 provided on the metal drive rod 140. The second integral pinion gear 152 is engaged with the first gear rack 141 on the drive member 138. The first integral pinion gear 150 has a first diameter and the second integral pinion gear 152 has a second diameter which is smaller than the first diameter.
- [0064] FIGS. 6, 8 and 9 depict respectively the handle portion 20 in the start position (open and unfired), a clamped position (closed and unfired) and a fired position. The firing trigger 28 is provided with a gear segment section 156. The gear segment section 156 engages with the second gear rack 142 on the drive member 138 such that motion of the firing trigger 28 causes the drive member 138 to move back and forth between a first drive position, shown in FIG. 8, and a second drive position, shown in FIG. 9. In order to prevent staple firing before tissue clamping has occurred, the upper latch arm 118 on the release button 30 is engaged with the second notch 148 on the drive member 138 such that the metal drive rod 140 is locked in its proximal-most position, as depicted in FIG. 6. When the upper latch arm 118 falls into the recess 122, the upper latch arm 118 disengages with the second notch 148 to permit distal movement of the metal drive rod 140, as depicted in FIG. 9.
- [0065] Because the first gear rack 141 on the drive member 138 and the gear rack 154 on the metal drive rod 140 are engaged with the multiplier 136, movement of the firing trigger 28 causes the metal drive rod 140 to reciprocate between a first reciprocating position, shown in FIG. 8, and a second reciprocating position, shown in FIG. 9. Since the diameter of the first pinion gear 150 is greater than the diameter of the second pinion gear 152, the multiplier 136 moves the reciprocating section 134 a

greater distance than the drive member 138 is moved by the firing trigger 28. The diameters of the first and second pinion gears 150 and 152 may be changed to permit the length of the stroke of the firing trigger 28 and the force required to move it to be varied.

[0066] It will be appreciated that the handle portion 20 is illustrative and that other actuation mechanisms may be employed. For instance, the closing and firing motions may be generated by automated means.

[0067] SEPARATE AND DISTINCT CLOSING AND FIRING END EFFECTOR

[0068] The end effector 12 of the surgical stapling and severing instrument 10 is depicted in further detail in FIGS. 10-16. As described above, the handle portion 20 produces separate and distinct closing and firing motions that actuate the end effector 12. The end effector 12 advantageously maintains the clinical flexibility of this separate and distinct closing and firing (i.e., stapling and severing). In addition, the end effector 12 introduces the aforementioned ability to affirmatively maintain the closed spacing during firing after the clinician positions and clamps the tissue. Both features procedurally and structurally enhance the ability of the surgical stapling and severing instrument 10 by ensuring adequate spacing for instances where an otherwise inadequate amount of tissue is clamped and to enhance the clamping in instances where an otherwise excessive amount of tissue has been clamped.

[0069] FIG. 10 depicts the end effector 12, which is in an open position by a retracted closure sleeve 32, with a staple cartridge 37 installed in the elongate channel 16. On a lower surface 200 of the anvil 18, a plurality of stapling forming pockets 202 are arrayed to correspond to a plurality of stapler apertures 204 in an upper surface 206 of the staple cartridge 37. The firing bar 14 is at its proximal position, with the upper pin 38 aligned in a noninterfering fashion with the anvil pocket 40. The anvil pocket 40 is shown as communicating with the longitudinal anvil slot 42 in the anvil 18. The distally presented cutting edge 48 of the firing bar 14 is aligned with and proximally from removed from the vertical slot 49 in the staple cartridge 37, thereby allowing removal of a spent cartridge and insertion of an unfired cartridge, which is snapfit into the elongate channel 16. Specifically, extension features 208, 210 of the staple cartridge 37 engage recesses 212, 214 (shown in FIG. 12) of the elongate channel 16.

[0070] FIG. 11 shows the implement portion 22 of the surgical stapling and severing instrument 10 in disassembled form. The staple cartridge 37 is shown as being comprised of a cartridge body 216, a wedge sled 218, single and double drivers 220, staples 222, and a cartridge tray 224. When assembled, the cartridge tray 224 holds the wedge sled 218, single and double drivers 220, and staples 222 inside the cartridge body 216.

[0071] Having a wedge sled 218 integral to the staple cartridge 37 enables a number of flexible design options as compared to incorporating camming surfaces onto a firing bar itself. For instance, a number of different staple cartridges may be selected for use in the instrument 10 with each staple cartridge having a different configuration of rows of staples, each thus having a unique wedge sled configured to contact the middle pin 46 of the firing bar 14 while causing the driving of the staples 222. As another example, the integral wedge sled 218 provides an opportunity for a number of lockout features, described in greater detail in the first and third aforementioned co-pending applications.

[0072] The elongate channel 16 has a proximally placed attachment cavity 226 that receives a channel anchoring member 228 on the distal end of the frame 34 for attaching the end effector 12 to the handle portion 20. The elongate channel 16 also has an anvil cam slot 230 that pivotally receives an anvil pivot 232 of the anvil 18. The closure sleeve 32 that encompasses the frame 34 includes a distally presented tab 234 that engages an anvil feature 236 proximate but distal to the anvil pivot 232 on the anvil 18 to thereby effect opening and closing of the anvil 18. The firing drive member 36 is shown as being assembled from the firing bar 14 attached to a firing connector 238 by pins 240, which in turn is rotatably and proximally attached to the metal drive rod 140. The firing bar 14 is guided at a distal end of the frame by a slotted guide 239 inserted therein.

[0073] With particular reference to FIG. 12, a portion of the staple cartridge 37 is removed to expose portions of the elongate channel 16, such as recesses 212, 214 and to expose some components of the staple cartridge 37 in their unfired position. In particular, the cartridge body 216 (shown in FIG. 11) has been removed. The wedge sled 218 is shown at its proximal, unfired position with a pusher block 242 contacting

the middle pin 46 (not shown in FIG. 12) of the firing bar 14. The wedge sled 218 is in longitudinal sliding contact upon the cartridge tray 224 and includes wedges 228 that force upward the single and double drivers 220 as the wedge sled 218 moves distally. Staples 222 (not shown in FIG. 12) resting upon the drivers 220 are thus also forced upward into contact with the anvil forming pockets 202 on the anvil 18 to form closed staples. Also depicted is the channel slot 45 in the elongate channel 16 that is aligned with the vertical slot 49 in the staple cartridge 37.

[0074] FIG. 13 depicts the end effector 12 of FIG. 12 with all of the staple cartridge 37 removed to show the middle pin 46 of the firing bar 14 as well as portion of the elongate channel 16 removed adjacent to the channel slot 45 to expose the firing bar cap 44. In addition, portions of the shaft 23 are removed to expose a proximal portion of the firing bar 14. Projecting downward from the anvil 18 near the pivot, a pair of opposing tissue stops 244 prevent tissue being positioned too far up into the end effector 12 during clamping.

[0075] FIG. 14 depicts the end effector 12 closed in a tissue clamping position with the firing bar 14 unfired. The upper pin 38 is in the anvil pocket 40, vertically aligned with the anvil slot 42 for distal longitudinal movement of the firing bar 14 during firing. The middle pin 46 is positioned to push the wedge sled 218 distally so that wedge 228 sequentially contacts and lifts double drivers 220 and the respective staples 222 into forming contact with staple forming pockets 202 in the lower surface 200 of the anvil 18.

[0076] FIG. 15 depicts the upper surface 206 of the staple cartridge 37 with the firing bar 14 in its unfired, proximal position. The stapler apertures 204 are arrayed on each side of the vertical slot 49 in the staple cartridge 37.

[0077] FIG. 16 depicts the end effector 12 near the pivot showing that the elongate channel 16 has opposing ramp portions 246 to thereby cooperate with the tissue stops 244 of the anvil 18 (not shown in FIG. 16) to prevent tissue from jamming the end effector 12. Also depicted in greater detail are the double drivers 220 and their relation to the staples 222.

[0078] OPERATION

[0079] In use, the surgical stapling and severing instrument 10 is used as depicted in FIGS 1, 2, and 17-23. In FIGS. 1-2, the instrument 10 is in its start position, having had an unfired, fully loaded staple cartridge 37 snap-fitted into the distal end of the elongate channel 16. Both triggers 26, 28 are forward and the end effector 12 is open, such as would be typical after inserting the end effector 12 through a trocar or other opening into a body cavity. The instrument 10 is then manipulated by the clinician such that tissue 248 to be stapled and severed is positioned between the staple cartridge 37 and the anvil 18, as depicted in FIG. 17.

[0080] With reference to FIGS. 18-19, next, the clinician moves the closure trigger 26 proximally until positioned directly adjacent to the pistol grip 24, locking the handle portion 20 into the closed and clamped position. The retracted firing bar 14 in the end effector 12 does not impede the selective opening and closing of the end effector 12, but rather resides within the anvil pocket 40. With the anvil 18 closed and clamped, the E-beam firing bar 14 is aligned for firing through the end effector 12. In particular, the upper pin 38 is aligned with the anvil slot 42 and the elongate channel 16 is affirmatively engaged about the channel slot 45 by the middle pin 46 and the firing bar cap 44.

[0081] With reference to FIGS. 20-21, after tissue clamping has occurred, the clinician moves the firing trigger 28 proximally causing the firing bar 14 to move distally into the end effector 12. In particular, the middle pin 46 enters the staple cartridge 37 through the firing drive slot 47 to effect the firing of the staples 222 (not shown in FIGS. 20-21) via wedge sled 218 toward the anvil 18. The lower most pin, or firing bar cap 44, cooperates with the middle pin 46 to slidably position cutting edge 48 of the firing bar 14 to sever tissue. The two pins 44, 46 also position the upper pin 38 of the firing bar 14 within longitudinal anvil slot 42 of the anvil 18, affirmatively maintaining the spacing between the anvil 18 and the elongate channel 16 throughout its distal firing movement.

[0082] With reference to FIGS. 22-23, the clinician continues moving the firing trigger 28 until brought proximal to the closure trigger 26 and pistol grip 24. Thereby, all of the ends of the staples 222 are bent over as a result of their

engagement with the anvil 18. The firing bar cap 44 is arrested against a firing bar stop 250 projecting toward the distal end of the channel slot 45. The cutting edge 48 has traversed completely through the tissue. The process is complete by releasing the firing trigger 28 and by then depressing the release button 30 while simultaneously squeezing the closure trigger 26 to open the end effector 12.

[0083] While the present invention has been illustrated by description of several embodiments and while the illustrative embodiments have been described in considerable detail, it is not the intention of the applicant to restrict or in any way limit the scope of the appended claims to such detail. Additional advantages and modifications may readily appear to those skilled in the art.

[0084] For example, the affirmative spacing of the anvil 18 and elongate channel 16 is achieved in part with two pins 44, 46 on the firing bar 14 engaging opposite sides of a channel slot 47 and a single upper pin 38 entrained within an anvil slot 42. It would be consistent with aspects of the invention for the anvil to be captured by opposing pins on either side of a longitudinal slot and/or for an elongate channel to have an internal slot that entrains a lower pin.

[0085] For another example, although the E-beam firing beam 14 has advantages for an endoscopically employed surgical severing and stapling instrument 10, a similar E-Beam may be used in other clinical procedures. It is generally accepted that endoscopic procedures are more common than laparoscopic procedures. Accordingly, the present invention has been discussed in terms of endoscopic procedures and apparatus. However, use herein of terms such as "endoscopic", should not be construed to limit the present invention to a surgical stapling and severing instrument for use only in conjunction with an endoscopic tube (i.e., trocar). On the contrary, it is believed that the present invention may find use in any procedure where access is limited to a small incision, including but not limited to laparoscopic procedures, as well as open procedures.

[0086] For yet another example, although an illustrative handle portion 20 described herein is manually operated by a clinician, it is consistent with aspects of the invention for some or all of the functions of a handle portion to be powered (e.g., pneumatic, hydraulic, electromechanical, ultrasonic, etc.). Furthermore, controls of

each of these functions may be manually presented on a handle portion or be remotely controlled (e.g., wireless remote, automated remote console, etc.).

[0087] What is claimed is:

Claims:

1. A surgical instrument, comprising:
 - a handle portion operable to separately produce a firing motion and a closing motion; and
 - an implement portion responsive to the separate firing and closing motions from the handle portion, the implement portion comprising:
 - an elongate channel coupled to the handle portion,
 - an anvil pivotally coupled to the elongate channel, comprising a vertical anvil slot inwardly open along a longitudinal axis of the anvil and comprising left and right longitudinal recesses communicating with, bisected by, and transverse to the vertical slot, and
 - a firing device including a distally presented cutting edge longitudinally received between the elongate channel and the anvil, an upper member comprising left and right engagement members each sized to have upper and lower surfaces that slidably engage inner surfaces of the respective left and right longitudinal recesses in the anvil, and a lower portion longitudinally engaging the elongate channel,

wherein the upper member remains retracted and disengaged from the anvil during closing thereof and wherein engagement of the firing device during firing maintains vertical spacing between the elongate channel and the anvil resisting both pinching due to inadequately clamped tissue and partial opening due to an excessive amount of clamped tissue.
2. The surgical instrument of claim 1, wherein the implement portion further comprises a staple cartridge received in the elongate channel, the firing device operable to actuate the staple cartridge during firing.
3. The surgical instrument of claim 1, wherein the anvil includes an inwardly open anvil pocket proximal to and communicating with the vertical anvil slot and proximate to the firing device when in an unfired position and the anvil communicating with the anvil pocket for receiving the upper member of the firing device when fired.

4. The surgical instrument of claim 3, wherein the elongate channel includes a longitudinal channel and lower portion of the firing device further comprises a middle member and a lower member opposingly engaging the longitudinal channel.
5. The surgical instrument of claim 1, wherein the elongate channel includes a longitudinal channel and lower portion of the firing device further comprises a middle member and a lower member opposingly engaging the longitudinal channel.
6. The surgical instrument of claim 1, wherein the elongate channel includes a longitudinal channel slidingly engaged by a lower portion of the firing device.
7. The surgical device of claim 6, wherein the longitudinal channel comprises a longitudinal slot and the lower portion of the firing device comprises a middle member and a lower member opposingly engaging the longitudinal slot of the elongate channel.
8. The surgical instrument of claim 1, wherein the handle portion further comprises a firing actuator coupled to the firing device and a closure actuator, the shaft further comprising a closure member communicating a closure motion from the closure actuator to the anvil to effect closure, wherein the firing device remains proximally retracted during transmission of the closure motion through the closure member to the anvil.
9. The surgical instrument of claim 8, wherein the closure actuator comprises a closure trigger and the firing actuator comprises a firing trigger.
10. The surgical instrument of claim 8, wherein the closure member comprises a closure tube distally engaged to the pivotal coupling of the anvil to the elongate channel to effect closure.
11. The surgical instrument of claim 8, wherein the anvil includes a recess proximate to the firing device when in an unfired position and a longitudinal anvil slot communicating with the recess for selective engaging the upper member of the firing device when fired.

12. The surgical instrument of claim 8, wherein the implement portion further comprises a staple cartridge received in the elongate channel, the firing device operable to actuate the staple cartridge during firing.

13. The surgical instrument of claim 8, wherein the anvil includes a recess proximate to the firing device when in an unfired position and the anvil slot communicating with the recess for receiving the upper member of the firing device when fired and wherein the elongate channel includes a longitudinal channel and the lower portion of the firing device further comprises a middle member and a lower member opposingly engaging the longitudinal channel.

14. The surgical instrument of claim 8, wherein the elongate channel includes a longitudinal channel and the lower portion of the firing device further comprises a middle member and a lower member opposingly engaging the longitudinal channel.

15. A surgical instrument, comprising:

a handle portion operable to separately produce a firing motion in response to actuating a firing trigger and a closing motion in response to actuating a closure trigger; and

an implement portion responsive to the separate firing and closing motions from the handle portion, the implement portion comprising:

an end effector comprising a lower jaw and a pivoting anvil for repeatedly closing upon and clamping tissue,

a closing means for pivoting the anvil toward the lower jaw of the end effector in response to the closure motion from the handle portion; and

a firing means for remaining retracted, stationary, and disengaged from the anvil of the end effector allowing repeated closing upon tissue and for distally advancing in response to the firing motion from the handle portion to engage two opposing surfaces of the anvil of the end effector during firing for severing tissue and for maintaining spacing between the opposing jaws against pinching or partial opening.

16. The surgical instrument of claim 15, further comprising:

a stapler cartridge held by the end effector means and responsive to the firing means for forming staples in the clamped tissue.

17. An endo-surgical instrument, comprising:

a handle portion operable to separately produce a firing motion and a closing motion;

an end effector sized for insertion through an endo-surgical cannula passageway; and

a shaft attached between the handle portion and the end effector and operably configured to separately transfer the firing and closing motions therebetween;

the end effector further comprising:

an elongate channel coupled to the shaft,
 an anvil pivotally coupled to the elongate channel including an anvil slot that proximally communicates with a downwardly open anvil pocket, and

a firing device longitudinally received between the elongate channel and the anvil and including an upper member engageable to the anvil slot wherein the anvil slot communicates to an upward surface and a downward surface of the anvil both slidingly contacted by the upper member during distal movement for firing and wherein engagement of the firing device during firing maintains vertical spacing between the elongate channel and the anvil resisting both pinching due to inadequately clamped tissue and partial opening due to an excessive amount of clamped tissue, and wherein the upper member resides disengaged within the downwardly open anvil pocket when retracted.

18. The surgical instrument of claim 17, further comprises a staple cartridge received in the elongate channel, the firing device operable to actuate the staple cartridge during firing.

19. The surgical instrument of claim 17, wherein the anvil includes a recess proximate to the firing device when in an unfired position and a longitudinal anvil slot communicating with the recess for receiving the upper member of the firing device when fired.

20. The surgical instrument of claim 19, wherein the elongate channel includes a longitudinal slot and the firing device further comprises a middle member and a lower member opposingly engaging the longitudinal slot of the elongate channel.

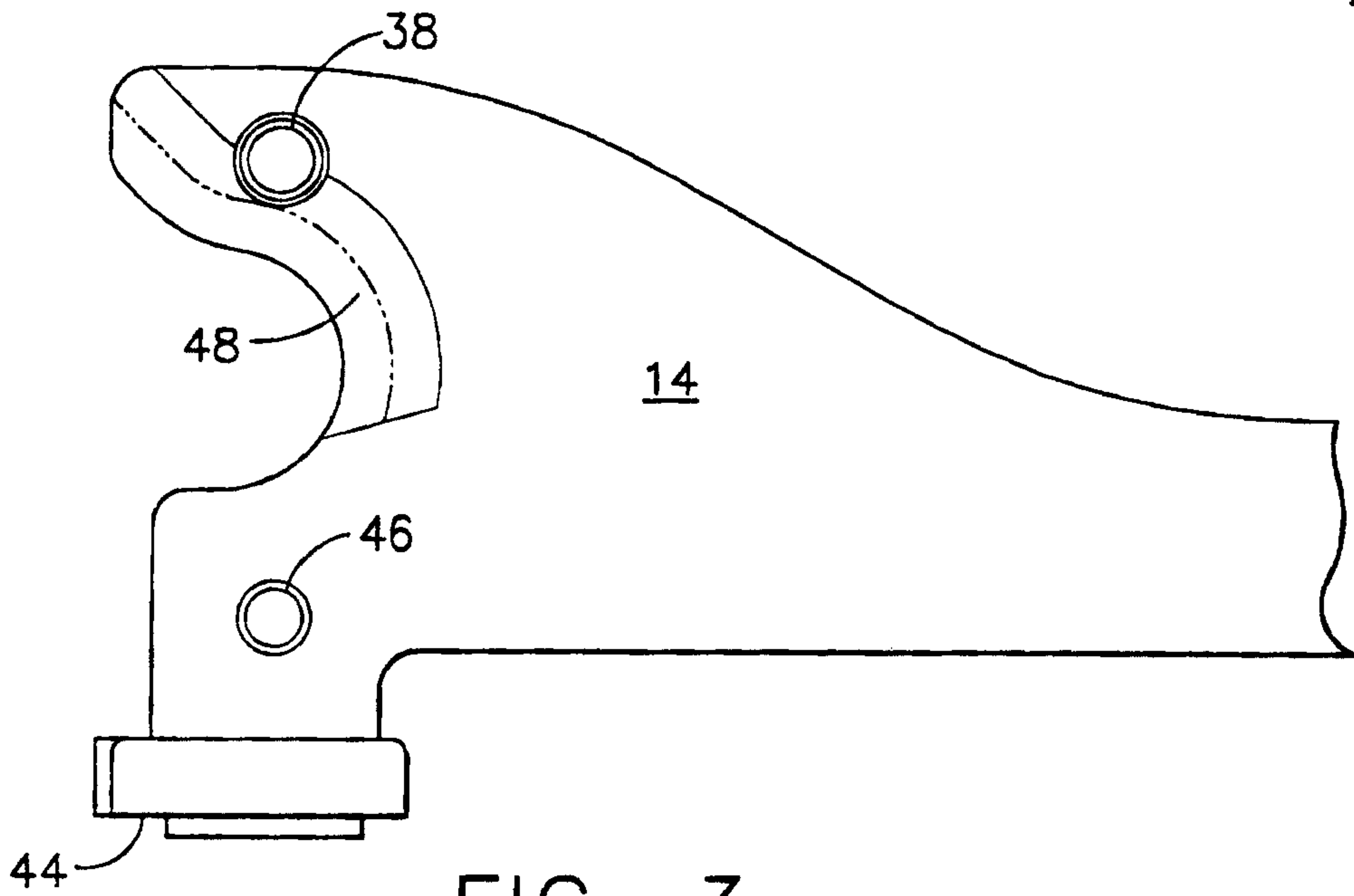

FIG. 3

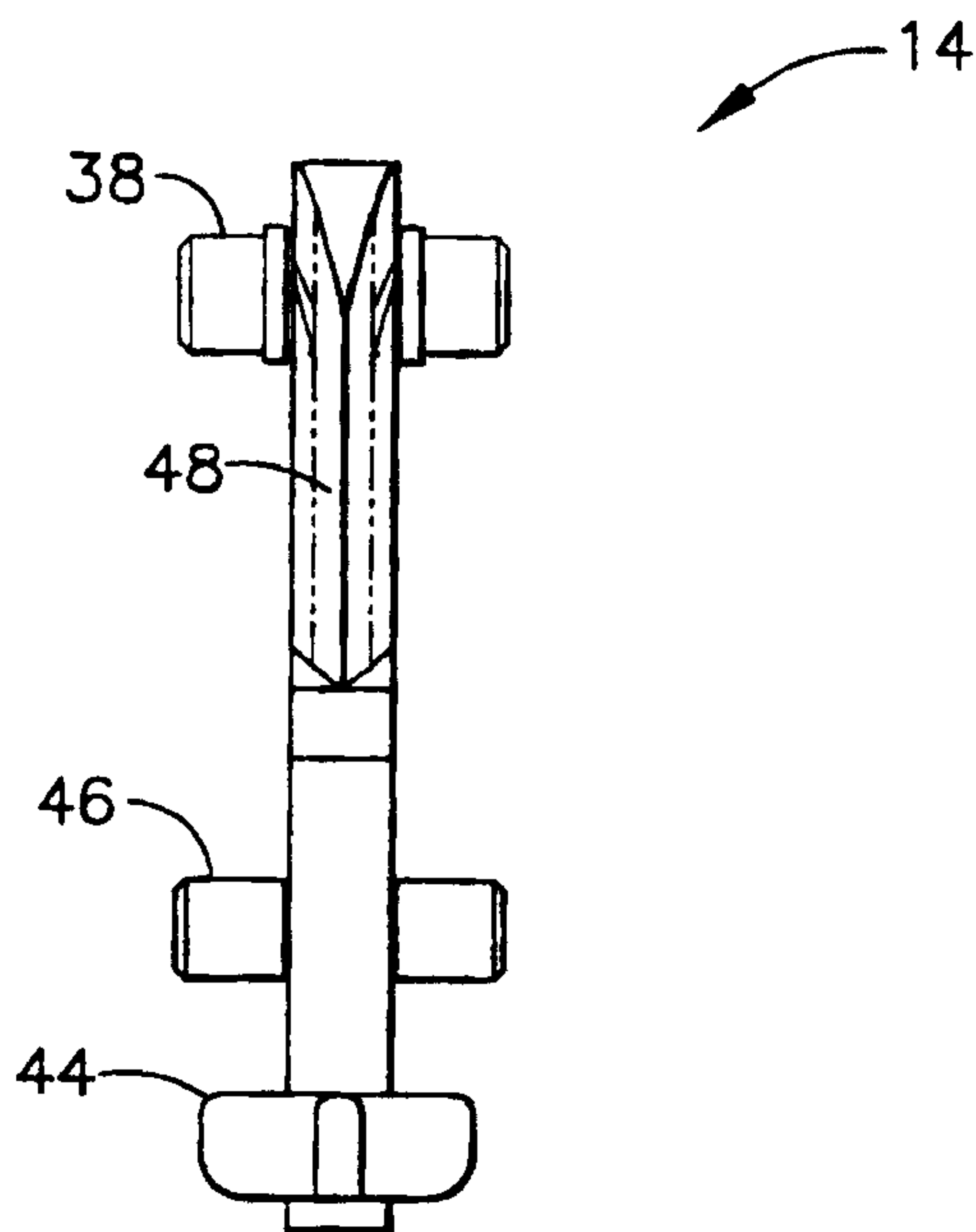

FIG. 4

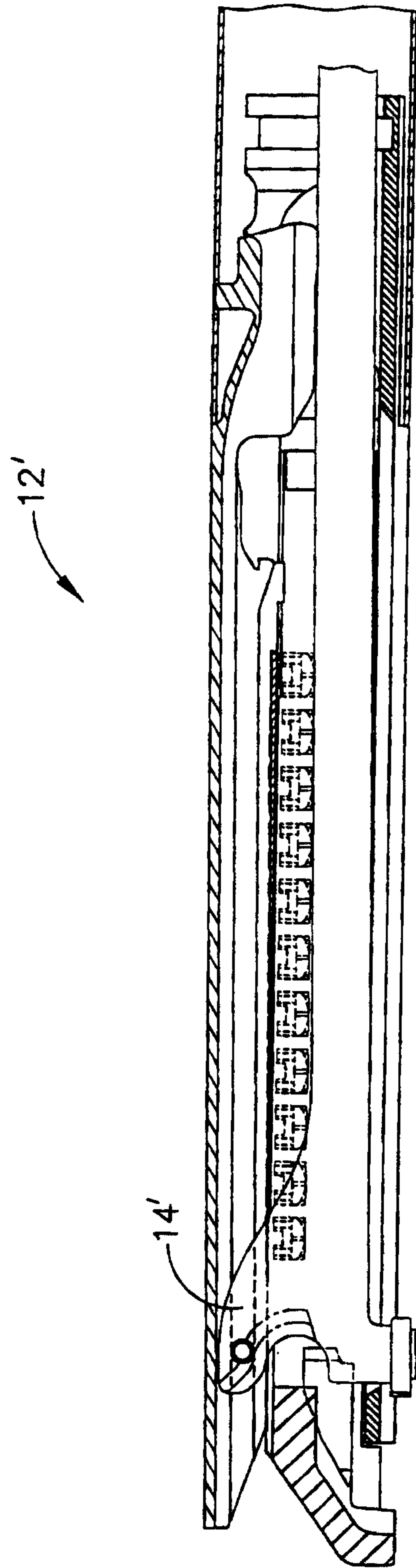

FIG. 5

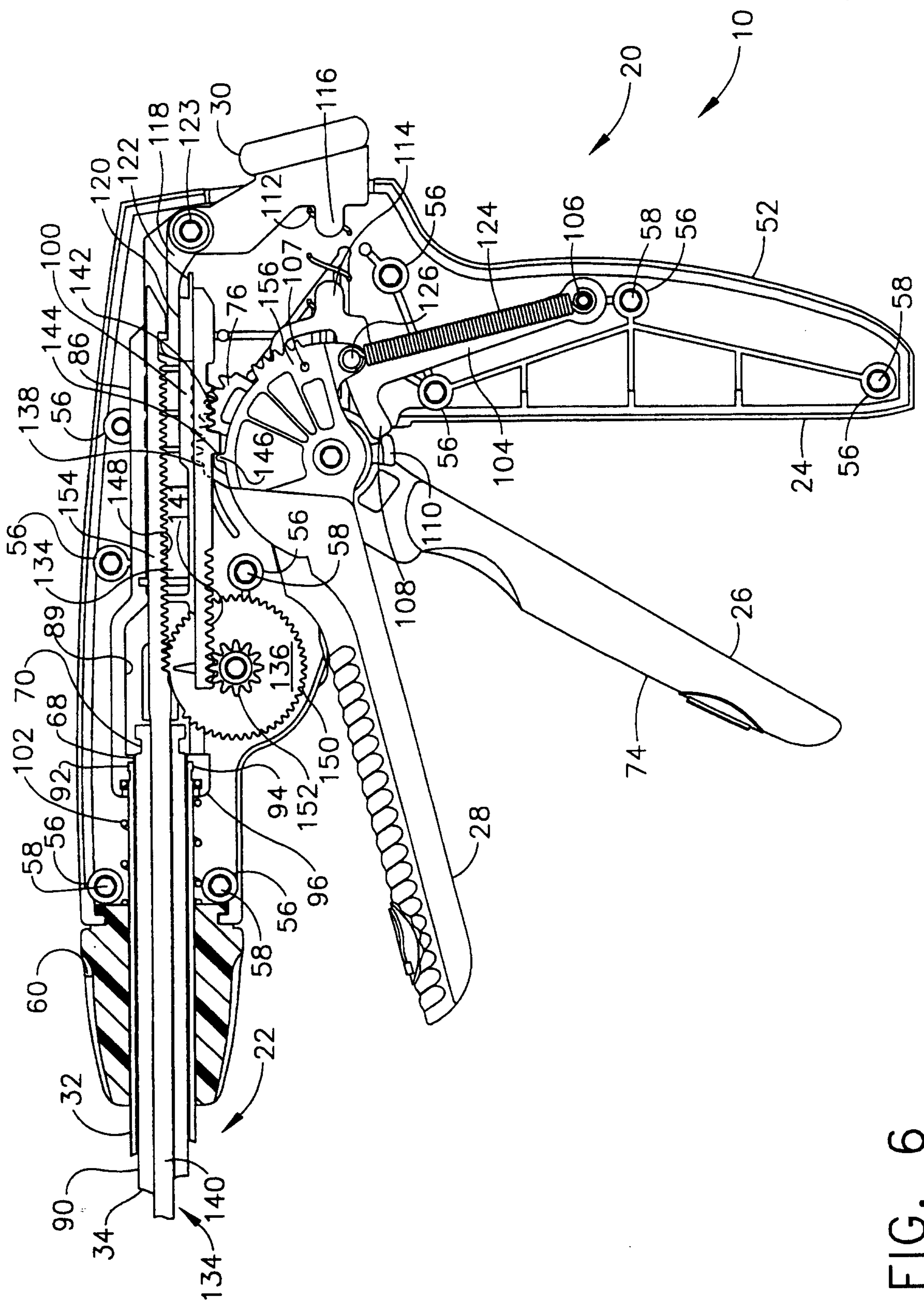

FIG. 6

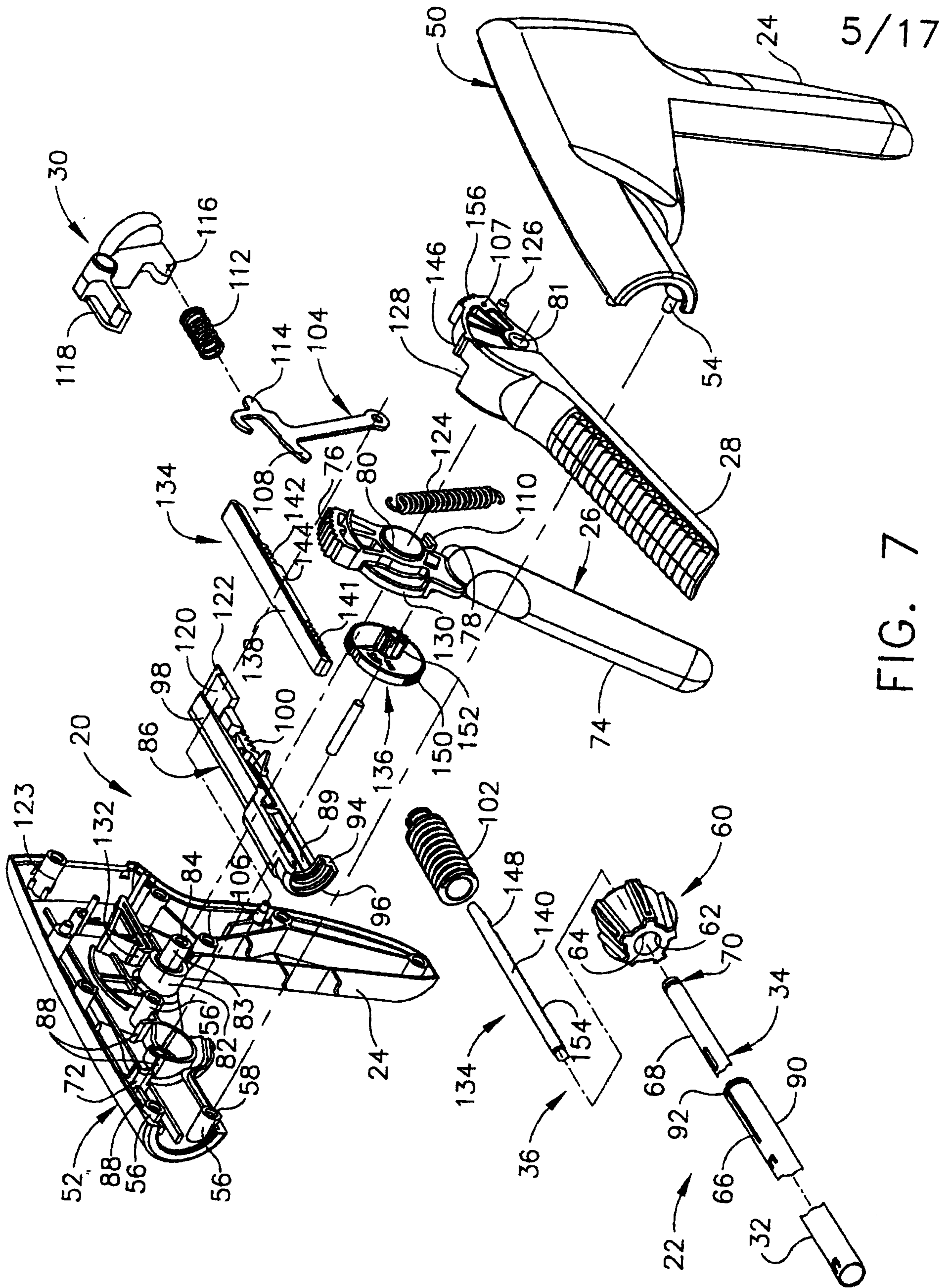

FIG. 7

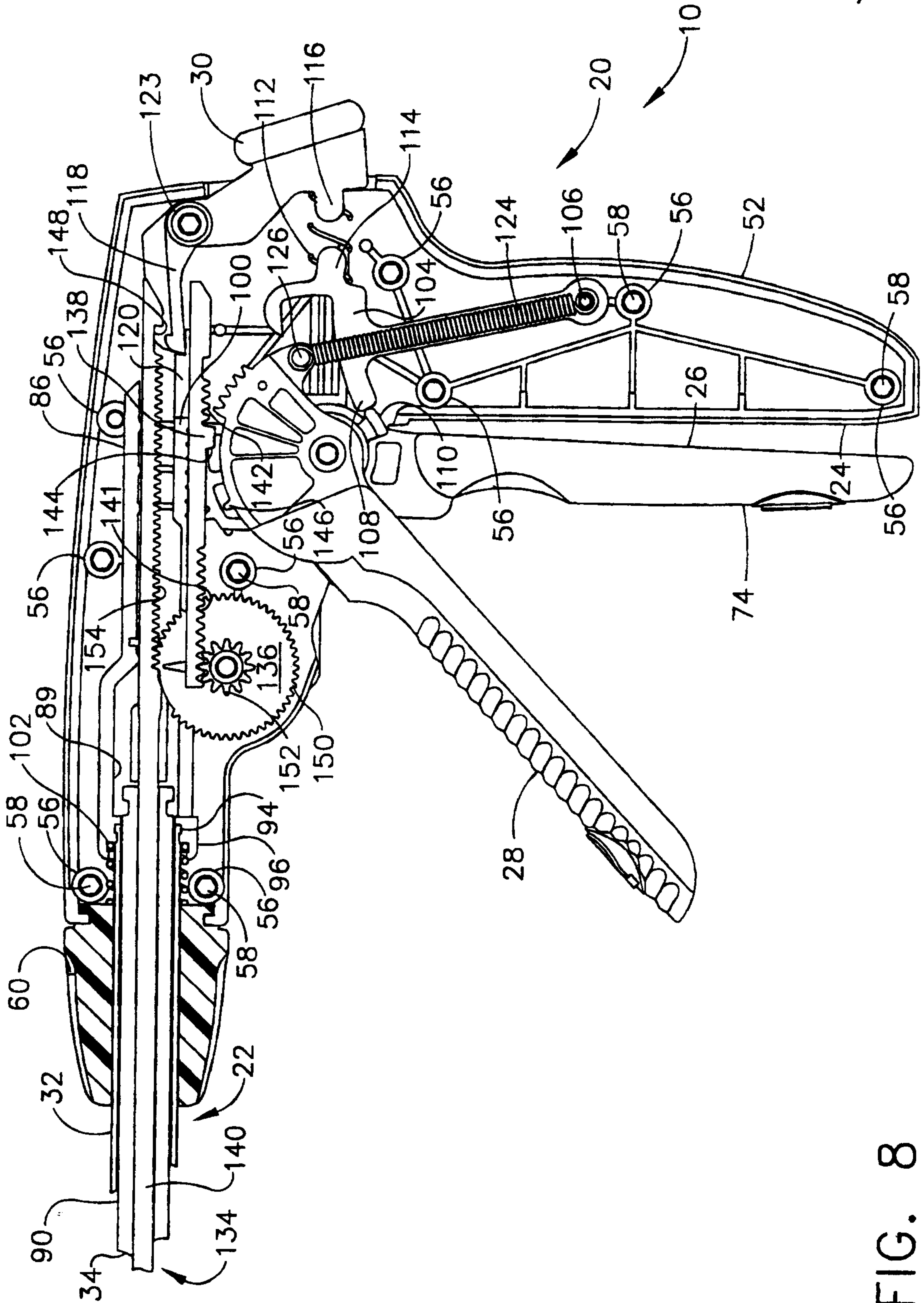

FIG. 8

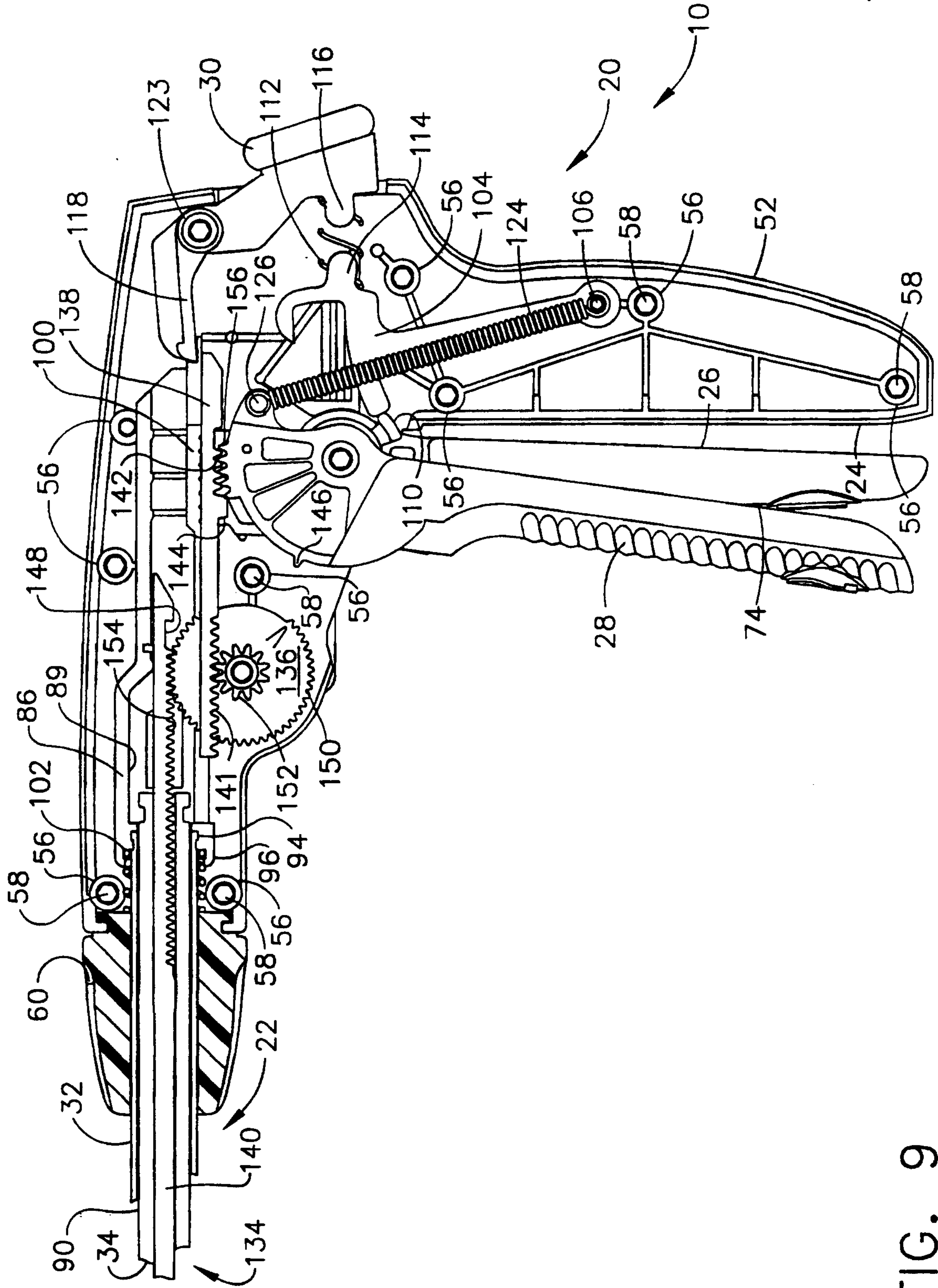

FIG. 9

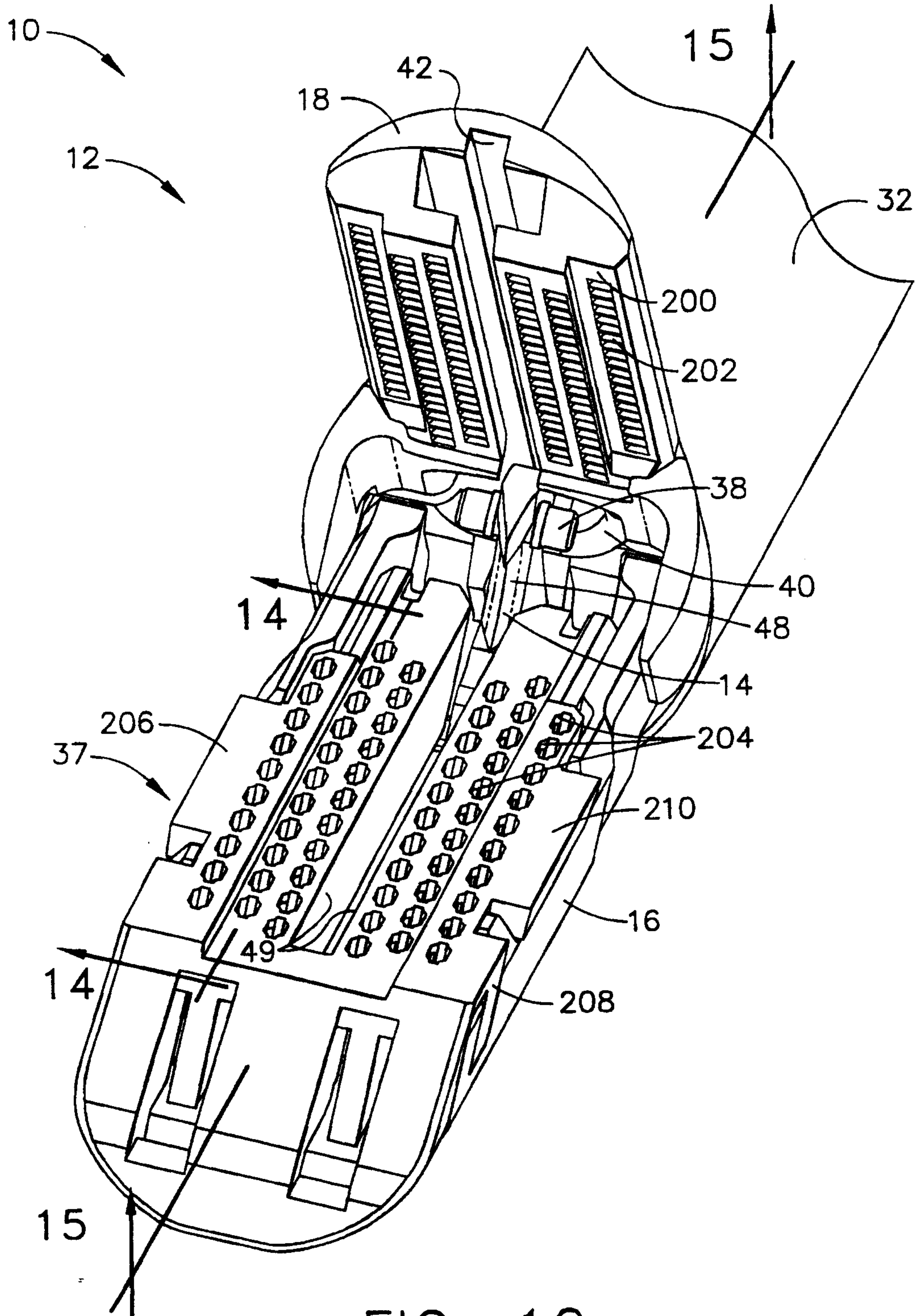

FIG. 10

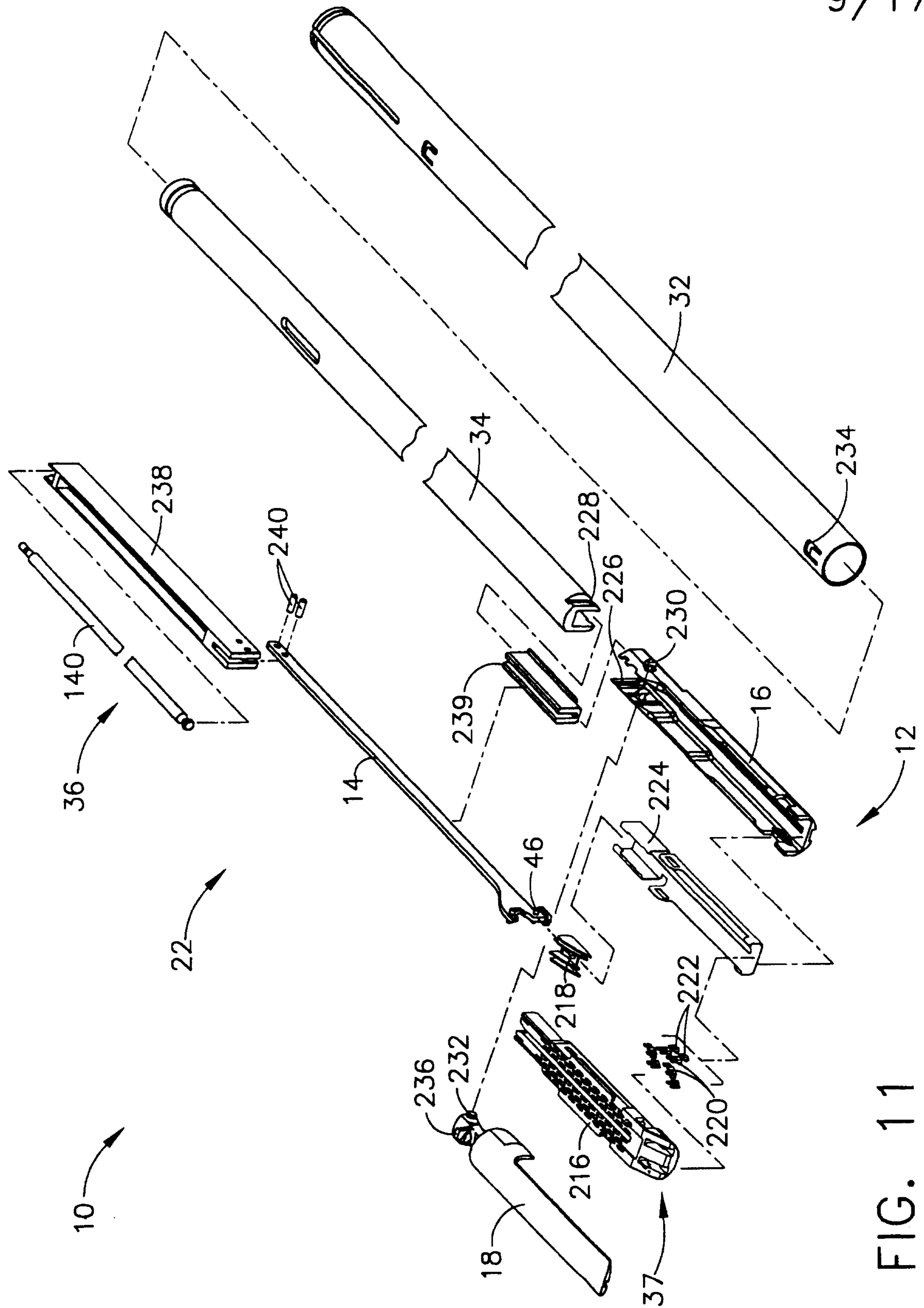

FIG. 11

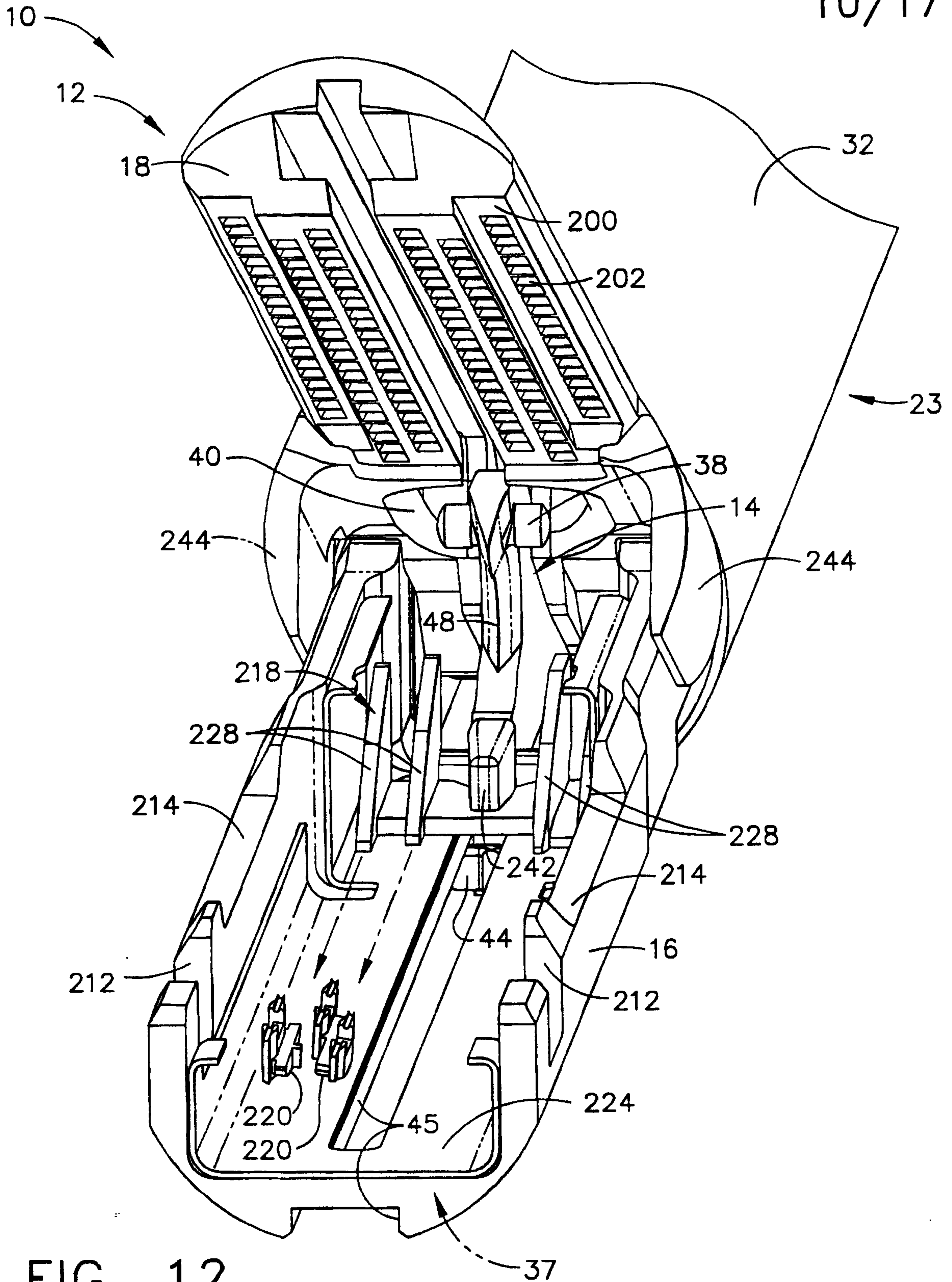

FIG. 12

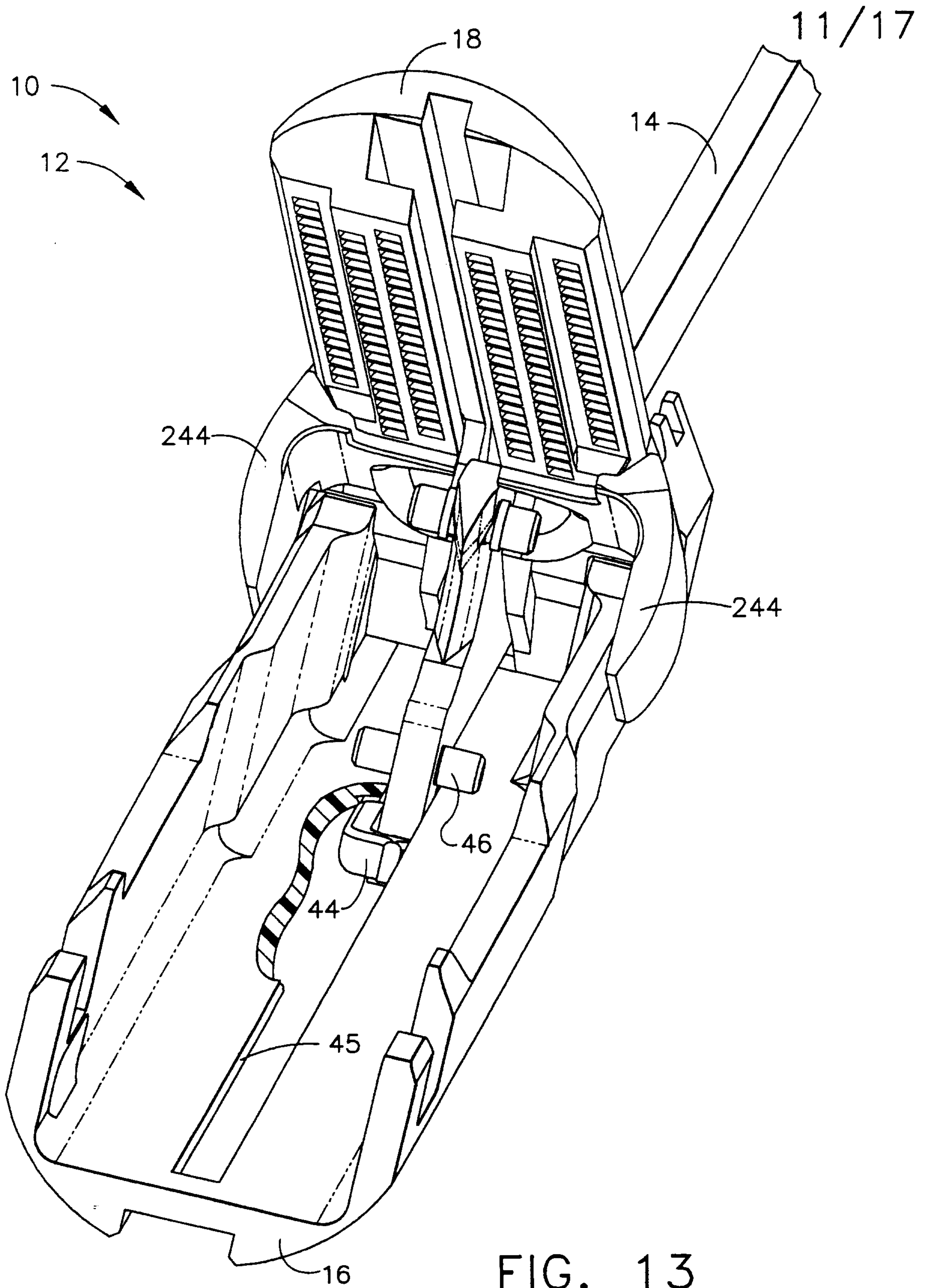
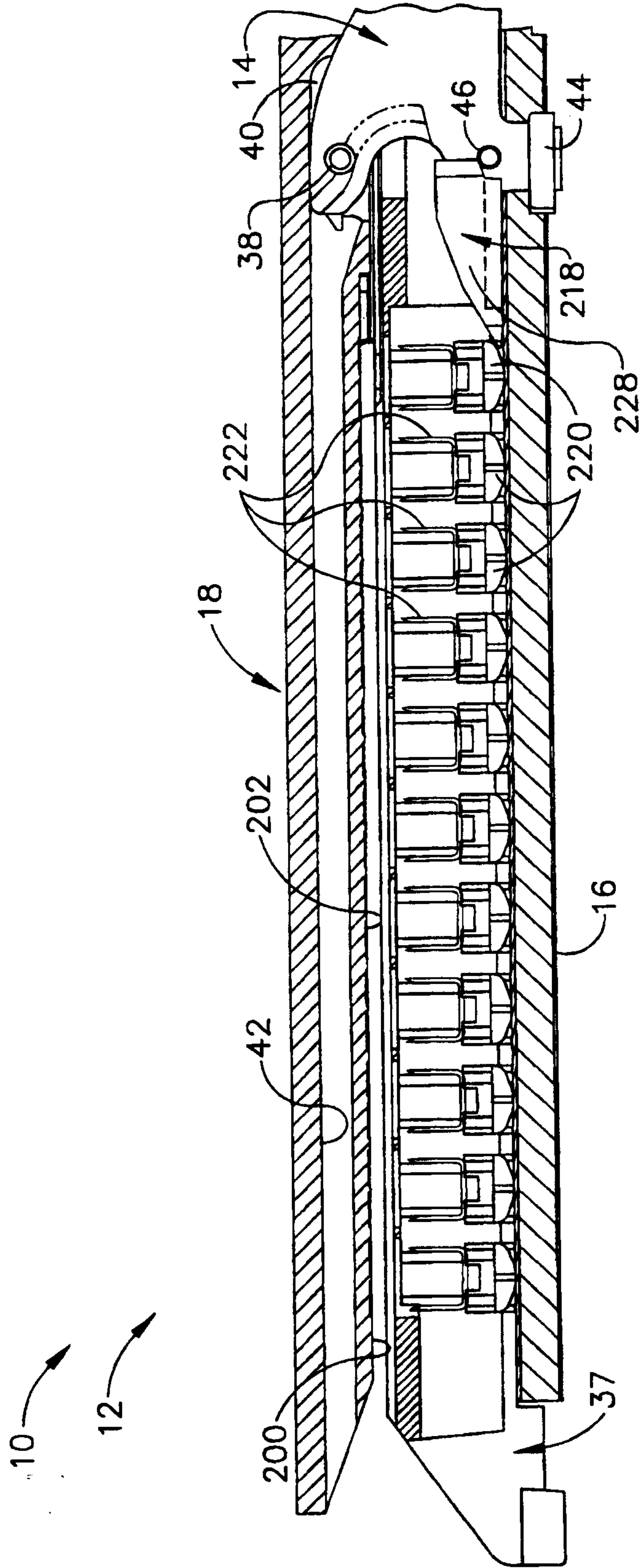

FIG. 13



12/17

FIG. 14

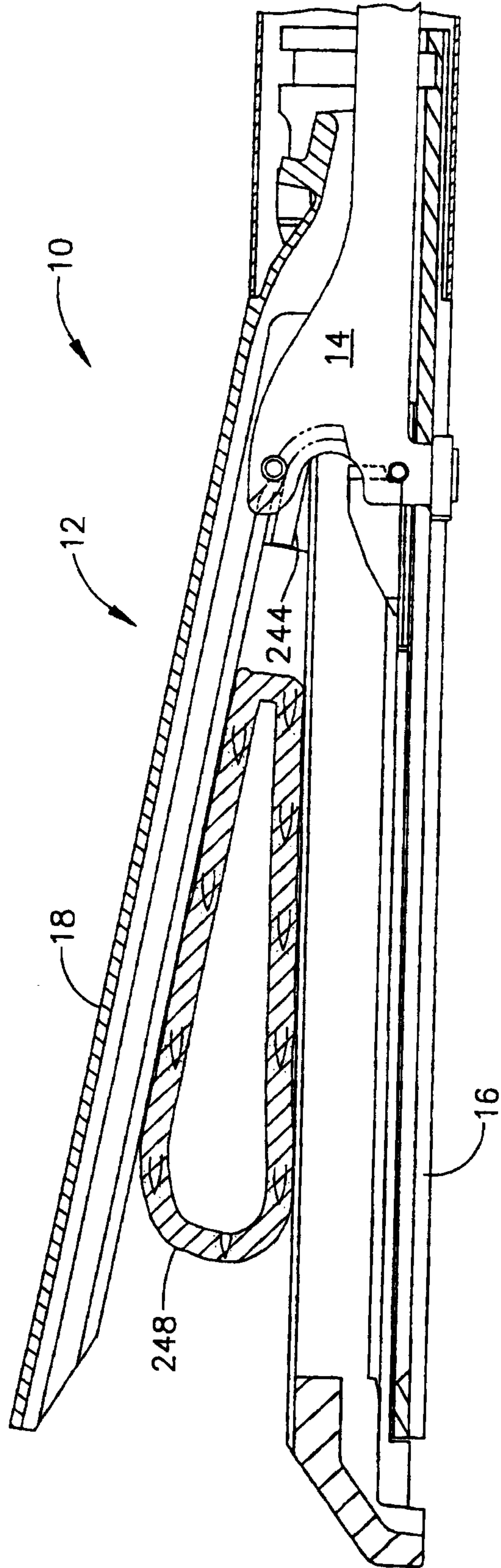
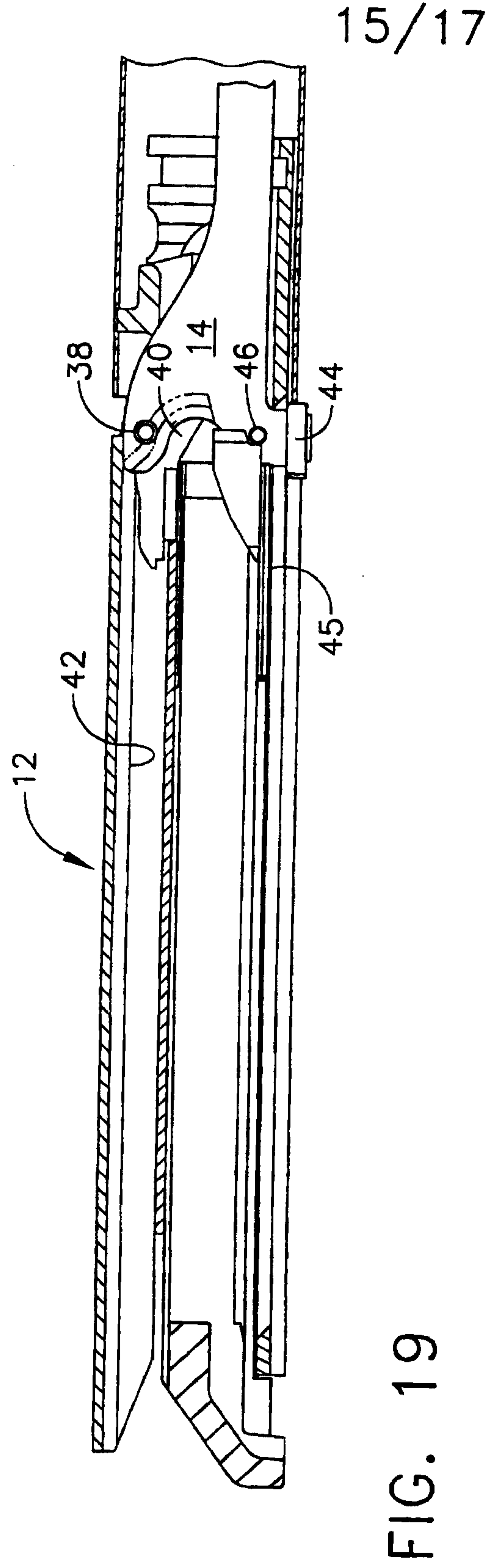
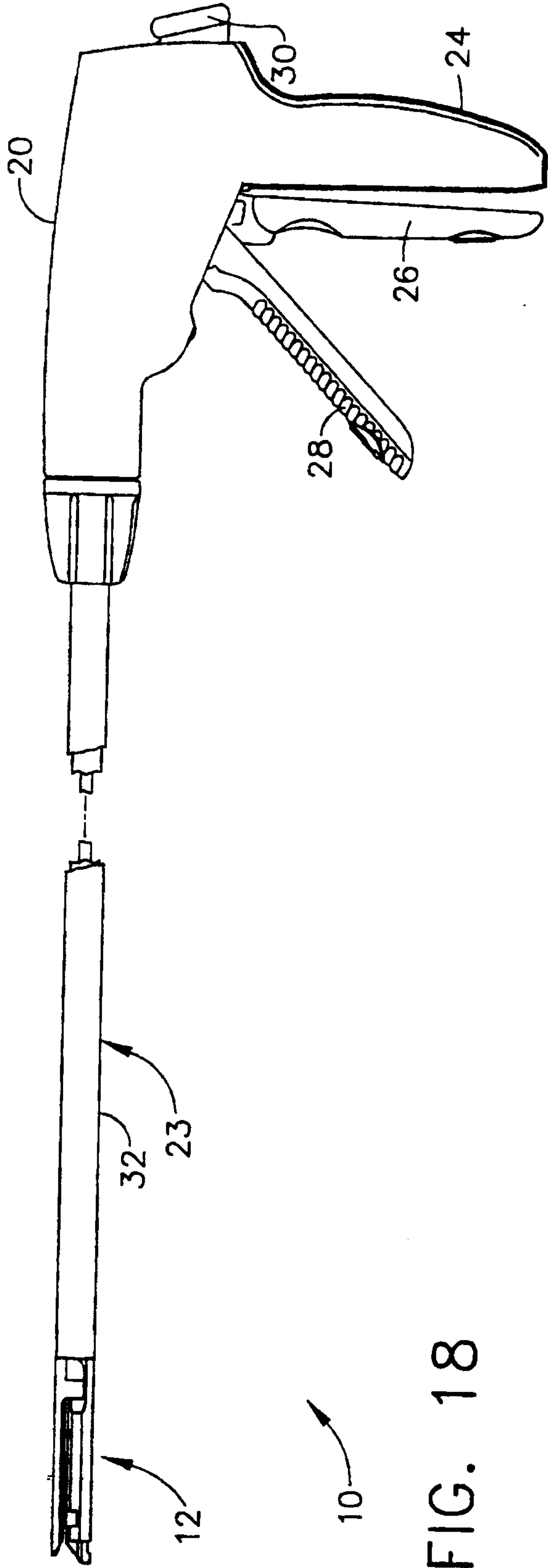

FIG. 17



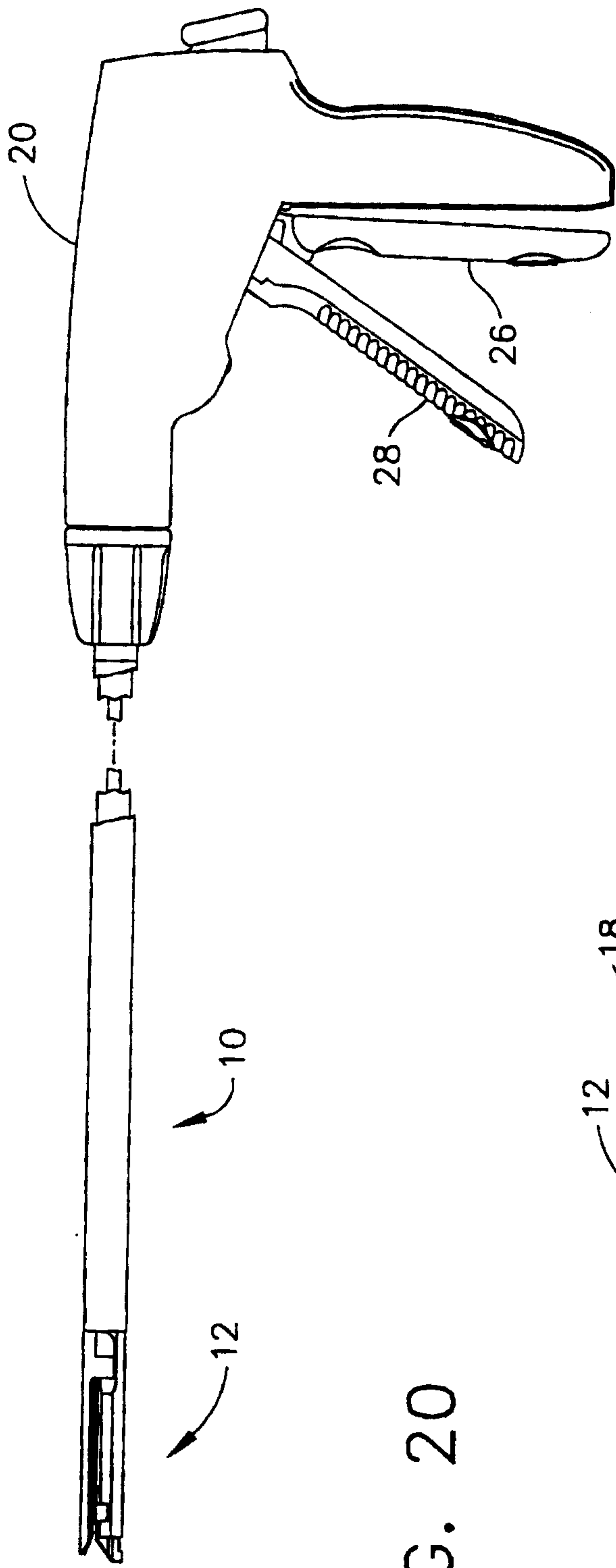

FIG. 20

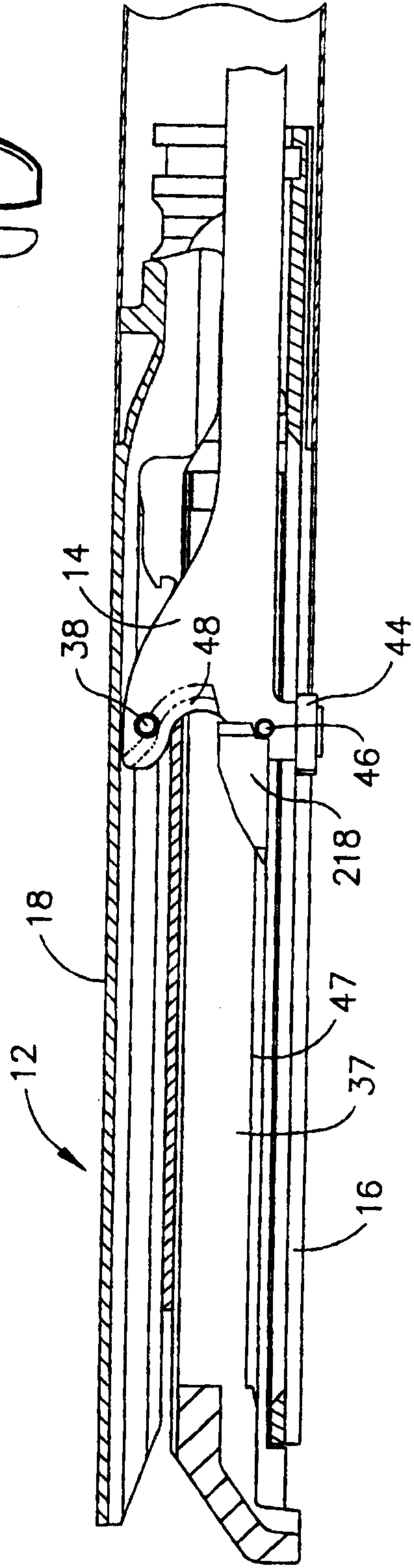

FIG. 21

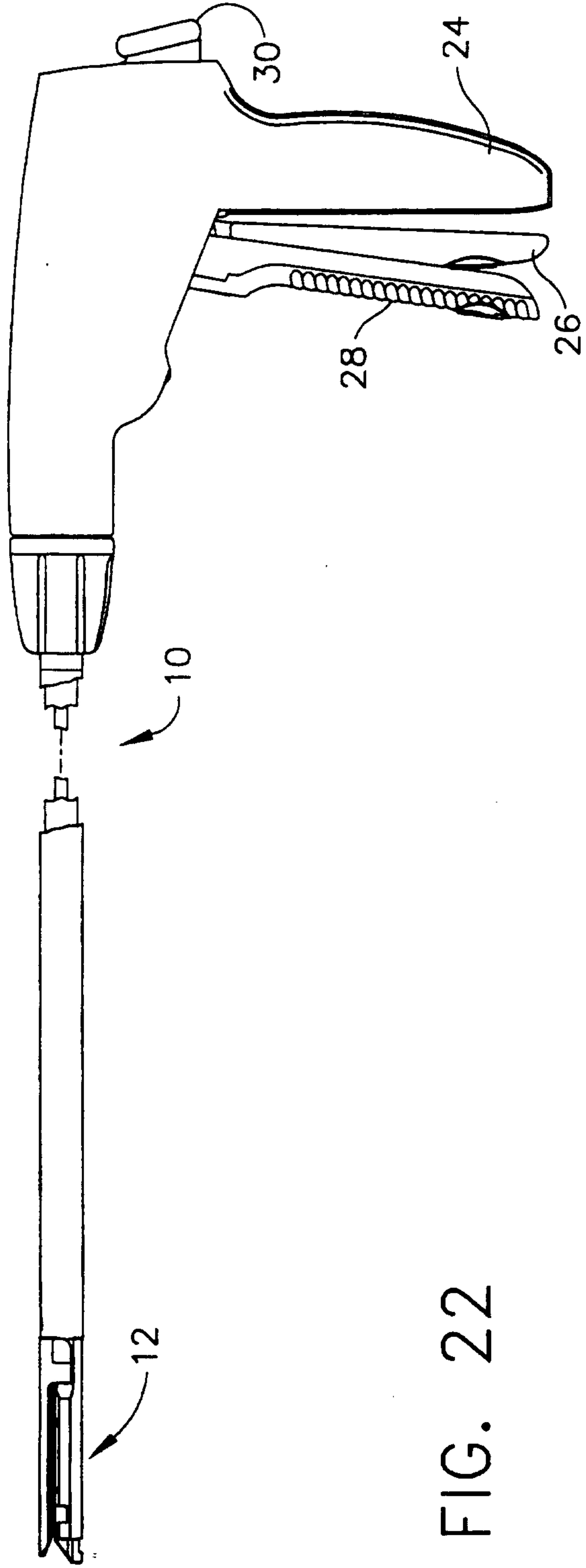

FIG. 22

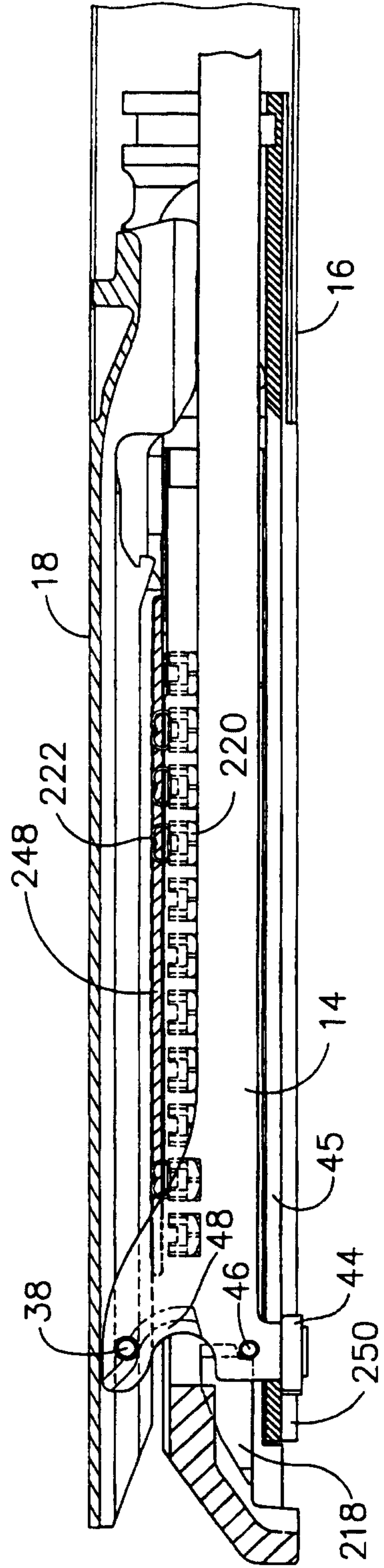

FIG. 23

