



HU000035857T2

(19) **HU**(11) Lajstromszám: **E 035 857**(13) **T2****MAGYARORSZÁG**  
Szellemi Tulajdon Nemzeti Hivatala**EURÓPAI SZABADALOM**  
**SZÖVEGÉNEK FORDÍTÁSA**(21) Magyar ügyszám: **E 14 188763**(51) Int. Cl.: **B65D 25/10** (2006.01)(22) A bejelentés napja: **2008. 07. 29.****B65D 5/50** (2006.01)

(96) Az európai bejelentés bejelentési száma:

**EP 20080188763**

(97) Az európai bejelentés közzétételi adatai:

**EP 2840036 A1** **2015. 02. 25.**

(97) Az európai szabadalom megadásának meghirdetési adatai:

**EP 2840036 B1** **2017. 08. 23.**

(30) Elsőbbségi adatok:

**12322007** **2007. 08. 02.** **CH**

(73) Jogosult(ak):

**STEVANATO GROUP INTERNATIONAL A. S.,**  
**844 03 Bratislava (SK)**

(72) Feltalálók:

**Nicoletti, Fabiano, 30034 MIRA (VENEZIA) (IT)**

(74) Képviselő:

**ARINOVA Szabadalmi és Védjegy Iroda,**  
**Budapest**

(54)

**Csomagoló szerkezet üvegtartályokhoz gyógyászati alkalmazásra**

Az európai szabadalom ellen, megadásának az Európai Szabadalmi Közlönyben való meghirdetésétől számított kilenc hónapon belül, felszólalást lehet benyújtani az Európai Szabadalmi Hivatalnál. (Európai Szabadalmi Egyezmény 99. cikk(1))

A fordítást a szabadalmat az 1995. évi XXXIII. törvény 84/H. §-a szerint nyújtotta be. A fordítás tartalmi helyességét a Szellemi Tulajdon Nemzeti Hivatala nem vizsgálta.

(19)



(11)

**EP 2 840 036 B1**

(12)

**EUROPEAN PATENT SPECIFICATION**

(45) Date of publication and mention of the grant of the patent:  
**23.08.2017 Bulletin 2017/34**

(51) Int Cl.:  
**B65D 25/10<sup>(2006.01)</sup> B65D 5/50<sup>(2006.01)</sup>**

(21) Application number: **14188763.8**

(22) Date of filing: **29.07.2008**

---

(54) **Package structure for glass containers for pharmaceutical use**

Verpackungsstruktur für Glasbehälter zur pharmazeutischen Verwendung

Structure de conditionnement pour contenants en verre à usage pharmaceutique

---

(84) Designated Contracting States:  
**AT BE BG CH CY CZ DE DK EE ES FI FR GB GR HR HU IE IS IT LI LT LU LV MC MT NL NO PL PT RO SE SI SK TR**

(30) Priority: **02.08.2007 CH 12322007**

(43) Date of publication of application:  
**25.02.2015 Bulletin 2015/09**

(62) Document number(s) of the earlier application(s) in accordance with Art. 76 EPC:  
**08785180.4 / 2 183 166**

(73) Proprietor: **STEVANATO GROUP INTERNATIONAL A. S.**  
**844 03 Bratislava (SK)**

(72) Inventor: **Nicoletti, Fabiano**  
**30034 MIRA (VENEZIA) (IT)**

(74) Representative: **Rapisardi, Mariacristina**  
**Ufficio Brevetti Rapisardi S.r.l.**  
**Via Serbelloni, 12**  
**20122 Milano (IT)**

(56) References cited:  
**US-A- 5 579 929 US-B2- 6 719 141**

**EP 2 840 036 B1**

---

Note: Within nine months of the publication of the mention of the grant of the European patent in the European Patent Bulletin, any person may give notice to the European Patent Office of opposition to that patent, in accordance with the Implementing Regulations. Notice of opposition shall not be deemed to have been filed until the opposition fee has been paid. (Art. 99(1) European Patent Convention).

---

## Description

**[0001]** The present invention refers to a package structure for necked glass containers for pharmaceutical use.

**[0002]** Known is a package structure for sterilised syringes comprising a container with closed bottom holding therein a grid having a plurality of accommodation holes wherein arranged with a vertical orientation are the syringes held into position by simply placing their flange at the perimeter edge of the accommodation holes.

**[0003]** The system for holding a package structure for sterilised syringes is ineffective and unsuitable for holding functioning with bottles or similar containers not provided with projecting parts.

**[0004]** Such packaging structure for syringes has a limited flexibility in use in that it is not suitable to be used effectively both for containers different from syringes available in the market and machinery for filling containers different from syringes available in the market, for example glass bottles, carpules and phials for pharmaceutical use.

**[0005]** In particular, it is not possible to insert glass containers for pharmaceutical use into such structure for delivery to the pharmaceutical companies, ready to be filled. US6719141 discloses a package structure for glass containers according to preamble of claim 1.

**[0006]** Therefore, the technical task proposed by the present invention is that providing a package structure for glass containers for pharmaceutical use capable of eliminating the technical drawbacks observed in the prior art.

**[0007]** Within the scope of this technical task an object of the invention is that of providing a package structure for glass containers for pharmaceutical use capable of allowing to hold the containers into a preset position in a stable manner also in order to protect them against accidental breakages and in order to be able to deliver them to the pharmaceutical companies ready for filling.

**[0008]** Another object of the invention is that of providing a package structure for glass containers for pharmaceutical use capable of guaranteeing the sterilisation of the product, maintaining the sterility of the product, maintaining the quality characteristics of the product, proving the integrity of the product, identification and traceability of the product, transfer of the product without jeopardising the aforelisted properties.

**[0009]** Last but not least, an object of the invention is that of providing a package structure for glass containers for pharmaceutical use capable of allowing an easy and quick step for loading glass containers into a process machine for handling thereof, in particular for filling, closure, packaging, etc thereof.

**[0010]** The technical task, as well as these and other objects, according to the present invention are attained by providing a package structure for glass containers for pharmaceutical use according to claim 1.

**[0011]** Furthermore, other characteristics of the present invention are defined in the subsequent depend-

ent claims.

**[0012]** Further characteristics and advantages of the invention shall be clearer from the description of a preferred but not exclusive embodiment of the package structure for glass containers for pharmaceutical use according to the finding, illustrated for indicative and non-limiting purposes in the attached drawings, wherein:

figure 1 shows a side elevated exploded view of a package structure for glass containers for pharmaceutical use according to a first preferred embodiment of the invention;

figure 2 shows a perspective exploded view of the package structure of figure 1; figure 3 shows a cross-sectional view according to a vertical plane of the package structure of figure 1;

figure 4 shows an enlargement of a detail circled in figure 3;

figure 5 shows a cross-sectional view according to a vertical plane a package structure for glass containers for pharmaceutical use according to an embodiment which is not part of the invention;

figure 6 shows an enlargement of a detail circled in figure 5;

figures 7 and 8 correspond to the embodiment of figures 5 and 6 but with the containers held overturned at a position of 180°;

figures 9 and 10 illustrate possible variants for the external protection casing of one or more trays of a package structure for glass containers for pharmaceutical use according to any one of the embodiments illustrated in the preceding figures;

figure 11 shows a perspective view of a package structure for glass containers for pharmaceutical use according to an embodiment which is not part of the invention;

figure 12 shows a cross-sectional view according to a vertical plane of the package structure of figure 11; figure 13 shows an enlargement of a detail circled in figure 12;

figure 14 shows the various sequential steps for the direct use of a package structure for glass containers for pharmaceutical use in a process machine;

figure 15 shows a top plan view of a support plane according to an embodiment which is not part of the invention;

figure 16 shows a perspective view of an enlarged detail of the support plane of figure 15;

figure 17 shows a view of one of the two parts forming the support plane sectioned along line 17-17 of figure 15; and

figure 18 shows a view of the two assembled parts forming the support plane sectioned along line 17-17 of figure 15.

**[0013]** Identical parts in the various embodiments shall be indicated with the same reference number.

**[0014]** Referring to the abovementioned figures, a package structure for glass containers for pharmaceuti-

cal use is shown indicated in its entirety with reference number 1. The package structure 1 comprises a tray 2 accommodating - at an elevated position with respect to its bottom - a support plane 4 having a plurality of holes 12, spaced with a preset spatial order, for introducing the containers 6.

**[0015]** The holes 12 have a central symmetry axis S orthogonal with respect to the support plane 4.

**[0016]** The support plane 4 has - at each hole 12 - special elastically yielding means for holding a container 6 through a holding force radial with respect to the central symmetry axis S.

**[0017]** The holding means extend into the volume enclosed by the projection of the perimeter of the introduction hole 12 in a manner parallel with respect to the central symmetry axis S.

**[0018]** As clear from the description and illustration of the various preferred embodiments of the invention, the holding means can be arranged beneath the support plane 4, above the support plane 4, or inside the introduction hole 12 and thus in a manner coplanar with the support plane 4.

**[0019]** Optionally, as is clear from the description and illustration of some embodiments which are not part of the invention, the support plane 4 has - at each introduction hole 12 - special support means 5 for bearing the weight of the container 6 also through a support force parallel with respect to the central symmetry axis S.

**[0020]** The introduction holes 12, which preferably - as shown - are circular-shaped, advantageously have a matrix order arranged in series of rows and columns which facilitates a possible automated movement and handling of the containers 6.

**[0021]** The tray 2 has a quadrangular bottom 7 raising from which are side walls 8.

**[0022]** The support plane 4 is supported perimetally by a support shoulder 9 which develops along the internal surface of the side walls 8 of the tray 2.

**[0023]** The distance of the support plane 4 from the bottom 7 of the tray 2 must be such to allow accommodating the containers 6 in the holes 12 in such a manner that they are held for their entire length of the space enclosed between the tray 2 and one of its closure covers 10.

**[0024]** The closure cover 10 is preferably a flexible flat sheet which can be applied for example through ultrasonic fastening against the flattened upper edge 11 of the side walls 8 of the tray 2 in a way to be removed therefrom through simple exfoliation, that is by pulling a special strip of the sheet. According to the invention, illustrated in figures 1-4, the means for holding the container 6 comprise, for each hole 12, flaps 13 adapted to elastically fit against the lower diameter of the neck of the container 6.

**[0025]** In particular, the flaps 13 develop entirely around the introduction hole 12 and above it with a longitudinal development axis having a first axial component radially directed towards the central symmetry axis S and

a second axial component directed in a manner parallel with respect to the central symmetry axis S. According to the invention, both the centred holding of the container 6 and the support of its weight are ensured only by the elastic flaps 13.

**[0026]** As a matter of fact, their first axial component generates a force ensuring the centred holding of the container 6 in the introduction hole 12 while their second axial component generates a force operating for supporting the weight of the container 6.

**[0027]** On the other hand, in the embodiment illustrated in figures 5-8 the means for holding the container 6 comprise, for each hole 12, at least one rib 14 which develops along a centred circumference on the central symmetry axis S and adapted to elastically fit against the external parameter of the side wall of the container 6.

**[0028]** In this case, the support means 5 for bearing the container 6 comprise a basket 16 projecting from the support plane 4 beneath the hole 12, and the rib 14 is provided right along the side surface of the basket 16.

**[0029]** Thus, the container 6 is arranged in the basket 16 whose base 17 serves as a support for the base (figures 7 and 8) or for the head (figures 5 and 6) of the container 6.

**[0030]** Contrary to the embodiment illustrated in figures 5-8 wherein the support plane 4 is borne in the tray 2, in the embodiment illustrated in figures 11-13 the tray 2 and the support plane 4 are integrated into a single piece. Alongside implying a more limited number of parts, the latter solution can have a small overall dimension in terms of height and it is suitable especially for use in short containers. Given that the containers 6 are placed at the bottom of the tray 2 the height of the tray 2 must be only slightly greater than the height of the containers 6 in such a manner to be able to hold them entirely therein.

**[0031]** On the other hand, referring to embodiments illustrated in figures 15-18, the flaps 13 develop inside the introduction hole 12 with a longitudinal development axis radially directed towards the central symmetry axis S.

**[0032]** In this case, the support plane 4 has two flat parts 4a and 4b formed in a mirror-like manner and mutually fastenable in an overlapped position by means of a bayonet fastening system which develops perimetally on the support plane 4 and provides for mutual engagement members 42 and 43 respectively, one of which is provided with a snap-tooth 40 couplable into a special snap-seat 41 of the other by means of relative translation sliding between the flat part 4a and the flat part 4b for example along a translation axis parallel to the greater axis of the support plane 4. Also disclosed is a system for locking the flat part 4a and the flat part 4b in the final configuration of complete overlapping.

**[0033]** The locking system, also provided for perimetally on the support plane 4 and more precisely at the sides of the support plane 4 orthogonal to the axis of mutual translation between the flat parts 4a and 4b, comprise at least one hook 46 which can be snap-fitted into

an engagement hole 47 preferably accessible only by means of a special tool for the subsequent disengagement of the hook 46.

**[0034]** The flaps 13 are at least two and they are provided for one on the flat part 4a and one on the flat part 4b in a manner such to be arranged diametrically in the introduction hole 12 for grasping on the diameter of the neck of the container 6 when the flat part 4a and the flat part 4b are entirely overlapped.

**[0035]** In this case, the introduction hole 12 has radial protrusions 44 adapted to increase the longitudinal development of the flaps 13 and reduce their portion for attaching against the support plane 4 to increase their elastic flexibility.

**[0036]** In an embodiment which is not part of the invention, the means 5 for supporting the container 6 comprise an internal flange 45 of the introduction hole 12 for supporting the base of the head of the container 6.

**[0037]** The flange 45 extends into the introduction hole 12 for a radial section smaller than the one with which the flaps 13 extend into the introduction hole so as not to interfere with the hole of the container 6.

**[0038]** The flange 45 is subdivided into at least two portions - one borne by the flat part 4a and the other by the flat part 4b - in such a manner to be aligned diametrically in the introduction hole 12 when the flat part 4a and the flat part 4b are entirely overlapped.

**[0039]** The implementation of the forces by the flaps 13 and the flange 45 at diametrically opposite ends of the container 6 allows providing a safe and stable holding in centred position of the container 6.

**[0040]** The tray 2 advantageously has means 30 for the identification and traceability of the product contained in the container 6, preferably an identification code of the RFID type.

**[0041]** The package structure 1 is completed by at least one external protection casing 18 which encloses a tray 2 therein, and allows its transfer to an area with a controlled environment (e.g.: an area where the glass containers are filled for pharmaceutical use).

**[0042]** The protection casing 18 can be closed (figure 10) or open and in particular provided with at least one opening 19 for quick transfer (figure 9).

**[0043]** Each protection casing 18 can contain one or more stacked trays 2.

**[0044]** The protection casing 18 is preferably made up of a bag or a plastic sheet.

**[0045]** Now, referring to figure 14 shown is the package structure 1 for directly delivering - in an automatic manner - the containers 6 with a spatially preset position to a process machine 20 for their handling thereof.

**[0046]** The process machine 20 comprises a robotised arm 21 provided with a head 22 for grasping the containers 6.

**[0047]** The robotised arm 21 has a horizontal translation axis X, a vertical translation axis Y and a rotation axis Z orthogonal to the translation axis X and Y.

**[0048]** The grasping head 22 has an open rectilinear

groove 23 for grasping a row of containers 6.

**[0049]** After being extracted from the external casing 18 and being removed of the cover 10, the support plane 4 (or the tray 2 if integral with the support plane 4) is moved towards the grabbing position by the grabbing head 22 wherein the containers 6 are arranged in rows oriented in a manner parallel to the axis X.

**[0050]** In particular, the grabbing head 22 is initially external with respect to the support template 4 and has a groove 23 oriented in a manner parallel to the axis X.

**[0051]** The grabbing head 22 translates along axis X to insert the groove 23 into the neck of the row of containers 6 aligned with the groove 23 itself.

**[0052]** After having engaged the row of containers 6, the grabbing head 22 translates along axis Y to lift the row of containers 6 engaged detaching it from the support 4.

**[0053]** Subsequently, the grabbing head 22 translates along axis X to transport the engaged row of containers 6 towards a conveying station 24 at which the grabbing head 22 rotates around axis Z to slide the engaged row of containers 6 towards it. The package structure for glass containers for pharmaceutical use thus conceived is susceptible to various modifications and variants, all falling within the scope of the invention concept; furthermore, all the details can be replaced by technically equivalent elements.

**[0054]** In practice, all the materials used, alongside the dimensions, may vary depending on the requirements and the state of art.

## Claims

1. Package structure (1) for necked glass containers for pharmaceutical use, comprising a tray (2) bearing therein - at a raised position with respect to its bottom - a support plane (4) having, for the introduction of said containers, a plurality of holes (12) spaced from each other with a preset spatial order and having a central symmetry axis (S) orthogonal to said support plane (4), said support plane (4) further comprising, at each of said holes (12), elastically yielding holding means (13) for a container (6) by means of a holding force, said holding means (13) extending into the volume enclosed by the projection of the perimeter of each of said holes (12) in a manner parallel to said central symmetry axis (S), said holding means comprising flaps (13) adapted to hold the container (6) under a bulged section of the upper part of the neck of said container (6), **characterised in that** the flaps (13) are elastic, and can elastically fit against the lower diameter of the neck of said container (6), both the centred holding of the container (6) and the support of its weight being ensurable by the elastic flaps (13) only.

2. Package structure (1) for necked glass containers

for pharmaceutical use according to the preceding claim, **characterised in that** said tray (2) has means for the identification and traceability of the product contained in said containers (6).

3. Package structure (1) for necked glass containers for pharmaceutical use according to one or more of the preceding claims, **characterised in that** it has at least one external protection casing (18) enclosing said tray (2), said casing being closed or having at least one quick transfer opening (19) for the introduction of said package structure into areas with a controlled environment.
4. Package structure (1) for necked glass containers for pharmaceutical use according to one or more of the preceding claims, **characterised in that** said introduction holes (12) have a matrix order arranged in a series of rows and columns.
5. Package structure (1) for necked glass containers for pharmaceutical use according to one or more of the preceding claims, **characterised in that** the distal ends of said flaps (13) are inclined towards the axis of symmetry (S) of the holes (12).
6. Package structure (1) for necked glass containers for pharmaceutical use according to one or more of the preceding claims, **characterised in that** said holding means (13) are arranged above said support plane (4).
7. A system comprising a package structure (1) according to one or more of the preceding claims and the container (6).

#### Patentansprüche

1. Verpackungsstruktur (1) für Glasbehälter mit Hals zur pharmazeutischen Verwendung, umfassend ein Tray (2), das in einer im Vergleich zu seinem Boden angehobenen Position eine Auflagefläche (4) trägt, aufweisend eine Vielzahl an Öffnungen (12) für die Einführung der Behälter, beabstandet voneinander in einer vorgegebenen räumlichen Reihenfolge und aufweisend eine mittige Symmetrieachse (S), rechtwinklig zur Auflagefläche (4), wobei die Auflagefläche (4) zudem an einer jeden der Öffnungen (12) elastisch nachgebende Haltemittel (13) für einen Behälter (6) mittels einer Haltekraft umfasst, wobei sich diese Haltemittel (13) im Volumen erstrecken, das durch den Vorsprung des Umfangs einer jeden der Öffnungen (12) parallel zur mittigen Symmetrieachse (S) umschlossen ist, wobei die Haltemittel Klappen (13) umfassen, die ausgelegt sind, um den Behälter (6) unter einem ausgebauchten Abschnitt des oberen Teils des Halses des Behälters zu halten,

**dadurch gekennzeichnet, dass** die Klappen (13) elastisch sind und elastisch gegen den unteren Durchmesser des Halses des Behälters (6) eingepasst werden können, wobei sowohl das zentrierte Halten des Behälters (6) als auch die Abstützung dessen Gewicht nur durch die elastischen Klappen (13) gesichert werden können.

2. Verpackungsstruktur (1) für Glasbehälter mit Hals zur pharmazeutischen Verwendung nach dem vorhergehenden Anspruch, **dadurch gekennzeichnet, dass** das Tray (2) Mittel zur Identifizierung und Rückverfolgung des in den Behältern (6) enthaltenen Produkts besitzt.
3. Verpackungsstruktur (1) für Glasbehälter mit Hals zur pharmazeutischen Verwendung nach einem oder mehreren der vorhergehenden Ansprüche, **dadurch gekennzeichnet, dass** sie mindestens ein externes Schutzgehäuse (18) aufweist, das das Tray (2) umschließt, wobei das Gehäuse geschlossen ist oder zumindest eine Schnellübergabeöffnung (19) für die Einführung der Verpackungsstruktur in Bereiche mit kontrollierter Atmosphäre aufweist.
4. Verpackungsstruktur (1) für Glasbehälter mit Hals zur pharmazeutischen Verwendung nach einem oder mehreren der vorhergehenden Ansprüche, **dadurch gekennzeichnet, dass** die Einführungsöffnungen (12) eine Matrixreihenfolge aufweisen, angeordnet in einer Serie von Reihen und Spalten.
5. Verpackungsstruktur (1) für Glasbehälter mit Hals zur pharmazeutischen Verwendung nach einem oder mehreren der vorhergehenden Ansprüche, **dadurch gekennzeichnet, dass** die distalen Enden der Klappen (13) hinführend zur Symmetrieachse (S) der Öffnungen (12) geneigt angeordnet sind.

6. Verpackungsstruktur (1) für Glasbehälter mit Hals zur pharmazeutischen Verwendung nach einem oder mehreren der vorhergehenden Ansprüche, **dadurch gekennzeichnet, dass** die Haltemittel über der Auflagefläche (4) angeordnet sind.
7. System mit einer Verpackungsstruktur (1) nach einem oder mehreren der vorhergehenden Ansprüche und mit dem Behälter (6).

#### Revendications

1. Structure de conditionnement (1) pour contenants à goulot en verre à usage pharmaceutique, comprenant un plateau (2) supportant en son sein, dans une position relevée par rapport à son fond, un plan de support (4) comportant, pour l'introduction desdits

- contenants, une pluralité d'orifices (12) espacés les uns des autres selon un ordre dans l'espace préétabli et comportant un axe central de symétrie (S) orthogonal au dit plan de support (4), ledit plan de support (4) comprenant de plus, en correspondance de chacun desdits orifices (12), des moyens de retenue (13) pouvant se déformer élastiquement pour un contenant (6) au moyen d'une force de retenue, lesdits moyens de retenue (13) se prolongeant dans le volume limité par la projection du périmètre de chacun desdits orifices (12) de façon parallèle au dit axe central de symétrie (S), lesdits moyens de retenue comprenant des rabats (13) pouvant maintenir le contenant (6) sous une section bombée de la partie supérieure du goulot dudit contenant (6), **caractérisée en ce que** les rabats (13) sont élastiques et peuvent s'adapter élastiquement contre le diamètre inférieur du goulot dudit contenant (6), le maintien centré du contenant (6) et le support de son poids étant assuré uniquement par les rabats élastiques (13).
2. Structure de conditionnement (1) pour contenants à goulot en verre à usage pharmaceutique selon la revendication précédente, **caractérisée en ce que** ledit plateau (2) comporte des moyens permettant l'identification et la traçabilité du produit contenu dans lesdits contenants (6).
3. Structure de conditionnement (1) pour contenants à goulot en verre à usage pharmaceutique selon l'une ou plusieurs des revendications précédentes, **caractérisée en ce qu'**elle comporte au moins un boîtier de protection externe (18) renfermant ledit plateau (2), ledit boîtier étant fermé ou ayant au moins une ouverture de transfert rapide (19) pour l'introduction de ladite structure de conditionnement dans des zones à milieu contrôlé.
4. Structure de conditionnement (1) pour contenants à goulot en verre à usage pharmaceutique selon l'une ou plusieurs des revendications précédentes, **caractérisée en ce que** lesdits orifices d'introduction (12) possèdent un ordre de matrice disposé en une série de rangées et de colonnes.
5. Structure de conditionnement (1) pour contenants à goulot en verre à usage pharmaceutique selon l'une ou plusieurs des revendications précédentes, **caractérisée en ce que** lesdites extrémités distales desdits rabats (13) sont inclinées en direction de l'axe de symétrie (S) des orifices (12).
6. Structure de conditionnement (1) pour contenants à goulot en verre à usage pharmaceutique selon l'une ou plusieurs des revendications précédentes, **caractérisée en ce que** lesdits moyens de retenue sont disposés au-dessus dudit plan de support (4).
7. Système comprenant une structure de conditionnement (1) selon l'une ou plusieurs des revendications précédentes et le contenant (6).

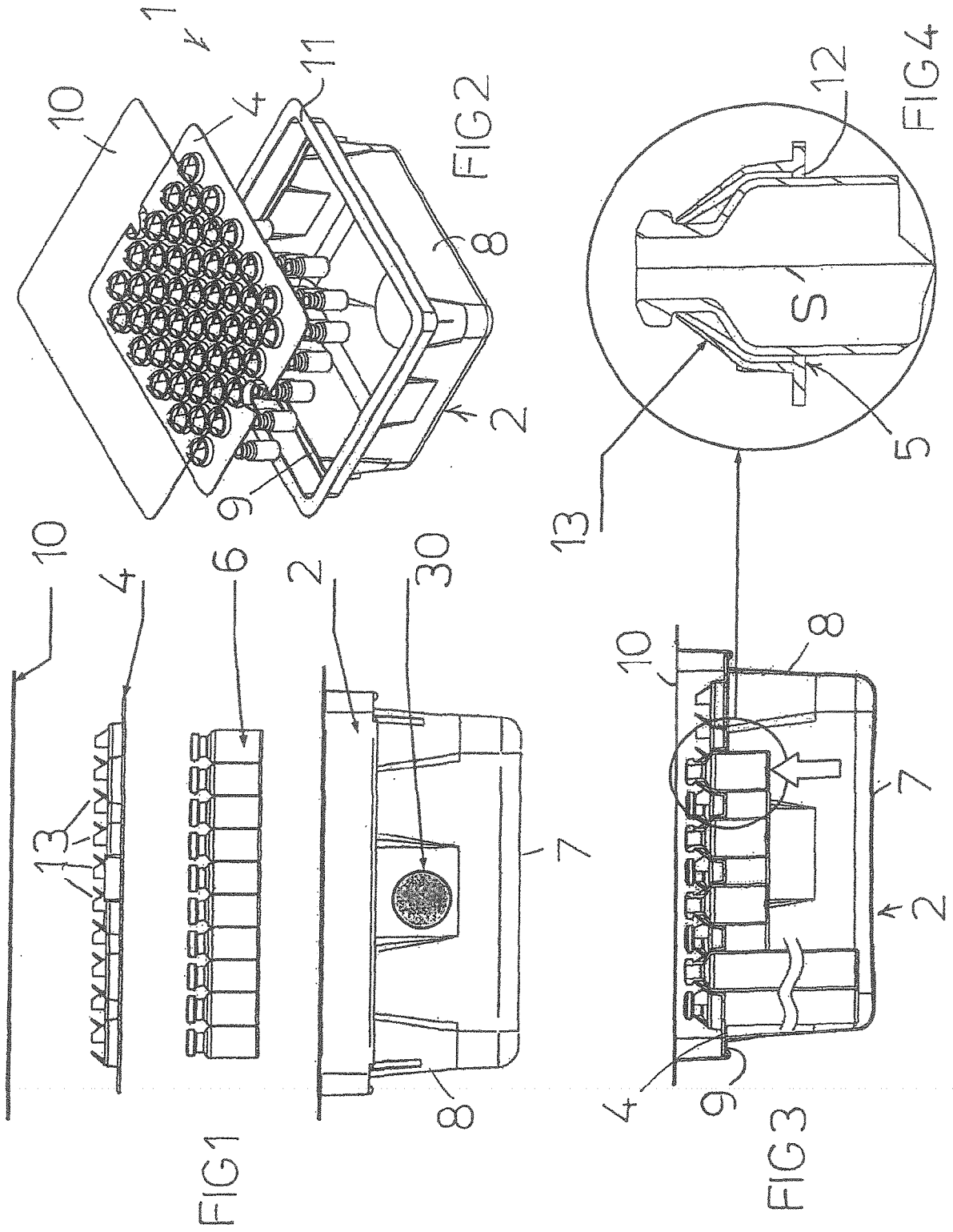

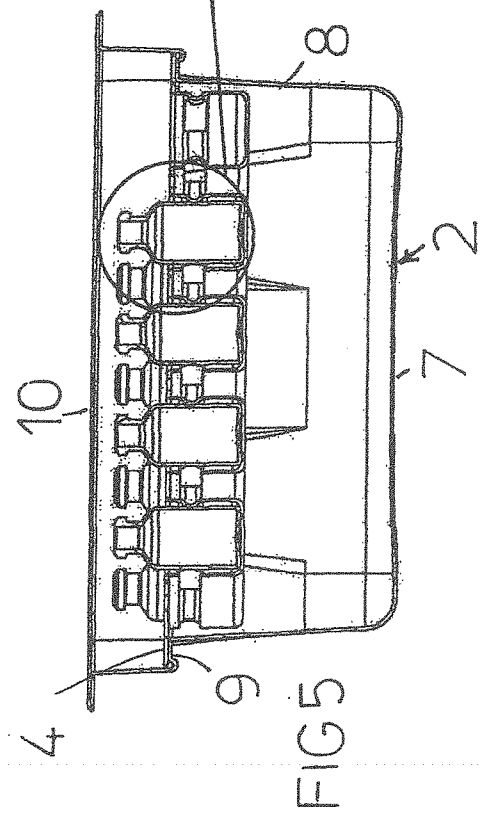
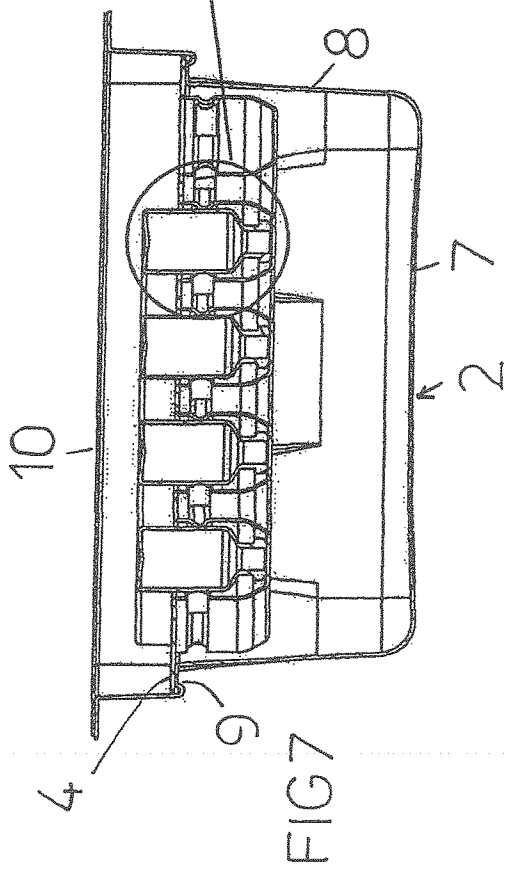
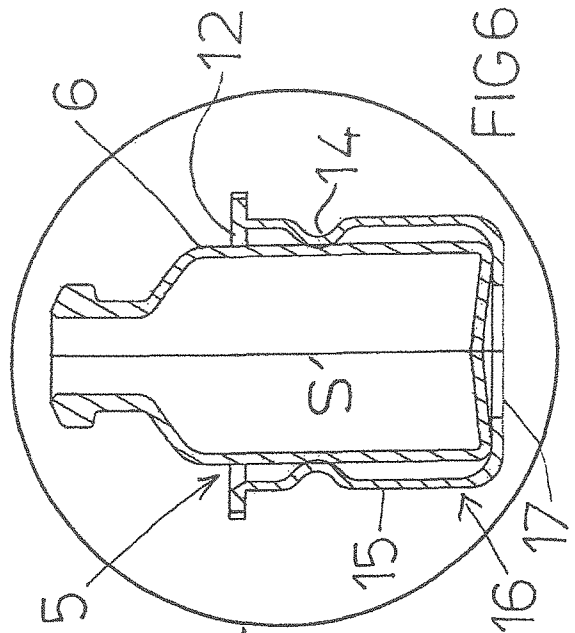
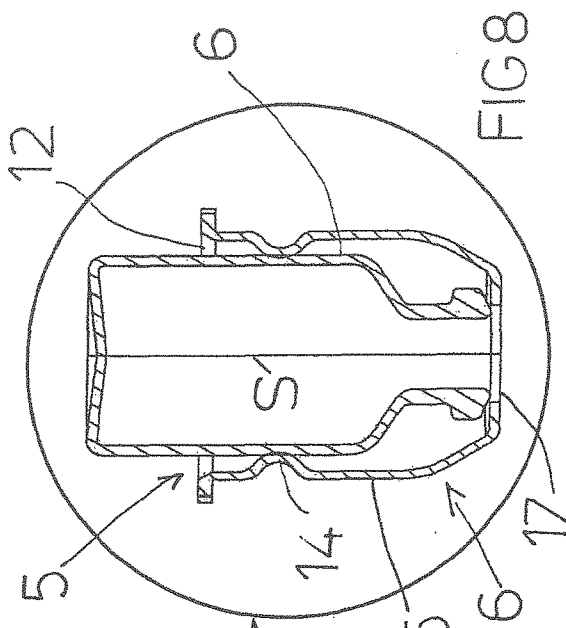

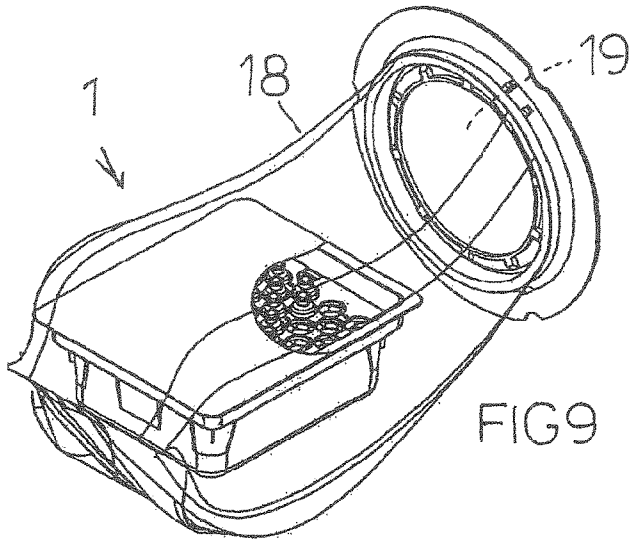

FIG 9

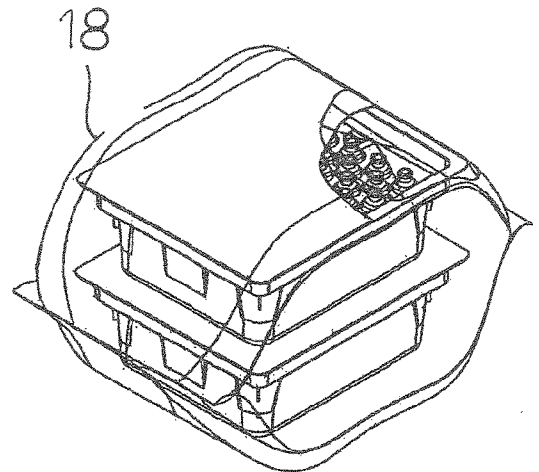

FIG 10

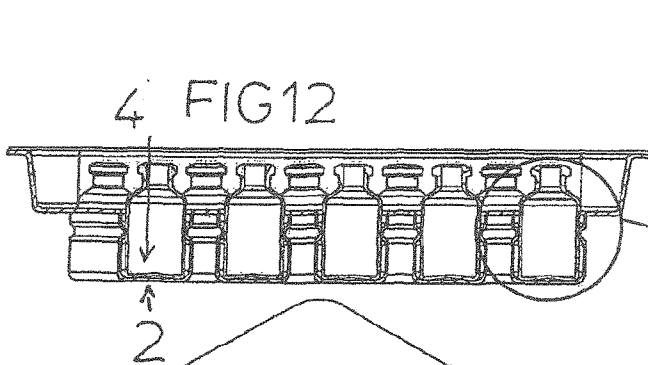

FIG 12

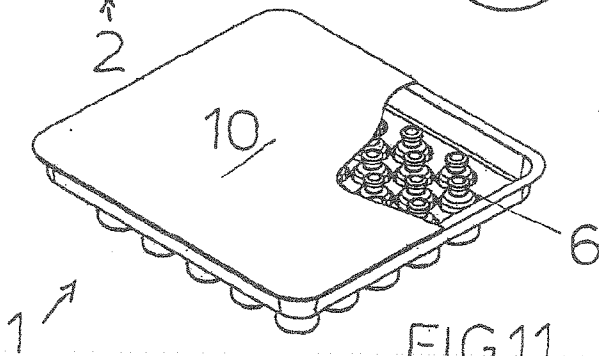

FIG 11

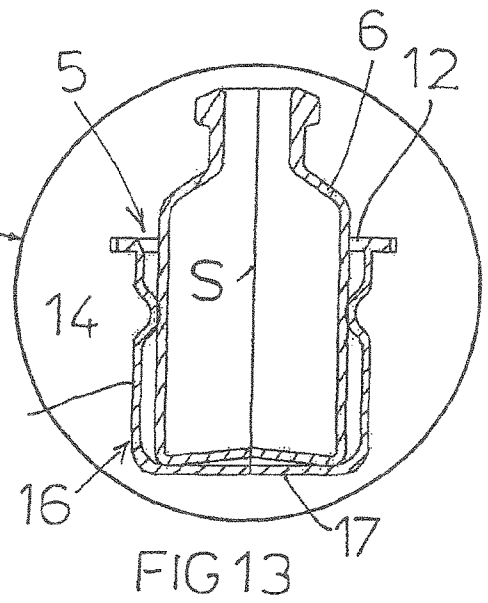
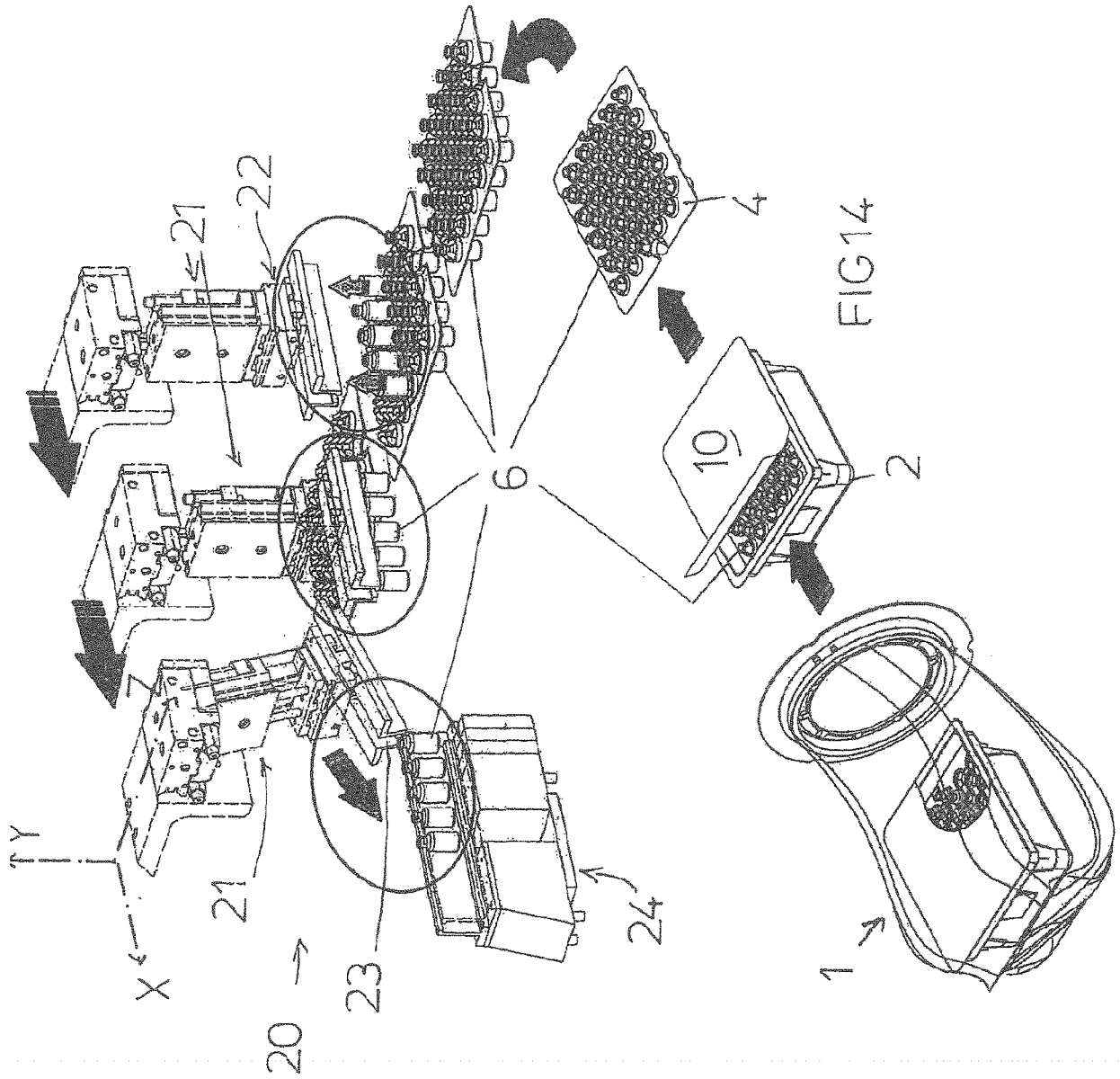
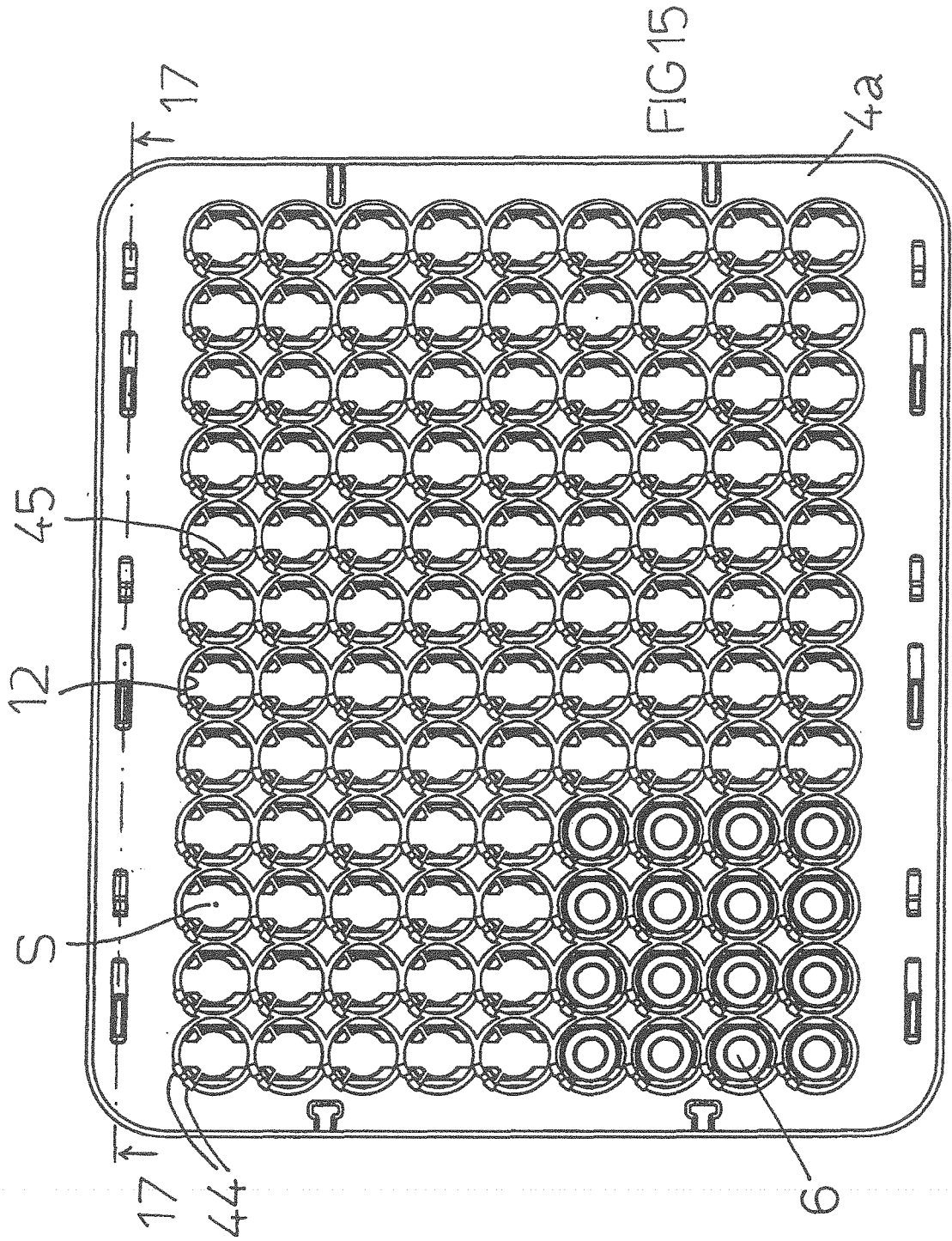

FIG 13





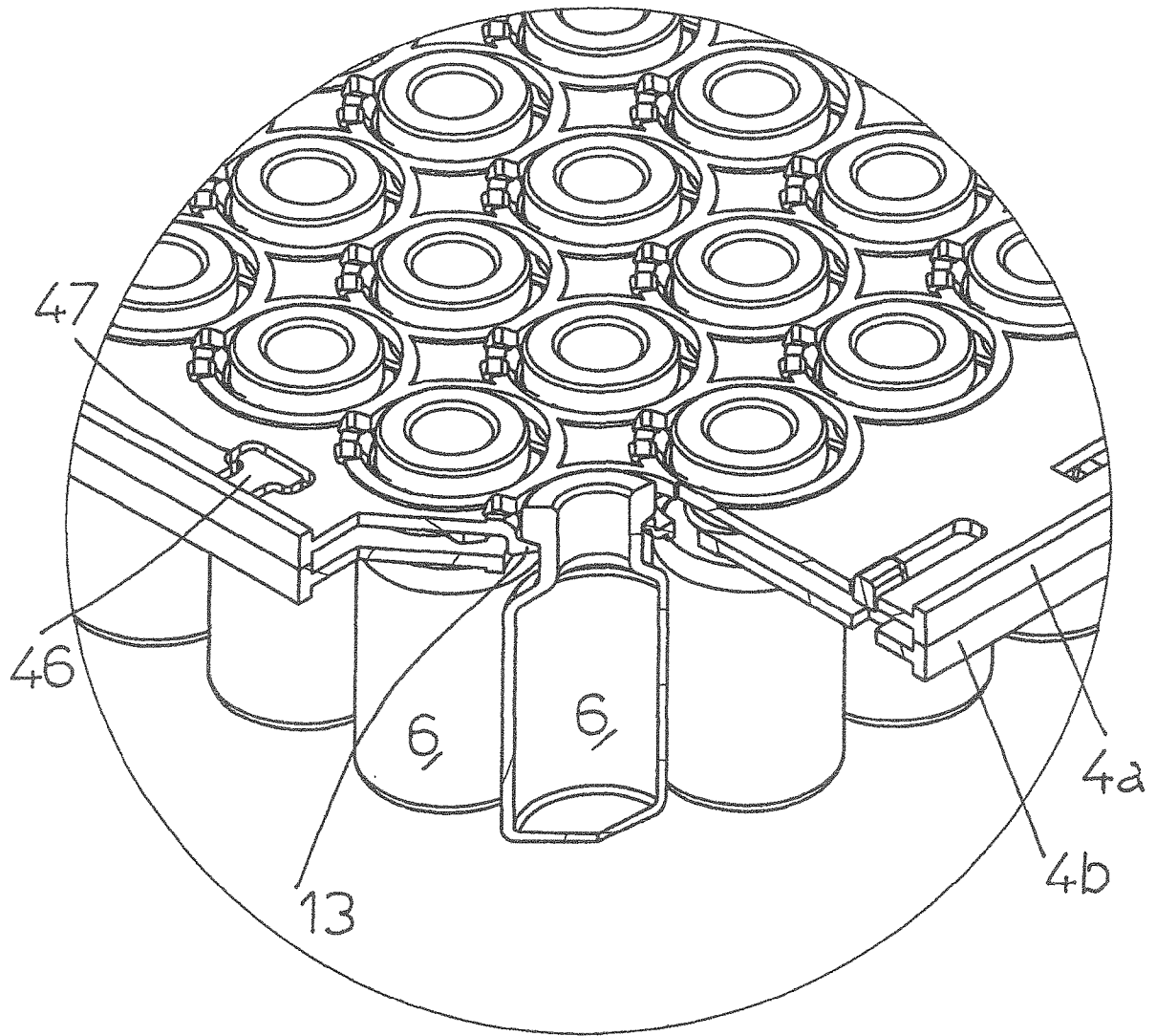
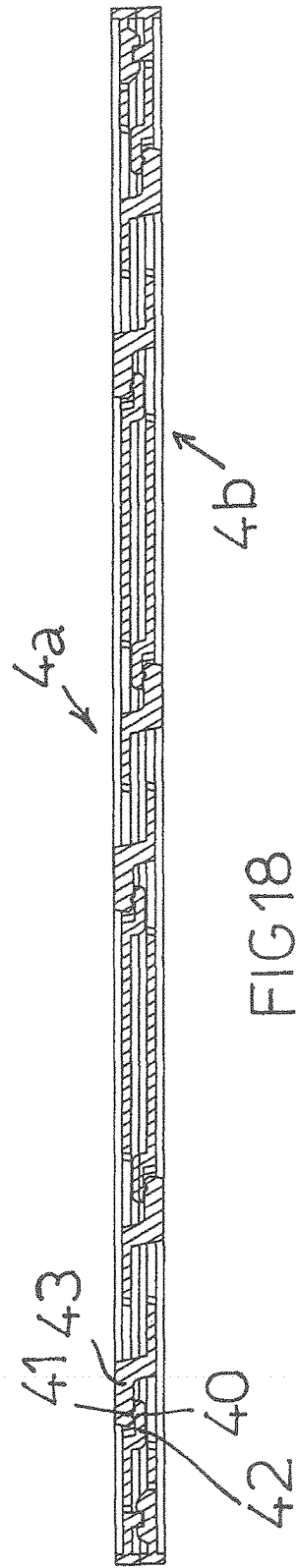
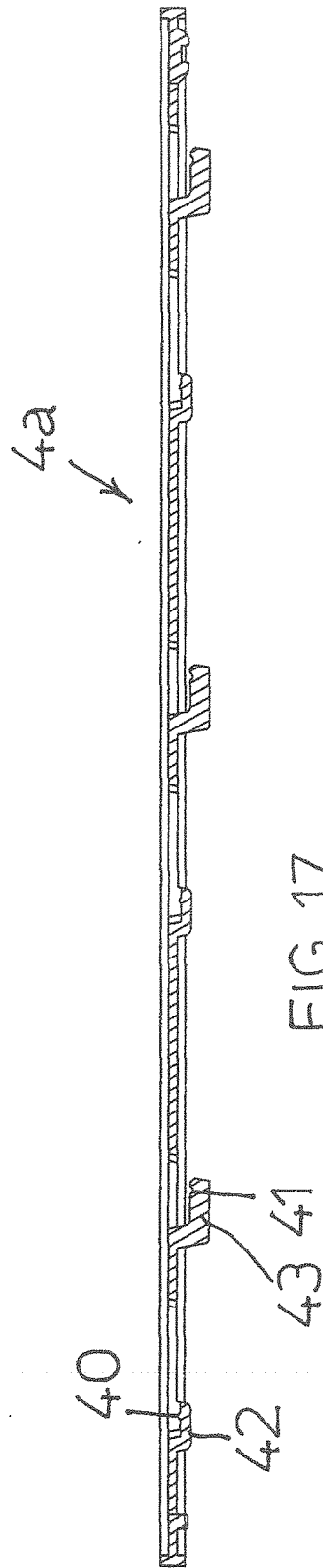

FIG 16



**REFERENCES CITED IN THE DESCRIPTION**

*This list of references cited by the applicant is for the reader's convenience only. It does not form part of the European patent document. Even though great care has been taken in compiling the references, errors or omissions cannot be excluded and the EPO disclaims all liability in this regard.*

**Patent documents cited in the description**

- US 6719141 B [0005]

EP 2 840 036 B1

## CSOMAGOLÓ SZERKEZET ÜVEGTARTÁLYOKHOZ GYÓGYÁSZATI ALKALMAZÁSRA

### Szabadalmi igénypontok

1. Csomagoló szerkezet (1) nyakrésszel ellátott üvegtartályokhoz gyógyászati alkalmazásra, ahol az magában foglal egy tálcát (2), amely magában hordoz - egy megemelt pozícióban a fenekéhez viszonyítva - egy felfekvési (támasztó) síkfelületet (4), amely, a nevezett tartályok bejuttatása céljából, rendelkezik több nyílással (12), amely nyílások térközrel vannak elhelyezve egymáshoz viszonyítva egy előre meghatározott térbeli elrendezés (sorrend) szerint és rendelkeznek egy centrális szimmetriatengellyel (S), amely merőleges a nevezett felfekvési (támasztó) síkfelületre (4), ahol a nevezett felfekvési (támasztó) síkfelület (4) továbbá magában foglal, a nevezett nyílások (12) közül mindegyiknél, egy tartóerő révén elasztikusan elhajló (rugalmasan engedő) tartóeszközöket (13) egy tartály (6) számára, ahol a nevezett tartóeszközök (13) abba a térfogatba (térrészebe) terjednek, amely a nevezett nyílások (12) közül mindegyik kerületének a kiálló része által van körülzárva a nevezett centrális szimmetriatengellyel (S) párhuzamos módon, ahol a nevezett tartóeszközök magukban foglalnak billenőlapokat (13), amelyek alkalmazása annak téve, hogy a tartály (6) legyen megtartva a nevezett tartály (6) nyakrészének a felső részének egy kidomborodó szakasza alatt, **azzal jellemezve, hogy a billenőlapok (13) elasztikusak (rugalmasak) és elasztikusan (rugalmasan) hozzá tudnak illeszkedni a nevezett tartály (6) nyakrészének az alsó átmérőjéhez, ahol mind a tartálynak (6) a centrálisan történő (központosított) tartása mind annak súlyának a megtámasztása (tartása) csak az elasztikus (rugalmas) billenőlapok (13) révén biztosítható.**
2. Csomagoló szerkezet (1) nyakrésszel ellátott üvegtartályokhoz gyógyászati alkalmazásra az előző igénypont szerint, **azzal jellemezve, hogy a nevezett tálcát (2) rendelkezik eszközökkel annak a terméknek az azonosítására és nyomon követésére, amelyet a nevezett tartály (6) tartalmaz.**
3. Csomagoló szerkezet (1) nyakrésszel ellátott üvegtartályokhoz gyógyászati alkalmazásra az előző igénypontok közül egy vagy több szerint, **azzal jellemezve, hogy az rendelkezik legalább egy külső védőburkolattal (18), amely körülzárja a nevezett tálcát (2), ahol a nevezett burkolat le van zárva vagy rendelkezik legalább egy gyors átadó (átviteli) nyílással (19) a nevezett csomagoló szerkezetnek a bejuttatása céljából olyan területekre, amelyek szabályozott környezettel rendelkeznek.**
4. Csomagoló szerkezet (1) nyakrésszel ellátott üvegtartályokhoz gyógyászati alkalmazásra az előző igénypontok közül egy vagy több szerint, **azzal jellemezve, hogy a nevezett bejuttató nyílások (12) egy mátrix-elrendezéssel (mátrix-sorrenddel, angolul: „matrix order”) rendelkeznek, amely egy sorokból és oszlopokból álló sorozatban van elrendezve.**
5. Csomagoló szerkezet (1) nyakrésszel ellátott üvegtartályokhoz gyógyászati alkalmazásra az előző igénypontok közül egy vagy több szerint, **azzal jellemezve, hogy a nevezett billenőlapoknak (13) a disztális végei hajlítva vannak (ferdén állnak) a nyílások (12) szimmetriatengelyének (S) az irányában.**
6. Csomagoló szerkezet (1) nyakrésszel ellátott üvegtartályokhoz gyógyászati alkalmazásra az előző igénypontok közül egy vagy több szerint, **azzal jellemezve, hogy a nevezett tartóeszközök (13) a nevezett felfekvési (támasztó) síkfelület (4) felett vannak elrendezve.**
7. Rendszer, amely magában foglalja a következőket: egy az előző igénypontok közül egy vagy több szerintű csomagoló szerkezetet (1) és a tartályt (6).

