

**(12) STANDARD PATENT**  
**(19) AUSTRALIAN PATENT OFFICE**

(11) Application No. **AU 2011237461 B2**

- (54) Title  
**Use of remote ischemic conditioning for traumatic injury**
- (51) International Patent Classification(s)  
**A61B 17/132** (2006.01) **A61B 5/02** (2006.01)
- (21) Application No: **2011237461** (22) Date of Filing: **2011.04.08**
- (87) WIPO No: **WO11/127341**
- (30) Priority Data
- (31) Number (32) Date (33) Country  
**61/322,070** **2010.04.08** **US**
- (43) Publication Date: **2011.10.13**  
(44) Accepted Journal Date: **2015.11.26**
- (71) Applicant(s)  
**The Hospital for Sick Children**
- (72) Inventor(s)  
**Caldarone, Christopher**
- (74) Agent / Attorney  
**Pizzeys Patent and Trade Mark Attorneys, GPO Box 1374, BRISBANE, QLD, 4001**
- (56) Related Art  
**Andreka et al., Heart 2007;93:749-752**  
**Botker HE et al., Lancet, 27 February 2010; 375: 727-34**  
**Kragh, J.F. et al., Practical Use of Emergency Tourniquets to Stop Bleeding in Major Limb Trauma. J Trauma. 2008;64:S38 -S50**  
**Jennings, P., Clinical Practice - A Critical Appraisal of the Revised Trauma Score. J Emergency Primary Health Care (JEPHC), 2004, Vol.2, Issue1-2, pages 2-9 as cited and reproduced in the Aus J of Paramedicine, Vol.2 [2004], Iss. 1, Art. 8**  
**US 2004/0255956**  
**WO 2006/069170**  
**WO 2008/148045**  
**WO 2008/148062**

(12) INTERNATIONAL APPLICATION PUBLISHED UNDER THE PATENT COOPERATION TREATY (PCT)

(19) World Intellectual Property Organization  
International Bureau



(43) International Publication Date  
13 October 2011 (13.10.2011)

PCT

(10) International Publication Number  
**WO 2011/127341 A2**

(51) International Patent Classification:  
*A61B 17/132* (2006.01) *A61B 5/02* (2006.01)

(21) International Application Number:  
PCT/US2011/031674

(22) International Filing Date:  
8 April 2011 (08.04.2011)

(25) Filing Language: English

(26) Publication Language: English

(30) Priority Data:  
61/322,070 8 April 2010 (08.04.2010) US

(71) Applicant (for all designated States except US): **THE HOSPITAL FOR SICK CHILDREN** [CA/CA]; 555 University Avenue, Toronto, Ontario, M5G 1X8 (CA).

(72) Inventor; and

(75) Inventor/Applicant (for US only): **CALDARONE, Christopher** [US/CA]; 96 Highland Avenue, Toronto, Ontario, M4W 2A6 (CA).

(74) Agent: **TREVISAN, Maria, A.**; Wolf, Greenfield & Sacks, P.C., 600 Atlantic Avenue, Boston, MA 02210-2206 (US).

(81) Designated States (unless otherwise indicated, for every kind of national protection available): AE, AG, AL, AM, AO, AT, AU, AZ, BA, BB, BG, BH, BR, BW, BY, BZ, CA, CH, CL, CN, CO, CR, CU, CZ, DE, DK, DM, DO, DZ, EC, EE, EG, ES, FI, GB, GD, GE, GH, GM, GT, HN, HR, HU, ID, IL, IN, IS, JP, KE, KG, KM, KN, KP, KR, KZ, LA, LC, LK, LR, LS, LT, LU, LY, MA, MD, ME, MG, MK, MN, MW, MX, MY, MZ, NA, NG, NI, NO, NZ, OM, PE, PG, PH, PL, PT, RO, RS, RU, SC, SD, SE, SG, SK, SL, SM, ST, SV, SY, TH, TJ, TM, TN, TR, TT, TZ, UA, UG, US, UZ, VC, VN, ZA, ZM, ZW.

(84) Designated States (unless otherwise indicated, for every kind of regional protection available): ARIPO (BW, GH, GM, KE, LR, LS, MW, MZ, NA, SD, SL, SZ, TZ, UG, ZM, ZW), Eurasian (AM, AZ, BY, KG, KZ, MD, RU, TJ, TM), European (AL, AT, BE, BG, CH, CY, CZ, DE, DK, EE, ES, FI, FR, GB, GR, HR, HU, IE, IS, IT, LT, LU, LV, MC, MK, MT, NL, NO, PL, PT, RO, RS, SE, SI, SK, SM, TR), OAPI (BF, BJ, CF, CG, CI, CM, GA, GN, GQ, GW, ML, MR, NE, SN, TD, TG).

Published:

— with declaration under Article 17(2)(a); without abstract; title not checked by the International Searching Authority



WO 2011/127341 A2

(54) Title: USE OF REMOTE ISCHEMIC CONDITIONING FOR TRAUMATIC INJURY

(57) Abstract:

- 1 -

**USE OF REMOTE ISCHEMIC CONDITIONING FOR TRAUMATIC INJURY****RELATED APPLICATIONS**

This application claims the benefit of U.S. Provisional Application Serial No. 61/322070, filed on April 8, 2010, entitled "USE OF REMOTE ISCHEMIC CONDITIONING FOR TRAUMATIC INJURY", the entire contents of which are incorporated by reference herein.

**BACKGROUND OF THE INVENTION**

Traumatic injury is one of the leading causes of death in children and young adults. In addition, it represents a significant proportion of health care expenditures. Trauma generally refers to severe bodily injury or wounding, typically resulting from blunt force as can occur with falls, automobile accidents, domestic or industrial accidents, and in battle. Traumatic injuries should be treated immediately in order to prevent or lessen the effects of such injuries. Many of the interventions and/or therapies known to be useful at least in the acute stages of traumatic injury however are not always available.

**SUMMARY OF THE INVENTION**

The invention is premised, in part, on the surprising finding that deliberately performing one or more cycles of transient blood flow occlusion followed by reperfusion in a region of the body of a subject, that is remote from the region where trauma occurs or that is being protected from the effects of the trauma, reduces the effects of such trauma. The trauma may be direct trauma or indirect trauma. The trauma may or may not be associated with hypovolemia. The methods of the invention provide benefit even if resuscitation therapy is performed, and more surprisingly even if resuscitation therapy is delayed.

The invention therefore provides for the use of remote ischemic conditioning (RIC) to treat traumatic injury. The invention contemplates the use of RIC on a subject that has experienced, is experiencing, or is likely to experience trauma. In subjects that have experienced or are experiencing trauma, the invention calls for RIC during or after the trauma, or during and after the trauma. In subjects that are likely to experience trauma, the invention calls for RIC before the expected trauma and optionally during and/or after such trauma occurs.

- 2 -

Accordingly, in one aspect, the invention provides a method for reducing or preventing injury to cells, tissues, or organs of a body as a result of trauma comprising performing one or more cycles of blood flow occlusion followed by reperfusion on a subject before, during, and/or following trauma, wherein the blood flow occlusion and reperfusion occurs at a remote region of the body, including but not limited to one or more lower and/or upper limbs. It will be understood that the blood flow occlusion and reperfusion cycles will be performed in an amount and frequency to reduce or prevent injury. In another aspect, the invention provides a method for reducing or preventing injury to cells, tissues, or organs of a body as a result of trauma comprising performing individual or repeated RIC regimens on a subject before, during, and/or following trauma. It will be understood that the RIC regimens will be performed in an amount and a frequency sufficient to reduce or prevent injury.

In some embodiments, the injury affects multiple organs, and may be referred to as multi-organ injury or dysfunction. In some embodiments, the injury is to the lungs and/or to the liver. In some embodiments, the injury is neurological injury or dysfunction.

In another aspect, the invention provides a method for treating a subject experiencing trauma comprising performing one or more cycles of blood flow occlusion followed by reperfusion on the subject during and/or following trauma, wherein the blood flow occlusion and reperfusion occurs at a remote region of the body, including but not limited to one or more lower and/or upper limbs. In another aspect, the invention provides a method for treating a subject experiencing trauma comprising performing individual or repeated RIC regimens on the subject during and/or following trauma.

In another aspect, the invention provides a method comprising performing one or more cycles of blood flow occlusion followed by reperfusion on a subject experiencing or likely to experience trauma, wherein the one or more cycles are performed before, during and/or following trauma, wherein the blood flow occlusion and reperfusion occurs at a remote region of the body, including but not limited to one or more lower and/or upper limbs. In another aspect, the invention provides a method comprising performing individual or repeated RIC regimens on the subject experiencing or likely to experience trauma, wherein the one or more RIC regimens are performed before, during and/or following trauma.

- 3 -

The invention contemplates that the subject will undergo one or more than one RIC regimen. Such multiple regimens may be performed on a single day and/or over the course of several days.

In some embodiments, the trauma is hemorrhagic shock. In some embodiments, the subject may be hypotensive and/or hypovolemic. In some embodiments, the subject has lost 10%, 15%, 20%, 25%, 30%, or more of total whole blood volume. In some embodiments, the subject has received resuscitation therapy. In some embodiments, the subject has not received resuscitation therapy.

In some embodiments, the trauma is not associated with hypovolemia (e.g., the trauma may be blast injury).

In some embodiments, the repeated RIC regimens comprise more than one RIC regimen performed on a single day. In some embodiments, the repeated RIC regimens comprise two, three, four or five RIC regimens performed on a single day. In some embodiments, the repeated RIC regimens comprise one or more RIC regimens on more than one day.

In some embodiments, at least one RIC regimen is performed within 30 minutes or 1 hour of the trauma. In some embodiments, at least one RIC regimen is performed immediately after trauma.

In some embodiments, the repeated RIC regimens comprise one or more RIC regimens performed on a daily basis for one month.

In some embodiments, the RIC regimens are performed before the trauma, in which case they may be regarded as remote ischemic preconditioning regimens. In some embodiments, the RIC regimens are performed before and after the trauma. In some embodiments, the RIC regimens are performed before, during and after the trauma. In some embodiments, the RIC regimens are performed during and after the trauma. In some embodiments, the RIC regimens are performed after the trauma.

In some embodiments, the subject is human.

In some embodiments of the foregoing aspects, a single RIC cycle is performed on the subject (i.e., the subject is subjected to a period of blood flow occlusion followed by a period of reperfusion). In some embodiments, the cycle comprises about 10 minutes of blood flow occlusion and about or less than 10 minutes of reperfusion.

- 4 -

In some embodiments, at least one individual RIC regimen (for example, within the repeated RIC regimen) comprises at least two, at least three, or at least four cycles, each cycle comprising blood flow occlusion and reperfusion. In some embodiments, at least one RIC regimen comprises at least four cycles, each cycle comprising blood flow occlusion and reperfusion. In some embodiments, at least one RIC regimen comprises one or more cycles of about 5 minutes of blood flow occlusion and about 5 minutes of reperfusion. In some embodiments, at least one RIC regimen comprises one or more cycles of about 10 minutes of blood flow occlusion and about 10 minutes of reperfusion.

In some embodiments, blood flow occlusion is effected by applying to the remote region of the body a pressure that is above systolic pressure. In some embodiments, blood flow occlusion is effected by applying to the remote region of the body a pressure that is below systolic pressure.

In some embodiments, at least one individual RIC regimen (for example, within the repeated RIC regimen) comprises at least two, at least three, or at least four cycles, each cycle comprising supra-systolic pressure and reperfusion. In some embodiments, at least one RIC regimen comprises at least four cycles, each cycle comprising supra-systolic pressure and reperfusion. In some embodiments, at least one RIC regimen comprises one or more cycles of 5 minutes of supra-systolic pressure and 5 minutes of reperfusion. In some embodiments, the supra-systolic pressure is a pressure that is 1-5 mmHg, or 1-10 mmHg, or 1-15 mmHg above systolic pressure. In some embodiments, the supra-systolic pressure is a pressure that is at least 15 mmHg above systolic pressure. In some embodiments, the supra-systolic pressure is pressure that is about 200 mmHg.

In some embodiments, at least one individual RIC regimen (for example, within the repeated RIC regimen) comprises at least two, at least three, or at least four cycles, each cycle comprising below-systolic pressure and reperfusion.

In some embodiments, individual or repeated RIC regimens are performed at the same site. In one embodiment, individual or repeated RIC regimens are performed on an upper limb. In one embodiment, the individual or repeated RIC regimens are performed on a lower limb. In one embodiment, individual or repeated RIC regimens are performed using two or more devices such as two or more cuffs, positioned at different sites on the body (e.g., one cuff per upper limb (or arm), two cuffs on a single upper limb, one cuff per lower

- 5 -

limb (or leg), two cuffs on a single lower limb, one cuff on an upper limb and one cuff on a lower limb, etc.).

In various embodiments, the subject may be administered two or more of these aforementioned agents.

These and other aspects and embodiments of the invention will be discussed in greater detail herein.

### BRIEF DESCRIPTION OF THE FIGURES

The accompanying figures are not intended to be drawn to scale. In the figures, each identical or nearly identical component that is illustrated in various figures is represented by a like numeral. For purposes of clarity, not every component may be labeled in every figure.

Various embodiments of the invention will now be described, by way of example, with reference to the accompanying figures, in which:

FIG. 1 is a schematic representation of one embodiment of a remote ischemic conditioning system, including a pneumatically inflatable cuff configured to contract about the limb of a subject.

FIG. 2 is a block diagram of one embodiment of an operating scheme of the RIC system.

FIG. 3 shows an alternate embodiment of a cuff configured to contract about the limb of a subject.

FIG. 4 shows the effect of RIC on shock and resuscitation induced liver damage in individual mice (A) and as an average (B).

FIG. 5 shows the effect of RIC on shock and resuscitation induced serum TNF-alpha levels in individual mice (A) and as an average (B).

### DETAILED DESCRIPTION OF THE INVENTION

The invention provides, in part, methods for treating subjects that have experienced trauma by performing on such subjects one or more RIC regimens during and/or after the trauma. The invention also provides, in part, methods for reducing the effects of trauma in subjects likely to experience trauma by performing one or more RIC regimens prior to trauma. Although not intending to be bound by any mechanism or theory of action, it is

- 6 -

contemplated that the one or more RIC cycles or regimens reduce the degree of injury in cells, one or more tissues and/or one or more organs that would be impacted by the trauma. RIC regimens are able to ameliorate the effects of ischemia and reperfusion injury when performed before or during the time of ischemia or reperfusion. RIC is associated with suppression of immune mediators believed to be responsible for trauma-associated morbidity.

The invention relates to the performance of RIC to treat (including to ameliorate) the systemic effects associated with traumatic injury. Examples of traumatic injury that can be treated according to the invention include but are not limited to blunt trauma and hemorrhage (e.g., hemorrhagic shock). In some aspects of the invention, a subject that has sustained a traumatic injury will undergo one or more cycles of deliberately induced blood flow occlusion and reperfusion at a location on the body that is uninjured (e.g., an uninjured limb). In some aspects of the invention, a subject that has sustained a traumatic injury will undergo one or more cycles of deliberately induced ischemia and reperfusion at a location on the body that is uninjured (e.g., an uninjured limb). As described in greater detail below, these cycles constitute a regimen. A regimen may comprise 1, 2, 3, 4, 5 or more cycles. Each cycle comprises induced occlusion or ischemia for a first period of time followed by reperfusion for a second period of time. The first and second periods of time may be identical or they may be different from each other. As a non-limiting example, one or more cycles of a regimen may comprise about 5 minutes of occlusion or ischemia followed by about 5 minutes of reperfusion. As another non-limiting example, one or more cycles may comprise about 10 minutes of occlusion or ischemia followed by about 10 minutes of reperfusion. If only a single cycle is used, then the reperfusion period may be shorter than the occlusion or ischemic period (e.g., it may be less than about 1 minute, less than about 30 seconds, less than about 10 seconds, etc.).

The invention contemplates that RIC will be performed on the subject by a first responder (i.e., the first qualified person to attend to the subject). RIC can therefore be performed using an automated device (such as a pressure cuff) or manually (using a tourniquet). The ability to achieve therapeutic benefit using RIC alone is invaluable in circumstances where other interventions, including intravenous fluid resuscitation, are not available or are delayed. These circumstances include without limitation battlefield conditions during military conflicts. Accordingly, the invention contemplates that RIC can



- 7 -

be used to reduce and/or prevent injury that is induced by trauma (e.g., hemorrhagic shock) in situations in which resuscitation therapy has not been performed or was delayed. RIC may be performed before the trauma, before resuscitation therapy, and/or after the resuscitation therapy. The invention provides intervention in the form of a light-weight, preferably automated, ischemic conditioning device that can be performed by any personnel with minimal training and minimal time required for treatment. In like manner, the invention also contemplates performing RIC on a subject in preparation for a probable traumatic injury, including for example prior to military engagement or confrontation.

Accordingly, the degree and/or severity of traumatic injury can be reduced by deliberately and repeatedly performing cycles of induced transient ischemia and reperfusion (i.e., an RIC regimen) in subjects. These subjects include those that are experiencing trauma and those that are likely to experience trauma. The ease of use of these methods make them amenable to particular circumstances including but not limited to battlefield injuries. The ability to provide therapy to such subjects, particularly where there is no other therapy or intervention immediately available, is valuable. In like manner, these methods can be used in other emergency situations in which no other therapy or intervention is immediately available such as can occur following catastrophic events such as earthquakes and other natural disasters, bombings, and the like.

The invention contemplates, in some aspects, performing a repeated RIC regimen on a subject. As used herein, an RIC regimen (or an individual RIC regimen) means at least one cycle of an induced transient ischemic event followed by a reperfusion event. An individual RIC regimen therefore may be comprised of 1, 2, 3, 4, 5, or more such cycles.

Also as used herein, a repeated RIC regimen is two or more individual RIC regimens that occur on a single day and/or one or more RIC regimens that occur on a number of days. For example, the repeated RIC regimen may comprise performing multiple RIC regimens on a single day, or performing single RIC regimens on a number of days, or performing multiple RIC regimens on a number of days. If the repeated RIC regimen occurs on a single day, the time between individual regimens may be at least 10 minutes, at least 20 minutes, at least 40 minutes, at least 1 hour, at least 2 hours, or at least 6 hours, for example. The invention contemplates that more than one RIC regimen may be performed prior to an expected trauma (such as a battlefield injury) in a short period of time in order to prepare the subject for the trauma.

- 8 -

As should be clear, there is no requirement that any or all of the RIC regimens in a repeated RIC regimen be identical with respect to timing, number of cycles per regimen, supra-systolic pressure, location, and the like. Moreover, even within a regimen, the times of ischemia and reperfusion may differ between cycles. Typically, however, for ease of use, the cycles within a given regimen are identical. The invention further contemplates that regimens performed prior to traumatic injury may comprise more cycles and potentially may be more frequent and/or greater in number than regimens performed during or following traumatic injury.

In some instances, RIC may be performed in an area of the body that is remote to the area of traumatic injury. However, in some instances, the effects of the traumatic injury are systemic (e.g., multi-organ injury or dysfunction) and thus RIC is performed in an area of the body that is accessible and preferably has not open wounds. Preferably but not exclusively, the RIC regimen is non-invasive. Accordingly, RIC may be performed on a limb such as an upper or lower limb. The repeated RIC regimen may be performed on a single site or on multiple sites in the body. For example, the repeated RIC regimen may comprise a first RIC regimen performed on the right upper arm, followed by a second RIC regimen performed on the left upper arm. The repeated RIC regimen may alternate between or cycle through sites on the body. In some instances, an RIC regimen may be performed on a subject at two different sites at overlapping times including simultaneously. In such instances, two devices may be used. These devices may be in communication with each other or they may be functioning independently of each other.

The subjects of the invention will preferably be humans, although non-human subjects such as companion animals (e.g., dogs, cats, etc.), agricultural or prize-winning animals (e.g., race horses, etc.) are also contemplated. Essentially, any subject that can experience traumatic injury can be treated according to the invention.

Trauma, as used herein, refers to critical or severe bodily injury, wound or shock. These forms of trauma typically require some form of resuscitation therapy. Resuscitation therapy typically involves replenishment of bodily fluids including but not limited to blood transfusion or other saline transfusion. Shock broadly refers to circulatory dysfunction. Shock may be hemorrhagic or hypovolemic shock (associated with inadequate blood volume) or it may be cardiogenic shock (associated with inadequate output of blood from the heart). Trauma associated with blood loss therefore typically also involves shock.

- 9 -

Symptoms associated with shock include without limitation low blood pressure (i.e., hypotension), hypovolemia, hyperventilation, and cyanotic skin. In some instances, the trauma involves traumatic brain injury (e.g., the injury is to the head). In some instances, the trauma does not involve traumatic brain injury (e.g., the injury may be to the torso or one or more limbs).

Therefore, RIC may be performed on a subject that is hypovolemic and/or hypotensive. A subject that is hypovolemic may be a subject that has lost 5%, 10%, 15%, 20%, 25%, 30% or more of its whole blood volume. The cause of blood loss volume may be external bleeding, internal bleeding, or reduced blood volume resulting from excessive loss of other body fluids as may occur with diarrhea, vomiting and burns.

Trauma may result from direct injury such as penetrating injury (e.g., bullet wound). Trauma may also result from indirect injury such as, for example, a blast injury that occurs from exposure to a pressure wave following, for example, an explosion. Such latter types of trauma may occur in the absence of hypovolemia. In some instances, the invention contemplates the use of RIC after traumatic injury not associated with hypovolemia. In these and other instances, RIC may diminish systemic manifestations of the response to injury which includes neurologic injury and multi-organ dysfunction.

Since it is important to treat the subject as soon as possible, the invention contemplates that the methods provided herein may be performed in a hospital setting or in a non-hospital setting including in the environment in which the trauma occurred. RIC may be performed before the trauma occurs, and/or after the trauma occurs, including before and/or after resuscitation therapy is performed.

The repeated RIC regimens may be performed before, during and/or after trauma. In some embodiments, at least one of the RIC regimens are performed before trauma. These are referred to as remote ischemic preconditioning regimens. In these embodiments, at least one RIC regimen may be performed within about 48 hours, within about 24 hours, within about 12 hours, within about 6 hours, within about 4 hours, within about 2 hours, or within about 1 hour prior to trauma.

In some embodiments, at least one of the RIC regimens is performed after trauma has occurred. As an example, the subject may no longer be hypotensive or hypovolemic, but RIC may still be performed. These are referred to as remote ischemic post-conditioning regimens. In these embodiments, at least one RIC regimen may be performed within about

- 10 -

48 hours, within about 24 hours, within about 12 hours, within about 6 hours, within about 4 hours, within about 2 hours, within about 1 hour, within about 30 minutes, within about 20 minutes, within about 10 minutes, within about 5 minutes, or just immediately after the occurrence of trauma, or after the subject has been stabilized (e.g., the subject is no longer hypovolemic and/or hypotensive).

In some embodiments, the repeated RIC regimens span a number of days, including 2, 3, 4, 5, 6, 7, 8, 9, 10, 15, or 30 or more days. It is to be understood that in such instances, a subject may undergo an RIC regimen daily, or every 2, 3, 4, 5, or 6 days, for example. Additionally, the RIC regimens may be performed in a non-regular, or random, manner.

### *Additional Therapies*

The repeated RIC regimen of the invention may be used in combination with other therapies or procedures aimed at treating traumatic injury, blood loss, hemorrhage, and/or shock. Depending upon the embodiment, one or more of these agents may be administered before, simultaneously with or following one or more RIC regimens and/or before, simultaneously with or following trauma. Trauma victims may be administered an anaesthetic simply to alleviate pain associated with the traumatic injury.

In some embodiments, the subject is administered a potassium channel opener or agonist. In some embodiments, the subject is administered an adenosine receptor agonist. In some embodiments, the subject is administered both of the foregoing agents.

Potassium channel openers include without limitation nicorandil, diazoxide, minoxidil, pinacidil, aprikalim, cromokulim and derivative U-89232, P-1075 (a selective plasma membrane K-ATP channel opener), emakalim, YM-934, (+)-7,8-dihydro-6,6-dimethyl-7-hydroxy-8-(2-oxo-1-piperidinyl)-6H-pyrano[2,3-f]benz-2,1,3-oxadiazole (NIP-121), RO316930, RWJ29009, SDZPCO400, rimakalim, symakalim, YM099, 2-(7,8-dihydro-6,6-dimethyl-6H-[1,4]oxazino[2,3-f][2,1,3]benzoxadiazol-8-yl) pyridine N-oxide, 9-(3-cyanophenyl)-3,4,6,7,9,10-hexahydro-1,8-(2H,5H)-acridinedione (ZM244085), [(9R)-9-(4-fluoro-3-<sup>125</sup>Iiodophenyl)-2,3,5,9-tetrahydro-4H-pyrano[3,4-b]thieno[2,3-e]pyridin-8(7H)-one-1,1-dioxide] ([<sup>125</sup>I]A-312110), (-)-N-(2-ethoxyphenyl)-N'-(1,2,3-trimethylpropyl)-2-nitroethene-1,1-diamine (Bay X 9228), N-(4-benzoyl phenyl)-3,3,3-trifluoro-2-hydroxy-2-methylpropionamine (ZD6169), ZD6169 (K-ATP opener) and

- 11 -

ZD0947 (K-ATP opener), WAY-133537 and a novel dihydropyridine potassium channel opener, A-278637. In addition, potassium channel openers can be selected from BK-activators (also called BK-openers or BK(Ca)-type potassium channel openers or large-conductance calcium-activated potassium channel openers) such as benzimidazolone derivatives NS004 (5-trifluoromethyl-1-(5-chloro-2-hydroxyphenyl)-1,3-dihydro-2H-benzimidazole-2-one), NS1619 (1,3-dihydro-1-[2-hydroxy-5-(trifluoromethyl)phenyl]-5-(trifluoromethyl)-2H-benzimidazole-2-one), NS1608 (N-(3-(trifluoromethyl)phenyl)-N'-(2-hydroxy-5-chlorophenyl)urea), BMS-204352, retigabine (also GABA agonist). There are also intermediate (eg. benzoxazoles, chlorzoxazone and zoxazolamine) and small-conductance calcium-activated potassium channel openers. Other compounds that are believed to open K-ATP channels include Levosimendan and hydrogen sulphide gas (H.sub.2S) or the H.sub.2S donors (eg sodium hydrosulphide, NaHS).

Adenosine receptor agonists include without limitation N<sup>6</sup>-cyclopentyladenosine (CPA), N-ethylcarboxamido adenosine (NECA), 2-[p-(2-carboxyethyl)phenethyl-amino-5'-N-ethylcarboxamido adenosine (CGS-21680), 2-chloroadenosine, N<sup>6</sup>-[2-(3,5-dimethoxyphenyl)-2-(2-methoxyphenyl)ethyl]adenosine, 2-chloro-N-6-cyclopentyladenosine (CCPA), N-(4-aminobenzyl)-9-[5-(methylcarbonyl)-beta-D-ribofuranosyl]-adenine (AB-MECA), ([IS-[1a,2b,3b,4a(S\*)]]-4-[7-[2-(3-chloro-2-thienyl)-1-methyl-propyl]amino]-3H-imidazole[4,5-b]pyridyl-3-yl]cyclopentane carboxamide (AMP579), N<sup>6</sup>-(R)-phenylisopropyladenosine (R-PLA), aminophenylethyladenosine (APNEA) and cyclohexyladenosine (CHA).

Adenosine A1 receptor agonists include without limitation N-[3-(R)-tetrahydrofuran-2-yl]-6-aminopurine riboside (CVT-510), or partial agonists such as CVT-2759 and allosteric enhancers such as PD81723. Other agonists may include N<sup>6</sup>-cyclopentyl-2-(3-phenylaminocarbonyl-1H-tetrazol-1-yl) adenosine (TCPA).

In some embodiments, the subjects may be administered anti-inflammatory agents, beta blockers (i.e., beta-adrenergic blocking agents) and/or calcium channel blockers.

Anti-inflammatory agents include without limitation Alclofenac; Alclometasone Dipropionate; Algestone Acetonide; Alpha Amylase; Amcinafal; Amcinafide; Amfenac Sodium; Amiprilose Hydrochloride; Anakinra; Anirolac; Anitrazafen; Apazone; Balsalazide Disodium; Bendazac; Benoxaprofen; Benzydamine Hydrochloride; Bromelains; Broperamol; Budesonide; Carprofen; Cicloprofen; Cintazone; Cliprofen; Clobetasol

- 12 -

Propionate; Clobetasone Butyrate; Clopirac; Cloticasone Propionate; Cormethasone Acetate; Cortodoxone; Deflazacort; Desonide; Desoximetasone; Dexamethasone Dipropionate; Diclofenac Potassium; Diclofenac Sodium; Diflorasone Diacetate; Diflumidone Sodium; Diflunisal; Difluprednate; Diftalone; Dimethyl Sulfoxide; Drocinonide; Endrysone; Enlimomab; Enolicam Sodium; Epirizole; Etodolac; Etofenamate; Felbinac; Fenamole; Fenbufen; Fenclofenac; Fenclorac; Fendosal; Fenpipalone; Fentiazac; Flazalone; Fluazacort; Flufenamic Acid; Flumizole; Flunisolide Acetate; Flunixin; Flunixin Meglumine; Fluocortin Butyl; Fluorometholone Acetate; Fluquazone; Flurbiprofen; Fluretofen; Fluticasone Propionate; Furaprofen; Furobufen; Halcinonide; Halobetasol Propionate; Halopredone Acetate; Ibufenac; Ibuprofen; Ibuprofen Aluminum; Ibuprofen Piconol; Ilonidap; Indomethacin; Indomethacin Sodium; Indoprofen; Indoxole; Intrazole; Isoflupredone Acetate; Isoxepac; Isoxicam; Ketoprofen; Lofemizole Hydrochloride; Lornoxicam; Loteprednol Etabonate; Meclofenamate Sodium; Meclofenamic Acid; Meclorisone Dibutyrate; Mefenamic Acid; Mesalamine; Meseclazone; Methylprednisolone Suleptanate; Morniflumate; Nabumetone; Naproxen; Naproxen Sodium; Naproxol; Nimazone; Olsalazine Sodium; Orgotein; Orpanoxin; Oxaprozin; Oxyphenbutazone; Paranyline Hydrochloride; Pentosan Polysulfate Sodium; Phenbutazone Sodium Glyccrate; Pirfenidone; Piroxicam; Piroxicam Cinnamate; Piroxicam Olamine; Pirprofen; Prednazate; Prifelone; Prodolic Acid; Proquazone; Proxazole; Proxazole Citrate; Rimexolone; Romazarit; Salcolex; Salnacedin; Salsalate; Salicylates; Sanguinarium Chloride; Seclazone; Sermetacin; Sudoxicam; Sulindac; Suprofen; Talmetacin; Talniflumate; Talosalate; Tebufelone; Tenidap; Tenidap Sodium; Tenoxicam; Tesicam; Tesimide; Tetrydamine; Tiopinac; Tixocortol Pivalate; Tolmetin; Tolmetin Sodium; Triclonide; Triflumidate; Zidometacin; Glucocorticoids; Zomepirac Sodium. One preferred anti-inflammatory agent is aspirin.

Calcium channel blockers are a chemically diverse class of compounds having important therapeutic value in the control of a variety of diseases including several cardiovascular disorders, such as hypertension, angina, and cardiac arrhythmias (Fleckenstein, *Cir. Res.* v. 52, (suppl. 1), p.13-16 (1983); Fleckenstein, *Experimental Facts and Therapeutic Prospects*, John Wiley, New York (1983); McCall, D., *Curr Pract Cardiol*, v. 10, p. 1-11 (1985)). Calcium channel blockers are a heterogeneous group of drugs that prevent or slow the entry of calcium into cells by regulating cellular calcium channels.

- 13 -

(Remington, The Science and Practice of Pharmacy, Nineteenth Edition, Mack Publishing Company, Eaton, PA, p.963 (1995)). Most of the currently available calcium channel blockers, and useful according to the present invention, belong to one of five major chemical groups of drugs. These are the dihydropyridines, such as nifedipine, nicardipine, and nimodipine; the phenyl alkyl amines, such as verapamil; the benzothiazepines, such as diltiazem; the diarylaminoethylamines, such as bepridil; and the benzimidazole-substituted tetralines, such as mibefradil.

Other calcium channel blockers useful according to the invention include but are not limited to amrinone, amlodipine, bencyclane, felodipine, fendiline, flunarizine, isradipine, perhexilene, gallopamil, tiapamil and tiapamil analogues (such as 1993RO-11-2933), phenytoin, barbiturates, and the peptides dynorphin, omega-conotoxin, and omega-agatoxin, and the like and/or pharmaceutically acceptable salts thereof.

Beta-adrenergic receptor blocking agents are a class of drugs that antagonize the cardiovascular effects of catecholamines in angina pectoris, hypertension, and cardiac arrhythmias. Beta-adrenergic receptor blockers include, but are not limited to, atenolol, acebutolol, alprenolol, befunolol, betaxolol, bunitrolol, carteolol, celiprolol, hedroxalol, indenolol, labetalol, levobunolol, mepindolol, methypranol, metindol, metoprolol, metrizoranolol, oxprenolol, pindolol, propranolol, practolol, practolol, sotalolnadolol, tiprenolol, tomalolol, timolol, bupranolol, penbutolol, trimepranol, 2-(3-(1,1-dimethylethyl)-amino-2-hydroxypropoxy)-3-pyridenecarbonitrilHCl, 1-butylamino-3-(2,5-dichlorophenoxy)-2-propanol, 1-isopropylamino-3-(4-(2-cyclopropylmethoxyethyl)phenoxy)-2-propanol, 3-isopropylamino-1-(7-methylindan-4-yloxy)-2-butanol, 2-(3-t-butylamino-2-hydroxy-propylthio)-4-(5-carbamoyl-2-thienyl)thiazol, 7-(2-hydroxy-3-t-butylaminopropoxy)phthalide. The above-identified compounds can be used as isomeric mixtures, or in their respective levorotating or dextrorotating form.

In some embodiments, the subjects may be administered antioxidant agents.

Antioxidants are agents that reduce or prevent damage associated with oxidation in tissue or organs. Antioxidants include without limitation allopurinol, carnosine, histidine, Coenzyme Q 10, n-acetyl-cysteine, superoxide dismutase (SOD), glutathione reductase (GR), glutathione peroxidase (GP) modulators and regulators, catalase and the other metalloenzymes, NADPH and AND(P)H oxidase inhibitors, glutathione, U-74006F,

- 14 -

vitamin E, Trolox (soluble form of vitamin E), other tocopherols (gamma and alpha, beta, delta), tocotrienols, ascorbic acid, Vitamin C, Beta-Carotene (plant form of vitamin A), selenium, Gamma Linoleic Acid (GLA), alpha-lipoic acid, uric acid (urate), curcumin, bilirubin, proanthocyanidins, epigallocatechin gallate, Lutein, lycopene, bioflavonoids, polyphenols, trolox(R), dimethylthiourea, tempol(R), carotenoids, coenzyme Q, melatonin, flavonoids, polyphenols, aminoindoles, probucol and nitecapone, 21-aminosteroids or lazaroids, sulphhydryl-containing compounds (thiazolidine, Ebselen, dithiolethiones), and N-acetylcysteine.

Other antioxidants include the ACE inhibitors which are described in greater detail below. Other antioxidants include beta-mercaptopropionylglycine, O-phenanthroline, dithiocarbamate, selegilize, desferrioxamine (Desferal), 5'-5-dimethyl-1-pyrrolione-N-oxide (DMPO) and (a-4-pyridyl-1-oxide)-N-t-butyl nitron (POBN). Other antioxidants include nitron radical scavenger alpha-phenyl-tert-N-butyl nitron (PBN) and derivatives PBN (including disulphur derivatives); N-2-mercaptopropionyl glycine (MPG) a specific scavenger of the OH free radical; lipooxygenase inhibitor nordihydroguaric acid (NDGA); Alpha Lipoic Acid; Chondroitin Sulfate; L-Cysteine; oxypurinol and Zinc.

An angiotensin system inhibitor is an agent that interferes with the function, synthesis or catabolism of angiotensin II. These agents include, but are not limited to, angiotensin-converting enzyme (ACE) inhibitors, angiotensin II antagonists, angiotensin II receptor antagonists, agents that activate the catabolism of angiotensin II, and agents that prevent the synthesis of angiotensin I from which angiotensin II is ultimately derived. The renin-angiotensin system is involved in the regulation of hemodynamics and water and electrolyte balance. Factors that lower blood volume, renal perfusion pressure, or the concentration of  $\text{Na}^+$  in plasma tend to activate the system, while factors that increase these parameters tend to suppress its function.

Angiotensin II antagonists are compounds which interfere with the activity of angiotensin II by binding to angiotensin II receptors and interfering with its activity. Angiotensin II antagonists are well known and include peptide compounds and non-peptide compounds. Most angiotensin II antagonists are slightly modified congeners in which agonist activity is attenuated by replacement of phenylalanine in position 8 with some other amino acid; stability can be enhanced by other replacements that slow degeneration in vivo. Examples of angiotensin II antagonists include: peptidic compounds (e.g., saralasin,



- 15 -

[(San<sup>1</sup>)(Val<sup>5</sup>)(Ala<sup>8</sup>)] angiotensin -(1-8) octapeptide and related analogs); N-substituted imidazole-2-one (US Patent Number 5,087,634); imidazole acetate derivatives including 2-N-butyl-4-chloro-1-(2-chlorobenzile) imidazole-5-acetic acid (see Long et al., J. Pharmacol. Exp. Ther. 247(1), 1-7 (1988)); 4, 5, 6, 7-tetrahydro-1H-imidazo [4, 5-c] pyridine-6-carboxylic acid and analog derivatives (US Patent Number 4,816,463); N2-tetrazole beta-glucuronide analogs (US Patent Number 5,085,992); substituted pyrroles, pyrazoles, and triazoles (US Patent Number 5,081,127); phenol and heterocyclic derivatives such as 1, 3-imidazoles (US Patent Number 5,073,566); imidazo-fused 7-member ring heterocycles (US Patent Number 5,064,825); peptides (e.g., US Patent Number 4,772,684); antibodies to angiotensin II (e.g., US Patent Number 4,302,386); and aralkyl imidazole compounds such as biphenyl-methyl substituted imidazoles (e.g., EP Number 253,310, January 20, 1988); ES8891 (N-morpholinoacetyl-(-1-naphthyl)-L-alanyl-(4, thiazolyl)-L-alanyl (35, 45)-4-amino-3-hydroxy-5-cyclo-hexapentanoyl-N-hexylamide, Sankyo Company, Ltd., Tokyo, Japan); SKF108566 (E-alpha-2-[2-butyl-1-(carboxy phenyl) methyl] 1H-imidazole-5-yl[methylane]-2-thiophenepropanoic acid, Smith Kline Beecham Pharmaceuticals, PA); Losartan (DUP753/MK954, DuPont Merck Pharmaceutical Company); Remikirin (RO42-5892, F. Hoffman LaRoche AG); A<sub>2</sub> agonists (Marion Merrill Dow) and certain non-peptide heterocycles (G.D.Searle and Company).

ACE inhibitors include amino acids and derivatives thereof, peptides, including di- and tri- peptides and antibodies to ACE which intervene in the renin-angiotensin system by inhibiting the activity of ACE thereby reducing or eliminating the formation of pressor substance angiotensin II. ACE inhibitors have been used medically to treat hypertension, congestive heart failure, myocardial infarction and renal disease. Classes of compounds known to be useful as ACE inhibitors include acylmercapto and mercaptoalkanoyl prolines such as captopril (US Patent Number 4,105,776) and zofenopril (US Patent Number 4,316,906), carboxyalkyl dipeptides such as enalapril (US Patent Number 4,374,829), lisinopril (US Patent Number 4,374,829), quinapril (US Patent Number 4,344,949), ramipril (US Patent Number 4,587,258), and perindopril (US Patent Number 4,508,729), carboxyalkyl dipeptide mimics such as cilazapril (US Patent Number 4,512,924) and benazapril (US Patent Number 4,410,520), phosphinylalkanoyl prolines such as fosinopril (US Patent Number 4,337,201) and trandolopril.

- 16 -

In some embodiments, the subject is administered HMG-CoA reductase inhibitors. Examples include, but are not limited to, simvastatin (U.S. Patent No. 4, 444,784), lovastatin (U.S. Patent No. 4,231,938), pravastatin sodium (U.S. Patent No. 4,346,227), fluvastatin (U.S. Patent No. 4,739,073), atorvastatin (U.S. Patent No. 5,273,995), cerivastatin, and numerous others described in U.S. Patent No. 5,622,985, U.S. Patent No. 5,135,935, U.S. Patent No. 5,356,896, U.S. Patent No. 4,920,109, U.S. Patent No. 5,286,895, U.S. Patent No. 5,262,435, U.S. Patent No. 5,260,332, U.S. Patent No. 5,317,031, U.S. Patent No. 5,283,256, U.S. Patent No. 5,256,689, U.S. Patent No. 5,182,298, U.S. Patent No. 5,369,125, U.S. Patent No. 5,302,604, U.S. Patent No. 5,166,171, U.S. Patent No. 5,202,327, U.S. Patent No. 5,276,021, U.S. Patent No. 5,196,440, U.S. Patent No. 5,091,386, U.S. Patent No. 5,091,378, U.S. Patent No. 4,904,646, U.S. Patent No. 5,385,932, U.S. Patent No. 5,250,435, U.S. Patent No. 5,132,312, U.S. Patent No. 5,130,306, U.S. Patent No. 5,116,870, U.S. Patent No. 5,112,857, U.S. Patent No. 5,102,911, U.S. Patent No. 5,098,931, U.S. Patent No. 5,081,136, U.S. Patent No. 5,025,000, U.S. Patent No. 5,021,453, U.S. Patent No. 5,017,716, U.S. Patent No. 5,001,144, U.S. Patent No. 5,001,128, U.S. Patent No. 4,997,837, U.S. Patent No. 4,996,234, U.S. Patent No. 4,994,494, U.S. Patent No. 4,992,429, U.S. Patent No. 4,970,231, U.S. Patent No. 4,968,693, U.S. Patent No. 4,963,538, U.S. Patent No. 4,957,940, U.S. Patent No. 4,950,675, U.S. Patent No. 4,946,864, U.S. Patent No. 4,946,860, U.S. Patent No. 4,940,800, U.S. Patent No. 4,940,727, U.S. Patent No. 4,939,143, U.S. Patent No. 4,929,620, U.S. Patent No. 4,923,861, U.S. Patent No. 4,906,657, U.S. Patent No. 4,906,624 and U.S. Patent No. 4,897,402, the disclosures of which patents are incorporated herein by reference.

It is to be understood that the invention contemplates the use of one or more of any of the foregoing agents in combination with RIC of the invention.

### ***RIC***

As used herein, a RIC regimen is at least one cycle of an induced transient ischemic event followed by a reperfusion event. Typically, these regimens are performed by restricting blood flow in a limb or a peripheral tissue of the subject and then removing the blood flow restriction and allowing blood to reperfuse the limb or tissue. A regimen may

- 17 -

comprise a single cycle or multiple cycles, including 2, 3, 4, 5, or more cycles. In one important embodiment, a regimen comprises 4 cycles of ischemia and reperfusion.

The blood flow restriction typically takes the form of an applied pressure to the limb or tissue that occludes blood flow. The applied pressure to the limb or tissue may be above systolic pressure (i.e., supra-systolic pressure). It may be about 5, about 10, about 15, about 20, or more mmHg above (or greater than) systolic pressure. Since systolic pressure will differ between subjects, the absolute pressure needed to induce ischemia will vary between subjects. In other embodiments, the pressure may be preset at, for example, 200 mmHg. In some embodiments, the applied pressure is less than systolic pressure provided blood flow is occluded. It is to be understood that, as used herein, blood flow occlusion refers to cessation of blood flow. As described herein, such blood flow occlusion or cessation occurs in a region of the body that is remote from a site of injury or one or more organs being protected from such injury. For example, blood flow occlusion or cessation may occur in a lower limb and/or an upper limb.

The blood flow restriction or occlusion may be accomplished using any method as the invention is not limited in this regard. Typically, it may be accomplished with an inflatable cuff, although a tourniquet system is also suitable. Further examples of automated devices for performing RIC are described below.

The induced ischemic event is transient. That is, it may have a duration of about 1, about 2, about 3, about 4, about 5, or more minutes. Similarly, the reperfusion event may have a duration of about 1, about 2, about 3, about 4, about 5, or more minutes.

If performed using a limb, the upper limb or lower limb may be used. In some instances the upper limb is preferred. In some instances the lower limb is preferred. In some instances, RIC is performed on two different sites on the body, in an overlapping or simultaneous manner.

RIC may be performed using any device provided it is capable of inducing transient ischemia and reperfusion, whether manually or automatically.

In one of its simplest forms, the method may be carried out using a sphygmomanometer (i.e., the instrument typically used to measure a subject's blood pressure). The cuff of the sphygmomanometer is placed about a subject's limb (e.g., an arm or leg) and is inflated to a pressure great enough to occlude blood flow through the limb (i.e., a pressure greater than the subject's systolic blood pressure). The cuff is maintained in

- 18 -

the inflated state to prevent blood flow through the limb for a specified period of time, referred to herein as the ischemic duration. After the ischemic duration, pressure is released from the cuff to allow reperfusion of blood through the limb for a period of time that is referred to herein as the reperfusion duration. The cuff is then re-inflated and the procedure is immediately repeated a number of times.

The method may similarly be carried out using a manual type tourniquet. Devices such as those described in published PCT application WO 83/00995 and in published US application 20060058717 may also be used.

Another system that may be used is described in published US application 20080139949. The advantage of this system is that it can be used independently of a medical practitioner, and that it automatically induces the required RIC regimen. This system is exemplified in part in FIG. 1, which illustrates a cuff 10, an actuator 12, a controller 14 and a user interface 16. The cuff is configured to be placed about the limb 15 of a subject, such as an arm or leg of the subject. The actuator, when actuated, causes the cuff to retract about the limb to occlude blood flow through the limb. The controller executes a protocol that comprises repeating a cycle one or more times. The cycle itself includes actuating the cuff to prevent blood flow, maintaining the cuff in an actuated state for an ischemic duration, releasing the cuff, and maintaining the cuff in a relaxed state to allow reperfusion.

FIG. 2 shows a block diagram that represents a scheme that may be used to perform RIC. The scheme begins with placement of a cuff about a subject's limb. The system is then activated and the protocol is initiated through the controller. In one embodiment, the system is activated by a medical professional. In another embodiment, the system may be activated by the subject. The cuff contracts to apply an initial pressure, greater than systolic pressure, to the subject's limb. As discussed herein, the initial pressure may be a default value of the system or may be programmed into a particular protocol. The cuff then deflates to identify the subject's systolic pressure. This may be accompanied by monitoring the subject for the onset of Korotkoff sounds or vibrations. Alternatively or additionally, a distal remote sensor (e.g., a device on the fingertip which is sensitive to the presence or absence of flow or maintenance of flow) may be used. Once systolic pressure has been identified, the system initiates the first cycle of the protocol. In some embodiments, systolic

- 19 -

pressure may be identified as an initial portion of the protocol. As used herein, the terms protocol and regimen are used interchangeably.

The cycle begins as the cuff contracts to apply a target pressure, greater than the subject's systolic pressure by an amount defined in the protocol, to the subject's limb. This occludes blood flow through the subject's limb. The external pressure against the subject's limb is held for an ischemic duration defined in the protocol. The system monitors the subject during the ischemic duration for pressure release criteria, which may include system power failure, system power spikes, and manual activation of quick release mechanism. The system also monitors the subject during the ischemic duration for any signs of reperfusion through the subject's limb, and accordingly, increases the external pressure applied by the cuff to prevent such reperfusion. Signs of reperfusion can include the onset of Korotkoff sounds or vibrations. After passage of the ischemic duration, the cuff releases pressure from about the subject's limb to allow reperfusion. Reperfusion is allowed for a reperfusion duration defined in the cycle.

The initial cycle typically concludes after the reperfusion duration. At this time, a subsequent cycle may begin as the cuff is actuated to contract about the subject's limb to occlude blood flow through the limb for another ischemic duration.

The cuff illustrated in FIG. 1 is configured to be positioned about the limb of a subject and to contract about the limb when actuated. In one embodiment, the sleeve is wrapped about a subject's upper arm, calf, or thigh and is fastened snugly in place. Portions of the cuff may include hook and loop type material that can be used to fasten the sleeve in place about the subject's limb. The actuator inflates the cuff such that the limb is constricted to the point of occluding blood flow through the subject's limb.

The illustrated cuff includes an inflatable bladder (not shown) that receives a fluid, such as air, to cause the cuff expand and retract about a subject's limb. The bladder is constructed of an air impermeable material, such as flexible plastic or rubber. A connection port 18 is present at one end of the bladder to allow air to enter the bladder during inflation, or to exit the bladder during deflation. The port may include engagement features to facilitate a connection to the actuator, such as by an air hose. These features may include threads, clips, and the like. Although the illustrated embodiment includes a single bladder positioned within a cuff, it is to be appreciated that other embodiments are also possible. By way of example, according to some embodiments, the fabric sleeve may itself be air

- 20 -

impermeable, such that no separate bladder is required. In other embodiments, multiple, separate inflatable bladders may be incorporated into a common sleeve, as aspects of the present invention are not limited in this respect.

The general size of subjects that undergo RIC may vary greatly, particularly given the range of species to which the methods may be applied. Given this variance, it may be desirable for some embodiments of cuffs to be adjustable over a wide range to accommodate the variety of subject limb girths that may be expected. According to some embodiments, the cuff comprises an inflatable fabric sleeve having a length greater than three feet, such that a girth of up to three feet may be accommodated. Embodiments of cuffs may include a width as small as two inches, one inch, or even smaller, so as to accommodate the upper arm or leg of a much smaller subject, including a neonatal infant. It is to be appreciated, however, that other embodiments may be configured to encircle a much smaller range of limb sizes, as aspects of the present invention are not limited in this regard.

Various devices may be used as an actuator to constrict the cuff about a subject's limb, or to release the cuff. As illustrated in embodiment of FIG. 1, the actuator includes a pneumatic pump to provide pressurized air to an inflatable cuff through an air hose. The actuator also includes a release valve 20 that, when actuated, opens a passageway between the inflatable cuff and the external environment to allow pressurized air to escape from the cuff, so that the cuff loosens about the subject's limb.

The air pump can comprise any device capable of delivering compressed air. According to some embodiments, the air pump includes a piston compressor, although other types of pumps, like centrifugal pumps and scroll compressor may also be used. The pump may be configured to provide air flow at a rate of between 0.1 to 20 cubic feet per minute, with a head pressure of up to 50 psi, according to some embodiments. However, other flow rates and/or pressures are possible, as aspects of the invention are not limited in this respect.

The device may therefore comprise or be suited for use with a compressed air canister or cartridge. Pressurized gas (e.g., air) can then be used to inflate the band, thereby constricting the limb. In certain situations, including situations in which traumatic injury is common or likely (e.g., on a battlefield), the use of compressed gas may be more suitable than other inflation or constriction mechanisms. As an example, compressed gas canisters or cartridges are less likely to become clogged or otherwise fouled by debris that may be encountered (e.g., such as mud, dirt, water, etc. that exists in battlefield environments).

- 21 -

As discussed above, the actuator may also include a release mechanism to release a cuff from about the subject's limb. In the illustrated embodiment, the release comprises a release valve 20 that is positioned within the controller housing. The release valve, as shown, may be a solenoid that moves rapidly between fully closed and fully open positions to rapidly release air from the cuff and, in turn, to rapidly release the cuff from a subject. According to some embodiments, the same release valve or another release valve may also be actuated to open slowly, such as to adjust the pressure of the cuff or to allow a more controlled release of pressure such as may be required when the subject's blood pressure is measured.

Embodiments of the system may include safety features to allow rapid release of the cuff from a subject's limb. Moreover, some of these embodiments may be readily activated by a subject, such as when the subject feels discomfort. In one embodiment, the safety release 22 includes a large button positioned on or near the cuff. In this regard, the safety release is within reach of the subject. In other embodiments, the safety release may comprise a separate actuator, such as one that may be held in the free hand of the subject. Activating the safety release may cause the release valve of a pneumatic cuff to open, thereby allowing rapid removal of air from the cuff.

The system may also include a continually operating, cuff release mechanism. By way of example, a slow release valve may be incorporated into a pneumatic cuff to provide for a continual, slow release of pressurized air from the cuff. The continual slow release mechanism may provide for the safe release of a subject's limb, even in the face of power failures or other events that may prevent redundant safety features from operating properly. Similar type mechanism may be incorporated into embodiments that do not utilize a pneumatically inflatable cuff, as continual slow release mechanisms are not limited to pneumatic cuffs.

Embodiments of the system include a controller that receives information from a protocol and any other sensors in the system to, in turn, control the actuator to perform RIC. The controller and protocol combination may be implemented in any of numerous ways. For example, in one embodiment the controller and protocol combination may be implemented using hardware, software or a combination thereof. When implemented in software, the software code can be executed on any suitable processor or collection of processors, whether provided in a single computer or distributed among multiple computers.

- 22 -

It should be appreciated that any component or collection of components that perform the functions described herein can be generically considered as one or more controllers that control the functions discussed herein. The one or more controllers can be implemented in numerous ways, such as with dedicated hardware, or with general purpose hardware (e.g., one or more processors) that is programmed using microcode or software to perform the functions recited above. The one or more controllers may be included in one or more host computers, one or more storage systems, or any other type of computer that may include one or more storage devices coupled to the one or more controllers. In one embodiment, the controller includes a communication link to communicate wirelessly, or via electrical or optical cable, to a remote location.

In this respect, it should be appreciated that one implementation of the embodiments of the present invention comprises at least one computer-readable medium (e.g., a computer memory, a floppy disk, a compact disk, a tape, etc.) encoded with a protocol in the form of a computer program (i.e., a plurality of instructions), which, when executed by the controller, performs the herein-discussed functions of the embodiments of the present invention. The computer-readable medium can be transportable such that the protocol stored thereon can be loaded onto any computer system resource to implement the aspects of the present invention discussed herein. In addition, it should be appreciated that the reference to a protocol or controller which, when executed, performs the herein-discussed functions, is not limited to an application program running on a host computer. Rather, the term protocol is used herein in a generic sense to reference any type of computer code (e.g., software or microcode) that can be employed to program a processor to implement the herein-discussed aspects of the present invention.

The system may also comprise one or more sensors 26 that receive information from the subject and/or portions of the system itself. Such sensors may receive information regarding blood flow in any portion of the subject, including the limb that is being treated. These sensors may also receive information regarding other operating parameters of the system, such as air pressure within a pneumatic cuff, direct readings of pressure applied by cuff, or tension within portions of a tension band.

Pneumatic cuffs may include a sensor to measure pressure within the cuff. Cuff pressure is often directly indicative of the pressure that exists within a blood vessel of the limb beneath the cuff. The controller of a system is often programmed to target a particular



- 23 -

cuff pressure that is to be maintained during the ischemic duration of a cycle, as is discussed herein. In embodiments that include a pneumatic cuff, the pressure sensor may be positioned anywhere within the pressurized space of the cuff, the air hose, or even within the actuator itself. Pressure sensors may also be positioned on an inner surface of the cuff to directly measure the pressure between the cuff and an outer surface of the subject's limb. In use, the cuff may be oriented such that the pressure sensor is positioned directly above the subject's artery, so as to provide a more direct measurement of pressure at a blood vessel of interest.

In one embodiment, systems may also include one or more vibration and/or ultrasonic sensors 28 to identify Korotkoff sounds. Korotkoff sounds are generally understood to be present when pressures between systolic and diastolic are externally applied to the artery of a subject. Systolic pressure is associated with a pressure value that completely occludes blood flow through a subject's blood vessels, and in this regard, may be used by the system as feedback to identify when pressure in the system is low enough to allow blood flow, or high enough to occlude blood flow.

One or more sensors may be included to confirm the cessation of blood flow or reperfusion in the limb that receives the cuff. For instance, in some embodiments, a pulse oximeter 30 may be positioned on a distal portion of the limb that receives the cuff, such as on a finger or toe of the limb. The pulse oximeter can provide information regarding blood pulsing through the subject's blood vessels and the percentage of haemoglobin that is saturated with oxygen. The pulse oximeter will detect an absence of pulses when blood flow through a limb is not occurring to confirm the occlusion of blood flow. Moreover, the pulse oximeter may also detect the percentage of haemoglobin saturated with oxygen, which will drop as blood flow through the limb ceases. It is to be appreciated that other sensors may also be used to confirm the cessation of blood flow, such as a photoplethysmographic transducer, an ultrasonic flow transducer, a temperature transducer, an infrared detector, and a near infrared transducer, as aspects of the invention are not limited in this respect.

As mentioned above, the system includes a protocol that, through the controller, directs the operation of the system. Embodiments of the protocol include a cycle that comprises cuff actuation, an ischemic duration, cuff release, and a reperfusion duration. In many embodiments of protocols, the cycle may be repeated multiple times. Additionally, some embodiments of the protocol include systolic pressure identification.

- 24 -

The cuff actuation portion of the cycle comprises contracting the cuff about the limb of a subject to occlude blood flow through the limb. Contraction of the cuff is accomplished by the controller reading instructions from the protocol, such as a target set point for cuff pressure, and then by the initiating the controller to bring the cuff to the target set point. Attainment of the target set point may be sensed through any of the herein described sensors and techniques.

During the ischemic phase of the cycle, pressure is maintained about the subject's limb to prevent reperfusion of blood flow through the limb. The length of the ischemic phase, termed the ischemic duration, is typically defined by a doctor, or other medical professional, and is programmed into the protocol. Ischemic duration may be as short as a few seconds, or as long as 20 minutes, or even longer, as aspects of the invention are not limited in this regard. In some embodiments, the ischemic duration varies from cycle to cycle during the same protocol, although in other embodiments, the ischemic duration remains constant.

The controller acts to maintain pressure, applied by the cuff, at a set point above the subject's systolic pressure. Embodiments of the cuff may relax relative to the subject's limb over time, thereby reducing pressure and eventually allowing reperfusion. This may be caused by various factors, including relaxation of muscles in the subject's limb, stretching of the cuff about the limb, air leaks (intentional or unintentional), and the like. To this end, a sensor may provide pressure readings as feedback to the controller. The controller can measure any difference between the set point and the actual pressure reading and can provide any necessary commands to the actuator to compensate for errors.

Various approaches may be used to define an appropriate set point for the controller during the ischemic duration. According to one embodiment, the set point is manually entered into the protocol by the doctor (or other medical professional). Alternately, the doctor may select a set point in terms of the subject's systolic blood pressure. In one embodiment, the set point may be selected as a fixed pressure amount over the subject's systolic blood pressure, such as 5 mmHg, 10 mmHg, 15 mmHg, 20 mmHg, 25 mmHg, 30 mmHg, or any other fixed amount above systolic pressure of the subject. In other embodiments, the set point may be defined as a percentage of the subject's systolic blood pressure, such as 102% of systolic, 105%, 110%, 115%, and other percentages, as aspects of the invention are not limited in this respect. The point above systolic pressure may be set

- 25 -

by the medical professional and may be dependent upon several factors including, but not limited to the size of the subject, the size of the subject's limb, the subject's blood pressure, confirmation of blood flow cessation, and the like. In still other embodiments, the pressure may be set below systolic pressure, such as but not limited to 95%, 96%, 97%, 98%, or 99% of systolic pressure, provided that blood flow is occluded at such pressure, as may be achieved by varying cuff parameters.

The protocol, according to some embodiments, includes phases to identify the subject's systolic blood pressure. The cuff may be allowed to loosen about the subject's limb, from a point believed to be above systolic pressure, in a systematic manner while sensors are monitoring the limb for the onset of Korotkoff sounds or vibrations. Once the systolic pressure is identified, the protocol may continue in the normal course.

Identification of systolic pressure may optionally occur at any time during a protocol, or not at all. According to some embodiments, each cycle begins with the identification of the subject's systolic blood pressure. In other embodiments, systolic pressure may be identified only once during an initial portion of the protocol. In still other embodiments, systolic pressure may be identified as the cuff is released during the cuff release portion of each cycle. Still, as discuss herein, systolic pressure may not be identified at all during a protocol, as aspects of the invention are not limited in this regard.

The system can be configured to adjust the pressure set point during the ischemic duration. As discussed herein, the system may include sensors that detect the onset of reperfusion. As an example, this may be accomplished by detecting the presence of Korotkoff sounds or vibrations. The presence of Korotkoff sounds during an ischemic duration can indicate that either cuff pressure has fallen below systolic or that systolic pressure has risen above the set point that was previously above systolic pressure. Other devices may additionally or alternatively be used including for example devices on digits that detect the presence or absence of flow. In such a situation, the controller may adjust the set point based on the newly identified systolic pressure and/or other information and in this regard, can identify and prevent unwanted reperfusion that might otherwise occur.

The cuff release portion of a cycle occurs at the end of the ischemic duration and includes release of the cuff to a point below diastolic pressure. According to some embodiments, cuff release comprises releasing the pressure or tension of the cuff. In embodiments that utilize a pneumatic cuff, this may simply be associated with moving an

- 26 -

air release valve to the fully open position to allow a rapid reduction in cuff pressure and a corresponding rapid relaxation of the cuff about the subject's limb. However, it is to be appreciated, that in other embodiments, that cuff relaxation may occur in a slower, more controlled manner, as aspects of the invention are not limited in this respect. Additionally, as discussed herein, the cuff release may be accompanied by monitoring for the onset of Korotkoff sounds or vibrations to identify or confirm the systolic pressure of the subject.

The reperfusion duration follows the cuff release in embodiments of the cycle. Reperfusion through the limb is allowed for a period of time termed the reperfusion duration. Much like the ischemic duration, reperfusion may be allowed for varied lengths of time, as short as a five seconds, one minute or more, and as long as 20 minutes, or even longer. The reperfusion duration may remain constant from cycle to cycle during a common protocol, or may vary between each cycle, as aspects of the invention are not limited in this respect.

The protocol may comprise any number of cycles. As discussed herein, a common cycle may simply be repeated a plurality of times, such as two, three, four, or more times, to complete a protocol. Alternately, the cycles of a protocol may be programmed with different parameters, such as different ischemic durations, reperfusion durations, pressure set points during the ischemic duration, and the like.

In some embodiments, the system may include a data logging feature that records the system parameters, such as cuff pressure or tension, during all phases of a protocol. Date of time of operation may also be recorded. Other features, such as personal information to identify the subject, may also be recorded by the system.

Embodiments of the system may incorporate various features to inform the subject or medical professional about the progress of the protocol. Audible or visual indicators may accompany any of the phases of the protocol. By way of example, a clock may show either the amount of time that has elapsed or that remains for a given portion of the protocol or the entire protocol. Embodiments may also include other features to keep the subject and/or medical professional informed, as aspects of the invention are not limited in this regard.

According to some embodiments, the system includes features to prevent tampering or accidental reprogramming by a subject. By way of example, in some embodiments, the reprogrammable features may only be accessed after entering a code. This can prevent a subject from mistakenly reprogramming the protocol or otherwise interfering with the

- 27 -

operation of the system. It is to be appreciated that other devices may also be used to prevent accidental reprogramming, such as electronic keys, mechanical locks and the like.

The system may be configured for use in a variety of environments. By way of example, the system may be mounted on a portable stand with casters to facilitate easy movement. The stand may position the controller, user interface, and connections to the cuff at a convenient height for the subject. In other embodiments, the system is configured for portable use. In such embodiments, the system may be configured for ready placement into a suitcase for easy transport.

The system is also not limited to components illustrated in the embodiment of FIG. 1. By way of example, according to other embodiments, like that illustrated in FIG. 3, cuffs may be configured to constrict a subject's limb through alternative mechanisms. In the illustrated embodiment, the cuff is configured as a band having a ratcheting mechanism positioned at one end. In use, the band is wrapped about the limb of a subject with the free end of the band passing through the ratcheting mechanism. In such an embodiment, the actuator may comprise a mechanism that pulls the free end of the band further through the ratcheting mechanism to retract the cuff about the limb, or that frees the ratcheting mechanism to release the band to, in turn, release the band from the limb. Still other mechanisms, such as tourniquet mechanisms, are possible, as aspects of the invention are not limited in this respect.

As described above with reference to FIG. 3, some embodiments may have a cuff that comprises a band that does not inflate, but rather is tightened about a subject's limb by another mechanism. In such embodiments, the actuator may comprise a tensioning mechanism configured to move one end of the band relative to other portions of the band so as to place the band in tension. As shown, the mechanism can include opposed rollers held in close proximity to one another within a housing. The housing includes a slot for receiving a free end of the band and a fixation point for fixed attachment to the opposite end of the band. The free end of the band is passed into the slot and between the rollers. The rollers may be mechanically actuated to rotate relative to one another, such as by an electric motor, to pull the free end through the housing and thus tighten the band around a subject's limb.

The tensioning mechanism may include opposed rollers mounted on a ratcheting, free wheel mechanism. The freewheel mechanism allows the band to be pulled through the

- 28 -

slot in one direction with minimal resistance so that the band may be pulled rapidly to a snug position about a subject's limb. The free wheel mechanism also prevents the band from moving through the slot in the loosening direction, unless the mechanism is released or the opposed rollers are actuated. It is to be appreciated that not all embodiments will include a free wheel mechanism, as aspects of the invention are not limited in this regard.

The opposed rollers rotate in either direction to tighten and loosen the band during use. When required, the rollers may rapidly rotate until the band achieves a particular tension. The rollers may further be actuated to make minor adjustments to the tension in the band during use. When the cuff is to be released from the subject's limb, a ratcheting mechanism or clutch may be released such that the opposed rollers are allowed to move freely, thus rapidly releasing tension.

The invention contemplates the placement of a cuff or cuff-containing device such as those described herein within a garment, including but not limited to a military uniform. The cuff may be placed in a pant or leg portion or in the sleeve or arm portion of the garment. The garment may be designed such that the wearer is able to initiate one or more cycles of blood flow occlusion and reperfusion. The device may be capable of remote operation in the event that the wearer is unable to initiate the occlusion/reperfusion cycles.

Aspects of the invention are not limited to the embodiments of cuffs illustrated herein.

#### EXAMPLES

Resuscitated hemorrhagic shock following trauma is known to contribute to the development of late organ dysfunction in those who survive the initial trauma insult and thus contributes to morbidity and mortality in this patient population. A number of mechanisms have been implicated in this process, but the activation of proinflammatory signaling cascades leading to cellular death directly via apoptotic pathways or alternatively through priming of the innate immune cell system have been shown to be contributory. Strategies directed at preventing the onset of these pathways would clearly have potential benefit in reducing attendant morbidity and mortality related to organ injury.

Remote ischemic conditioning (RIC), a process whereby distant vascular beds are temporarily rendered ischemic, protects organs from the effects of ischemia/reperfusion (I/R) injury. For example, transient remote vascular occlusion has been shown to be

- 29 -

protective of I/R injury in the heart, liver, lung, intestine and kidney. This Example shows the effect of RIC on end organ injury, particularly in the lung and liver, following hemorrhagic shock.

***Materials and Methods:***

*Animal model of hemorrhagic shock (HS).* Animals were cared for in accordance with the guidelines set forth by the Canadian Council on Animal Care. C57Bl/6 mice weighing 20 to 30g (Charles River, St Constant, Quebec) were anaesthetized with intra-peritoneal ketamine (200mg/kg) and xylazine (10mg/kg). The right femoral artery was cannulated for hemorrhagic shock and resuscitation. Hemorrhagic shock was initiated by blood withdrawal equivalent to 20% of blood volume (22.5 mL of blood/kg) over 15 mins as previously reported. To prevent clotting, shed blood was collected in the presence of 3.8% Na-citrate. After a hypotensive period of 1-10 mins or 60 mins, animals were resuscitated by transfusion of the shed blood plus an equal volume of Ringer's Lactate using a timed-delivery pump system. Total resuscitation time was standardized to two hours. Sham animals were instrumented but not bled. Finally, animals were sacrificed at the end of the resuscitation period by pentobarbital overdose.

At the end of the resuscitation period (t=0) and at t=2, 4 and 6h later, a tracheostomy was performed and alveolar cells were recovered by bronchoalveolar lavage (BAL). In some studies, cell count and differential were performed following Giemsa staining and in other studies lung were harvested for histopathology and determination of wet/dry ratios as a measure of lung injury. Cells recovered from BAL at the end of a resuscitation period have been reported to exhibit a primed phenotype (Rizoli et al. J Immunol 161(11):6288-6296, 1998). Cells recovered at t=0 following resuscitated HS were plated and then stimulated in vitro with LPS (100 ng/ml). Supernatants were recovered for measurement of TNF- $\alpha$  by ELISA. In some experiments, the pelleted cells were re-suspended in serum-free DMEM and processed for immunofluorescence staining or flow cytometry analysis. Primed cells have also been reported to exhibit augmented Toll-like receptor 4 on their plasma membrane as a measure of priming (Powers et al. J Exp Med 193(8):1951-1961, 2006).

Serum alanine aminotransferase (ALT) levels, an indicator of hepatocellular injury, were measured in blood samples obtained at different times after the end of the resuscitation

- 30 -

period. Measurements of ALT were made using BIOTRON Diagnostic Kits. Liver tissue was fixed by immersion in formaldehyde, embedded by paraffin wax, and then cut in 5  $\mu$ m slices. Sections were evaluated by light microscopy following staining by haematoxylin and eosin. TUNEL staining for apoptotic nuclei was detected in dewaxed sections using the DeadEnd Fluorometric TUNEL Kit (Promega Corp).

*RIC Protocol.* Animals were subjected to unilateral hindlimb ischemia (or sham operation) using an elastic band around the thigh for varying times and then released for an equivalent time prior to initiation of hemorrhagic shock. Animals were subjected to 10 min of ischemia followed by 10 min of reperfusion.

*Statistical Analysis.* The data are presented as mean  $\pm$  standard error of n determinations as indicated in the Figure legends. Data were analyzed by one-way analysis of variance, and Newman-Keuls Multiple Comparison Test post-hoc using the Prism software (GraphPad, San Diego, CA). Results were considered significant when  $p \leq 0.05$ . Significance is indicated with an asterisk.

### **Results:**

FIG. 4 shows the effect of RIC on shock-resuscitation induced liver damage as indicated by ALT levels in the treated subjects. FIG. 4A shows the results from individual subjects while FIG. 4B shows the results as the mean  $\pm$  standard error. The animals were divided into five groups as follows:

- (i) basal, in which animals were treated as described above for sham;
- (ii) S/R – 0', in which animals were subjected to shock (15 mins of blood withdrawal) and then resuscitated within 0-10 minutes;
- (iii) S/R – 0' + Hind Limb, in which animals were ischemically conditioned prior to shock, then subjected to shock, and then resuscitated within 1-10 minutes;
- (iv) S/R – 1 HR, in which animals were subjected to shock and then resuscitated 60 minutes later; and
- (v) S/R – 1 HR + Hind Limb, in which animals were ischemically conditioned prior to shock, then subjected to shock, and then resuscitated 60 minutes later.

FIG. 4 shows that, on average, RIC prevents liver damage, as measured by ALT levels, in subjects that have experienced hemorrhagic shock. RIC reduces and/or prevents



- 31 -

liver damage in subjects that receive resuscitation therapy immediately following shock and in subjects that receive delayed resuscitation therapy.

FIG. 5 shows the effect of RIC on shock-resuscitation induced TNF- $\alpha$  serum levels. TNF- $\alpha$  is a mediator of systemic inflammation and can be used as an indicator of liver damage. FIG. 5A shows the results from individual subjects while FIG. 5B shows the results as the mean  $\pm$  standard error. The animals were divided into five groups as described above for FIG. 4.

FIG. 5 shows that RIC prevents the induction of TNF- $\alpha$  levels following shock and resuscitation. In subjects that received RIC and were resuscitated within 0-10 minutes of shock, serum TNF- $\alpha$  was undetectable, as compared to an average level of 6.9 pg/ml in subjects that did not receive RIC. In subjects that received RIC and were resuscitated 60 minutes after shock, serum TNF- $\alpha$  level was reduced almost 25 fold, on average, as compared to subjects that did not receive RIC. The level of serum TNF- $\alpha$  in subjects receiving RIC and delayed resuscitation more closely resembled that of sham (untreated) subjects.

Accordingly, the data show that RIC reduces or prevents injury resulting from shock, whether the subjects receive immediate or delayed resuscitation therapy.

#### ***Conclusion:***

RIC represents a safe and effective approach to minimizing organ injury in subjects at risk for hemorrhagic shock. These findings have relevance to the preoperative surgical setting as well as civilian and military trauma injury.

The foregoing written specification is considered to be sufficient to enable one ordinarily skilled in the art to practice the invention. The present invention is not to be limited in scope by examples provided, since the examples are intended as mere illustrations of one or more aspects of the invention. Other functionally equivalent embodiments are considered within the scope of the invention. Various modifications of the invention in addition to those shown and described herein will become apparent to those skilled in the art from the foregoing description. Each of the limitations of the invention can encompass various embodiments of the invention. It is, therefore, anticipated that each of the limitations of the invention involving any one element or combinations of elements can be

- 32 -

included in each aspect of the invention. This invention is not limited in its application to the details of construction and the arrangement of components set forth or illustrated in the drawings. The invention is capable of other embodiments and of being practiced or of being carried out in various ways.

Also, the phraseology and terminology used herein is for the purpose of description and should not be regarded as limiting. The use of “including”, “comprising”, or “having”, “containing”, “involving”, and variations thereof herein, is meant to encompass the items listed thereafter and equivalents thereof as well as additional items.

What is claimed is:

**CLAIMS**

1. A method for treating a subject experiencing, or likely to experience, hypovolemia caused by a traumatic injury to protect an organ of the subject from effects associated with hypovolemia, comprising:  
performing non-invasive, individual or repeated remote ischemic conditioning (RIC) regimens on a subject experiencing or likely to experience hypovolemia caused by a traumatic injury, before performance of resuscitation therapy, wherein the RIC regimens are performed on a limb of the subject remote from the organ and wherein each RIC regimen comprises two or more cycles of blood flow occlusion followed by reperfusion, wherein each cycle of blood flow occlusion has a duration of one minute or more and wherein each subsequent cycle begins upon conclusion of reperfusion of a previous cycle.
2. The method of claim 1, wherein repeated RIC regimens comprise more than one RIC regimen performed on a single day.
3. The method of claim 2, wherein repeated RIC regimens comprise two, three, four or five RIC regimens performed on a single day.
4. The method of claim 1, wherein repeated RIC regimens comprise one or more RIC regimens on more than one day.
5. The method of claim 1, wherein at least one RIC regimen is performed within 30 minutes or 1 hour of the traumatic injury.
6. The method of claim 1, wherein the RIC regimens are performed before the traumatic injury.
7. The method of claim 1, wherein the RIC regimens are performed before and after the traumatic injury.
8. The method of claim 1, wherein the RIC regimens are performed before, during and after the traumatic injury.

9. The method of claim 1, wherein the RIC regimens are performed during and after the traumatic injury.
10. The method of claim 1, wherein the RIC regimens are performed after the traumatic injury.
11. The method of claim 1, wherein the subject is human.
12. The method of claim 1, wherein at least one RIC regimen comprises at least four cycles, each cycle comprising occlusion and reperfusion.
13. The method of claim 1, wherein at least one RIC regimen comprises one or more cycles of 5 minutes of occlusion and 5 minutes of reperfusion.
14. The method of claim 1, wherein at least one RIC regimen comprises at least four cycles, each cycle comprising supra-systolic pressure and reperfusion.
15. The method of claim 1, wherein at least one RIC regimen comprises one or more cycles of 5 minutes of supra-systolic pressure and 5 minutes of reperfusion.
16. The method of claim 14, wherein the supra-systolic pressure is a pressure that is at least 15 mmHg above systolic pressure.
17. The method of claim 14, wherein the supra-systolic pressure is a pressure that is about 200 mmHg.
18. The method of claim 1, wherein repeated RIC regimens are performed at the same site.

19. The method of claim 1, wherein repeated RIC regimens are performed on an upper limb.
20. The method of claim 1, wherein repeated RIC regimens are performed on a lower limb.
21. The method of claim 1, wherein the subject is hypotensive.
22. A method for treating a subject for systemic effects associated with hypovolemia caused by a traumatic injury to protect one or more organs of the subject, comprising:  
performing two or more cycles of non-invasive remote blood flow occlusion followed by reperfusion on a subject experiencing or likely to experience hypovolemia caused by a traumatic injury, before onset of ischemia and performance of resuscitation therapy, wherein the two or more cycles of non-invasive remote blood flow occlusion followed by reperfusion are performed on a limb of the subject remote from the one or more organs, and wherein each cycle of blood flow occlusion has a duration of one minute or more and wherein each subsequent cycle begins upon conclusion of reperfusion of a previous cycle.
23. The method of claim 22, wherein the remote blood flow occlusion and reperfusion is performed on one or more lower and/or upper limbs.
24. A method for treating a subject who is experiencing or likely to experience hypovolemia and ischemia as a result of a traumatic injury to reduce or prevent systemic effects associated with hypovolemia to protect one or more organs, comprising performing individual or repeated remote ischemic conditioning (RIC) regimens on the subject before onset of ischemia and performance of resuscitation therapy, wherein the RIC regimens are performed on a limb of the subject remote from the one or more organs and wherein each RIC regimen comprises two or more cycles of blood flow occlusion followed by reperfusion, and wherein each cycle of blood flow occlusion has a duration of one minute or more and wherein each subsequent cycle begins upon conclusion of reperfusion of a previous cycle.

25. A method for treating a subject who is hypotensive as a result of a traumatic injury to reduce or prevent systemic effects associated with hypotension to protect one or more organs, comprising performing individual or repeated remote ischemic conditioning (RIC) regimens on the subject before performance of resuscitation therapy, wherein the RIC regimens are performed on a limb of the subject remote from the one or more organs and wherein each RIC regimen comprises two or more cycles of blood flow occlusion followed by reperfusion, and wherein each cycle of blood flow occlusion has a duration of one minute or more and wherein each subsequent cycle begins upon conclusion of reperfusion of a previous cycle.

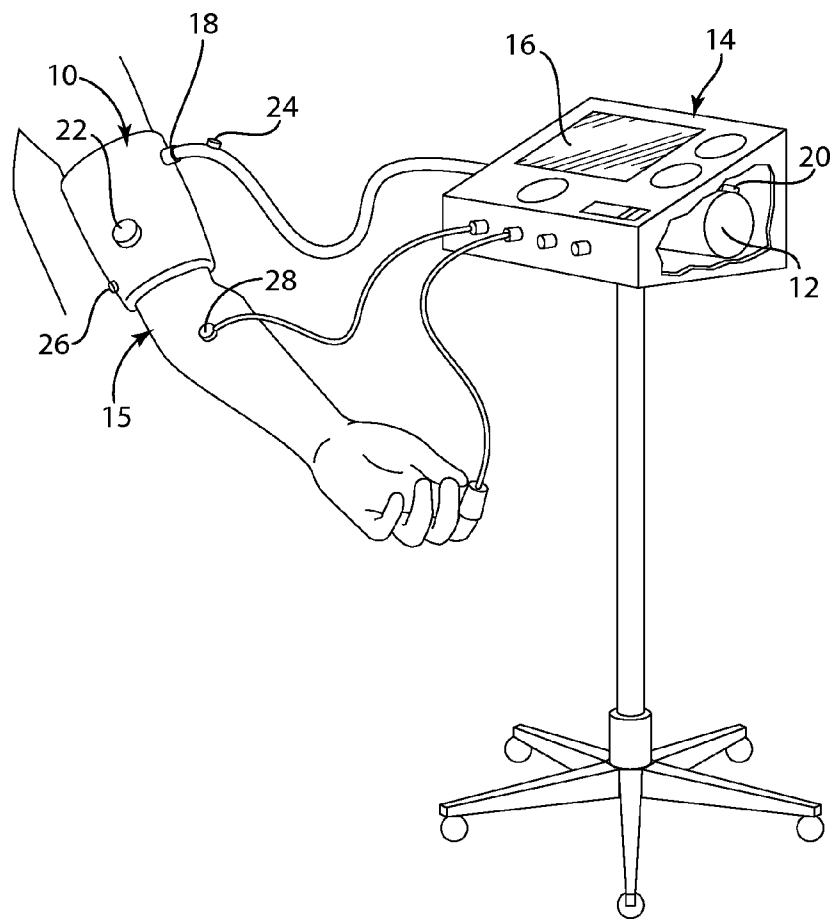

Fig. 1

2/5

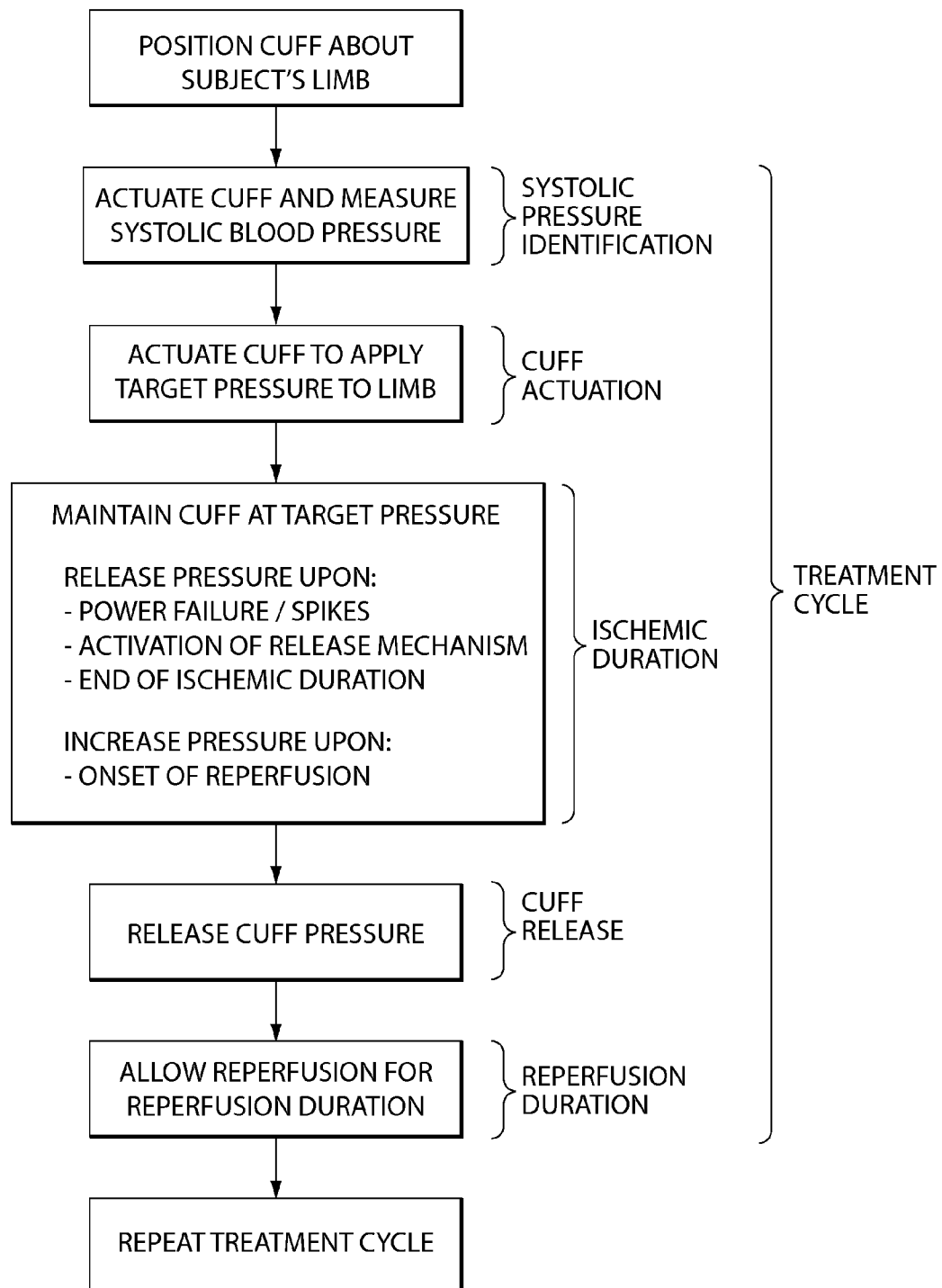

Fig. 2



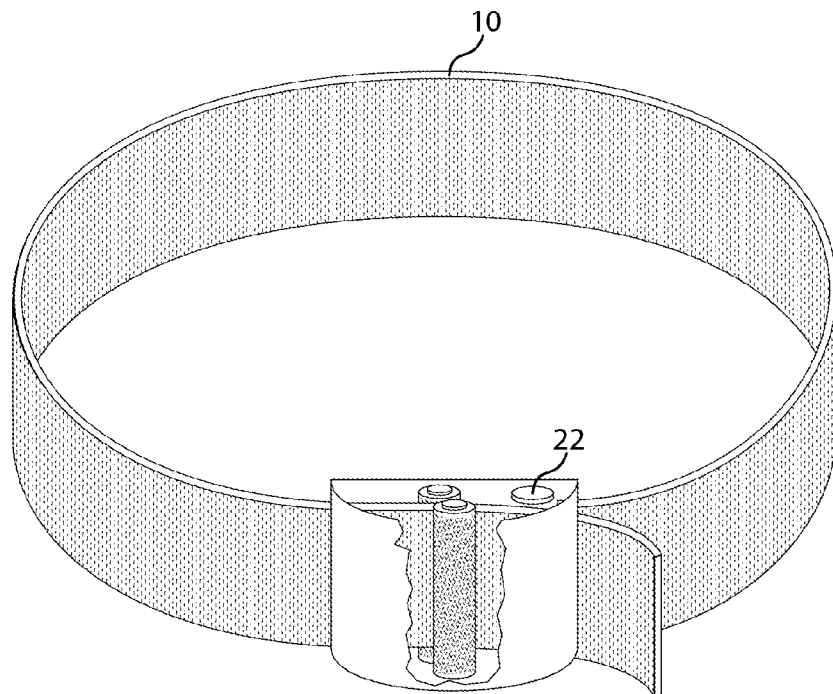

Fig. 3

4/5

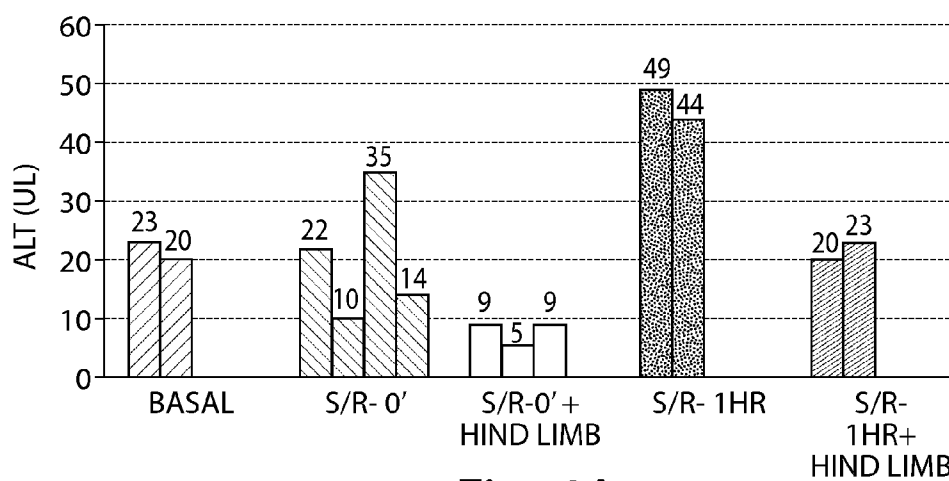

Fig. 4A

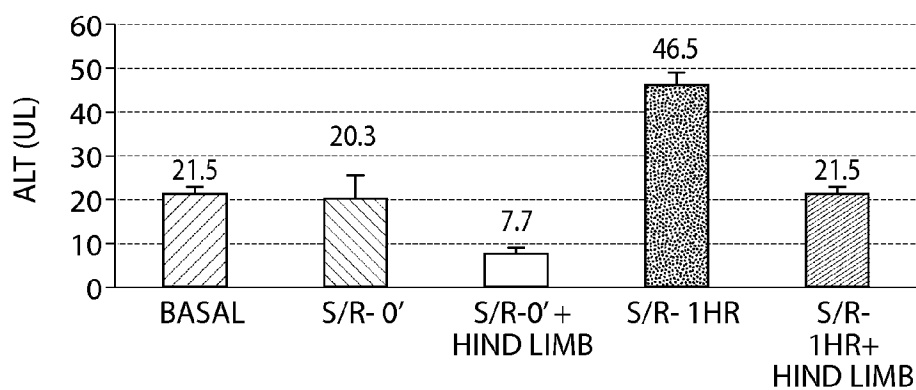

Fig. 4B

5/5

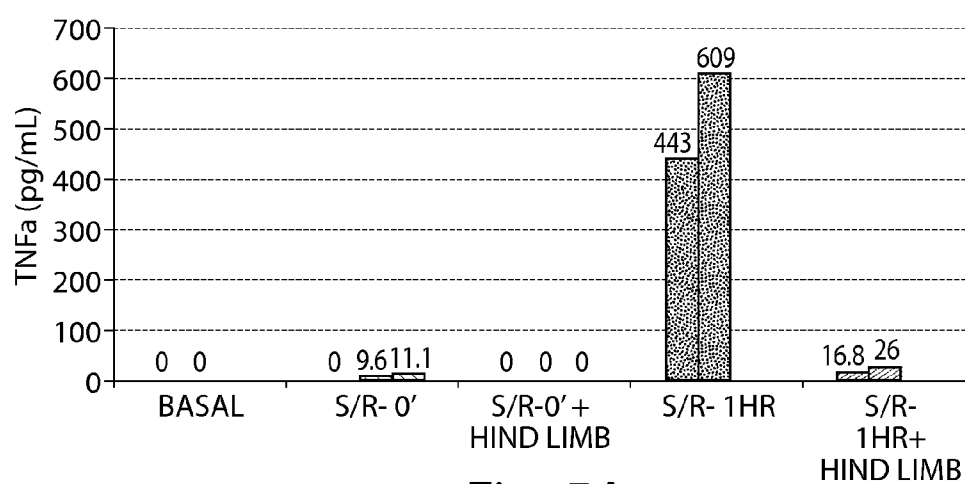

Fig. 5A

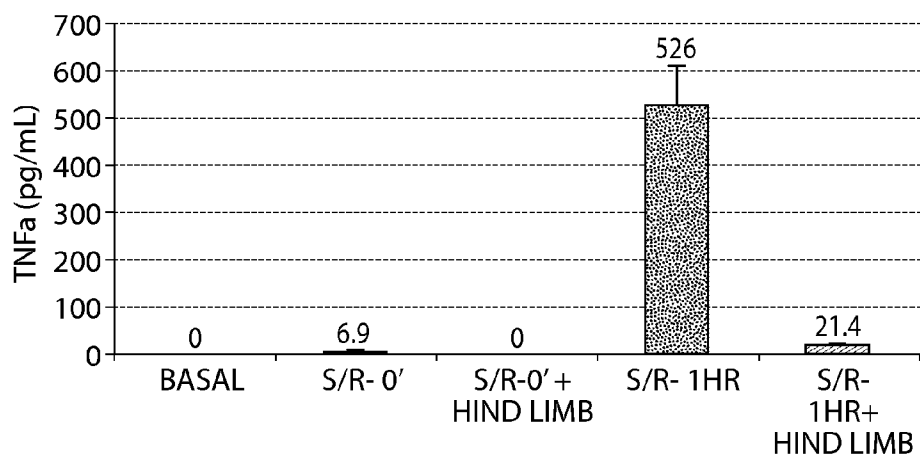

Fig. 5B

# PATENT COOPERATION TREATY

# PCT

## DECLARATION OF NON-ESTABLISHMENT OF INTERNATIONAL SEARCH REPORT

(PCT Article 17(2)(a), Rules 13~~ter~~.1(c) and Rule 39)

Applicant's or agent's file reference HO780.70005	IMPORTANT DECLARATION	Date of mailing( <i>day/month/year</i> ) 29 August 2011 (29-08-2011)
International application No. PCT/US2011/031674	International filing date( <i>day/month/year</i> ) 8 April 2011 (08-04-2011)	(Earliest) Priority date( <i>day/month/year</i> ) 8 April 2010 (08-04-2010)
International Patent Classification (IPC) or both national classification and IPC A61B17/132, A61B5/02		
Applicant THE HOSPITAL FOR SICK CHILDREN		

This International Searching Authority hereby declares, according to Article 17(2)(a), that **no international search report will be established** on the international application for the reasons indicated below

1. ☒ The subject matter of the international application relates to:
  - a. ☐ scientific theories
  - b. ☐ mathematical theories
  - c. ☐ plant varieties
  - d. ☐ animal varieties
  - e. ☐ essentially biological processes for the production of plants and animals, other than microbiological processes and the products of such processes
  - f. ☐ schemes, rules or methods of doing business
  - g. ☐ schemes, rules or methods of performing purely mental acts
  - h. ☐ schemes, rules or methods of playing games
  - i. ☒ methods for treatment of the human body by surgery or therapy
  - j. ☐ methods for treatment of the animal body by surgery or therapy
  - k. ☐ diagnostic methods practised on the human or animal body
  - l. ☐ mere presentations of information
  - m. ☐ computer programs for which this International Searching Authority is not equipped to search prior art
2. ☐ The failure of the following parts of the international application to comply with prescribed requirements prevents a meaningful search from being carried out:
 

☐ the description
 ☐ the claims
 ☐ the drawings
3. ☐ A meaningful search could not be carried out without the sequence listing; the applicant did not, within the prescribed time limit:
 

☐ furnish a sequence listing on paper complying with the standard provided for in Annex C of the Administrative Instructions, and such listing was not available to the International Searching Authority in a form and manner acceptable to it.  
☐ furnish a sequence listing in electronic form complying with the standard provided for in Annex C of the Administrative Instructions, and such listing was not available to the International Searching Authority in a form and manner acceptable to it.  
☐ pay the required late furnishing fee for the furnishing of a sequence listing in response to an invitation under Rule 13~~ter~~.1(a) or (b).
4. Further comments:

Name and mailing address of the International Searching Authority  European Patent Office, P.B. 5818 Patentlaan 2 NL-2280 HV Rijswijk Tel. (+31-70) 340-2040 Fax: (+31-70) 340-3016	Authorized officer VAN LOON-MéGARD, Véronique Tel: +31 (0)70 340-3058
--	---

**FURTHER INFORMATION CONTINUED FROM PCT/ISA/ 203**

The subject-matter of claims 1-30 appears to constitute a method for treatment of the human or animal body by therapy, and therefore under Rule 39.1(iv) PCT (Method for treatment of the human or animal body by therapy), these claims have not been searched.

It should be noted that under the PCT prophylactic treatments are still considered as therapy.

Further comments:

Although claims 1-3 and 26-28 have been drafted as separate independent claims, they appear to relate effectively to the same subject-matter and to differ from each other only with regard to the definition of the subject-matter for which protection is sought and/or in respect of the terminology used for the features of that subject-matter. The minor differences in the claims regarding the timing of the therapy are not considered sufficient to justify separate claims. The aforementioned claims therefore lack conciseness and as such do not meet the requirements of Article 6 PCT.

The term 'remote ischaemic conditioning' (RIC) is not an internationally recognised term that would be recognised by the skilled person and as such renders the definition of the subject-matter of said claim unclear, Article 6 PCT.

The applicant's attention is drawn to the fact that claims relating to inventions in respect of which no international search report has been established need not be the subject of an international preliminary examination (Rule 66.1(e) PCT). The applicant is advised that the EPO policy when acting as an International Preliminary Examining Authority is normally not to carry out a preliminary examination on matter which has not been searched. This is the case irrespective of whether or not the claims are amended following receipt of the search report or during any Chapter II procedure. If the application proceeds into the regional phase before the EPO, the applicant is reminded that a search may be carried out during examination before the EPO (see EPO Guideline C-VI, 8.2), should the problems which led to the Article 17(2) declaration be overcome.