

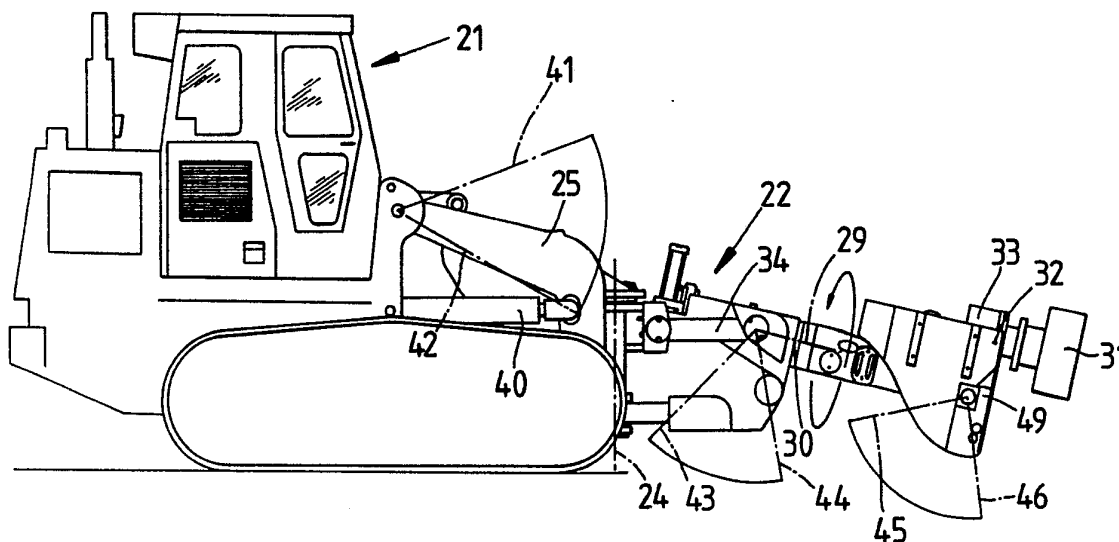

INTERNATIONAL APPLICATION PUBLISHED UNDER THE PATENT COOPERATION TREATY (PCT)

<p>(51) International Patent Classification ⁵ : E02F 3/78, 9/14, 3/18</p>	<p>A1</p>	<p>(11) International Publication Number: WO 92/20875 (43) International Publication Date: 26 November 1992 (26.11.92)</p>
<p>(21) International Application Number: PCT/GB92/00891 (22) International Filing Date: 18 May 1992 (18.05.92) (30) Priority data: 9110798.7 18 May 1991 (18.05.91) GB (71) Applicant (for all designated States except US): WEBSTER EQUIPMENT LIMITED [GB/GB]; Wortley Road, Rotherham S61 1LZ (GB). (72) Inventor; and (75) Inventor/Applicant (for US only) : WEBSTER, Ian, Frederick [GB/GB]; 8 Bishopdale Rise, Mossborough, Sheffield S19 5TE (GB). (74) Agents: HULSE, Thomas, Arnold et al.; Hulse & Co, Cavendish Buildings, West Street, Sheffield S1 1ZZ (GB).</p>		<p>(81) Designated States: AT (European patent), AU, BE (European patent), CH (European patent), DE (European patent), DK (European patent), ES (European patent), FR (European patent), GB (European patent), GR (European patent), IT (European patent), LU (European patent), MC (European patent), NL (European patent), SE (European patent), US. Published With international search report. With amended claims.</p>

(54) Title: MECHANISM FOR SUPPORTING AN EARTHWORKING ETC. TOOL



(57) Abstract

A mechanism (22) for supporting an earthworking tool from a vehicle such as a front end-loader (21) comprising: (i) a primary support structure (23) adapted to be pivotally attached, in a readily releasable manner, about a generally upright, slewing axis (24), to a conventionally-provided elevating linkage mechanism (25) of a vehicle; (ii) power means (26, 27) to effect controlled slewing of the primary support structure (23) about its slewing axis (24); (iii) a secondary support structure (28) rotatably mounted about a generally forwardly directed axis (29) on the primary support structure (23); (iv) power means (30) to effect controlled rotation of the secondary support structure with respect to the primary support structure; (v) tool support means (32) pivotally mounted on the secondary support structure (28); and (vi) means (33) to pivot the tool support means with respect to the secondary support structure.

FOR THE PURPOSES OF INFORMATION ONLY

Codes used to identify States party to the PCT on the front pages of pamphlets publishing international applications under the PCT.

AT	Austria	FI	Finland	ML	Mali
AU	Australia	FR	France	MN	Mongolia
BB	Barbados	GA	Gabon	MR	Mauritania
BE	Belgium	GB	United Kingdom	MW	Malawi
BF	Burkina Faso	GN	Guinea	NL	Netherlands
BG	Bulgaria	GR	Greece	NO	Norway
BJ	Benin	HU	Hungary	PL	Poland
BR	Brazil	IE	Ireland	RO	Romania
CA	Canada	IT	Italy	RU	Russian Federation
CF	Central African Republic	JP	Japan	SD	Sudan
CG	Congo	KP	Democratic People's Republic of Korea	SE	Sweden
CH	Switzerland	KR	Republic of Korea	SN	Senegal
CI	Côte d'Ivoire	LI	Liechtenstein	SU	Soviet Union
CM	Cameroon	LK	Sri Lanka	TD	Chad
CS	Czechoslovakia	LU	Luxembourg	TG	Togo
DE	Germany	MC	Monaco	US	United States of America
DK	Denmark	MG	Madagascar		
ES	Spain				

- 1 -

MECHANISM FOR SUPPORTING AN EARTHWORKING ETC. TOOL

This invention relates to a mechanism for supporting an earthworking tool (such as a bucket loader or a rotary cutting head) from a vehicle (such as a tractor or track-laying vehicle).

Existing vehicles, known as "front end-loaders", which may be wheeled or track-laying, are provided with a fixed arm, having vertical movement, which carries a bucket, the bucket being provided with rotary movement for tipping.

It would clearly be advantageous if such a vehicle could be adapted for multiple uses, by having an ability to mount a plurality of tool types for different earthworking operations either above ground (such as trenching, floor/road planing, bankside excavation, spoil loading/tipping) or underground operations (such as the driving of civil engineering tunnels or of mine roadways), with minimum downtime for tool changing operations.

A basic object of the present invention is to provide a mechanism for supporting on a front end-loader an earthworking tool exhibiting improved characteristics over prior art proposals.

According to a first aspect of the present invention there is provided a mechanism for supporting an earthworking tool from a vehicle such as a front end-loader, comprising;

- (i) a primary support structure adapted to be pivotally attached, in a readily releasable manner, about a generally upright, slewing axis, to a conventionally-provided elevating linkage

- 2 -

mechanism of a vehicle;

- (ii) power means to effect controlled slewing of the primary support structure about its slewing axis;
- (iii) a secondary support structure rotatably mounted about a generally forwardly directed axis on the primary support structure;
- (iv) power means to effect controlled rotation of the secondary support structure with respect to the primary support structure;
- (v) tool support means pivotally mounted on the secondary support structure; and
- (vi) means to pivot the tool support means with respect to the secondary support structure.

The power means to effect slewing may consist of a double acting hydraulic ram, or a pair of single acting rams, while the power means to effect rotation of the secondary support structure with respect to the first may comprise an hydraulically powered linear actuator.

The tool support means may be provided with means to readily attach various equipment to the mechanism such as, in one instance, a detachable, drum or disc carrying cutter-picks for cutting or extracting material.

Power means may also be provided to pivot the secondary support structure with respect to the primary support structure about a generally horizontal axis, said power means may consist of a double acting hydraulic ram, or a pair of single acting rams.

- 3 -

Lugs may be provided on the secondary support structure to engage corresponding lugs on a bucket so that the bucket may be picked up by utilising the movements of the mechanism thus eliminating the need to lift and bolt the bucket in place.

Other types of tools which may be attached to the secondary support structure include a bore hole drilling unit or a hydraulic hammer.

According to a second aspect of the present invention there is provided a vehicle provided with the mechanism of the first aspect.

The invention will now be described, by way of example, with reference to the accompanying drawings in which:-

Figure 1 is a side elevation of the mechanism supported on a front end-loader and carrying a cutter drum;

Figure 2 is a plan of the mechanism and front end-loader of Figure 1;

Figure 3 is a front view of the mechanism and front end-loader of Figure 1;

Figure 4 corresponds to Figure 2 but shows the mechanism slewed about its slewing axis;

Figure 5 corresponds to Figure 1 but shows the various degrees of lift, tilt and rotation of the mechanism;

Figure 6 corresponds to Figure 1 but shows the mechanism adjusted for floor planing;

Figure 7 corresponds to Figure 1 but shows the mechanism adjusted for cutting below ground level;

- 4 -

Figure 8 corresponds to Figure 1 but shows the mechanism adjusted for bankside excavation;

Figure 9 corresponds to Figure 1 but shows the mechanism adjusted for tunnelling;

Figure 10 corresponds to Figure 1 but shows the mechanism adjusted for tunnel profiling;

Figures 11 to 13 correspond to Figure 1 but show the mechanism variously adjusted for trenching;

Figure 14 is a side elevation of a bucket for use with the mechanism;

Figure 15 is a rear elevation of the bucket of Figure 14;

Figure 16 corresponds to Figure 1 but shows the bucket of Figure 14 attached to the mechanism;

Figure 17 corresponds to Figure 16 but shows the mechanism lifted and the secondary support structure rotated to effect side tipping of the bucket;

Figure 18 corresponds to Figure 1 but shows an hydraulic hammer attached to the secondary support structure;

Figure 19 corresponds to Figure 18 but shows a bucket attached to the secondary support structure for loading; and

Figures 20 and 21 correspond to Figure 1 but show a drill unit attached to the secondary support structure.

In Figures 1 to 4 a track-laying front end-loader vehicle 21 is provided with a mechanism 22 for supporting an earthworking tool to be described in detail later.

The mechanism 22 comprises a primary support structure 23 attached about a generally upright, slewing axis 24 to a

- 5 -

conventionally-provided elevating linkage mechanism 25 of the vehicle 21, operable by a pair of hydraulic rams 40. Power means to effect controlled slewing is provided by a pair of single acting rams 26 and 27, and with a secondary support structure 28 rotatably mounted about a generally forwardly directed axis 29 on the primary support structure 23. Further power means to effect controlled rotation of the secondary support structure 28 with respect to the primary support structure 23 is provided by an hydraulically powered linear actuator 30. An earthworking tool in the form of a detachable cutter drum 31 is illustrated, being attached to tool support means 32 pivotally mounted on the secondary support structure 28, and means 33 is provided to pivot the tool support means 32 with respect to the secondary support structure 28.

A further pair of rams 34 and 35 are provided to pivot the secondary support structure 28 with respect to the primary support structure about a horizontal axis 36.

Referring specifically to Figure 4, actuation of the rams 25 and 26 effect slewing about the slewing axis 24, between positions 37 and 38, up to 30° either side of the central position 39 of the mechanism 22.

In Figure 5 the various degrees of lift, tilt and rotation of the mechanism 22 are shown, where it can be seen that the elevating linkage mechanism 25 provides up to 50° of lift between upper and lower position 41 and 42. Up to 345° of rotation of the secondary support structure 28 about the axis 29 is also provided. Rams 34 and 35 provide up to 54°

- 6 -

of tilt of the secondary support structure 28 between rear and forward positions 43 and 44. The means 33, preferably hydraulic, provide up to 85° of tilt of the tool support means 32 between rear and forward positions 45 and 46.

In Figure 6 the linkage mechanism 25 is in its lower position 42, with tool support means 32 tilted towards its rear position 45 and the secondary support structure 28 tilted towards its forward position 44 aligning the cutter drum 31 to effect floor or road planing, as illustrated.

In Figure 7 the secondary support structure 28 is tilted towards its rear position 43 with suitable adjustment of the tool support means 32 towards its forward position 46 aligning the cutter drum 31 to cut below the level of the ground, as illustrated.

In Figure 8 the linkage mechanism 25 is in its upper position 41, the tool support means 32 tilted towards its forward position 46 and the secondary support structure 28 is tilted further towards its rear position 43 to align the cutter drum 31 for bankside excavation, as illustrated. Further adjustment of tilt and lift enables re-alignment of the cutter drum 31 during excavation.

In Figure 9 the linkage mechanism 25 moves between its lower (shown here) and upper positions with suitable adjustment of the tilt of the tool support means 32 and slewing of the mechanism to effect tunnelling, as illustrated.

In Figure 10 the linkage mechanism 25 is raised to its upper position 41 and the tool support means 32 suitably aligned in conjunction with controlled slewing to effect

- 7 -

profiling of the tunnel, as illustrated.

In Figures 11 to 13, with linkage mechanism 25 in its lower position 42, various degrees of tilt of the secondary support structure 28 and the tool support means 32 in conjunction with controlled slewing allow the cutter drum 31 to effect trenching.

In Figures 14 and 15 an alternative earthworking tool in the form of a bucket 47 is illustrated, having lugs 48 for engagement with corresponding lugs 49 on the secondary support structure 28. A bore 50 is also provided on the bucket for alignment with a corresponding bore 51 on the secondary support structure 28 wherein both bores receive a retaining pin 52 (see Figure 16). Removable side plates (not shown) may be provided for the bucket 47 and connected thereto with the aid of slots 53. Controlled movement of the mechanism 22 can be used to engage the lugs 48 and pick up the bucket 47 without the need to lift and bolt the bucket 47 in place.

Referring particularly to Figures 16 and 17 it can be seen that the bucket 47 can be loaded and by utilising the lift, tilt and rotational movements of the mechanism 22 the bucket can be raised and emptied.

In Figure 18 the tool support means is provided with an earthworking tool in the form of an hydraulic hammer 54, shown with the secondary support structure in its rear position 45 and adapted for vertical operation thus, through tilting of the secondary support structure to its forward position 46 the hydraulic hammer 54 is adapted for horizontal operation 54A.

- 8 -

Figure 19 shows a bucket 47 attached to the secondary support structure 28 in the manner described above for subsequent loading and removal of extracted material.

In Figures 20 and 21 the tool support means is provided with an earthworking tool in the form of a drill unit 55 adapted for vertical, horizontal or intermediate drilling, respectively, through a range of positions and heights utilising the lift, tilt and rotational movements of the mechanism 22.

CLAIMS

1. A mechanism for supporting an earthworking tool from a vehicle such as a front end-loader comprising:-

- (i) a primary support structure adapted to be pivotally attached, in a readily releasable manner, about a generally upright, slewing axis, to a conventionally-provided elevating linkage mechanism of a vehicle;
- (ii) power means to effect controlled slewing of the primary support structure about its slewing axis;
- (iii) a secondary support structure rotatably mounted about a generally forwardly directed axis on the primary support structure;
- (iv) power means to effect controlled rotation of the secondary support structure with respect to the primary support structure;
- (v) tool support means pivotally mounted on the secondary support structure; and
- (vi) means to pivot the tool support means with respect to the secondary support structure.

2. A mechanism for supporting an earthworking tool from a vehicle as claimed in Claim 1, wherein the power means to effect slewing consists of a double acting hydraulic ram.

3. A mechanism for supporting an earthworking tool from a vehicle as claimed in Claim 1, wherein the power means to effect slewing consists of a pair of single acting hydraulic rams.

- 10 -

4. A mechanism for supporting an earthworking tool from a vehicle as claimed in any preceding Claim wherein the power means to effect rotation of the secondary support structure with respect to the first is an hydraulically powered linear actuator.

5. A mechanism for supporting an earthworking tool from a vehicle as claimed in any preceding Claim, wherein the tool support means is provided with means to readily attach various tools to the mechanism.

6. A mechanism for supporting an earthworking tool from a vehicle as claimed in any preceding Claim, wherein power means is provided to pivot the secondary support structure, with respect to the primary support structure, about a generally horizontal axis.

7. A mechanism for supporting an earthworking tool from a vehicle as claimed in Claim 6, wherein the power means consists of at least one hydraulic ram.

8. A mechanism for supporting an earthworking tool from a vehicle as claimed in any preceding Claim, wherein lugs are provided on the secondary support structure to engage corresponding lugs on a bucket.

9. A mechanism for supporting an earthworking tool from a vehicle as claimed in Claim 5, wherein a detachable drum or disc carrying cutter picks is attached to the secondary support structure.

10. A mechanism for supporting an earthworking tool from a vehicle as claimed in Claim 5, wherein a drilling unit is attached to the secondary support structure.

- 11 -

11. A mechanism for supporting an earthworking tool from a vehicle as claimed in Claim 5, wherein an hydraulic hammer is attached to the secondary support structure.

12. A vehicle provided with a mechanism for supporting an earthworking tool which mechanism comprising:-

- (i) a primary support structure adapted to be pivotally attached, in a readily releasable manner, about a generally upright, slewing axis, to a conventionally-provided elevating linkage mechanism of a vehicle;
- (ii) power means to effect controlled slewing of the primary support structure about its slewing axis;
- (iii) a secondary support structure rotatably mounted about a generally forwardly directed axis on the primary support structure;
- (iv) power means to effect controlled rotation of the secondary support structure with respect to the primary support structure;
- (v) tool support means pivotally mounted on the secondary support structure; and
- (vi) means to pivot the tool support means with respect to the secondary support structure.

13. A vehicle provided with a mechanism for supporting an earthworking tool substantially as hereinbefore described with reference to the accompanying drawings.

AMENDED CLAIMS

[received by the International Bureau
on 13 October 1992 (13.10.92);
new claims 14-19 added;
original claims unchanged (2 pages)]

14. A front end loader characterised in that the conventionally-provided loading and tipping bucket - carried at the front ends of a pair of parallel arms pivoted at their rear ends about a common horizontal pivot axis to the front end loader with the arms elevatable by rams in parallel vertical planes - is replaced by a mechanism (22) for supporting an alternative and universal earthworking tool (31,47,54), the mechanism (22) comprising a king post structure (24a) providing a generally upright, slewing axis (24), secured by structure (24b) to the front ends of parallel arms (25) of the front end loader, which arms (25) together with hydraulic rams (50) provide an elevating linkage, and power means (26,27) to effect controlled slewing of the mechanism (22) about the slewing axis (24).

15. A front end loader as claimed in Claim 14, wherein the power means (26,27) to effect slewing consists of a double acting hydraulic ram (26,27).

16. A front end loader as claimed in Claim 14, wherein the power means (26,27) to effect slewing consists of a pair of single acting hydraulic rams (26,27).

17. A front end loader as claimed in any of Claims 14 to 16, wherein the parallel arms (25) include downwardly depending portions (25a) so as to be generally of inverted "L"-shape, with upper and lower plates (24b) attached to the portions (25a) and spaced apart to secure the king post (24a) between them.

18. A mechanism (22) for fitting as an attachment to a conventional front end loader (21), whether tracked or

wheeled, characterised in that, the mechanism (22) comprises, in combination;

- (i) a pair of parallel link arms (25) to replace the link arms of the conventional front end loader and with rear ends of the arms being adapted to be pivotable about the same pivot axes (25b) on the loader, as the replaced conventional arms;
- (ii) a pair of primary, parallel rams (25c) pivotably connected at their rear ends (25d) to the front end loader (21) and at their front ends to one of the parallel link arms (25), so as to be capable of elevating and lowering the link arms (25) about their pivots (25b) in a generally vertical plane to provide a primary elevating and lowering facility;
- (iii) a slewing axis (24) provided by a king post structure (24a) carried, commonly, by the front ends of the arms, and
- (iv) tool support structure (28) pivotally attached to the king post structure (24a), and
- (v) a pair of secondary parallel rams (34,35) pivotally connected between the king post structure (24a) and the tool support structure (28), to provide a secondary elevating structure to provide a secondary elevating and lowering facility.

19. A mechanism (22) as claimed in Claim 18, characterised in that, the primary link arms (25) are of inverted "L"-shape in side profile.

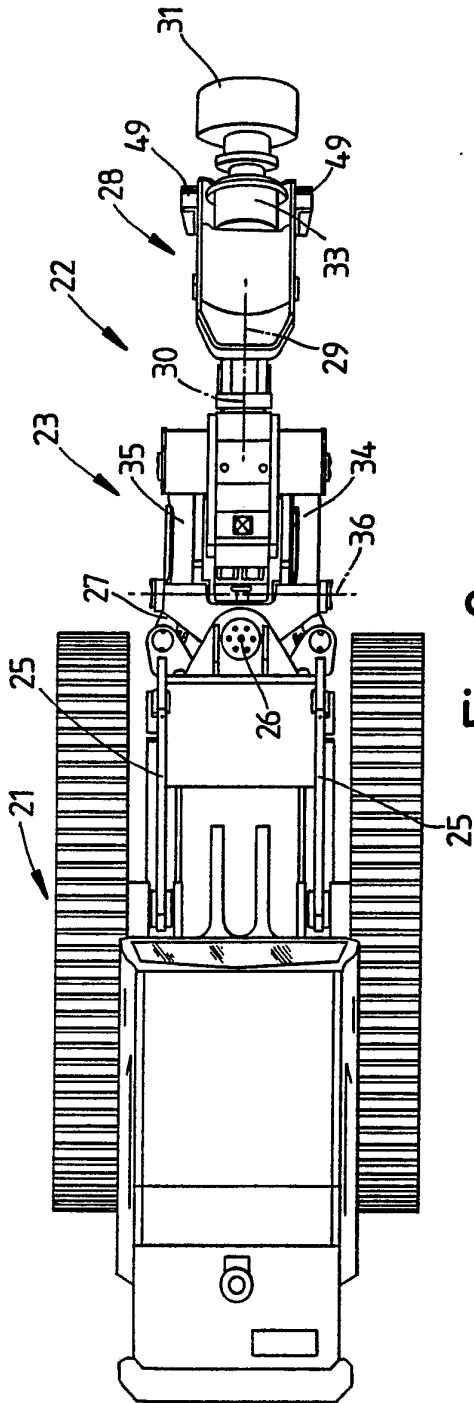

Fig. 2

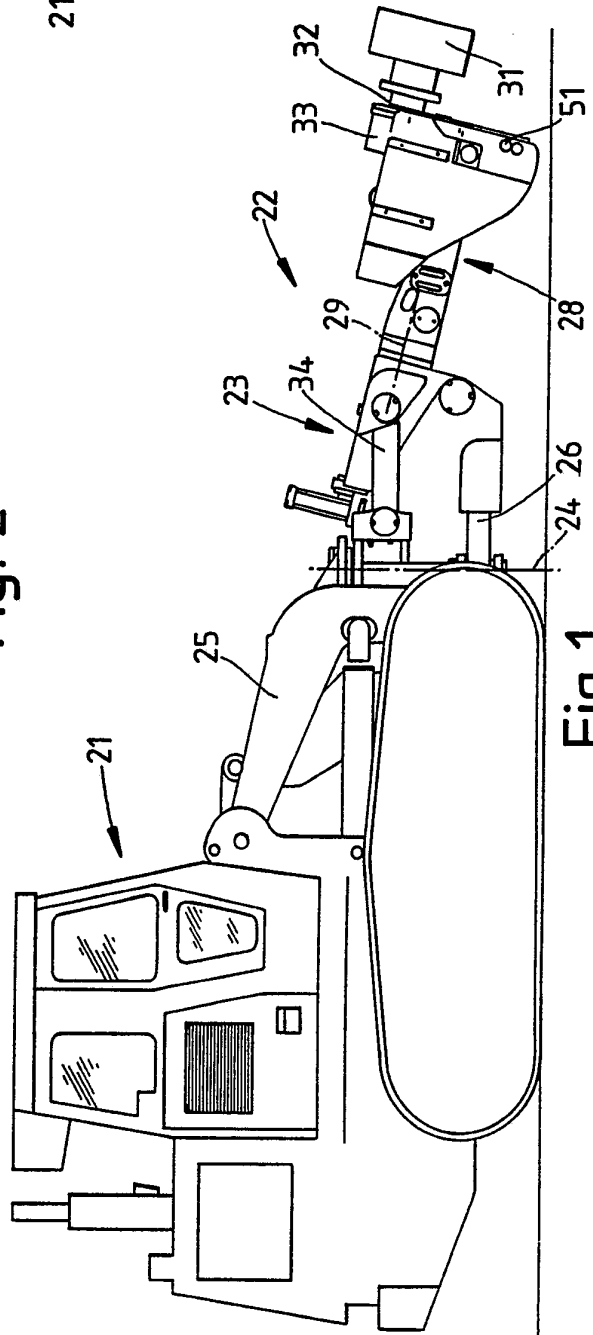

Fig. 1

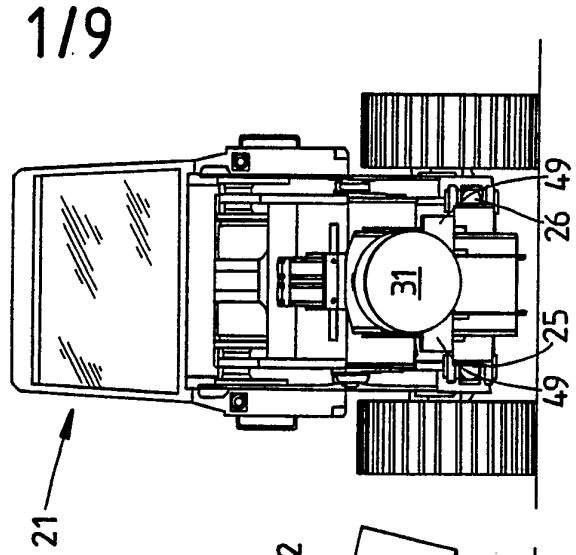

Fig. 3

219

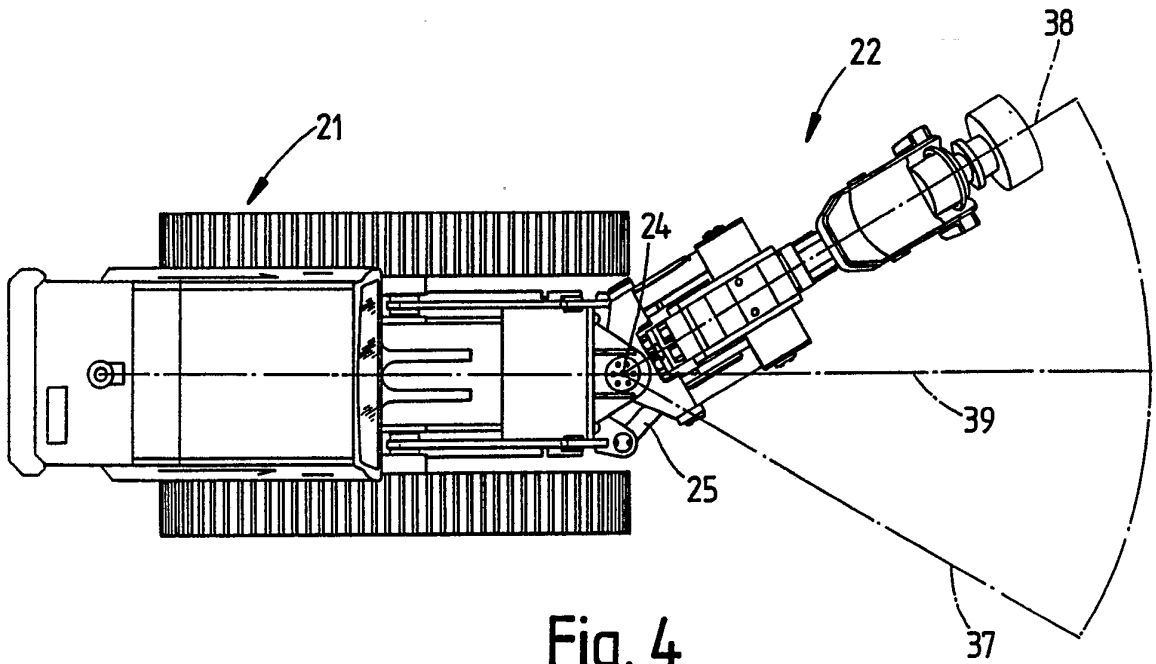

Fig. 4

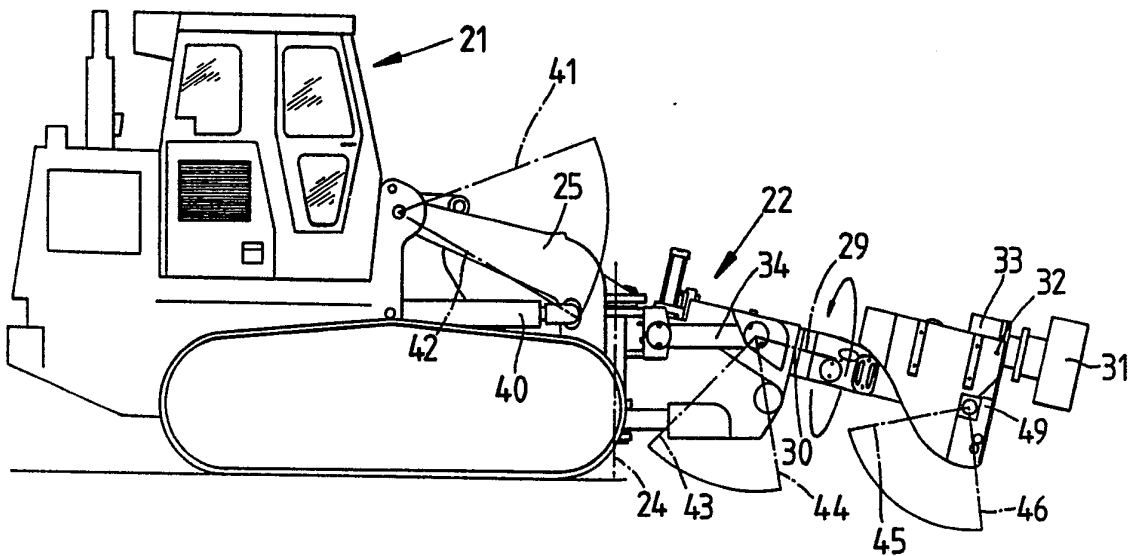

Fig. 5

3/9

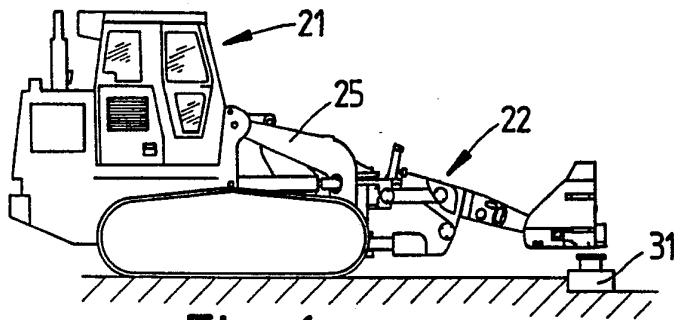

Fig. 6

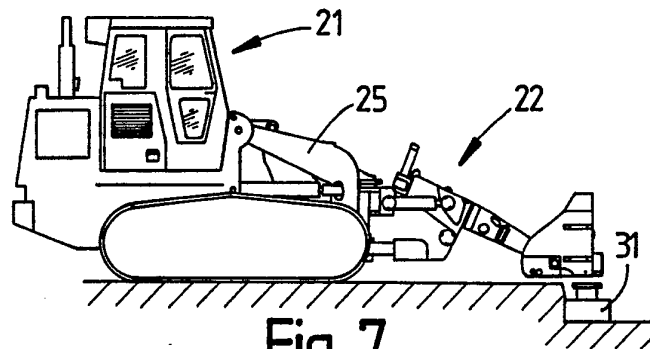

Fig. 7

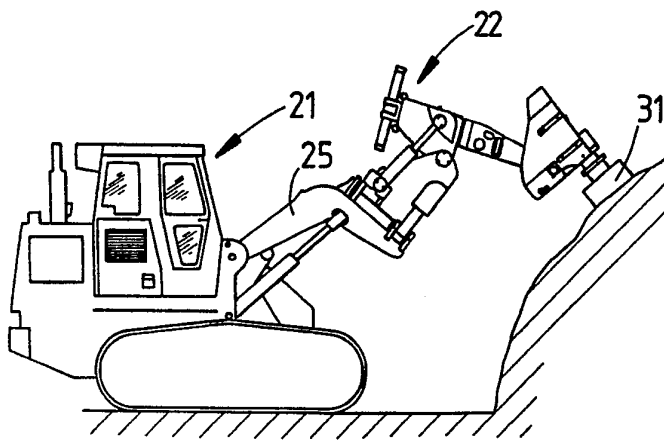

Fig. 8

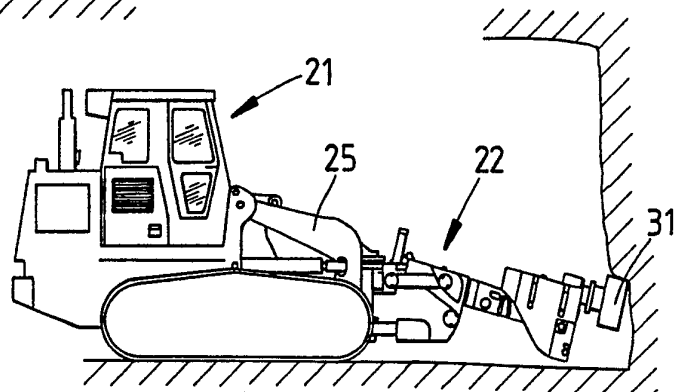

Fig. 9

4/9

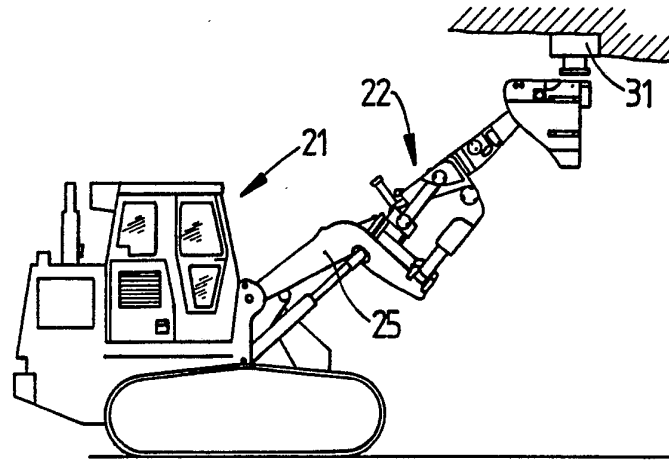

Fig. 10

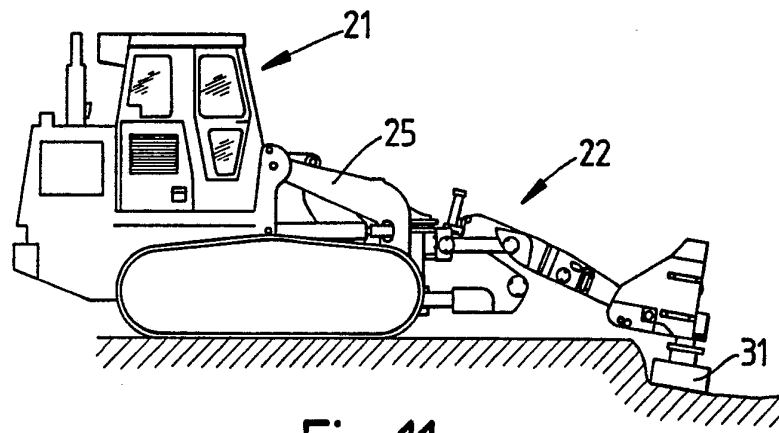

Fig. 11

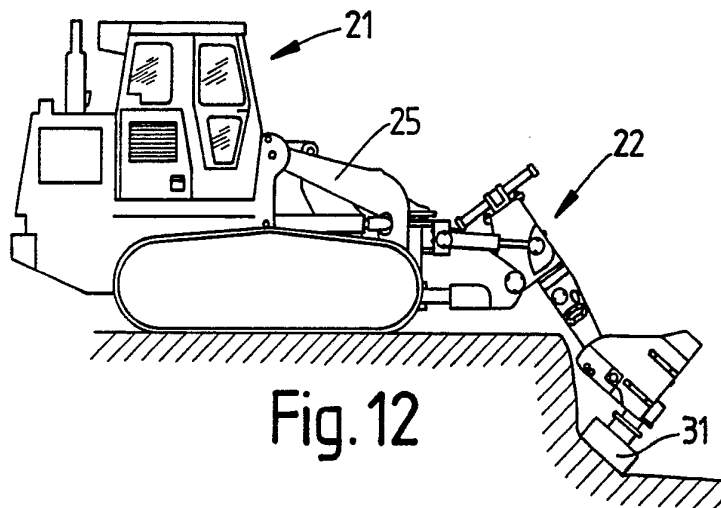

Fig. 12

5/9

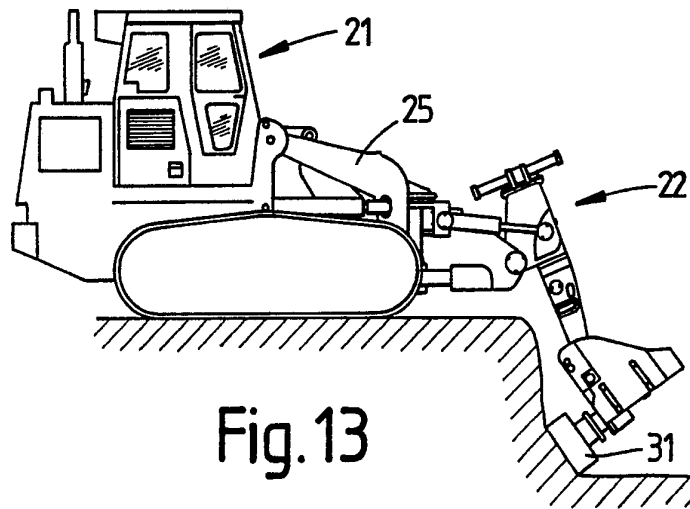

Fig. 13

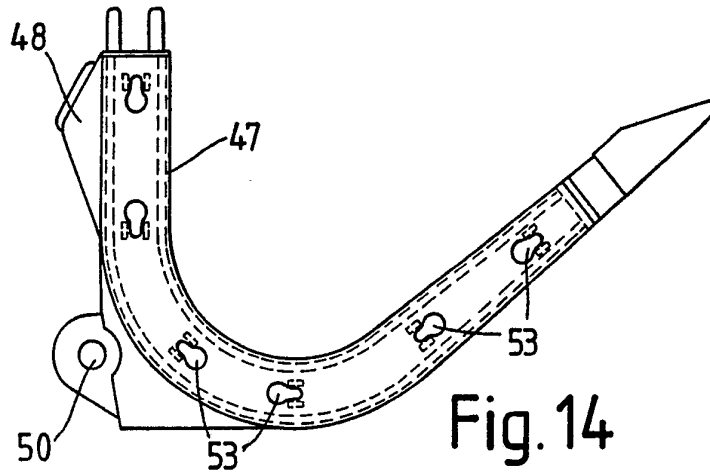

Fig. 14

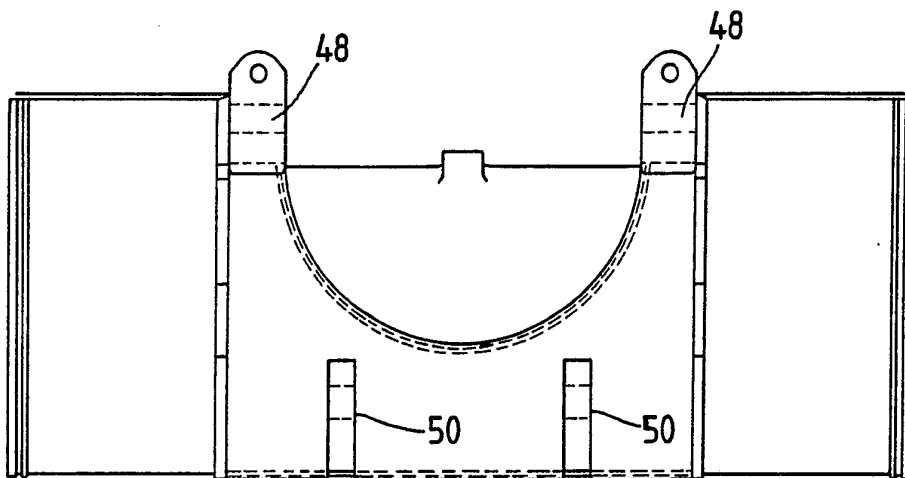

Fig. 15

6/9

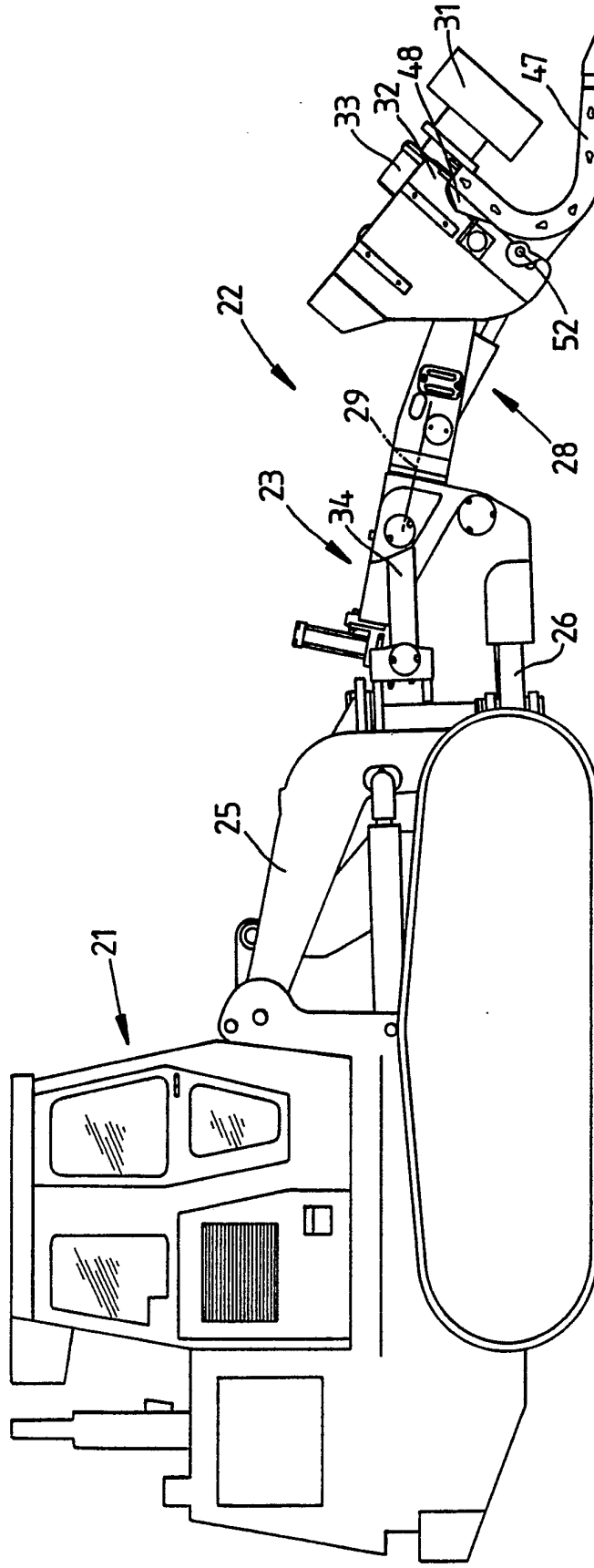

Fig. 16

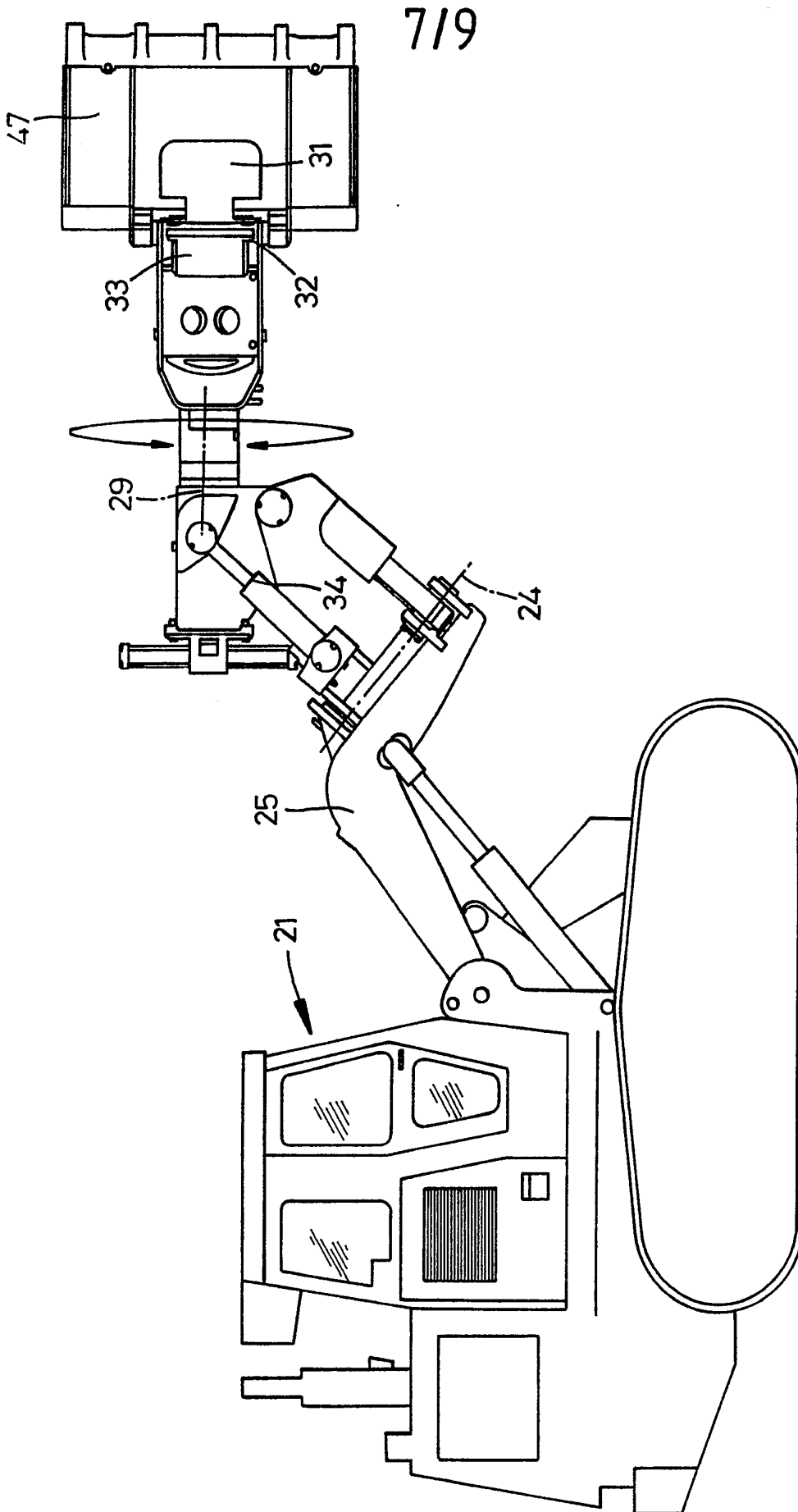

Fig. 17

8/9

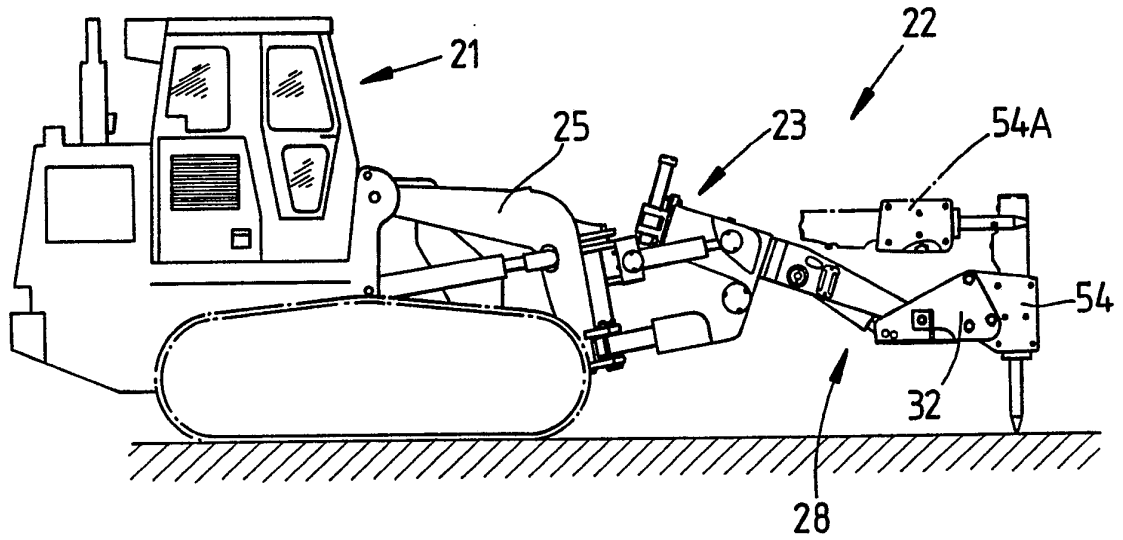

Fig. 18

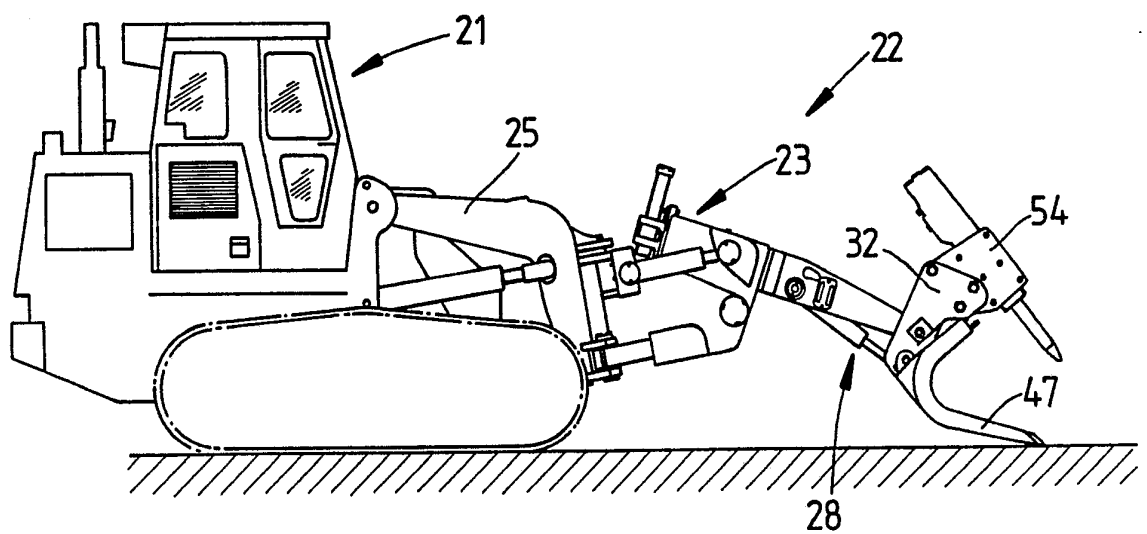

Fig. 19

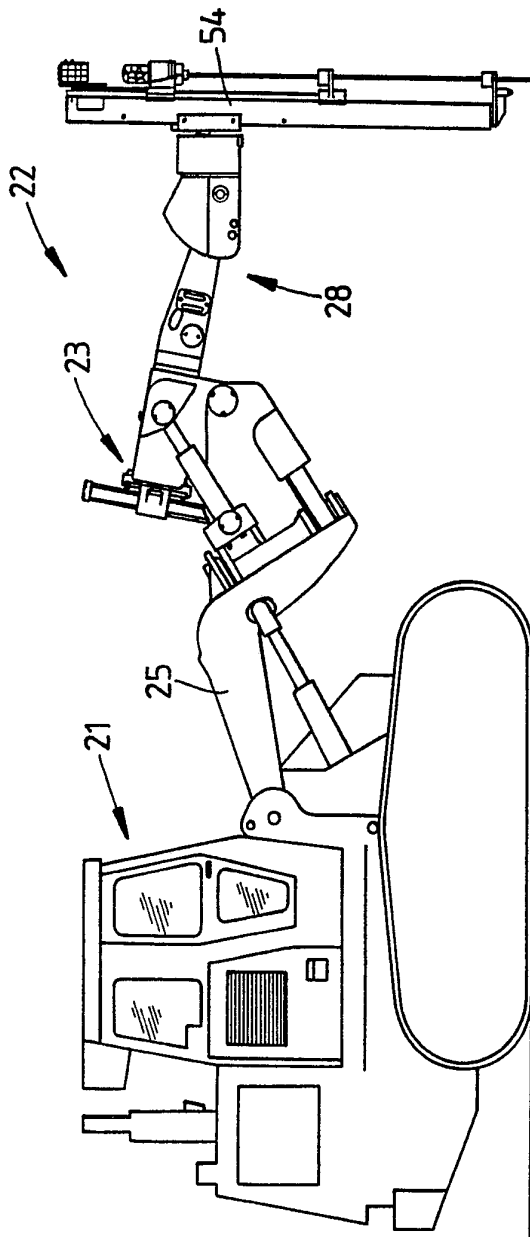

Fig. 20

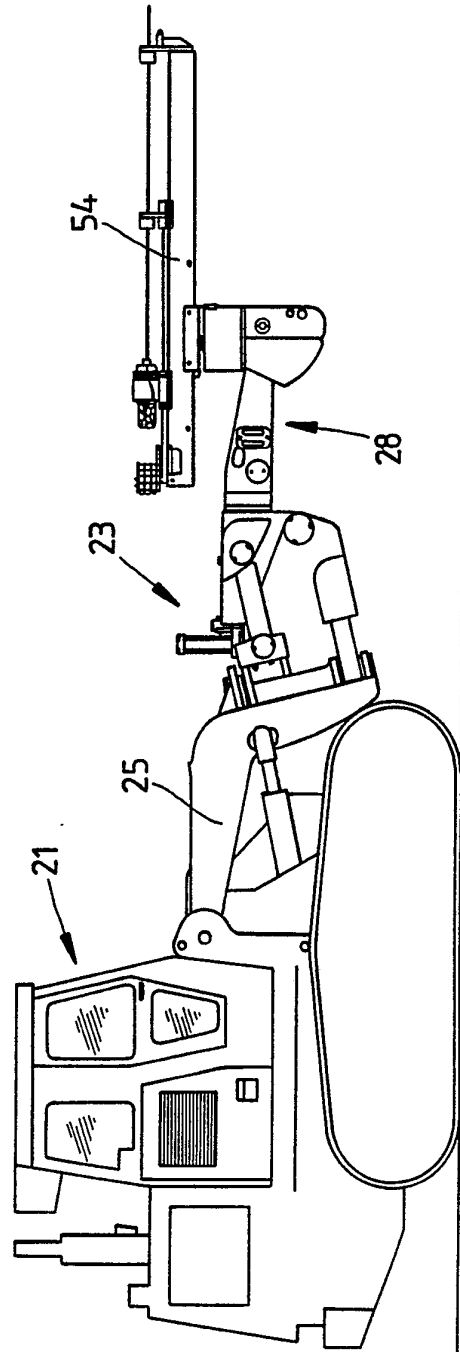

Fig. 21

III. DOCUMENTS CONSIDERED TO BE RELEVANT (CONTINUED FROM THE SECOND SHEET)		
Category °	Citation of Document, with indication, where appropriate, of the relevant passages	Relevant to Claim No.
A	GB,A,2 090 310 (ALEXANDER SHAND SERVICES) 7 July 1982 see figures	1,12,13

**ANNEX TO THE INTERNATIONAL SEARCH REPORT
ON INTERNATIONAL PATENT APPLICATION NO.**

GB 9200891
SA 59444

This annex lists the patent family members relating to the patent documents cited in the above-mentioned international search report. The members are as contained in the European Patent Office EDP file on
The European Patent Office is in no way liable for these particulars which are merely given for the purpose of information. 21/07/92

Patent document cited in search report	Publication date	Patent family member(s)	Publication date
DE-U-8525675	03-07-86	None	
US-A-3539014	10-11-70	None	
DE-A-1533688	12-03-70	None	
DE-B-2700950	30-03-78	US-A- 4173836	13-11-79
GB-A-2090310	07-07-82	GB-A- 2088933	16-06-82

EPO FORM P0479

For more details about this annex : see Official Journal of the European Patent Office, No. 12/82