



US00D660757S

(12) **United States Design Patent**
Kubo et al.

(10) **Patent No.:** **US D660,757 S**

(45) **Date of Patent:** **** May 29, 2012**

(54) **BODY PANEL FOR AN AUTOMOBILE**

D597,459 S * 8/2009 Wagner et al. D12/184
D598,347 S * 8/2009 Mattin et al. D12/184
D613,219 S * 4/2010 Elliott et al. D12/184

(75) Inventors: **Kosuke Kubo**, Toyota (JP); **Mineo Imaiida**, Kariya (JP)

* cited by examiner

(73) Assignee: **Toyota Jidosha Kabushiki Kaisha**,
Toyota-shi (JP)

Primary Examiner — Melody N Brown

(74) *Attorney, Agent, or Firm* — Finnegan, Henderson,
Farabow, Garrett & Dunner, LLP

(**) Term: **14 Years**

(57) **CLAIM**

The ornamental design for a body panel for an automobile, as shown and described.

(21) Appl. No.: **29/382,696**

(22) Filed: **Jan. 6, 2011**

DESCRIPTION

(51) **LOC (9) Cl.** **12-16**

FIG. 1 is a front perspective view of a body panel for an automobile of our new design;

(52) **U.S. Cl.** **D12/196; D12/184**

FIG. 2 is a rear perspective front view thereof;

(58) **Field of Classification Search** D12/184,

FIG. 3 is a front view thereof;

D12/196, 90-92; 280/152.1, 847-849, 851;
296/181.1, 181.5

FIG. 4 is a rear view thereof;

See application file for complete search history.

FIG. 5 is a left side view thereof;

FIG. 6 is a right side view thereof;

FIG. 7 is a top plan view thereof; and,

FIG. 8 is a bottom view thereof.

Our design includes a mirror image of the embodiment depicted.

(56) **References Cited**

We claim:

U.S. PATENT DOCUMENTS

D572,182 S * 7/2008 Deane D12/184
D576,090 S * 9/2008 Zavatski et al. D12/184
D581,332 S * 11/2008 Song et al. D12/184
D591,213 S * 4/2009 Woolley et al. D12/184

1 Claim, 6 Drawing Sheets

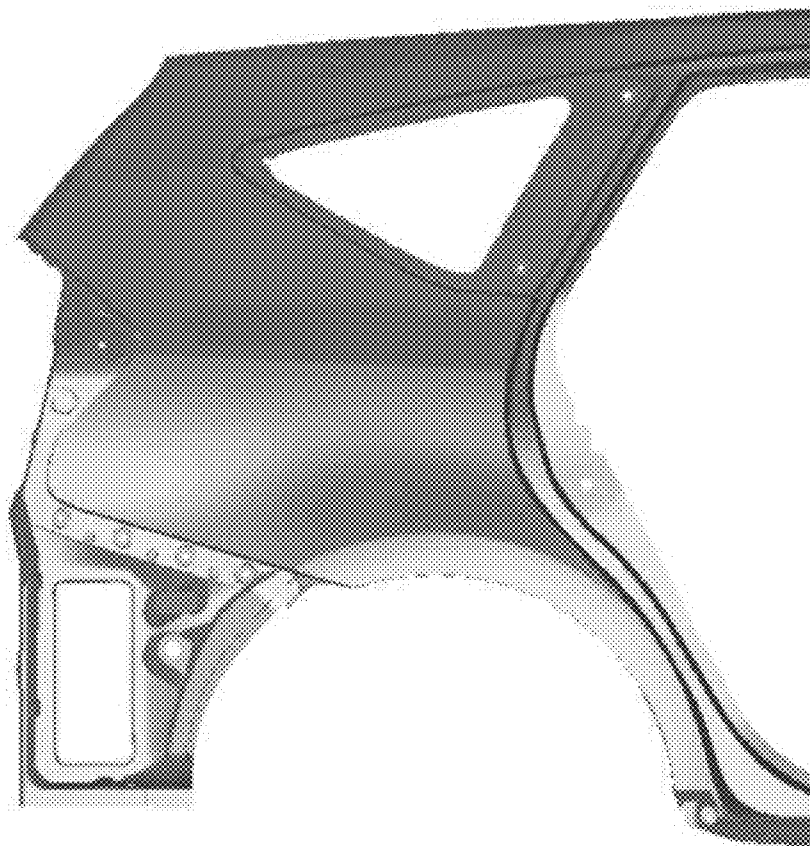

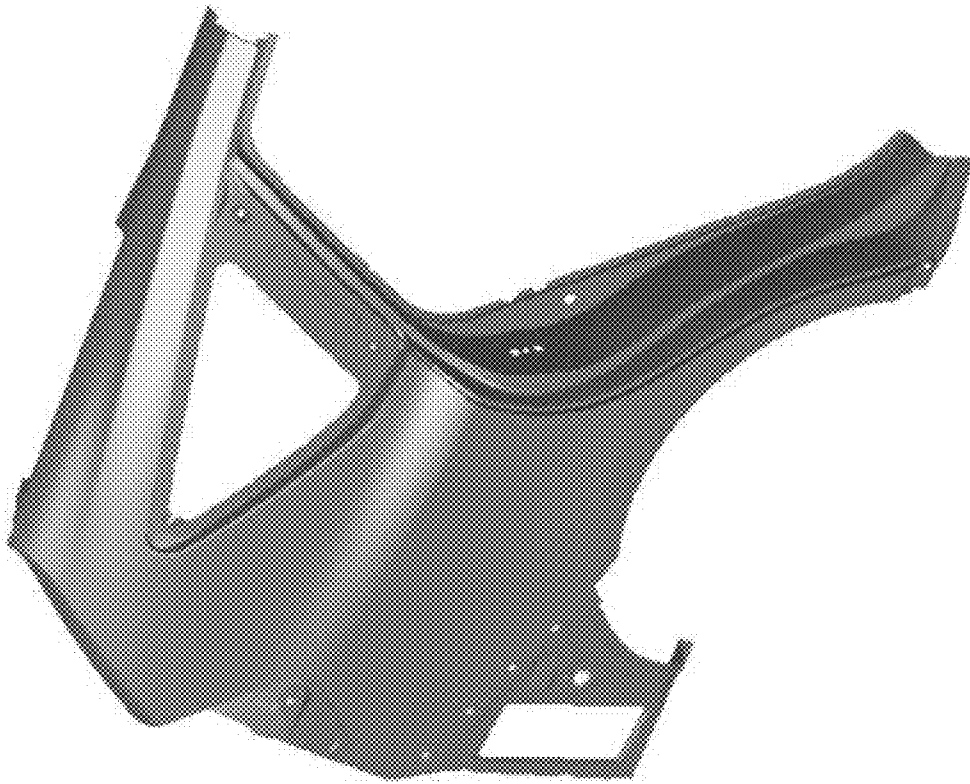

FIG. 1

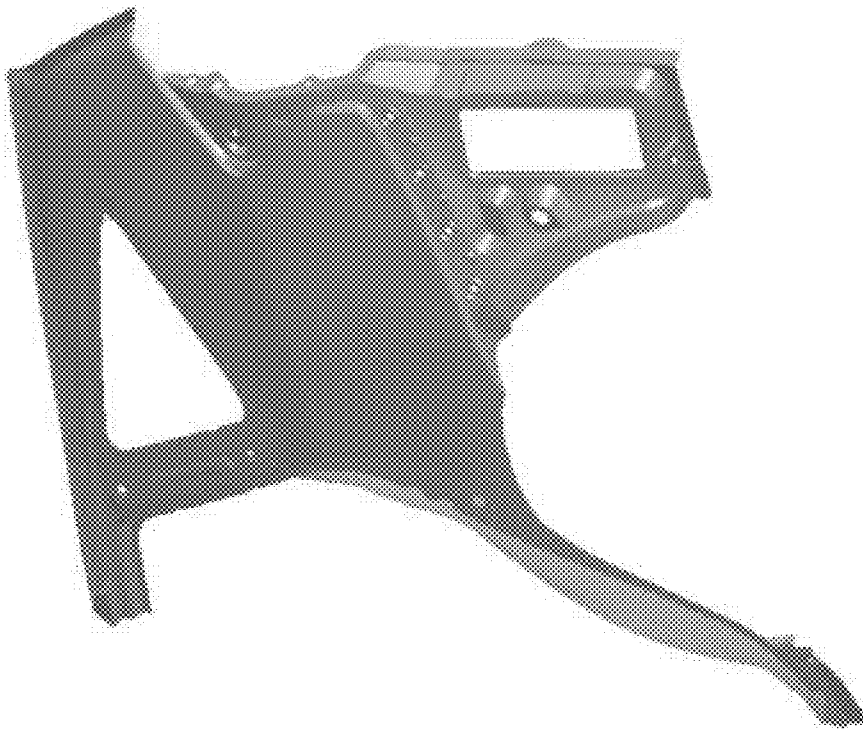

FIG. 2

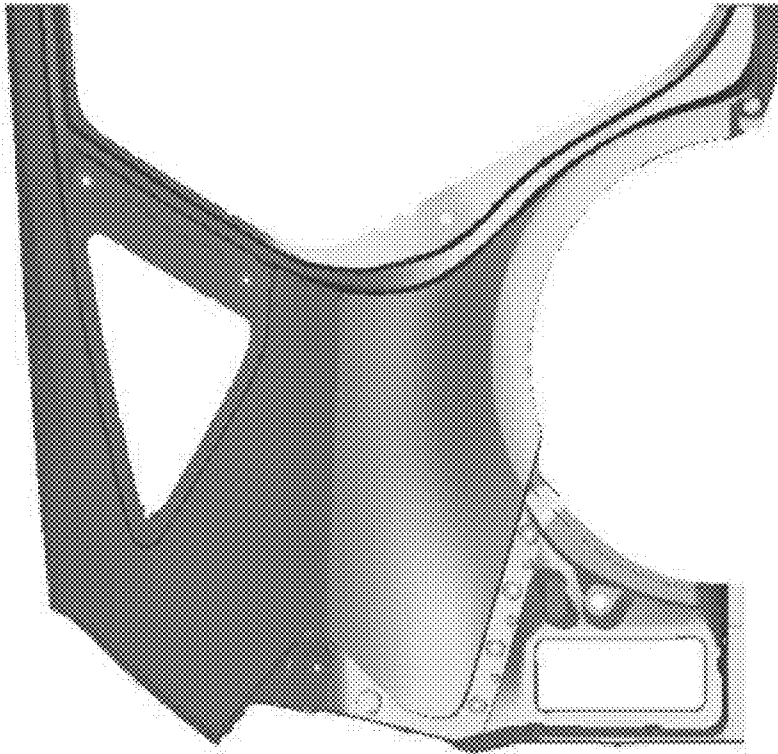

FIG. 3

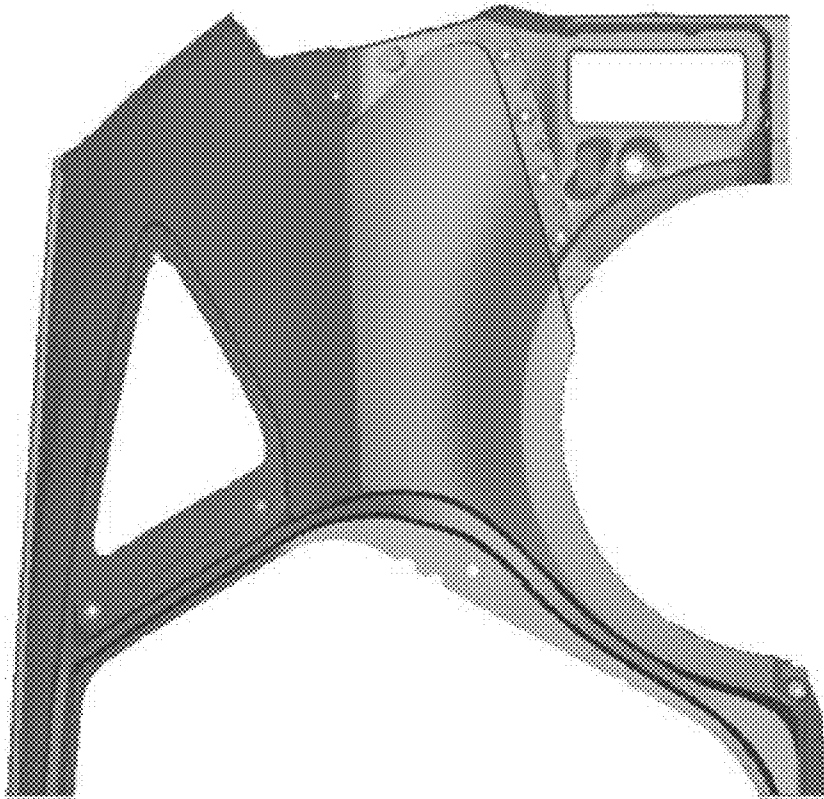

FIG. 4

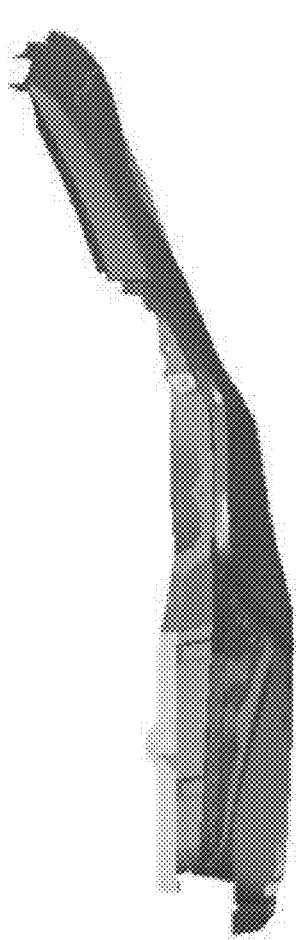

FIG. 5

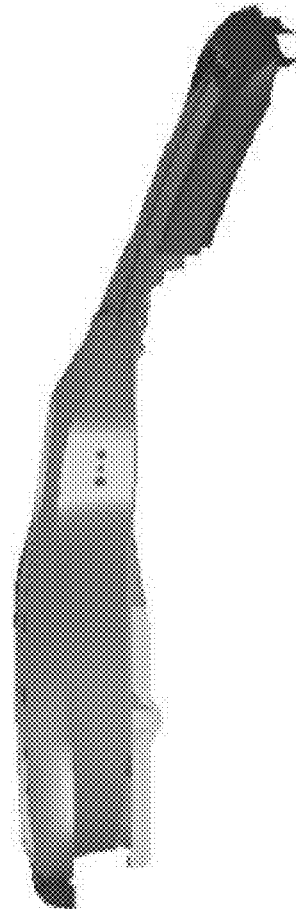

FIG. 6



FIG. 7

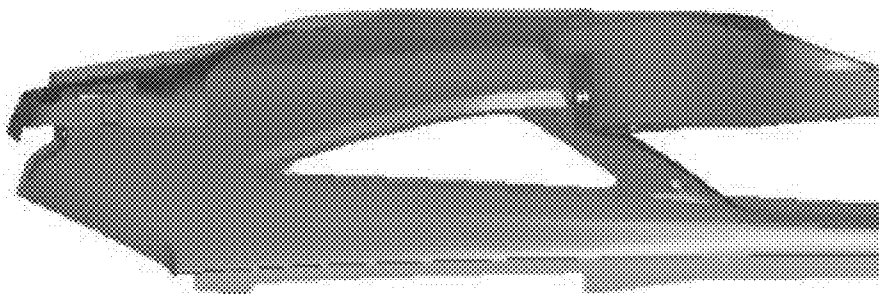

FIG. 8