

(19) World Intellectual Property Organization
International Bureau



(43) International Publication Date
23 December 2009 (23.12.2009)

(10) International Publication Number
WO 2009/153396 A1

- (51) **International Patent Classification:**
H01H 3/30 (2006.01) *H01H 33/40* (2006.01)
H01H 19/24 (2006.01)
- (21) **International Application Number:**
PCT/FI2009/050512
- (22) **International Filing Date:**
12 June 2009 (12.06.2009)
- (25) **Filing Language:** English
- (26) **Publication Language:** English
- (30) **Priority Data:**
20085616 19 June 2008 (19.06.2008) FI
- (71) **Applicant (for all designated States except US):** **ABB OY** [FI/FI]; Strömbergintie 1, FI-00380 Helsinki (FI).
- (72) **Inventors; and**
- (75) **Inventors/Applicants (for US only):** **SOININEN, Matti** [FI/FI]; Kirkkokuja 4, FI-66470 Jukaja (FI). **SUUTARINEN, Aki** [FI/FI]; Karhuntie 5 C 27, FI-65350 Vaasa (FI).
- (74) **Agent:** **KOLSTER OY AB**; Iso Roobertinkatu 23, P.O.Box 148, FI-00121 Helsinki (FI).
- (81) **Designated States (unless otherwise indicated, for every kind of national protection available):** AE, AG, AL, AM,

AO, AT, AU, AZ, BA, BB, BG, BH, BR, BW, BY, BZ, CA, CH, CL, CN, CO, CR, CU, CZ, DE, DK, DM, DO, DZ, EC, EE, EG, ES, FI, GB, GD, GE, GH, GM, GT, HN, HR, HU, ID, IL, IN, IS, JP, KE, KG, KM, KN, KP, KR, KZ, LA, LC, LK, LR, LS, LT, LU, LY, MA, MD, ME, MG, MK, MN, MW, MX, MY, MZ, NA, NG, NI, NO, NZ, OM, PE, PG, PH, PL, PT, RO, RS, RU, SC, SD, SE, SG, SK, SL, SM, ST, SV, SY, TJ, TM, TN, TR, TT, TZ, UA, UG, US, UZ, VC, VN, ZA, ZM, ZW.

(84) **Designated States (unless otherwise indicated, for every kind of regional protection available):** ARIPO (BW, GH, GM, KE, LS, MW, MZ, NA, SD, SL, SZ, TZ, UG, ZM, ZW), Eurasian (AM, AZ, BY, KG, KZ, MD, RU, TJ, TM), European (AT, BE, BG, CH, CY, CZ, DE, DK, EE, ES, FI, FR, GB, GR, HR, HU, IE, IS, IT, LT, LU, LV, MC, MK, MT, NL, NO, PL, PT, RO, SE, SI, SK, TR), OAPI (BF, BJ, CF, CG, CI, CM, GA, GN, GQ, GW, ML, MR, NE, SN, TD, TG).

Declarations under Rule 4.17:

— as to applicant's entitlement to apply for and be granted a patent (Rule 4.17(ii))

Published:

— with international search report (Art. 21(3))

(54) **Title:** TRIPPING ASSEMBLY FOR SWITCHING DEVICE

Fig. 7A

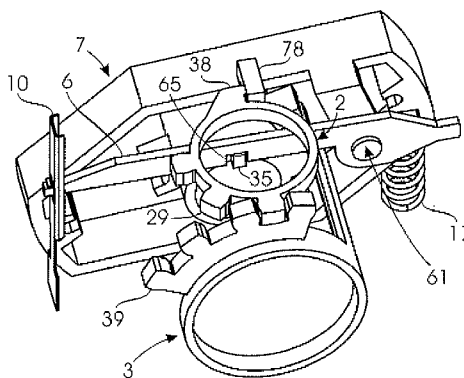

(57) **Abstract:** A tripping assembly for a switching device, comprising a body part; a tripping axle (3) arranged to turn between a trip position and a tensioned position in relation to the body part; a tripping frame (7) arranged to turn between a trip position and a tensioned position in relation to the body part and whose turning axis is substantially parallel with the turning axis of the tripping axle (3); at least one tripping spring (5) which has a non-tensioned state and a tensioned state and which is functionally connected to the tripping axle (3) and to the tripping frame (7); a frame spring (17) which has a non-tensioned state and a tensioned state and which is functionally connected between the body part and the tripping frame (7); and a connecting member (2) which is arranged to functionally connect the tripping axle (3) and the tripping frame (7) both in the final stage of a tensioning event and in the initial stage of a tripping event; whereby in the tripping event both the frame spring (17) and the at least one tripping spring (5) are arranged to transfer from the tensioned state to the non-tensioned state thus releasing energy needed for the tripping event to the tripping assembly; and the tripping frame (7) and the tripping axle (3) are arranged to turn from their tensioned positions to their trip positions, and while doing so, to turn to opposite directions with respect to one another.



WO 2009/153396 A1

Tripping assembly for switching device

Background of the invention

[0001] The invention relates to a tripping assembly for a switching device according to the preamble of the independent claim 1.

[0002] A switching device is a device with contact means for selectively providing an open state and a closed state in an electric circuit. An open position of the contact means is arranged to provide the open state of the electric circuit, and a closed position of the contact means is arranged to provide the closed state of the electric circuit. The switching device may be provided with a tripping assembly, which is functionally connected to the contact means of the switching device in such a manner that a tripping event of the tripping assembly is able to change the state of the contact means of the switching device from the closed position to the open position. The tripping assembly may be arranged to be remotely controlled by an electric signal.

[0003] An example of a switching device provided with a remote tripping assembly is disclosed in European Patent 1 053 553 "Remote trip mechanism of a switch device".

Brief description of the invention

[0004] It is an object of the invention to provide a new type of tripping assembly for a switching device. The tripping assembly according to the invention is characterized by what is said in the independent claim. Preferred embodiments of the invention are disclosed in the dependent claims.

Brief description of the figures

[0005] The invention will now be described in greater detail in connection with the preferred embodiments and with reference to the accompanying drawings, in which:

Figures 1 to 6 show sectional views of a controller unit of a modular switching device, comprising a tripping assembly according to an embodiment of the invention;

Figures 7A and 7B show the tripping assembly in a tensioned state;

Figures 8A and 8B show the tripping assembly in a trip state;

Figure 9 shows a diagram, in which the positions of the most significant components of the controller unit according to Figures 1 to 6 are shown in different modes;

Figure 10 shows the control unit of Figure 1 provided with a body part, and

Figure 11 shows a functional connection between a tripping axle and an operating axle.

Detailed description of the invention

[0006] The tripping assembly of the invention has a trip state and a tensioned state. In a tensioning event the tripping assembly is arranged to transfer from the trip state to the tensioned state and in a tripping event from the tensioned state to the trip state. The tripping assembly is arranged to be functionally connected to the contact means of the switching device in such a manner that the tripping event of the tripping assembly is able to change the state of the contact means of the switching device from a closed position to an open position.

[0007] Figures 1 to 6 show sectional views of different modes of a controller unit of the switching device comprising the tripping assembly according to an embodiment of the invention. The operation of the tripping assembly shown in Figures 7A, 7B, 8A and 8B corresponds to that of the tripping assembly of the controller unit in Figures 1 to 6. To understand the invention, it is useful to examine Figures 7A, 7B, 8A and 8B together with Figures 1 to 6.

[0008] The controller unit according to Figures 1 to 6 comprises a tripping axle 3, a tripping frame 7, two tripping springs 5, an operating axle 4, a connecting member 2, a control axle 1 and connecting means. The controller unit also comprises a frame spring 17 and locking means 6 and 10, which are omitted from Figures 1 to 6 but shown in Figures 7A, 7B, 8A and 8B. A tripping event is started by releasing the locking means in a manner shown later. All components are mounted in the body part, which is omitted from Figures 1 to 6 but shown in Figure 10. Figure 10 shows a controller unit, in which the components of Figure 1 are mounted in the body part 200.

[0009] The tripping axle 3 is arranged to turn between a trip position and a tensioned position in relation to the body part. The tripping frame 7 is arranged to turn between a trip position and a tensioned position in relation to the body part. The operating axle 4 is arranged to turn between an open position and a closed position in relation to the body part. The turning axes of the tripping axle 3, tripping frame 7 and operating axle 4 substantially converge, which means that the tripping axle 3, the tripping frame 7 and the operating axle 4 are mounted at the body part substantially coaxially.

[0010] Each tripping spring 5 is a pressure spring, one end of which is connected to the tripping frame 7 and the other end is connected to the tripping axle 3. Each tripping spring 5 has a non-tensioned state and a tensioned state. In the tensioned state, more energy is stored in the tripping spring 5 than in the non-tensioned state, and when the tripping spring 5 transfers from the tensioned state to the non-tensioned state, it is able to impart energy.

[0011] The frame spring 17 is a pressure spring, which is connected between the body part and the tripping frame 7 and has a non-tensioned and tensioned state.

[0012] The operating axle 4 is arranged to be connected to the main axis of the switching device in such a manner that the open position of the operating axle 4 corresponds to the open position of the contact means of the switching device and the closed position of the operating axle 4 corresponds to the closed position of the contact means. In Figures 1, 3, 4, 5 and 6, the operating axle 4 is in the open position, and in Figure 2 the operating axle 4 is in the closed position. The contact means of the switching device are not shown in the figures.

[0013] The connecting member 2 is a sleeve-like member, which is arranged to be turnable between the trip position and the tensioned position in relation to the body part. The connecting member 2 is supported so that it is not able to move axially in relation to the body part. The connecting member 2 is arranged to functionally connect the tripping axle 3 and the tripping frame 7 both in the final stage of a tensioning event and in the initial stage of a tripping event so that in these cases the tripping axle 3 and the tripping frame 7 turn in the opposite directions in relation to one another.

[0014] The connecting member 2 is functionally connected to the tripping axle 3 by providing the connecting member 2 with a plurality of connecting member teeth 29 and providing the tripping axle 3 with a plurality of tripping axle teeth 39, and by setting the connecting member 2 and the tripping axle 3 to such a position with respect to each other that the connecting member teeth 29 and the tripping axle teeth 39 are in a cogwheel connection with one another.

[0015] The connecting member 2 is functionally connected to the tripping frame 7 by providing the connecting member 2 with a turn tooth 38 and providing the tripping frame 7 with a turn projection 78, and by setting the connecting member 2 and the tripping frame 7 to such a position with respect to

each other that the turn tooth 38 of the connecting member and the turn projection 78 of the tripping frame 7 are able to transmit torque between the connecting member 2 and the tripping frame 7 in the final stage of the tensioning event and in the initial stage of the tripping event. The turn tooth 38 and the turn projection 78 are shown in Figures 7A, 7B, 8A and 8B.

[0016] The control axle 1 is arranged to be turnable about its turning axis in relation to the body part, the turning axis being perpendicular to the turning axis of the operating axle 4. The control axle 1 is mounted coaxially to the connecting member 2. The control axle 1 has four positions: test position, off-position, trip position and on-position. The functional connection between the control axle 1 and the operating axle 4 is implemented in a manner described in publication WO 2005076302 "Switching device". The control axle 1 is thus arranged to turn the operating axle 4 by means of an actuator 11.

[0017] The control axle 1 extends through the operating axle 4 in a manner known to a person skilled in the art from the above mentioned publications WO 2005076302 and WO 2005069323 "Switching device", for example. The turning axes of the operating axle 4 and control axle 1 intersect.

[0018] A control handle, by which the user of the switching device may turn the control axle 1 manually, may be fastened to the control axle 1. Alternatively, a control motor capable of turning the control axle 1 may be connected to the control axle 1. It is also possible to use a combination of a control handle and a control motor. Figures 1 to 6 do not show a control handle or a control motor.

[0019] The control axle 1 and the connecting member 2 are functionally connected to one another through connecting means. The connecting means comprise a connecting pin 9, a spring 18 of the connecting pin and counterpart means formed on the outer surface of the control axle 1. The connecting means are in certain operating situations arranged to connect the control axle 1 to the connecting member 2 so that they rotate together coupled to one another, and in other operating situations they are arranged to allow the rotation of the control axle 1 and the connecting member 2 with respect to one another.

[0020] In Figures 1 to 6, part of the connecting member 2, tripping frame 7 and tripping axle 3 has been cut away for better illustrating the connecting means. A person skilled in the art understands that the entire tripping frame 7 is substantially symmetrical in that the tripping frame 7 surrounds the

tripping springs 5 peripherally. Accordingly, the entire connecting member 2 surrounds the control axle 1 peripherally from all sides.

[0021] The connecting pin 9 is an elongated member, which is mounted in a pin hole in the connecting member 2, the pin hole being parallel to the rotational axes of the control axle 1 and connecting member 2. The connecting pin 9 comprises a first contact member 91 and a second contact member 92, each of which is a radially inwards extending projection arranged to co-operate with the counterpart means.

[0022] The connecting pin 9 is able to axially move in the pin hole between the first position and the second position in relation to the connecting member 2. Since the connecting member 2 is in an axially fixed position in relation to the control axle 1, the connecting pin 9 is also able to move axially between the first position and the second position in relation to the control axle 1.

[0023] The spring 18 of the connecting pin is a helical spring, which is arranged to exert an axial force to the connecting pin 9, tending to transfer the connecting pin 9 from the second position to the first position. In Figures 1 to 6, the first position of the connecting pin 9 is an axially lower position and the second position is an axially upper position, whereby the spring 18 of the connecting pin is arranged to press the connecting pin 9 axially downwards. The body part supports the upper end of the spring 18 of the connecting pin, thus producing a counterforce to the force exerted by the connecting pin 9 to the spring 18 of the connecting pin.

[0024] The counterpart means are formed on the circumference of the control axle 1, and they comprise guide members 42, 44, 46, 48 and a guide opening 49. The counterpart means are arranged to co-operate with the connecting pin 9 to selectively connect the control axle 1 and the connecting member 2.

[0025] The guide members 42, 44, 46 and 48 are projections extending in the direction of the circumference on the outer surface of the control axle 1. The guide members 42 and 44 extend axially at a distance from one another so that a guide groove 43 is formed between them. In the direction of the circumference, the guide members 42 and 44 are equally long. In the direction of the circumference, the first end and second end of the guide member 42 are at the same locations as the first and second end of the guide member 44.

[0026] The guide members 46 and 48 extend axially at a distance from one another so that a guide groove 47 is formed between them. In the di-

rection of the circumference, the guide members 46 and 48 are equally long. In the direction of the circumference, the first end and second end of the guide member 46 are at the same locations as the first and second end of the guide member 48. The guide members 46 and 48 resemble each other in other respects, too, and thus the higher guide member 48 in Figures 1 to 6 may be regarded as a copy of the lower guide element 46.

[0027] In the direction of the circumference, the guide members 42 and 44 are at a distance from the guide members 46 and 48 so that a guide opening 49 is formed between them. In Figures 1 to 6, the guide members 46 and 48 are located clockwise to the guide opening 49, i.e. on the left-hand side of the guide opening 49, and the guide members 42 and 44 are located anti-clockwise to the guide opening 49, i.e. on the right-hand side of the guide opening 49. In the axial direction, the guide member 42 is below the guide member 46 and the guide member 44 is between the guide members 46 and 48.

[0028] The width of the guide member 44, i.e. the dimension parallel to the turning axis of the control axle 1, equals to the width of the guide member 46 and 48. The guide member 42 is wider than the guide members 44, 46 and 48. The width of the guide groove 43 and that of the guide groove 47 are substantially equal to the width of the guide members 44, 46 and 48.

[0029] The diagram of Figure 9 shows the positions of the control axle 1, operating axle 4, tripping assembly and connecting pin 9 in different modes of the controller unit, and shifts of the controller unit between the different modes. In the diagram of Figure 9, a manual shift from one mode to another is illustrated by a continuous arrow, whereas shifts from one mode to another caused by a tripping event are illustrated by discontinuous arrows. Each mode is marked with a mode code comprising four mode symbols separated by hyphens ' - '.

[0030] The first mode symbol of each mode code represents the position of the control axle 1. The first mode symbol may obtain the value '0', when the control axle 1 is in the off-position, the value 'I', when the control axle 1 is in the on-position, the value 'II', when the control axle 1 is in the trip position, and the value 'III', when the control axle 1 is in the test position.

[0031] The second mode symbol represents the position of the operating axle 4. The second mode symbol may obtain the value '0', when the operating axle 4 is in the open position, and the value 'I', when the operating

axle 4 is in the closed position. When the operating axle 4 is connected to the contact means of the switching device in order to control them, the value '0' of the second mode symbol corresponds to the open position of the contact means and the value '1' corresponds to the closed position of the contact means.

[0032] The third mode symbol represents the state of the tripping assembly. The third mode symbol may obtain the value '0', when the tripping assembly is in the trip state, and the value '1', when the tripping assembly is in the tensioned state.

[0033] When the tripping assembly is in the trip state, the frame spring 17 is in the non-tensioned state, the tripping frame 7 in the trip position, the tripping springs 5 in the non-tensioned state, the tripping axle 3 in the trip position, and the connecting member 2 in the trip position. Accordingly, when the tripping assembly is in the tensioned state, the frame spring 17 is in the tensioned state, the tripping frame 7 in the tensioned position, the tripping springs 5 in the tensioned state, the tripping axle 3 in the tensioned position, and the connecting member 2 in the tensioned position.

[0034] The fourth mode symbol represents the position of the connecting pin 9. The fourth mode symbol may obtain the value 'I', when the connecting pin 9 is in its first position, and the value 'II', when the connecting pin 9 is in its second position.

[0035] Let us next examine the positions of the controller unit parts in different modes with reference to Figures 1 to 6 and to the diagram of Figure 9.

[0036] In Figure 1, the controller unit is in the mode 0-0-0-I, whereby the control axle 1 is in the off-position, the operating axle 4 in the open position, the tripping assembly in the trip state, and the connecting pin 9 in the first position.

[0037] In Figure 2, the controller unit is in the mode I-I-I-II, whereby the control axle 1 is in the on-position, the operating axle 4 in the closed position, the tripping assembly in the tensioned position and the connecting pin 9 in the second position. For the tripping assembly, the shift from the mode of Figure 1 to the mode of Figure 2 is a tensioning event.

[0038] The shift from the mode 0-0-0-I of Figure 1 to the mode I-I-I-II of Figure 2 is carried out by turning the control axle 1 90° clockwise, i.e. from the off-position to the on-position. The connecting member 2 turns along with

the control axle 1 90° clockwise, i.e. from its trip position to its tensioned position. The tripping axle 3 turns from its trip position to its tensioned position due to the cogwheel connection between the connecting member teeth 29 and the tripping axle teeth 39.

[0039] In the initial stage of the tensioning event, the tripping frame 7 tends to rotate clockwise with the tripping axle 3, because the tripping axle 3 exerts a torque to the tripping frame 7 via the tripping springs 5. However, the tripping frame 7 is not allowed to rotate clockwise from its trip position, because the body part prevents the tripping frame from rotating clockwise by exerting a supporting force to it. Thus, the tripping axle 3 turns in relation to the tripping frame 7, and the tripping springs 5 are compressed.

[0040] In the final stage of the tensioning event, the tripping frame 7 turns anticlockwise from its trip position to its tensioned position, pressing the frame spring 17 to the tensioned state. The tripping axle 3 and the tripping frame 7 thus turn to opposite directions with respect to one another. The tripping frame 7 turns to the tensioned position as a result of the co-operation of the turn tooth 38 in the connecting member 2 and the turn projection 78 in the tripping frame 7. The turn tooth 38 and the turn projection 78 are shown in Figures 7A, 7B, 8A and 8B, as was stated above.

[0041] In the tensioning event, the tripping springs 5 transfer from the non-tensioned state to the tensioned state. When the tripping springs transfer from their non-tensioned state to their tensioned state, they pass by their dead point where they do not tend to turn the tripping axle 3 in relation to the tripping frame 7. In their tensioned state, the tripping springs 5 actually tend to turn the tripping axle 3 clockwise and the tripping frame 7 anticlockwise. The tensioned state of the tripping springs 5 is close to the dead point, wherein the torques exerted by the tripping springs 5 to the tripping axle 3 and the tripping frame 7 are relatively small.

[0042] In an alternative embodiment of the invention, the tripping springs are arranged to be in their tensioned state at the dead point. In another alternative embodiment, the tripping springs are in their tensioned state arranged to be on that side of their dead point where they tend to turn the tripping axle towards its trip position.

[0043] As described above, the connecting member 2 turns along with the control axle 1 when the mode changes from 0-0-0-I to I-I-I-II. The connecting member 2 turns with the control axle 1 as a result of the co-operation

of the first contact member 91 and second contact member 92 of the connecting pin with counter surfaces 491 and 492. The first counter surface 491 and the second counter surface 492 can be seen in Figures 3 and 4. The first counter surface 491 is formed by the perimetral end of the guide member 42, and the second counter surface 492 is formed by the perimetral end of the guide member 44.

[0044] When the control axle 1 is turned from the off-position to the on-position, the operating axle 4 turns from its open position to the closed position by means of the actuator 11. Figure 2 shows that when the operating axle 4 turns from the open position to the closed position, it is arranged to be in contact with the connection pin 9 by means of a pin transferring projection 140 in order to transfer it from the first position to the second position. In other words, a little before the operating axle 4 reaches its closed position, the pin transferring projection 140 touches the lower surface of the connecting pin 9 and lifts the connecting pin 9 to its upper position while the operating axle 4 reaches its closed position.

[0045] The movement of the connecting pin 9 from its first position to its second position pushed by the pin transferring projection 140 of the operating axle 4 is possible, because the connecting pin 9 is located at the guide opening 49. The guide opening 49 allows the axial movement of the connecting pin 9 between the first and the second position.

[0046] The shift from the mode I-I-I-II of Figure 2 to the mode 0-0-I-I of Figure 3 is carried out by turning the control axle 1 90° anticlockwise, i.e. from the on-position to the off-position. In this case, the tripping assembly remains in its tensioned state, and thus the connecting member 2 also remains in its tensioned position and turns 90° clockwise in relation to the control axle 1. The operating axle 4 for its part turns to the open position and the connecting pin 9 moves to the first position. The connecting pin 9 moves to the first position, because the pin transferring projection 140 of the operating axle 4 no longer exerts force on the lower end of the connecting pin 9, whereby the spring 18 of the connecting pin 9 presses the connecting pin 9 to its lower position. Figure 3 shows that in the mode 0-0-I-I the connecting pin 9 is no longer at the guide opening 49 but at the guide members 46 and 48, and the other contact member 92 is in the guide groove 47. The connecting pin 9 has transferred to its first position while the connecting pin 9 was still at the guide opening 49.

[0047] The shift from the mode I-I-I-II of Figure 2 to the mode II-0-0-II of Figure 4 is caused by a tripping event. In this case, the frame spring 17 transfers from the tensioned state to the non-tensioned state and turns the tripping frame 7 from the tensioned position to the trip position. In the initial stage of the tripping event, the tripping axle 3 is forced to turn to the direction opposite to that of the tripping frame 7 by the connecting member 2. In the initial stage of the tripping event, the turn projection 78 of the tripping frame transmits torque to the connecting member 2 via the turn tooth 38 and the connecting member 2 transmits the torque to the tripping axle 3 by means of the cogwheel connection between the connecting member 2 and the tripping axle 3. As was stated in the description of the tripping event, the turn tooth 38 and the turn projection 78 are shown in Figures 7A, 7B, 8A and 8B.

[0048] In the beginning of the tripping event the role of the connecting member 2 is significant, because it makes the tripping axle 3 turn in relation to the tripping frame 7 to the extent that the tripping springs 5 are transferred to the other side of their dead point, so far from the dead point that the tripping springs 5 are able to turn the tripping axle 3 to its trip position.

[0049] In the tripping event, the tripping axle 3 turns the operating axle 4 directly by means of the functional connection between the tripping axle 3 and the operating axle 4. Thus, in the tripping event force is not transmitted from the tripping axle 3 to the operating axle 4 via the control axle 1. The functional connection between the tripping axle 3 and the operating axle 4 is arranged such that when the tripping axle 3 is in the tensioned position, the operating axle 4 may freely turn between the open position and the closed position without the tripping axle 3 needing to turn. An example of providing a functional connection between the tripping axle 3 and the operating axle 4 is shown in Figure 11 in a simplified manner.

[0050] When the mode changes from I-I-I-II to II-0-0-II, the control axle 1 turns to the trip position, which is in the middle of the on-position and the off-position. The trip position of the control axle 1 is thus 45° anticlockwise to the on-position and 45° clockwise to the off-position.

[0051] The control axle 1 is turned to the trip position by the operating axle 4 via the actuator 11. No torque is transmitted between the connecting member 2 and the control axle 1 when the mode changes from I-I-I-II to II-0-0-II, because in this mode shift the first contact member 91 of the connecting pin

9 glides in the guide groove 43 and the second contact member 92 of the connecting pin 9 glides on the upper surface of the guide member 44.

[0052] The shift from the mode II-0-0-II of Figure 4 to the mode 0-0-0-I of Figure 1 is carried out by turning the control axle 1 45° anticlockwise, i.e. from the trip position to the off-position. The turning of the control axle 1 from the trip position to the off-position has no effect on the position of the operating axle 4 or the state of the tripping assembly. Instead, the connecting pin 9 transfers from its second position to its first position after reaching the guide opening 49.

[0053] The shift from the mode 0-0-I-I of Figure 3 to the mode 0-0-0-I of Figure 1 is caused by a tripping event. For the tripping assembly, such a mode shift is identical with the above described shift between the modes I-I-I-II and II-0-0-II. The control axle 1 remains in its off-position and the connecting member 2 turns 90° anticlockwise to it. The connecting pin 9 remains in its first position.

[0054] The shift from the mode 0-0-I-I of Figure 3 to the mode III-0-I-I of Figure 5 is carried out by turning the control axle 1 45° anticlockwise from the off-position, whereupon the control axle 1 reaches the test position. This mode shift has no effect on the position of the operating axle 4 or the state of the tripping assembly. The connecting member 2 turns 45° clockwise in relation to the control axle 1 as the second contact member 92 of the connecting pin 9 glides in the guide groove 47.

[0055] The shift from the mode III-0-I-I of Figure 5 to the mode III-0-0-I of Figure 6 is caused by a tripping event. For the tripping assembly, this mode shift is identical with the above described shift between the modes I-I-I-II and II-0-0-II. The control axle 1 remains in its test position and the connecting member 2 turns 90° anticlockwise to it. The connecting member 9 remains in its first position.

[0056] The shift from the mode III-0-0-I of Figure 6 to the mode 0-0-0-I of Figure 1 is carried out by turning the control axle 1 45° clockwise, whereupon the control axle 1 reaches the off-position. The shift between these modes has no effect on the position of the operating axle 4 or the state of the tripping assembly. The connecting member 2 turns 45° anticlockwise to the control axle 1. The connecting pin 9 is in the guide opening 49 during the whole time of the mode shift.

[0057] A person skilled in the art understands that the shift from the mode 0-0-0-I to the mode III-0-0-I occurs in reverse order as the shift from the mode III-0-0-I to the mode 0-0-0-I. Accordingly, the shift from the mode 0-0-I-I to the mode I-I-I-II occurs in reverse order as the shift from the mode I-I-I-II to the mode 0-0-I-I, and the shift from the mode III-0-I-I to the mode 0-0-I-I occurs in reverse order as the shift from the mode 0-0-I-I to the mode III-0-I-I. The reciprocity of these three mode shifts is illustrated in the diagram of Figure 9 by bidirectional arrows.

[0058] When the control axle 1 is in the test position shown in Figures 5 and 6, a test function of the switching device may be achieved, which is known to a person skilled in the art from publication WO 2005076302, for example.

[0059] The mode I-0-0-II shown in the diagram of Figure 9 is an unstable state, which only occurs when the user holds the handle of the control axle 1 during the tripping event. When the user lets go of the handle, the control axle 1 turns to its trip position, forced by a non-shown spring. The operation of this spring is described in publication WO 2005076302.

[0060] The controller unit of Figures 1 to 6 and 10 is a modular controller unit of the switching device. In addition to a controller module, the modular switching device comprises one or more non-shown contact modules, which comprise the contact means of the switching device. Forces that are necessary for changing the state of the contact means are transmitted from the controller module to one or more contact modules by the operating axle 4. The modular switching device is known to a person skilled in the art from publication WO 2005069324 "Modular switching device", for example.

[0061] In the modular switching device, the controller unit and each contact module comprise their own body parts. The tripping assembly of the invention may also be used in an integrated switching device, which means that the tripping assembly may be mounted in the same body part as the contact means.

[0062] Let us next examine the tripping assembly shown in Figures 7A, 7B, 8A and 8B. As stated above, the tripping assembly of these figures operates in the same manner as the tripping assembly shown in Figures 1 to 6. In Figures 7A and 7B, the tripping assembly is in a tensioned state, its mode corresponding to that of the tripping assembly of the controller units according to Figures 2, 3 and 5. In Figures 8A and 8B, the tripping assembly is in a trip

state, its mode corresponding to that of the tripping assembly of the controller units according to Figures 1, 4 and 6. The shift from the situation of Figures 7A and 7B to the situation of Figures 8A and 8B is caused by a tripping event.

[0063] The tripping assembly of Figures 7A, 7B, 8A and 8B comprises a tripping axle 3, a tripping frame 7, a frame spring 17, a connecting member 2 and locking means. The tripping assembly also comprises two non-shown tripping springs, the location and operation of which are identical with those of the tripping springs of the tripping assembly of the controller unit according to Figures 1 to 6.

[0064] The tripping assembly of Figures 7A, 7B, 8A and 8B is arranged to be connected to the main axis (not shown) of the switching device by means of the tripping axle 3. In this case, the tensioning of the tripping assembly is carried out by turning the main axis of the switching device to the closed position. In the tripping event, respectively, the tripping axle 3 turns the main axis of the switching device via the functional connection between the tripping axle 3 and the main axis of the switching device. The functional connection between the tripping axle and the main axis of the switching device may be fixed, or it may be arranged to be similar to the functional connection between the tripping axle 3 and the operating axle 4, shown in Figure 11. In that case, when the tripping axle is in the tensioned position, the main axis of the switching device may freely turn between the open position and the closed position without the tripping axle needing to turn. The tripping assembly of Figures 7A to 8B may practically be mounted in any switching device with a main axis.

[0065] The locking means have a locking state and a trip state. In the locking state according to Figures 7A and 7B, the locking means lock the tripping assembly to the tensioned state. The tripping event is started by releasing the locking means in such a manner that they allow the tripping assembly to shift from their tensioned state to the trip state. When the tripping event ends, the locking means are in the trip state according to Figures 8A and 8B.

[0066] The locking means comprise a locking lever 6 and a locking clamp 10, each of which has a locking position and a trip position. When the locking means are in the locking state, the locking lever 6 and the locking clamp 10 are in the locking position. When the locking means are in the trip state, the locking lever 6 and the locking clamp 10 are in the trip position.

[0067] The locking lever 6 is an elongated member, which is pivoted at a pivot point 61 to the tripping frame 7 in such a manner that the turning axis of the locking lever 6 is parallel to the turning axis of the tripping frame 7 and is located at a distance therefrom. The locking lever 6 has a longer lever arm part extending from the pivot point 61 of the locking lever towards the locking clamp 10, and a shorter lever arm part extending from the pivot point 61 of the locking lever away from the locking clamp 10.

[0068] In the locking state of the locking means, a first and a second supporting force are exerted to the locking lever 6, the co-operation of which prevents the locking lever 6 from rotating about the pivot point 61 of the locking lever and in relation to the body part. The first supporting force is exerted by the body part on the shorter lever arm part of the locking lever 6, and the second supporting force is exerted by the locking clamp 10 close to the distal end of the longer lever arm part of the locking lever 6.

[0069] In its locking position, the locking clamp 10 is arranged to hold the locking lever 6 in the locking position of the locking lever and, when released, to allow the movement of the locking lever 6 from the locking position of the locking lever to the trip position of the locking lever. The locking clamp 10 comprises an elongated rectangular member, the first axial end of which is fixedly connected to the body part. When the locking clamp 10 is in the locking position, it is substantially perpendicular to both the locking lever 6 and the turning axis of the locking lever 6. The locking clamp 10 comprises a clamp opening 15, which receives the distal end of the longer lever arm part of the locking lever 6 when the locking means are in the locking state. The clamp opening 15 is on that side of the longitudinal middle point of the locking clamp 10 that is closer to the second axial end. The locking clamp 10 exerts said second supporting force on the locking lever 6 via the rim of the clamp opening 15.

[0070] In the tripping event, the shift to the trip state of the locking means is carried out by moving the second axial end of the locking clamp 10 away from the pivot point 61 of the locking lever in such a manner that the distal end of the longer lever arm part of the locking lever 6 is no longer received in the clamp opening 15. In this case, the locking clamp 10 does not exert the second supporting force close to the distal end of the longer lever arm part of the locking lever 6, thus allowing the locking lever 6 to rotate about the pivot point 61. The rotation of the locking lever 6 about the pivot point 61 allows, for

its part, the turning of the tripping frame 7 from its tensioned position to its trip position.

[0071] The locking lever 6 comprises a locking slot 65 arranged to co-operate with a locking projection 35 provided in the tripping axle 3. When the locking lever 6 is in the locking position, the locking projection 35 is in the locking slot 65, and the co-operation of the locking projection 35 and the locking slot 65 prevents the tripping axle 3 from turning away from the tensioned position. When the locking lever 6 is in the trip position, the locking projection 35 and the locking slot 65 do not co-operate, and thus the locking lever 6 allows the tripping axle 3 to turn to the trip position.

[0072] The locking clamp 10 may be arranged to be manually transferred from the locking position to the trip position by a movable knob. Alternatively or in addition, the locking clamp 10 may be arranged to be transferred from the locking position to the trip position by means of a solenoid. The figures do not show the manually movable knob or the solenoid.

[0073] The transfer of the locking clamp 10 from the locking position to the trip position requires little force, since the locking clamp 10 is located far from the pivot point 61 of the locking lever. The locking means thus utilize a lever arm.

[0074] The small amount of force required for using the locking clamp 10 is advantageous for instance in embodiments, in which the locking clamp 10 is arranged to be transferred from the locking position to the trip position by means of a solenoid. For safety reasons, the solenoid is often arranged to operate according to the holding current principle, which means that holding current must be supplied to the solenoid all the time in order to keep the locking clamp 10 in the locking position. The smaller the force required for using the locking clamp 10, the smaller the required holding current.

[0075] In the tripping assembly of Figures 7A to 8B the connecting member is sleeve-like. In embodiments where the control axle does not extend coaxially to the connecting member, the connecting member can alternatively be shaped as a cogwheel, which does not comprise an opening arranged to receive the control axle. Furthermore, the connecting member may be shaped, for instance, into an elongated bar, the turning axis of which is perpendicular to the longitudinal direction of the bar. The first end of the bar is arranged to co-operate with the tripping frame, and the second end of the bar is arranged to co-operate with the tripping axle.

[0076] It is obvious to a person skilled in the art that the basic idea of the invention may be implemented in many different ways. The invention and its embodiments are thus not restricted to the above examples, but may vary within the scope of the claims.

Claims

1. A tripping assembly for a switching device, the tripping assembly having a trip state and a tensioned state and, in a tensioning event, being arranged to transfer from the trip state to the tensioned state and, in a tripping event, from the tensioned state to the trip state, the tripping assembly being arranged to be functionally connected to contacts of the switching device in such a manner that the tripping event of the tripping assembly is able to change the state of the contacts of the switching device from a closed position to an open position, the tripping assembly being characterized in that it comprises

a body part;

a tripping axle (3) arranged to turn between a trip position and a tensioned position in relation to the body part;

a tripping frame (7) arranged to turn between a trip position and a tensioned position in relation to the body part and whose turning axis is substantially parallel to the turning axis of the tripping axle (3);

at least one tripping spring (5) which has a non-tensioned state and a tensioned state and which is functionally connected to the tripping axle (3) and to the tripping frame (7) in such a manner that when the at least one tripping spring (5) transfers from the tensioned state to the non-tensioned state, the tripping axle (3) turns in relation to the tripping frame (7);

a frame spring (17) which has a non-tensioned state and a tensioned state and which is functionally connected between the body part and the tripping frame (7); and

a connecting member (2) which is arranged to functionally connect the tripping axle (3) and the tripping frame (7) both in the final stage of a tensioning event and in the initial stage of a tripping event;

whereby in the tripping event:

both the frame spring (17) and the at least one tripping spring (5) are arranged to transfer from their tensioned state to their non-tensioned state, thus releasing energy needed for the tripping event to the tripping assembly; and

the tripping frame (7) and the tripping axle (3) are arranged to turn from their tensioned positions to their trip positions, and while doing so, to turn to opposite directions with respect to one another.

2. A tripping assembly as claimed in claim 1, characterized in that the at least one tripping spring (5) has a dead point where it does not

tend to turn the tripping axle (3) in relation to the tripping frame (7), whereby, in the tensioned state of the tripping assembly, the at least one tripping spring (5) is close to its dead point.

3. A tripping assembly as claimed in claim 2, characterized in that, in the tensioned state of the tripping assembly, the at least one tripping spring (5) is on that side of its dead point where the at least one tripping spring (5) tends to turn the tripping axle (3) away from the trip position.

4. A tripping assembly as claimed in claim 2 or 3, characterized in that in the initial stage of the tripping event the tripping frame (7) is arranged to turn the tripping axle (3) in relation to the tripping frame (7) by means of the connecting member (2) in such a manner that the tripping axle (3) reaches a position in which the at least one tripping spring (5) is able to exert a force on the tripping axle (3), sufficient to turn the tripping axle (3) to the trip position.

5. A tripping assembly as claimed in any one of claims 1 to 4, characterized in that the tripping assembly also comprises locking means which have a locking state, in which they are arranged to lock the tripping frame (7) to its tensioned position, and a trip state, in which they are arranged to allow the transfer of the tripping frame (7) from its tensioned position to its trip position.

6. A tripping assembly as claimed in claim 5, characterized in that the locking means comprise a locking lever (6) and a locking clamp (10), the locking lever (6) being pivoted at a pivot point (61) to the tripping frame (7) in such a manner that the turning axis of the locking lever (6) is parallel to the turning axis of the tripping frame (7) and is located at a distance from it, the tripping assembly being arranged such that in the locking state of the locking means, the locking clamp (10) exerts a supporting force on the locking lever (6) to hold the locking lever (6) in the locking position, and the tripping event is started by transferring the locking clamp (10) in relation to the locking lever (6) in such a manner that said supporting force is eliminated.

7. A tripping assembly as claimed in claim 5 or 6, characterized in that in their locking state the locking means are also arranged to lock the tripping axle (3) in its tensioned position.

8. A tripping assembly as claimed in any one of the preceding claims, characterized in that the tripping axle (3) is arranged to be functionally connected to the contacts of the switching device in such a manner

that in the tensioned position of the tripping axle (3), the state of the contact means of the switching device may be changed between the closed position and the open position while the tripping axle (3) remains in the tensioned position.

Fig. 1

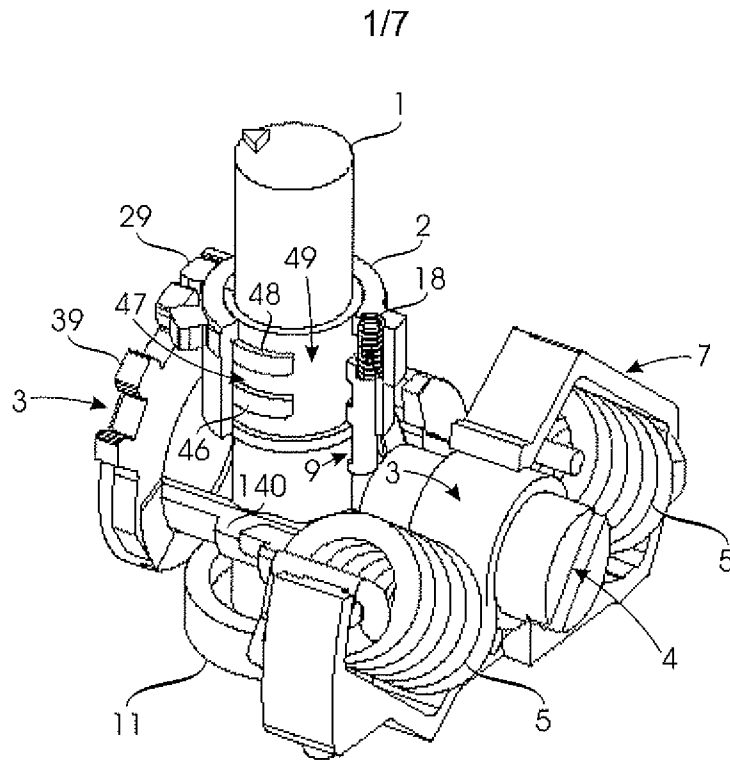

Fig. 2

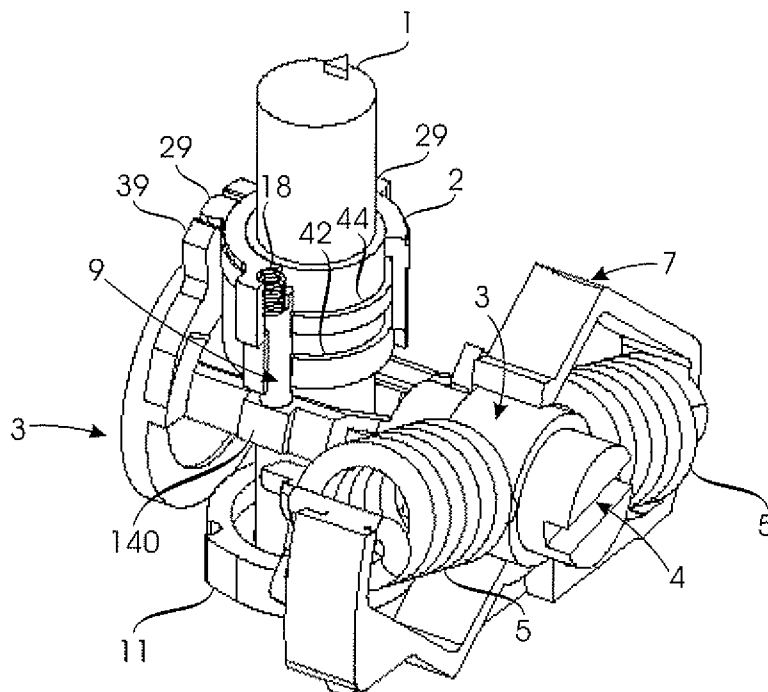

Fig.3

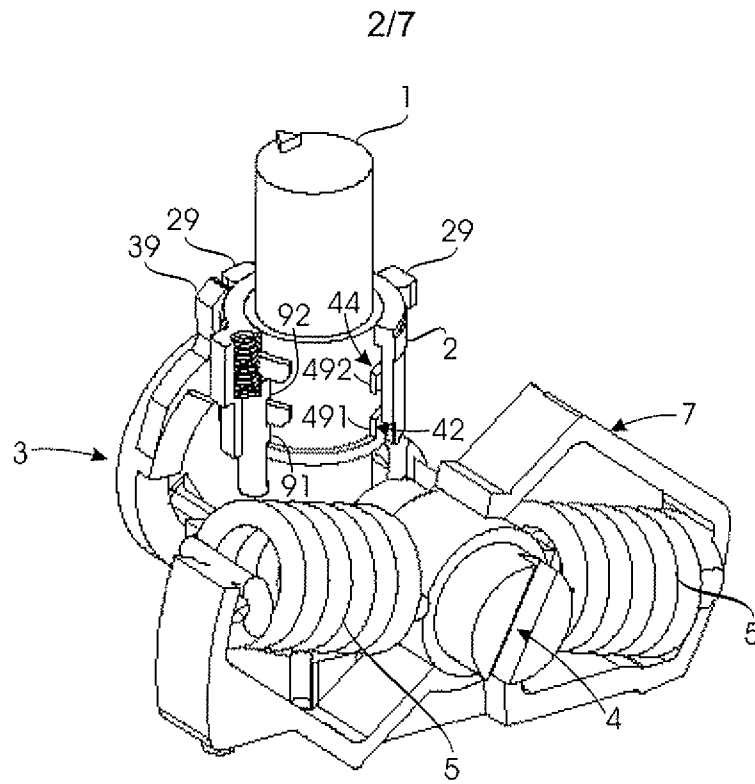
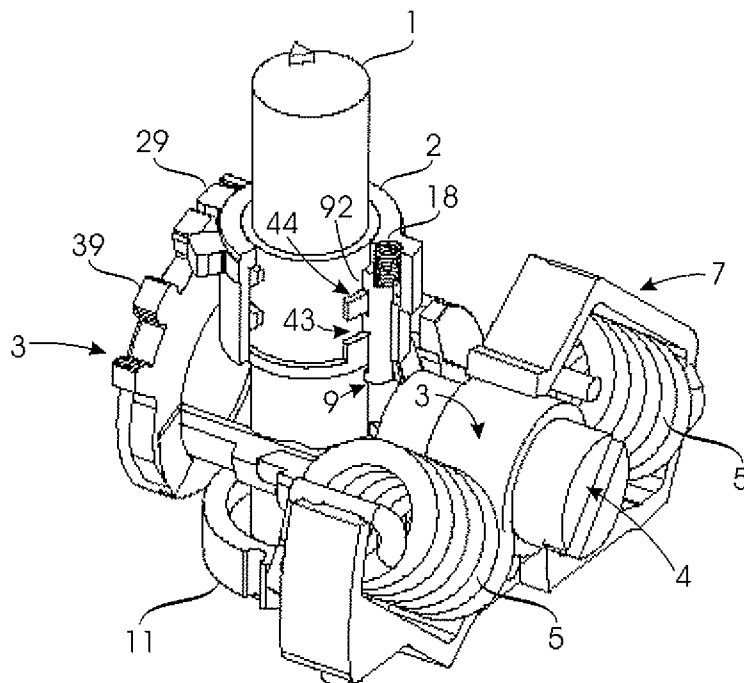

Fig.4



3/7

Fig.5

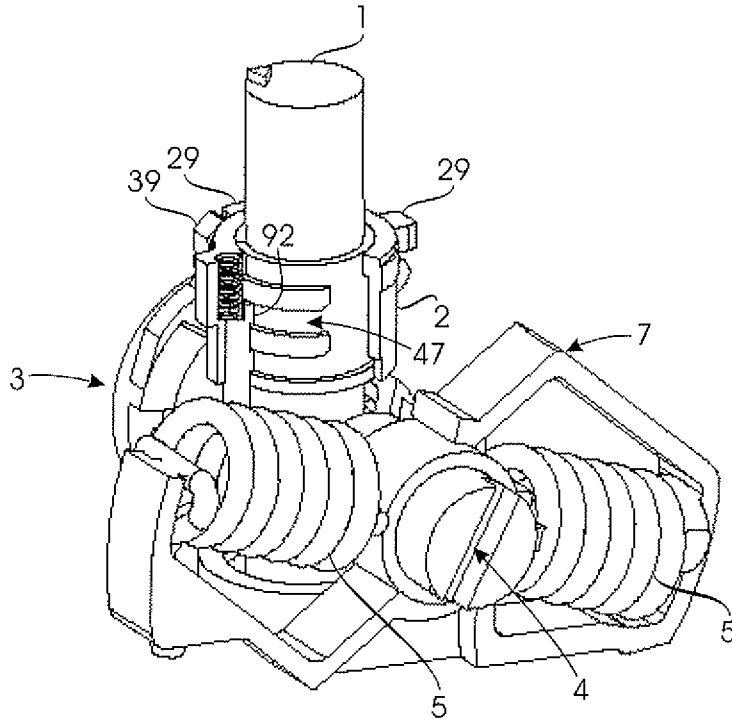

Fig.6

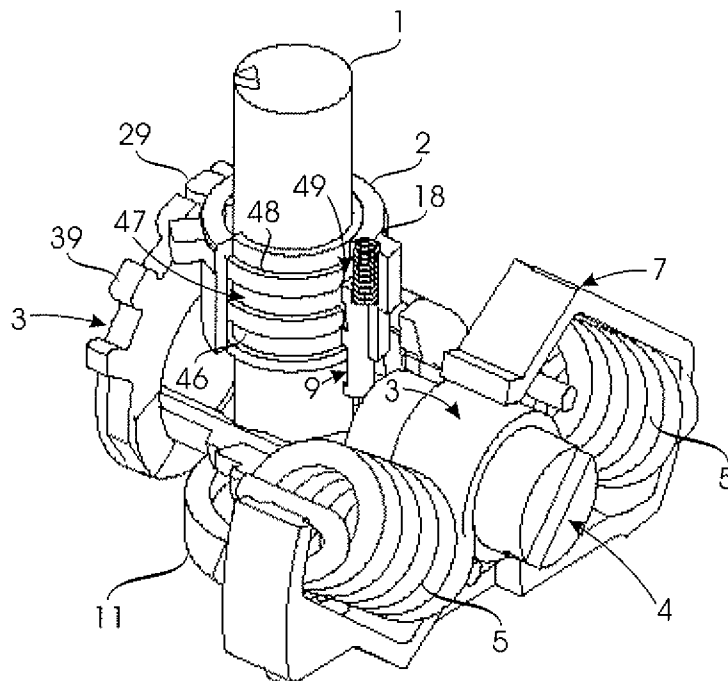

Fig. 7A

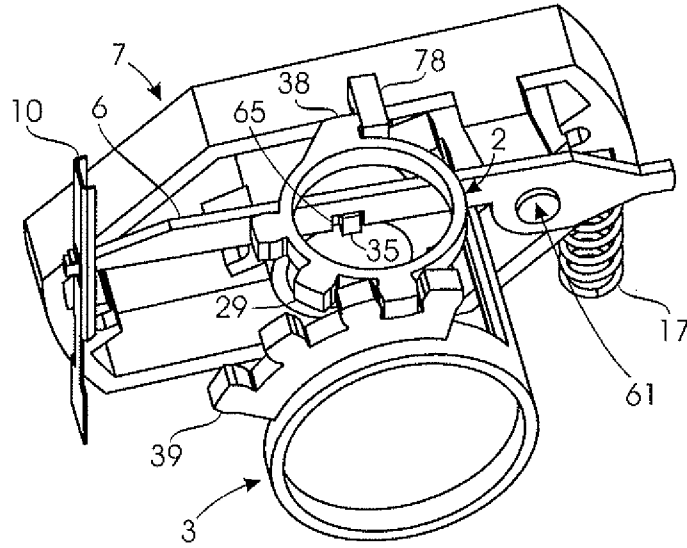
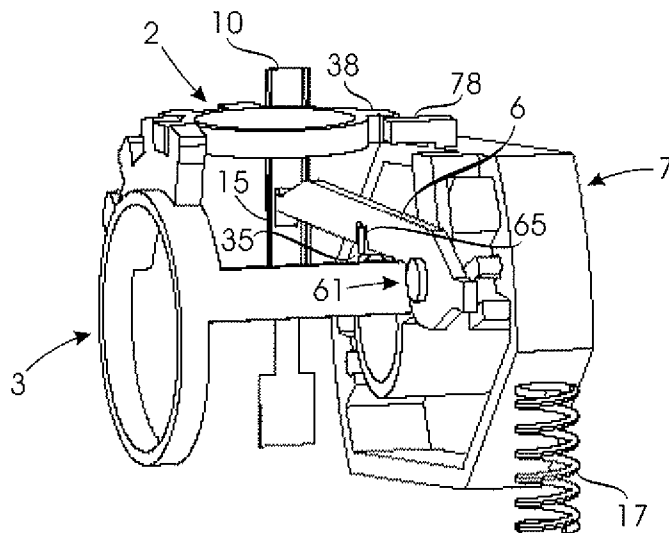

Fig. 7B



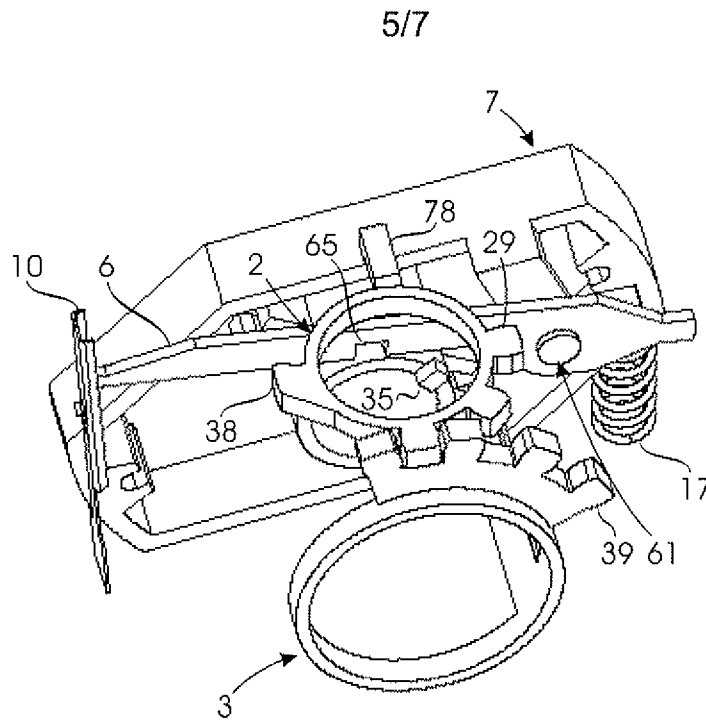

Fig. 8A

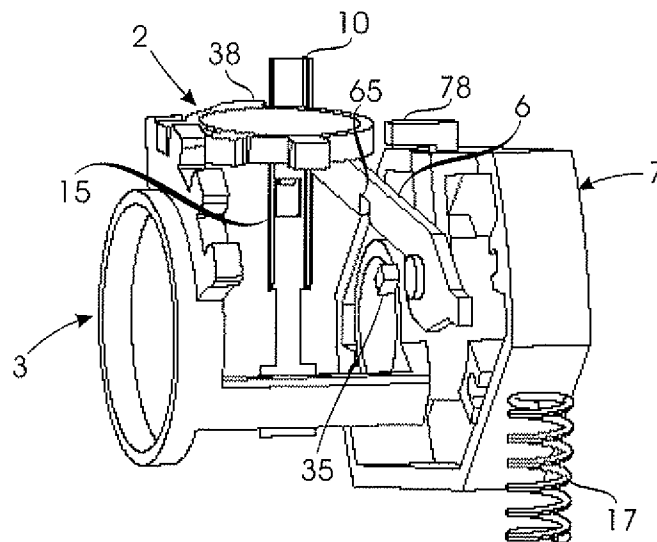
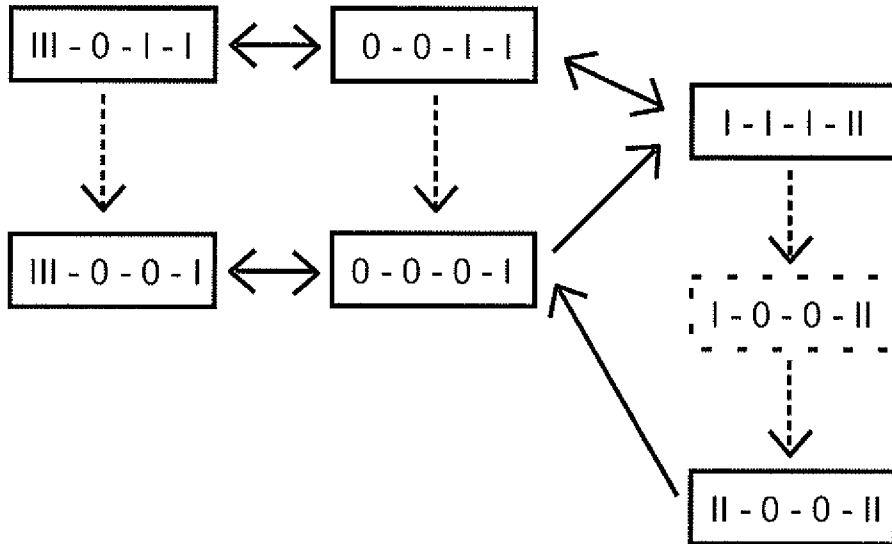

Fig. 8B

Fig.9



→ =Manual control
-----> =Tripping function

Fig. 10

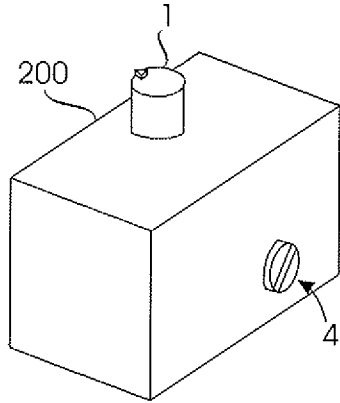
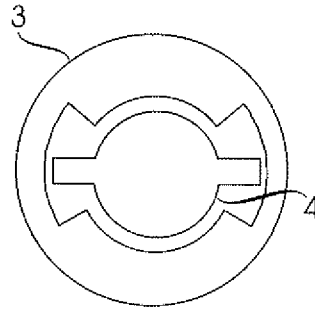

Fig. 11



INTERNATIONAL SEARCH REPORT

International application No.

PCT/FI2009/050512

A. CLASSIFICATION OF SUBJECT MATTER

See extra sheet

According to International Patent Classification (IPC) or to both national classification and IPC

B. FIELDS SEARCHED

Minimum documentation searched (classification system followed by classification symbols)

IPC: H01H

Documentation searched other than minimum documentation to the extent that such documents are included in the fields searched

FI, SE, NO, DK

Electronic data base consulted during the international search (name of data base and, where practicable, search terms used)

EPODOC, WPI, TXTE

C. DOCUMENTS CONSIDERED TO BE RELEVANT

Category*	Citation of document, with indication, where appropriate, of the relevant passages	Relevant to claim No.
A	US 2007131528 A1 (MATTLAR HARRI et al.) 14 June 2007 (14.06.2007), abstract, Figs. 4 - 6	1-8
A	US 6501039 B1 (MATTLAR HARRI et al.) 31 December 2002 (31.12.2002), abstract; Figs 1 - 3	1-8

 Further documents are listed in the continuation of Box C.

 See patent family annex.

* Special categories of cited documents:

"A" document defining the general state of the art which is not considered to be of particular relevance

"E" earlier application or patent but published on or after the international filing date

"L" document which may throw doubts on priority claim(s) or which is cited to establish the publication date of another citation or other special reason (as specified)

"O" document referring to an oral disclosure, use, exhibition or other means

"P" document published prior to the international filing date but later than the priority date claimed

"T" later document published after the international filing date or priority date and not in conflict with the application but cited to understand the principle or theory underlying the invention

"X" document of particular relevance; the claimed invention cannot be considered novel or cannot be considered to involve an inventive step when the document is taken alone

"Y" document of particular relevance; the claimed invention cannot be considered to involve an inventive step when the document is combined with one or more other such documents, such combination being obvious to a person skilled in the art

"&" document member of the same patent family

Date of the actual completion of the international search

04 September 2009 (04.09.2009)

Date of mailing of the international search report

07 October 2009 (07.10.2009)

Name and mailing address of the ISA/FI
National Board of Patents and Registration of Finland
P.O. Box 1160, FI-00101 HELSINKI, Finland

Facsimile No. +358 9 6939 5328

Authorized officer
Jorma Lehtonen

Telephone No. +358 9 6939 500

INTERNATIONAL SEARCH REPORT
Information on patent family members

International application No.
PCT/FI2009/050512

Patent document cited in search report	Publication date	Patent family members(s)	Publication date
US 2007131528 A1	14/06/2007	CN 1914703 A	14/02/2007
		EP 1719142 A1	08/11/2006
		CA 2554290 A1	18/08/2005
		WO 2005076302 A1	18/08/2005
		FI 20045026 A	04/08/2005
.....			
US 6501039 B1	31/12/2002	ES 2264251T T3	16/12/2006
		DE 69931147T T2	08/02/2007
		AT 325421T T	15/06/2006
		WO 9940595 A1	12/08/1999
		EP 1053553 A1	22/11/2000
		CN 1289444 A	28/03/2001
		CA 2316801 A1	12/08/1999
		FI 980243 A	04/08/1999
.....			

CLASSIFICATION OF SUBJECT MATTER

Int.Cl.

H01H 3/30 (2006.01)

H01H 19/24 (2006.01)

H01H 33/40 (2006.01)