



## INTERNATIONAL APPLICATION PUBLISHED UNDER THE PATENT COOPERATION TREATY (PCT)

<b>(51) International Patent Classification <sup>5</sup>:</b>  <b>H02J 7/00</b>	<b>A1</b>	<b>(11) International Publication Number:</b> <b>WO 94/16489</b>  <b>(43) International Publication Date:</b> 21 July 1994 (21.07.94)
<b>(21) International Application Number:</b> PCT/US93/10407  <b>(22) International Filing Date:</b> 27 October 1993 (27.10.93)  <b>(30) Priority Data:</b> 08/005,101                      15 January 1993 (15.01.93)                      US  <b>(71) Applicant:</b> HUBBELL INCORPORATED [US/US]; 584 Derby Milford Road, P.O. Box 549, Orange, CT 06477-4024 (US).  <b>(72) Inventor:</b> HOFFMAN, Ernest, G.; 33 Stowe Street, Middlefield, CT 06455 (US).  <b>(74) Agents:</b> GOODMAN, Alfred, N.; 1225 Connecticut Avenue, N.W., Suite 315, Washington, DC 20036 (US) et al.		<b>(81) Designated States:</b> CA, JP, KR, European patent (AT, BE, CH, DE, DK, ES, FR, GB, GR, IE, IT, LU, MC, NL, PT, SE).  <b>Published</b> <i>With international search report.</i> <i>With amended claims.</i>

**(54) Title:** ELECTRIC VEHICLE CHARGING STATION**(57) Abstract**

An electric vehicle charging station (10) for recharging an electric vehicle which is safe and convenient. The charging station (10) has a base unit (12) with a control box (22) electrically coupled to an electrical power line (20), and a retractable support arm assembly (18) with an electrical connector (16) coupled thereto for movement between a retracted position and an extended position. The support arm assembly (18) includes various support arms and/or linkages which provide limited degrees of vertical movement and horizontal movement.

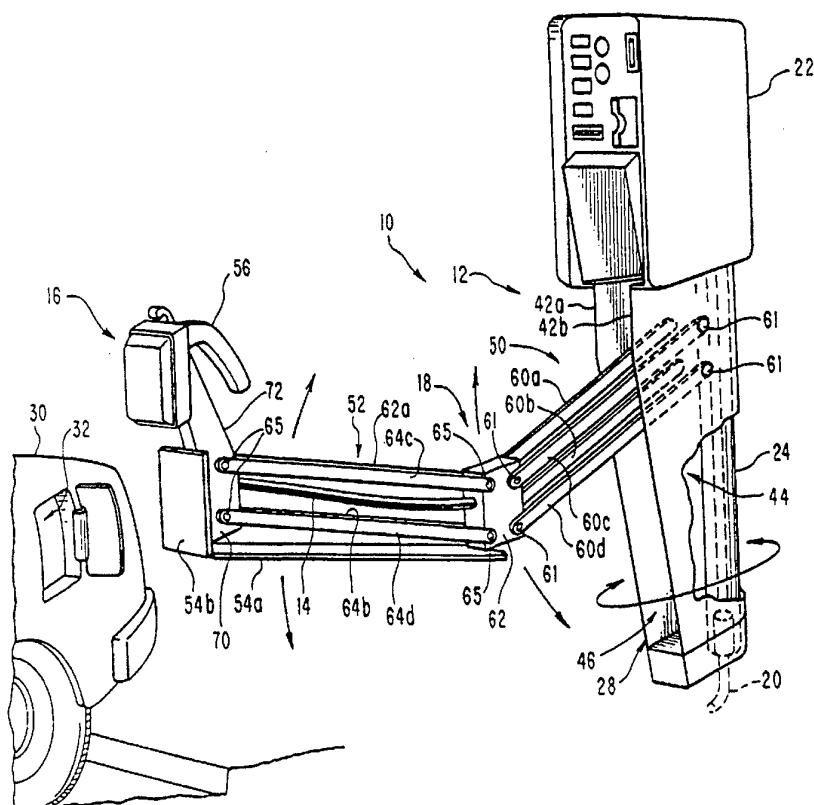

**FOR THE PURPOSES OF INFORMATION ONLY**

Codes used to identify States party to the PCT on the front pages of pamphlets publishing international applications under the PCT.

AT	Austria	GB	United Kingdom	MR	Mauritania
AU	Australia	GE	Georgia	MW	Malawi
BB	Barbados	GN	Guinea	NE	Niger
BE	Belgium	GR	Greece	NL	Netherlands
BF	Burkina Faso	HU	Hungary	NO	Norway
BG	Bulgaria	IE	Ireland	NZ	New Zealand
BJ	Benin	IT	Italy	PL	Poland
BR	Brazil	JP	Japan	PT	Portugal
BY	Belarus	KE	Kenya	RO	Romania
CA	Canada	KG	Kyrgyzstan	RU	Russian Federation
CF	Central African Republic	KP	Democratic People's Republic of Korea	SD	Sudan
CG	Congo	KR	Republic of Korea	SE	Sweden
CH	Switzerland	KZ	Kazakhstan	SI	Slovenia
CI	Côte d'Ivoire	LI	Liechtenstein	SK	Slovakia
CM	Cameroon	LK	Sri Lanka	SN	Senegal
CN	China	LU	Luxembourg	TD	Chad
CS	Czechoslovakia	LV	Latvia	TG	Togo
CZ	Czech Republic	MC	Monaco	TJ	Tajikistan
DE	Germany	MD	Republic of Moldova	TT	Trinidad and Tobago
DK	Denmark	MG	Madagascar	UA	Ukraine
ES	Spain	ML	Mali	US	United States of America
FI	Finland	MN	Mongolia	UZ	Uzbekistan
FR	France			VN	Viet Nam
GA	Gabon				

Patent Application  
for  
ELECTRIC VEHICLE CHARGING STATION

Field of the Invention

This invention relates to an electric vehicle charging station for recharging electric vehicles. Specifically, the invention relates to an electric vehicle recharging station having at least one electrical conductor with an electrical connector mounted on a retractable support arm assembly which articulates in both vertical and horizontal directions.

### Background of the Invention

The number of automobiles being operated is continuing to increase which has significantly increases the worldwide air pollution problem. This air pollution problem from automobiles has prompted many countries to regulate the exhaust emissions from automobiles. In fact, the exhaust emissions standards are constantly becoming stricter each year. For example, California regulators have recently passed a law requiring 2% of all vehicles sold in California to be "zero-emissions" or electric powered by 1998. Failure to meet the new emission standard would result in significant fines to automobile manufacturers selling automobiles in California. Accordingly, automobile manufacturers' ability to sell automobiles in California will be hurt if they do not produce an automobile with zero-emissions.

In view of these increasingly stricter emission requirements, automobile manufacturers are beginning to develop electric powered vehicles. Accordingly, it will be necessary to provide the owners of the electric vehicles with a safe and easy way of recharging their batteries. Moreover, electric vehicles have a limited range of travel before requiring their batteries to be recharged. Thus, recharging stations will be needed which are conveniently located and easy to operate in substantially the same manner in which gas stations are currently available for gas powered vehicles.

One example of an electric vehicle and a recharging station for recharging the batteries of electric vehicles is disclosed in U.S. Patent No. 4,158,802 to Rose, II. The electric vehicle and the recharging station disclosed in the patent issued to Rose, II have many drawbacks. For instance, the vehicle is exposed to the environment which can cause the contacts of the electrical inlet mounted on

the vehicle to corrode. Also, the electrical contact surfaces of the vehicle and the recharging station are exposed to the driver such that the driver of the vehicle could accidentally touch one of the electric contacts and receive an electrical shock. Furthermore, this recharging station would require all electric vehicles to be manufactured within a certain range of sizes and shapes to allow its spring biased contacts to properly engage the contacts on the vehicle.

In view of the above, it is apparent that there exists a need for electrical recharging stations which will overcome the above problems of the prior art, and which are safe and convenient to operate. This invention addresses this need in the art along with other needs which will become apparent to those skilled in the art once given this disclosure.

#### Summary of the Invention

Accordingly, a primary object of the present invention is to provide an electric vehicle charging station which is safe and convenient to operate.

Another object of the present invention is to provide an electric vehicle charging station which can be located in practically any location, including both residential and commercial applications.

Another object of the present invention is to provide an electric vehicle charging station which is relatively inexpensive to construct.

Another object of the present invention is to provide an electric vehicle charging station which can be easily adapted for use with vehicles of any size or shape.

Another object of the present invention is to provide support to the electrical connector to protect it from damage.

The foregoing objects are basically attained by providing an electric vehicle charging station for recharging an electric vehicle, comprising a base structure coupled to an electrical power source; at least one electrical conductor having a first end and a second end with the first end being electrically coupled to the power source; an electrical contact coupled to the second end of the electrical conductor for electrically coupling and dispensing electrical energy to the electric vehicle; a substantially rigid support assembly movably coupled to the base structure for movably supporting the electrical contact and the electrical conductor between a retracted position and an extended position; and a control mechanism electrically coupled to the electrical power source for regulating the flow of electrical energy from the power source to the electric vehicle.

Other objects, advantages and salient features of the invention will become apparent from the following detailed description, which, taken in conjunction with the annexed drawings, discloses several preferred embodiments of the invention.

#### Brief Description of the Drawings

Referring now to the drawings which form part of this original disclosure:

Figure 1 is a partial perspective view of an electric vehicle charging station in accordance with a first embodiment of the present invention, especially designed for use in parking garages and along curbs of streets;

Figure 1A is a horizontal cross-sectional view of the electric vehicle charging station illustrated in Figure 1;

Figure 2 is an perspective view of the electric vehicle charging station of Figure 1 with the support arm in its retracted position;

-5-

Figure 3 is a schematic top plan view of the electric vehicle charging station of Figures 1 and 2 illustrating the pivotal movement of the support arm;

Figure 4 is a partial perspective view of an electric vehicle charging station in accordance with a second embodiment of the present invention, and having its support arm in its retracted position;

Figure 5 is a perspective view of the electric vehicle charging station illustrated in Figure 4 with the support arm in its extended position;

Figure 5A is a partial perspective view of a modified support arm of Figure 5 having a counterweight coupled thereto;

Figure 6 is a partial perspective view of an electric vehicle charging station in accordance with a third embodiment of the present invention especially designed for commercial application such as gas stations, and having its support arm in the retracted position;

Figure 7 is a partial perspective view of the electric vehicle charging station illustrated in Figure 6 with the support arm in its extended position and just prior to connection with an electric vehicle;

Figure 8 is a partial perspective view of a fourth embodiment of the present invention especially designed for use in residential applications;

Figure 9 is a fifth embodiment of an electric vehicle charging station in accordance with a fifth embodiment of the present invention which is also especially designed for residential applications;

Figure 10 is a partial perspective view of a sixth embodiment of an electric vehicle charging station in accordance with the present invention;

Figure 11 is a partial perspective view of a seventh embodiment of an electric vehicle charging station in accordance with the present invention;

Figure 12 is a partial perspective view of the electric vehicle charging station of Figure 11 with its electrical connector plugged into an electric vehicle; and

Figure 13 is an enlarged, partial perspective view of the post assembly of the electric vehicle charging of Figures 11 and 12.

#### Detailed Description of the Invention

Referring initially to Figures 1-3, a first embodiment of an electric vehicle charging station 10 in accordance with the present invention is illustrated, and includes a base unit structure 12 mounted at the side of a street curb, an electrical cable 14 electrically coupled at one end to base unit 12, an electrical connector 16 electrically connected to the other end of cable 14, and a retractable support arm assembly 18 movably coupled at one end to base unit 12 for supporting cable 14 and movably coupled electrical connector 16 for movement therewith.

Base unit 12 includes a control box 22 with conventional electronic circuitry, a support post 24 for supporting control box 22 above the ground, and an enclosure 28 pivotally coupled to support post 24.

Base unit 12 is electrically coupled to an electrical power line or source 20, which in turn is preferably connected to the local electrical utility company's power line or any other conventional source of electrical energy. Base unit 12 can be mounted in practically any location, including residential houses, apartment buildings, gas stations, parking garages, or even at the side of a street curb as illustrated in Figure 1 so that power can be readily available to a vehicle 30.



In commercial applications such as illustrated in Figures 1-3, base unit 12 can be constructed to use similar electronic circuitry as is currently being used in today's automated gas stations. For example, control box 22 can be provided with a conventional power meter for determining the amount of electrical energy dispensed, a credit card or debit card slot for payment of the dispensed electrical energy, and/or any other similar type of controls which are provided at automated gas stations.

Support post 24 is preferably rigidly coupled at its upper end to control box 22 and rigidly connected to the ground. Post 24 is preferably cemented into the sidewalk or parking garage. Preferably, power line 20 enters through the interior of support post 24, and is then electrically connected to control box 22 in a conventional manner.

Enclosure 28 is preferably pivotally coupled to post 24 to pivot at least approximately 180° as seen in Figure 3, and includes a tubular member 40 pivotally coupled to post 24, and a pair of parallel side panels 42a and 42b fixedly coupled to tubular member 40 along its rear edges to form a cavity 44 between side panels 42a and 42b with an open front end 46 for receiving support arm assembly 18 therein as seen in Figure 2.

Electrical power cable 14 is preferably a conventional electrical cable preferably having three insulated power conductors and two insulated communication conductors which are electrically connected at one end to power line 20 and the circuitry of control box 22 and electrically coupled at their other ends to electrical connector 16. Since electrical cable 14 and its electrical connections to power line 20, control box 22 and electrical connector 16 are conventional and well known in the electrical art, they will not be discussed or illustrated in detail herein.

Electrical connector 16 is only schematically represented in Figures 1-3 since any electrical connector with electrical contacts can be utilized in the present invention which will mate with a complementary electrical connector mounted in vehicle 30. Preferably, electrical connector 16 is a plug with female contacts which is received in a mating electrical connector or receptacle 32 with male contacts in vehicle 30.

Support arm assembly 18 includes a first counterbalanced parallelogram linkage 50, a second counterbalanced parallelogram linkage 52, a pair of cover panels 54a and 54b coupled to second parallelogram 52, and a connector mounting 56 movably coupled to second parallelogram 52 for supporting electrical connector 16.

First parallelogram linkage 50 includes four rigid side links 60a-60d which form a pair of parallelograms. In particular, one end of each link 60a-60d is pivotally coupled to enclosure 28 by horizontal pins 61, while the other ends of each of the links 60a-60d is pivotally coupled to an intermediate support block 62 by horizontal pins 61. Specifically, links 60a and 60b together with a portion of panel 42a and a portion of support block 62 form a first parallelogram. Likewise, links 60c and 60d together with a portion of panel 42b and a portion of support block 62 form a second parallelogram which is parallel to the first parallelogram which is formed by links 60a and 60b. Accordingly, links 60a-60d will always remain parallel, while support block 62 will always remain in the same vertical position or orientation. Preferably, links 60a-60d are constructed of a hard, rigid material such as a corrosion resistant metallic material. As seen in Figure 1A, links 60a and 60c are preferably not vertically aligned with links 60b and 60d to permit links 60a-60d to fold within enclosure 28.

Second parallelogram linkage 52 includes four rigid links 64a-64d which form a pair of parallelograms. In particular, links 64a and 64b are pivotally connected at one of their ends to a portion of support block 62 by horizontal pins 65, and pivotally connected at their other ends to a portion of handle 56 by horizontal pins 65. Likewise, links 64c and 64d are pivotally connected at one end to a portion of support block 62 by horizontal pins 65 and pivotally connected at their other ends to a portion of connector mounting 56. Accordingly, links 64a-64d will always remain parallel and connector mounting 56 will also remain in the same vertical orientation. Preferably, links 64a-64d are constructed of a hard, rigid material such as a corrosion resistant metallic material.

Parallelogram linkages 50 and 52 are counterbalanced so that when support arm assembly 18 is pivoted vertically via links 60a-60d and links 64a-64d, support arm assembly 18 along with electrical connector 16 will remain in that position.

Panel 54a is preferably a flat rectangular panel which is slightly larger than the space of cavity 44 between side panels 42a and 42b. Panel 54a is rigidly coupled to the bottom surfaces of links 64b and 64c and covers a lower portion of the open end 46 of cavity 44 when support arm assembly 18 is in its retracted position.

Panel 54b is preferably a substantially rectangular, flat plate which is slightly larger than the width of cavity 44 between side panels 42a and 42b for covering an upper portion of open end 46 of cavity 44 when support arm assembly 18 is in its retracted position. Panel 54b is rigidly coupled to lower portion 70 of handle 56. Accordingly, panels 54a and 54b completely cover open end 46 of cavity 44 when support arm assembly 18 is in its retracted position.

Connector mounting 56 preferably includes a lower portion 70 which is pivotally connected to links 64a-64d, and an upper handle portion 72 with electrical connector 16 rigidly coupled thereto and pivotally connected to lower portion 70 via a pivot shaft 89 in a conventional manner for rotatably supporting electrical connector 16 relative to links 60a-60d and 64a-64d.

In operation, a user would grasp upper handle portion 72 and pull electrical connector 16 from control box 22, and then insert electrical connector 16 into the mating electrical connector 32 of vehicle 30. This will cause support arm assembly 18 to move from its retracted position contained within enclosure 28 to an extended position in which tubular member 40 and parallelogram linkages 50 and 52 allow the user to obtain correct alignment between male electrical connector 16 and the female electrical connector 32 of vehicle 30. Specifically, parallelogram linkages 50 and 42 allow for vertical movement of electrical connector 16 while upper portion 72 of handle 56 and tubular member 40 allows for horizontal movement and orientation of electrical connector 16.

Now the user can transfer electrical energy from power source 20 by using control box 22 to dispense electrical energy through cable 14 and electrical connector 16 to vehicle 30. When the user is finished recharging vehicle 30, the user will reinsert electrical connector 16 into the port of control box 22, which will in turn cause support arm assembly 18 with cable 14 thereon to retract into enclosure 28.

#### Electric Vehicle Charging Station 110

Referring now to Figures 4 and 5, an electric vehicle charging station 110 in accordance with a second embodiment of the present invention is illustrated. Electric vehicle

charging station 110 includes a base unit 112 rigidly mounted to the ground in a conventional manner, a plurality of electrical cables 114 electrically coupled at one of their ends to base unit 112, an electrical connector 116 electrically connected to the other ends of cables 114, and a retractable support arm assembly 118 movably coupled at one end to base unit 112 for supporting cables 114 and electrical connector 116 thereon.

Base unit 112 includes a control box 122 with conventional electronic circuitry therein, a support post 124 for supporting control box 122 above the ground, and a port 128 in control box 122 for receiving a portion of electrical connector 116 therein.

Base unit 112 is electrically connected to an electrical power line or source 120, which in turn is preferably connected to the local electrical utility company's power line or any other conventional source of electrical energy. The base unit 112 is preferably mounted in commercial applications such as at gas stations, parking garages, or at the side of a street curb.

Electrical power cables 114 are preferably conventional electrical cables with a conductive core and an insulated sheath which are electrically connected at one of their ends to the circuitry of control box 122 and power line 120, and electrically coupled at their other ends to electrical connector 116. Since electrical cables 114 and its electrical connections are well known in the electrical art, they will not be discussed or illustrated in detail herein.

Electrical connector 116 is only schematically represented in Figures 4 and 5 since any electrical connector with electrical contacts can be utilized in the present invention, which will mate with a complementary electrical connector mounted in an electric vehicle.

-12-

Preferably, electrical connector 116 is a male electrical connector or a plug which is received in a mating female electrical connector in an electric vehicle.

Support arm assembly 118 includes a first arm 140 pivotally coupled at one end to control box 122, a second support arm 142 pivotally coupled to the other end of first pivot arm 140, a counterbalanced parallelogram support linkage 146 pivotally coupled to second support arm 142, and a connector mounting 148 rotatably coupled to parallelogram support linkage 146.

First support arm 140 is preferably a hollow tubular member having a rectangular transverse cross section for receiving cables 114 therethrough, as well as for receiving cooling air from fan 130 therethrough via tube 132. Support arm 140 also shields cables 114 from RFI, EMI and extra low frequency magnetic fields (ELF). One end of support arm 140 is pivotally coupled to control box 122 via vertically extending pivot pin 150. Accordingly, support arm 140 can move horizontally about the vertical axis of pivot pin 150 between a retracted position as seen in Figure 4 and an extended position as seen in Figure 5.

Referring to Figure 5A, the end of first support arm 140 may also be pivotally coupled to base unit 112 via a horizontal pivot pin 151 in addition to vertical pivot pin 150, and have either a counterweight 153 or a tension spring 155 coupled to the end opposite second support arm 142 for counterbalancing support arm assembly 118. In other words, if a downwardly directed force is applied to support arm assembly 118, then pivot pin 151 will permit support arm assembly 118 to pivot vertically downwardly while counterweight 153 will restore support arm assembly 118 to its normal position upon release of such a downwardly directed force.

Support arm 142 is preferably a hollow tubular member having a rectangular transverse cross section for receiving cables 114 therethrough, as well as for receiving cooling air from fan 130 therethrough via tube 132. Support arm 142 also shields cables 114 from RFI, EMI and ELF. Support arm 142 is pivotally connected to support arm 140 by a pair of pivot links 152 which are pivotally connected at opposite ends by a pair of vertical pivot pins 154 and 156 to support arms 140 and 142, respectively. The other end of support arm 142 is pivotally connected to parallelogram linkage 146 by a pair of support links 158.

Links 158 each includes a first pivot pin 160 pivotally coupling one end of link 158 to support arm 142 and a second pivot pin 162 pivotally coupling a second end of link 158 to parallelogram linkage 146. Accordingly, second support arm 142 is pivotally coupled for horizontal movement about the vertical axes of pins 154 and 156 between a retracted position as seen in Figure 4 and an extended position as seen in Figure 5.

Parallelogram support linkage 146 includes a first side link 170, a second side link 172, a first end link 174 and a second end link 176. Side links 170 and 172 are preferably hollow tubular members having a rectangular transverse cross section for receiving cables 114 therethrough, as well as for receiving cooling air from fan 130 therethrough. First side link 170 is pivotally coupled to first end link 174 by a horizontal pivot pin 178 and pivotally coupled to second end link 176 by a second horizontal pivot pin 180.

Side link 172 is pivotally coupled at one end to end link 174 by a first horizontal pivot pin 182 and pivotally coupled at its other end to end link 176 by a second horizontal pivot pin 184.

Accordingly, links 170, 172, 174 and 176 allow parallelogram linkage 146 to pivot vertically relative to support arms 140 and 142. In fact, parallelogram support linkage 146 can also pivot horizontally relative to support arms 140 and 142 via pivot pins 160.

Connector mounting 148 includes a lower base portion 186 rigidly coupled to end link 176, an intermediate portion 188 rotatably coupled to lower portion 186 via a vertical pivot shaft 189, and an upper handle portion 190 pivotally coupled to intermediate portion 188 via a pair of horizontal pivot pins 192.

Connector mounting 148 has a passageway 194 extending through lower base portion 186, intermediate portion 188 and handle portion 190 so that cables 114 as well as cooling air passes from side links 170 and 172 to the electrical contacts contained within electrical connector 116. Electrical connector 116 is provided with a pivotally mounted cover 117 which is pivotally connected to handle portion 190 via hinges (not shown). When cover 117 is pivoted to expose the contacts of electrical connector 116, the cooling air passing through the passageway 194 exits handle portion, and is then fed into the receptacle 32 of vehicle 30.

Handle portion 190 has electrical connector 116 rigidly coupled thereto. Accordingly, electrical connector 116 is movably mounted horizontally about the vertical axis of pivot shaft 189 and vertically about pivot pins 192, as well as horizontally by support arms 140 and 142 and vertically by parallelogram linkage 146.

#### Electric Vehicle Charging Station 210

Referring now to Figures 6 and 7, an electric vehicle charging station 210 in accordance with a third embodiment of the present invention is illustrated, and includes a



base unit 212 fixedly mounted to the ground or a support structure 213 such as a building, a plurality of electrical cables 214 electrically coupled at one of their ends to base unit 212, an electrical connector 216 electrically coupled to the other ends of cables 214, and an retractable support arm assembly 218 movably coupled at one end to base unit 212 for supporting cable 214 and an electrical connector 216 for movement therewith.

Electric vehicle charging station 210 is a modified version of electrical recharging station 110 and is substantially identical in construction and function, except that support arm assembly 218 of electrical vehicle charging station 210 has been modified. Accordingly, base unit 212, electrical cable 214, and electrical connector 216 will not be discussed in detail.

Support arm assembly 218 includes a first counterbalance parallelogram linkage 240, a second counterbalance parallelogram linkage 242, and a connector mounting 248 pivotally coupled to second parallelogram linkage 242.

First parallelogram linkage 240 is rotatably coupled to a support structure or ceiling 250 by a conventional rotatably plate 252, and pivotally coupled at its other end to second parallelogram support linkage 242. First parallelogram support linkage 240 includes a first side link 254 pivotally coupled between a downwardly extending flange or universal joint of plate 252 and second parallelogram support linkage 242, and a second side link 256 pivotally coupled between a downwardly extending flange or universal joint of plate 252 and second parallelogram support linkage 242.

Links 254 and 256 are preferably hollow tubular members for receiving electrical cables 214 therethrough. Tubular links 254 and 256 are positioned to receive cooling

air from a fan (not shown) located in the ceiling 250 for cooling cables 214. Also, tubular links 254 and 256 shields cables 214 from RFI, EMI and ELF. First side link 254 is pivotally coupled to plate 252 via a horizontal pivot pin 260 extending through a bore in a downwardly extending flange of plate 252, while the other end of pivot link 254 is pivotally coupled to an end link 262 via a horizontal pivot pin 264. Likewise, second side link 256 is pivotally coupled at one end to plate 252 via a horizontal pivot pin 266 extending through a bore in a downwardly extending flange of plate 252, while the other end of second link 256 is pivotally coupled to end link 262 via a horizontal pivot pin 268.

Preferably, plate 252 includes a pair of conventional universal joints (not shown) connecting side link 254 and 256 via pins 260 and 266 thereto. This pivotal arrangement allows for a limited amount of pivot movement therebetween.

Parallelogram support linkage 242 includes a first side link 270, a second side link 272 maintained parallel to first side link 270, a first end link 274 pivotally coupled to first and second side links 270 and 272, and a second end link 276 pivotally coupled to the other ends of side links 270 and 272. First side link 270 is pivotally coupled to first end link 274 via a horizontal pivot pin 278 at one end and pivotally coupled at its other end to second end link 276 via a horizontal pivot pin 280.

Second side link 272 is pivotally coupled at one end to first end link 274 via a horizontal pivot pin 282 and pivotally coupled at its other end to end link 276 via a horizontal pivot pin 284.

First side link 270 is fixedly coupled to end link 262 for movably coupling second parallelogram linkage 242 to first parallelogram support linkage 240. Second end link 276 is fixedly coupled to connector mounting 248 for

movably coupling connector mounting 248 to second parallelogram linkage 242.

Connector mounting 248 includes a lower base portion 286 rigidly coupled to end link 276, an intermediate portion 288 rotatably coupled to lower portion 286 via a vertical pivot shaft 289, and an upper handle portion 290 pivotally coupled to intermediate portion 288 via a pair of horizontally mounted pivot pins 292.

Upper portion 290 has electrical connector 216 rigidly coupled thereto. Accordingly, electrical connector 216 is movably mounted horizontally about the vertical axis of pivot shaft 289 and vertically about pins 292, as well as horizontally by plate 252 and vertically by parallelogram support linkages 240 and 242.

#### Electric Vehicle Charging Station 310

Referring now to Figure 8, an electrical vehicle charging station 310 in accordance with a fourth embodiment of the present invention is illustrated. Electric vehicle charging station 310 includes a base unit 312 coupled to a building or other support structure 313, a plurality of electrical cables 314 electrically coupled at one end to base unit 312, an electrical connector 316 electrically coupled to the other ends of electrical cables 314, and a retractable support arm assembly 318 movably coupled at one end to base unit 312 for supporting cables 314 thereon as well as electrical connector 316.

Electric vehicle charging station 310 is a further modified version of the electric vehicle charge stations 10, 110 and 210, and is substantially identical thereto in construction, except it has been modified for residential applications and has a modified support arm assembly 318. Thus, the similarities of vehicle charging station 310 with

stations 10, 110 and 210 will not be discussed or illustrated in detail herein.

Base unit 312 includes a control box 322 with conventional electronic circuitry therein which is electrically coupled to an electrical power line or source 320, which in turn is preferably connected to the local electrical utility company's power line or any other convention source of electrical energy. The base unit 312 is preferably mounted in a residential setting and coupled to either the residential circuit breaker or residential power meter.

In residential applications, power source 320 can be typically connected in a conventional manner to a circuit breaker panel or power meter in residential homes or apartments. Since the electrical connections, breaker panel, and/or power meter are conventional and well known in the art, they will not be discussed or illustrated in detail herein.

Support arm assembly 318 includes a first arm 340 pivotally coupled to control box 322, a second support arm 342 pivotally coupled at one end to first pivot arm 340, a counterbalanced parallelogram linkage 346 pivotally coupled to second support arm 342, and a handle 348 movably coupled to parallelogram support linkage 346. Optionally, support arm assembly 318 can include a support wheel 334 coupled to second support 342. Wheel 334 support the weight of support arm assembly 318 to prevent bending or breakage thereof.

First support arm 340 is preferably a hollow tubular member having a rectangular transverse cross section for receiving cables 314 therethrough. One end of support arm 340 is pivotally coupled to control box 322 via vertically extending pivot pin 350. Accordingly, support arm 340 can move horizontally about pivot pin 350 between a retracted

position and an extended position. Also, this pivotal arrangement allows support arm 340 to swing approximately 180°.

Support arm 342 is preferably a hollow tubular member having a rectangular transverse cross section for receiving cables 314 from support arm 340 therethrough, as well as for receiving cooling air from fan 330 therethrough. Support arm 342 also shields cables 314 from RFI, EMI and ELF. Support arm 342 is pivotally connected to support arm 340 by a vertically extending pivot shaft 352, while the other end of support arm 342 is pivotally connected to parallelogram support linkage 346 via a vertical pivot pin 358.

Forced cooling via fan 330 is not normally required for most residential charging, since the current levels in cables 314 for residential charging should be low enough so as not to cause an over heating problem. However, fan 330 would allow smaller than normal cables to be used and therefore result in a more compact and lighter support structure.

First and second support arms 340 and 342 can be provided with a self stowing feature for automatically retracting support arm assembly 318 when released by the user. Specifically, a torsion spring or other retracting mechanism can be mounted about pivot pins 350, 352 and 358 so that support arms 340 and 342, as well as linkage 346, are all biased to fold up in a retracted position.

Parallelogram support linkage 346 includes a first side link 370, a second side link 372, a first end link 374, and a second end link 376. First side link 370 is pivotally coupled to first end link 374 via a horizontal pivot pin 378 and pivotally coupled to second end link 376 via a second horizontal pivot pin 380.

Side link 372 is pivotally coupled at one end to end link 374 by a horizontally mounted pivot pin 382 and pivotally coupled at its other end to end link 376 by a horizontally pivot pin 384. Accordingly, links 370, 372, 374 and 376 allow parallelogram linkage 346 to pivot vertically relative to support arms 340 and 342. In fact, parallelogram support linkage 346 can also pivot horizontally relative to support arms 340 and 342 via pivot pin 358.

End links 374 and 376 are preferably tubular members which are pivotally coupled about pivot pins 358 and 384, respectively.

Handle 348 includes a base portion 386 rotatably coupled to end link 376 via a pivot shaft 389, and an upper handle portion 390 pivotally coupled to base portion 386 via a pair of horizontally mounted pivot pins 392.

Upper handle portion 390 has electrical connector 316 rigidly coupled thereto. Accordingly, electrical connector 316 is movably mounted horizontally about the vertical axis of pivot shaft 389 and vertically about pivot pins 392, as well as horizontally by support arms 340 and 342 and vertically by parallelogram support linkage 346.

#### Electric Vehicle Charging Station 410

Referring now to Figure 9, an electric vehicle charging station 410 in accordance with a fifth embodiment of the present invention is illustrated. Electric vehicle charging station 410 includes a base unit 412 rigidly coupled to a support structure or building 413, a plurality of electrical cables 414 electrically coupled at one of their ends to base unit 412, an electrical connector 416 electrically coupled to the other ends of cables 414, and a retractable support assembly 418 movably coupled at one

end to base unit 412 for supporting cable 414 and electrical connector 416 for movement therewith.

Electric vehicle charging station 410 is a modified version of electric vehicle charging station 310 with substantially identical construction, except for a modified support arm assembly 418 is utilized. Thus, only the differences between vehicle charging station 410 and station 310 will be discussed and illustrated in detail.

Base unit 412 includes a control box 422 with conventional electronic circuitry therein which is electrically coupled to an electrical power line or source 420, which in turn is preferably connected to the local electrical utility company's power line or any other convention source of electrical energy. The base unit 412 is preferably mounted in a residential setting and coupled to either the residential circuit breaker or residential power meter.

Support arm assembly 418 includes a first arm 440 pivotally coupled to control box 422, a second support arm counterbalanced 442 pivotally coupled at one end to first pivot arm 440, a parallelogram linkage 446 pivotally coupled to second support arm 442, and a handle 448 movably coupled to parallelogram support linkage 446.

One end of support arm 440 is pivotally coupled to control box 422 via vertically extending pivot pin 450. Accordingly, support arm 440 can move horizontally about pivot pin 450 between a retracted position and an extended position. Also, this pivotal arrangement allows support arm 440 to swing approximately 180°.

Support arm 442 is pivotally connected to support arm 440 by a vertically extending pivot shaft 452, while the other end of support arm 442 is pivotally connected to parallelogram support linkage 446 via a vertical pivot pin 458.

Parallelogram support linkage 446 includes a first side link 470, a second side link 472, a first end link 474, and a second end link 476. First side link 470 is pivotally coupled to first end link 474 via a horizontal pivot pin 478 and pivotally coupled to second end link 476 via a second horizontal pivot pin 480.

Side link 472 is pivotally coupled at one end to end link 474 by a horizontally mounted pivot pin 482 and pivotally coupled at its other end to end link 476 by a horizontally pivot pin 484. Accordingly, links 470, 472, 474 and 476 allow parallelogram linkage 446 to pivot vertically relative to support arms 440 and 442. In fact, parallelogram support linkage 446 can also pivot horizontally relative to support arms 440 and 442 via pivot pin 458.

End links 474 and 476 are preferably tubular members which are pivotally coupled about pivot pins 458 and 484, respectively.

Handle 448 includes a base portion 486 rotatably coupled to end link 476 via a pivot shaft 489, and an upper handle portion 490 pivotally coupled to base portion 488 via a horizontally mounted pivot pin 492.

Upper handle portion 490 has electrical connector 416 rigidly coupled thereto. Accordingly, electrical connector 416 is movably mounted horizontally about the vertical axis of pivot shaft 489 and vertically about pivot pin 492, as well as horizontally by support arms 440 and 442 and vertically by parallelogram support linkage 446.

#### Electric Vehicle Charging Station 510

Referring now to Figure 10, an electric vehicle charging station 510 in accordance with a sixth embodiment of the present invention is illustrated. Electric vehicle charging station 510 includes a base unit 512 coupled to a



building or support structure 513, an electrical cable 514 with a plurality of insulated electrical conductors therein, and an electrical connector 516 electrically coupled to the other end of electrical cable 514.

Electric vehicle charging station 510 is a further modified version of electric vehicle charging stations 10, 110, 210, 310 and 410, and is similar in construction thereto, except that it has been modified to eliminate the use of a support arm assembly.

Specifically, electric vehicle charging station 510 is an inexpensive version of the prior embodiments, and includes a hand held conductor 516 which is secured in a cavity 528 of base unit 512. The connector 516 is locked against unauthorized removal by a conventional key locking mechanism 529. Instead of a key operated locking system, an electronic code similar to bank teller machines, i.e., buttons (not shown), could be utilized for locking connector 516 within port 528.

Base unit 512 includes an upwardly extending flange 531 and a downwardly extending flange 533 for retaining cable 514 on base unit 512 when wrapped thereabouts as shown in Figure 10. Thus, flanges 531 and 533 provide convenient storage of cable 514.

#### Electric Vehicle Charging Station 610

Referring now to Figure 10, an electric vehicle charging station 610 in accordance with a sixth embodiment of the present invention is illustrated. Electric vehicle charging station 610 includes a base unit 612 coupled to a building or support structure 613, an electrical cable 614 with a plurality of insulated electrical conductors (not shown) therein, and an electrical connector 616 electrically coupled to the other end of electrical cable 614.

Electric vehicle charging station 610 is a further modified version of electric vehicle charging stations 10, 110, 210, 310 and 410, and is similar in construction thereto, except that it has been modified to eliminate the use of a support arm assembly.

Specifically, electric vehicle charging station 610 is an inexpensive version of the prior embodiments, and includes a hand held conductor 616 which is secured in a cavity 628 of base unit 612. The connector 616 is locked against unauthorized removal by a conventional key locking mechanism 629. Instead of a key operated locking system, an electronic code similar to bank teller machines, i.e., buttons (not shown), could be utilized for locking connector 616 within port 628.

Cable 614 is supported on base unit 612 by a spring mounted pole assembly 615. Pole assembly 615 includes a steel or nonmetallic tube 617, an inverted U-shaped cable guide 619, a coil spring 621 coupled between tube 617 and base unit 612, and a compliant sealing boot 623 surrounding spring 621 for creating a seal between tube 617 and base unit 612. The length of cable 614 and the height of tube 617 are such that if the connector 616 is not restored into its storage cavity 628, then electric connector 616 will hang downwardly but not touch the floor. Thus, spring mounted tube 617 prevents electric connector 616 from getting wet or picking up contaminants from the floor.

Tube 617 is constructed of a rigid, substantially non-bendable material. The inside diameter of tube 617 is slightly larger than the diameter of cable 614 to permit cable 614 to pass therethrough.

Inverted U-shaped cable guide 619 is coupled at one end to the free end of tube 617 for receiving cable 614 therethrough. Preferably, guide 619 is rotatably coupled to tube 617 to allow a limited degree of rotation of guide

619 relative to tube 617. The first half of U-shaped guide 619, which is coupled to tube 617, is a J-shaped tube. The second half of U-shaped guide 619 has an open portion so as to form a channel for receiving cable 614. This allows cable 614 to position itself tangentially relative to the internal radius of guide 619 without strain, when the pole assembly 615 is tilted from the vertical position as seen in Figure 12.

The bottom portion of pole assembly 615 has a closely wound coil spring 612 coupled thereto. The top end of coil spring 612 has several coils of uniform diameter which frictionally receives the lower end of tube 617. The bottom end of the coil spring 612 has several coils of uniform diameter which fastens onto a collar 625 which is fixedly coupled to base unit 612.

The coil spring 621 is enclosed by compliant sealing boot 623 to prevent moisture and other contaminants from entering base unit 612. Preferably, complaint sealing boot 623 is made of a resilient rubber material.

The spring rate of the coil spring 612 is designed such that tube 617 is normally held in a vertical position, and is capable of being tilted from its vertical position to a substantially horizontal position. When tube 617 is in a substantially horizontal position, spring 612 has a restoring force which somewhat greater than the weight of the cable 614 and connector 616 so that the tube 617 will return to its vertical position when the connector 616 is returned to port 628 of base unit 612.

While several preferred embodiments have been chosen to illustrate the invention, it will be understood by those skilled in the art that various changes and modifications can be made herein without departing from the scope of the invention as defined in the appended claims.

WHAT IS CLAIMED IS:

1. An electric vehicle charging station for recharging an electric vehicle, comprising:

a base structure coupled to an electrical power source;

at least one electrical conductor having a first end and a second end with said first end being electrically coupled to said power source;

electrical contact means, coupled to said second end of said electrical conductor, for electrically coupling and dispensing electrical energy to the electric vehicle;

substantially rigid support means movably coupled to said base structure, for movably supporting said electrical contact means and said electrical conductor means between a retracted position and an extended position; and

control means, electrically coupled to said electrical power source, for regulating the flow of electrical energy from said power source to the electric vehicle.

2. An electric vehicle charging station according to claim 1, wherein

said support means includes means for horizontally moving said electrical contact means.

3. An electric vehicle charging station according to claim 1, wherein

said support means includes first means for vertically moving said electrical contact means.

4. An electric vehicle charging station according to claim 3, wherein

said support means includes second means for horizontal moving said electrical contact means.

5. An electric vehicle charging station according to claim 4, wherein

said second means is pivotally coupled about a first vertical axis.

6. An electric vehicle charging station according to claim 5, wherein

said support means includes third means for horizontal moving said electrical contact means about a second vertical axis spaced from said first vertical axis.

7. An electric vehicle charging station according to claim 3, wherein

said first means includes a first parallelogram support linkage.

8. An electric vehicle charging station according to claim 7, wherein

said first means further includes a second parallelogram support linkage movably coupled between said

first parallelogram support linkage and said electrical contact means.

9. An electric vehicle charging station according to claim 7, wherein

said support means includes second means for horizontal moving said electrical contact means.

10. An electric vehicle charging station according to claim 9, wherein

said second means pivotally supports one end of said first parallelogram support linkage to said base structure.

11. An electric vehicle charging station according to claim 9, wherein

said second means includes a first rigid support arm having a first end pivotally coupled at one end to said first parallelogram support linkage and a second end pivotally coupled to said base structure.

12. An electric vehicle charging station according to claim 11, wherein

said second means includes a second rigid support arm for pivotally coupling said second end of said first support arm to said base structure.

13. An electric vehicle charging station according to claim 12, wherein

said second arm has a first end pivotally coupled about a first vertical pivot axis to said base structure and a second end pivotally coupled about a second vertical pivot axis to said first support arm.

14. An electric vehicle charging station according to claim 7, wherein

said first parallelogram support linkage includes at least one hollow tubular member for receiving said electrical conductor therein.

15. An electric vehicle charging station according to claim 14, further comprising

cooling means, fluidly coupled to said tubular member, for cooling said electrical conductor.

16. An electric vehicle charging station according to claim 14, wherein

said first parallelogram support linkage is counterbalanced.

17. An electric vehicle charging station according to claim 1, wherein

said support means includes a rigid tubular member for receiving said electrical conductor therethrough.

18. An electric vehicle charging station according to claim 17, wherein

said tubular member is movably coupled to said base structure by resilient biasing means for normally biasing said tubular member to said retracted position.

19. An electric vehicle charging station for recharging an electric vehicle, comprising:

a base structure coupled to an electrical power source;

at least one electrical conductor having a first end and a second end with said first end being electrically coupled to said power source;

electrical contact means, coupled to said second end of said electrical conductor, for electrically coupling and dispensing electrical energy to the electric vehicle;

storage means, coupled to said base structure, for supporting said electrical conductor thereon; and

control means, electrically coupled to said electrical power source, for regulating the flow of electrical energy from said power source to the electric vehicle.

20. An electric vehicle charging station according to claim 19, wherein

said storage means includes a pair of oppositely extending flanges for retaining said electrical conductor on said base unit.



## AMENDED CLAIMS

[received by the International Bureau on 16 June 1994 (16.06.94);  
original claims 1 and 2 cancelled; original claims 3,4,6,8-10,13,15,19 and 20 amended  
new claims 21 and 22 added; other claims unchanged (6 pages)]

1. (Canceled)

2. (Canceled)

3. (Amended) An electric vehicle charging station  
for recharging an electric vehicle, comprising:

a base structure coupled to an electrical power  
source;

at least one electrical conductor having a first  
end and a second end with said first end being electrically  
coupled to said power source;

electrical connector means, coupled to said  
second end of said electrical conductor, for electrically  
coupling and dispensing electrical energy to the electric  
vehicle;

substantially rigid support means, movably  
coupled to said base structure, for movably supporting said  
electrical connector means and said electrical conductor  
between a retracted position and an extended position, said  
support means including first means for vertically moving  
said electrical connector means; and

control means, electrically coupled to said  
electrical power source, for regulating the flow of said  
electrical energy from said power source to the electric  
vehicle.

4. (Amended) An electric vehicle charging station  
according to claim 3, wherein

said support means includes second means for horizontally moving said electrical connector means.

5. An electric vehicle charging station according to claim 4, wherein

said second means is pivotally coupled about a first vertical axis.

6. (Amended) An electric vehicle charging station according to claim 5, wherein

said support means includes third means for horizontally moving said electrical connector means about a second vertical axis which is horizontally spaced from said first vertical axis such that said first and second vertical axes are not vertically aligned with each other.

7. An electric vehicle charging station according to claim 3, wherein

said first means includes a first parallelogram support linkage.

8. (Amended) An electrical vehicle charging station according to claim 7, wherein

said first means further includes a second parallelogram support linkage movably coupled between said first parallelogram support linkage and said electrical connector means.

9. (Amended) An electrical vehicle charging station according to claim 7, wherein

said support means includes second means for horizontally moving said electrical connector means.

10. (Amended) An electric vehicle charging station according to claim 9, wherein

said second means is pivotally coupled to one end of said first parallelogram support linkage and pivotally coupled to said base structure.

11. An electric vehicle charging station according to claim 9, wherein

said second means includes a first rigid support arm having a first end pivotally coupled at one end to said first parallelogram support linkage and a second end pivotally coupled to said base structure.

12. An electric vehicle charging station according to claim 11, wherein

said second means includes a second rigid support arm for pivotally coupling said second end of said first support arm to said base structure.

13. (Amended) An electric vehicle charging station according to claim 12, wherein

said second arm has a first end pivotally coupled to said base structure by a first vertically extending pivot pin and a second end pivotally coupled to said first support arm by a second vertically extending pivot pin.

14. An electric vehicle charging station according to claim 7, wherein

said first parallelogram support linkage includes at least one hollow tubular member for receiving said electrical conductor therein.

15. (Amended) An electrical vehicle charging station according to claim 14, further comprising

cooling means, coupled to said tubular member, for cooling said electrical conductor by forcing a cooling fluid through said tubular member.

16. An electric vehicle charging station according to claim 14, wherein

said first parallelogram support linkage is counterbalanced.

17. An electric vehicle charging station according to claim 1, wherein

said support means includes a rigid tubular member for receiving said electrical conductor therethrough.

18. An electric vehicle charging station according to claim 17, wherein

said tubular member is movably coupled to said base structure by resilient biasing means for normally biasing said tubular member to said retracted position.

19. (Amended) An electrical system for transferring electrical energy, comprising:

a base structure coupled to an electrical power source;

at least one electrical conductor having a first end and a second end with said first end being electrically coupled to said power source;

an electrical connector coupled to said second end of said electrical conductor for electrically coupling and dispensing electrical energy to an electrical device with a complementary electrical connector;

a substantially rigid support member movably coupled to said base structure at one end for moving at least a portion of said electrical conductor between a retracted position and an extended position, said at least a portion of said electrical conductor being coupled to and supported by said support member for movement with said support member in both a horizontal direction and a vertical direction; and

a control member electrically coupled to said electrical power source for regulating the flow of electrical energy from said power source to the electrical device.

20. (Amended) An electrical system according to claim 19, wherein

said support member includes a substantially rigid tube with said at least a portion of said electrical

conductor extending therethrough, and said support member further includes a spring element coupled between said base structure and said tube.

21. An electrical system according to claim 20, wherein

said tube extends substantially vertical to said base structure.

22. An electrical system according to claim 19, wherein

said electrical connector is coupled to said support member for movement in the horizontal and vertical directions.

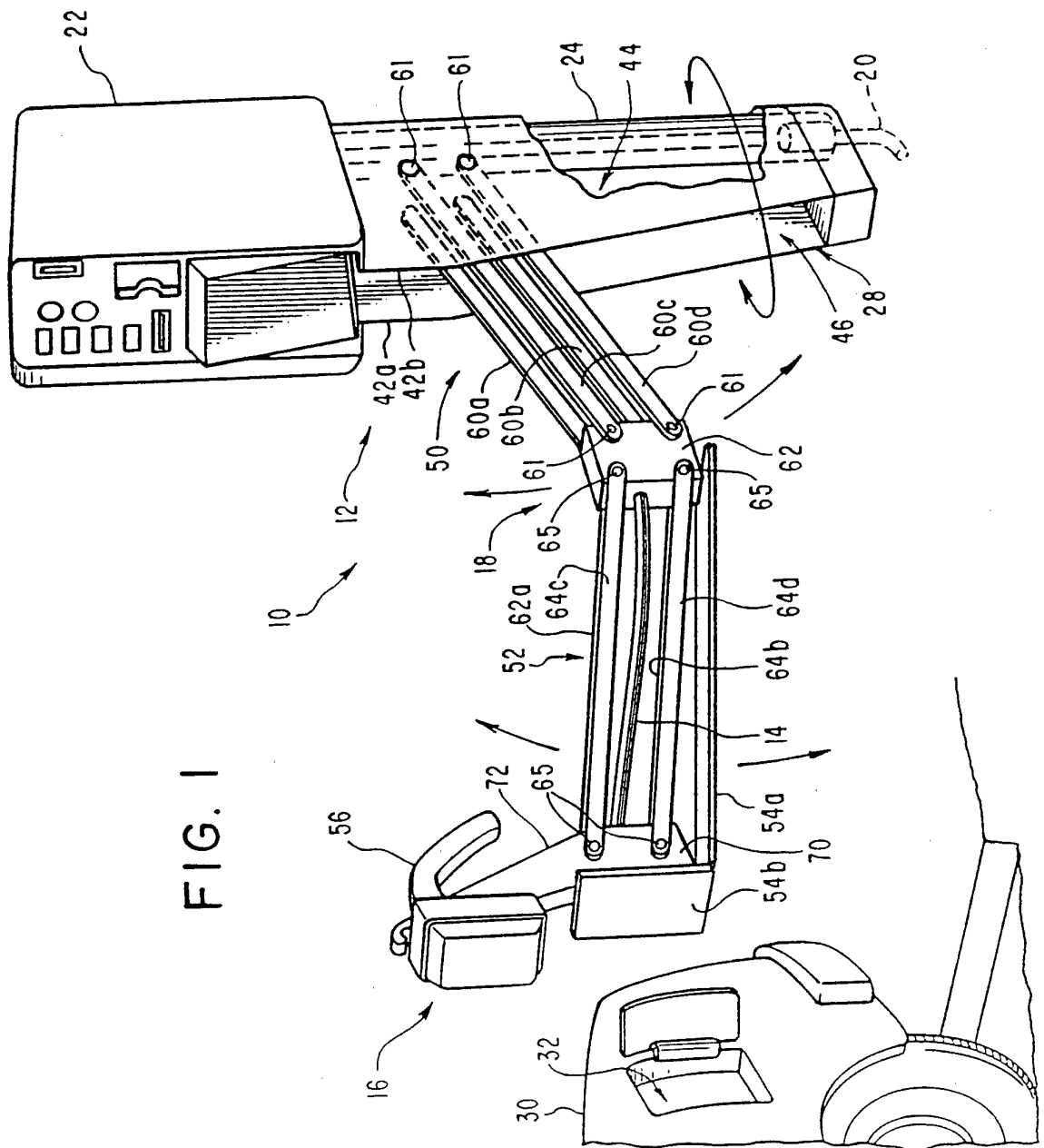
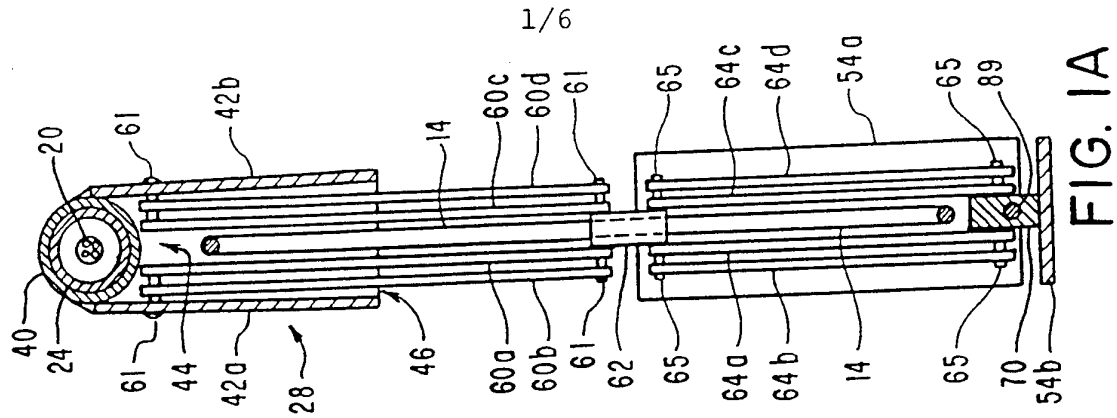

FIG. 3

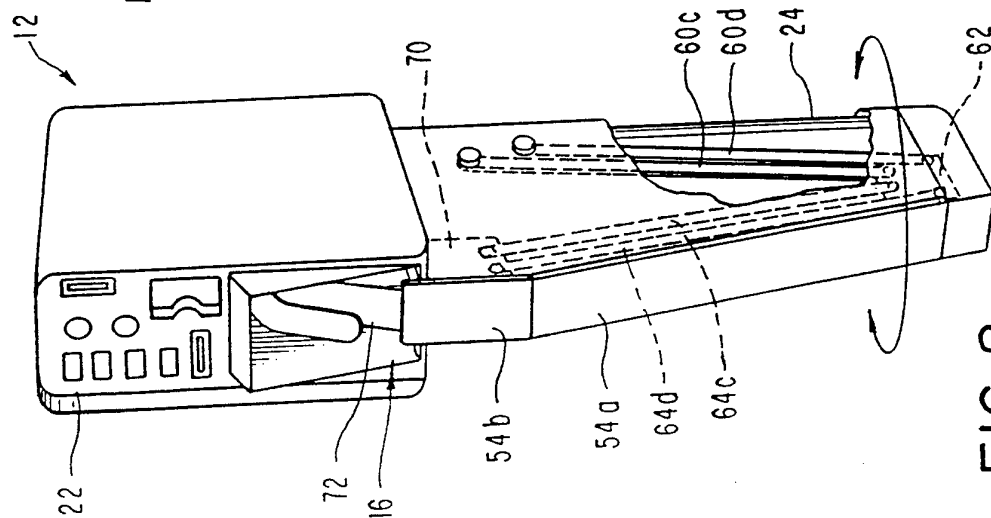
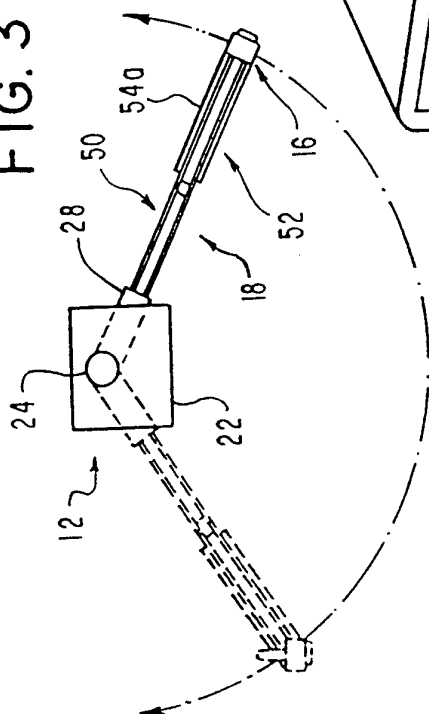

FIG. 4

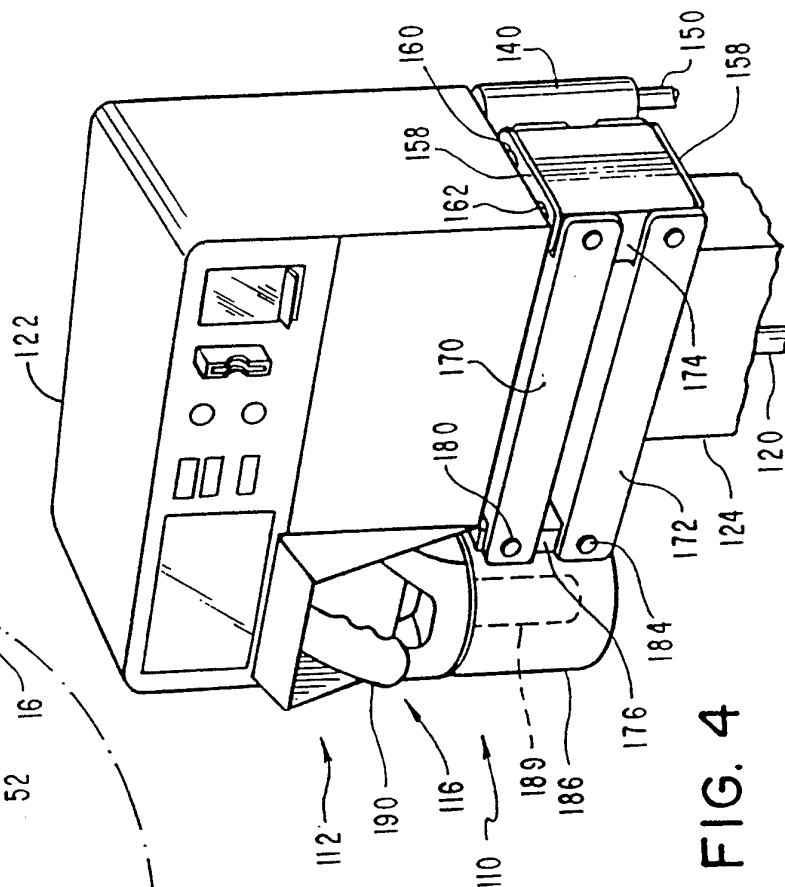
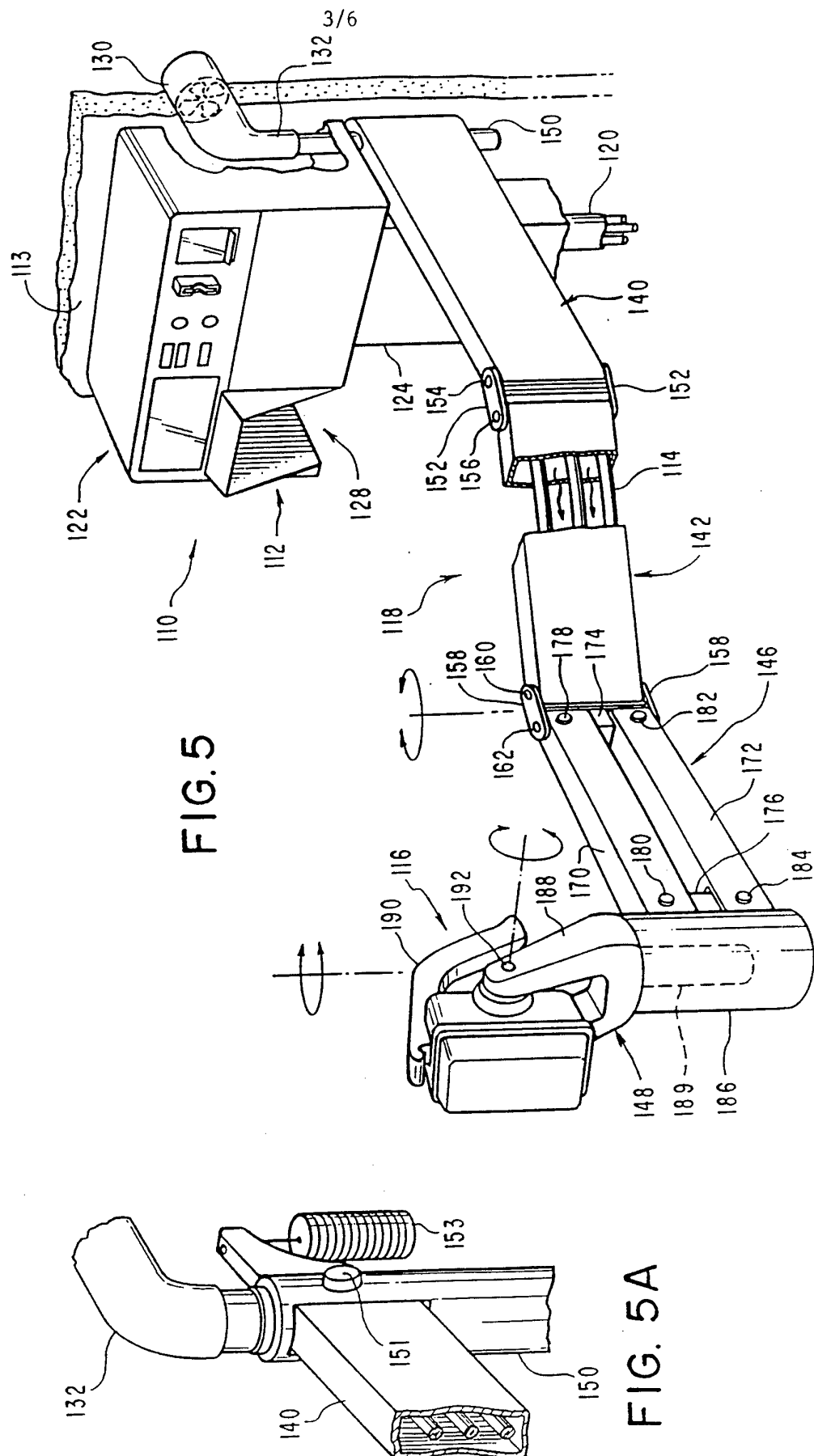

FIG. 2





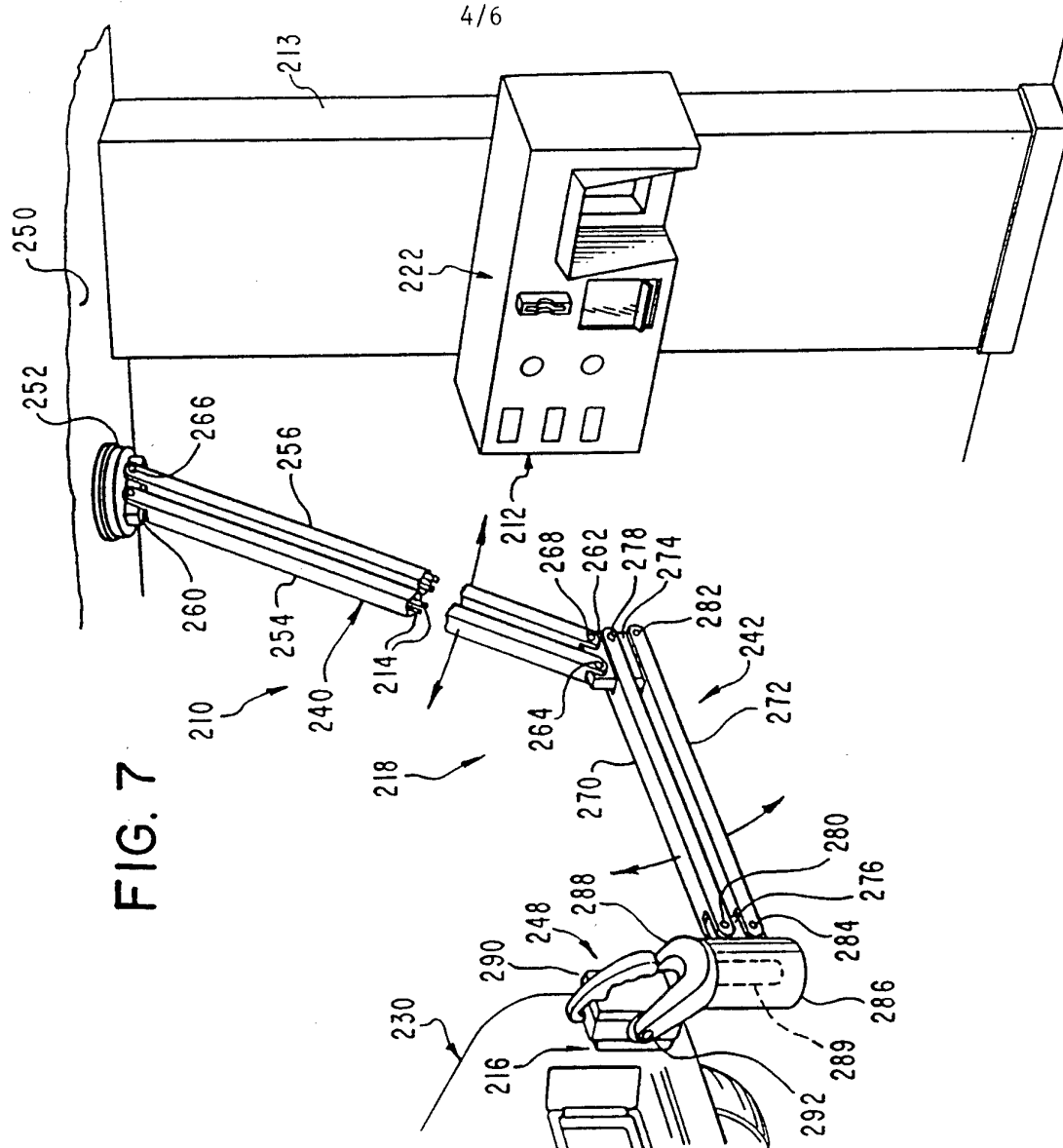
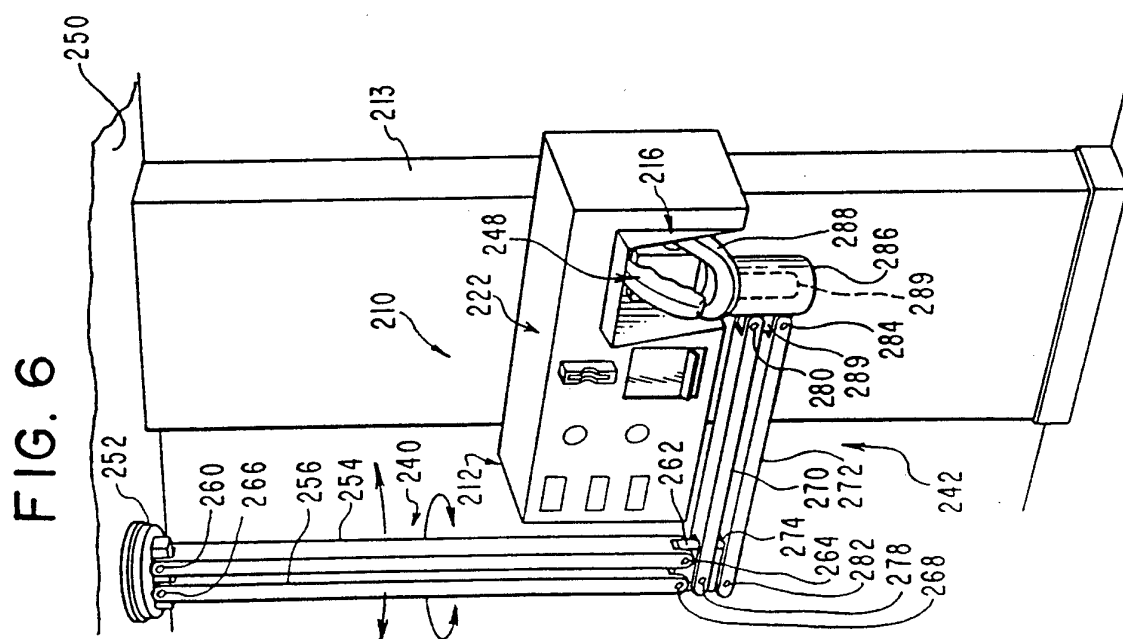

FIG. 7



୧୬୮

FIG. 8

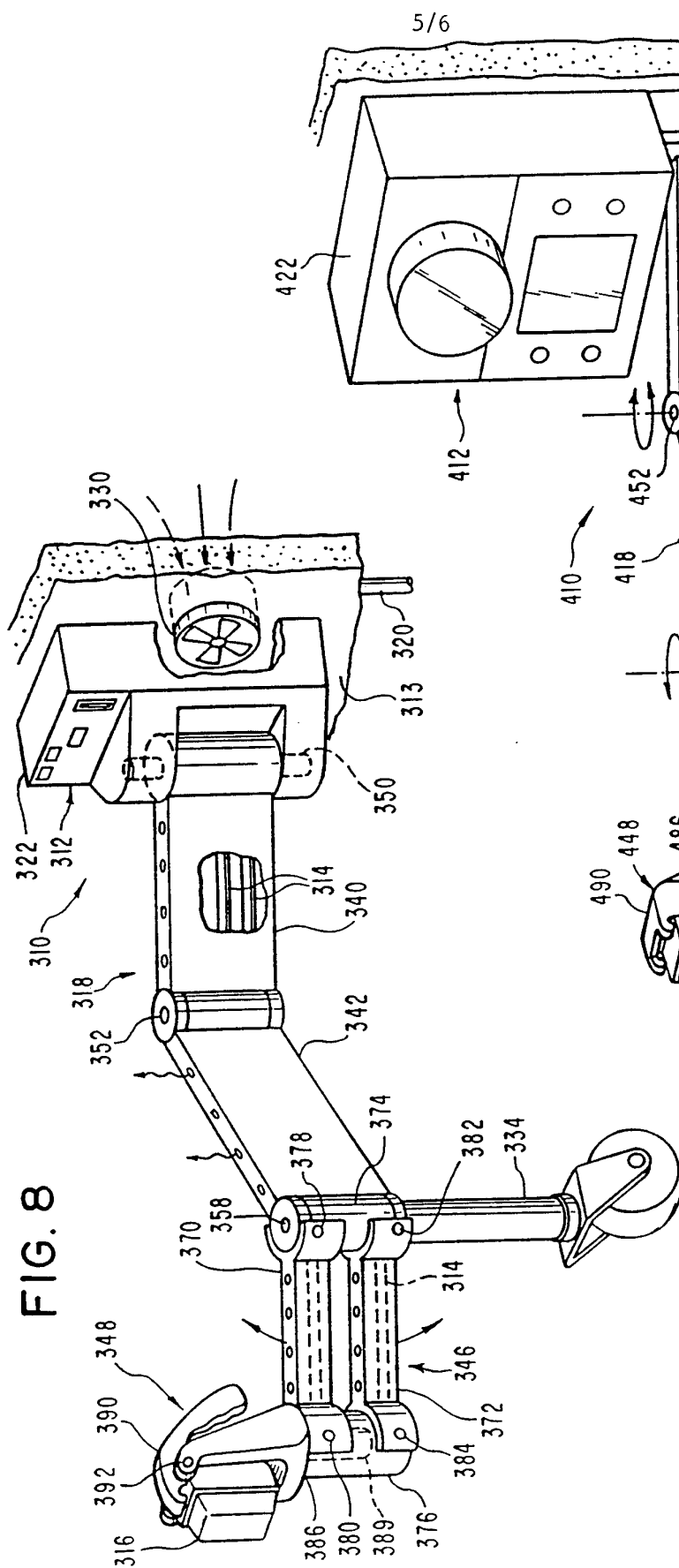
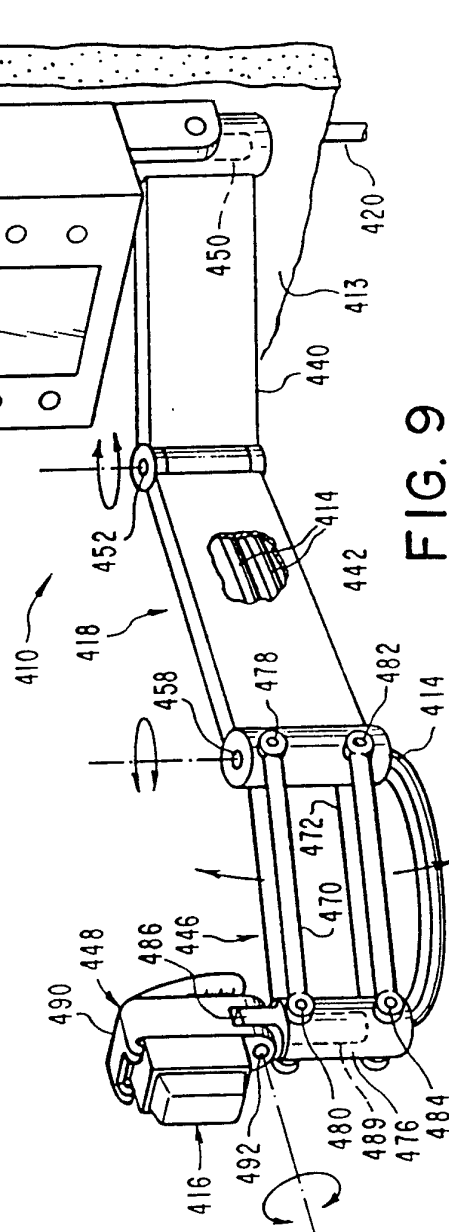
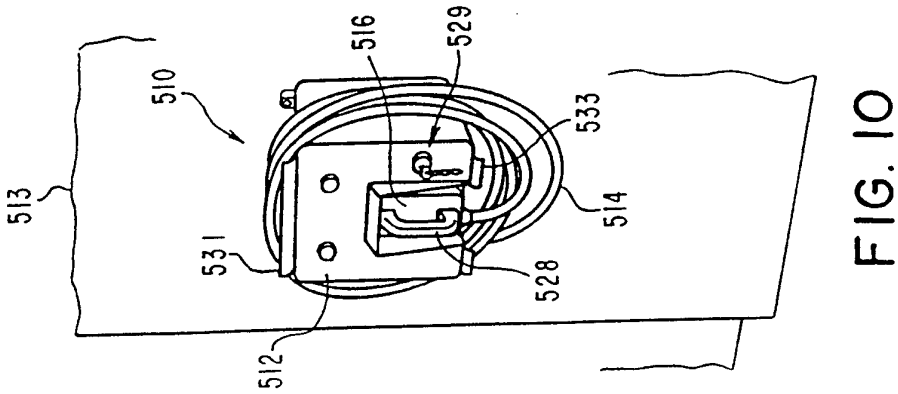
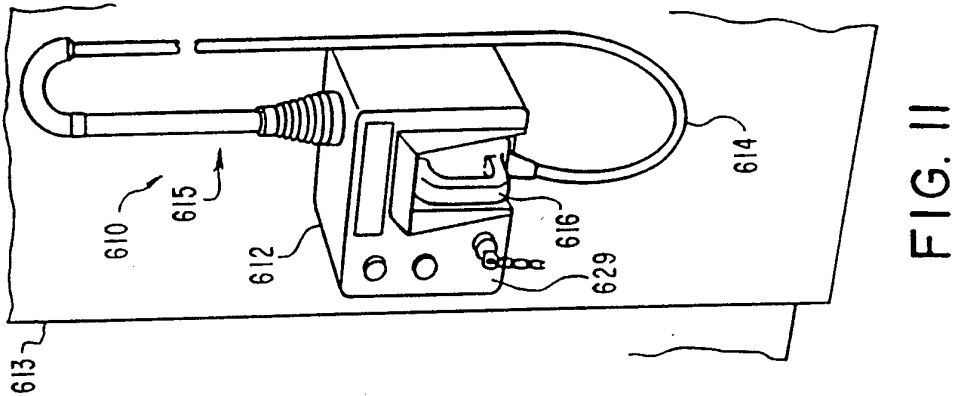
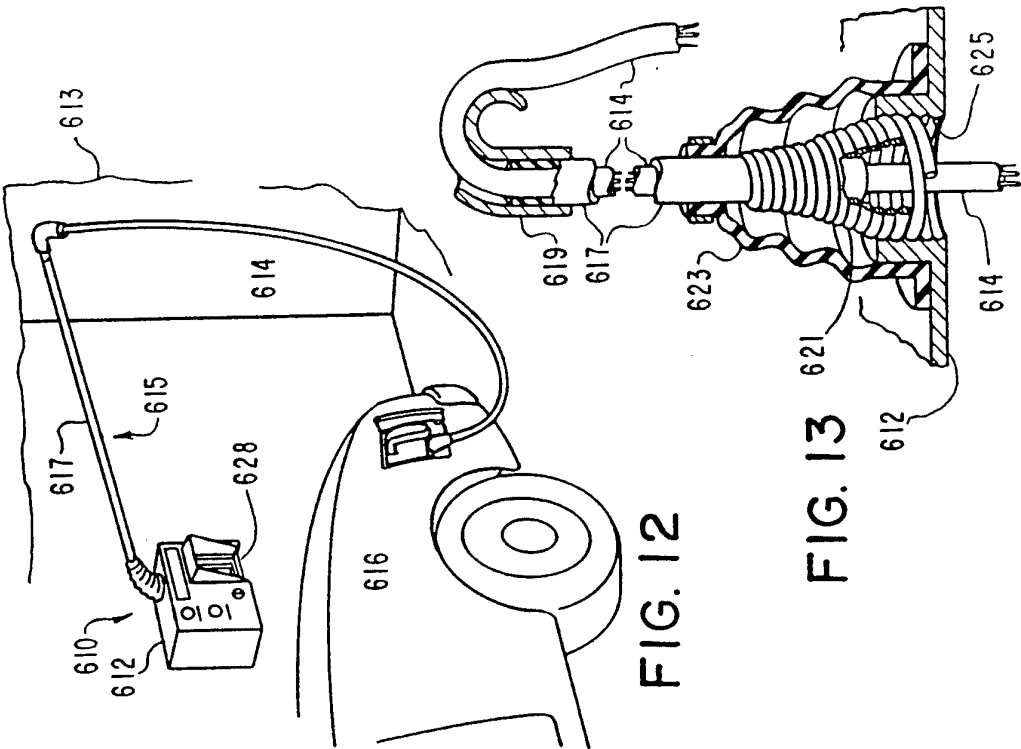

FIG. 9





# INTERNATIONAL SEARCH REPORT

International application No.  
PCT/US93/10407

## A. CLASSIFICATION OF SUBJECT MATTER

IPC(5) :H02J 7/00

US CL :320/2, 21

According to International Patent Classification (IPC) or to both national classification and IPC

## B. FIELDS SEARCHED

Minimum documentation searched (classification system followed by classification symbols)

U.S. : 320/2, 21

Documentation searched other than minimum documentation to the extent that such documents are included in the fields searched

Electronic data base consulted during the international search (name of data base and, where practicable, search terms used)

## C. DOCUMENTS CONSIDERED TO BE RELEVANT

Category*	Citation of document, with indication, where appropriate, of the relevant passages	Relevant to claim No.
Y	US, A, 5,157,319 (KLONTZ et al) 20 OCTOBER 1992 (see figs. 1 and 8)	1,2 ,17,18
X	US, A, 5,083,076 (SCOTT) 21 JANUARY 1992 (see fig. 1)	19, 20
A	US, A, 4,158,802 (ROSE II) 19 JUNE 1979 (see entire document)	1-20
A	US, A, 4, 347,472 (LEMELSON) 31 AUGUST 1982 (see entire document)	1-20
A	US, A, 4,431,241 (HAZELHURST) 14 FEBRUARY 1984 (see entire document)	1-20
A	US, A, 4,800, 328 (BOLGER et al) 24 JANUARY 1989 (see entire document)	1-20



Further documents are listed in the continuation of Box C.



See patent family annex.

* Special categories of cited documents:	*T* later document published after the international filing date or priority date and not in conflict with the application but cited to understand the principle or theory underlying the invention
*A* document defining the general state of the art which is not considered to be part of particular relevance	*X* document of particular relevance; the claimed invention cannot be considered novel or cannot be considered to involve an inventive step when the document is taken alone
*E* earlier document published on or after the international filing date	*Y* document of particular relevance; the claimed invention cannot be considered to involve an inventive step when the document is combined with one or more other such documents, such combination being obvious to a person skilled in the art
*L* document which may throw doubts on priority claim(s) or which is cited to establish the publication date of another citation or other special reason (as specified)	*Z* document member of the same patent family
*O* document referring to an oral disclosure, use, exhibition or other means	
*P* document published prior to the international filing date but later than the priority date claimed	

Date of the actual completion of the international search

26 FEBRUARY 1994

Date of mailing of the international search report

18 APR 1994

Name and mailing address of the ISA/US  
Commissioner of Patents and Trademarks  
Box PCT  
Washington, D.C. 20231

Facsimile No. (703) 305-3230

Authorized officer

KRISTINE PECKMAN

Telephone No. (703) 308-0640

# INTERNATIONAL SEARCH REPORT

International application No.  
PCT/US93/10407

C (Continuation). DOCUMENTS CONSIDERED TO BE RELEVANT		
Category*	Citation of document, with indication, where appropriate, of the relevant passages	Relevant to claim No.
A	US, A, 4,843, 477 (MIZUTANI et al) 27 JUNE 1989 (see entire document)	1-20
A,P	US, A, 5,252,078 (LANGENBAHN) 12 OCTOBER 1993 (see entire document)	1-20
A	JP, A, 58-69404(YAMADA) 25 APRIL 1983 (see English abstract)	1-20