



US010307115B2

(12) **United States Patent**
Yorkston et al.

(10) **Patent No.:** **US 10,307,115 B2**

(45) **Date of Patent:** ***Jun. 4, 2019**

(54) **EXTREMITY IMAGING APPARATUS FOR
CONE BEAM COMPUTED TOMOGRAPHY**

(71) Applicants: **CARESTREAM HEALTH, INC.**,
Rochester, NY (US); **Jeffrey H.
Siewerdsen**, Rochester, NY (US)

(72) Inventors: **John Yorkston**, Penfield, NY (US);
Robert J. Asento, Rochester, NY (US);
Jeffrey H. Siewerdsen, Baltimore, MD
(US); **David H. Foos**, Webster, NY
(US)

(73) Assignee: **Carestream Health, Inc.**, Rochester,
NY (US)

(*) Notice: Subject to any disclaimer, the term of this
patent is extended or adjusted under 35
U.S.C. 154(b) by 0 days.

This patent is subject to a terminal dis-
claimer.

(21) Appl. No.: **16/008,357**

(22) Filed: **Jun. 14, 2018**

(65) **Prior Publication Data**

US 2018/0296172 A1 Oct. 18, 2018

Related U.S. Application Data

(63) Continuation of application No. 15/424,935, filed on
Feb. 6, 2017, now Pat. No. 10,010,295, which is a
(Continued)

(51) **Int. Cl.**
A61B 6/00 (2006.01)
A61B 6/03 (2006.01)
A61B 6/04 (2006.01)

(52) **U.S. Cl.**
CPC **A61B 6/035** (2013.01); **A61B 6/03**
(2013.01); **A61B 6/032** (2013.01); **A61B 6/04**
(2013.01);

(Continued)

(58) **Field of Classification Search**

CPC **A61B 6/4441**

See application file for complete search history.

(56) **References Cited**

U.S. PATENT DOCUMENTS

4,014,398 A 3/1977 Gresko
4,316,091 A 2/1982 Bernardi
(Continued)

FOREIGN PATENT DOCUMENTS

CN 1711052 11/2003
CN 1617688 5/2005
(Continued)

OTHER PUBLICATIONS

US Food and Drug Administration, "A Guide for the Submission of
Initial Reports on Computed Tomography X-Ray Systems," Dec.
1985, 30 pages.

(Continued)

Primary Examiner — Hoon K Song

(57) **ABSTRACT**

A system for cone beam computed tomography of an
extremity has an x-ray source and a digital radiographic
detector both revolved about a central imaging axis so that
the detector moves at least partially around a first extremity
of a patient and, if the extremity is the leg of the patient, the
detector moves between the legs of the patient. The detector
path has a radial distance less than that of the source path.
A housing that encloses the source and detector includes a
pivoting door to allow sideways access for the patient's leg
to be placed at the central imaging axis.

15 Claims, 20 Drawing Sheets

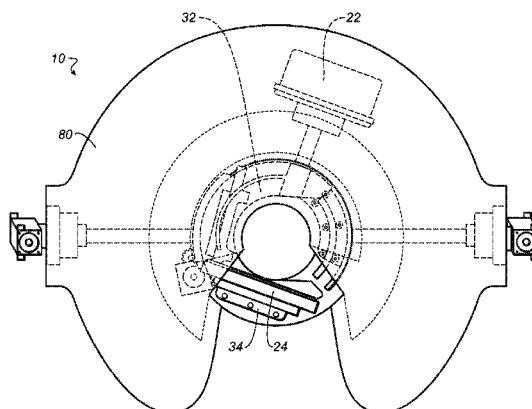

Related U.S. Application Data

continuation of application No. 15/012,995, filed on Feb. 2, 2016, now Pat. No. 9,597,044, which is a continuation of application No. 14/639,363, filed on Mar. 5, 2015, now Pat. No. 9,277,899, which is a continuation of application No. 14/266,861, filed on May 1, 2014, now Pat. No. 8,998,486, which is a continuation of application No. 13/681,579, filed on Nov. 20, 2012, now Pat. No. 8,746,972, which is a continuation of application No. 12/771,250, filed on Apr. 30, 2010, now Pat. No. 8,348,506.

- (60) Provisional application No. 61/175,091, filed on May 4, 2009.

(52) U.S. CL.

CPC *A61B 6/4085* (2013.01); *A61B 6/4441* (2013.01); *A61B 6/4452* (2013.01); *A61B 6/466* (2013.01); *A61B 6/505* (2013.01)

(56) References Cited**U.S. PATENT DOCUMENTS**

- | | | | | |
|--------------|------|---------|------------------------|-----------------------|
| 4,741,015 | A | 4/1988 | Charrier | |
| 5,014,293 | A | 5/1991 | Boyd et al. | |
| 5,748,704 | A | 5/1998 | Mazess et al. | |
| 6,131,690 | A | 10/2000 | Galando et al. | |
| 6,236,704 | B1 | 5/2001 | Navab et al. | |
| 6,580,777 | B1 | 6/2003 | Ueki et al. | |
| 6,842,502 | B2 | 1/2005 | Jaffray et al. | |
| 6,940,941 | B2 | 9/2005 | Gregerson et al. | |
| 7,001,045 | B2 | 2/2006 | Gregerson et al. | |
| 7,108,421 | B2 | 9/2006 | Gregerson et al. | |
| 7,224,764 | B2 | 5/2007 | Sukovic et al. | |
| 7,388,894 | B2 | 6/2008 | Sukovic et al. | |
| 7,388,941 | B2 | 6/2008 | Sukovic et al. | |
| 7,394,888 | B2 | 7/2008 | Sukovic et al. | |
| 7,460,636 | B2 | 12/2008 | Ein-Gal | |
| 7,471,765 | B2 | 12/2008 | Jaffray et al. | |
| 7,558,367 | B1 | 7/2009 | Tinwala et al. | |
| 8,210,745 | B2 | 7/2012 | Yorkston et al. | |
| 8,348,506 | B2 * | 1/2013 | Yorkston | A61B 6/032
378/196 |
| 8,746,972 | B2 | 6/2014 | Yorkston et al. | |
| 9,240,045 | B2 | 1/2016 | Noshi et al. | |
| 9,277,899 | B2 | 3/2016 | Yorkston et al. | |
| 2003/0026464 | A1 | 2/2003 | Kamiyama et al. | |
| 2003/0072416 | A1 | 4/2003 | Rasche et al. | |
| 2003/0091156 | A1 * | 5/2003 | Crain | A61B 6/107
378/197 |
| 2004/0022350 | A1 | 2/2004 | Gregerson et al. | |
| 2004/0096035 | A1 | 5/2004 | Yamazaki et al. | |
| 2004/0120467 | A1 | 6/2004 | Wollenweber | |
| 2005/0053185 | A1 | 3/2005 | Sukovic et al. | |
| 2005/0053186 | A1 | 3/2005 | Sukovic et al. | |
| 2006/0245539 | A1 | 11/2006 | Sukovic et al. | |
| 2007/0036274 | A1 | 2/2007 | Haras et al. | |
| 2007/0053486 | A1 | 3/2007 | Zelnik et al. | |
| 2008/0013691 | A1 | 1/2008 | Gregerson | |
| 2008/0022890 | A1 | 1/2008 | Doumaux et al. | |
| 2008/0037701 | A1 | 2/2008 | Banks | |
| 2008/0037712 | A1 * | 2/2008 | Klingenbeck-Regn | A61B 6/102
378/167 |
| 2008/0056440 | A1 | 3/2008 | Fischer et al. | |
| 2008/0101533 | A1 | 5/2008 | Ein-Gal | |
| 2008/0112534 | A1 | 5/2008 | Defreitas et al. | |
| 2008/0205584 | A1 | 8/2008 | Sukovic et al. | |
| 2008/0245972 | A1 | 10/2008 | Drapeau | |
| 2008/0285724 | A1 | 11/2008 | Dehler | |
| 2009/0080604 | A1 | 3/2009 | Shores et al. | |
| 2009/0097618 | A1 | 4/2009 | Jiang et al. | |
| 2009/0128351 | A1 | 5/2009 | Ma | |

- | | | | |
|--------------|----|---------|-------------------|
| 2009/0175406 | A1 | 7/2009 | Zhang et al. |
| 2009/0252290 | A1 | 10/2009 | Plut et al. |
| 2010/0172468 | A1 | 7/2010 | Gregerson |
| 2010/0278300 | A1 | 11/2010 | Yorkston et al. |
| 2010/0329534 | A1 | 12/2010 | Biermann et al. |
| 2011/0082348 | A1 | 4/2011 | Herold et al. |
| 2011/0210261 | A1 | 9/2011 | Maurer, Jr. |
| 2011/0228901 | A1 | 9/2011 | Yorkston et al. |
| 2011/0280364 | A1 | 11/2011 | Maschke |
| 2012/0043475 | A1 | 2/2012 | Ahn |
| 2012/0059239 | A1 | 3/2012 | Yamaguchi |
| 2012/0078568 | A1 | 3/2012 | Koelling et al. |
| 2012/0256099 | A1 | 10/2012 | Gregerson et al. |
| 2012/0289821 | A1 | 11/2012 | Graumann et al. |
| 2012/0300909 | A1 | 11/2012 | Simmons et al. |
| 2013/0004042 | A1 | 1/2013 | Yang et al. |
| 2013/0032413 | A1 | 2/2013 | Smith et al. |
| 2014/0003583 | A1 | 1/2014 | Krupica et al. |
| 2015/0173703 | A1 | 6/2015 | Siewerdsen et al. |

FOREIGN PATENT DOCUMENTS

- | | | |
|----|-----------------|------------|
| CN | 101589957 | 5/2009 |
| CN | 102421368 | 5/2010 |
| CN | 202027591 | 4/2011 |
| CN | 102429672 | 9/2011 |
| DE | 198 46 980 | 10/1999 |
| DE | 101 46 915 | 4/2003 |
| DE | 101 47 157 | 4/2003 |
| DE | 10 2005 013 832 | 8/2006 |
| DE | 10 2008 019 646 | 10/2009 |
| EP | 0 119 660 | 9/1984 |
| EP | 1016375 | 12/1999 |
| EP | 0 676 911 | 9/2000 |
| EP | 0 919 187 | 1/2005 |
| EP | 2127696 | 3/2009 |
| JP | H02-228946 | 9/1990 |
| JP | H05-192342 | 8/1993 |
| JP | H07-023942 | 1/1995 |
| JP | H10-328173 | 12/1998 |
| JP | 2001-29342 | 2/2001 |
| JP | 2001-37747 | 2/2001 |
| JP | 2001-269332 | 10/2001 |
| JP | 2003-088523 | 3/2003 |
| JP | 2005-517486 | 6/2005 |
| JP | 2006-314605 | 11/2006 |
| JP | 2007-159598 | 6/2007 |
| JP | 2010-154992 | 7/2010 |
| JP | 2010-200929 | 9/2010 |
| JP | 2013-066784 | 4/2013 |
| WO | 95/21570 | 8/1995 |
| WO | 95/22241 | 8/1995 |
| WO | 95/31936 | 11/1995 |
| WO | 03/070101 | 8/2003 |
| WO | 03/077763 | 9/2003 |
| WO | 2006-042211 | A2 4/2006 |
| WO | 2006-119420 | A1 11/2006 |
| WO | 2010/078481 | 7/2010 |
| WO | 2011/126555 | 10/2011 |
| WO | 2011/156526 | 12/2011 |
| WO | 2014/058775 | 4/2014 |

OTHER PUBLICATIONS

Robert B. Stanley, "Use of intraoperative computed tomography during repair of orbitozygomatic fractures," Archives of facial plastic surgery 1.1, 1999, pp. 19-24.

European Search Report, application No. EP 16195074, dated Feb. 1, 2017, 2 pages.

International Search Report for International application No. PCT/US2010/001308, dated Nov. 22, 2010, 2 pages.

International Search Report for International application No. PCT/US2011/000596, dated Nov. 23, 2011, 2 pages.

Supplementary European Search Report for application No. EP 10 77 2373, dated Apr. 10, 2013, 2 pages.

International Search Report for International application No. PCT/US2013/063670 dated Dec. 10, 2013, 3 pages.

(56)

References Cited

OTHER PUBLICATIONS

International Search Report for International application No. PCT/US2013/063673 dated Feb. 14, 2014, 4 pages.

International Search Report for International application No. PCT/US2013/063666 dated Feb. 7, 2014, 3 pages.

International Search Report for International application No. PCT/US2013/063662 dated Feb. 17, 2014, 3 pages.

Definitions-Merriam-Webster.com, Merriam-Webster, n. d. Wed, Aug. 2, 2016.

Page from website=www.planmed.com, 1 page, Mar. 2011.

European Search Report, EP Application No. 18 199 035.9, dated Feb. 12, 2019, 2 pages.

Jeffrey H. Siewerdsen, et al., "Optimization of x-ray imaging geometry (with specific application to flat-panel cone-beam computed tomography)," Med. Phys. 27 (8), Aug. 2000, pp. 1903-1914.

* cited by examiner

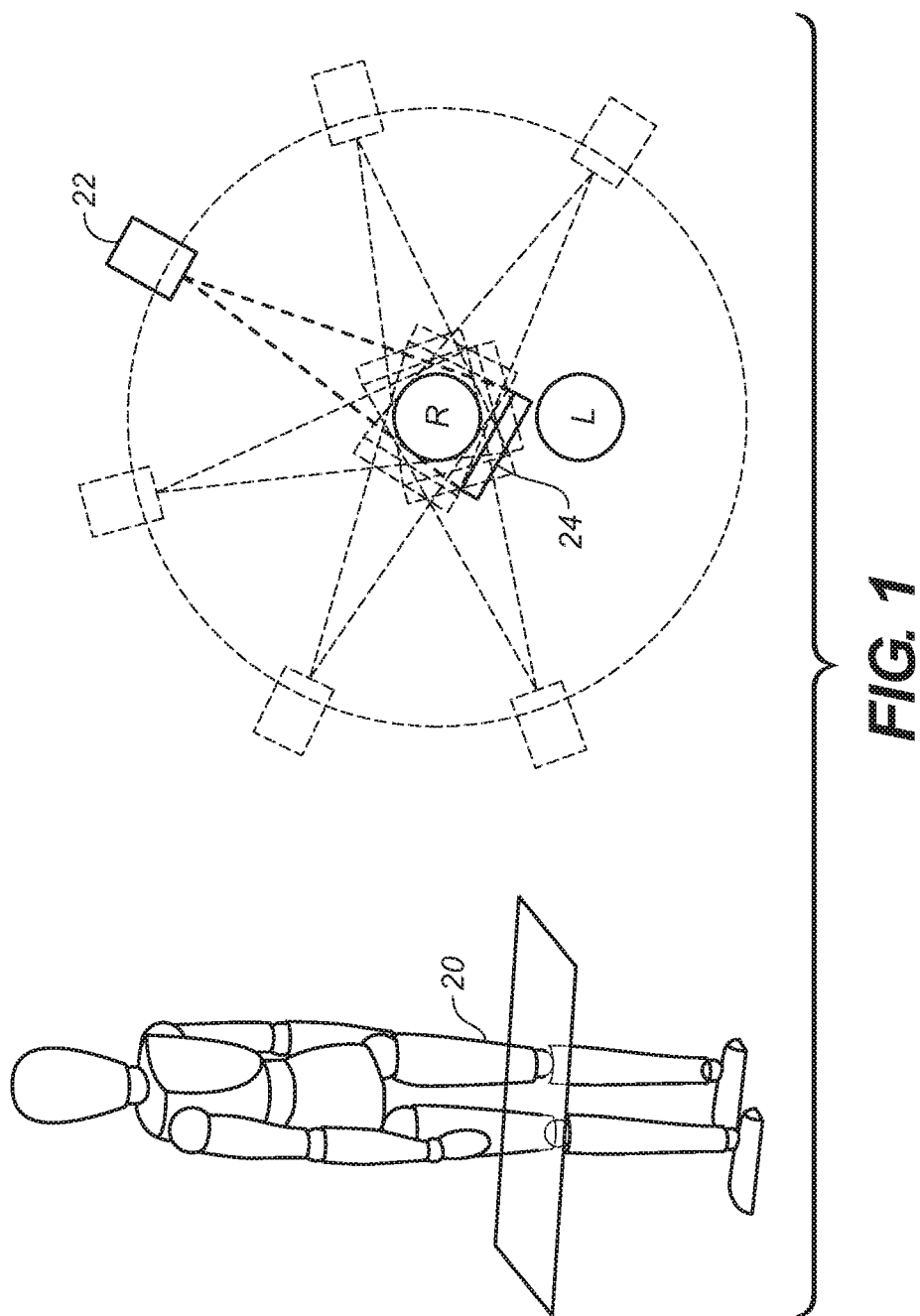

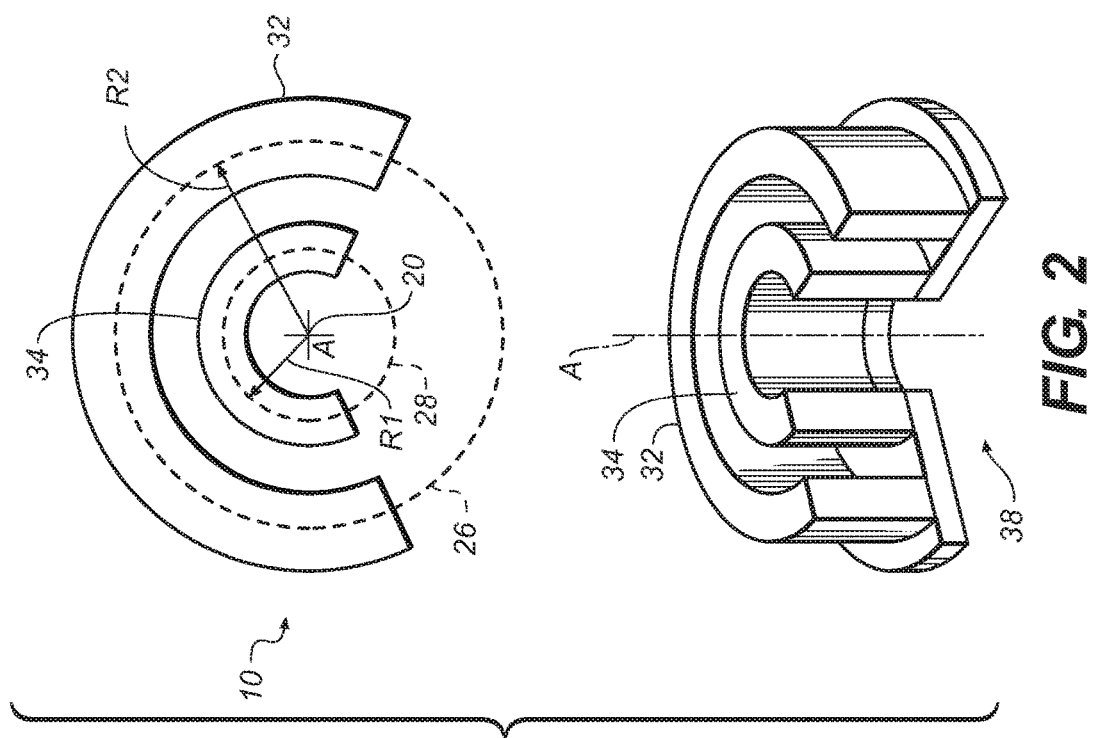

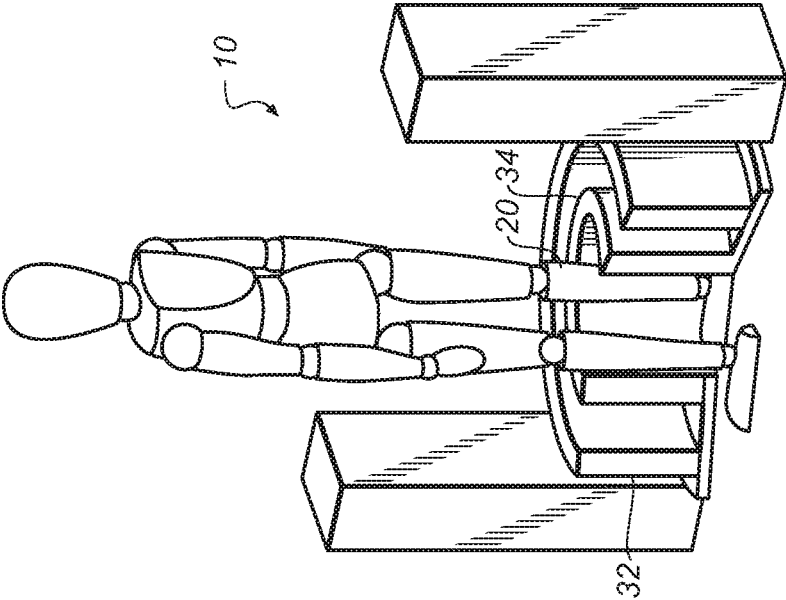
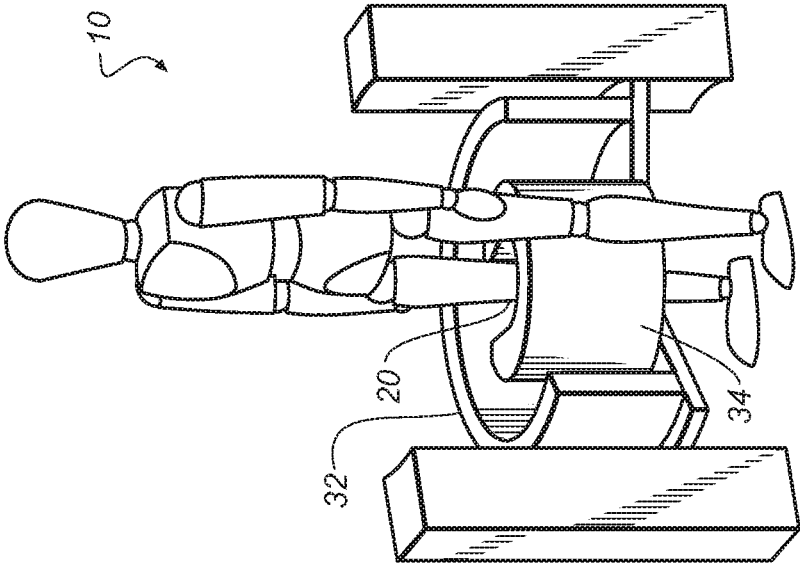
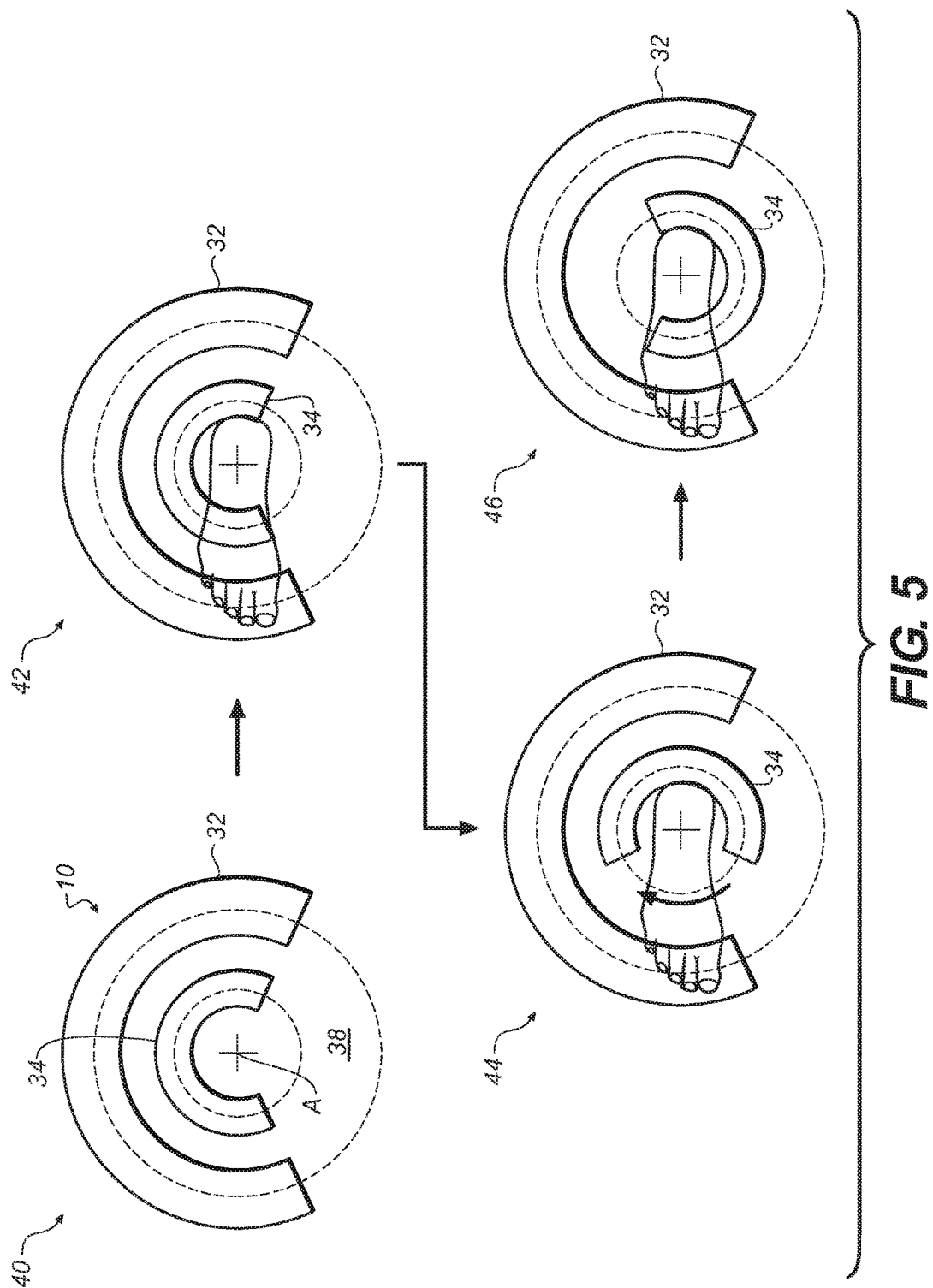
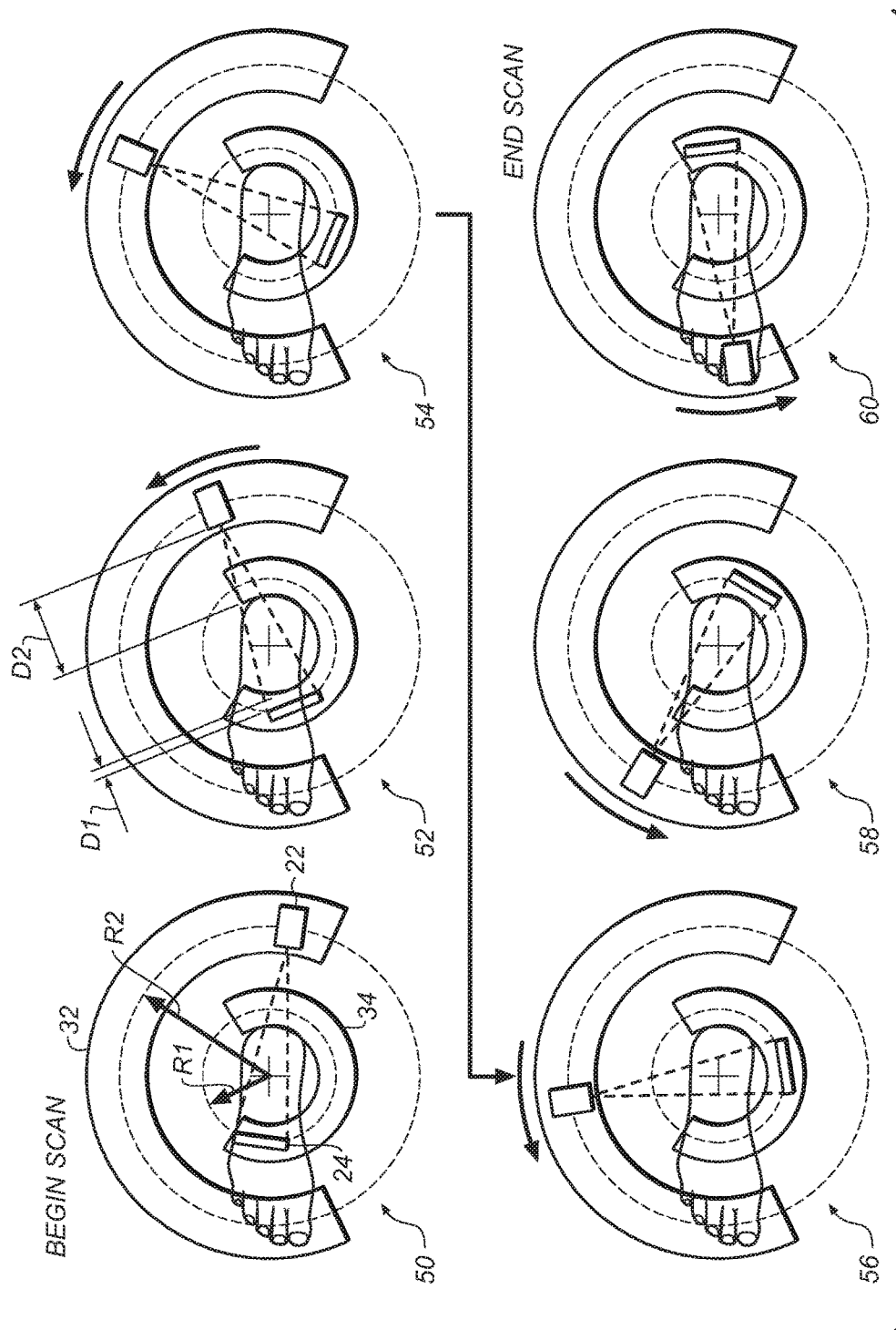
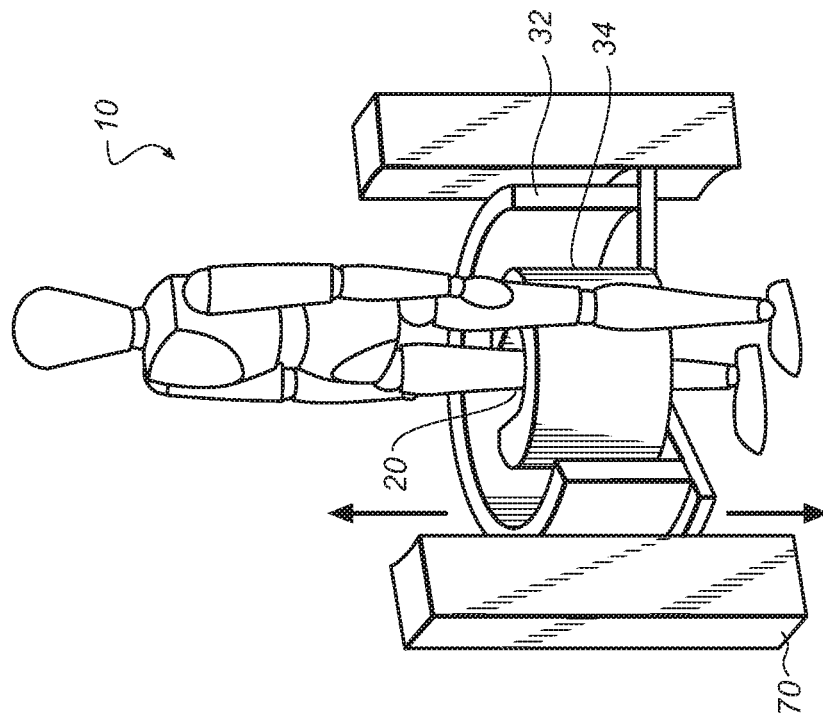

FIG. 3









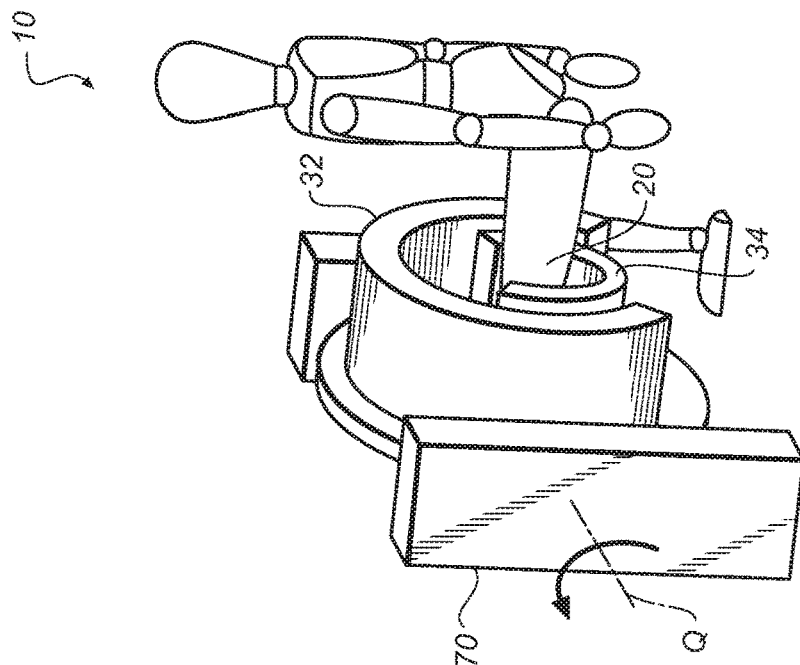

FIG. 8A

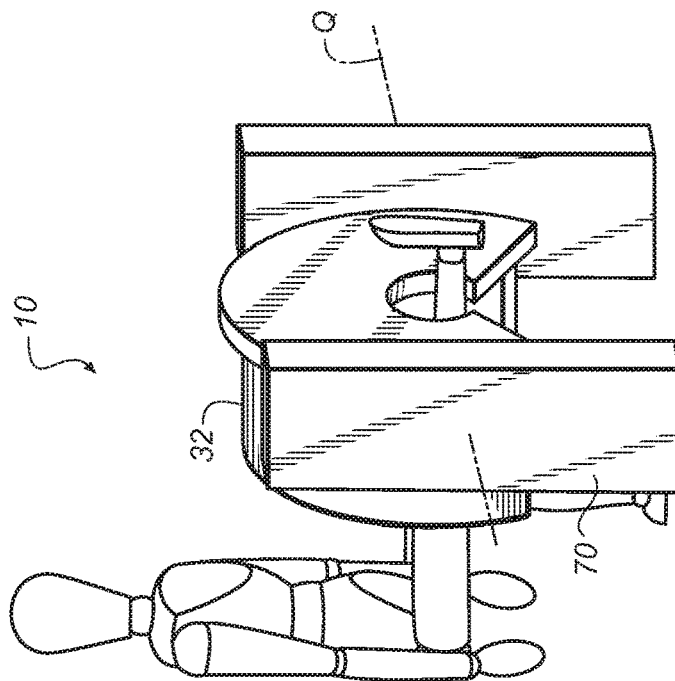

FIG. 8B

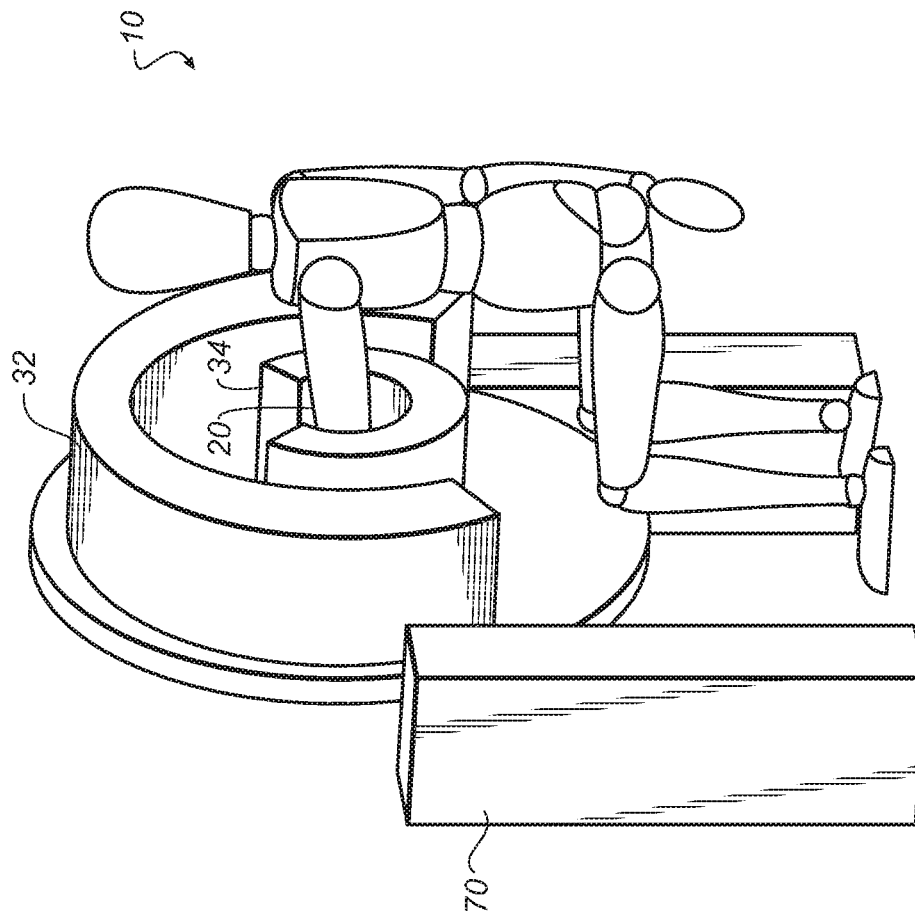
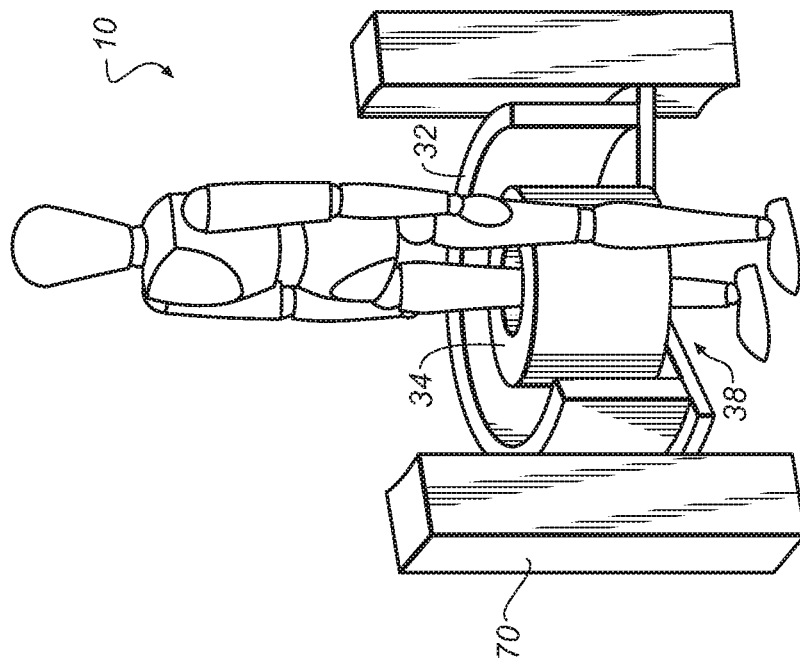

FIG. 9



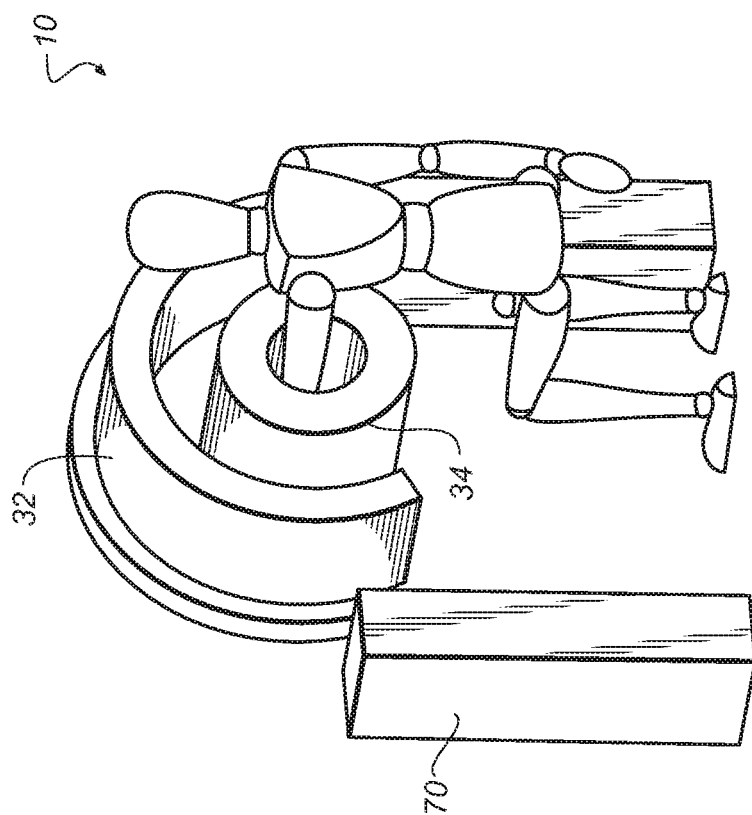

FIG. 11

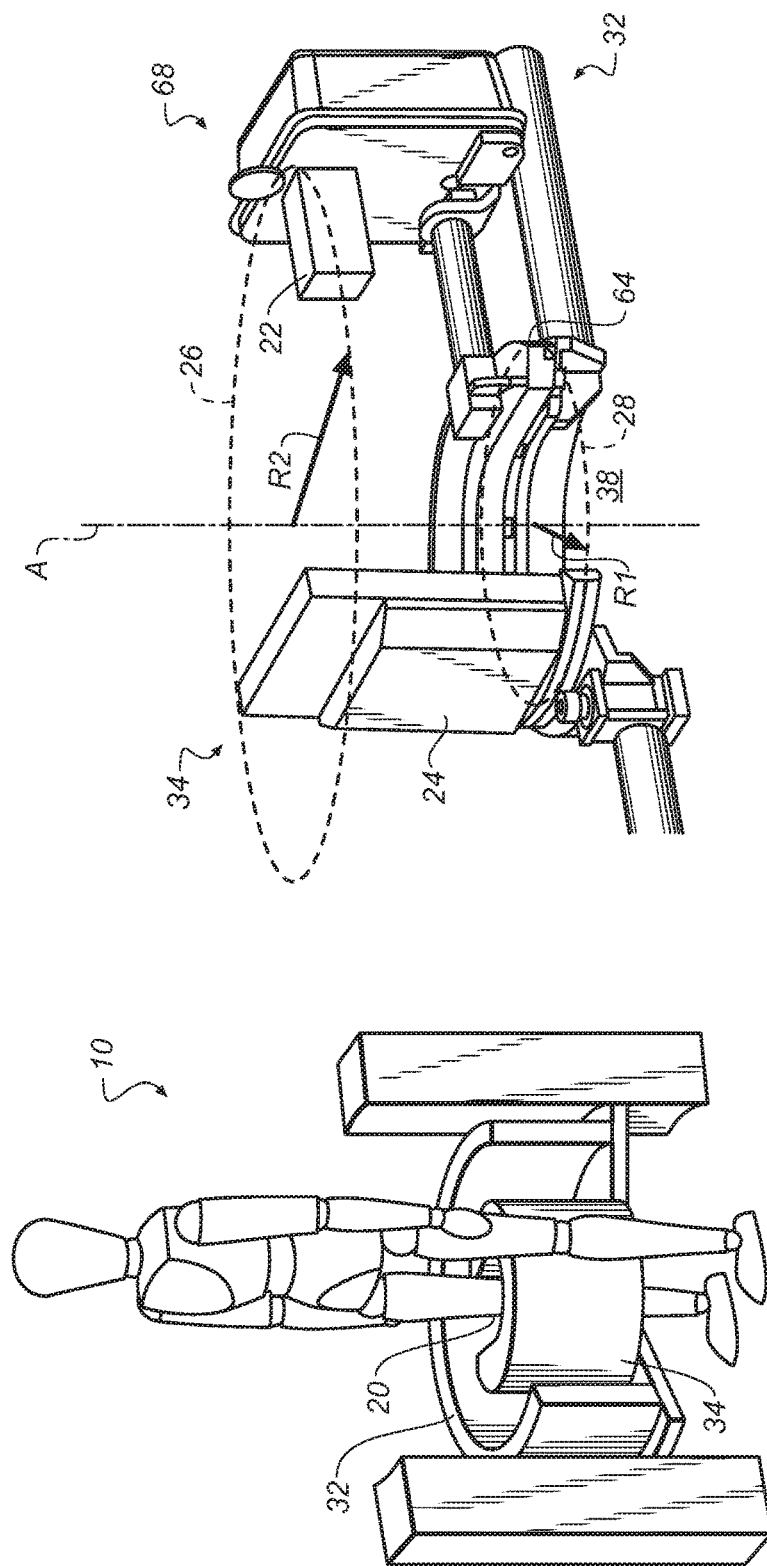

FIG. 12A

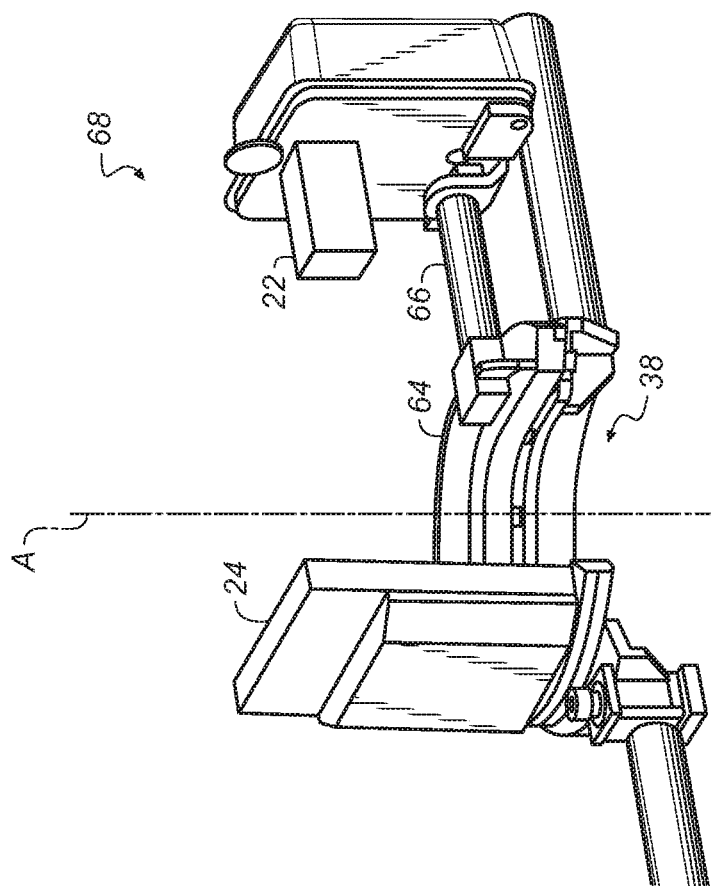

FIG. 12B

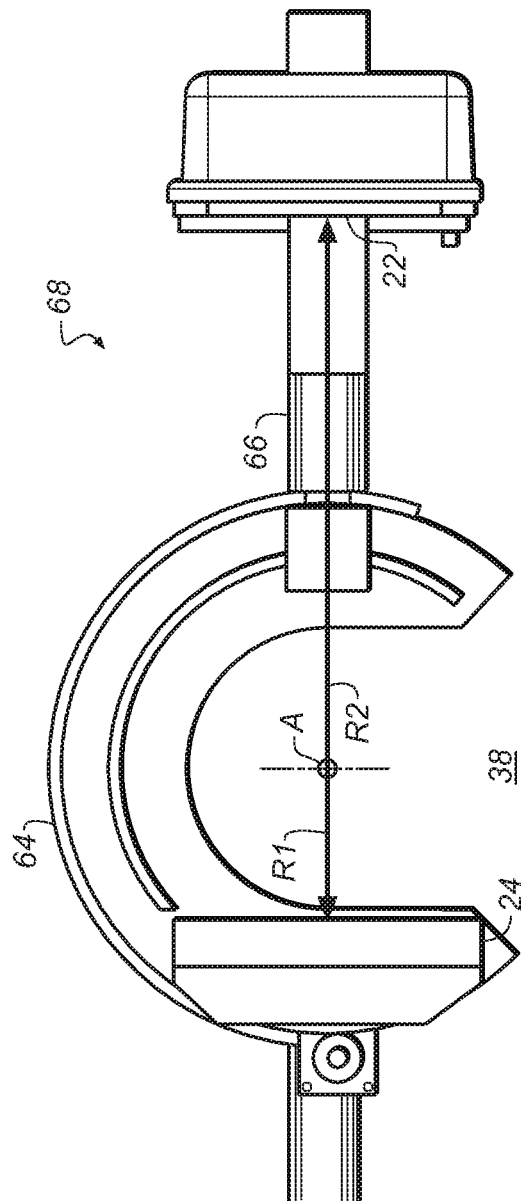

FIG. 13

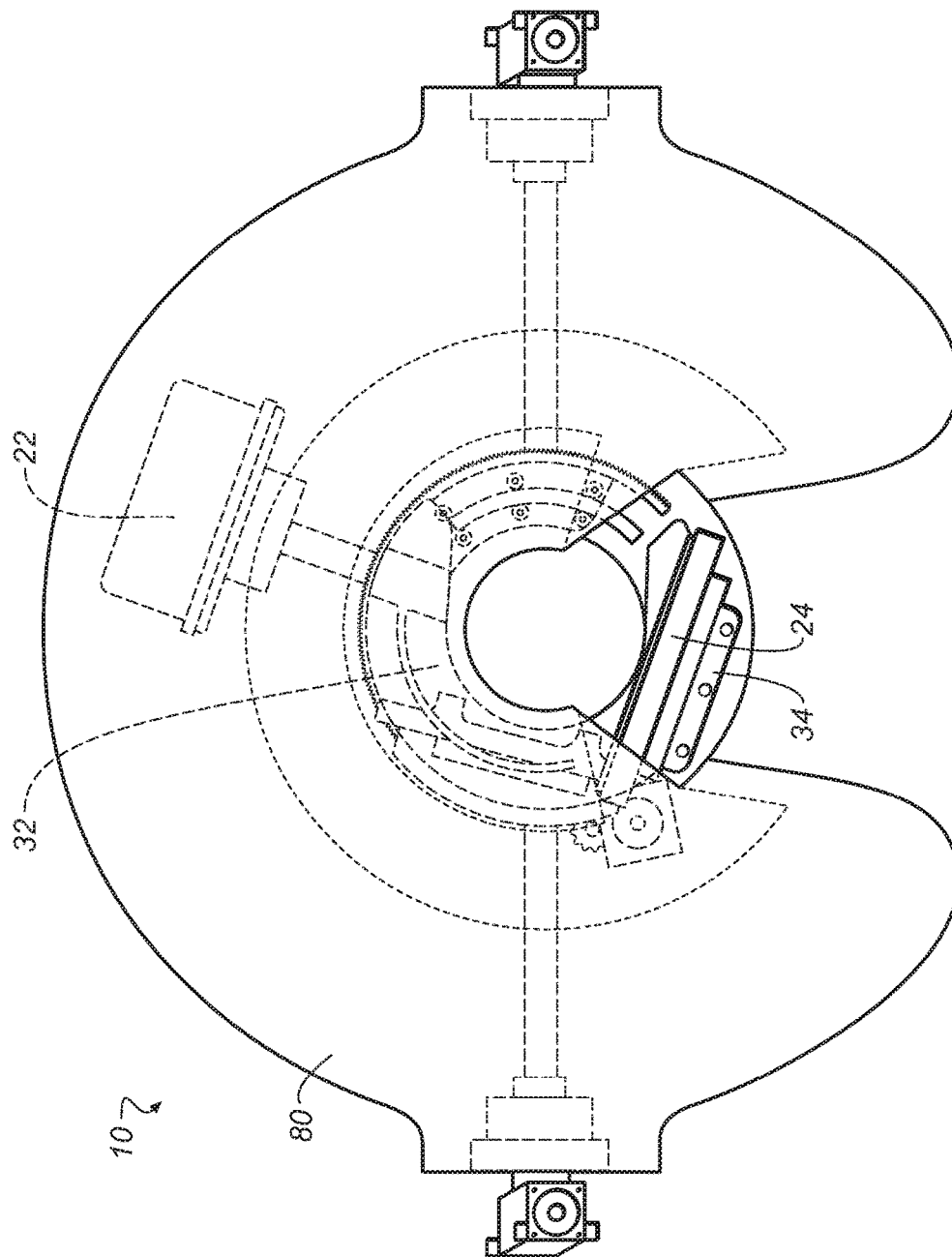
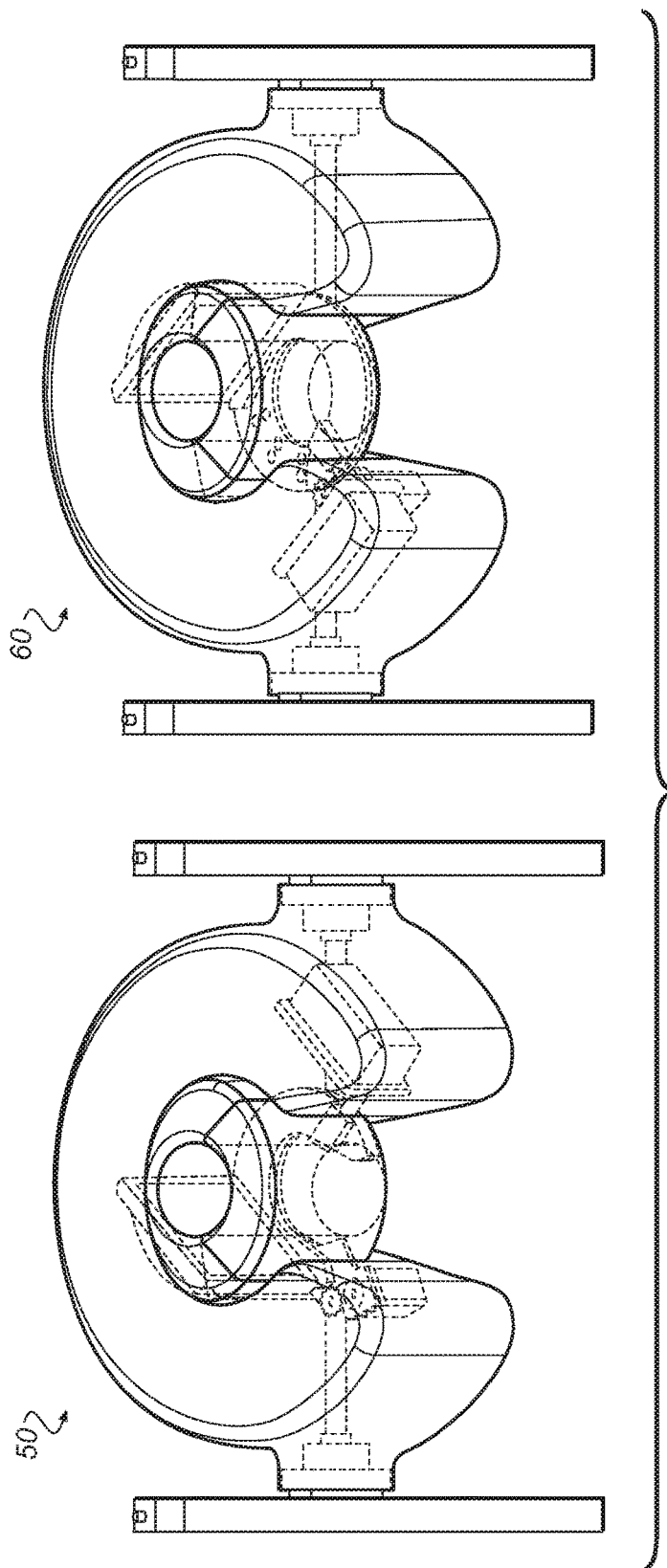
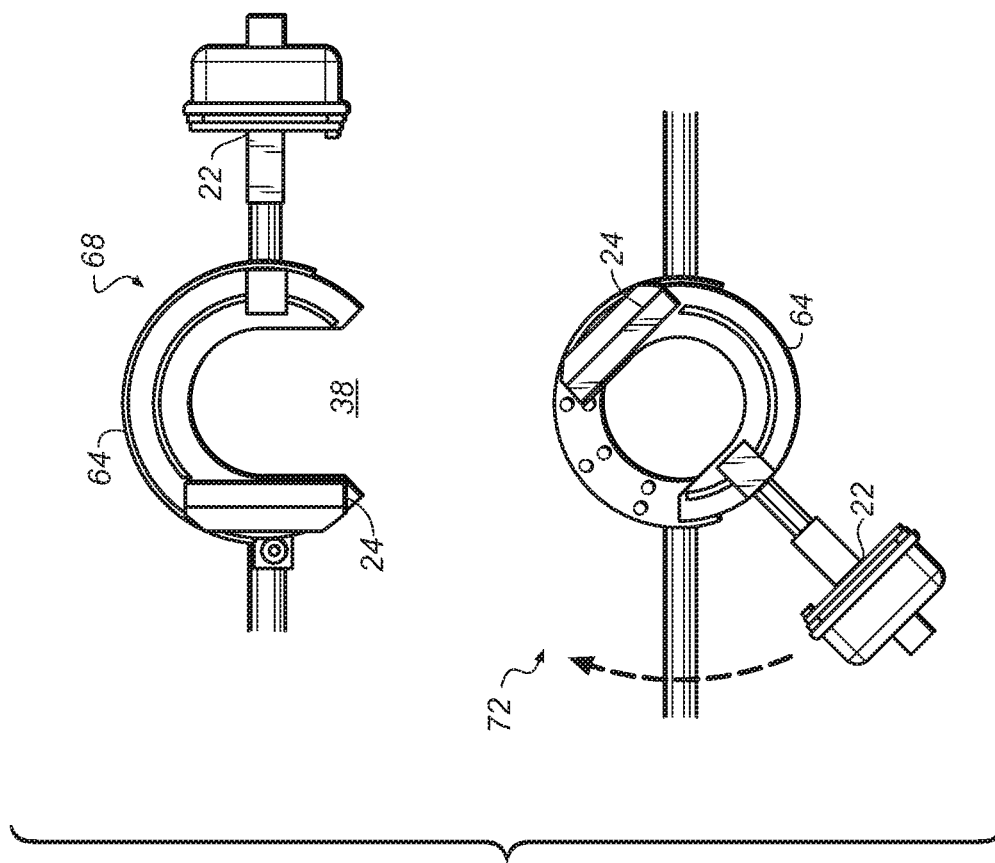

FIG. 14A





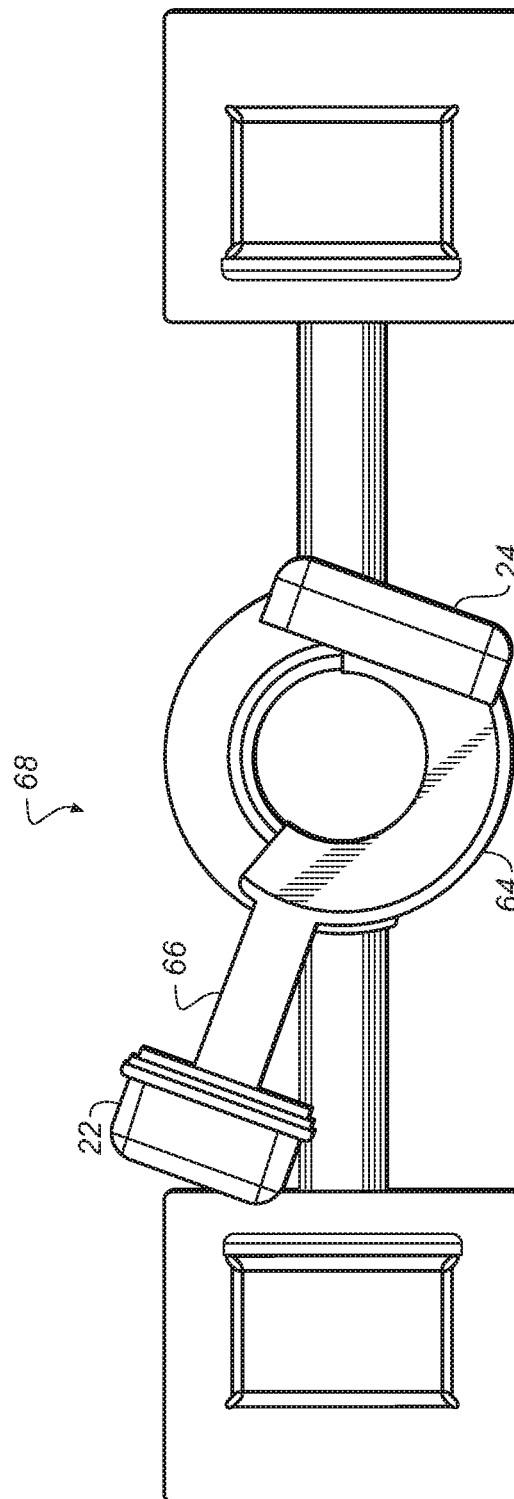

FIG. 16

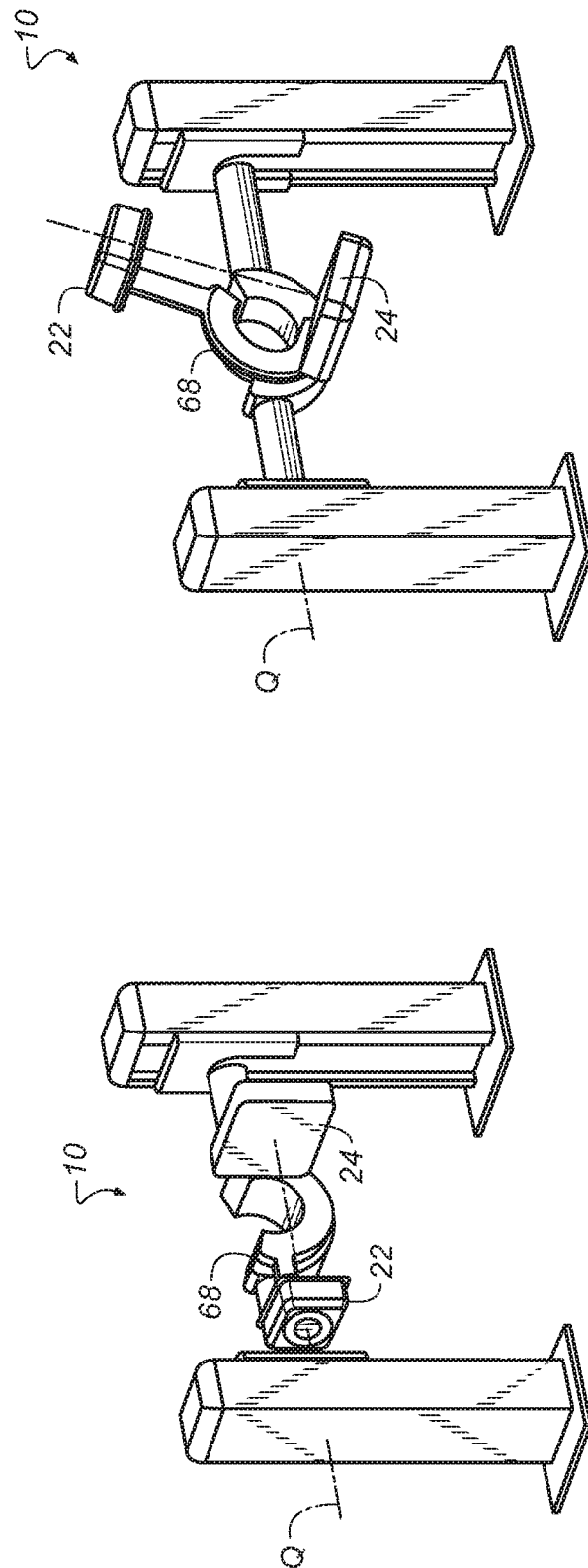

FIG. 17

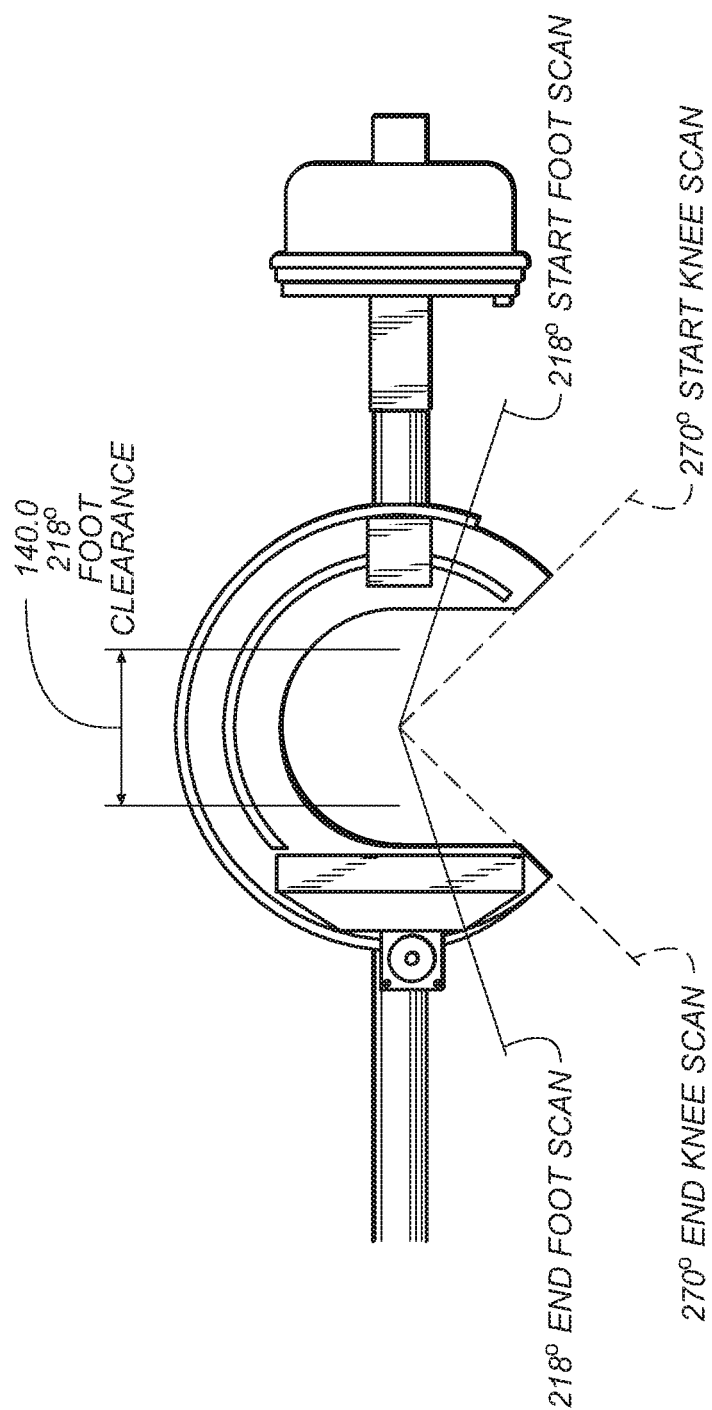

FIG. 18

1

**EXTREMITY IMAGING APPARATUS FOR
CONE BEAM COMPUTED TOMOGRAPHY****CROSS REFERENCE TO RELATED
APPLICATIONS**

This patent application is a continuation of U.S. patent application Ser. No. 15/424,935, filed Feb. 6, 2017, in the name of Yorkston et al., entitled EXTREMITY IMAGING APPARATUS FOR CONE BEAM COMPUTED TOMOGRAPHY, which is a continuation of U.S. patent application Ser. No. 15/012,995, filed Feb. 2, 2016, in the name of Yorkston et al., entitled EXTREMITY IMAGING APPARATUS FOR CONE BEAM COMPUTED TOMOGRAPHY, which is a continuation of U.S. Pat. No. 9,277,899, filed Mar. 5, 2015, in the name of Yorkston et al., entitled EXTREMITY IMAGING APPARATUS FOR CONE BEAM COMPUTED TOMOGRAPHY, which is a continuation of U.S. Pat. No. 8,998,486, filed May 1, 2014, in the name of Yorkston et al., entitled EXTREMITY IMAGING APPARATUS FOR CONE BEAM COMPUTED TOMOGRAPHY, which is a continuation of U.S. Pat. No. 8,746,972, filed Nov. 20, 2012, in the name of Yorkston et al., entitled EXTREMITY IMAGING APPARATUS FOR CONE BEAM COMPUTED TOMOGRAPHY, which is a continuation of U.S. Pat. No. 8,348,506, filed Apr. 30, 2010, in the name of Yorkston et al., entitled EXTREMITY IMAGING APPARATUS FOR CONE BEAM COMPUTED TOMOGRAPHY, which claims the benefit of U.S. Ser. No. 61/175,091 provisionally filed on May 4, 2009, in the names of Yorkston et al., entitled Cone Beam Computed Tomography (CBCT) For Extremity Imaging, which is hereby incorporated herein by reference in its entirety.

FIELD OF THE INVENTION

The invention relates generally to diagnostic imaging and in particular to cone beam imaging systems used for obtaining volume images of extremities.

BACKGROUND OF THE INVENTION

3-D volume imaging has proved to be a valuable diagnostic tool that offers significant advantages over earlier 2-D radiographic imaging techniques for evaluating the condition of internal structures and organs. 3-D imaging of a patient or other subject has been made possible by a number of advancements, including the development of high-speed imaging detectors, such as digital radiography (DR) detectors that enable multiple images to be taken in rapid succession.

Cone beam (CB) computed tomography (CT) (CBCT) or cone beam CT technology offers considerable promise as one type of diagnostic tool for providing 3-D volume images. Cone beam CT systems capture volumetric data sets by using a high frame rate digital radiography (DR) detector and an x-ray source, typically affixed to a gantry that rotates about the object to be imaged, directing, from various points along its orbit around the subject, a divergent cone beam of x-rays toward the subject. The CBCT system captures projections throughout the rotation, for example, one 2-D projection image at every degree of rotation. The projections are then reconstructed into a 3D volume image using various techniques. Among the most common methods for reconstructing the 3-D volume image are filtered back projection approaches.

2

Although 3-D images of diagnostic quality can be generated using CBCT systems and technology, a number of technical challenges remain. In some cases, for example, there can be a limited range of angular rotation of the x-ray source and detector with respect to the subject. CBCT Imaging of legs, arms, and other extremities can be hampered by physical obstruction from a paired extremity. This is an obstacle that is encountered in obtaining CBCT image projections for the human leg or knee, for example. Not all imaging positions around the knee are accessible; the patient's own anatomy prevents the radiation source and image detector from being positioned over a portion of the scan circumference.

To illustrate the issues faced in CBCT imaging of the knee, the top view of FIG. 1 shows the circular scan paths for a radiation source 22 and detector 24 when imaging the right knee R of a patient as a subject 20. Various positions of radiation source 22 and detector are shown in dashed line form. Source 22, placed at some distance from the knee, can be positioned at different points over an arc of about 200 degrees; with any larger arc, left knee L blocks the way. Detector 24, smaller than source 22 and typically placed very near subject 20, can be positioned between the patient's right and left knees and is thus capable of positioning over the full circular orbit.

A full 360 degree orbit of the source and detector is not needed for conventional CBCT imaging; instead, sufficient information for image reconstruction can be obtained with an orbital scan range that just exceeds 180 degrees by the angle of the cone beam itself, for example. However, in some cases it can be difficult to obtain much more than about 180 degree revolution for imaging the knee or other joints and other applications. Moreover, there can be diagnostic situations in which obtaining projection images over a certain range of angles has advantages, but patient anatomy blocks the source, detector, or both from imaging over that range.

For imaging the leg, one way around this problem is to arrange the patient in a pose such that the subject leg is extended into a CBCT scanning apparatus and the paired leg is supported in some other way or bent with respect to the subject leg, such as at a right angle. This is the approach used, for example, in the CT scanner device taught in U.S. Pat. No. 7,394,888 entitled "CT Scanner for Lower Extremities" to Sukovic et al. In the methods of the Sukovic et al. '888 disclosure, the other leg must either be lifted out of place or spread at a distance, or is relaxed while the subject leg is lifted out of place and extended into the scanner equipment. This arrangement can be particularly disadvantageous for a number of reasons. It can be helpful, for example, to examine the condition of a knee or ankle joint under the normal weight load exerted on that joint by the patient. But, in requiring the patient to assume a position that is not usually encountered in typical movement, the Sukovic et al. '888 apparatus may obtain an image when there is excessive strain, or insufficient strain, or poorly directed strain, on the joint.

Another issue with conventional approaches relates to imaging of a load-bearing extremity such as the human leg. Because of the inability to image the leg under a normal load, as the patient is in a standing position, various artificial ways of mimicking load conditions have been attempted. Such approaches have used various types of braces, compression devices, and supports. As one example intended to remedy the shortcomings of conventional imaging techniques, the Sukovic et al. '888 disclosure teaches simulating the normal loading of the leg by elevating the leg to a

non-standing position, then applying an external force against the leg. However, it can be readily appreciated that while this type of simulation allows some approximation of load-bearing limb response, it can be inaccurate. The knee or ankle joint, under some artificially applied load and at an angle not taken when standing, may not behave exactly as it does when bearing the patient's weight in a standing position.

Another difficulty with the Sukovic et al. '888 apparatus and with other devices designed to address knee and lower leg imaging relates to poor image quality. For image quality, the CBCT sequence requires that the detector be up close to the subject and the source of the cone beam radiation be at a sufficient distance from the subject. This provides the best image and reduces image truncation and consequent lost data. Positioning the subject midway between the detector and the source, as Sukovic et al. '888 apparatus and with other devices require, not only noticeably compromises image quality, but also places the patient too near the radiation source, so that radiation levels are considerably higher. One example of this strategy is shown in German patent publication DE 10146915. With the C-shaped gantry arrangement shown, centering the subject at the center of rotation of source and detector would apply considerably higher radiation amounts with each projection and severely compromise image quality. Any other positioning of the subject, such as closer to the detector, might reduce radiation levels over some part of the image capture sequence, but would result in unduly complex image reconstruction problems, since this would actually vary the distances between radiation source and subject and between subject and detector with each projection image obtained. Attempted imaging of the knee with such a system would require the patient to be supported in some way, balancing on the leg being imaged. It can be appreciated that this requirement is unreasonable or impossible for many situations in which an injured knee is being imaged. Thus, the C-shaped gantry shown would not be suitable for imaging only one knee of the patient.

Imaging of the foot and ankle presents additional obstacles for CBCT projection image capture. Approaches such as that given in the Sukovic et al. '888 disclosure, centering the foot between source and detector, suffer from the same problems of poorly positioned exposure and noticeably compromised image quality.

In summary, for extremity imaging, particularly for imaging the lower paired extremities, a number of improvements are needed, including the following: (i) improved placement of the radiation source and detector to provide acceptable radiation levels and image quality throughout the scanning sequence; (ii) system flexibility for imaging at different heights with respect to the rotational axis of the source and detector, including the flexibility to allow imaging with the patient standing or seated comfortably, such as with a foot in an elevated position, for example; (iii) improved patient accessibility, so that the patient does not need to contort, twist, or unduly stress limbs or joints that may have been injured in order to provide images of those body parts; (iv) improved ergonomics for obtaining the CBCT image, allowing the patient to stand with normal posture, for example. This would also allow load-bearing extremities, such as legs, knees, and ankles, to be imaged under the normal load exerted by the patient's weight, rather than under simulated loading conditions as taught in the Sukovic et al. '888 disclosure and elsewhere.

Thus, it can be seen that although a number of solutions have been proposed to address the problem of CBCT

extremity imaging, conventional solutions fall short of what is needed for both usability and performance.

SUMMARY OF THE INVENTION

It is an object of the present invention to advance the art of diagnostic imaging of extremity body parts, particularly jointed or load-bearing, paired extremities such as knees, legs, ankles, fingers, hands, wrists, elbows, arms, and shoulders.

It is a feature of the present invention that it provides an apparatus with different radii for orbital paths of sensor and radiation source components.

It is an advantage of the present invention that it allows imaging of load-bearing extremities for a patient who is standing.

From one aspect, the present invention provides apparatus for cone beam computed tomography of an extremity of a patient, the apparatus comprising: a digital radiation detector; a first device to move the detector along at least a portion of a circular detector path, the portion of the detector path extending so that the detector moves both at least partially around a first extremity of the patient and between the first extremity and a second, adjacent extremity of the patient, the detector path having a radius R_1 that is sufficiently long to allow the first extremity of the patient to be positioned approximately at a center of the detector path; a radiation source; a second device to move the source along at least a portion of a concentric circular source path having a radius R_2 greater than radius R_1 , radius R_2 being sufficiently long to allow adequate radiation exposure of the first extremity for an image capture by the detector; and a first circumferential gap in the source path to allow the second extremity to be positioned in the first circumferential gap during the image capture.

According to another aspect, the present invention provides an apparatus for cone beam computed tomography of a portion of a subject leg of a patient who is standing on the subject leg and its paired leg, the apparatus comprising: a digital radiation detector; a detector transport that defines a detector path for movement of the digital radiation detector along a first circular arc, wherein the first circular arc has a radius R_1 with respect to a central point within the subject leg and wherein the first circular arc extends through the space between the subject leg and its paired leg; a radiation source; a radiation source transport that defines a radiation source path for movement of the radiation source along a second circular arc of a second radius R_2 , larger than radius R_1 , with respect to the central point in the subject leg, wherein the second circular arc lies outside the space between the subject leg and its paired leg; and a circumferential gap in the radiation source path for placement of the subject leg.

These objects are given only by way of illustrative example, and such objects may be exemplary of one or more embodiments of the invention. Other desirable objectives and advantages inherently achieved by the disclosed invention may occur or become apparent to those skilled in the art. The invention is defined by the appended claims.

BRIEF DESCRIPTION OF THE DRAWINGS

The foregoing and other objects, features, and advantages of the invention will be apparent from the following more particular description of the embodiments of the invention,

as illustrated in the accompanying drawings. The elements of the drawings are not necessarily to scale relative to each other.

FIG. 1 is a schematic view showing the geometry and limitations of CBCT scanning for portions of the lower leg.

FIG. 2 shows a top and perspective view of the scanning pattern for an imaging apparatus according to an embodiment of the present invention.

FIG. 3 is a perspective view showing patient access to an imaging apparatus according to an embodiment of the present invention.

FIG. 4 is a perspective view showing the patient in a scanning position.

FIG. 5 is a series of top schematic views showing the sequence for patient access and system preparation for CBCT imaging.

FIG. 6 is a series of top schematic views showing the sequence for obtaining CBCT projections at a number of angular positions.

FIG. 7 is a perspective view showing optional height adjustment.

FIGS. 8A and 8B are perspective views that show extremity imaging for an extended leg in an alternate configuration.

FIG. 9 is a perspective view that shows a configuration of the imaging apparatus for upper extremity imaging.

FIG. 10 is a perspective view that shows imaging with the detector transport fully encircling the lower extremity.

FIG. 11 is a perspective view that shows imaging with the detector transport fully encircling the upper extremity.

FIG. 12A shows perspective views of imaging apparatus with and without covers.

FIG. 12B is a perspective view of an imaging apparatus using a turntable for source and detector transport.

FIG. 13 is a top view of the transport arrangement shown in FIG. 12B.

FIG. 14A shows a top view of the imaging apparatus with the hood partially transparent.

FIG. 14B shows internal components in start and stop scan positions.

FIG. 15 shows top views of the turntable transport arrangement for initial positioning of the extremity of the patient and beginning of scan.

FIG. 16 shows a top view during the scan sequence.

FIG. 17 shows perspective views of an embodiment for extremity imaging at a horizontal position.

FIG. 18 is a top view that compares angular considerations for foot and knee imaging.

DETAILED DESCRIPTION OF THE INVENTION

The following is a detailed description of the preferred embodiments of the invention, reference being made to the drawings in which the same reference numerals identify the same elements of structure in each of the several figures.

In the context of the present disclosure, the term “extremity” has its meaning as conventionally understood in diagnostic imaging parlance, referring to knees, legs, ankles, fingers, hands, wrists, elbows, arms, and shoulders and any other anatomical extremity. The term “subject” is used to describe the extremity of the patient that is imaged, such as the “subject leg”, for example. The term “paired extremity” is used in general to refer to any anatomical extremity wherein normally two or more are present on the same patient. In the context of the present invention, the paired extremity is not imaged; only the subject extremity is imaged.

To describe the present invention in detail, the examples given herein for embodiments of the present invention focus on imaging of the load-bearing lower extremities of the human anatomy, such as the leg, the knee, the ankle, and the foot, for example. However, these examples are considered to be illustrative and non-limiting.

In the context of the present disclosure, the term “arc” or, alternately, “circular arc”, has its conventional meaning as being a portion of a circle of less than 360 degrees or, considered alternately, of less than 2π radians for a given radius.

Embodiments of the present invention address the difficulties of lower extremity imaging by providing an imaging apparatus that defines orbital source and detector paths, concentric about a center point, wherein components that provide the source and detector paths are configured to allow patient access prior to and following imaging and configured to allow the patient to stand with normal posture during the CBCT image capture series. In embodiments of the present invention, this capability is effected by using a detector transport device that has a circumferential access opening allowing positioning of the extremity, wherein the detector transport device is revolved about the positioned extremity once it is in place, enclosing the extremity as it is revolved through at least a portion of the scan.

It is instructive to consider dimensional attributes of the human frame that can be considerations for design of CBCT equipment for scanning extremities. For example, an adult human patient of average height in a comfortable standing position has left and right knees generally anywhere from about 10 to about 35 cm apart. For an adult of average height, exceeding about 35-40 cm (14-15.7 inches) between the knees becomes increasing less comfortable and out of the range of normal standing posture. It is instructive to note that this constraint makes it impractical to use gantry solutions such as that shown in DE 10146915, described earlier, for knee imaging. Either the source or the detector must be able to pass between the legs of a standing patient for knee CBCT imaging, a capability not available with gantry or other conventional solutions.

The perspective and top views of FIG. 2 show how the scanning pattern is provided using various embodiments of a CBCT imaging apparatus 10 according to the present invention. A detector path 28 of a suitable radius R1 from a central axis A is provided by a first device, a detector transport 34. A source path 26 of a second, larger radius R2 is provided by a second device, a source transport 32. The extremity, subject 20, is substantially centered along central axis A so that central axis A can be considered as a line through points in subject 20. The limiting geometry for image capture is due to the arc of source transport 32, blocked by patient anatomy, such as by a paired limb, to typically about 200 degrees, as noted previously. This defines a partial circular sector, bounded by this arc and radii at start and end-of-scan.

Detector transport 34, while capable of a fully circular orbit because it can be moved between the standing patient's legs, follows the necessary complementary arc to that of source transport 32. Patient access before scanning is eased by providing a circumferential gap 38 in detector transport 34. With detector transport 34 in the open position shown in FIG. 3, the patient can freely move in and out of position for imaging. When the patient is properly in position, detector transport 34 is revolved about axis A, substantially 180 degrees. This orbital movement confines the extremity more narrowly and places detector 24, not visible in FIGS. 2-4 due

to the detector transport **34** housing, in position near subject **20** for obtaining the first projection image in sequence.

Circumferential gap **38** not only allows access for positioning of the subject leg or other extremity, but also allows sufficient space for the patient to stand in normal posture during imaging, placing the subject leg for imaging in the central position of axis A (FIG. 2) and the non-imaged paired leg within the space defined by circumferential gap **38**. Circumferential gap **38** extends approximately 180 degrees plus the fan angle, which is determined by source-detector geometry and distance.

The top views of FIG. 5 show the sequence for patient access for imaging apparatus **10**. In an open access position **40**, circumferential gap **38** permits access of the extremity so that it can be centered in position along central axis A. The outline of the foot corresponding to an open access position **42** indicates positioning of the patient and is shown for reference. In this example, the left leg is the subject imaged; the paired right leg would lie within or just outside circumferential gap **38**. Once the patient's leg or other extremity is in place, detector transport **34**, or a hooded cover or other member that defines this transport path, can be revolved into position, closing the detector portion of circumferential gap **38**, as shown in a revolving transport position **44**. A transport in place position **46** shows detector transport **34** in suitable position for executing the CBCT imaging sequence.

The top views of FIG. 6 continue the operational sequence begun in FIG. 5 and show the sequence for obtaining CBCT projections at a number of angular positions when using imaging apparatus **10**. The relative positions of radiation source **22** and detector **24**, which may be concealed under a hood, as noted earlier, are shown in FIG. 6. The source and detector are diametrically opposite at each position during the CBCT scan and projection imaging. The sequence begins at a begin scan position **50**, with radiation source **22** and detector **24** at initial positions to obtain an image at a first angle. Then, both radiation source **22** and detector **24** revolve about axis A as represented in interim scan positions **52**, **54**, **56**, and **58**. Imaging terminates at an end scan position **60**. As this sequence shows, source **22** and detector **24** are in diametrically opposing positions relative to subject **20** at each imaging angle. Throughout the scanning cycle, detector **24** is within a short distance D1 of subject **20**. Source **22** is positioned beyond a longer distance D2 of subject **20**. The positioning of source and detector components can be carried out by separate actuators, one for each transport path, or by a single rotatable member, as described in more detail subsequently. It should be noted that scanning motion in the opposite direction, that is, clockwise with respect to the example shown in FIG. 6, is also possible, with the corresponding changes in initial and terminal scan positions.

Other features of imaging apparatus **10** are provided by the capability to move both source and detector transports **32** and **34** along the axis direction as a unit, as shown in the perspective view of FIG. 7. A vertical support **70** provides vertical transport of the imaging apparatus, so that the source and detector can be translated upwards or downwards in the direction of the central axis in order to suit patients of different heights and to image different portions of the leg. The height adjustment can be made before or after the patient's subject leg to be imaged is enclosed by detector transport **34** using the setup sequence of FIG. 5.

In one embodiment, vertical support **70** also allows rotation of the CBCT imaging apparatus **10** to allow imaging of an extremity that is disposed horizontally or is extended at some oblique angle other than vertical. FIGS. 8A and 8B

show perspective views of knee imaging in a horizontal position, with the patient seated and the leg outwardly extended. Full 360 degree rotation about an axis Q is possible. It should be noted that, with this application, similar patient accessibility applies, with detector transport **34** revolved into position once the extremity is centered in place. Further height adjustment is also possible, such as for arm, elbow, or shoulder imaging, as shown in FIG. 9.

Using revolving detector transport **34** simplifies patient access and provides sufficient imaging path for CBCT imaging, since the angular limitation of the orbital imaging path is due to source obstruction, rather than to the detector path. Thus, for example, detector transport **34** could fully encircle the limb, as shown in the examples of FIGS. 10 and 11. In these embodiments, there is a circumferential gap **38** only in the source orbit.

Referring back to the schematic diagrams of FIG. 6, radiation source **22** and detector **24** each orbit the subject along an arc with radii R2 and R1, respectively. Within source transport **32**, a source actuator could be used, cooperating with a separate, complementary detector actuator that is part of detector transport **34**. Thus, two independent actuator devices, one in each transport assembly, can be separately controlled and coordinated by an external logic controller to move source **22** and detector **24** along their respective arcs, in unison, about subject **20**.

In an alternate embodiment, source and detector transport components are mechanically linked to a single revolving or rotating assembly. One such arrangement, shown at the right in FIG. 12A and enlarged in FIG. 12B, provides source and detector transports **32** and **34** using a single mechanical assembly, a rotating member **68**, on a turntable **64** that revolves about central axis of rotation A and provides the needed radii for source **22** and detector **24**. As is best shown in the top view of FIG. 13, detector **24** rides along the surface of the C-shaped turntable **64**, orbiting the subject at radius R1. Source **22** is connected to turntable **64** along an arm **66** that provides the longer radius R2. Circumferential gap **38** extends across both source and detector paths.

It should be emphasized that the embodiments shown using rotating member **68** on turntable **64** can be encased in one or more housings, thereby providing similar appearance to imaging apparatus **10** shown in FIGS. 7-11, for example. This type of arrangement has advantages for isolating the patient from moving components and for alleviating at least some of the patient anxiety that might be caused by automatically moving components during imaging.

FIG. 14A shows sources and detector transports **32** and **34** and source and detector **22** and **24** components as they are fitted within covers **80** that protect moving mechanical parts and help to prevent patient contact with moving components. FIG. 14B shows the covered system with internal components in begin and end scan positions **50** and **60** respectively, when using the scan sequence described earlier with reference to FIG. 6.

The top views of FIGS. 13, 15, and 16 show how patient access is provided using this mechanical arrangement. Once the patient is positioned, rotating member **68** is swung around the positioned extremity, to a start position **72**, as shown at the bottom in FIG. 15. Imaging begins at this position and continues as rotating member **68** revolves source and detector components about axis A. For the example of FIGS. 15 and 16, rotating member **68** moves in a clockwise direction. Counter-clockwise rotation would also be possible.

Rotating member **68** can also be used with an imaging configuration for upper extremities, as shown in FIG. 17.

Because none of the patient anatomy blocks the transport path, a full circular orbit is permitted for scanning with this configuration. Again, full 360 degree rotation of the components in the plane of rotating member 68 is possible, about axis Q.

Imaging of the ankle and foot is also possible with CBCT imaging apparatus 10. However, because the foot protrudes outward into the desired detector transport path, the allowable angular range for foot imaging is more constrained than the range for leg and knee imaging. The top view of FIG. 18 shows, for example, that the angular range for CBCT scanning of the foot, for a standing patient, is about 50 degrees less than that for knee imaging, for example. A range of optional devices can also be provided to facilitate the imaging process. For example, a horizontal or vertical foot support can be provided for support of the patient's foot. Optionally, the foot support can be adjustable to some oblique angle between horizontal and vertical, such as at a 33 degree or 45 degree angle for example.

The invention has been described in detail with particular reference to a presently preferred embodiment, but it will be understood that variations and modifications can be effected within the spirit and scope of the invention. The presently disclosed embodiments are therefore considered in all respects to be illustrative and not restrictive. The scope of the invention is indicated by the appended claims, and all changes that come within the meaning and range of equivalents thereof are intended to be embraced therein.

PARTS LIST

10. CBCT imaging apparatus
 20. Subject
 22. Source
 24. Detector
 26. Source path
 28. Detector path
 32. Source transport
 34. Detector transport
 38. Circumferential gap
 40. Open access position
 42. Open access position
 44. Revolving transport position
 46. Transport in place position
 50. Begin scan position
 52, 54, 56, 58. Interim scan position
 60. End scan position
 64. Turntable
 66. Arm
 68. Rotating member
 70. Vertical support
 72. Start position
 74. Foot insert member
 80. Cover
 A. Central axis
 D1, D2. Distance
 L. Left knee
 Q. Axis
 R. Right knee
 R1, R2. Radius

What is claimed is:

1. An apparatus for tomographic imaging, the apparatus comprising:
 a radiographic radiation source;
 a digital radiographic detector;
 a turntable to move the source and detector about a central axis;

a detector support attached to the turntable and to the detector to support the detector as the detector moves about the central axis, the turntable having at least a portion thereof spaced from the central axis at a same distance as the detector is spaced from the central axis;
 a source support attached to the turntable and to the source to support the source as the source moves about the central axis, the source support having at least a portion thereof spaced at a distance from the central axis greater than the distance that the turntable is spaced from the central axis;
 a C-shaped housing configured to enclose the source as the source moves about the central axis and to enclose the detector as the detector moves about the central axis, the C-shaped housing comprising a gap configured to allow a subject to be positioned at the central axis by moving the subject through the housing gap; and
 a housing extension attached to the housing and configured to controllably extend from the housing across the housing gap to enclose the detector as the detector moves across the housing gap and to prevent the subject from moving through the housing gap, wherein the detector is configured to capture radiographic images of the subject positioned at the central axis, which subject is radiographically exposed using the radiographic radiation source.

2. The apparatus of claim 1, wherein the turntable includes at least a portion thereof in the shape of a circular arc.

3. The apparatus of claim 1, wherein a detector path distance as measured from the central axis to a point on a detector path is equivalent to a turntable distance as measured from the central axis to a point on the turntable.

4. The apparatus of claim 1, wherein the turntable includes a portion thereof shaped in a circular arc having a center at the central axis.

5. The apparatus of claim 1, wherein the source support comprises a support arm extending away from the central axis, and wherein the source is attached to a distal end of the support arm furthest from the central axis.

6. The apparatus of claim 5, wherein the support arm comprises a straight, linear, rigid configuration.

7. The apparatus of claim 6, wherein the C-shaped housing is further configured to enclose the source support, the detector support and the turntable as the source moves about the central axis and as the detector moves about the central axis.

8. The apparatus of claim 7, wherein the gap in the C-shaped housing is further configured to allow the subject to be positioned at the central axis by moving the subject through the housing gap in a direction substantially perpendicular to the central axis.

9. An apparatus for cone beam computed tomographic imaging of one extremity of a patient, the apparatus comprising:

a digital radiation detector configured to move around a central axis along a detector path at a first radial distance from the central axis;

a radiation source configured to move around the central axis along a source path simultaneously with the movement of the detector along the detector path, the source path at a second radial distance from the central axis, the second radial distance greater than the first radial distance;

a C-shaped housing configured to enclose the source as the source moves around the source path and to enclose

11

the detector as the detector moves around a portion of the detector path, the housing comprising a gap configured to allow the one extremity of the patient to be positioned at the central axis by moving the one extremity of the patient through the housing gap in a direction substantially perpendicular to the central axis; and

a housing extension attached to the housing and configured to controllably extend from the housing across the housing gap to enclose the detector as the detector moves along the detector path and across the housing gap and to prevent the one extremity of the patient from moving through the housing gap.

10. The apparatus of claim **9**, further comprising a turntable to support both the detector and the source as the detector and the source move around the central axis, the turntable having at least a portion thereof in a shape of a circular arc.

12

11. The apparatus of claim **10**, wherein a distance as measured from the central axis to a point on the detector path is equivalent to a distance as measured from the central axis to a point on the turntable.

12. The apparatus of claim **9**, wherein the detector is configured to capture radiographic images of a subject positioned at the central axis when the subject is radiographically exposed using the radiation source.

13. The apparatus of claim **10**, wherein the turntable portion in the shape of the circular arc comprises a center coinciding with the central axis.

14. The apparatus of claim **10**, further comprising a source support arm attached to the turntable and to the source, wherein the source support arm extends away from the central axis, and wherein the source is attached to a distal end of the support arm furthest from the central axis.

15. The apparatus of claim **14**, wherein the source support arm comprises a straight, linear, rigid configuration.

* * * * *