

(12) STANDARD PATENT
(19) AUSTRALIAN PATENT OFFICE

(11) Application No. **AU 2005298949 B2**

(54) Title
An optical proximity sensor for a liquid-jet instrument, and a liquid-jet instrument equipped with such a sensor

(51) International Patent Classification(s)
G01B 11/14 (2006.01) **B43K 8/22** (2006.01)
B05B 15/00 (2006.01)

(21) Application No: **2005298949** (22) Date of Filing: **2005.10.20**

(87) WIPO No: **WO06/045531**

(30) Priority Data

(31) Number	(32) Date	(33) Country
04/11358	2004.10.25	FR

(43) Publication Date: **2006.05.04**

(44) Accepted Journal Date: **2011.07.07**

(71) Applicant(s)
Societe BIC

(72) Inventor(s)
Bich, Xavier;Rath, Kurth;Rosenzweig, Alain

(74) Agent / Attorney
Griffith Hack, Level 29, Northpoint 100 Miller Street, North Sydney, NSW, 2060

(56) Related Art
FR 2841498 A

(19) World Intellectual Property Organization
International Bureau



(43) International Publication Date
4 May 2006 (04.05.2006)

PCT

(10) International Publication Number
WO 2006/045531 A1

- (51) International Patent Classification:
G01B 11/14 (2006.01) **B05B 15/00** (2006.01)
B43K 8/22 (2006.01)
- (21) International Application Number:
PCT/EP2005/011290
- (22) International Filing Date: 20 October 2005 (20.10.2005)
- (25) Filing Language: English
- (26) Publication Language: English
- (30) Priority Data:
04/11358 25 October 2004 (25.10.2004) FR
- (71) Applicant (for all designated States except US): **SOCIETE BIC** [FR/FR]; 14, rue Jeanne D'Asnières, F-92110 Clichy (FR).
- (72) Inventors; and
- (75) Inventors/Applicants (for US only): **BICH, Xavier** [FR/FR]; 18 rue de l'Hotel de Ville, F-92000 Neuilly-sur-Seine (FR). **ROSENZWEIG, Alain** [FR/FR]; 44bis, rue Jean Jaurès, F-94107 Saint Maur Des Fosses (FR). **RATH, Kurth** [FR/FR]; 98 Boulevard Bineau, F-92000 Neuilly Sur Seine (FR).
- (74) Agents: **VOUGNY, Christophe** et al.; Cabinet Plasseraud, 65/67, rue de la Victoire, F-75440 Paris Cédex 09 (FR).

- (81) Designated States (unless otherwise indicated, for every kind of national protection available): AE, AG, AL, AM, AT, AU, AZ, BA, BB, BG, BR, BW, BY, BZ, CA, CH, CN, CO, CR, CU, CZ, DE, DK, DM, DZ, EC, EE, EG, ES, FI, GB, GD, GE, GH, GM, HR, HU, ID, IL, IN, IS, JP, KE, KG, KM, KP, KR, KZ, LC, LK, LR, LS, LT, LU, LV, LY, MA, MD, MG, MK, MN, MW, MX, MZ, NA, NG, NI, NO, NZ, OM, PG, PH, PL, PT, RO, RU, SC, SD, SE, SG, SK, SL, SM, SY, TJ, TM, TN, TR, TT, TZ, UA, UG, US, UZ, VC, VN, YU, ZA, ZM, ZW.
- (84) Designated States (unless otherwise indicated, for every kind of regional protection available): ARIPO (BW, GH, GM, KE, LS, MW, MZ, NA, SD, SL, SZ, TZ, UG, ZM, ZW), Eurasian (AM, AZ, BY, KG, KZ, MD, RU, TJ, TM), European (AT, BE, BG, CH, CY, CZ, DE, DK, EE, ES, FI, FR, GB, GR, HU, IE, IS, IT, LT, LU, LV, MC, NL, PL, PT, RO, SE, SI, SK, TR), OAPI (BF, BJ, CF, CG, CI, CM, GA, GN, GQ, GW, ML, MR, NE, SN, TD, TG).

Declaration under Rule 4.17:

— of inventorship (Rule 4.17(iv))

Published:

— with international search report

For two-letter codes and other abbreviations, refer to the "Guidance Notes on Codes and Abbreviations" appearing at the beginning of each regular issue of the PCT Gazette.

(54) Title: AN OPTICAL PROXIMITY SENSOR FOR A LIQUID-JET INSTRUMENT, AND A LIQUID-JET INSTRUMENT EQUIPPED WITH SUCH A SENSOR

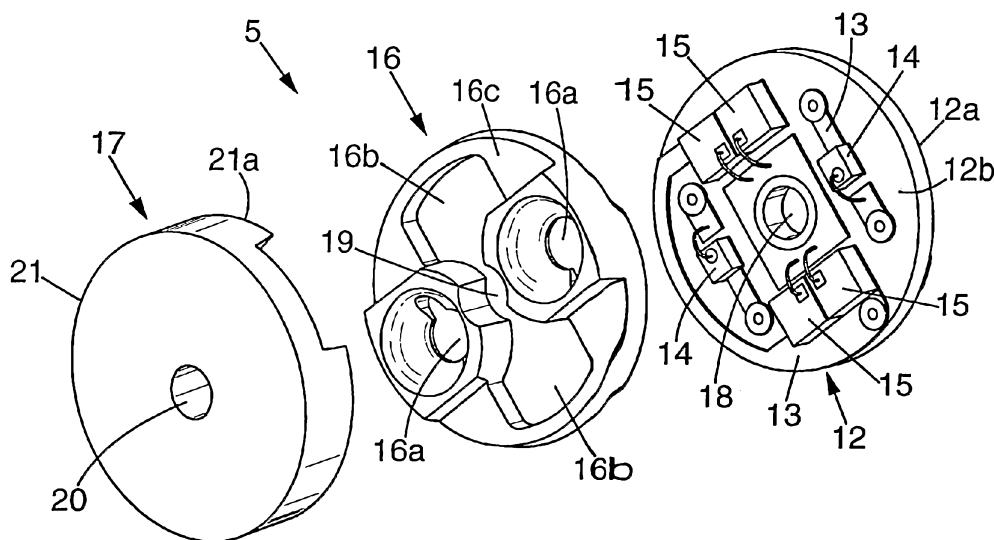

(57) Abstract: An optical proximity sensor (5) adapted to be mounted in a liquid-jet instrument. The sensor comprises: a printed circuit (12) on which light-emitting and light-receiving elements (14, 15) are positioned to make it possible to evaluate the distance between them and a given surface; an intermediate part (16) in which the light-emitting and the light-receiving elements (14, 15) are received; and protective means (17) that cover the intermediate part. The printed circuit (12) and the intermediate part (16) are provided with through holes (18, 19) which are mutually superposed to form a passageway serving to enable the liquid to be sprayed from a liquid spray head.

WO 2006/045531 A1

AN OPTICAL PROXIMITY SENSOR FOR A LIQUID-JET INSTRUMENT,
AND A LIQUID-JET INSTRUMENT EQUIPPED WITH SUCH A SENSOR

The present invention relates to optical proximity
sensors for liquid-jet instruments that spray jets of
5 liquid, and also to liquid-jet instruments equipped with
such optical sensors.

More particularly, the invention relates to an
optical proximity sensor adapted to be mounted in a
liquid-jet instrument having a spray head for spraying a
10 jet of liquid, said optical sensor serving to evaluate a
distance between it and a given surface onto which the
liquid is to be sprayed.

French Patent Application FR 2 841 498 describes, in
particular, a writing instrument that includes such an
15 optical sensor which can, for example, be formed by an
infrared light-emitting diode (LED) which sends an
incident light beam towards the given surface so as to
form a light spot on said given surface and a reflected
light beam which is then received, for example, by a
20 photodiode which then issues a signal representing the
reflected light beam. The signal representing the
reflected light beam is then analyzed by a processor unit
in order to evaluate the distance between the optical
sensor and the given surface in order to trigger or not
25 to trigger activation of the liquid spray head so as to
spray or not spray a certain quantity of liquid onto the
given surface, such as a writing surface.

In known writing instruments, the light-emitting
element of the optical sensor can be mounted in the
30 writing instrument anywhere that is in the vicinity of
the spray head, and the light-receiving element is also
mounted on any support that can be different while also
being situated in the vicinity of the spray head. It can
thus be understood that mounting the various light-
35 emitting and light-receiving elements one after another
complicates mounting the optical sensor as a whole on the
liquid-jet instrument without being certain that the

light-emitting and of the light-receiving elements can give rise to errors in evaluating the distance between the optical sensor and the given surface, which also modifies the sensitivity of the optical sensor from one liquid-jet instrument to another.

In an embodiment, the present invention seeks to mitigate the above-mentioned technical problems by proposing an optical sensor and a liquid-jet instrument, the optical sensor being more reliable, simple, and guaranteeing that the distance between the given surface and the optical sensor is always evaluated in the same manner from one optical sensor to another and thus from one liquid-jet instrument to another.

To this end, the invention provides an optical proximity sensor characterized in that it comprises:

a printed circuit having a first face and a second face on which at least one light-emitting element and at least one light-receiving element are positioned, the light-emitting and the light-receiving elements being adapted to make it possible to evaluate the distance between them and the given surface;

an intermediate part that is mounted on the second face of the printed circuit, and that is provided with at least two through recesses in which the light-emitting and the light-receiving elements of the printed circuit are received; and

protective means that cover at least one of the two through recesses, the protective means presenting optical properties adapted to the wavelength of the light used by the light-emitting and the light-receiving elements so as to enable the light to be focused;

the printed circuit and the intermediate part are provided with through holes which are mutually superposed

to form a passageway serving to enable the liquid to be sprayed from the liquid spray head.

By means of these provisions, the light-emitting and the light-receiving elements forming the optical sensor
5 are systematically disposed on the same printed circuit disposed against a part, thereby making it possible to define their relative positions in advance because of the rigidity of the printed circuit and/or of the intermediate part. The sensitivity of the sensor is thus
10 improved, while using a conventional technique of assembling electrical elements on a printed circuit board or strip, thereby also making it possible to reduce the cost of manufacturing the optical sensor. In addition, the presence of the intermediate part and of the
15 protective means also makes it possible to offer a protective function for protecting the light-emitting and the light-receiving elements which are relatively fragile, in order to avoid them being irreparably damaged while the sensor is in use, while also offering an
20 optical function by means of the optical properties of the protective means, which properties are adapted to the wavelength of the light used, in particular to enable the light to be focused onto the given surface, such as a writing medium, for example. Finally, by means of these
25 provisions, the printed circuit, the intermediate part, and the protective means can be assembled and fastened together in order to obtain an optical sensor forming a pre-assembled unit serving to be placed directly in the writing instrument, and offering a passageway serving to
30 enable the liquid to be sprayed through the optical sensor. In addition, the liquid spray head of the liquid-jet instrument can also be disposed on the second face of the printed circuit and immediately facing the passageway or even inside the passageway, thereby
35 enabling the various light-emitting and light-receiving elements to be disposed very close to the liquid spray head in order to evaluate exactly the conditions

determining whether or not liquid is to be sprayed, as a function of the distance between the spray head and the given writing surface.

In preferred embodiments of the invention, use is
5 further made of one or more of the following provisions:

- the printed circuit comprises a rigid board disposed against the intermediate part, and conductive tracks preferably formed on the first face of the printed circuit;

10 - the printed circuit is a flexible strip that is secured to the intermediate part, and that is provided with conductive tracks preferably formed on the second face of the printed circuit;

15 - the conductive tracks are adapted to power the light-emitting and the light-receiving elements, and to convey the signals from said at least one light-receiving element to a processor unit;

- the printed circuit and the intermediate part are fastened together by adhesive bonding;

20 - the intermediate part and the protective means are fastened together by adhesive bonding;

25 - the second face of the printed circuit is provided with a plurality of light-emitting and light-receiving elements, the intermediate part is provided with a plurality of through recesses in which the plurality of light-emitting and light-receiving elements are received, and the protective means cover said plurality of recesses;

30 - the protective means are in the form of a transparent plate;

- the transparent plate is obtained directly by overmolding a transparent material on the intermediate part;

35 - a refractive matching material is disposed between the protective means and the light-emitting and light-receiving elements, in order to minimize refractive index discontinuities;

- the refractive index matching material is made of a rubber silicone;

- the protective means cover said at least one through recess in which said at least one light-emitting element is received, said protective means presenting optical properties adapted to the wavelength of the light used in order to enable the emitted light to be focused onto the given surface;

- the protective means cover said at least one recess in which said at least one light-receiving element is received, said protective means having optical properties adapted to the wavelength of the light used in order to enable the received light to be focused towards said at least one light-receiving element;

- the sensor has at least two light-receiving elements, and the protective means have a first zone adapted to focus the received light towards said at least two light-receiving elements in a first manner, and a second zone adapted to focus the received light towards the other of said at least two light-receiving elements in a manner different from the first manner;

- the first and second zones of the protective means are respectively first and second facets presenting profiles that are different;

- a light barrier is arranged between said at least one light-emitting element and said at least one light-receiving element, thereby preventing the light emitted by the light-emitting element and diffused or reflected in the sensor from reaching the light-receiving element and from disturbing the distance evaluation;

- the intermediate part has a front face which is on the opposite side from its face facing the printed circuit and in which the through recesses open out, and the light barrier comprises a projection arranged on the front face of the intermediate part between the outlet of a recess in which said at least one light-emitting

element is received and the outlet of a recess in which said at least one light-receiving element is received;

- the projection, which is preferably formed integrally with the intermediate part, extends across the front face and subdivides said face into a first portion in which all of the recesses receiving light-emitting elements open out, and a second portion in which all of the recesses receiving light-receiving elements open out;

- the protective means comprise at least one one-piece part, said one-piece part covering only those recesses which receive light-emitting elements, or only those recesses which receive light-receiving elements, thereby preventing transmission of light from the light-emitting element to the light-receiving element upon multiple reflections within the protective means;

- the protective means are provided with a through hole superposed on the through holes in the printed circuit and in the intermediate part; and

- the recesses in the intermediate part have walls shaped to optimize the guiding of the light emitted by said at least one light-emitting element and/or received by said at least one light-receiving element.

In addition, the invention also provides a liquid-jet instrument comprising a liquid spray head, a processor unit, and an optical proximity sensor as defined above.

Other characteristics and advantages of the invention appear from the following description of embodiments given by way of non-limiting example and with reference to the accompanying drawings.

In the drawings:

Figure 1 is a diagrammatic section view of a liquid-jet instrument equipped with an optical proximity sensor of the invention;

Figure 2 is an exploded perspective view of the various component elements of a first variant of a first embodiment of the optical proximity sensor;

Figure 3 is a view in section and in perspective of a second variant of the first embodiment of the optical proximity sensor when it is disposed on or in the vicinity of a liquid spray head of the instrument;

5 Figure 4 is an exploded perspective view of the component elements of a second embodiment of the optical proximity sensor; and

10 Figure 5 is a cutaway view of the second embodiment of the optical sensor when it is disposed on or in the vicinity of a liquid spray head of the instrument.

In the various figures, like references designate elements that are identical or similar.

15 Figure 1 shows a liquid-jet instrument 1 which, in the example considered herein, is in the form of a writing instrument 1 that includes a substantially tubular element 2 which extends between a first end 2a and a second end 2b. Said tubular element 2 has an inside wall 23 defining a hollow inside space, and an outside wall 22 designed to be held by a user.

20 The hollow inside space defined by the inside wall 23 of the tubular element 2 contains a reservoir of liquid 3 and a spray system 4 for spraying said liquid, said spray system being associated directly with the reservoir 3. The reservoir of liquid 3 is removably
25 mounted in the hollow inside space in the tubular element 2 so as to be replaced with another reservoir after said liquid has been used up. Depending on the use to be made of the instrument, the liquid contained in said reservoir can be formed of ink, or of an ink-erasing or ink-masking
30 liquid when the instrument is used as a corrector, or even of adhesive when said instrument is used as an adhesive applicator or spray. The spray system 4 is formed by a liquid feed channel 41 connected directly to the reservoir of liquid 3 via a channel 31, and by an
35 electrical signal generator 42 designed to control activation and deactivation of a spray head 43 situated at the end of the feed channel 41 of the spray system.

In the example considered herein, the spray head 43 is a thermal-effect spray head that has at least one spray nozzle disposed at the end 2a of the tubular element 2. It could be constituted by any other type of spray head, and in particular by an electrostatic head offering higher efficiency. Said end 2a of the tubular element can be constituted by an end-piece fitted directly into the central portion of the tubular element 2 over the inside wall 23 of said central portion. Said end-piece 2a presents an end orifice 2c via which provision is made for the spray head 43 to spray droplets of liquid 7 onto a given surface 8 which, in the example considered herein, is formed by a writing surface such as a sheet of paper.

The liquid-jet instrument also includes a processor unit 6 designed to activate the generator 42 for generating electrical signals (or electrical pulses) in order to enable the spray nozzle 43 of the spray system to spray the droplets 7 onto the medium 8 from a distance. At its end 2b, the hollow inside space of the tubular element 2 also contains an electrical power source 10 formed, for example by a battery, or even two batteries, rechargeable or otherwise, making it possible, by means of a switch 11 to switch on the various electrical elements forming the writing instrument. The end 2b of the tubular element 2 can, for example, be in the form of a cap removably mounted on the central portion of said tubular element 2 in order to enable two worn batteries 10 to be replaced with new batteries.

At its end 2a, the tubular element 2 is also provided with an optical proximity sensor 5 adapted to be mounted in the through orifice 2c of the end 2a of the tubular element. Said optical proximity sensor 5 serves to evaluate the distance between it and the writing medium 8 on which the droplets of liquid 7 are to be sprayed.

The optical proximity sensor 5 of the invention is described in more detail below with reference to Figures 2 and 3 which show two variants of a first embodiment of the optical proximity sensor 5.

5 As can be seen in Figure 2 which shows a first variant embodiment of the optical proximity sensor 5, said sensor includes a printed circuit 12. In known manner, the printed circuit 12 comprises a rigid board 12 presenting a first face 12a facing towards the inside of
10 the tubular element 2, and a second face 12b which is provided with a plurality of conductive tracks 13 to which light-emitting elements 14 and light-receiving elements 15 are electrically connected, said light-emitting elements and said light-receiving elements
15 serving to be directed towards the writing medium 8 when the liquid-jet instrument is in the in-use position.

In the example considered herein, the printed circuit board 12, or more exactly its second face 12b, has two light-emitting elements 14 and four light-
20 receiving elements 15. Naturally, the second face 12b of the printed circuit board 12 could have a single light-emitting element 14 and a single light-receiving element 15. The first face 12a of the printed circuit board 12 is also provided with conductive tracks (not shown in the
25 drawings) for powering the light-emitting and light-receiving elements (14, 15) and for conveying the signals from the light-receiving elements 15 to a processor unit 6 as described in detail below.

The optical sensor 5 also includes an intermediate
30 part 16 serving to be mounted in fixed manner on the second face 12b of the printed circuit board. For example, said intermediate part 16 is provided with two through recesses 16a which pass through its entire thickness and which serve to receive the two light-
35 emitting elements 14, and with two recesses 16b, each of which serves to receive a pair of light-receiving elements 15. The intermediate part 16 is preferably

rigid, e.g. made of a plastics material. However, in this embodiment in which the printed circuit 12 is a rigid board, it can be imagined for the intermediate part to be made of elastomer.

5 The optical sensor 5 also includes protective means 17 which, in the example considered herein, cover the entire intermediate part 16 so as to protect the light-emitting and the light-receiving elements (14, 15) from the outside. Said protective means 17 also have optical
10 properties adapted to the wavelength of the light used by the light-emitting and the light-receiving elements (14, 15) for enabling the light to be focused onto the writing medium 8 and more exactly onto zones that can be more or less point-like on the writing medium 8 onto which the
15 droplets 7 are to be sprayed.

As can also be seen in Figure 2, the printed circuit board 12, the intermediate part 16, and the protective means 17 are respectively provided with through holes (18, 19, 20) that are mutually superposed in order to
20 form a passageway for enabling the liquid to be sprayed from the spray head 43 which is disposed immediately behind the first face 12a of the printed circuit board 12. The passageway formed by the through holes (18, 19, 20) can also receive the spray head 43 of the liquid
25 spray system 4 in full or in part.

In the example shown in Figure 2, the protective means 17 are in the form of a transparent plate or patch 21 that presents a face 21a that is of shape complementary to the shape of the face 16c of the
30 intermediate part 16 on which it is designed to be mounted in fixed manner, i.e. the face opposite from the printed circuit 12 and facing the orifice 2c. Said transparent plate 21 has zones that can be machined or treated specifically and that are in register with the
35 recesses 16a and 16b in the intermediate part 16 so as to make it possible to focus the light emitted from the two light-emitting elements 14 towards the writing medium 8

and to maximize reception of the light reflected by the medium 8 towards the light-receiving elements 15.

The protective means 17 can also be formed by a plurality of small transparent patches, each of which is disposed in a corresponding recess 16a or 16b in the intermediate part 16.

By way of example, the light-emitting means 14 can be formed by laser diodes of the Vertical Cavity Surface Emitting Laser (VCSEL) type or by infrared LEDs that send an incident light beam FI (see Figure 1) towards the writing medium 8 so as to form a light spot on said medium 8 and a reflected light beam FR that is received by the light-receiving elements 15 formed, for example, by receiver phototransistors or photodiodes. The light-receiving elements 15 then send electrical signals that are representative of the received light to the processor unit so as to evaluate the distance between the proximity sensor 5 and the writing medium 8.

In addition, according to another characteristic of the invention, the intermediate part 16 can be made of a plastics material covered by a surface layer of metal so that, at the walls of the recesses 16a and 16b, reflective surfaces are formed around the light-receiving and the light-emitting elements 14, 15 so as to guide and to optimize light emission and light reception.

In addition, as can be seen in Figure 2, the walls of the recesses 16a and/or 16b can be shaped, e.g. by having a substantially conical shape, in order to make it possible to optimize guiding the light emitted and received by the light-emitting and the light-receiving elements 14, 15.

In addition, prior to fastening the transparent plate 21 onto the intermediate part 16, a refractive matching material can be disposed inside the recesses 16a and 16b so as to avoid or reduce the refractive index discontinuities between the light-receiving and light-emitting elements 14, 15 and the outside of the writing

instrument. Said refractive index matching material can be made, for example from silicone-based rubber.

The printed circuit board 12, the intermediate part 16, and the transparent plate or patch 21 can be fastened together by adhesive bonding.

In another variant embodiment, the plate or patch 21 can be obtained directly by overmolding a transparent material having suitable optical properties onto the intermediate part 16.

Thus, the optical proximity sensor 5 forms a pre-assembled unit that is designed to be mounted in the opening 2c provided in the end 2a of the writing instrument (see Figure 1). When the printed circuit board, the intermediate part 16, and the transparent plate 21 are circular in shape, the resulting optical proximity sensor 5 can be fastened directly by adhesive bonding or by any other suitable means into the opening 2c provided in the end 2a of the writing instrument.

The optical proximity sensor, or more exactly the printed circuit board, the intermediate part 16 and the transparent plate 21 can, for example, present an outside diameter of about 3 millimeters (mm) while the passageway formed by the through holes 18, 19, 20 can present a diameter of about 0.6 mm in order to enable the ink to pass from the ink spray head 43. The total thickness of the resulting optical sensor 5 can be about 1 mm. In addition, when the spray head 43 is provided with a plurality of spray nozzles, the passageway delimited by the through holes (18, 19, 20) can have some other, non-circular shape, e.g. oblong or rectangular.

Figure 3 shows a second variant of the first embodiment of the optical proximity sensor 5. In this variant embodiment, the face 12b of the printed circuit board 12 has a single light-emitting element 14 and two light-receiving elements 15 which are mounted and connected via suitable electrical connections such as wires onto the conductive tracks 13 which are connected

to the other conductive tracks formed directly on the first face 12a of the printed circuit board 12. The functions of the conductive tracks on the first face 12a of the first printed circuit board 12 are to power the light-emitting and the light-receiving elements 14, 15, and to convey signals from the light-receiving elements 15 to the processor unit 6.

In this second variant embodiment, the intermediate part 16 is thus provided with a single through recess 16a for receiving the light-emitting element 14 and two through recesses 16b which serve to receive the light-receiving elements 15 of the printed circuit board 12.

In this example, the protective means 17 are also formed by a transparent plate or patch 21 mounted directly on the intermediate part 16, e.g. by adhesive bonding. As can be seen in Figure 3, in register with the recesses 16a and 16b in the intermediate part 16, the patch 21, or more exactly its face 21b that is designed to face towards the writing medium 8, is provided with zones 21c that can be machined or treated specifically to enable the light emitted from the light-emitting element 15 to be focused optimally towards the writing medium 8, and to enable reception of the light reflected by the support 8 to be maximized by focusing towards the light-receiving elements 15.

In addition, as can be seen in Figure 3, the liquid spray head 43 of the liquid spray system 4 is disposed directly against or in the vicinity of the first face 12a of the printed circuit board 12. For example, said spray head 43 can be provided with four spray nozzles 43a which are disposed directly facing the passageway formed by the through holes 18, 19, 20 formed in the printed circuit board 12, in the intermediate element 16 and in the transparent plate or patch 21. Naturally, the spray head 4 can be provided with a single spray nozzle 43a or with a plurality of spray nozzles 43a.

Figures 4 and 5 show a second embodiment of the optical proximity sensor 5 of the invention. This embodiment essentially uses the same elements as the preceding embodiment, and therefore only the differences are described in detail below.

In this example, the printed circuit 12 has as its backing a flexible backing strip that can be in form of a flexible sheet of a plastics material with the conductive tracks 13 formed on the second face 12b.

Light-emitting and light-receiving elements (14, 15) are fastened to the printed circuit backing strip 12 and are electrically connected to the conductive tracks 13. As in the preceding embodiment, the second face 12b is positioned against the intermediate part 16, and more precisely fastened by adhesive bonding against the rear face (not referenced) thereof. Mounting the light-emitting and the light-receiving elements (14, 15) on the printed circuit strip 12 guarantees that said elements are positioned properly relative to one another, and fastening the printed circuit strip against the intermediate part 16 guarantees that the directions of said elements are fixed, due to the rigidity of said intermediate part. Like the first embodiment, the second embodiment thus makes it possible for the distance relative to the given medium 8 to be evaluated with precision. In addition, the strip forming the backing for the printed circuit 12 is small in thickness, and the spray head 43, also mounted against the first face 12a, is closer to the outlet of the spray channel formed by the holes (18, 19, 20) through the parts of the sensor 5. The use of a printed circuit strip 12 also offers the advantage of being able to establish an electrical connection between the sensor and the processor unit 6, by means of a tab 12c integrally formed with the printed circuit, and which can be curved back along the inside wall 23 of the tubular body of the instrument towards the rear end 2b thereof.

The light-emitting element 14 is analogous to the light-emitting elements of the first embodiment, but it presents the property of emitting a directional infrared beam, so that it is not necessary to dispose optical means facing said element 14 in order to focus the light onto the given medium 8.

It should be noted that, in this embodiment, no protective means cover the recess 16a in which the light-emitting element 14 is received, since the depth of the recess and the directional nature of the diode used limit the risks of said diode being damaged. But, it is naturally possible to provide an optical part for forming protective means for protecting the light-emitting element 14.

For this second embodiment, two light-receiving elements 15 are provided on the printed circuit strip 12, and are disposed substantially opposite each other about the hole 18 so as to space apart the light-receiving elements 15. The recesses 16b, each of which receives one of the two light-receiving elements 15, are covered by a one-piece optical part 21. The one-piece part 21 forms protective means for all of the light-receiving elements 15 of the sensor. In this way, it is possible to avoid one of the light-receiving elements being damaged or having its frequency disturbed by any debris that might become lodged in the recesses 16b, and thus to avoid the electrical signal transmitted by the light-receiving means to the processor unit 6 not matching the light reflected by the given medium 8. As in the preceding embodiment, the protective means 17 have optical properties adapted to the wavelength of the light emitted by the light-emitting element 14 in order to focus the reflected light towards the corresponding light-receiving element. More particularly, in said second embodiment, the one-piece part 21 forming the protective means 17 is made of a transparent rigid plastics material, and it has facets (21e, 21f), each of

which covers a respective one of the recesses 16b receiving respective ones of the light-receiving elements 15. Each of the facets (21e; 21f), which are plane in this example, acts as a prism. But said facets could be 5 concave or convex. The facets (21e, 21f) can be of equal focal length corresponding substantially to the distance at which the liquid is to be sprayed. But preferably, the focal length f_1 of facet 21e is slightly different from the focal length f_2 of facet 21f. The signals sent 10 to the processor unit by each of the light-receiving elements are thus different for the same received reflected beam. The difference between said signals can be used advantageously by the processor unit 6 in order to increase the precision of the distance evaluation over 15 a given distance range, and in particular over the distance range within which it is desirable to cause liquid to be sprayed onto the given medium 8. For example, it is possible to choose the first focal length f_1 to be close to the minimum distance at which the liquid is sprayed and to choose the focal distance f_2 to 20 be close to the maximum distance beyond which no liquid must be caused to be sprayed. The processor unit 6 is then adapted, by addition and/or subtraction of the signals received from each of the light-receiving 25 elements 15, to evaluate whether the distance between the given medium 8 and the spray head 43 corresponds to the center of the desired range, or whether said distance is close to the allowed maximum distance or to the allowed minimum distance. Determined precision is thus obtained 30 over a relatively wide distance range, and not merely around a single nominal distance as is obtained when protective means are used that focus the light identically for each of the light-receiving elements 15.

It should be noted that, for the second embodiment, 35 the intermediate part 16 is provided with a projection 25 projecting from the front surface 16c of said part. Said projection 25 is formed integrally with the part 16 and

it forms a light barrier between the light-emitting element 14 and the light-receiving elements 15. Anomalies have been observed in distance evaluation when the dimensions of the optical sensor are so small that the spacing between the light-emitting and the light-receiving elements (14, 15) is about one millimeter. By forming a light barrier by means of the projection 25, such anomalies are considerably reduced. In addition to the walls of the recesses (16a, 16b), the projection 25 forms a light barrier that prevents a fraction of the light emitted by the light-emitting element(s) 14 from being received by the light-receiving elements 15 in almost direct manner by diffusion and/or reflection inside the optical sensor 5 itself, and in particular in the protective means 17. The fact that the projection 25 is formed integrally with the intermediate part 16 reduces the number of components of the sensor. But, it can be advantageous, in a variant embodiment (not shown), to form the barrier 25 by means of a separate part, optionally made of material different from the material of the intermediate part, in order to improve the extent to which the light diffusion is stopped.

The light barrier formed by the projection 25 extends along a chord of the optical sensor that is substantially disk-shaped, and thus subdivides the front face 16c of the intermediate part 16 into a first zone into which the recess 16a that receives the light-emitting element 14 opens out, and a second zone into which the recesses 16b that receive light-receiving elements 15 open out. The projection 25 thus forms single barrier between the two types of element, namely the light-emitting type and the light-receiving type. But, in a variant, it is quite possible to provide one or more barriers that extend to greater or lesser extents between the outlet of a recess 16a receiving a light-emitting element 14 and the outlet of one or more

recesses 16b, each of which receives a light-receiving element 15.

For the same reason, it is also preferable for the one-piece part 21 that constitutes the protective means 17 to cover the light-receiving elements 15 only, or alternatively, to cover the light-emitting elements only. In the embodiment shown, the one-piece part 21 covers all of the light-receiving elements 15, but, in a variant, it could cover some of them only. Naturally, the protective means 17 can comprise a plurality of one-piece optical parts, but, it is then preferable for one of said parts that covers the light-emitting element(s) 14 not to cover one of the light-receiving elements 15 as well, and vice versa.

The optical proximity sensor 5, as implemented in one of the above-described embodiments, is disposed at the end 2a of the liquid-jet instrument, and said sensor is connected via the first or the second face (12a, 12b) of the printed circuit to the processor unit 6 which, for example, is adapted to activate the spray head 43 of the spray system 4 when the distance between the optical proximity sensor 5 and the medium is evaluated as being a suitable distance for enabling droplets of liquid 7 to be sprayed onto the writing medium 8. Conversely, if the distance evaluated by the optical sensor does not lie within a range of predetermined distances, the processor unit 6 can then be adapted not to activate or to stop spraying of droplets 7.

As can be seen in Figure 1, the tubular element 2 can also be provided with movement or displacement detector means 40 for detecting movement or displacement of the liquid-jet instrument. Such movement or displacement detector means 40 for detecting movement or displacement of the liquid-jet instrument can, by way of example be formed by an accelerometer 40 connected directly to the processor unit 6 and that can be disposed anywhere inside said tubular element 2. By way of

example, the accelerometer can be disposed at the end 2b of the tubular element so as to be subjected to the movements that have the largest amplitude when the user is using the liquid-jet implement.

5 When the liquid-jet or writing instrument 1 is provided with displacement or movement detector means 40, the processor unit 6 can then be adapted to activate the liquid spray head 43 firstly when the optical proximity sensor 5 evaluates or determines that the distance
10 between it and the writing medium 8 lies within a suitable distance range, and secondly when the accelerometer 14 detects movement of the tubular element 2.

 In which case, the writing instrument can operate in
15 the same way as described in French Patent Application FR 2 841 498, which also corresponds to International Application WO 2004/002751 or to US Patent Application US 2004/052569.

 In addition, the optical proximity sensor 5 and the
20 processor unit 6 of the writing instrument 1 can be adapted such that the processor unit 6 stores in a memory the various measurements taken by the optical proximity sensor 5. The processor unit 6 can, for example, be adapted to cause the optical proximity sensor 5 to
25 perform distance evaluation or measurement operations that are repeated at predetermined time intervals. For example, said time intervals could lie in the range 1 millisecond to 0.1 milliseconds so that the processor unit 6 can compare the various measured distance values
30 in order to determine whether a difference in distance is representative of the writing instrument being moved or displaced relative to the writing medium 8. In which case, when the processor unit 6 determines that the distance evaluated by means of the optical sensor 5 lies
35 within a suitable range, and that the writing instrument is being moved, by means of non-zero difference in measured distances, the processor unit 6 can then

activate and/or influence operation of the spray head 43, e.g. by modulating the frequency and/or the amplitude of the control signals sent to the spray head 43.

THE CLAIMS DEFINING THE INVENTION ARE AS FOLLOWS:

1. An optical proximity sensor adapted to be mounted in a liquid-jet instrument having a spray head for spraying a jet of liquid, said optical sensor serving to evaluate a distance between it and a given surface onto which the liquid is to be sprayed; said optical proximity sensor being characterized in that it comprises:
- 5
- a printed circuit having a first face and a second face on which at least one light-emitting element and at least one light-receiving element are positioned, the light-emitting and the light-receiving elements being adapted to make it possible to evaluate the distance between them and the given surface;
- 10
- an intermediate part that is mounted on the second face of the printed circuit, and that is provided with at least two through recesses in which the light-emitting and the light-receiving elements of the printed circuit are received; and
- 15
- protective means that cover at least one of the two through recesses, the protective means presenting optical properties adapted to the wavelength of the light used by the light-emitting and the light-receiving elements so as to enable the light to be focused; and
- 20
- in that the printed circuit and the intermediate part are provided with through holes which are mutually superposed to form a passageway serving to enable the liquid to be sprayed from the liquid spray head.
- 25
2. An optical sensor according to Claim 1, in which the printed circuit comprises a rigid board disposed against
- 30

the intermediate part, and conductive tracks preferably formed on the first face of the printed circuit.

3. A sensor according to Claim 1, in which the printed
5 circuit is a flexible strip that is secured to the intermediate part, and that is provided with conductive tracks preferably formed on the second face of the printed circuit.

10 4. A sensor according to Claim 2 or Claim 3, in which the conductive tracks are adapted to power the light-emitting and the light-receiving elements, and to convey the signals from said at least one light-receiving element to a processor unit.

15 5. A sensor according to any one of the preceding claims, in which the printed circuit and the intermediate part are fastened together by adhesive bonding.

20 6. A sensor according to any one of the preceding claims, in which the intermediate part and the protective means are fastened together by adhesive bonding.

7. An optical sensor according to any preceding claim,
25 in which the second face of the printed circuit is provided with a plurality of light-emitting and light-receiving elements, in which sensor the intermediate part is provided with a plurality of through recesses in which the plurality of light-emitting and light-receiving elements are
30 received, and in which the protective means cover said plurality of recesses.

8. A sensor according to any one of the preceding claims, in which the protective means are in the form of a transparent plate.

5 9. A sensor according to Claim 8, in which the transparent plate is obtained directly by overmolding a transparent material on the intermediate part.

10 10. A sensor according to any one of the preceding claims, in which a refractive matching material is disposed between the protective means and the light-emitting and light-receiving elements, in order to minimize refractive index discontinuities.

15 11. A sensor according to Claim 10, in which the refractive index matching material is made of a rubber based on silicone.

20 12. A sensor according to any one of the preceding claims, in which the protective means cover said at least one through recess in which said at least one light-emitting element is received, said protective means presenting optical properties adapted to the wavelength of the light used in order to enable the emitted light to be
25 focused onto the given surface.

30 13. A sensor according to any preceding claim, in which the protective means cover said at least one recess in which said at least one light-receiving element is received, said protective means having optical properties adapted to the wavelength of the light used in order to

enable the received, light to be focused towards said at least one light-receiving element.

14. A sensor according to Claim 13, having at least two
5 light-receiving elements, in which the protective means have a first zone adapted to focus the received light towards said at least two light-receiving elements in a first manner, and a second zone adapted to focus the received light towards the other of said at least two
10 light-receiving elements in a manner different from the first manner, and so that the light received by each of said at least two elements has different characteristics.

15. A sensor according to Claim 14, in which the first
15 and second zones of the protective means are respectively first and second facets presenting profiles that are different.

16. A sensor according to any one of the preceding
20 claims, in which a light barrier is arranged between said at least one light-emitting element and said at least one light-receiving element.

17. A sensor according to Claim 16, in which the
25 intermediate part has a front face which is on the opposite side from its face facing the printed circuit and in which the through recesses open out, and in which sensor the light barrier comprises a projection arranged on the front face of the intermediate part between the outlet of a
30 recess in which said at least one light-emitting element is received and the outlet of a recess in which said at least one light-receiving element is received.

18. A sensor according to Claim 17, in which the projection extends across the front face and subdivides said face into a first portion in which all of the recesses
5 receiving light-emitting elements open out, and a second portion in which all of the recesses receiving light-receiving elements open out.

19. A sensor according to any one of the preceding
10 claims, in which the protective means comprise at least one one-piece part, said one-piece part covering only those recesses which receive light-emitting elements, or only those recesses which receive light-receiving elements.

15 20. A sensor according to any one of the preceding claims, in which the protective means are provided with a through hole superposed on the through holes in the printed circuit and in the intermediate part.

20 21. A sensor according to any one of the preceding claims, in which the recesses in the intermediate part have walls shaped to optimize the guiding of the light emitted by said at least one light-emitting element and/or received by said at least one light-receiving element.

25 22. A liquid-jet instrument comprising:
a liquid spray head;
a processor unit; and
an optical proximity sensor according to any
30 preceding claim.

FIG. 1

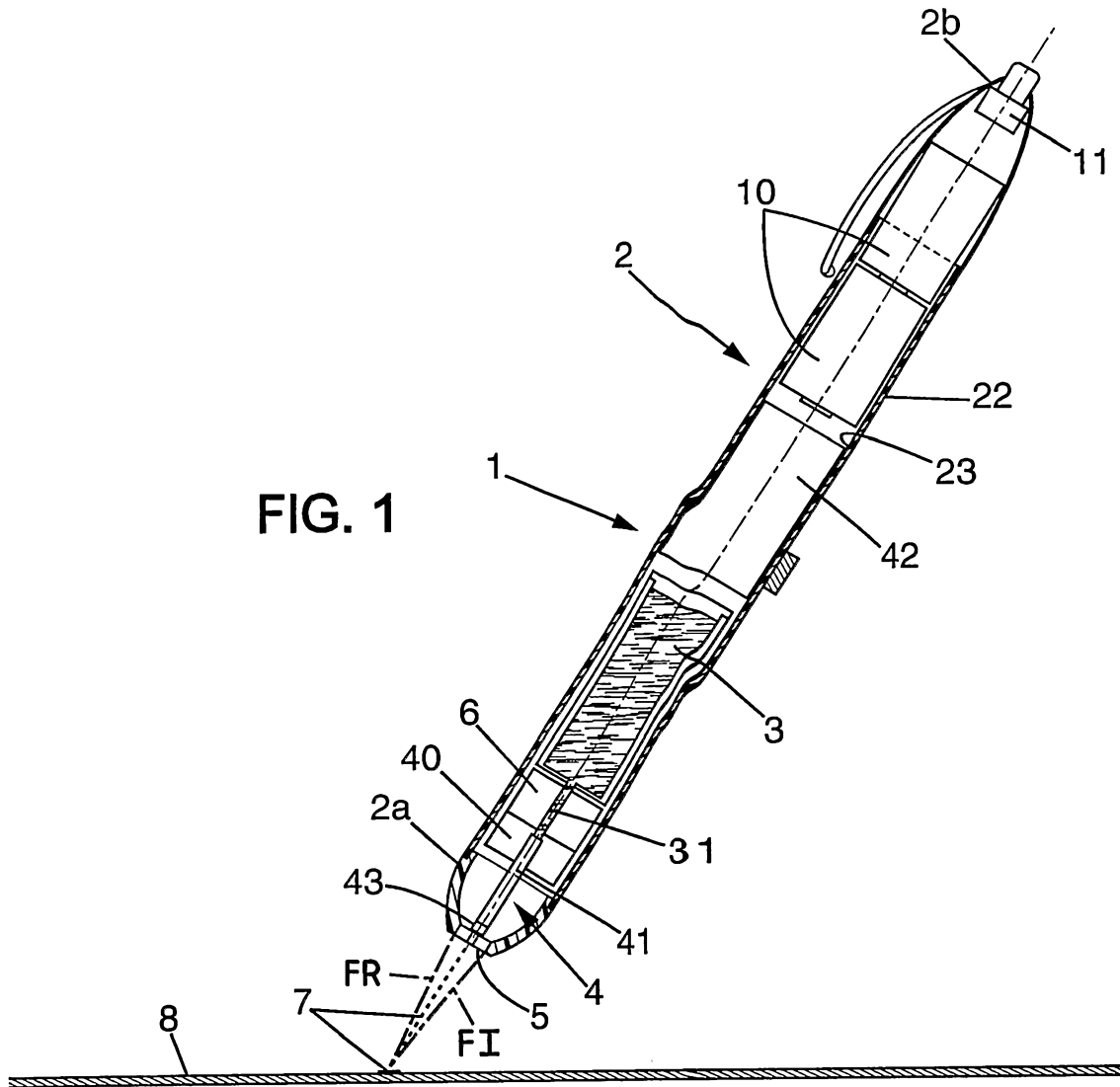

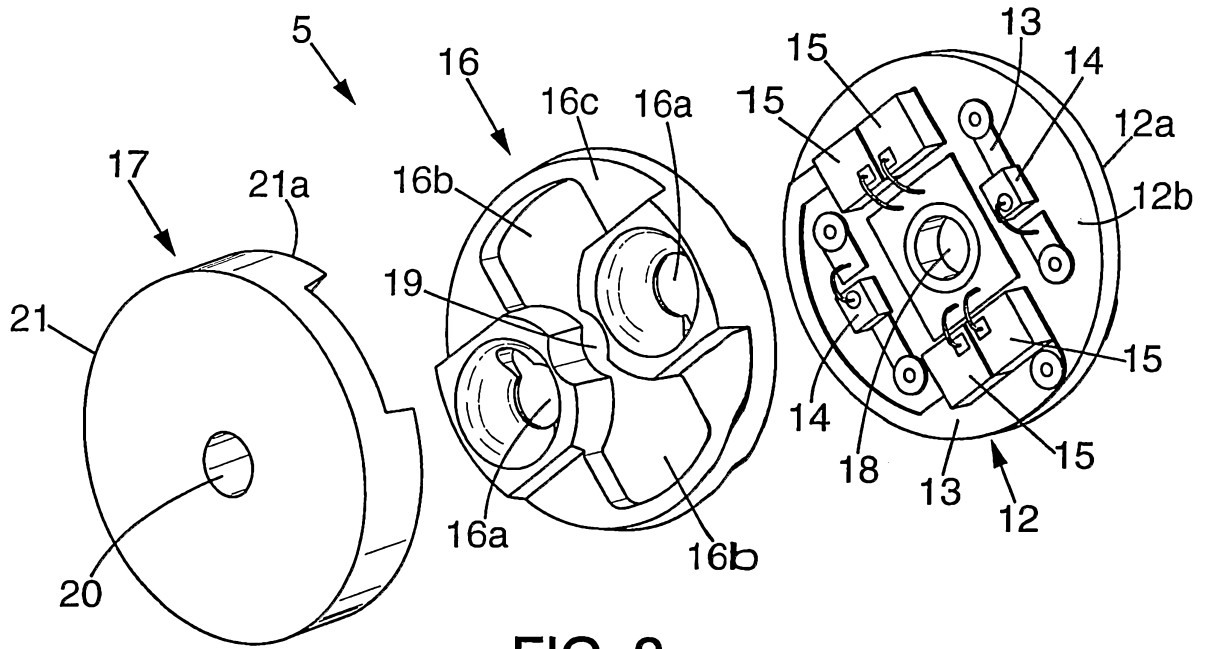

FIG. 2

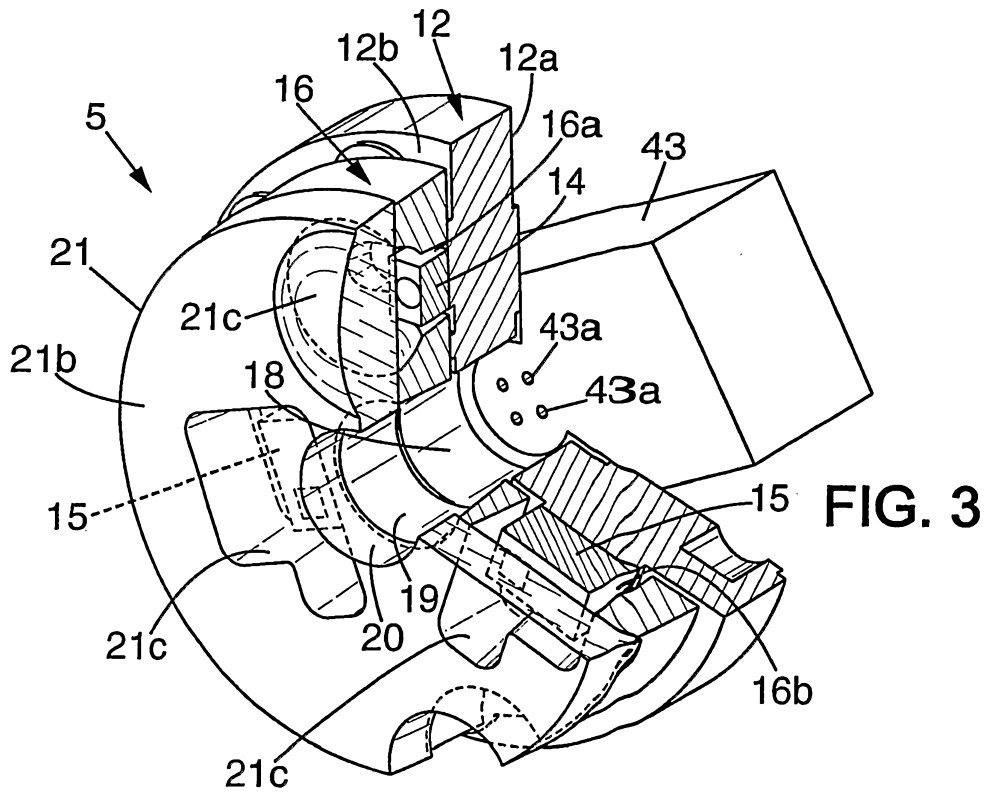

FIG. 3

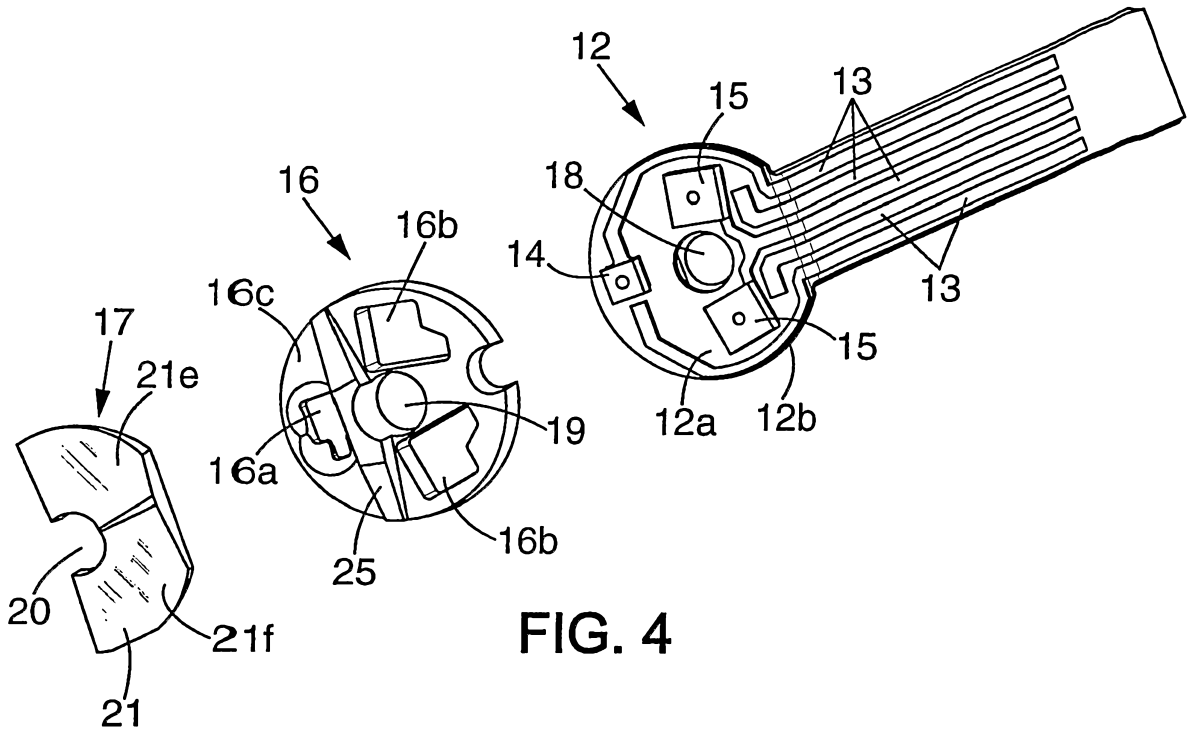

FIG. 4

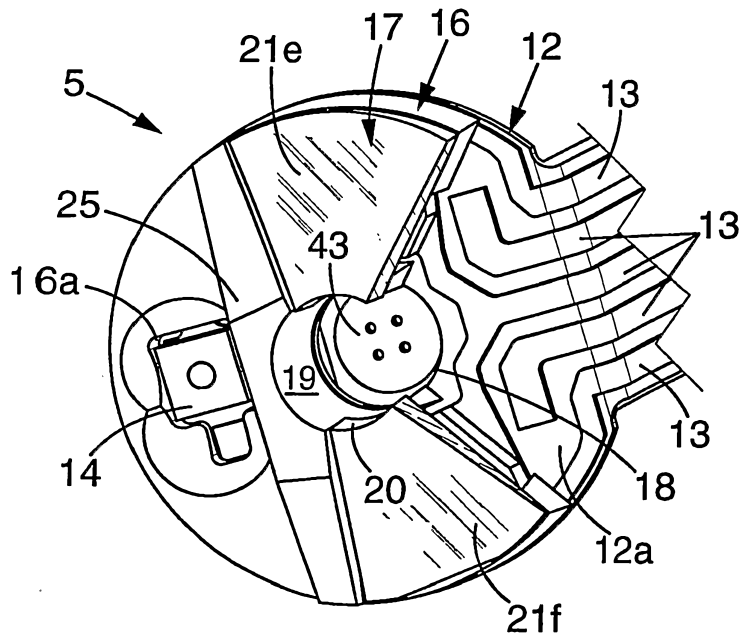

FIG. 5