

(19) World Intellectual Property Organization
International Bureau



(43) International Publication Date
19 September 2002 (19.09.2002)

PCT

(10) International Publication Number
WO 02/072192 A3

(51) International Patent Classification⁷: **A61N 1/05**

(21) International Application Number: PCT/US02/07024

(22) International Filing Date: 8 March 2002 (08.03.2002)

(25) Filing Language: English

(26) Publication Language: English

(30) Priority Data:
60/274,364 8 March 2001 (08.03.2001) US

(71) Applicant: **MEDTRONIC, INC.** [US/US]; 710
Medtronic Parkway LC340, Minneapolis, MN 55432
(US).

(72) Inventor: **CROSS, Thomas, E., Jr.**; 23810 Nightingale
Street, St. Francis, MN 55070 (US).

(74) Agents: **ALBRECHT, John, W.** et al.; Medtronic, Inc.,
710 Medtronic Parkway LC340, Minneapolis, MN 55432
(US).

(81) Designated States (*national*): AE, AG, AL, AM, AT, AU,
AZ, BA, BB, BG, BR, BY, BZ, CA, CH, CN, CO, CR, CU,
CZ, DE, DK, DM, DZ, EC, EE, ES, FI, GB, GD, GE, GH,
GM, HR, HU, ID, IL, IN, IS, JP, KE, KG, KP, KR, KZ, LC,
LK, LR, LS, LT, LU, LV, MA, MD, MG, MK, MN, MW,
MX, MZ, NO, NZ, OM, PH, PL, PT, RO, RU, SD, SE, SG,
SI, SK, SL, TJ, TM, TN, TR, TT, TZ, UA, UG, UZ, VN,
YU, ZA, ZM, ZW.

(84) Designated States (*regional*): ARIPO patent (GH, GM,
KE, LS, MW, MZ, SD, SL, SZ, TZ, UG, ZM, ZW),
Eurasian patent (AM, AZ, BY, KG, KZ, MD, RU, TJ, TM),
European patent (AT, BE, CH, CY, DE, DK, ES, FI, FR,
GB, GR, IE, IT, LU, MC, NL, PT, SE, TR), OAPI patent
(BF, BJ, CF, CG, CI, CM, GA, GN, GQ, GW, ML, MR,
NE, SN, TD, TG).

Published:
— with international search report

(88) Date of publication of the international search report:
27 February 2003

For two-letter codes and other abbreviations, refer to the "Guidance Notes on Codes and Abbreviations" appearing at the beginning of each regular issue of the PCT Gazette.

(54) Title: LEAD WITH ADJUSTABLE ANGULAR AND SPATIAL RELATIONSHIPS BETWEEN ELECTRODES

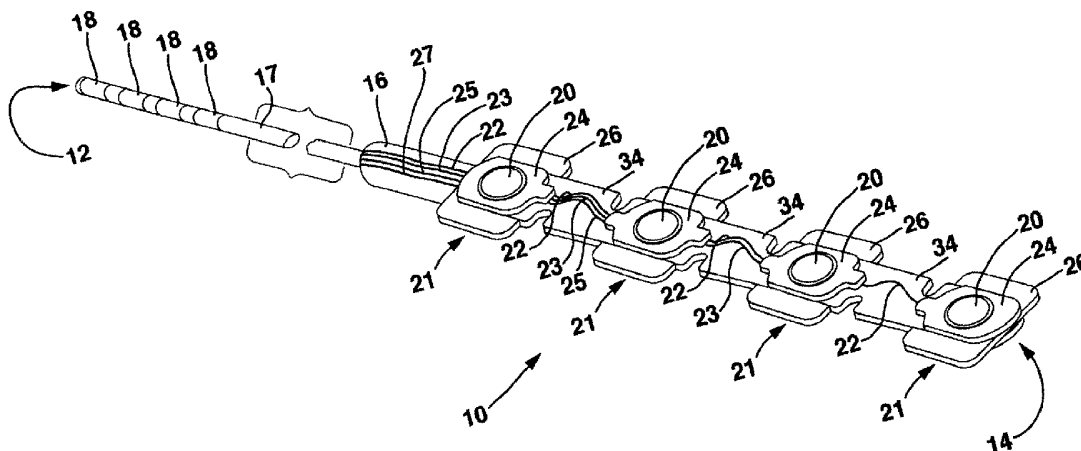

(57) **Abstract:** An apparatus and method for relative movement of electrodes in a medical lead are provided. The apparatus includes first and second electrode nodes and a wire connecting the electrode nodes. The wire includes a deformable sigma segment that allows movement of one or both of the first and second electrode nodes relative to each other. The method includes placing the medical lead adjacent tissue. The method further includes moving one of the electrode nodes relative to the other of the electrode nodes.



WO 02/072192 A3

INTERNATIONAL SEARCH REPORT

International Application No
PCT/US 02/07024

A. CLASSIFICATION OF SUBJECT MATTER
IPC 7 A61N1/05

According to International Patent Classification (IPC) or to both national classification and IPC

B. FIELDS SEARCHED

Minimum documentation searched (classification system followed by classification symbols)
IPC 7 A61N A61B

Documentation searched other than minimum documentation to the extent that such documents are included in the fields searched

Electronic data base consulted during the international search (name of data base and, where practical, search terms used)

EPO-Internal, WPI Data

C. DOCUMENTS CONSIDERED TO BE RELEVANT

Category *	Citation of document, with indication, where appropriate, of the relevant passages	Relevant to claim No.
A	US 6 066 165 A (RACZ GABOR B) 23 May 2000 (2000-05-23) column 2, line 55 -column 5, line 22; figures ---	1,17
A	US 4 903 702 A (PUTZ DAVID A) 27 February 1990 (1990-02-27) column 4, line 21 -column 6, line 30; figures ---	1,17
A	US 3 724 467 A (AVERY R ET AL) 3 April 1973 (1973-04-03) cited in the application column 2, line 36 -column 3, line 37; figures --- -/--	1,17

☒ Further documents are listed in the continuation of box C.

☒ Patent family members are listed in annex.

* Special categories of cited documents:

- *A* document defining the general state of the art which is not considered to be of particular relevance
- *E* earlier document but published on or after the international filing date
- *L* document which may throw doubts on priority claim(s) or which is cited to establish the publication date of another citation or other special reason (as specified)
- *O* document referring to an oral disclosure, use, exhibition or other means
- *P* document published prior to the international filing date but later than the priority date claimed

- *T* later document published after the international filing date or priority date and not in conflict with the application but cited to understand the principle or theory underlying the invention
- *X* document of particular relevance; the claimed invention cannot be considered novel or cannot be considered to involve an inventive step when the document is taken alone
- *Y* document of particular relevance; the claimed invention cannot be considered to involve an inventive step when the document is combined with one or more other such documents, such combination being obvious to a person skilled in the art.
- * & * document member of the same patent family

Date of the actual completion of the international search

28 November 2002

Date of mailing of the international search report

04/12/2002

Name and mailing address of the ISA

European Patent Office, P.B. 5818 Patentlaan 2
NL - 2280 HV Rijswijk
Tel. (+31-70) 340-2040, Tx. 31 651 epo nl,
Fax: (+31-70) 340-3016

Authorized officer

Rakotondrajaona, C

INTERNATIONAL SEARCH REPORT

International Application No

PCT/US 02/07024

C.(Continuation) DOCUMENTS CONSIDERED TO BE RELEVANT

Category *	Citation of document, with indication, where appropriate, of the relevant passages	Relevant to claim No.
A	<p>US 5 417 719 A (CROSS THOMAS E ET AL) 23 May 1995 (1995-05-23) cited in the application column 3, line 57 -column 5, line 53; figures</p> <p>-----</p>	1,17

INTERNATIONAL SEARCH REPORT

Information on patent family members

International Application No

PCT/US 02/07024

Patent document cited in search report		Publication date	Patent family member(s)	Publication date
US 6066165	A	23-05-2000	EP 1075301 A1 WO 9956817 A1	14-02-2001 11-11-1999
US 4903702	A	27-02-1990	NONE	
US 3724467	A	03-04-1973	NONE	
US 5417719	A	23-05-1995	NONE	