



(51) International Patent Classification:

B66C 23/88 (2006.01) *B66C 15/04* (2006.01)
B66C 23/36 (2006.01)

(21) International Application Number:

PCT/US2017/014525

(22) International Filing Date:

23 January 2017 (23.01.2017)

(25) Filing Language:

English

(26) Publication Language:

English

(30) Priority Data:

15/011,267 29 January 2016 (29.01.2016) US

(71) Applicant: **KEPPEL LE TOURNEAU USA, INC.** [US/US]; 3110 H.G. Mosley Parkway, Longview, TX 75605 (US).

(72) Inventors: **WILLIAMS, Timothy**; 3110 H.G. Mosley Parkway, Longview, TX 75605 (US). **SAKER, Timothy**; 3110 H.G. Mosley Parkway, Longview, TX 75605 (US).

(74) Agents: **KOFFS, Steven E.** et al.; Duane Morris LLP, 30 South 17th Street, Philadelphia, PA 19103 (US).

(81) Designated States (unless otherwise indicated, for every kind of national protection available):

AE, AG, AL, AM, AO, AT, AU, AZ, BA, BB, BG, BH, BN, BR, BW, BY, BZ, CA, CH, CL, CN, CO, CR, CU, CZ, DE, DJ, DK, DM, DO, DZ, EC, EE, EG, ES, FI, GB, GD, GE, GH, GM, GT, HN, HR, HU, ID, IL, IN, IR, IS, JP, KE, KG, KH, KN, KP, KR, KW, KZ, LA, LC, LK, LR, LS, LU, LY, MA, MD, ME, MG, MK, MN, MW, MX, MY, MZ, NA, NG, NI, NO, NZ, OM, PA, PE, PG, PH, PL, PT, QA, RO, RS, RU, RW, SA, SC, SD, SE, SG, SK, SL, SM, ST, SV, SY, TH, TJ, TM, TN, TR, TT, TZ, UA, UG, US, UZ, VC, VN, ZA, ZM, ZW.

(84) Designated States (unless otherwise indicated, for every kind of regional protection available):

ARIPO (BW, GH, GM, KE, LR, LS, MW, MZ, NA, RW, SD, SL, ST, SZ, TZ, UG, ZM, ZW), Eurasian (AM, AZ, BY, KG, KZ, RU, TJ, TM), European (AL, AT, BE, BG, CH, CY, CZ, DE, DK, EE, ES, FI, FR, GB, GR, HR, HU, IE, IS, IT, LT, LU, LV, MC, MK, MT, NL, NO, PL, PT, RO, RS, SE, SI, SK, SM, TR), OAPI (BF, BJ, CF, CG, CI, CM, GA, GN, GQ, GW, KM, ML, MR, NE, SN, TD, TG).

Published:

— with international search report (Art. 21(3))

(54) Title: ANTI-TWO-BLOCK SENSING SYSTEMS

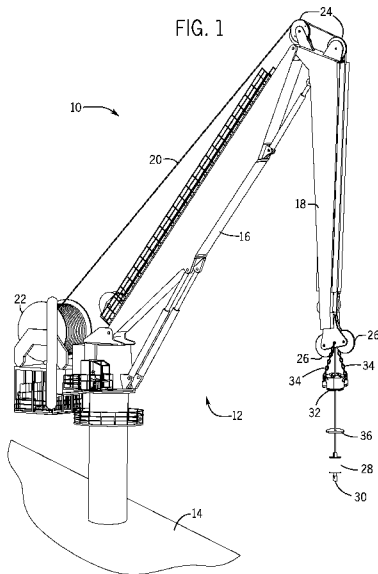

(57) Abstract: Various hoisting systems with anti-two-block sensing devices are provided. In one embodiment, an apparatus includes a crane having a hoisting line and an anti-two-block sensing device installed about the hoisting line. The anti-two-block sensing device includes an upper chandelier, a lower trigger assembly suspended from the upper chandelier, and a detector positioned to detect movement of the lower trigger assembly with respect to the upper chandelier. The lower trigger assembly can include two plates each having a hoisting line aperture and a slot that allows transverse installation of the plate about the hoisting line. Further, the two plates can be positioned such that their slots are offset from one another and the plates cooperate to fully surround the hoisting line. Additional systems, devices, and methods are also disclosed.

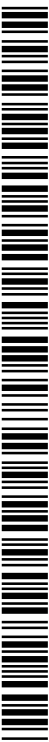

ANTI-TWO-BLOCK SENSING SYSTEMS

BACKGROUND

[0001] This section is intended to introduce the reader to various aspects of art that may be related to various aspects of the presently described embodiments. This discussion is believed to be helpful in providing the reader with background information to facilitate a better understanding of the various aspects of the present embodiments. Accordingly, it should be understood that these statements are to be read in this light, and not as admissions of prior art.

[0002] In order to meet consumer and industrial demand for natural resources, companies often invest significant amounts of time and money in finding and extracting oil, natural gas, and other subterranean resources from the earth. Particularly, once a desired subterranean resource such as oil or natural gas is discovered, drilling and production systems are often employed to access and extract the resource. These systems may be located onshore or offshore depending on the location of a desired resource.

[0003] Offshore drilling platforms often include hoisting systems for raising and lowering equipment. In some instances, these hoisting systems take the form of cranes used to load and unload equipment from an offshore platform. Of course, cranes and other hoisting systems can be used onshore as well. Cranes often include hoisting lines that are spooled from drums, reeved over sheaves in upper blocks at fixed locations in booms of the cranes (e.g., at the ends of the booms), and are connected to loads via lower, traveling blocks (or hook assemblies) at the ends of the hoisting lines. When raising connected loads with cranes, care is taken to avoid contact between the upper and lower blocks. Such contact, which is referred to as two-blocking, can interfere with crane operation and lead to failure of a hoisting line or disconnection of the suspended load from the hoisting line. Various anti-two-block sensing devices have been used on cranes to help avoid two-blocking.

SUMMARY

[0004] Certain aspects of some embodiments disclosed herein are set forth below. It should be understood that these aspects are presented merely to provide the reader with a brief summary of certain forms the invention might take and that these aspects are not intended to limit the scope of the invention. Indeed, the invention may encompass a variety of aspects that may not be set forth below.

[0005] At least some embodiments of the present disclosure generally relate to anti-two-block safety systems intended to warn or stop hoisting or crane motion that would cause a two-block condition between a traveling hook block and an upper block of a crane. In certain embodiments, an anti-two-block sensing device includes a chandelier that can be hung below an upper block of a crane and can receive the hoisting line. The sensing device in at least one embodiment includes a trigger assembly for detecting an actuator coupled to the hoisting line and raised into contact with the trigger assembly. In one embodiment, the sensing device has a low-maintenance design devoid of seals, springs, lubricants, and precision sliding components. A sensing cap having proximity sensors or other detectors can be mounted on the chandelier for detecting the approach of the lower block toward the upper block and triggering alerts or preventive measures to avoid two-blocking.

[0006] Various refinements of the features noted above may exist in relation to various aspects of the present embodiments. Further features may also be incorporated in these various aspects as well. These refinements and additional features may exist individually or in any combination. For instance, various features discussed below in relation to one or more of the illustrated embodiments may be incorporated into any of the above-described aspects of the present disclosure alone or in any combination. Again, the brief summary presented above is intended only to familiarize the reader with certain aspects and contexts of some embodiments without limitation to the claimed subject matter.

BRIEF DESCRIPTION OF THE DRAWINGS

[0007] These and other features, aspects, and advantages of certain embodiments will become better understood when the following detailed description is read with reference to the accompanying drawings in which like characters represent like parts throughout the drawings, wherein:

[0008] FIG. 1 generally depicts a hoisting system in the form of a crane having an anti-two-block sensing apparatus in accordance with one embodiment of the present disclosure;

[0009] FIGS. 2 and 3 are perspective views of an anti-two-block sensing device of the apparatus of FIG. 1, which is shown as having a cap mounted to a main body with a lower trigger assembly in accordance with one embodiment;

[0010] FIGS. 4 and 5 are perspective views of the main body and lower trigger assembly of the sensing device and show the lower trigger assembly in resting and actuated positions in accordance with one embodiment;

[0011] FIG. 6 is an exploded view of the main body and lower trigger assembly of the sensing device in accordance with one embodiment;

[0012] FIG. 7 is a perspective view of the sensing device of FIG. 2 positioned about a hoisting line and further shows a sensing cap having interlocking half-shells mounted on the main body in accordance with one embodiment;

[0013] FIG. 8 is a perspective view of one of the half-shells of the cap of FIG. 7;

[0014] FIG. 9 is an elevational view of the sensing cap, shown without the main body and lower trigger assembly, and depicts a detector installed in the sensing cap in accordance with one embodiment;

[0015] FIG. 10 depicts a hoisting line as having a sleeve that can be sensed by the cap of the anti-two-block sensing device in accordance with one embodiment;

[0016] FIG. 11 is a cross-section of the sleeve of FIG. 10 in accordance with one embodiment;

[0017] FIG. 12 is a block diagram of a control system for a crane in accordance with one embodiment;

[0018] FIG. 13 depicts a hoisting line sleeve as having multiple radio-frequency identification tags to be detected with the anti-two-block sensing device in accordance with one embodiment;

[0019] FIG. 14 depicts the hoisting line sleeve as extending upwardly from a strike plate coupled to the hoisting line in accordance with one embodiment; and

[0020] FIG. 15 is a block diagram of a controller that can be used in the control system of FIG. 13 in accordance with one embodiment.

DETAILED DESCRIPTION OF SPECIFIC EMBODIMENTS

[0021] Specific embodiments of the present disclosure are described below. In an effort to provide a concise description of these embodiments, all features of an actual implementation may not be described in the specification. It should be appreciated that in the development of any such actual implementation, as in any engineering or design project, numerous implementation-specific decisions must be made to achieve the developers' specific goals, such as compliance with system-related and business-related constraints, which may vary from one implementation to another. Moreover, it should be appreciated that such a development effort might be complex and time-consuming, but would nevertheless be a routine undertaking of

design, fabrication, and manufacture for those of ordinary skill having the benefit of this disclosure.

[0022] When introducing elements of various embodiments, the articles “a,” “an,” “the,” and “said” are intended to mean that there are one or more of the elements. The terms “comprising,” “including,” and “having” are intended to be inclusive and mean that there may be additional elements other than the listed elements. Moreover, any use of “top,” “bottom,” “above,” “below,” other directional terms, and variations of these terms is made for convenience, but does not require any particular orientation of the components.

[0023] Turning now to the present figures, a hoisting system 10 is illustrated in FIG. 1 in accordance with one embodiment. In this example, the hoisting system 10 is embodied in a crane 12, but the hoisting system 10 could take other forms in different embodiments and could be provided as an electric or hydraulic hoisting system. The crane 12 is shown in FIG. 1 as a pedestal crane mounted on a deck 14. The deck 14 is part of a drilling rig (e.g., a jackup rig, a drillship, or a semi-submersible drilling rig) in certain embodiments.

[0024] The depicted crane 12 is a knuckle-jib crane having a boom with a main beam 16 connected to a second beam 18. The illustrated system 10 includes a hoisting line 20 reeled out from a rotatable drum 22 on the crane 12. The hoisting line 20 is reeved through sheaves 24 and 26, and a hook assembly 28 with a hook 30 on the end of the hoisting line 20 is used to connect the hoisting line 20 to a load (e.g., supplies or equipment to be lifted by the crane 12). Once connected, the hoisting line 20 can be reeled in or reeled out from the drum 22 to raise or lower the load. Any suitable hoisting line 20 could be used with the hoisting system 10, such as a wire rope, a fiber rope, or a metal cable.

[0025] The hoisting system 10 includes an anti-two-block sensing device 32 intended to detect when the hook 30 (or other moving component coupled to the

hoisting line 20) reaches a predetermined distance from the boom tip of the crane 12. In the presently depicted embodiment, the anti-two-block sensing device 32 is suspended from the end of the boom of the crane 12 via chains 34, although the sensing device 32 could instead be suspended with cables or in some other suitable manner. The hoisting line 20 extends downwardly from the end of the boom through the sensing device 32 to the hook assembly 28. An actuator 36 (e.g., a strike plate) is coupled to the hoisting line 20 for engaging a trigger of the sensing device 32, as discussed in greater detail below. In some hoisting systems, the hoisting line 20 will move through the sensing device 32; in others, the hoisting line 20 in the sensing device 32 will remain stationary, while the actuator 36 is a traveling block or other component that will move relative to the sensing device 32. Although the use of the sensing device 32 with a jib crane is generally depicted in FIG. 1, it will be appreciated that the sensing device 32 could be used with other cranes or hoisting systems in full accordance with the present techniques to reduce or avoid two-blocking in such other systems.

[0026] The anti-two-block sensing device 32 is illustrated in greater detail in FIGS. 2 and 3. As shown here, the sensing device 32 includes a main body 42, with a trigger device 44 coupled below the main body 42 and a cap 46 mounted over the main body 42. The cap 46 is drawn in phantom in FIG. 3 to show certain additional details regarding the main body 42 and trigger device 44, which may be better appreciated with reference to FIGS. 4–6.

[0027] The main body 42 (which may also be referred to as a chandelier) can be suspended from a crane via lifting eyes 64. The trigger device 44 is coupled to the main body 42 via links that allow the trigger device 44 to freely move between a resting position, as shown in FIG. 4, and an actuated position, as shown in FIG. 5. More specifically, in the resting position of FIG. 4, the trigger device 44 is suspended from the main body 42 via links including connecting bolts 52, sleeves 54, and heads 56. In some embodiments, the heads 56 are integral with the sleeves 54, but

the heads 56 and sleeves 54 could be separate components in other instances. Although other arrangements are envisioned, in the presently depicted embodiment the links extend through the main body 42 and the trigger device 44 is suspended from the main body 42 through engagement of the heads 56 with an upper surface of the main body 42. The links are rigidly coupled to the trigger device 44, but are free to move a certain distance in the axial direction with respect to the main body 42. When the trigger device 44 is driven upwardly toward the main body 42 (e.g., when the hoisting line is reeled in and the actuator 36 coupled to the hoisting line lifts the trigger device 44 toward the main body 42), the links move with the trigger device and the heads 56 lift away from the upper surface of the main body 42, as depicted in FIG. 5.

[0028] The anti-two-block sensing device 32 includes one or more detectors for identifying movement of the trigger device 44. More particularly, in at least some embodiments the sensing device 32 includes a proximity sensor for detecting movement of a link caused by movement of the trigger device 44 toward the main body 42 (e.g., when driven upwardly by the actuator 36). If the sensing device 32 includes a cap 46 mounted on the main body 42, the proximity sensor or other detector can be installed in the cap 46 (e.g., as detector 128 of FIG. 9). In other embodiments, such as those in which the cap 46 is omitted from the sensing device 32, the proximity sensor or other detector can be provided elsewhere (e.g., mounted on the main body 42).

[0029] Two of the heads 56 are shown in FIGS. 4–6 as having proximity targets 60 in the form of outwardly extending tabs to be detected by a pair of proximity sensors, but targets 60 can be provided in any other suitable form. Two detectors (e.g., two detectors 128 at opposite sides of the cap 46) can be positioned with respect to the targets 60 such that each of the targets 60 lie within the detection zone of one of the detectors when the trigger device 44 is in its lowered, resting position during normal operation of the hoisting system with the hook sufficiently spaced

from the boom of the crane. When the actuator 36 (e.g., strike plate, traveling block, or some other component) coupled to the hoisting line 20 is raised into contact with and then lifts the trigger device 44, the links move upwardly and the targets 60 rise out of the detection zones (which are also referred to as the sensing areas) of the detectors. In such instances, the detectors can signal to a controller that the targets have moved out of the detection zones and, as discussed below, the controller can automatically stop the hoisting motion or crane movement (to avoid continuing to a two-block condition) or notify an operator (e.g., by triggering a warning alarm on a control panel).

[0030] In at least some embodiments, the detectors continuously (or continually) sense the targets 60 during normal hoisting operations (e.g., while moving the hoisting line 20 through the sensing device 32) until the trigger device 44 is moved through contact with the actuator 36, which causes lifting of the targets 60 as described above. Further, in this arrangement improper adjustment (or malfunctioning) of the detectors can be indicated by the inability of the detectors to “see” the targets 60 during normal conditions (i.e., in which the trigger device 44 has not been actuated). This is in contrast to other possible arrangements in which the detectors are used to detect movement of objects into the detection zone of the sensors upon actuation of the trigger device 44.

[0031] Any suitable detectors could be used for sensing the presence or absence of the targets 60. In at least some instances, the detectors are provided as solid-state, non-contact sensing devices. Further, in certain embodiments the detectors are provided as inductive proximity sensors that detect metal targets 60. Other proximity sensors (e.g., acoustic, capacitive, or infrared sensors), or other forms of detectors, could be used in additional embodiments. And while two detectors are described above for detecting the targets 60 shown in FIGS. 4–6, the anti-two-block sensing device 32 could have any suitable number of detectors and associated targets 60. It is

noted, however, that while the sensing device 32 could have just a single detector for sensing one target 60, two or more detectors could be used for redundancy.

[0032] As noted above, the depicted anti-two-block sensing device 32 includes lifting eyes 64 for connecting the sensing device 32 in a hoisting system (e.g., suspended from the boom of the crane 12 via the chains 34). Although other embodiments may differ, the sensing device 32 in FIGS. 4–6 has multiple, interlocking layers to completely encircle the hoisting line 20 and enhance the rigidity of the overall assembly. The main body or chandelier 42 includes upper and lower plates 70 and 72. Although these components are generally depicted as plates in FIGS. 4–6, the components could be provided in other forms in different embodiments. The upper plate 70 includes an aperture 74 for receiving the hoisting line 20 and a slot 76 that allows the plate to be installed on an existing hoisting system. That is, the slot 76 allows the plate 70 to be transversely installed by moving the plate so that the hoisting line 20 passes through the slot 76 and into the aperture 74, rather than threading the hoisting line 20 through the aperture 74. The lower plate 72 includes a similar aperture 80 and slot 82, which also allows the plate 72 to be positioned about the hoisting line 20. Additionally, the depicted trigger device 44 includes upper and lower plates 90 and 92, which have hoisting line apertures 94 and 100 and slots 96 and 102 that allow transverse installation of the plates 90 and 92 about the hoisting line 20 in a manner similar to that described above. In other embodiments, the trigger device 44 could be provided in other forms, such as a solid wire or rod that partially or fully surrounds the hoisting line 20.

[0033] It will be appreciated that the ability to transversely install the plates 70, 72, 90, and 92 about the hoisting line 20 enables the main body 42 and the trigger device 44 to be installed on an assembled hoisting line system (e.g., without disconnecting the hoisting line 20 from the hook assembly 28 and threading the hoisting line through each of the plates). Although no individual plate of the main

body 42 and the trigger device 44 fully surrounds the hoisting line 20 (due to their slots), once positioned about the hoisting line 20 the plates may be aligned and fastened together so that their slots are offset from one another such that the plates cooperate to fully encircle the hoisting line 20. More particularly, the slots 76 and 82 are rotationally offset from one another such that the plates 70 and 72 of the main body 42 cooperate to fully surround the hoisting line 20. Similarly, the slots 96 and 102 are offset from one another so the plates 90 and 92 of the trigger device 44 also cooperate to fully surround the hoisting line 20. Further, as shown in FIGS. 4–6, the lower plate 72 includes a key 86 that is received in the slot 76 of the upper plate 70. The interlocking of the key 86 with the slot 76 facilitates proper alignment of the plates 70 and 72 and enhances rigidity of the main body 42. Also, by fully surrounding the hoisting line 20 with rigid plates, the sensing device 32 is intrinsically locked together so as to prevent inadvertent disconnection of the device 32 from the hoisting line.

[0034] In contrast to some previous anti-two-block sensing devices, in at least some embodiments of the present disclosure the sensing device 32 is devoid of seals, springs, and sliding surfaces (e.g., precision plungers) requiring periodic lubrication. Further by not using lubricants or seals, the sensing device 32 of at least some embodiments is a low-maintenance (or effectively a no-maintenance) device in that it does not require manual intervention to lubricate sliding surfaces or routinely replace parts. It can also be assembled over an intact hoisting line and still have full circumferential contact with the wire rope. Further, the operation of the sensing of the targets 60 is insensitive to the weight of the linkages suspending the trigger device 44 from the chandelier 42 in at least some embodiments.

[0035] As noted above, the anti-two-block sensing device 32 of some embodiments includes a cap 46 coupled to the main body 42. In one embodiment generally depicted in FIG. 7, the body of the cap 46 is formed of shell portions 110 fastened to the main body 42 with fasteners 112. More specifically, the cap 46 is shown here

with a half-shell interlocking design that can be assembled around the hoisting line 20 and then fastened to the main body 42. The two half-shells 110 depicted in FIG. 7 each include a key 116 and a mating slot 118, such as shown in FIG. 8. This allows the key 116 of each half-shell to be axially aligned with the slot 118 of the other so that the half-shells can be coupled by sliding the keys 116 into the slots 118. The depicted half-shells 110 are identical and can be manufactured as a single part, which will allow a manufacturer to produce and stock just one part for the cap body (rather than two different parts) and permit an operator to reduce their spare parts for the cap body by one-half. In one embodiment, the cap body is made of plastic, though other materials could be used as desired.

[0036] The half-shells 110 of the cap 46 are shown assembled about the hoisting line 20 in FIG. 9 without the main body 42 or the trigger device 44 of the sensing device 32 to better show recesses 122 for mating with the main body 42. As also generally shown in this figure, the half-shells 110 include recesses 126 for receiving detectors 128 used to sense targets and facilitate avoidance of two-blocking conditions. In at least some embodiments, the detectors 128 are duplicated between the two half-shells 110 and are used with if/or logic for increased reliability. The detectors 128 can communicate with a controller in any suitable manner. In the embodiment depicted in FIG. 9, each half-shell 110 includes a cable 130 coupled to a connector assembly 132 received in a protective, snap-fit recess 134. An external cable 136 can be coupled to each connector assembly 132 to facilitate communication between the detectors 128 and a controller.

[0037] In some instances, the detectors 128 include proximity sensors used to detect targets 60 moved through actuation of the trigger device 44, as described above. In other embodiments, however, the detectors 128 are also or instead used to sense one or more components (which may also be referred to as targets) provided on the hoisting line itself. For example, such components (e.g., a metallic material or radio-frequency identification tags) can be embedded in a sleeve 142 positioned about the

hoisting line 20 as generally shown in FIG. 10. The sleeve 142 has a layered construction designed to wrap around the circumference of the hoisting line 20 for a given length in at least some embodiments, and can have a high-visibility design to assist operators with visual location of the hook 30 and the hoisting line.

[0038] As depicted in FIG. 11, the sleeve 142 includes a metallic material 144 (e.g., a magnetic material) positioned between inner and outer protective, insulation layers 146 and 148. The metallic material 144 is presently depicted as a layer entirely surrounding the inner protective layer 146, although it will be appreciated that this need not be the case. In this embodiment, the detectors 128 include proximity sensors for detecting the metallic material 144 when the sleeve 142 enters the anti-two-block sensing device 32. When the detectors 128 sense the presence of the sleeve 142 in the sensing device 32 a signal may be transmitted from the detectors 128 to a control system, which may respond by altering the hoisting speed. For example, in one embodiment, the control system may activate a slowdown feature that slows the ascent of the hook (e.g., by slowing the speed of the hoisting line) once the metallic material 144 is detected by the detectors 128. The ascent of the hook can then be stopped when the trigger device 44 is triggered by the actuator 36.

[0039] An example of a hoisting control system 152 is generally depicted in FIG. 12 as including a detector 154, a controller 156, and a motor 158 coupled to the hoisting line drum 22. When the detector 154 (e.g., detector 128 or some other detector) senses the sleeve 142 or detects movement of the trigger device 44, the detector sends a signal to the controller 156. As generally discussed above, the controller 156 can command the motor 158 to slow down or stop reeling in of the hoisting line 20 in response to the signal sent by the detector. The controller 156 in some embodiments also controls or limits movement of a crane in response to the signal.

[0040] In still other embodiments, the targets sensed by the detectors 128 (or 154) are radio-frequency identification (RFID) tags positioned along the hoisting line 20. One example of such an embodiment is depicted in FIG. 13, in which RFID tags 164 are embedded in the sleeve 142 and the detectors 128 are provided as RFID readers. In this embodiment, the metallic layer 144 can be omitted and the RFID tags 164 are embedded between the protective layers 146 and 148 of the sleeve 142. As shown in the present figure, RFID tags 164 are spaced longitudinally along the hoisting line 20. In at least some instances, the RFID signatures of these tags 164 are progressively different through the longitudinal axis, providing positive location of the sleeve 142 (e.g., in reference to the strike plate or other actuator 36). As the RFID tags 164 travel up through the cap 46, the detectors of the cap 46 read the RFID tags 164 and indicate detection of the tags to the controller 156. The action to be taken by the controller 156 in response to the signals can be varied based on the RFID tag detected. For example, in some embodiments the controller activates a slowdown of an ascending hoisting line when a first RFID tag 164 is detected (e.g., a tag nearer the top of the sleeve 142) and then commands the hoisting line to stop when a second RFID tag 164 is detected (e.g., a tag closer to the bottom of the sleeve 142). In some such embodiments, the main body 42 and the trigger device 44 may be retained in the anti-two-block sensing device 32 as a backup (i.e., as a redundant stop feature). In still further embodiments, additional RFID tags 164 could be used to trigger still further functions when detected (e.g., for slowing the hoisting speed in stages before stopping).

[0041] The length of the sleeve 142 can be varied between different implementations. For instance, the length can vary depending on the speed or rate of travel of the hoisting line 20. In one embodiment, the sleeve 142 is placed around the hoisting line 20 extending upward from a location starting at the actuator 36 (e.g., a strike plate) located at the top of a hook ball/weight, as generally depicted in FIG. 14.

[0042] It is noted that a controller 156 for implementing various functionality described herein (e.g., slowing or stopping hoisting in response to signals from anti-two-block sensing device 32) can be provided in any suitable form. In at least some embodiments, such a controller 156 is provided in the form of a processor-based system, an example of which is illustrated in FIG. 15 and generally denoted by reference numeral 170. In this depicted embodiment, the system 170 includes a processor 172 connected by a bus 174 to a memory device 176. It will be appreciated that the system 170 could also include multiple processors or memory devices, and that such memory devices can include volatile memory (e.g., random-access memory) or non-volatile memory (e.g., flash memory and a read-only memory). The one or more memory devices 176 are encoded with application instructions 178, such as software executable by the processor 172 to control hoisting system operation as described herein. Data 180 may also be stored in memory devices 176. In one embodiment, the application instructions 178 are stored in a read-only memory and the data 180 is stored in a writeable non-volatile memory (e.g., a flash memory). The system 170 also includes an interface 182 that enables communication between the processor 172 and various input or output devices 184 (e.g., detectors 128 or 154). The interface 182 can include any suitable device that enables such communication, such as a modem or a serial port. The devices 184 could also include an operator control panel for communicating information (e.g., warning alerts triggered by sensing of the device 32) to, and receiving input from, an operator.

[0043] While the aspects of the present disclosure may be susceptible to various modifications and alternative forms, specific embodiments have been shown by way of example in the drawings and have been described in detail herein. But it should be understood that the invention is not intended to be limited to the particular forms disclosed. Rather, the invention is to cover all modifications, equivalents, and alternatives falling within the spirit and scope of the invention as defined by the following appended claims.

CLAIMS

1. An apparatus comprising:
a crane having a hoisting line; and
an anti-two-block sensing device installed about the hoisting line, the anti-two-block sensing device including:
an upper chandelier;
a lower trigger assembly suspended from the upper chandelier, the lower trigger assembly including two plates each having a hoisting line aperture and a slot that allows transverse installation of the plate about the hoisting line, wherein the two plates are positioned such that their slots are offset from one another and the two plates cooperate to fully surround the hoisting line; and
a detector positioned to detect movement of the lower trigger assembly with respect to the upper chandelier.
2. The apparatus of claim 1, wherein the anti-two-block sensing device does not use lubricants or a seal.
3. The apparatus of claim 2, wherein the anti-two-block sensing device does not include a precision plunger.
4. The apparatus of claim 1, wherein the upper chandelier includes upper and lower plates each having a hoisting line aperture and a slot that allows transverse installation of the plate about the hoisting line, wherein the upper and lower plates of the upper chandelier are positioned such that their slots are offset from one another and the upper and lower plates cooperate to fully surround the hoisting line.

5. The apparatus of claim 4, wherein at least one of the upper plate or lower plate of the upper chandelier includes a key received in the slot of the other of the upper plate or lower plate.

6. The apparatus of claim 1, wherein the two plates of the lower trigger assembly are fastened together and coupled to the upper chandelier via fasteners installed through the two plates.

7. The apparatus of claim 1, wherein the lower trigger assembly is suspended from the upper chandelier by a link having a target positioned within a sensing area of the detector.

8. The apparatus of claim 7, wherein the link is coupled to move with the lower trigger assembly relative to the upper chandelier such that the detector is able to detect movement of the lower trigger assembly through detection of movement of the target of the link out of the sensing area of the detector.

9. The apparatus of claim 1, wherein the anti-two-block sensing device includes a cap mounted on the upper chandelier.

10. The apparatus of claim 9, wherein the detector is installed in the cap.

11. An apparatus comprising:

an anti-two-block sensing device configured to be installed in a hoisting system to facilitate prevention of two-blocking in the hoisting system, the anti-two-block sensing device including a main body, a trigger

device moveably coupled to the main body by a link, and a proximity sensor positioned to detect a target coupled to move with the trigger device, wherein the anti-two-block sensing device is devoid of seals, springs, and precision plungers.

12. The apparatus of claim 11, wherein the anti-two-block sensing device includes an aperture for receiving a hoisting line of the hoisting system.

13. The apparatus of claim 11, comprising the hoisting system.

14. The apparatus of claim 13, wherein a hoisting line of the hoisting system extends through the anti-two-block sensing device, an actuator is coupled to the hoisting line, and the actuator and the trigger device are positioned so as to allow the actuator to contact and move the trigger device in a manner that causes the proximity sensor to detect movement of the target coupled to the trigger device.

15. The apparatus of claim 13, wherein the hoisting system includes a crane and the anti-two-block sensing device is suspended from a boom of the crane.

16. The apparatus of claim 11, wherein the trigger device includes a plate.

17. A method comprising:

moving a hoisting line through an anti-two-block sensing device including a main body and a trigger suspended from the main body via a link;

continually sensing a target portion of the link with a proximity sensor of the anti-two-block sensing device while moving the hoisting line through the anti-two-

block sensing device until the trigger is driven toward the main body so as to cause the link to move upwardly with respect to the main body;

detecting, with the proximity sensor, movement of the target portion of the link out of a detection zone of the proximity sensor when the link is moved upwardly with respect to the main body; and

stopping movement of the hoisting line in response to the detected movement of the target portion of the link out of the detection zone.

18. The method of claim 17, wherein continually sensing a target portion of the link with a proximity sensor of the anti-two-block sensing device includes continually sensing the target portion of the link with the proximity sensor positioned on an opposite side of the main body from the trigger.

19. The method of claim 17, wherein continually sensing a target portion of the link with a proximity sensor of the anti-two-block sensing device includes continually sensing the target portion of the link with the proximity sensor installed in a cap mounted on the main body.

20. The method of claim 17, wherein moving the hoisting line through the anti-two-block sensing device includes reeling in the hoisting line until an actuator coupled to the hoisting line drives the trigger toward the main body so as to cause the link to move upwardly with respect to the main body.

1 / 8

FIG. 1

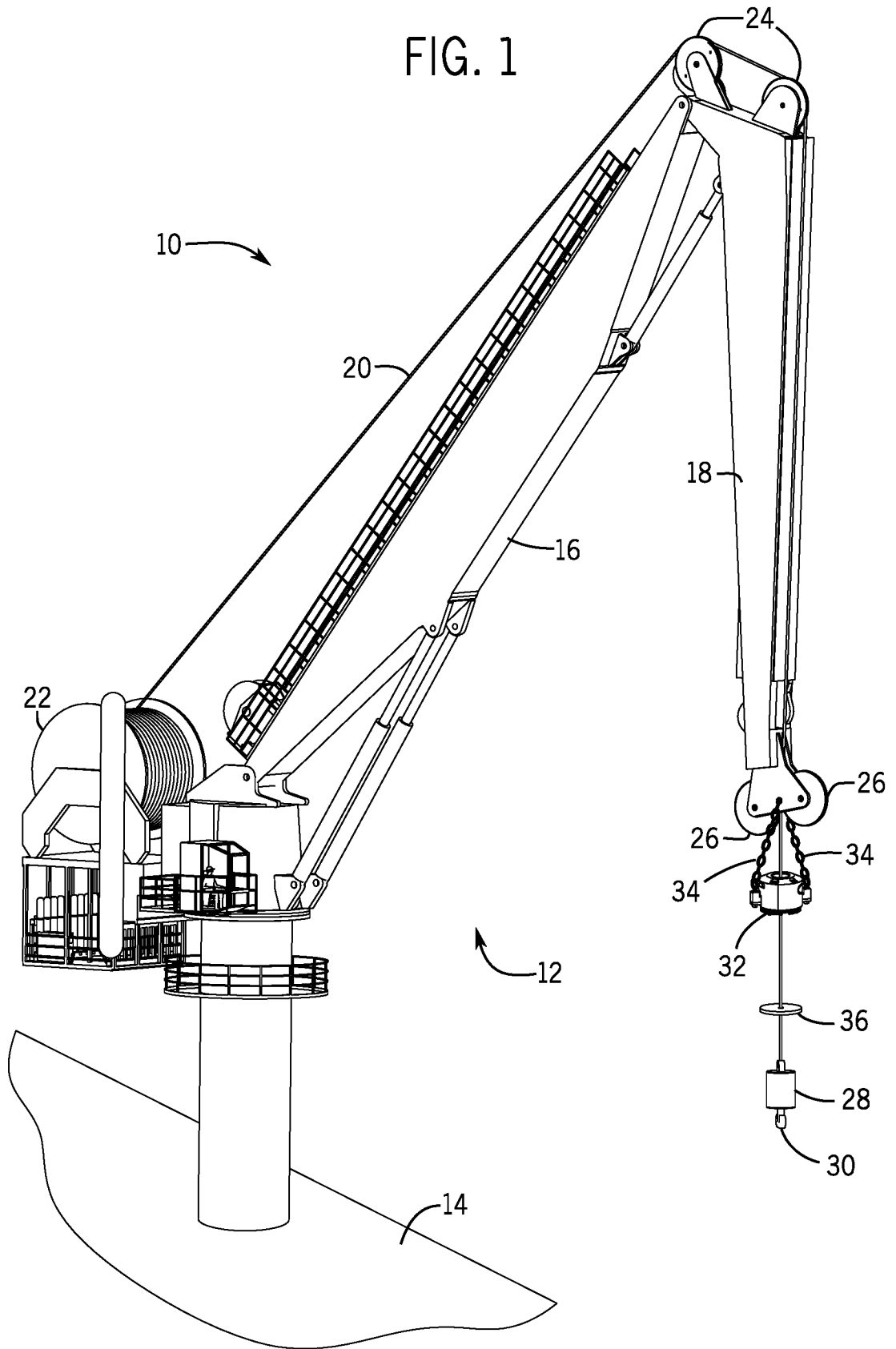

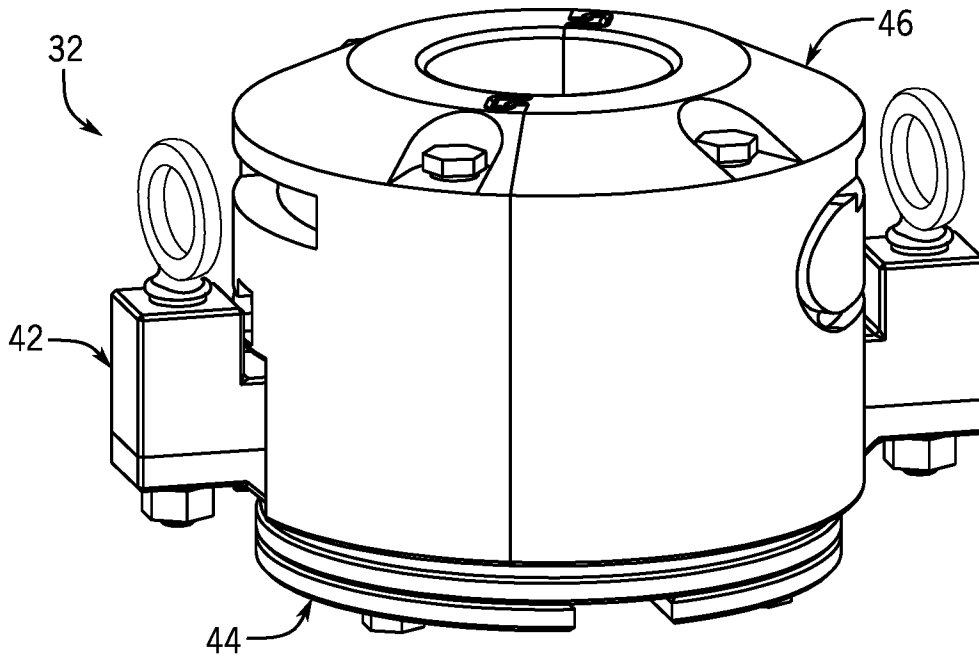

FIG. 2

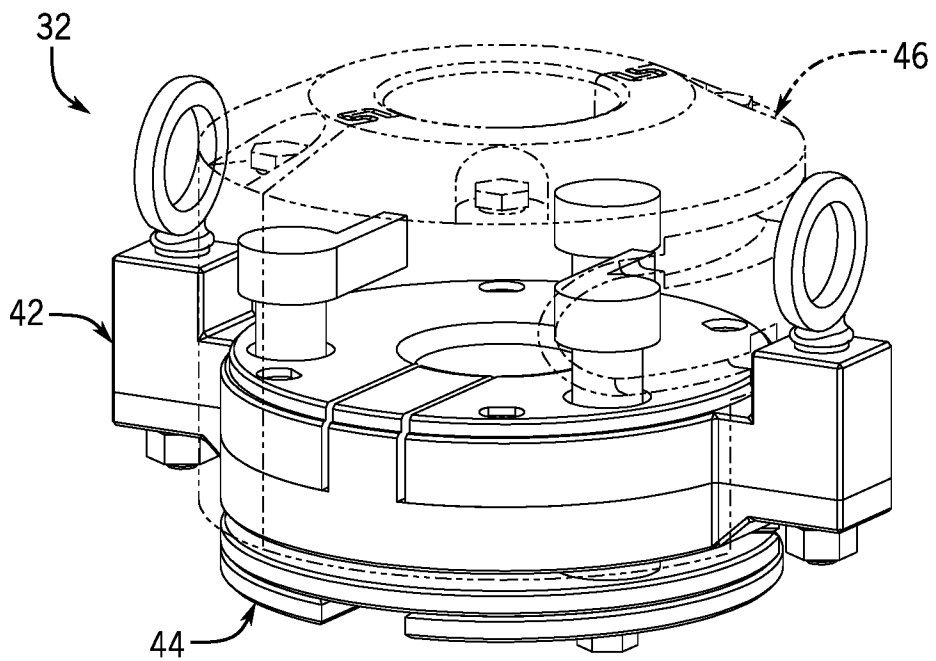

FIG. 3

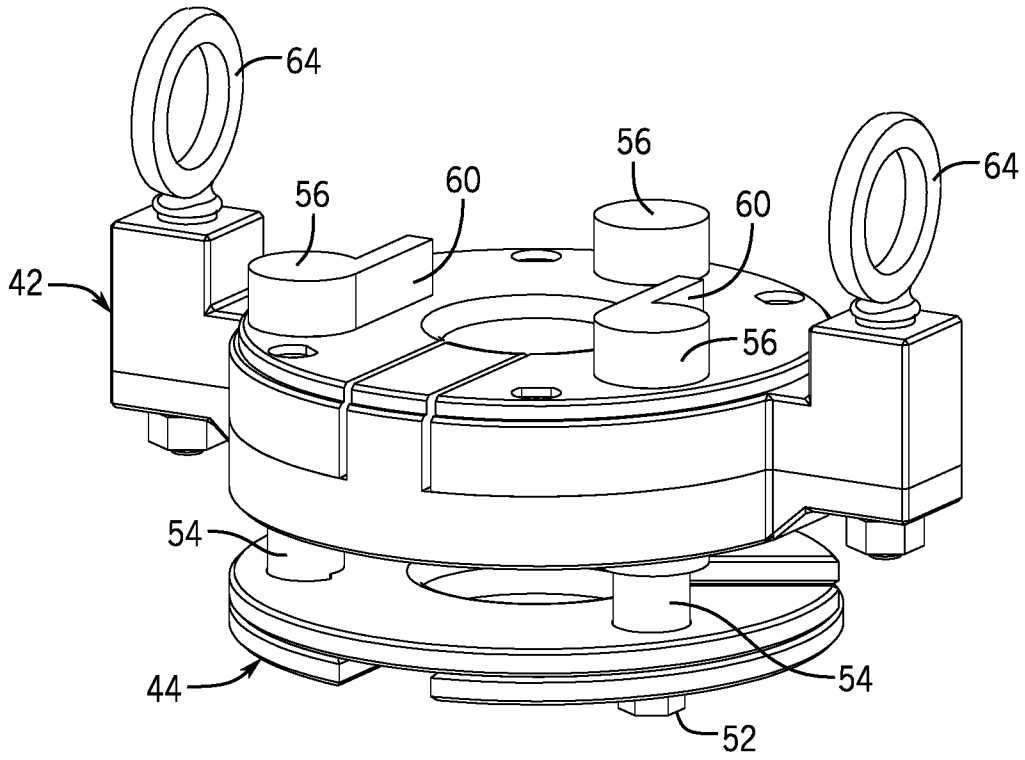

FIG. 4

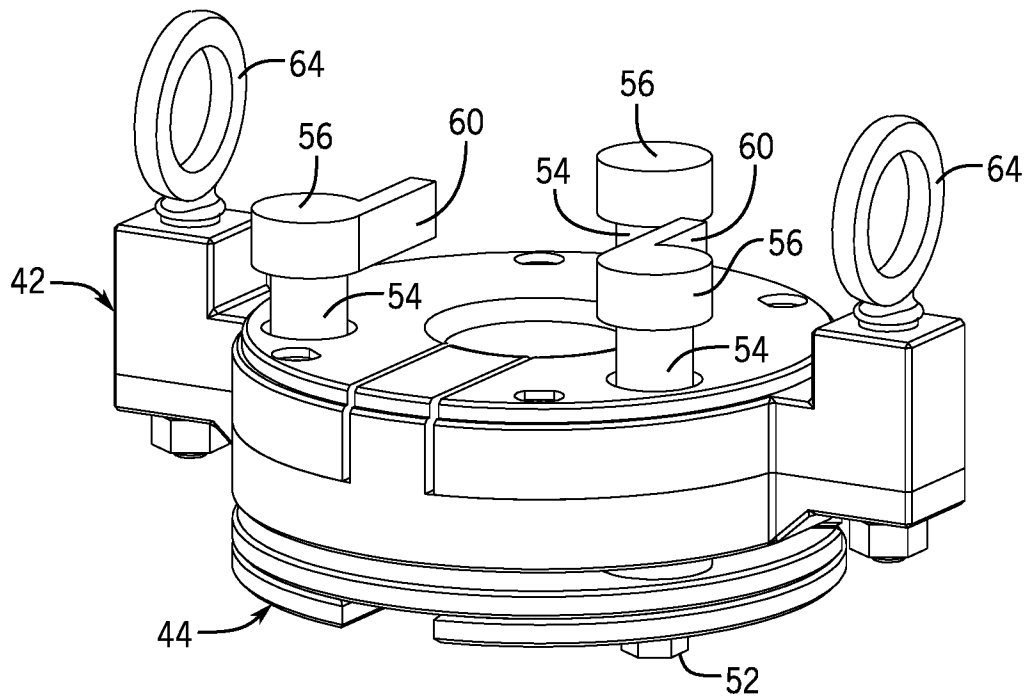
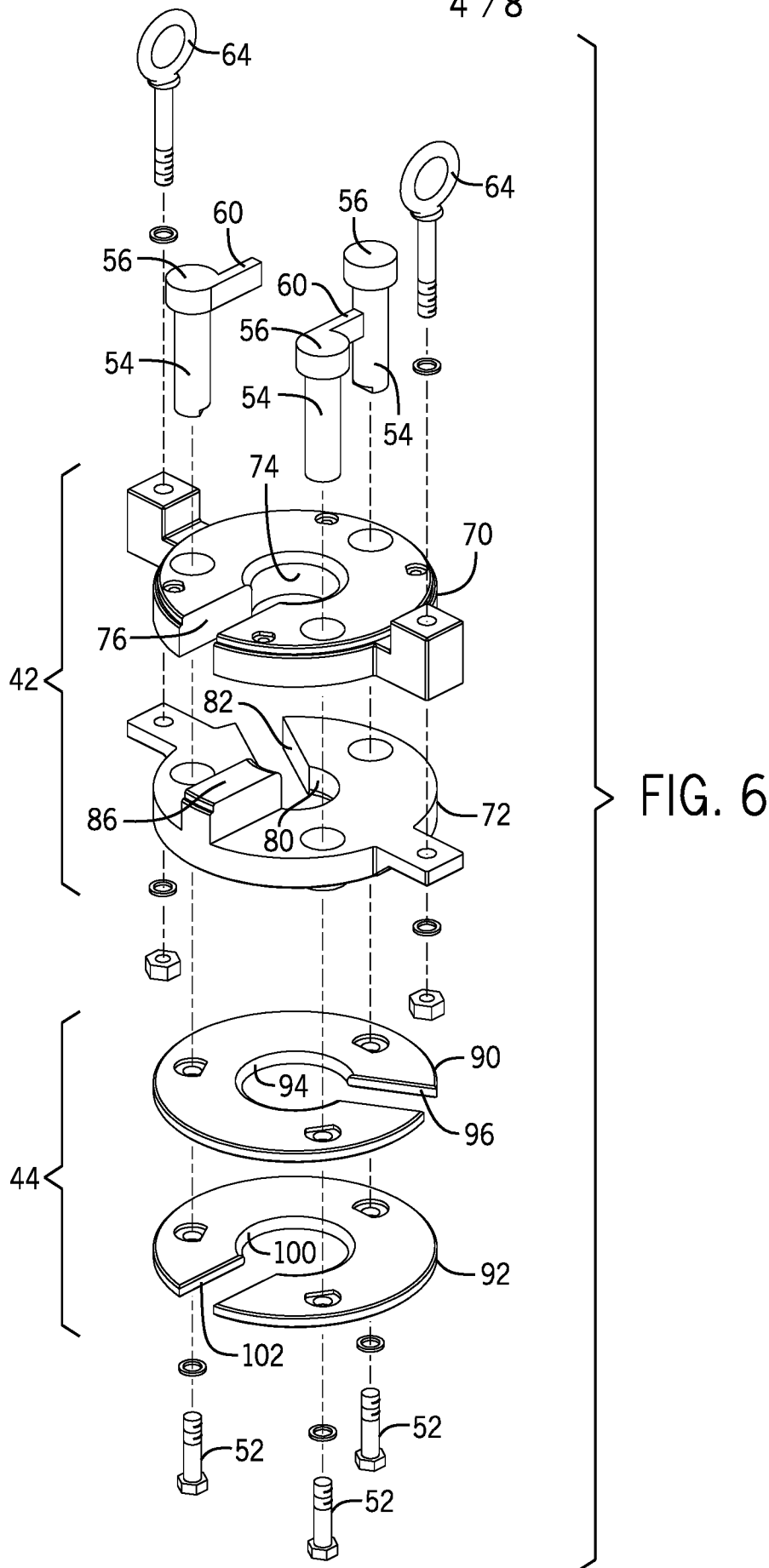
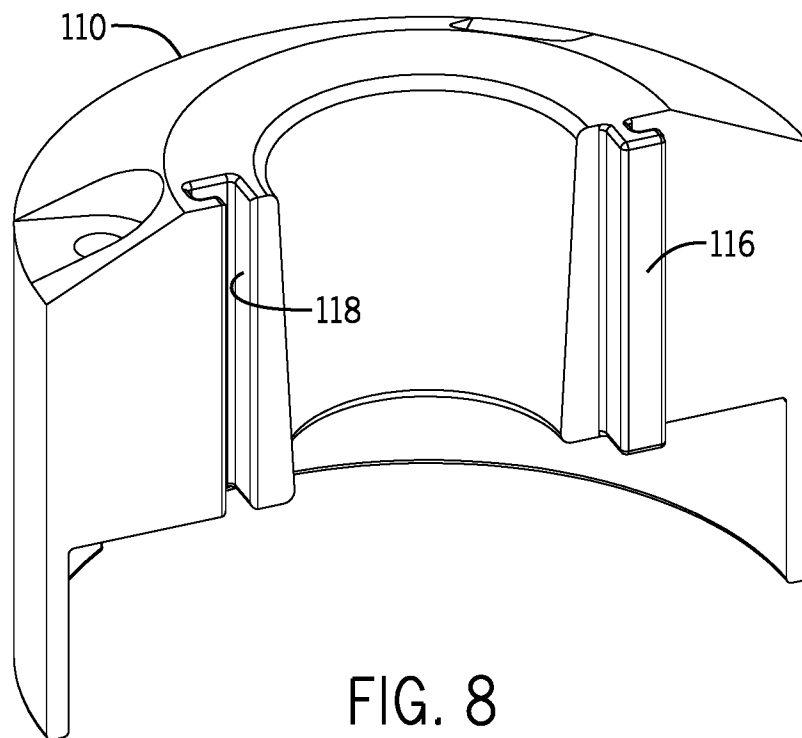
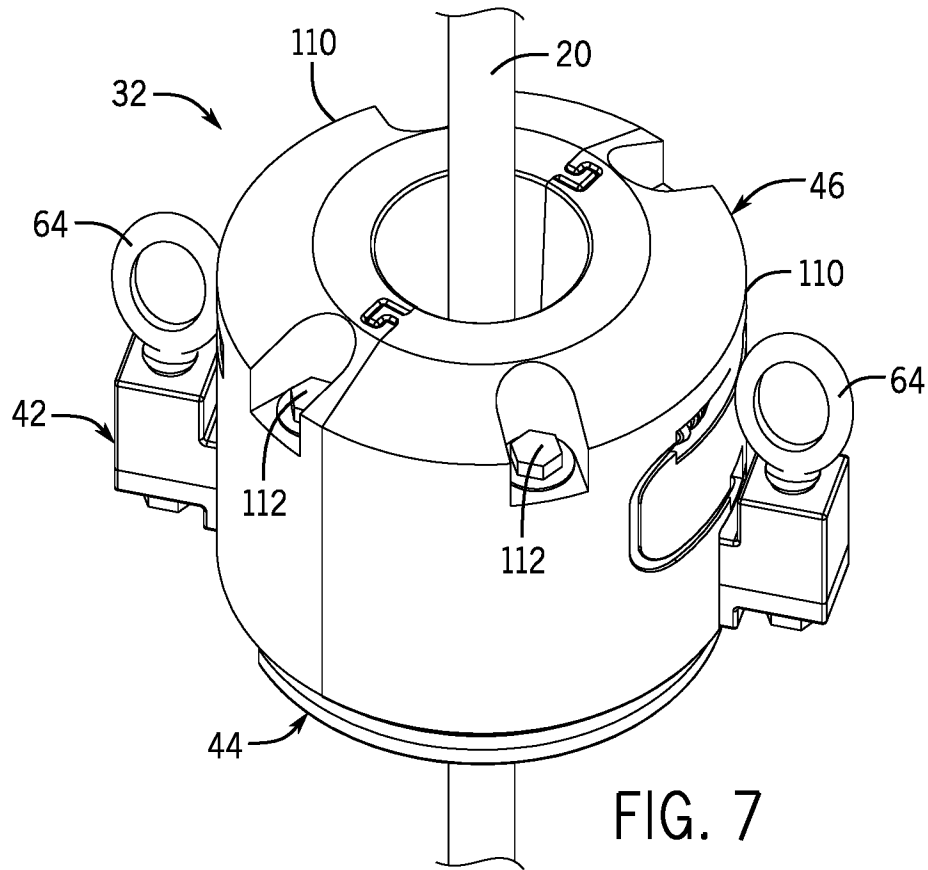
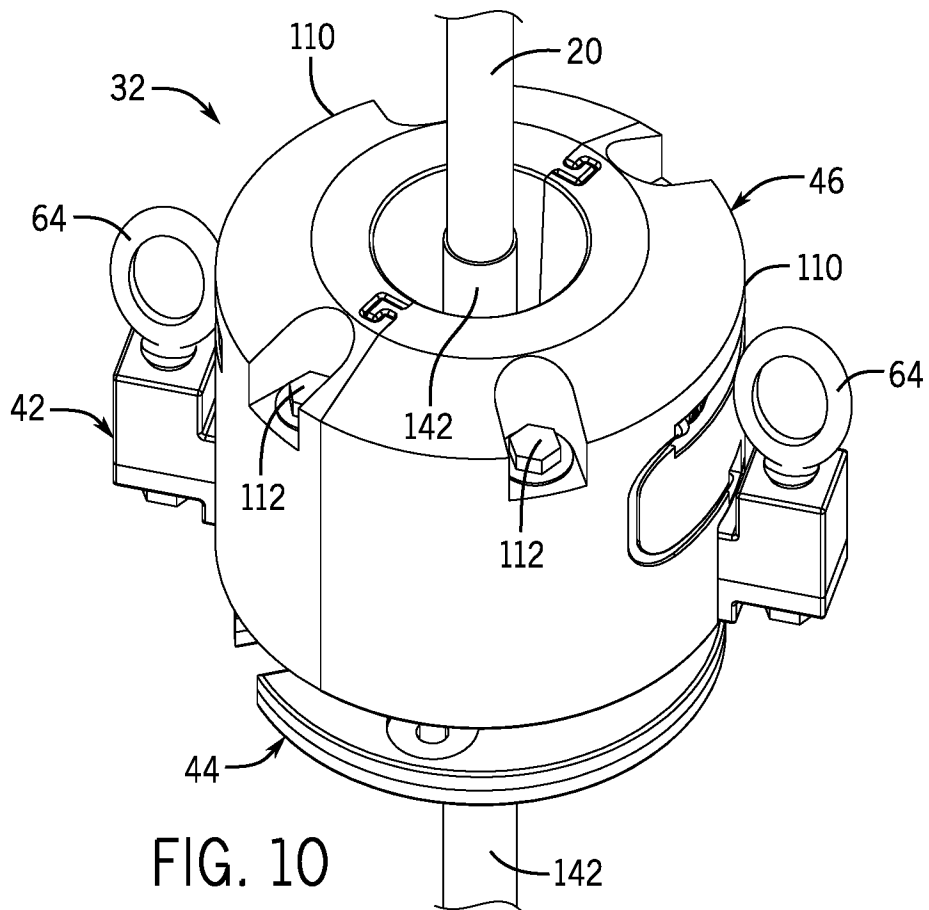
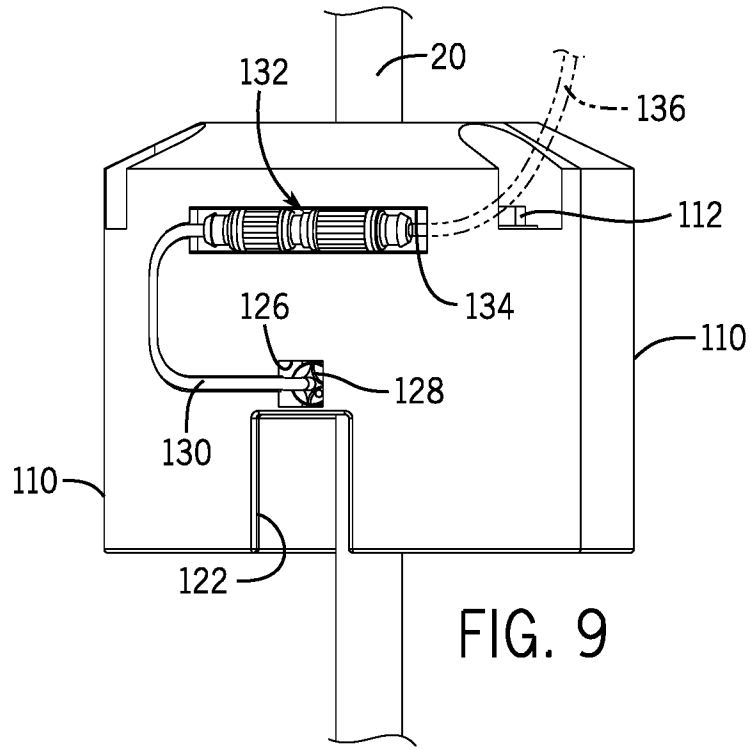

FIG. 5





6 / 8



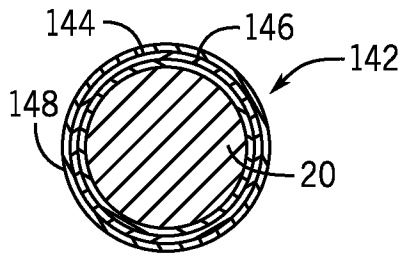

FIG. 11

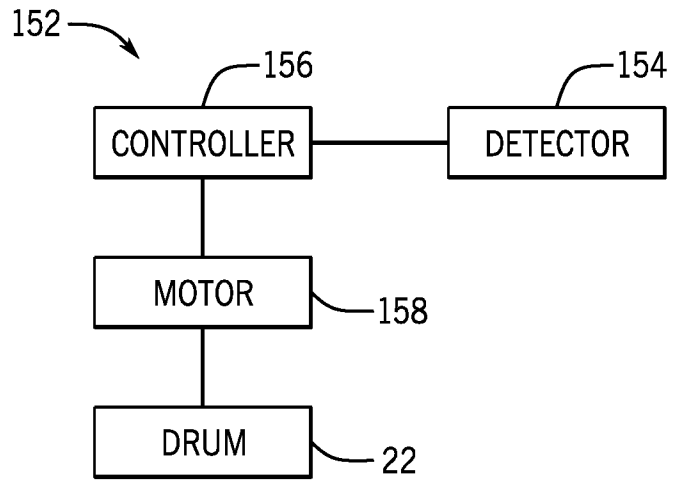

FIG. 12

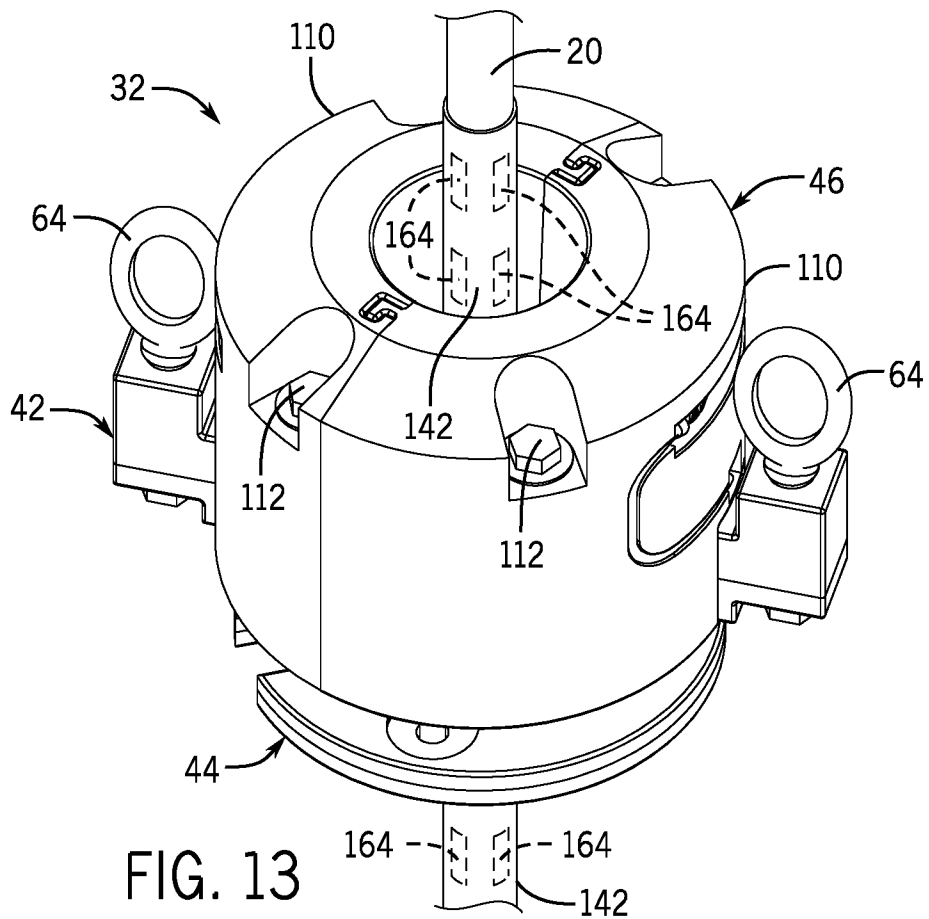
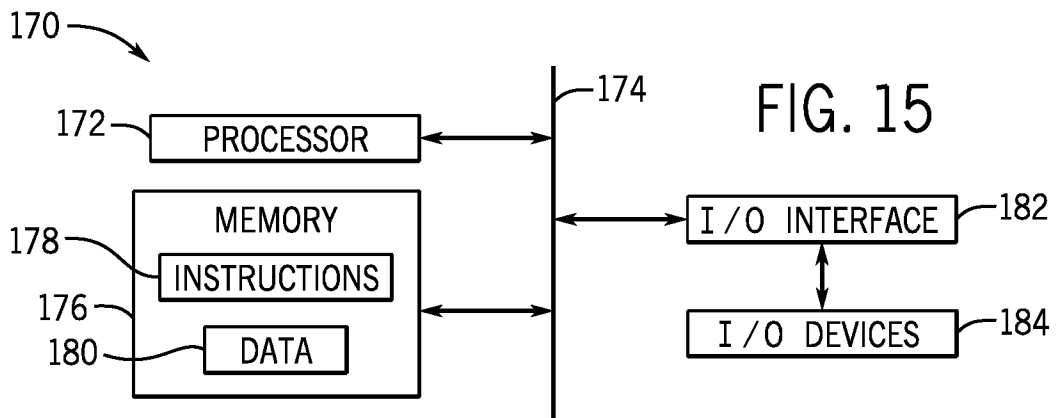
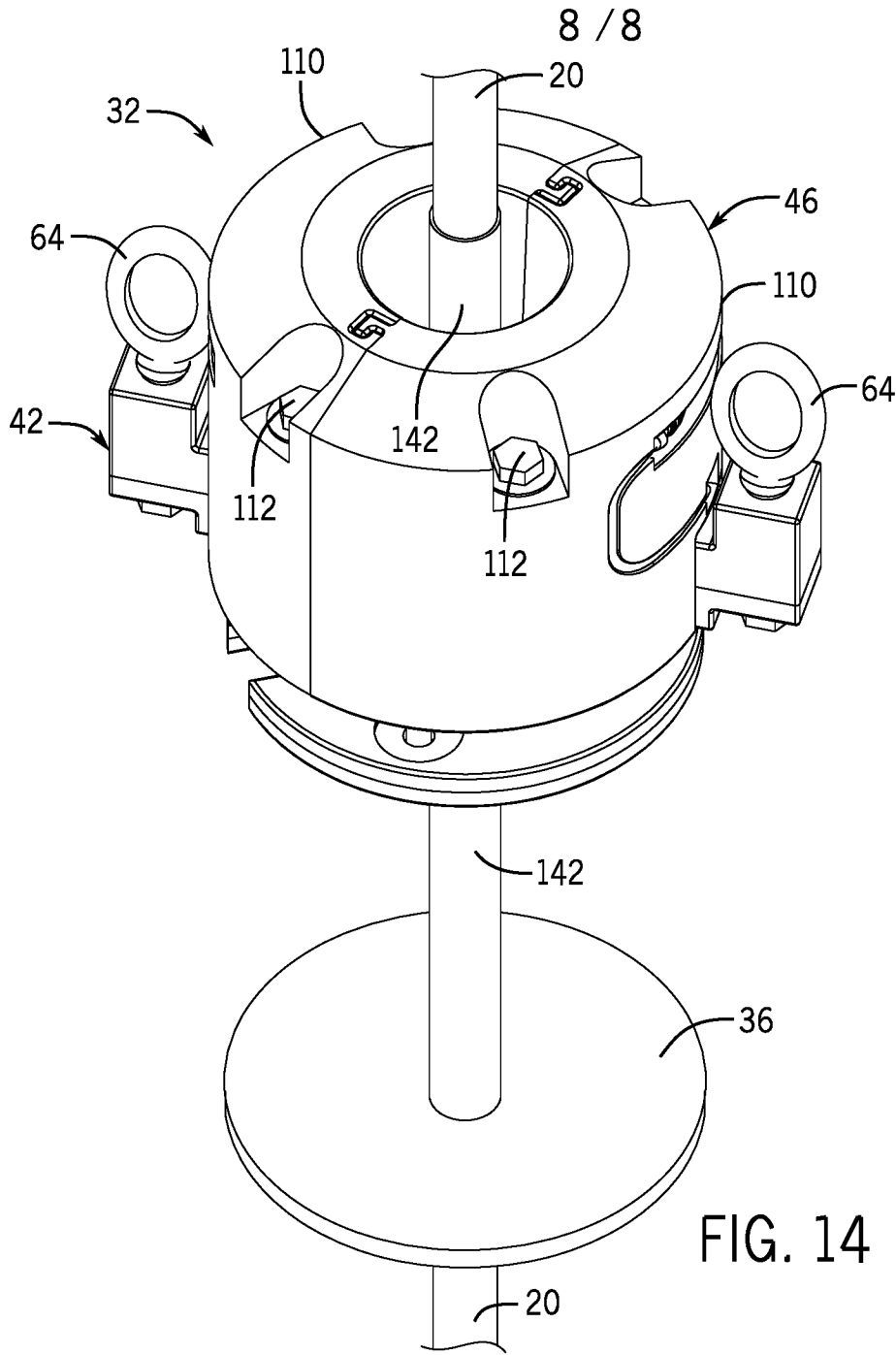

FIG. 13



A. CLASSIFICATION OF SUBJECT MATTER**B66C 23/88(2006.01)i, B66C 23/36(2006.01)i, B66C 15/04(2006.01)i**

According to International Patent Classification (IPC) or to both national classification and IPC

B. FIELDS SEARCHED

Minimum documentation searched (classification system followed by classification symbols)

B66C 23/88; B66C 13/16; B66C 23/90; B66C 13/12; B66C 13/48; B66C 15/00; B66C 13/18; B66D 1/48; B66C 15/04; G01C 21/00; B66C 23/36

Documentation searched other than minimum documentation to the extent that such documents are included in the fields searched

Korean utility models and applications for utility models

Japanese utility models and applications for utility models

Electronic data base consulted during the international search (name of data base and, where practicable, search terms used)

eKOMPASS(KIPO internal) & Keywords: anti-two-block sensing device, chandelier, trigger, detector, actuator, link

C. DOCUMENTS CONSIDERED TO BE RELEVANT

Category*	Citation of document, with indication, where appropriate, of the relevant passages	Relevant to claim No.
X	JP 06-271282 A (HITACHI CONSTR MACH CO., LTD.) 27 September 1994 See abstract, paragraphs [0007], [0010]-[0022], and figures 1-4.	1-20
A	US 6343703 B1 (FLEAGLE et al.) 05 February 2002 See abstract, column 2, line 12 - column 3, line 17, and figures 1, 2.	1-20
A	US 4067447 A (GOSS et al.) 10 January 1978 See abstract, column 2, line 3 - column 6, line 19, and figures 1-5.	1-20
A	US 5263660 A (BROZIK, JAMES) 23 November 1993 See abstract, column 3, line 43 - column 5, line 52, and figures 1-4.	1-20
A	US 2014-0081536 A1 (TRIMBLE NAVIGATION LIMITED) 20 March 2014 See abstract, paragraphs [0038], [0046], and figures 1A-2A.	1-20

 Further documents are listed in the continuation of Box C. See patent family annex.

* Special categories of cited documents:

"A" document defining the general state of the art which is not considered to be of particular relevance

"E" earlier application or patent but published on or after the international filing date

"L" document which may throw doubts on priority claim(s) or which is cited to establish the publication date of another citation or other special reason (as specified)

"O" document referring to an oral disclosure, use, exhibition or other means

"P" document published prior to the international filing date but later than the priority date claimed

"T" later document published after the international filing date or priority date and not in conflict with the application but cited to understand the principle or theory underlying the invention

"X" document of particular relevance; the claimed invention cannot be considered novel or cannot be considered to involve an inventive step when the document is taken alone

"Y" document of particular relevance; the claimed invention cannot be considered to involve an inventive step when the document is combined with one or more other such documents, such combination being obvious to a person skilled in the art

"&" document member of the same patent family

Date of the actual completion of the international search

02 May 2017 (02.05.2017)

Date of mailing of the international search report

02 May 2017 (02.05.2017)

Name and mailing address of the ISA/KR

International Application Division

Korean Intellectual Property Office

189 Cheongsa-ro, Seo-gu, Daejeon, 35208, Republic of Korea

Facsimile No. +82-42-481-8578

Authorized officer

KIM, Jin Ho

Telephone No. +82-42-481-8699



INTERNATIONAL SEARCH REPORT

Information on patent family members

International application No.

PCT/US2017/014525

Patent document cited in search report	Publication date	Patent family member(s)	Publication date
JP 06-271282A	27/09/1994	None	
US 6343703 B1	05/02/2002	CA 2255093 A1	05/06/1999
		CA 2255093 C	17/05/2005
		CA 2255105 A1	05/06/1999
		CA 2255105 C	31/01/2006
		CA 2255111 A1	05/06/1999
		CA 2255111 C	23/11/2004
		CA 2255233 A1	05/06/1999
		CA 2255234 A1	05/06/1999
		CA 2255234 C	28/03/2006
		CN 1154610 C	23/06/2004
		CN 1234364 A	10/11/1999
		CN 1235118 A	17/11/1999
		CN 1236694 A	01/12/1999
		CN 1236890 A	01/12/1999
		CN 1239070 A	22/12/1999
		DE 69818781 T2	19/05/2004
		DE 69823965 T2	21/10/2004
		DE 69826817 T2	17/02/2005
		EP 0921089 A2	09/06/1999
		EP 0921089 A3	16/06/1999
		EP 0921089 B1	08/10/2003
		EP 0921091 A2	09/06/1999
		EP 0921091 A3	16/06/1999
		EP 0921092 A2	09/06/1999
		EP 0921092 A3	16/06/1999
		EP 0921092 B1	19/05/2004
		EP 0921093 A2	09/06/1999
		EP 0921093 A3	16/06/1999
		EP 0921093 B1	06/10/2004
		EP 0921096 A2	09/06/1999
		EP 0921096 A3	16/06/1999
		EP 0921096 B1	12/07/2006
		JP 11-257492 A	21/09/1999
		JP 11-286393 A	19/10/1999
		JP 11-311512 A	09/11/1999
		JP 11-311513 A	09/11/1999
		JP 2000-001298 A	07/01/2000
		JP 3318277 B2	26/08/2002
		US 6067024 A	23/05/2000
		US 6380849 B1	30/04/2002
		US 6473715 B1	29/10/2002
US 4067447 A	10/01/1978	None	
US 5263660 A	23/11/1993	None	
US 2014-0081536 A1	20/03/2014	CN 102471040 A	23/05/2012

INTERNATIONAL SEARCH REPORT

Information on patent family members

International application No.

PCT/US2017/014525

Patent document cited in search report	Publication date	Patent family member(s)	Publication date
		CN 102471040 B	15/10/2014
		EP 2531433 A2	12/12/2012
		EP 2531433 A4	06/08/2014
		EP 2531433 B1	29/06/2016
		US 2011-187548 A1	04/08/2011
		US 2011-191025 A1	04/08/2011
		US 2014-081534 A1	20/03/2014
		US 2014-081535 A1	20/03/2014
		US 2014-081537 A1	20/03/2014
		US 2014-081538 A1	20/03/2014
		US 8618949 B2	31/12/2013
		US 8768609 B2	01/07/2014
		US 9067767 B2	30/06/2015
		US 9248998 B2	02/02/2016
		US 9278833 B2	08/03/2016
		US 9290361 B2	22/03/2016
		US 9359177 B2	07/06/2016
		WO 2011-094764 A2	04/08/2011
		WO 2011-094764 A3	01/03/2012