

(19) World Intellectual Property
Organization
International Bureau



(43) International Publication Date
31 December 2003 (31.12.2003)

PCT

(10) International Publication Number
WO 2004/000390 A1

- (51) International Patent Classification⁷: **A61M 1/06**
- (21) International Application Number:
PCT/GB2003/002633
- (22) International Filing Date: 19 June 2003 (19.06.2003)
- (25) Filing Language: English
- (26) Publication Language: English
- (30) Priority Data:
0214525.8 24 June 2002 (24.06.2002) GB
- (71) Applicant and
(72) Inventor: **SAMSON, Ian** [GB/GB]; 8a Chesterfield Gardens, London, Greater London NW3 7DE (GB).
- (72) Inventor; and
(75) Inventor/Applicant (for US only): **WEBB, Ian** [GB/GB]; 12 Junction Mews, London, Greater London W12 1PN (GB).
- (74) Agent: **SANDERSON, Michael, J.**; Mewburn Ellis, York House, 23 Kingsway, London, Greater London WC2B 6HP (GB).
- (81) Designated States (national): AE, AG, AL, AM, AT, AU, AZ, BA, BB, BG, BR, BY, BZ, CA, CH, CN, CO, CR, CU, CZ, DE, DK, DM, DZ, EC, EE, ES, FI, GB, GD, GE, GH, GM, HR, HU, ID, IL, IN, IS, JP, KE, KG, KP, KR, KZ, LC, LK, LR, LS, LT, LU, LV, MA, MD, MG, MK, MN, MW, MX, MZ, NI, NO, NZ, OM, PG, PH, PL, PT, RO, RU, SC, SD, SE, SG, SK, SL, TJ, TM, TN, TR, TT, TZ, UA, UG, US, UZ, VC, VN, YU, ZA, ZM, ZW.
- (84) Designated States (regional): ARIPO patent (GH, GM, KE, LS, MW, MZ, SD, SL, SZ, TZ, UG, ZM, ZW), Eurasian patent (AM, AZ, BY, KG, KZ, MD, RU, TJ, TM), European patent (AT, BE, BG, CH, CY, CZ, DE, DK, EE, ES, FI, FR, GB, GR, HU, IE, IT, LU, MC, NL, PT, RO, SE, SI, SK, TR), OAPI patent (BF, BJ, CF, CG, CI, CM, GA, GN, GQ, GW, ML, MR, NE, SN, TD, TG).

[Continued on next page]

(54) Title: BREAST PUMP

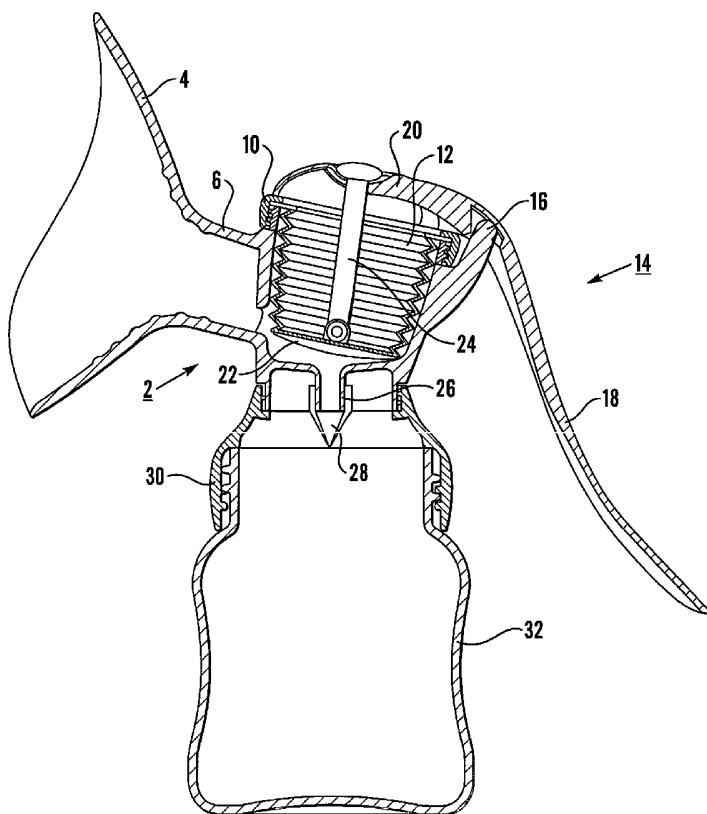

(57) Abstract: A breast pump comprises a body member (2) including a breast engaging portion (4) shaped to engage a region of a user's breast, a container (32) attached to the body member (2), valve means (28) between the body member (2) and the container (32), and, within the body member (2), a sleeve (12) sealing the interior of the body member (2) from the atmosphere, the sleeve (12) being selectively movable from a rest condition to a displaced condition by actuating means (14) operatively connected to the sleeve (12), movement of the sleeve (12) from the rest condition to the displaced condition creating an increasing volume of reduced pressure within the body member (2) whereby firstly the valve means (28) is closed to prevent evacuation of the container (32), and whereby milk is expressed by the user into the body member (2), and return movement of the sleeve (12) from the displaced condition to the extended condition releasing the reduced pressure allowing the valve to open, the expressed milk flowing through the valve means (28) and into the container (32), the configuration of the sleeve (12) or the material of the sleeve (12) being such as to substantially prevent stretching of the sleeve (12) on movement between the rest and displaced conditions.

WO 2004/000390 A1



Published:

- *with international search report*
- *before the expiration of the time limit for amending the claims and to be republished in the event of receipt of amendments*

For two-letter codes and other abbreviations, refer to the "Guidance Notes on Codes and Abbreviations" appearing at the beginning of each regular issue of the PCT Gazette.

BREAST PUMP

This invention relates to a breast pump for use by a mother of a young infant.

5 It is well established that a mother's natural milk is preferable to, for example, cow's milk or various feeding formulae for feeding infants, and various types of pumping devices have been devised to express a mother's milk from her breasts for more convenient subsequent feeding to the
10 infant.

Although manually operated pumps have been found to be less costly and more practical than electrically operated pumps, most existing manual pumps still suffer from various disadvantages.

15 In particular, it is well-established practice to incorporate a piston-cylinder assembly within the pump, movement of the piston in the cylinder creating the vacuum necessary to extract the milk from the breast of the user, subsequent release of the vacuum allowing the extracted
20 milk to pass through a valve assembly and into an associated container.

However, with such an arrangement, and to ensure creation of the vacuum, it is necessary for the piston cylinder assembly, and in particular the seal between the
25 piston and the cylinder, to be accurately manufactured to

ensure a fluid-tight seal. Such critical and precise engineering, and the requirement for an accurately machined seal, can prove expensive.

Furthermore movement of the piston within the cylinder, and in particular the continuous sealing engagement of the piston with the cylinder, being pressed together by suction forces, creates friction within the pump that needs to be overcome by the user and whereby energy is wasted.

It has been proposed to replace the piston cylinder arrangement of a breast pump with a cup-shaped diaphragm of silicone or flexible elastomeric material the peripheral regions of which are fixed and the base portion of which is moved or rolled generally axially of the diaphragm through the peripheral regions to create the vacuum necessary to express milk.

However, as the region of reduced pressure within the pump is created, the material of the diaphragm is stretched due to the pressure differential thereacross, this stretching increasing on decrease of pressure within the pump.

Thus, in order to continue movement of the diaphragm it is necessary to overcome this stretching of the material of the diaphragm, whereby considerable extra energy has to be expended by the user.

It would be desirable to be able to provide a breast pump capable of more economical and less precise manufacture than heretofore, and which was more energy efficient than heretofore.

5 According to the present invention there is provided a breast pump comprising a body member including a breast engaging portion shaped to engage a region of a user's breast, a container attached to the body member, and valve means between the body member and the container,
10 characterised by, within the body member, a sleeve sealing the interior of the body member from the atmosphere, the sleeve being selectively movable from a rest condition to a displaced condition by actuating means operatively connected to the sleeve, movement of the sleeve from the
15 rest condition to the displaced condition creating an increasing volume of reduced pressure within the body member whereby firstly the valve means is closed to prevent evacuation of the container, and whereby milk is expressed by the user into the body member, and return movement of
20 the sleeve from the displaced condition to the extended condition releasing the reduced pressure allowing the valve to open, the expressed milk flowing through the valve means and into the container, the configuration of the sleeve or the material of the sleeve being such as to substantially

prevent stretching of the sleeve on movement between the rest and displaced conditions.

It will be appreciated that the return movement of the sleeve to the extended condition brings the reduced
5 pressure back up towards atmospheric, this in turn, together with the pressure of any milk resting above the valve, opening the valve, starting to feed the milk into the container, completing release of the milk through the valve once the return movement of the sleeve member has
10 restored the pressure to atmospheric (or slightly above this) to counteract the milk's surface tension. Furthermore the sleeve is made such as to substantially prevent stretching without impairing flexibility.

Thus it will be appreciated that, with such an
15 arrangement, where, on displacement of the sleeve, the volume within the body member available to receive milk expressed by the user is increased, with a consequential reduction in the pressure therein and the creation of the vacuum necessary to express the milk, the non-stretch
20 nature of the sleeve reduces the effort required to effect the displacement compared with conventional arrangements.

In some embodiments of the invention, the sleeve is of generally concertina shape, and is selectively movable between an extended rest condition and a compacted
25 displaced condition.

Preferably the concertina shape has a closed base thereto at least part of which is substantially rigid, movement of the sleeve being by pulling the base from inside the sleeve so as to contract its length.

5 The configuration of such a sleeve is such as to ensure substantially no stretching thereof when under suction in the only possible direction, namely radially, on movement between the extended condition and the displaced condition. Furthermore, as the projected surface area of
10 the bellows that is exposed to the aforementioned stretching differential pressure reduces as the sleeve is compacted, the stretching force does not continue to grow with the increase in the generated suction.

Preferably the concertina sleeve is of a flexible
15 material, for example silicone or a thermoplastic elastomer such as polyurethane, the inherent properties of which are such that, on release of the lever arm by the user, the sleeve returns to its extended condition within the body member.

20 In other embodiments of the invention the sleeve acts essentially as a 'roll diaphragm' and comprises a substantially non-stretch material, and includes, for example a flexible layer, such as silicone or a thermoplastic elastomer, to which is bonded or which is
25 inlaid with a substantially non-stretch layer such as a

fabric mesh. Thus the material of the sleeve itself is such as to resist stretching on movement between the rest and displaced conditions without impairing its flexibility.

The actuating means may comprise a lever arm pivotally
5 mounted at an intermediate region thereof to the body member, one end extent of the lever arm being for engagement by the user, and the other end extent being operatively connected to the sleeve.

One end of the sleeve may be secured between a collar
10 and a defining wall of the body member whereby the interior of the sleeve is sealed from the interior of the body member, the other end of the sleeve being closed.

Conveniently the other, closed end of the sleeve carries an end plate, a link pin extending axially within
15 the sleeve and through the collar to interconnect the end plate and the other end extent of the lever arm whereby, on pivoting movement of the lever arm by the user, the link pin is moved substantially axially of the sleeve to compact the sleeve.

20 The end plate, link pin, sleeve and lever arm may comprise an integral unit, and may incorporate flexible joints at one or both ends of the link pin.

The actuating means may comprise an operating member one end of which is secured to a closed end of the sleeve

and the other end of which carries a thumb-receiving element for receiving the thumb of a user.

Preferably a handle member is provided as a rest and grip for the fingers of the actuating hand, said handle
5 being rigidly secured to the pump body, the arrangement being such that, on location of the thumb in the thumb-receiving element, and on pulling of the thumb towards the fingers, the base of the sleeve is pulled in the direction generally away from the breast.

10 In a preferred embodiment of the invention the valve means between the body member and the container comprise a duck bill type one way valve.

By way of example only, embodiments of the invention will now be described in greater detail with reference to
15 the accompanying drawings of which:

Fig. 1 is a vertical section through a first breast pump according to the invention with the sleeve in its rest condition,

Figs. 2 and 3 are vertical sections through part of
20 the pump of Fig. 1 with the sleeve in a partly displaced condition and a fully displaced condition respectively, and

Fig. 4 is a vertical section through a second breast pump according to the invention.

Referring to Figs. 1 to 3, the illustrated breast pump
25 comprises a body member indicated generally at 2 preferably

moulded from a thermoplastic elastomer such as polypropylene or polycarbonate, and including a generally conical breast engaging portion or horn 4 shaped to receive part of the breast of a user with the nipple located

5 substantially centrally of the horn 4.

The horn 4 feeds into a tubular portion 6 of the body member 2, the tubular portion 6 itself feeding into a main volume 8 of the body member 2.

The body member 2 includes an upwardly open top end

10 onto which may be attached an optional retaining annular collar 10. Secured between the collar 10 and the top end of the body member 2 is the annular flange of one end of a hollow, concertina-shaped sleeve 12 of an elastic material such a polyurethane which extends into the body member 2,

15 the other end of the sleeve 12 within the body member 2 being closed. The arrangement is such that the co-operation between the collar 10 and the one end of the sleeve 12 seals the top end of the body member, the sleeve 12 thereby constituting a dividing barrier between the

20 sealed interior of the body member and the external atmosphere, with the hollow interior of the sleeve 12 communicating with the atmosphere outside the body member 2.

Alternatively the sealing connection between the open

25 end of the body member 2 and the flange on the sleeve 12

may be effected by the elasticity of the flange wrapping over the rim of the body member without a collar 10.

An operating lever arm is indicated generally at 14 and is pivotally mounted to the body member at 16, the
5 lever arm 14 including a first end extent 18 for engagement by the user to actuate the pump as will be detailed below, and a second end extent 20 for operative connection to the sleeve 12.

More particularly, the other end of the sleeve 12 has
10 mounted externally or internally thereon a rigid end plate 22 to the centre of which one end of a link pin 24 is pivotally mounted. The pin 24 extends axially of the sleeve 12 and through the collar 10 with the other end of the pin 24 being attached to the second end extent 20 of
15 the lever arm 14.

It will thus be appreciated that, on pivoting of the lever arm 14 to move the first end extent 18 thereof towards the body member 2, the link pin 24 is raised by the resulting movement of the second end extent 20 of the lever
20 arm 14 away from the body member 2, thus drawing the end plate 22 upwardly therewith and compacting the sleeve 12 as shown in Figs. 2 and 3. The arcuate movement of the second end extent 20 of the lever arm 14 is readily accommodated by a combination of the pivotal attachment of the link pin
25 24 to the end plate 22, the nature of the attachment of the

other end of the pin 24 to the second end extent 20 of the lever arm 14, and the generally flexible nature of the material of the sleeve 12.

The sleeve 12 is of an flexible material, for example
5 silicone or a thermoplastic elastomer such as polyurethane, and has an inherent memory whereby the sleeve 12 tends to return towards the extended condition shown in Fig. 1. Thus, on release of any pivoting force from the first end extent 18 of the lever arm 14, the sleeve 12 extends to the
10 rest condition of Fig. 1, the balance of the lever arm 14 being such as to encourage the sleeve 12 and the arm 14 to return to their rest conditions as shown in Fig. 1.

The lower end of the body member 2 comprises an outlet 26 to which is mounted a duck bill type one way valve 28.

15 The pump may optionally include an adaptor 30 by which the body member 2 is attached to a container 32, conveniently by a screw thread.

The described breast pump operates as follows. The user takes hold of the container 2 and applies the horn 4
20 of the pump to her breast with sufficient pressure to seal against the breast. She then pivots the lever arm 14 about the pivot point 16 whereby, as detailed above, the concertina sleeve 12 is compacted. Thus the volume 8 between the outside of the sleeve 12 and the inside of the
25 surrounding body member 2 is increased. As this volume is

sealed from the atmosphere by way of the user's breast, the one-way valve 28 and the co-operation between the collar 10 and the one end of the sleeve 12, the pressure in the volume 8 is reduced to create a vacuum whereby milk is expressed from the breast and into the volume 8. In view of the concertina or convoluted shape of the sleeve, there is little tendency for the material of the sleeve 12 to stretch radially outward despite the pressure differential thereacross - there is a corresponding decrease in the projected surface area of the sleeve as the pressure differential increases which maintains substantially constant the force necessary to effect continuous compaction of the sleeve.

On release of the lever arm 14, the sleeve 12 returns to its extended condition in view of its inherent elasticity and the supplementary effect of the lever arm 14 to increase the pressure within the volume 8, that is releasing the suction therein allowing the valve to open and milk to flow and pump the milk through the valve 28 into the container 32 as a result of the vacuum release, this flow of milk from the body member 2 to the container 32 being supplemented by gravity.

This procedure can be repeated until sufficient milk has been expressed or until all available milk has been expressed.

The provision of the concertina sleeve 12 as the pumping element substantially eliminates the requirement for accurate machining, in that there is no need for the sleeve 12 to be guided during its compaction and extension movements. Furthermore, and as detailed above, there is substantial relative movement available between the lever arm 14 and the sleeve 12, in particular in view of the relatively flexible mounting of the link pin 24 to the second end extent 20 of the lever arm 14. Additional flexibility may be achieved by providing a link pin 24 of a non-rigid, bendable material. Conveniently the end plate 22, the link pin 24, the sleeve 12 and the lever arm 14 are manufactured as an integral unit.

Clearly the precise construction and orientations of the component parts of the pumping mechanism may vary from those described and illustrated without departing from the scope of the invention. For example the central axis of the sleeve 12 may be other than substantially vertical, for example substantially horizontal, the actuating means may be other than a lever arm 14 and may be movable other than towards the container 32, for example away from the container and by the thumb of the user, and the valve means may be other than a duck bill one way valve. The sleeve may be of a suitable elastic material such as a thermoplastic elastomer, for example polyurethane, or of silicone or of

natural rubber, while the body member 2 and horn 4 may be of a suitable thermoplastic material such as polypropylene or polycarbonate. The container 32 is conveniently of a translucent or transparent plastic material. Actuating
5 means may be electric or mechanical, hand-held or attached such as battery powered or a separate remote mains powered unit.

Referring to Fig. 4 there is shown an alternative embodiment of the invention the operation of which is
10 substantially the same as that of the embodiment of Figs 1 to 3 and which will therefore not be described in detail again.

Instead of the concertina sleeve 12 there is provided a sleeve 12' a free end of which is mounted to the body 2'
15 and the other closed end of which extends transversely of the body 2' to seal the interior of the body 2' from the atmosphere.

The sleeve 12' is of a substantially non-stretch material, comprising a non-stretching flexible material or
20 a layer of elastic material, for example silicone or a thermoplastic elastomer such as polyurethane, to which is bonded, inlaid or insert moulded a substantially non-stretch layer such as a fabric mesh.

One end of a lever 14' is secured centrally to the
25 closed end of the sleeve 12' externally of the body 2', the

other end of the lever 14' comprising an element 40 adapted to receive the thumb of a user, which element 40 may be ring-shaped as shown or of other suitable configuration.

Displacement of the sleeve 12' from the rest condition shown in Fig. 4 to a displaced condition to create the
5 required volume of reduced pressure within the body 2' is achieved by engaging the thumb of the user in the portion 40 and moving the thumb away from the pump in the direction of arrow T. This arrangement obviates the cost and energy
10 loss associated with a hinged lever mechanism.

The non-stretch nature of the material of the sleeve 12' ensures an energy-efficient arrangement.

Although the embodiment of Figs. 1 to 3, which includes a concertina-shaped sleeve, shows a lever arm as
15 the actuating means, it will be appreciated that other actuating means, such as a thumb-receiving element similar to that shown in Fig. 4, could be used.

Similarly, although the embodiment of Fig. 4, which includes a 'roll diaphragm' type sleeve, shows a thumb-
20 receiving element as the actuating means, it will be appreciated that other actuating means, such as a lever arm similar to that shown in Figs. 1 to 3, could be used.

Thus there are provided breast pumps, which may be operated manually or electrically, which are substantially
25 more energy efficient than heretofore, this efficiency

being achieved either by the configuration or the material of the sleeve, or by both - i.e. the material of the sleeve 12 may be non-stretch - and which can be manufactured more economically and with less precision than heretofore.

5 Reference will now be made to the generally conical breast engaging portion of the pump hereinafter referred to as the horn.

Conventionally, the horn of a breast pump is shaped to engage a region of the mother's breast whereby a sealed 10 chamber is created in the pump and whereby a vacuum can be created in the chamber to express milk from the breast.

Heretofore horns have commonly been moulded from relatively rigid materials such as polycarbonate, which results in certain disadvantages not the least of which are 15 potential discomfort to the user, the possibility of non-sealing engagement with the breast, and the inability of the user to manually stimulate her breast in accordance with the Marmet technique to supplement the suction effect of the pump.

20 In order to improve the comfort of the user, it has been proposed to provide relatively soft inserts typically hooking over the outer edge of the horn or being pressed into the interior of the horn.

However, it will be appreciated that such inserts, 25 being separate from the horn, require assembly into and

disassembly from the horn, have to be removed from the horn for cleaning purposes, and don't allow manual stimulation of her breast by the user.

It has also been proposed to configure certain of the
5 inserts in an attempt to create an arrangement which, when subjected to the suction effect of the associated pump, serves to further stimulate the breast whereby expressing of milk is improved.

Such inserts include a series of resilient,
10 circumferentially spaced petals surrounding the nipple and arranged to apply a peristaltic pressure thereto by being moved in and out in accordance with the negative pressure created by the pump.

However, such an arrangement suffers from the
15 disadvantage that the movement of the petals is out of synchronism with the pressure within the pump, when milk is being expressed, the petals are drawn away from the breast, and, with positive pressure within the pump, when milk is not being expressed but is being fed to a container, the
20 petals are moved towards, to engage and stimulate, the breast.

Furthermore, such an insert does not enable manual stimulation of the breast.

It would be desirable to be able to provide a breast
25 pump having a horn which was comfortable to the user and

which enabled manual stimulation of the breast by the user whilst still supporting the breast.

Accordingly there is provided a breast pump having a horn shaped to engage a region of a user's breast, the horn
5 being of a relatively rigid material such as polypropylene or polycarbonate and having bonded thereto at least one region of relatively soft, elastic material such as a thermoplastic elastomer, the relatively soft material of the or each region infilling an associated aperture through
10 the relatively rigid material to comprise the thickness of the horn at said region.

Thus it will be appreciated that the soft material is an integral part of the horn, being bonded to the rigid material, and provides one or more regions of elasticity to
15 the horn whereby the user can manipulate said region(s) which in turn stimulates the underlying area(s) of the breast, conveniently the nipple or an adjacent area, the rigid material providing the necessary support to the breast.

20 There may be two opposed regions of relatively soft, elastic material remote from the open end of the horn, one for location above the breast and one for location below the breast adjacent the nipple for manipulation by the thumb and a finger of the user.

Conveniently the whole of the internal area of the rigid material is lined with said soft material, while the outer peripheral edge of the horn may comprise a lip of said soft material encasing the periphery of the rigid material.

Preferably the horn comprises a two-shot moulding with the relatively soft, elastic material permanently bonded to the relatively rigid material by virtue of the inherent characteristics of the materials.

By way of example only, a pump incorporating the preferred horn will now be described in greater detail with reference to the accompanying drawings of which:

Figs 5 and 6 show pumps with two alternative horns;

Figs 7 and 8 show the horn of Figs 5 and 6 positioned on a breast, and

Fig. 9 is an isometric view of part of the pump of Fig. 6.

Referring to Fig. 5 there is shown a horn indicated generally at 4 which comprises a rigid shell 50 typically of polypropylene or polycarbonate in the lower regions of which, adjacent the tubular portion 6, is formed an aperture.

The rigid shell 50 is lined with a layer 52 of a soft flexible elastic material such as a thermoplastic elastomer which is bonded to the shell 50 and which infills, at 54,

the aperture in the shell 50 to comprise the full thickness of the horn at that region. The layer 52 includes a peripheral lip 56 which surrounds the outer peripheral edge of the shell 50.

5 Integrally formed on the inner surface of the soft layer 52 in the region of the infill 54 and in the region above this infill may be a plurality of dimples 58 or similar small embossed areas.

 The described horn is manufactured by a two-shot
10 moulding process, the first shot forming the rigid shell 50 and the second shot moulding on the soft layer 52 whereby the two layers are permanently bonded together.

 In use of the described horn, and referring in particular to Fig. 7, the soft layer 54 together with the
15 lip 56, ensures a comfortable fit on the breast, while the presence of the soft infill at 54 enables the mother to manipulate her breast using her thumb 60 together with her finger 62. The strategically positioned dimples further assist in this stimulation.

20 Figs 6 to 8 shows a preferred horn in which there are two opposed apertures in the rigid shell 50, the second aperture being immediately above the first, this second aperture also being infilled at 64 with the soft material to provide opposed regions of soft material which can be

manipulated by the user's thumb 60 and finger 62 to stimulate lactation.

It will be appreciated that providing a one-piece horn eliminates the requirement for assembly and disassembly, facilitates cleaning and is safer to use. The presence of the rigid shell 50 supports the breast of the user, while the presence of the infill(s) 54,64 enables manual stimulation of the breast to supplement the effect of the associated pump. The overall lining of the shell 50 with soft material, together with the provision of the lip 56 of said soft material, ensures a comfortable fit of the horn on the user.

Clearly the precise locations and numbers of the infills of soft material can be varied to suit particular requirements, as can the materials of the shell 50 and the layer 52 and the surface configurations thereon.

CLAIMS

1. A breast pump comprising a body member including
a breast engaging portion shaped to engage a region of a
5 user's breast, a container attached to the body member, and
valve means between the body member and the container,
characterised by, within the body member, a sleeve sealing
the interior of the body member from the atmosphere, the
sleeve being selectively movable from a rest condition to a
10 displaced condition by actuating means operatively
connected to the sleeve, movement of the sleeve from the
rest condition to the displaced condition creating an
increasing volume of reduced pressure within the body
member whereby firstly the valve means is closed to prevent
15 evacuation of the container, and whereby milk is expressed
by the user into the body member, and return movement of
the sleeve from the displaced condition to the extended
condition releasing the reduced pressure allowing the valve
to open the expressed milk flowing through the valve means
20 and into the container, the configuration of the sleeve or
the material of the sleeve being such as to substantially
prevent stretching of the sleeve on movement between the
rest and displaced conditions.

2. A breast pump as claimed in claim 1 in which the
25 sleeve is of generally concertina shape, and is selectively

movable between an extended rest condition and a compacted displaced condition.

3. A breast pump as claimed in claim 2 in which the concertina shape has a closed base thereto at least part of
5 which is substantially rigid, movement of the sleeve being by pulling the base from inside the sleeve so as to contract its length.

4. A breast pump as claimed in any one of claims 1 to 3 in which the concertina sleeve is of an elastic
10 material the inherent properties of which are such that, on release of the actuating means by the user, the sleeve returns to its extended condition within the body member.

5. A breast pump as claimed in claim 1 in which the sleeve comprises a substantially non-stretch material.

15 6. A breast pump as claimed in claim 5 in which the sleeve includes a flexible layer to which is bonded or which is inlaid with a substantially non-stretch layer.

7. A breast pump as claimed in any one of claims 1 to 6 in which the actuating means comprises a lever arm
20 pivotally mounted at an intermediate region thereof to the body member, one end extent of the lever arm being for engagement by the user, and the other end extent being operatively connected to the sleeve.

8. A breast pump as claimed in any one of claims 1
25 to 7 in which one end of the sleeve is secured between a

collar and a defining wall of the body member whereby the interior of the sleeve is sealed from the interior of the body member, the other end of the sleeve being closed.

9. A breast pump as claimed in claim 8 in which the
5 other, closed end of the sleeve carries an end plate, a link pin extending axially within the sleeve and through the collar to interconnect the end plate and the other end extent of the lever arm whereby, on pivoting movement of the lever arm by the user, the link pin is moved
10 substantially axially of the sleeve to compact the sleeve.

10. A breast pump as claimed in claim 9 in which the end plate, link pin, sleeve and lever arm comprise an integral unit.

11. A breast pump as claimed in claim 10 and
15 incorporating flexible joints at one or both ends of the link pin.

12. A breast pump as claimed in any one of claims 1 to 6 in which the actuating means comprises an operating member one end of which is secured to a closed end of the
20 sleeve and the other end of which carries a thumb-receiving element for receiving the thumb of a user.

13. A breast pump as claimed in claim 12 in which a handle member is provided as a rest and grip for the fingers of the actuating hand, said handle being rigidly
25 secured to the pump body, the arrangement being such that,

on location of the thumb in the thumb-receiving element,
and on pulling of the thumb towards the fingers, the base
of the sleeve is pulled in the direction generally away
from the breast.

5 14. A breast pump as claimed in any one of claims 1
to 13 in which the valve means between the body member and
the container comprise a duck bill type one way valve.

 15. A horn for a breast pump, the horn being shaped
to engage a region of a user's breast, and being of a rigid
10 material and having bonded thereto at least one region of
soft, elastic material the soft material of the or each
region infilling an associated aperture through the rigid
material to comprise the thickness of the horn at said
region.

15 16. A horn as claimed in claim 15 in which the rigid
material is polypropylene or polycarbonate, and the soft
elastic material is a thermoplastic elastomer.

 17. A horn as claimed in claim 15 or claim 16 in
which there are two opposed regions of soft, elastic
20 material remote from the open end of the horn, one for
location above the breast and one for location below the
breast adjacent the nipple for manipulation by the thumb
and a finger of the user.

18. A horn as claimed in any one of claims 15 to 17 in which the whole of the internal area of the rigid material is lined with said soft material.

19. A horn as claimed in claim 18 in which the outer
5 peripheral edge of the horn comprises a lip of said soft material encasing the periphery of the rigid material.

20. A horn as claimed in any one of claims 15 to 19 and comprising a two-shot moulding with the soft, elastic material permanently bonded to the rigid material by virtue
10 of the inherent characteristics of the materials.

Fig. 1

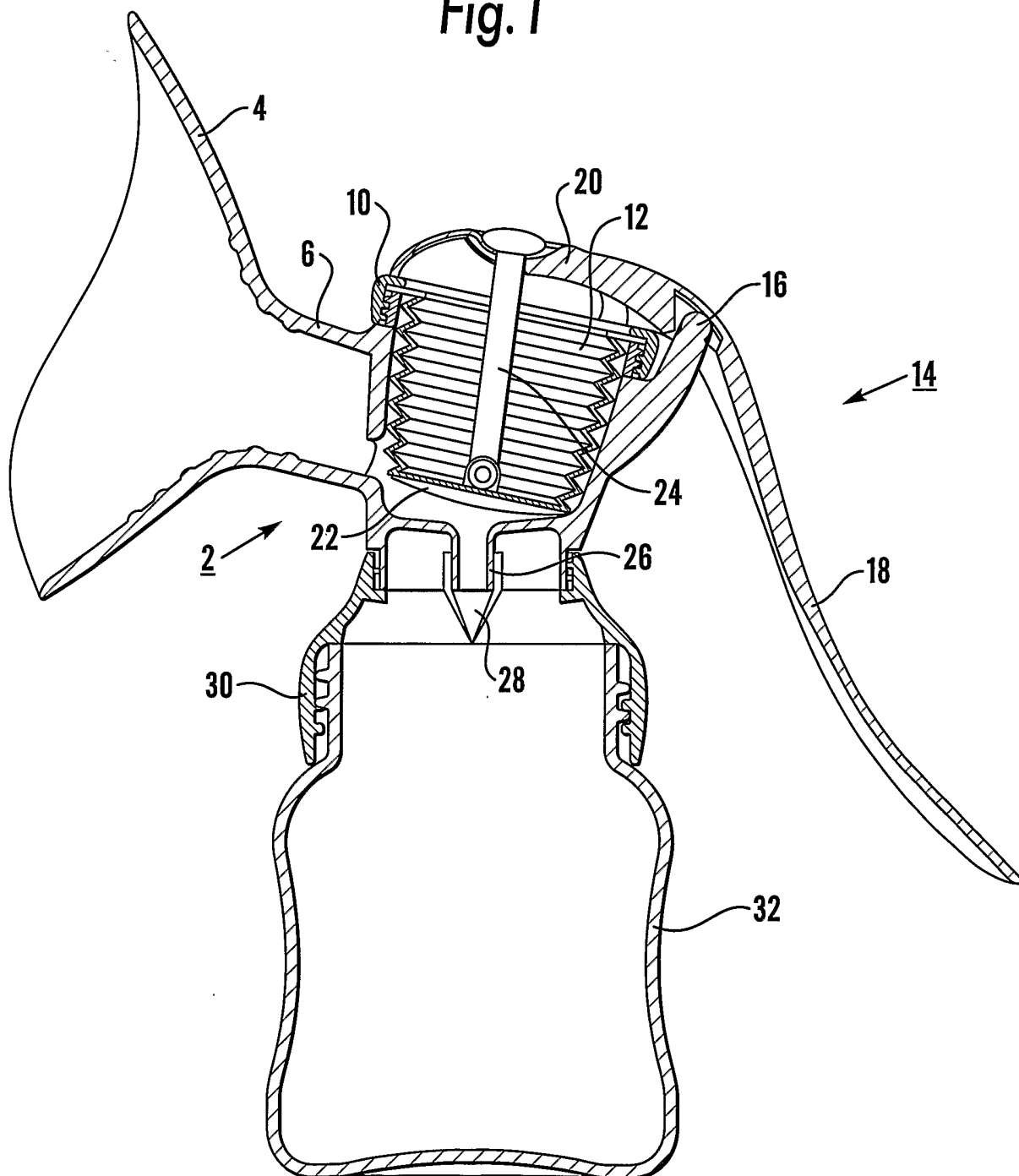

Fig.2

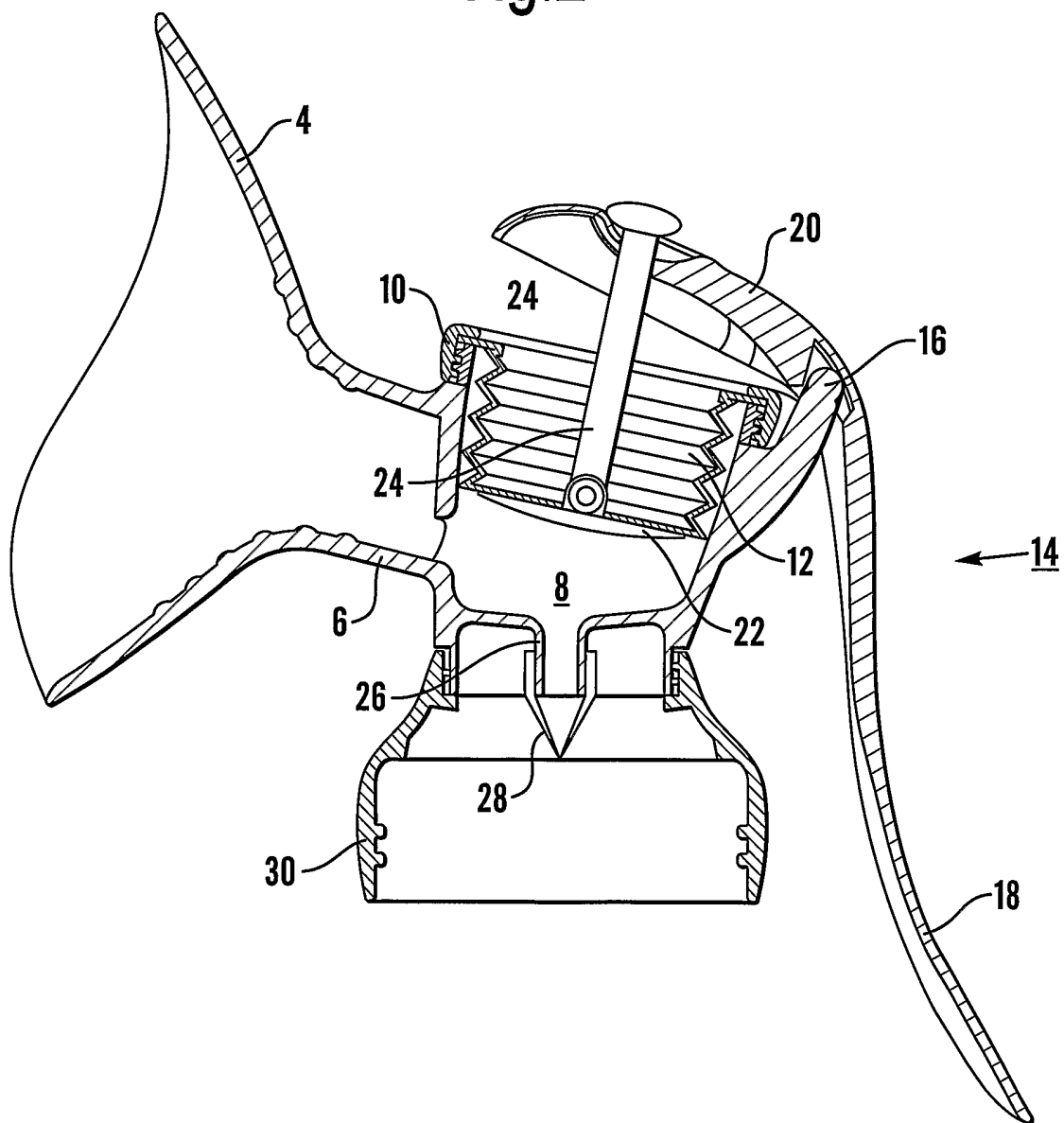

Fig.3

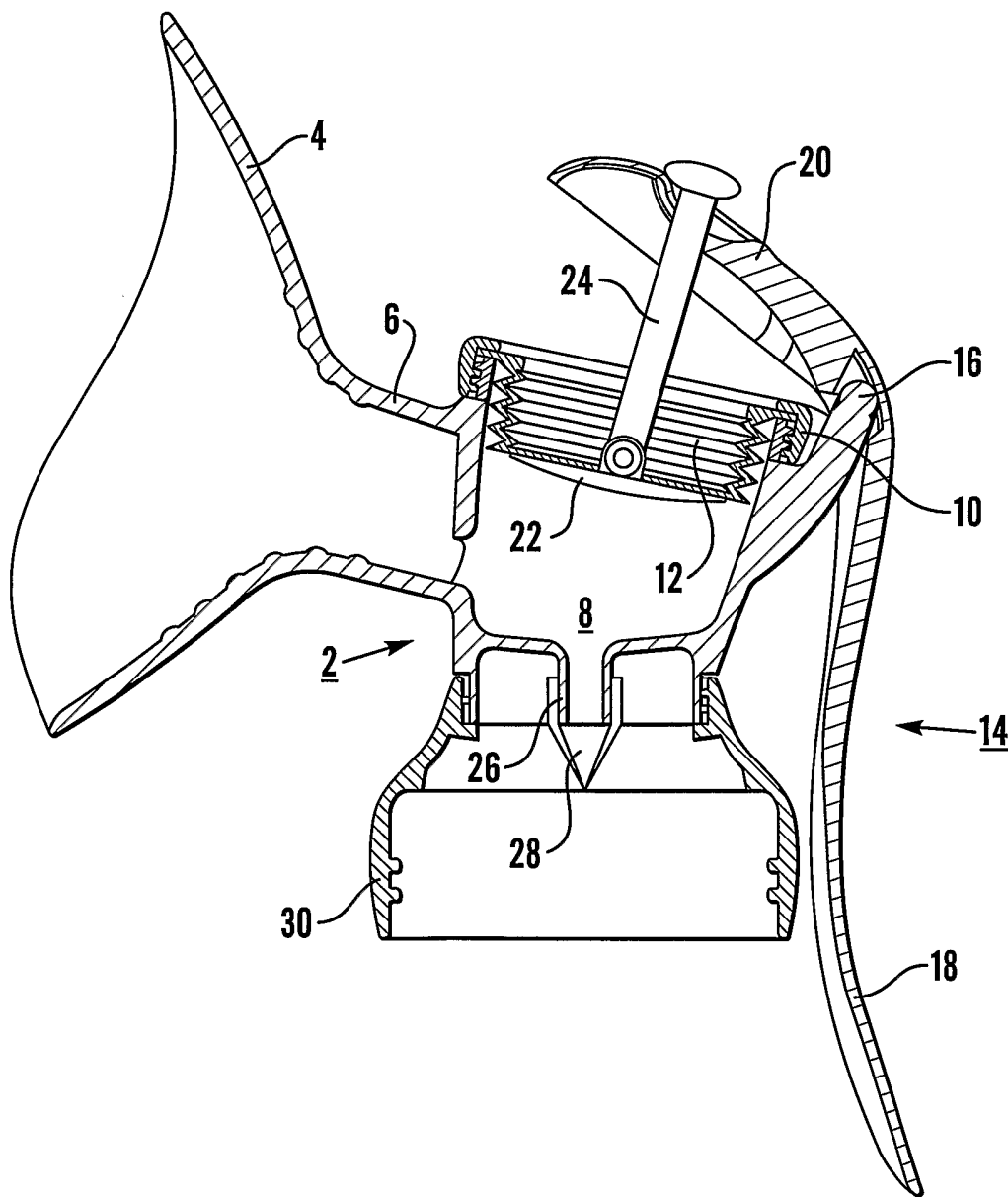
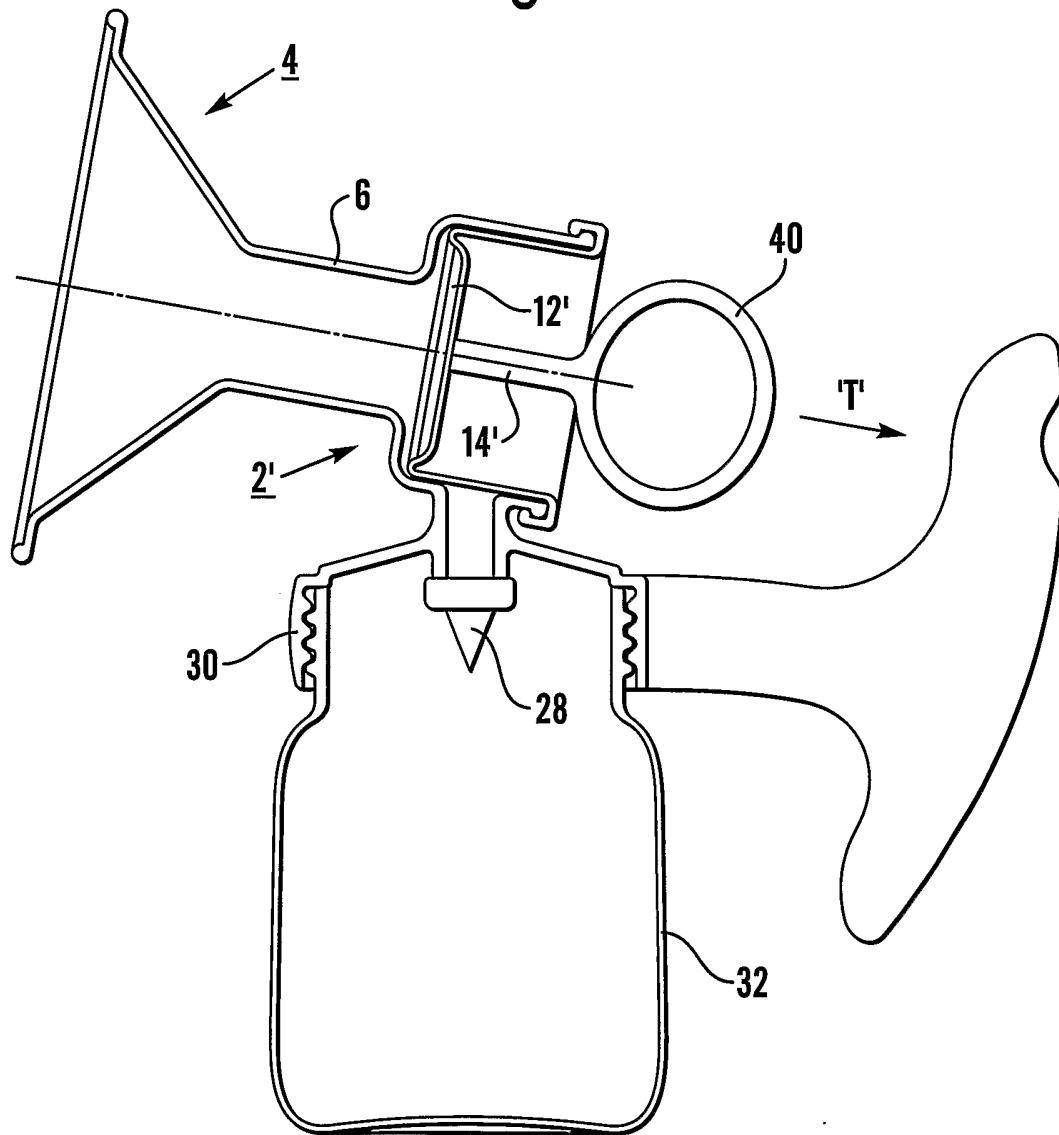
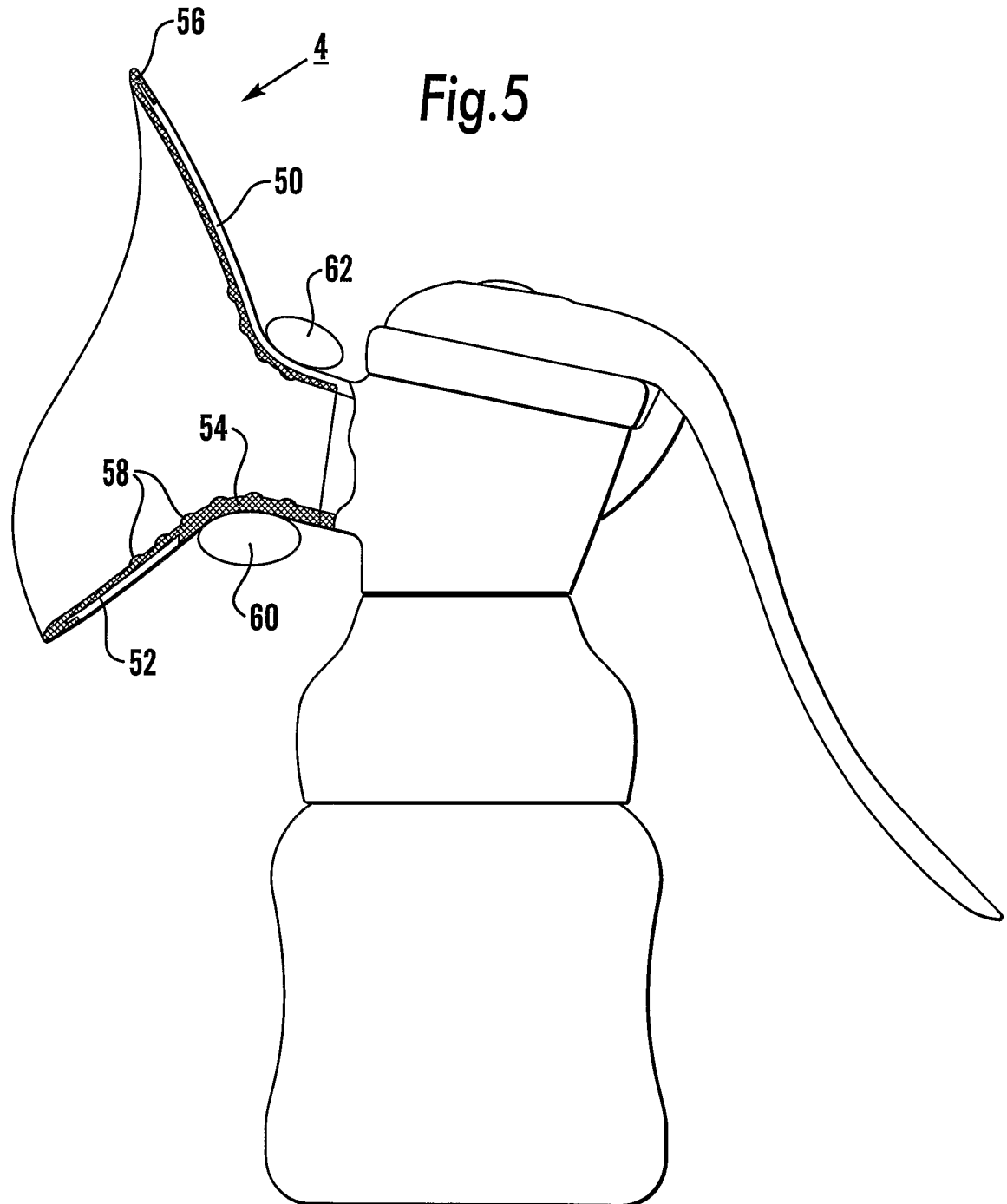
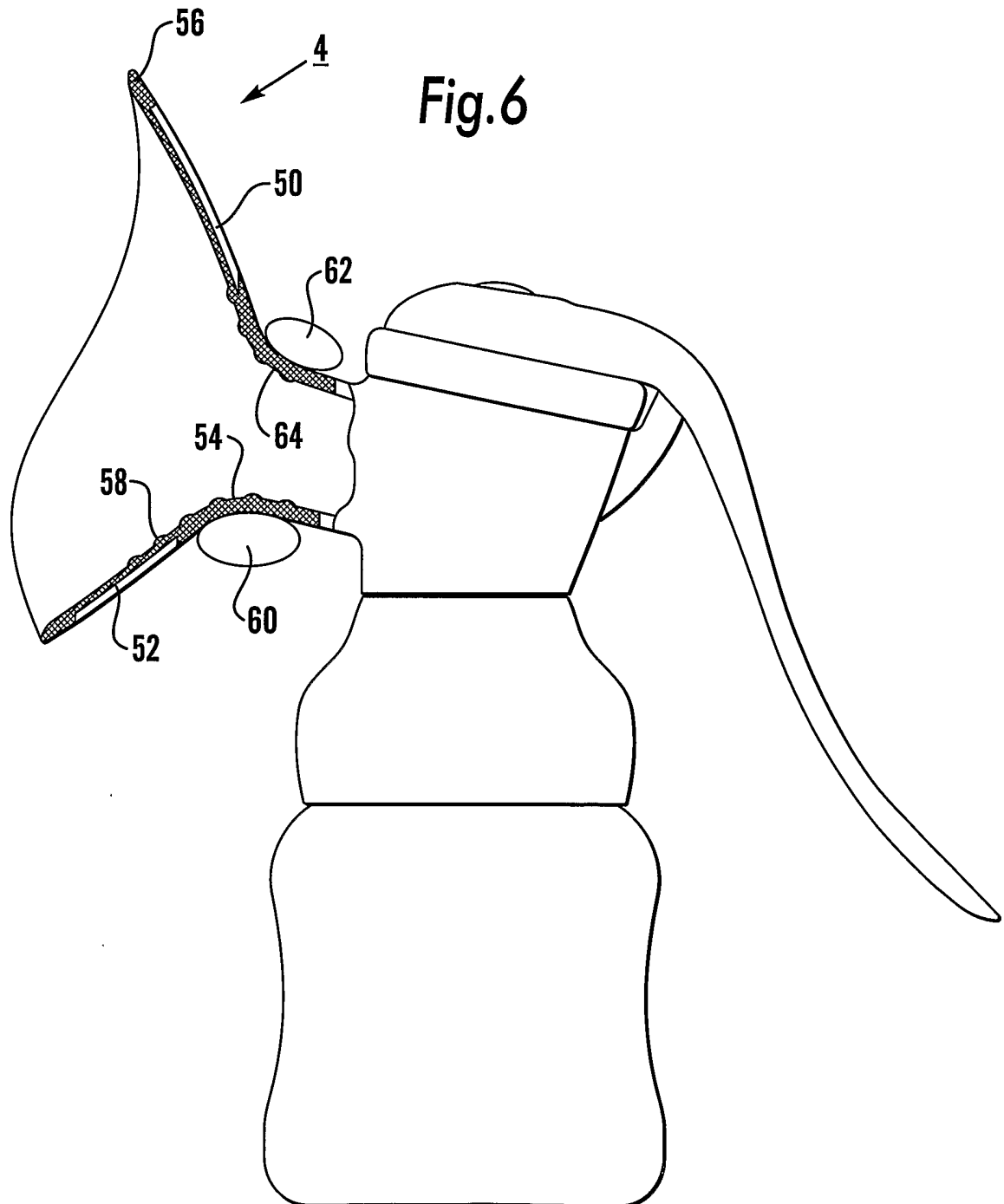

Fig.4







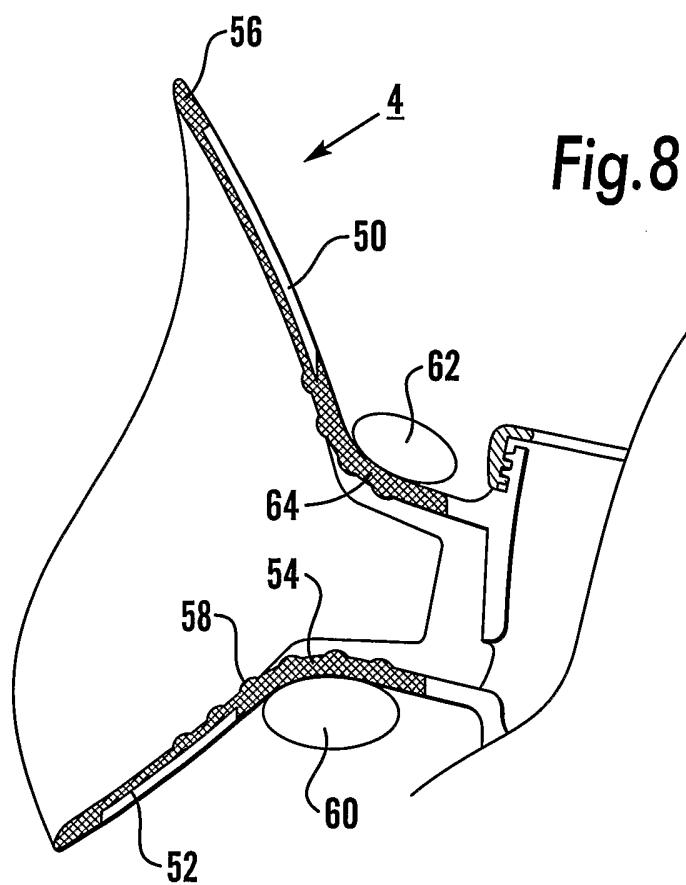
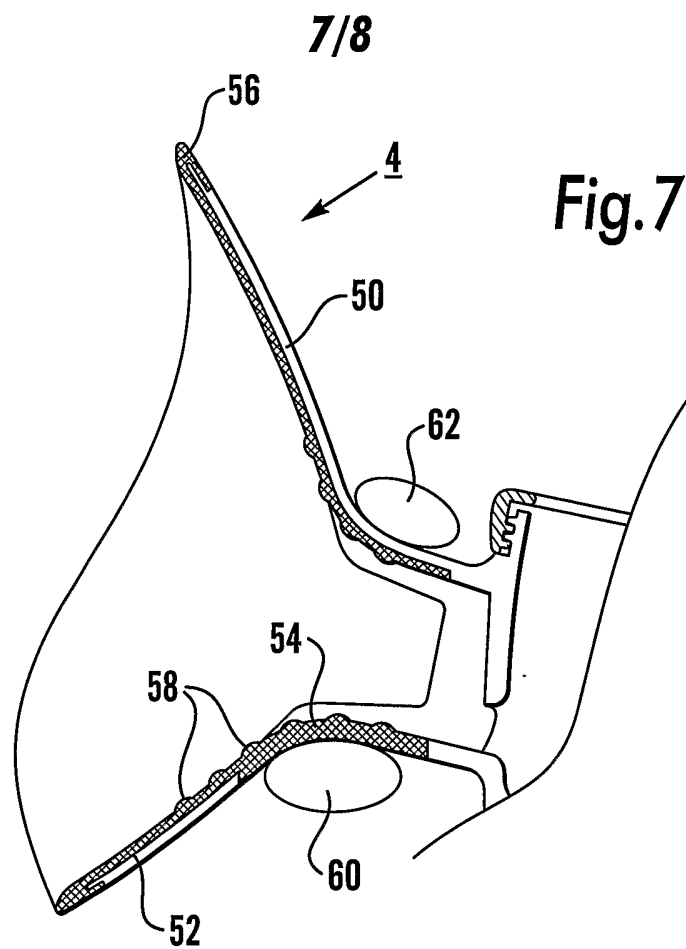
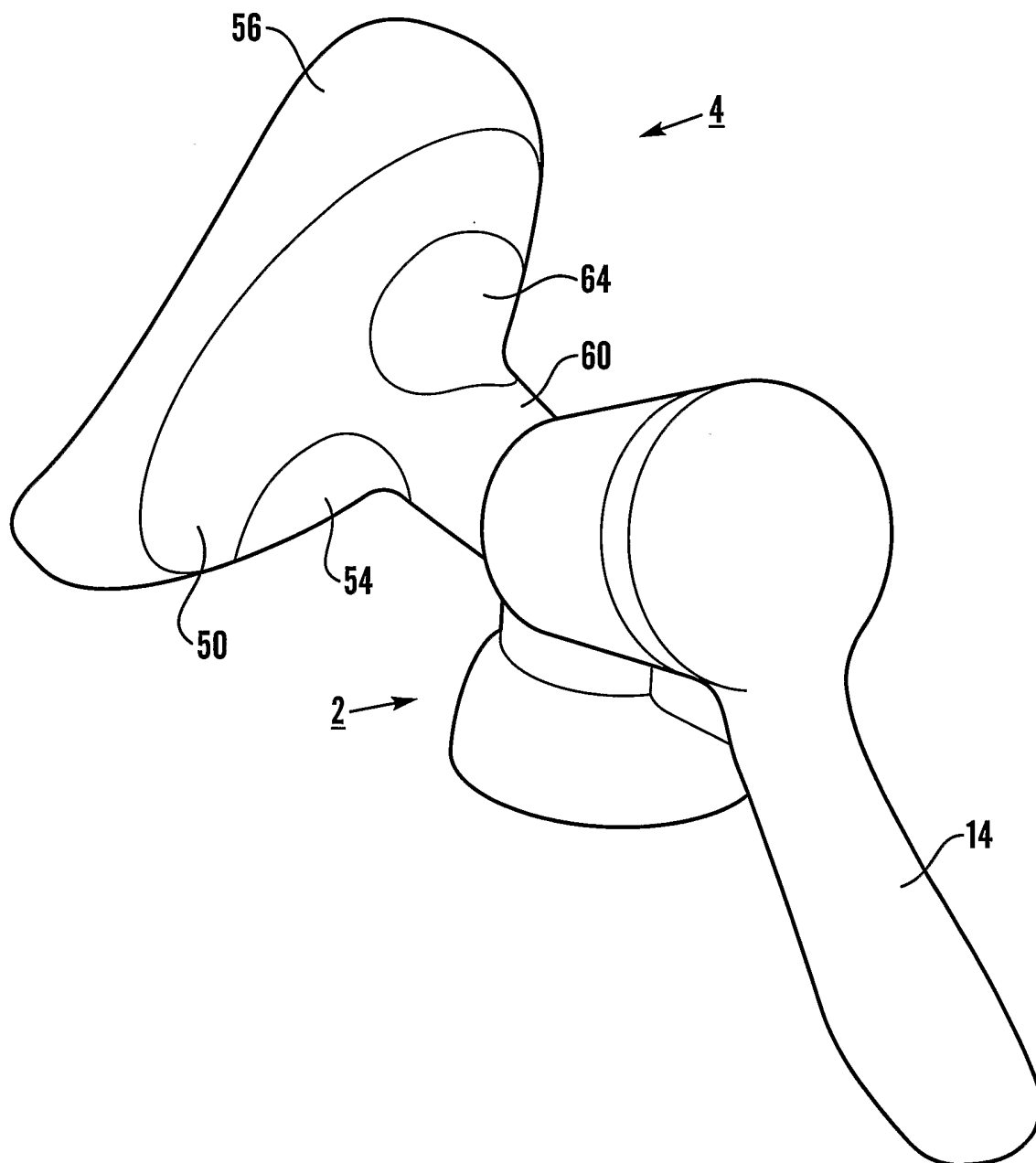

Fig.9



INTERNATIONAL SEARCH REPORT

PCT/GB 03/02633

A. CLASSIFICATION OF SUBJECT MATTER
IPC 7 A61M1/06

According to International Patent Classification (IPC) or to both national classification and IPC

B. FIELDS SEARCHED

Minimum documentation searched (classification system followed by classification symbols)

IPC 7 A61M

Documentation searched other than minimum documentation to the extent that such documents are included in the fields searched

Electronic data base consulted during the international search (name of data base and, where practical, search terms used)

EPO-Internal, WPI Data, PAJ

C. DOCUMENTS CONSIDERED TO BE RELEVANT

Category °	Citation of document, with indication, where appropriate, of the relevant passages	Relevant to claim No.
X	EP 0 385 933 A (AMEDA AG) 5 September 1990 (1990-09-05) claim 10; figure 3 ---	1,2,4,5, 14
X	US 4 794 915 A (LARSSON KARL O O A H) 3 January 1989 (1989-01-03) column 3, line 53 -column 4, line 18; figure 1 ---	15-19
Y	DE 37 09 560 A (CELIK NEJDET) 13 October 1988 (1988-10-13) column 3, line 28 - line 32; figure 1 ---	1,2,4,5, 14
Y	US 5 415 632 A (SAMSON ILAN) 16 May 1995 (1995-05-16) the whole document ---	1,2,4,5, 14
A	---	12,13
	-/--	

 Further documents are listed in the continuation of box C. Patent family members are listed in annex.

° Special categories of cited documents:

- *A* document defining the general state of the art which is not considered to be of particular relevance
- *E* earlier document but published on or after the international filing date
- *L* document which may throw doubts on priority claim(s) or which is cited to establish the publication date of another citation or other special reason (as specified)
- *O* document referring to an oral disclosure, use, exhibition or other means
- *P* document published prior to the international filing date but later than the priority date claimed

- *T* later document published after the international filing date or priority date and not in conflict with the application but cited to understand the principle or theory underlying the invention
- *X* document of particular relevance; the claimed invention cannot be considered novel or cannot be considered to involve an inventive step when the document is taken alone
- *Y* document of particular relevance; the claimed invention cannot be considered to involve an inventive step when the document is combined with one or more other such documents, such combination being obvious to a person skilled in the art.
- * & * document member of the same patent family

Date of the actual completion of the international search

29 October 2003

Date of mailing of the international search report

07.11.2003

Name and mailing address of the ISA

European Patent Office, P.B. 5818 Patentlaan 2
 NL - 2280 HV Rijswijk
 Tel. (+31-70) 340-2040, Tx. 31 651 epo nl,
 Fax: (+31-70) 340-3016

Authorized officer

Lakkis, A

INTERNATIONAL SEARCH REPORT

Internat. Application No
PCT/GB 03/02633

C.(Continuation) DOCUMENTS CONSIDERED TO BE RELEVANT		
Category °	Citation of document, with indication, where appropriate, of the relevant passages	Relevant to claim No.
A	US 2001/016708 A1 (KONG CARL CHEUNG TUNG ET AL) 23 August 2001 (2001-08-23) paragraphs '0033!', '0036!; figures 1,2 paragraph '0039!; figure 4 ----	1-5,15
A	EP 0 733 376 A (CANNON RUBBER LTD) 25 September 1996 (1996-09-25) abstract; figure 8 ----	1,7
A	EP 1 034 807 A (AMEDA AG) 13 September 2000 (2000-09-13) paragraphs '0024!', '0031!', '0033!', '0035! paragraphs '0025!', '0045! ----	1,15,16, 18,19
A	US 4 680 028 A (STUART HERBERT H) 14 July 1987 (1987-07-14) column 4, line 12 - line 17; figures ----	15,17
A	US 6 383 164 B1 (MCCORMICK PATRICK A ET AL) 7 May 2002 (2002-05-07) column 3, line 7 - line 22; figure 2 column 3, line 39 - line 40 -----	15-20

INTERNATIONAL SEARCH REPORT

International application No.
PCT/GB 03/02633

Box I Observations where certain claims were found unsearchable (Continuation of item 1 of first sheet)

This International Search Report has not been established in respect of certain claims under Article 17(2)(a) for the following reasons:

1. Claims Nos.:
because they relate to subject matter not required to be searched by this Authority, namely:

2. Claims Nos.:
because they relate to parts of the International Application that do not comply with the prescribed requirements to such an extent that no meaningful International Search can be carried out, specifically:

3. Claims Nos.:
because they are dependent claims and are not drafted in accordance with the second and third sentences of Rule 6.4(a).

Box II Observations where unity of invention is lacking (Continuation of item 2 of first sheet)

This International Searching Authority found multiple inventions in this international application, as follows:

see additional sheet

1. As all required additional search fees were timely paid by the applicant, this International Search Report covers all searchable claims.
2. As all searchable claims could be searched without effort justifying an additional fee, this Authority did not invite payment of any additional fee.
3. As only some of the required additional search fees were timely paid by the applicant, this International Search Report covers only those claims for which fees were paid, specifically claims Nos.:

4. No required additional search fees were timely paid by the applicant. Consequently, this International Search Report is restricted to the invention first mentioned in the claims; it is covered by claims Nos.:

Remark on Protest

- The additional search fees were accompanied by the applicant's protest.
- No protest accompanied the payment of additional search fees.

FURTHER INFORMATION CONTINUED FROM PCT/ISA/ 210

This International Searching Authority found multiple (groups of) inventions in this international application, as follows:

1. Claims: 1-14

A breast pump comprising a sleeve sealing

2. Claims: 15-20

A horn for a breast pump having bonded thereto soft, elastic material

INTERNATIONAL SEARCH REPORT

Information on patent family members

International Application No

PCT/GB 03/02633

Patent document cited in search report		Publication date	Patent family member(s)	Publication date
EP 0385933	A	05-09-1990	CH 676795 A5	15-03-1991
			AT 83159 T	15-12-1992
			CA 2010891 A1	01-09-1990
			DE 69000542 D1	21-01-1993
			DE 69000542 T2	15-04-1993
			EP 0385933 A2	05-09-1990
			ES 2036108 T3	01-05-1993
			NO 900952 A ,B,	03-09-1990
			US 5009638 A	23-04-1991
US 4794915	A	03-01-1989	CH 666614 A5	15-08-1988
			CA 1266411 A1	06-03-1990
			EP 0187328 A1	16-07-1986
DE 3709560	A	13-10-1988	DE 3709560 A1	13-10-1988
			WO 8807385 A1	06-10-1988
			PT 87046 A ,B	30-03-1989
US 5415632	A	16-05-1995	AT 222783 T	15-09-2002
			AU 677893 B2	08-05-1997
			AU 1526195 A	01-08-1995
			DE 69527940 D1	02-10-2002
			DE 69527940 T2	27-03-2003
			EP 0739220 A1	30-10-1996
			ES 2181764 T3	01-03-2003
			WO 9518639 A1	13-07-1995
US 2001016708	A1	23-08-2001	US 6210360 B1	03-04-2001
			WO 02081004 A1	17-10-2002
EP 0733376	A	25-09-1996	GB 2299027 A	25-09-1996
			AT 242648 T	15-06-2003
			DE 69628608 D1	17-07-2003
			DK 733376 T3	06-10-2003
			EP 0733376 A2	25-09-1996
			US 5749850 A	12-05-1998
EP 1034807	A	13-09-2000	EP 1034807 A1	13-09-2000
			AU 3328799 A	20-09-1999
			US 6461324 B1	08-10-2002
			WO 9944650 A1	10-09-1999
US 4680028	A	14-07-1987	NONE	
US 6383164	B1	07-05-2002	AU 1590702 A	08-04-2002
			BR 0114146 A	22-07-2003
			CA 2421809 A1	04-04-2002
			WO 0226290 A2	04-04-2002
			EP 1324786 A2	09-07-2003