

N. C. LOWE.
DEVICE FOR FILLING GRAVES.
APPLICATION FILED NOV. 9, 1915.

1,206,558.

Patented Nov. 28, 1916.
2 SHEETS—SHEET 1.

Fig. 1.

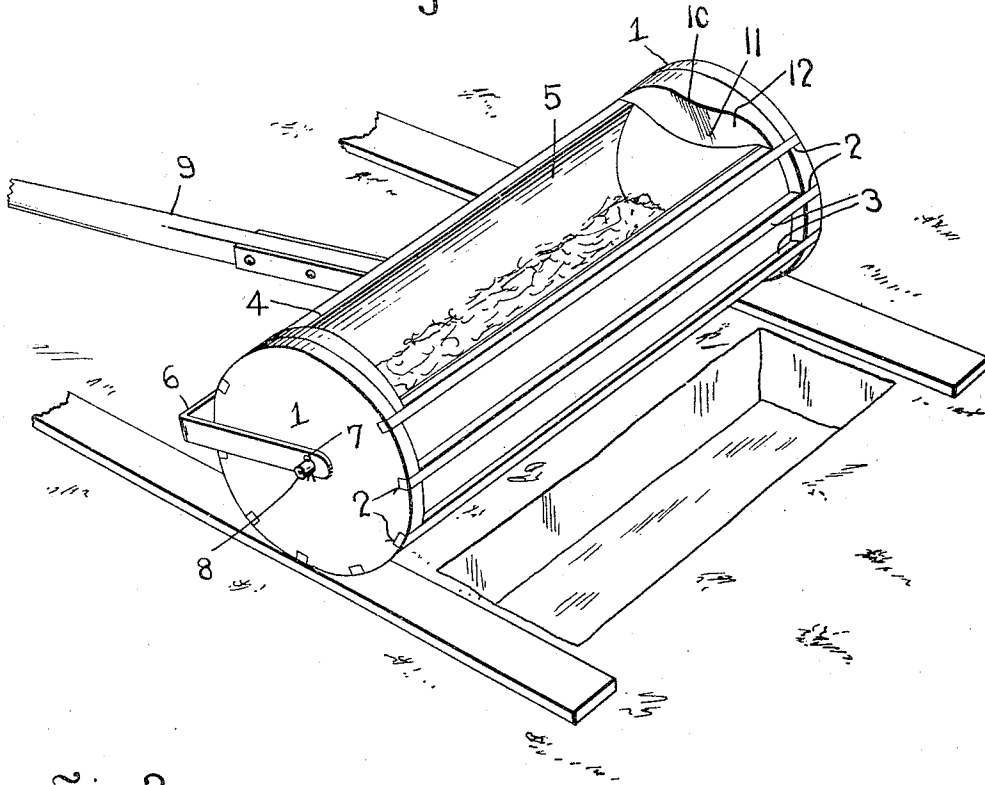
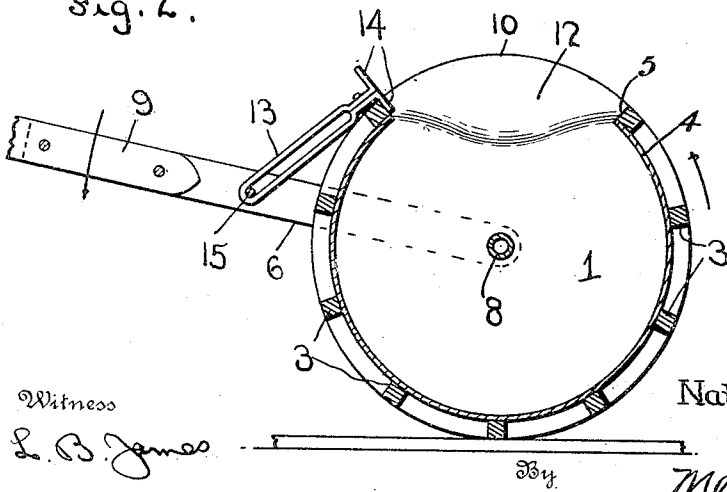

Fig. 2.



Witness

L. B. James

Inventor

Nathan C. Lowe

Mansell J. Mill

Attorney

N. C. LOWE.
 DEVICE FOR FILLING GRAVES.
 APPLICATION FILED NOV. 9, 1915.

1,206,558.

Patented Nov. 28, 1916.

2 SHEETS—SHEET 2.

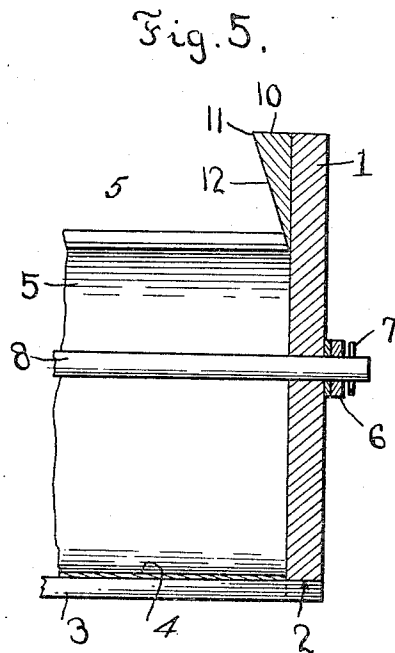
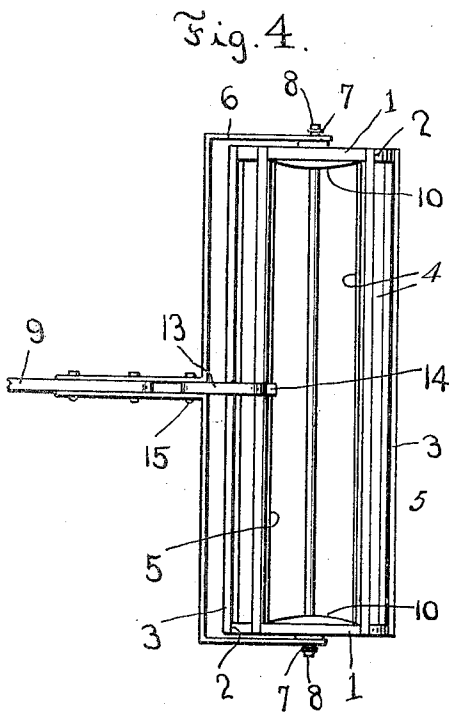
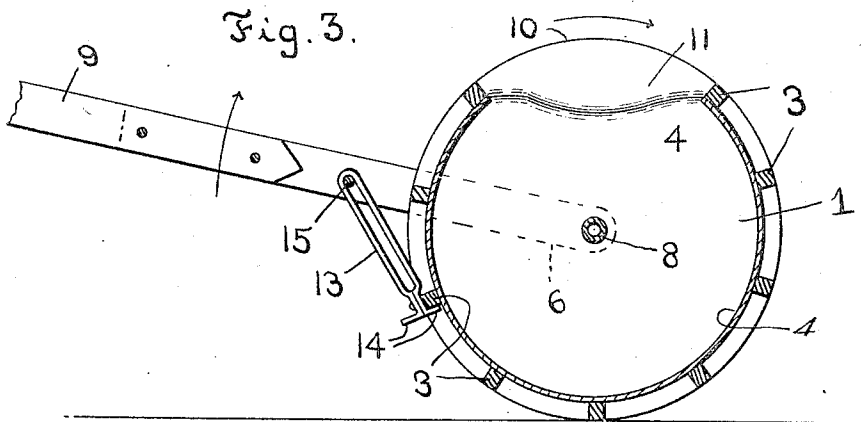

Inventor

Nathan C. Lowe

By *Mansell D. Mills*

Attorney

Witness
L. B. James

UNITED STATES PATENT OFFICE.

NATHAN C. LOWE, OF LEBANON, OREGON.

DEVICE FOR FILLING GRAVES.

1,206,558.

Specification of Letters Patent. Patented Nov. 28, 1916.

Application filed November 9, 1915. Serial No. 60,518.

To all whom it may concern:

Be it known that I, NATHAN C. LOWE, a citizen of the United States, residing at Lebanon, in the county of Linn and State of Oregon, have invented certain new and useful Improvements in Devices for Filling Graves, of which the following is a specification.

This invention relates to new and useful improvements in devices for filling graves, and has for its primary object to provide a device whereby a grave may be entirely filled when the device has been emptied.

A further object of the invention is to provide a receptacle or container for the dirt during the time which the grave remains open, thus doing away with the unsightliness of a pile of dirt and at the same time obviating the many disadvantages which said pile of dirt has.

Referring to the drawings; Figure 1 is a perspective view of the device; Fig. 2 is a transverse sectional view thereof; Fig. 3 is an end elevation; Fig. 4 is a top plan view; and Fig. 5 is a detail sectional view.

Referring more particularly to the drawings, the device consists of end plates 1—1 which are preferably circular in form and are provided on their periphery with a plurality of equidistantly spaced notches 2. The end plates 1—1 are connected by means of bars 3, the ends of which lie in the notches 2 and are secured to the end plates 1—1 in any desired manner. Connecting the longitudinally extending bars 3 and arranged interiorly thereof is a lining 4 which as shown in Fig. 1 has a cutout portion 5 which lies between two of the adjacent bars 3. This lining when secured to the longitudinally extending bars 3 forms a dirt receptacle.

Passing around the end plates 1—1 is a yoke which comprises two members 6, the forward ends of each of which are perforated as at 7 to receive the projecting end 8 of the spindle or the like carried by each end of the plates 1—1. The opposite end of each of the yoke members 6 is secured to an operating handle 9 by which the device is moved along the ground. Each of the end plates 1—1 is provided on its inner face with a block 10, the forward wall 11 of which is angular as shown at 12 in Fig. 5 for a purpose to be hereinafter described.

Pivoted to the handle 9 is a T-shaped

member 13 having oppositely disposed hook members 14—14 which are adapted to engage the longitudinally extending bars 3 to prevent the rotation of the hollow cylindrical member. 60

In operation, when it is desired to dig a grave the device is positioned directly over the place where the grave is to be dug, the pivoted latch being swung upon its pivot 15 to release the longitudinally extending bars 3 which it engages. The whole device is then moved forwardly or rearwardly as the case may be until the opening 5 is uppermost. With the device in this position, the grave is dug and the dirt is thrown into the cylindrical member from the grave. When it is desired to fill the grave it is only necessary to release the pivoted latch 13 whereupon the device is moved forwardly until its opening 5 occupies a position directly over the grave opening whereupon the dirt contained therein is discharged into the grave opening and owing to the inclined faces 12 of the members 10, said dirt is deflected toward the center of the grave opening. 80

From the foregoing it will be seen that the present invention provides a device which is economical as to time consumed in operation of filling graves and also serves to hold the dirt out of contact with the lawn around the grave opening. 85

What is claimed is:

A device for filling graves comprising a cylindrical member including a pair of spaced circular end members, longitudinally extending spaced bars connecting the circular end members, a lining secured to the inner face of said longitudinally extending bars and having its free ends secured to adjacent bars to provide a discharge opening, a handle, means carried by the handle and engaging one of the longitudinal bars to secure the cylindrical member against movement, and inclined deflecting plates secured to each of the circular members, and of a length equal to the width of the discharge opening. 90 95 100

In testimony whereof I affix my signature in presence of two witnesses.

NATHAN C. LOWE.

Witnesses:

ALFRED TODD,
Mrs. N. C. LOWE.