

(19)



(11)

EP 3 401 059 B1

(12)

EUROPEAN PATENT SPECIFICATION

(45) Date of publication and mention of the grant of the patent:
27.11.2019 Bulletin 2019/48

(51) Int Cl.:
B25C 5/00 (2006.01) B25C 5/08 (2006.01)

(21) Application number: **18181162.1**

(22) Date of filing: **21.07.2014**

(54) **STAPLE TOOL**

KLAMMERWERKZEUG

OUTIL D'AGRAFE

(84) Designated Contracting States:
AL AT BE BG CH CY CZ DE DK EE ES FI FR GB GR HR HU IE IS IT LI LT LU LV MC MK MT NL NO PL PT RO RS SE SI SK SM TR

(30) Priority: **30.08.2013 US 201314014733**
30.08.2013 AU 2013222021

(43) Date of publication of application:
14.11.2018 Bulletin 2018/46

(62) Document number(s) of the earlier application(s) in accordance with Art. 76 EPC:
14748069.3 / 3 038 796

(73) Proprietor: **Illinois Tool Works, Inc.**
Glenview, Illinois 60025 (US)

(72) Inventor: **YOUNG, Graeme**
Glenview, IL Illinois 60025 (US)

(74) Representative: **HGF Limited**
3rd Floor Central Square South Orchard Street
Newcastle
Newcastle upon Tyne NE1 3AZ (GB)

(56) References cited:
EP-A2- 0 798 503 EP-A2- 1 364 750
DE-A1- 1 930 490 DE-A1- 10 109 962
DE-A1- 10 358 442 DE-A1-102011 013 292
DE-U1-202005 008 988 US-A- 3 855 688

EP 3 401 059 B1

Note: Within nine months of the publication of the mention of the grant of the European patent in the European Patent Bulletin, any person may give notice to the European Patent Office of opposition to that patent, in accordance with the Implementing Regulations. Notice of opposition shall not be deemed to have been filed until the opposition fee has been paid. (Art. 99(1) European Patent Convention).

Description

TECHNICAL FIELD

[0001] This disclosure relates tools for driving staples into a workpiece and in particular, staples of the type that comprise barbs that may provide increased retention in a workpiece. The disclosure also relates to methods of driving staples into a workpiece and to staple assemblies.

BACKGROUND

[0002] EP-A2-0 798 503, DE-A1-19 30 490 and DE-A1-103 58 442 pertain to the background of the invention.

[0003] Traditionally, staples have been used to attach items to workpieces (e.g. rural posts, wire livestock fences, power poles etc.). Often, such staples are hand driven into the workpiece using a manual tool.

[0004] Power tools for driving staples into a workpiece are also known in the art. These generally comprise a driver blade for driving the staple into the workpiece and a nosepiece comprising a passage to guide the staple as it is driven into the workpiece. These power tools can also comprise a magazine which is able to hold an arrangement of collated staples that may be fed into the firing chamber of the nosepiece.

[0005] Barbed staples, which comprise barbs extending from the legs of the staples, are also known in the art. The barbs on the staples can allow stronger retainment (i.e. when compared to traditional non-barbed staples) of the staple in a workpiece.

[0006] The barbs on such staples meant that they are not suitable for power tools known in the art that are configured for use with non-barbed staples. As such, only manual (i.e. hand driven) tools are presently used for such staples.

[0007] The above references to the background art do not constitute an admission that the art forms part of the common general knowledge of a person of ordinary skill in the art. The above references are also not intended to limit the application of the staple tool as disclosed herein.

SUMMARY

[0008] Disclosed is a tool for driving a barbed staple into a workpiece, the tool includes a housing enclosing a power delivery source and a driver blade driven by the power delivery source and comprising an engagement portion configured for engagement with the staple. The tool further includes a nosepiece comprising an aperture providing access for loading a staple into the nosepiece and a passage configured for slidable mounting of the driver blade. In use, the driver blade may be driven along a longitudinal axis of the passage by the power delivery source to engage and drive a staple into a workpiece. The nosepiece further comprises at least one space configured to provide clearance in the passage for a barb of the staple when driven by the driver blade.

[0009] Also disclosed is a tool for driving a barbed staple into a workpiece, the tool includes a housing enclosing a power delivery source and a driver blade driven by the power delivery source and comprising an engagement portion configured for engagement with the staple. The tool further includes a nosepiece comprising an aperture providing access for loading a staple into the nosepiece and a passage configured for slidable mounting of the driver blade. In use, the driver blade may be driven along a longitudinal axis of the passage by the power delivery source to engage and drive a staple into a workpiece. The engagement portion of the driver blade is configured to provide lateral support to the staple as it is driven along the longitudinal axis of the passage.

BRIEF DESCRIPTION OF THE DRAWINGS

[0010] Embodiments will now be described by way of example only, with reference to the accompanying drawings in which

Figs. 1a and 1b are side views of an embodiment of a powered staple tool;

Fig. 2 is a section view of a nosepiece assembly of the tool of Fig. 1a and 1b;

Fig. 3a and 3b are a front and side view respectively of a driver assembly of the tool of Fig. 1a and 1b; and

Fig. 4 is a perspective view of an assembly of collated staples that may be suitable for use with an embodiment of the tool.

DETAILED DESCRIPTION

[0011] In the following detailed description, reference is made to accompanying drawings which form a part of the detailed description. The illustrative embodiments described in the detailed description, depicted in the drawings and defined in the claims, are not intended to be limiting.

[0012] Disclosed is a tool for driving a barbed staple into a workpiece, the tool comprising: a housing enclosing a power delivery source; a driver blade driven by the power delivery source and comprising an engagement portion configured for engagement with the staple; a nosepiece comprising an aperture providing access for loading a staple into the nosepiece, the nosepiece further comprising a passage configured for slidable mounting of the driver blade; such that, in use, the driver blade may be driven along a longitudinal axis of the passage by the power delivery source to engage and drive a staple into a workpiece; wherein, the nosepiece further comprises at least one space configured to provide clearance in the passage for a barb of the staple when driven by the driver blade.

[0013] In some forms, the nosepiece comprises two

opposing spaces, the spaces being configured to provide clearance for outwardly facing barbs on respective legs of the staple.

[0014] In some forms, the nosepiece comprises at least one lateral passage arranged to provide clearance for a barb of the staple when the staple is being loaded into the nosepiece. In some forms, the nosepiece comprises two opposing lateral passages arranged to provide clearance for outwardly facing barbs on respective legs of the staple.

[0015] In some forms, the at least one space is in the form of a channel that extends from the at least one lateral passage to a distal end of the nosepiece.

[0016] In some forms, the nosepiece includes wall portions that define a proximal portion of the passage and which are arranged to be in facing relation with an upper portion of respective legs of the staple so as to assist in maintaining correct alignment of the staple in the nosepiece.

[0017] In some forms, the engagement portion of the driver blade is configured to provide lateral support to the staple as it is driven along the longitudinal axis of the passage.

[0018] Also disclosed is a tool for driving a barbed staple into a workpiece, the tool comprising: a housing enclosing a power delivery source; a driver blade driven by the power delivery source and comprising an engagement portion configured for engagement with the staple; a nosepiece comprising an aperture providing access for loading a staple into the nosepiece, the nosepiece further comprising a passage configured for slidable mounting of the driver blade; such that, in use, the driver blade may be driven along a longitudinal axis of the passage by the power delivery source to engage and drive a staple into a workpiece; wherein the engagement portion of the driver blade is configured to provide lateral support to the staple as it is driven along the longitudinal axis of the passage.

[0019] In some forms, the engagement portion of the driver blade is formed such that its profile conforms to the crown of the staple.

[0020] In some forms, the driver blade further comprises a guide element configured to resist lateral movement of the driver blade with respect to the longitudinal axis of the passage.

[0021] In some forms, the guide element is a ridge formed along the longitudinal axis of the driver blade, the ridge configured for slidable engagement with a corresponding recess in the nosepiece.

[0022] In some forms, a workpiece contact element slidably mounted on the nosepiece and configured to retract upon the tool being pressed against a workpiece.

[0023] In some forms, the workpiece contact element comprises a groove, the groove aligned such that, in use, when the staple is driven into the workpiece, the legs the staple will be located either side of the groove.

[0024] In some forms, the groove is configured for receipt of a fence wire.

[0025] In some forms, the power delivery source is pneumatically powered. In an alternative form, the power delivery source is powered by a gas fuel cell. The power delivery source may be in other forms, such as electrically driven for example a cordless battery powered tool.

[0026] In some forms, the tool further comprises a staple supply mechanism for supplying staples into the nosepiece through the aperture.

[0027] In some forms, the staple supply mechanism is arranged to receive a plurality of collated staples. In some forms, the inside crown of the staples rest and slide along a magazine rail into the nose.

[0028] In some forms, the staple supply mechanism comprises a guard arranged to protect a user from contact with the barbs of the staples stored therein.

[0029] Also disclosed is a system for driving a barbed staple into a workpiece, the system comprising: a plurality of staples, each staple comprising a crown having two legs extending therefrom, at least one of the staples comprising a barb; and a tool according to any form described above, the tool being arranged to receive individual ones of the plurality of staples into the nosepiece through the aperture to be driven into the workpiece under movement of the driver blade.

[0030] In some forms, the plurality of staples is collated when stored in a staple supply mechanism of the tool.

[0031] In some forms, the staple assembly comprises at least one strip of collation tape secured to the legs of the staples

[0032] In some forms, the at least one strip of collation tape is secured at a location on at least one leg of respective ones of the staples between the crowns and barb of the staple.

[0033] In some forms, the at least one strip of collation tape is frangible such that upon driving of a staple by the driver blade, the at least one strip of collation tape is broken and the staple separated from the remaining collated staples.

[0034] In some forms, the at least one strip of collation tape is broken during driving of the staple, a portion of the at least one strip of collation tape remains on the staple.

[0035] In some forms, the portion of the at least one strip of collation tape inhibits lateral movement of the staple with respect to the longitudinal axis of the passage, when the staple is driven along the passage.

[0036] Also disclosed is an assembly of staples, the staples comprising a crown portion having at least two legs extending therefrom and one or more barbs protruding from at least one of the legs, the assembly further comprising at least one strip of collation tape, wherein the staples are collated and connected by way of the at least one strip of collation tape secured to the staples.

[0037] In some forms, the at least one strip of collation tape is secured to legs of the staples at a location between the respective crowns and the one or more barbs of the staples.

[0038] In some forms, each of the legs of the plurality

of staples includes one or more barbs which project outwardly from the legs.

[0039] In some forms, the barbs may have a flat, square or round tip.

[0040] Also disclosed is a barbed staple comprising: a crown; two legs extending from the crown; and one or more barbs protruding from the legs; wherein the staple further comprises at least one guiding element secured to at least one of the legs at a location between the respective barb of the leg and the crown.

[0041] In some forms, the at least one guiding element is a portion of collation tape.

[0042] Also disclosed is a method of driving a barbed staple into a workpiece, the method comprising: locating a barbed staple in a nosepiece of a powered tool; and driving the staple along a longitudinal axis of the nosepiece and into the workpiece under operation of a driver blade of the powered tool; wherein an engagement portion of the driver blade is configured to provide lateral support to the staple as it is driven along the longitudinal axis of the nosepiece.

[0043] Also disclosed is a method of driving a barbed staple into a workpiece, the method comprising: locating a barbed staple in a nosepiece of a powered tool, the barbed staple being in the form having a crown; two legs extending from the crown; and one or more barbs protruding from the legs; wherein the staple further comprises at least one guiding element secured to at least one of the legs at a location between the respective barb of the leg and the crown.; and driving the staple along a longitudinal axis of the nosepiece and into the workpiece under operation of a driver blade of the powered tool; wherein the guiding element inhibits lateral movement of the staple with respect to the longitudinal axis when it is being driven..

[0044] When compared to manual methods, the use of a power tool for driving a staple into a workpiece (e.g. a post, bench, wall etc.) can be both quicker and easier. This can be especially true with regards to barbed staples, which can offer more resistance against insertion into a workpiece. Moreover, a power tool may provide greater precision and control over the placement and depth of a staple in a workpiece. For example, a power tool may provide the precision required when driving a staple across a fence wire in order to avoid damage to the fence wire. Additionally, use of a power tool instead of a manual method reduces the manual labour required by a user, which may in turn reduce repetitive strain injuries and operator fatigue.

[0045] To accommodate for the barbs in the staple legs, adequate clearances need to be provided in the nosepiece of the tool for both loading and passage of the staple through the nosepiece. These clearances increase the likelihood that the staple may twist or move laterally in the nosepiece which may result in jamming of the staple in the nosepiece. To compensate for this, the tool may include arrangements to maintain the staple alignment. These may include modification of the en-

gagement portion of the driver blade to laterally support the staple, including a guide arrangement for maintain alignment of the driver blade and maintaining close support of the staple in the proximal portion of the nosepiece, and using guiding elements on the legs of the staples to assist in maintaining this close support.

[0046] Figs. 1a and 1b show an embodiment of a tool 10 for driving a barbed staple into a workpiece. The tool 10 comprises a housing 12 containing a power delivery source (not shown). In the illustrated form, the tool is pneumatic (i.e. powered pneumatically). In other embodiments the tool may be, for example, gas powered. A person of ordinary skill in the art would understand that other means for powering a tool would also be suitable.

[0047] The tool 10 further comprises a nosepiece assembly 14 extending from a lower end of the housing 12. A staple supply assembly, in the form of a magazine 16, extends laterally from the nosepiece assembly 14. Fig. 1a shows the magazine 16 holding staples 18, whilst in Fig. 1b, the magazine 16 is empty. The magazine 16 supplies collated staples 18 to a loading chamber of the nosepiece assembly 14. In the illustrated form of Fig. 1a, the staples 18 are collated by way of collation tape 20. In other forms, the staples 18 may be collated by way of adhesive, or alternatively may not be collated (i.e. they may be provided individually).

[0048] A hand grip 22 extends from the housing 12 and is configured such that a user may comfortably handle the tool 10. Adjacent the hand grip 22 is a trigger 24, which when pressed, activates the power delivery source such that a staple (loaded in the nosepiece assembly 14) may be driven into a workpiece by the tool 10. As a safety measure a lower workpiece contact 48 disposed at a distal end of the nosepiece assembly 14 may need to be retracted to allow activation of the power delivery source.

[0049] Referring to Fig. 2, a section of the nosepiece assembly 14 is shown. The nosepiece assembly 14 comprises a nosepiece 26 having a passage 28 along which a driver blade 30 is arranged to travel. In Fig. 2, a staple 18 is located partway down the passage 28 in the nosepiece 26 and is in contact with the driver blade 30 which is designed to push the staple through the nosepiece passage 28.

[0050] The tool further comprises a power delivery source (not shown) that is arranged to drive the driver blade 30 down the passage 28 (i.e. towards the distal end of the nosepiece 26 that is located at the workpiece). The driver blade 30 (which is described in more detail below with reference to Fig. 3A and 3B) comprises an engagement portion 32 that engages the crown 34 of a staple 18 that has been loaded into the passage 28, to drive the staple 18 down the passage 28. In this way, the staple 18 may be driven into and secured in a workpiece.

[0051] The staple 18 comprises barbs 40 extending outwardly from the staple legs 42, thereby increasing the overall width of the staple 18. The barbs 40 of the staple 18 as shown comprise a truncated point such that the tips of the barbs 40 are flat (i.e. square) so that they are

less likely to come in contact, or sustain damage from contact, with the nosepiece when the staple 18 is driven in the passage 28.

[0052] Typically the staple 18 comprises a hot dip galvanization coating, which may provide the staple 18 with rust resistance. A person of ordinary skill in the art would understand that other, or additional, coating or treatment may be applied to the staple such as e.g. electro-galvanization, heat treatment, phosphate etc.

[0053] The staple 18 further comprises tape 44 attached to each of its legs 42. The thickness of the tape 44 may be such that it assists in positioning and/or guiding the staple in the nosepiece as will be explained in more detail below.

[0054] The tape 44 may, for example, be a portion of collation tape that remains on the staple when it is broken away from a collated staple arrangement. Such a collated arrangement is shown in Fig. 4. In this way, the tape would be 'dual purpose', in that it would first provide for collating the assembly of staples, and secondly provide stability of a staple 18 in the passage 28 when driven by forming a wadding barrier. The tape may alternatively be applied individually to the staple (i.e. such that it is not a portion of collation tape applied to an assembly of collated staples). In one form the tape 44 may be formed of paper, however a person of ordinary skill in the art would understand that the tape may be formed of other suitable materials such as plastic. In addition, the collation tape may protect the staple leg and wire coating and barb from damage.

[0055] In the illustrated form the collated staple arrangement is loaded in the magazine 16 and supplies staples 18 to the loading chamber of the nosepiece 26 via an access aperture in the nosepiece 26. The aperture comprises means to provide access for the barbs 40 of the staple 18. In the illustrated form, the means is in the form of lateral passages 46, which provide clearance for the barbs 40 on the staples 18 when loaded from the magazine 16. Furthermore to allow for passage of the staple 18 through the nosepiece 26, clearance spaces in the form of channels 38 are provided along the walls defining the passage 28. These channels extend from the lateral passages 46 to the distal end of the nosepiece 26.

[0056] The workpiece contact element 48, in the form of a foot, is located at the lower end of the nosepiece 26. The foot 48 is configured to retract, in use, as it contacts the workpiece. That is, the foot 48 will retract back up the nosepiece 26 when a user pushes the end of the tool 10 against a workpiece in order to allow the power delivery source of the tool 10 to be activated for driving of a staple into 18 the workpiece (under operation of the tool trigger). A slot 50 is located in the base of the foot 48 and aligned such that it is perpendicular to the longitudinal axis of the crown 34 of the staple 18, and such that it is located between the legs 42 of the staple in use. Thus in use, a user can align, for example, a fence wire in the slot 50 in order to ensure that the legs of a staple 18 will be driven

into the workpiece either side of the wire. This helps to prevent a user from accidentally aligning the tool 10 such that a leg 42 of the staple 18 is driven into the wire, which could cause damage to the wire or any surface treatment applied to the wire. Thus, the slot 50 may help to ensure that the durability of the wire being attached to a workpiece is not compromised (e.g. due to rust).

[0057] Because of the existence of the channels 38 and the lateral passages 46 (both of which are provided to cater for the barbs 40 on the staples 18), the tool 10 includes various means to support and/or maintain alignment of the staple in the nosepiece. As mentioned above, the outer surface of the tape is in contact, or close to being in contact, with the surface of the passage 54 disposed proximal of the lateral passages 46. Such an arrangement may provide a closer fit of the upper portion of the staple 18 in the passage 28. This may help to correctly position the staple in the nosepiece to receive the driver blade and to stabilise the motion (i.e. by limiting motion of the staple to the longitudinal axis of the passage 28) of the staple 18 when it is initially driven by the driver blade 30 down the passage 28.

[0058] To further assist in maintaining the position of the staple 18 in the nosepiece, the drive blade 36 may be modified to provide lateral support for the staple.

[0059] Figures 3A and 3B provide front and side views respectively of the driver assembly of the embodiment of the tool 10. The driver assembly comprises a driver blade 30 having an engagement portion 32 and ridge 36.

[0060] The engagement portion 32 is crescent shaped, such that it conforms to the form of the crown 34 of the staple 18. Such a configuration may allow the engagement portion 32 to guide the staple 18 in the passage 28 and prevent movement of the staple 18 away from the longitudinal axis of the passage 28 (e.g. rotation or lateral movement of the staple 18 in the passage 28). In other words, receipt of the crown 34 of the staple 18 in the concave engagement portion 32 helps to self-centre the staple 18 whilst it is being driven. In use, the power delivery source can be configured such that the driver blade 30 is accelerated as it engages the staple 18 and drives the staple 18 into the workpiece. In this respect, the staple will be held in the crescent (i.e. in continuous contact) throughout the driving action of the driver blade 30 (i.e. from engagement with the driver blade to the staple being embedded in a workpiece). 1

[0061] The crescent shaped engagement portion 32 may also reduce or eliminate damage to any coating that may be applied to the staple 18. This may especially be the case when compared to manual methods of driving a staple 18 into a workpiece (e.g. hand hammer driven).

[0062] The driver blade 30 also comprises a ridge 36. This ridge 36 is arranged to align and engage with a corresponding slot (not shown) located on the nosepiece 26. This engagement aligns the driver blade 30 in the passage 28, such that when it is driven, it is substantially restricted to motion along the longitudinal axis of the passage. In the absence of complete side support (i.e. due

to the passage 28 comprising channels 38) the ridge 36 may provide partial or full stability to the driver blade 30 during driving action.

[0063] Now referring to Fig. 4, the assembly of staples 18 for use with the embodiment of the tool is shown. Each staple comprises a crown 34, two legs 42 and a barb 40 on each leg 42. The staples 18 are collated and connected by paper collation tape 44 applied to the legs 42 of the staples 18. Each staple 18 comprises diverging points 52, which have opposing angled faces such that when a staple 18 is driven into a workpiece, the legs 42 are caused to diverge. As discussed above, the collation tape 44 not only secures the collated staples together but can assist in maintaining alignment of the staple 18 in the nosepiece 26 by providing a closer fit of the upper portion of the staple 18 in the passage 28.

[0064] To allow for reliable operation of the staple tool, the dimensions of the staples 18 and their alignment in the collated assembly need to be within relative tight tolerances which may be in the order of ± 5 mm. Also the adhesion of the collation tape and its properties influence the operation of the tool. In one form, the staples are manufactured and collated to meet the desired criteria using a process whereby the staples are made using a pressing operation including a 3 stage bending process. During this pressing operation the barbs are formed on the staple legs. The staples then pass onto a staple collation rail where the staples are heated to approximately 300° C. The collation tape (which in one form may be a paper based tape supplied under the trade name PASLODE PRO-STRIP EQ98) is applied to the heated staples where a bond is formed between the collation tape and the metal surface of the staples.

[0065] Accordingly a powered staple tool 10 is provided that uses barbed staples 18 which may be supplied in a collated assembly. This allows for rapid and effective fixing of the staples and is ideal for applications such as fencing. To accommodate for the barbs in the staple legs, adequate clearances are provided in the nosepiece of the tool for both loading and passage of the staple through the nosepiece. As these clearances increase the likelihood of the staple twisting or moving laterally in the nosepiece (which may result in jamming of the staple in the nosepiece), support arrangements are provided to maintain correct positioning of the staple in the nosepiece.

[0066] In the claims which follow and in the preceding summary except where the context requires otherwise due to express language or necessary implication, the word "comprising" is used in the sense of "including", that is, the features as above may be associated with further features in various embodiments.

Claims

1. A tool (10) for driving a barbed staple (18) into a workpiece, the tool comprising:

a housing (12) enclosing a power delivery source;

a driver blade (30) driven by the power delivery source and comprising an engagement portion (32) configured for engagement with the staple; a nosepiece (26) comprising an aperture providing access for loading a staple into the nosepiece, the nosepiece further comprising a passage (28) configured for slidable mounting of the driver blade; such that, in use, the driver blade may be driven along a longitudinal axis of the passage by the power delivery source to engage and drive a staple into a workpiece;

wherein the engagement portion of the driver blade is configured to provide lateral support to the staple as it is driven along the longitudinal axis of the passage, the engagement portion of the driver blade is formed such that its profile conforms to a crown (34) of the staple,

characterized in that the driver blade further comprises a guide element configured to resist lateral movement of the driver blade with respect to the longitudinal axis of the passage and, wherein the guide element is a ridge (36) formed along the longitudinal axis of the driver blade, the ridge configured for slidable engagement with a corresponding recess in the nosepiece.

2. A tool (10) according to claim 1, further comprising a workpiece contact element (48) slidably mounted on the nosepiece (26) and configured to retract upon the tool being pressed against a workpiece.

3. A tool (10) according to claim 2, wherein the workpiece contact element (48) comprises a groove, the groove aligned such that, in use, when the staple (18) is driven into the workpiece, the legs (42) the staple will be located either side of the groove.

4. A tool (10) according to claim 3, wherein the groove is configured for receipt of a fence wire.

5. A tool (10) according to any one of claims 1 to 4, further comprising a staple supply mechanism for supplying staples (18) into the nosepiece (26) through the aperture.

6. A tool (10) according to claim 5, wherein the staple supply mechanism is arranged to receive a plurality of collated staples (18).

7. A tool (10) according to any one of claims 1 to 6, wherein the power delivery source is pneumatically powered.

8. A tool (10) according to any one of claims 1 to 6, wherein the power delivery source is powered by a

gas fuel cell.

9. A tool (10) according to any one of claims 1 to 6, wherein the power delivery source is electrically driven.
10. A tool (10) according to any one of claims 1 to 9, wherein the inside crown of the staples rest and slide along a magazine rail into the nosepiece (26).
11. A tool (10) according to claim 5 or 6, wherein the staple supply mechanism comprises a guard arranged to protect a user from contact with barbs of the staples (18) stored therein.

Patentansprüche

1. Werkzeug (10) zum Treiben einer Widerhakenklammer (18) in ein Werkstück, wobei das Werkzeug Folgendes umfasst:

ein Gehäuse (12), das eine Energieversorgungsquelle umschließt,

eine von der Energieversorgungsquelle angetriebene Treiberklinge (30), die einen Eingriffsabschnitt (32) umfasst, der zum Eingriff mit der Klammer ausgestaltet ist,

ein Mundstück (26), das eine Öffnung umfasst, die für Zugang zum Laden einer Klammer in das Mundstück sorgt, wobei das Mundstück ferner einen zur verschiebbaren Montage der Treiberklinge ausgestalteten Durchgang (28) umfasst, so dass die Treiberklinge im Gebrauch durch die Energieversorgungsquelle entlang einer Längsachse des Durchgangs getrieben werden kann, um eine Klammer in Eingriff zu nehmen und in ein Werkstück zu treiben,

wobei der Eingriffsabschnitt der Treiberklinge dazu ausgestaltet ist, die Klammer seitlich zu stützen, während sie entlang der Längsachse des Durchgangs getrieben wird, und der Eingriffsabschnitt der Treiberklinge so ausgebildet ist, dass sein Profil einer Krone (34) der Klammer entspricht,

dadurch gekennzeichnet, dass die Treiberklinge ferner ein Führungselement umfasst, das dazu ausgestaltet ist, einer seitlichen Bewegung der Treiberklinge bezüglich der Längsachse des Durchgangs zu widerstehen, und wobei das Führungselement eine entlang der Längsachse der Treiberklinge ausgebildete Rippe (36) ist, wobei die Rippe für den Gleiteingriff mit einer entsprechenden Aussparung im Mundstück ausgestaltet ist.

2. Werkzeug (10) nach Anspruch 1, ferner umfassend ein Werkstückkontaktelement (48), das verschieb-

bar am Mundstück (26) montiert und dazu ausgestaltet ist, sich zurückzuziehen, wenn das Werkzeug gegen ein Werkstück gedrückt wird.

3. Werkzeug (10) nach Anspruch 2, wobei das Werkstückkontaktelement (48) eine Nut umfasst, wobei die Nut so ausgerichtet ist, dass im Gebrauch, wenn die Klammer (18) in das Werkstück getrieben wird, die Schenkel (42) der Klammer beidseitig der Nut angeordnet sind.

4. Werkzeug (10) nach Anspruch 3, wobei die Nut zur Aufnahme eines Zaundrahts ausgestaltet ist.

5. Werkzeug (10) nach einem der Ansprüche 1 bis 4, ferner umfassend einen Klammerzuführmechanismus zum Zuführen von Klammern (18) durch die Öffnung in das Mundstück (26).

6. Werkzeug (10) nach Anspruch 5, wobei der Klammerzuführmechanismus dazu angeordnet ist, eine Vielzahl von zusammengetragenen Klammern (18) aufzunehmen.

7. Werkzeug (10) nach einem der Ansprüche 1 bis 6, wobei die Energieversorgungsquelle pneumatisch angetrieben ist.

8. Werkzeug (10) nach einem der Ansprüche 1 bis 6, wobei die Energieversorgungsquelle durch eine Gasbrennstoffzelle angetrieben ist.

9. Werkzeug (10) nach einem der Ansprüche 1 bis 6, wobei die Energieversorgungsquelle elektrisch angetrieben ist.

10. Werkzeug (10) nach einem der Ansprüche 1 bis 9, wobei die inneren Kronen der Klammern auf einer Magazinschiene ruhen und entlang dieser in das Mundstück (26) gleiten.

11. Werkzeug (10) nach Anspruch 5 oder 6, wobei der Klammerzuführmechanismus einen Schutz umfasst, der dazu angeordnet ist, einen Benutzer vor einem Kontakt mit Widerhaken der darin gelagerten Klammern (18) zu schützen.

Revendications

1. Outil (10) servant à enfoncer une agrafe barbelée (18) dans une pièce à traiter, l'outil comprenant :

un boîtier (12) renfermant une source d'apport de puissance ;

une lame d'enfoncement (30) entraînée par la source d'apport de puissance et comprenant une partie d'interaction (32) configurée à des

- fins d'interaction avec l'agrafe ;
 un embout (26) comprenant une ouverture permettant un accès à des fins de chargement d'une agrafe dans l'embout, l'embout comprenant en outre un passage (28) configuré à des fins d'installation à coulissement de la lame d'enfoncement ; de telle sorte que, en cours d'utilisation, la lame d'enfoncement puisse être entraînée le long d'un axe longitudinal du passage par la source d'apport de puissance de façon à interagir avec une agrafe et à l'enfoncer dans une pièce à traiter ;
 dans lequel la partie d'interaction de la lame d'enfoncement est configurée pour assurer un support latéral pour l'agrafe tandis qu'elle est entraînée le long de l'axe longitudinal du passage, la partie d'interaction de la lame d'enfoncement est formée de telle sorte que son profil épouse une couronne (34) de l'agrafe,
caractérisé en ce que la lame d'enfoncement comprend en outre un élément de guidage configuré pour assurer une résistance à un mouvement latéral de la lame d'enfoncement par rapport à l'axe longitudinal du passage et dans lequel l'élément de guidage est une arête (36) formée le long de l'axe longitudinal de la lame d'enfoncement, l'arête étant configurée à des fins d'interaction par coulissement avec un renfoncement correspondant dans l'embout.
2. Outil (10) selon la revendication 1, comprenant en outre un élément de contact avec la pièce à traiter (48) installé à coulissement sur l'embout (26) et configuré pour se rétracter lorsque l'outil est pressé contre une pièce à traiter.
3. Outil (10) selon la revendication 2, dans lequel l'élément de contact avec la pièce à traiter (48) comprend une gorge, la gorge étant alignée de telle sorte que, en cours d'utilisation, lorsque l'agrafe (18) est enfoncée dans la pièce à traiter, les pattes (42) de l'agrafe soi(en)t positionnée(s) de part et d'autre de la gorge.
4. Outil (10) selon la revendication 3, dans lequel la gorge est configurée pour recevoir un fil de clôture.
5. Outil (10) selon l'une quelconque des revendications 1 à 4, comprenant en outre un mécanisme d'acheminement d'agrafes servant à acheminer des agrafes (18) à l'embout (26) à travers l'ouverture.
6. Outil (10) selon la revendication 5, dans lequel le mécanisme d'acheminement d'agrafes est conçu pour recevoir une pluralité d'agrafes (18) groupées.
7. Outil (10) selon l'une quelconque des revendications 1 à 6, dans lequel la source d'apport de puissance est alimentée pneumatiquement.
8. Outil (10) selon l'une quelconque des revendications 1 à 6, dans lequel la source d'apport de puissance est alimentée par une pile à combustible gazeux.
9. Outil (10) selon l'une quelconque des revendications 1 à 6, dans lequel la source d'apport de puissance est alimentée électriquement.
10. Outil (10) selon l'une quelconque des revendications 1 à 9, dans lequel la couronne interne des agrafes repose et glisse le long d'un rail de magasin jusque dans l'embout (26).
11. Outil (10) selon la revendication 5 ou 6, dans lequel le mécanisme d'acheminement d'agrafes comprend une protection prévue pour protéger un utilisateur contre le contact avec des barbelures des agrafes (18) logées dans celui-ci.

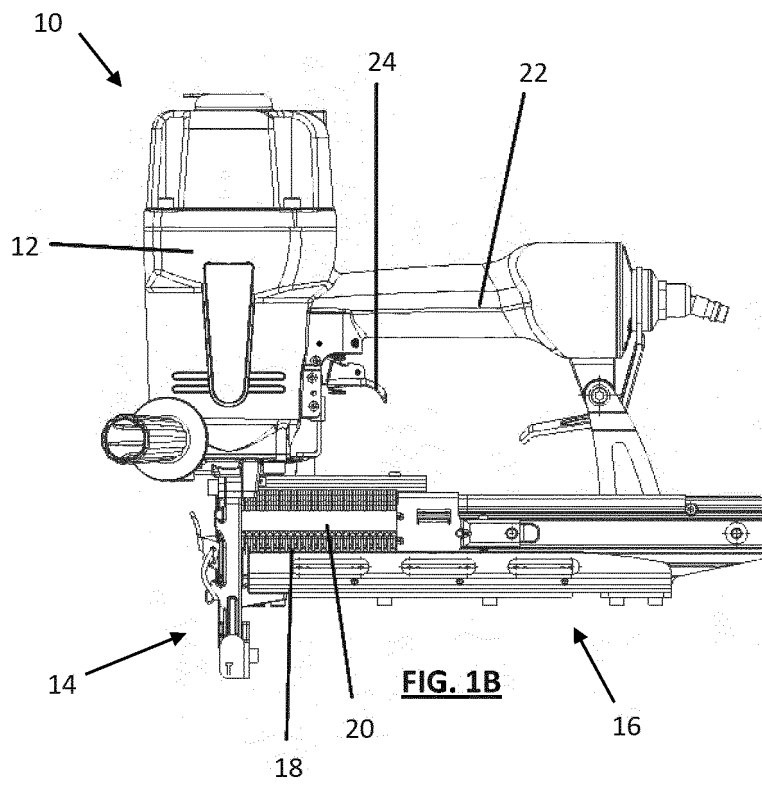
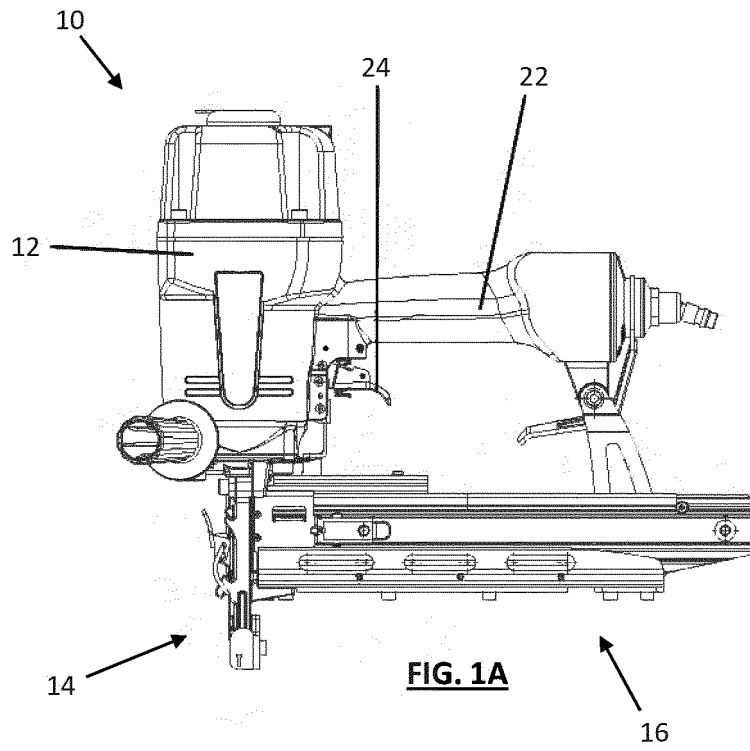

14
↙

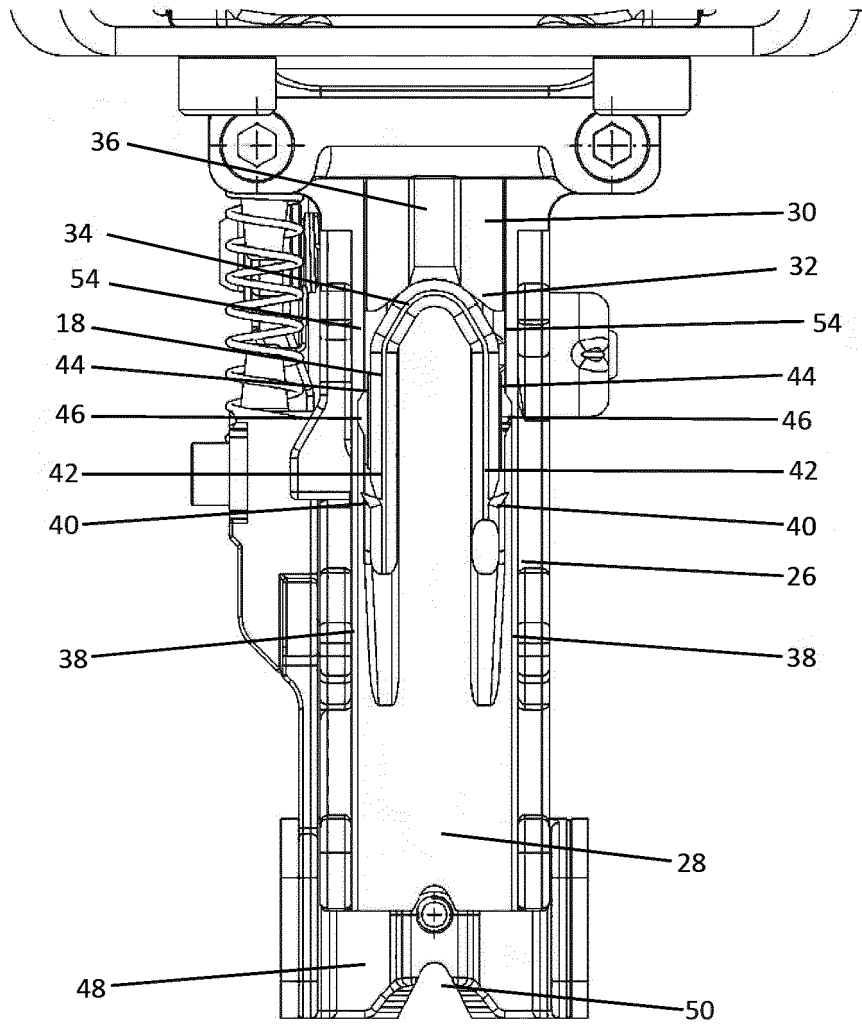

FIG. 2

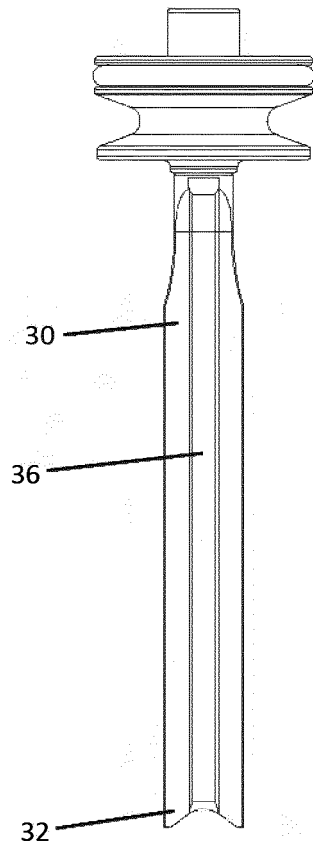

FIG. 3A

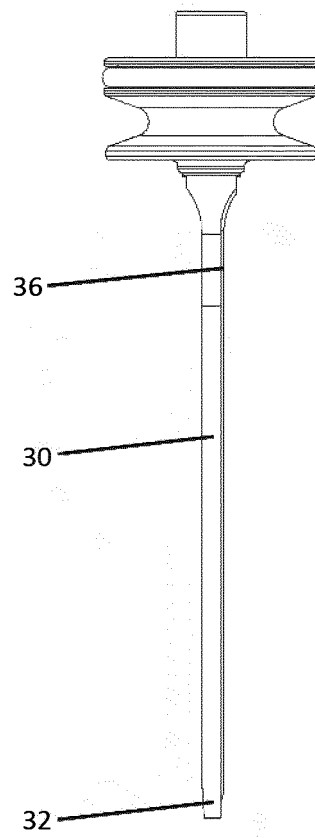

FIG. 3B

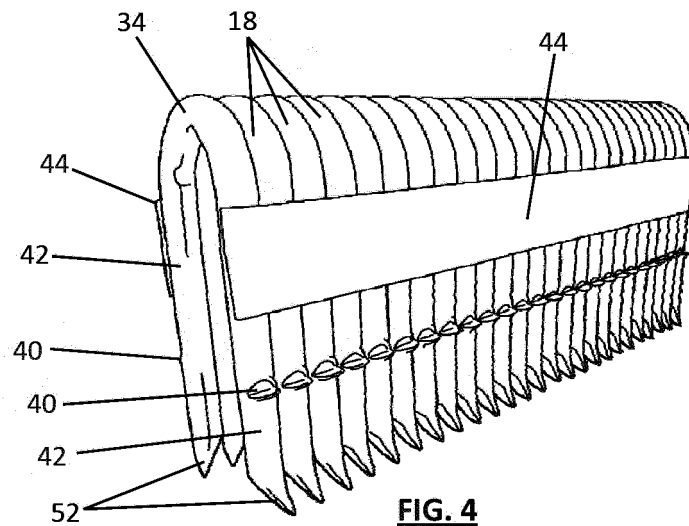

FIG. 4

REFERENCES CITED IN THE DESCRIPTION

This list of references cited by the applicant is for the reader's convenience only. It does not form part of the European patent document. Even though great care has been taken in compiling the references, errors or omissions cannot be excluded and the EPO disclaims all liability in this regard.

Patent documents cited in the description

- EP 0798503 A2 [0002]
- DE 1930490 A1 [0002]
- DE 10358442 A1 [0002]