

(19) **DANMARK**



Patent- og
Varemærkestyrelsen

(12)

Oversættelse af europæisk patentskrift

(10) **DK/EP 2512256 T3**

-
- (51) Int.Cl.: **A 22 C 21/00 (2006.01)**
- (45) Oversættelsen bekendtgjort den: **2015-08-31**
- (80) Dato for Den Europæiske Patentmyndigheds bekendtgørelse om meddelelse af patentet: **2015-05-27**
- (86) Europæisk ansøgning nr.: **10805679.7**
- (86) Europæisk indleveringsdag: **2010-12-17**
- (87) Den europæiske ansøgnings publiceringsdag: **2012-10-24**
- (86) International ansøgning nr.: **DE2010001487**
- (87) Internationalt publikationsnr.: **WO2011072660**
- (30) Prioritet: **2009-12-17 DE 202009017070 U**
- (84) Designerede stater: **AL AT BE BG CH CY CZ DE DK EE ES FI FR GB GR HR HU IE IS IT LI LT LU LV MC MK MT NL NO PL PT RO RS SE SI SK SM TR**
- (73) Patenthaver: **Marel Stork Poultry Processing B.V., Handelstraat 3, 5831 AV Boxmeer, Holland**
- (72) Opfinder: **Janssen, Jörg, An der Bleiche 7, 26180 Rastede, Tyskland**
- (74) Fuldmægtig i Danmark: **Chas. Hude A/S, H.C. Andersens Boulevard 33, 1780 København V, Danmark**
- (54) Benævnelse: **Apparat og fremgangsmåde til fjernelse af en brystbrusk på fjerkræ**
- (56) Fremdragne publikationer:
US-A- 3 541 634
US-A- 3 665 553
US-A- 3 889 317
US-B1- 6 283 847

Description

The invention relates to a device for removing breast cartilage from a poultry breast carcass.

5

The breast cartilage (Engl. "keel bone"), which in the case of poultry forms the extension of the breastbone, is needed by the pharmaceutical industry as raw material for the recovery of chondroitin sulfate and sodium hyaluronate and other medicinally valuable amino acids.

10

As a rule, the separating and collecting of the small pieces of cartilage weighing only a few grams is expensive manual work such that not all theoretically recoverable pieces of breast cartilage are actually recoverable and the demand outstrips the available amount by a multiple.

15

Poultry stripping is extensively automated in Europe and is effected for the most part by machines where in a first step for separating the breast fillet from the poultry body, the entire breast piece with bones (sternum, breast cartilage and costal arches) is separated off and the breast piece is clamped in a further automatic stripping
20 machine. In said machine, the breast piece is pulled through the stripping device by means of a conveyor. In the case of the conveying speeds usually applied, for example approximately 15 km/h, it is impossible to recover the breast cartilage by hand.

25 The object of the invention is to propose a device by way of which the breast cartilage can be separated from a breast piece without slowing down the conveying speed of the breast piece or having to hold the breast piece again in another device.

This object is achieved as claimed in the invention by a device for removing breast
30 cartilage from a poultry breast carcass, said device having a conveying device for moving the breast carcass along a straight, in particular horizontal path of motion in a fixed orientation, wherein a median plane of the breast carcass is aligned perpendicularly with respect to the path of motion, a positionally fixed cutting device having a transversal blade for carrying out a transversal cut, which passes through

the breast cartilage and extends in a transversal cutting plane arranged perpendicularly to the median plane, wherein the transversal cutting plane encloses an angle of up to 30° with a transversal plane of the breast carcass which transversal plane is arranged perpendicularly with respect to the median plane, and having a
5 frontal blade for carrying out a frontal cut which passes through the breast cartilage and extends in a frontal cutting plane arranged perpendicularly with respect to the median plane, wherein the frontal cutting plane encloses an angle of up to 30° with a frontal plane of the breast carcass which frontal plane is arranged perpendicularly with respect to the median plane (20) and perpendicularly with respect to the
10 transversal plane.

As a result of the predetermined orientation of the positionally fixed cutting device in comparison with the moved breast carcass, the two blades, the transversal and the frontal blade, are able to cut the breast cartilage from the breastbone in a defined
15 manner without any unwanted contact between the transversal and/or frontal blade and the conveying device or other parts such as meat or bones of the breast carcass.

According to the definition, the transversal and frontal planes extend perpendicularly with respect to the median plane of the breast carcass and perpendicularly with
20 respect to each other, it not being necessary, however, for the transversal and frontal cutting planes to be necessarily perpendicular with respect to each other.

Preferably, the transversal blade and/or the frontal blade is (are) plane. In addition, it is preferred that the transversal blade and/or the frontal blade is (are) realized in a
25 straight manner. The transversal blade extends preferably manner in the transversal cutting plane. Also the further transversal blade extends preferably in the transversal cutting plane. The frontal blade extends preferably in the frontal cutting plane.

In addition, it can be provided that the transversal blade and/or the frontal blade is
30 (are) arranged at an acute angle with respect to the path of motion, in particular at an angle of up to 10°, 15° or 20° with respect thereto.

The transversal blade and the frontal blade can extend from a tip pointing in opposition to the direction of movement. In this case, it can be envisaged that a start

region adjacent the tip (up to 10%, 20% or 30% of an overall length, starting with the tip, of the respective blade of the transversal blade and/or of the frontal blade is obtuse. An acute angle enclosed between the start regions of the transversal and frontal blades can be between 5° and 30°, preferably between 10° and 20°.

5

The invention provides preferably that the transversal blade has associated therewith a further transversal blade, which is opposite said transversal blade, for carrying out a further transversal cut, in particular in the transversal cutting plane. The further transversal blade can be realized as a rotating cutting blade or as a rigidly held
10 cutting blade, for instance as a cutting blade arranged converging with the transversal blade at an acute angle in the direction of movement of the breast carcass.

In a further development of the invention it can be envisaged that a mechanical
15 entrainment means and/or scraper for moving breast cartilage, separated completely or in part from the breast carcass, in the direction of movement of the breast carcass and/or for scraping the transversal blade is arranged over and/or under the transversal blade.

20 The entrainment means or scraper can be coupled to a drive element which is arranged above the transversal blade and is movable by means of the conveying device or by means of the breast carcass which is moved by said conveying device.

In a preferred embodiment it is envisaged that the drive element and the entrainment
25 means each have radially extending arms and are rotatably mounted.

As an alternative or in addition to the entrainment means, a scraper, which scrapes the transversal blade or further transversal blade after each cutting operation, can be provided above and/or below the transversal blade or the further transversal blade, in
30 an expedient manner in opposition to the direction of movement of the breast carcass.

The invention also relates to a method for removing breast cartilage from a poultry breast carcass, in particular using a device as claimed in the invention, where the

breast carcass is moved along a straight, in particular horizontal path of motion and a median plane of the breast carcass is aligned perpendicularly with respect to the path of motion, a positionally fixed cutting device having two blades is provided, and by means of interaction between the moved breast carcass and the positionally fixed
5 cutting device, a transversal cut is carried out which extends through the breast cartilage and extends in a transversal cutting plane arranged perpendicularly with respect to the median plane, wherein the transversal cutting plane encloses an angle of up to 30° with a transversal plane of the breast carcass which transversal plane is arranged perpendicularly with respect to the median plane, and a frontal cut is carried
10 out which extends through the breast cartilage and extends in a frontal cutting plane arranged perpendicularly with respect to the median plane, wherein the frontal cutting plane encloses an angle of up to 30° with a frontal plane of the breast carcass which frontal plane is arranged perpendicularly with respect to the median plane and perpendicularly with respect to the transversal plane, wherein at least part of the
15 breast cartilage is separated from the breast carcass.

Preferably, a frontal plane of the breast carcass is aligned vertically, or within an angular range of up to 10° , 15° , 20° or 30° with respect to the vertical.

20 The transversal cut can be carried out preferably in the sagittal direction extending horizontally forward.

The frontal cut can be carried out preferably in the vertical direction extending downward.

25

Preferably it is envisaged that the transversal cut and the frontal cut extend from a common starting point or a common starting line.

It is preferably envisaged that there is carried out a further transversal cut, which
30 extends in the opposite direction to the transversal cut and can extend in the same plane as the transversal cut.

A transversal cut, a frontal cut and a further transversal cut can be carried out at the same time.

It is envisaged that preferably at least one of the transversal cut, frontal cut and further transversal cut is carried out progressively in a proportional manner with respect to a progression of movement of the breast carcass, in particular in
5 comparison with or at a speed of 5%, 10%, 15%, 20%, 30%, 40% or 50% of a conveying speed of the breast carcass.

The invention is explained further below by way of an exemplary embodiment, reference being made to a drawing, in which:

10

figure 1 shows a side view of a fixing element for a poultry breast carcass,

figure 2 shows a front view of the fixing element according to figure 1,

15 figure 3 shows a top view from above onto the fixing element according to figures 1 and 2,

figure 4 shows a perspective view inclinedly from the front onto the fixing element according to figures 1 to 3,

20

figure 5 shows a perspective view inclinedly from the front onto the fixing element according to figures 1 to 4 with a poultry breast carcass held thereon,

figure 6 shows a side view of the fixing element with a poultry breast carcass held
25 thereon,

figure 7 shows a front view of the poultry breast carcass held on the fixing element,

figure 8 shows a perspective schematic representation of a cutting device prior to
30 penetrating into a breast cartilage of a breast carcass,

figure 9 shows the cutting device according to figure 8 immediately after penetrating into the breast cartilage,

- figure 10 shows the cutting device when cutting into the breast cartilage,
- figure 11 shows a perspective view of the cutting device,
- 5 figure 12 shows a perspective view of a further embodiment of the invention,
- figure 13 shows a top view onto the embodiment according to figure 12,
- figure 14 shows a front view in the direction of movement of the embodiment
- 10 according to figures 12 and 13,
- figure 15 shows a view from below onto the embodiment according to figures 12 to 14,
- 15 figure 16 shows an exploded representation of essential elements of the embodiment according to figures 12 to 15 and
- figure 17 shows a top view onto the cutting device of the embodiment according to figures 12 to 16.

20

A conveying device for holding and moving poultry breast carcasses as well as the aligning and fixing of a poultry breast carcass on the conveying device is explained first of all with reference to figures 1 to 7.

- 25 Figure 1 shows a side view of a fixing element 2 for a poultry breast carcass 4, indicated by the broken line, having a guide portion 6 and a fixing portion 8. The guide portion 6 has an undercut guide groove 10 which is T-shaped in cross section, by way of which guide groove the fixing element 2 can be pulled on a guide rail of a conveying device realized with a corresponding cross section in order to convey the
- 30 poultry breast carcass 4 held on the fixing portion 8 one after the other to different processing stations. The poultry breast carcass 4 is insertable between a hook-shaped projection 12 and an angled, suitably contoured contact surface 14 of the fixing portion 8 and can be fixed in a positive locking manner and with low play by

means of a fixing journal 16 (figure 4) which can be pulled out in the direction of the projection 12, as figure 7 shows in comparison with figure 2.

In the position fixed on the fixing portion 8, shown in figures 5 to 7, a median plane 20 of the poultry breast carcass 4 extends in a vertical manner and in the longitudinal direction of the fixing element 2, that is centrally through the contact surface 14, the fixing journal 16 and the projection 12. As the median plane of the poultry breast carcass is the plane which extends centrally through the backbone and breastbone as a plane of symmetry, a vertical alignment of the breastbone 22 and the breast cartilage 24 at the same time is ensured with this orientation. It can be seen that the median plane 20 extends perpendicularly with respect to a path of motion 26, along which the fixing element 2 moves forward in the conveying direction in a direction of movement 28.

As, in practice, a specific processing installation and conveying device always processes slaughtered animals of one and the same size, it is ensured that the breast carcasses 4 also always have the same dimensions such that fixing of the same on the fixing elements 2 can be effected in a reproducible manner and with low play. In a side view, figure 6 once again clearly shows the arrangement of breastbone 22 and breast cartilage 24 located directly adjacent a lower portion of the contact surface 14.

The device for separating off the breast cartilage as claimed in the invention is explained below with reference to figures 8 to 11. A cutting device 30 arranged in a positionally fixed manner with reference to the conveying device and the moved fixing elements 2 is positioned such that the poultry breast carcasses, which are fixed on the fixing elements 2 moved forward along a predetermined path of motion, move in a forcible manner into engagement with the cutting device, as a result of which the breast cartilage is separated off in a targeted manner without the breast carcass being otherwise impaired in any other way.

The cutting device 30 has at least two blades for this purpose, namely first of all a transversal blade 32, which in the exemplary embodiment shown is arranged parallel to a transversal plane 34 (see also figure 7) of the breast carcass 4, and in addition a

frontal blade 36 which is arranged parallel to a frontal plane 38 of the breast carcass 4. The transversal plane 34 extends perpendicularly with respect to the median plane 20 and, in the exemplary embodiment shown, runs in a substantially horizontal manner. The frontal plane 38 also extends perpendicularly with respect to the median plane 20 and in addition perpendicularly with respect to the transversal plane 34 and, in the exemplary embodiment shown, runs in a vertical manner. As the median plane 20 extends perpendicularly with respect to the path of motion 26 and to the direction of movement 28 of the carcass, the transversal and frontal planes 34, 38 each run parallel to the path of motion 26 and to the direction of movement 28.

10

Because variations are possible with reference to the shape of the breast cartilage and also with reference to the fixing of the breast carcass 4 on the fixing element 2, it can be expedient when the transversal blade 32 does not run precisely in the transversal plane 34, but in a transversal cutting plane extending at an angle thereto in order to be able to follow in a more precise manner, for example, a non horizontal, but inclinedly extending transition 40 (figure 6) between the breastbone 22 and the breast cartilage 24. In each case it is expedient when the transversal blade 32 runs in a plane parallel to the path of motion 26 so that when the breast carcass moves past the stationary blade, there is no height misalignment in a direction transversely with respect to the conveying movement.

20

In order to enable a gradual cutting operation in, for example, a sagittal direction 42, i.e. in a direction running in the median plane 20 and transversal plane 34, pointing away from the fixing element 2, the transversal blade 32 is arranged at an acute angle t with reference to the path of motion 26 or to the direction of movement 28.

25

The frontal blade 36 does not have to run precisely in the frontal plane 38 either, but can be arranged in a frontal cutting plane running at an angle thereto, also with the aim of compensating for certain deviations in the shape or fixing of individual breast carcasses. In order to obtain a gradual cutting progression in the downward direction 43 also in the region of the frontal blade 36 corresponding to the forward movement of the breast carcass, the frontal blade 36, just as the transversal blade 32, is arranged at an acute angle f with respect to the path of motion 26 or to the direction of movement 28 of the breast carcass 4.

30

The transversal blade 32 and frontal blade 36 are arranged such that they converge in a substantial manner at a point, proceeding from a tip 44 in the region of which they are comparatively obtuse. The tip 44 is positioned such that it penetrates into
5 the breast cartilage or between the breast cartilage and the fixing element directly adjacent the breastbone at the level of the transition 40 between the breastbone and the breast cartilage such that from this point, the transversal blade 32 can carry out a substantially horizontal cut along the transition 40 in the direction 42 and the front blade 36 can carry out a substantially vertical cut between the breastbone and the
10 breast cartilage in the direction 43.

The effect of the obtuse development of the blades in the region of the tip is that when the tip initially penetrates there is no cutting action, but the breast cartilage is raised or lifted off the fixing element in part due to the wedge effect of the tip and the
15 subsequent cutting operation is simplified and improved.

Figure 9 shows the first phase of the penetration of the tip between the breast cartilage and the breastbone or costal arch.

20 Figure 10 shows the further cutting development, the sharp regions of the transversal and frontal blades now taking effect.

In order to simplify cutting off the breast cartilage completely, there is provided in an advantageous manner a further transversal blade 50 which is arranged in the plane
25 of the transversal blade 32 and is also aligned at an acute angle with respect to the path of motion 26, although in the reverse orientation, such that between the two transversal blades 32, 50 a tapering, narrowing gap is formed into which the breast cartilage is moved on account of the movement of the breast carcass 4 and at the end of which it is cut off in a defined manner.

30

Figure 11 shows a top view onto a cutting device 30 as claimed in the invention, it being possible to see the transversal and frontal blades 32, 36 arranged at an acute angle with respect to the path of motion 26, the tip 44 and the further transversal blade 50. Shown by the broken line is also a mechanical entrainment means 52 with

arms 54 underneath the transversal blades 32, 50, the purpose of which is to move the breast cartilage, separated off substantially or completely, further in the direction of movement 28 each time a breast carcass moves past so that there is no jam in the region of the cutting device. The entrainment means 52 can be non-rotatably
5 connected to a rotatable drive element, which is arranged above the transversal blade 32 and also has one or more radially extending arm or arms which (in each case) is (are) to be entrained by a passing breast carcass.

A further embodiment of the invention is explained below by way of figures 12 to 17,
10 said embodiment matching the previously explained embodiment in many respects such that the same references are used for the same elements.

The fixing element 2 with contact surfaces 14, the projection 12 of which is only indicated, is guided by way of its guide groove 10 on a guide rail 11, which is
15 indicated by the broken line, the cross section of which (indicated in a hatched manner in figure 12) matches that of the guide groove 10.

As shown by figures 13, 15 and 17, there is provided a transversal blade 32 and a further transversal blade 50 arranged in the same plane, said blades being arranged
20 at an acute angle at approximately 20° with respect to each other and at the same angles with respect to the direction of movement of the incoming breast carcasses or with respect to the longitudinal direction of the guide rail 11.

Figure 13 clarifies the position of the median plane 20 which extends centrally
25 through the fixing element 2 perpendicularly with respect to the plane of the drawing and perpendicularly with respect to the (horizontal) direction of movement 28. As shown in figure 14, in which the median plane 20 is also indicated along with the surface lying in the drawing plane, the transversal blade 32 and the further transversal blade 50 (not shown separately) extend in a transversal cutting plane 35
30 which is arranged perpendicularly with respect to the median plane 20. The transversal cutting plane 35 can enclose an angle α of up to 30° , in the present case for instance between 5 and 10° , with the transversal plane 34, which is fixed by the geometry of the breast carcass 4 and, as a rule, extends in a horizontal manner.

The frontal blade 36 extends in a frontal cutting plane 39, which is arranged perpendicularly with respect to the median plane 20 and can enclose an angle α of up to 30° , in the present case for instance between 5 and 10° , with the frontal plane 38, which is fixed by the geometry of the breast carcass 4 and extends perpendicularly with respect to the transversal plane 34, in the example shown, that is in a vertical manner.

As figure 14 further shows, the transversal blade 32 and the frontal blade 36 extend from the tip 44.

10

As can be seen in particular in figure 16, all the blades 32, 36 and 50 are mounted on a rectangular cutting body 60, which has an approximately horizontal portion 62, on which the transversal blade 32 and the further transversal blade 50 are mounted, and an approximately vertical portion 64, which proceeds therefrom and on which the frontal blade 36 is mounted. The tip 44 protrudes in opposition to the direction of movement 28 in the transition region between the horizontal and vertical portion 62, 64. All the blades are realized as interchangeable inserts or cutting blades which are fixed by clamping plates fastened on the cutting body 60 by means of screws so as to be easily exchangeable. Figure 16 shows this for the frontal blade 36, which is formed as an insert 66 which is held so as to be interchangeable on the vertical portion 64 by means of a clamping plate 68 and screws 70, as well as the transversal blades 32, 50. The position of the respective insert, in this case, is fixed precisely by a recess in an outside edge of the respective portion, for instance by a recess 72 in the vertical portion 64.

25

An upper scraper 74 and a lower scraper 76 are held on the horizontal portion 62 of the cutting body 60 so as to be non-rotatable on a scraper shaft 78 which is rotatably mounted perpendicularly with respect to the transversal cutting plane 35. In addition, an actuating lever 80 is non-rotatably mounted on the scraper shaft 78, said actuating lever, on the arrival of a fixing element 2 or a breast carcass 4, is pivoted by the same and at the same time entrains the scrapers 74, 76 such that they are moved along above and below the transversal blade 32 and the further transversal blade 50 and first of all strip past them in the direction of movement 28. In this case, any possibly adhering residual meat is scraped off, and in addition the scraper 74

and/or the scraper 76 fulfill an entrainment function as in the case of the first embodiment in order to move the breast cartilage along the blades and to avoid adherence.

- 5 Pivotaly connected on the actuating lever 80 is a spring-loaded pressure cylinder 82, which moves the actuating lever 80 back into the initial position after a fixing element 2 or a breast carcass 4 has passed through (seen clockwise in figure 13), until the actuating lever 80 bears against a stop 84 which is fixed to the cutting body. In this case, once the breast carcass has passed through, the scrapers are moved in
- 10 opposition to the direction of movement 28 and once again strip the transversal and further transversal blades.

List of reference

	2	Fixing element (conveying device)
5	4	Poultry breast carcass
	6	Guide portion
	8	Fixing portion
	10	Guide groove
	11	Guide rail
10	12	Projection
	14	Contact surface
	16	Fixing journal
	20	Median plane
	22	Breastbone
15	24	Breast cartilage
	26	Path of motion
	28	Direction of movement
	30	Cutting direction
	32	Transversal blade
20	34	Transversal plane
	35	Transversal cutting plane
	36	Frontal blade
	38	Frontal plane
	39	Frontal cutting plane
25	40	Transition
	42	Sagittal direction
	43	Downward direction
	44	Tip
	50	Further transversal blade
30	t	Angle between 32 and 28
	f	Angle between 36 and 28
	ts	Angle between 35 and 34
	fs	Angle between 39 and a

	52	Entrainment means
	54	Arm
	60	Cutting body
5	62	Horizontal portion
	64	Vertical portion
	66	Insert
	68	Clamping plate
	70	Screw
10	72	Recess
	74	Upper scraper
	76	Lower scraper
	78	Scraper shaft
	80	Actuating lever
15	82	Pressure cylinder
	84	Stop

Patentkrav

1. Apparat til fjernelse af en brystbrusk (24) fra et fjerkræ-brystskrog (4), med en transportindretning (2) til bevægelse af brystskroget (4) langs en retlinet, især vandret bevægelsesbane (26) i en fast orientering, hvorved et medianplan (20) i brystskroget (4) er rettet ind vinkelret på bevægelsesbanen (26), en stationært anbragt skæreindretning (30) med et transversalskær (32), til udførelse af et igennem brystbrusken gående transversalsnit, som forløber i et vinkelret på medianplanet (20) anbragt transversalsnitplan, hvorved transversalsnitplanet sammen med et vinkelret på medianplanet (20) anbragt transversalplan (34) i brystskroget (4) afgrænser en vinkel på op til 30°, og med et frontalskær (36) til udførelse af et igennem brystbrusken (24) gående frontalsnit, som forløber i et vinkelret på medianplanet (20) anbragt frontalsnitplan, hvorved frontalsnitplanet med et vinkelret på medianplanet (20) og vinkelret på transversalplanet (34) anbragt frontalplan (38) i brystskroget (4) afgrænser en vinkel på op til 30°, og hvorved transversalskæret (32) og frontalskæret (36) udgår fra en imod bevægelsesretningen (38) vendende spids (44).
2. Apparat ifølge krav 1, **kendetegnet ved, at** transversalskæret (32) og/eller frontalskæret (36) er plant/plane.
3. Apparat ifølge krav 1 eller 2, **kendetegnet ved, at** transversalskæret (32) og/eller frontalskæret (36) er retlinet tildannet.
4. Apparat ifølge et af de foregående krav, **kendetegnet ved, at** transversalskæret (32) og/eller frontalskæret (36) er anbragt under en spids vinkel i forhold til bevægelsesbanen (26), især under en vinkel på fra 10°, 15° eller 20°.
5. Apparat ifølge et af de foregående krav, **kendetegnet ved, at** et op til spidsen (44) stødende begyndelsesområde på transversalskæret (32) og/eller frontalskæret (36) er stumt tildannede.

6. Apparat ifølge et af de foregående krav, **kendetegnet ved, at** transversalskæret (32) er tilknyttet et her overfor stående og i brystskrogets (4) bevægelsesretning under en spids vinkel med transversalskæret (32)
- 5 sammenløbende yderligere anbragt transversalskær (50) til udførelsen af et supplerende transversalsnit, især i transversalsnitplanet.
7. Apparat ifølge et af de foregående krav, **kendetegnet ved, at** der over og/eller under transversalskæret (32) er anbragt en mekanisk medbringer (52)
- 10 og/eller afstryger (74, 76) til bevægelsen af en fra brystskroget (4) helt eller delvist afskåret brystbrusk (24) i brystskrogets (4) bevægelsesretning og/eller til afstrygningen af transversalskæret (32).
8. Apparat ifølge et af foregående krav, **kendetegnet ved, at** medbringeren
- 15 (52) eller afstrygeren (74, 76) er koblet sammen med et over transversalskæret (32) anbragt drivelement (80), som er bevægeligt ved hjælp af transportindretninger (2) eller det ved hjælp heraf bevægede brystskrog.
9. Apparat ifølge krav 8, **kendetegnet ved, at** drivelementet og medbringeren
- 20 (52) hver for sig har radiale forløbende arme (54).
10. Fremgangsmåde til fjernelse af en brystbrusk (24) fra et fjerkræ-brystskrog (4), især under anvendelse af et apparat ifølge et af kravene 1-9, hvorved brystskroget (4) bevæges langs en retlinet, især vandret bevægelsesbane (26)
- 25 og et medianplan (20) i brystskroget (4) er rettet ind vinkelret på bevægelsesbanen (26), en stationært anbragt skæreindretning (30) med et transversalskær (32) og et frontalskær (36), hvorved transversalskæret (32) og frontalskæret (36) udgår fra en spids (44), som vender imod bevægelsesretningen (28), tilvejebringes, og ved det bevægede brystskrogs (4)
- 30 samvirken med transversalskæret (32) udføres et igennem brystbrusken (24) forløbende transversalsnit af den stationære skæreindretning (30), hvilket transversalsnit strækker sig i et vinkelret på medianplanet (20) anbragt transversalsnitplan, hvorved transversalsnitplanet sammen med et vinkelret på

medianplanet (20) anbragt transversalplan (24) i brystskroget (4) afgrænser en vinkel på op til 30°, og med frontalskæret (36) udføres et gennem brystbrusken forløbende frontalsnit, som forløber i et vinkelret på medianplanet (20) anbragt frontalsnitplan, hvorved frontalsnitplanet sammen med et vinkelret på medianplanet (20) og vinkelret på transportplanet (34) anbragt frontalplan (38) i brystskroget (4) afgrænser en vinkel på op til 30°, hvorved i det mindste en del af brystbrusken (24) afskæres fra brystskroget (4).

11. Fremgangsmåde ifølge krav 10, **kendetegnet ved, at** brystskroget (24) frontalplan (38) er rettet ind vinkelret eller inden for et vinkelområde på fra op til 10°, 15°, 20° eller 30° i forhold til lodret.

12. Fremgangsmåde ifølge krav 10 eller 11, **kendetegnet ved, at** transversalsnittet og frontalsnittet forløber fra et fælles udgangspunkt eller en fælles udgangslinje.

13. Fremgangsmåde ifølge et af kravene 10 til 12, **kendetegnet ved, at** transversal- og frontalsnittet udføres samtidig.

14. Fremgangsmåde ifølge et af kravene 10 til 13, **kendetegnet ved, at** der udføres et modsat transversalsnittet rettet yderligere transversalsnit, som kan forløbe i samme plan som transversalsnittet.

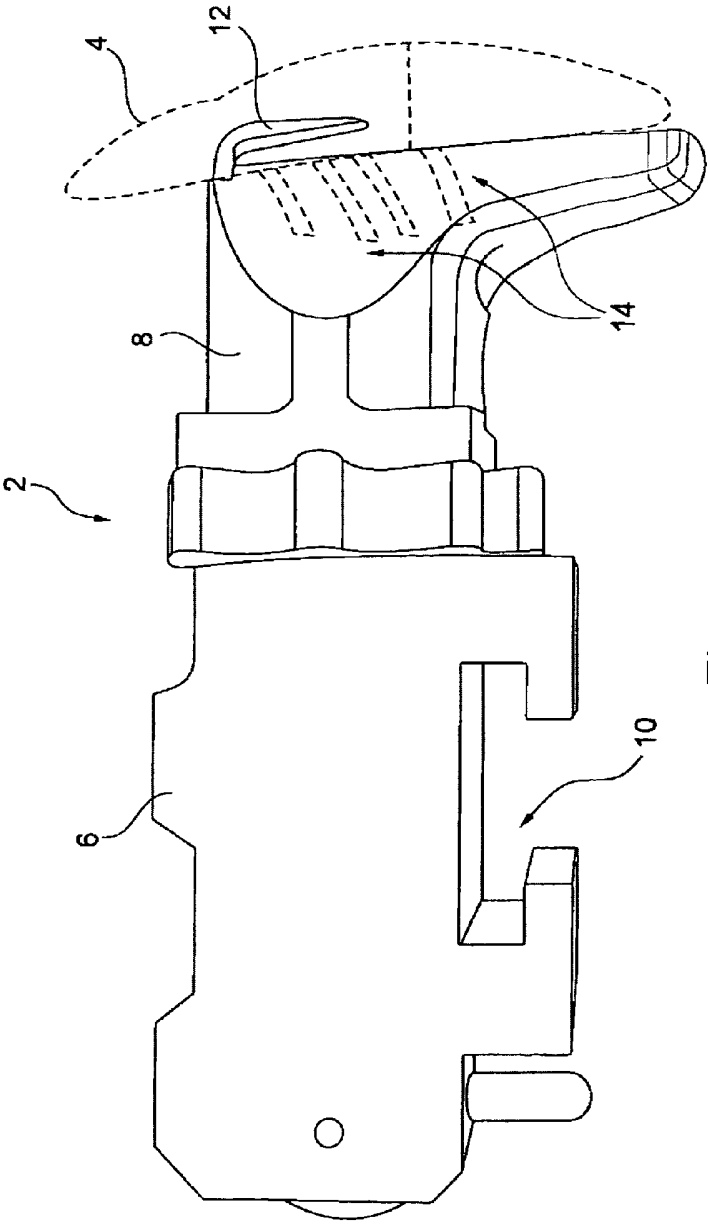

Fig. 1

2

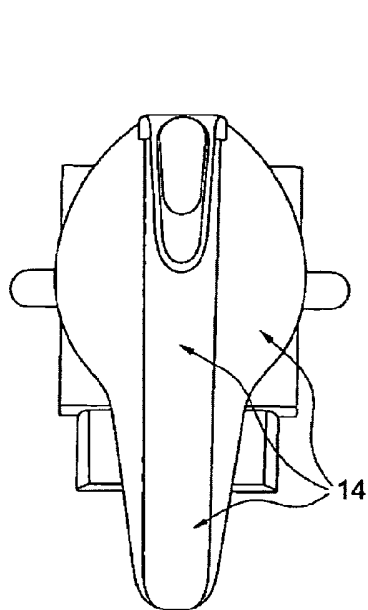

Fig. 2

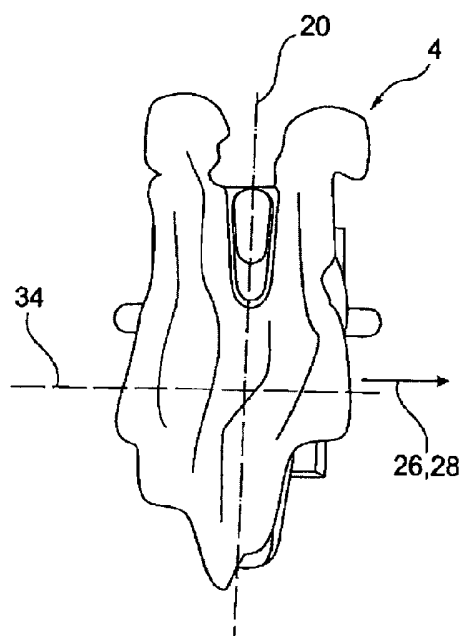

Fig. 7

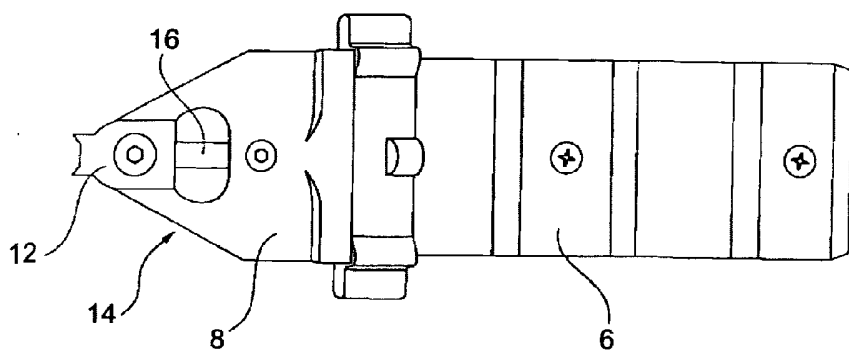

Fig. 3

3

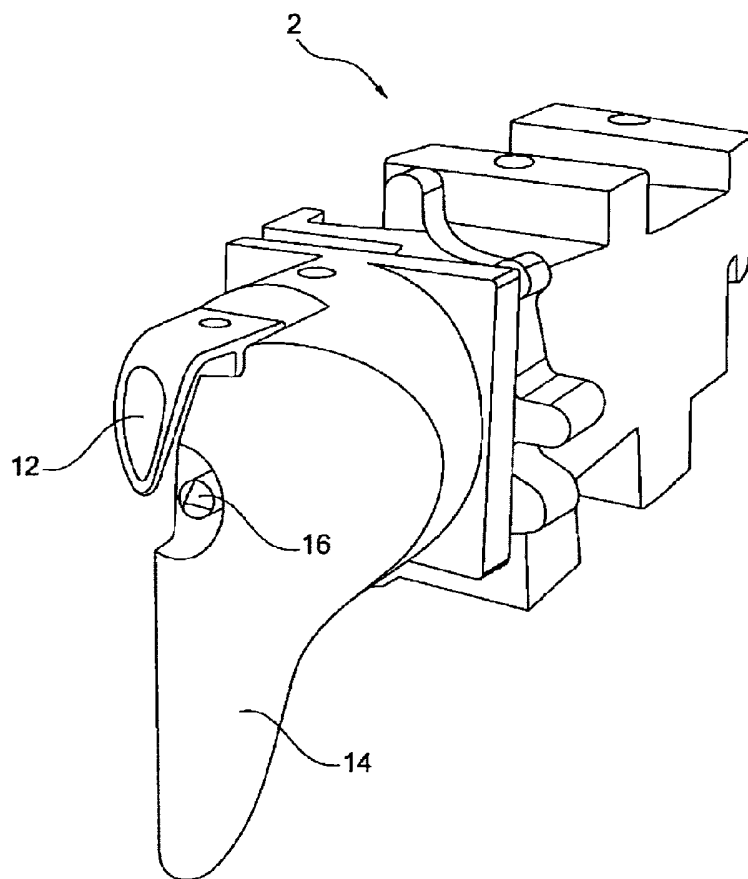

Fig. 4

4

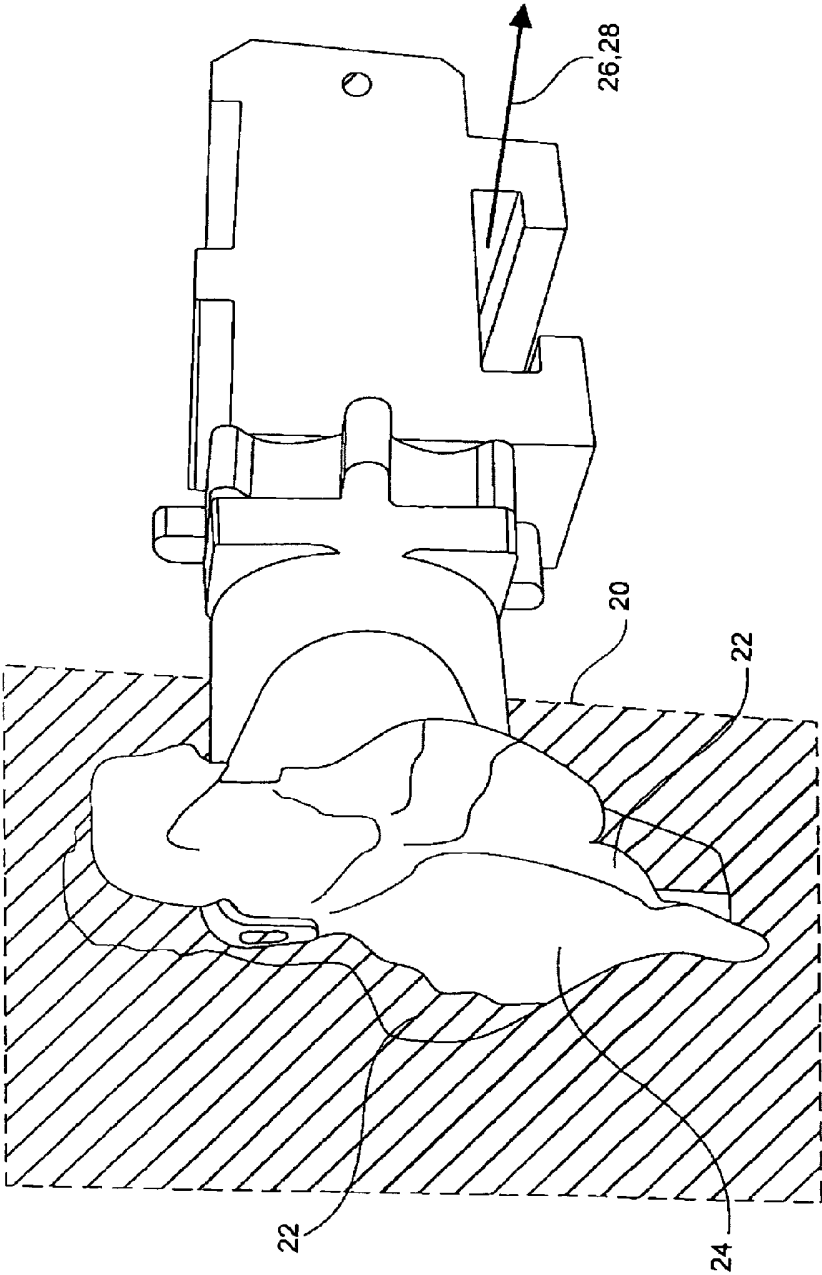
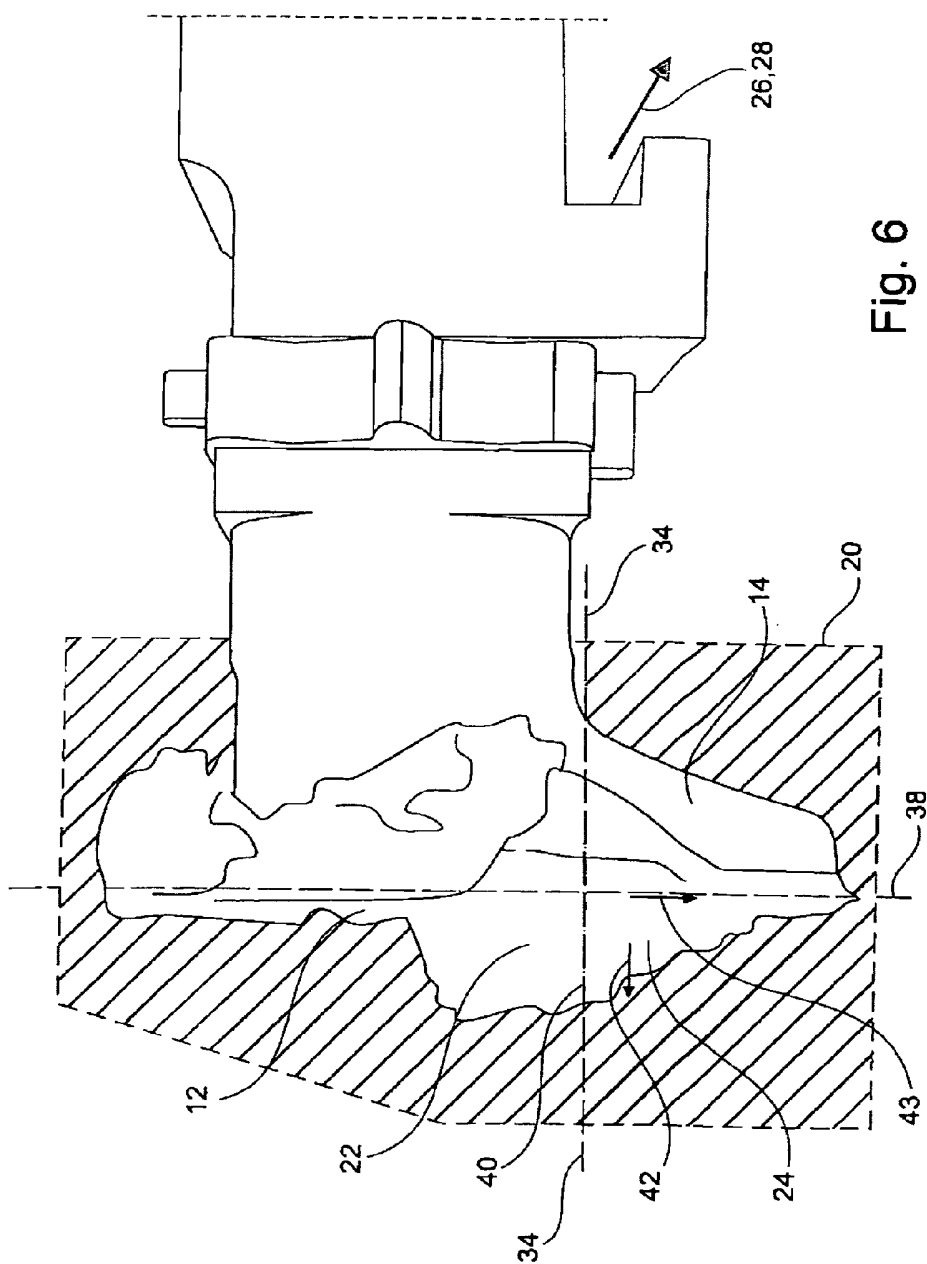

Fig. 5



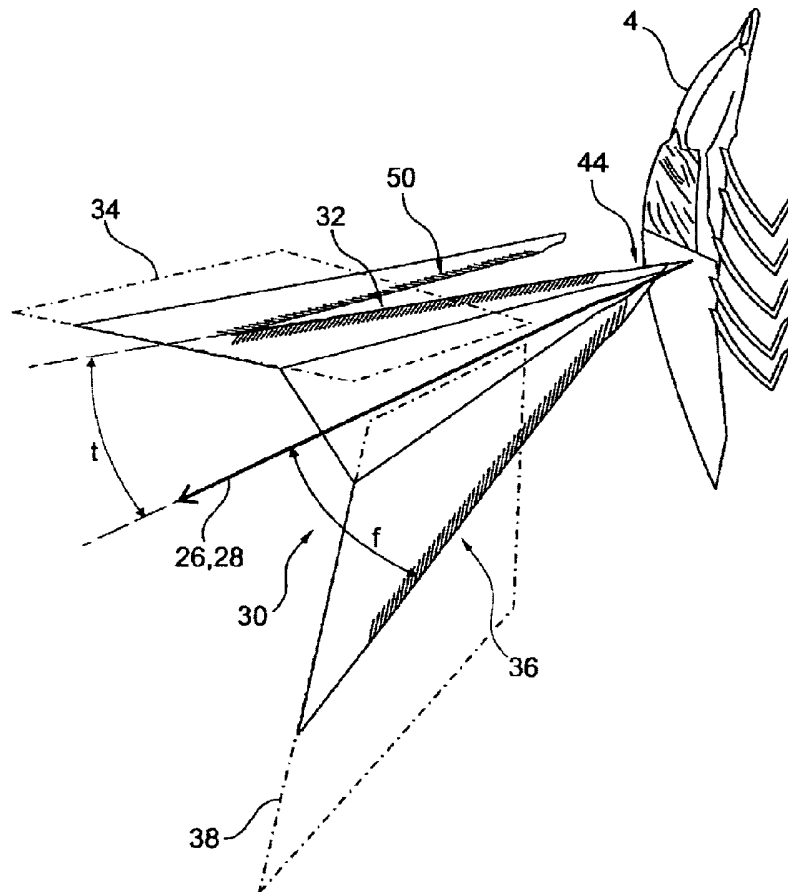

Fig. 8

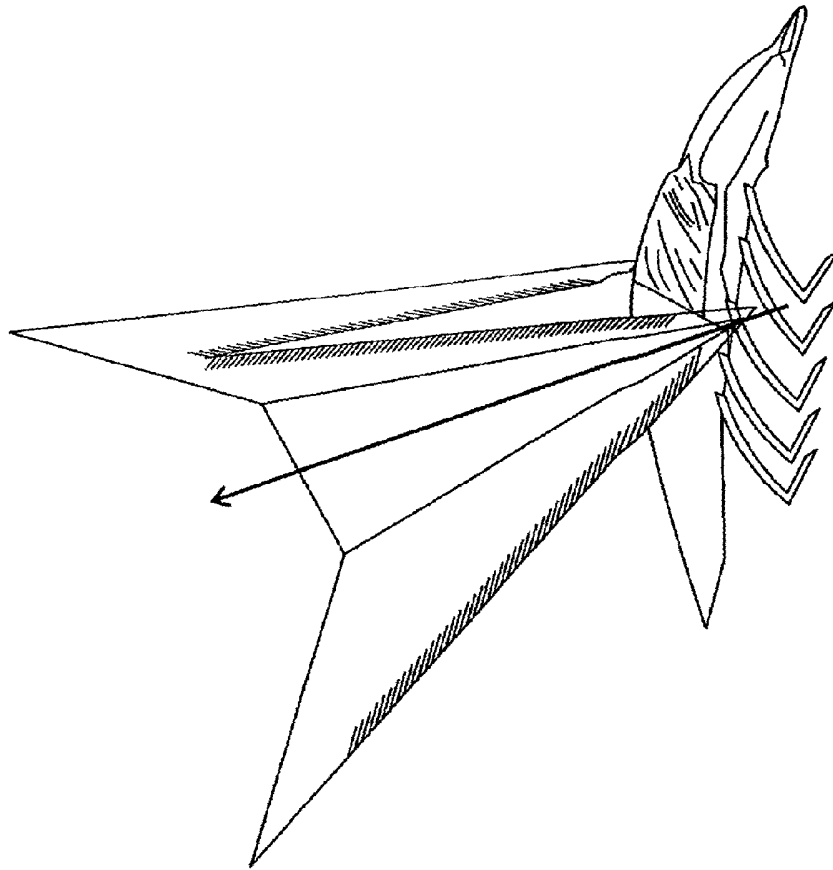

Fig. 9

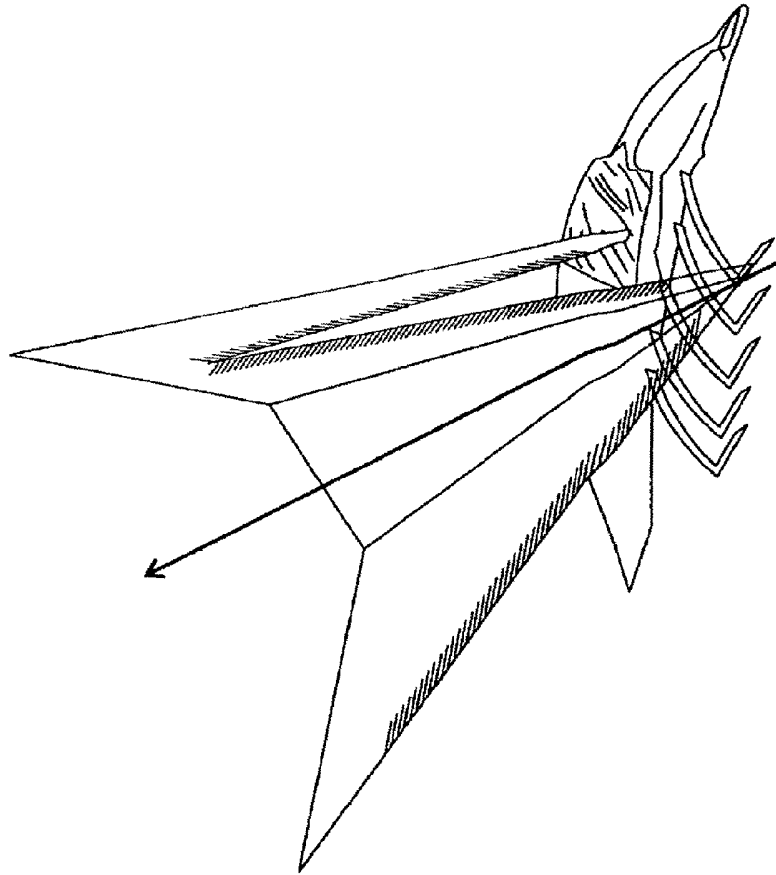

Fig. 10

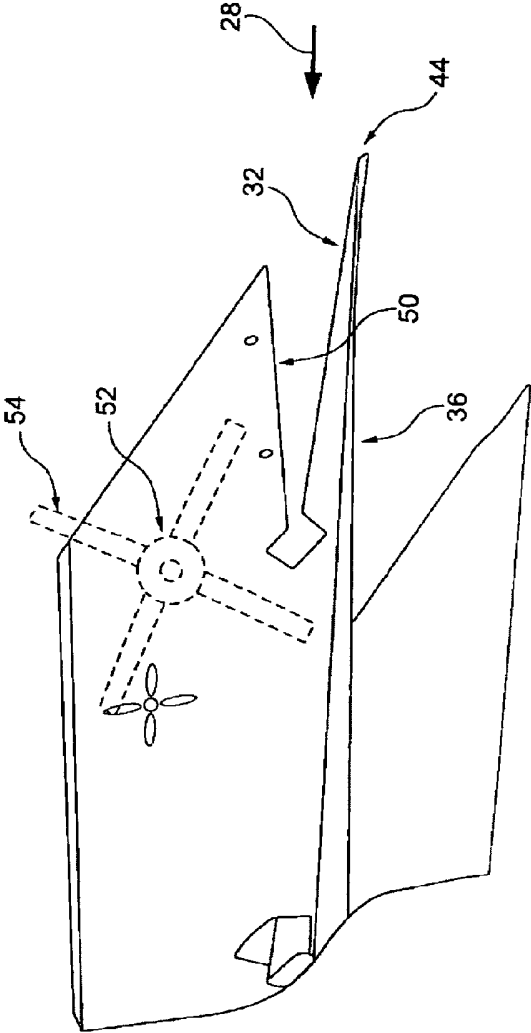
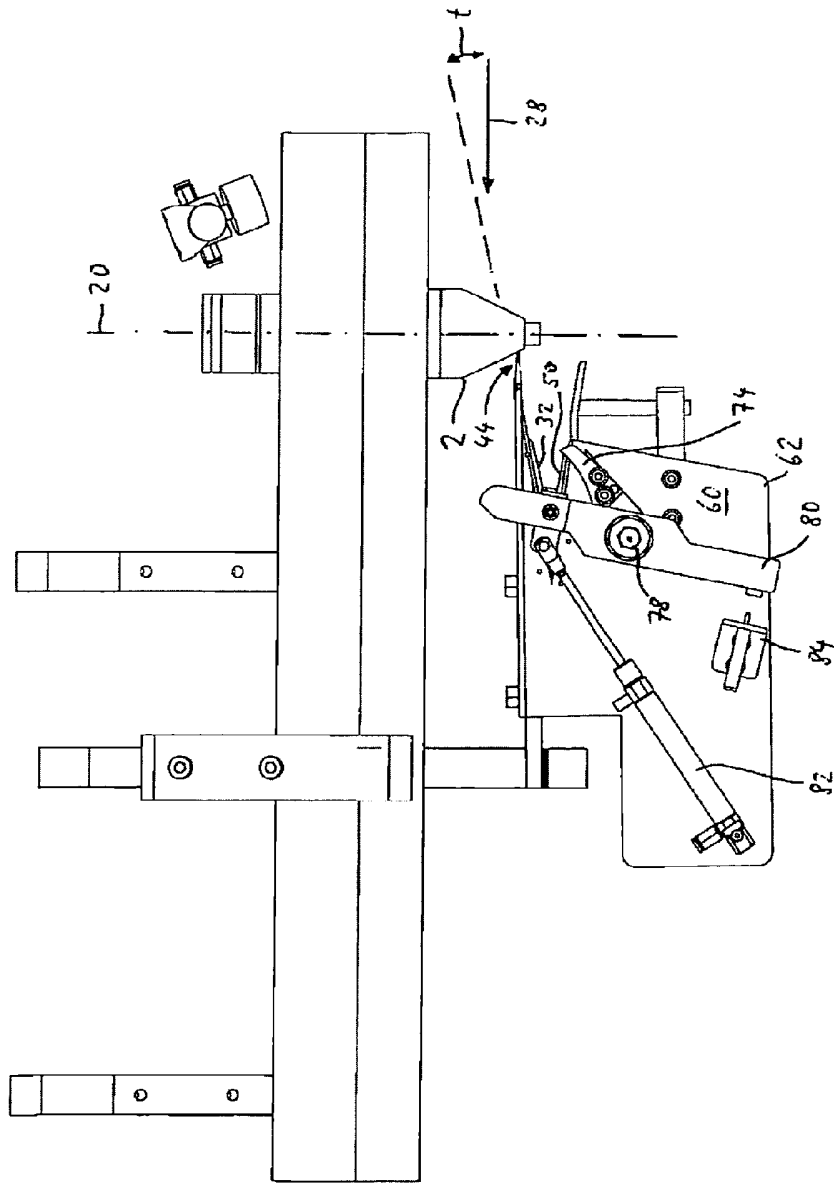

Fig. 11

Fig. 13



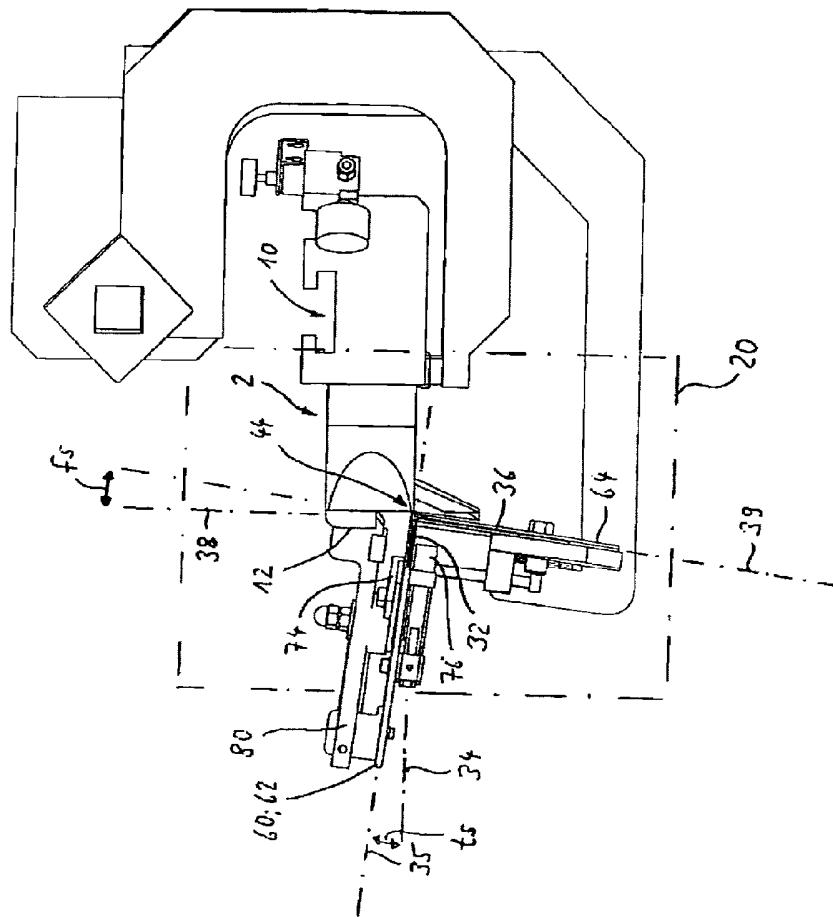

Fig. 14

Fig. 15

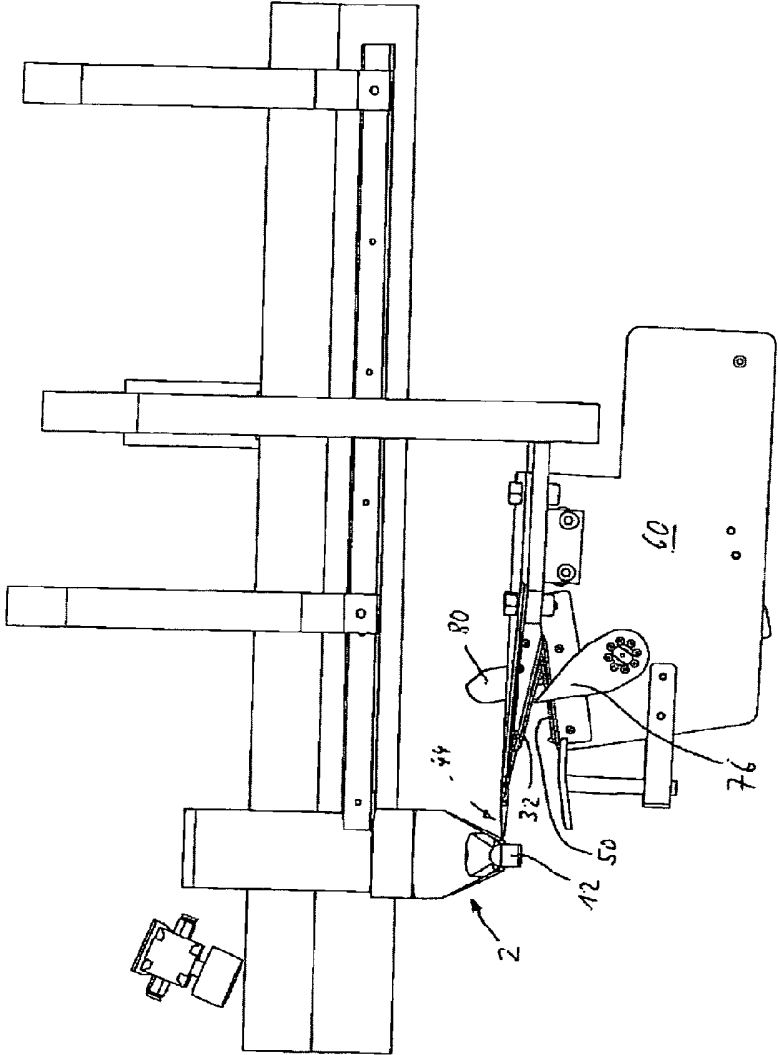

Fig. 16

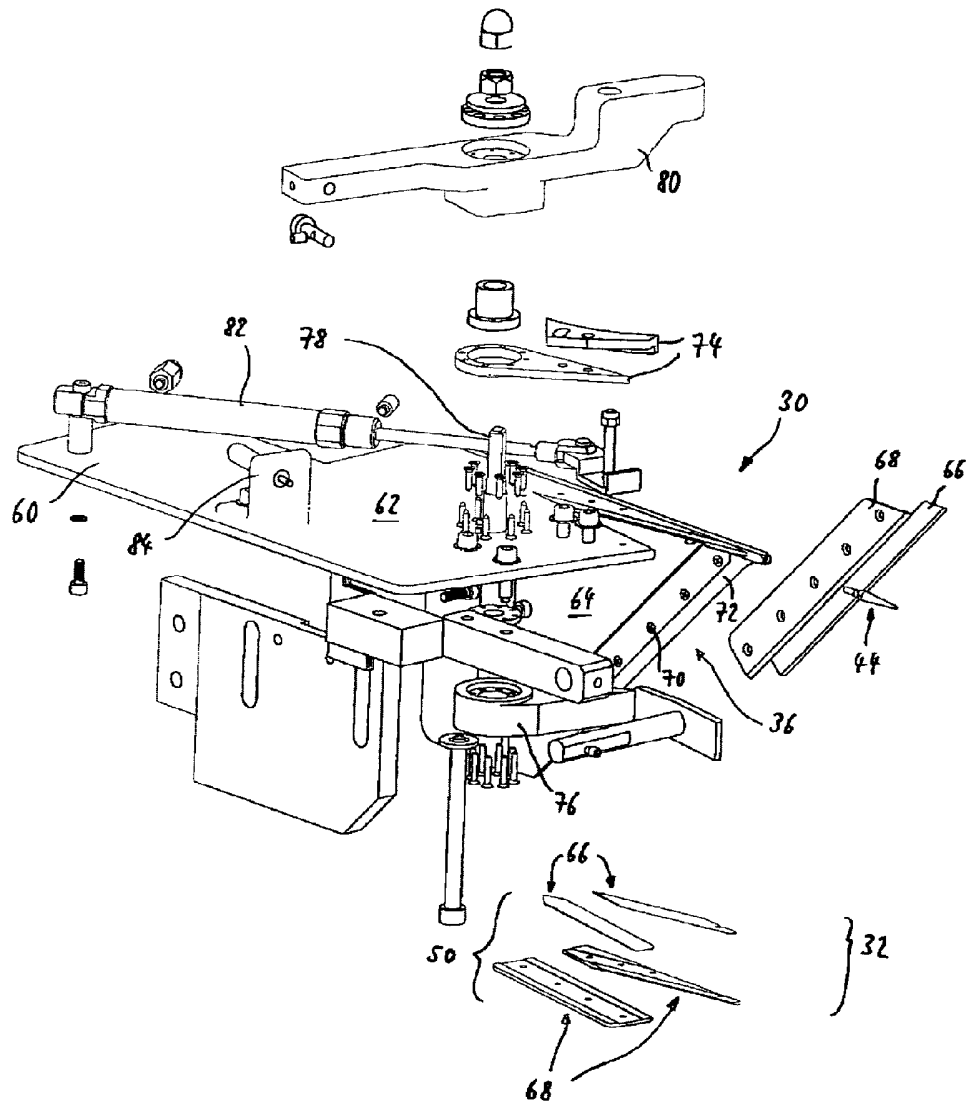

Fig. 17

