

12 **EUROPEAN PATENT APPLICATION**

21 Application number: **87301876.6**

51 Int. Cl.4: **A45D 40/26 , A45D 40/24**

22 Date of filing: **04.03.87**

30 Priority: **06.03.86 US 838227**

43 Date of publication of application:
09.09.87 Bulletin 87/37

64 Designated Contracting States:
AT BE CH DE FR GB GR IT LI NL SE

68 Date of deferred publication of the search report:
23.11.88 Bulletin 88/47

71 Applicant: **CHESEBROUGH-POND'S INC.**
Nyala Farm Road
Westport Connecticut 06881(US)

72 Inventor: **Pettengill, Edwin Raymond**
222B Shoshoni Lane
Stratford Connecticut 06497(US)

74 Representative: **Froud, Clive et al**
Elkington and Fife High Holborn House 52/54
High Holborn
London WC1V 6SH(GB)

54 **Mascara applicator.**

57 A mascara applicator is described which comprises a reservoir (11) for mascara containing dual side-by-side openings (15a, 15b) for the mascara and a handle (12) integrally connected to two substantially straight application brushes (13a, 13b) which are adapted to be placed in the openings to receive mascara on the brushes.

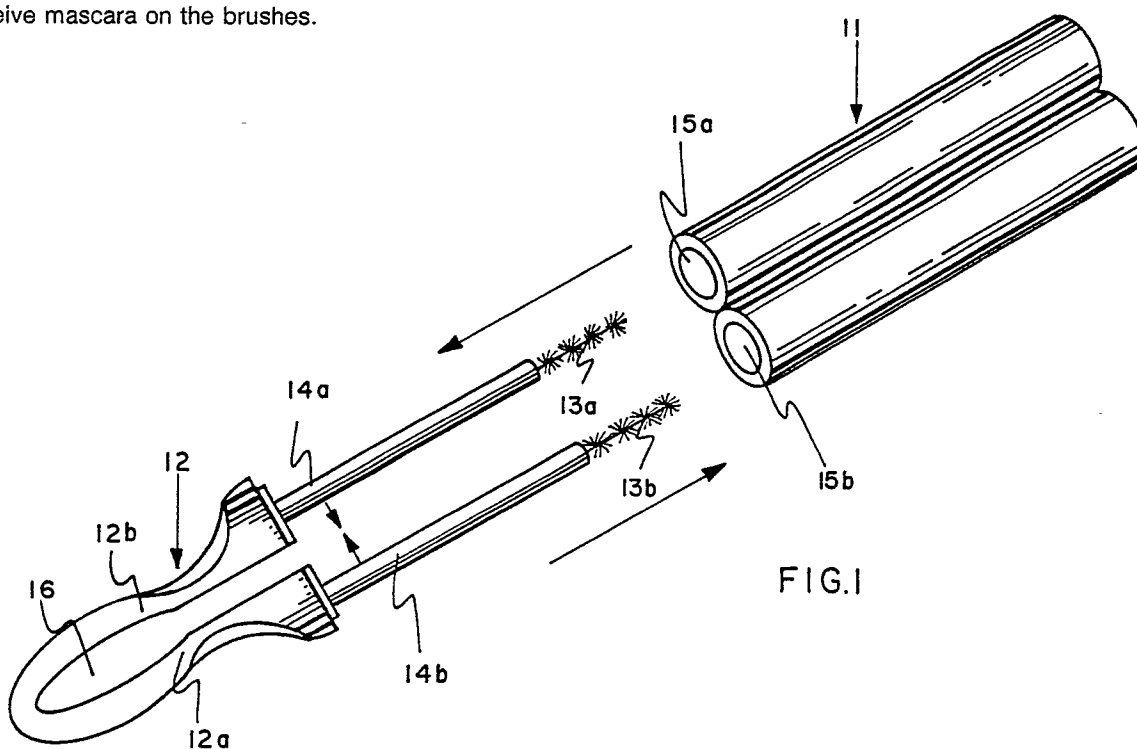

EP 0 236 133 A3



DOCUMENTS CONSIDERED TO BE RELEVANT			
Category	Citation of document with indication, where appropriate, of relevant passages	Relevant to claim	CLASSIFICATION OF THE APPLICATION (Int. Cl.4)
E	DE-A-3 610 007 (BUBLITZ) * Whole document *	1-5,8	A 45 D 40/26 A 45 D 40/24
A	DE-C- 820 792 (HEROLD) * Whole document *	1-6	
A	FR-A- 850 370 (BODIN) * Figures 1,5 *	1	
D,A	US-A-4 458 701 (HOLLAND)		
A	DE-A-3 240 152 (G. KARL)		
A	FR-A- 354 335 (TOBEL)		
A	FR-A- 801 333 (NATHANS)		
			TECHNICAL FIELDS SEARCHED (Int. Cl.4)
			A 45 D B 65 D
The present search report has been drawn up for all claims			
Place of search THE HAGUE		Date of completion of the search 08-09-1988	Examiner SIGWALT C.
CATEGORY OF CITED DOCUMENTS		T : theory or principle underlying the invention E : earlier patent document, but published on, or after the filing date D : document cited in the application L : document cited for other reasons & : member of the same patent family, corresponding document	
X : particularly relevant if taken alone Y : particularly relevant if combined with another document of the same category A : technological background O : non-written disclosure P : intermediate document			