

(51) International Patent Classification:  
*A61B 1/005* (2006.01)(21) International Application Number:  
PCT/US2015/047334(22) International Filing Date:  
28 August 2015 (28.08.2015)

(25) Filing Language: English

(26) Publication Language: English

(30) Priority Data:  
62/043,647 29 August 2014 (29.08.2014) US  
62/066,760 21 October 2014 (21.10.2014) US

(71) Applicant: ENDOCHOICE, INC. [US/US]; 11810 Wills Rd., Alpharetta, GA 30009 (US).

(72) Inventors: SALMAN, Golan; Halochamim 108, 3030000 Atlit (IL). SHTEIMAN, Igal; 50 Odem Street, Pob 5308, 4034733 Kfar Yona (IL). SCHWARCZ, Hadar; 2 Kislef, Apartment 11, 4256304 Netanya (IL). AVRO, Jeruham; 36 Holland Street, 34987 Haifa (IL). STEPHEN, Christopher; 1621 Liberty Lane, Roswell, GA 30075 (US).

(74) Agent: DALAL, Sona; Novel IP, 191 West Second Street, Santa Ana, CA 92701 (US).

(81) Designated States (*unless otherwise indicated, for every kind of national protection available*): AE, AG, AL, AM,

AO, AT, AU, AZ, BA, BB, BG, BH, BN, BR, BW, BY, BZ, CA, CH, CL, CN, CO, CR, CU, CZ, DE, DK, DM, DO, DZ, EC, EE, EG, ES, FI, GB, GD, GE, GH, GM, GT, HN, HR, HU, ID, IL, IN, IR, IS, JP, KE, KG, KN, KP, KR, KZ, LA, LC, LK, LR, LS, LU, LY, MA, MD, ME, MG, MK, MN, MW, MX, MY, MZ, NA, NG, NI, NO, NZ, OM, PA, PE, PG, PH, PL, PT, QA, RO, RS, RU, RW, SA, SC, SD, SE, SG, SK, SL, SM, ST, SV, SY, TH, TJ, TM, TN, TR, TT, TZ, UA, UG, US, UZ, VC, VN, ZA, ZM, ZW.

(84) Designated States (*unless otherwise indicated, for every kind of regional protection available*): ARIPO (BW, GH, GM, KE, LR, LS, MW, MZ, NA, RW, SD, SL, ST, SZ, TZ, UG, ZM, ZW), Eurasian (AM, AZ, BY, KG, KZ, RU, TJ, TM), European (AL, AT, BE, BG, CH, CY, CZ, DE, DK, EE, ES, FI, FR, GB, GR, HR, HU, IE, IS, IT, LT, LU, LV, MC, MK, MT, NL, NO, PL, PT, RO, RS, SE, SI, SK, SM, TR), OAPI (BF, BJ, CF, CG, CI, CM, GA, GN, GQ, GW, KM, ML, MR, NE, SN, TD, TG).**Published:**

- with international search report (Art. 21(3))
- before the expiration of the time limit for amending the claims and to be republished in the event of receipt of amendments (Rule 48.2(h))

(54) Title: SYSTEMS AND METHODS FOR VARYING STIFFNESS OF AN ENDOSCOPIC INSERTION TUBE

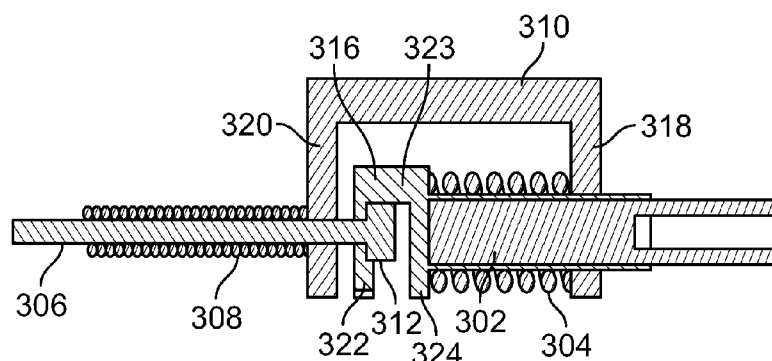
**FIG. 3b**

(57) **Abstract:** The specification describes endoscopes that enable varying stiffness of an insertion portion in an endoscope assembly. In one example, an actuator operates either a spring or a flexible tube to vary stiffness of the insertion portion. In alternative examples, an elliptical wheel arrangement or screw mechanism provides a means to increase stiffness of the insertion portion of an endoscope assembly. In further examples, fluid and gas may be used inside the insertion portion to vary stiffness by varying pressure of the fluid/gas.

## SYSTEMS AND METHODS FOR VARYING STIFFNESS OF AN ENDOSCOPIC INSERTION TUBE

### **CROSS-REFERENCE**

5           The present specification relies on United States Patent Provisional Application No. 62/043,647, filed on August 29, 2014, for priority and is hereby incorporated by reference in its entirety.

          The present specification also relies on United States Patent Provisional Application 62/066,760, filed on October 21, 2014, for priority and is hereby incorporated by reference in its  
10   entirety.

### **FIELD**

          The present specification generally relates to an endoscope unit having an insertion portion whereby the stiffness of the insertion portion can be varied.

### **BACKGROUND**

          Endoscopes have attained great acceptance within the medical community, since they provide a means to perform procedures with minimal patient trauma, while enabling the physician to view the internal anatomy of the patient. Over the years, numerous endoscopes  
20   have been developed and categorized according to specific applications, such as cystoscopy, colonoscopy, laparoscopy, upper GI endoscopy and others. Endoscopes may be inserted into the body's natural orifices or through an incision in the skin.

          An endoscope is usually an elongated tubular shaft, rigid or flexible, having one or more video cameras or fiber optic lens assemblies at its distal end. The shaft is connected to a handle,  
25   which sometimes includes an ocular for direct viewing. Viewing is also usually possible via an external screen. Various surgical tools may be inserted through a working channel in the endoscope to perform different surgical procedures.

          Endoscopes may have a front camera and a side camera to view the internal organ, such as the colon, illuminators for each camera, one or more fluid injectors to clean the camera  
30   lens(es) and sometimes also the illuminator(s) and a working channel to insert surgical tools, for example, to remove polyps found in the colon. Often, endoscopes also have fluid injectors

("jet") to clean a body cavity, such as the colon, into which they are inserted. The illuminators commonly used are fiber optics which transmit light, generated remotely, to the endoscope tip section. The use of light-emitting diodes (LEDs) for illumination is also known.

The elongated tubular shaft, also known as the insertion portion of the endoscope has a  
5 bending section, proximal to a distal end of the shaft that can bend upon application of an external control to navigate a curved path inside a body cavity, or to access difficult areas within the cavity. However, sometimes it is desirable to vary the degree of bending, based on the application or based on the region inside the body cavity where a distal end of the shaft is navigating. A stiffer insertion portion may reduce the chances of looping of the tubular shaft  
10 inside the body cavity, whereas a softer insertion portion may make it easier to reach the cecum. Lack of the ability to vary the stiffness of the insertion portion, such as around the bending portion, could result in patient discomfort and/or increased time for endoscopic examinations. Additionally, some physicians may prefer using a stiffer insertion portion, while some others may prefer a flexible insertion portion. Moreover, repeated reprocessing of parts of endoscope,  
15 including its cleaning, may influence the flexible characteristics of the insertion portion. As a result, the insertion portion may become more flexible than required with each time it is cleaned.

United States Patent Number 7,789,827, assigned to Storz, discloses "a flexible endoscope comprising: a flexible shaft portion having a distal and a proximal end and including an outer layer comprising an electrically insulated water-tight material, an inner layer enclosed  
20 by said outer layer, a plurality of elongated segments disposed in said outer layer and comprising a polymer material that changes characteristics upon the application of an electrical current, a handle portion coupled to said flexible shaft portion, an electrical source for providing the electrical current to said at least one elongated segment, and electrical conductors electrically connected between said plurality of elongated segments and said electrical source, said electrical  
25 conductors extending from said flexible shaft portion through said handle portion to said electrical source, wherein said plurality of elongated segments are positioned in said outer layer in an end-to-end fashion along a longitudinal length of said flexible shaft portion and each elongated segment has at least one end affixed to said inner layer such that upon an application of electrical current to said plurality of elongated segments, said plurality of elongated segments  
30 change physical dimension, and wherein said inner layer moves relative to said outer layer based on the dimensional change of at least one of said plurality of elongated segments." However, the

'827 patent does not provide a complete mechanical control of the flexibility of the insertion portion.

Thus, what is needed is an insertion portion with an ability to vary its stiffness or flexibility, with minor modifications to the existing structure, shape, size, and manufacturing complexity. Additionally, what is needed is a flexible shaft with an insertion portion that may utilize material available with an endoscope system.

## **SUMMARY**

The following embodiments and aspects thereof are described and illustrated in conjunction with systems, tools and methods, which are meant to be exemplary and illustrative, not limiting in scope.

The present specification discloses various endoscope assemblies comprising an element of variable stiffness embedded within an insertion portion of the endoscope assembly and a controller to vary stiffness of the element.

The present specification discloses an endoscope assembly comprising an insertion portion that is connected to a handle at a proximal end of the insertion portion and a bending portion at a distal end of the insertion portion, comprising: a screw configured to rotate around a longitudinal axis of the endoscope assembly; a housing in physical communication with the screw, wherein the housing is configured to move in a direction that is at least one of a distal direction and a proximal direction along the longitudinal axis of the endoscope assembly, with the rotation of the screw; a stopper placed within the housing; and a wire having a proximal end and a distal end, wherein the proximal end of the wire is connected to the stopper, the wire stretches along a length of the insertion portion, and the distal end of the wire is connected to a proximal end of the bending portion and wherein the wire stiffens the insertion portion upon rotation of the screw towards distal end of the insertion portion.

Optionally, the wire is placed inside a coil fixed to an internal periphery of the insertion portion.

Optionally, the endoscope assembly further comprises a housing containing at least one of the screw, the internal housing, the stopper, and the wire.

Optionally, the endoscope assembly further comprises a knob located in the handle and in physical communication with the screw, wherein a rotation of the knob causes a rotation of the screw.

5           The stopper may be configured within said housing such that a proximal movement of the housing causes said stopper to move proximally and such that a distal movement of the housing causes the stopper to move distally.

Movement of the wire may cause at least one of the pitch, degree of expansion, degree of compression, and flexibility of the coil to change.

10           Movement of the wire may cause at least one of the tensile strength, flexibility, or compressibility of the bending portion to change.

Optionally, the housing is positioned around the longitudinal axis of the screw and is configured to move longitudinally along said axis.

15           The present specification also discloses an endoscope assembly comprising an insertion portion that is connected to a handle at a proximal end of the insertion portion and a bending portion at a distal end of the insertion portion, comprising: an actuator; a spring, having a proximal end and a distal end, wherein the proximal end of the spring is connected to the actuator and wherein the actuator activates the spring; and, a wire, having a proximal end and a distal end, with the proximal end of the wire connected to the distal end of the spring, wherein  
20           the wire stretches along a length of the insertion portion and wherein the distal end of the wire is connected to a proximal end of the bending portion, and wherein the wire stiffens the insertion portion upon activation of the spring.

The spring may comprise superelastic material. Optionally, the superelastic material is Nitinol.

25           Optionally, the actuator is connected to an electric current source that activates the spring. Optionally, the actuator is connected to a heat source that activates the spring. Still optionally, the actuator is connected to a gear motor that activates the spring.

Optionally, the endoscope assembly further comprises a shaft connecting the spring and the wire. The shaft may have a U-shaped structure comprising: a first wall connected to distal  
30           end of the spring; and a second wall, parallel to the first wall, connected to the proximal end of the wire.

The wire may be placed inside a coil fixed to an internal periphery of the insertion portion.

Optionally, the endoscope assembly further comprises a housing containing at least one of the actuator, the spring, and the wire.

5       The present specification also discloses an endoscope assembly comprising an insertion portion that is connected to a handle at a proximal end of the insertion portion and a bending portion at a distal end of the insertion portion, comprising: an actuator; a tube with slits centered and stretching along its longitudinal axis across a portion of its length, the tube having a proximal end and a distal end, wherein the proximal end of the tube is connected to the actuator, 10 and wherein the actuator activates the tube; and, a wire, having a proximal end and a distal end, the proximal end of the wire connected to the tube, wherein the wire stretches along a length of the insertion portion and the distal end of the wire is connected to a proximal end of the bending portion, wherein the wire stiffens the insertion portion upon activation of the tube.

15       The tube may be manufactured with a superelastic material. Optionally, the superelastic material is Nitinol.

20       The present specification also discloses an endoscope assembly comprising an insertion portion that is connected to a handle at a proximal end of the insertion portion and a bending portion at a distal end of the insertion portion, comprising: a wheel, approximately shaped as an ellipse, wherein said wheel further comprises a first portion, a second portion, and a center portion; a shaft connected to a center of the wheel; a lever connected to the shaft, wherein rotation of the lever rotates the shaft and the wheel; a wire having a proximal end and a distal end, wherein the proximal end of the wire rests on an edge of the wheel, the wire stretches along a length of the insertion portion and the distal end of the wire is connected to a proximal end of the bending portion and wherein the wire stiffens the insertion portion upon rotation of the 25 wheel; and a stopper connected to the proximal end of the wire, wherein the stopper anchors the wire with the wheel.

Optionally, the wire is placed inside a coil fixed to an internal periphery of the insertion portion.

30       The present specification also discloses an endoscope assembly comprising a working channel, wherein the outer periphery of the working channel is covered with an enforcement layer providing stiffness to the working channel.

Optionally, the enforcement layer is manufactured from a material comprising at least one metal from family of stainless steel metals.

5 The present specification also discloses an insertion portion in an endoscope assembly, comprising: at least one flexible tube extending from a proximal end of the insertion portion along length of the insertion portion; a pressure pump connected to the at least one flexible tube at the proximal end of the insertion portion; and a fluid inflating the at least one flexible tube, wherein a pressure of the fluid is controlled by the pressure pump.

10 Optionally, the fluid is at least one of water, a fluid that changes viscosity based on an applied electric field, a fluid that changes viscosity based on shear rate or shear rate history, a fluid that changes viscosity based on a magnetic field, and a fluid that changes viscosity based on exposure to light.

The fluid may be water sourced from a water supply of the endoscope assembly.

Optionally, varying an operating voltage of the pressure pump controls pressure of the fluid.

15 A pressure regulator may be connected to the pressure pump to control pressure of the fluid.

Optionally, the at least one flexible tube extending from a proximal end of the insertion portion extends up to a proximal end of bending section of the insertion portion and not into a tip section of the endoscope assembly.

20 Optionally, the at least one flexible tube extending from a proximal end of the insertion portion extends up to a distal end of the insertion portion.

Still optionally, the at least one flexible tube extending from a proximal end of the insertion portion extends up to an opposite end of the flexible tube, wherein the opposite end is sealed.

25 The pressure pump may control pressure of the fluid to control flexibility of the at least one flexible tube.

The present specification also discloses an insertion portion in an endoscope assembly, comprising: a flexible tube coiled around an outer circumferential surface of a treatment tool insertion channel embedded inside the insertion portion, the coiled tube extending from a proximal end of the insertion portion along a length of the insertion portion; a pressure pump

30

connected to the flexible tube at the proximal end of the insertion portion; and a fluid inflating the flexible tube, wherein a pressure of the fluid is controlled by the pressure pump.

Optionally, the fluid is at least one of water, a fluid that changes viscosity based on an applied electric field, a fluid that changes viscosity based on shear rate or shear rate history, a fluid that changes viscosity based on a magnetic field, and a fluid that changes viscosity based on exposure to light.

The fluid may be water sourced from a water supply of the endoscope assembly.

Optionally, varying an operating voltage of the pressure pump controls pressure of the fluid.

A pressure regulator may be connected to the pressure pump to control pressure of the fluid.

Optionally, the flexible tube extending from a proximal end of the insertion portion extends up to a proximal end of bending section of the insertion portion and not into said tip section.

Optionally, the flexible tube extending from a proximal end of the insertion portion extends only up to a distal end of the insertion portion.

Still optionally, the flexible tube extending from proximal end of the insertion portion extends up to an opposite end of the flexible tube, wherein the opposite end is sealed.

The pressure pump may control pressure of the fluid to control flexibility of the flexible tube.

The present specification also discloses an insertion portion in an endoscope assembly, comprising: at least one flexible lining stretching along an inner wall of the insertion portion, the flexible lining forming a parallel wall inside the insertion portion such that a gap exists between the parallel wall and the inner wall of the insertion portion, and extending from a proximal end of the insertion portion along a length of the insertion portion; a pressure pump connected to the gap at the proximal end of the insertion portion; and a fluid filling the gap, wherein a pressure of the fluid is controlled by the pressure pump.

The present specification also discloses an insertion portion in an endoscope assembly, comprising: at least one flexible tube extending from a proximal end of the insertion portion along a length of the insertion portion, wherein the flexible tube encloses a gas; at least one sealed chamber into which the at least one flexible tube opens and carries gas into the at least one



sealed chamber; and a pressure pump connected to the at least one flexible tube at the proximal end of the insertion portion, wherein a pressure of gas is controlled by the pressure pump.

Optionally, the gas is air.

Optionally, three flexible tubes open into three corresponding sealed chambers.

5 Each chamber may be located adjacent to one another along a longitudinal axis of the insertion portion.

Each chamber may be concentrically located along a longitudinal axis of the insertion portion.

The aforementioned and other embodiments of the present specification shall be described in greater depth in the drawings and detailed description provided below.

10

### **BRIEF DESCRIPTION OF THE DRAWINGS**

These and other features and advantages of the present specification will be further appreciated, as they become better understood by reference to the detailed description when considered in connection with the accompanying drawings:

15 Figure 1 shows a multiple viewing elements endoscopy system, in accordance with some embodiments;

Figure 2 shows a view of a scope handle of an endoscope, in accordance with some embodiments;

20 Figure 3a illustrates a cross-sectional view of a portion of the handle extending from near working channel-opening towards beginning of the insertion portion, in accordance with some embodiments;

Figure 3b illustrates another cross-sectional view of a spring and related arrangements in accordance with some embodiments;

Figure 4a illustrates an exemplary embodiment of an energy source for an actuator;

25 Figure 4b illustrates another exemplary embodiment of an energy source for an actuator;

Figure 4c illustrates yet another exemplary embodiment of an energy source for an actuator;

Figure 4d illustrates still another exemplary embodiment of an energy source for an actuator;

30 Figure 5a illustrates another cross-sectional view of the spring and related arrangements described in context of Figures 3 and 4, in accordance with some embodiments;

Figure 5b shows an exemplary display illustrating a degree of stiffness of an insertion tube, in accordance with some embodiments;

Figure 6 illustrates an alternative embodiment of an arrangement to influence variable stiffness of an insertion portion in an endoscope;

5        Figure 7a illustrates a portion of an endoscope handle with an elliptical wheel arrangement that enables variable stiffness of an insertion portion of an endoscope, in accordance with some embodiments;

Figure 7b illustrates a perspective view of the endoscope handle with the elliptical wheel arrangement of Figure 7a, in accordance with some embodiments;

10       Figure 7c illustrates an enlarged view of the elliptical wheel arrangement, in accordance with some embodiments;

Figure 8a illustrates a cross-sectional view of yet another embodiment of a screw mechanism within a handle portion of an endoscope, in accordance with some embodiments;

15       Figure 8b illustrates a cross-sectional view of yet another embodiment of a screw mechanism within a handle portion of an endoscope, in accordance with some embodiments;

Figure 9 illustrates a three-dimensional view of the screw mechanism of Figures 8a and 8b, in accordance with some embodiments;

Figure 10 illustrates a housing and a screw mechanism placed within an opening of a handle of an endoscope, in accordance with some embodiments;

20       Figure 11a illustrates another embodiment of a mechanism that reinforces the stiffness of an insertion portion of an endoscope, in accordance with some embodiments;

Figure 11b illustrates another view of the embodiment of Figure 11a, in accordance with some embodiments;

25       Figure 12 shows a longitudinal cross-sectional view of a portion of an elongated shaft in an endoscope in accordance with some embodiments;

Figure 13a illustrates an embodiment of a sealing mechanism used to seal a flexible lining within an insertion portion;

Figure 13b illustrates another embodiment a sealing mechanism used to seal a flexible lining within an insertion portion;

30       Figure 13c illustrates another embodiment a sealing mechanism used to seal a flexible lining within an insertion portion;

Figure 13d illustrates another embodiment a sealing mechanism used to seal a flexible lining within an insertion portion;

Figure 14 shows a cross-sectional view of a portion of an elongated shaft in an endoscope in accordance with another embodiment;

5        Figure 15 shows a cross-sectional view of a portion of an elongated shaft in an endoscope in accordance with yet another embodiment;

Figure 16a shows a longitudinal cross-sectional view of a portion of an elongated shaft in an endoscope in accordance with another embodiment;

10       Figure 16b shows a longitudinal cross-sectional view of a portion of an elongated shaft in an endoscope in accordance with another embodiment;

Figure 16c shows a longitudinal cross-sectional view of a portion of an elongated shaft in an endoscope in accordance with another embodiment; and

Figure 16d shows a longitudinal cross-sectional view of a portion of an elongated shaft in an endoscope in accordance with another embodiment.

15

#### **DETAILED DESCRIPTION**

The present specification is directed towards multiple embodiments. The following disclosure is provided in order to enable a person having ordinary skill in the art to practice the specification. Language used in this specification should not be interpreted as a general  
20       disavowal of any one specific embodiment or used to limit the claims beyond the meaning of the terms used therein. The general principles defined herein may be applied to other embodiments and applications without departing from the spirit and scope of the specification. Also, the terminology and phraseology used is for the purpose of describing exemplary embodiments and should not be considered limiting. Thus, the present specification is to be accorded the widest  
25       scope encompassing numerous alternatives, modifications and equivalents consistent with the principles and features disclosed. For purpose of clarity, details relating to technical material that is known in the technical fields related to the specification have not been described in detail so as not to unnecessarily obscure the present specification.

It is noted that the term "endoscope" as mentioned to herein may refer particularly to a colonoscope and a gastroscope, according to some embodiments, but is not limited only to colonoscopes and/or gastroscopes. The term "endoscope" may refer to any instrument used to examine the interior of a hollow organ or cavity of the body, provided it further includes an insertion section, bending portion, and viewing tip as described herein.

Reference is now made to Figure 1, which shows a multiple viewing elements endoscopy system 400, in accordance with some embodiments. System 400 may include a multiple viewing elements endoscope 402, having a multiple viewing elements tip section 408. Multiple viewing elements endoscope 402 may include a handle 404, from which an elongated shaft 406 emerges. Elongated shaft 406 terminates with a tip section 408, which can be turned by way of a bending section 410. Handle 404 may be used to maneuver elongated shaft 406 within a body cavity. The handle 404 may include one or more knobs and/or switches 405 that control bending section 410 as well as functions such as fluid injection and suction. Handle 404 may further include a working channel opening 412 through which surgical tools may be inserted, as well as one or more side service channel openings.

A utility cable 414 may connect between handle 404 and a main control unit 416. Utility cable 414 may include therein one or more fluid channels and one or more electrical channels. The electrical channel(s) may include at least one data cable to receive video signals from the front and side-pointing viewing elements, as well as at least one power cable to provide electrical power to the viewing elements and to the discrete illuminators. Main control unit 416 governs a plurality of operational functionalities of the endoscope. For example, main control unit 416 may govern power transmission to the endoscope's 402 tip section 408, such as for the tip section's viewing elements and illuminators. Main control unit 416 may further control one or more fluid, liquid and/or suction pump, which supply corresponding functionalities to endoscope 402. One or more input devices, such as a keyboard 418, may be connected to main control unit 416 for the purpose of human interaction with main control unit 416. In another configuration (not shown), an input device, such as a keyboard, may be integrated with main control unit 416 in a same casing.

A display 420 may be connected to main control unit 416, and configured to display images and/or video streams received from the viewing elements of multiple viewing elements

endoscope 402. Display 420 may further be operative to display a user interface to allow a human operator to set various features of system 400.

Optionally, the video streams received from the different viewing elements of multiple viewing elements endoscope 402 may be displayed separately on display 420, either side-by-side or interchangeably (namely, the operator may switch between views from the different viewing elements manually). Alternatively, these video streams may be processed by main control unit 416 to combine them into a single, panoramic video frame, based on an overlap between fields of view of the viewing elements.

In another configuration (not shown), two or more displays may be connected to main control unit 416, each to display a video stream from a different viewing element of the multiple viewing elements endoscope.

Referring now to Figure 2, a view of a scope handle 200 of an endoscope, such as endoscope 402 of Figure 1, is shown. Handle 200 includes various components such as an umbilical tube 202 that connects its control head to a supply plug at the end of a utility cable, such as utility cable 414 of Figure 1. The control head on handle 200 includes knobs 204 to enable turning of a bending section as well as for functions such as fluid injection and suction. Additionally, handle 200 may include switches/buttons 205. Both knobs 204 and buttons 205 may provide multiple controlling functions. The figure also shows the position of a working channel opening 206 through which surgical tools may be inserted. An insertion portion 208 (shown in part) emerges from handle 200, and has been described as elongated shaft 406 in context of Figure 1. For purposes of describing the specification, elongated shaft will be known as the 'insertion portion', since it is the part of the endoscope assembly that is inserted inside a body cavity. In embodiments, at a proximal end, handle 200 connected to insertion portion 208 maneuvers it within the body cavity.

Figure 3a illustrates a cross-sectional view of a portion of handle 200 extending from near working channel opening 206 towards the beginning of insertion portion 208. In embodiments, handle 200 includes an actuator 302 that is responsible for activating a spring 304, thus allowing the spring 304 to modulate its degree of elasticity to change its stiffness. In the embodiments of the present specification, activating is defined as being at least one of modifying the pitch, length, degree of compression, or degree of expansion of the spring. In various embodiments, the spring is any one of a tension/extension spring, compression spring, constant spring, variable

spring, coil spring, flat spring, machined spring, In embodiments, actuator 302 and spring 304 are manufactured with Nitinol. Nitinol is an alloy of Nickel and Titanium, and is known for its properties of shape memory and super elasticity. Nitinol deforms at low temperatures and recovers its original shape when heated. In embodiments, this property is used to control or vary the stiffness of insertion portion 208.

In embodiments, a first end of a wire 306 is connected to a shaft over which spring 304 is wound, inside a housing. In the embodiments of the present specification, a wire comprises any single, cylindrical, flexible strand or rod of metal or any member capable of having its extent or degree of mechanical load bearing be modulated. Movement of spring 304 influences stiffness of wire 306. A second end of wire 306 may be connected to a proximal end of a bending section within insertion portion 208. Therefore, movement of spring 304 influences the stiffness of insertion portion 208 along its entire length. In embodiments, a coil 308 is wound around wire 306 to protect it and enable movement of wire 306. In the embodiments of the present specification, movement of the wire causes at least one of the pitch, degree of expansion, degree of compression, and flexibility of the coil to change. In addition, in the embodiments of the present specification, movement of the wire causes at least one of the tensile strength, flexibility, or compressibility of the bending section of the endoscope to change.

Referring now to Figure 3b, another cross-sectional view of spring 304 and related arrangements is illustrated in accordance with some embodiments. A housing 310 accommodates spring 304 and a dynamic shaft 316. Housing 310 stretches across the length of spring 304, and has two ends – a proximal end 318 and a distal end 320, which may be proximal and distal respectively to a beginning of the handle of the endoscope. Shaft 316 is connected to a distal end of actuator 302 inside housing 310. The proximal end of actuator 302 may continuously exit housing 310 towards a source of energy that actuates spring's 304 movements. Spring 304 is wound around a tubular length of actuator 302, positioned inside housing 310. A proximal end of spring 304 is fixed to the internal surface of proximal end 318 of housing 310. A distal end of spring 304 is fixed to shaft 316.

In one embodiment, shaft 316 is a U-shaped structure, where the two straight parallel edges of its U-shape may be referred to as a first wall 324 and a second wall 322, positioned parallel to one another, each having internal and external surfaces. First and second walls 324, 322, may be connected to each other with a flat base 323 completing the U-shaped form. Wall

324, which is on the proximal side, connects to spring 304 on its external surface, while wall 322 on the distal side, is pierced by, or generally attached to, wire 306. Wire 306 enters shaft 316 from the external surface of wall 322 and is held in place by a stopper 312 on the other side of wall 322. Thus, stopper 312 aids in anchoring of wire 306 inside housing 310. The distal end of wire 306 continuously exits distal end 320 of housing 310, opposite to the side where actuator 302 exits housing 310. Outside housing 310, wire 306 is protected by coil 308 that is fixed to the internal surface of the insertion portion.

Referring now to Figures 4a, 4b, 4c, and 4d, exemplary embodiments of energy sources for an actuator, such as actuator 302, are illustrated. Figure 4a illustrates an actuator 402 that may be energized by an electric current. In embodiments, actuator 402 may comprise two parallel terminals 402a and 402b that are connected to each end of spring 404. In an embodiment, terminal 402a is connected to proximal end of spring 404, and terminal 402b is connected to distal end of spring 404. Any one of the two terminals may be connected to an anode, while the other is connected to a cathode. Electric current may pass through the two terminals, resulting in activation of spring 404, thus allowing spring 404 to modulate its degree of elasticity to change its stiffness. In embodiments, actuator 402 and spring 404 are manufactured with Nitinol. Nitinol is an alloy of Nickel and Titanium, and is known for its properties of shape memory and superelasticity, namely an elastic, reversible response to applied stress. Nitinol deforms at low temperatures and recovers its original shape when heated or placed at low temperatures. Electric current passing through the two terminals heat actuator 402 and as a result spring 404 is also heated, thereby contracting spring 404, resulting in increased stiffness of a wire 414. The second end of wire 414, connected to the proximal end of the bending section within the insertion portion, therefore increases the stiffness of the insertion portion along its entire length. In embodiments, property of superelasticity is used to control or vary the stiffness of the insertion portion.

Figure 4b illustrates an actuator 406 that may be energized by a heating body or heat source, such as but not limited to resistance based heater. Actuator 406 is heated, due to thermal conductivity and/or heat transfer from the heating body or heat source. Thus, actuator 406 may be a heat body connected to a spring 408 along the length of the shaft over which spring 408 is wound. In embodiments, heating the actuator 406 activates spring 408, which may be manufactured from a super-elastic material such as Nitinol. Temperature changes applied on the

two terminals of heat actuator 406 also causes spring 408 to be heated, thereby causing spring 408 to be in a first configuration, or its original shape, which results in an increase in the stiffness of the insertion portion via pulling or stretching of wire 414. In embodiments, the superelastic property is used to control or vary the stiffness of the insertion portion.

5 In another embodiment, reduction of temperature of actuator 406 and therefore that of spring 408 results in deformation of both (due to Nitinol deforming at low temperatures), owing to their superelastic property. As a result, lowering the temperature of actuator 406 in order to cool it results in spring 408 to be brought to a second configuration, which causes contraction of wire 414 and subsequently, an increase in the stiffness of the insertion portion. In embodiments,  
10 a coolant is used to cool actuator 406 and spring 408.

The extent of stiffness of the insertion tube is therefore controlled by changing temperature of the structure, and therefore of the properties of the wire 414, such that the wire is either pushed or contracted or pulled or expanded.

In yet another embodiment, Figures 4c and 4d illustrate a gear motor 410 that drives a  
15 dynamic shaft 412 connected to a wire 414 placed inside the endoscope's insertion portion. In one embodiment, shaft 412 is a U-shaped structure, where the two straight parallel edges of its U-shape may be referred to as a first wall 418 and a second wall 420, positioned parallel to one another, each having internal and external surfaces. First and second walls 418, 420, may be connected to each other with a flat base 419, thus completing the U-shape. Wire 414 stretches  
20 over the complete length of the insertion portion and is connected to shaft 412 at proximal end of wire 414. First wall 418 of shaft 412 is connected to wire 414 while a proximal end of second wall 420 is connected to an actuator 416 driven by gear motor 410. In embodiments, operation of gear motor 410 results in stiffening or relaxing of wire 414 with backward or forward movements of shaft 412, respectively, that is pulled by gear motor 410.

25 Referring now to Figure 5a, another cross-sectional view of spring 304 and related arrangements described in context of Figures 3 and 4a-4d is illustrated in accordance with some embodiments. Embodiments of Figures 4a and 4b include wire, coil, and housing configurations (not labelled) similar to those described in context of Figures 3a and 3b. Hereinafter, wire 306 coil 308, housing 310, and distal end 320 of housing 310, also refer to similar configurations  
30 described for Figures 4a and 4b. In embodiments, coil 308 is wound around wire 306 to protect it and enable movement of wire 306. An arrow 502 illustrates an exemplary direction of



movement of spring 304. Movement in one direction may stretch spring 304, such that spring 304 lengthens. As a result, wire 306 also relaxes and decreases the stiffness of the insertion portion, which may make the insertion portion more flexible. Movement in an opposite direction may tighten spring 304, resulting in a tightening of wire 306 and an increase in the stiffness of the insertion portion. Actuator 302, also described above with respect to Figures 4a-4d, causes movement of spring 304. An energized actuator 302 may activate spring 304, which results in the tightening of spring 304. Alternatively, when the energy is not provided to actuator 302, or its source is interrupted, spring 304 may return to a loosened or stretched state. While actuator 302 may energize and activate a Nitinol spring causing it to stiffen, in certain embodiments utilizing a mechanical means to move actuator 302 may similarly stiffen or deform spring 304 by a mechanical movement. In embodiments, wire 306 is placed inside coil 308, which is positioned outside of housing 310. Coil 308 is fixed to an internal surface of the insertion portion along its length, and is also fixed to an external surface of distal end 320 of housing 310. As a result, when spring 304 is stiffened, wire 306 is pulled, resulting from the pulling motion by actuator 302.

In operation, as actuator 302 is energized, spring 304 is activated. Activation of spring 304 results in a change in its shape owing to superelastic properties of Nitinol. Consequently, dynamic shaft 316 moves while pulling or pushing wire 306, as wire 306 is also connected to shaft 316. The stiffness character of the insertion portion is influenced by pulling or pushing the wire, influenced respectively by heating or cooling actuator 302. In embodiments, controlling the amount of energy provided to actuator 302 may further control the degree of stiffness of the insertion portion. In embodiments, a controller to control the degree of energy provided to actuator 302 and therefore the degree of stiffness of the insertion portion is provided in either the handle of the endoscope, the main control unit connected to the endoscope, through a foot pedal attached to the endoscope, or through any other means. The control mechanism may be provided through an interface such as a push button, a valve, a nob, or any other digital or analogue interface. As the energy provided to actuator 302 is increased, wire 306 is pulled more, and the degree of stiffness increases. In embodiments, one or more screens connected to the system may display the use of a control to control the stiffness, and may even display a degree of stiffness achieved through the control. For example a display may illustrate the stiffness in effect through a binary illustration, such as whether the insertion tube is or is not stiff. In another example, a

display may indicate a degree of stiffness over a numerical or any other scale, such as 1 to 4, where 1 may be first degree of stiffness and 4 may be the highest degree of stiffness that can be applied to the insertion tube, or vice versa. In yet another example, also illustrated in Figure 5b, a degree of stiffness may be indicated through a display 506 by means of a slider 501 between  
5 standard “+” and “-“ symbols 503 and 504, respectively indicating maximum and minimum degrees of stiffness.

Figure 6 illustrates an alternative embodiment of an arrangement to manipulate and vary the stiffness of an insertion portion in an endoscope. In this embodiment, the spring is replaced by a tube 604, which is also manufactured with Nitinol. Tube 604 comprises slits 605 along its  
10 tubular walls, and along its longitudinal axis. The slits 605 may stretch across a portion of tube 604 and may be centered at the center of the total length of tube 604. In embodiments, the slits 605 are typically equidistant from each other, spaced throughout the circumference of tube 604. Similar to the previous embodiment, tube 604 may be placed over an actuator 602, inside a housing 610. Housing 610 accommodates tube 604 and a dynamic shaft 616. Housing 610 may  
15 stretch across the length of tube 604, and have two ends – a proximal end 618 and a distal end 620, which may be proximal and distal respectively to a beginning of the handle of the endoscope. Shaft 616 may be connected to a distal end of actuator 602 inside housing 610. The proximal end of actuator 602 may continuously exit housing 610 towards a source of energy that actuates tube’s 604 movements. Tube 604 may be placed around a tubular length of actuator  
20 602, positioned inside housing 610. Proximal end of tube 604 is fixed to internal surface of proximal end 618 of housing 610. Distal end of tube 604 is fixed to shaft 616.

In one embodiment, shaft 616 is a U-shaped structure, where the two straight parallel edges of its U-shape may be referred to as a first wall 624 and a second wall 622, positioned parallel to one another, each having internal and external surfaces. First and second walls 624,  
25 622, may be connected to each other with a flat base 623, thus completing the U-shape. External surface of wall 624, which is on the proximal side of the endoscope handle, connects to tube 604, while wall 622 on the distal side, is pierced by wire 606. Wire 606 enters shaft 616 from the external surface of wall 622 and is held in place by a stopper 612 on the other side of wall 622. Thus, stopper 612 aids in anchoring of wire 606 within the inside of housing 610. The distal end  
30 of wire 606 continuously exits distal end 620 of housing 610, opposite to the side where actuator 602 exits housing 610. Outside housing 610, a coil 608 that is fixed to the internal surface of

insertion portion 208 protects wire 606. An arrow 614 illustrates exemplary direction of movement of tube 604, which is caused by energising or de-energising of actuator 602. Actuator 602 may be one of several embodiments described previously, such as in context of Figures 4a, 4b, 4c, and 4d. Additionally, operation of tube 604 mechanism may be similar to operation of spring 304 mechanism, similar to that described in context of Figure 5a.

Figure 7a illustrates a portion of an endoscope handle with an elliptical wheel mechanism 700 that enables variable stiffness of an insertion portion 708 of the endoscope. In an embodiment, an elliptical wheel 704 comprises two side portions - a first side portion 716 and a second side portion 718 that sandwich a center portion. The edges of first portion 716 and second portion 718 rest slightly above the center portion of the sandwich. Thus, the diameter of first portion 716 and second portion 718 is larger than the diameter of the center portion. In embodiments, a wire 702 rests on an outer edge of the center portion, between two sides 716 and 718 of wheel 704. In embodiments, wire 702 is connected at its proximal end to a stopper 714. Stopper 714 rests against edges two sides 716 and 718 of wheel 704. Wheel 704 may have a shape similar to that of an ellipse. In embodiments, one or both of the longer edges of elliptical wheel 704 may have an indentation such that the indentation provides a recess or a notch for stopper 714 to rest and stop rotation of wheel 704. Thus, stopper 714 enables anchoring of wire 702 with wheel 704. At its other end, wire 702 is connected to a proximal end of a bending section within insertion portion 708. In embodiments, wire 702 is placed inside a coil 706. Coil 706 enables movement of wire 702, and is fixed to the internal surface of insertion portion 708.

In embodiments, wheel 704 is connected to a shaft 712, which in turn is connected to a lever 710. Thus, lever 710 operates wheel 704. In embodiments, lever 710 is manually operated, and the extent of its rotation influences the degree of stiffness of insertion portion 708. In operation, rotation of lever 710 rotates wheel 704, which influences wire 702. Consequently, wire 702 either tightens or relaxes, based on the direction of rotation of lever 710.

Figure 7b illustrates another perspective view of the endoscope handle with the elliptical wheel arrangement of Figure 7a. In the arrangement, wheel 704 is located at a proximal end of the endoscope's handle, and wire 702 extends towards a distal end into insertion portion 708.

Figure 7c illustrates an enlarged two-dimensional view of assembly 700, in accordance with some embodiments. In embodiments, wheel 704 has an asymmetric shape, similar to an ellipse. In this figure, one side 716 is visible, and the second side cannot be seen. Central edge

of wheel 704 is also hidden behind side 716, between the two sides. Wire 702 is seen connected to stopper 714 and passing over the central edge of wheel 704. The concentric center of elliptical wheel 704 allows its radius to increase as wheel 704 rotates. Increased radius results in tightening of wire 702. Shaft 712, connected to lever 710, rotates with the movement of lever 710. Wheel 704 is placed on shaft 712 and rotates with it. In embodiments, wire stopper 714 is adapted to fix position of wire 702 relative to wheel 704. In embodiments, one of the longer edges of elliptical wheel 704 may have an indentation such that the indentation provides a recess or a notch for stopper 714 to rest and stop rotation of wheel 704. Thus, stopper 714 enables anchoring of wire 702 with wheel 704. At its other end, wire 702 is connected to a proximal end of a bending section within insertion portion 708. Once the wheel stops rotating, wire 702 may not move further around outer edge of centre portion of wheel 704, thus fixing location of wire 702 relative to wheel 704.

Figures 8a and 8b illustrate cross-sectional views 800 of another embodiment for varying the stiffness of an insertion portion 802 of an endoscope involving a screw mechanism located within the handle of an endoscope. Simultaneously referring to Figures 8a and 8b, the mechanism includes a screw 804 placed within a housing 806 located in the handle of the endoscope. In embodiments, housing 806 further includes an internal housing (further illustrated in Figure 9) to house a wire stopper 808. In embodiments, internal housing moves in accordance with a tightening/releasing movement of screw 804, in a direction that is at least one of a distal direction and a proximal direction along the longitudinal axis of the endoscope assembly. In embodiments, a proximal end of a wire 810 is connected to stopper 808. Distal end of wire 810 is connected to a proximal side of a bending portion at distal end of insertion portion 802. In embodiments, an opening 818 in the endoscope handle provides an optimal space and location suitable to place the screw mechanism in accordance with described embodiments. In some embodiments, a knob on the handle, such as knob 405 described with reference to Figure 1, may be used to rotate the screw 804. The knob is in communication with the screw such that a rotation of the knob causes a rotation of the screw. In some embodiments, the physical connection between the knob and the screw 804 may be geared such that a large rotation of the knob 804 would cause a smaller rotation of the screw or a small rotation of the knob would cause a larger rotation of the screw 804.

Referring to Figure 9 in combination with Figures 8a and 8b, a three-dimensional view of the screw mechanism of Figures 8a and 8b is illustrated. In addition to components described in context of Figures 8a and 8b, Figure 9 illustrates an internal housing 906, placed within housing 806. Internal housing 906 moves with tightening/releasing of screw 804. In embodiments, as  
5 screw 804 is tightened, internal housing 906 moves in a direction of its proximal end 908, towards a proximal end 904 of housing 806. In operation, screw 804 may be rotated around a longitudinal axis of the endoscope's handle. Rotating screw 804 may cause internal housing 906 to move along the longitudinal axis. In embodiments, rotation of screw in a clock-wise direction 814 may move internal housing 906 in a proximal direction 816, towards a proximal end of the  
10 endoscope's handle. In embodiments, distal end of wire 810 is connected to a proximal end of a bending section within the endoscope. In embodiments, wire 810 is placed within a coil 812, which enables movement of wire 810. Coil 812 is fixed to the internal surface of insertion portion 802.

Screw 804 is connected to proximal end 908. In embodiments, screw 804 is screwed  
15 inside internal housing 906 through its proximal end 908. Rotation of screw 804 moves internal housing 906 closer to proximal end 904 of housing 806, in proximal direction 816. Consequently, wire 804 is pulled resulting in stiffening of the insertion portion. When screw 804 is released, internal housing 906 moves towards a distal end 902 of housing 806, resulting in a relaxed insertion portion. Therefore, movement of screw 804 influences tightening or loosening  
20 of wire 810.

In embodiments, an opening 818 in the endoscope handle provides an optimal space and location suitable to place the screw mechanism in accordance with described embodiments. Figure 10 illustrates housing 806 and the screw mechanism placed inside opening 818 in a handle 1002 of the endoscope. In embodiments, internal design of scope handle 1002 allows  
25 secure placement of the screw mechanism. Figure 10 illustrates a view of handle 1002 when it is open. Once handle 1002 is closed and locked, the screw mechanism is invisible, secure, and intact. The mechanism may be operated, likely to tighten screw 804, during a maintenance activity when handle 1002 is unlocked and opened to reveal the screw mechanism.

Referring to Figures 11a and 11b, an additional embodiment is described, which  
30 influences stiffness of an insertion portion of an endoscope. Figure 11a illustrates a cross-sectional view of a handle 1100. A service channel opening leads to a working channel 1104

inside handle 1100. Working channel 1104 extends towards tip section of the endoscope, stretching over entire length of an insertion portion 1106. In embodiments, an enforcement layer 1108 is placed over an outer periphery of working channel 1104. In embodiments, layer 1108 may be manufactured from a metal that is from the family of stainless steel metals, or any other material that may stiffen working channel 1104 such that utility of working channel 1104 remains unaffected. Physicians are able to insert surgical tools and/or equipment to perform procedures through working channel 1104 that is covered by layer 1108. Working channel 1104 stretches over entire length of insertion portion 1106, therefore layer 1108 may influence stiffness characteristic of insertion portion 1106, for example by providing permanent stiffness to insertion portion 1106.

Figure 11b illustrates a cross-sectional view of working channel 1104 inside the endoscope handle. The figure also clearly illustrates enforcement layer 1108 on the outer periphery of working channel 1104.

Although the present specification has been described with particular focus on an actuator that can controls a super-elastic element in order to vary stiffness of an insertion portion in an endoscope assembly, the present specification is also designed to vary stiffness through means of fluid and gas provided within the insertion portion. Therefore, various embodiments of the present specification describe elements (solid, liquid, and gas) that are controlled through different mechanisms to vary stiffness of an insertion portion in an endoscope.

Referring now to Figure 12, a longitudinal cross-sectional view of a portion of an elongated shaft in an endoscope is shown, in accordance with some embodiments. For purposes of describing the specification, elongated is termed as the 'insertion portion', since it is the part of the endoscope assembly that is inserted inside a body cavity.

An insertion portion 1222 terminates at a tip section 1224, which is at the distal end (that is, the end that is farthest from the endoscope handle) of insertion portion 1222. In embodiments, at a proximal end, a handle connected to insertion portion 1222 assists/help maneuvers the insertion portion within the body cavity. The arrangement of these components is described above with reference to Figure 1. In some embodiments, a flexible tube 1226 extends from the proximal end of insertion portion 1222 along its entire length. In embodiments, flexible tube 1226 is a separate tube outside a working channel and inside insertion portion 1222. In embodiments, length of flexible tube 1226 may vary with the length of insertion portion 1222.

Diameter of flexible tube 1226 may also vary to adapt to the endoscope device where is it embedded. In embodiments, flexible tube 1226 may have an amorphous shape that adapts to space available within insertion portion 1222. In embodiments, flexible tube 1226 is manufactured with a polymer that is used for conductivity of fluid under pressure. Examples of such polymer may include, but are not limited to, Polyurethane, Polyamide, Polyethylene, Polypropylene, Nylon, Silicon, and TPE.

The illustrated embodiment shows flexible tube 1226 terminating at tip section 1224. In alternative embodiments, flexible tube 1226 terminates some distance prior to tip section 1224, and within the bending section of insertion portion 1222. In other embodiments, flexible tube 1226 terminates just before a first vertebra of the bending section, or at a proximal end of the bending section. In embodiments, flexible tube 1226 is configured to enclose a fluid, such as but not limited to water. In embodiments where water inflates flexible tube 1226, the water may be sourced from the same supply that feeds the injector channel. Flexible tube 1226 may be sealed at its distal end, referred to as a sealed end 1234, such that it carries a volume of water enclosed within flexible tube 1226. An increase in this volume results directly in an increase of pressure of the water inside the flexible tube 1226, which, in turn, results in an increase in stiffness (or decrease in flexibility) of flexible tube 1226. Conversely, a decrease in this volume results directly in a decrease of pressure of the water inside the flexible tube 1226, which, in turn, results in a decrease in stiffness (or increase in flexibility) of flexible tube 1226. This arrangement also affects the overall flexibility of insertion portion 1222, thus enabling control over its maneuverability inside a body cavity.

In embodiments, a pressure pump 1228 is connected to flexible tube 1226 at the proximal end of insertion portion 1222. In alternative embodiments, pressure pump 1228 is connected through the handle to flexible tube 1226. Pressure pump 1228 may control the pressure of water inside flexible tube 1226. Pressure control may be enabled through a button, a switch, or a knob located on the handle or on a main control unit of the endoscope assembly or by a foot pedal. The control may adjust the pressure by varying an operating voltage or by using a pressure regulator. In embodiments, water is input at an inlet 1230 of pump 1228. Water of variable pressure may be output through an outlet 1232, which feeds into flexible tube 1226. In embodiments, a user/physician interfaces with a scale that allows selection of a stiffness percentage, such as in the range of 0% to 100%. 0% may represent an insertion portion stiffness

without any pressure, inside flexible tube 1226. And 100% may represent insertion portion 1222 with the maximum pressure that may be applied inside flexible tube 1226. A percentage value within this range may vary based on user requirements.

5 In alternative embodiments, other fluids may be used in place of water, within flexible tube 1226. Variable viscosity of a fluid may contribute to variation in stiffness of flexible tube 1226 containing the fluid. Therefore, any fluid that may change its viscosity properties may be used within flexible tube 1226. In embodiments, the fluid within flexible tube 1226 may undergo a viscosity change due to a change in at least one of temperature, electric charge, magnetic field, exposure to light, or any other factor influencing viscosity. Examples of such  
10 fluids may include, but are not limited to, electrorheological fluids that change viscosity based on an applied electric field, non-Newtonian fluids that change viscosity based on shear rate or shear rate history, magnetorheological fluids that change viscosity based on a magnetic field, photo-rheological fluids that change viscosity based on exposure to light, and the like.

In embodiments, electrorheological fluids (ERFs) are material composed of dielectric  
15 properties suspended in an insulating oil. Flow characteristics of ERFs may depend on properties of the dispersed material and the oil. Examples of ERFs include dispersions consisting of oil (mineral or silicon oil) and solid polymer particles, Hydroxyl-terminated silicon oil, RheOil®, and the like. In embodiments, magnetorheological fluids (MRFs) are liquids that display adjustable flow properties through introduction of magnetic fields. As a result, their  
20 characteristics can be changed from free flowing to solid and back again in a few milliseconds. Examples of MRF include fluid made using Carbonyl Iron powder, hydrocarbon-based MRFs, and the like.

In embodiments, pump 1228 is a lightweight pump suitable for liquids that provides a high-pressure capability for a small device. Pump 1228 may be a small-sized pump that delivers  
25 a consistent flow throughout a wide range of varying pressures. In embodiments, an electronic driver circuit may be used to operate the motor of pump 1228.

Figure 12 also illustrates a horizontal cross sectional view of insertion portion 1222 above its longitudinal cross-sectional view. This view shows an exemplary position of flexible tube 1226 within insertion portion 1222. Flexible tube 1226 is seen positioned at the radial center of  
30 insertion portion 1222. Thus, flexible tube 1226 enables variation in flexibility of insertion portion 1222 from within and from its center. In another embodiment, flexible tube 1226 may be



positioned in an empty space within and along insertion portion 1222. In embodiments, such empty spaces may include but are not limited to spaces between electronic wires, working channels, and air/water channel(s).

In an alternative embodiment, flexible tube 1226 is coiled around an outer circumferential surface of a treatment tool insertion channel, such as a working channel, embedded within insertion portion 1222. In this case, flexible tube 1226 coils around entire length of the working channel extending from the proximal end of insertion portion 1222. In another embodiment, flexible tube 1226 coils around the working channel and terminates some distance prior to the bending section of insertion portion 1222.

In yet another embodiment, flexible tube 1226 is replaced with a flexible lining that extends from a proximal end of insertion portion 1222 along length of insertion portion 1222. The flexible lining may form a tubular wall concentric to the inner wall of insertion portion 1222 such that a gap exists between the two walls. In embodiments, at least one flexible lining stretches along the inner wall of insertion portion 1222. In alternative embodiments, multiple flexible linings may be utilized. The flexible lining forms a parallel wall inside insertion portion 1222 such that a gap exists between the parallel wall and the inner wall of insertion portion 1222. A pressure pump may be connected to the gap at the proximal end of insertion portion 1222 that controls pressure of a fluid that fills the gap.

Figures 13a, 13b, 13c, and 13d illustrate various embodiments of methods that are utilized to seal the flexible lining. In embodiments, the flexible lining may be sealed at the distal end of insertion portion 1222. Figure 13a illustrates a method of sealing by soldering a flexible lining 1302, with the wall of an insertion portion 1304 at its distal ends 1306. In embodiments, flexible lining 1302 may be punched at its distal ends with insertion portion 1304.

Figure 13b illustrates another embodiment where a plug 1308 is utilized in addition to sealing by soldering flexible lining 1302 with the wall of insertion portion 1304 at its distal ends 1306. Plug 1308 may be placed between inner walls of flexible lining 1302 proximal to ends 1306 to provide additional support to sealed ends 1306.

Figure 13c illustrates another embodiment where an Ultra Violet (UV) cure adhesive 1310 is used to seal open ends of flexible lining 1302, in addition to plug 1308.

Figure 13d illustrates yet another embodiment where only UV cure adhesive 1310 is used to seal open ends of flexible lining 1302.

Figure 14 illustrates a cross-sectional view of another embodiment of an insertion portion 1402. In this embodiment, two or more flexible tubes 1404 are inserted within insertion portion 1402. Sealed ends 1406 towards the distal ends of each of tubes 1404 may seal the tubes, such that it carries a volume of water enclosed within tubes 1404.

5 An increase in this volume results directly in an increase of pressure of the water inside the flexible tubes 1404, which, in turn, results in an increase in stiffness (or decrease in flexibility) of flexible tubes 1404. Conversely, a decrease in this volume results directly in a decrease of pressure of the water inside the flexible tubes 1404, which, in turn, results in a decrease in stiffness (or increase in flexibility) of flexible tubes 1404. This arrangement also  
10 affects the overall flexibility of insertion portion 1402, thus enabling control over its maneuverability inside a body cavity.

Figure 15 illustrates a cross-sectional view of yet another embodiment of an insertion portion 1502. In this embodiment, a flexible tube 1504 is inserted inside insertion portion 1502. Tube 1504 stretches along one side of an inner wall of insertion portion 1502, and may  
15 continually stretch along another side of the inner wall of insertion portion 1502. Tube 1504 may bend near the distal end of insertion portion 1502 to direct its water contents along other sides of its inner wall. In embodiments, flexible tube 1504 may be placed within insertion portion 1502 during its extrusion. In alternative embodiments, a guide is used to insert and place flexible tube 1504 inside insertion portion 1502. Once tube 1504 is placed, the guide may be  
20 withdrawn from insertion portion 1502.

Figure 15 also illustrates a pressure-regulating valve 1506 that may be used to stop or allow the water within tube 1504 from flowing back to a pressure pump 1508 through an inlet 1510. In embodiments, once pressure-regulating valve 1506 is closed, water stops flowing out of tube 1504, such that a volume of water is enclosed within tube 1504. An increase or decrease in  
25 this volume results directly in an increase or decrease of pressure of the water inside tube 1504. An increase in this volume results directly in an increase of pressure of the water inside the flexible tube 1504, which, in turn, results in an increase in stiffness (or decrease in flexibility) of flexible tube 1504. Conversely, a decrease in this volume results directly in a decrease of pressure of the water inside the flexible tube 1504, which, in turn, results in a decrease in  
30 stiffness (or increase in flexibility) of flexible tube 1504. This arrangement also affects the

overall flexibility of insertion portion 1502, thus enabling control over its maneuverability inside a body cavity.

Figures 16a, 16b, 16c, and 16d show longitudinal cross-sectional views of a portion of an elongated shaft in an endoscope in accordance with another embodiment. Referring to Figures 5 16a to 16d, an insertion portion 1602 terminates at a tip section 1610 (shown in Figure 16a), which is at the distal end of insertion portion 1602. In embodiments, at a proximal end, a handle (not shown) connected to insertion portion 1602 assists in maneuvering it within the body cavity. The arrangement of these components is described above with reference to figure 1.

Referring to Figure 16a, in embodiments, a flexible tube 1604a extends from the proximal 10 end of insertion portion 1602 along its length. The illustrated embodiment shows flexible tube 1604a terminating near tip section 1610. In alternative embodiments, flexible tube 1604a terminates within the bending section of insertion portion 1602. In another embodiment, flexible tube 1604a terminates some distance prior to the bending section of insertion portion 1602. In embodiments, flexible tube 1604a is configured to carry gas, such as but not limited to air, or 15 fluid. In embodiments where gas/fluid inflates flexible tube 1604a, the gas/fluid may be sourced from the same supply that feeds the injector channel. Flexible tube 1604a may open into a sealed gas chamber 1612 near tip section 1610, such that the gas carried by tube 1604a is filled inside chamber 1612.

An increase or decrease in this volume of the gas within tube 1604a results directly in an 20 increase or decrease of pressure of the gas within chamber 1612. An increase in this volume results directly in an increase of pressure of the gas within chamber 1612, which, in turn, results in an increase in stiffness (or decrease in flexibility) of insertion portion 1602 that houses chamber 1612. Conversely, a decrease in this volume results directly in a decrease of the pressure of the gas within chamber 1612, which, in turn, results in a decrease in stiffness (or 25 increase in flexibility) of insertion portion 1602 that houses chamber 1612.

Referring to Figure 16b, an additional flexible tube 1604b is shown. Flexible tube 1604b may be similar in its characteristics and operation to flexible tube 1604a, and may open into a different chamber 1614 (similar to chamber 1612). In embodiments, chamber 1614 may be located adjacent to chamber 1612 along the longitudinal axis of insertion portion 1602. In 30 another embodiment, chamber 1614 is located at a predefined distance from chamber 1612 along the longitudinal axis of insertion portion 1602. Chambers 1612 and 1614 may be placed

concentrically, such that chamber 1612 is inside chamber 1614, and both are aligned inside and along the inner circumferential surface of insertion portion 1602.

Referring to Figure 16c, another flexible tube 1604c is shown. Flexible tube 1604c may be similar in its characteristics and operation to flexible tubes 1604a and 1604b, and may open  
5 into a third chamber 1616 (similar to chambers 1612 and 1614). In embodiments, chamber 1616 may be located adjacent to chamber 1614 along the longitudinal axis of insertion portion 1602. In an embodiment, chamber 1616 may be located at a predefined distance from chamber 1614 along the longitudinal axis of insertion portion 1602. Chambers 1612, 1614, and 1616 may be placed concentrically, such that chamber 1612 is inside chamber 1614, which is inside chamber  
10 1616, and both all are aligned inside and along the inner circumferential surface of insertion portion 1602.

In embodiments, insertion portion 1602 may include multiple chambers, and the number of chambers may vary. Length of chambers may also vary. In an embodiment, length of the chambers may vary from 1 to 30 cm. In other embodiments, the lengths may exceed 30 cm.

15 Pressure of gas/fluid may be varied separately in all of the chambers described in the above embodiments to variably control stiffness of insertion portion 1602.

In embodiments, a pressure pump 1608 is connected to flexible tubes 1604a, 1604b, and 1604c, at the proximal end of insertion portion 1602. In alternative embodiments, pressure pump 1608 is connected through the handle. Pressure pump 1608 may control pressure of gas inside  
20 each flexible tube 1604a, 1604b, and 1604c. A switch 1606 or any other external control (such as a button or a knob) may enable an operator to configure pressures within each tube and thus each chamber, to manage stiffness of insertion portion 1602. Switch 1606 may be located on the handle or on a main control unit of the endoscope assembly. The control may adjust the pressure by varying an operating voltage or through a pressure regulator.

25 Various embodiments of the specification described herein may thus allow flexibility of an insertion portion of an endoscope to vary, thereby increasing ease of navigation through different parts and contours inside a body cavity while solving problems related to looping. The gas and fluid pressure controls provide an additional layer of control over the flexibility of the insertion portion of most available endoscopes.

30 Alternative embodiments may also be considered that enable control over the flexibility of the insertion portion. These additional alternatives may be in the form of various methods of

manufacturing the insertion tube of the insertion portion. Such embodiments enable flexibility of the insertion tube to be controlled on the basis of the manufactured characteristics of the tube. Some embodiments of methods of manufacturing are discussed here.

#### Immersion Method

5           The immersion method of manufacturing the insertion tube may enable control over rigidity of different areas of the tube. Rigidity of the tube may be controlled by use of different viscosity liquids that construct the base material of a jacket of the tube, which is also known as a sheath. In embodiments, the jacket may be Thermoplastic Polyurethane. Additionally, a portion of the sheath may be of the braided hose type. In embodiments, the hose braid may be  
10       manufactured using stainless steel, or a synthetic material, or Kevlar, or any other material known in the art. In embodiments, the type of hose braid used (wire diameter, number of wires per bobbin, number of carriers) also affects the rigidity of the tube. Moreover, flat coils may be used as framework for insertion tubes to provide control over the rigidity of the tube. In embodiments, flat coils may be manufactured using stainless steel, or copper, or any other  
15       material known to manufacture flat coils. An advantage of the immersion method is that the insertion tubes manufactured by this method do not require an extra coating.

#### Extrusion Method

          This method offers advantages when the control over stiffness of the insertion tube is maintained with hose braids and flat spirals. One of the advantages include an improved quality  
20       of connection of the insertion tube with its mesh, which is used for the jacket. The improved quality of connection ensure that the sheath remains attached to the tube braid, and thus a widespread form of beads bend in the insertion tube in a tight radius. With a surface treatment of the tubular braid and / or use by the extrusion, a uniform thickness of the casing is achieved. This also results in improved uniformity of stiffness in the rigidity zones. Another advantage is that  
25       insertion tubes have a constant stiffness among different manufacturing batches. As a result, the reject rate in production by this method is much lower. Additionally, the tubes manufactured by this method may have a relatively smoother surface. The insertion tubes manufactured by this method also do not require an extra coating.

#### Shrink Tube Method

In this method, flat coils are prepared with the hose braid, and coated with a heat shrink tube, followed by baking in an oven until maximum shrinkage is reached. Variable stiffness may be achieved with this method by differing the quality of the flat coils and of the hose braid.

5 Various embodiments of the specification described herein may thus allow flexibility of an insertion portion of an endoscope to vary, thereby increasing ease of navigation through different parts and contours inside a body cavity while solving problems related to looping.

10 The above examples are merely illustrative of the many applications of the system of present specification. Although only a few embodiments of the present specification have been described herein, it should be understood that the present specification might be embodied in many other specific forms without departing from the spirit or scope of the specification. Therefore, the present examples and embodiments are to be considered as illustrative and not restrictive, and the specification may be modified within the scope of the appended claims.

**CLAIMS****We claim:**

1. An endoscope assembly comprising an insertion portion that is connected to a handle at a proximal end of the insertion portion and a bending portion at a distal end of the insertion portion, comprising:
  - a screw configured to rotate around a longitudinal axis of the endoscope assembly;
  - a housing in physical communication with the screw, wherein the housing is configured to move in a direction that is at least one of a distal direction and a proximal direction along the longitudinal axis of the endoscope assembly, with the rotation of the screw;
  - a stopper placed within the housing; and
  - a wire having a proximal end and a distal end, wherein the proximal end of the wire is connected to the stopper, the wire stretches along a length of the insertion portion, and the distal end of the wire is connected to a proximal end of the bending portion and wherein the wire stiffens the insertion portion upon rotation of the screw towards distal end of the insertion portion.
2. The endoscope assembly of claim 1, wherein the wire is placed inside a coil fixed to an internal periphery of the insertion portion.
3. The endoscope assembly of claim 1 further comprising a housing containing at least one of the screw, the internal housing, the stopper, and the wire.
4. The endoscope assembly of claim 1, further comprising a knob located in the handle and in physical communication with the screw, wherein a rotation of the knob causes a rotation of the screw.
5. The endoscope assembly of claim 1, wherein said stopper is configured within said housing such that a proximal movement of the housing causes said stopper to move proximally and such that a distal movement of the housing causes the stopper to move distally.
6. The endoscope assembly of claim 1, wherein movement of the wire causes at least one of the pitch, degree of expansion, degree of compression, and flexibility of the coil to change.
7. The endoscope assembly of claim 1, wherein movement of the wire causes at least one of the tensile strength, flexibility, or compressibility of the bending portion to change.
8. The endoscope assembly of claim 1, wherein the housing is positioned around the longitudinal axis of the screw and is configured to move longitudinally along said axis.

9. An endoscope assembly comprising an insertion portion that is connected to a handle at a proximal end of the insertion portion and a bending portion at a distal end of the insertion portion, comprising:
- an actuator;
  - a spring, having a proximal end and a distal end, wherein the proximal end of the spring is connected to the actuator and wherein the actuator activates the spring; and,
  - a wire, having a proximal end and a distal end, with the proximal end of the wire connected to the distal end of the spring, wherein the wire stretches along a length of the insertion portion and wherein the distal end of the wire is connected to a proximal end of the bending portion, and wherein the wire stiffens the insertion portion upon activation of the spring.
10. The endoscope assembly of claim 9, wherein the spring comprises superelastic material.
11. The endoscope assembly of claim 10, wherein the superelastic material is Nitinol.
12. The endoscope assembly of claim 9, wherein the actuator is connected to an electric current source that activates the spring.
13. The endoscope assembly of claim 9, wherein the actuator is connected to a heat source that activates the spring.
14. The endoscope assembly of claim 9, wherein the actuator is connected to a gear motor that activates the spring.
15. The endoscope assembly of claim 9 further comprises a shaft connecting the spring and the wire.
16. The endoscope assembly of claim 15, wherein the shaft has a U-shaped structure comprising:
- a first wall connected to distal end of the spring; and
  - a second wall, parallel to the first wall, connected to the proximal end of the wire.
17. The endoscope assembly of claim 9, wherein the wire is placed inside a coil fixed to an internal periphery of the insertion portion.
18. The endoscope assembly of claim 9 further comprising a housing containing at least one of the actuator, the spring, and the wire.



1/20

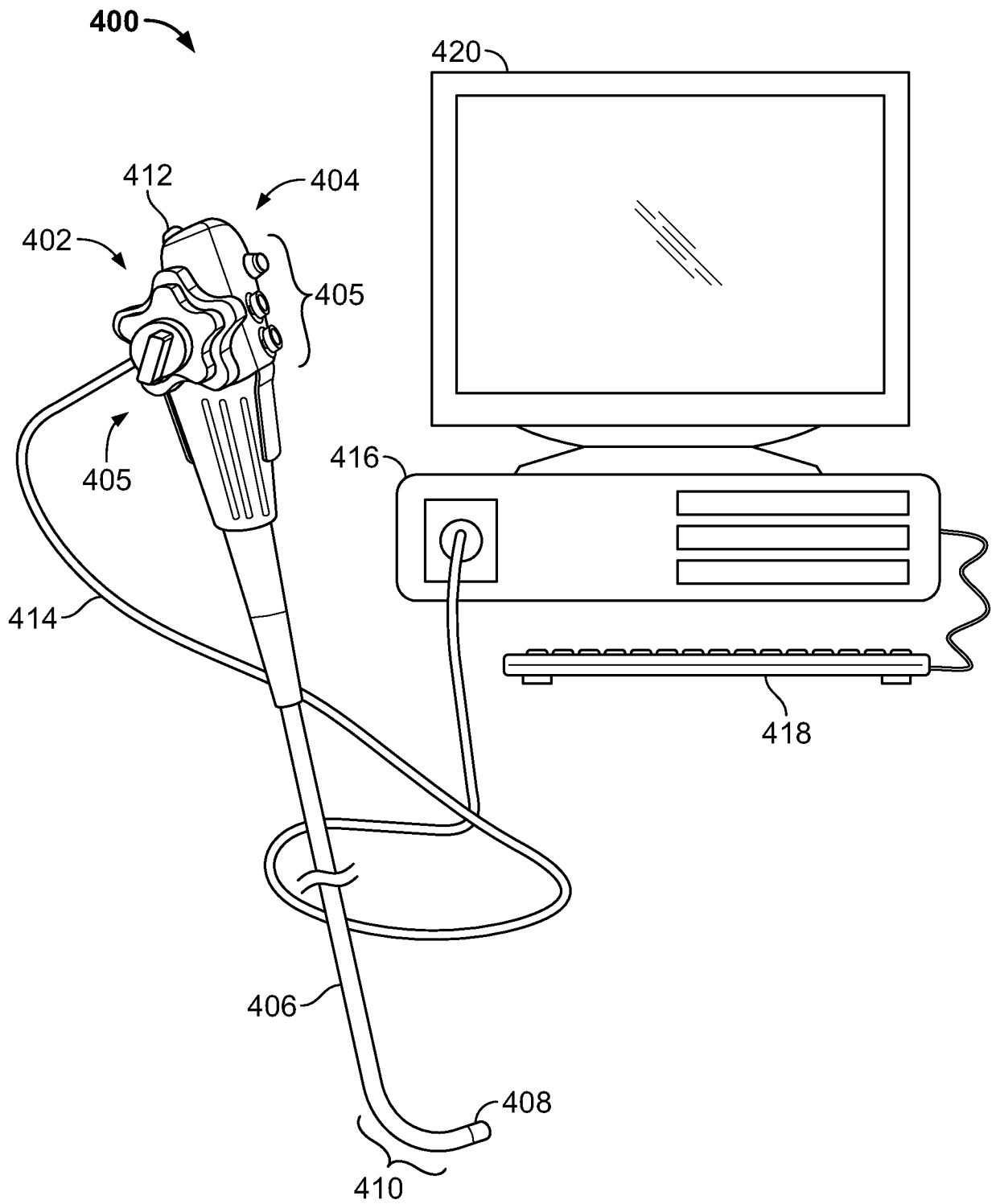

FIG. 1

2/20

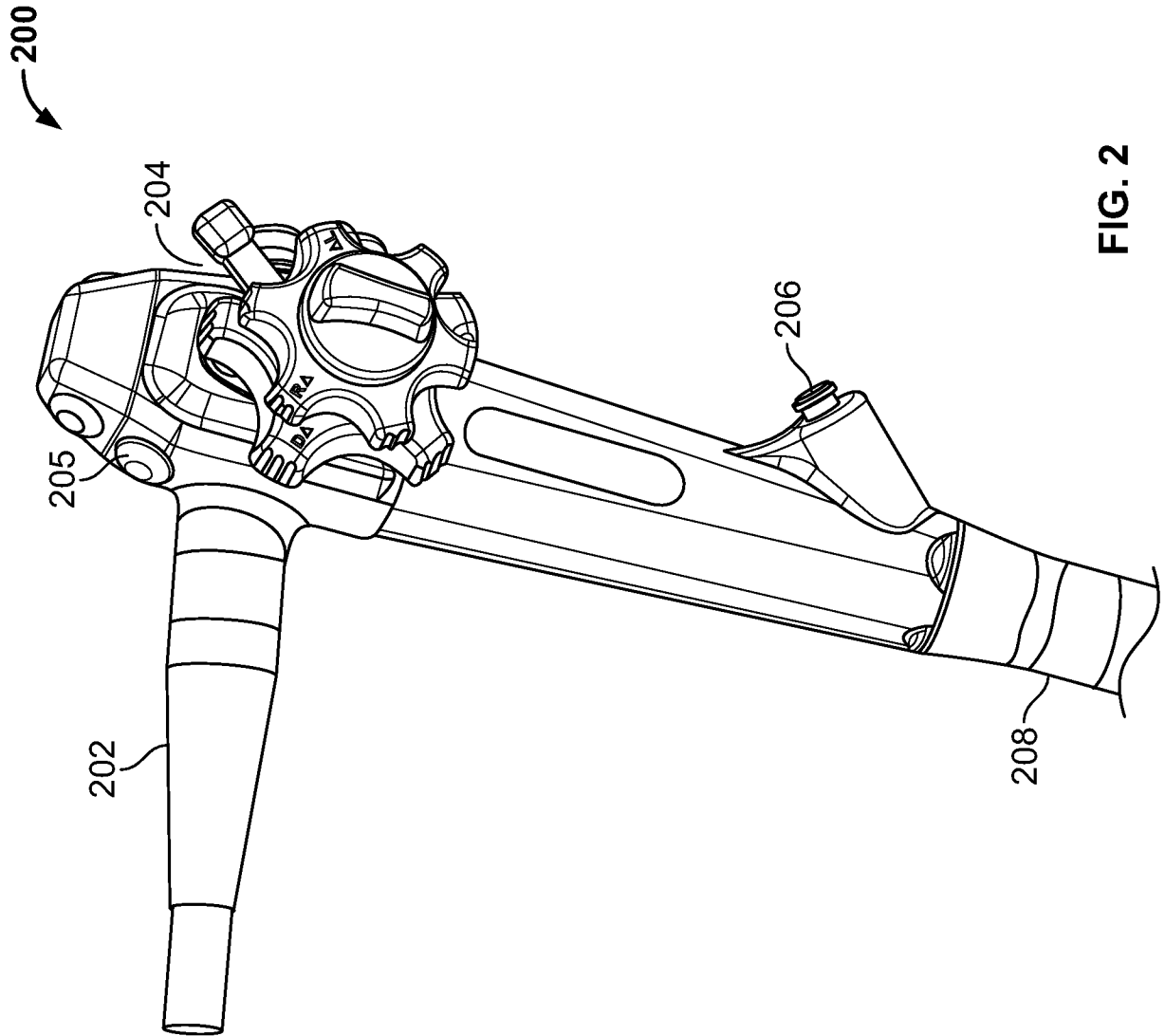
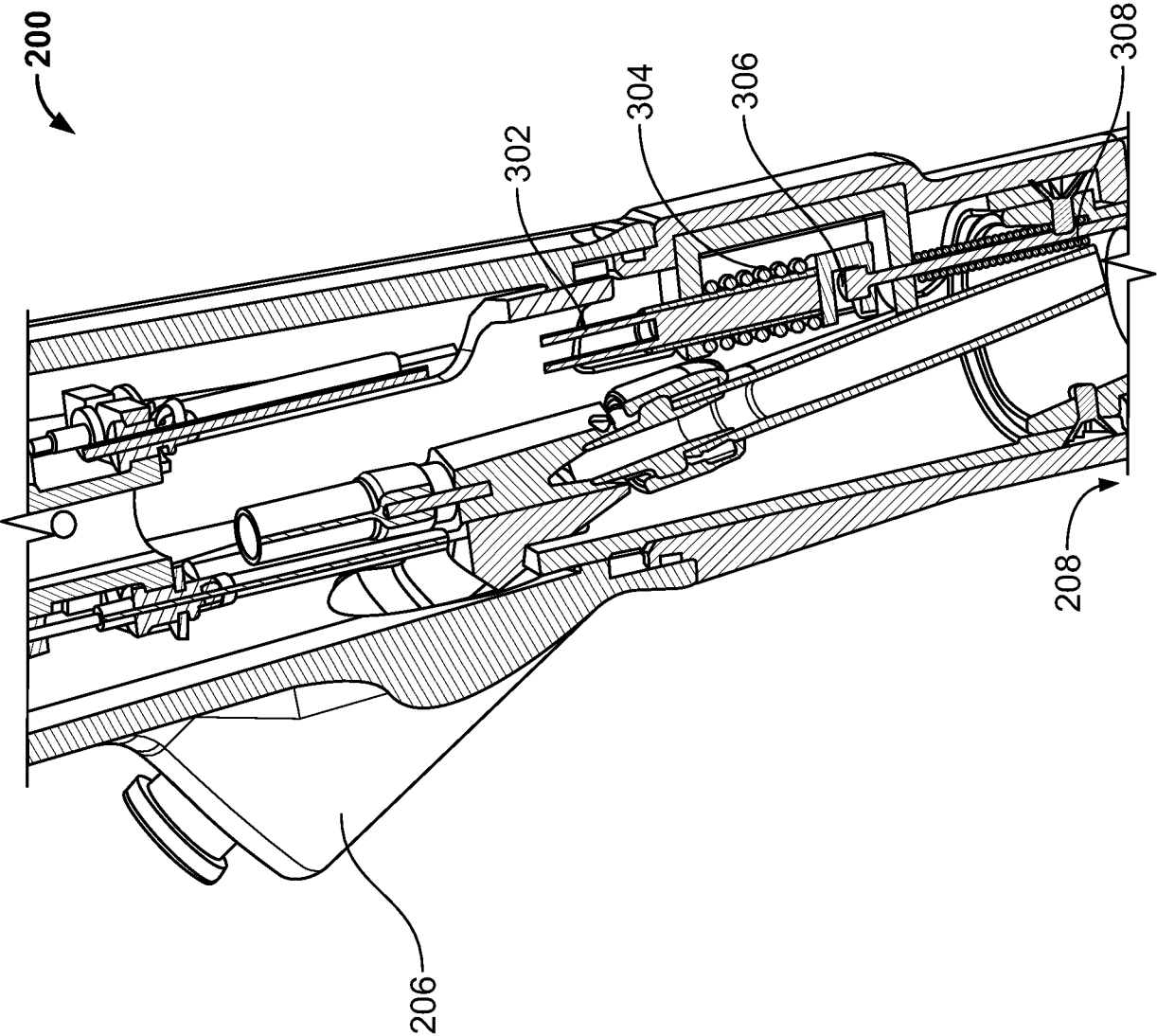

FIG. 2

FIG. 3a



4/20

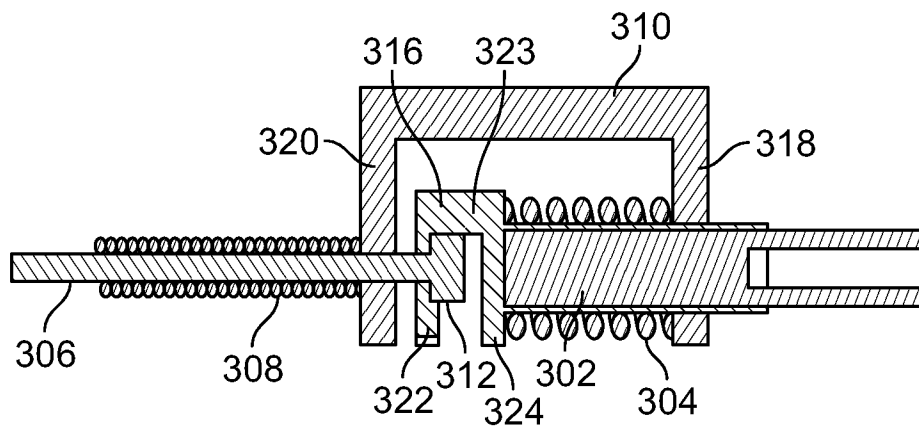

FIG. 3b

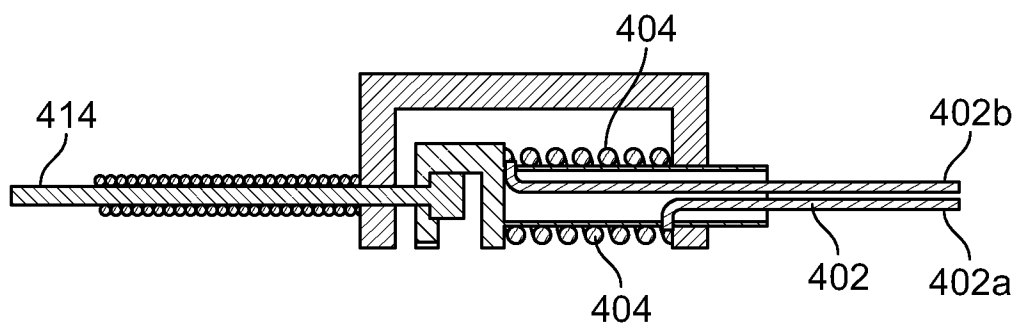

FIG. 4a

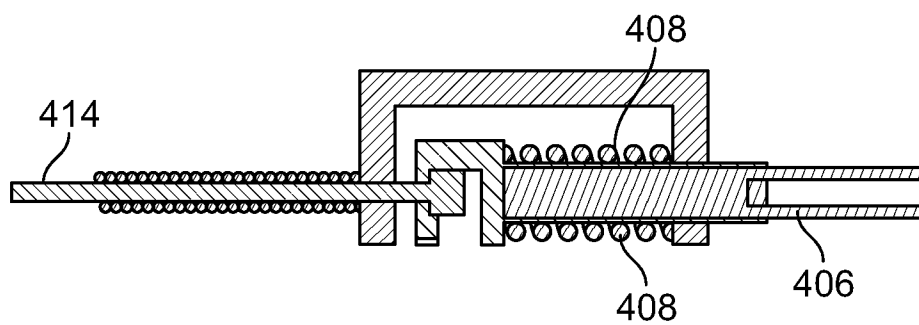

FIG. 4b

5/20

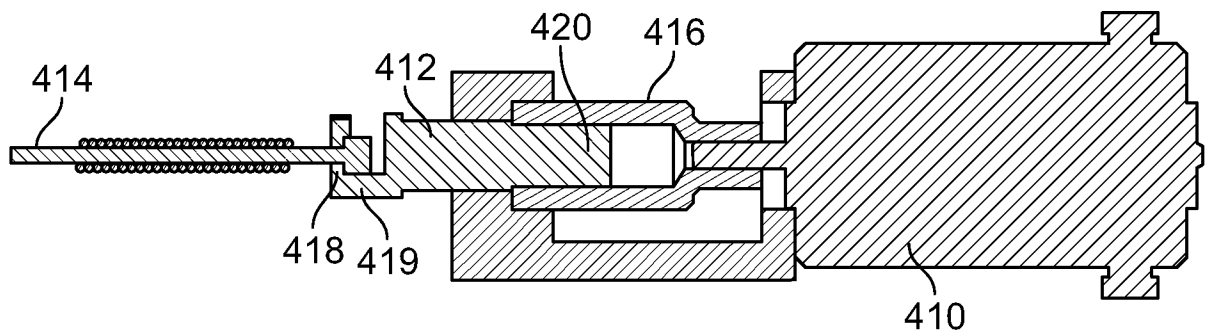

FIG. 4c

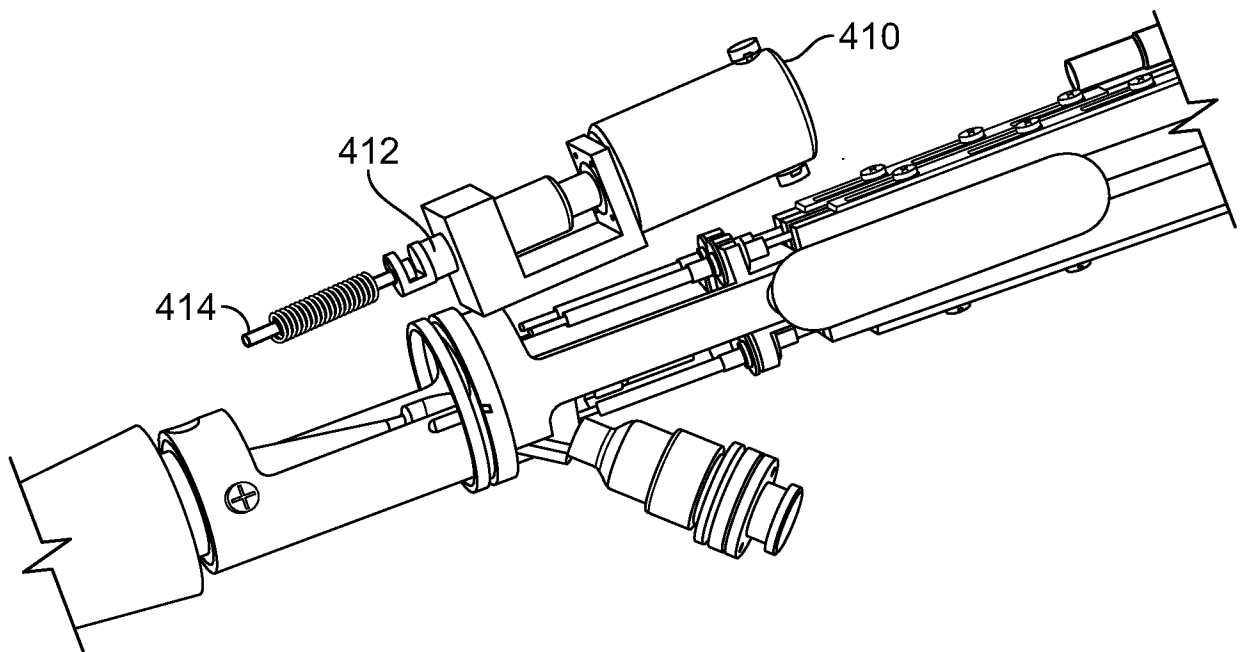
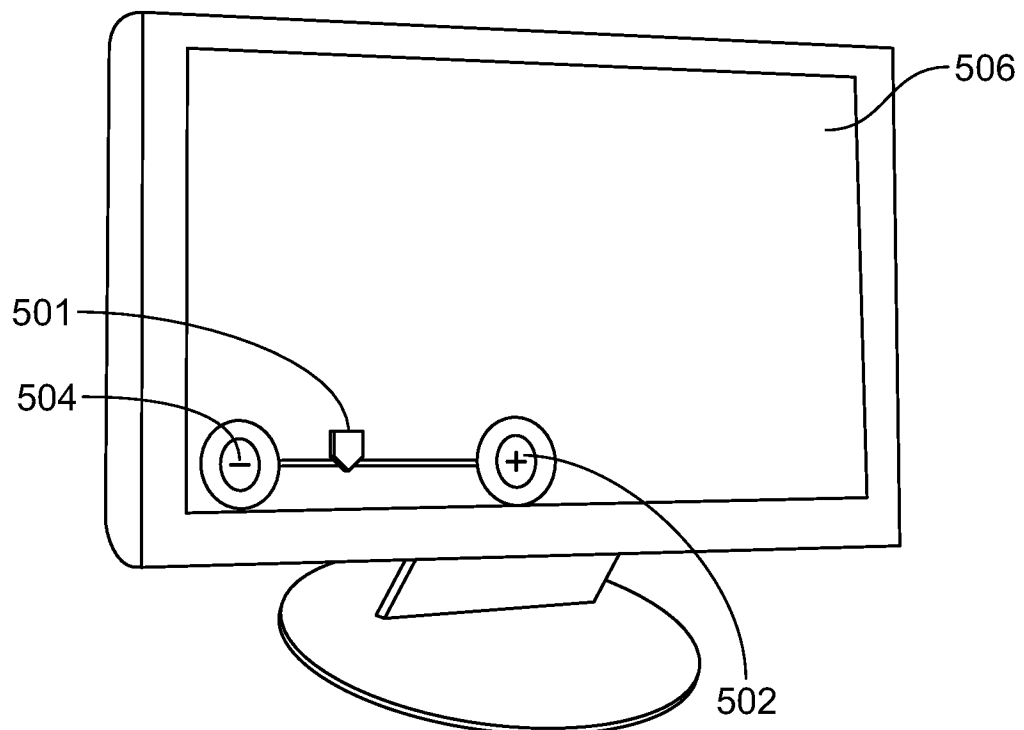
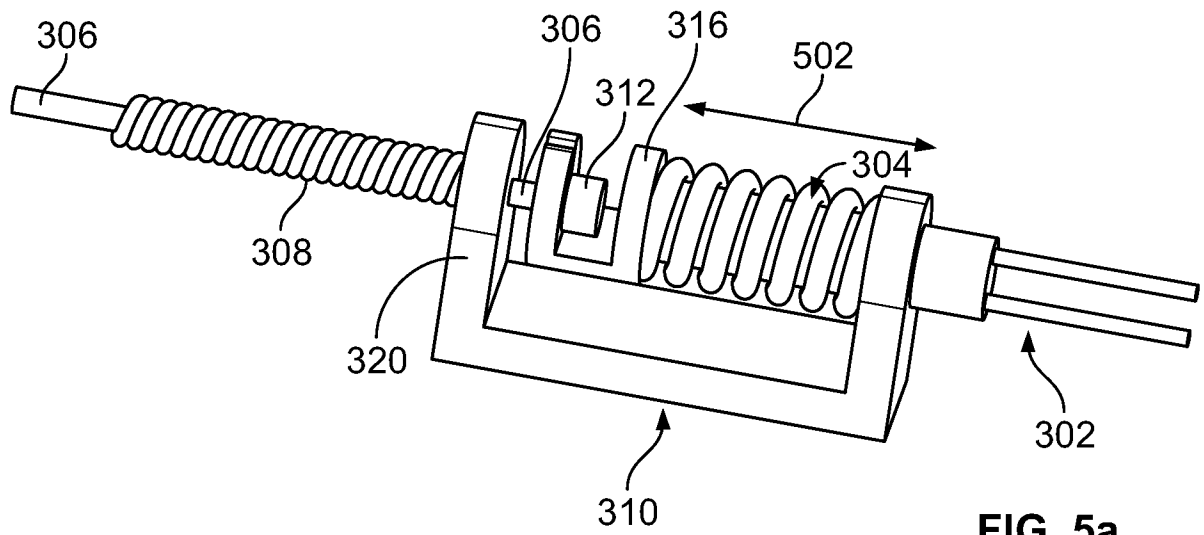
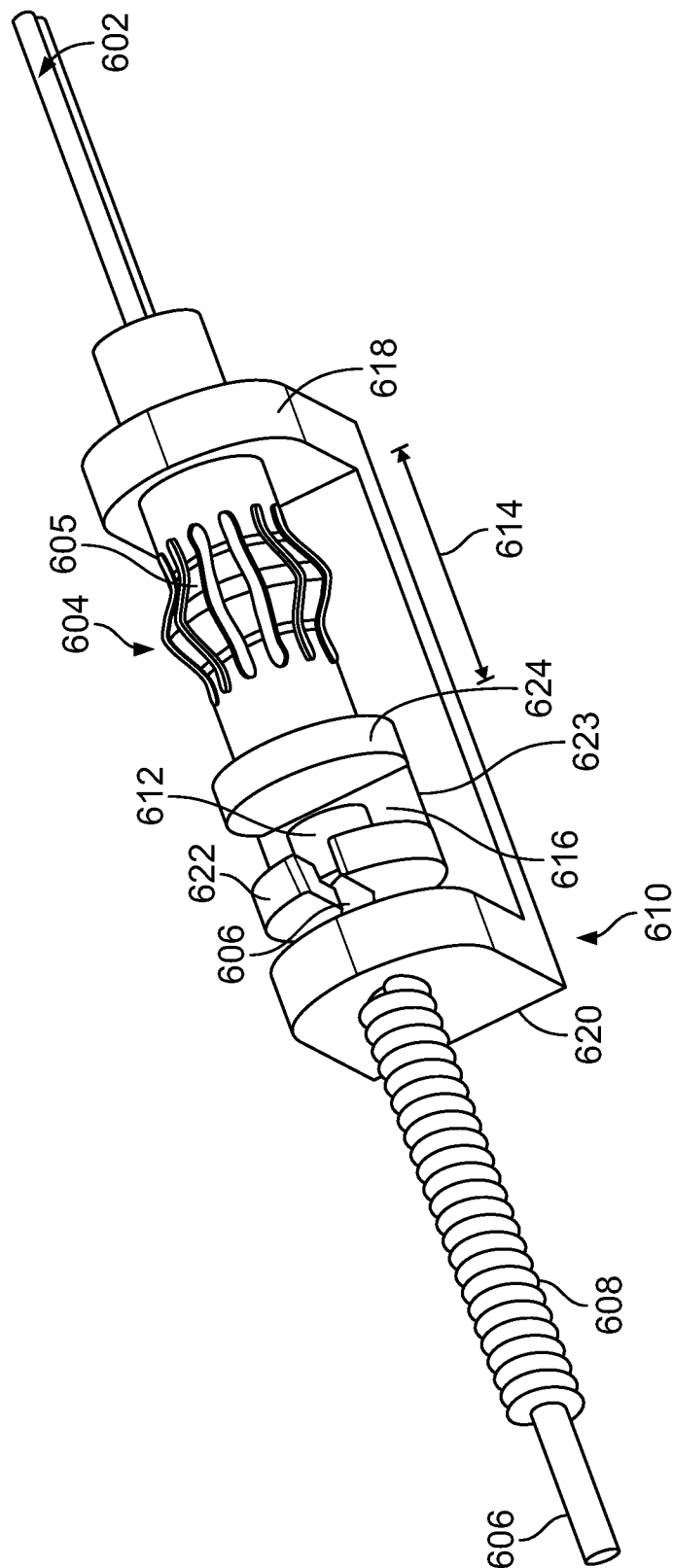

FIG. 4d

6/20





**FIG. 6**

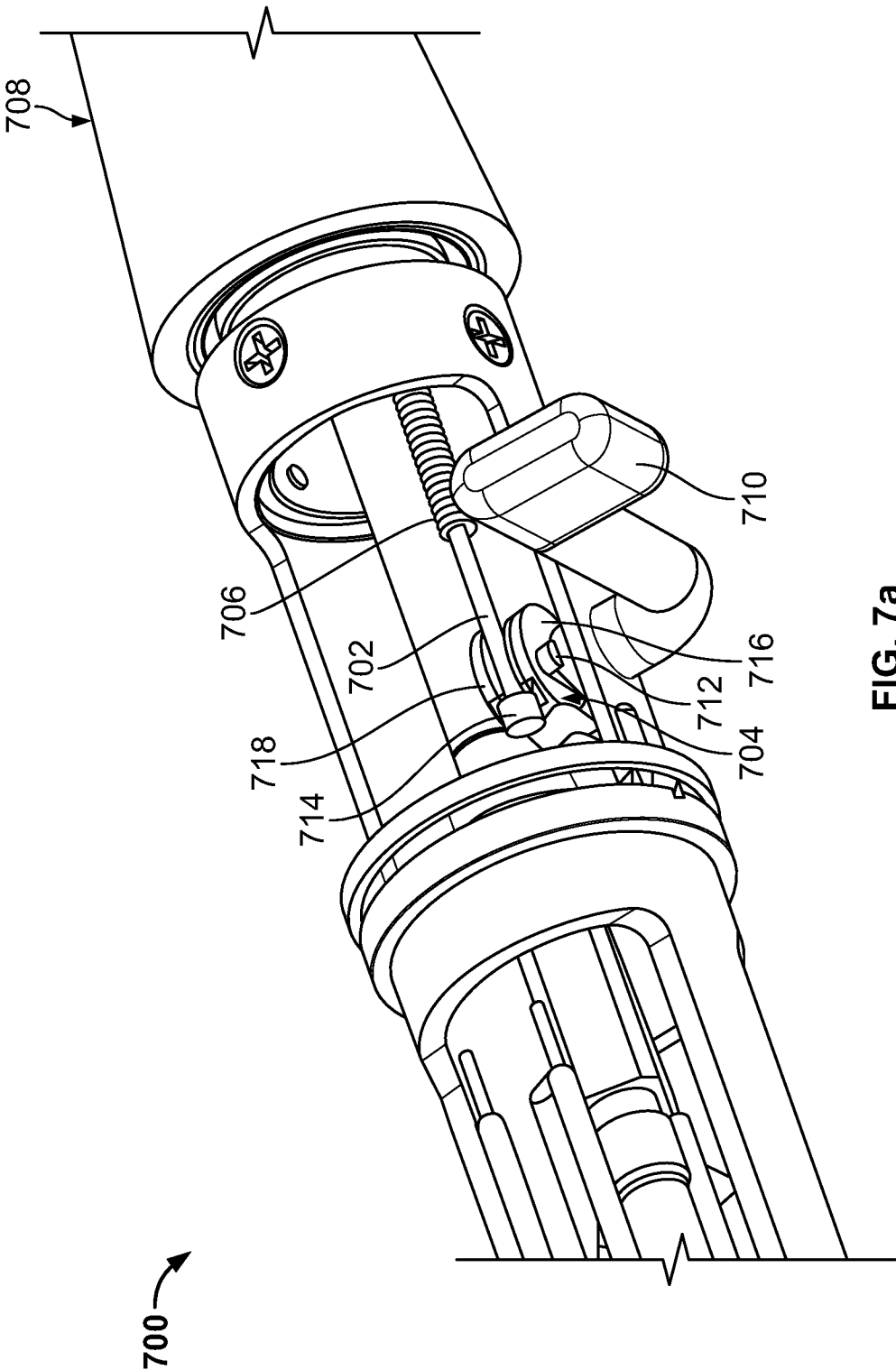

FIG. 7a



9/20

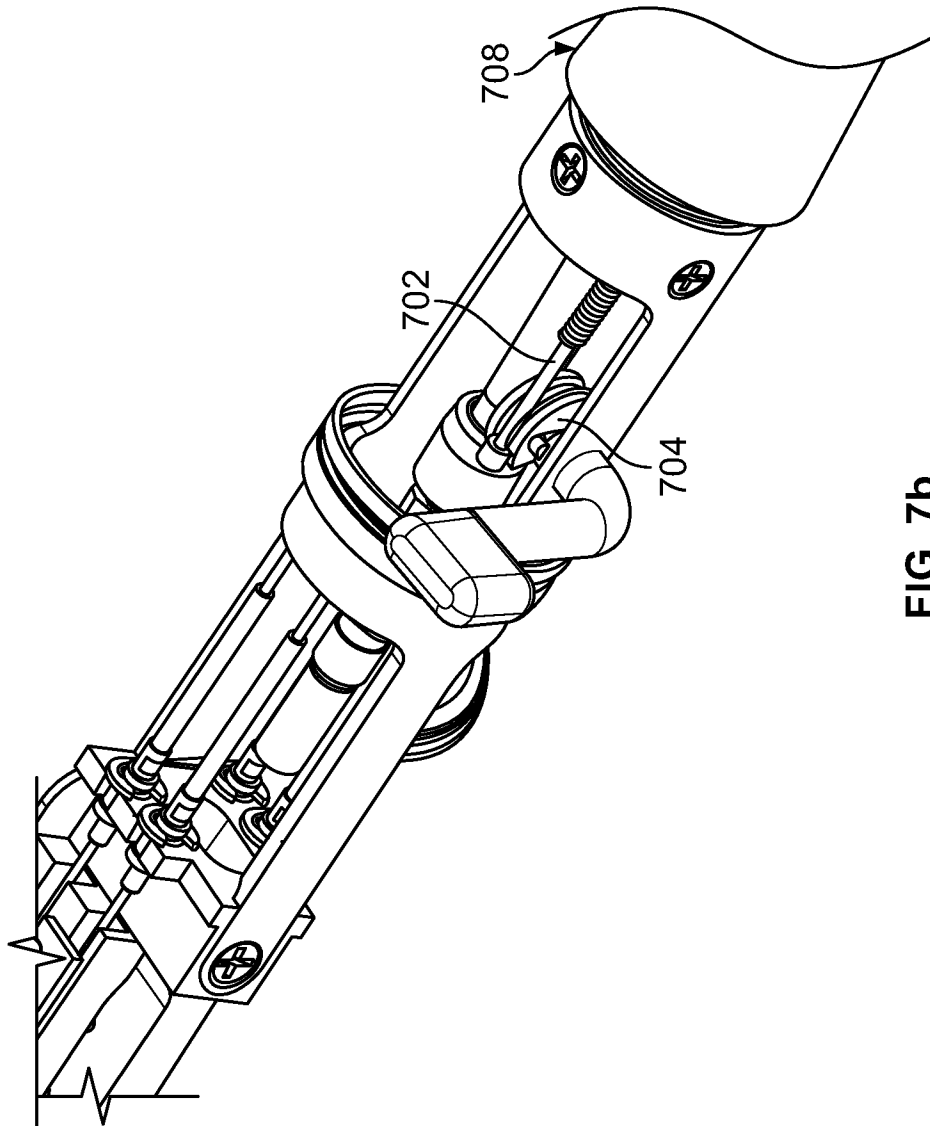

FIG. 7b

10/20

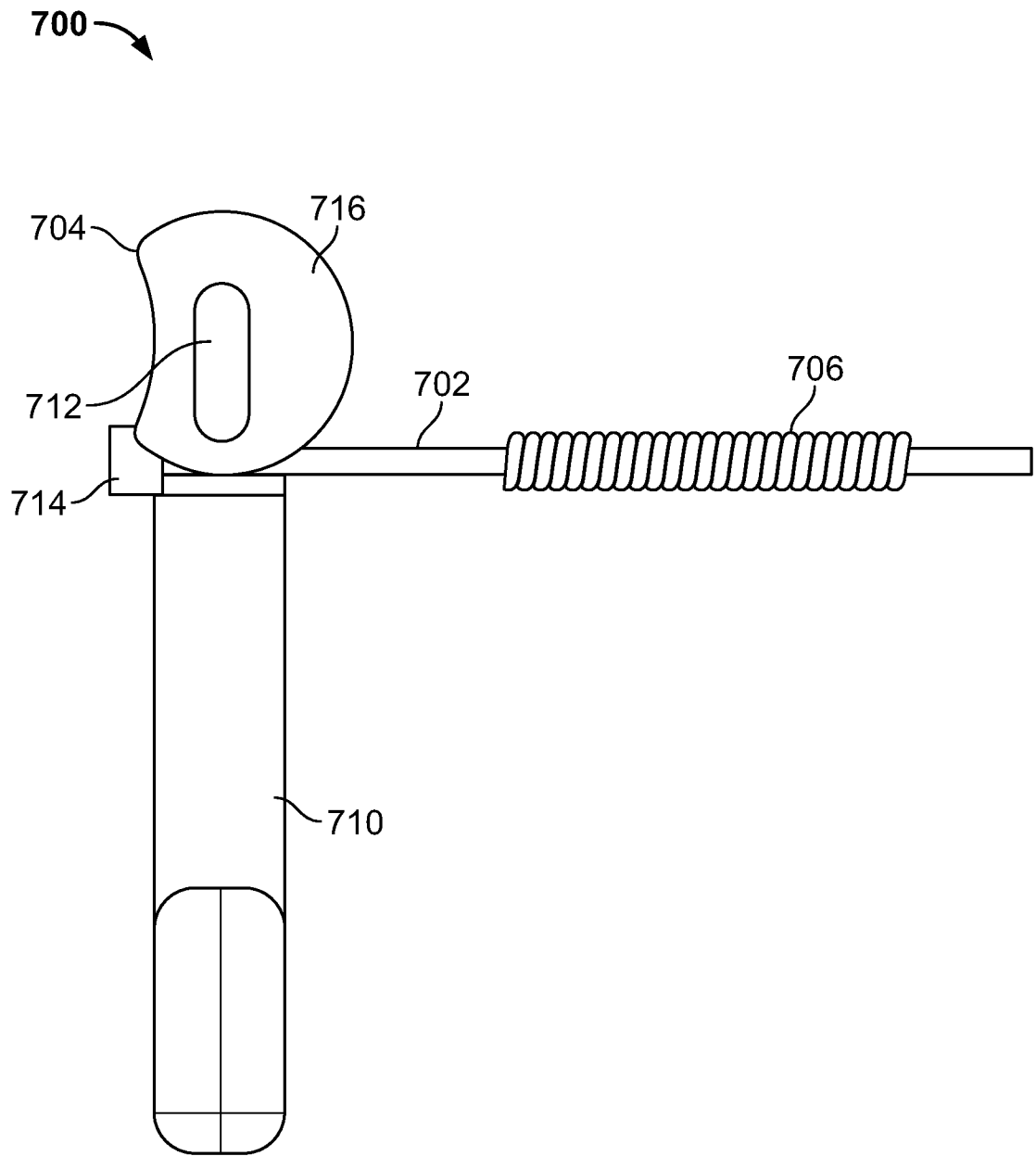

FIG. 7c

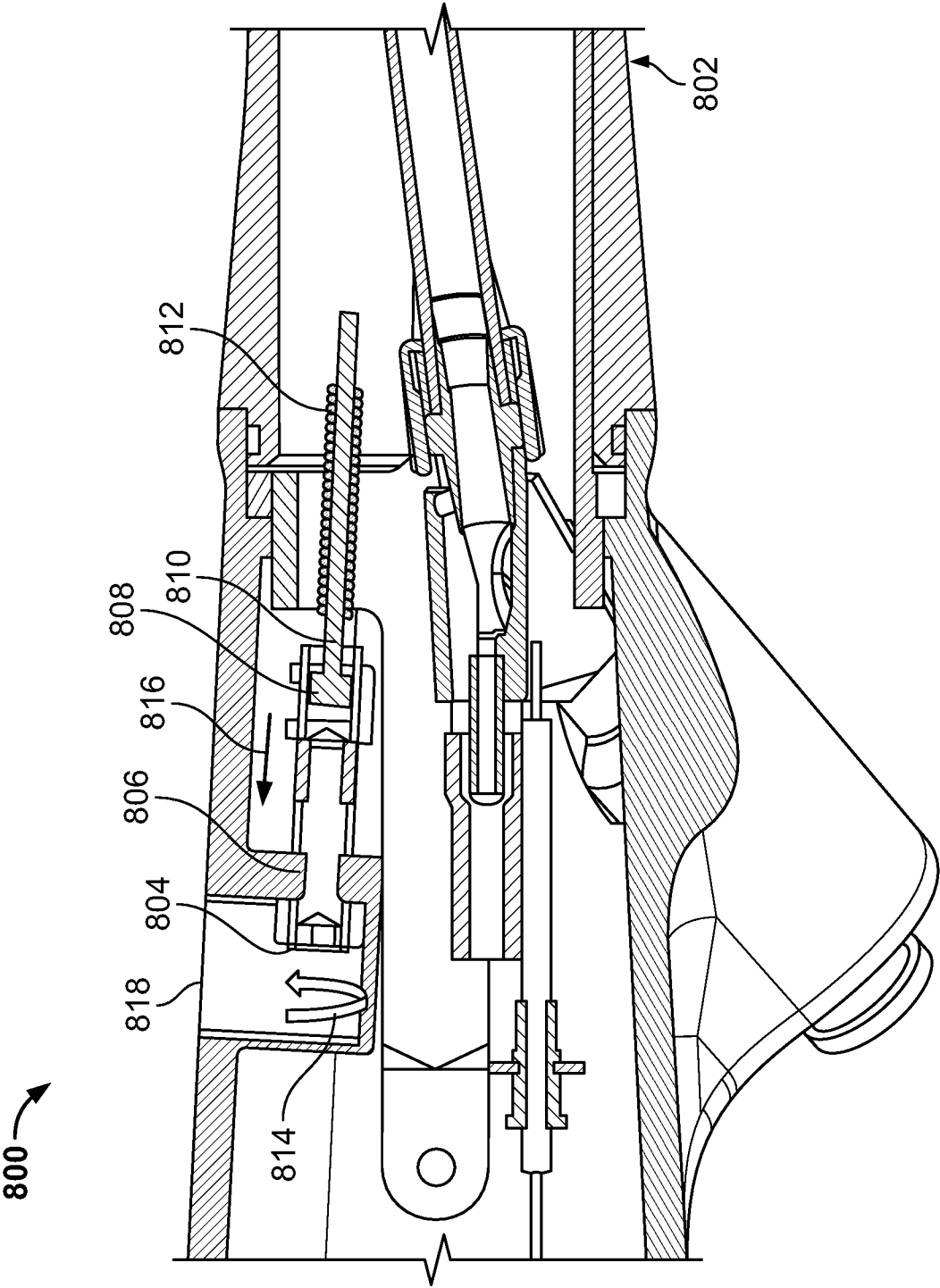

FIG. 8a

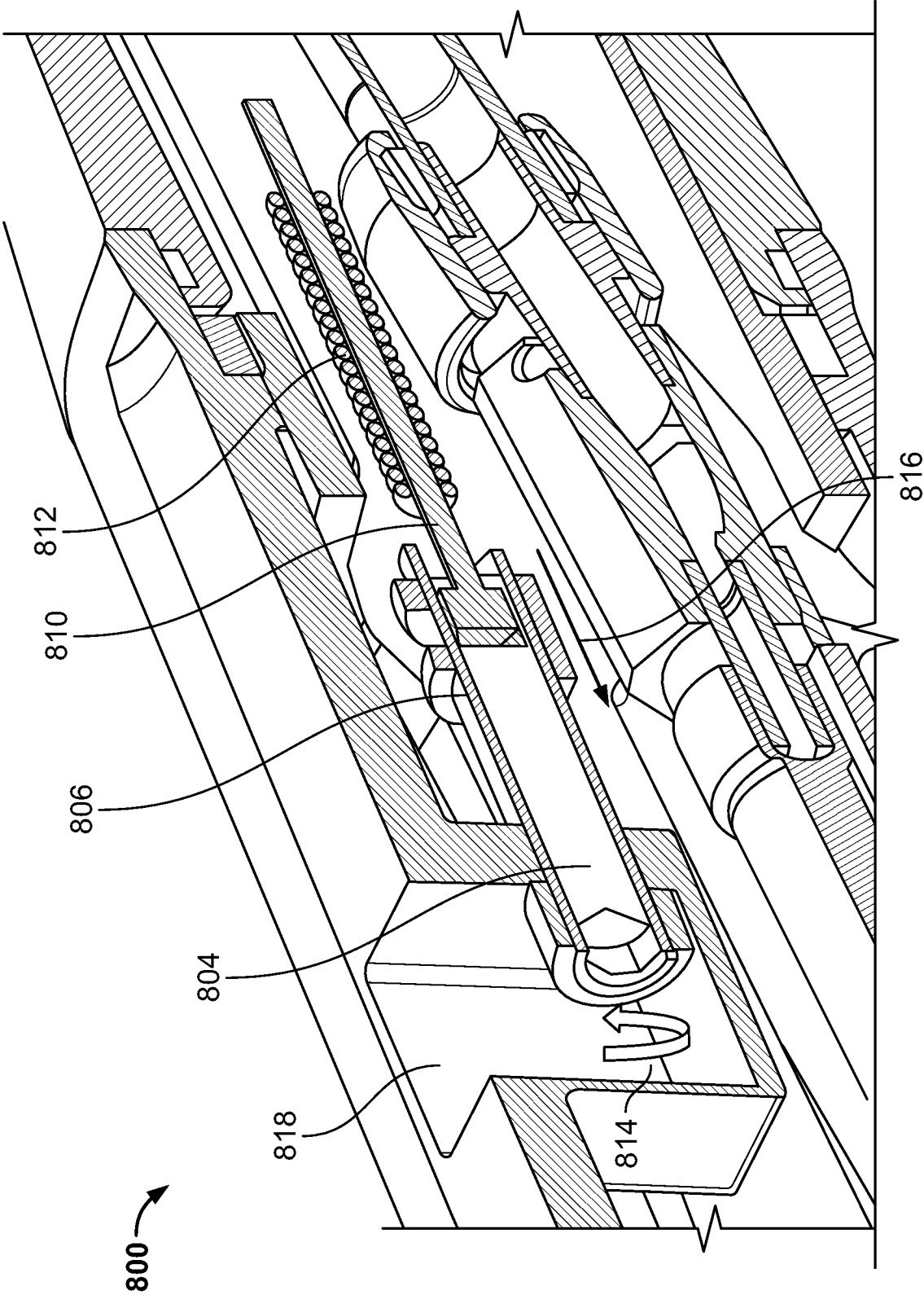

FIG. 8b

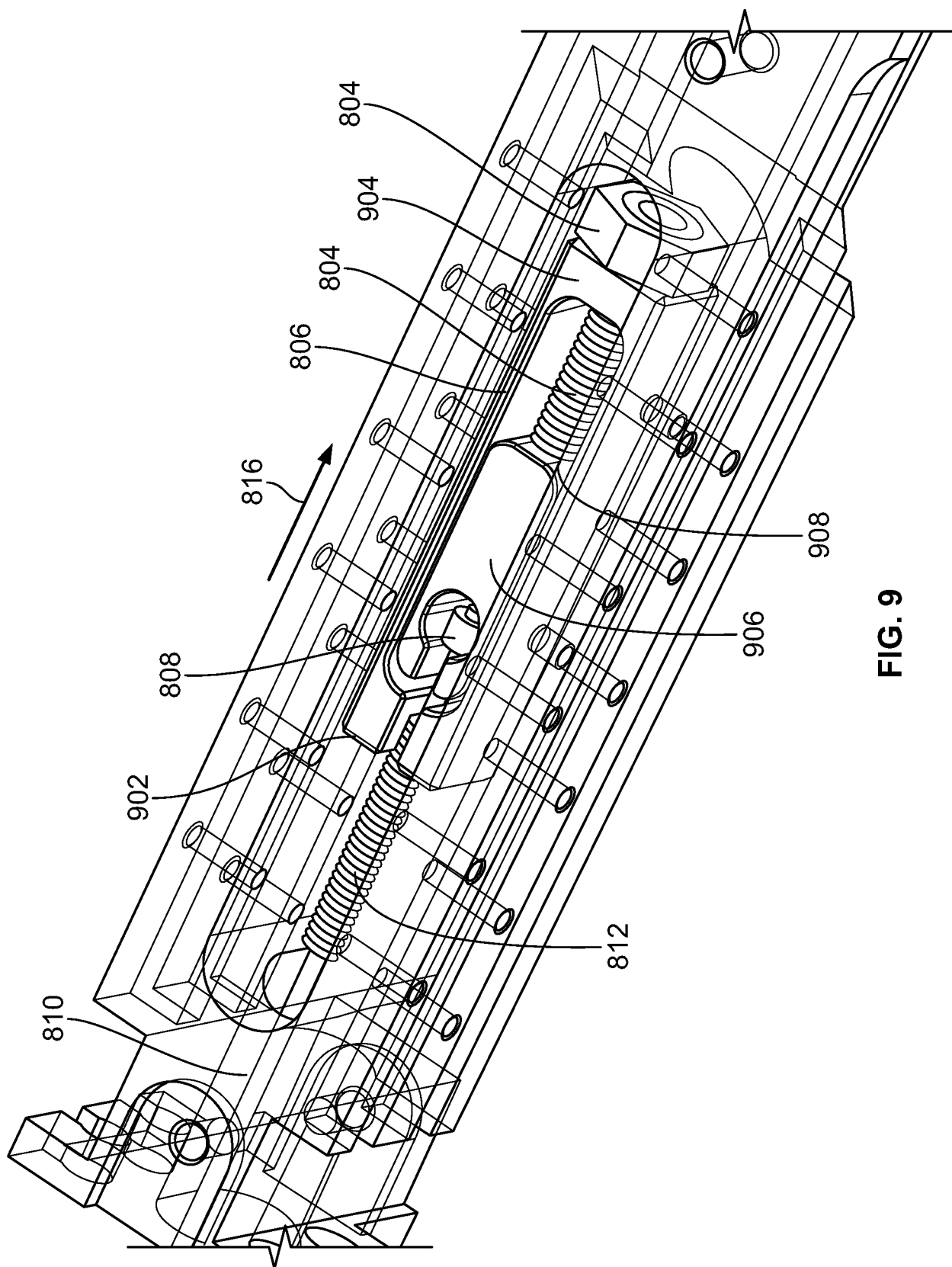

FIG. 9

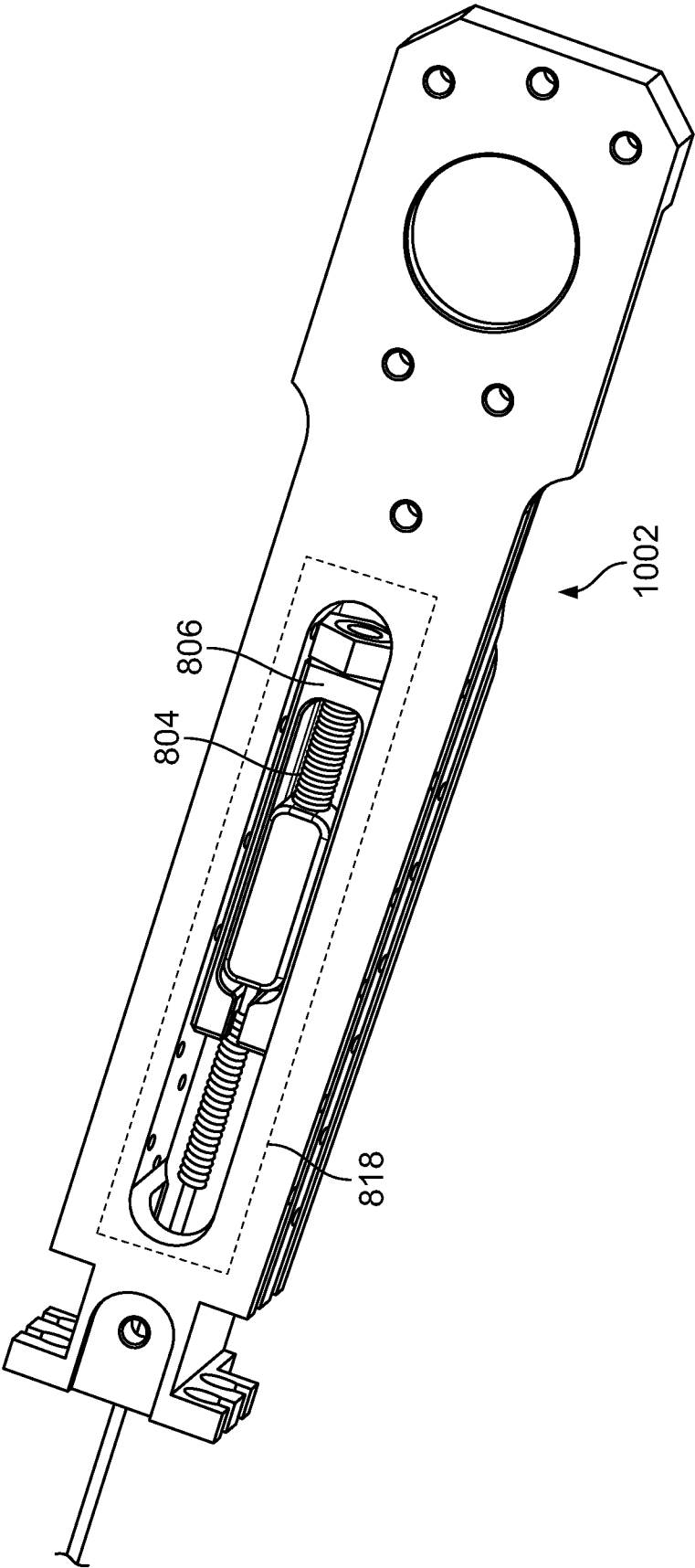

FIG. 10

15/20

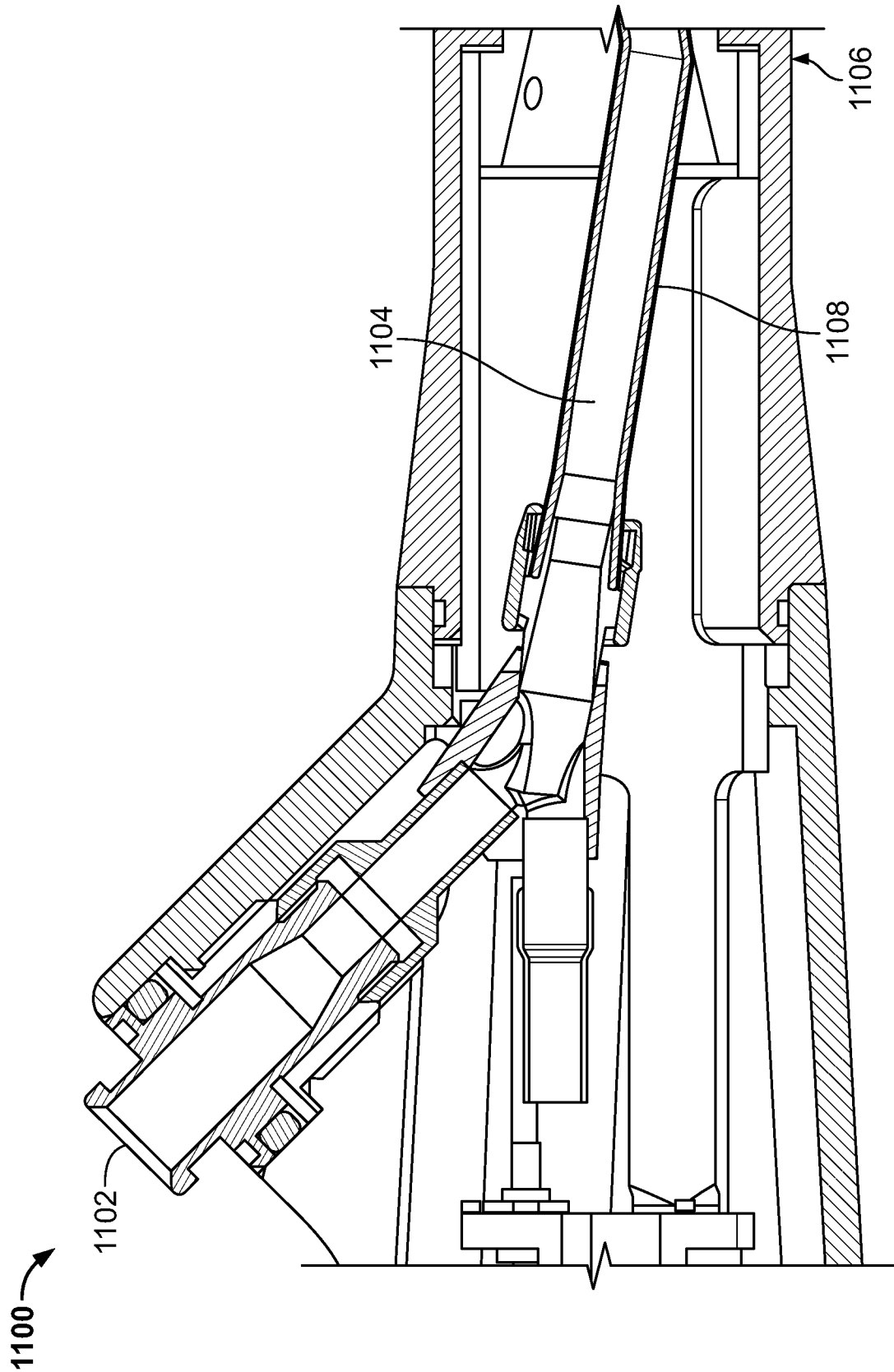
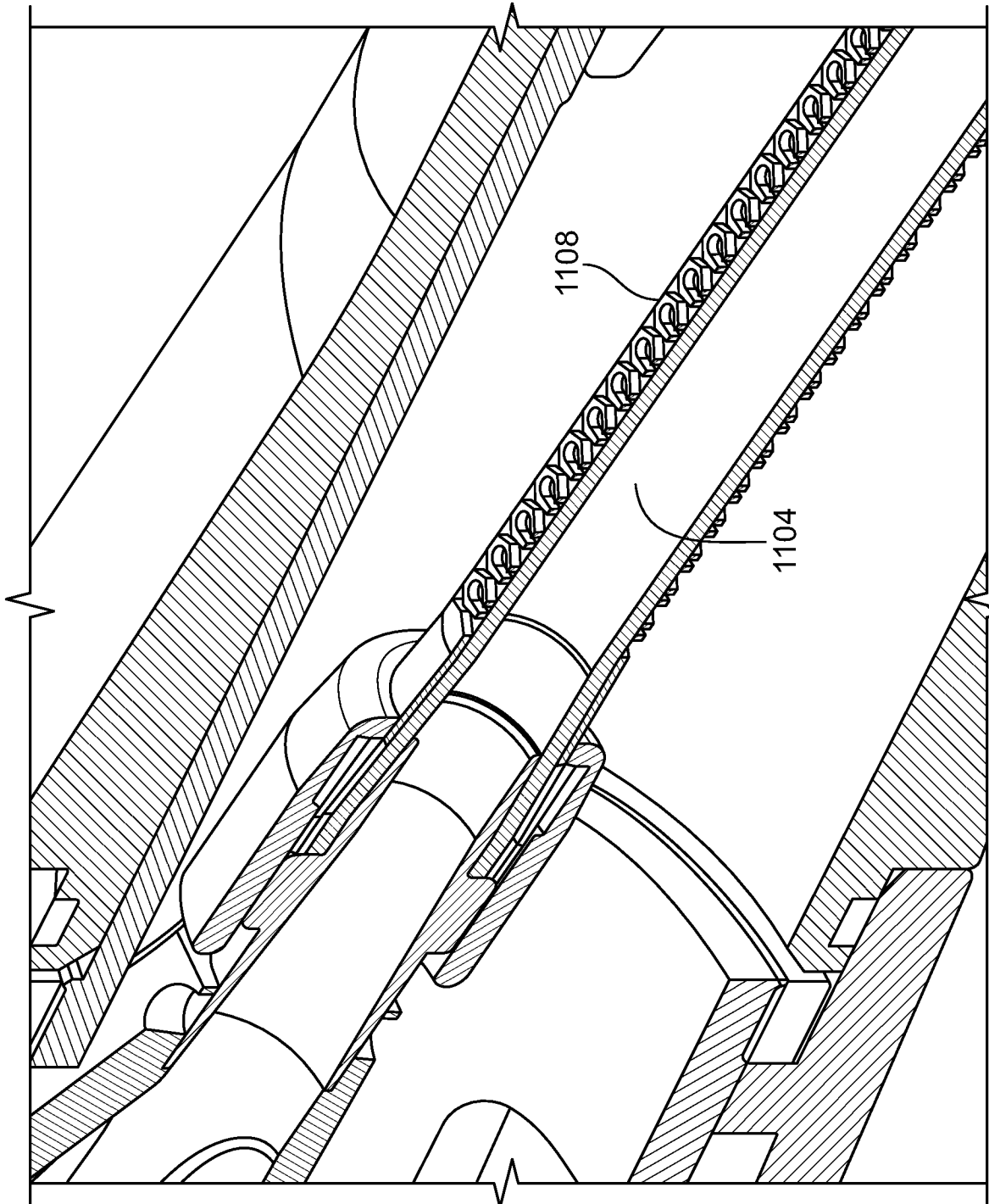

FIG. 11a

16/20





17/20

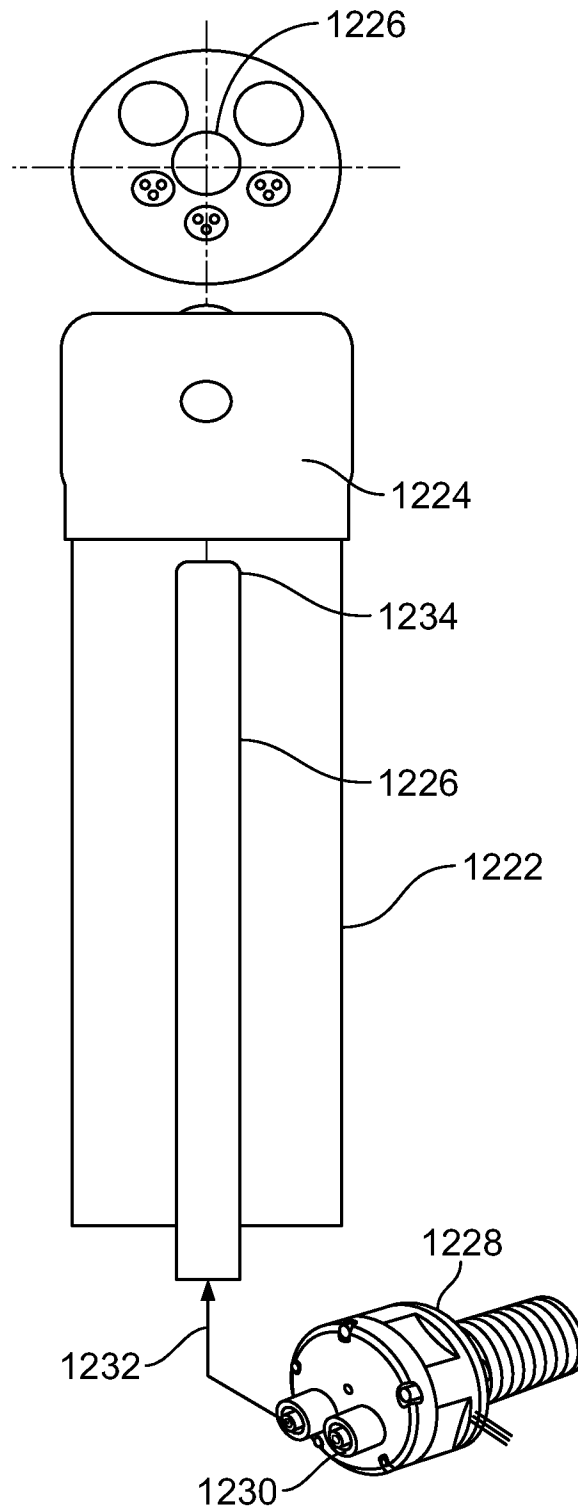

FIG. 12

18/20

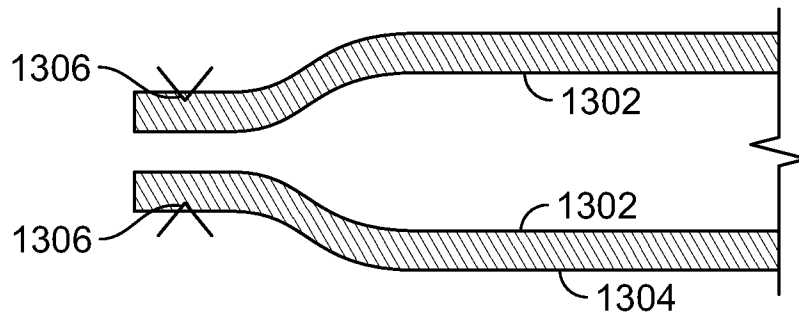

FIG. 13a

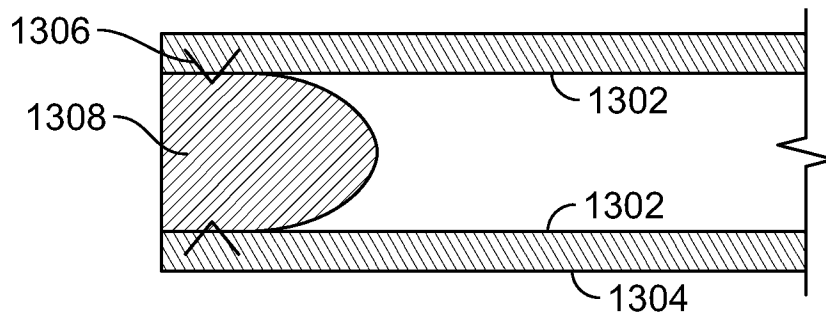

FIG. 13b

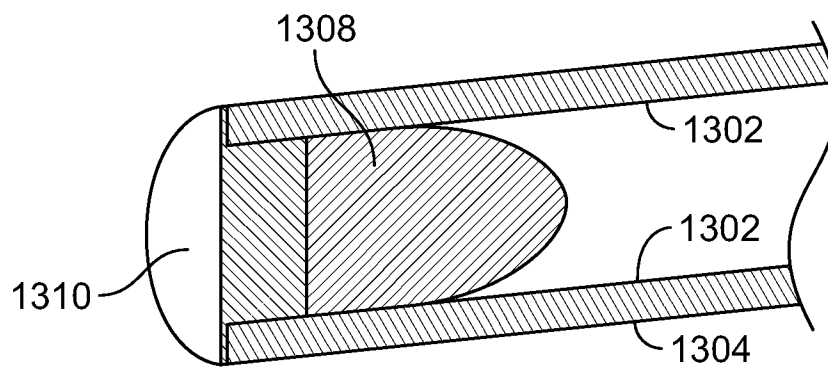

FIG. 13c

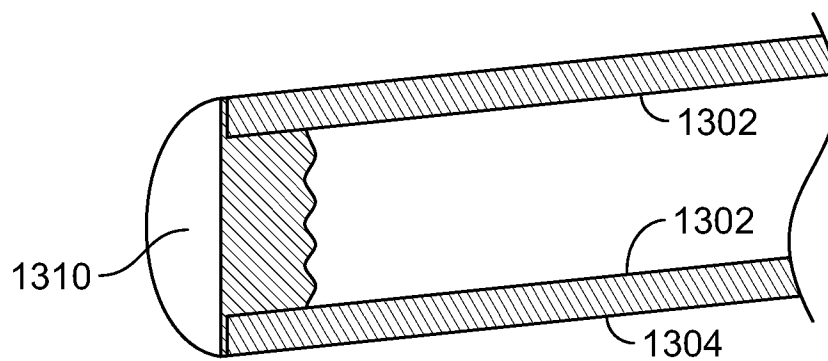

FIG. 13d

19/20

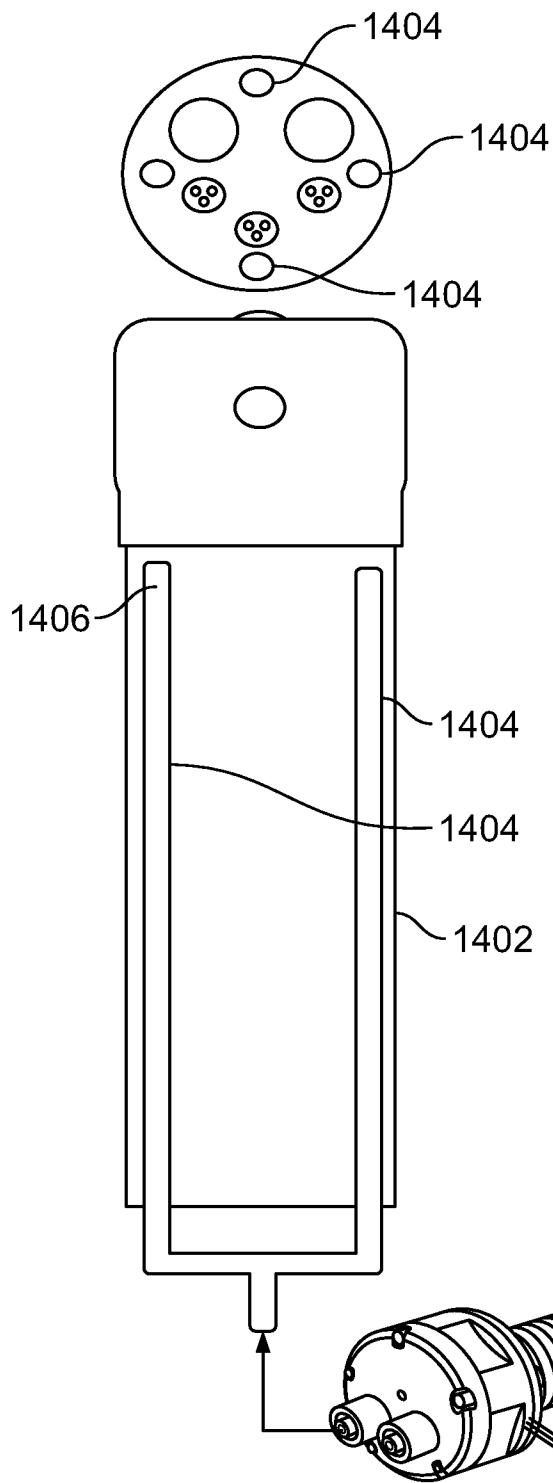

FIG. 14

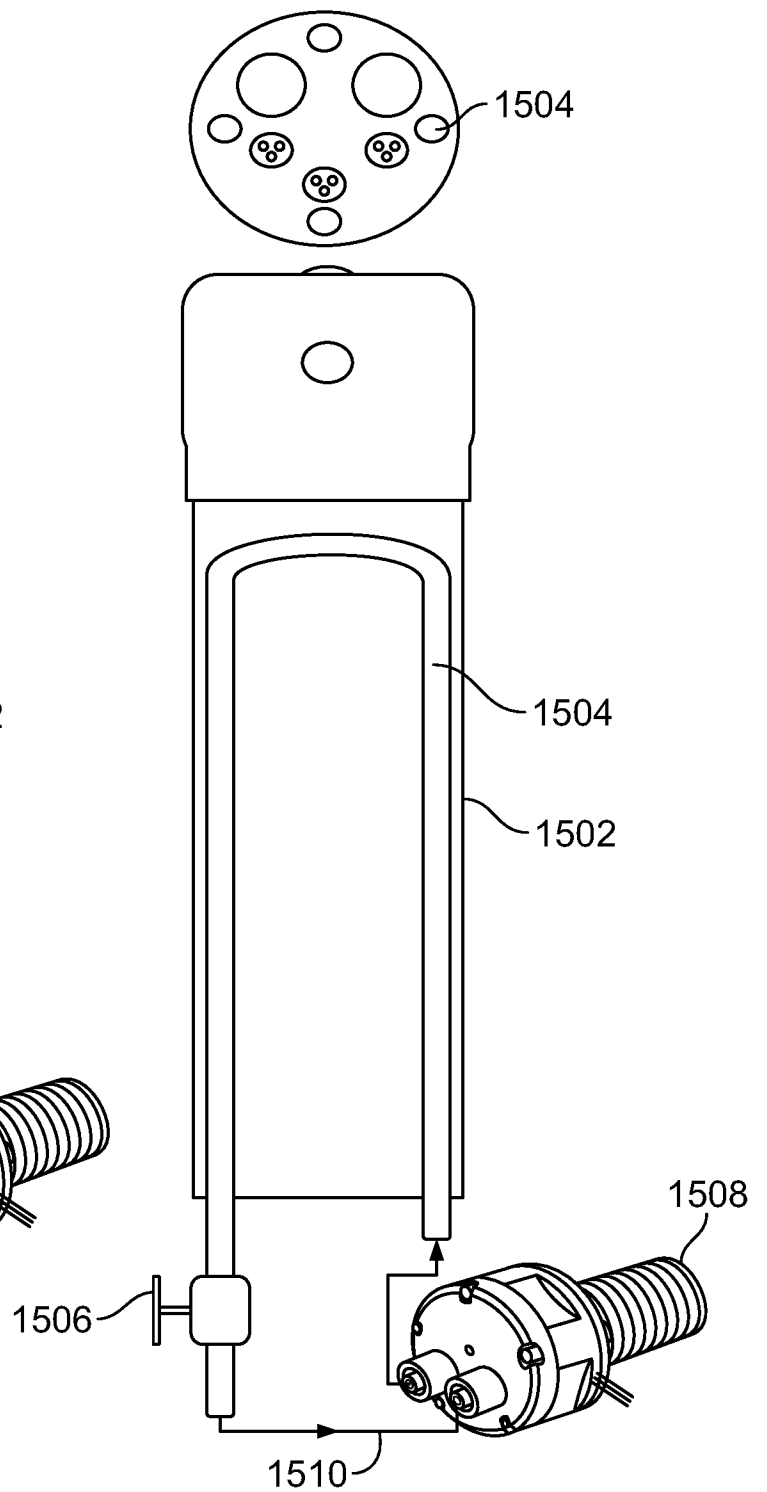
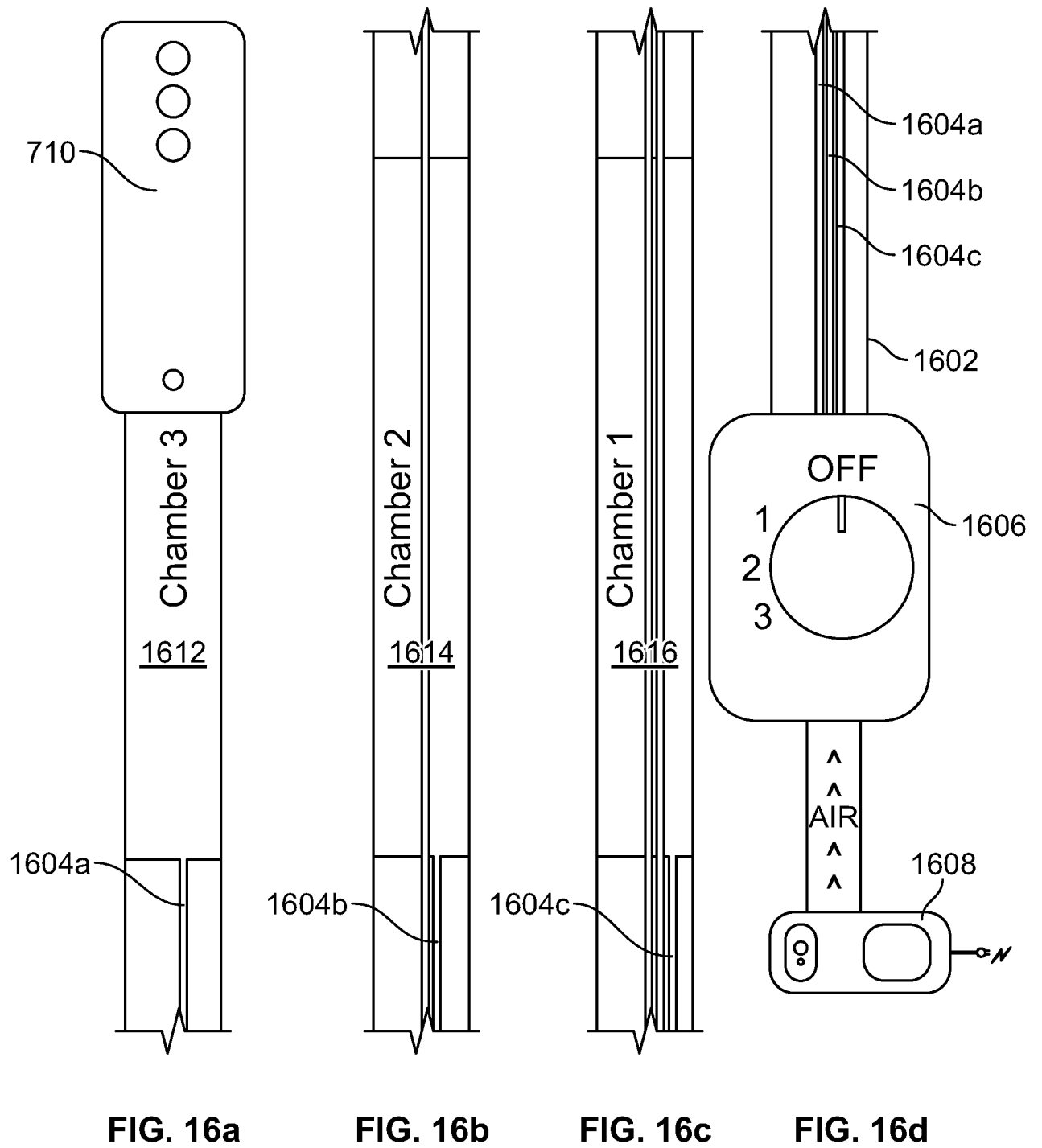

FIG. 15



## INTERNATIONAL SEARCH REPORT

International application No.

PCT/US 15/47334

## A. CLASSIFICATION OF SUBJECT MATTER

IPC(8) - A61B 1/005 (2015.01)

CPC - A61B 1/005

According to International Patent Classification (IPC) or to both national classification and IPC

## B. FIELDS SEARCHED

Minimum documentation searched (classification system followed by classification symbols)

IPC (8) A61B 1/005 (2015.01)

CPC: A61B 1/005

Documentation searched other than minimum documentation to the extent that such documents are included in the fields searched

CPC: A61B 1/00078

Electronic data base consulted during the international search (name of data base and, where practicable, search terms used)

PatBase; Google (Web, Scholar, Patents)

search terms: endoscope stiffness variable vary control wire screw rotate lengthen stretch housing hardness adjustable adjust modify rotate stopper move pull knob proximal distal translate connected operator controlled thread adjustment catheter

## C. DOCUMENTS CONSIDERED TO BE RELEVANT

Category*	Citation of document, with indication, where appropriate, of the relevant passages	Relevant to claim No.
X ----- Y	US 5,395,329 A (FLEISCHHACKER et al.); 07 March 1995 (07.03.1995); entire document, especially Figs. 1, 3, and 6, and col. 3, lines 47-49, col. 5, lines 32-35, col. 6, lines 50-53, and col. 7, lines 47-51.	1, 3-5, 7-8 ----- 2, 6
Y	US 5,810,715 A (MORIYAMA); 22 September 1998 (22.09.1998); entire document, especially Fig. 2 and col. 8, lines 1-11	2, 6
A	US 2005/0272975 A1 (McWEENEY); 08 December 2005 (08.12.2005); entire document.	1-8

☐ Further documents are listed in the continuation of Box C.

\* Special categories of cited documents:

"A" document defining the general state of the art which is not considered to be of particular relevance

"E" earlier application or patent but published on or after the international filing date

"L" document which may throw doubts on priority claim(s) or which is cited to establish the publication date of another citation or other special reason (as specified)

"O" document referring to an oral disclosure, use, exhibition or other means

"P" document published prior to the international filing date but later than the priority date claimed

"T" later document published after the international filing date or priority date and not in conflict with the application but cited to understand the principle or theory underlying the invention

"X" document of particular relevance; the claimed invention cannot be considered novel or cannot be considered to involve an inventive step when the document is taken alone

"Y" document of particular relevance; the claimed invention cannot be considered to involve an inventive step when the document is combined with one or more other such documents, such combination being obvious to a person skilled in the art

"&amp;" document member of the same patent family

Date of the actual completion of the international search

22 October 2015

Date of mailing of the international search report

28 DEC 2015

Name and mailing address of the ISA/US

Mail Stop PCT, Attn: ISA/US, Commissioner for Patents

P.O. Box 1450, Alexandria, Virginia 22313-1450

Facsimile No. 571-273-8300

Authorized officer:

Lee W. Young

PCT Helpdesk: 571-272-4300

PCT OSP: 571-272-7774

## INTERNATIONAL SEARCH REPORT

International application No.

PCT/US 15/47334

**Box No. II Observations where certain claims were found unsearchable (Continuation of item 2 of first sheet)**

This international search report has not been established in respect of certain claims under Article 17(2)(a) for the following reasons:

1. ☐ Claims Nos.:  
because they relate to subject matter not required to be searched by this Authority, namely:
  
2. ☐ Claims Nos.:  
because they relate to parts of the international application that do not comply with the prescribed requirements to such an extent that no meaningful international search can be carried out, specifically:
  
3. ☐ Claims Nos.:  
because they are dependent claims and are not drafted in accordance with the second and third sentences of Rule 6.4(a).

**Box No. III Observations where unity of invention is lacking (Continuation of item 3 of first sheet)**

This International Searching Authority found multiple inventions in this international application, as follows:  
This application contains the following inventions or groups of inventions which are not so linked as to form a single general inventive concept under PCT Rule 13.1. In order for all inventions to be examined, the appropriate additional examination fees must be paid.

Group I: Claims 1-8, directed to an endoscope assembly comprising an insertion portion that is connected to a handle at a proximal end of the insertion portion and a bending portion at a distal end of the insertion portion, comprising a screw, a housing in communication with the screw, a stopper within the housing, and a wire connected to the stopper.

Group II: Claims 9-18 directed to an endoscope assembly comprising an insertion portion that is connected to a handle at a proximal end of the insertion portion and a bending portion at a distal end of the insertion portion, comprising an actuator, a spring in communication with the actuator, and a wire connected to the spring.

-\*-Continued in extra sheet\*-\*

1. ☐ As all required additional search fees were timely paid by the applicant, this international search report covers all searchable claims.
2. ☐ As all searchable claims could be searched without effort justifying additional fees, this Authority did not invite payment of additional fees.
3. ☐ As only some of the required additional search fees were timely paid by the applicant, this international search report covers only those claims for which fees were paid, specifically claims Nos.:
4. ☒ No required additional search fees were timely paid by the applicant. Consequently, this international search report is restricted to the invention first mentioned in the claims; it is covered by claims Nos.:  
1-8

**Remark on Protest**

- ☐ The additional search fees were accompanied by the applicant's protest and, where applicable, the payment of a protest fee.
- ☐ The additional search fees were accompanied by the applicant's protest but the applicable protest fee was not paid within the time limit specified in the invitation.
- ☐ No protest accompanied the payment of additional search fees.

## INTERNATIONAL SEARCH REPORT

International application No.

PCT/US 15/47334

-\*Box III - Observations where unity of invention is lacking-\*

The inventions listed as Groups I-II do not relate to a single general inventive concept under PCT Rule 13.1 because, under PCT Rule 13.2, they lack the same or corresponding special technical features for the following reasons:

## SPECIAL TECHNICAL FEATURES

The invention of Group I includes the special technical feature of a screw configured to rotate around a longitudinal axis of the endoscope assembly, a housing in physical communication with the screw, wherein the housing is configured to move in a direction that is at least one of a distal direction and a proximal direction along the longitudinal axis of the endoscope assembly, with the rotation of the screw, a stopper placed within the housing, and a wire having a proximal end and a distal end, wherein the proximal end of the wire is connected to the stopper, the wire stretches along a length of the insertion portion, and the distal end of the wire is connected to a proximal end of the bending portion and wherein the wire stiffens the insertion portion upon rotation of the screw towards distal end of the insertion portion, not required by the claims of Group II.

The invention of Group II includes the special technical feature of an actuator, a spring, having a proximal end and a distal end, wherein the proximal end of the spring is connected to the actuator and wherein the actuator activates the spring, and a wire, having a proximal end and a distal end, with the proximal end of the wire connected to the distal end of the spring, wherein the wire stretches along a length of the insertion portion and wherein the distal end of the wire is connected to a proximal end of the bending portion, and wherein the wire stiffens the insertion portion upon activation of the spring, not required by the claims of Group I.

## COMMON TECHNICAL FEATURES

Groups I-II share the common technical features of an endoscope assembly comprising an insertion portion that is connected to a handle at a proximal end of the insertion portion and a bending portion at a distal end of the insertion portion. However, this shared technical feature does not represent a contribution over prior art as being anticipated by US 5,810,715 A to Moriyama, which discloses an endoscope assembly (electronic endoscope 2, Fig. 2), comprising an insertion portion that is connected to a handle at a proximal end of the insertion portion (insertion part 6 is connected to operation part 7, Fig. 1) and a bending portion at a distal end of the insertion portion (a curveable curvature part 12 is formed at the distal end of insertion part 6, Fig. 1).

As the common technical features were known in the art at the time of the invention, these cannot be considered special technical feature that would otherwise unify the groups.

Therefore, Groups I-II lack unity under PCT Rule 13 because they do not share a same or corresponding special technical feature.