

(19)  
(12)

(KR)  
(B1)

(51) 。 Int. Cl. <sup>7</sup>  
B62D 67/00

(45)  
(11)  
(24)

2002 08 24  
10 - 0349751  
2002 08 09

(21) 10 - 2000 - 0062060  
(22) 2000 10 20

(65) 2002 - 0031547  
(43) 2002 05 02

(73) 231

(72) 1 8 - 204 201

(74)  
:

(54)

가 , /  
, /  
, /  
, /  
, /  
가 ,  
.

1

2

3a

3b

가

4

5

6

7

8

9

10

<

10 : 12 :

14 : 20 :

22 : 26 :

30 : 40 :

50 : 60 :

70 :

, , , 가 가 / /

가

가

가

10

(80)

(12)

(14)  
(18a, 18b)

가

가

(14)

(14)

(80)

가

가

(80)

가  
가

(22)

(22)

(26)

(12)

(20) ;

(36) 가 (35)  
(32) (34)가 (32) , (32)  
(32) 가 (36) (38)  
(30) ;

(410) , (414) (410) (14) /  
(410) (412) , (412) (418)  
(12) , (416) , (410) (4)  
10) (420) , (420) (422)  
(410) (428) (426)가  
(424) , (420) 가 (424)  
가 (410) (424) (430)  
(40) ;

(54) 가 (52) , (52)  
(50) ;

(20, 30, 40, 50)가 (20, 30, 40, 50)  
(60) ; ,

(50) / (60) (14) (70)

;

(22) (12) (24)가

(30) (40) (50) /  
(14) (10) /

(30) 2 1 (32) (32)  
(38)가

(30) (60) (39) (18) /

(40) (420) (424)가 (430)  
(424) 가 (40)

(54) (52) (55) ,

(55) (56) , (56)  
(14) (57)

1 , 2

3a 가 3b

4 5

(50) (60) (70) (20) (30) (40)

(20) (12) (14) (26) (12) (22)

(22) (12) (12) 가 (24) (12)

/ (12) (22) 가 (26)가 (22)가

(30) (40) (50) (12)

(12) (14) (18a, 18b) (14) (30, 40)가 (50)가

(14)

/ (14) (30, 40)가 (10)

/ (40) (30, 40) (30)

(32) (30) (32)가 (36) (36) 가 ( / )

(32)가 (38)가

(32) (35) (18a)

(34)가 (12) (18a) (16) (18a) 가 (18a)

(30) (38)가 3b (38)가 (32) (32)

(10) (18a) /

(30) / 1 (39)

(10)

(39) / (30)가

(30) 가

(40) (10) (18b)

/ (14) (10) /

2) , (410) (422) (412) (40) (410) , (414) (12) (410) (416) , (420) , (420) (428) (41) (424) (426)가 (424) , (420) (424) 가 (410) (424) (430) .

(424) (420) (424)가 (40) (430) .

가 (424)가 (18b) (12) (18b) (18b) (16) (426)가 ,

(420)가 (424) (418) (12) , (416) (412) (12)

(424)가 (12)

, .

, (414) (40) (414) (412)가 (10) (14)

(40)가 .

, (412) 300 mm/min .

(14) (50) (12) (30, 40) (18a, 18b) (60)

(52) , (52) (54) , (54)가 (52) (14) .

(55) (54) (52) (56) , (56) (55) , (57)

(57) (14)가 .

/ 12 (14) , / 1 , 14 (14)

(57)가 (57)가 .

, (57)가 (14) (56) (56) ,

(54) (14) (52) 가 300 mm/min가 (60) ,

(14)

(14) (70) (50) / (60)

, (60) (14)가 (12)

(12) / (20) 1 , /

(30) 1 , / (40) 1 , (50) 1

가가

1 (30, 40) (50)

6 9 , ,

(20) (14)가 (10)가

(30) (20) (12)가 , / (14)

(40)가 (12) / 가

(38,420) (34) 가

(30) , (34) (34) (35) (18a) (18a)

(38) (34) (18a)

가

(12) (16)가 , 90

가

(40) , (426) (428) (18b)

(412) (40) , (418) (416)가 (12)

(40) (424)가 (420) (428)

(18b) 가 (12) (16) ,

90

(18a, 18b)가 (30, 40) , (10) /

(50)가

(56) / (54) , / (57)가 (14)

(14)

/ , ,

가 가 가 , ,

가 가 .

(57)

1.

(12) / , (22) , (22)  
 (26) (20) ;

(36) 가 (35)  
 (34)가 (32) , (32)  
 (32) 가 (36) (38)  
 (30) ;

(410) , (414) (410) (14) /  
 (410) (412) , (412) (418)  
 (12) , (416) , (410) (4)  
 10) (420) , (420) (422)  
 (410) (428) (426)가  
 (424) , (420) 가 (424)  
 가 (410) (424) (430)  
 (40) ;

가 (52) , (52)  
 (54) (50) ;

(20, 30, 40, 50)가 , (20, 30, 40, 50)  
 (60) ;

(50) / (60) (14) (70)

;

2.

1 , (22) (12) (24)가

3.

1 , (30) (40) (50) /  
 (14) (10) /

4.

1 , (30) 2 1 (32) (  
 32) (38)가

5.

1 , (30) (60) (39) (18)  
/

6.

1 , (40) (420) (424)가 (430)  
0) , (424) 가 (4

7.

1 , (54) (52) (55) ,  
(14) (55) (56) , (56) (55)

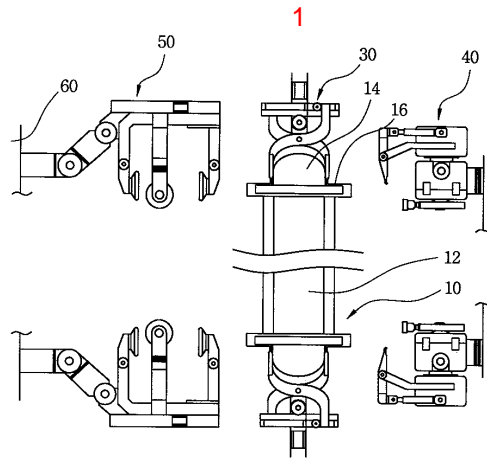

2

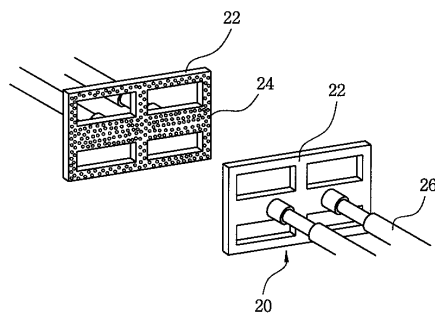

3a

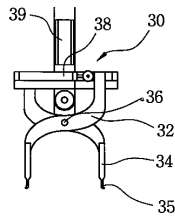

3b

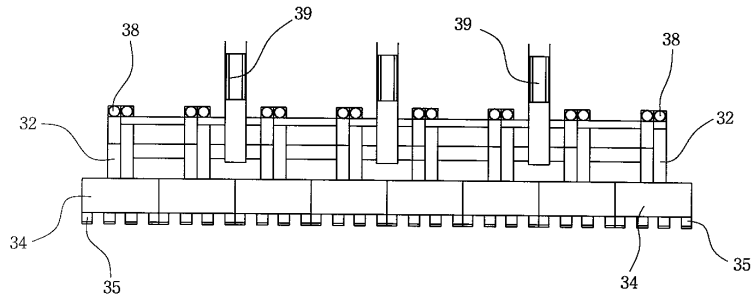

4

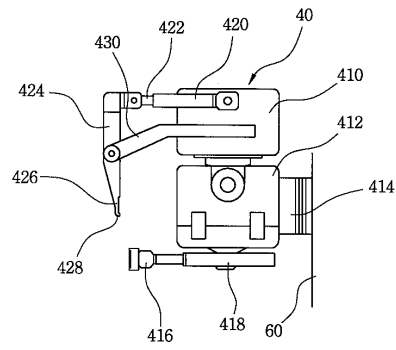

5

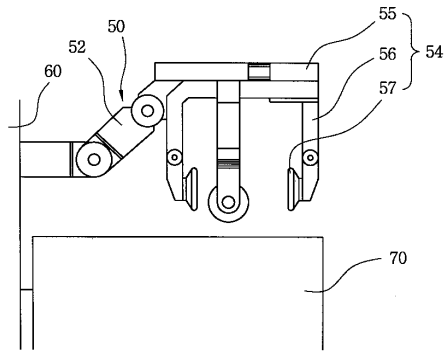

6

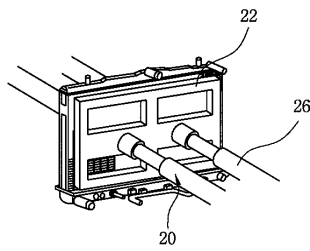

7

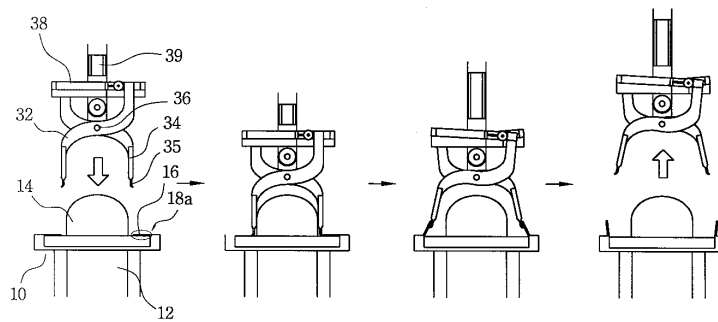

8

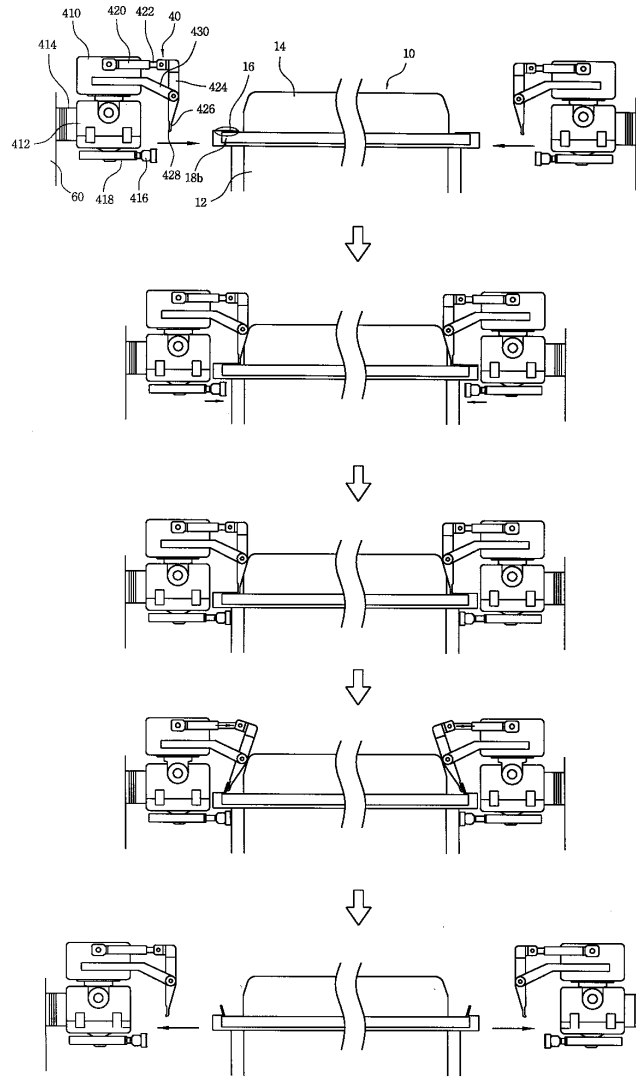

9

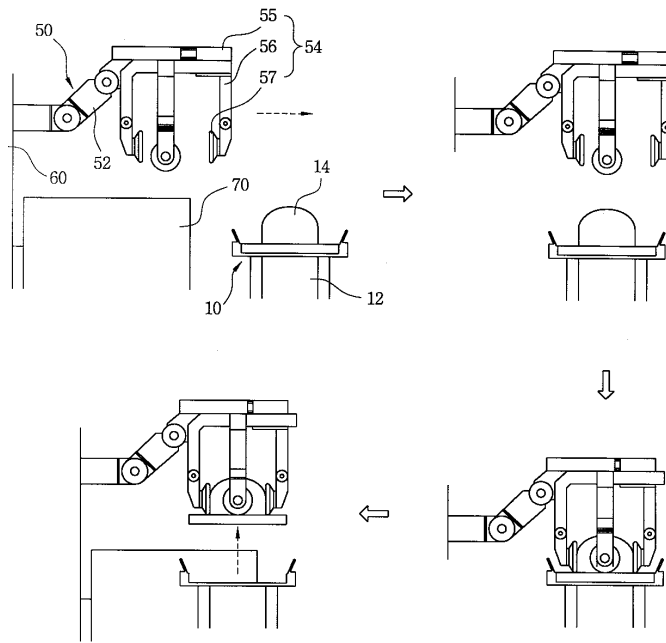

10

