



(51) International Patent Classification:
B62D 35/00 (2006.01)

(21) International Application Number:

PCT/US2017/013028

(22) International Filing Date:

11 January 2017 (11.01.2017)

(25) Filing Language:

English

(26) Publication Language:

English

(30) Priority Data:

62/277,045 11 January 2016 (11.01.2016) US

(71) Applicant: **MULTIMATIC PATENTCO, LLC**
[US/US]; 26475 American Drive, Southfield, Michigan
48034 (US).

(72) Inventors: **CZAPKA, Richard Anthony**; 463 Feasby Rd.,
Uxbridge, Ontario L9P 1R1 (CA). **CAUSLEY, Joel Dav-
id**; 2 St. Moritz Way, Unit #8, Markham, Ontario L3R 4E8
(CA). **GRUBER, Rudolf**; 12 Hillborne Crt., Uxbridge,
Ontario L9P 1R4 (CA).

(74) Agent: **GOTTSCHALK, William S.**; Carlson, Gaskey &
Olds, P.C., 400 West Maple Road, Suite 350, Birmingham,
Michigan 48009 (US).

(81) Designated States (unless otherwise indicated, for every
kind of national protection available): AE, AG, AL, AM,
AO, AT, AU, AZ, BA, BB, BG, BH, BN, BR, BW, BY,
BZ, CA, CH, CL, CN, CO, CR, CU, CZ, DE, DJ, DK, DM,
DO, DZ, EC, EE, EG, ES, FI, GB, GD, GE, GH, GM, GT,
HN, HR, HU, ID, IL, IN, IR, IS, JP, KE, KG, KH, KN,
KP, KR, KW, KZ, LA, LC, LK, LR, LS, LU, LY, MA,
MD, ME, MG, MK, MN, MW, MX, MY, MZ, NA, NG,
NI, NO, NZ, OM, PA, PE, PG, PH, PL, PT, QA, RO, RS,
RU, RW, SA, SC, SD, SE, SG, SK, SL, SM, ST, SV, SY,
TH, TJ, TM, TN, TR, TT, TZ, UA, UG, US, UZ, VC, VN,
ZA, ZM, ZW.

(84) Designated States (unless otherwise indicated, for every
kind of regional protection available): ARIPO (BW, GH,
GM, KE, LR, LS, MW, MZ, NA, RW, SD, SL, ST, SZ,
TZ, UG, ZM, ZW), Eurasian (AM, AZ, BY, KG, KZ, RU,
TJ, TM), European (AL, AT, BE, BG, CH, CY, CZ, DE,
DK, EE, ES, FI, FR, GB, GR, HR, HU, IE, IS, IT, LT, LU,

[Continued on next page]

(54) Title: VEHICLE REAR WING WITH ADAPTIVE SECTION AND EXTENDABLE FLAP

(57) Abstract: A deployable vehicle rear wing conforms closely to the styled surface of the vehicle body in a retracted, or stowed, position while adaptively changing its cross section in a deployed position so as to provide a highly efficient airfoil section, with an integrated Gurney flap. Additionally, the adaptive cross section changes and Gurney flap deployment is provided via a linkage that utilizes a drive mechanism of a main deployment system.

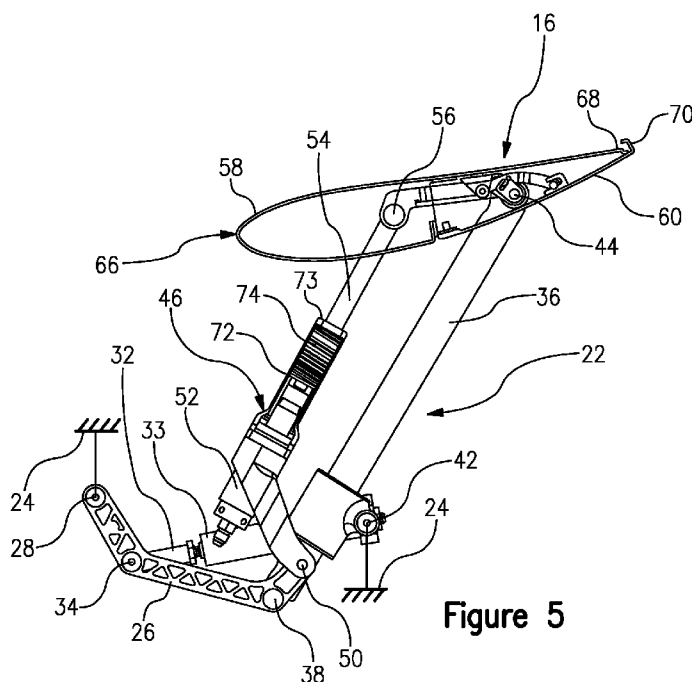

Figure 5



LV, MC, MK, MT, NL, NO, PL, PT, RO, RS, SE, SI, SK, **Published:**

SM, TR), OAPI (BF, BJ, CF, CG, CI, CM, GA, GN, GQ,

GW, KM, ML, MR, NE, SN, TD, TG).

— *without international search report and to be republished
upon receipt of that report (Rule 48.2(g))*

VEHICLE REAR WING WITH ADAPTIVE SECTION AND EXTENDABLE FLAP**CROSS-REFERENCE TO RELATED APPLICATIONS**

[0001] This application claims priority to United States Provisional Application No. 62/277,045, which was filed on January 11, 2016 and is incorporated herein by reference.

BACKGROUND

[0002] This invention relates to a deployable vehicle rear wing that adaptively optimizes its cross sectional shape during operation while simultaneously extending a trailing edge Gurney flap. Deployable rear aerodynamic elements generally cannot offer high operating efficiency as their geometric section is typically limited by the vehicle styling. The present invention overcomes this limitation by automatically modifying the aerodynamic element's geometric shape as it is deployed, so as to produce a highly efficient airfoil section with an extended Gurney flap, using a simple mechanical linkage.

[0003] It is well understood that a wing section mounted on the rear of a vehicle is desirable as it increases aerodynamic downforce which ultimately improves handling performance. However, it is also known that a supplemental wing increases aerodynamic drag and therefore degrades fuel economy and maximum speed capability of the vehicle. It has therefore become common to utilize deployable aerodynamic elements that can be retracted to achieve relatively low drag and extended when higher vehicle dynamic performance is required. However, the limitation of most deployable aerodynamic elements is that their geometric section is typically forced to conform to the vehicle styling, which limits efficiency. In the case of a wing element, the aerodynamic efficiency refers to the ratio of lift to drag, or L/D , where lift is the opposite of downforce, so represented as a negative number on a vehicle. The higher the negative lift, or downforce, can be made relative to a given drag, the higher the calculated efficiency becomes. Conversely the lower the drag can be made for a given downforce the higher the calculated efficiency becomes. The aircraft industry has spent considerable effort in optimizing the cross sectional shape of wings using the fundamental fluid mechanics laws as described by the Bernoulli principle and the behavior of continuum flow fields. In fixed wing vehicle applications L/D efficiencies of up to 4 have been achieved with careful development of the section and span shape. However these sections and shapes are

highly specialized for the purpose and therefore do not conform to the styled shape of road vehicles.

[0004] US4558898 to Deaver and US5678884 to Murkett et al. both describe fixed wing applications on vehicles and clearly illustrate the specialized shape required by a highly efficient wing section. Their sections and shapes clearly do not conform to the styled surface of the vehicle bodies that they are attached to. US7213870 to Williams describes a novel adjustable rear wing that is fixed to the vehicle in which both the chord length and angle of attack of the section can be adaptively changed using actuators and a controller. In this manner the L/D of the rear wing can be automatically modified during vehicle operation. It is generally understood that increasing the chord length of the wing section creates higher downforce with minimal effect on drag, resulting in a more efficient L/D, and increasing the angle of attack of the wing section creates higher downforce with a significant effect on drag, resulting in a less efficient L/D. It should be noted that the '898, '884 and '870 patents utilize purpose developed cross sections that do not conform to the styled shape of the vehicle body to which they are mounted, and are permanently deployed such that the associated drag is always imparted on the vehicle.

[0005] US4773692 to Schleicher et al. describes a deployable rear spoiler that can be moved between a retracted position and an extended position using a novel mechanical arrangement that creates a dual motion that moves the deployable rear spoiler, or air deflector, away from the vehicle body and to an inclined position. The mechanical arrangement consists of an arcuate adjuster and guide channel in conjunction with an electric motor and cable drive. However, the cross section of the air deflector is clearly not of an optimized airfoil shape as it has been designed to conform to the styled shape of the vehicle body when in its retracted position. When deployed it offers the advantage of being oriented with an increased angle of attack from its stowed position, which is dictated by having to match the styled shape of the vehicle body, so that it generates a higher downforce than a simple vertical translation would produce. However, although potentially being able to generate adequate downforce, the non-airfoil section of the '692 spoiler would have a highly inefficient L/D therefore creating significant drag when deployed.

[0006] US4854635 to Durm et al. specifically claims a unique drive mechanism for the moving of an air guide arrangement on the rear of a vehicle from a retracted rest position

to an extended operating position. The air guide device itself is clearly illustrated as a moveable panel on the sloping rear side of the vehicle which has no resemblance to an airfoil cross section and appears to function purely as a method of creating a discontinuity in the flow field of the air travelling over the body of the vehicle. A spoiler performs a significantly different function than a wing in that it is simply configured to eliminate the positive lift that the styled shape of the vehicle body creates. In the case of the '635 air guide arrangement there is no air flow underneath the moveable panel in its extended position which is a critical operating requirement of a wing. The panel would therefore only be capable of disturbing the airflow on the rear side of vehicle so as to eliminate the lift that the styled shape generates and although effecting a positive change to the vehicle lift it would not actually generate a measureable L/D efficiency.

[0007] US8113571 to Goenueldine describes an air guiding device on the rear end of a vehicle which is moveable relative to the rear end using a setting-out mechanism. Although the '571 patent claims a novel approach for the attachment of the setting-out mechanism to the underside of the air guiding device so as to help improve its aerodynamic and aeroacoustic performance, the cross section of the air guiding device, described as both a wing and a spoiler, is clearly not an fully optimized airfoil shape. However, the styled shape of the vehicle body appears to have been created to be of an aerodynamically efficient shape so that the moveable air guiding device is closer to an optimal cross section when deployed. Aspects of the shape, such as the blunt trailing edge, which is configured to match the vehicle body, still significantly reduce the L/D efficiency of the air guiding device.

[0008] US8944489 to Patterson et al. claims a variable aerodynamic device for a vehicle that is configured to move a wing element between a raised position and a lowered position relative to the vehicle body and additionally to a third, air brake condition when required. The deployment mechanism is configured to be driven by hydraulic actuators via a novel guide strut and linkage arrangement that results in a low angle of attack in the lowered position, an increased angle of attack in the raised position and an extreme, high drag, angle of attack in the air brake position. In this manner the wing element develops minimal drag and also downforce in the lowered position, increased downforce as well as drag in the raised position and extremely high drag in the air brake position with some increase in downforce. However the L/D efficiency in this third position would be extremely poor due to an

undesirable aerodynamic characteristic known as stall in which the air flow on the underside of the wing element separates from the surface and causes significant disruption to the flow field so that Bernoulli's principle no longer applies. It is also evident from the illustrations that the wing element of the '489 patent does not conform to a classic airfoil cross section so as to match the styled surface of the vehicle body in the lowered position and so the L/D efficiency of the wing element would be far from optimized.

[0009] It is generally understood that the lift and drag of optimized wing sections can be modified by adding extensions to the main surfaces known as flaps or slats. In aircraft these extensions are configured to be deployable and create increased lift at lower air speed as an aid to take-off and landing. The deployment of these devices generally increase drag proportionally and in most cases actually decrease the L/D efficiency of the wing. The devices are retracted for normal flight as the additional lift is not required and the increased drag would be highly undesirable. In a specific subset of these types of devices it has been found that the addition of a relatively small upstanding, thin section flap at the trailing edge of a wing section creates an increase in downforce disproportionately larger than the increase in drag, therefore resulting in a higher L/D efficiency. The parameters associated with the thickness and height limitations to achieve the increase in L/D are well known and the device is generally referred to as a Gurney flap. The fixed wings on competition vehicles are rarely implemented without Gurney flaps. However, the use of Gurney flaps on deployable vehicle rear wings has not been adopted as the upstanding flap would create considerable drag in the retracted position and be difficult to match the styled surface of the vehicle body.

[0010] US5141281 to Eger et al. claims a novel rear-end spoiler arrangement for a vehicle in which a flap is moved from an inoperative position flush with the vehicle body to an operative position that creates a breaking away of the air current passing the sloping rear side, or fast back, of the vehicle. The usage of the term flap to define the moving element in the specification and claims of the patent is not appropriate as the device should be technically described as a spoiler. This moving element performs in the same manner as described in the previously referenced '635 patent to Durm et al. The flap, or spoiler, of both the '635 and '281 patents eliminates the positive lift that the styled shape that the vehicle body creates, but has no air flow underneath the element in its operative position which is a critical operating requirement of an airfoil wing. An additional novelty of the '281 invention is the inclusion of

an air current breakaway element which is constructed separately from the flap and independently extends in the transverse direction of the vehicle, in the operative position of the spoiler arrangement, the breakaway element extending adjacent to the rear edge of the flap. Although this breakaway element is a thin section, vertically oriented feature at the trailing edge of the main spoiler, it is not a Gurney flap as the main section that it modifies is not an airfoil and so the aerodynamic effect would not increase the L/D as there is no efficiency associated with the isolated element.

SUMMARY

[0011] In one exemplary embodiment, a deployable vehicle rear wing includes a rear mounted moveable element constructed from a main upper surface and a hinged lower surface that in a first configuration closely conforms to the surrounding styled surface of the vehicle body and in a second configuration provides an airfoil section with an integrated Gurney flap that is configured to provide an extended position. A lift mechanism includes an arrangement of rotating linkages and sliding components such that a first actuator is configured to drive a pair of fixed arms to move the moveable element between a stowed position and a deployed position. The lift mechanism includes a second pair of actuators interconnected to the moveable element and the rotating linkages. The second actuators are configured to move the moveable element between the deployed position and an air brake position. A flap linkage is packaged within the moveable element and coupled between the main upper surface and the hinged lower surface. The flap linkage incorporates a cam affixed with respect to the fixed arm so that the flap linkage is configured to move the hinged lower surface to the second configuration with the Gurney flap in the extended position in response to a change in relative position between the cam and the flap linkage.

[0012] In a further embodiment of any of the above, the lift mechanism includes a support structure. A pair of lift levers are pivotally mounted to the support structure. The pair of fixed arms are interconnected to the lift levers. A pair of guide collars are pivotally mounted to the support structure. The first actuator is interconnected to the lift levers and the support structure and is configured to move the moveable element between the stowed position and the deployed position by rotating the lift levers and causing the fixed arms to rise through the guide

collars. The second pair of actuators are interconnected to the moveable element and the lift lever.

[0013] In a further embodiment of any of the above, the cam is coupled to a distal end of the fixed arms where they are rotationally mounted to the moveable element. A drive link is pivotally attached to the main upper surface at one end and to the hinged lower surface via a slotted rotational joint at another end so that as the lift mechanism deploys the moveable element. Initially in the first configuration, the flap linkage pivots the hinged lower surface towards the main upper surface creating the second configuration. An airfoil section with a blunt rear section of the first configuration transforming the blunt rear section into the vertically oriented Gurney flap.

[0014] In a further embodiment of any of the above, the lift mechanism is configured to move the moveable element upward and rearward along an arcuate path from the stowed position to the deployed position.

[0015] In a further embodiment of any of the above, the lift mechanism is configured to move the moveable element upward and rearward along an arcuate path from the stowed position to the deployed position.

[0016] In a further embodiment of any of the above, when the lift mechanism moves the moveable element between the deployed position and the air brake position, the cam of the flap mechanism drives the hinged lower surface back to the first configuration.

[0017] In a further embodiment of any of the above, when the lift mechanism moves the moveable element between the deployed position and the stowed position, the cam of the flap mechanism drives the hinged lower surface back to the first configuration.

[0018] In a further embodiment of any of the above, the plan view shape of the moveable element includes a reduced centre cross section. The hinged lower surface is broken into two parts at the outer ends of the moveable element. Two identical flap linkages are utilized and driven individually by each of the two fixed arms.

[0019] In a further embodiment of any of the above, the first and second actuators are hydraulic.

[0020] In a further embodiment of any of the above, the second actuators each include a spring arranged beneath a cover that is secured to a cylinder that includes a flange. A rod of each of the second actuators is telescopically arranged with respect to the cylinder of

the respective second actuator. The spring is in a compressed state between the flange and the cover of the respective second actuator in an extended actuator position. The spring is configured to force the respective rod into the respective cylinder to a collapsed position that provides the air brake position.

[0021] In another exemplary embodiment, a deployable vehicle rear wing includes a rear mounted moveable element constructed from a main upper surface and a hinged lower surface. In a first configuration it closely conforms to the surrounding styled surface of the vehicle body and in a second configuration it provides an airfoil section with an integrated Gurney flap that is configured to provide an extended position. A lift mechanism includes a support structure. A pair of lift levers are pivotally mounted to the support structure. A pair of fixed arms are interconnected to the lift levers and cooperate with a pair of guide collars pivotally mounted to the support structure. A first actuator is interconnected to the lift levers and the support structure and is configured to move the moveable element between a stowed position and a deployed position by rotating the lift levers and causing the fixed arms to rise through the guide collars. A second pair of actuators are interconnected to the moveable element and the lift levers. The second actuators are configured to move the moveable element between the deployed position and an air brake position. A flap linkage is packaged within the moveable element that includes a cam that is coupled to a distal end of the fixed arms where they are rotationally mounted to the moveable element. A drive link that is rotationally attached to the main upper surface at one end and to the hinged lower surface via a slotted rotational joint at another end so that as the lift mechanism deploys the moveable element. Initially in the first configuration, the flap linkage pivots the hinged lower surface towards the main upper surface creating the second configuration. An airfoil section with a blunt rear section of the first configuration transforms the blunt rear section into the vertically oriented Gurney flap.

BRIEF DESCRIPTION OF THE DRAWINGS

[0022] The disclosure can be further understood by reference to the following detailed description when considered in connection with the accompanying drawings wherein:

[0023] Figure 1 is a perspective view of the deployable vehicle rear wing, shown in its stowed position in the vehicle body.

[0024] Figure 2 is a perspective view of the deployable vehicle rear wing, shown in isolation in its stowed position including its supporting structure.

[0025] Figure 3 is a perspective view of the deployable vehicle rear wing, shown in isolation in its stowed position excluding its supporting structure.

[0026] Figure 4 is a partial sectional side view of the deployable vehicle rear wing, shown in its stowed position.

[0027] Figure 5 is a partial sectional side view of the deployable vehicle rear wing, shown in its deployed position.

[0028] Figure 6 is partial sectional side view of the deployable vehicle rear wing, shown in its air brake position.

[0029] Figure 7 is a perspective view of the deployable vehicle rear wing, shown in isolation in its air brake position.

[0030] Figure 8 A, B are isolated partial sectional side views of the deployable vehicle rear wing, shown in its stowed and deployed positions respectively.

[0031] Figures 9 A, B, C are isolated partial sectional side views of the deployable vehicle rear wing, shown in its stowed, deployed and air brake positions respectively

[0032] The embodiments, examples and alternatives of the preceding paragraphs, the claims, or the following description and drawings, including any of their various aspects or respective individual features, may be taken independently or in any combination. Features described in connection with one embodiment are applicable to all embodiments, unless such features are incompatible.

DETAILED DESCRIPTION

[0033] Accordingly, in view of the limitations of the prior art it would be advantageous to provide a deployable vehicle rear wing that conforms closely to the styled surface of the vehicle body in a retracted, or stowed, position while adaptively changing its cross section in the deployed position so as to provide a highly efficient airfoil section with an integrated Gurney flap. Additionally, it would be highly desirable to provide the adaptive cross section change and Gurney flap deployment via a linkage that utilizes the drive mechanism of the main deployment system.

[0034] In a primary embodiment of the present invention the lower surface of a moveable element, that closely matches the styled surface of the vehicle body, is adapted to hinge around a predetermined point so that as the moveable element is moved between a stowed and deployed position, the lower surface is rotated around the hinge axis to eliminate the blunt trailing edge of the section, defined by the vehicle body, to create a highly desirable sharp trailing edge with a vertically extending Gurney flap. A main lift mechanism creates a combined motion path that lifts the moveable element into the free stream of air passing over the vehicle while also increasing its angle of attack. The cross section change is driven by a linkage arrangement that is coupled to the main deployment motion so that when the moveable element is fully deployed, with an associated vertical lift and increased angle of attack, it is also a fully optimized airfoil section with an associated high L/D efficiency. In this manner the moveable element provides an aesthetically pleasing shape that conforms to the styled surface of the vehicle body and creates very little drag or downforce in its stowed position. Additionally in its deployed position the moveable element provides a highly efficient airfoil section with an integrated Gurney flap that is located in the free stream air flow over the vehicle with an optimized angle of attack to provide a high level of downforce with an efficient L/D.

[0035] An additional feature of the lift mechanism is an ability to generate an extreme angle of attack during selected events such as high braking demand so that aerodynamic drag assists in decelerating the vehicle. A consequence of this air brake position is a highly inefficient element that results in aerodynamic stall but extremely high drag. In this condition the lower surface of the moveable element returns to its stowed position shape with the Gurney flap retracted.

[0036] Figure 1 illustrates the rear of a vehicle body **10** with an integrated moveable element **16** that is designed to conform to the styled surface of the vehicle body **10**. Figure 2 shows a perspective view of the moveable element **16** and a lift mechanism **22** that translates the moveable element **16** rearward, upwards and into positive angle of attack along an arcuate path from stowed position shown in Figure 4 to a deployed position shown in Figure 5. The lift mechanism **22** includes a support structure **24**, as best shown in Figure 2, which is secured to the vehicle body. The support structure **24** includes first and second brackets **29**, **31**. A pair of lift levers **26** are mounted for rotation with respect to the support structure **24** by first pivotal connections **28** provided by the first brackets **29**.

[0037] A first actuator **30** (e.g., hydraulic), which includes a cylinder **33** and a rod **35**, is interconnected between the support structure **24** and the lift levers **26** via a bar **32** at second pivotal connection **34**. In operation, the rod **35** is retracted from the stowed position to move the moveable element **16** to the deployed position, which rotates the lift levers **26** rearward about the first pivotal connections **28**.

[0038] A pair of fixed arms **36** are secured between each pair of lift levers **26** at third pivotal connections **38**. A pair of guide collars **40** are slidably received on each fixed arm **36** and secured to the support structure **24** via the second brackets **31** at a fourth pivotal connection **42**. An end of the fixed arms **36** opposite the lift levers **26** is connected to the moveable element **16** at fifth pivotal connections **44**.

[0039] A second pair of actuators **46** (e.g., hydraulic) are secured between each pair of lift levers **26** by a leg **48** secured at sixth pivotal connections **50**. The second actuators **46** include a cylinder **52** secured to its respective leg **48**, and a rod **54** extends from the cylinder **52** and is connected to the moveable element **16** at seventh pivotal connections **56**. The second actuators **46** are in an extended position throughout the stowed and deployed positions.

[0040] The moveable element **16** includes a main upper surface **58** with a trailing edge **68** and a hinged lower surface **60**. The moveable element includes a stiffening rib **62** extending laterally within its interior volume. The hinged lower surface **60** includes a lip **70** arranged near the trailing edge **68**. The hinged lower surface **60** is rotational secured to the main upper surface **58** via a hinge **64** at the stiffening rib **62**. Together the main upper surface **58** and hinged lower surface **60** create an exterior surface **66** that in a first configuration, best illustrated in Figure 8A, conforms to the surrounding styled surface of the vehicle body, and in a second configuration, best illustrated in Figure 8B, provides a highly efficient airfoil section with an integrated Gurney flap.

[0041] The transition of the exterior surface **66** of the moveable element **16** from the first configuration to the second configuration is coupled directly to the translation of the lift mechanism **22** from the stowed position shown in Figure 4 to a deployed position shown in Figure 5. In operation, as the first actuator **30** is retracted, the lift levers **26** are rotated upward and rearward, sliding the fixed arms **36** upward through the guide collars **40**. Due to the geometry of the components of the lift mechanism **22**, as the moveable element **16** is translated rearward and upward its angle of attack is also increased.

[0042] In the example embodiment, the hinged lower surface **60** is driven between the first configuration and the second configuration without using a separate actuator, although one may be used if desired. Instead, the hinged lower surface is passively driven using interlinked components moved by virtue of the lift mechanism's **22** changing geometry, which is described in more detail in connection with Figures 8A-8B. Once the moveable element **16** reaches the deployed position, as shown in Figure 5, the hinged lower surface **60** moves to the second configuration, which extends the lip **70** beyond the trailing edge **68**. In this manner the lip **70** creates the effect of a Gurney flap on a sharp trailing edge airfoil which significantly increases the aerodynamic efficiency of the deployed moveable element.

[0043] Referencing Figures 3, 4 and 5, the second actuators **46** each include a spring **74** arranged beneath a cover **73** that is secured to the cylinder **52**. A rod **54** cooperates with the cylinder **52** and includes a flange **72**. The spring **74** is in a compressed state between the flange **72** and cover **73** with the second actuators **46** in the extended position. In operation, to move the moveable element **16** from the deployed position (Figure 5) to the air brake position (Figures 6), a hydraulic valve associated with the cylinder **52** is opened, which enables the spring **74** to force the rod **54** into the cylinder **52** thereby collapsing the second actuators **46**. Aerodynamic forces on the moveable element **16** assist in the collapse of the second actuators **46**, which are attached at a pivotal connection **56** which is located ahead of the fixed arm's **36** pivotal connection **44**. In the example embodiment, the hinged lower surface **60** returns to its first configuration, with the Gurney flap retracted, when the moveable element **16** moves to the air brake position.

[0044] Actuation of the hinged lower surface **60** is explained in more detail in connection with Figures 9A-9C. A shaft **76** extends laterally outward from each fixed arm **36** coaxially with the pivotal connections **44**. Each shaft **76** is rotationally fixed with respect to the pivotal connections **44** by interlocking features.

[0045] Referring to Figures 9A, a first support bracket **82** is secured to the main upper surface **58**, and a second support bracket **84** is secured to hinged lower surface **60**. A flap linkage **86** is coupled between the first and second support brackets **82**, **84**. The hinged lower surface **60** is broken into two parts at the outer ends of the moveable element **16**, as shown by the hidden lines in Figure 7. The plan view shape of the moveable element **16** includes a

reduced centre cross section **120**. Two identical flap linkages **86** are utilized and driven individually by each of the two fixed arms **36**.

[0046] The flap linkage **86** includes a drive link **88** attached to the first support bracket **82** at one end by a pivot **90**. The second support bracket **84** includes a slot **95** that receives a first pin **94** at the other end of the drive link **88**. The slot **95** enables the hinged lower surface **60** to be secured to the main upper surface **58** during assembly with the drive link **88** already installed on the first support bracket **82**.

[0047] The flap linkage **86** includes a cam **92** that is affixed to the shaft **76**. A second pin **96** extending from the drive link **88** is received within a slot **98** in the cam **92** to provide a slotted rotational joint that includes a ramped surface **100**. Referring to Figures 9A, 9B and 9C, the second pin **96** is shown in three positions which respectively correspond to the moveable element **16** being in the stowed, deployed and air brake positions. As depicted in the figures, the shaft **76** maintains the position of the cam **92** throughout all operational positions of the moveable element **16**. However, the moveable element **16** articulates with respect to the cam **92** as the geometry of the lift mechanism **22** changes. As the moveable element **16** articulates from the stowed position (Figure 9A) to the deployed position (Figure 9B), the drive link **88** cants upward causing the second pin **96** to move up the ramped surface **100** which rotates the hinged lower surface **60** around the hinge **64** towards the main upper surface **58** as the first pin **94** pulls upward on the second support bracket **84**.

[0048] As the moveable element **16** continues to articulate from the deployed position (Figure 9B) to the air brake position (Figure 9C), the second pin **96** slides from the ramped surface **100** back down into the slot **98**, which permits the hinged lower surface **60** to return to the retracted position.

[0049] It should also be understood that although a particular component arrangement is disclosed in the illustrated embodiment, other arrangements will benefit herefrom. Although particular step sequences are shown, described, and claimed, it should be understood that steps may be performed in any order, separated or combined unless otherwise indicated and will still benefit from the present invention.

[0050] Although the different examples have specific components shown in the illustrations, embodiments of this invention are not limited to those particular combinations. It

is possible to use some of the components or features from one of the examples in combination with features or components from another one of the examples.

[0051] Although an example embodiment has been disclosed, a worker of ordinary skill in this art would recognize that certain modifications would come within the scope of the claims. For that reason, the following claims should be studied to determine their true scope and content.

CLAIMS

What is claimed is:

1. A deployable vehicle rear wing comprising:
 - a rear mounted moveable element constructed from a main upper surface and a hinged lower surface, that in a first configuration closely conforms to the surrounding styled surface of the vehicle body and in a second configuration provides an airfoil section with an integrated Gurney flap;
 - a lift mechanism including an arrangement of rotating linkages and sliding components such that a first actuator is configured to drive a pair of fixed arms to move the moveable element between a stowed position and a deployed position, the lift mechanism includes a second pair of actuators interconnected to the moveable element and the rotating linkages, the second actuators configured to move the moveable element between the deployed position and an air brake position; and
 - a flap linkage packaged within the moveable element and coupled between the main upper surface and the hinged lower surface, the flap linkage incorporating a cam affixed with respect to the fixed arm so that the flap linkage is configured to move the hinged lower surface to the second configuration with the Gurney flap in an extended position in response to a change in relative position between the cam and the flap linkage.
2. The deployable vehicle rear wing of Claim 1, wherein the lift mechanism includes a support structure, a pair of lift levers pivotally mounted to the support structure, the pair of fixed arms interconnected to the lift levers, a pair of guide collars are pivotally mounted to the support structure, the first actuator interconnected to the lift levers and the support structure and configured to move the moveable element between the stowed position and the deployed position by rotating the lift levers and causing the fixed arms to rise through the guide collars, and the second pair of actuators interconnected to the moveable element and the lift lever.
3. The deployable vehicle rear wing of Claim 1, wherein the cam is coupled to a distal end of the fixed arms where they are rotationally mounted to the moveable element, a drive link is pivotally attached to the main upper surface at one end and to the hinged lower surface via a

slotted rotational joint at another end so that as the lift mechanism deploys the moveable element, initially in the first configuration, the flap linkage pivots the hinged lower surface towards the main upper surface creating the second configuration, an airfoil section with a blunt rear section of the first configuration, transforming the blunt rear section into the vertically oriented Gurney flap.

4. The deployable vehicle rear wing of Claim 1, wherein the lift mechanism is configured to move the moveable element upward and rearward along an arcuate path from the stowed position to the deployed position.

5. The deployable vehicle rear wing of Claim 2, wherein the lift mechanism is configured to move the moveable element upward and rearward along an arcuate path from the stowed position to the deployed position.

6. The deployable vehicle rear wing of Claim 1, wherein when the lift mechanism moves the moveable element between the deployed position and the air brake position, the cam of the flap mechanism drives the hinged lower surface back to the first configuration.

7. The deployable vehicle rear wing of Claim 1, wherein when the lift mechanism moves the moveable element between the deployed position and the stowed position, the cam of the flap mechanism drives the hinged lower surface back to the first configuration.

8. The deployable vehicle rear wing of Claim 1, wherein the plan view shape of the moveable element includes a reduced centre cross section, and the hinged lower surface is broken into two parts at the outer ends of the moveable element, and two identical flap linkages are utilized and driven individually by each of the two fixed arms.

9. The deployable vehicle rear wing of Claim 1, wherein the first and second actuators are hydraulic.

10. The deployable vehicle rear wing of Claim 1, wherein the second actuators each include a spring arranged beneath a cover that is secured to a cylinder that includes a flange, a rod of each of the second actuators is telescopically arranged with respect to the cylinder of the respective second actuator, the spring is in a compressed state between the flange and the cover of the respective second actuator in an extended actuator position, and the spring is configured to force the respective rod into the respective cylinder to a collapsed position that provides the air brake position.

11. A deployable vehicle rear wing comprising:

a rear mounted moveable element constructed from a main upper surface and a hinged lower surface, that in a first configuration closely conforms to the surrounding styled surface of the vehicle body and in a second configuration provides an airfoil section with an integrated Gurney flap that is configured to provide an extended position;

a lift mechanism including a support structure, a pair of lift levers pivotally mounted to the support structure, a pair of fixed arms interconnected to the lift levers and cooperating with a pair of guide collars pivotally mounted to the support structure, a first actuator interconnected to the lift levers and the support structure and configured to move the moveable element between a stowed position and a deployed position by rotating the lift levers and causing the fixed arms to rise through the guide collars, and a second pair of actuators interconnected to the moveable element and the lift levers, the second actuators configured to move the moveable element between the deployed position and an air brake position; and

a flap linkage packaged within the moveable element that includes a cam that is coupled to a distal end of the fixed arms where they are rotationally mounted to the moveable element, a drive link that is rotationally attached to the main upper surface at one end and to the hinged lower surface via a slotted rotational joint at another end so that as the lift mechanism deploys the moveable element, initially in the first configuration, the flap linkage pivots the hinged lower surface towards the main upper surface creating the second configuration, an airfoil section, with a blunt rear section of the first configuration, transforming the blunt rear section into the vertically oriented Gurney flap.

1/6

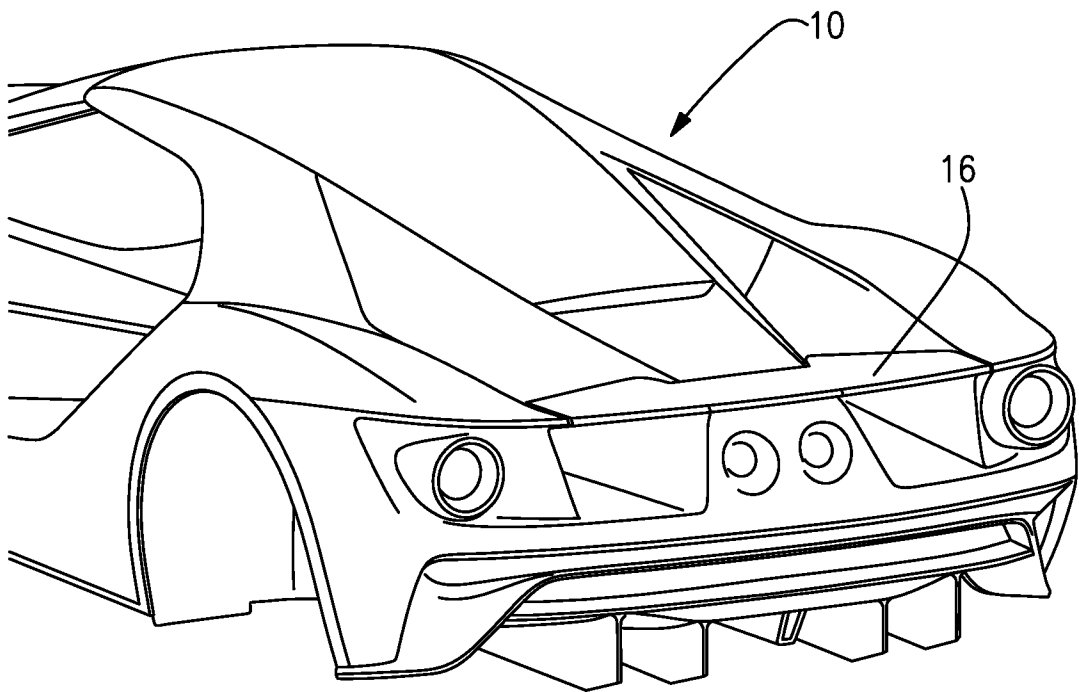

Figure 1

2/6

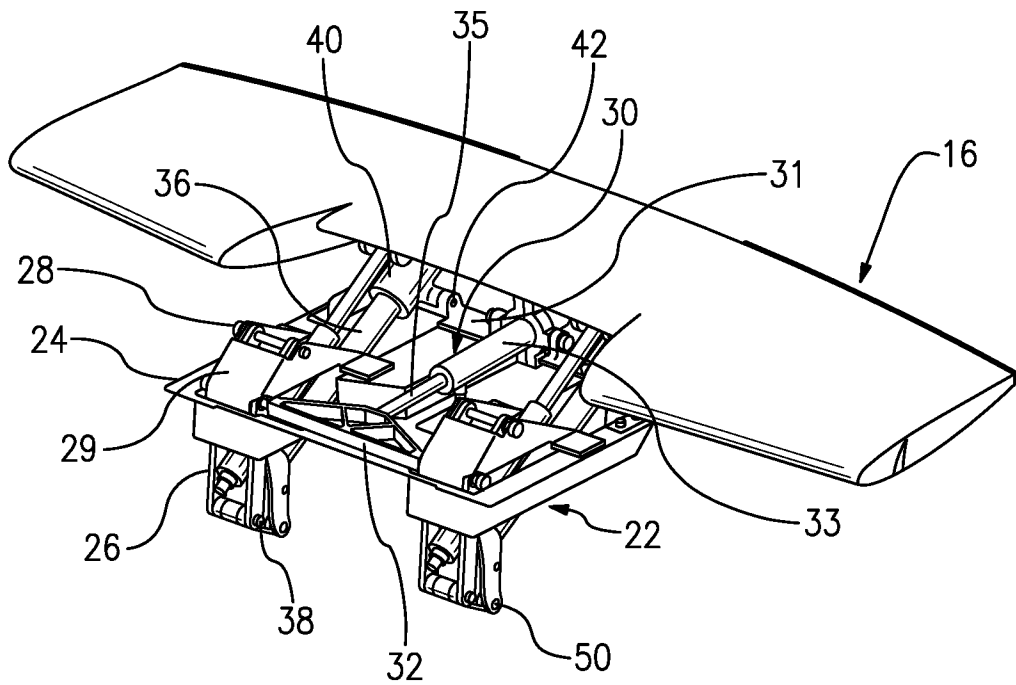

Figure 2

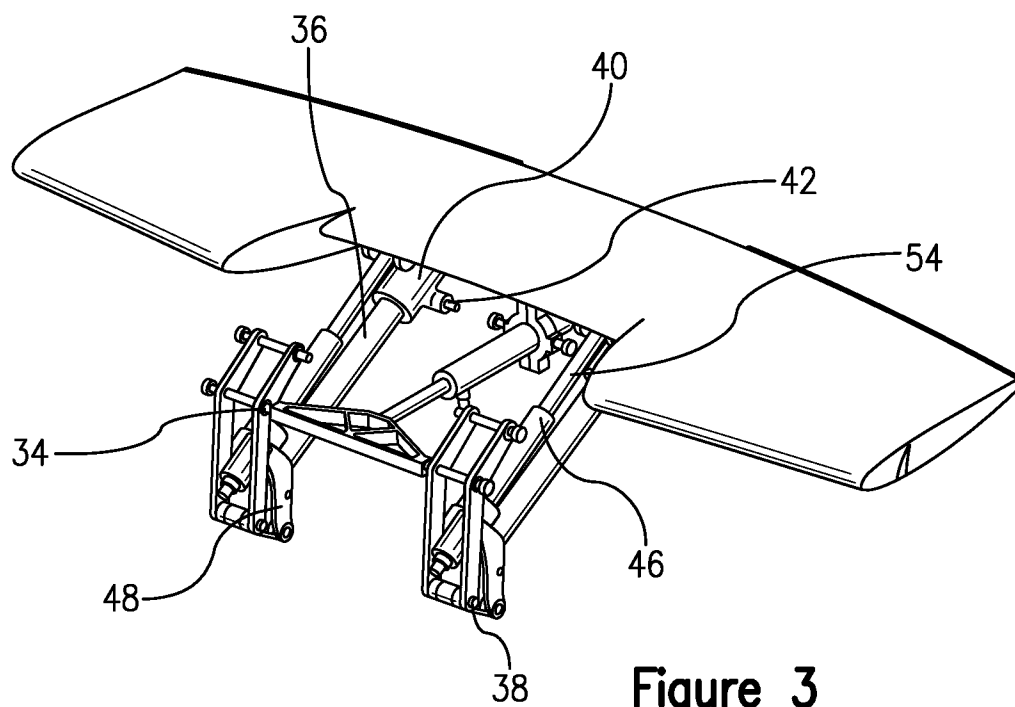
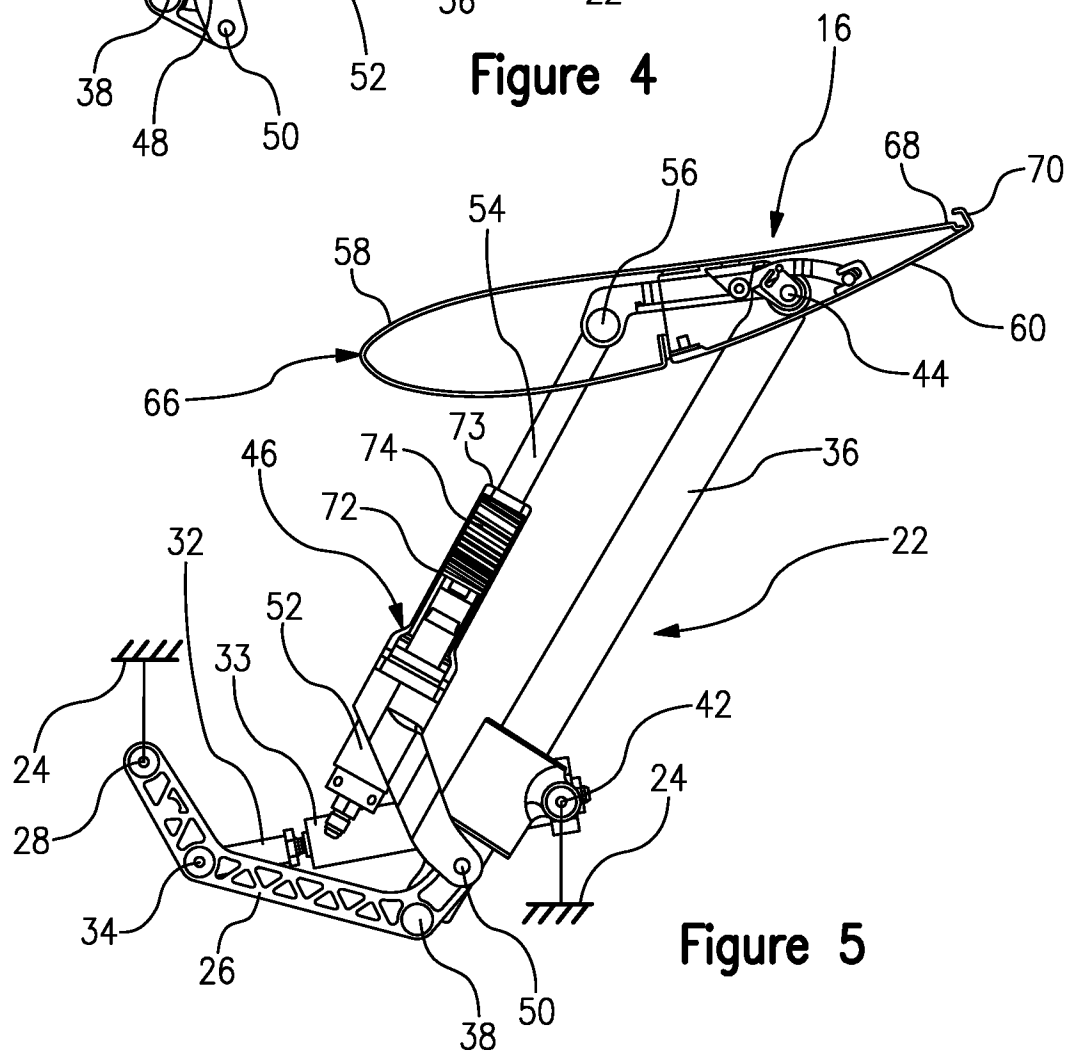
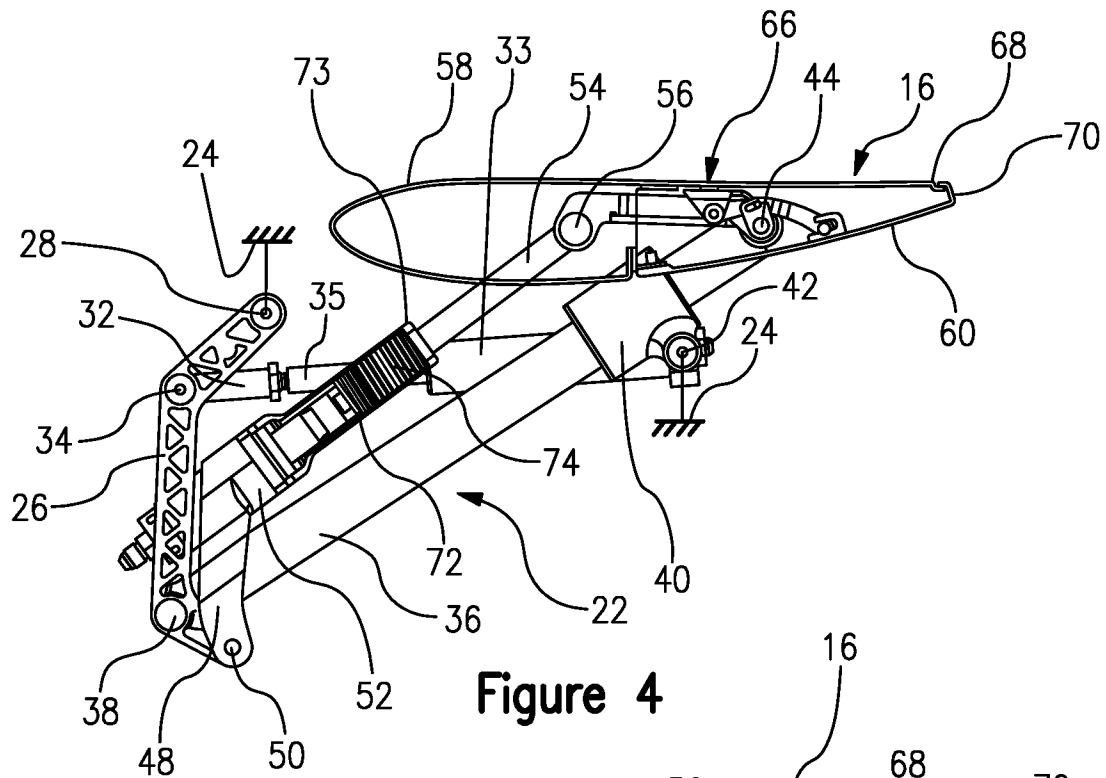

Figure 3

3/6



4/6

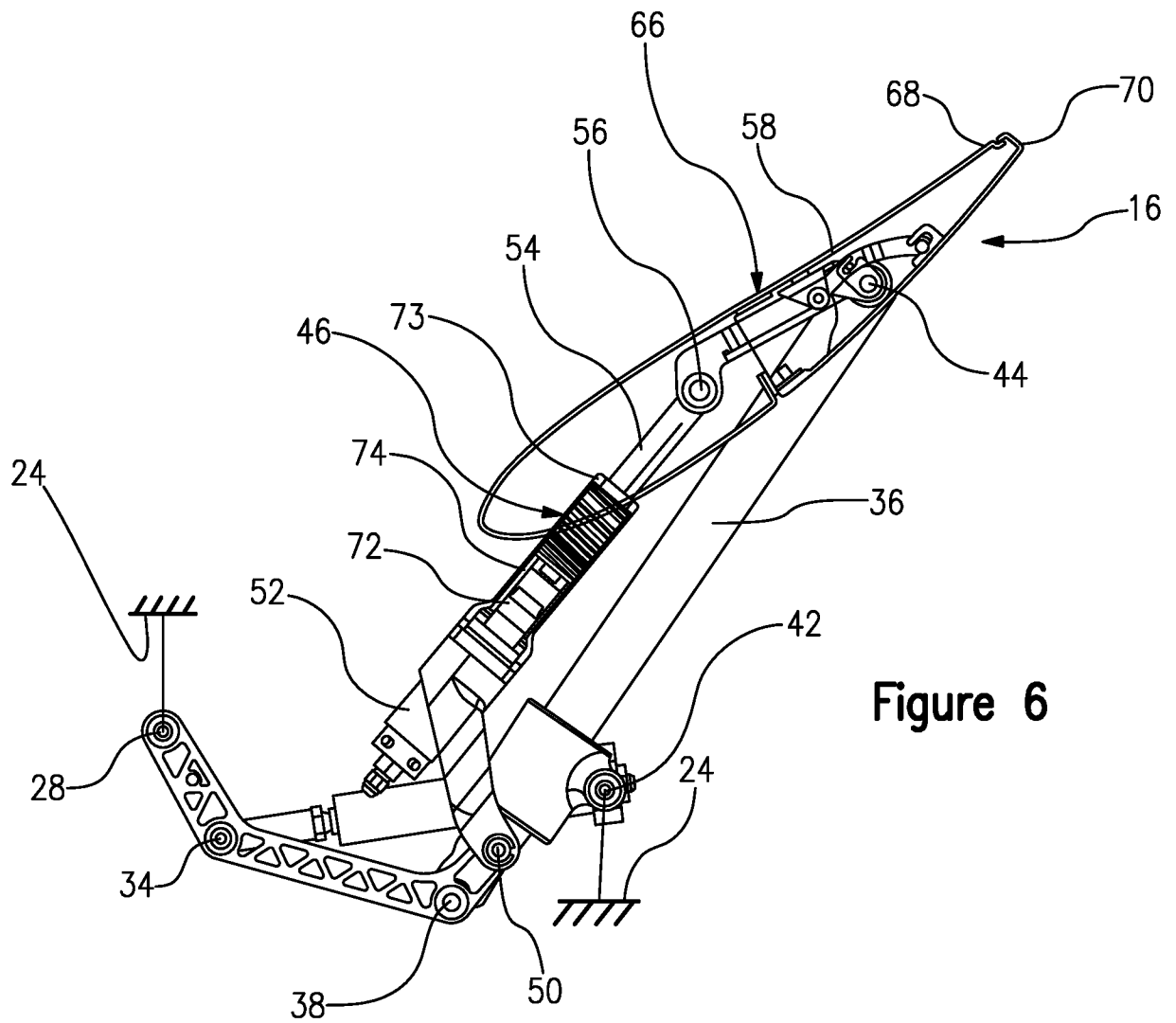

Figure 6

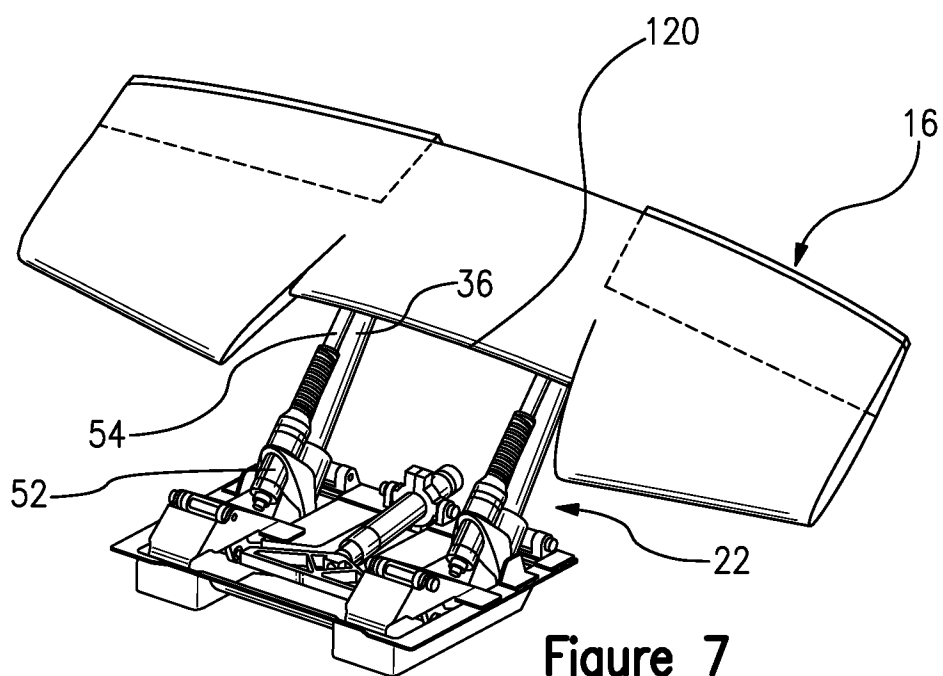

Figure 7

5/6

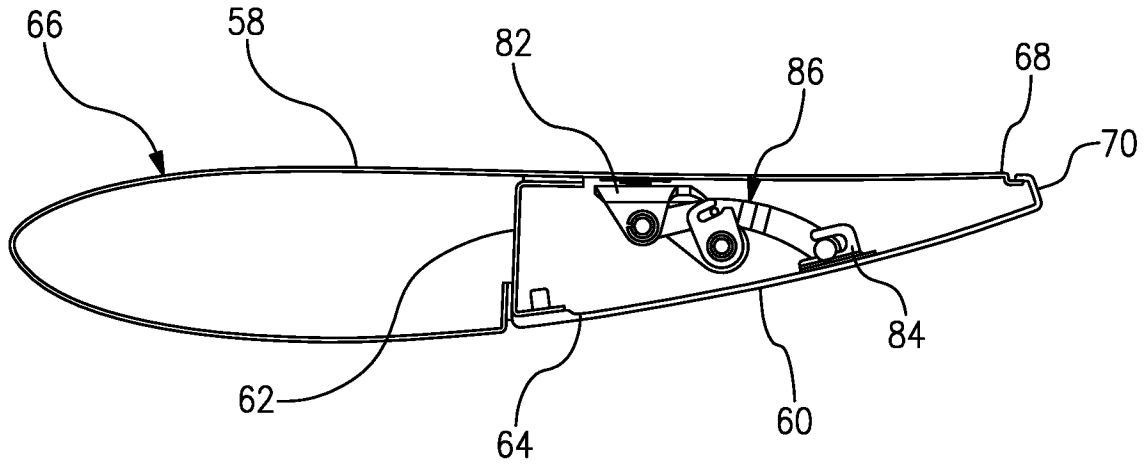

Figure 8A

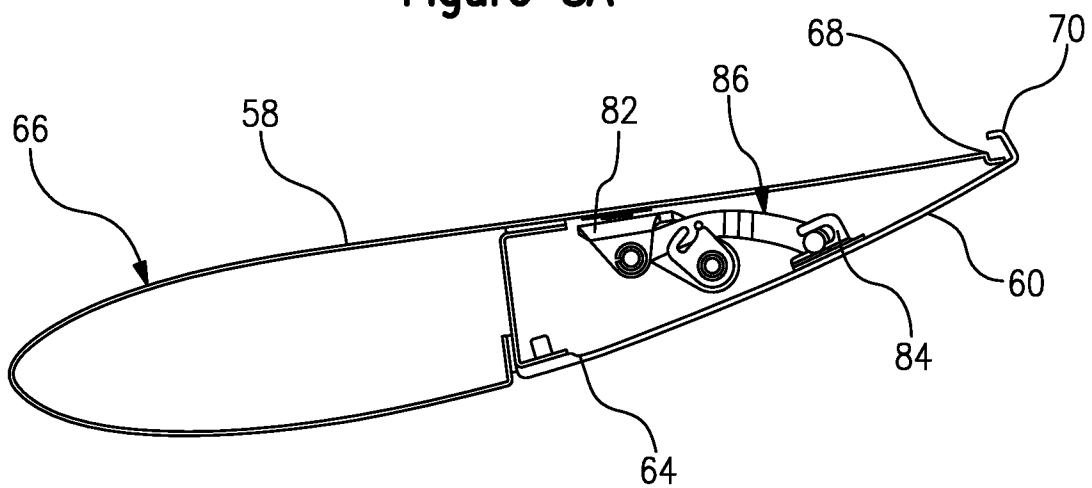

Figure 8B

6/6

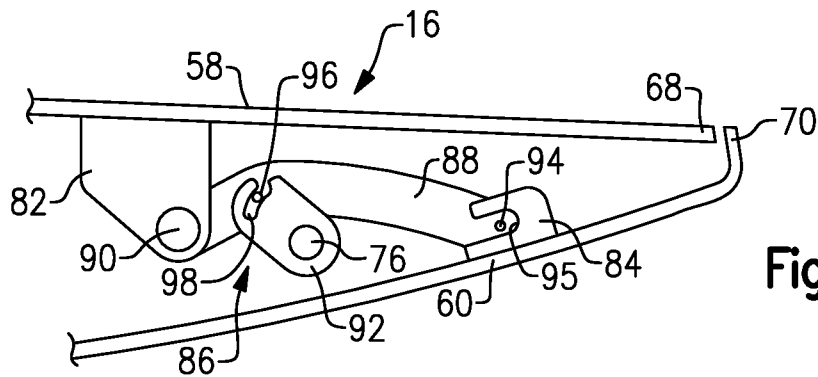

Figure 9A

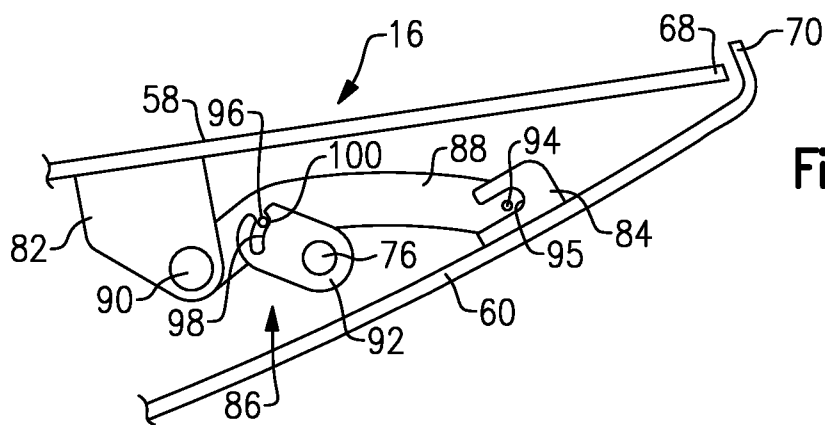

Figure 9B

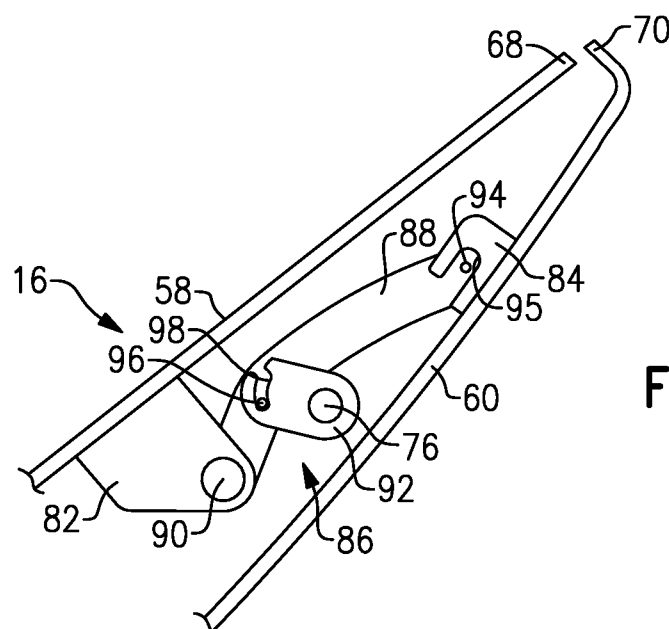

Figure 9C