

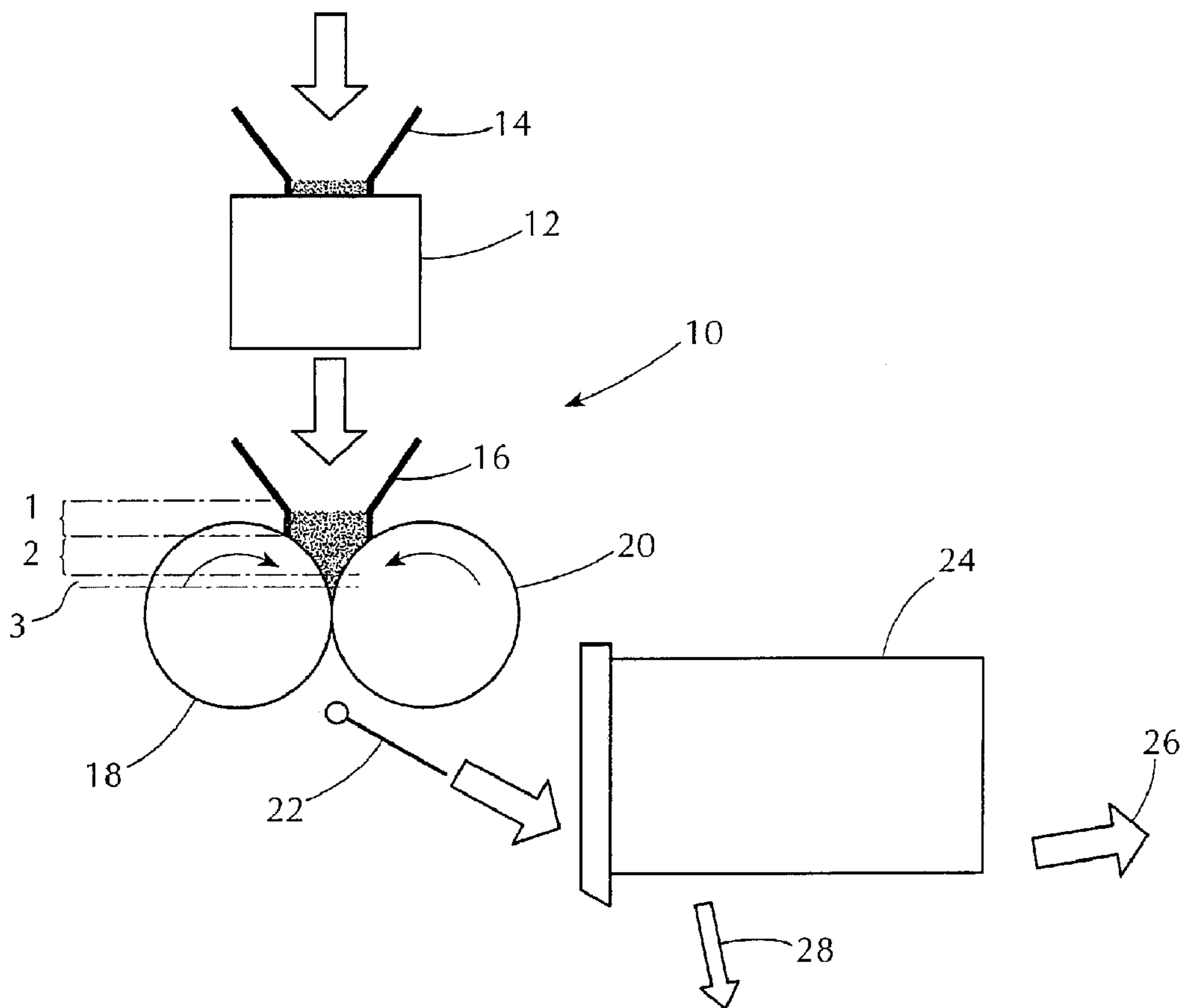

(86) Date de dépôt PCT/PCT Filing Date: 2000/12/11  
 (87) Date publication PCT/PCT Publication Date: 2001/06/14  
 (45) Date de délivrance/Issue Date: 2011/03/22  
 (85) Entrée phase nationale/National Entry: 2002/06/13  
 (86) N° demande PCT/PCT Application No.: US 2000/033470  
 (87) N° publication PCT/PCT Publication No.: 2001/041583  
 (30) Priorité/Priority: 1999/12/13 (US09/459,474)

(51) Cl.Int./Int.Cl. *A23G 1/20* (2006.01),  
*A23G 3/02* (2006.01)  
 (72) Inventeurs/Inventors:  
KASHULINES, PETER THOMAS JR., US;  
KRITZER, EMIL ANTHONY, US;  
BRANDT, ROBERT OTTO JR., US;  
JONES, AUBREY ELMO JR., US;  
AUSTIN, MALCOLM ALBERT, PL;  
PETERSON, RAY LOUIS, US  
 (73) Propriétaire/Owner:  
MARS, INCORPORATED, US  
 (74) Agent: BERESKIN & PARR LLP/S.E.N.C.R.L.,S.R.L.

(54) Titre : PROCÉDE ET APPAREIL DE CONCEPTION D'UN PRODUIT DE CONFISERIE  
 (54) Title: METHOD AND APPARATUS FOR FORMING CONFECTIONERY PRODUCT



(57) Abrégé/Abstract:

A method and apparatus for making a shaped confectionery product of Bingham plastic rheology by cold extrusion wherein particles of the confectionery product are fed between counter-rotating form rolls having depressions corresponding to the desired

(57) **Abrégé(suite)/Abstract(continued):**

product shape. The particles are compacted and compressed between the form rolls and fuse together to exit with a thin web of material interconnecting the shaped confectionery product. The release of the product from the roll surface is aided by induced differential motion between the rolls.

## (12) INTERNATIONAL APPLICATION PUBLISHED UNDER THE PATENT COOPERATION TREATY (PCT)

(19) World Intellectual Property Organization  
International Bureau(43) International Publication Date  
14 June 2001 (14.06.2001)

PCT

(10) International Publication Number  
WO 01/41583 A1(51) International Patent Classification<sup>7</sup>: A23G 1/20, 3/02

(21) International Application Number: PCT/US00/33470

(22) International Filing Date:

11 December 2000 (11.12.2000)

(25) Filing Language:

English

(26) Publication Language:

English

(30) Priority Data:

09/459,474 13 December 1999 (13.12.1999) US

(71) Applicant: MARS, INCORPORATED [US/US]; 6885  
Elm Street, McLean, VA 22101-3883 (US).(72) Inventors: KASHULINES, Peter, Thomas, Jr.; 294  
Morris Avenue, Mountain Lakes, NJ 07046 (US).  
KRITZER, Emil, Anthony; 5018 Stage Bridge Road,  
Shipman, VA 22971 (US). BRANDT, Robert, Otto, Jr.;  
P.O. Box 5606, Wilmington, NC 28403 (US). JONES,  
Aubrey, Elmo, Jr.; 6 Boulder Ridge Crossing, Sparta,NJ 07871 (US). AUSTIN, Malcolm, Albert; ul. So-  
bieszynskiej 10, PL-00-764 Warsaw (PL). PETERSON,  
Ray, Louis; 619 Swansons Ridge Road, Chattanooga, TN  
37421 (US).(74) Agents: MANDRA, Raymond, R. et al.; Fitzpatrick,  
Cella, Harper & Scinto, 30 Rockefeller Plaza, New York,  
NY 10112-3801 (US).(81) Designated States (*national*): AE, AG, AL, AM, AT, AU,  
AZ, BA, BB, BG, BR, BY, BZ, CA, CH, CN, CR, CU, CZ,  
DE, DK, DM, DZ, EE, ES, FI, GB, GD, GE, GH, GM, HR,  
HU, ID, IL, IN, IS, JP, KE, KG, KP, KR, KZ, LC, LK, LR,  
LS, LT, LU, LV, MA, MD, MG, MK, MN, MW, MX, MZ,  
NO, NZ, PL, PT, RO, RU, SD, SE, SG, SI, SK, SL, TJ, TM,  
TR, TT, TZ, UA, UG, UZ, VN, YU, ZA, ZW.(84) Designated States (*regional*): ARIPO patent (GH, GM,  
KE, LS, MW, MZ, SD, SL, SZ, TZ, UG, ZW), Eurasian  
patent (AM, AZ, BY, KG, KZ, MD, RU, TJ, TM), European  
patent (AT, BE, CH, CY, DE, DK, ES, FI, FR, GB, GR, IE,  
IT, LU, MC, NL, PT, SE, TR), OAPI patent (BF, BJ, CF,  
CG, CI, CM, GA, GN, GW, ML, MR, NE, SN, TD, TG).

[Continued on next page]

(54) Title: METHOD AND APPARATUS FOR FORMING CONFECTIONERY PRODUCT

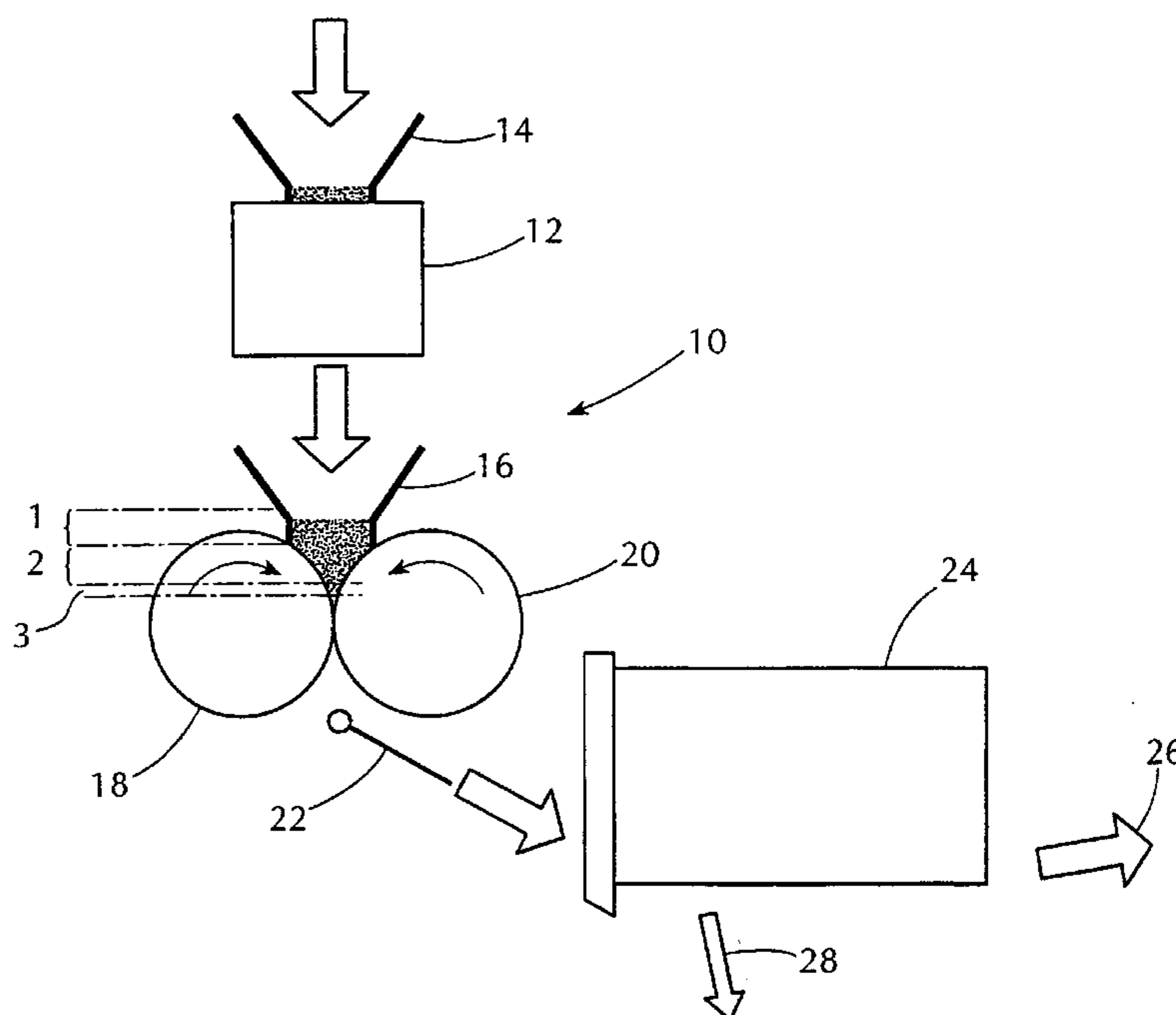

(57) Abstract: A method and apparatus for making a shaped confectionery product of Bingham plastic rheology by cold extrusion wherein particles of the confectionery product are fed between counter-rotating form rolls having depressions corresponding to the desired product shape. The particles are compacted and compressed between the form rolls and fuse together to exit with a thin web of material interconnecting the shaped confectionery product. The release of the product from the roll surface is aided by induced differential motion between the rolls.

WO 01/41583 A1

- 1 -

TITLE

METHOD AND APPARATUS FOR FORMING CONFECTIONERY PRODUCT

BACKGROUND OF THE INVENTION

5 Field of the Invention

The present invention relates to a process and apparatus to make shaped confectionery products from a chocolate or other material which approximates a behavior similar to a Bingham material. More particularly the present invention relates to the formation of such shaped confectionery product by a cold extrusion process.

Confectionery products such as chocolate products are typically made from a molten mass of chocolate after the chocolate has been formulated. There are many different chocolate formulations such as dark and light chocolate, milk chocolate and white compound coatings which typically include sugars or sugar substitutes, dry milk powders, emulsifiers, and a fat such as cocoa butter or vegetable or other fat substitutes.

Traditional chocolate processing to make shaped chocolate products, i.e., bars or other shapes, and enrobed products are carried out while the chocolate is

- 2 -

in a molten or flowable state. Following a melt conditioning process, known as tempering, usually at a temperature of between 27°-32°C, the chocolate is molded into a desired shape by molds or formed into a desired shape by other molding processes while the chocolate is still in a molten state at an elevated temperature above ambient temperature.

Recently there has been reported work on the formulation of chocolate products by a cold extrusion process, e.g., Becket et al., The Cold Extrusion of Chocolate, Transcript of the Institution of Chemical Engineers, Vol. 72, Part C, March 1994, pp. 47-54, U.S. Patent 5,439,695 and European Patent Application EP 0 730 827, published September 11, 1996. The processes and apparatus disclosed in these publications do not teach or suggest use of a cold extrusion process to make chocolate products having a distinct shape such as a lentil shape, star shape or a shaped figure to represent seasonal holidays such as Easter, Halloween, Christmas or any other shaped figure. The extrusion processes and apparatus disclosed in these prior publications utilize molding techniques and apparatus which by their nature preclude the formation of precisely shaped chocolate products.

European patent EP-0-776-608 discloses a process for molding chocolate products in a non melted state. This process involves subjecting crystallized chocolate to die extrusion to form a malleable sheet. This sheet is then fed directly into forming rolls. This patent does not disclose or suggest a process involving forming a

- 3 -

particulate feedstock or the unique products formed by  
shape particulate Bingham plastics. The patent also  
does not disclose or suggest a process for generating  
release of the formed sheet from the rolls by  
5 controlled differential motion between the rolls.

Devices for roll compacting or sintering shaped  
articles by passing granular material between counter-  
rotating rolls having spaced depressions in the rolls  
have been utilized heretofore for many types of  
10 products. Merely illustrative of some of these prior  
art devices are U.S. Patent 5,358,727 which discloses  
counter-rotating rolls with mold cavities to form food  
products from fruit such as pitted prunes or berries;  
U.S. Patent 4,411,611 discloses counter rotating rolls  
15 to form briquettes from pulverized and/or granular  
material; U.S. Patent 5,073,323 which discloses an  
apparatus for compacting non-extrudable ceramic  
tumbling media between counter-rotating form rolls;  
U.S. Patent 4,017,241 which discloses a briquetting  
20 apparatus for forming briquettes of metallic ore; and  
U.S. Patent 3,255,285 which discloses counter-rotating  
ridged rolls to compact granular fertilizers and animal  
feed.

Additional prior art to compact and form briquettes  
25 using various types of presses to compact the material  
are shown in U.S. Patents 5,667,824, 4,882,105,  
4,394,395 and 4,178,392.

None of these prior art devices and processes suggest  
use of counter-rotating rolls to compact a material

- 4 -

having a Bingham plastic rheology and none of these prior art devices disclose or suggest using a differential movement between the counter-rotating rolls to assist in release of the sheet of formed pieces and interconnecting web from the rolls.

Currently in the manufacture of a shaped chocolate product, for example, a lentil shape which is subsequently provided with a sugar coated shell, the chocolate mass in molten form is provided to relatively large diameter counter-rotating rolls which have an appropriate lentil shaped depression in the face of each roll. Side panels are provided to keep the molten chocolate confined to the area between the rolls and the molten chocolate sits in a puddle above the rolls. As the rolls turn the molten chocolate is drawn into the nip between the rolls and shaped to the appropriate lentil shape by the mating indentations in each roll.

The rolls are chilled by flowing a cooled liquid such as 50/50 by volume an ethylene glycol and water solution at approximately  $-20^{\circ}\text{C}$  through the rolls beneath the chocolate contact surface to draw heat from the molten chocolate to allow it to be formed to shape with a sufficient degree of rigidity to retain the imparted shape. The formed chocolate exiting from the rolls is what may be termed in a semi-solid state requiring additional cooling to bring the chocolate to room temperature where it can be readily processed to remove the flashing between each lentil and then subsequently sugar coated, or for baking chocolate pieces just deflashed and packaged. This process also

- 5 -

requires dehumidification near the form rolls to withdraw moist air.

The additional cooling step after passage from the formation rolls requires the use of cooling tunnels, conveyors and additional refrigeration to provide a proper cooling temperature within the cooling tunnels.

Because the process begins with chocolate in a molten state which must flow into the shaped depressions, of necessity, larger sized shapes must be employed and, smaller shapes, or shapes having irregular variations such as star shapes or shaped figures are difficult to provide with this traditional method and apparatus because of the flow properties of molten chocolate when it contacts a chilled surface.

In addition, the diameter of the rolls must be relatively large and the rolls turn at a relatively slow speed to insure that the molten plastic is drawn from the puddle of chocolate between the roll nips to fill all of the formed space in the opposed rolls.

These current processes require relatively large equipment size, use of refrigerated fluids such as an ethylene glycol solution to chill the formation rolls, dehumidification and use of cooling tunnels with added refrigeration which all add to the manufacturing cost and complexity.

Accordingly, there has been a need in the confectionery field to provide a process and apparatus to more

- 6 -

economically form shaped confectionery products, such as chocolate, and increase throughput by the ability to operate formation equipment at higher throughput rates at less cost due to the elimination of the use of super cooled coolants and refrigeration equipment in cooling tunnels.

#### SUMMARY OF THE INVENTION

In one aspect of the invention there is provided a process for cold forming a shaped article of an edible product comprising:

feeding material having a Bingham plastic rheology from which the article is to be shaped in free flowable particulate form to a nip formed between a pair of counter rotating form rolls which are mounted on flexible shafts and which have indentations on their surfaces conforming to the desired shape of said article;

compacting and compressing said particulate material to form a unified cohesive sheet of said material including shaped articles which conform to said indentations interconnected by a thin web of said material; and

separating the shaped formed article from the interconnecting web.

25

30

- 6a -

Another aspect of the invention provides an apparatus for cold forming a shaped article of an edible product from particulate pieces of said product. The apparatus  
5 includes a support frame structure, a pair of form rolls mounted on flexible shafts for counter rotation within the frame structure, the mounting for the form rolls comprising a shaft for each form roll rotatably mounted within the frame structure. Each form roll includes a  
10 plurality of depressions on the peripheral surface thereof shaped to form an article of a desired shape. Each form roll is mounted for counterrotation toward each other with the depressions aligned to match with the depressions in the other of the form rolls at the interface where each  
15 form roll is closest to the other. Drive means is provided for driving the form rolls in counterrotation. The rolls are spaced from each other so as to compress and compact the particulate pieces into shaped articles conforming to the shaped depressions on the form rolls  
20 interconnected by thin web of the material. The shafts are dimensioned and mounted to flex and/or twist when the particulate pieces are formed into shaped configuration as the form rolls are driven.

25

30

- 6b -

In a preferred embodiment of the present invention applicable to the forming of shaped confectionery products, a preferred confectionery product being chocolate, a pair of opposed rolls are provided having the desired shape for the formed chocolate product as a depression on the surface of each roll. The rolls are mounted for counter rotation with no or a slight space between the rolls and a hopper is provided above the counter-rotating rolls to direct, by a gravity feed, highly crystalline tempered chocolate in the form of flakes, shavings or granules to the rolls. Because the Bingham plastic material used in this process is mostly crystallized and cooled before forming, it allows for the use of more efficient cooling and crystallization methods to arrive at the desired final product morphology, temperature and crystallization state. There are many cooling and/or crystallization processes involving mechanical agitation and manipulation of Bingham plastics which can be used on the feed stream of the process of the present invention to arrive at the desired morphology, temperature and crystallization state. These more efficient processes often cannot be used for hot formed products because they are

5

10

15

20

25

30

- 7 -

crystallized and cooled after forming which would result in mechanical damage to the desired final piece shape.

The counter-rotating rolls draw the chocolate pieces  
5 down between the nip of the rolls to compress and compact the chocolate pieces in a process akin to sintering to form the chocolate into the desired shape. The chocolate leaves the rolls in a downward direction in sheet form with the formed chocolate pieces  
10 interconnected by a thin web of chocolate. The bulk temperature of the chocolate is not changed. A small portion of the chocolate, specifically that in what is called the Beta 3 form and below melts. However, this melting is not significant and no additional cooling in  
15 cooling tunnels is necessary.

The sheet is then deflashed and the chocolate pieces agitated in a conventional manner to smooth the edge where the web interconnected the formed pieces. The chocolate pieces may then be further processed, if  
20 desired, by coating with a sugar shell or packaged without coating for ultimate consumer use.

#### BRIEF DESCRIPTION OF THE DRAWING

Fig. 1 is a schematic representation of the overall process and apparatus of the present invention;

25 Fig. 2 is a partial perspective view showing the essential features of the apparatus of the present invention;

- 8 -

Fig. 3 is a top plan view of the apparatus of the present invention;

Fig. 4 is an exploded perspective schematic of a shaft bearing mount;

5 Fig. 5 is a plan view of a form roll illustrating one embodiment of shaped depression to form a shaped product;

Fig. 6 is a side view of a form roll of the present invention; and

10 Fig. 7 is a partial perspective view of a form roll of the present invention.

#### DESCRIPTION OF A PREFERRED EMBODIMENT

With reference initially to Fig. 1, the apparatus 10 of the present invention includes a storage bin 12 having  
15 a hopper 14 into which flaked, shaved or granulated chocolate of granule size less than 6 mm diameter is fed. From bin 12 the chocolate pieces are fed, as needed, to a feed hopper 16 from which it is deposited between the nip of a pair of counter-rotating form  
20 rolls 18 and 20. Form rolls 18 and 20 rotate toward each other in the direction indicated by the arrows. Form rolls 18 and 20 are provided, as will be explained below, with shaped depressions, which mate as the form rolls rotate, to compress and compact the chocolate  
25 particles to form the desired shape.

- 9 -

Due to the gravity feed nature of the process, it has been found that the particle diameter of the feed material should be  $< \frac{1}{2}$  the diameter of the mold pocket. Smaller feed particles have no detrimental effect while  
5 large particles will often yield insufficient filled pockets yielding incomplete pieces. The chocolate composition used in the preferred embodiment was USA standard identity chocolate containing approximately 30% fat by weight and had a microscopic particle size  
10 of approximately 40 microns.

The preferred temperature range of the freshly crystallized (2-10 minutes old) feed chocolate was 12-16° C. with the majority of the fat in the type V stable crystalline form. If the freshly crystallized  
15 feed chocolate is allowed to age for several hours to days, the crystallinity level gradually increases to its thermodynamic equilibrium level. The preferred feed temperature of this aged crystallized chocolate then shifts upwardly to 17-21° C. This preferred high  
20 fat crystallinity level of the feed chocolate is characterized by hardness to the touch. The feed chocolate is hard enough to exhibit a distinctive snap sound when a 5 cm long melt chunk is slowly broken in half by hand.

25 The throughput exiting from the rolls is in the form of a continuous sheet. The sheet is composed of the compacted and cohesive shaped forms called pieces as well as a flat webbing between the pieces called the web.

- 10 -

The exiting formed sheet may be directed by a diverter gate 22 to a rotating deflash drum 24 which rotates to separate the formed chocolate pieces from the thin interconnecting web. From the deflash drum the formed pieces are directed, as indicated by arrow 26, for further processing and the disconnected webs of chocolate are directed, as indicated by arrow 28, to another location where it can be reused as a feed material in the process.

10 With reference now to Figs. 2 to 4, the form rolls 18 and 20, are respectively mounted on shafts 30 and 32 within a housing 34. A variable speed drive motor 36 rotatably drives one shaft 32. Each shaft is provided with a spur gear 38 and 40, respectively, which mesh so  
15 that when the driven shaft rotates it drives the other shaft in a counter-rotation. It will be appreciated by those of ordinary skill in the art that other mechanical drive systems could be employed including other gearing arrangements or drive transmission  
20 systems. The important factor is that a drive system of sufficient power is present to drive the shafts on which the form rolls 18 and 20 are mounted so that the form rolls rotate toward each other. Another important consideration is the ability to vary the speed of  
25 rotation. This can be done with a variable speed drive motor 36 or appropriate gear transmission systems for speed adjustments.

Each shaft 30 and 32 extends through a front wall 42 and a rear wall 44 of housing 34 and are mounted  
30 therein by a bearing arrangement which accommodates

- 11 -

slight shaft flexure as will be described more fully below. The bearing arrangement for each shaft is shown schematically in Fig. 4 where the left side represents the outer bearing and the right side the inner bearing  
5 mount. Each shaft 30 and 32 is similarly mounted for rotation by a pair of bearing mounts.

As seen in Fig. 4, rear housing wall 44 includes a shaft access bore 46 and a liner plate 48 with a shaft access bore 50. Liner plate 48 is on one side of the  
10 form rolls 18 and 20 and a similar liner plate 48 is provided on the other side of form rolls 18 and 20 within housing 34. Each bearing mount also includes a bearing mount plate 52 outside rear wall 44 and a bearing mount plate 54 outside front wall 42. Each  
15 plate 52 and 54 includes an access bore 56 within which the bearings mounting shafts 30 and 32 are disposed.

Each shaft is provided with a pair of bearings at each bearing mount with the outer bearing member 58 preferably being a cylindrical roller bearing to  
20 provide additional support for shafts 30 and 32 and the innermost bearing 60 being tapered thrust bearings which assist in shaft flexure between the bearings. Bearings 58 and 60 are separated by a bearing spacer 62. The bearings 58 and 60 with spacer 62 are press  
25 fit into a respective bearing mount plate 52 and 54.

Reference is now made to Figs. 5-7 for details of form rolls 18 and 20, with each roll being the same. As shown in Figs. 5 and 6, each form roll includes a peripheral ring member 64, preferably made from

- 12 -

anodized aluminum with a Teflon coating to facilitate removal of the compressed formed sheet of chocolate. Preferably the surface is a highly polished or smooth finish to form shaped pieces with no surface discontinuities. A plurality of depressions 66 are provided in the surface of ring member 64. The spacing between depressions 66 on ring member 64 is dependent upon the size and diameter of the depressions. It has been found that the mold cavities, when arranged in a staggered fashion, should be separated a minimum from each other on all sides by the distance equal to approximately  $\frac{1}{4}$  the major diameter of the mold cavities. Closer spacing has been found to yield split pieces due to interference from the backflow of material during forming of neighboring pieces. Other factors to be considered are the release angle of the formed sheet as it passes through the nip and the depth of the formed piece. The most desired behavior is full release without hang up on the forming rolls.

Depressions 66 may be of any desired shape to achieve the desired shaped confectionery product. In a preferred embodiment the depressions 66 are shaped to make a lentil shape for subsequent sugar shell coating to make a product such as M&M's® candy. It has been found that other desired shapes such as character figures, stars, hearts, eggs and other shapes may be employed as well. However, because of the nature of chocolate it has been found that shapes with a rounded peripheral extent are best to provide a good release angle to allow the formed sheet to readily disengage from the form rolls. The depression on each roll need

- 13 -

not be identical as a character figure can be made with a back side and a front side which is different. The important consideration is that each impression as it mates in the nip align so that a piece is formed having  
5 similar radial dimensions.

When the confectionery product being processed is chocolate, the chocolate flakes or granules at the start of the process are at ambient temperature.

However, when it is compacted, the pressure exerted by  
10 the compressive force as the chocolate passes through the nips of the form rolls causes the surface of the chocolate in contact with the form rolls to rise and would result in the chocolate adhering to the surface of the form rolls so as to retard the release of the  
15 formed sheet from the form rolls. Accordingly, it is desirable to provide coolant to maintain the surface of the form rolls within a preferred temperature range of 14° to 20°C.

Thus, each form roll 18 and 20 is provided with a  
20 coolant circulation pathway to allow a coolant, such as cooled water, to circulate near the surface of the form roll. As best seen in Figs. 6 and 7, each form roll 18 and 20 is provided with a plurality of through bores 68 through the form roll disposed in an annular undercut  
25 groove 70 on each side of a form roll 18 and 20. An annular groove sealer plate 72 is sealingly engaged over each undercut groove 70.

Each shaft 30 and 32 is provided with a partial central bore 74 through which the coolant can flow. A coolant

- 14 -

coupling 76 is provided at each shaft end which rotates with its respective shaft. A coolant distribution line 78 is provided which communicates with central bore 74 and with undercut groove 70 through groove sealer plate 5 72. Thus coolant flows through an inlet 80, through central bore 74 and distribution line 78 into undercut groove 70 through form roll 18 and 20 and out coolant outlet line 82 into a central bore 74 in the shaft to exit through fluid coupler 76 at an exit 86. Each form 10 roll 18 and 20 is also provided, see Fig. 2, with end covers 88 to cover the coolant distribution system.

A preferred material for the frame and rolls of apparatus 10 is 6061T6 Aluminum for its high thermal conductivity, light weight, and desired mechanical 15 properties. The shafts 30 and 32 are preferably 316 stainless steel for its corrosion resistance and mechanical rigidity.

To provide further consistency for the temperature dependent expansion and contraction of the 6061T6 20 aluminum used for constructing the apparatus, coolant flow paths 90, see Fig. 2, are provided through the front 42 and rear 44 walls, and side walls 92 of the housing 34. Cooling of those walls also cools the liner plates 48. In this manner a consistent expansion 25 and contraction of the apparatus is provided so that a consistent gap between the form rolls can be maintained without requiring adjustment for differences in expansion or contraction because of temperature differences.

- 15 -

While it is contemplated that cooling will be used when the confectionery product is a chocolate confection, other confectionery products may require heating instead of cooling. Accordingly, in such instances  
5 rather than flowing cooled water through the system, a heated fluid may be used instead.

The process and apparatus of the present invention in effect consists, especially when the confectionery product is chocolate, in submitting chocolate flakes or  
10 shavings and/or granules to sufficiently high compressive and shear stresses causing the individual particles to deform and fuse together. The process occurs in three distinct phases which correlate somewhat to the position of the material relative to  
15 the nip between the form rolls 18 and 20. As indicated in Fig. 1, the first phase indicated at 1, corresponds to a bulk compacting process. As the form rolls 18 and 20 counter-rotate the mass of particulate chocolate between the rolls is agitated so that the particles  
20 interact with one another imparting a general rotation to the particles within the bed of particles. In this phase the particles undergo weak forces which mainly tend to rearrange their location. The net effect is similar to shaking particles which result in a increase  
25 in the bulk material density of the material but no compression or material deformation.

The compaction phase ends when additional particle redistribution cannot result in a further reduction of bulk volume and a compression phase, indicated at 2,  
30 begins. Since the motion of the form rolls and the

- 16 -

geometry requires a further reduction in volume this further reduction in volume is achieved by crushing and deforming the chocolate particles, mainly under high compressive forces applied by the surface of the form rolls. Thus, particle deformation proceeds, first by filling the available air pockets between particles and then causing the individual contiguous particles to fuse or sinter. This compaction phase results in mechanical energy transfer by way of heat so that the surface of the chocolate particles become heated into the temperature range where chocolate is in a more softened state. This surface warming of the chocolate particles also is beneficial in the fusing or sintering of the particles.

The force balance between the tangential frictional forces at the surface of the form rolls and the compressive force component parallel to the nip defines the feasibility condition for the sintering process. The compressive force depends on the particle size, mold cavity size and spacing, and form roll diameter. The frictional force depends on the shear rate at the surface and is a function of the form roll speed of rotation.

The compression phase begins just above where the smallest spacing between the form rolls exists, indicated at 3 in Fig. 1. Chocolate is a non-Newtonian fluid whose flow properties are dependent on time or duration of shear. In the compression phase 3 the chocolate deformation rates are high and the material behavior is essentially plastic akin to the behavior of

- 17 -

a Bingham plastic fluid. Bingham plastic fluids are probably the simplest non-Newtonian fluids because in a graph of shear stress plotted against shear rate the relationship is linear with a positive offset  
5 corresponding to the characteristic yield value of the chocolate.

Thus, when the chocolate in the compression phase exceeds the yield stress the material behavior becomes elastic. The rate of strain is relatively independent  
10 of the applied force and the energy of deformation is dissipated as heat (i.e. the process is irreversible). Yield stress is a function of the chocolate composition and temperature. Thus, control of temperature by cooling of the form rolls permits repeatable  
15 consistency of product.

As noted above, due to the high compressive forces which result when shaping highly crystalline chocolate, the reactive forces imparted to the form rolls 18 and 20 and their respective shafts 30 and 32 are also quite  
20 high. This results in an outward flexing or bowing of the shafts 30 and 32.

The outward flexing of shafts 30 and 32, which also causes an outward movement of the form rolls 18 and 20 also have a beneficial aspect in assisting separation  
25 of the formed sheet from the form rolls below the nip.

It has also been found when processing chocolate, which behaves like a Bingham plastic, that due to the high resulting pressures the shafts 30 and 32, in addition

- 18 -

to flexing, also twist as well. This results because there is a large change in the reactive force imparted to the form rolls and shafts during rotation depending on the rotation position with respect to pocket passage through the nip area. Thus as the form rolls are rotated they are subject to an increase in reactive force, a decrease and an increase. The net result is to impart an oscillating twisting force to the shafts as well which, along with the oscillating shaft flexing, is beneficial in initiating separation of the formed sheet of chocolate after the chocolate sheet has passed between the nip of the rolls.

To attain the desired shaft flexure and twisting effect it is important to maintain a dimensional relationship between the diameter of shafts 30 and 32 and the diameter and width of form rolls 18 and 20. The mechanical properties of the shafts are also a critical factor in determining the level of flexure and twist effect. The magnitude of these effects can be determined through mechanical analysis of the system, the operating conditions, and the physical properties of the material being formed. Measurement of formed material attributes indicates that the magnitude of this flexure is 0.1 mm in both the separation and twist orientation.

If the diameter of the shafts 30 and 32 is large in comparison to the diameter of the form rolls shaft flexing and twisting would not take place to the degree necessary to obtain the desired movement to insure that the sheet of formed material comes off the rolls

- 19 -

without degradation in the integrity of the product shape.

It has been found that good sheet separation may be obtained with a form roll outer diameter of about 28 cm  
5 and a width of about 14.8 cm with a shaft diameter of about 6.5 cm when the shafts are 316 stainless steel.

As noted the diameter of the form roll is also dictated by the overall size of the piece to be formed to insure repeatable disengagement of the sheet from the form  
10 roll without degradation of the product shape. It has been found that with form rolls having an outer diameter of about 28 cm to form a lentil shape as used for the size of an M&M's® candy a depression having an overall diameter of about 12.19 mm and a maximum depth  
15 of about 2.74 mm may be effectively employed.

The apparatus and process of the present invention achieves significant cost benefits over the traditional melt processing system employed heretofore. Current production equipment used to melt process chocolate to  
20 form lentils as used in M&M's® candies use form rolls having a diameter of about 40 cm and width of about 80 cm. These rolls contain over 6,500 pockets. This process must crystallize and cool the chocolate from its liquid depositing temperature near 30°C. to its  
25 discharge temperature near 15°C. Also these form rolls must rotate at the relatively slow speed of 5 rpm. Under these conditions throughput of finished chocolate pieces is about 1200 kg/hr.

- 20 -

With the apparatus of the present invention form rolls of about 28 cm in diameter and about 15 cm wide can operate at a speed of over 100 rpm and produce a throughput of 1500 kg/hr of finished pieces. In  
5 addition, cooling using only 10-20°C. chilled water is necessary rather than use of an antifreeze solution such as an ethylene glycol solution at about -20°C. Also, post forming cooling tunnels are not necessary so that a significant cost factor for this equipment and  
10 its refrigeration system is completely eliminated. Decoupling of the crystallization and forming process in the present invention allows for the independent optimization of both functions yielding a more overall optimized process.

15 It is thus seen that the present invention achieves significant cost saving in equipment and power requirements while achieving significant increase in throughput with equipment which occupies less space.

**CLAIMS**

1. A process for cold forming a shaped article of an  
5 edible product comprising:

feeding material having a Bingham plastic rheology  
from which the article is to be shaped in free flowable  
particulate form to a nip formed between a pair of counter  
rotating form rolls which are mounted on flexible shafts  
10 and which have indentations on their surfaces conforming  
to the desired shape of said article;

compacting and compressing said particulate material  
to form a unified cohesive sheet of said material  
including shaped articles which conform to said  
15 indentations interconnected by a thin web of said  
material; and

separating the shaped formed article from the  
interconnecting web.

20 2. The process of claim 1 wherein the material to be  
processed is selected from the group consisting of fat  
continuous materials and chocolate.

25 3. The process of claim 1 wherein the material to be  
processed is gravity fed to said form rolls.

4. The process of claim 1 including the step of cooling  
the surfaces of said form rolls to remove heat from said  
article generated by said compaction and compression.

- 22 -

5. The process of claim 4 including circulating a cooling medium near the surfaces of said form rolls and circulating a cooling medium through the shafts upon which said form rolls are mounted.

5

6. The process of claim 1 including the step of generating differential motion between said form rolls to enhance the release of the shaped product sheet from said rolls.

10

7. The process of claim 1 including the step of imparting a differential flexing motion to the shafts on which said form rolls are mounted as said material passes through the nip between said form rolls.

15

8. The process of claim 1 including the step of imparting a differential twisting force to the shafts on which said form rolls are mounted, as said material passes through the nip between said form rolls.

20

9. The process of claim 1 including the step of imparting a differential flexing motion and a differential twisting force to the shafts on which said form rolls are mounted, as said material passes through the nip between said form rolls.

25

10. An apparatus for cold forming a shaped article of an edible product from particulate pieces of said product comprising:

30

a support frame structure;

a pair of form rolls mounted on flexible shafts for counter rotation within said frame structure;

- 23 -

said mounting for said form rolls comprising a shaft for each said form roll rotatably mounted within said frame structure;

5 each said form roll including a plurality of depressions on the peripheral surface thereof shaped to form an article of a desired shape;

10 each said form roll being mounted for counterrotation toward each other with said depressions aligned to match with the depressions in the other of said form rolls at the interface where each form roll is closest to the other;

drive means for driving said form rolls in counterrotation;

15 said rolls being spaced from each other so as to compress and compact said particulate pieces into shaped articles conforming to the shaped depressions on said form rolls interconnected by a thin web of said material; and

20 wherein said shafts are dimensioned and mounted so as to flex and/or twist when said particulate pieces are formed into a shaped configuration as said form rolls are driven.

11. Apparatus according to claim 10 wherein said drive means comprises a variable speed drive means.

25

12. Apparatus according to claim 10 wherein said form rolls are further provided with a coolant circulation pathway to allow a coolant to circulate in an annular undercut groove near the surface of the form rolls.

30

- 24 -

13. Apparatus according to claim 12 wherein said shafts are further provided with a partial central bore through which coolant can flow.

5 14. Apparatus according to claim 13 wherein said support frame structure includes a housing having front, rear and side walls, and wherein coolant flow paths are provided through the front, rear and side walls of the support frame structure.

10

15. Apparatus according to claim 10 wherein said form rolls are mounted within said frame structure with no space between the form rolls.

15 16. Apparatus according to claim 10 wherein said shafts are dimensioned and mounted so as to flex when said particulate pieces are shaped into a shaped configuration as said form rolls are driven.

20 17. Apparatus according to claim 10 wherein said shafts are dimensioned and mounted so as to twist when said particulate pieces are shaped into a shaped configuration as said form rolls are driven.

25 18. Apparatus according to claim 10 wherein said shafts are dimensioned and mounted so as to flex and twist when said particulate pieces are shaped into a shaped configuration as said form rolls are driven.

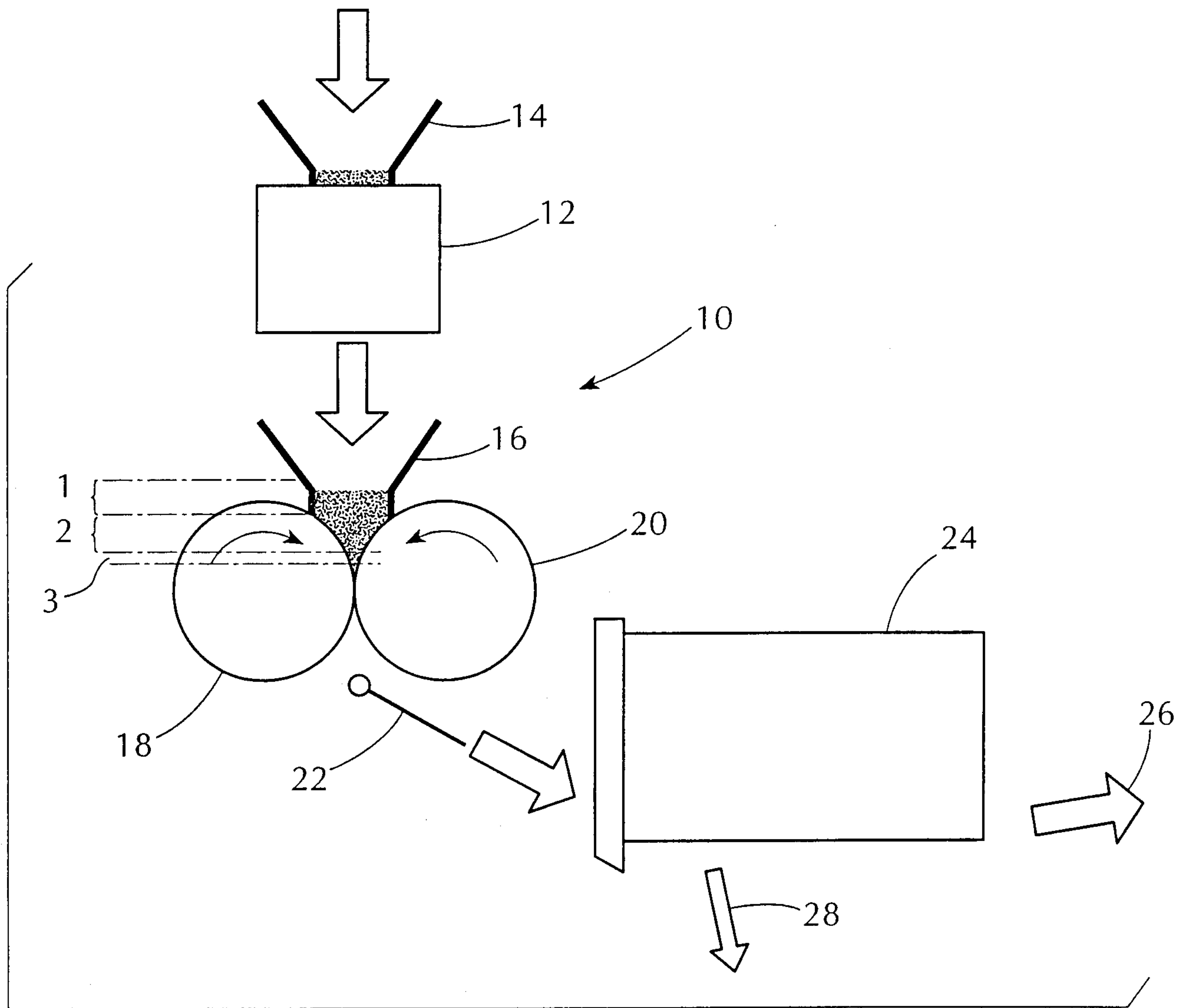
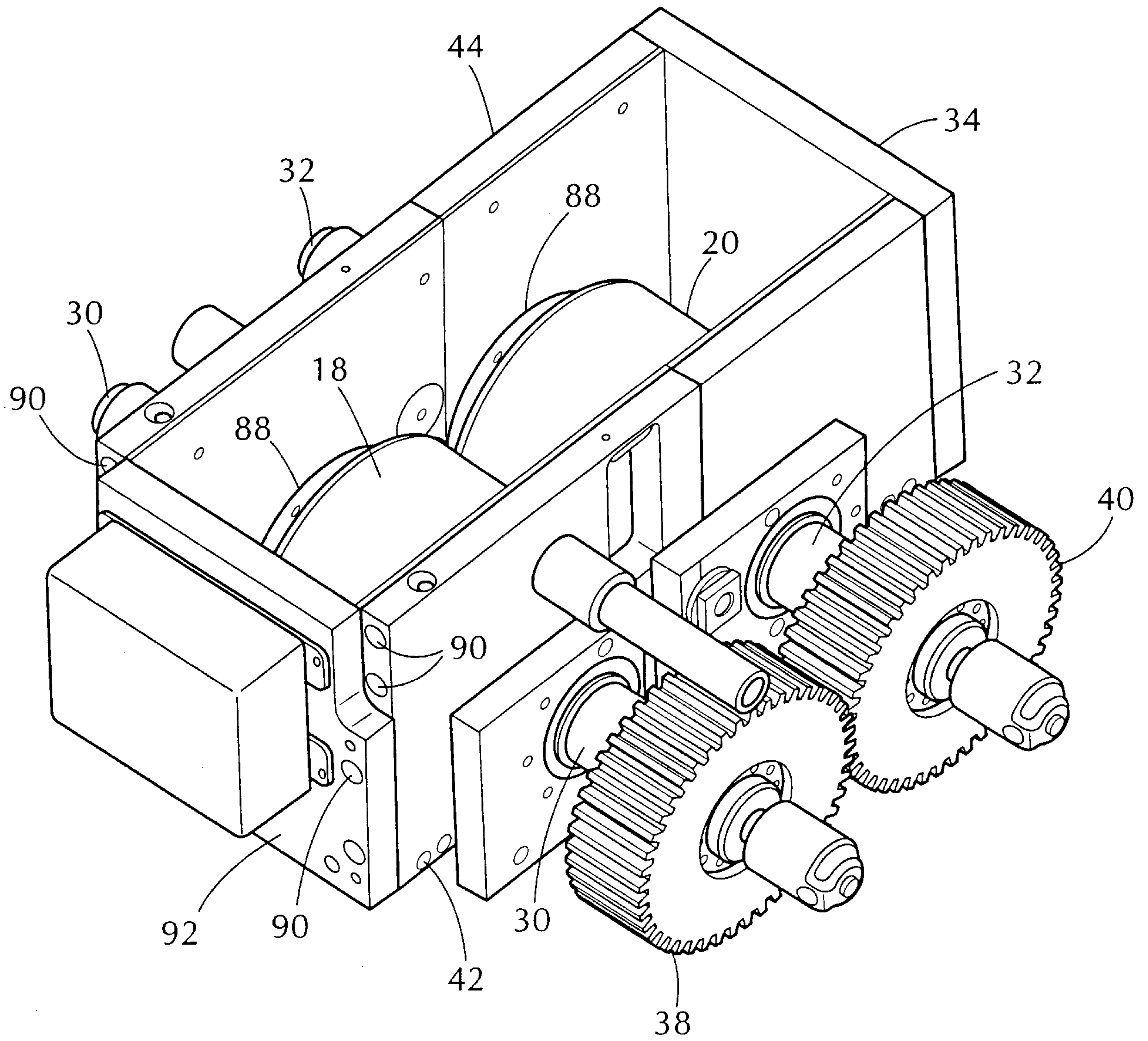

FIG. 1



**FIG. 2**

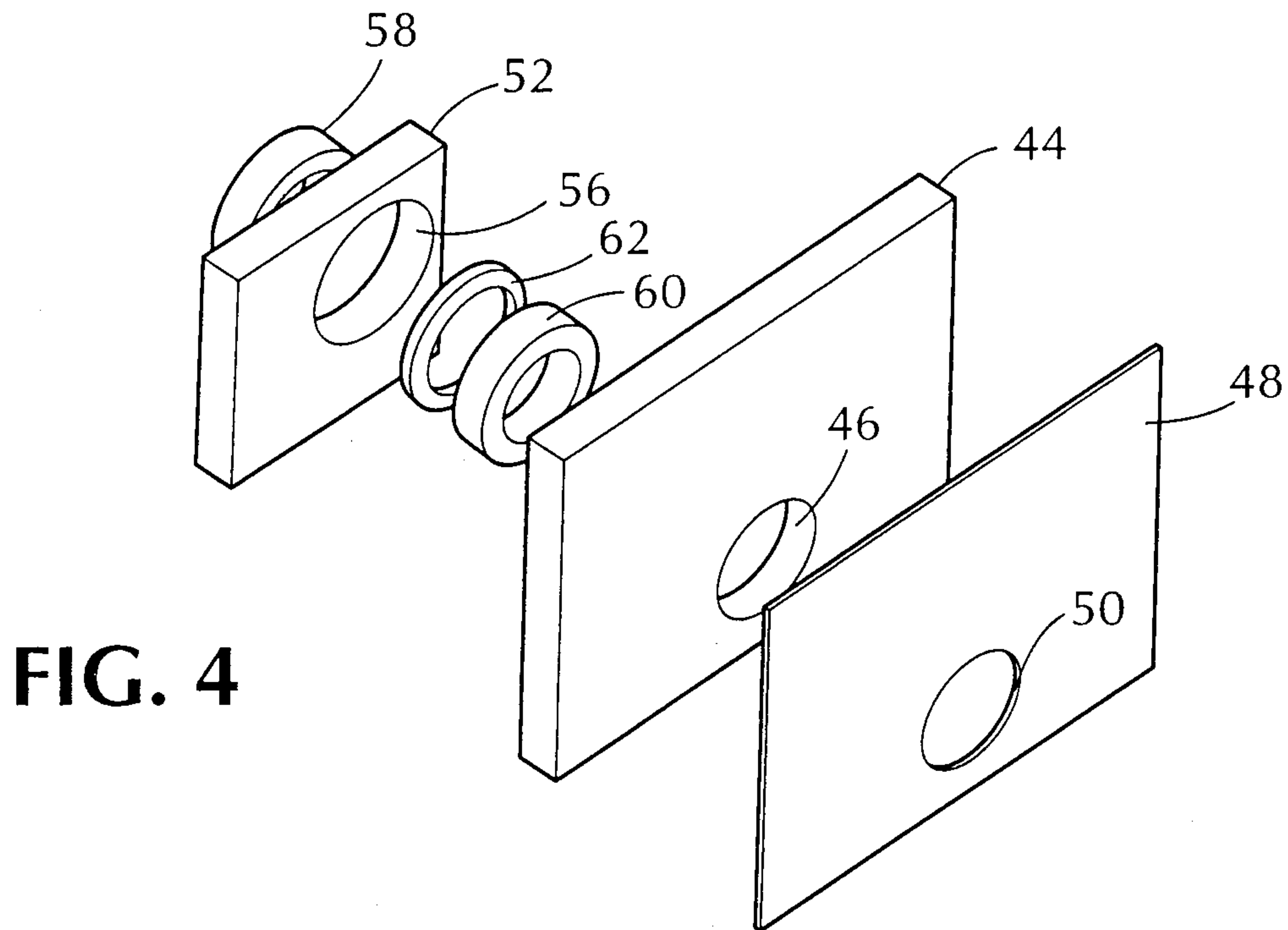
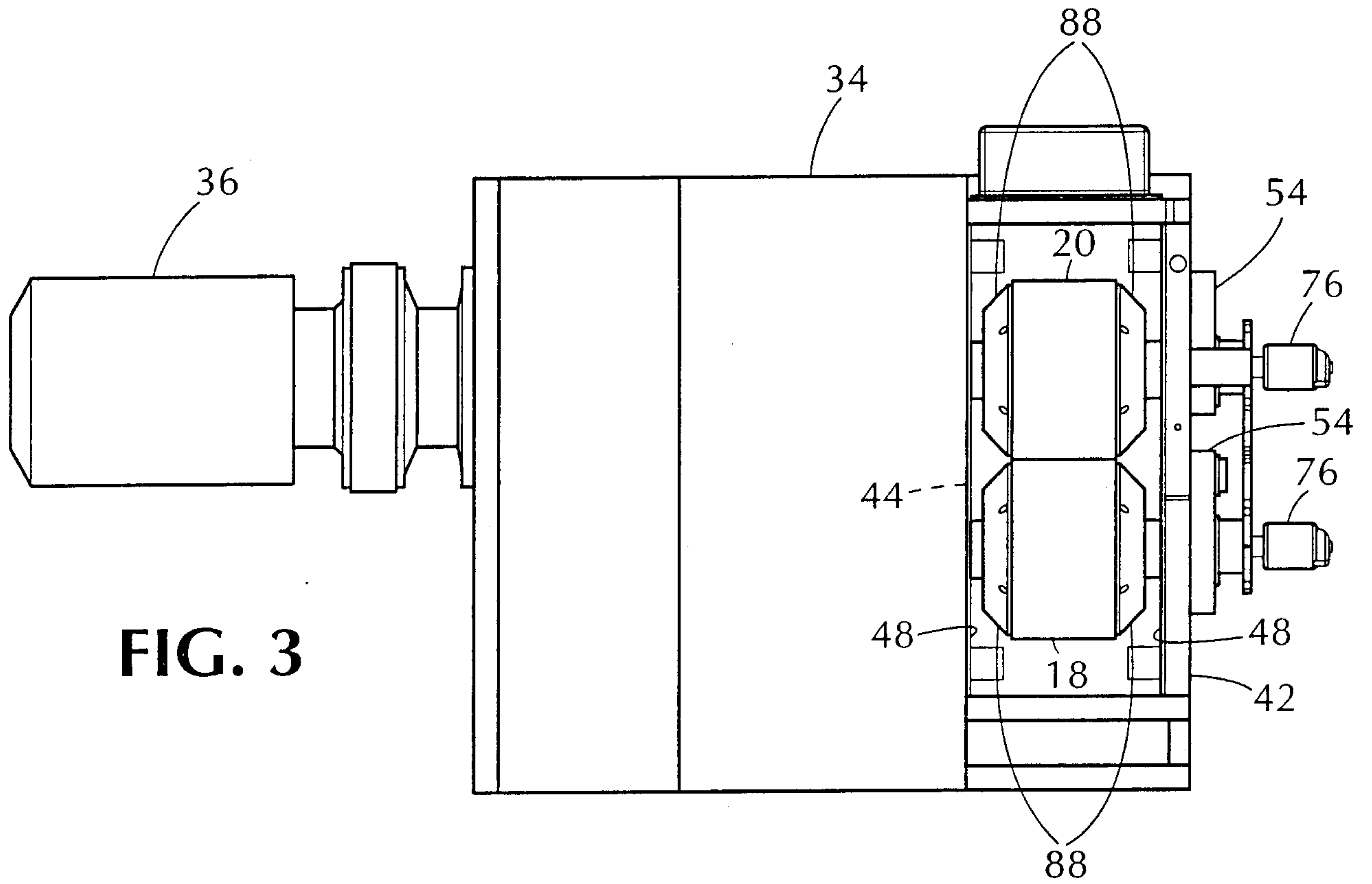

FIG. 5

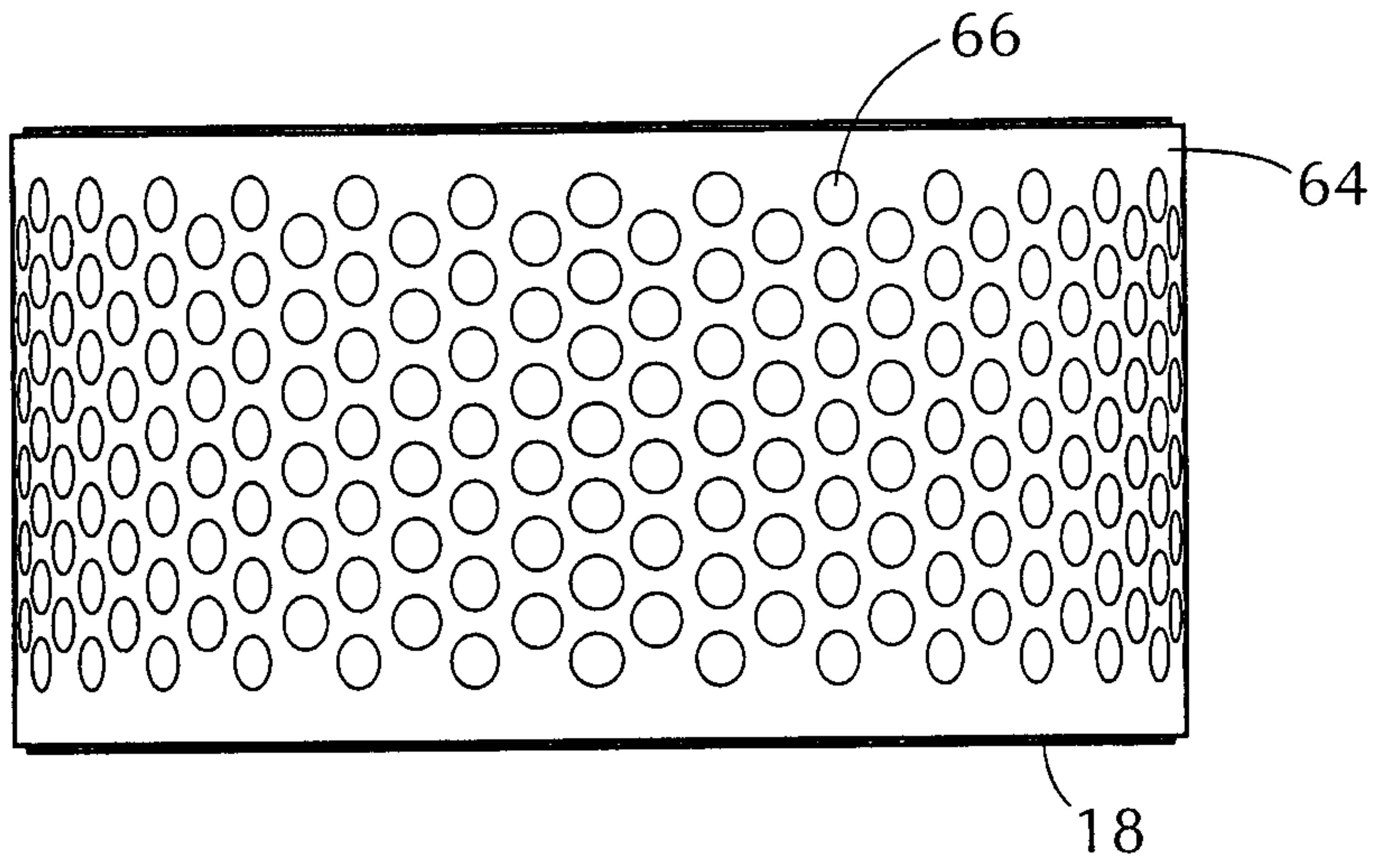

FIG. 6

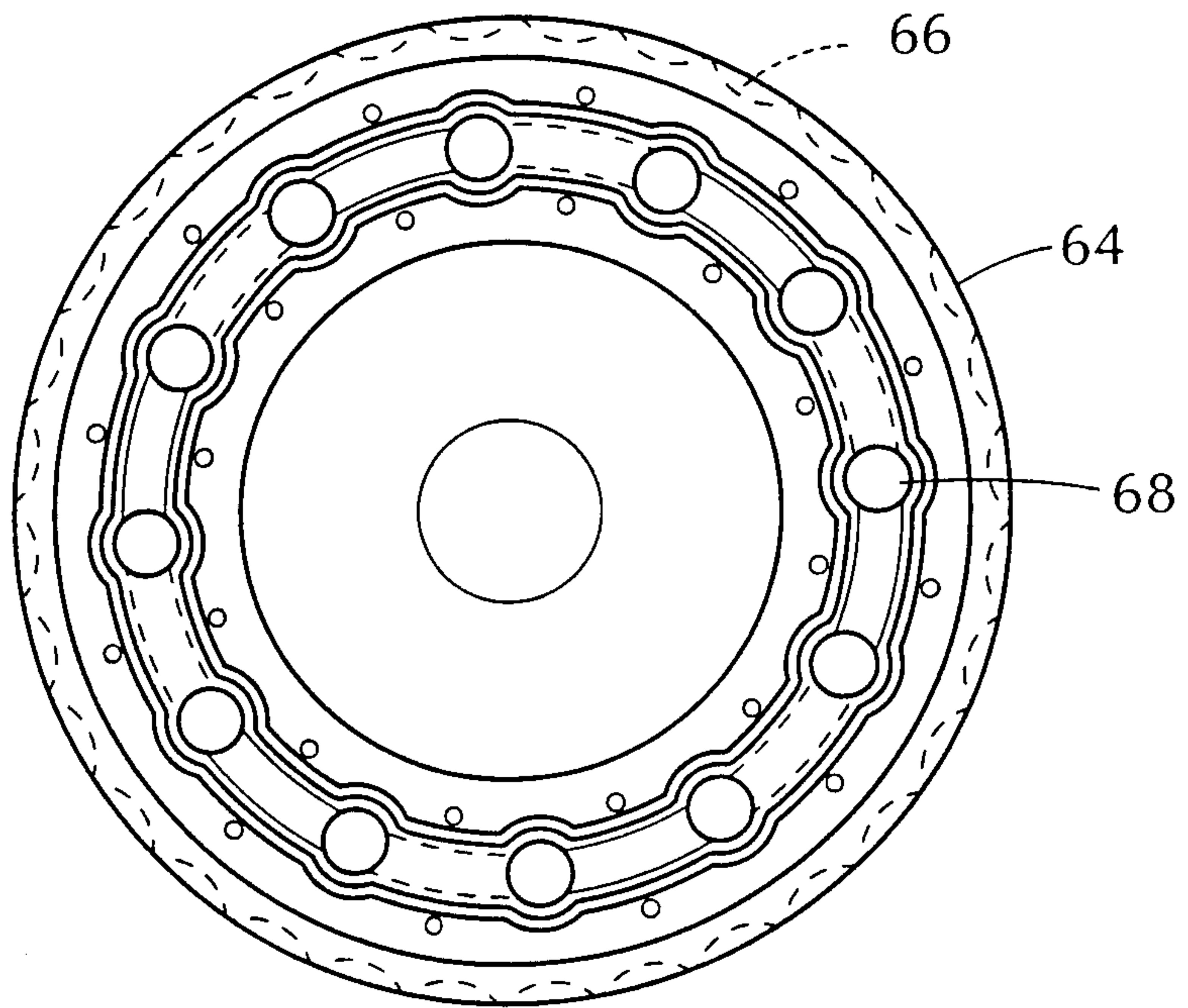

FIG. 7

