



(51) International Patent Classification:

F16D 7/00 (2006.01)

A61M 39/10 (2006.01)

F16D 7/04 (2006.01)

(21) International Application Number:

PCT/US2020/019863

(22) International Filing Date:

26 February 2020 (26.02.2020)

(25) Filing Language:

English

(26) Publication Language:

English

(30) Priority Data:

16/287,913

27 February 2019 (27.02.2019) US

(71) Applicant: CAREFUSION 303, INC. [US/US]; 3750 Torrey View Court, San Diego, California 92130 (US).

(72) Inventor: LEUNG, Gilbert; 3750 Torrey View Court, San Diego, California 92130 (US).

(74) Agent: HALES, M. Todd; MORGAN, LEWIS & BOCK-IUS LLP, 600 Anton Boulevard, Costa Mesa, California 92626 (US).

(81) Designated States (unless otherwise indicated, for every kind of national protection available): AE, AG, AL, AM, AO, AT, AU, AZ, BA, BB, BG, BH, BN, BR, BW, BY, BZ, CA, CH, CL, CN, CO, CR, CU, CZ, DE, DJ, DK, DM, DO, DZ, EC, EE, EG, ES, FI, GB, GD, GE, GH, GM, GT, HN, HR, HU, ID, IL, IN, IR, IS, JO, JP, KE, KG, KH, KN, KP, KR, KW, KZ, LA, LC, LK, LR, LS, LU, LY, MA, MD, ME, MG, MK, MN, MW, MX, MY, MZ, NA, NG, NI, NO, NZ, OM, PA, PE, PG, PH, PL, PT, QA, RO, RS, RU, RW, SA, SC, SD, SE, SG, SK, SL, ST, SV, SY, TH, TJ, TM, TN, TR, TT, TZ, UA, UG, US, UZ, VC, VN, WS, ZA, ZM, ZW.

(54) Title: TORQUE LIMITING CONNECTOR

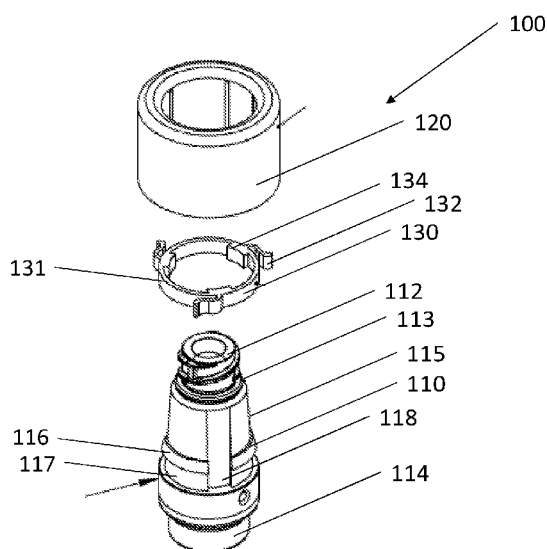

FIG. 3

(57) Abstract: Torque limiting connectors are described herein. A torque limiting connector includes an outer connector, and inner connector, and a clutch. The outer connector includes a profile disposed on an inner surface of the outer connector. The inner connector may be disposed within the outer connector and can include an upper threaded portion and a lower threaded portion. The clutch can be disposed around and rotationally coupled to the inner connector and can include a plurality of clutch teeth extending from an outer surface of the clutch, wherein the plurality of clutch teeth are outwardly biased to be releasably engaged with the profile of the outer connector. The plurality of clutch teeth can be configured to transfer torque from the outer connector to the inner connector when the torque is below a torque limit, and prevent transfer of torque when the torque exceeds the torque limit.



(84) Designated States (*unless otherwise indicated, for every kind of regional protection available*): ARIPO (BW, GH, GM, KE, LR, LS, MW, MZ, NA, RW, SD, SL, ST, SZ, TZ, UG, ZM, ZW), Eurasian (AM, AZ, BY, KG, KZ, RU, TJ, TM), European (AL, AT, BE, BG, CH, CY, CZ, DE, DK, EE, ES, FI, FR, GB, GR, HR, HU, IE, IS, IT, LT, LU, LV, MC, MK, MT, NL, NO, PL, PT, RO, RS, SE, SI, SK, SM, TR), OAPI (BF, BJ, CF, CG, CI, CM, GA, GN, GQ, GW, KM, ML, MR, NE, SN, TD, TG).

Published:

— *with international search report (Art. 21(3))*

TORQUE LIMITING CONNECTOR

FIELD OF THE INVENTION

[0001] The present disclosure generally relates to connectors, and, in particular, to torque limiting connectors.

BACKGROUND

[0002] Medical treatments often include the infusion of a medical fluid (e.g., a saline solution or a liquid medication) to patients using an intravenous (IV) catheter that is connected through an arrangement of flexible tubing and fittings, commonly referred to as an “IV set,” to a source of fluid, for example, an IV bag. Often, tubing, syringes, needles and other medical equipment are made with threaded connectors and/or a universal luer conical fitting that may be tightened to make it leak-free.

[0003] In some applications, overtightened connections may be difficult or impossible to remove by hand.

SUMMARY

[0004] The disclosed subject matter relates to infusion disposables. In certain embodiments, a torque limiting connector is disclosed that comprises an outer connector comprising a profile disposed on an inner surface of the outer connector; an inner connector disposed within the outer connector, the inner connector comprising: an upper threaded portion; and a lower threaded portion; and a clutch disposed around and rotationally coupled to the inner connector, the clutch comprising a plurality of clutch teeth extending from an outer surface of the clutch, wherein the plurality of clutch teeth are outwardly biased to be releasably engaged with the profile of the outer connector, wherein the plurality of clutch teeth are configured to transfer an operational torque from the outer connector to the inner connector when the operational torque is below a torque limit, and the plurality of clutch teeth are forced inward to disengage the profile of the outer connector and prevent transfer of the operational torque when the operational torque exceeds the torque limit.

[0005] In certain embodiments, a torque limiting connector is disclosed that comprises an outer connector comprising a profile disposed on an inner surface of the outer connector; an inner

connector disposed within the outer connector, the inner connector comprising: an upper threaded portion; and a lower threaded portion; and a clutch disposed around and rotationally coupled to the inner connector, the clutch comprising a plurality of clutch teeth extending from an outer surface of the clutch, wherein the plurality of clutch teeth are outwardly biased to be releasably engaged with the profile of the outer connector, wherein the plurality of clutch teeth are configured to permit the outer connector to rotate the inner connector when an operational torque is below a torque limit, and the plurality of clutch teeth are forced inward to disengage the profile of the outer connector and permit rotation of the outer connector relative to the inner connector when the operational torque exceeds the torque limit.

[0006] In certain embodiments, a method to tighten a connection is disclosed that comprises threadedly engaging a first connector with a second connector; rotating an outer connector of the first connector at an operational torque below a connection torque limit; and rotating an inner connector of the first connector via the rotation of the outer connector, wherein a clutch rotationally engages the inner connector and the outer connector.

[0007] It is understood that various configurations of the subject technology will become readily apparent to those skilled in the art from the disclosure, wherein various configurations of the subject technology are shown and described by way of illustration. As will be realized, the subject technology is capable of other and different configurations and its several details are capable of modification in various other respects, all without departing from the scope of the subject technology. Accordingly, the summary, drawings and detailed description are to be regarded as illustrative in nature and not as restrictive.

BRIEF DESCRIPTION OF THE DRAWINGS

[0008] The accompanying drawings, which are included to provide further understanding and are incorporated in and constitute a part of this specification, illustrate disclosed embodiments and together with the description serve to explain the principles of the disclosed embodiments. In the drawings:

[0009] FIG. 1 is a perspective view of a connector assembly, in accordance with various aspects of the present disclosure.

[0010] FIG. 2 is an elevation view of the connector assembly of FIG. 1, in accordance with various aspects of the present disclosure.

[0011] FIG. 3 is an exploded perspective view of the connector assembly of FIG. 1, in accordance with various aspects of the present disclosure.

[0012] FIG. 4 is a cross-sectional view of the connector assembly of FIG. 1, in accordance with various aspects of the present disclosure.

[0013] FIG. 5 is a bottom view of the connector assembly of FIG. 1, in accordance with various aspects of the present disclosure.

[0014] FIG. 6 is a detail view of the connector assembly of FIG. 5, in accordance with various aspects of the present disclosure.

DETAILED DESCRIPTION

[0015] The disclosed torque limiting connector incorporates a two-part connector with a clutch. The clutch can be disposed between the inner connector and the outer connector to limit torque to the inner connector. By limiting torque to the inner connector, overtightening of connectors can be prevented, preventing damage to connectors and simplifying removal.

[0016] The detailed description set forth below is intended as a description of various configurations of the subject technology and is not intended to represent the only configurations in which the subject technology may be practiced. The detailed description includes specific details for the purpose of providing a thorough understanding of the subject technology. However, it will be apparent to those skilled in the art that the subject technology may be practiced without these specific details. In some instances, well-known structures and components are shown in block diagram form in order to avoid obscuring the concepts of the subject technology. Like components are labeled with identical element numbers for ease of understanding. Reference numbers may have letter suffixes appended to indicate separate instances of a common element while being referred to generically by the same number without a suffix letter.

[0017] While the following description is directed to the connection of medical fittings for the administration of medical fluid using the disclosed torque limiting connector, it is to be understood that this description is only an example of usage and does not limit the scope of the claims. Various aspects of the disclosed torque limiting connector may be used in any application where it is desirable to provide for the connection of various tubing and fittings without overtightening.

[0018] The disclosed torque limiting connector overcomes several challenges discovered with respect to certain conventional connectors. One challenge with certain conventional connectors is that threaded connectors may be easily overtightened if the engagement surfaces are wet, such as from a disinfectant. Further, clinicians may overtighten conventional connectors to prevent leaks. Because overtightened connectors may require increased (up to three times greater) disconnection force, necessitating the use of mechanical aids such as forceps or pliers, or the replacement of the connected catheter and/or tubing sets, the use of conventional connectors is undesirable.

[0019] Therefore, in accordance with the present disclosure, it is advantageous to provide a torque limiting connector as described herein that eliminates or substantially reduces potential overtightening of the connector. The disclosed torque limiting connector provides an intermediate clutch that permits tightening of the connector, while preventing overtightening of the connector.

[0020] An example of a torque limiting connector that prevents overtightening is now described.

[0021] FIG. 1 is a perspective view of a connector assembly 100, in accordance with various aspects of the present disclosure. FIG. 2 is an elevation view of the connector assembly 100 of FIG. 1, in accordance with various aspects of the present disclosure. With reference to FIGS. 1 and 2, the connector assembly 100 facilitates a fluid connection with a mating connector. In the depicted example, the inner connector 110 can be threaded to a mating connector at the upper end and/or the lower end. For example, the connector assembly 100 can be utilized with medical tubing.

[0022] To tighten the connector assembly 100 to a mating connector, the outer connector 120 can be twisted to tighten the threaded connections of the inner connector 110. In some applications, a desired tightness or torque is specified for the connection between the connector assembly 100 and the mating connector. However, during use, clinicians may overtighten connections. For example, the disconnecting force for a connection may be higher after disinfecting the connectors. Mating connections may be disassembled or removed by twisting the connector assembly 100 in the opposite direction.

[0023] Advantageously, the connector assembly 100 prevents the inner connector 110 from being overtightened to a mating connector. During operation, until the desired torque is reached,

rotation of the outer connector 120 rotates the inner connector 110, tightening the mating connection therebetween.

[0024] However, after the desired torque is reached, a clutch mechanism prevents the outer connector 120 from further tightening the inner connector 110. Therefore, after the desired torque is reached, the outer connector 120 may be rotated independently of the inner connector 110.

[0025] In addition to preventing overtightening of the inner connector 110, the connector assembly 100 can provide feedback or signals to the user that the desired mating torque has been reached. For example, upon rotation of the outer connector 120 after a desired torque is reached, the connector assembly 100 may provide an auditory or tactile signal or feedback (such as a “click”).

[0026] FIG. 3 is an exploded perspective view of the connector assembly of FIG. 1, in accordance with various aspects of the present disclosure. FIG. 4 is a cross-sectional view of the connector assembly of FIG. 1, in accordance with various aspects of the present disclosure. With reference to FIGS. 3 and 4, a clutch 130 permits the connector assembly 100 to limit the amount of torque delivered to the inner connector 110 from the outer connector 120.

[0027] In the depicted example, the clutch 130 is rotatably coupled with the inner connector 110 and releasably engaged with the outer connector 120. Therefore, during operation, the clutch 130 allows the outer connector 120 to rotate the inner connector 110 until a desired maximum torque is achieved.

[0028] As shown, the clutch 130 may be disposed between the inner connector 110 and the outer connector 120. In some embodiments, the clutch 130 is concentrically disposed about the inner connector 110. For example, the clutch 130 can be disposed along the tapered outer surface 115 of the inner connector 110. Optionally, the clutch 130 can be axially retained relative to the inner connector 110. For example, the clutch 130 can be axially retained in a clutch groove 117 defined by an angled flange 116 formed on the tapered outer surface 115 of the inner connector 110. In some embodiments, the outer connector 120 can include features to axially retain the clutch 130. The angled flange 116 can have an angled surface to facilitate assembly of the clutch 130 onto the inner connector 110.

[0029] In the depicted example, the clutch 130 can receive rotational torque from the outer connector 120. Further, as illustrated, the clutch teeth 132 extend from an outer surface 131 of

the clutch 130 to interface with an inner profile of the outer connector 120. The interface of the clutch teeth 132 with the outer connector 120 allows for torque to be transferred to the clutch 130.

[0030] As illustrated, the outer connector 120 is disposed about the inner connector 110 and the clutch 130. Optionally, the outer connector 120 is concentrically disposed about the inner connector 110 and the clutch 130. In some embodiments, the outer connector 120 is axially retained relative to the inner connector 110. For example, the outer connector 120 can snap fit over the angled flange 116 of the inner connector 110 to axially retain the outer connector 120 relative to the inner connector 110.

[0031] During operation, to transfer torque from the clutch 130 to the inner connector 110, the clutch 130 is rotationally coupled with the inner connector 110 to permit the clutch 130 and the inner connector 110 to rotate together. In the depicted example, the clutch 130 transfers rotational torque to the inner connector 110 via dogs or features 134 formed on the inner surface of the clutch 130 that engage with the outer surface of the inner connector 110. In some embodiments, the features 134 of the clutch 130 engage with the slots or channels 118 formed in the tapered outer surface 115 of the inner connector 110. Therefore, during operation, torque from the outer connector 120 is transferred to the inner connector 110 via the clutch 130 to rotate the inner connector 110 relative to any mating connectors.

[0032] In the depicted example, the inner connector 110 includes an upper threaded portion 112 and a lower threaded portion 114. By rotating the inner connector 110, the upper threaded portion 112 and/or the lower threaded portion 114 can be tightened. For example, the threaded surface 113 of the upper threaded portion 112 can be tightened into a mating connector at a desired torque or until the upper threaded portion 112 bottoms out against the mating connector. Similarly, the lower threaded portion 114 can be tightened into a mating connector at a desired torque or until the lower threaded portion 114 bottoms out against the mating connector. As previously described, the outer connector 120 can rotate the inner connector 110 until the predetermined maximum torque is achieved.

[0033] During operation, after the maximum torque is achieved, the clutch teeth 132 can disengage from the outer connector 120, permitting the outer connector 120 to spin without tightening the inner connector 110. In some embodiments, the number of clutch teeth 132 in engagement with the outer connector 120 can determine the maximum torque that can be

imparted from the outer connector 120 to the inner connector 110 prior to disengaging the outer connector 120. For example, the clutch 130 can include more clutch teeth 132 to allow the outer connector 120 to impart more torque to the inner connector 110, while in some embodiments, the clutch 130 can include fewer clutch teeth 132 to allow the outer connector 120 to impart less torque to the inner connector 110. By way of example, the clutch 130 can include one clutch tooth 132, three clutch teeth 132, five clutch teeth 132, or any other suitable number of clutch teeth 132.

[0034] Similarly, the clutch 130 can permit the outer connector 120 to loosen the inner connector 110 from any mating connectors. The clutch 130 and the outer connector 120 may interface to limit loosening torque.

[0035] FIG. 5 is a bottom view of the connector assembly of FIG. 1, in accordance with various aspects of the present disclosure. FIG. 6 is a detail view of the connector assembly of FIG. 5, in accordance with various aspects of the present disclosure. With reference to FIGS. 5 and 6, clutch teeth 132 releasably engage against the connector profile 122 of the outer connector 120 to receive or transfer torque from the outer connector 120.

[0036] During operation, the outer connector 120 is rotated, thereby rotating the connector profile 122. The rotation of the connector profile 122 transmits torque to the clutch teeth 132 and thereby to the inner connector 110. The outer connector 120 can continue to provide torque to or otherwise rotate the inner connector 110 as long as the clutch teeth 132 remain in engagement with the connector profile 122.

[0037] In the depicted example, the clutch teeth 132 extend radially outward toward the connector profile 122. As shown, the clutch teeth 132 are outwardly biased to maintain engagement with the connector profile 122. In some embodiments, the clutch teeth 132 are resiliently or elastically biased toward the connector profile 122. In some applications, the biasing force of the clutch teeth 132 can be modified by selecting the material, thickness, depth, and other characteristics of the clutch teeth 132 and the clutch 130. Optionally, the angle or geometry of the bend 133 of the clutch teeth 132 can be modified to adjust the biasing force of the clutch teeth.

[0038] As illustrated, the connector profile 122 includes a plurality of engagement features 124 that can transfer rotational force from the outer connector 120 to the engaged clutch teeth 132 in a tangent direction to provide torque to the inner connector 110 and/or force in a radial direction

to urge the clutch teeth 132 inwardly and out of engagement with the connector profile 122. For example, an engagement feature 124 that transfers rotational force from the outer connector 120 to a clutch tooth 132 in a primarily tangential direction (the engagement feature 124 extending primarily normal to the outer connector 120) will transfer proportionally more torque than inward radial force to a clutch tooth 132 compared to an engagement feature 124 that transfers rotational force from the outer connector 120 to the clutch tooth 132 in a primarily radial direction (the engagement feature 124 extending primarily tangent to the outer connector 120), which may transfer less torque and more inward radial force to the clutch tooth 132. In some embodiments, the engagement features 124 can include a combination tangent and radial components to control the proportion of torque that is transferred from the outer connector 120 to the inner connector 110 and the amount of inward radial force that is applied to the clutch teeth 132.

[0039] During operation, when the inward radial force imparted on the clutch teeth 132 by the engagement features 124 overcomes the outward biasing force maintaining the clutch teeth 132 in engagement with the connector profile 122, the clutch teeth 132 are disengaged from the outer connector 120 and allow the outer connector 120 to rotate relative to the inner connector 110, limiting torque transferred to the inner connector 110. Optionally, the disengaged clutch teeth 132 may provide an audible and/or tactile signal to the user.

[0040] By modifying geometric and material properties of the engagement features 124 and the clutch teeth 132, the amount of torque that is applied to the inner connector 110 prior to disengaging the clutch teeth 132 can be controlled. For example, the relative angle of the engagement features 124 can be adjusted to have a higher operational torque limit or a lower operational torque limit.

[0041] In some embodiments, the connector assembly 100 can provide different torque limits for tightening and loosening. For example, the connector assembly 100 may provide a lower torque limit for tightening the connector assembly 100 and a higher torque limit for loosening the connector assembly 100.

[0042] In the depicted example, the engagement features 124 may be asymmetric. As shown, the profile on the leading side 126 of the engagement feature 124 may differ from the profile on the trailing side 128 of the engagement feature 124. In some embodiments, the leading side 126 may allow for less torque to be imparted in the tightening direction (the leading side 126

extending relatively tangent to the outer connector 120) while the trailing side 128 may allow for greater torque to be imparted in the loosening direction (the trailing side 128 extending relatively normal to the outer connector 120).

[0043] Optionally, the engagement features 124 can include varying geometric features. For example, the engagement features 124 can be rounded or angular to facilitate or inhibit the clutch teeth 132 to disengaging from the connector profile 122. Similarly, complimentary geometric features of the tooth profile 135 of the clutch tooth 132 can be altered to engage with the engagement features 124.

[0044] The present disclosure is provided to enable any person skilled in the art to practice the various aspects described herein. The disclosure provides various examples of the subject technology, and the subject technology is not limited to these examples. Various modifications to these aspects will be readily apparent to those skilled in the art, and the generic principles defined herein may be applied to other aspects.

[0045] A reference to an element in the singular is not intended to mean “one and only one” unless specifically so stated, but rather “one or more.” Unless specifically stated otherwise, the term “some” refers to one or more. Pronouns in the masculine (e.g., his) include the feminine and neuter gender (e.g., her and its) and vice versa. Headings and subheadings, if any, are used for convenience only and do not limit the invention.

[0046] The word “exemplary” is used herein to mean “serving as an example or illustration.” Any aspect or design described herein as “exemplary” is not necessarily to be construed as preferred or advantageous over other aspects or designs. In one aspect, various alternative configurations and operations described herein may be considered to be at least equivalent.

[0047] A phrase such as an “aspect” does not imply that such aspect is essential to the subject technology or that such aspect applies to all configurations of the subject technology. A disclosure relating to an aspect may apply to all configurations, or one or more configurations. An aspect may provide one or more examples. A phrase such as an aspect may refer to one or more aspects and vice versa. A phrase such as an “embodiment” does not imply that such embodiment is essential to the subject technology or that such embodiment applies to all configurations of the subject technology. A disclosure relating to an embodiment may apply to all embodiments, or one or more embodiments. An embodiment may provide one or more examples. A phrase such an embodiment may refer to one or more embodiments and vice versa.

A phrase such as a “configuration” does not imply that such configuration is essential to the subject technology or that such configuration applies to all configurations of the subject technology. A disclosure relating to a configuration may apply to all configurations, or one or more configurations. A configuration may provide one or more examples. A phrase such a configuration may refer to one or more configurations and vice versa.

[0048] In one aspect, unless otherwise stated, all measurements, values, ratings, positions, magnitudes, sizes, and other specifications that are set forth in this specification, including in the claims that follow, are approximate, not exact. In one aspect, they are intended to have a reasonable range that is consistent with the functions to which they relate and with what is customary in the art to which they pertain.

[0049] In one aspect, the term “coupled” or the like may refer to being directly coupled. In another aspect, the term “coupled” or the like may refer to being indirectly coupled.

[0050] Terms such as “top,” “bottom,” “front,” “rear” and the like if used in this disclosure should be understood as referring to an arbitrary frame of reference, rather than to the ordinary gravitational frame of reference. Thus, a top surface, a bottom surface, a front surface, and a rear surface may extend upwardly, downwardly, diagonally, or horizontally in a gravitational frame of reference.

[0051] Various items may be arranged differently (e.g., arranged in a different order, or partitioned in a different way) all without departing from the scope of the subject technology. All structural and functional equivalents to the elements of the various aspects described throughout this disclosure that are known or later come to be known to those of ordinary skill in the art are expressly incorporated herein by reference and are intended to be encompassed by the claims. Moreover, nothing disclosed herein is intended to be dedicated to the public regardless of whether such disclosure is explicitly recited in the claims. No claim element is to be construed under the provisions of 35 U.S.C. §112, sixth paragraph, unless the element is expressly recited using the phrase “means for” or, in the case of a method claim, the element is recited using the phrase “step for.” Furthermore, to the extent that the term “include,” “have,” or the like is used, such term is intended to be inclusive in a manner similar to the term “comprise” as “comprise” is interpreted when employed as a transitional word in a claim.

[0052] The Title, Background, Summary, Brief Description of the Drawings and Abstract of the disclosure are hereby incorporated into the disclosure and are provided as illustrative examples

of the disclosure, not as restrictive descriptions. It is submitted with the understanding that they will not be used to limit the scope or meaning of the claims. In addition, in the Detailed Description, it can be seen that the description provides illustrative examples and the various features are grouped together in various embodiments for the purpose of streamlining the disclosure. This method of disclosure is not to be interpreted as reflecting an intention that the claimed subject matter requires more features than are expressly recited in each claim. Rather, as the following claims reflect, inventive subject matter lies in less than all features of a single disclosed configuration or operation. The following claims are hereby incorporated into the Detailed Description, with each claim standing on its own as a separately claimed subject matter.

[0053] The claims are not intended to be limited to the aspects described herein, but is to be accorded the full scope consistent with the language claims and to encompass all legal equivalents. Notwithstanding, none of the claims are intended to embrace subject matter that fails to satisfy the requirement of 35 U.S.C. §101, 102, or 103, nor should they be interpreted in such a way.

CLAIMS

What is claimed is:

1. A torque limiting connector, comprising:

an outer connector comprising a profile disposed on an inner surface of the outer connector;

an inner connector disposed within the outer connector, the inner connector comprising:

an upper threaded portion; and

a lower threaded portion; and

a clutch disposed around and rotationally coupled to the inner connector, the clutch comprising a plurality of clutch teeth extending from an outer surface of the clutch, wherein the plurality of clutch teeth are outwardly biased to be releasably engaged with the profile of the outer connector,

wherein the plurality of clutch teeth are configured to transfer an operational torque from the outer connector to the inner connector when the operational torque is below a torque limit, and the plurality of clutch teeth are forced inward to disengage the profile of the outer connector and prevent transfer of the operational torque when the operational torque exceeds the torque limit.

2. The torque limiting connector of Claim 1, wherein the clutch is concentrically disposed about the inner connector.

3. The torque limiting connector of Claim 1, the clutch further comprising a plurality of clutch features, wherein the clutch features engage a plurality of channels formed in the inner connector to rotationally couple the clutch and the inner connector.

4. The torque limiting connector of Claim 1, the inner connector further comprising an angled flange configured to axially retain the clutch.

5. The torque limiting connector of Claim 1, wherein the plurality of clutch teeth comprises three clutch teeth.

6. The torque limiting connector of Claim 1, wherein the profile comprises a plurality of engagement features.

7. The torque limiting connector of Claim 6, wherein each of the plurality of engagement features is asymmetric.

8. The torque limiting connector of Claim 7, wherein each of the plurality of engagement features comprises a leading side and a trailing side, wherein the leading side comprises a rounded geometry and the trailing side comprises an angular geometry.

9. The torque limiting connector of Claim 1, wherein the clutch and the outer connector emit an audible signal when the operational torque exceeds the torque limit.

10. The torque limiting connector of Claim 1, wherein the clutch and the outer connector emit a tactile signal when the operational torque exceeds the torque limit.

11. A torque limiting connector, comprising:

- an outer connector comprising a profile disposed on an inner surface of the outer connector;

- an inner connector disposed within the outer connector, the inner connector comprising:

- an upper threaded portion; and

- a lower threaded portion; and

- a clutch disposed around and rotationally coupled to the inner connector, the clutch comprising a plurality of clutch teeth extending from an outer surface of the clutch, wherein the plurality of clutch teeth are outwardly biased to be releasably engaged with the profile of the outer connector,

- wherein the plurality of clutch teeth are configured to permit the outer connector to rotate the inner connector when an operational torque is below a torque limit, and the plurality of clutch teeth are forced inward to disengage the profile of the outer connector and permit rotation of the outer connector relative to the inner connector when the operational torque exceeds the torque limit.

12. The torque limiting connector of Claim 11, the clutch further comprising a plurality of clutch features, wherein the clutch features engage a plurality of channels formed in the inner connector to rotationally couple the clutch and the inner connector.

13. The torque limiting connector of Claim 11, the inner connector further comprising an angled flange configured to axially retain the clutch.

14. The torque limiting connector of Claim 11, wherein the profile comprises a plurality of engagement features.

15. The torque limiting connector of Claim 14, wherein each of the plurality of engagement features is asymmetric.

16. The torque limiting connector of Claim 15, wherein each of the plurality of engagement features comprises a leading side and a trailing side, wherein the leading side comprises a rounded geometry and the trailing side comprises an angular geometry.

17. The torque limiting connector of Claim 11, wherein the clutch and the outer connector emit an audible signal when the operational torque exceeds the torque limit.

18. The torque limiting connector of Claim 11, wherein the clutch and the outer connector emit a tactile signal when the operational torque exceeds the torque limit.

19. A method to tighten a connection, the method comprising:

- threadedly engaging a first connector with a second connector;
- rotating an outer connector of the first connector at an operational torque below a connection torque limit; and
- rotating an inner connector of the first connector via the rotation of the outer connector, wherein a clutch rotationally engages the inner connector and the outer connector.

20. The method of Claim 19, further comprising:

rotating the outer connector at the operational torque exceeding the connection torque limit; and

rotating the outer connector relative to the inner connector, wherein the clutch disengages the outer connector from the inner connector.

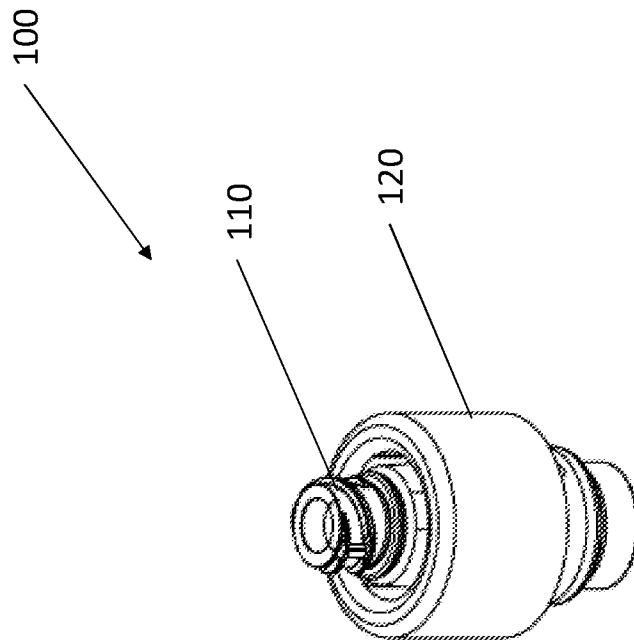

FIG. 1

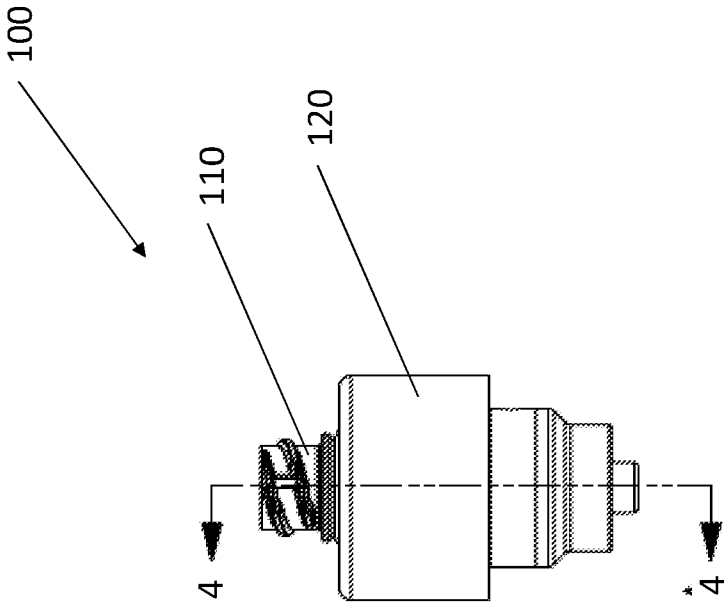

FIG. 2

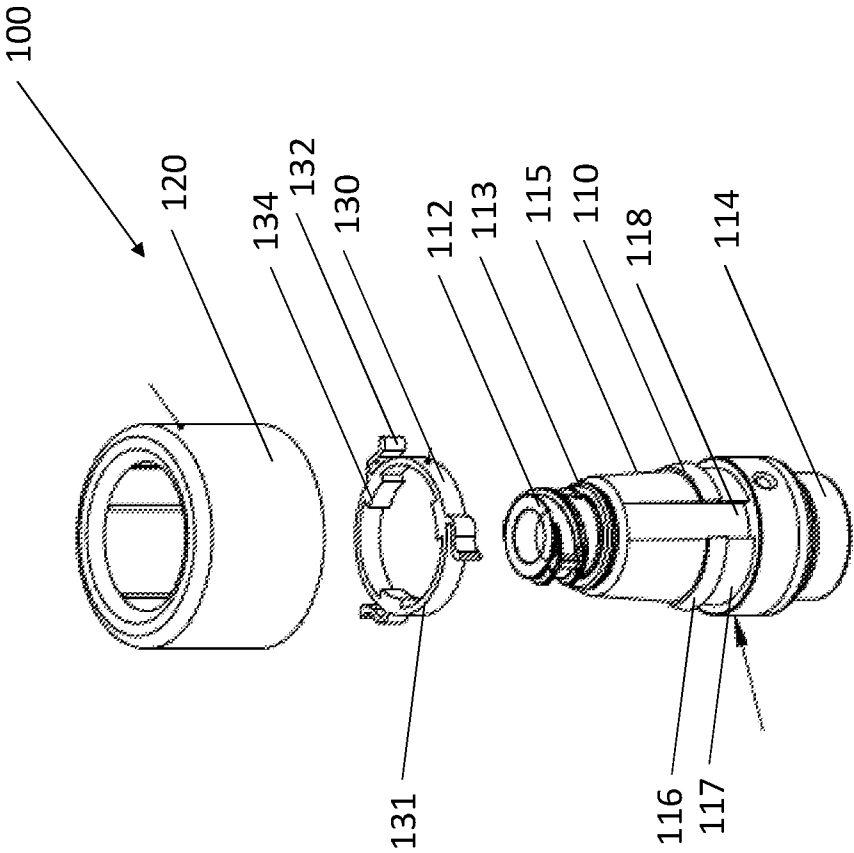

FIG. 3

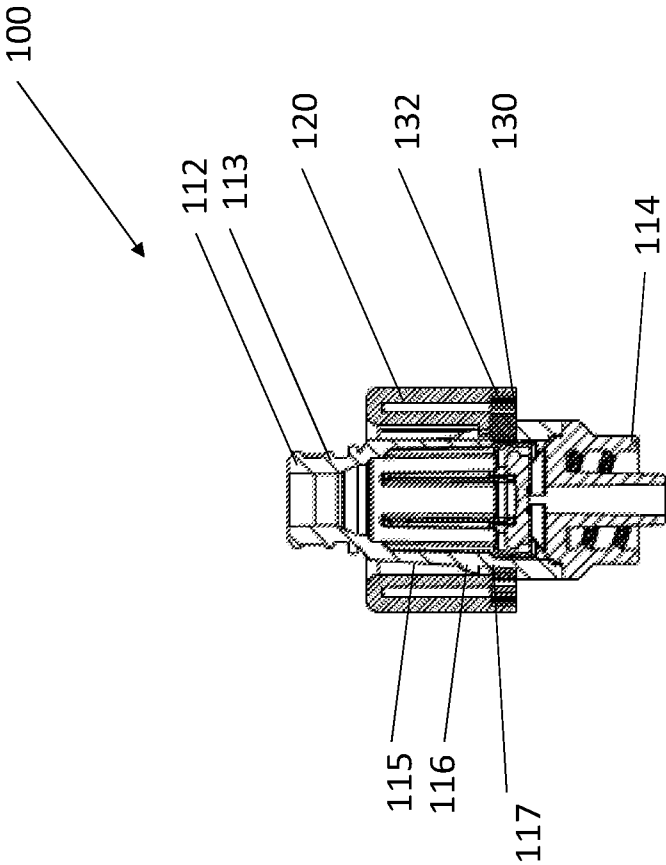

FIG. 4

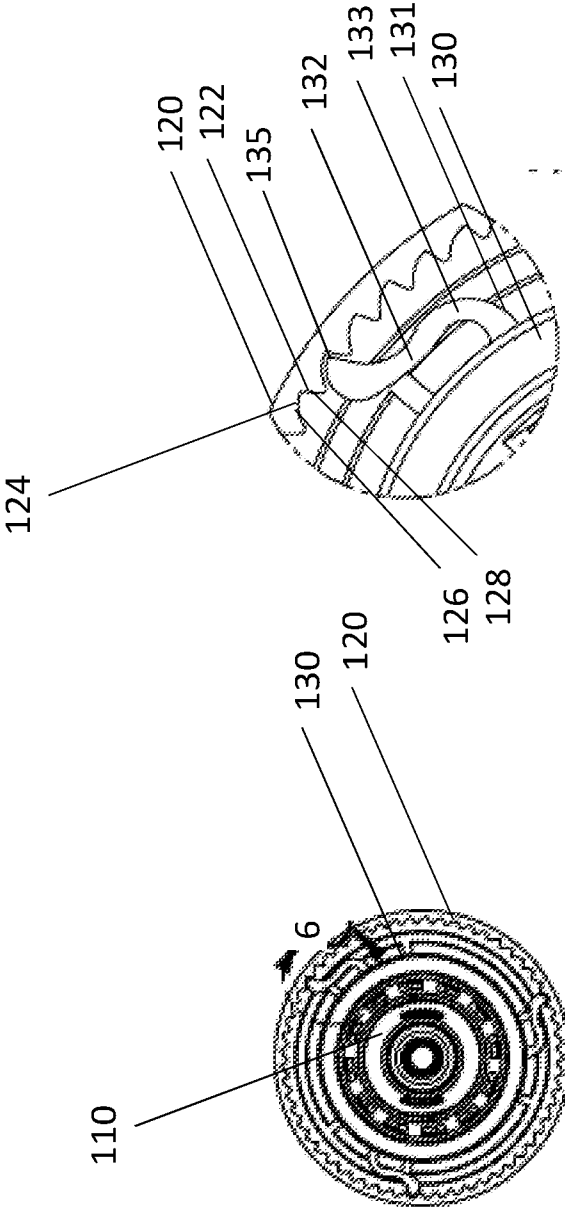

FIG. 5

FIG. 6

INTERNATIONAL SEARCH REPORT

International application No
PCT/US2020/019863

A. CLASSIFICATION OF SUBJECT MATTER
INV. F16D7/00 F16D7/04 A61M39/10
ADD.

According to International Patent Classification (IPC) or to both national classification and IPC

B. FIELDS SEARCHED

Minimum documentation searched (classification system followed by classification symbols)
F16D A61M

Documentation searched other than minimum documentation to the extent that such documents are included in the fields searched

Electronic data base consulted during the international search (name of data base and, where practicable, search terms used)

EPO-Internal, WPI Data

C. DOCUMENTS CONSIDERED TO BE RELEVANT

Category*	Citation of document, with indication, where appropriate, of the relevant passages	Relevant to claim No.
X	US 8 888 143 B2 (DIBA IND INC [US]) 18 November 2014 (2014-11-18) column 5, lines 27-42 figures 1-5,6A	1-20
X	----- WO 2018/161359 A1 (HANGZHOU NUO MAO MEDICAL TECH CO LTD [CN]) 13 September 2018 (2018-09-13) figures 3,5-10,19,20,22,24,26	1-20
X	----- US 2009/133980 A1 (SWAIM JASON A [US] ET AL) 28 May 2009 (2009-05-28)	19,20
A	paragraphs [0001], [0020] - [0023], [0026], [0030], [0041] figures 1-10 ----- -/-	1-18



Further documents are listed in the continuation of Box C.



See patent family annex.

* Special categories of cited documents :

"A" document defining the general state of the art which is not considered to be of particular relevance

"E" earlier application or patent but published on or after the international filing date

"L" document which may throw doubts on priority claim(s) or which is cited to establish the publication date of another citation or other special reason (as specified)

"O" document referring to an oral disclosure, use, exhibition or other means

"P" document published prior to the international filing date but later than the priority date claimed

"T" later document published after the international filing date or priority date and not in conflict with the application but cited to understand the principle or theory underlying the invention

"X" document of particular relevance; the claimed invention cannot be considered novel or cannot be considered to involve an inventive step when the document is taken alone

"Y" document of particular relevance; the claimed invention cannot be considered to involve an inventive step when the document is combined with one or more other such documents, such combination being obvious to a person skilled in the art

"&" document member of the same patent family

Date of the actual completion of the international search

1 May 2020

Date of mailing of the international search report

13/05/2020

Name and mailing address of the ISA/

European Patent Office, P.B. 5818 Patentlaan 2
NL - 2280 HV Rijswijk
Tel. (+31-70) 340-2040,
Fax: (+31-70) 340-3016

Authorized officer

Walther, Manuel

INTERNATIONAL SEARCH REPORT

International application No
PCT/US2020/019863

C(Continuation). DOCUMENTS CONSIDERED TO BE RELEVANT		
Category*	Citation of document, with indication, where appropriate, of the relevant passages	Relevant to claim No.
X	US 2013/233053 A1 (BEEMER ERIC [US] ET AL) 12 September 2013 (2013-09-12) paragraphs [0035] - [0039] figures 2,8,10-12 -----	1-20
X	EP 3 415 194 A1 (KOYO SANGYO CO [JP]) 19 December 2018 (2018-12-19) paragraphs [0018] - [0022] figures 5,6A-B -----	1-20

INTERNATIONAL SEARCH REPORT

Information on patent family members

International application No

PCT/US2020/019863

Patent document cited in search report	Publication date	Patent family member(s)	Publication date
US 8888143	B2	18-11-2014	NONE
WO 2018161359	A1	13-09-2018	EP 3545916 A1 02-10-2019 US 2020121891 A1 23-04-2020 WO 2018161359 A1 13-09-2018
US 2009133980	A1	28-05-2009	NONE
US 2013233053	A1	12-09-2013	DE 112013001387 T5 11-12-2014 GB 2515214 A 17-12-2014 JP 6257097 B2 10-01-2018 JP 2015512053 A 23-04-2015 US 2013233053 A1 12-09-2013 US 2017051860 A1 23-02-2017 WO 2013138293 A1 19-09-2013
EP 3415194	A1	19-12-2018	CN 109041571 A 18-12-2018 EP 3415194 A1 19-12-2018 JP 6462900 B1 30-01-2019 JP WO2018189842 A1 18-04-2019 US 2018369559 A1 27-12-2018 WO 2018189842 A1 18-10-2018