



US 20040097884A1

(19) **United States**

(12) **Patent Application Publication**  
**Capes et al.**

(10) **Pub. No.: US 2004/0097884 A1**

(43) **Pub. Date: May 20, 2004**

(54) **SINGLE-USE SYRINGE**

**Publication Classification**

(76) Inventors: **David Francis Capes**, Singapore (SG);  
**Marcos Calucho Villas**, Fraga-Huesca  
(ES); **Martin Clapes Pons**,  
Alcobendas - Madrid (ES)

(51) **Int. Cl.<sup>7</sup> ..... A61M 5/00**

(52) **U.S. Cl. .... 604/240**

Correspondence Address:

**BECTON, DICKINSON AND COMPANY**  
**1 BECTON DRIVE**  
**FRANKLIN LAKES, NJ 07417-1880 (US)**

(21) Appl. No.: **10/706,795**

(22) Filed: **Nov. 12, 2003**

**Related U.S. Application Data**

(63) Continuation of application No. 09/941,030, filed on Aug. 28, 2001.  
Continuation of application No. 09/274,117, filed on Mar. 23, 1999, now Pat. No. 6,361,525, which is a continuation-in-part of application No. 09/249,431, filed on Feb. 12, 1999, now abandoned, which is a continuation-in-part of application No. 09/124,447, filed on Jul. 29, 1998, now abandoned.

(57) **ABSTRACT**

A syringe includes a barrel having a fluid chamber, a proximal end, a distal end and an elongated tip extending from the distal end and having a passageway therethrough in fluid communication with the chamber. A collar surrounds the tip and includes at least one deflectable locking tab projecting radially inwardly from the collar. The locking tab is adapted to engage the hub of a needle assembly to prevent removal of a needle assembly away from the tip. The locking tab is configured to allow the assembly of the needle assembly to the barrel through axial motion of the hub toward the barrel. A plunger is provided for drawing fluid into and out of the barrel. The plunger includes an elongated plunger rod having a proximal portion and a distal portion connected by a breakable connection. The breakable connection is strong enough to hold the proximal portion and distal portion together during normal use of the syringe and breakable upon application of additional force to the proximal portion.

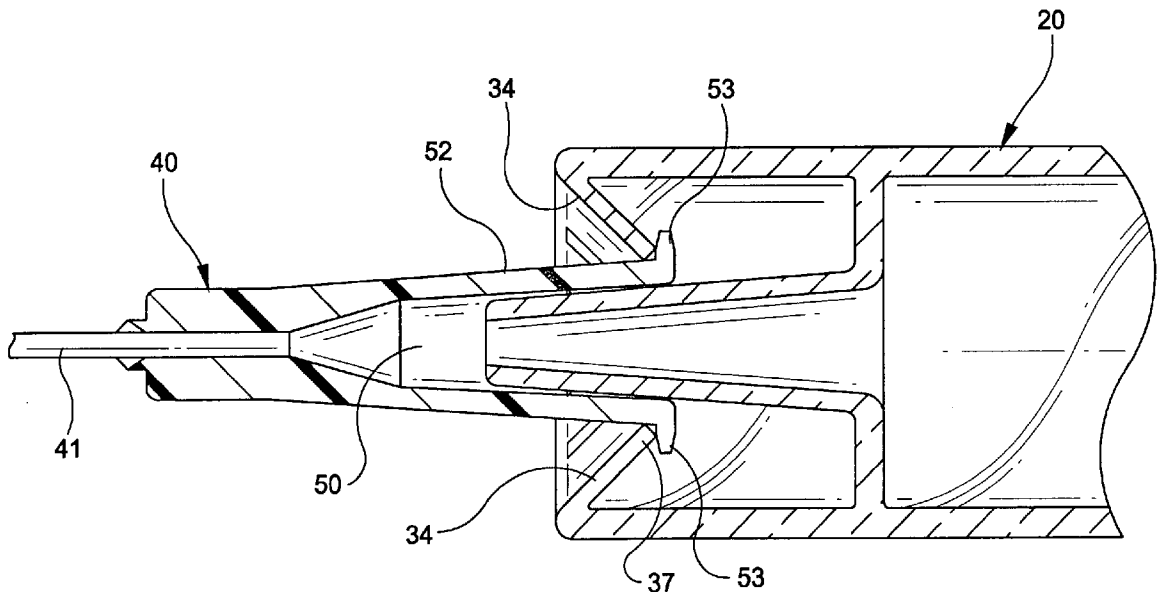
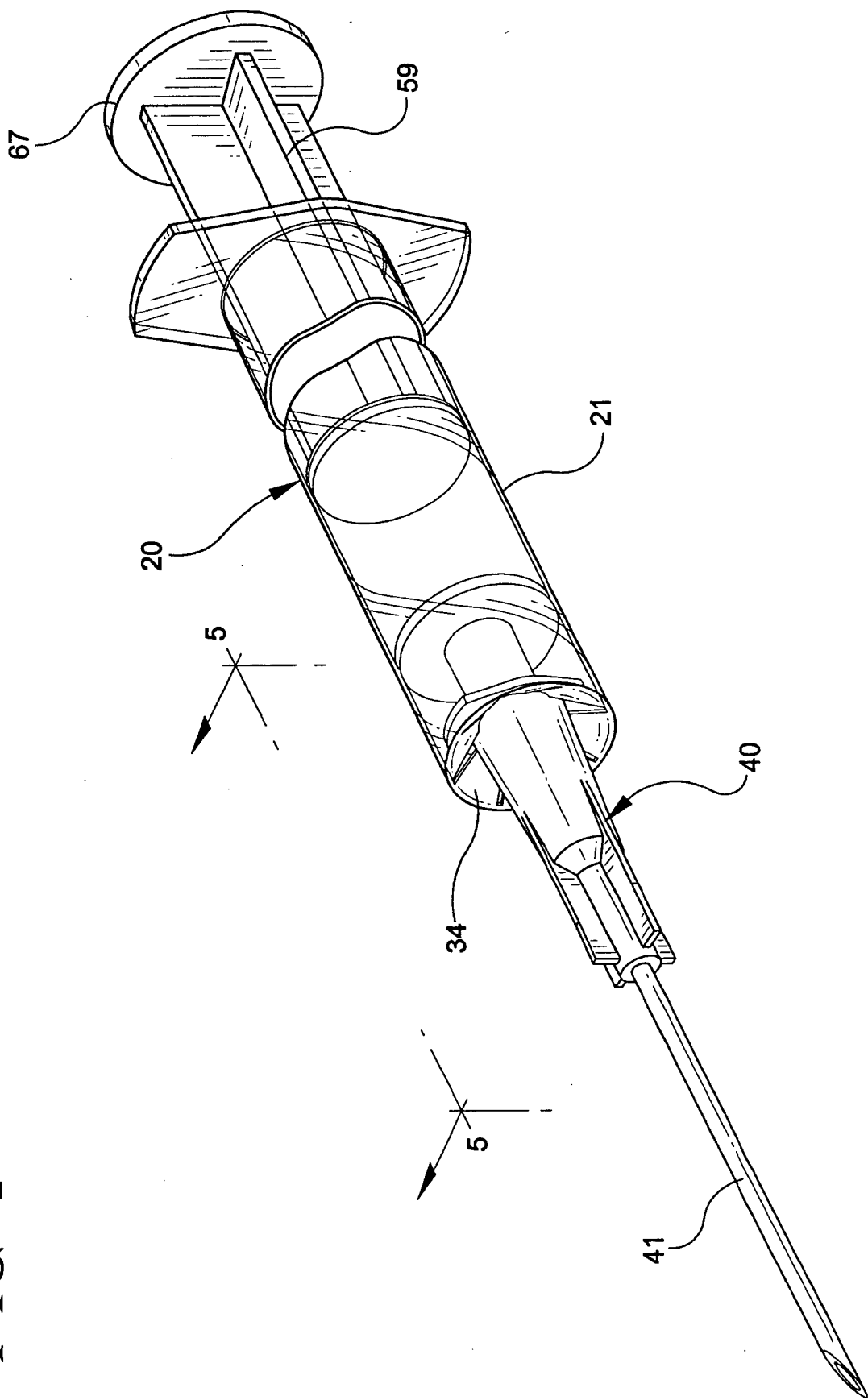

FIG-1



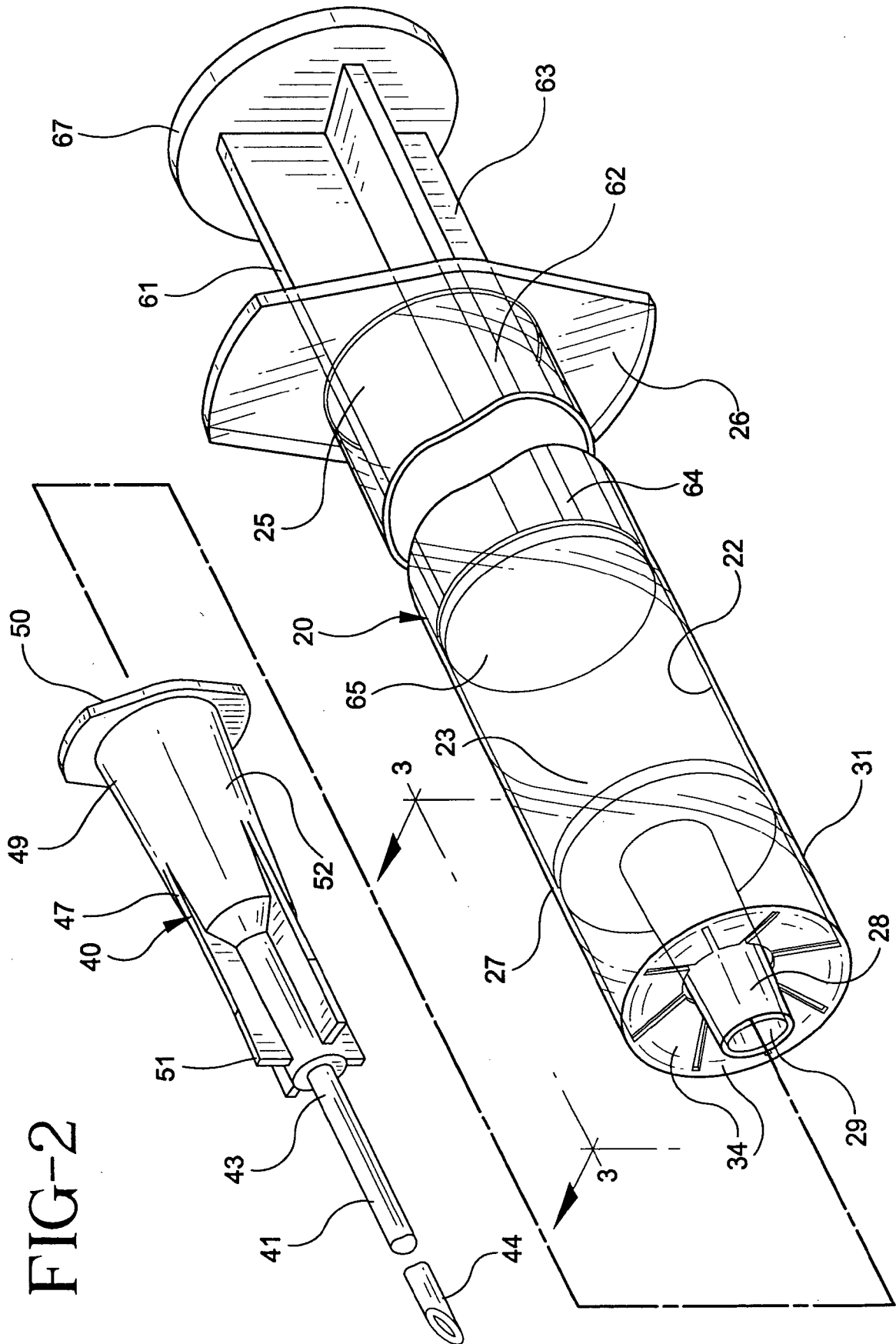

FIG-3

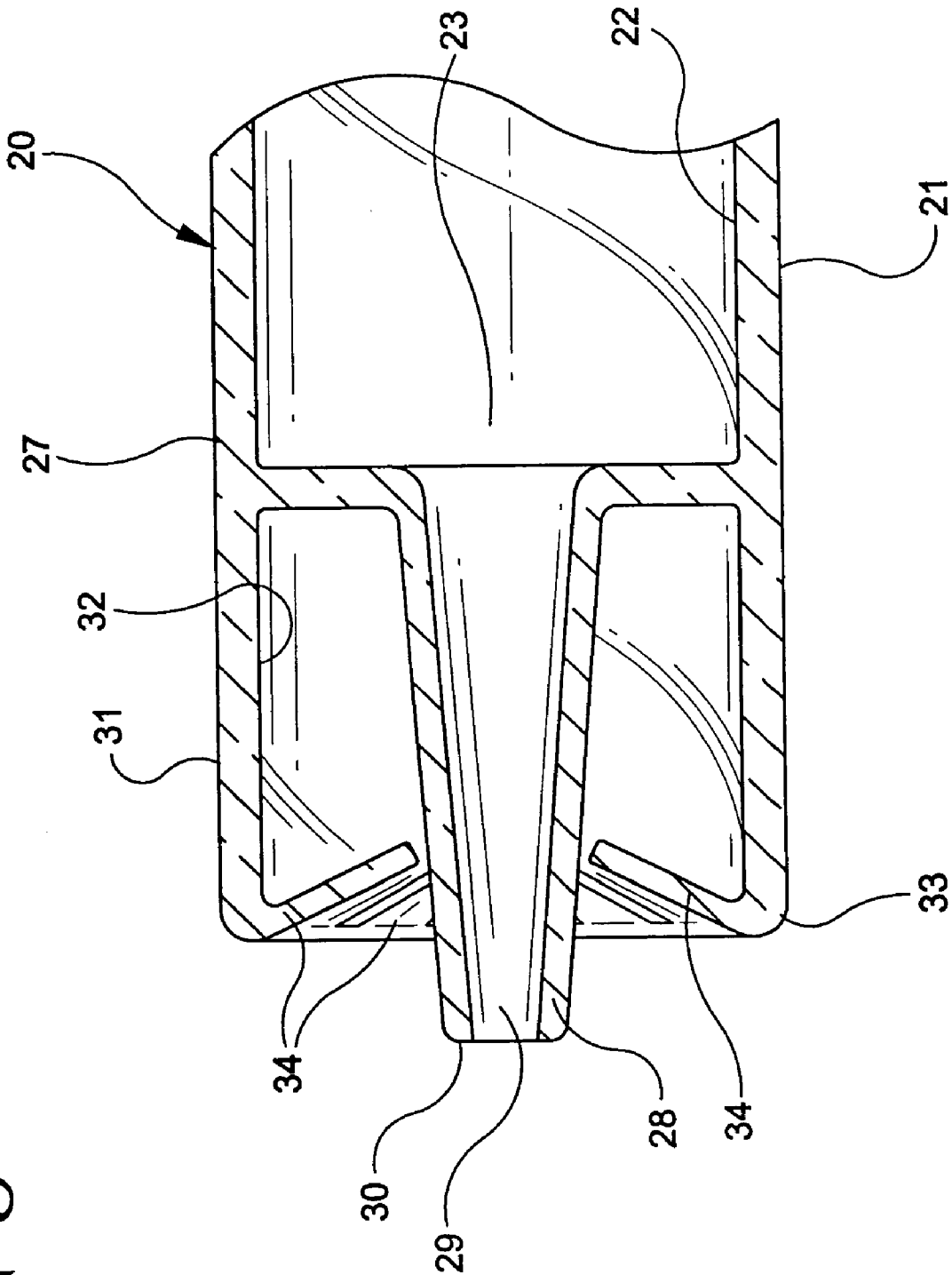

FIG-4

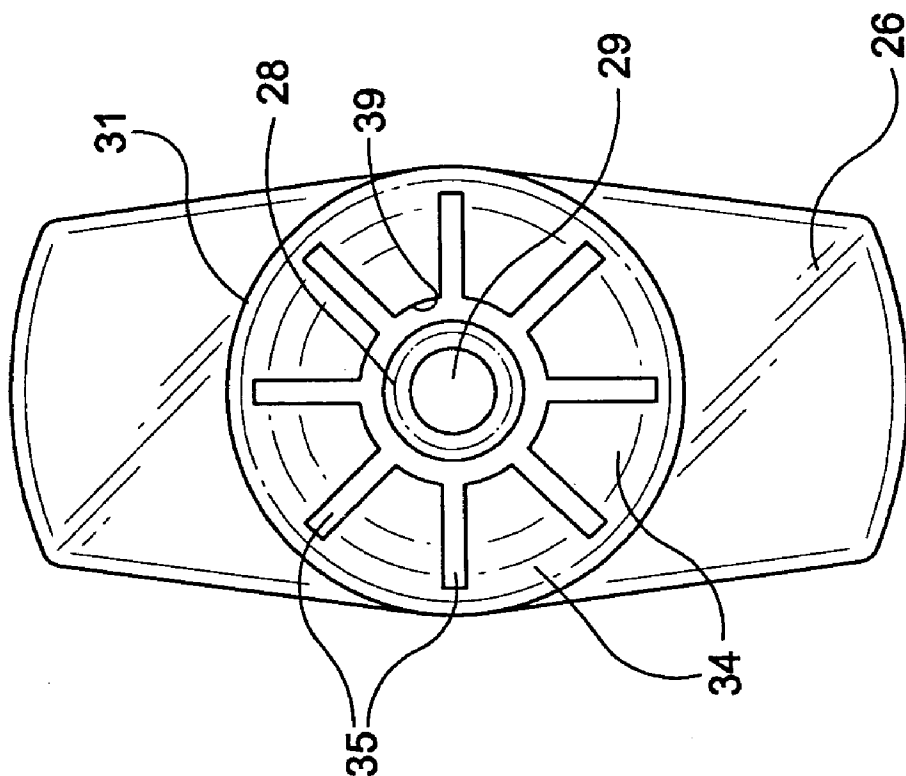
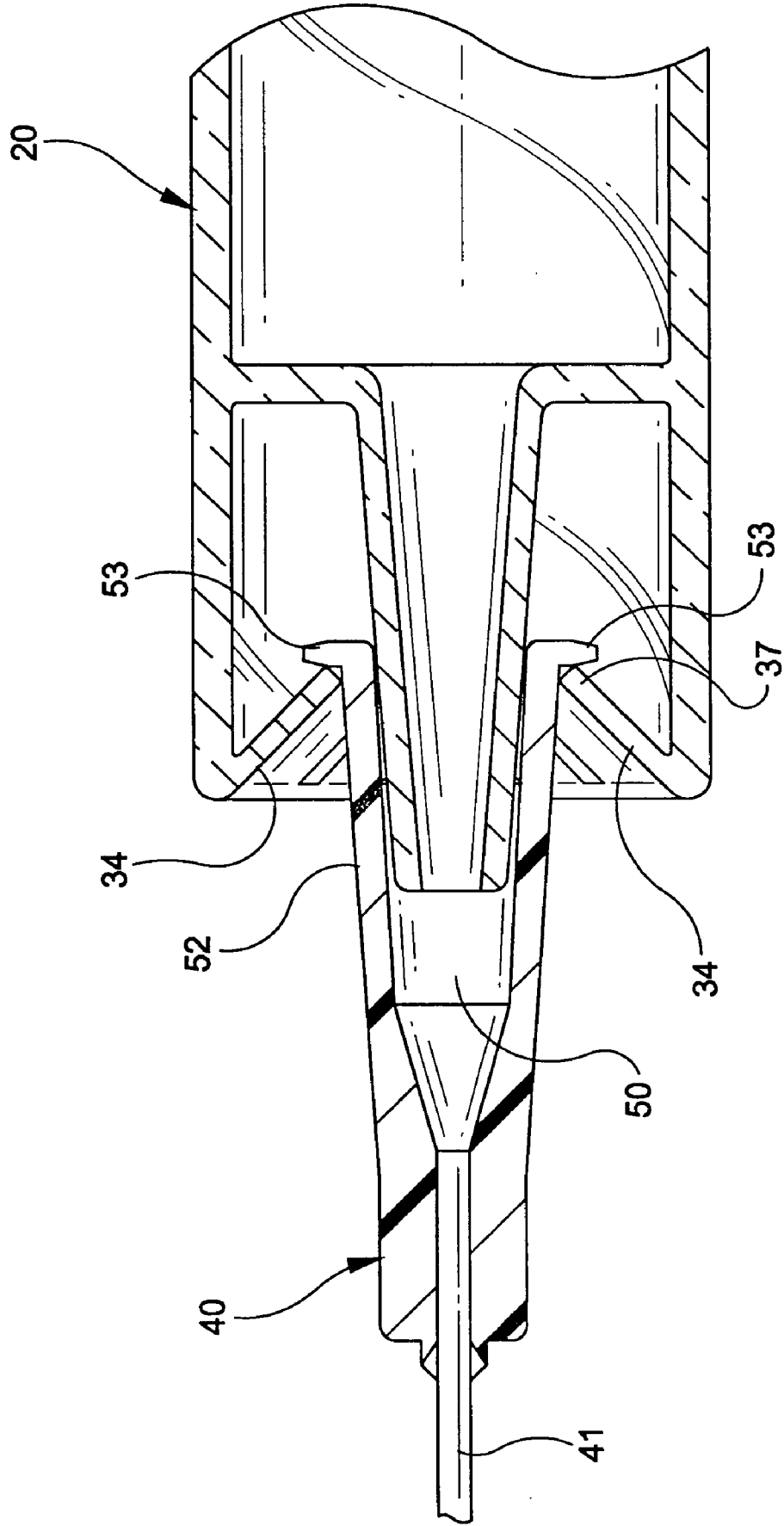

FIG-5



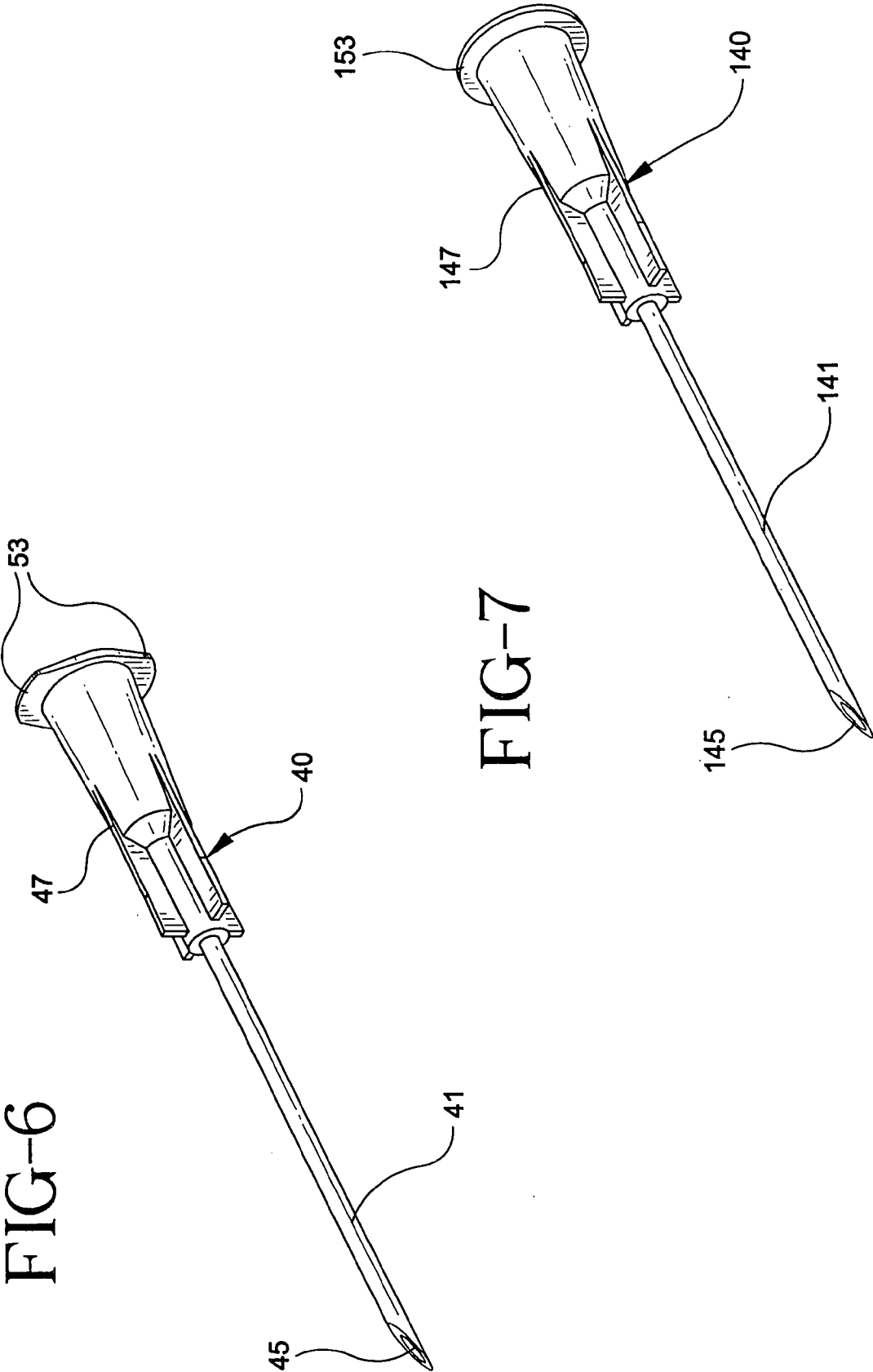

FIG-8

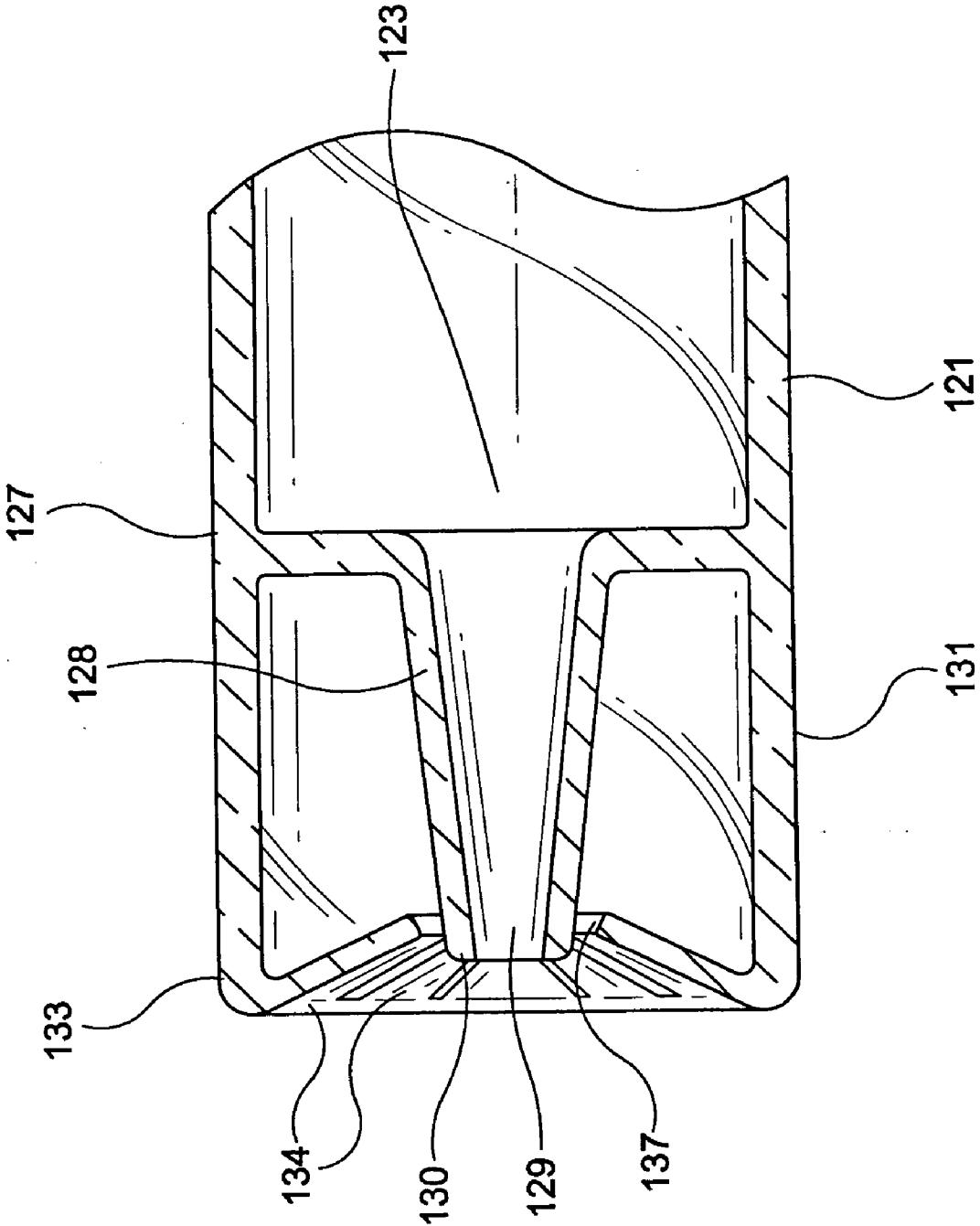



FIG-9

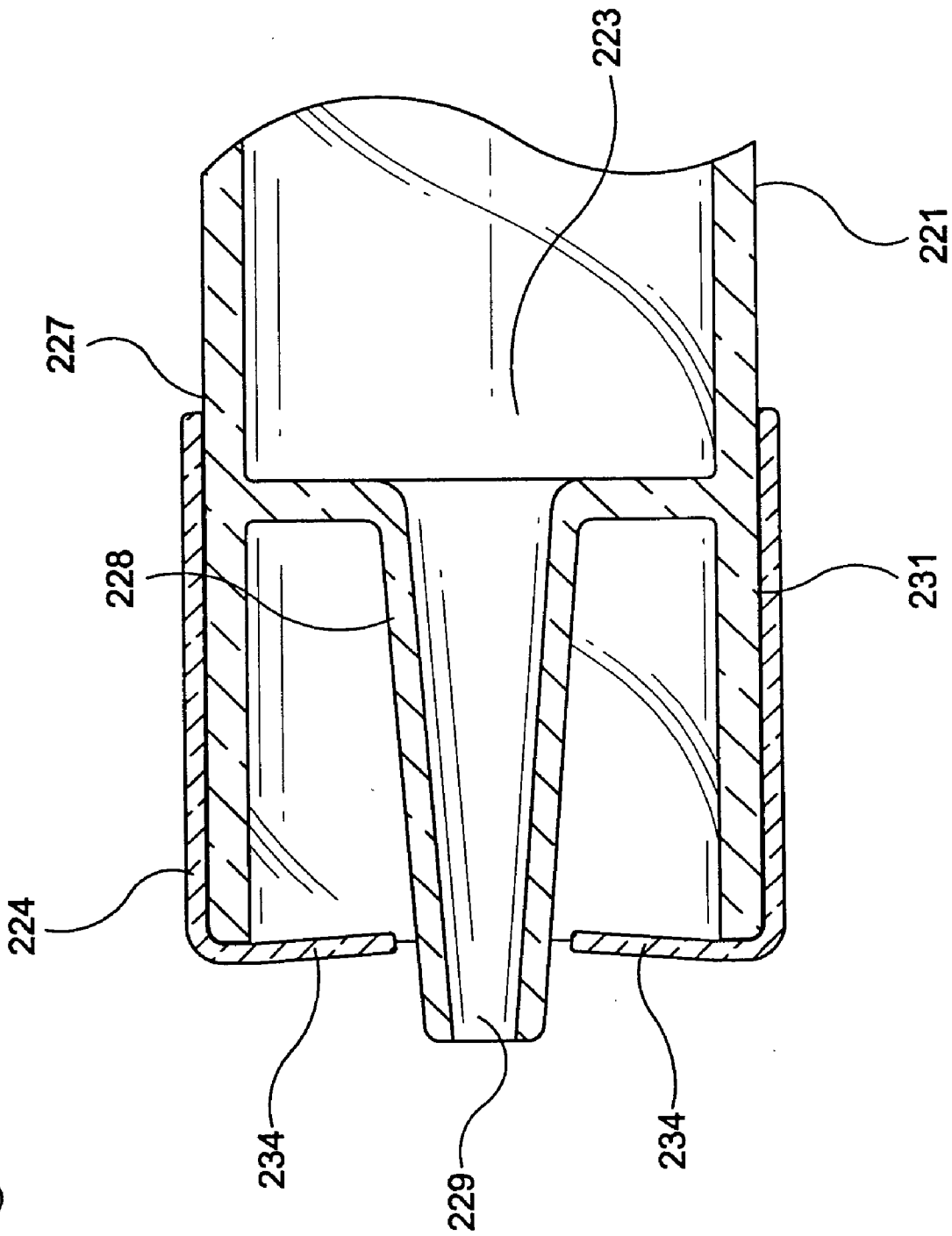

FIG-10

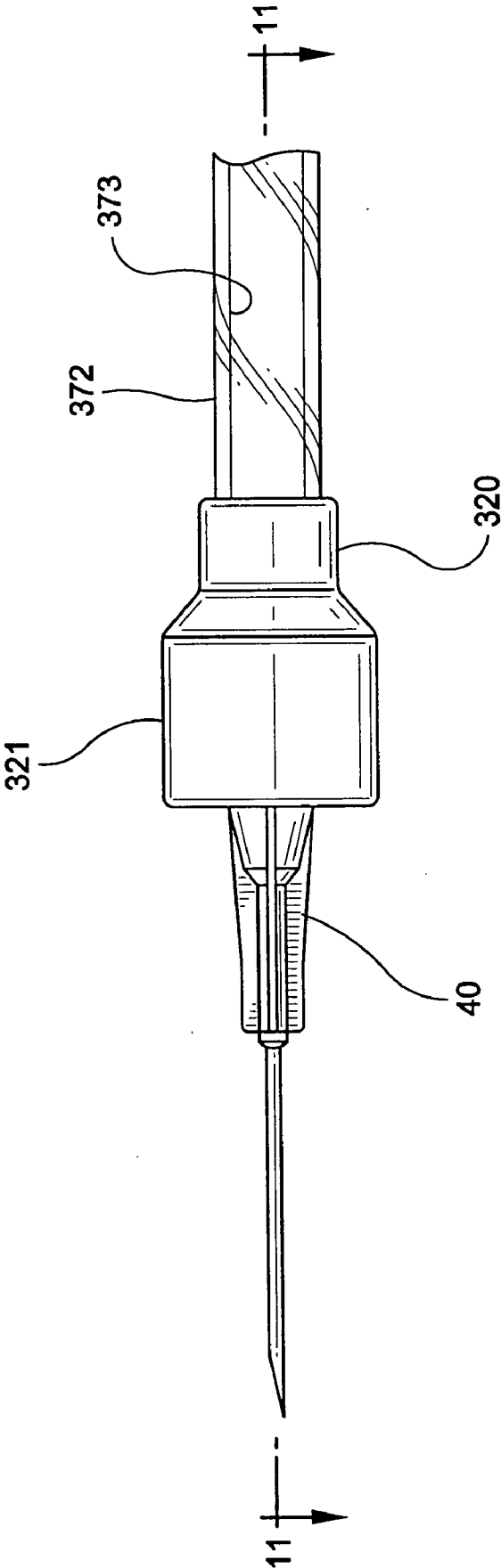

FIG-11

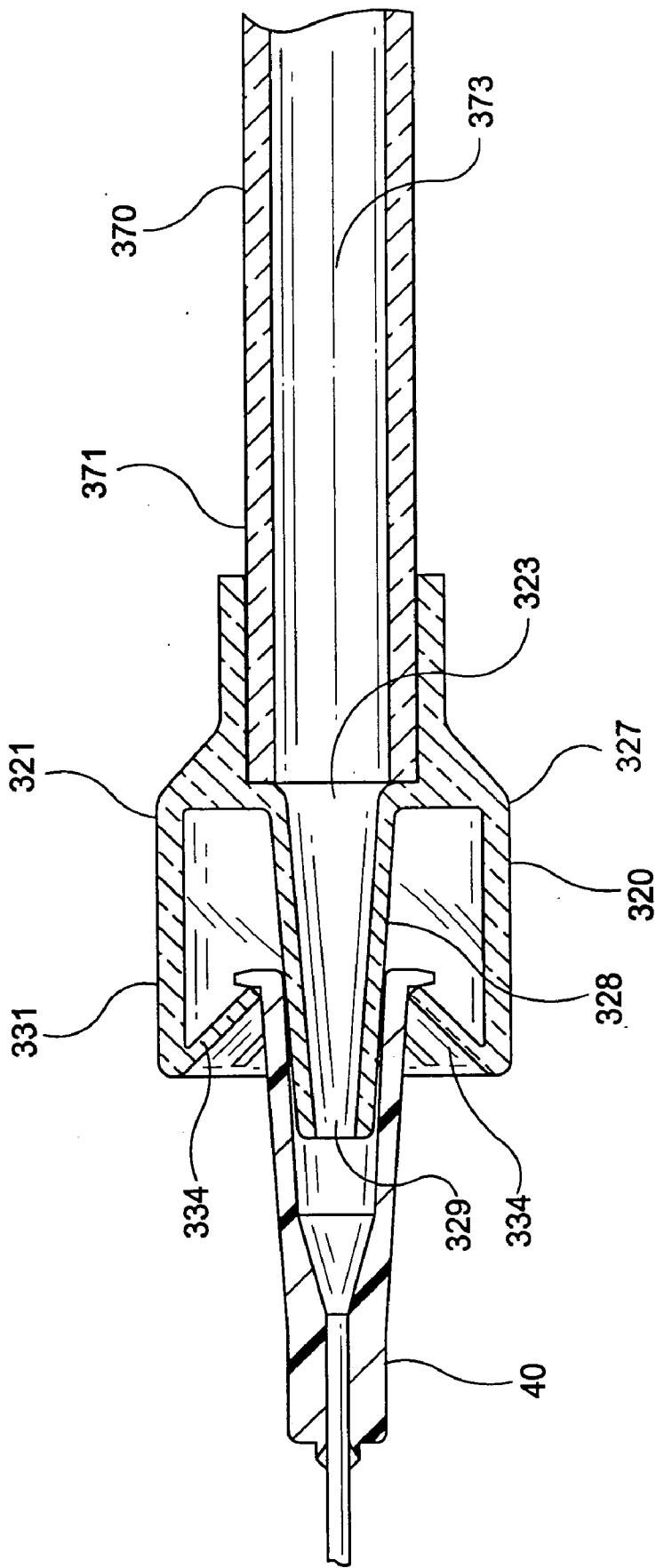

FIG-12

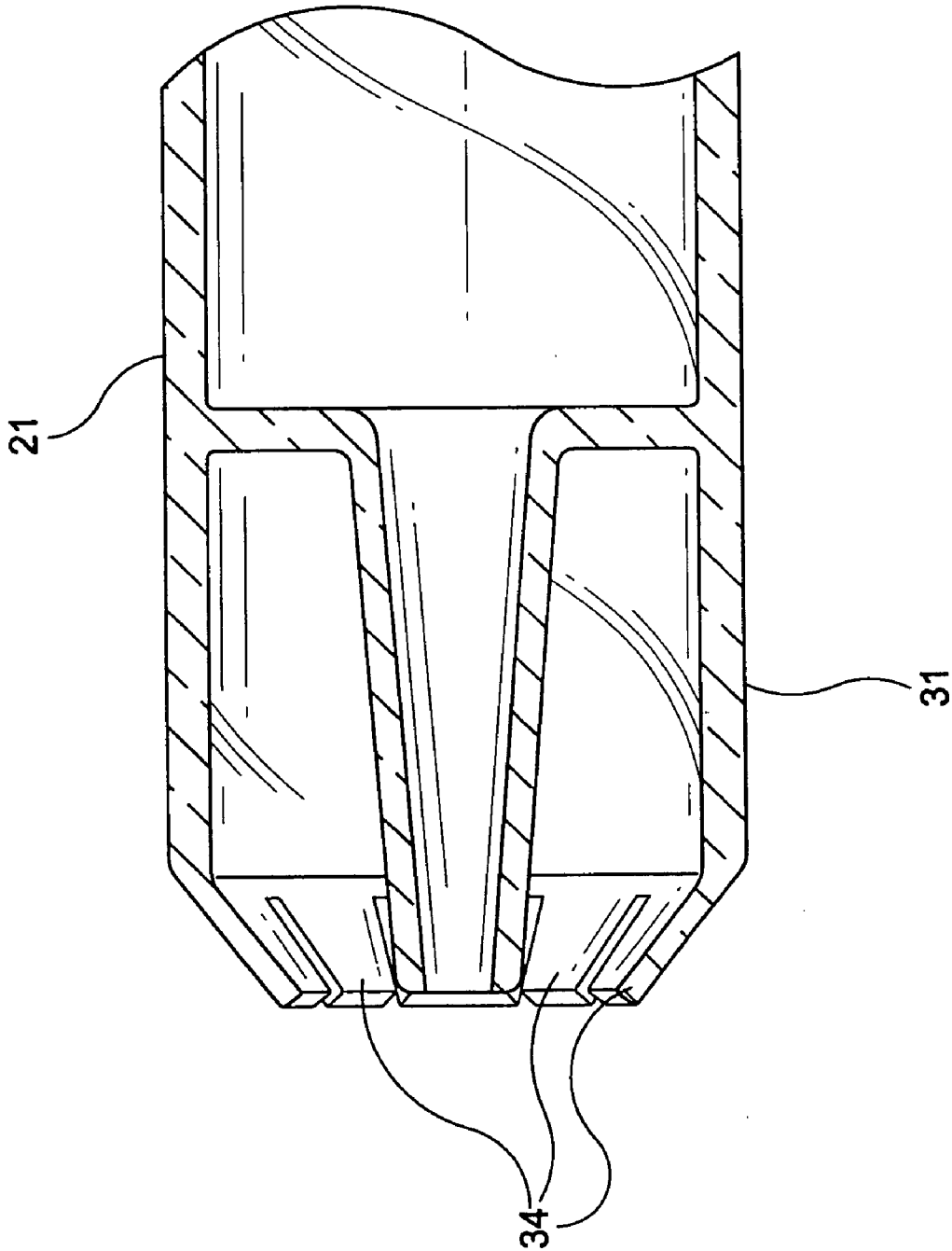

FIG-13

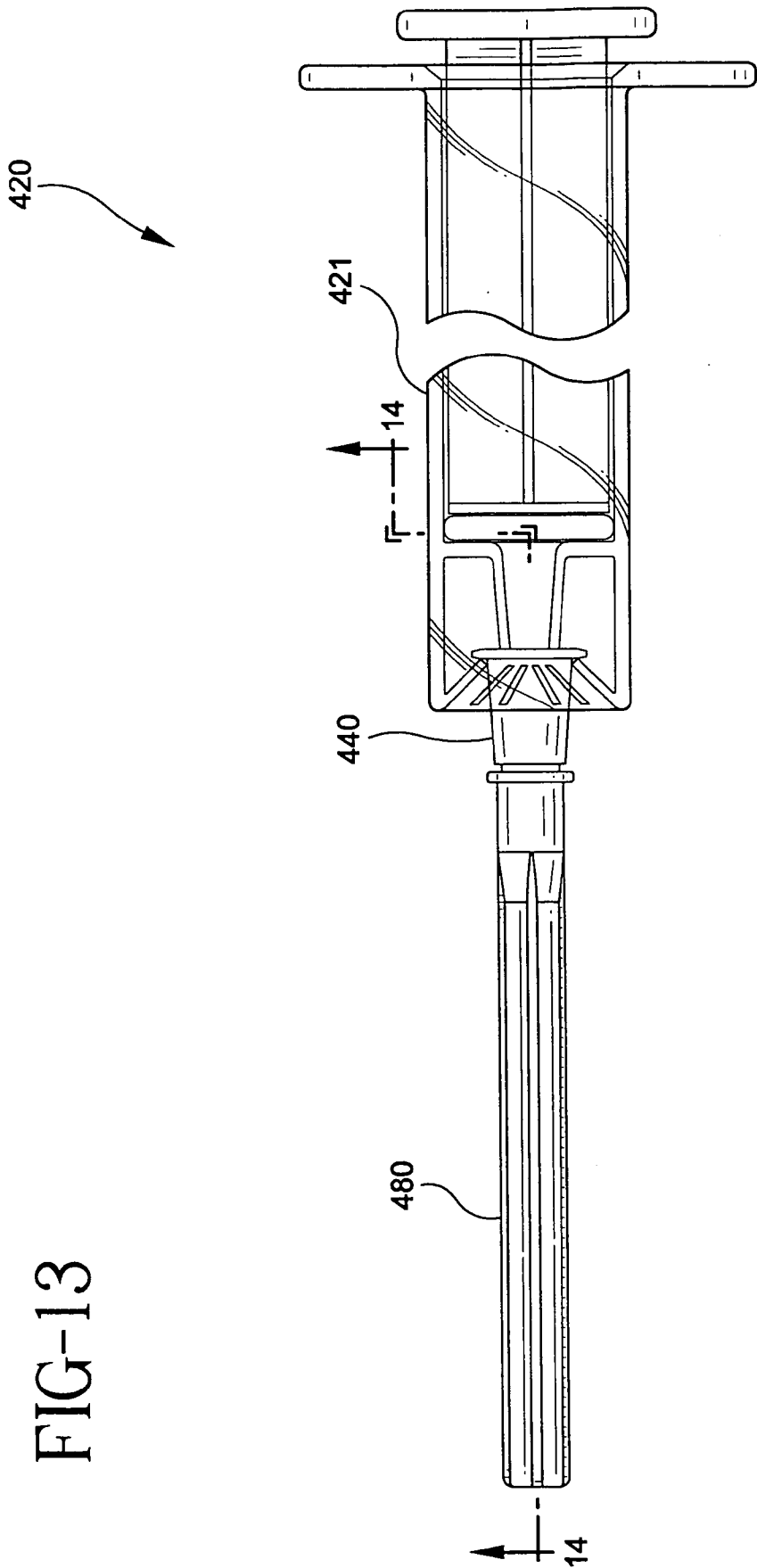

FIG-14

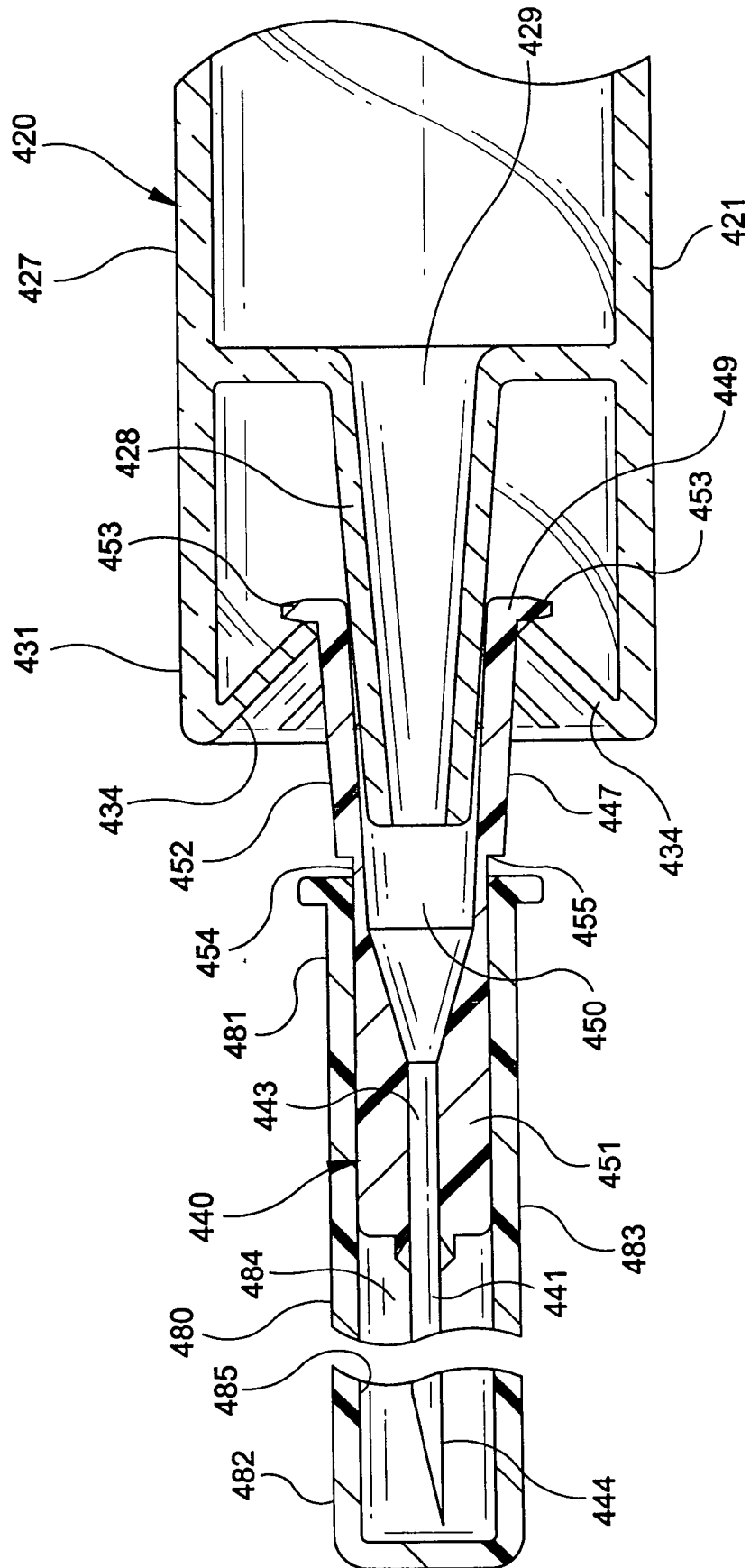

FIG-15

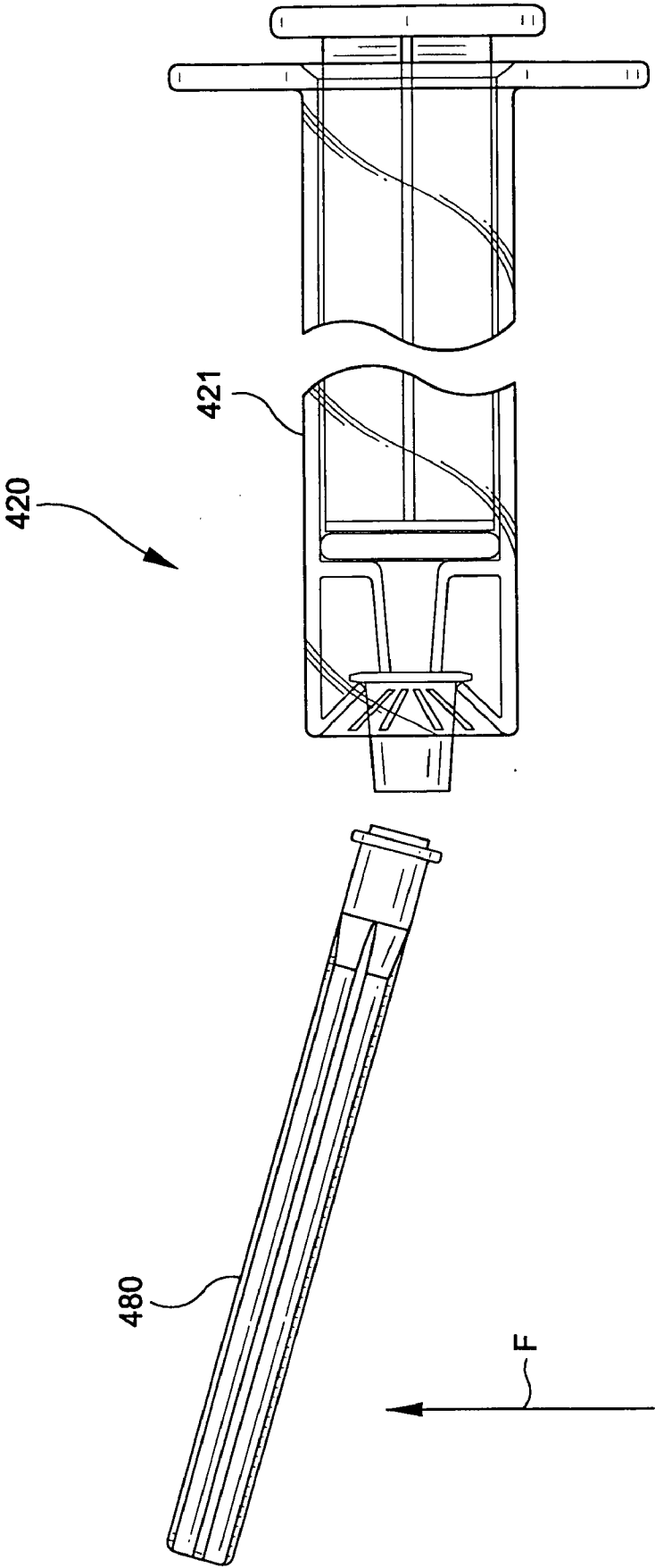

FIG-16

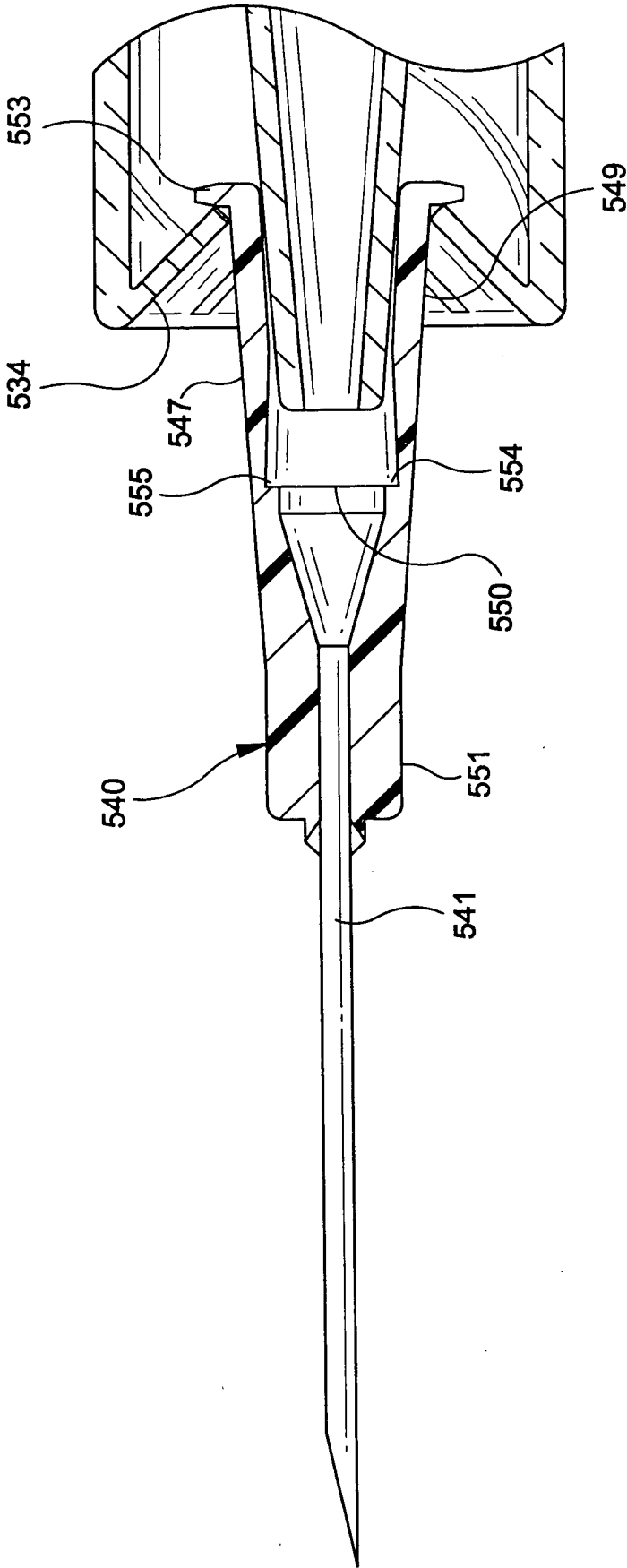



FIG-17

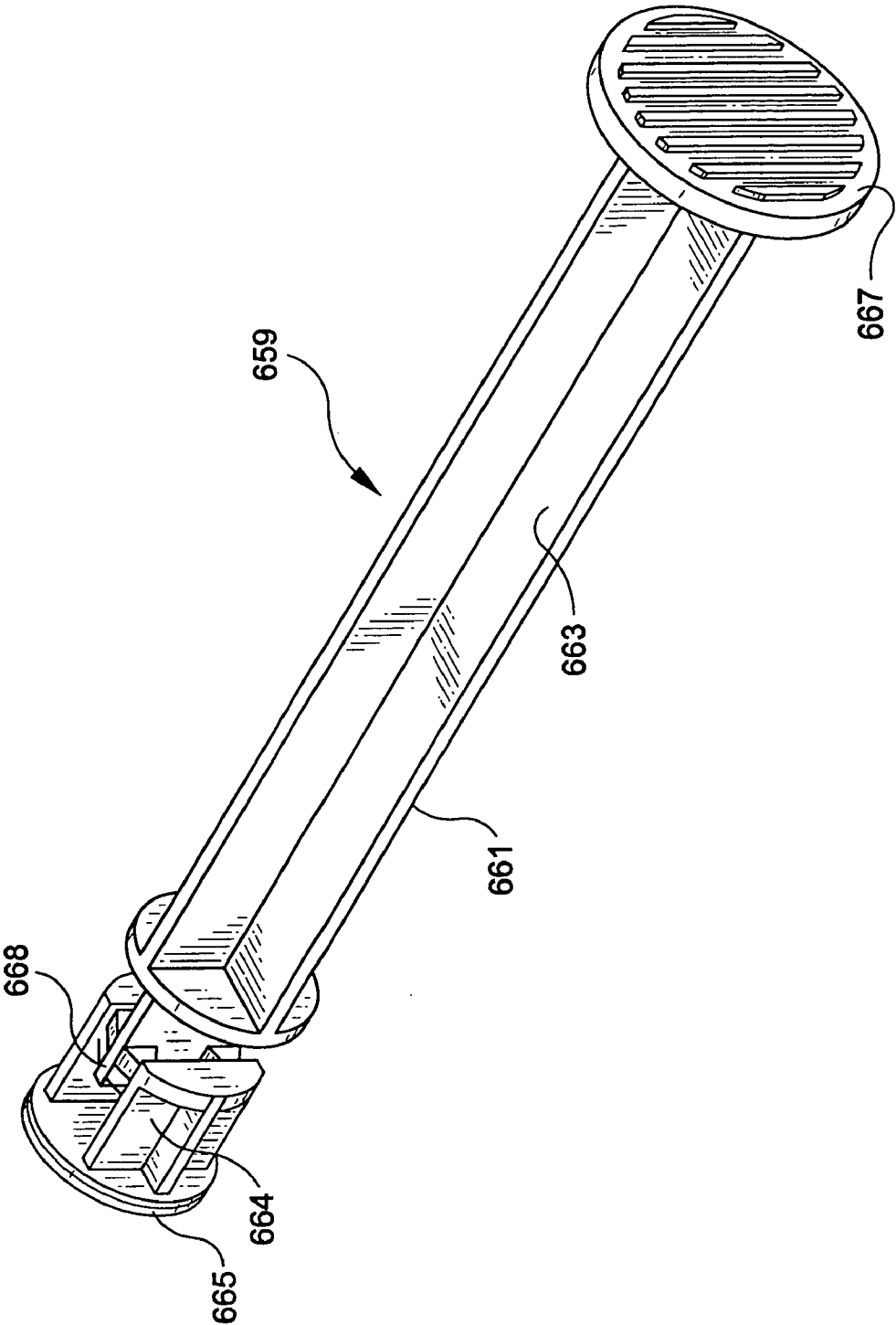

FIG-18

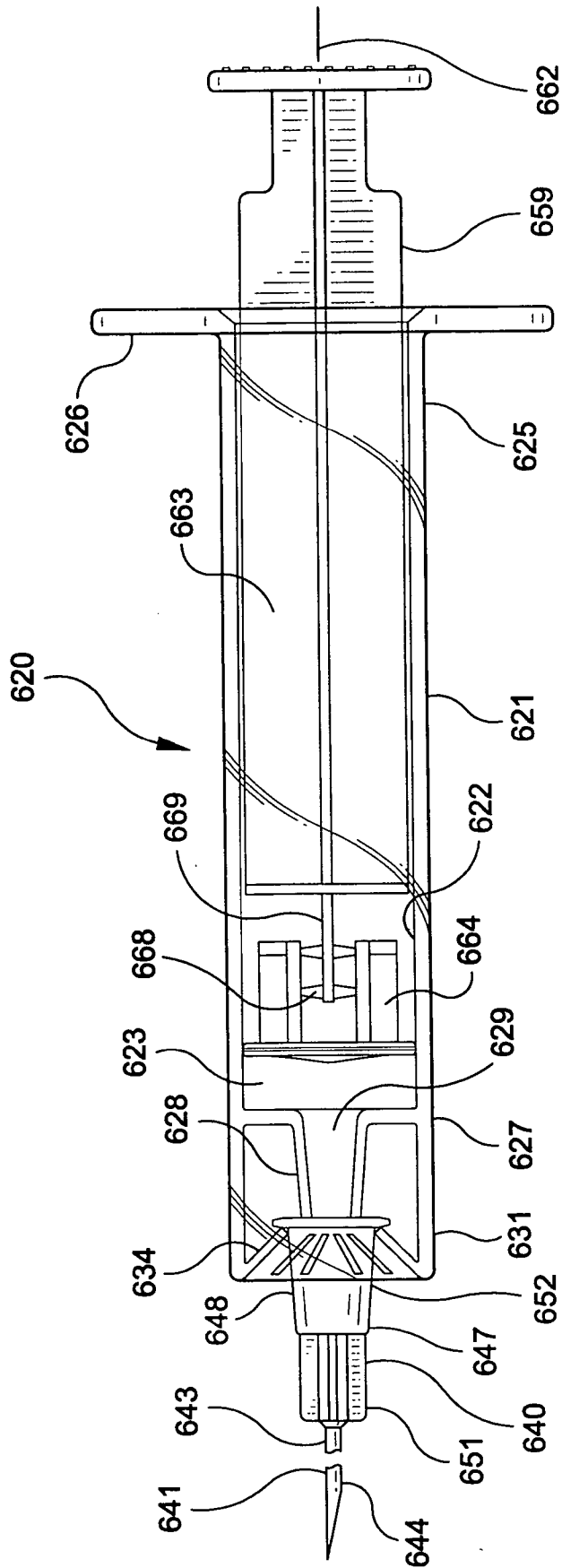

FIG-19

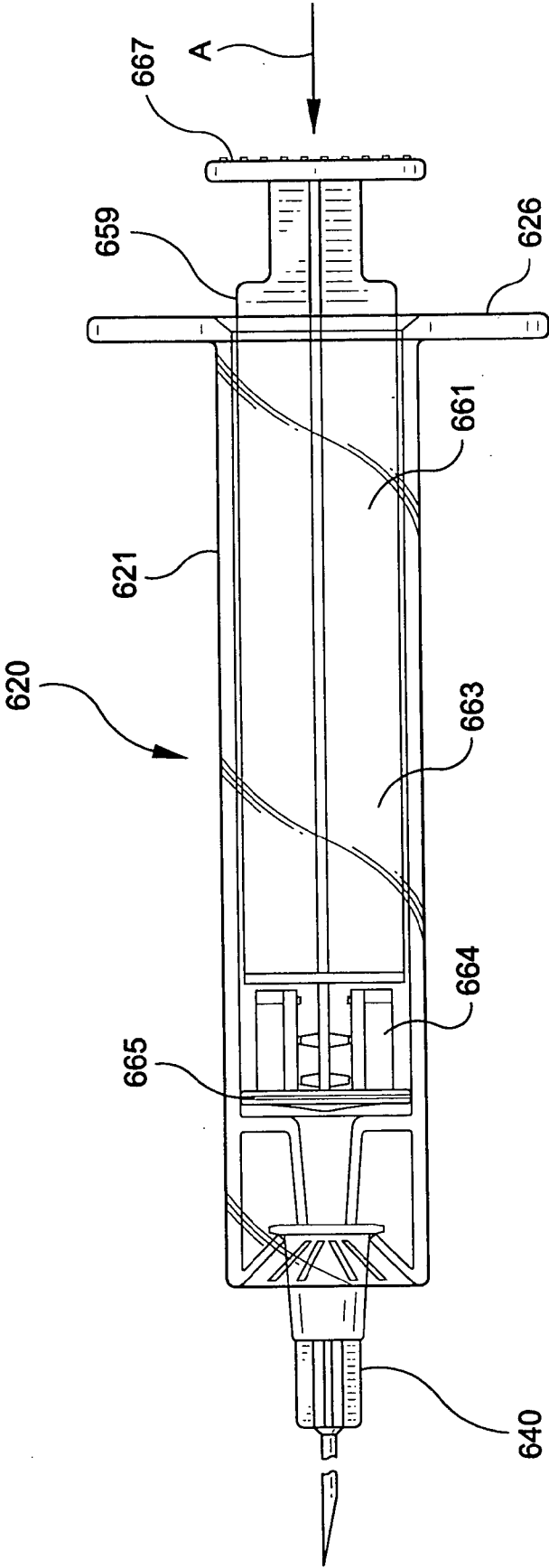
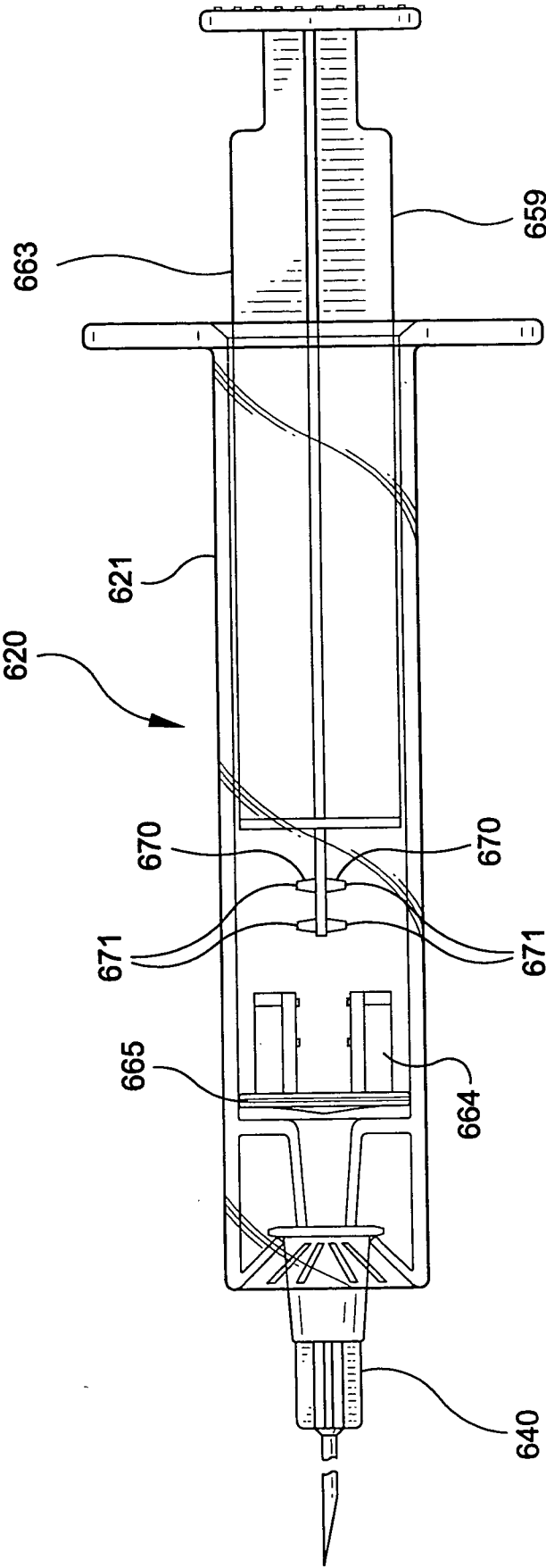

FIG-20



## SINGLE-USE SYRINGE

### CROSS-REFERENCE TO RELATED APPLICATIONS

[0001] This patent application is a continuation-in-part of U.S. patent application Ser. No. 09/249,431 filed on Feb. 12, 1999 which is a continuation-in-part of U.S. patent application Ser. No. 09/124,447 filed on Jul. 29, 1998.

### FIELD OF THE INVENTION

[0002] The present invention relates to a syringe having a breakable plunger rod to prevent further use of the syringe after fluid delivery or injection. The present invention also relates to fluid transfer devices having improved needle attaching features and in particular, structure to help prevent the removal of a hypodermic needle assembly from a fluid transfer device such as a hypodermic syringe.

### BACKGROUND

[0003] Throughout the world the re-use of hypodermic syringe products which are intended for single-use only is instrumental in drug abuse and in the transfer of contagious diseases. Intravenous drug users who routinely share and re-use syringes are a high-risk group with respect to the AIDS virus. Also, the effects of multiple use are a major concern in some countries where the repeated use of syringe products during mass inoculation programs may be responsible for the spread of many diseases. Syringes are often recycled in developing countries without proper sterilization.

[0004] Many attempts have been made to remedy this problem. Some designs involve the inclusion of structure which will allow the destruction or defeating of the syringe function through a conscious act by the user, such as breaking a syringe or one of its components. In addition, there are single-use hypodermic syringes which become incapable of further use automatically upon delivery of the medication without any additional act on the part of the user. Such syringes are taught in U.S. Pat. No. 4,961,728.

[0005] With single-use syringes using needle assemblies having a hub attached to a needle cannula there is a need to prevent the removal of the needle assembly after the use of the single-use syringe so that the needle assembly cannot be used again with other syringes. In addition to preventing the removal of the needle assembly, there is also a need for structure which will allow the easy attachment of the needle assembly to the syringe so that the needle assembly may be attached at the time of use and an appropriately sized needle may be used.

### SUMMARY OF THE INVENTION

[0006] A fluid transfer device comprises a barrel having a fluid chamber, a proximal end, a distal end and an elongated tip extending from the distal end having a passageway therethrough in fluid communication with the chamber. A collar surrounds the tip. For the purposes of the present invention collar is intended to include not only continuous structures but also discontinuous structures such as a wall with gaps in its structure. At least one deflectable locking tab projects radially inwardly from the collar and is adapted to engage the hub of a needle assembly to prevent the removal of the needle assembly away from the tip. The locking tab

is configured to allow assembly of the needle assembly to the barrel through axial motion of the hub toward the barrel.

[0007] Another embodiment of the present fluid transfer device includes a needle assembly having a cannula with a proximal end, a distal end, and a lumen therethrough. A hub includes an open proximal end with a cavity therein and a distal end is joined to the proximal end of the cannula so that the lumen is in fluid communication with the cavity. The hub includes an outside surface. A barrel having a fluid chamber includes an open proximal end, a distal end and an elongated frusto-conically shaped tip extending from the distal end having a passageway therethrough in fluid communication with the chamber. A collar surrounding the tip includes a plurality of deflectable locking tabs projecting radially and proximally inwardly from the collar defining an inner aperture surrounding the tip. The tip extends distally beyond the aperture defined by the locking tabs. The needle assembly is connected to the barrel so that the elongated tip of the barrel is in the cavity of the hub and the outside surface of the hub is adjacent to the inner aperture defined by the locking tabs so that the locking tabs prevent removal of the needle assembly from the barrel through contact between the locking tabs and the outside surface of the hub.

[0008] Another embodiment of the present fluid transfer device includes means on the hub between the distal end of the hub and the proximal end of the hub for allowing the hub to break upon application of a bending force to the hub. Such means includes a fracturable section between the proximal end and the distal end of the hub such as an annular discontinuity on the outside surface of the hub or an annular discontinuity in the cavity of the hub. The fracturable section is provided to prevent removal of the needle assembly from the fluid transfer device by allowing the hub to break if an excessive bending force is applied to the hub.

[0009] Another embodiment of the present invention includes a plunger having an elongated plunger rod, a proximal portion and a distal portion. The distal portion includes a stopper slidably positioned in fluid-tight engagement with an inside surface of the barrel for drawing fluid into and out of the barrel by movement of the plunger relative to the barrel. The plunger further includes means for allowing the connection between the proximal portion of the plunger rod and the distal portion of the plunger rod to break upon application of additional force to the proximal portion.

### BRIEF DESCRIPTION OF THE DRAWINGS

[0010] FIG. 1 is a perspective view of a fluid transfer device of the present invention with a needle assembly attached;

[0011] FIG. 2 is an exploded prospective view of the fluid transfer device and needle assembly of FIG. 1;

[0012] FIG. 3 is an enlarged cross-sectional view of the fluid transfer device of FIG. 2 taken along line 3-3;

[0013] FIG. 4 is a side-elevational view of the left side of the fluid transfer device of FIG. 2;

[0014] FIG. 5 is an enlarged partial cross-sectional view of the needle assembly and fluid transfer device of FIG. 1 taken along line 5-5;

[0015] FIG. 6 is a perspective view of the needle assembly of FIG. 2;

[0016] FIG. 7 is an alternative needle assembly, similar to the needle assembly of FIG. 6;

[0017] FIG. 8 is an enlarged partial cross-sectional view of an alternative fluid transfer device of the present invention;

[0018] FIG. 9 is an enlarged cross-sectional view of another alternative embodiment of the present invention;

[0019] FIG. 10 is an enlarged side-elevational view of an alternative embodiment of the present invention including a flexible tube;

[0020] FIG. 11 is an enlarged cross-sectional view of the fluid transfer device of FIG. 10 taken along line 11-11;

[0021] FIG. 12 is an enlarged cross-sectional view illustrating the barrel of the fluid transfer device of FIG. 2 during the manufacturing process;

[0022] FIG. 13 is a side elevational view of an alternative embodiment of the fluid transfer device of the present invention;

[0023] FIG. 14 is an enlarged cross-sectional view of the fluid transfer device of FIG. 13 taken along line 14-14;

[0024] FIG. 15 is a side-elevational view of the fluid transfer device of FIG. 13 illustrating the hub breaking upon application of a bending force;

[0025] FIG. 16 is an enlarged cross-sectional view of another alternative fluid transfer device;

[0026] FIG. 17 is a perspective view of the plunger of an alternative embodiment of the present invention;

[0027] FIG. 18 is a side elevation view of a syringe assembly using the plunger of FIG. 17;

[0028] FIG. 19 is a side elevational view of the syringe of FIG. 18 illustrated with a force being applied to break the connection to the proximal and distal ends of the plunger rod; and

[0029] FIG. 20 is a side elevational view of the syringe of FIG. 19 illustrating the separated proximal and distal ends of the plunger rod.

#### DETAILED DESCRIPTION

[0030] While this invention is satisfied by embodiments in many different forms, there is shown in the drawings and will herein be described in detail preferred embodiments of the invention with the understanding that the present disclosure is to be considered as exemplary of the principles of the invention and is not intended to limit the invention to the embodiments illustrated. The scope of the invention will be measured by the appended claims and their equivalents.

[0031] Adverting to FIGS. 1-7 a fluid transfer device such as syringe 20 includes a barrel 21 having a barrel inside surface 22, a fluid chamber 23, a proximal end 25, a distal end 27 and an elongated tip 28 extending from the distal end having a passageway 29 therethrough in fluid communication with the chamber. In this embodiment the elongated tip is preferably frusto-conically shaped.

[0032] Barrel 21 further includes a collar 31 having an inside surface 32 and at least one deflectable locking tab projecting radially inwardly from the collar. The collar

preferably but not necessarily surrounds the tip. In this preferred embodiment, there are a plurality of locking tabs 34 projecting radially and proximally inwardly from the inside surface. In this preferred embodiment a distal end 30 of elongated tip 28 extends distally beyond distal end 33 of the collar. It is preferable that the collar and the locking tabs are integrally formed of a single material preferably a metal such as stainless steel or a plastic material such as polypropylene. Also, the collar can be made of thermoplastic material and the locking tabs of metal, such as stainless steel attached to the collar.

[0033] The fluid transfer device of the present invention is intended to be used with a needle assembly 40 including a cannula 41 having a proximal end 43 a distal end 44 and a lumen 45 therethrough. The needle assembly also includes a hub 47 having an open proximal end 49 with a cavity 50 therein, and a distal end 51 joined to proximal end 43 of cannula 41 so that lumen 45 is in fluid communication with cavity 50. Hub 47 also includes outside surface 52. The hub in this embodiment preferably, but not necessarily, includes at least one projection extending radially outwardly from outside surface 52 of the hub. This embodiment includes two projections 53. It is within the purview of the present invention to include needle assemblies having one-piece construction wherein the cannula and the hub are formed of one piece.

[0034] Some prior art syringe barrels include a collar around the distal tip having a thread on the inside surface of the collar. This configuration is often referred to as a locking luer collar. A needle assembly having a hub with outwardly extending projections is placed on the distal end of the syringe by aligning the distal tip of the syringe with a cavity in the hub and moving the needle assembly toward the syringe so that the outward projections of the hub engage the thread. The needle assembly is then rotated or screwed into the locking luer collar so that the needle assembly is held tightly on the distal tip of the syringe barrel through interaction of the locking luer collar thread and the projections on the hub. This is an excellent structure for most applications since it allows for applying the appropriate sized needle assembly at the time of use and for changing needle assemblies during a procedure which may require two or more different sizes. However, for many applications it is not desirable to have structure which provides for the easy removal of the needle assembly. For example, in mass inoculation programs using single-use syringes, a needle assembly which is not removable compliments the syringe assembly which is not reusable. Although most healthcare institutions have procedures for disposal of used fluid transfer devices, an unscrupulous healthcare worker can, if the structure allows, remove the relatively small hypodermic needle assembly before disposing of the larger syringe assembly catheter or I.V. set.

[0035] The present invention provides structure to prevent removal of the needle assembly during normal use of the fluid transfer device. In particular, the locking tab projecting radially inwardly from the inside surface of the collar is adapted to engage the outside surface of the hub of the needle-assembly to prevent removal of the needle assembly away from the tip of the barrel. The locking tab is configured to allow assembly of needle assembly to the syringe barrel through axial motion of the hub toward the barrel. In use, the needle assembly is connected to the barrel by moving the

needle assembly toward the barrel so that elongated tip **28** of the barrel is in cavity **50** of the hub and outside surface **52** of the hub is adjacent to locking tabs **34** so that the locking tab prevents removal of the needle assembly from the barrel through contact of the locking tabs with the outside surface of the hub. Accordingly, the force for removal of the needle assembly from the syringe is much higher than the force for installation of the needle assembly to the barrel. This is an important feature of the present invention.

[0036] Although only one locking tab is required for the present invention, the preferred embodiment illustrated herein includes a plurality of locking tabs **34** which are deflected by the proximal end and/or the outside surface of the hub when the needle assembly is installed onto the barrel. Tabs **34** are separated by gaps **35** to allow them to flex more freely and provide for lower forces when attaching the needle assembly to the barrel. The locking tabs include distal ends **37** which in this preferred embodiment describe a opening **39** which is preferably circularly shaped and smaller than the outside surface of the hub and/or the width described by projections **53** so that the locking tabs deflect when the needle assembly is installed onto the barrel. Because the locking tabs are facing radially and proximally inwardly after needle attachment they are very resistant to flexing outwardly to allow the removal of the needle assembly, as best illustrated in **FIG. 5**. Some portion of the outside surface of the hub preferably describes a dimension which is larger than the opening **39** described by the distal ends **37** of the locking tabs so that an attempt to remove the needle assembly there will not be enough space for the tabs to move towards a position which is perpendicular to the longitudinal axis of the barrel.

[0037] In this preferred embodiment, the needle assembly includes projections **53** projecting outwardly from the outside surface of the hub to help prevent removal of the needle assembly from the barrel through contact between the locking tabs and the projections. The present invention can accomplish its purpose without the radial projection or projections on the hub however the projection or projections provide a stronger attachment of the needle assembly to the barrel and allow for more liberal tolerances for the locking tab dimensions.

[0038] An alternate needle assembly **140** is illustrated in **FIG. 7**. This needle assembly is similar to the needle assembly **40** and includes cannula **141** and hub **147**. Hub **147** includes one projection **153** extending 360° around the hub. This structure is especially desirable if only one or two locking tabs are used so that it is not necessary to align the projection on the needle hub with the locking tabs since the projection on the hub will always be positioned so that it can contact a locking tab.

[0039] The syringe of the present embodiment further comprises a plunger **59** including a plunger rod **61** having an elongated body portion **62** having a proximal end **63**, a distal end **64** and a stopper **65** at the distal end. The stopper is slidably positioned in fluid-tight engagement with the barrel inside surface. The plunger rod extends outwardly from proximal end **25** of the barrel. The plunger rod is accessible outside of proximal end **25** of the barrel and is provided to move the stopper along the barrel to force fluid into and out of chamber **23** through passageway **29**. Disc-shaped plunger rod flange **67** is provided as a convenient structure for

applying forces to move the plunger rod with respect to barrel **21**. A flange **26** is also provided at the proximal end of the barrel to facilitate handling and for maintaining the relative position of the barrel with respect to the plunger rod during fluid transfer using known procedures.

[0040] It is within the purview of the present invention to include plunger rods and stoppers which are separately formed or integrally formed of the same material or different materials such as in two-color molding, or separately formed of the same or different materials and joined together by mechanical means, adhesives, ultrasonic welding, heat sealing or other suitable means. It is understood that the plunger of the present embodiment merely illustrates these many possibilities.

[0041] **FIG. 8** illustrates an alternative embodiment of the present invention. This embodiment is structurally and functionally similar to the embodiment of **FIGS. 1-7**. In this embodiment, barrel **121** having a chamber **123**, a distal end **127** and an elongated, frusto-conically shaped tip **128** extending from the distal end and having a passageway **129** in fluid communication with the chamber. A collar **131** preferably surrounds the tip. A plurality of deflectable locking tabs **134** project radially and proximally inward from the collar and toward the tip. Distal ends **137** of the locking tabs define an opening for allowing attachment of a needle assembly to the barrel. In this embodiment, distal end **130** of tip **128** does not extend beyond distal end **133** of the collar as it does in the preferred embodiment of **FIGS. 1-7**. Having the distal end of the tip extend beyond the distal end of the collar is preferred because it is easier to see the tip of the barrel and to align the barrel tip with the hub cavity for attachment of the needle assembly to the barrel. However, this structure is preferred and not necessary to carry out the present invention. A shorter tip may be desired for various reasons including reducing the amount of material in the barrel.

[0042] **FIG. 9** illustrates another alternative embodiment of the present invention. This embodiment is similar to the embodiment of **FIGS. 1-7**. In this alternative embodiment, barrel **221** includes an elongated tip **228** extending from distal end **227** of the barrel and having a passageway **229** therethrough in fluid communication with a chamber **223**. A collar **231** surrounds the tip. A mounting element **224** is attached to the collar. The mounting element includes at least one locking tab, and in this embodiment, a plurality of locking tabs **234**. In this embodiment it is preferred that mounting element **224** and locking tabs **234** are integrally formed of the same material selected from the group of plastic and metal with stainless steel being preferred. The mounting element allows for molding the barrel with a straight collar after which the mounting element can be attached to the distal end of the collar. In this embodiment, deflectable locking tabs are projecting radially inwardly. They are configured so that when the needle assembly is attached to the barrel the hub will force the locking tabs to project radially inwardly and proximally inwardly in an orientation similar to the locking tabs of **FIGS. 3 and 8** to prevent the removal of the needle assembly away from the tip after attachment. In this embodiment the locking tabs can also be positioned to project radially inwardly and proximally before the installation of the needle assembly as with the locking tabs of **FIGS. 3 and 8**. The mounting element can be attached to the collar through various means such as

adhesive, welding and/or mechanical means such as press fitting or having locking tabs in the mounting element which allow it to be pressed onto the collar but not removed.

[0043] FIGS. 10 and 11 illustrate another alternative embodiment of the present invention. This embodiment is illustrated with needle assembly 40 which is identical to the needle assembly of FIG. 6. In this embodiment, fluid transfer device 320 includes a barrel 321 having a chamber 323 and an elongated tip 328 extending from distal end 327 of the barrel and having a passageway 329 therethrough in fluid communication with the chamber. A collar 331 preferably surrounds the tip and includes a plurality of deflectable locking tabs 334 projecting radially and proximally inwardly from said collar. A flexible tube 370 having a proximal end, a distal end 371 and a bore 373 therethrough. The distal end of flexible tube 370 is connected to barrel 321 so that bore 373 is in fluid communication with said passageway. Tube 370 can be a catheter or it can be part of an I.V. fluid administration set or various other fluid transfer devices.

[0044] One method of manufacturing barrel 21 of the present invention is to injection mold the barrel out of thermoplastic material so that deflectable locking tabs 34 are projecting radially and distally inwardly from collar 31 as illustrated in FIG. 12. This configuration allows for easy removal of the barrel from the injection mold. After molding, locking tabs 34 are bent inwardly using force or heat or a combination thereof so that the locking tabs assume a radially and proximally inwardly directed orientation as illustrated in FIG. 3.

[0045] FIGS. 13-15 illustrate another alternative embodiment of the fluid transfer device of the present invention. This embodiment is similar to the embodiment of FIGS. 1-7. In this embodiment, fluid transfer device 420 includes a barrel 421 having an elongated tip 428 extending from distal end 427 of the barrel and having a passageway 429 therethrough. A collar 431 preferably surrounds the tip and includes a plurality of deflectable locking tabs 434 projecting radially and proximally inwardly from the collar.

[0046] A needle assembly 440 includes a cannula 441 having a proximal end 443, a distal end 444 and a lumen therethrough. The needle assembly also includes a hub 447 having an open proximal end 449 with a cavity 450 therein, and a distal end 451 joined to the proximal end 443 of the cannula so that the lumen is in fluid communication with the cavity. Hub 447 also includes outside surface 452. The hub in this embodiment preferably, but not necessarily, includes projections 453 extending radially outwardly from the outside surface of the hub.

[0047] A needle shield 480 includes an open proximal end 481, a distal end 482 and a side wall 483 therebetween defining a cavity 484 in the shield. The cavity includes inside surface 485. The shield is removably connected to hub 447 so that distal end 444 of the cannula is contained within cavity 484 of the shield. The removable connection between the shield and the hub is preferably achieved by frictional engagement between inside surface 485 of the shield and outside surface 452 of the hub. There are numerous ways for removably connecting a shield to a hub including a snap-fit arrangement or threaded engagement with the frictional engagement described herein being merely representative of these many possibilities, all of which are within the purview

of the present invention. The needle shield is provided to protect the cannula from damage or contamination.

[0048] In this embodiment, hub 447 further includes means on the hub between the distal end and the proximal end of the hub for allowing the hub to break upon application of bending force to the hub. In this embodiment, the means for allowing the hub to break includes a fracturable section in the form of annular discontinuity 454 on outside surface 452 of the hub which creates a fracturable section which will cause the hub to break upon application of force F illustrated in FIG. 15. As indicated hereinabove, the fluid transfer device of the present invention provides structure to prevent removal of the needle assembly in the form of one or more locking tabs projecting radially inwardly from the inside surface of the collar which are adapted to engage the outside surface of the hub of the needle assembly. This structure is provided to prevent the improper and undesirable removal of the needle assembly from the barrel. However, an unscrupulous healthcare worker may attempt to apply excessive force to remove the needle assembly by grasping the needle shield and applying a bending force which is generally perpendicular to the longitudinal axis of the cannula in an attempt to cause the hub to overcome the resisting force of the deflectable locking tabs. Since substantial force can be applied it is desirable to have a means on the hub for allowing the hub to break upon the application of a force to the hub which is in excess of the hub forces normally encountered during the known and proper use of the fluid transfer device. In this embodiment, a fracturable section is provided in the form of annular discontinuity 454 on the outside surface of the hub. When force F, illustrated in FIG. 15 is applied the hub will break, preferably in the area of annular discontinuity 454. The discontinuity can, as does in this case, produce an area of reduced cross section in the hub so that this area is the weakest portion of the hub. The discontinuity can also be in the shape of a sharp edge or edges which produce a stress concentration when the hub is subject to bending. In this situation, the result may be obtained without reducing the cross-sectional area significantly or at all. The design would rely on the stress concentration to promote breaking just as scoring of a medication tablet will allow the tablet to break in half along the score line. In this embodiment, sharp annular edge 455 is also provided to promote a stress concentration in the area where the hub is intended to break. Breaking in the area of the fracturable section will cause the cannula to be safely trapped within the needle shield and the needle assembly to be rendered non-reusable. Also, the presence of the proximal end of the hub on the fluid transfer device prevents the addition of a new needle assembly to the device which could allow the undesirable second use of the fluid transfer device. The discontinuity may be on the outside surface of the hub or in the cavity of the hub.

[0049] Also, means for allowing the hub to break can be achieved through the use of a brittle material in the entire hub, or in the desired breaking area so that bending force will fracture the hub in the area of the brittle material. This result can be achieved using two-part or multi-part molding wherein, for example, the proximal end of the hub is molded of a resilient plastic and the breaking area and the distal end of the hub is molded of a brittle plastic so that the hub will tend to break close to the intersection of the two different plastics where the largest bending moment on the brittle plastic would be experienced. Since many plastics can be



formulated to exhibit a wide variety of properties from very ductile to very brittle, the choice of a hub material is quite broad. When using two-part molding, the plastics should be chosen for their properties and for their compatibility with each other at the intersection of the two plastic materials in the hub. Polypropylene, polyethylene, styrene and polycarbonate are preferred plastic materials for the hub. Styrene and polycarbonate can be formulated to be very brittle and/or sensitive to surface discontinuities and can be used for the entire hub for the part of the hub where the fracture is desired. All of the above-described materials and structures are within the purview of the present invention.

[0050] It is an important feature of the present embodiment that it provides two means for preventing the unwanted removal of the needle assembly from the fluid transfer device. The first is the resisting action of the deflectable locking tab or tabs against the outside surface of the hub and the second is the fracturable section of the hub which will cause the hub to break upon the application of excessive force used in an attempt to overcome the action of the deflectable locking tabs.

[0051] FIG. 16 illustrates another alternate embodiment of the fluid delivery device of the present invention. In this embodiment, needle assembly 540 includes a cannula 541 and a hub 547. The hub includes open proximal end 549 with a cavity 550 therein and a distal end 551. Needle assembly 540 further includes a fracturable section between the proximal end and the distal end of the hub for allowing the hub to break upon application of a bending force to the hub. In this embodiment, the fracturable section includes an annular discontinuity 554 in cavity 550. Annular discontinuity 554 also preferably includes sharp annular stress concentrating edge 555 to help promote breakage in the area of the discontinuity. This embodiment, like the embodiment of FIGS. 13-15 provides two-step protection against the undesirable removal of the needle assembly from the fluid transfer device. The first protection is offered by the interaction of flexible locking tabs 534 to hold the hub in its position on projection 553. The second protection is the fracturable section for allowing the hub to break upon the application of bending forces on the hub in excess of those experienced during normal proper use of the fluid transfer device.

[0052] FIGS. 17-20 illustrate another alternative embodiment of the present invention. In this embodiment the fluid delivery device is syringe 620 comprising barrel 621 having a fluid chamber 623, a proximal end 625, a distal end 627 and an elongated tip 628 extending from the distal end and having a passageway 629 therethrough in fluid communication with the chamber. A collar 631 surrounds the tip. At least one deflectable locking tab projects radially inwardly from the collar. In this embodiment, there are a preferably a plurality of locking tabs 634.

[0053] A needle assembly 640 includes a cannula 641 having a proximal end 643, a distal end 644 and a lumen therethrough. A hub 647 includes an open proximal end 649 with a cavity therein, and a distal end 651 joined to the proximal end of the cannula so that the lumen is in fluid communication with the cavity of the hub. The hub further includes an outside surface 652. The needle assembly is connected to the barrel so that the elongated tip of the barrel is in the cavity of the hub and the outside surface of the hub

is adjacent to the one or more locking tabs so that the locking tabs prevent removal of the needle assembly from the barrel through contact between the locking tab and the outside surface of the hub. Locking tabs are configured to allow the assembly of the needle assembly to the barrel through axial motion of the hub toward the barrel.

[0054] A plunger 659 includes an elongated plunger rod 661 having a longitudinal axis 662, a proximal portion 663 and a distal portion 664 connected by a breakable connection 668. Distal portion 664 includes a stopper 665 slidably positioned in fluid-tight engagement with an inside surface 622 of the chamber for drawing fluid in and out of the chamber by movement of the plunger relative to the barrel. Stopper 665 may be a separate element connected to distal portion 664 or it may be integrally molded with the distal portion in a one-piece plastic construction. Separate stoppers are preferably made of elastomeric material such as natural rubber, synthetic rubber, thermoplastic elastomers and combinations thereof. Breakable connection 668 is strong enough to hold proximal portion 663 and distal portion 664 together during normal use of the syringe and is breakable upon application of additional force to the proximal portion.

[0055] Proximal end 663 further includes a flange 667 for applying forces to move the plunger rod with respect to the barrel and for breaking the breakable connection. A flange 626 is also provided at the proximal end of the barrel to facilitate handling of the syringe and for applying forces to the plunger using a one-handed procedure as will be explained in more detail hereinafter.

[0056] In this embodiment, there are a plurality of breakable connections connecting proximal portion 663 and distal portion 664. Specifically, proximal portion 663 includes a distal projection 669 having at least one transverse protuberance projecting therefrom. In this preferred embodiment, there are four transverse protuberances 670. The protuberances are connected to distal portion 664 and the breakable connection is on the protuberance. In this preferred embodiment breakable connection 671 is on the distal end of the protuberance. The distal projection may be circularly shaped and fit into a cylindrically shaped recess in the distal portion. With this structure a single protuberance extending up to 360 degrees may be used. The structure may also be reversed so that the projection extends proximally from the distal portion toward the proximal portion.

[0057] In this preferred embodiment, proximal portion 663 and distal portion 664 and the breakable connections are integrally molded of plastic material. A wide variety of plastic materials are suitable for molding the plunger with polystyrene and polyethylene being preferred.

[0058] The breakable connections can be anywhere along the protuberance, at its proximal end, its distal end, or in between, depending on, among other things, the geometry of the protuberance. A breakable connection can also be made by connecting the protuberance to the distal end or to the proximal end using a frangible adhesive. The protuberance may be very short and made entirely of adhesive or frangible material. The connection can also be made using a shear pin passing through the distal projection 669 and distal portion 664. The shear pin may be made of plastic with one or more notches or stress risers suitably placed to cause breaking at the desired force levels. The breakable connection between the proximal portion and the distal portion may also be

accomplished by using a snap-fit arrangement a portion of which is damaged or broken when the desired force is applied. In this latter situation, the distal portion and the proximal portion can be individually molded and snapped together during the assembly process.

**[0059]** In use, the syringe of this embodiment can be filled from a vial, ampoule or other suitable container using known safe procedures. An important advantage of the present embodiment is that the plunger can be moved back and forth along the barrel as many times as necessary to properly fill the syringe barrel. For example, the syringe barrel may be filled with sterile water and then the sterile water can be injected into a vial containing a lyophilized medication which is then drawn back into the syringe barrel. Many single-use syringes in the prior art only allow one proximal motion of the plunger with respect to the barrel. With these single-use syringes, once the plunger is moved in a distal direction with respect to the barrel it can no longer be withdrawn. Therefore, mixing sterile water and a lyophilized medication as described above is not possible.

**[0060]** Another advantage of the present embodiment is that the plunger can be moved to its distal-most position with respect to the barrel and then moved proximally. Some prior art single use syringes automatically lock the plunger to the barrel when the plunger is moved to its distal-most position. These prior art designs can lead to unintentional locking of the plunger before use and can compromise filling and mixing procedures.

**[0061]** The liquid in the barrel can now be injected into a patient or delivered in another suitable manner such as through the pierceable septum of a catheter connector. Upon completion of the injection the user can apply an additional force indicated as A in **FIG. 19**, to the proximal portion. In this embodiment the breakable connections are broken by the application of a distally directed force A applied to the proximal end of the proximal portion along longitudinal axis 662. Force A is sufficient to break the breakable connections which causes the plunger rod to separate into two or more unusable pieces. In this enablement the proximal portion and the distal portion are separated as illustrated in **FIG. 20**.

**[0062]** An important advantage of the present invention is that the breakable connection can be broken using any one-handed technique, for example, pressing on plunger rod flange 667 in direction A with the thumb of one hand while holding the syringe barrel and/or the syringe barrel flange with some or all of the remaining fingers. This is desirable over a two-handed technique wherein the barrel must be held by one hand and the plunger by another to carry out a breaking manipulation such as bending or twisting.

**[0063]** The embodiment of **FIGS. 17-20** is a significant advance over single-use syringes of the prior art. In particular, it allows multiple strokes of the plunger with respect to the barrel without automatically locking and rendering the syringe unusable. This design also allows the plunger to move to its distal-most position inside the barrel without automatically locking the plunger to the barrel. It also provides two mechanisms to prevent or discourage re-use. First, the needle assembly is securely locked in place so that it cannot be removed from the barrel for improper re-use. Second, the plunger is breakable so that its proximal and distal ends are separated and the syringe, with the needle locked in place, can no longer be used to inject medication.

Further, the plunger breaking feature is accomplished by a simple one-handed procedure.

What is claimed is

1. A syringe comprising:

a barrel having a fluid chamber, a proximal end, a distal end and an elongated tip extending from said distal end having a passageway therethrough in fluid communication with said chamber, a collar surrounding said tip, and at least one deflectable locking tab projecting radially inwardly from said collar

a needle assembly including a cannula having a proximal end, a distal end and a lumen therethrough, a hub having an open proximal end with a cavity therein, and a distal end joined to said proximal end of said cannula so that said lumen is in fluid communication with said cavity, an outside surface of said hub, said needle assembly being connected to said barrel so that said elongated tip of said barrel is in said cavity of said hub and said outside surface on said hub is adjacent to said locking tab so that said locking tab prevents removal of said needle assembly from said barrel through contact between said locking tab and said outside surface of said hub, said locking tab being configured to allow assembly of the needle assembly to said barrel through axial motion of the hub toward the barrel; and

a plunger including an elongated plunger rod having a longitudinal axis, a proximal portion and a distal portion connected by a breakable connection, said distal portion including a stopper slidably positioned in fluid-tight engagement with an inside surface of said chamber for drawing fluid into and out of said chamber by movement of said plunger relative to said barrel, said breakable connection being strong enough to hold said proximal portion and said distal portion together during normal use of said syringe and breakable upon application of an additional force to said proximal portion.

2. The syringe of claim 1 wherein one of said proximal portion and said distal portion includes an axial projection having a plurality of transverse protuberances projecting therefrom, said protuberances being connected to the other of said proximal portion and said distal portion, said breakable connection being on said protuberances.

3. The syringe of claim 1 wherein the at least one deflectable locking tab comprises a plurality of locking tabs.

4. The syringe of claim 3 wherein the tabs are cantilevered members extending radially inward and proximally from the collar.

5. The syringe of claim 1 further comprising means on the hub between the distal end and the proximal end of the hub for allowing the hub to break upon application of bending force to the hub.

6. A syringe comprising:

a barrel having a fluid chamber, a proximal end, a distal end and an elongated tip extending from said distal end having a passageway therethrough in fluid communication with said chamber, a collar surrounding said tip, and at least one deflectable locking tab projecting radially inwardly from said collar

a needle assembly including a cannula having a proximal end, a distal end and a lumen therethrough, a hub having an open proximal end with a cavity therein, and

a distal end joined to said proximal end of said cannula so that said lumen is in fluid communication with said cavity, an outside surface of said hub, a fracturable section between said proximal end and said distal end of said hub for allowing said hub to break upon application of a bending force to said hub, said needle assembly being connected to said barrel so that said elongated tip of said barrel is in said cavity of said hub and said outside surface on said hub is adjacent to said locking tab so that said locking tab prevents removal of said needle assembly from said barrel through contact between said locking tab with said outside surface of said hub, said locking tab being configured to allow assembly of the need assembly to said barrel through axial motion of the hub toward the barrel; and

- a plunger including an elongated plunger rod having a longitudinal axis, a proximal portion and a distal portion connected by a breakable connection, said distal portion including a

stopper slidably positioned in fluid-tight engagement with an inside surface of said chamber for drawing fluid into and out of said chamber by movement of said plunger relative to said barrel, said breakable connection being strong enough to hold said proximal portion and said distal portion together during normal use of said syringe and breakable upon application of an additional force to said proximal portion so that said proximal portion can be removed from said syringe barrel and said distal portion remains in said barrel.

7. The syringe of claim 6 wherein the at least one deflectable locking tab comprises a plurality of locking tabs and wherein the tabs are cantilevered members extending radially inward and proximally from the collar.

8. The syringe of claim 7 wherein one of said proximal portion and said distal portion includes an axial projection having a plurality of transverse protuberances projecting therefrom, said protuberances being connected to the other of said proximal portion and said distal portion, said breakable connection being on said protuberances.

9. A syringe comprising:

- a barrel having a fluid chamber, a proximal end, a distal end and an elongated tip extending from said distal end having a passageway therethrough in fluid communication with said chamber, and a collar surrounding said tip;

a needle assembly including a cannula having a proximal end, a distal end and a lumen therethrough, a hub having an open proximal end with a cavity therein, and a distal end joined to said proximal end of said cannula so that said lumen is in fluid communication with said cavity, an outside surface of said hub, said needle assembly being connected to said barrel so that said elongated tip of said barrel is in said cavity of said hub and means for preventing removal of said needle assembly from said barrel; and

- a plunger including an elongated plunger rod having a longitudinal axis, a proximal portion and a distal portion connected by a breakable connection, said distal portion including a stopper slidably positioned in fluid-tight engagement with an inside surface of said chamber for drawing fluid into and out of said chamber by movement of said plunger relative to said barrel by exertion of an operation force to the proximal portion of the plunger, said connection being adapted to hold said proximal portion and said distal portion together during operation of the syringe until the stopper is disposed near the distal end of the barrel, and means for allowing said connection to break by application of breaking force to said proximal portion of the plunger while the stopper is disposed near the distal end of the barrel, wherein the breaking force is greater than the operation force.

10. The syringe of claim 9 wherein the means for allowing the connection to break includes a plurality of transverse protuberances projecting from one of said proximal portion and said distal portion, said protuberances being connected to the other of said proximal portion and said distal portion.

11. The syringe of claim 9 wherein the means for preventing removal of said needle assembly from said barrel includes a plurality of cantilevered members extending radially inward and proximally from the collar.

12. The syringe of claim 9 further comprising means on the hub between the distal end and the proximal end of the hub for allowing the hub to break upon application of bending force to the hub.

\* \* \* \* \*