



US00D498181S

(12) **United States Design Patent**
Ratto

(10) **Patent No.:** **US D498,181 S**

(45) **Date of Patent:** **** Nov. 9, 2004**

(54) **TUBULAR FRAME FOR MOTOR PROPELLED BIKE**

(74) *Attorney, Agent, or Firm*—William Michael Hynes; Townsend and Townsend and Crew LLP

(76) Inventor: **Richard Ratto**, 121 Landrum Cir., Folsom, CA (US) 95630

(57) **CLAIM**

(**) Term: **14 Years**

The ornamental design for a tubular frame for motor propelled bike, as shown and described.

(21) Appl. No.: **29/183,380**

DESCRIPTION

(22) Filed: **Jun. 10, 2003**

FIG. 1 is a perspective view of a tubular frame for motor propelled bike showing our new design; FIG. 2 is a side elevational view thereof; FIG. 3 is a side elevational view, the opposite side elevational view being a mirror image thereof; FIG. 4 is a top plan view thereof; FIG. 5 is a bottom plan view thereof; FIG. 6 is a front elevational view thereof; and, FIG. 7 is a rear elevational view thereof.

(51) **LOC (7) Cl.** **12-11**

(52) **U.S. Cl.** **D12/111**

(58) **Field of Search** D12/110, 111, D12/117; 180/219, 220, 311; 280/274, 275, 281.1, 283, 288.1-288.4

The phantom representation illustrated in broken lines of the wheels, handle bars, and driving motor and other accessories of the bike are shown in the drawings merely for the purpose of illustrating the environment in which the frame member of this invention is utilized. The structure shown in broken lines is not part of the design sought to be patented.

(56) **References Cited**

U.S. PATENT DOCUMENTS

D238,419 S * 1/1976 Apodaca D12/111
2003/0132599 A1 * 7/2003 Yu et al. 280/274

* cited by examiner

Primary Examiner—Alan P. Douglas

Assistant Examiner—Linda Brooks

1 Claim, 7 Drawing Sheets

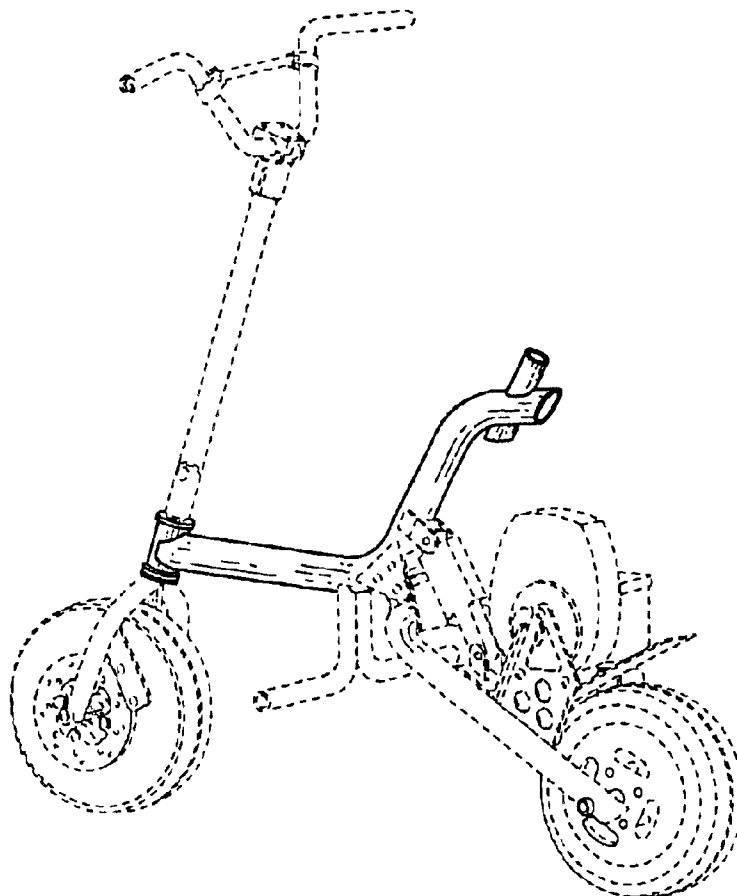

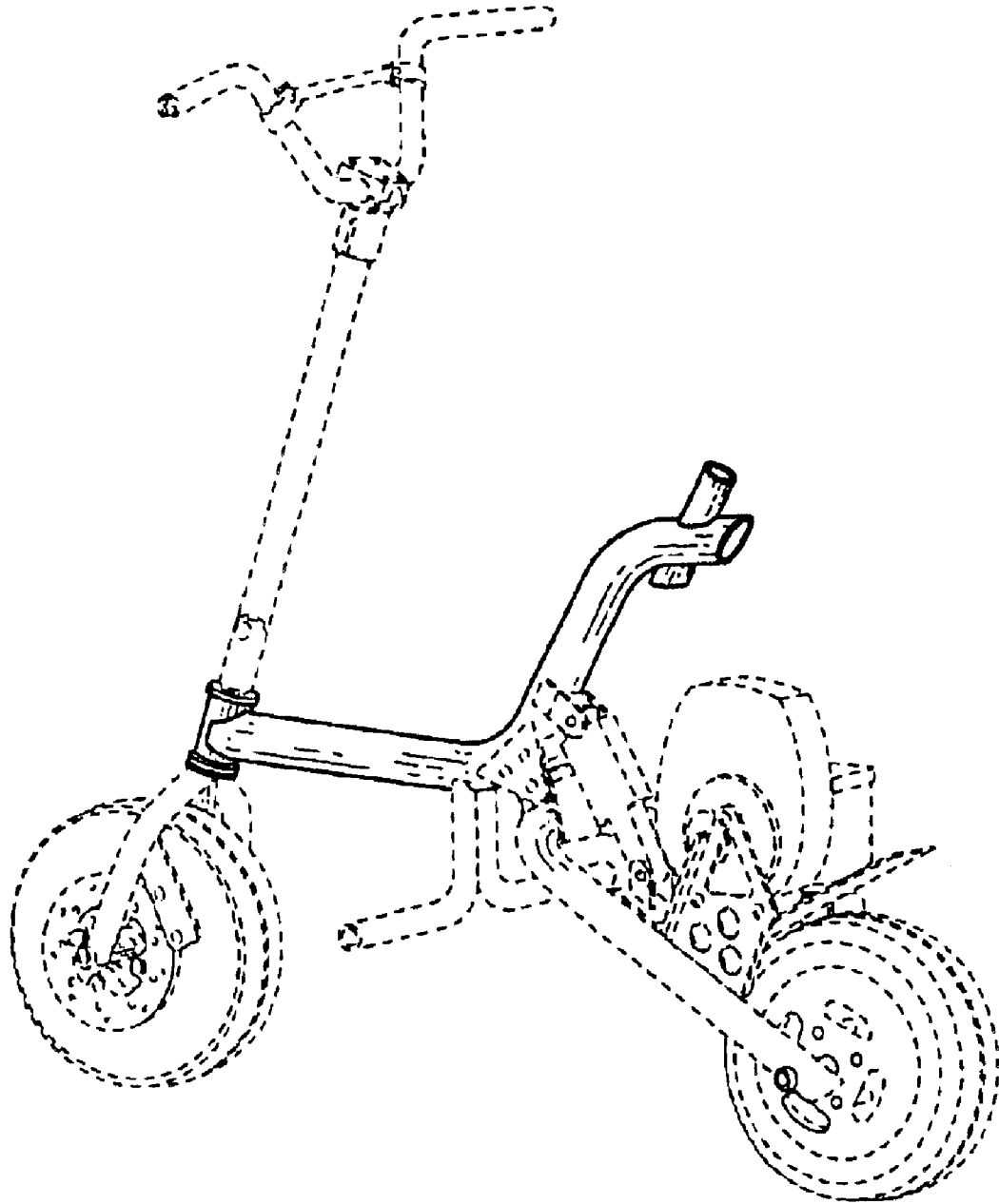

FIG. 1

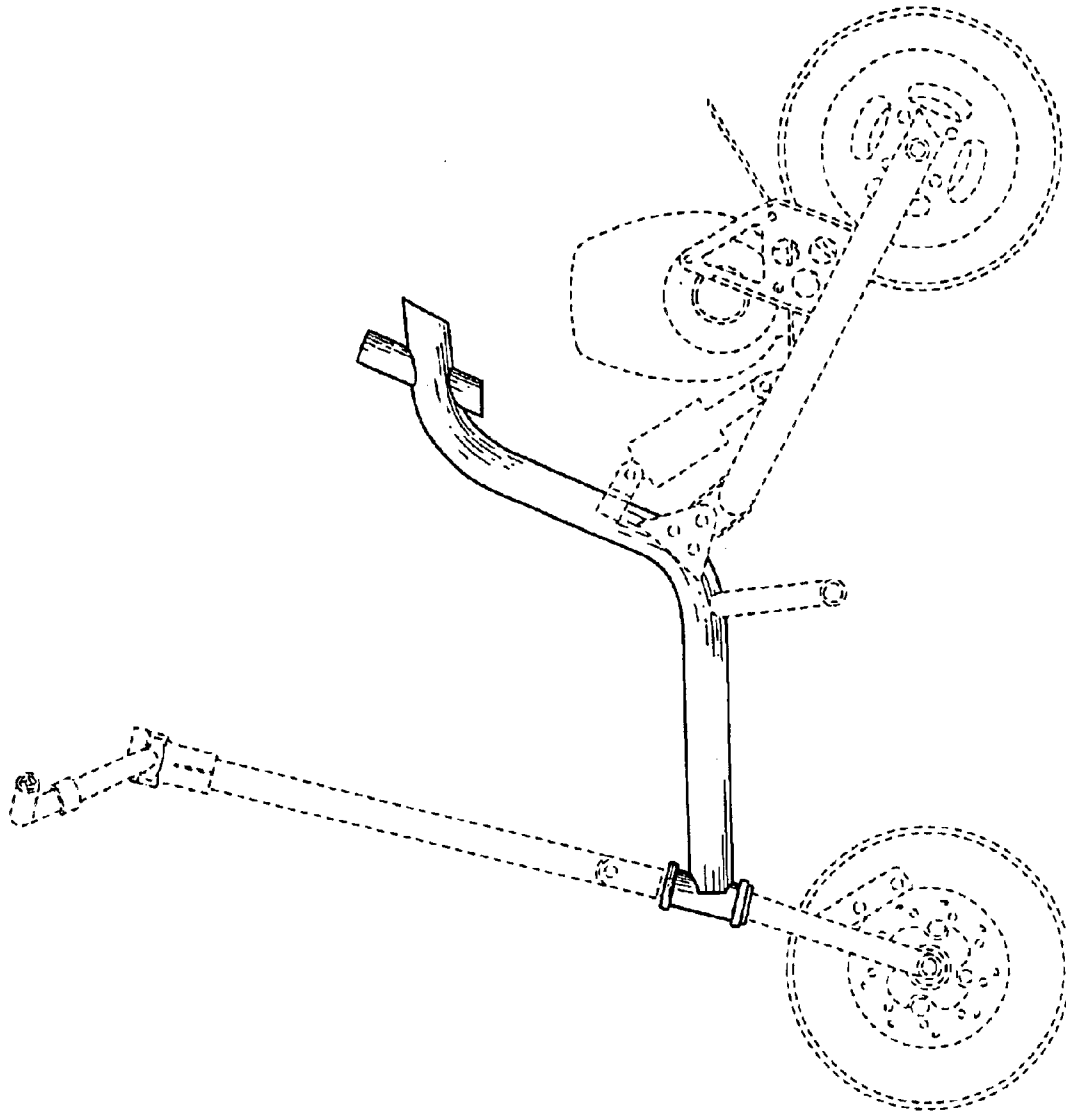

FIG. 2

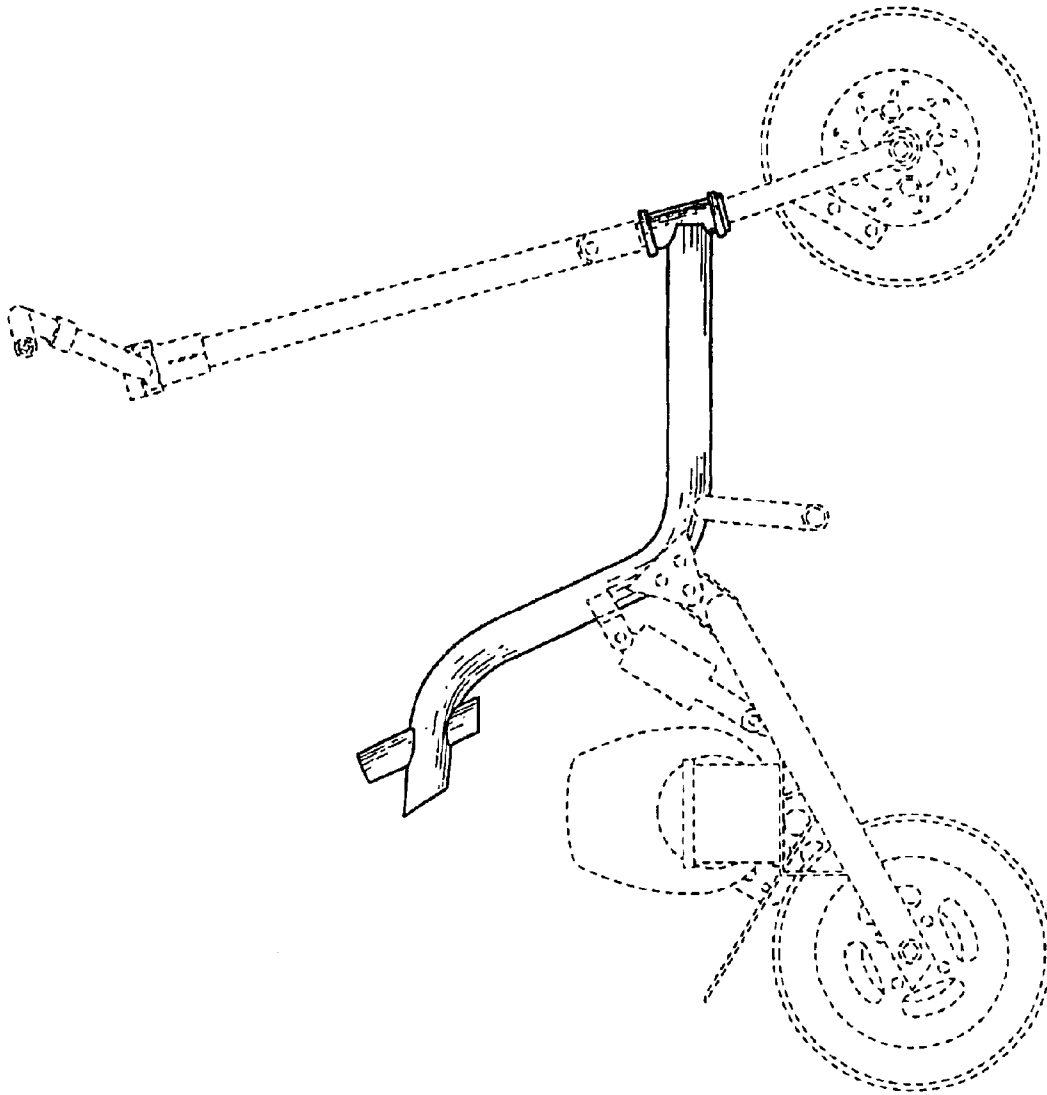

FIG. 3

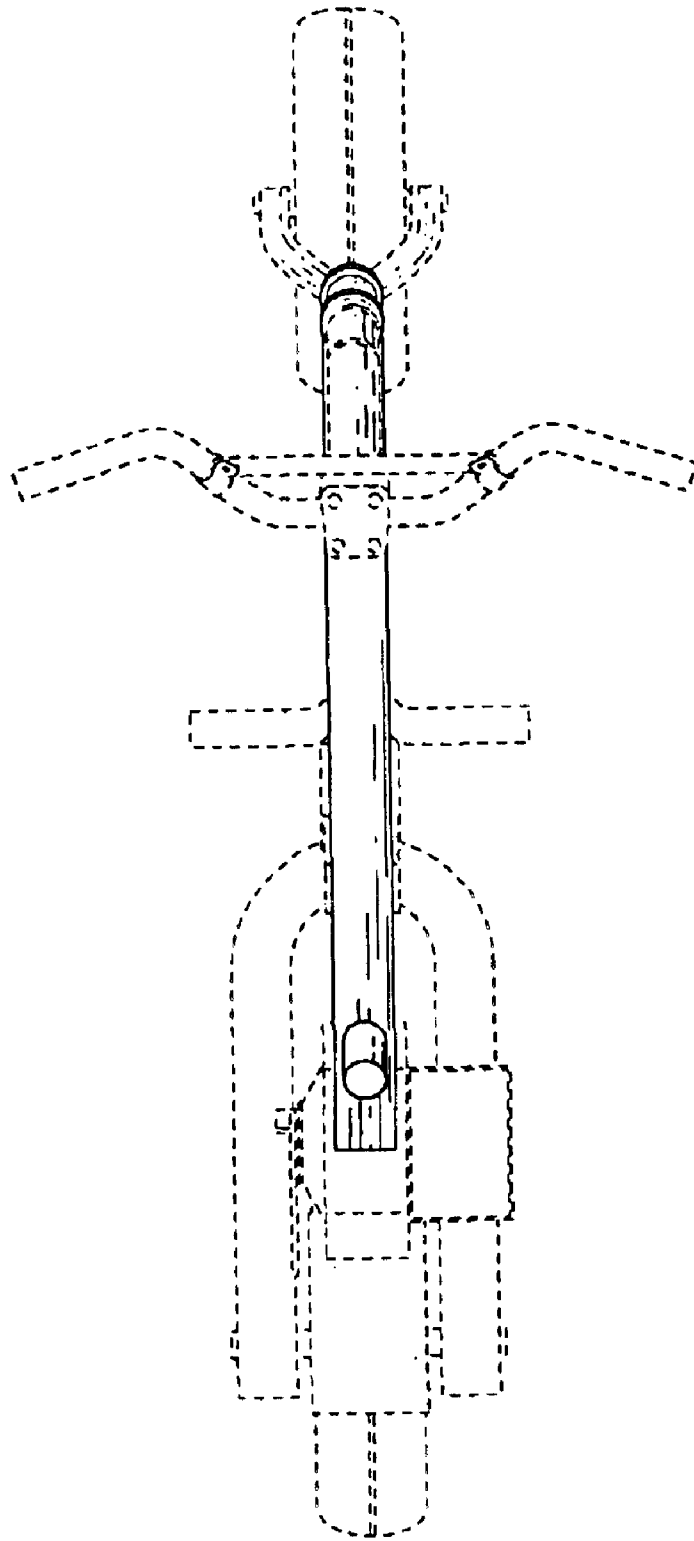

FIG. 4

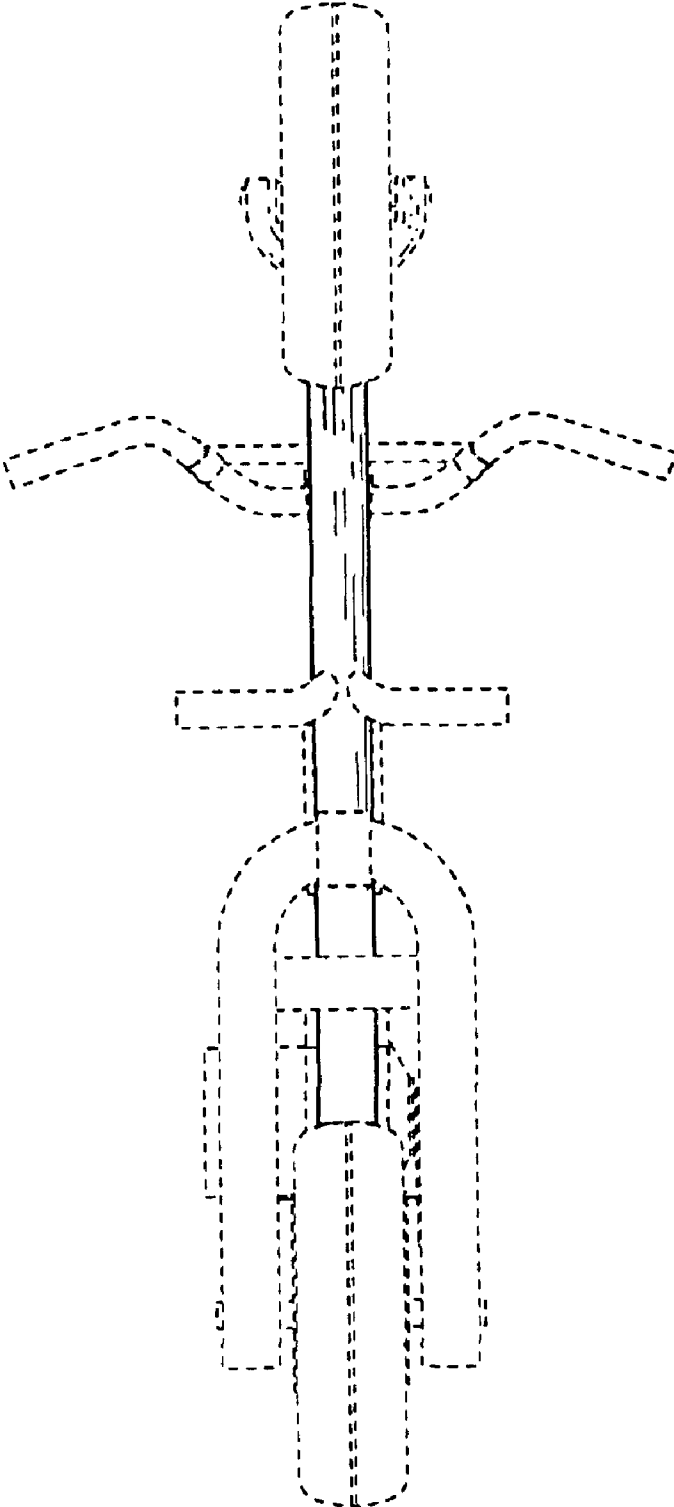

FIG. 5

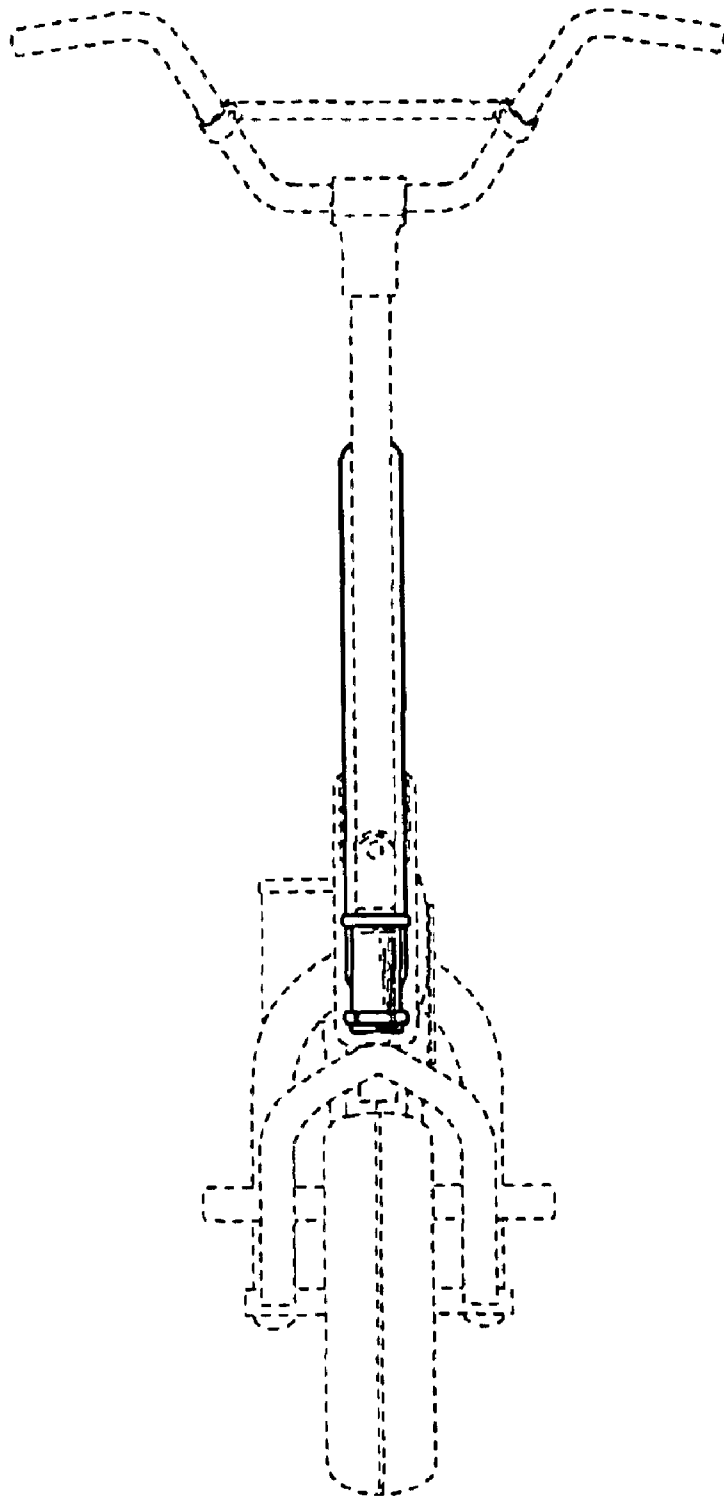

FIG. 6

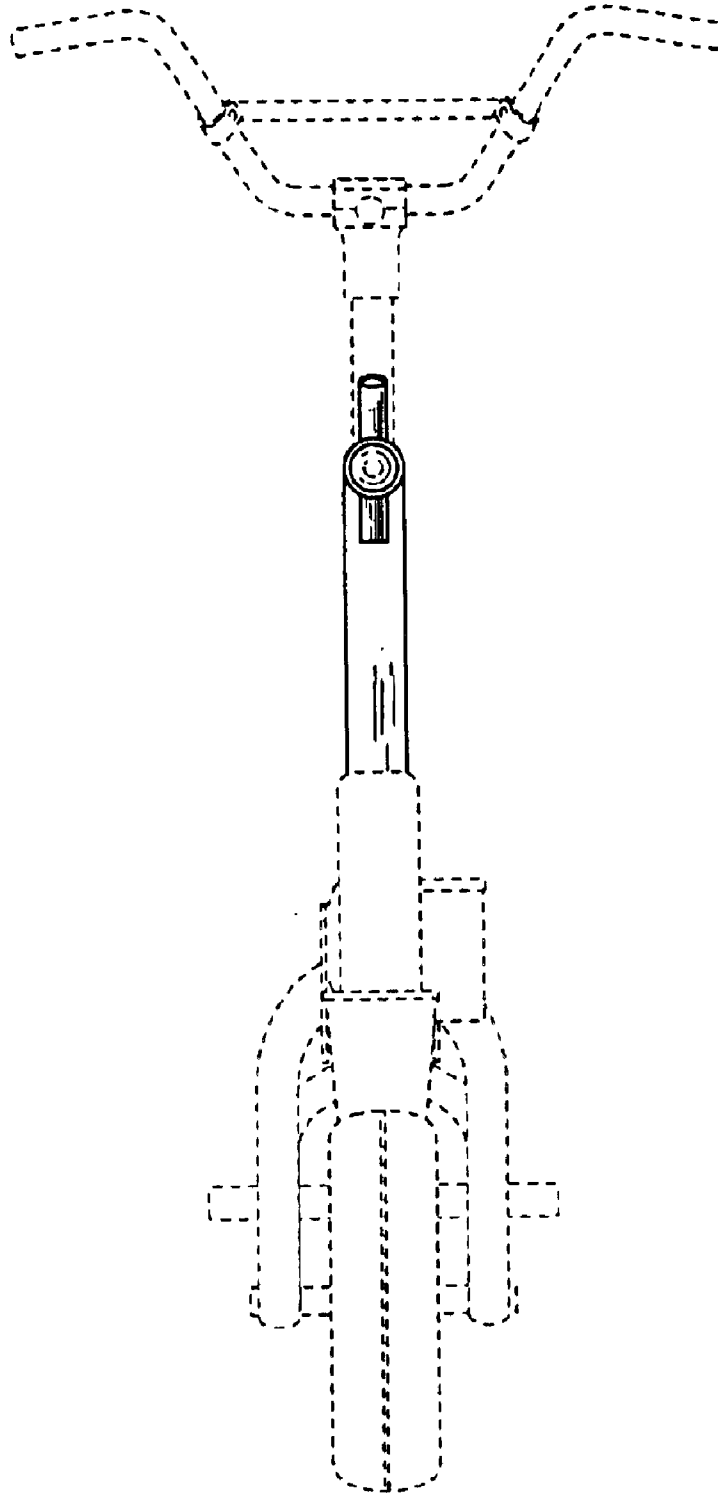

FIG. 7