



US 20010039434A1

(19)

United States

(12)

Patent Application Publication

Frazier et al.

(10)

Pub. No.: US 2001/0039434 A1

(43)

Pub. Date:

Nov. 8, 2001

(54) **METHOD AND APPARATUS FOR CLOSING
A SUBCUTANEOUS TISSUE OPENING**

(76) Inventors: **Andrew G.C. Frazier**, Sunnyvale, CA
(US); **Michael D. Lesh**, Mill Valley,
CA (US); **Chad C. Roue**, Fremont, CA
(US); **Erik J. van der Burg**,
Sunnyvale, CA (US)

Correspondence Address:
KNOBBE MARTENS OLSON & BEAR LLP
620 NEWPORT CENTER DRIVE
SIXTEENTH FLOOR
NEWPORT BEACH, CA 92660 (US)

(21) Appl. No.: **09/903,900**
(22) Filed: **Jul. 12, 2001**

Related U.S. Application Data

(60) Division of application No. 09/447,390, filed on Nov. 22, 1999, which is a continuation-in-part of application No. 09/399,521, filed on Sep. 20, 1999, now Pat. No. 6,231,561.

Publication Classification

(51) **Int. Cl.⁷** **A61M 31/00**
(52) **U.S. Cl.** **606/213**

(57) **ABSTRACT**

Disclosed is a closure catheter, for patching a tissue opening such as an atrial septal defect, patent foreman ovale, or the left atrial appendage of the heart. The closure catheter carries a deployable patch and a plurality of tissue anchors, which may be deployed to secure the patch to surrounding tissue. Methods are also disclosed.

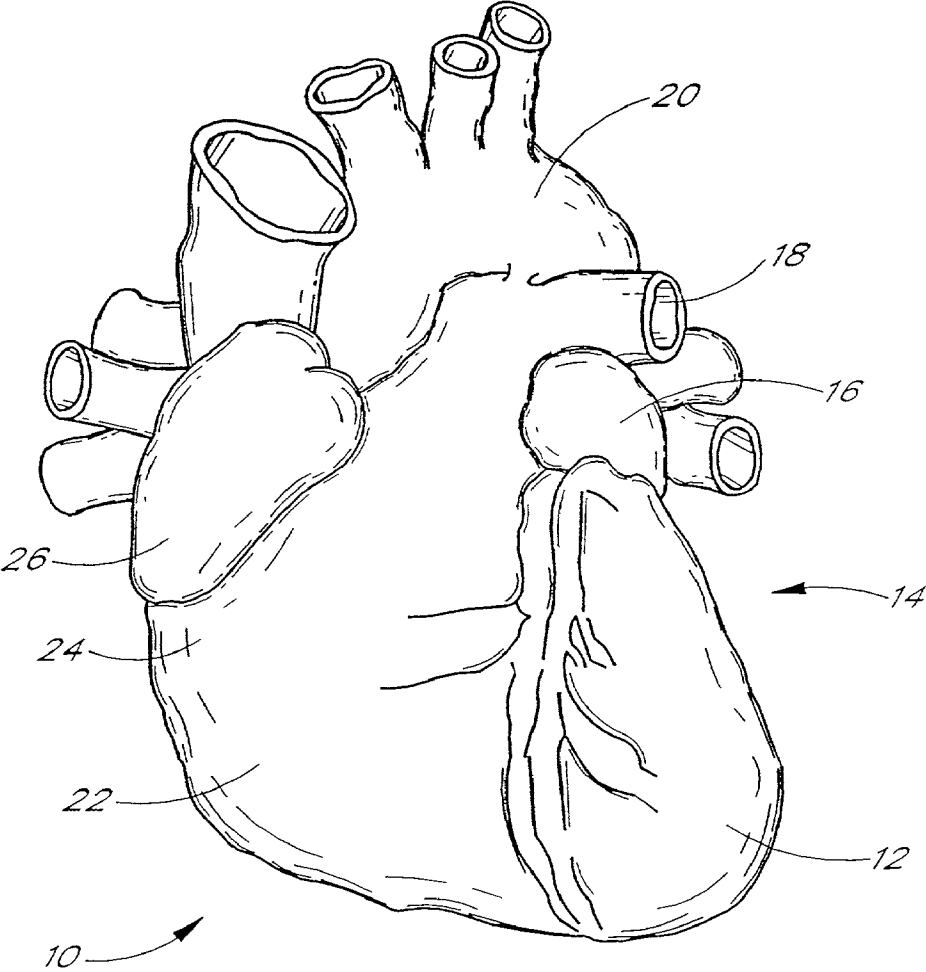

FIG. 1

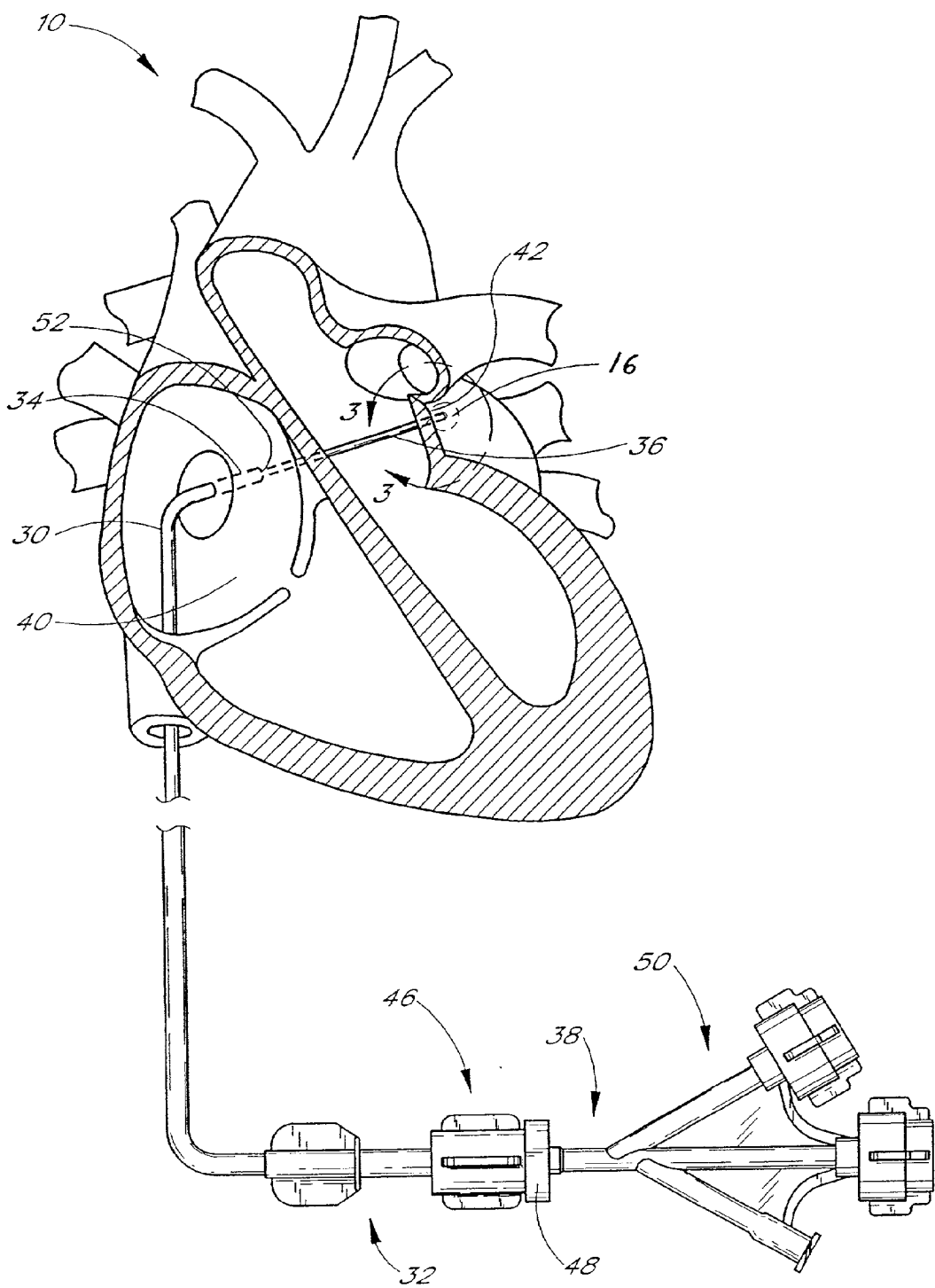
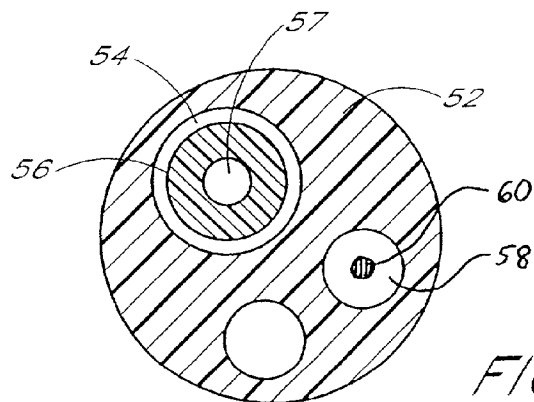
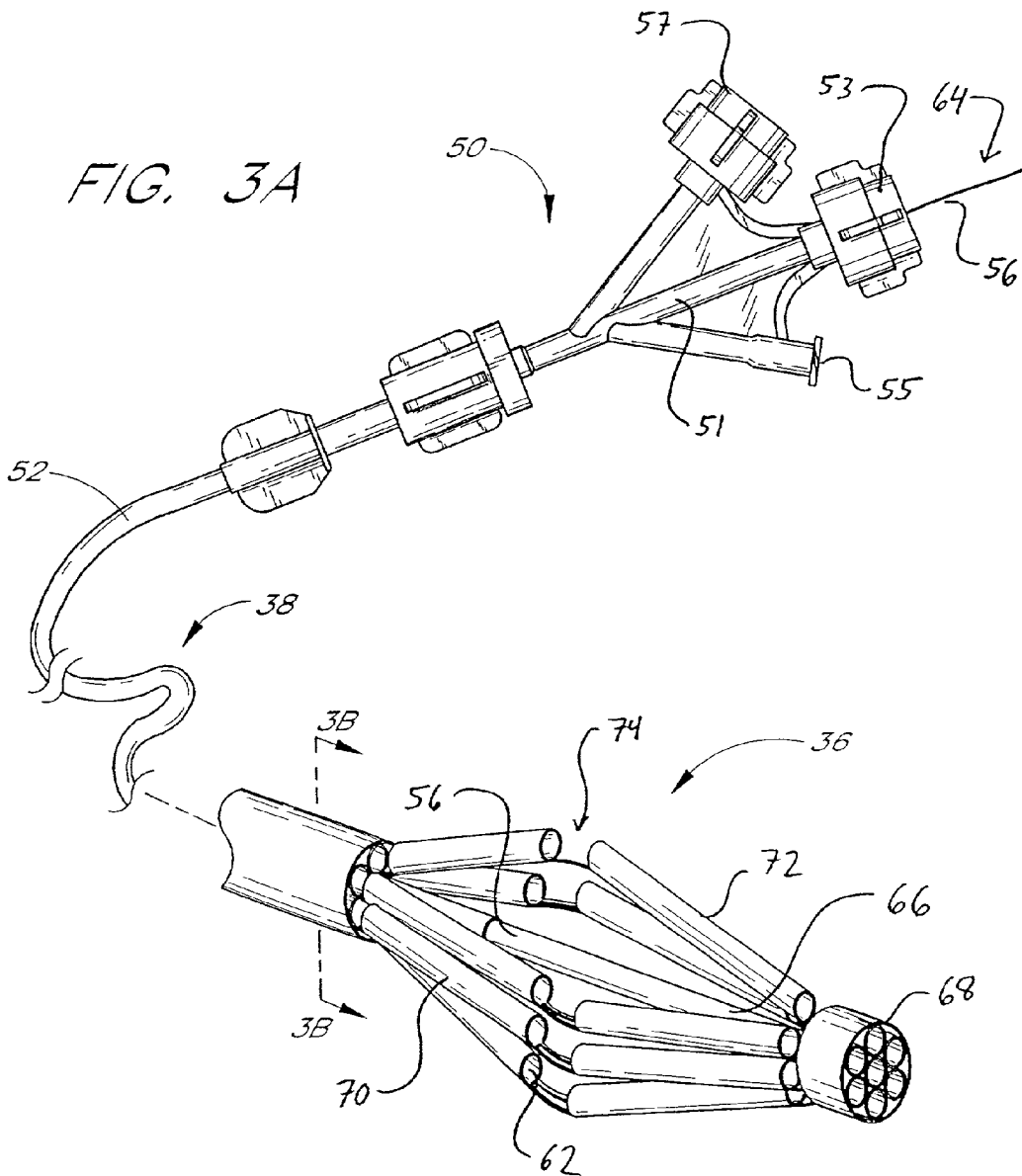

FIG. 2



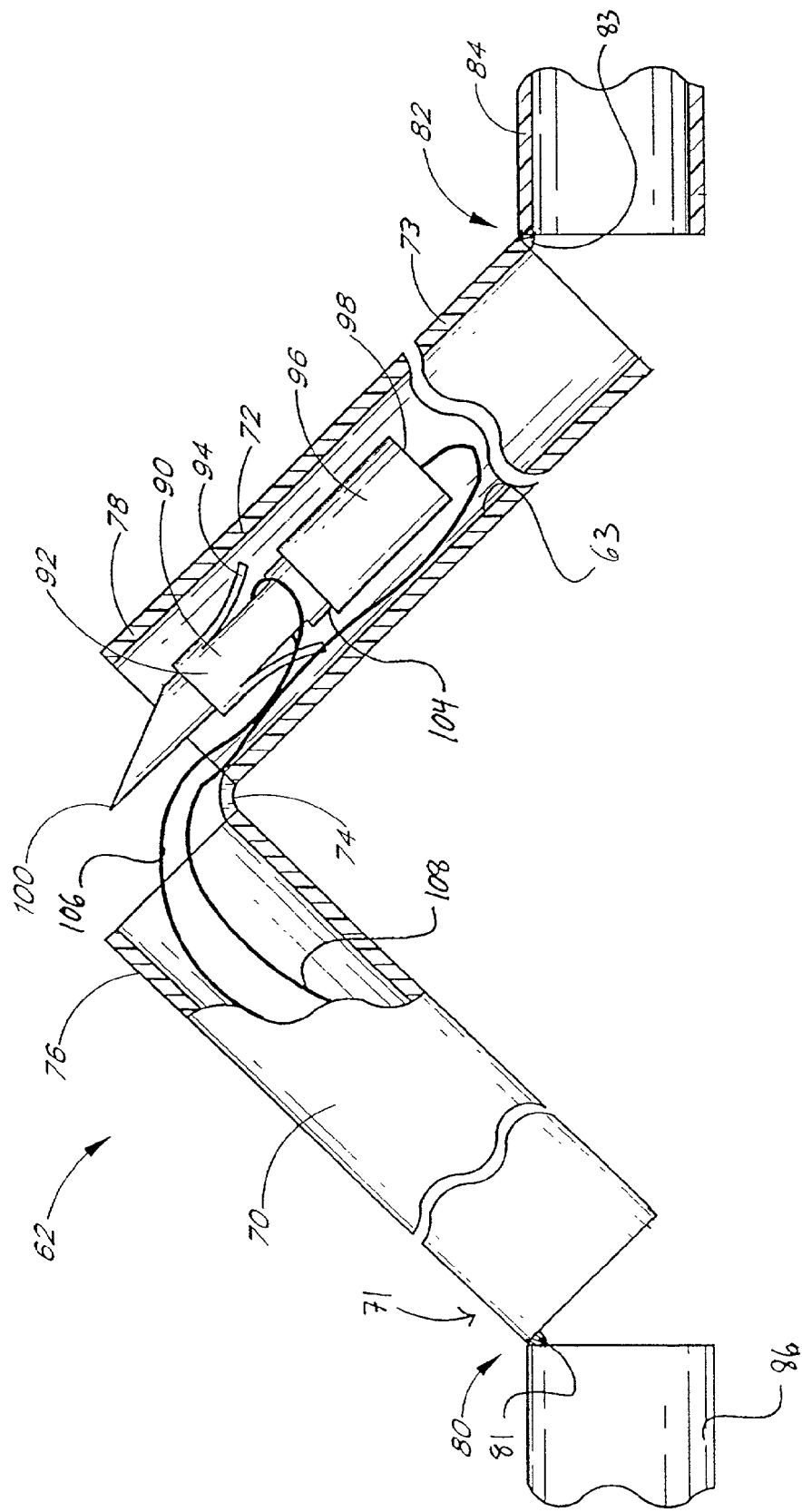

FIG. 4

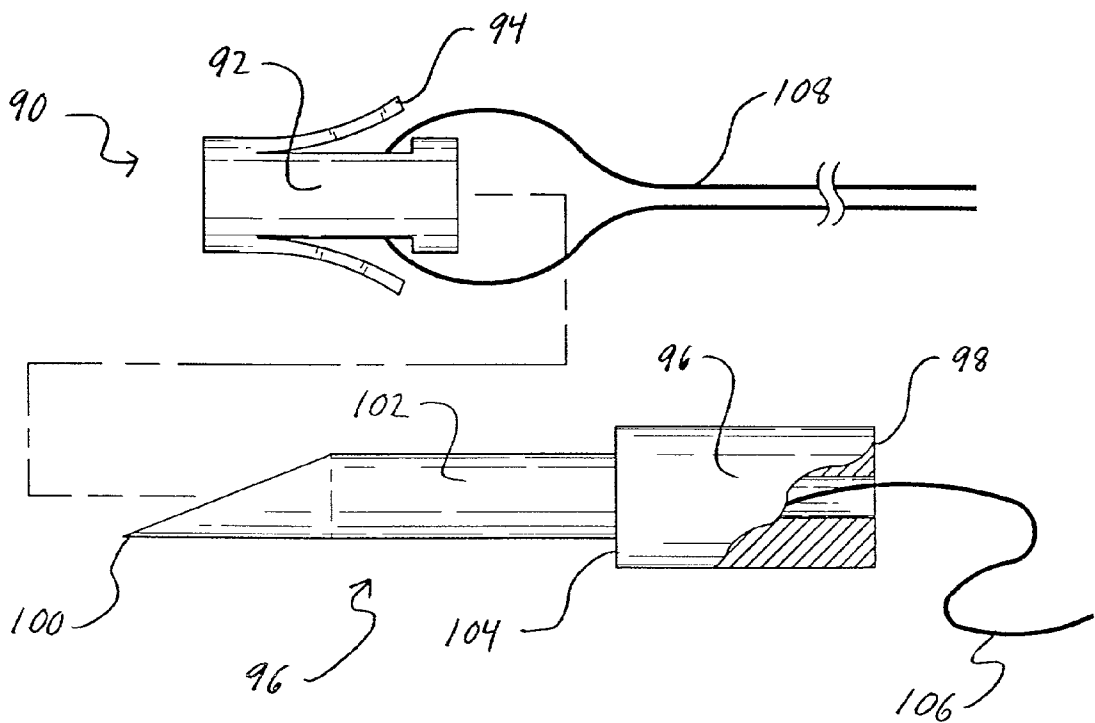

FIG. 5

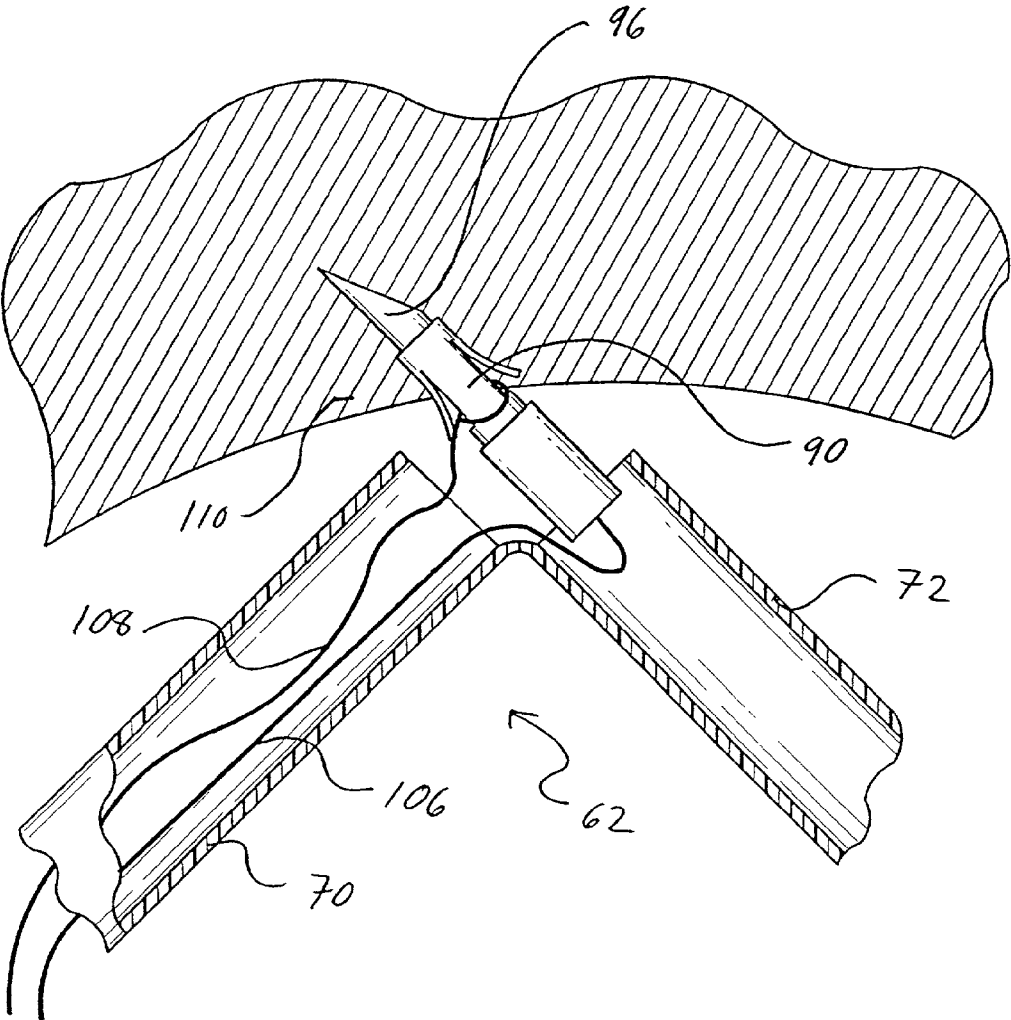
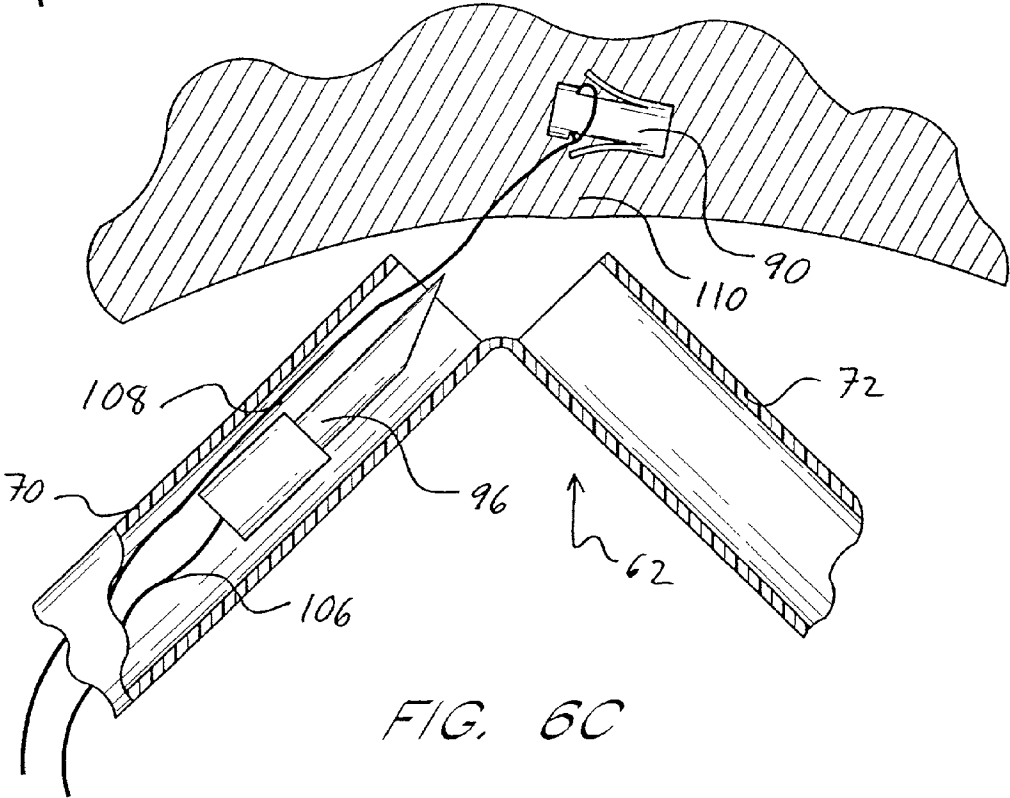
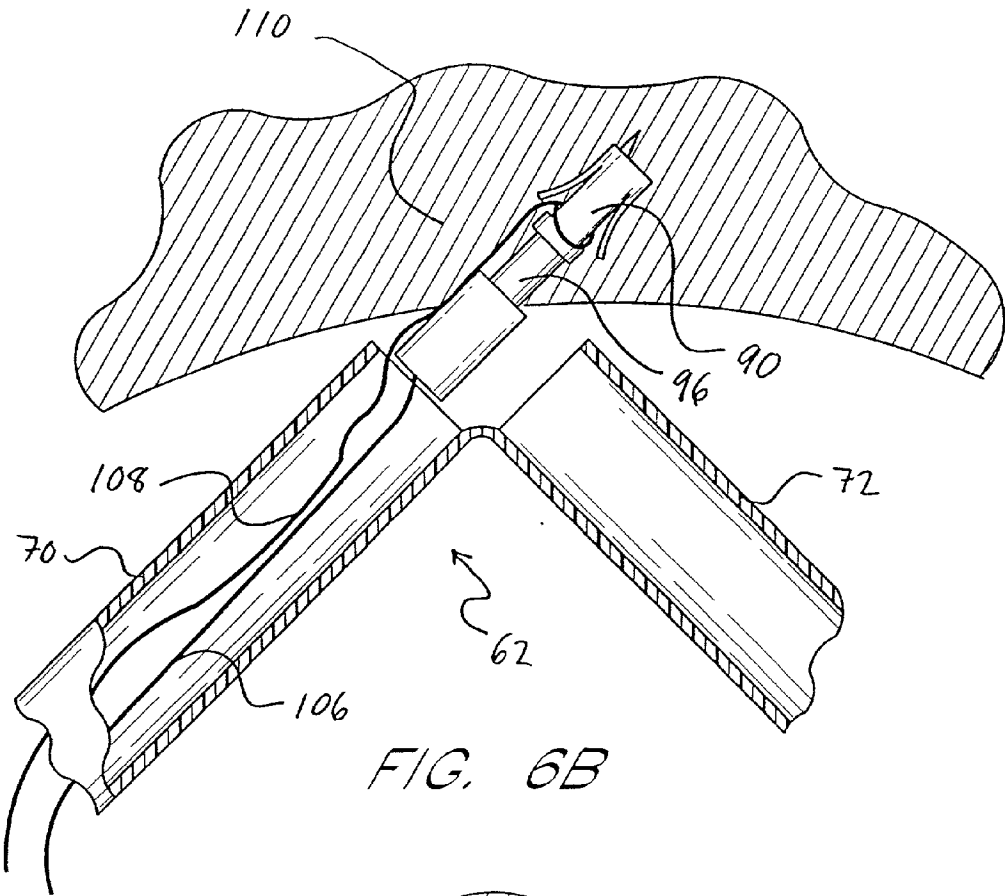
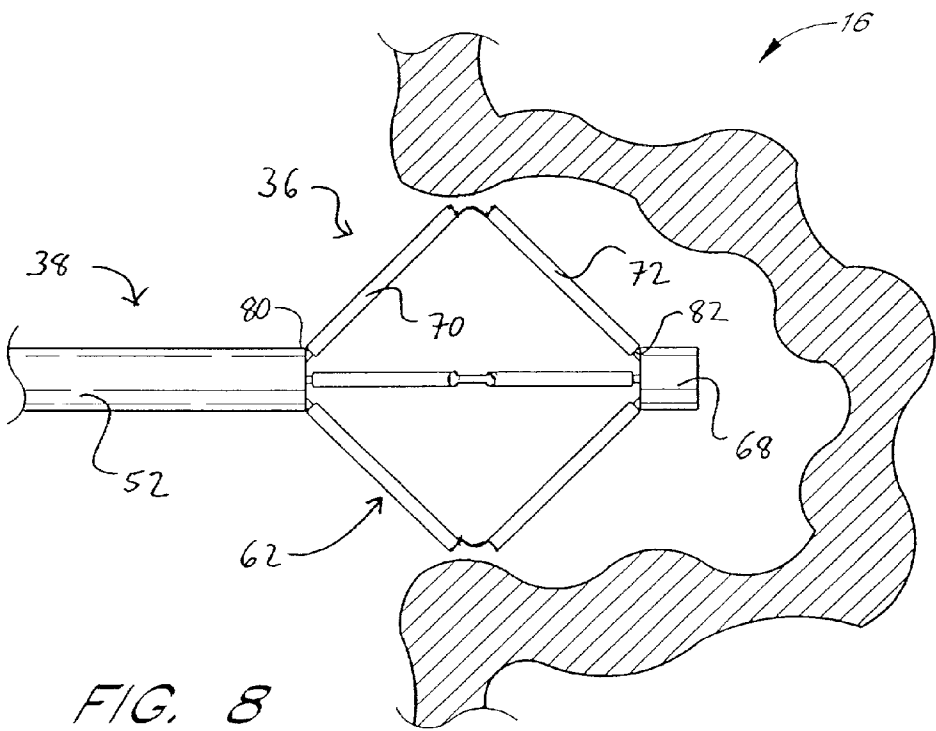
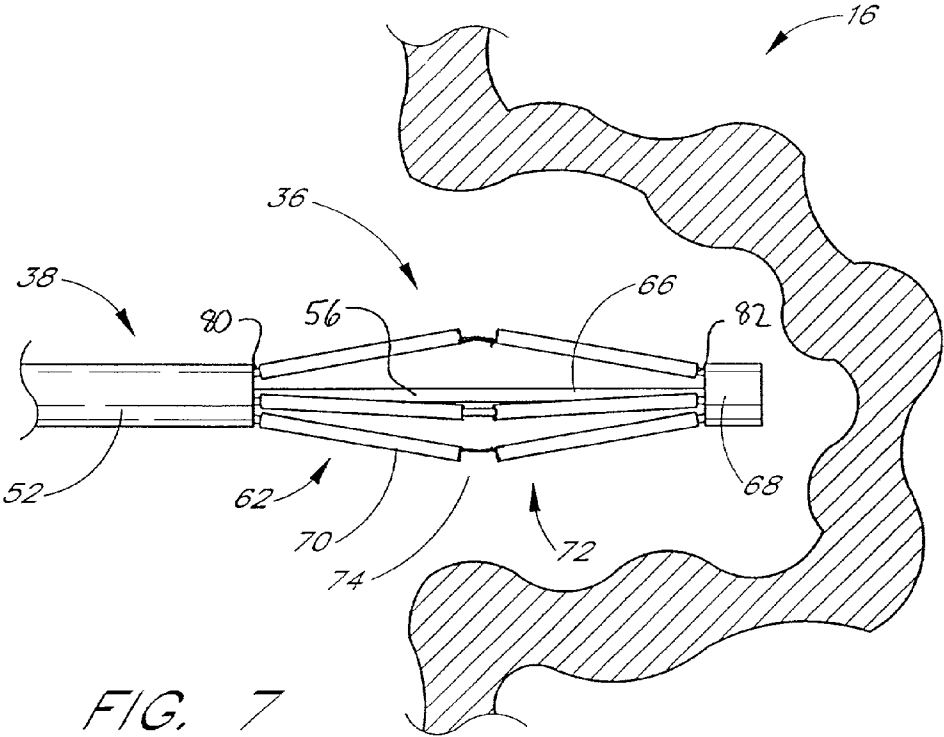
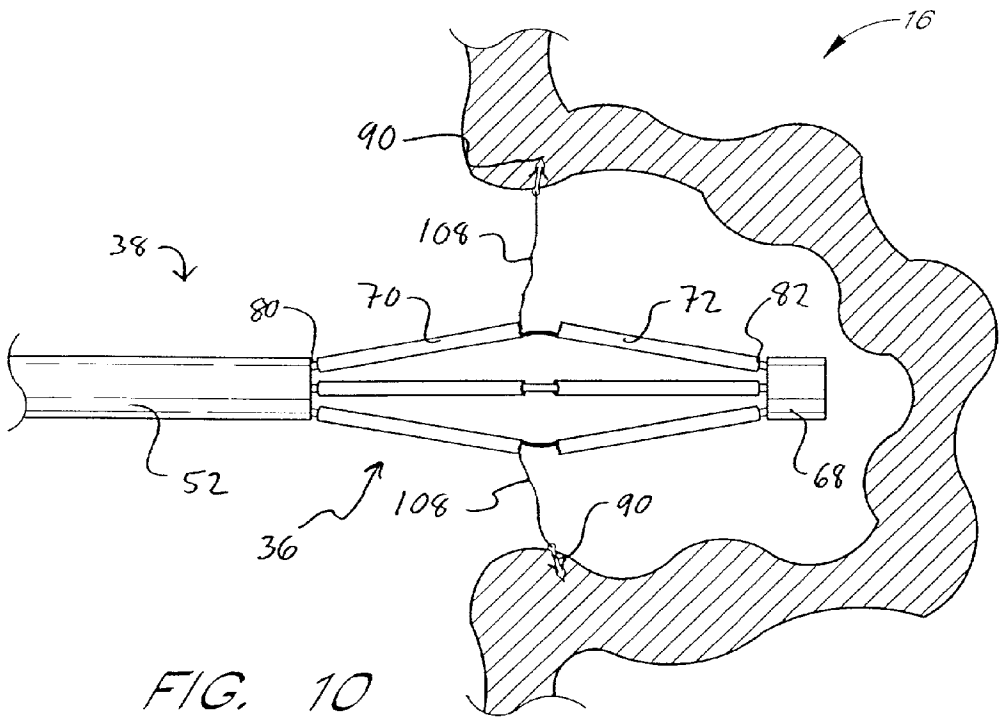
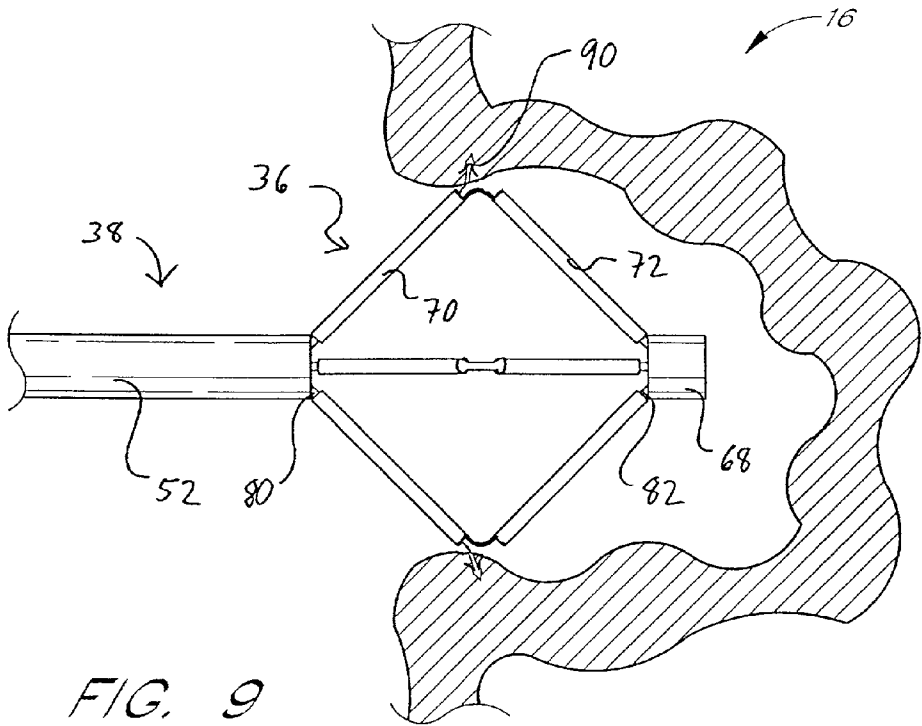

FIG. 6A







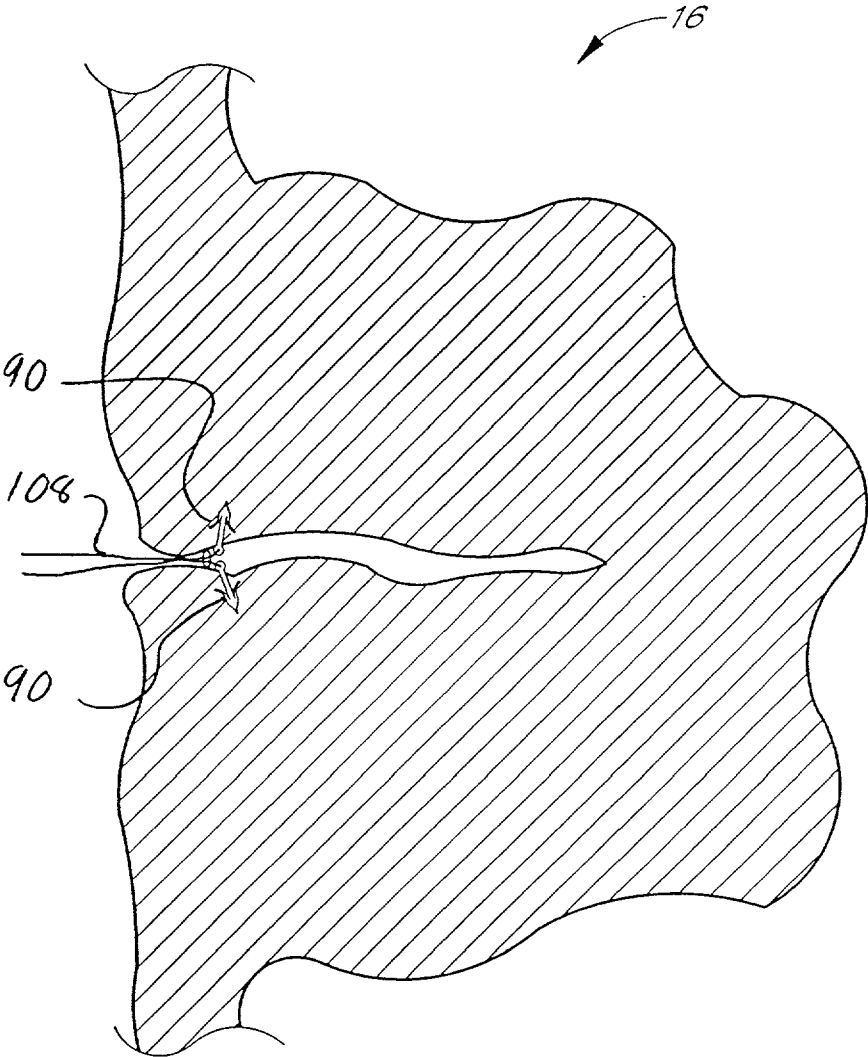
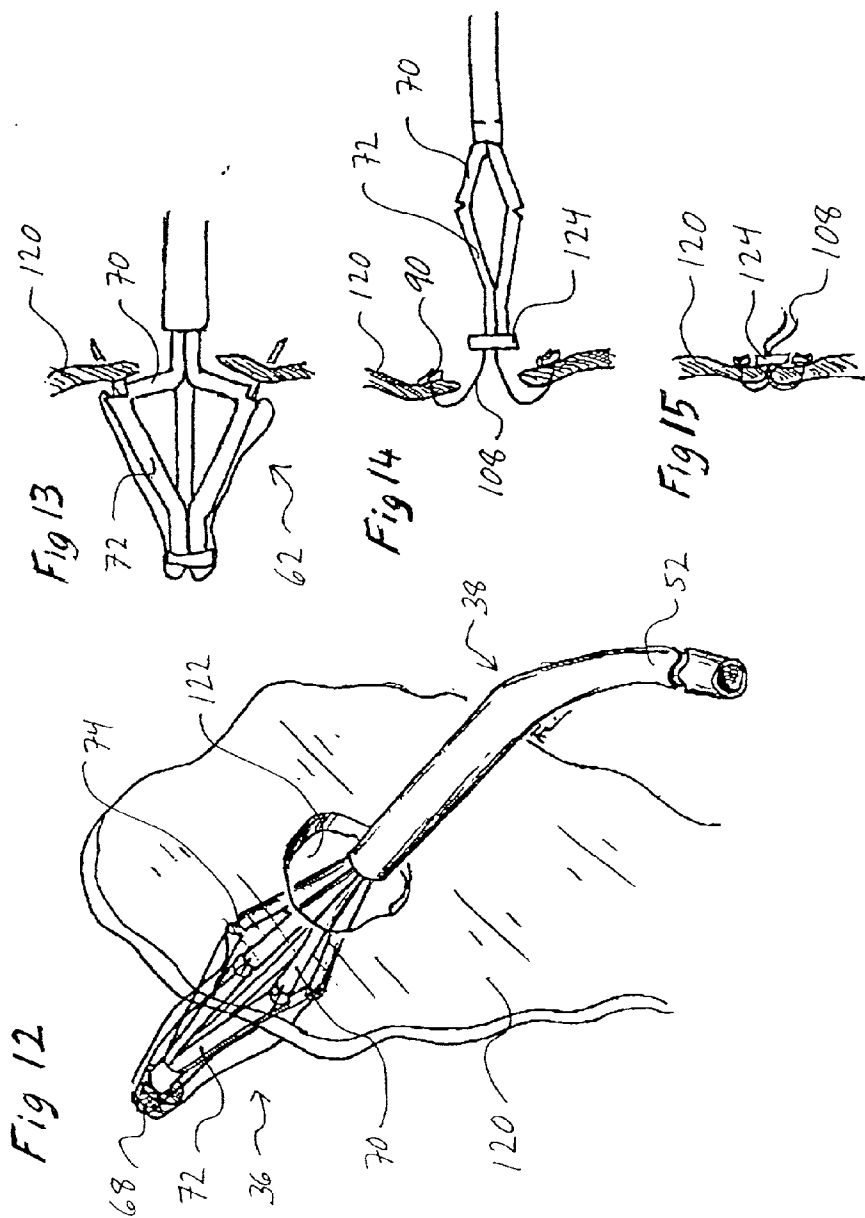
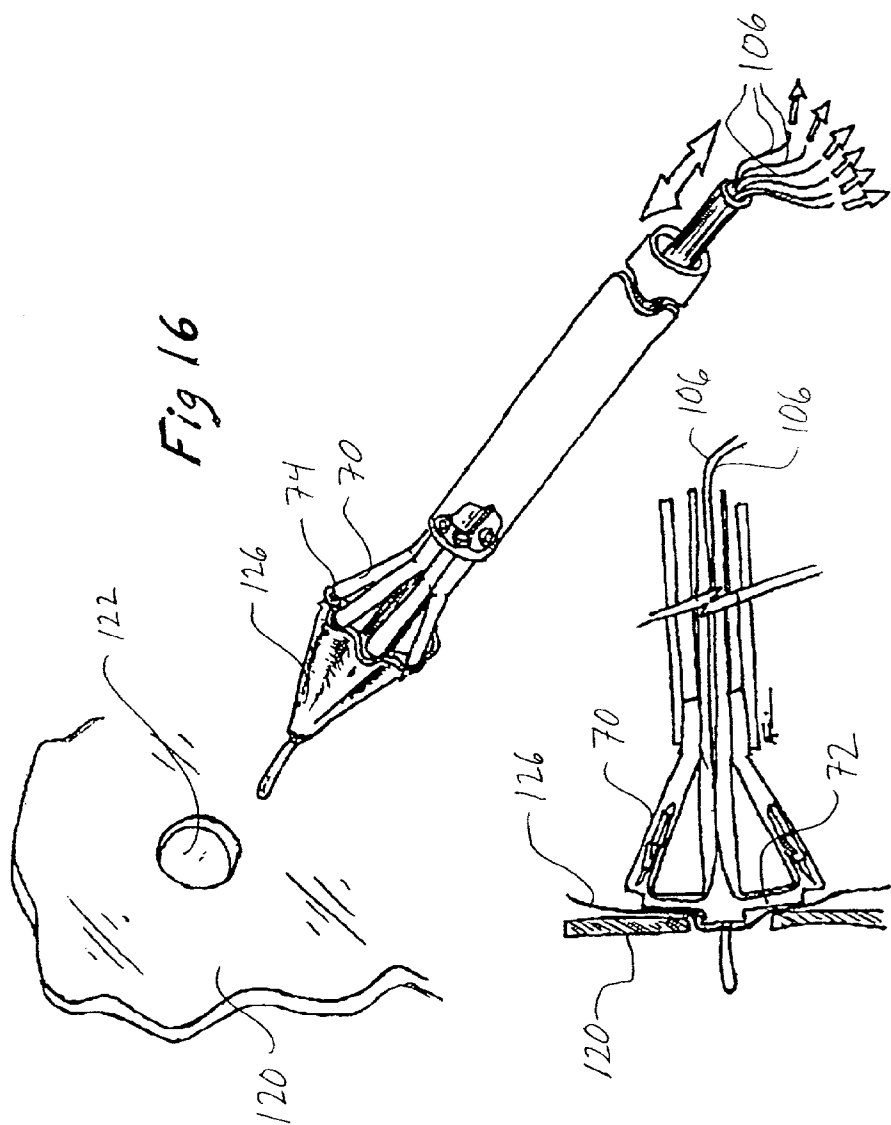

FIG. 11





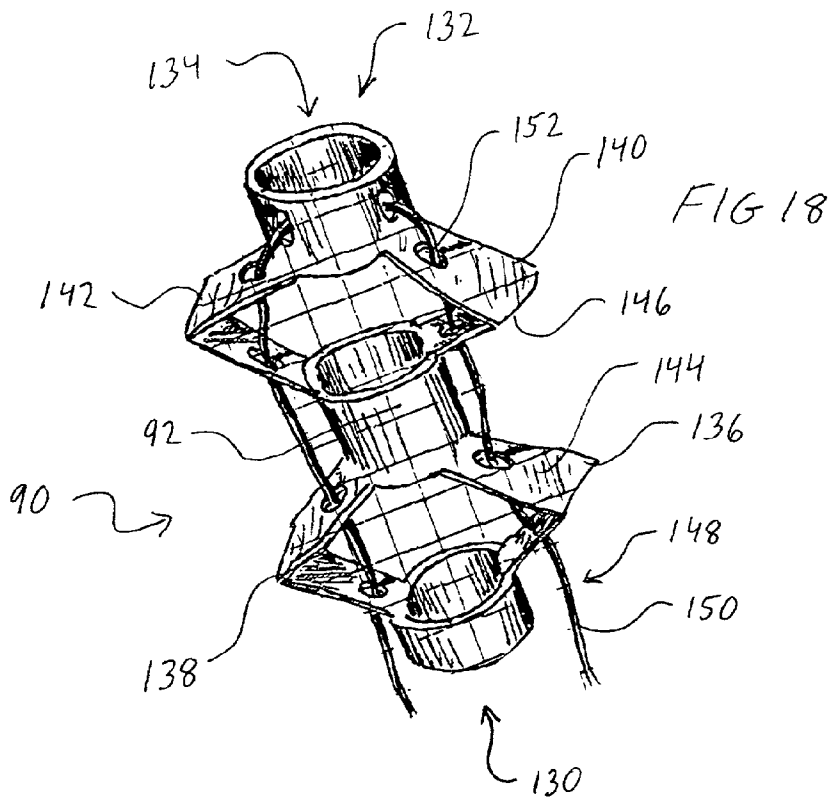

FIG 19

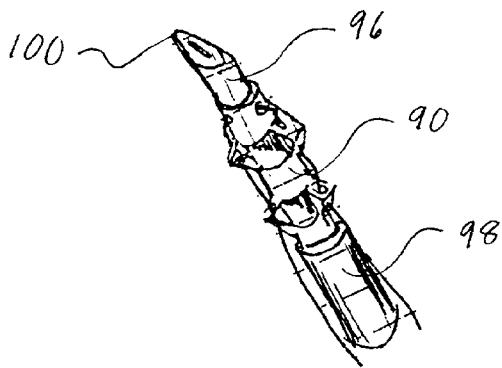
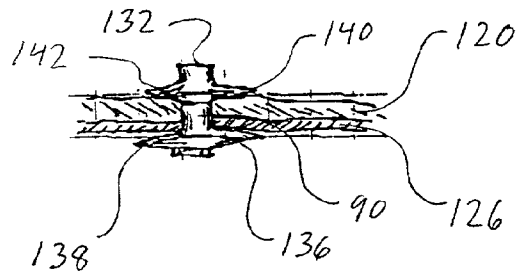

FIG 20



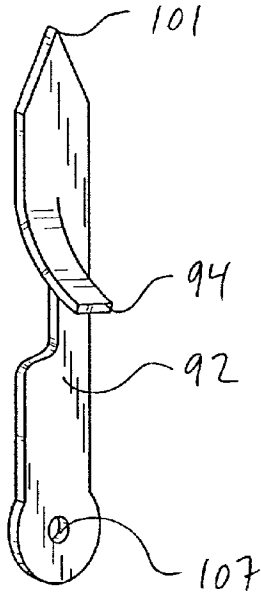

FIG. 21A

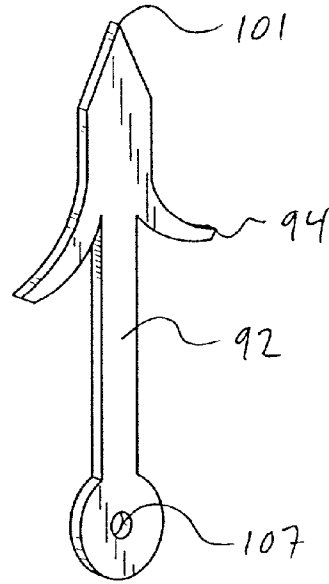

FIG. 21B

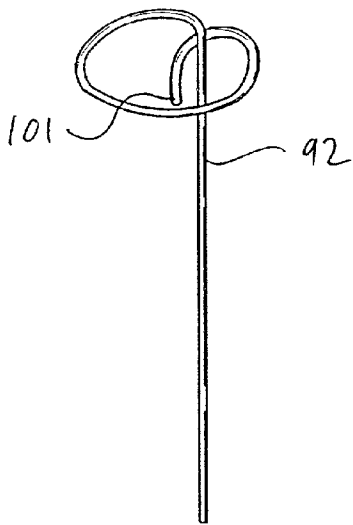

FIG. 21C

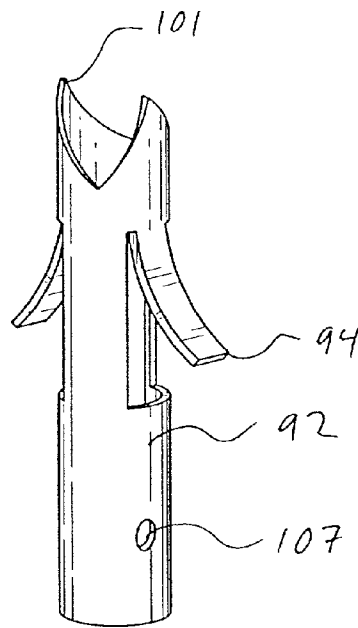

FIG. 21D

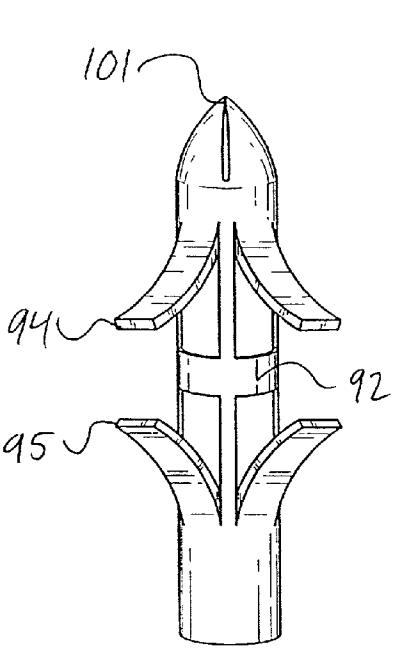

FIG. 21E

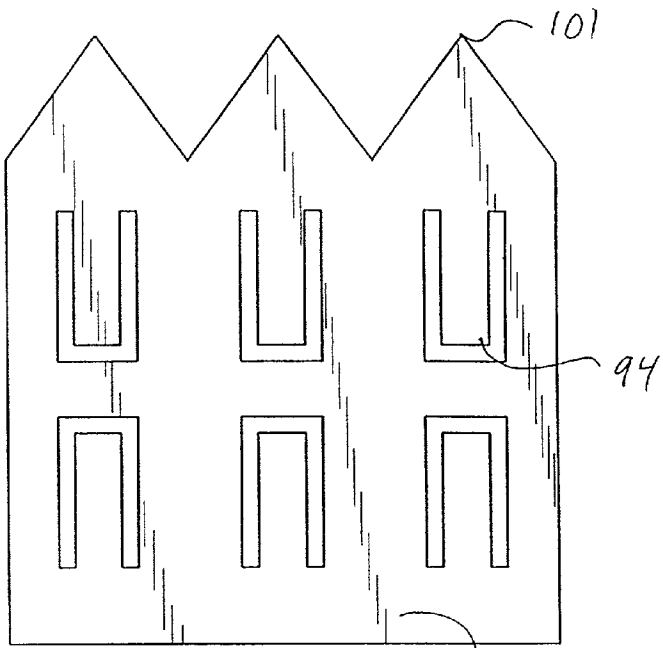

FIG. 21F

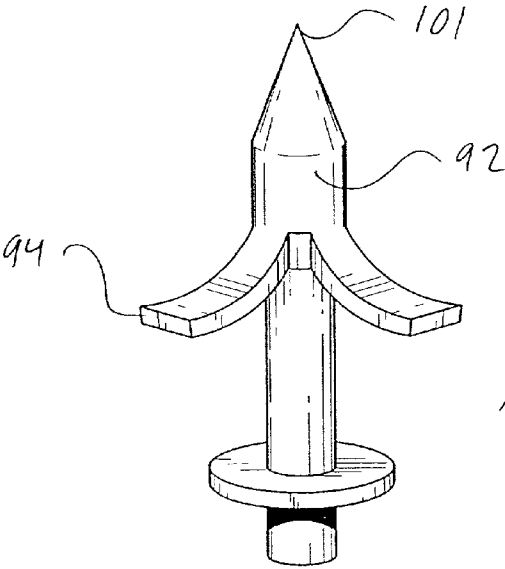

FIG. 21G

METHOD AND APPARATUS FOR CLOSING A SUBCUTANEOUS TISSUE OPENING

[0001] This application is a divisional of application Ser. No. 09/447,390, filed Nov. 22, 1999 which is a continuation-in-part of application Ser. No. 09/399,521, filed Sep. 20, 1999.

[0002] The present invention relates to methods and devices for closing a body lumen, tissue opening, or cavity and, in particular, for closing an atrial septal defect.

Background of the Invention

[0003] Embolic stroke is the nation's third leading killer for adults, and is a major cause of disability. There are over 700,000 strokes per year in the United States alone. Of these, roughly 100,000 are hemorrhagic, and 600,000 are ischemic (either due to vessel narrowing or to embolism). The most common cause of embolic stroke emanating from the heart is thrombus formation due to atrial fibrillation. Approximately 80,000 strokes per year are attributable to atrial fibrillation. Atrial fibrillation is an arrhythmia of the heart that results in a rapid and chaotic heartbeat that produces lower cardiac output and irregular and turbulent blood flow in the vascular system. There are over five million people worldwide with atrial fibrillation, with about four hundred thousand new cases reported each year. Atrial fibrillation is associated with a 500 percent greater risk of stroke due to the condition. A patient with atrial fibrillation typically has a significantly decreased quality of life due, in part, to the fear of a stroke, and the pharmaceutical regimen necessary to reduce that risk.

[0004] For patients who develop atrial thrombus from atrial fibrillation, the clot normally occurs in the left atrial appendage (LAA) of the heart. The LAA is a cavity which looks like a small finger or windsock and which is connected to the lateral wall of the left atrium between the mitral valve and the root of the left pulmonary vein. The LAA normally contracts with the rest of the left atrium during a normal heart cycle, thus keeping blood from becoming stagnant therein, but often fails to contract with any vigor in patients experiencing atrial fibrillation due to the discoordinate electrical signals associated with AF. As a result, thrombus formation is predisposed to form in the stagnant blood within the LAA.

[0005] Blackshear and Odell have reported that of the 1288 patients with non-rheumatic atrial fibrillation involved in their study, 221 (17%) had thrombus detected in the left atrium of the heart. Blackshear J L, Odell J A., Appendage Obliteration to Reduce Stroke in Cardiac Surgical Patients With Atrial Fibrillation. *Ann Thorac. Surg.*, 1996.61(2):755-9. Of the patients with atrial thrombus, 201 (91%) had the atrial thrombus located within the left atrial appendage. The foregoing suggests that the elimination or containment of thrombus formed within the LAA of patients with atrial fibrillation would significantly reduce the incidence of stroke in those patients.

[0006] Pharmacological therapies for stroke prevention such as oral or systemic administration of warfarin or the like have been inadequate due to serious side effects of the medications and lack of patient compliance in taking the medication. Invasive surgical or thorascopic techniques have been used to obliterate the LAA, however, many

patients are not suitable candidates for such surgical procedures due to a compromised condition or having previously undergone cardiac surgery. In addition, the perceived risks of even a thorascopic surgical procedure often outweigh the potential benefits. See Blackshear and Odell, above. See also Lindsay B D., Obliteration of the Left Atrial Appendage: A Concept Worth Testing, *Ann Thorac. Surg.*, 1996.61(2):515.

[0007] Despite the various efforts in the prior art, there remains a need for a minimally invasive method and associated devices for reducing the risk of thrombus formation in the left atrial appendage.

[0008] Other conditions which would benefit from a tissue aperture closure catheter are tissue openings such as an atrial septal defect. In general, the heart is divided into four chambers, the two upper being the left and right atria and the two lower being the left and right ventricles. The atria are separated from each other by a muscular wall, the interatrial septum, and the ventricles by the interventricular septum.

[0009] Either congenitally or by acquisition, abnormal openings, holes or shunts can occur between the chambers of the heart or the great vessels (interatrial and interventricular septal defects or patent ductus arteriosus and aortico-pulmonary window respectively), causing shunting of blood through the opening. The ductus arteriosus is the prenatal canal between the pulmonary artery and the aortic arch which normally closes soon after birth. The deformity is usually congenital, resulting from a failure of completion of the formation of the septum, or wall, between the two sides during fetal life when the heart forms from a folded tube into a four-chambered, two unit system.

[0010] These deformities can carry significant sequelae. For example, with an atrial septal defect, blood is shunted from the left atrium of the heart to the right, producing an over-load of the right heart. In addition to left-to-right shunts such as occur in patent ductus arteriosus from the aorta to the pulmonary artery, the left side of the heart has to work harder because some of the blood which it pumps will recirculate through the lungs instead of going out to the rest of the body. The ill effects of these lesions usually cause added strain on the heart with ultimate failure if not corrected.

[0011] Previous extracardiac (outside the heart) or intracardiac septal defects have required relatively extensive surgical techniques for correction. To date the most common method of closing intracardiac shunts, such as atrial-septal defects and ventricular-septal defects, entails the relatively drastic technique of open-heart surgery, requiring opening the chest or sternum and diverting the blood from the heart with the use of a cardiopulmonary bypass. The heart is then opened, the defect is sewn shut by direct suturing with or without a patch of synthetic material (usually of Dacron, Teflon, silk, nylon or pericardium), and then the heart is closed. The patient is then taken off the cardiopulmonary bypass machine, and then the chest is closed.

[0012] In place of direct suturing, closures of interauricular septal defects by means of a mechanical prosthesis have been disclosed.

[0013] U.S. Pat. No. 3,874,388 to King, et al. relates to a shunt defect closure system including a pair of opposed umbrella-like elements locked together in a face to face relationship and delivered by means of a catheter, whereby a defect is closed. U.S. Pat. No. 5,350,399 to Erlebacher, et

al. relates to a percutaneous arterial puncture seal device also including a pair of opposed umbrella-like elements and an insertion tool.

[0014] U.S. Pat. No. 4,710,192 to Liotta, et al. relates to a vaulted diaphragm for occlusion in a descending thoracic aorta.

[0015] U.S. Pat. No. 5,108,420 to Marks relates to an aperture occlusion device consisting of a wire having an elongated configuration for delivery to the aperture, and a preprogrammed configuration including occlusion forming wire segments on each side of the aperture.

[0016] U.S. Pat. No. 4,007,743 to Blake relates to an opening mechanism for umbrella like intravascular shunt defect closure device having foldable flat ring sections which extend between pivotable struts when the device is expanded and fold between the struts when the device is collapsed.

[0017] Notwithstanding the foregoing, there remains a need for a transluminal method and apparatus for correcting intracardiac septal defects, which enables a patch to be placed across a septal defect to inhibit or prevent the flow of blood therethrough.

SUMMARY OF THE INVENTION

[0018] The present invention provides a closure catheter and methods for closing an opening in tissue, a body lumen, hollow organ or other body cavity. The catheter and methods of its use are useful in a variety of procedures, such as treating (closing) wounds and naturally or surgically created apertures or passageways. Applications include, but are not limited to, atrial septal defect closure, patent ductus arteriosus closure, aneurysm isolation and graft and/or bypass anastomosis procedures.

[0019] There is provided in accordance with one aspect of the present invention, a method of patching an intracardiac septal defect such as an atrial septal defect. The method comprises the steps of providing a catheter having an elongate flexible body with a proximal end and a distal end, a patch and at least two anchors removably carried by the distal end. The distal end is advanced to a position near the atrial septal defect, and the patch is positioned across the defect. The anchors are thereafter deployed from the catheter to secure the patch across the defect.

[0020] In one embodiment, the positioning step comprises enlarging the cross section of the patch from a reduced profile for advancing the catheter, to an enlarged profile for patching the defect. The positioning step comprises inclining at least one patch support from an axial orientation to an inclined orientation to position the patch across the defect. The positioning step preferably comprises inclining at least three patch supports from an axial orientation to an inclined orientation to position the patch across the defect. In one embodiment, the deploying the anchors step comprises advancing the anchors distally through the patch and into tissue adjacent the defect to secure the patch across the defect.

[0021] In accordance with another aspect of the present invention, there is provided a method of closing an opening in a subcutaneous tissue plane. The method comprises the steps of providing a catheter having a patch and at least one

anchor. The catheter is advanced to the opening, and the patch is positioned across the opening. The anchor is advanced into tissue to secure the patch across the opening. Preferably, the advancing the anchor step comprises advancing at least three anchors into the tissue to secure the patch across the opening. The opening may be a naturally occurring opening such as an atrial septal defect, or a surgically created opening.

[0022] In accordance with a further aspect of the present invention, there is provided a deployment catheter for deploying a patch across a tissue aperture. The deployment catheter comprises an elongate body having a proximal end and a distal end. At least one patch support is provided on the body for removably carrying a patch. At least one anchor support is also provided for removably carrying at least one anchor. The anchor support is movable between an axial orientation and an inclined orientation with respect to a longitudinal axis of the body. In one embodiment, the anchor support is hingably connected to the patch support. The anchor support and patch support may also be the same structure, such that the patch is carried by the anchor supports. Preferably, at least three anchor supports and/or at least three patch supports are provided.

[0023] In accordance with a further aspect of the present invention, there is provided a patch deployment catheter for deploying a patch across an opening. The catheter comprises an elongate body, having a proximal end and a distal end. At least two supports are provided on the catheter, movable between an axial orientation and an inclined orientation. Each support comprises a proximal section, a distal section and a hinge in-between. A control is provided on the catheter for moving the hinge radially outwardly from a first position for introducing the catheter to a site in the body to a second position for deploying the patch at the site. The supports are in the axial orientation when the hinge is in the first position.

[0024] In one embodiment, the elongate body is flexible. Preferably, at least one tissue anchor is carried by the proximal section of each support. At least one patch is preferably carried by the distal section of each support. In one embodiment, the patch comprises a tissue ingrowth surface.

[0025] Further features and advantages of the present invention will become apparent to those of skill in the art in view of the detailed description of preferred embodiments which follows, when considered together with the attached drawings and claims.

BRIEF DESCRIPTION OF THE DRAWINGS

[0026] FIG. 1 is an anterior illustration of a heart, with the proximal parts of the great vessels.

[0027] FIG. 2 is a schematic cross section through the heart with a transeptal catheter deployed through the septum and a closure catheter extending into the LAA.

[0028] FIG. 3A is an enlarged perspective view of the distal end of a closure catheter in accordance with the present invention.

[0029] FIG. 3B is a cross section taken along the lines 3B-3B of FIG. 3A.

[0030] FIG. 4 is a partial cross-sectional view of a tissue anchor and introducer, positioned within an anchor guide in accordance with the present invention.

[0031] FIG. 5 is an exploded view of a tissue anchor and introducer in accordance with one aspect of the invention.

[0032] FIG. 6A is a schematic illustration of a tissue anchor and introducer advancing into a tissue surface.

[0033] FIG. 6B is an illustration as in FIG. 6A, with the anchor positioned within the tissue and the introducer partially retracted.

[0034] FIG. 6C is an illustration as in FIG. 6B, with the introducer fully retracted and the anchor positioned within the tissue.

[0035] FIG. 7 shows a schematic view of a closure catheter disposed within the opening of the LAA.

[0036] FIG. 8 is a schematic illustration of the opening of the LAA as in FIG. 7, with the anchor guides in an inclined orientation.

[0037] FIG. 9 is a schematic illustration as in FIG. 8, with tissue anchors deployed from the anchor guides.

[0038] FIG. 10 is a schematic illustration as in FIG. 9, with the anchor guides retracted into an axial orientation.

[0039] FIG. 11 is a schematic illustration as in FIG. 10, with the closure catheter retracted and the LAA drawn closed using the tissue anchors.

[0040] FIG. 12 is a perspective view of a closure catheter in accordance with the present invention positioned within a tissue aperture, such as an atrial septal defect.

[0041] FIG. 13 is a side elevational partial cross-section of the catheter of FIG. 12, in an anchor deployment orientation within the aperture.

[0042] FIG. 14 is a side elevational partial cross-section as in FIG. 13, with the deployment catheter withdrawn from the aperture.

[0043] FIG. 15 is a side elevational cross section through the aperture, which has been closed in accordance with the present invention.

[0044] FIG. 16 is a perspective view of a closure catheter in accordance with the present invention, carrying an aperture patch.

[0045] FIG. 17 is a cross-sectional view through the catheter of FIG. 16, shown deploying a patch across a tissue aperture.

[0046] FIG. 18 is a perspective view of a buckling rivet type anchor in accordance with the present invention.

[0047] FIG. 19 is a perspective view of the buckling rivet of FIG. 18, carried by an introducer.

[0048] FIG. 20 is a cross-sectional schematic view of a buckling rivet of the type shown in FIG. 18, deployed on a tissue membrane.

[0049] FIGS. 21A-21G are alternate tissue anchors for use with the closure catheter of the present invention.

DETAILED DESCRIPTION OF THE PREFERRED EMBODIMENT

[0050] For simplicity, the present invention will be described primarily in the context of a left atrial appendage closure procedure. However, the device and methods herein are readily applicable to a wider variety of closure or attachment procedures, and all such applications are con-

templated by the present inventors. For example, additional heart muscle procedures such as atrial septal defect closure and patent ductus arteriosus closure are contemplated. Vascular procedures such as isolation or repair of aneurysms, anastomosis of vessel to vessel or vessel to prosthetic tubular graft (e.g., PTFE or Dacron tubes, with or without wire support structures as are well known in the art) joints may also be accomplished using the devices of the present invention. Attachment of implantable prostheses, such as attachment of the annulus of a prosthetic tissue or mechanical heart valve may be accomplished. A variety of other tissue openings, lumens, hollow organs and surgically created passageways may be closed, patched or reduced in volume in accordance with the present invention. For example, an opening in a tissue plane may be closed or patched, such as by attaching a fabric or tissue sheet across the opening. In one specific application, the device of the present invention is used to anchor a fabric patch to close an atrial septal defect. The target aperture or cavity may be accessed transluminally (e.g., vascular catheter or endoscope) or through solid tissue, such as transmural, percutaneous or other approach. The present invention may also be used in an open surgical procedure such as to close the left atrial appendage during open heart surgery to correct or address a different condition. In another example, the device is advanced through the percutaneous opening and used to close a vascular puncture such as a femoral artery access site for a PTA or other diagnostic or therapeutic interventional procedure. Adaptation of the devices and methods disclosed herein to accomplish procedures such as the foregoing will be apparent to those of skill in the art in view of the disclosure herein.

[0051] Referring to FIG. 1, a heart 10 is illustrated to show certain portions including the left ventricle 12, the left atrium 14, the left atrial appendage (LAA) 16, the pulmonary artery 18, the aorta 20, the right ventricle 22, the right atria 24, and the right atrial appendage 26. As is understood in the art, the left atrium 14 is located above the left ventricle 12 and the two are separated by the mitral valve (not illustrated). The LAA 16 is normally in fluid communication with the left atrium 14 such that blood flows in and out of the LAA 16 as the heart 10 beats.

[0052] In accordance with the present invention, a closure catheter 38 is advanced through the heart and into the LAA. In general, the closure catheter 38 is adapted to grasp tissue surrounding the opening to the LAA, and retract it radially inwardly to reduce the volume of and/or close the LAA. The LAA is thereafter secured in its closed orientation, and the closure catheter 38 is removed. Specific aspects of one embodiment of the closure catheter in accordance with the present invention are described in greater detail below.

[0053] The LAA may be accessed through any of a variety of pathways as will be apparent to those of skill in the art. Transeptal access, as contemplated by FIG. 2, may be achieved by introducing a transeptal catheter through the femoral or jugular vein, and transluminally advancing the catheter into the right atrium. Once in the right atrium, a long hollow needle with a preformed curve and a sharpened distal tip is forcibly inserted through the fossa ovalis. A radiopaque contrast media may then be injected through the needle to allow visualization and ensure placement of the needle in the left atrium, as opposed to being in the pericardial space, aorta, or other undesired location.

[0054] Once the position of the needle in the left atrium is confirmed, the transeptal catheter is advanced into the left atrium. The closure catheter **38** may then be advanced through the transeptal catheter **30**, and steered or directed into the left atrial appendage. Alternative approaches include venous transatrial approaches such as transvascular advancement through the aorta and the mitral valve. In addition, the devices of the present invention can be readily adapted for use in an open heart surgical procedure, although transluminal access is presently preferred.

[0055] Thus, referring to **FIG. 2**, a transeptal catheter **30** has a proximal end **32** and a distal end **34**. The distal end **34** of the transeptal catheter **30** has breached the septum **40** of the patient's heart **10** and is disposed adjacent the opening **42** of the patient's LAA **16**. The distal end **36** of a closure catheter **38** extends from the distal end **34** of the transeptal catheter **30** and into the LAA **16**.

[0056] At the proximal end **46** of the transeptal catheter **30**, a luer connector coupled to a hemostasis valve **48** prevents the egress of blood from a central lumen of the transeptal catheter **30**. The proximal end **50** of the closure catheter **38** extends proximally from the hemostasis valve **48**. Additional details concerning the use and design of transeptal access catheters are well known in the art and will not be discussed further herein.

[0057] Referring to **FIGS. 2 and 3**, the closure catheter **38** thus has a proximal end **50**, a distal end **36**, and an elongate flexible tubular body **52** extending therebetween. The axial length of the closure catheter **38** can be varied, depending upon the intended access point and pathway. For a femoral vein-transeptal approach, the closure catheter **38** generally has an axial length within the range of from about 100 cm to about 140 cm, and, in one embodiment, about 117 cm.

[0058] The outside diameter of the flexible body **52** can also be varied, depending upon the number of internal lumen and other functionalities as will be understood by those of skill in the art. In one embodiment, the outside diameter is about 12 FR (0.156 inches), and closure catheters are contemplated to have OD's generally within the range of from about 0.078 inches to about 0.250 inches. Diameters outside of the above range may also be used, provided that the functional consequences of the diameter are acceptable for the intended application of the catheter.

[0059] For example, the lower limit of the outside diameter for tubular body **52** in a given application will be a function of the number of fluid or other functional lumen contained within the catheter. In addition, tubular body **52** must have sufficient pushability to permit the catheter to be advanced to its target location within the heart without buckling or undesirable bending. The ability of the tubular body **52** to transmit torque may also be desirable, such as in embodiments in which the tissue anchor deployment guides are not uniformly circumferentially distributed about the distal end **36** of the catheter. Optimization of the outside diameter of the catheter, taking into account the flexibility, pushability and torque transmission characteristics can be accomplished through routine experimentation using conventional catheter design techniques well known to those of skill in the art.

[0060] The flexible body **52** can be manufactured in accordance with any of a variety of known techniques. In one embodiment, the flexible body **52** is extruded from any of a variety of materials such as HDPE, PEBAX, nylon, polyimide, and PEEK. Alternatively, at least a portion or all

of the length of tubular body **52** may comprise a spring coil, solid walled hypodermic needle or other metal tubing, or braided reinforced wall, as are known in the art.

[0061] The proximal end **50** of the closure catheter **38** is provided with a manifold **51**, having a plurality of access ports. Generally, manifold **51** is provided with an access port **53** which may be used as a guidewire port in an over the wire embodiment, and a deployment wire port **57**. Additional access ports such as a contrast media introduction port **55**, or others may be provided as needed, depending upon the functional requirements of the catheter.

[0062] The tubular body **52** has at least a first actuator lumen **54**, for axially movably receiving an actuator **56**. Actuator **56** extends between a proximal end **64** at about the proximal end of the closure catheter, and a distal end **66** at or near the distal end **36** of the closure catheter **38**. The distal end **66** of the actuator **56** is secured to a cap **68**. In the illustrated embodiment, the actuator lumen **54** is in communication with the access port **53** to permit the actuator **56** to extend proximally therethrough.

[0063] Actuator **56** can have a variety of forms, depending upon the construction of the anchor supports **62** on the distal end **36** of the closure catheter **38**. In general, the catheter in the area of the anchor supports **62** should have a crossing profile of no more than about 14 French for transluminal advancement and positioning. However, the anchor supports must then be capable of directing tissue anchors into the wall of the cavity or lumen which may have an inside diameter on the order of about 1.5 cm to about 3 cm in the case of the LAA in an average adult. The device of the present invention can be readily scaled up or down depending upon the intended use, such as to accommodate a 5 cm to 10 cm cavity in GI tract applications or 5 mm to about 2 cm for vascular applications. For this purpose, the anchor supports are preferably moveable between a reduced cross sectional orientation and an enlarged cross sectional orientation to aim at, and, in some embodiments, contact the target tissue surface.

[0064] One convenient construction to accomplish the foregoing is for each anchor support **62** to take the form of a lever arm structure which is pivotably connected at one end to the catheter body. This construction permits inclination of the anchor support throughout a continuous range of outside diameters which may be desirable to aim the anchor and accommodate different treatment sites and/or normal anatomical variation within the patient population.

[0065] A laterally moveable anchor support can be moved between an axial orientation and an inclined orientation in a variety of ways. One convenient way is through the use of a pull wire or other actuator which increases the diameter of the deployment zone of the catheter in response to an axial shortening of fixed length moveable segments as disclosed in more detail below. For this construction, the actuator will be under pulling tension during actuation. Any of a variety of structures such as polymeric or metal single or multiple strand wires, ribbons or tubes can be used. In the illustrated embodiment, the actuator **56** comprises stainless steel tube, having an outside diameter of about 0.025 inches.

[0066] A pull wire can alternatively be connected to the radially outwardly facing surface and preferably near the distal end of each anchor support, and each anchor support

is hingably attached at its proximal end to the catheter. Proximal traction on the pull wire will cause the anchor support to incline radially outwardly in the distal direction, and toward the target tissue.

[0067] In an alternate construction, the anchor support is inclined under a compressive force on the actuator 56. For example, the embodiment described in detail below can readily be converted to a push actuated system by axially immovably fixing the distal end of the anchor guide assembly to the catheter and slideably pushing the proximal end of the anchor guide assembly in the distal direction to achieve axial compression as will become apparent from the discussion below.

[0068] Push wire actuators have different requirements, than pull actuator systems, such as the ability to propagate a sufficient compressive force without excessive compression bending or friction. Thus, solid core wires or tubular structures may be preferred, as well as larger outside diameters compared to the minimum requirements in a pull actuated system. Thus, the inside diameter of the actuator lumen 57 may be varied, depending upon the actuator system design. In the illustrated embodiment, the actuator lumen 57 has an ID of about 0.038 inches, to slideably accommodate the 0.025 inch OD actuator 56.

[0069] A radially outwardly directed force on the anchor supports 62 can be provided by any of a variety of alternative expansion structures, depending upon desired performance and construction issues. For example, an inflatable balloon can be positioned radially inwardly from a plurality of hingably mounted anchor supports 62, and placed in communication with actuator lumen 54 which may be used as an inflation lumen. Any of a variety of balloon materials may be used, ranging in physical properties from latex for a highly compliant, low pressure system to PET for a non-compliant high pressure and consequently high radial force system, as is understood in the balloon angioplasty arts.

[0070] The tubular body 52 may additionally be provided with a guidewire lumen 57, or a guidewire lumen 57 may extend coaxially throughout the length of a tubular actuator 56 as in the illustrated embodiment.

[0071] The tubular body 52 may additionally be provided with a deployment lumen 58, for axially movably receiving one or more deployment elements 60 such as a wire, or suture for deploying one or more tissue anchors 90 into the target tissue 110. Deployment force for deploying the tissue anchors 90 can be designed to be in either the distal or proximal direction, and many of the considerations discussed above in connection with the actuator 56 and corresponding actuator lumen 54 apply to the deployment system as well. In the illustrated embodiment, deployment of the tissue anchors 90 is accomplished by proximal retraction on the deployment element 60 which, in turn, retracts deployment wire 106. Pushability is thus not an issue, and common suture such as 0.008 inch diameter nylon line may be used. For this embodiment, deployment lumen 58 has an inside diameter of about 0.038 inches. The deployment lumen 58 can be sized to receive either a single deployment element 60, or a plurality of deployment elements 106 such as a unique suture for each tissue anchor.

[0072] The distal end 36 of the closure catheter 38 is provided with one or more anchor supports 62, for removably carrying one or more tissue anchors. Preferably, two or more anchor supports 62 are provided, and, generally, in a device intended for LAA closure, from about 3 to about 12

anchor supports 62 are provided. In the illustrated embodiment, six anchor supports 62 are evenly circumferentially spaced around the longitudinal axis of the closure catheter 38.

[0073] Each anchor support 62 comprises a surface 63 for slideably retaining at least one tissue anchor, and permitting the tissue anchor to be aimed by manipulation of a control on the proximal end 50 of the closure catheter 38. Specific details of one embodiment of the anchor support 62 having a single anchor therein will be discussed below. Multiple anchors, such as two or three or more, can also be carried by each anchor support for sequential deployment.

[0074] The anchor supports 62 are movable between an axial orientation and an inclined orientation, in response to manipulation of a proximal control. The proximal control can take any of a variety of forms, such as slider switches or levers, rotatable levers or knobs, or the like, depending upon the desired performance. For example, a rotatable knob control can permit precise control over the degree of inclination of the anchor supports 62. A direct axial slider control, such as a knob or other grip directly mounted to the actuator 56 will optimize tactile feedback of events such as the anchor supports 62 coming into contact with the target tissue.

[0075] Each of the illustrated anchor supports 62 comprises at least a proximal section 70, a distal section 72, and a flex point 74. See FIG. 4. The distal end 73 of each distal section 72 is movably connected to the catheter body or the cap 68. In this embodiment, proximal retraction of the actuator 56 shortens the axial distance between the proximal end 71 of the proximal section 70 and the distal end 73 of distal section 72, forcing the flex point 74 radially outwardly from the longitudinal axis of the closure catheter 38. In this manner, proximal retraction of the actuator 56 through a controlled axial distance will cause a predictable and controlled increase in the angle between the proximal and distal sections 70 and 72 of the anchor support 62 and the longitudinal axis of the catheter. This is ideally suited for aiming a plurality of tissue anchors at the interior wall of a tubular structure, such as a vessel or the left atrial appendage.

[0076] Referring to FIG. 4, there is illustrated an enlarged detailed view of one anchor support 62 in accordance with the present invention. The proximal section 70 and distal section 72 preferably comprise a tubular wall 76 and 78 joined at the flex point 74. In one embodiment, the proximal section 70 and distal section 72 may be formed from a single length of tubing, such as by laser cutting, photolithography, or grinding to separate the proximal section 70 from the distal section 72 while leaving one or two or more integrally formed hinges at flex point 74. Any of a variety of polymeric or metal tubing may be utilized for this purpose, including stainless steel, Nitinol or other super-elastic alloys, polyimide, or others which will be appreciated by those of skill in the art in view of the disclosure herein.

[0077] In the illustrated six tube embodiment, the proximal section 70 and distal section 72 are formed from a length of PEEK tubing having an inside diameter of about .038 inches, an outside diameter of about 0.045 inches and an overall length of about 1.4 inches. In general, if more than six anchor supports 62 are used, the diameter of each will be commensurately less than in the six tube embodiment for

any particular application. When the proximal section **70** and the distal section **72** are coaxially aligned, a gap having an axial length of about .030 is provided therebetween. In the illustrated embodiment, the proximal section **70** and distal section **72** are approximately equal in length although dissimilar lengths may be desirable in certain embodiments. The length of the portion of the anchor support **62** which carries the tissue anchor **90** is preferably selected for a particular procedure or anatomy so that the anchor support **62** will be inclined at an acceptable launch angle when the deployment end of the anchor support **62** is brought into contact with the target tissue **110**. Lengths from the hinge to the deployment end of the anchor support **62** within the range of from about 0.5 cm to about 1.5 cm are contemplated for the LAA application disclosed herein.

[0078] For certain applications, the proximal section **70** is at least about 10% and preferably at least about 20% longer than the distal section **72**. For example, in one device adapted for the LAA closure application, the proximal section **70** in a six anchor device has a length of about 0.54 inches, and the distal section **72** has a length of about 0.40 inches. Each anchor support has an OD of about 0.045 inches. As with previous embodiments, the functional roles and/or the dimensions of the proximal and distal sections can be reversed and remain within the scope of the present invention. Optimization of the relative lever arm lengths can be determined for each application taking into account a variety of variables such as desired device diameter, target lumen or tissue aperture diameter, launch angle and desired pull forces for aiming and deployment.

[0079] The proximal end **71** of the proximal section **70** and distal end **73** of distal section **72** are movably secured to the closure catheter **38** in any of a variety of ways which will be apparent to those of skill in the art in view of the disclosure herein. In the illustrated embodiment, each anchor support **62** comprises a four segment component which may be constructed from a single length of tubing by providing an intermediate flex point **74**, a proximal flex point **80** and a distal flex point **82**. Distal flex point **82** provides a pivotable connection between the anchor support **62** and a distal connection segment **84**. The distal connection segment **84** may be secured to the distal end of actuator **56** by any of a variety of techniques, such as soldering, adhesives, mechanical interfit or others, as will be apparent to those of skill in the art. In the illustrated embodiment, the distal connection segment **84** is secured to the distal end **66** of the actuator **56** by adhesive bonding.

[0080] The proximal flex point **80** in the illustrated embodiment separates the proximal section **70** from a proximal connection segment **86**, which is attached to the catheter body **52**. In this construction, proximal axial retraction of the actuator **56** with respect to the tubular body **52** will cause the distal connection segment **84** to advance proximally towards the proximal connection segment **86**, thereby laterally displacing the flex point **74** away from the longitudinal axis of the closure catheter **38**. As a consequence, each of the proximal section **70** and the distal section **72** are aimed at an angle which is inclined outwardly from the axis of the closure catheter **38**.

[0081] In general, each flex point **80**, **82** includes a hinge **81**, **83** which may be, as illustrated, a strip of flexible material. The hinges **81** and **83** are preferably positioned on the inside radius of the flex points **80**, **82**, respectively, for many construction materials. For certain materials, such as Nitinol or other superelastic alloys, the hinges **81** and **83** can

be positioned at approximately 90° or 180° or other angle around the circumference of the tubular anchor guide from the inside radius of the flex point.

[0082] A tissue anchor **90** is illustrated as positioned within the distal section **72**, for deployment in a generally proximal direction. Alternatively, the anchor **90** can be loaded in the proximal section **70**, for distal deployment. A variety of tissue anchors can be readily adapted for use with the closure catheter **38** of the present invention, as will be appreciated by those of skill in the art in view of the disclosure herein. In the illustrated embodiment, the tissue anchor **90** comprises a tubular structure having a body **92**, and one or more barbs **94**. Tubular body **92** is coaxially movably disposed about an introducer **96**. Introducer **96** has a proximal section **98**, and a sharpened distal tip **100** separated by an elongate distal section **102** for slideably receiving the tissue anchor **90** thereon.

[0083] The tissue anchor **90** in the illustrated embodiment comprises a tubular body **92** having an axial length of about 118 inches, an inside diameter of about 0.017 inches and an outside diameter of about 0.023 inches. Two or more barbs **94** may be provided by laser cutting a pattern in the wall of the tube, and bending each barb **94** such that it is biased radially outwardly as illustrated. The tissue anchor **90** may be made from any of a variety of biocompatible metals such as stainless steel, Nitinol, Elgiloy or others known in the art. Polymeric anchors such as HDPE, nylon, PTFE or others may alternatively be used. For embodiments which will rely upon a secondary closure structure such as staples, sutures or clips to retain the LAA or other cavity closed, the anchor may comprise a bioabsorbable or dissolvable material so that it disappears after a period of time. An anchor suture **108** is secured to the anchor.

[0084] In one embodiment of the invention, the introducer **96** has an axial length of about 0.250 inches. The proximal section **98** has an outside diameter of about 0.023 inches and an axial length of about 0.100 inches. The distal section **102** has an outside diameter of about 0.016 inches and an axial length of about 0.150 inches. The outside diameter mismatch between the proximal section **98** and the distal section **102** provides a distally facing abutment **104**, for supporting the tubular body **92** of tissue anchor **90**, during the tissue penetration step. A deployment wire (e.g., a suture) **106** is secured to the proximal end **98** of the introducer **96**. The introducer **96** may be made in any of a variety of ways, such as extrusion or machining from stainless steel tube stock.

[0085] Referring to FIGS. 6A-6C, introduction of the tissue anchor **90** into target tissue **110** is illustrated following inclination of the anchor support **62** with respect to the longitudinal axis of the closure catheter **38**. Proximal retraction of the deployment wire **106** causes the tissue anchor **90** and introducer **96** assembly to travel axially through the distal section **72**, and into the tissue **110**. Continued axial traction on the deployment wire **106** causes the longitudinal axis of the introducer **96** to rotate, such that the introducer **96** becomes coaxially aligned with the longitudinal axis of the proximal section **70**. Continued proximal traction on the deployment wire **106** retracts the introducer **96** from the tissue anchor **90**, leaving the tissue anchor **90** in place within the tissue. The anchor suture **108** remains secured to the tissue anchor **90**, as illustrated in FIG. 6C.

[0086] In use, the closure catheter **38** is percutaneously introduced into the vascular system and transluminally advanced into the heart and, subsequently, into the left atrial appendage using techniques which are known in the art.

Referring to **FIG. 7**, the distal end **36** of the closure catheter **38** is positioned at about the opening of the LAA **16**, and the position may be confirmed using fluoroscopy, echocardiography, or other imaging. The actuator **56** is thereafter proximally retracted, to incline the anchor supports **62** radially outwardly from the longitudinal axis of the closure catheter **38**, as illustrated in **FIG. 8**. Preferably, the axial length of the proximal section **70** of each anchor support **62**, in combination with the angular range of motion at the proximal flex point **80**, permit the flex point **74** to be brought into contact with the tissue surrounding the opening to the LAA. In general, this is preferably accomplished with the distal section **72** inclined at an angle within a range of from about 45° to about 120° with respect to the longitudinal axis of the closure catheter **38**. Actuator **56** may be proximally retracted until the supports **62** are fully inclined, or until tactile feedback reveals that the anchor supports **62** have come into contact with the surrounding tissue **110**.

[0087] Following inclination of the anchor supports **62**, the deployment wire **106** is proximally retracted thereby advancing each of the tissue anchors **90** into the surrounding tissue **110** as has been discussed. See **FIG. 9**. The anchor supports **62** are thereafter returned to the first, axial position, as illustrated in **FIG. 10**, for retraction from the left atrial appendage. Proximal retraction on the anchor sutures **108** such as through a tube, loop or aperture will then cause the left atrial appendage wall to collapse as illustrated in **FIG. 11**. Anchor sutures may thereafter be secured together using any of a variety of conventional means, such as clips, knots, adhesives, or others which will be understood by those of skill in the art. Alternatively, the LAA may be sutured, pinned, stapled or clipped shut, or retained using any of a variety of biocompatible adhesives.

[0088] In an alternate embodiment, a single suture is slideably connected to the at least three and preferably five or more anchors such that proximal retraction of the suture following deployment of the anchors draws the tissue closed in a "purse string" fashion. A similar technique is illustrated in **FIGS. 31A and 31B** in U.S. Pat. No. 5,865,791 to Whayne, et al., the disclosure of which is incorporated in its entirety herein by reference.

[0089] The foregoing closure techniques may be accomplished through the closure catheter, or through the use of a separate catheter. The closure catheter may thereafter be proximally retracted from the patient, and the percutaneous and vascular access sites closed in accordance with conventional puncture closure techniques.

[0090] In accordance with a further aspect of the present invention, the closure catheter **38** with modifications identified below and/or apparent to those of skill in the art in view of the intended application, may be utilized to close any of a variety of tissue apertures. These include, for example, atrial septal defects, ventricle septal defects, patent ductus arteriosus, patent foramen ovale, and others which will be apparent to those of skill in the art. Tissue aperture closure techniques will be discussed in general in connection with **FIGS. 12-17**.

[0091] Referring to **FIG. 12**, there is schematically illustrated a fragmentary view of a tissue plane **120** such as a septum or other wall of the heart. Tissue plane **120** contains an aperture **122**, which is desirably closed. The closure catheter **38** is illustrated such that at least a portion of the distal end **36** extends through the aperture **122**. Although the present aspect of the invention will be described in terms of

a retrograde or proximal tissue anchor advancement from the back side of the tissue plane, the anchor deployment direction can readily be reversed by one of ordinary skill in the art in view of the disclosure herein, and the modifications to the associated method would be apparent in the context of a distal anchor advancement embodiment. In general, the proximal anchor advancement method, as illustrated, may desirably assist in centering of the catheter within the aperture, as well as permitting positive traction to be in the same direction as anchor deployment.

[0092] Closure catheter **38** is provided with a plurality of anchor supports **62** as have been described previously herein. In an embodiment intended for atrial septal defect closure, anywhere within the range of from about 3 to about 12 anchor supports **62** may be utilized.

[0093] Referring to **FIG. 13**, each anchor support **62** comprises a proximal section **70**, a distal section **72**, and a hinge or flex point **74** therebetween as has been previously discussed. At least one anchor **90** is carried by each anchor support **62**, such as within the tubular distal section **72** in the context of a proximal deployment direction embodiment. Anchor **90** is connected to an anchor suture **108** as has been discussed. In the illustrated embodiment, the anchor suture **108** extends along the outside of the anchor support **62** and into the distal opening of a lumen in tubular body **52**. The anchor sutures **108** may, at some point, be joined into a single element, or distinct anchor sutures **108** may extend throughout the length of the catheter body to the proximal end thereof.

[0094] As shown in **FIG. 13**, the anchor support **62** is advanced from a generally axially extending orientation to an inclined orientation to facilitate deployment of the anchor **90** into the tissue plane **120** adjacent aperture **122**. Preferably, the geometry of the triangle defined by distal section **72**, proximal section **70** and the longitudinal axis of the catheter is selected such that the plurality of anchors **90** will define a roughly circular pattern which has a greater diameter than the diameter of aperture **122**. Thus, the length of proximal section **70** will generally be greater than the approximate radius of the aperture **122**.

[0095] In general, for atrial septal defect applications, the circle which best fits the anchor deployment pattern when the distal section **72** is inclined to its operative angle will have a diameter within the range of from about 0.5 centimeters to about 3 centimeters. Dimensions beyond either end of the foregoing range may be desirable to correct defects of unusual proportions. In addition, it is not necessary that the anchors define a circular pattern when deployed into the tissue plane **120**. Non-circular patterns such as polygonal, elliptical, oval or other, may be desirable, depending upon the nature of the aperture **122** to be closed.

[0096] **FIG. 13** illustrates the anchors **90** partially deployed into or through the tissue plane **120**. In general, the anchors **90** may either be designed to reside within the tissue plane **120** such as for locations of the aperture **120** which are adjacent relatively thick tissues. Alternatively, the tissue anchor **90** may be designed to reside on one side of the tissue plane **120**, and attached to a suture which extends through the tissue plane **120** as illustrated in **FIGS. 14 and 15**.

[0097] Referring to **FIG. 14**, the closure catheter **38** is illustrated as returned to the generally axial orientation and proximally retracted through the aperture **122** following deployment of a plurality of tissue anchors **90**. The anchor sutures **108** may thereafter be proximally retracted from the

proximal end of the closure catheter **38**, thereby drawing the tissue surrounding aperture **122** together to close the aperture. The anchor sutures **108** may thereafter be secured together in any of a variety of manners, such as by clamping, knotting, adhesives, thermal bonding or the like.

[0098] In the illustrated embodiment, the closure catheter **38** carries a detachable clamp **124** which may be deployed from the distal end of the closure catheter **38** such as by a push wire, to retain the anchor sutures **108**. The clamp **124** may be an annular structure with an aperture therein for receiving the anchor sutures **108**. The clamp is carried on the catheter in an "open" position and biased towards a "closed" position in which it tightens around the sutures **108**. A ring of elastomeric polymer or a shape memory metal alloy may be used for this purpose. Any of a variety of clamps, clips, adhesives, or other structures may be utilized to secure the anchor sutures **108** as will be appreciated by those of skill in the art in view of the disclosure herein. Anchor sutures **108** may thereafter be severed such as by mechanical or thermal means, and the closure catheter **38** is thereafter retracted from the treatment site.

[0099] In accordance with a further aspect of the present invention, the closure catheter **38** is provided with a deployable patch **126**, as illustrated in FIGS. 16 and 17. The patch **126** may comprise of any of a variety of materials, such as PTFE, Dacron, or others depending upon the intended use. Suitable fabrics are well-known in the medical device art, such as those used to cover endovascular grafts or other prosthetic devices.

[0100] The patch **126** is preferably carried by the distal sections **72** of the anchor support **62**. In the illustrated embodiment, the tissue anchors **90** are carried within the proximal section **70** of anchor support **62**. In this manner, as illustrated in FIG. 17, the patch **126** is automatically unfolded and positioned across the aperture **122** as the anchor supports **62** are inclined into the anchor deployment orientation. The tissue anchor **90** may thereafter be advanced through the patch **126** and into the tissue plane **120** to tack the patch **126** against the opening **122**. Alternatively, the tissue anchors may be deployed in a pattern which surrounds but does not penetrate the tissue patch. In this embodiment, the tissue anchors are preferably connected to the tissue patch such as by a suture. The tissue anchors may also both be connected to the patch or to each other by sutures and penetrated through the patch into the target tissue.

[0101] Tissue anchors **90** may be deployed proximally by pulling the deployment wire **106**. Alternatively, tissue anchors **90** with or without an anchor suture **108**, may be deployed from the proximal section **70** by a push wire axially movably positioned within the proximal section **70**. Tissue anchors **90** may be carried on an introducer **96** as has been discussed previously herein.

[0102] The patch **126** may be retained on the distal section **72** in any of a variety of ways, such as through the use of low strength adhesive compositions, or by piercing the anchors **90** through the material of the patch **126** during the catheter assembly process.

[0103] Referring to FIGS. 18 through 20, there is disclosed an alternate anchor **90** in accordance with the present invention. The anchor **90** may be utilized to anchor a suture within a solid tissue mass, or, as illustrated in FIG. 20, to secure a graft or patch to a tissue plane.

[0104] Referring to FIG. 18, anchor **90** comprises a proximal end **130**, a distal end **132** and a central lumen **134** extending therebetween. Central lumen **134** allows the anchor **90** to be positioned on an introducer **96** as is illustrated in FIG. 19, and has been previously discussed.

[0105] The anchor **90** is provided with at a least first proximal projection **136** and a second proximal projection **138**. First and second proximal projections **136** and **138** are designed to enlarge radially outwardly in response to axial compression of the anchor **90**. Thus, in an uncompressed configuration such as that illustrated in FIG. 19, the first and second proximal projections **136** and **138** extend generally in parallel with the longitudinal axis of the anchor **90**. A distally facing tissue contact surface **144** is forced to incline radially outwardly in response to axial shortening of the anchor **90**, as will be apparent to those of skill in the art in view of the illustration in FIG. 18. Although illustrated with two proximal projections positioned at approximately 180° apart from each other, three or four or more proximal projections may be provided, preferably evenly distributed about the circumference of the anchor **90**.

[0106] At least a first distal projection **140**, and preferably a second distal projection **142** are provided on the tubular body **92** spaced distally apart from the proximal projections. First and second distal projections **140** and **142** similarly expand or enlarge radially outwardly in response to axial compression of the anchor **90**. Axial separation between the first proximal projection **136** and first distal projection **140** allows the anchor **90** to secure a patch **126** or graft or other structure to a tissue plane **120** as illustrated in FIG. 20, by sandwiching the patch **126** and tissue plane **120** between distally facing tissue contact surface **144** and proximally facing tissue contact surface **146**. The anchor **90** can be deployed from the introducer **96**, utilizing any of the deployment catheters disclosed elsewhere herein.

[0107] The radial enlargement of the proximal and distal projections is accomplished by axially shortening the anchor **90** along its longitudinal axis. This may be accomplished by preventing proximal movement of proximal end **130** by seating the proximal end **130** against the proximal section **98** of an introducer **96**, such as illustrated in FIG. 19. The distal end **132** is thereafter advanced proximally, such as by proximal traction on a proximal force transmitter **148** which may be a suture **150**. Suture **150** may extend in a loop through a plurality of apertures **152**, extending through the proximal and distal projections. Alternatively, the suture **150** may extend alongside the anchor **90** or through central lumen **134** depending upon the tolerance between the central lumen **134** and the introducer **96**. Alternative proximal force transmitter structures may also be utilized, as will be apparent to those of skill in the art.

[0108] The anchor **90** may be manufactured in a variety of ways, such as by cutting or etching from a metal or polymeric tube. Preferably, the anchor **90** is laser cut from a Nitinol or steel tube having an outside diameter within the range of from about 0.014" to about 0.038" and an axial length within the range of from about 0.050" to about 0.250". The axial length of each of the distally facing tissue contact surface **144** and proximally facing tissue contact **146** is within the range of from about 0.010" to about 0.060". The wall thickness of the tube is within the range of from about 0.002" to about 0.012". Full axial compression of most metal

tube embodiments will bend the metal beyond its elastic limit at each apex on the various projections, such that the suture **150** may be removed from the anchor **190** following deployment and the anchor will remain in its deployed (axially compressed) configuration as illustrated in **FIG. 20**.

[0109] Although illustrated primarily as an embodiment intended for attaching a patch or other membrane to a tissue plane, the anchor **90** illustrated in **FIG. 18** may also be used to anchor a suture to a solid tissue mass as discussed previously herein. For this purpose, the anchor may be simplified to include only a first and second proximal projection **136** and **138**, or additional projections in the same plane as the first and second proximal projections. However, first and second distal projections or additional projections may be added, depending upon the desired pull force required to dislodge the anchor **90** from the implanted position within the tissue.

[0110] The cardiac defects may be accessed via catheter through a variety of pathways. An ASD or VSD may be accessed from the arterial circuit. The catheter is introduced into the arterial vascular system and guided up the descending thoracic and/or abdominal aorta. The catheter may then be advanced into the left ventricle (LV) through the aortic outflow tract. Once in the LV, the patch may be deployed in the VSD. Alternatively, once in the LV, the patch may be directed up through the mitral valve and into the left atrium (LA). When the patch is in the LA, it may be directed into the ASD and installed.

[0111] Alternatively, an ASD or VSD may be accessed from the venous circuit. The catheter with a patch thereon may be introduced into the venous system, advanced into the Inferior Vena Cava (IVC) or Superior Vena Cava (SVC) and guided into the right atrium (RA). The patch may then be directed into the ASD. Alternatively, once in the RA, the patch may be advanced through the tricuspid valve and into the right ventricle (RV) and directed into the VSD and installed.

[0112] Referring to **FIGS. 21A-21G**, there are illustrated a variety of tissue anchors which may be used in the tissue closure or attachment device of the present invention. Each of **FIGS. 21A and 21B** disclose an anchor having a body **92**, a distal tip **101**, and one or more barbs **94** to resist proximal movement of the anchor. An aperture **107** is provided to receive the anchor suture. The embodiments of **FIG. 21A and 21B** can be readily manufactured such as by stamping or cutting out of flat sheet stock.

[0113] The anchor illustrated in **FIG. 21C** comprises a wire having a body **92** and a distal tip **101**. The wire preferably comprises a super-elastic alloy such as Nitinol or other nickel titanium-based alloy. The anchor is carried within a tubular introducer, in a straight orientation, for introduction into the tissue where the anchor is to reside. As the body **92** is advanced distally from the carrier tube, the anchor resumes its looped distal end configuration within the tissue, to resist proximal retraction on the wire body **92**.

[0114] **FIG. 21D** illustrates a tubular anchor, which may be manufactured from a section of hypotube, or in the form of a flat sheet which is thereafter rolled about a mandrel and soldered or otherwise secured. The anchor comprises a distal

tip **101**, one or more barbs **94**, and an aperture **107** for securing the anchor suture. The anchor of **FIG. 21D** may be carried by and deployed from the interior of a tubular anchor support as has been discussed. Alternatively, the anchor of **FIG. 21D** can be coaxially positioned over a central tubular or solid anchor support wire.

[0115] **FIG. 21E** illustrates an anchor which may be formed either by cutting from tube stock or by cutting a flat sheet such as illustrated in **FIG. 21F** which is thereafter rolled about an axis and soldered or otherwise secured into a tubular body. In this embodiment, three distal tips **101** in the flat sheet stock may be formed into a single distal tip **101** in the finished anchor as illustrated in **FIG. 21E**. One or more barbs **94** may be formed by slotting the sheet in a U or V-shaped configuration as illustrated. The anchor in **FIG. 21E** is additionally provided with one or more barbs **95** which resist distal migration of the anchor. This may be desirable where the anchor is implanted across a thin membrane, or in other applications where distal as well as proximal migration is desirably minimized.

[0116] Although the present invention has been described in terms of certain preferred embodiments, other embodiments will become apparent to those of skill in the art in view of the disclosure herein. Accordingly, the scope of the invention is not intended to be limited by the specific disclosed embodiments, but, rather, by the attached claims.

What is claimed is:

1. A method of closing an opening in a subcutaneous tissue plane, comprising the steps of:

providing a catheter having a patch and at least one anchor thereon;

advancing the catheter to the opening;

positioning the patch across the opening; and

advancing the anchor into tissue to secure the patch across the opening.

2. A method of closing an opening in a subcutaneous tissue plane as in claim 1, wherein the advancing the anchor step comprises advancing the anchor through the patch and into the tissue.

3. A method of closing an opening in a subcutaneous tissue plane as in claim 1, wherein the advancing the anchor step comprises advancing at least three anchors into the tissue to secure the patch across the opening.

4. A method of closing an opening in a subcutaneous tissue plane as in claim 1, wherein the opening is a naturally occurring opening.

5. A method of closing an opening in a subcutaneous tissue plane as in claim 4, wherein the opening is an atrial septal defect.

6. A method of closing an opening in a subcutaneous tissue plane as in claim 1, wherein the opening is a surgically created opening.

7. A method of closing an opening in a subcutaneous tissue plane as in claim 1, further comprising the step of unfolding the patch from a reduced configuration to an enlarged configuration prior to the advancing the anchor step.

* * * * *