



(86) Date de dépôt PCT/PCT Filing Date: 2015/10/28
 (87) Date publication PCT/PCT Publication Date: 2016/05/06
 (45) Date de délivrance/Issue Date: 2023/02/14
 (85) Entrée phase nationale/National Entry: 2017/04/25
 (86) N° demande PCT/PCT Application No.: US 2015/057709
 (87) N° publication PCT/PCT Publication No.: 2016/069688
 (30) Priorité/Priority: 2014/10/28 (US14/526,395)

(51) Cl.Int./Int.Cl. *A61M 5/145* (2006.01),
A61M 5/31 (2006.01)

(72) Inventeurs/Inventors:
 COWAN, KEVIN P., US;
 TUCKER, BARRY L., US;
 UBER, ARTHUR E., III, US;
 RHINEHART, EDWARD J., US;
 SPOHN, MICHAEL A., US;
 NEIL, JAMES R., US;
 WILLIAMS, GLEN P., US

(73) Propriétaire/Owner:
 BAYER HEALTHCARE LLC, US

(74) Agent: SMART & BIGGAR LP

(54) Titre : SERINGUE AUTO-ORIENTEE ET INTERFACE DE SERINGUE
 (54) Title: SELF-ORIENTING SYRINGE AND SYRINGE INTERFACE

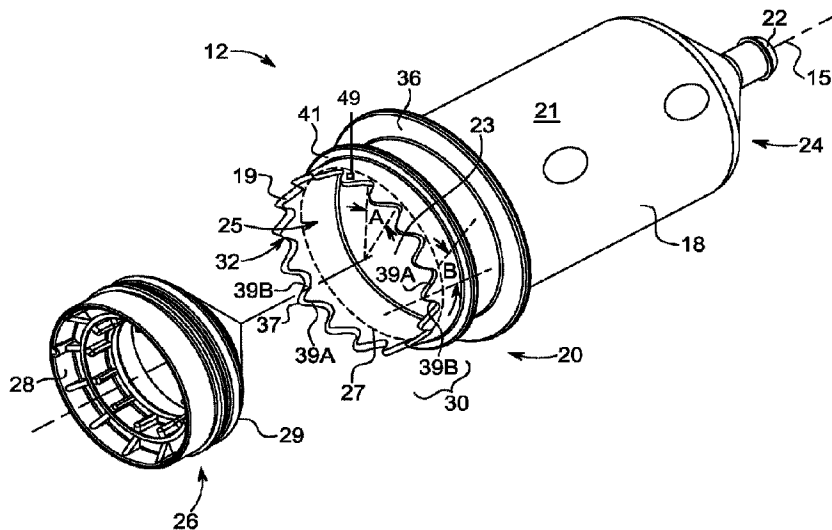

(57) Abrégé/Abstract:

A syringe includes a barrel having a distal end, a proximal end, and a sidewall extending therebetween along a longitudinal axis. At least one engagement member protrudes from a terminal portion of the sidewall in a proximal direction along the longitudinal axis. The at least one engagement member tapers axially in a direction from the distal end toward the proximal end. The at least one engagement member is configured for engagement with a locking mechanism of a fluid injector to releasably lock the syringe with the fluid injector. A taper of the at least one engagement member is configured to rotationally guide the syringe into alignment with the locking mechanism and axially eject the syringe upon rotation of the syringe. The locking mechanism operatively engages the at least one engagement member regardless of an orientation of the syringe about the longitudinal axis relative to the injector.

(12) INTERNATIONAL APPLICATION PUBLISHED UNDER THE PATENT COOPERATION TREATY (PCT)

(19) World Intellectual Property
Organization
International Bureau(43) International Publication Date
6 May 2016 (06.05.2016)(10) International Publication Number
WO 2016/069688 A1

- (51) **International Patent Classification:**
A61M 5/145 (2006.01)
- (21) **International Application Number:**
PCT/US2015/057709
- (22) **International Filing Date:**
28 October 2015 (28.10.2015)
- (25) **Filing Language:** English
- (26) **Publication Language:** English
- (30) **Priority Data:**
14/526,395 28 October 2014 (28.10.2014) US
- (71) **Applicant:** BAYER HEALTHCARE LLC [US/US]; 100 Bayer Blvd., Whippany, NJ 07981 (US).
- (72) **Inventors:** COWAN, Kevin, P.; 4242 Estates Court, Allison Park, PA 15101 (US). TUCKER, Barry, L.; 219 McGregor Drive, Verona, PA 15147 (US). UBER, Arthur, E., III; 7426 Ben Hur Street, Pittsburgh, PA 15208 (US). RHINEHART, Edward, J.; 1780 McClure Road, Monroeville, PA 15146 (US). SPOHN, Michael, A.; 2814 Old Route 422 East, Fenelton, PA 16034 (US). NEIL, James, R.; 213 Merriwood Drive, Oakdale, PA 15071 (US). WILLIAMS, Glen, P.; 213 Sycamore Ridge Drive, Springdale, PA 15144 (US).
- (74) **Agents:** KENT, Joseph, L. et al.; Bayer Healthcare LLC, 100 Bayer Blvd., Whippany, NJ 07981 (US).
- (81) **Designated States** (*unless otherwise indicated, for every kind of national protection available*): AE, AG, AL, AM, AO, AT, AU, AZ, BA, BB, BG, BH, BN, BR, BW, BY, BZ, CA, CH, CL, CN, CO, CR, CU, CZ, DE, DK, DM, DO, DZ, EC, EE, EG, ES, FI, GB, GD, GE, GH, GM, GT, HN, HR, HU, ID, IL, IN, IR, IS, JP, KE, KG, KN, KP, KR, KZ, LA, LC, LK, LR, LS, LU, LY, MA, MD, ME, MG, MK, MN, MW, MX, MY, MZ, NA, NG, NI, NO, NZ, OM, PA, PE, PG, PH, PL, PT, QA, RO, RS, RU, RW, SA, SC, SD, SE, SG, SK, SL, SM, ST, SV, SY, TH, TJ, TM, TN, TR, TT, TZ, UA, UG, US, UZ, VC, VN, ZA, ZM, ZW.
- (84) **Designated States** (*unless otherwise indicated, for every kind of regional protection available*): ARIPO (BW, GH, GM, KE, LR, LS, MW, MZ, NA, RW, SD, SL, ST, SZ, TZ, UG, ZM, ZW), Eurasian (AM, AZ, BY, KG, KZ, RU, TJ, TM), European (AL, AT, BE, BG, CH, CY, CZ, DE, DK, EE, ES, FI, FR, GB, GR, HR, HU, IE, IS, IT, LT, LU, LV, MC, MK, MT, NL, NO, PL, PT, RO, RS, SE, SI, SK, SM, TR), OAPI (BF, BJ, CF, CG, CI, CM, GA, GN, GQ, GW, KM, ML, MR, NE, SN, TD, TG).
- Published:**
— with international search report (Art. 21(3))

(54) **Title:** SELF-ORIENTING SYRINGE AND SYRINGE INTERFACE

FIG. 1B

(57) **Abstract:** A syringe includes a barrel having a distal end, a proximal end, and a sidewall extending therebetween along a longitudinal axis. At least one engagement member protrudes from a terminal portion of the sidewall in a proximal direction along the longitudinal axis. The at least one engagement member tapers axially in a direction from the distal end toward the proximal end. The at least one engagement member is configured for engagement with a locking mechanism of a fluid injector to releasably lock the syringe with the fluid injector. A taper of the at least one engagement member is configured to rotationally guide the syringe into alignment with the locking mechanism and axially eject the syringe upon rotation of the syringe. The locking mechanism operatively engages the at least one engagement member regardless of the orientation of the syringe about the longitudinal axis relative to the injector.

WO 2016/069688 A1

SELF-ORIENTING SYRINGE AND SYRINGE INTERFACE

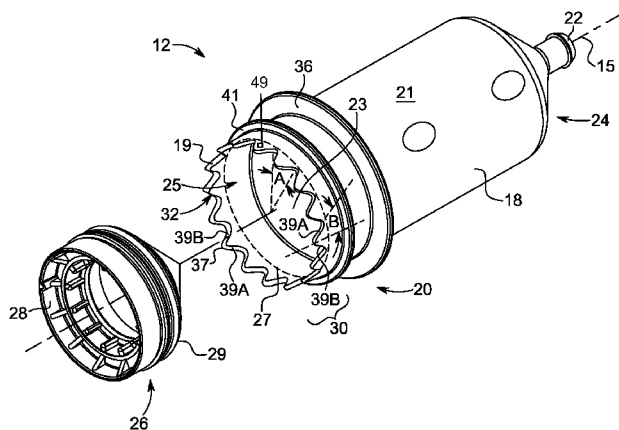
BACKGROUND OF THE DISCLOSURE

Field of the Disclosure

[0001] The present disclosure relates generally to a system including a self-orienting, front-loading syringe for use with a fluid injector and, further, to a connection interface for securing the syringe to the fluid injector and to a method for loading and removal of the syringe to and from the fluid injector.

Description of Related Art

[0002] In many medical diagnostic and therapeutic procedures, a medical practitioner, such as a physician, injects a patient with one or more medical fluids. In recent years, a number of injector-actuated syringes and fluid injectors for pressurized injection of medical fluids, such as a contrast solution (often referred to simply as “contrast”), a flushing agent, such as saline, and other medical fluids have been developed for use in procedures such as angiography, computed tomography (CT), ultrasound, magnetic resonance imaging (MRI), positron emission tomography (PET), and other molecular imaging procedures. In general, these fluid injectors are designed to deliver a preset amount of fluid at a preset pressure and/or flow rate.

[0003] In some injection procedures, the medical practitioner places a catheter or a needle connected to tubing, or other fluid delivery connection into a vein or artery of the patient. The catheter or the tubing is connected to either a manual or to an automatic fluid injection mechanism. Automatic fluid injection mechanisms typically include at least one syringe connected to at least one fluid injector having, for example, at least one powered linear piston. The at least one syringe includes, for example, a source of contrast and/or a source of flushing fluid. The medical practitioner enters settings into an electronic control system of the fluid injector for a fixed volume of contrast and/or saline and a fixed rate of injection for each.

[0004] The injected contrast and/or saline are delivered to a patient’s vasculature through the catheter or needle inserted into the patient’s body, such as the patient’s arm or groin area. A dose of contrast is referred to as a bolus. Once the bolus of contrast is delivered to the desired site, that area is imaged using a conventional imaging technique, such as angiography imaging or scanning, computed tomography (CT), ultrasound, magnetic resonance imaging (MRI), positron emission tomography (PET), and other molecular imaging procedures. The

presence of the contrast becomes clearly visible against the background of the surrounding tissue.

[0005] Various front-loading connection interfaces have been developed to facilitate the loading and removal of the syringe to and from the fluid injector. In some embodiments, the syringe having a retention feature is inserted into a syringe port on the fluid injector by aligning the syringe with a corresponding locking feature provided on the fluid injector. It is often necessary for the medical practitioner to manually align the retention feature of the syringe with the corresponding locking feature on the fluid injector before the syringe can be loaded onto the injector. In some cases, there are only one or two alignments, such as shown in United States Patent No. 6,336,913. In this syringe, the operator must manually rotate the syringe to find an alignment that allows the syringe to engage the fluid injector. It is then necessary for the operator to manually rotate the syringe relative to the locking feature to create a strong enough engagement for operation of the injector. In another syringe disclosed in US 6,652,489, there is no need to rotationally align the syringe or to rotate the syringe for installation or engagement. To remove the syringe, the operator must rotate the syringe at least 45 degrees, and more commonly 90 degrees, about its longitudinal axis to disengage the locking mechanism. After rotation, the operator must then physically pull the syringe out of the injector. In some embodiments, the operator must pull on the syringe at the same time while rotating the syringe. Such syringe injector features require additional time and effort to load/remove the syringe from the injector, resulting in increased time for a medical injection procedure.

[0006] Accordingly, there is a need in the art for an improved syringe and injector attachment, interface, and/or locking feature that allows the operator to more easily disengage or release the syringe from the fluid injector, for example to relieve the operator of the effort of simultaneously pulling and rotating the syringe. There is a further need in the art for reducing or eliminating the need for rotationally aligning the syringe with the fluid injector during installation of the syringe on the fluid injector. While various syringes, syringe connection interfaces and methods are known in the medical field, improved syringes, connection interfaces between the syringe and the fluid injector and methods for loading and removing the syringe to and from the fluid injector continue to be in demand.

SUMMARY OF DISCLOSURE

[0007] In view of certain disadvantages of the existing connection interfaces between the syringe and the fluid injector, there is a need in the art for an improved syringe and connection interface between the syringe and the fluid injector that overcomes the deficiencies of the prior art. There is an additional need for improved methods for loading or installing and removing the syringe to and from the fluid injector so that the syringe does not have to be rotationally aligned about its longitudinal axis relative to the fluid injector to allow loading or removal of the syringe to and from the fluid injector.

[0008] In one embodiment, a syringe may include a barrel having a distal end, a proximal end, and a substantially circumferential sidewall extending between the distal end and the proximal end along a longitudinal axis. At least one engagement member may protrude from a terminal portion at the proximal end of the sidewall in a proximal direction along the longitudinal axis. The at least one engagement member may taper axially and/or circumferentially in a direction from the distal end toward the proximal end. The at least one engagement member may be configured for engagement with a locking mechanism of a fluid injector to releasably position the syringe within a syringe port of the fluid injector. A taper of the at least one engagement member may be configured to rotationally guide the syringe into alignment with the locking mechanism and axially eject the syringe upon rotation of the syringe.

[0009] In another embodiment, a plurality of engagement members may extend about at least a portion of a circumference of the terminal portion. The plurality of engagement members may be spaced apart evenly or unevenly about the circumference of the terminal portion. In certain embodiments, the at least one engagement member may have a wave form or a substantially sinusoidal form. In other embodiments, the at least one engagement member may have a pointed proximal end with at least one tapered surface that extends from the pointed proximal end in a distal direction along the longitudinal axis to the terminal portion of the sidewall. The pointed proximal end of the at least one engagement member may have a sharp or rounded point. The at least one tapered surface may be angled relative to a direction of the longitudinal axis. The at least one tapered surface may be linear, curvilinear, continuous, discontinuous, or planar. In some embodiments, an encoding device may be provided on at least a portion of the syringe, such as on at least one of the at least one engagement member. In certain embodiments, the at least one engagement member may be

monolithically formed with the terminal portion of the sidewall. The at least one engagement member may have a circular, triangular, or a polygonal shape. In other embodiments, the at least one engagement member may be separable from the terminal portion of the sidewall.

[0010] In another embodiment, a retention flange may protrude radially outwardly from the outer surface of the sidewall relative to the longitudinal axis and distally of the at least one engagement member for engaging with the locking mechanism of the fluid injector to releasably lock the syringe with the syringe port of the fluid injector. The retention flange may extend around at least a portion of the outer surface of the sidewall. The retention flange may interact with at least one deflectable retaining element to retain the syringe within the locking mechanism. In certain embodiments, the retention flange may have a longitudinal stop surface for limiting a length of a longitudinal insertion of the syringe into the locking mechanism. A plunger may be slidably disposed within the barrel of the syringe and movable between the proximal end and the distal end. The syringe may further include a drip flange distal to the retention flange for preventing medical fluid from dripping from the distal end of the syringe into a syringe port of a medical injector and fouling the interior workings of the medical injector.

[0011] In another embodiment, a fluid injection apparatus may include at least one syringe having a barrel with a distal end, a proximal end, and a substantially circumferential sidewall extending between the distal end and the proximal end along a longitudinal axis. The barrel may have at least one engagement member protruding from a terminal portion of the proximal end of the sidewall in a proximal direction along the longitudinal axis. The at least one engagement member may taper axially and/or circumferentially in a direction from the distal end toward the proximal end. The fluid injection apparatus may further include an injector having an injector housing defining at least one syringe port for receiving the proximal end of the at least one syringe. A locking mechanism may be associated with the at least one syringe port for releasably securing the at least one syringe within the at least one syringe port. The locking mechanism may be configured for engaging the at least one engagement member of the syringe to releasably position the at least one syringe. A taper of the at least one engagement member may be configured to rotationally guide the syringe into self-alignment with the locking mechanism and axially eject the syringe upon rotation of the syringe within the locking mechanism. In certain embodiments, rotation of the syringe

within the locking mechanism disengages the retention flange from the at least one deflectable retaining element prior to axially ejecting the syringe.

[0012] In yet another embodiment, the locking mechanism may include a housing having a central opening configured to receive the proximal end of the at least one syringe. A guide ring may be fixed relative to the housing with a central axis of the guide ring in coaxial alignment with a central axis of the housing. The guide ring may have at least one recess extending from an inner circumference of the guide ring to an outer circumference of the guide ring. At least one deflectable retaining element may be configured to be movably received within the at least one recess of the guide ring. A lock/release ring may be configured for engagement with the at least one engagement member when the at least one syringe is inserted into the at least one syringe port. The lock/release ring may be rotatable relative to the housing with a rotation of the at least one syringe about the longitudinal axis. At least one elastically resilient member may be connected at one end to at least a portion of the at least one deflectable retaining element to urge the at least one deflectable retaining element in a radially inward direction to disengage a retention flange on the at least one syringe.

[0013] In another embodiment, the at least one deflectable retaining element may have a locking lip that is angled relative to the longitudinal axis such that movement of the at least one syringe in a proximal direction causes movement of the at least one deflectable retaining element in a radially outward direction. The lock/release ring may include one or more syringe engagement members that have a complementary shape to receive the at least one engagement member. The lock/release ring may include at least one guide slot disposed on a top surface to guide a movement of the at least one deflectable retaining element. The at least one guide slot may include at least one guide track. The at least one deflectable retaining element may engage the at least one guide track at a first end when the at least one deflectable retaining element is in a first radial position, and may engage the at least one guide track at a second end when the at least one deflectable retaining element is in a second radial position that is different than the first radial position. Lateral edges of the at least one recess may define a travel path for guiding movement of the at least one deflectable retaining element. At least a portion of a top surface of the guide ring may define a stop surface that limits a movement of the at least one syringe in a proximal direction when the at least one syringe is inserted into the at least one syringe port.

[0014] In a further embodiment, a syringe may include a barrel having a distal end, a proximal end, and a substantially circumferential sidewall extending between the distal end and the proximal end along a longitudinal axis. At least one engagement member may protrude from a terminal portion of the proximal end of the sidewall in a proximal direction along the longitudinal axis. The at least one engagement member may taper axially and/or circumferentially in a direction from the distal end toward the proximal end. A retention flange may protrude radially outwardly from the outer surface of the sidewall relative to the longitudinal axis and distally of the at least one engagement member. The at least one engagement member may be configured for engagement with a locking mechanism of a fluid injector to releasably position the syringe within the syringe port of the fluid injector. A taper of the at least one engagement member may be configured to rotationally guide the syringe into self-alignment with the locking mechanism and axially eject the syringe upon rotation of the syringe. In certain embodiments, rotation of the syringe within the locking mechanism disengages the retention flange from the at least one deflectable retaining element prior to axially ejecting the syringe.

[0015] According to one aspect, the present disclosure provides a syringe comprising:

a barrel having a distal end, a proximal end, and a sidewall extending substantially circumferentially between the distal end and the proximal end along a longitudinal axis; and

at least one engagement member protruding from a terminal portion of the sidewall in a proximal direction along the longitudinal axis, the at least one engagement member tapering axially in a direction from the distal end toward the proximal end,

wherein the at least one engagement member is configured for engagement with a locking mechanism of a fluid injector to releasably position the syringe with a syringe port of the fluid injector, and

wherein a taper of the at least one engagement member rotationally guides the syringe into self-orienting alignment with the locking mechanism and axially ejects the syringe upon rotation of the syringe.

[0016] According to another aspect, the present disclosure provides a syringe according to any of the aspects described herein, wherein a plurality of engagement members extend about at least a portion of a circumference of the terminal portion.

[0017] According to another aspect, the present disclosure provides a syringe according to any of the aspects described herein, wherein the plurality of engagement members are spaced apart evenly about the circumference of the terminal portion.

[0018] According to another aspect, the present disclosure provides a syringe according to any of the aspects described herein, wherein the at least one engagement member has a wave form or sinusoidal form.

[0019] According to another aspect, the present disclosure provides a syringe according to any of the aspects described herein, wherein the at least one engagement member has a pointed proximal end with at least one tapered surface that extends from the pointed proximal end in a distal direction along the longitudinal axis to the terminal portion of the sidewall.

[0020] According to another aspect, the present disclosure provides a syringe according to any of the aspects described herein, wherein the pointed proximal end of the at least one engagement member has a sharp or rounded point.

[0021] According to another aspect, the present disclosure provides a syringe according to any of the aspects described herein, wherein the at least one tapered surface is angled relative to a direction of the longitudinal axis.

[0022] According to another aspect, the present disclosure provides a syringe according to any of the aspects described herein, wherein the at least one tapered surface is linear or curvilinear.

[0023] According to another aspect, the present disclosure provides a syringe according to any of the aspects described herein, wherein the at least one tapered surface is continuous or discontinuous.

[0024] According to another aspect, the present disclosure provides a syringe according to any of the aspects described herein, wherein the at least one tapered surface is planar.

[0025] According to another aspect, the present disclosure provides a syringe according to any of the aspects described herein, further comprising at least one encoding device on at least a portion of the syringe.

[0026] According to another aspect, the present disclosure provides a syringe according to any of the aspects described herein, wherein the at least one encoding device is on at least one of the at least one engagement member.

[0027] According to another aspect, the present disclosure provides a syringe according to any of the aspects described herein, wherein the at least one engagement member is monolithically formed with the terminal portion of the sidewall.

[0028] According to another aspect, the present disclosure provides a syringe according to any of the aspects described herein, wherein the at least one engagement member is separable from the terminal portion of the sidewall.

[0029] According to another aspect, the present disclosure provides a syringe according to any of the aspects described herein, further comprising a flange protruding radially outwardly from the outer surface of the sidewall relative to the longitudinal axis and distally of the at least one engagement member for engaging with the locking mechanism of the fluid injector to releasably lock the syringe with the syringe port of the fluid injector.

[0030] According to another aspect, the present disclosure provides a syringe according to any of the aspects described herein, wherein the flange extends around at least a portion of the outer surface of the sidewall.

[0031] According to another aspect, the present disclosure provides a syringe according to any of the aspects described herein, wherein the flange has a longitudinal stop surface for limiting a length of a longitudinal insertion of the syringe into the locking mechanism.

[0032] According to another aspect, the present disclosure provides a syringe according to any of the aspects described herein, wherein the at least one engagement member has a circular, triangular, or a polygonal shape.

[0033] According to another aspect, the present disclosure provides a syringe according to any of the aspects described herein, further comprising a plunger slidably disposed within the barrel and movable between the proximal end and the distal end.

[0034] According to another aspect, the present disclosure provides a fluid injection apparatus, comprising:

at least one syringe comprising a barrel with a distal end, a proximal end, and a sidewall extending substantially circumferentially between the distal end and the proximal end along a longitudinal axis, the barrel having at least one engagement member protruding from a terminal portion of the sidewall in a proximal direction along the longitudinal axis, the at least one engagement member tapering axially in a direction from the distal end toward the proximal end;

an injector comprising an injector housing defining at least one syringe port for receiving the at least one syringe; and

a locking mechanism associated with the at least one syringe port for securing the at least one syringe within the at least one syringe port, the locking mechanism configured for engaging the at least one engagement member of the at least one syringe to releasably position the at least one syringe within the at least one syringe port,

wherein a taper of the at least one engagement member is configured to rotationally guide the at least one syringe into self-orienting alignment with the locking mechanism and axially ejects the at least one syringe upon rotation of the at least one syringe.

[0035] According to another aspect, the present disclosure provides a fluid injection apparatus according to any of the aspects described herein, wherein the locking mechanism further comprises:

a housing having a central opening configured to receive the proximal end of the at least one syringe;

a guide ring fixed relative to the housing with a central axis of the guide ring in coaxial alignment with a central axis of the housing, the guide ring having at least one recess extending from an inner circumference of the guide ring to an outer circumference of the guide ring;

[0036] at least one deflectable retaining element configured to be movably received within the at least recess of the guide; and

a lock/release ring configured for engagement with the at least one engagement member when the at least one syringe is inserted into the at least one syringe port, the lock/release ring being rotatable relative to the housing with a rotation of the at least one syringe about the longitudinal axis.

[0037] According to another aspect, the present disclosure provides a fluid injection apparatus according to any of the aspects described herein, further comprising at least one elastically resilient member connected at one end to at least a portion of the at least one deflectable retaining element to urge the at least one deflectable retaining element in a radially inward direction.

[0038] According to another aspect, the present disclosure provides a fluid injection apparatus according to any of the aspects described herein, wherein the at least one deflectable retaining element comprises a locking lip that is angled relative to the longitudinal axis such that movement of the at least one syringe in a proximal direction causes movement of the at least one deflectable retaining element in a radially outward direction.

[0039] According to another aspect, the present disclosure provides a fluid injection apparatus according to any of the aspects described herein, wherein the lock/release ring comprises one or more syringe engagement members that have a complementary shape to receive the at least one engagement member.

[0040] According to another aspect, the present disclosure provides a fluid injection apparatus according to any of the aspects described herein, wherein the lock/release ring comprises at least one guide slot disposed on a top surface to guide a movement of the at least one deflectable retaining element.

[0041] According to another aspect, the present disclosure provides a fluid injection apparatus according to any of the aspects described herein, wherein the at least one guide slot comprises at least one guide track.

[0042] According to another aspect, the present disclosure provides a fluid injection apparatus according to any of the aspects described herein, wherein the at least one deflectable retaining element engages the at least one guide track at a first end when the at least one deflectable retaining element is in a first radial position, and wherein the at least one deflectable retaining element engages the at least one guide track at a second end when the at least one deflectable retaining element is in a second radial position that is different than the first radial position.

[0043] According to another aspect, the present disclosure provides a fluid injection apparatus according to any of the aspects described herein, wherein lateral edges of the at least one recess define a travel path for guiding movement of the at least one deflectable retaining element.

[0044] According to another aspect, the present disclosure provides a fluid injection apparatus according to any of the aspects described herein, wherein at least a portion of a top surface of the guide ring defines a stop surface that limits a movement of the at least one syringe in a proximal direction when the at least one syringe is inserted into the at least one syringe port.

[0045] According to one aspect, the present disclosure provides a syringe comprising:

- a barrel having a distal end, a proximal end, and a sidewall extending substantially circumferentially between the distal end and the proximal end along a longitudinal axis;

- at least one engagement member protruding from a terminal portion of the sidewall in a proximal direction along the longitudinal axis, the at least one engagement member tapering axially in a direction from the distal end toward the proximal end; and

a flange protruding radially outwardly from an outer surface of the sidewall relative to the longitudinal axis and distally of the at least one engagement member, wherein the at least one engagement member is configured for engagement with a locking mechanism of a fluid injector to releasably position the syringe with a fluid port of the fluid injector, and

wherein a taper of the at least one engagement member rotationally guides the syringe into self-orienting alignment with the locking mechanism and axially ejects the syringe upon rotation of the syringe.

[0046] These and other features and characteristics of the syringe and the syringe connection interface of the fluid injection apparatus, as well as the methods of operation and functions of the related elements of structures and the combination of parts and economies of manufacture, will become more apparent upon consideration of the following description and the appended claims with reference to the accompanying drawings, all of which form a part of this specification, wherein like reference numerals designate corresponding parts in the various figures. It is to be expressly understood, however, that the drawings are for the purpose of illustration and description only. As used in the specification and the claims, the singular form of “a”, “an”, and “the” include plural referents unless the context clearly dictates otherwise.

BRIEF DESCRIPTION OF THE DRAWINGS

[0047] **FIG. 1A** is a schematic view of a system including a fluid injector and syringe according to an embodiment of the present disclosure;

[0048] **FIG. 1B** is a perspective view of a syringe according to one embodiment of the present disclosure;

[0049] **FIG. 2A** is an exploded perspective view of a connection interface for securing a syringe to a fluid injector according to one embodiment;

[0050] **FIG. 2B** is a cross-sectional assembled view of the connection interface shown in **FIG. 2A**;

[0051] **FIGS. 3A-3D** show cylindrical plan projection views of engagement members for guiding/ejecting a syringe into/from a fluid injector according to various other embodiments;

- [0052] FIGS. 4A-4Q show various embodiments of engagement members on a syringe;
- [0053] FIG. 5A is a schematic diagram of forces on the connection interface during an insertion of a syringe into a fluid injector;
- [0054] FIG. 5B is a graph of a syringe insertion force as a function of an angle of tapered surfaces at a connection interface for materials with different coefficients of friction μ ;
- [0055] FIG. 6A is a graphical overlay of various profiles of engagement members on a syringe;
- [0056] FIG. 6B is a graph of an angular orientation relative to a longitudinal axis of a sinusoidal engagement member about a circumference of a syringe;
- [0057] FIG. 7A is a schematic diagram of forces on the connection interface during an ejection of a syringe from a fluid injector;
- [0058] FIG. 7B is a graph of a slip angle for syringe ejection as a function of a coefficient of friction between a syringe and a locking mechanism;
- [0059] FIG. 7C is a graph of a ratio of a rotational force on a syringe during ejection relative to a restoring force of a locking mechanism as a function of an angle of tapered surfaces at a connection interface;
- [0060] FIG. 8A is a side cross-sectional view of a coupling configured for connecting a syringe of the present disclosure to an injector;
- [0061] FIG. 8B is a perspective view of an adapter configured for connecting a syringe to an injector of the present disclosure; and
- [0062] FIGS. 9A-9B are perspective views of alternative embodiments of connection portions of the coupling shown in FIG. 8A.

DETAILED DESCRIPTION OF THE PREFERRED EMBODIMENTS

[0063] For purposes of the description hereinafter, the terms “upper”, “lower”, “right”, “left”, “vertical”, “horizontal”, “top”, “bottom”, “lateral”, “longitudinal”, and derivatives thereof shall relate to the disclosure as it is oriented in the drawing figures. When used in relation to a syringe, the term “proximal” refers to a portion of a syringe nearest to an injector when a syringe is oriented for connecting to an injector. The term “distal” refers to a portion of a syringe farthest away from an injector when a syringe is oriented for connecting to an

injector. The term “radial” refers to a direction in a cross-sectional plane normal to a longitudinal axis of a syringe extending between proximal and distal ends. The term “circumferential” refers to a direction around an inner or outer surface of a sidewall of a syringe. The term “axial” refers to a direction along a longitudinal axis of a syringe extending between proximal and distal ends. The term “self-orienting” means that a syringe orients itself to the correct orientation within a syringe port during insertion without effort by a technician. The terms “axial taper”, “axial tapering”, and “tapering axially” mean an angle of inclination of at least one virtual or real surface on a syringe in a cylindrical plan projection view in a direction from a distal end toward a proximal end of a syringe. It is also to be understood that specific devices and processes illustrated in the attached drawings, and described in the following specification, are simply exemplary embodiments of the disclosure. Hence, specific dimensions and other physical characteristics related to the embodiments (*i.e.*, aspects, variants, variations, etc.) disclosed herein are not to be considered as limiting.

[0064] Referring to the drawings in which like reference characters refer to like parts throughout the several views thereof, the present disclosure is generally directed to a connection interface between at least one syringe and a fluid injector.

[0065] With reference to **FIG. 1A**, a fluid injector **10** (hereinafter referred to as “injector **10**”), such as an automated or powered fluid injector, is illustrated, which is adapted to interface with and actuate one or more syringes **12**, which may be filled with a medical fluid **F**, such as contrast media, saline solution, or any desired medical fluid. The injector **10** may be used during a medical procedure to inject the medical fluid into the body of a patient by driving a plunger **26** of the syringe **12** with a piston element. The injector **10** may be a multi-syringe injector, wherein several syringes **12** may be oriented in a side-by-side or other relationship and are separately actuated by plungers **26** on respective linear actuators or piston elements associated with the injector **10**. The injector **10** may be configured to independently deliver one or more fluids from the at least one syringes **12**.

[0066] The injector **10** may be enclosed within a housing **14** formed from a suitable structural material, such as plastic or metal. The housing **14** may be of various shapes and sizes depending on the desired application. For example, the injector **10** may be a free-standing structure configured to be placed on the floor or may be a smaller design for placement on a suitable table or support frame. The injector **10** includes at least one syringe

port **16** for connecting the at least one syringe **12** to respective piston elements. As will be described hereinafter, in some embodiments, the syringe **12** includes at least one engagement member configured for releasably self-orienting the syringe **12** within the syringe port **16** of the injector **10**. The at least one engagement member is configured to operatively engage a locking mechanism provided in the syringe port **16** of the injector **10** to facilitate loading or removal of the syringe **12** to and from the injector **10**, including ejecting the syringe **12** from the syringe port **16**, as will be described herein. The at least one engagement member and the locking mechanism together define a connection interface for reversibly connecting the at least one syringe **12** to the injector **10**.

[0067] A fluid path set **17** may be fluidly connected with at least one of the at least one syringe **12** for delivering medical fluid **F** from the at least one syringe **12** to a catheter (not shown), needle, or other fluid delivery connection inserted into a patient at a vascular access site. Fluid flow from the at least one syringe **12** may be regulated by a fluid control module (not shown). The fluid control module operates various pistons, valves and flow regulating structures to regulate the delivery of the medical fluid, such as saline solution and contrast to the patient based on user selected injection parameters, such as injection flow rate, duration, total injection volume, and ratio of contrast media and saline. A suitable front-loading fluid injector that may be modified for use with at least one syringe and at least one syringe interface for self-oriented loading and releasable retaining of the at least one syringe with the fluid injector described herein is disclosed in United States Patent No. 5,383,858 to Reilly et al. Other relevant multi-fluid delivery systems that may be so modified are found in United States Patent No. 7,553,294 to Lazzaro et al.; United States Patent No. 7,666,169 to Cowan et al.; International Patent Application No. PCT/US2012/037491, (published as WO 2012/155035); and United States Patent Application Publication No. 2014/0027009 to Riley et al.; all of which are assigned to the assignee of the present application.

[0068] Having described the general structure and function of the injector **10**, the structure of the at least one syringe **12** will now be discussed in greater detail. With reference to **FIG. 1B**, the syringe **12** generally has a substantially cylindrical syringe barrel **18** formed from glass, metal, or a suitable medical-grade plastic. The barrel **18** has a proximal end **20** and a distal end **24**, with a substantially circumferential sidewall **19** extending therebetween along a

length of a longitudinal axis **15** extending through a center of the barrel **18**. The barrel **18** may be made from a transparent or translucent material, and may include at least one fluid verification member **11** for verifying a presence of the fluid **F** within the syringe barrel **18** (shown in **FIG. 1A**). A nozzle **22** for connecting to a fluid path **17** extends from the distal end **24** of the barrel **18**. The barrel **18** has an outer surface **21** and an inner surface **23** that defines an interior volume **25** configured for receiving the medical fluid therein. The proximal end **20** of the barrel **18** may be sealed with the plunger **26** that is slidable through the barrel **18**. The plunger **26** forms a liquid-tight seal against the inner surface of sidewall **19** of the barrel **18** as it is reversibly advanced therethrough. The plunger **26** may have a rigid inner element **28** configured for engagement with the piston of the injector **10**. The plunger **26** may further include an elastomeric cover **29** disposed over at least a portion of the rigid inner element **28**. The elastomeric cover **29** is configured to engage the inner surface **23** of the barrel **18** and provide a liquid-tight seal against the sidewall **19** of the barrel **18** as it is reversibly advanced therethrough.

[0069] With continued reference to **FIG. 1B**, the proximal end **20** of the syringe **12** is sized and adapted to be inserted in the at least one syringe port **16** of the injector **10** (shown in **FIG. 1A**). In some embodiments, the proximal end **20** of the syringe **12** defines an insertion portion **30** that is configured to be removably inserted into the syringe port **16** of the injector **10** while the remaining portion of the syringe **12** remains outside of the syringe port **16**. As will be described in detail hereinafter, in certain embodiments, the proximal end **20** of the syringe **12** includes at least one engagement member **32** adapted to form a locking engagement with a corresponding locking mechanism in the syringe port **16** of the injector **10** for releasably retaining the syringe **12** in the syringe port **16**. The combination of the syringe **12** having the one or more engagement members **32** with a retention flange **41** and the locking mechanism **35** (shown in **FIG. 2B**) of the injector **10** defines a connection interface for loading and unloading of the syringe **12** to and from the injector **10**.

[0070] According to certain embodiments, a drip flange **36** may extend radially outward from the outer surface **21** of the syringe barrel **18** relative to the longitudinal axis **15**. The drip flange **36** may extend around at least a portion of the outer circumference of the barrel **18**. In one embodiment, the drip flange **36** is positioned distally along the longitudinal axis **15** relative to the one or more engagement members **32** and distal to the retention flange **41**. The drip flange **36** may be configured to prevent fluid that drips from the nozzle **22** from

entering the syringe port **16** on the injector **10**. In this manner, the drip flange **36** helps reduce the amount of fluid that may enter the syringe port **16** and jam or interfere with the connection interface **100** or otherwise foul the mechanics or electronics of the injector **10**. In some embodiments, the drip flange **36** may define an insertion stop surface that delimits how far the insertion portion **30** of the syringe **12** may be inserted into the syringe port **16** and/or locking mechanism of the injector **10**. The drip flange **36** may be formed integrally with the barrel **18** or it may be affixed or otherwise secured to the outer surface **21** of the barrel **18** using, for example, a frictional fit and/or an adhesive, welding, or by molding. In other embodiments, the drip flange **36** may be formed on the outer surface **21** of the barrel **18** by etching, laser cutting, or machining.

[0071] In other embodiments, the insertion stop surface may be defined by the retention flange **41** positioned closer to the proximal end **20** of the barrel **18** relative to the drip flange **36**, if present. The retention flange **41** may extend radially outward from the outer surface **21** of the syringe barrel **18** relative to the longitudinal axis **15**. The retention flange **41** may extend around at least a portion of the outer circumference of the barrel **18** and may be a single continuous flange or one or more discontinuous or intermittent segments. In one embodiment, the retention flange **41** is positioned distally along the longitudinal axis **15** relative to the engagement member **32**. The retention flange **41** may be formed integrally with the barrel **18** or it may be affixed or otherwise secured to the outer surface **21** of the barrel **18** using, for example, a frictional fit and/or an adhesive, welding, or by molding. In other embodiments, the retention flange **41** may be formed on the outer surface **21** of the barrel **18** by etching, laser cutting, or machining. The retention flange **41** may be anywhere along the length of the barrel **18** in a distal direction from the one or more engagement members **32**. In some embodiments, the retention flange **41** may be formed directly on or adjacent the one or more engagement members **32**. The retention flange **41** may also be formed by increasing the thickness of the sidewall **19** while maintaining a constant inner diameter of the barrel **18** or by increasing the inner diameter of the barrel **18** and maintaining, decreasing, or increasing the thickness of the sidewall **19**. In this example embodiment, the distal surface of the retention flange **41** forms a retention surface **41R** (shown in **FIG. 2A**) which interfaces with one or more retention surfaces **78R** (shown in **FIG. 2B**) on one or more retaining elements **78** of syringe port **16**. At least a portion of the retention flange **41**, for

example a proximal surface of retention flange 41, may be tapered or beveled in a radial direction toward or away from the longitudinal axis 15.

[0072] With specific reference to FIGS. 2A-2B, a connection interface 100 for loading and removing/ejecting the at least one syringe 12 from the at least one syringe port 16 of the injector 10 (shown in FIG. 1) is shown in accordance with one embodiment. The syringe 12 and the injector 10 include the connection interface 100 having at least one engagement member 32 provided on the syringe 12 and a corresponding locking mechanism 35 provided on the syringe port 16 of the injector 10 (shown in FIG. 1). In one embodiment, the at least one engagement member 32 is provided on the proximal end 20 of the syringe barrel 18. For example, the at least one engagement member 32 may protrude axially in a proximal direction from the terminal end 27 of the syringe barrel 18. The at least one engagement member 32 may be formed integrally and monolithically with the barrel 18 or it may be affixed or otherwise secured to the terminal end 27 of the barrel 18 using, for example, a frictional fit and/or an adhesive, or by welding. In other embodiments, the at least one engagement member 32 may be formed on the terminal end 27 of the barrel 18 by etching, laser cutting, machining, or molding. In some embodiments, the one or more engagement members 32 cooperate with at least a portion of the locking mechanism to self-orient the syringe 12 relative to the syringe port 16 such that the syringe 12 may be releasably locked with the syringe port 16 without physical aligning of the syringe or other effort by the user or technician to orient the syringe 12 with syringe port 16 and/or locking mechanism 35.

[0073] In the embodiment shown in FIGS. 2A-2B, the at least one engagement member 32 is formed as one or more projections that protrude axially in a proximal direction from the terminal end 27 of the syringe barrel 18 indicated by a dashed line in FIGS. 1B and 2A-2B. The at least one engagement member 32 may have the same radial thickness as the sidewall 19 of the syringe barrel 18 such that the at least one engagement member 32 is substantially continuous with the outer surface 21 and the inner surface 23 (shown in FIG. 1B) of the barrel 18. In other embodiments, the at least one engagement member 32 may protrude radially outward or radially inward relative to the outer surface 21 of the barrel 18. In addition, or alternatively, the at least one engagement member 32 may protrude radially outward or radially inward relative to the inner surface 23 of the barrel 18. In other embodiments, the at least one engagement members 32 may be located within the interior of sidewall 19, for example, such that terminal ends of the inner surface 23 and outer surface 21

are substantially even with the proximal end of the at least one engagement member **32**. In certain embodiments, a plurality of engagement members **32** may be arranged around a circumference of the barrel **18** in a waveform or sinusoidal form, as detailed herein. In embodiments where more than two engagement members **32** are provided, the engagement member **32** may be evenly spaced about an outer circumference of the barrel **18**. For example, in an embodiment with six engagement members **32**, each engagement member **32** is separated 60 degrees apart from adjacent engagement members **32**. In other embodiments having x engagement members **32**, each engagement member **32** is separated $360/x$ degrees apart from adjacent engagement members **32**, where x is an integer from 1 to 360. In other embodiments, the at least one engagement members **32** may have unequal angular spacing therebetween about the outer circumference of the barrel **18**. For example, one or more engagement members **32** may subtend an angle **A** (shown in **FIG. 1B**), which may be more than 60 degrees or less than 60 degrees of the circumference of the barrel **18**. In some embodiments, where the at least one engagement members **32** have unequal angular spacing, the spacing and arrangement of the various engagement members **32** may be used to encode information regarding the syringe and/or the syringe content, such as manufacturer, lot number, date of manufacture, volume, pressure minimum/maximum, compatibility with various medical fluids, etc. In some embodiments, each of the engagement members **32** may protrude at an equal distance from the terminal end **27** of the syringe barrel **18** in a proximal direction. In other embodiments, one or more engagement members **32** may be longer or shorter than the remaining engagement members **32**. Each engagement member **32** is substantially rigid and free from deflecting in a radial or circumferential direction during insertion and removal of the syringe **12** to and from the syringe port **16**. Each engagement member **32** may be continuous and uninterrupted, or it may be comprised of a plurality of separate elements that together define the engagement member **32**.

[0074] Referring back to **FIG. 1B**, each of the engagement members **32** may have a substantially pointed proximal end **37** with a pair of tapered surfaces **39A-39B** that extend from the proximal end **37** of engagement member **32** in a distal direction along the longitudinal axis **15** toward the terminal end **27** of the syringe **12**. The proximal end **37** may have a sharp or rounded point. At least one of the tapered surfaces **39A-39B** may be angled axially and/or circumferentially relative to a direction of the longitudinal axis **15** at an angle **B** (shown in **FIG. 1B**). The axial/circumferential tapering of the at least one tapered surfaces

39A-39B relative to the longitudinal axis **15** may be defined as an angle of inclination of at least one of the tapered surfaces **39A-39B** in a cylindrical plan projection view in a direction from the distal end **24** toward the proximal end **20** of the syringe barrel **18**. The tapered surfaces **39A-39B** may be angled at a same or different angle relative to the longitudinal axis **15**. In some embodiments, the tapered surfaces **39A-39B** may be linear, curved, or a combination thereof. In other embodiments, the profile of one of the tapered surfaces **39A-39B** may be the same or different from the other of the tapered surfaces **39A-39B**. For example, one of the tapered surfaces **39A-39B** may be angled relative to the direction of the longitudinal axis **15**, while the other of the tapered surfaces **39A-39B** may be parallel with the direction of the longitudinal axis **15**. In embodiments where at least two engagement members **32** are positioned adjacent to each other, the tapered surface **39A** on one engagement member **32** may transition to the tapered surface **39B** of each adjacent engagement member **32**.

[0075] While **FIGS. 2A-2B** illustrate one non-limiting embodiment of the at least one engagement member **32**, various other shapes are also contemplated (see, for example **FIG. 4A-4Q** for other non-limiting embodiments). For example, the at least one engagement member **32** may have a generally circular, triangular, square, rectangular, or any other polygonal shape. In each embodiment, the at least one engagement member **32**, in combination with the retention flange **41**, is configured for forming a self-orienting locking engagement with a corresponding locking mechanism **35** in the syringe port **16** of the injector **10** for releasably retaining the syringe **12** in the syringe port **16**, as described herein. For each of the embodiments of the engagement member **32**, it is also contemplated that the number of engagement members **32** used may be varied while remaining within the scope of the present disclosure. For example, for the syringe **12** illustrated in **FIG. 1B**, it is contemplated that only one engagement member **32** is provided at the terminal end **27** of the syringe **12**. While a single engagement member **32** may be used, embodiments of the syringe **12** may have at least two engagement members **32**. In some embodiments having even numbers of engagement members **32**, the engagement members **32** may be located diametrically opposite one another. In other embodiments, the engagement members **32** are provided adjacent to each other. The engagement members **32** may be appropriately sized and optionally may be of different circumferential dimension. Various non-limiting

embodiments of suitable shapes for the at least one engagement member **32** are described herein with reference to **FIGS. 4A-4Q**.

[0076] With continuing reference to **FIGS. 2A-2B**, the syringe port **16** of the injector **10** has a locking mechanism **35** configured to operatively engage the at least one engagement member **32** and the retention flange **41** of the syringe **12**. The locking mechanism **35** includes a housing **70** with a central opening **71** configured to receive the proximal end **20** of the syringe **12**. The housing **70** may be formed as part of the housing **14** of the injector **10** (shown in **FIG. 1A**) or may be attachable to the housing **14** to convert an existing injector to include the presently described locking mechanism **35**. A guide ring **48** may be secured relative to the housing **70** such the guide ring **48** cannot rotate or move longitudinally relative to the housing **70**. In one embodiment, the guide ring **48** has a body **72** having one or more tabs **74** (shown in **FIG. 2A**) extending radially outward from an outer circumference of the body **72**. The body **72** of the guide ring **48** may have a continuous annular shape, or it may be formed from two or more discrete segments. When installed within the housing **70**, the one or more tabs **74** engage corresponding one or more grooves **76** (shown in **FIG. 2A**) on an inner sidewall **73** of the housing **70** to prevent rotation/longitudinal movement of guide ring **48**. In other embodiments, the guide ring **48** may be secured to the housing **70** by other mechanical fastening arrangements, such as a clip, fastener, or a snap fit arrangement. In further embodiments, the guide ring **48** may be welded, glued, or molded with the housing **70**. When installed on the housing **70**, a central axis of the guide ring **48** is coaxial with a central axis of the housing **70**.

[0077] With reference to **FIG. 2A**, the guide ring **48** has one or more first recesses **60** that are configured to slidably receive a corresponding one or more deflectable retaining elements **78**. The one or more first recesses **60** may be evenly spaced about the body **72** of the guide ring **48**. In one embodiment, the one or more first recesses **60** extend from an inner circumference of the guide ring **48** to an outer circumference thereof. For example, in an embodiment where the guide ring **48** has four first recesses **60**, each first recess **60** may be separated 90 degrees apart from the first recesses **60** adjacent on either side. In other embodiments, the one or more first recesses **60** may be unevenly spaced about the body **72** of the guide ring **48**. The number of first recesses **60** on the guide ring **48** may correspond to the number of deflectable retaining elements **78**. First recesses **60** may include a groove or pin on the bottom surface to interface with a pin or groove, respectively, on the bottom surface of

deflectable retaining elements **78** to guide movement of the deflectable retaining elements **78**. The lateral edges of each first recess **60** define a radial travel path for guiding the movement of the deflectable retaining elements **78** in a radial direction as the insertion portion **30** of the syringe **12** is inserted into and out of the guide ring **48**. At least a portion of a top surface of the guide ring **48** may define a stop surface **59** that limits a movement of the syringe **12** in the proximal direction when the syringe **12** is inserted into the locking mechanism **35**. In one embodiment, the retention flange **41** of the syringe **12** engages the stop surface **59** to limit the movement of the syringe **12** in the proximal direction.

[0078] With continued reference to **FIG. 2A**, the locking mechanism **35** further includes one or more deflectable retaining elements **78** configured for sliding in a radial direction relative to the guide ring **48**. As detailed further herein, each of the one or more deflectable retaining elements **78** is radially slidable relative to the guide ring **48** and the housing **70**, which are both fixed relative to each other. At least one first elastically resilient member **102** (shown in **FIG. 2A**), such as a spring, is connected at one end to at least a portion of the one or more deflectable retaining elements **78** and at the other end to at least a portion of the housing **70**. The at least one first elastically resilient member **102** urges the one or more deflectable retaining elements **78** to a first position (see **FIG. 2B**) where a locking lip **80** on the at least one deflectable retaining element **78** is positioned over the stop surface **59** of the guide ring **48** to define a retaining gap **81** (see **FIG. 2B**). In one embodiment, by inserting the syringe **12** into the syringe port **16**, the retention flange **41** of the syringe **12** engages the locking lip **80** of the at least one deflectable retaining element **78** to deflect the deflectable retaining element **78** radially outward and allow the syringe **12** to be inserted into the locking mechanism **35**. The locking lip **80** may be radially angled relative to the longitudinal axis **15** such that movement of the syringe **12** in the proximal direction results in a force having a radially directed component that urges the at least one deflectable retaining element **78** radially outward relative to the syringe **12**. Alternatively, the proximal surface of the retention flange **41** may be radially angled or beveled relative to the longitudinal axis **15** such that movement of the syringe **12** in the proximal direction results in a force having a radially directed component that urges the at least one deflectable retaining element **78** radially outward relative to the syringe **12**. After the retention flange **41** of the syringe **12** clears the locking lip **80**, the at least one deflectable retaining element **78** is restored to its initial, first position under the urging of the at least one first elastically resilient member **102**. In order to

release the syringe **12** from the locking mechanism **35**, the one or more engagement members **32** on the syringe **12** engage a lock/release ring **84**, and, when rotated, cause the one or more deflectable retaining elements **78** to move to a second or open position and allowing ejection of the syringe **12** from the locking mechanism **35**, as described herein.

[0079] With continued reference to **FIG. 2A**, the locking mechanism **35** may further include the lock/release ring **84** having a generally annular shape. The lock/release ring **84** is configured for engaging one or more of the at least one engagement member **32** to control selective positioning of the syringe **12** within the syringe port **16** to allow for selective locking engagement of one or more deflectable retaining elements **78** with the retention flange **41** of the syringe **12**. The lock/release ring **84** is rotatable relative to the housing **70** with the rotation of the syringe **12** about its longitudinal axis **15** by engagement of the at least one engagement member **32** with at least one syringe engagement member **83**.

[0080] In certain embodiments, the lock/release ring **84** has one or more syringe engagement members **83** extending around an inner circumference of the lock/release ring **84**. The one or more syringe engagement members **83** have a complementary shape to that of one or more of the at least one engagement members **32** on the syringe **12**. In one embodiment, the one or more syringe engagement members **83** are shaped to correspond to the shape of the at least one engagement members **32** at the terminal end **27** of the syringe **12**. For example, in various embodiments, the one or more one or more syringe engagement members **83** may have a waveform or sinusoidal shape. The one or more syringe engagement members **83** have interacting surfaces **85A**, **85B** along which the tapered surfaces **39A-39B** can slide as the syringe **12** is inserted into or withdrawn from the syringe port **16**. The interacting surfaces **85A**, **85B** are tapered to a sharp or rounded point in a distal direction facing the syringe **12**. At least one of the interacting surfaces **85A**, **85B** may be angled axially relative to a direction of the longitudinal axis **15**. The axial tapering of the at least one interacting surface **85A**, **85B** relative to the longitudinal axis **15** may be defined as an angle of inclination of the interacting surface **85A**, **85B** in a cylindrical plan projection view in a direction toward the proximal end **20** of the syringe **12** when the syringe **12** is inserted into the syringe port **16**. The interacting surfaces **85A**, **85B** may be angled at a same or different angle relative to the longitudinal axis **15**. In some embodiments, the interacting surfaces **85A**, **85B** may be linear, curved, stepped but defining a substantially linear/curved surface, or a combination thereof. In other embodiments, the profile of one of the interacting

surfaces **85A**, **85B** may be the same or different from the other of the interacting surfaces **85A**, **85B**. For example, one of the interacting surface **85A**, **85B** may be angled relative to the direction of the longitudinal axis **15**, while the other of the interacting surface **85A**, **85B** may be parallel with the direction of the longitudinal axis **15**.

[0081] In embodiments where more than two engagement members **32** are provided on the syringe **12**, the one or more syringe engagement members **83** may be shaped to have a corresponding or complimentary shape and angular spacing such that each of the engagement members **32** engages a respective syringe engagement member **83**. In other embodiments, the at least one engagement members **32** may have a multiple of engagement members **32** relative to the number of the one or more syringe engagement members **83**. In a first position, such as when the syringe **12** is locked within the locking mechanism **35**, each engagement member **32** is aligned with the corresponding syringe engagement member **83**. In a second position, such as when the syringe **12** is to be removed from the locking mechanism **35**, each engagement member **32** is rotationally moved out of alignment with the corresponding syringe engagement member **83**.

[0082] With continuing reference to **FIG. 2A**, the lock/release ring **84** further includes a guide slot **86** to guide the movement of each of the deflectable retaining elements **78**. Each guide slot **86** is disposed on an outer periphery of a top surface **88** of the lock/release ring **84**. Each guide slot **86** has a guide track **90** on which the corresponding deflectable retaining element **78** is guided between the first position, where the syringe **12** is locked within the locking mechanism **35**, and a second position, where the syringe **12** is unlocked from the locking mechanism **35**. In one embodiment, at least a portion of each deflectable retaining element **78** engages the guide track **90**, such as by a pin or other engaging member protruding proximally from the bottom of the deflectable retaining element **78**. In a first position, each deflectable retaining element **78** engages the guide track **90** at a first end **92** such that each deflectable retaining element **78** is at its most radially-inward position. In this position, the retention flange **41** of the syringe **12** is retained by the locking lip **80** of the one or more deflectable retaining elements **78** such that the syringe **12** cannot be removed from the locking mechanism **35** without rotating the syringe **12** relative to its longitudinal axis **15** and engaging the release mechanism. With the rotation of the syringe **12** about its longitudinal axis **15**, the lock/release ring **84** is rotated such that each deflectable retaining element **78** is guided radially outward along the guide track **90** toward a second end **94**, where each

deflectable retaining element **78** is at its most radially-outward position. In this position, the syringe **12** is removed from the locking mechanism **35** by ejecting or urging the syringe **12** in a distal direction such that the retention flange **41** clears the locking lip **80** of each deflectable retaining element **78**. As the syringe **12** is released from the locking mechanism **35**, the lock/release ring **84** is concurrently rotated to the first position under a restoring action of a second elastically resilient member **96** that may be secured to a base **98** of the housing **70**. In certain embodiments, rotation of the lock/release ring **84** back to the first position under the restoring action of a second elastically resilient member **96** may provide a lateral force to the syringe **12** to eject or urge the syringe **12** out of the syringe port **16**.

[0083] To insert the syringe **12** into the syringe port **16**, the longitudinal axis **15** of the syringe **12** is roughly aligned with the longitudinal axis of the syringe port **16**. Initially, the syringe **12** can be inserted into a top portion of the central opening **71** without rotationally orienting the syringe **12** about the longitudinal axis **15** relative to the syringe port **16**. The insertion portion **30** of the syringe **12** is inserted into the opening **71** of the syringe port **16**. The syringe retention flange **41** is urged in a proximal direction into contact with the locking lip **80** of the at least one deflectable retaining element **78** to deflect it radially outward and allow the syringe **12** to be inserted into the housing **70**. Continued proximal movement of the syringe **12** relative the syringe port **16** causes the one or more deflectable retaining elements **78** to be deflected radially outward within the first recesses **60** to a second position in which the size of the central opening is increased to allow the retention flange **41** to pass through. The syringe **12** is advanced proximally into the syringe port **16** such that the one or more tapered surfaces **39A**, **39B** on each engagement member **32** come into contact with the corresponding interacting surfaces **85A**, **85B** to rotationally self-orient the syringe **12** such that the peaks of the engagement members **32** are received in the valleys of the syringe engagement member **83** on the syringe port **16** and/or until the retention flange **41** engages the stop surface **59** on the guide ring **48**. Under the restoring action of the at least one first elastically resilient member **102**, the one or more deflectable retaining elements **78** are then urged radially from the second position to the first position where the locking lip **80** of the one or more deflectable retaining elements **78** may be positioned over the retention flange **41** between the stop surface **59** and a bottom face of the locking lip **80**. In certain embodiments, wherein the drip flange **36** acts as a retention flange **41** the one or more deflectable retaining elements **78** may be positioned over the retention flange **41** to retain the drip flange **36**

between the stop surface 59 and a bottom face of the locking lip 80. An audible and/or tactile feedback may be provided by this action to indicate to the user that the syringe 12 is locked within the syringe port 16.

[0084] To unlock and release the syringe 12 from the syringe port 16, the syringe 12 may be rotated about its longitudinal axis 15, for example in a clockwise or counterclockwise direction. Rotation of the syringe 12 causes the at least one engagement members 32 to move against the one or more syringe engagement members 83, thus rotating lock/release ring 84 to move the one or more deflectable retaining elements 78 radially to the second position to release the retention flange 41 from locking lip 80. Continued rotation of syringe 12 causes further movement of the at least one engagement members 32 against and thus axially out of alignment with the one or more syringe engagement members 83 due to an axially directed force component imparted on the syringe 12 by the movement of the tapered surfaces 39A-39B along the interacting tapered surfaces 85A-85B of the syringe engagement members 83. In this manner, the terminal end 27 of the syringe 12 is urged/ejected in a distal direction by movement of the tapered surfaces 39A-39B along the interacting tapered surfaces 85A-85B of one or more syringe engagement members 83. As described herein, as the syringe 12 is rotated, the lock/release ring 84 is also rotated such that each deflectable retaining element 78 is guided radially outward along the guide track 90 toward the second end 94, where each deflectable retaining element 78 is at its most radially-outward position. In this position, due to the axially directed force created by the interaction of the tapered surfaces 39A-39B and the interacting tapered surfaces 85A-85B of the syringe engagement members 83, the syringe barrel 18 and the retention flange 41 are urged distally against the one or more deflectable retaining elements 78 which further urges the one or more deflectable retaining elements 78 radially outward from a first position to a second position. The syringe 12 may be ejected, urged, or popped out of the syringe port 16 when the locking lip 80 of the one or more deflectable retaining elements 78 clears the retention flange 41 of the syringe 12 without any applied distal force from the user. This tactile and physical confirmation of sufficient rotation for unlocking and the ejection or popping out of the syringe 12 with no further user effort, such as no need for an axial pull, is a significant improvement over prior art syringes and syringe injector ports. The ejected syringe 12 can be readily removed from the locking mechanism 35 by withdrawing the syringe 12 in a distal direction. As the syringe 12 is ejected from the locking mechanism 35, such as when the retention flange 41 moves distally

past locking lip **80** and/or the at least one engagement members **32** disengages from the one or more syringe engagement members **83**, the lock/release ring **84** is rotated to the first position under a restoring action of the second elastically resilient member **96** such that the one or more deflectable retaining elements **78** are returned to their first, initial position and the locking mechanism **35** is ready for insertion of a new syringe **12**.

[0085] To further discuss the operation of the locking mechanism **35**, the retention surfaces of the syringe **12** and the syringe port **16** that cooperate to retain the syringe **12** in the syringe port **16** once it is engaged are one or more surfaces of the retention flange **41** on the syringe **12** and the one or more retention surfaces of the deflectable retaining elements **78** on the syringe port **16**. The syringe **12** is initially generally axially aligned and inserted into the opening **71** of the syringe port **16**. Once partially inserted, the guiding surfaces of the syringe **12** and syringe port **16** that cooperate to self-orient or automatically force the rotational movement to self-orient the syringe **12** and the syringe port **16** for installation are the one or more surfaces **39A-39B** of the engagement members **32** on the syringe **12** and the one or more tapered guiding surfaces **85A-85B** of syringe engagement member **83** of the syringe port **16**. The opening surfaces of the syringe **12** and syringe port **16** that cooperate to push open the syringe port **16** for the installation of the syringe **12** are the one or more bottom surfaces of the retention flange **41** on the syringe **12** and one or more of tapered surfaces of the locking lip **80** on the syringe port **16**. The tightening surfaces of the syringe **12** and syringe port **16** that cooperate to take up the mechanical slack or tolerance may include one or more surfaces on the drip flange **36** on the syringe **12** which push against the outside housing or a seal of the syringe port **16** and urge the retention flange **41** against the locking lip **80** on the syringe port **16**. Alternatively, the tightening force to urge the syringe **12** forward may be provided by a resilient member, such as a second elastically resilient member **96** that rotationally urges lock/release ring **84** causing a distal force from interaction of one or more surfaces **39A-39B** of the engagement members **32** on the syringe **12** and the one or more tapered guiding surfaces **85A-85B** of syringe engagement member **83** or a third resilient member (not shown) that urges the lock/release ring **84** in a distal direction, and when cooperating with a syringe **12** of sufficient length, urges the retention flange **41** against the locking lip **80**. The detachment surfaces of the syringe **12** and syringe port **16** that cooperate to disengage or remove the syringe **12** from the syringe port **16** are surfaces of the engagement members **32** of the syringe **12** and surfaces of the syringe engagement member

83 of the syringe port **16**. The ejection surfaces of the syringe **12** and syringe port **16** that cooperate to create a distally directed force to urge ejection of the syringe **12** from the syringe port **16** are the one or more tapered surfaces **39A, 39B** on the engagement members **32** of the syringe **16** and one or more tapered guiding surfaces **85A-85B** of the syringe engagement member **83** on the syringe port **16**. The rotational stop surfaces of the syringe **12** and syringe port **16** that cooperate to prevent rotation as a luer connector is screwed onto the syringe **12** are one or more tapered surfaces **39A, 39B** on the engagement members **32** of the syringe **12** and one or more tapered guiding surfaces **85A-85B** of the syringe engagement member **83** on the syringe port **16**, as well as any frictional force between the one or more surfaces of the retention flange **41** of the syringe **12** and one or more retention surfaces of the deflectable retaining elements **78** of the syringe port **16** and/or between the bottom surface of drip flange **36** and the outside housing or a seal of the syringe port **16**.

[0086] FIGS. 3A-3D show cylindrical plan projection views of various embodiments of the at least one engagement members **32** at the proximal end **20** of the syringe **12** and the syringe engagement member **83** of a corresponding syringe port **16** for receiving the proximal end **20** of the syringe **12**. With reference to FIG. 3A, a cylindrical plan projection view of the interface between the at least one engagement members **32** at the proximal end **20** of the syringe **12** and the syringe engagement member **83** of the lock/release ring **84** is shown in a rotationally aligned orientation for mating the syringe **12** to the syringe port **16**. In this example embodiment, the at least one engagement members **32** on the syringe **12** and the corresponding syringe engagement members **83** on the syringe port **16** are configured as generally sinusoidal projections the proximal end **20** of the syringe **12** having alternating peaks and valleys on the syringe **12** and on the lock/release ring **84**. The engagement members **32** on the syringe **12** project axially away from the terminal end **27** of the syringe **12**. If the syringe **12** and the syringe engagement members **83** are initially misaligned, the downward or distal force in a direction of arrow **A** causes a sliding interaction of the tapered surfaces **39A-39B** on the syringe **12** with the corresponding tapered guiding surfaces **85A-85B** on the syringe engagement members **83**. Such sliding interaction causes the syringe **12** to rotate and self-orient into the correct rotational position for alignment with the corresponding tapered guiding surfaces **85A-85B** on the syringe engagement members **83** and correctly oriented installation of the syringe **12** into the syringe port **16**.

[0087] **FIG. 3B** is another cylindrical plan projection view of an alternative embodiment of the syringe **12**. In this embodiment, the engagement members **32** extend only partially through the thickness of sidewall **19** of the syringe barrel **18**. In some embodiments, the engagement members **32** may be positioned on the outside surface **21** of the syringe barrel **18**. The proximal end **37** of the engagement members **32** may terminate at the terminal end **27** of the syringe barrel **18**. In other embodiments, the proximal end **37** may extend in a proximal direction relative to the terminal end **27** of the syringe barrel **19**, as illustrated, for example, in **FIG. 3A**. In this manner, the syringe barrel **18** can be made stronger for a more rigid axial alignment. Additionally, the interior surface of the proximal end **20** may be formed as a smooth continuous surface for an easier installation of the syringe plunger **26**. Similarly, the lock/release ring **84** may have syringe engagement members **83** that extend only through a portion of the radial thickness of the lock/release ring **84**. **FIG. 3C** is another cylindrical plan projection view of an alternative embodiment in which the engagement members **32** extend only partially through the thickness of sidewall **19** of the syringe barrel **18** and are positioned on the inside surface of the syringe barrel **12**. A corresponding complementary arrangement of the syringe engagement members **83** is present on the lock/release ring **84**. In this embodiment, the inside material of the lock/release ring **84** may strengthen the proximal end **20** of the syringe barrel **18** and allow use in higher pressure injections. In some embodiments, the engagement members **32** may extend through at least a portion of the sidewall **19** of the syringe barrel **18** from the outer surface **21** or the inner surface **23** of the syringe **12**. In other embodiments, the engagement members **32** are formed by creating voids or pockets of appropriate cross sections within the sidewall **19** of the syringe barrel **18**. The voids or pockets may be configured to interact with complementary syringe engagement members **83** present on the lock/release ring **84**.

[0088] **FIG. 3D** is a cylindrical plan projection view of an embodiment of an adapter **12B** for use with an alternative syringe **12A** that cannot itself directly interface with the syringe port **16** and/or locking mechanism **35** described herein. According to an embodiment, the adapter **12B** may be configured, for example as a ring, arc, or other shape, that removably or non-removably attaches to at least a portion of the terminal end **27A** of the alternative syringe **12A** or that may be inserted into locking mechanism **35** in syringe port **16** to adapt locking mechanism **35** to interact with the alternative syringe **12A**. The adapter **12B** may have one or more engagement members **32B** similar to the at least one engagement members **32** of

syringe **12** described herein. Each engagement member **32B** may be configured for interacting with a corresponding syringe engagement member **83** of the syringe port **16**. The distal side of the adapter **12B** may have features or projections that mate with corresponding features or projections of the syringe **12A**. For example, the adapter **12B** may have locking members **87B** that are configured to be received within a corresponding locking member **87A** on the syringe **12A**, or other locking features that allow syringe **12A** to mate with adapter **12B** and be retained within syringe port **16** and/or locking mechanism **35**.

[0089] FIGS. 4A-4Q show portions of the cylindrical plan projection views of various embodiments of a portion of the at least one engagement members **32** on the syringe **12** and the corresponding embodiments of syringe engagement members **83** on the lock/release ring **84** in syringe port **16**. FIGS. 4A-4Q display shapes of alternative embodiments of engagement members **32** (labeled as 32A-32Q) and/or syringe engagement members **83** (labeled as 83A-83Q) suitable for use with embodiments of the syringe **12** and/or lock/release ring **84** in syringe port **16**. FIG. 4A shows segments of engagement members **32** and **83** of the embodiment described herein with reference to FIG. 3A in a cylindrical plan projection view. FIG. 4B illustrates with dotted lines the approximate surfaces of engagement members **32B** on the syringe **12** and the corresponding syringe engagement members **83B** on the syringe port **16** for various embodiments. FIG. 4C shows an embodiment in which a valley **YYC** of syringe engagement members **83C** is extended compared to the surface of engagement member **32C**, while FIG. 4D shows an embodiment in which the surfaces of the syringe engagement member **83D** include one or more linear segments to define a valley **YYD** for receiving engagement member **32D**. FIG. 4E illustrates an embodiment in which at least a portion of a valley **YYE** of **83E** has a substantially rectangular profile, for example, to reduce interference from any debris or other external material while still being capable of interacting with engagement member **34E**. FIG. 4F illustrates an embodiment in which the syringe engagement member **83F** has a flat bottom surface **83FA** with one or more distal projections **83FB** which may selectively contact the engagement members **32F** on the syringe **12**. In this embodiment, the bottom segment of engagement members **32F** of syringe **12** touch valley sections **YYF** of the syringe engagement member **83F** to allow some rotational slop, gap, or tolerance before rotation of the syringe **12** will cause contact between tapered surface **32F** and one or more distal projection **83FB** and a corresponding rotation of the lock/release ring **84F**. In the

embodiment shown in **FIG. 4G**, the bottom segment of the engagement members **32G** do not touch valley sections **YYG** of the syringe engagement member **83G**. Rather, the engagement members **32G** engage at least a portion of the projections **83GB** in an operation similar to that in **FIG. 4F**. **FIG. 4H** shows an embodiment in which both the engagement members **32H** and the syringe engagement members **83H** have at least one segmented linear surface, with the peaks of the syringe engagement members **83H** fitting into but preferably not fully filling the valleys of engagement members **32H** on the syringe **12**. **FIG. 4I** shows another embodiment in which both the engagement members **32I** and syringe engagement members **83I** are too wide to fit completely into the respective valleys to ensure that the interaction takes place between the angled surfaces of the respective members.

[0090] **FIG. 4J** shows engagement members **32J** having a plurality of separate segments of varying length in the longitudinal direction **15**, with the tips or ends of the segments defining the generally sinusoidal profile or other profile described herein required to fit within syringe engagement members **83J**. **FIG. 4K** shows engagement members **32K** having a plurality of separate segments of a common length such that a portion of the segments may flex radially but not circumferentially when the syringe **12** is inserted into the syringe port **16**. In this embodiment, when the engagement members **32K** interact with the syringe engagement members **83K**, the overlapping projections flex radially relative to syringe engagement members **83K** whereas the non-overlapping projections on engagement members **32K** engage the corresponding syringe engagement members **83K** as described herein. In an alternative embodiment, syringe engagement members **83** may include spring-loaded balls or fingers which can travel circumferentially and group together to match the contours of engagement members **32** on the syringe **12** and transmit rotational forces for activation of the disengagement action. **FIG. 4L** shows an embodiment with engagement members **32L** having a rod-shaped structure including a projection substantially parallel with the longitudinal axis **15** configured for interacting with the syringe engagement member **83L**. The engagement members **32L** have a virtual tapering surfaces **39A-39B** extending from a proximal tip of each engagement member **32L** in a distal direction toward the terminal end **27** of the syringe barrel **18** (shown in **FIG. 1B**). **FIG. 4M** shows an embodiment of the engagement members **32M** having a rod-shaped structure with a projection that is angled such that it tapers relative to the longitudinal axis **15** (shown in **FIG. 2B**). In some embodiments, the engagement members **32M** may be sufficiently rigid

to interact with the syringe engagement member **83M**. Other embodiments of engagement member **32** may include a strengthening support between the syringe terminal end **27** and a middle portion of the projection. Alternatively, the engagement members **32M** may flex when rotated for disengagement and thus provide an added spring force during the ejection of the syringe **12** from the syringe port **16**.

[0091] **FIG. 4N** shows an embodiment in which the engagement members **32N** and syringe engagement members **83N** define a saw tooth pattern having substantially linear tapered surfaces meeting to form a substantially angled peak. The engagement members **32N** may have equal or unequal peak to peak height or taper angles relative to the syringe engagement members **83N** or vice versa. **FIG. 4O** illustrates an embodiment in which the frequency of the engagement members **32O** on the syringe **12** is greater than, for example twice, that of the syringe engagement members **83O** on the lock/release ring **84** in syringe port **16**. In other embodiments, the frequency of the engagement members **32O** on the syringe **12** may be an integer multiple to the frequency of the syringe engagement members **83O** on the syringe port **16**. In other embodiments, the frequency of the engagement members **32O** on the syringe **12** may be less than the frequency of the syringe engagement members **83O** on the syringe port **16**, for example an integer ratio of the frequency. **FIG. 4P** illustrates an embodiment in which one or more of the syringe engagement members **83P** is absent. Although not shown, one or more of the engagement members **32P** on the syringe **12** could also be absent. Alternatively, one or more of the engagement members **32P** may be absent. **FIG. 4Q** illustrates an embodiment in which the engagement members **32Q** are rounded at their proximal point and angular at their most distal point, with complementary syringe engagement member **83Q** having a substantially pointed peak. While various non-embodiments for shapes of the at least one engagement members **32** have been represented in **FIGS. 4A-4Q** it is to be understood that such shapes may be used on the syringe engagement members **83** or on both the engagement members **32** and syringe engagement members **83** according to other embodiments of the present disclosure. Further, combinations of the various engagement member shapes may be used on syringe **12**, lock/release ring **84** or both. In addition, the engagement members **32** on a syringe **12** may include various combinations of the various embodiments of the engagement members represented in **FIGS. 4A-4Q** and equivalents, as described herein. Further, the syringe engagement members **83** on a lock/release ring **84** may include various combinations of the various embodiments of the

syringe engagement members represented in **FIGS. 4A-4Q** and equivalents, as described herein.

[0092] **FIG. 5A** is an illustration of a generalized free body diagram of forces present between the tapered surface **39A-39B** on the at least one engagement member **32** and the tapered guiding surface **85A-85B** on the at least one syringe engagement member **83** during insertion of the syringe **12** into the syringe port **16**. The at least one engagement member **32** on the syringe **12** interacts with the at least one syringe engagement member **83** on the syringe port **16** due to a distally directed force **P** provided by the user's hand. Performing a static force analysis on this generalized interaction provides an estimate of the force for insertion as a function of the angle **A** measured from the axial direction of the interaction of the two sets of tapered surfaces for various coefficients of friction μ between the surfaces, as shown in **FIG. 5B**. In some embodiments, the syringe **12** may be made from a polyethylene terephthalate (PET) material, while the lock/release ring **84** may be made from a polyoxymethylene (POM) material, such as DELRIN™. The coefficient of friction μ of DELRIN™ on another DELRIN™ surface is approximately 0.4. The coefficients of friction of various other surfaces can be measured and used in the calculations as appropriate. Using this value, a practical limit of the angle **A** to enable reasonable insertion behavior is approximately 60-65 degrees measured relative to a direction of the longitudinal axis **15** of the syringe **12**. Other practical limits of angle **A** may be determined for other coefficients of friction to determine the optimal angle range for tapered surfaces **39A-39B** and **85A-85B** of the at least one engagement members **32** and the at least one syringe engagement members **83**, respectively. For a coefficient of friction of 0.6, an angle less than 50-55° may be used.

[0093] **FIG. 6A** shows an overlay of three different sinusoidal designs for the at least one engagement members **32** of syringe **12**. Pattern **AA** has a peak to peak height of 0.2 inch and a repetition of 16 cycles around a 1.9 inch diameter syringe. The barrel wall thickness is relatively small compared to the syringe diameter. Pattern **BB** has a peak to peak height of 0.2 inch, and a repetition of 6 cycles around the 1.9 inch diameter syringe. Pattern **CC** has a peak to peak height of 0.4 inch with a repetition of 8 cycles around a 1.9 inch diameter syringe. **FIG. 6B** shows the angular orientation relative to the longitudinal axis **15** (shown in **FIG. 5A**) around a circumference of a 1.9 inch diameter syringe. The angle may be expressed by a formula $\text{Angle} = 90 - \text{Abs}(\text{ArcTan}(-(\text{H} * \text{N} / \text{D}) * \text{Sin}(\text{N} * \text{theta})))$, where H is the peak to peak height of the pattern, D is the diameter of the pattern, N is the number of cycles

of repetition around the barrel, and the angle is measured from a direction parallel to the orientation of the longitudinal axis **15** shown in **FIG. 5A**. From this calculation, patterns AA and CC have small portions where the angle is above 65° and thus may be difficult to insert.

[0094] **FIG. 7A** is an illustration of a generalized free body diagram of forces between the tapered surface **39A-39B** on the at least one engagement member **32** and the tapered guiding surface **85A-85B** on the at least one syringe engagement member **83** present during release ejection of the syringe **12** into the syringe port **16**. The forces on the syringe **12** are the normal force **N1** and frictional force **F1** of the engagement member **32** against the engagement member **83**, the normal force **N2** and frictional force **F2** of the deflectable retaining elements **78** on the retention flange **41** as well as the rotational force **T** applied by the user to rotate the syringe and any force **D** urging the syringe proximally provided by the drip flange **36**, for example. The syringe engagement member **83** there has a normal force **N3** and frictional force **F3** as it slides over base **98** and the restoring force **S** from the second elastically resilient members **96**. As shown in **FIG. 7B**, the static analysis shows that the angle **A** is needed for slip at the interface between engagement member **32** and the syringe engagement member **83**. For a coefficient of friction μ_1 of 0.4, the minimum angle is approximately 20 degrees. Thus for angles greater than 20 degrees, there will be slip and upon sufficient motion for the deflectable retaining elements **78** to clear the retention flange **41**, the syringe will be ejected from the syringe port **16**. **FIG. 7C** shows a ratio of the rotational force **T** to rotate the syringe **12** as the restoring force **S** of the second elastically resilient member **96** increases. The ratio is relatively constant as the angle increases, but the ratio increases dramatically at higher angles. In some examples, an angle of at least 30 degrees and less than approximately 60 degrees may be used.

[0095] In another embodiment, the presence or absence of one or more of the at least one engagement members **32** around the circumference of the syringe barrel **18** may be used to convey or encode information about the syringe **12** or the syringe contents (for example with prefilled syringes). For example, such presence or absence of one or more of the at least one engagement members **32** at specific sites around the circumference of the syringe **12** can be sensed by various electronic means, for example, optical sensors, mechanical switches, capacitive sensors, and other means within the syringe port **16** of injector **10**. As an example of encoded information that may be represented by the presence or absence of one or more of the at least one engagement members **32**, a single code can be indicative of the absence of

engagement member **32**, the absence of two or more engagement members **32** may provide multiple codes, for example for different spaces between the engagement members **32**.

[0096] With reference to **FIG. 8A**, a coupling **130**, including a mounting member therefor, can be fabricated to be separate from and attachable to the syringe barrel **18**. The coupling **130** can, for example, be configured to accept the syringe **12** having at least one engagement member **32** described herein and to adapt the syringe **12** for use with a fluid injector having a syringe port with a locking mechanism not configured to receive the at least one engagement member **32**. For example, the coupling **130** can adapt the syringe **12** for use with the fluid injector described in United States Patent No. 5,383,858 or United States Patent No. 6,652,489, or any other fluid injector. In some embodiments, the coupling **130** is releasably connectable to the injector. In other embodiments, the coupling **130** may be inserted into and retained in a locking mechanism of the fluid injector. The coupling **130** may also be releasably connected or attached to the syringe **12** independently of the attachment of the coupling to the injector.

[0097] With reference to **FIG. 8A**, the coupling **130** has a first portion **132** configured for receiving the syringe **12** having at least one engagement member **32** according to an embodiment described herein and a second portion **134** configured for loading into an injector having a syringe port not configured to receive the syringe **12** having at least one engagement member **32** according to an embodiment described herein. The first portion **132** may be directly connected and monolithically formed with the second portion **134**. In some embodiments, the first portion **132** may be releasably connected to the second portion **134** such that various second portions (shown in **FIGS. 9A-9B**) may be used with the first portion **132**. With continued reference to **FIG. 8A**, the first portion **132** has a locking mechanism **35** described herein. In various embodiments, the first portion **132** of the coupling **130** may be configured for releasably receiving the syringe **12** having a corresponding at least one engagement member **32**, as described herein. With reference to **FIGS. 9A-9B**, the second portion **134** of the coupling **130** may have a connection interface configured for connecting with an injector that would otherwise not be capable of receiving the syringe **12** having at least one engagement member **32** described herein. **FIG. 9A** shows the second portion **134** configured for use with an engagement mechanism of the injector described in United States Patent No. 5,383,858, while **FIG. 9B** shows the second portion **134** configured for use with an engagement mechanism of the injector described in United States Patent No. 6,652,489.

The second portion **134** may be configured to interface with various other injectors not expressly described herein, based on the configuration of the engagement mechanism on the proximal end of the syringe. In some embodiments, the coupling **130** may have a separate mechanism for engaging and disengaging the coupling **130** to and from a locking mechanism of the injector.

[0098] With reference to **FIG. 8B**, an adapter **230** may be configured to receive a syringe **S** not having one or more engagement members **32** described herein for removably inserting into an injector having the locking mechanism **35** in accordance with one of the embodiments described herein. In various embodiments, the adapter **230** may be configured for connecting to a syringe **S** for subsequent installation on an injector. For example, the adapter **230** may be connected to the non-compatible syringe **S** releasably or permanently. Such an adapter **230** may have a connection interface having at least one engagement member **32** in accordance with embodiments described herein. The adapter **230** may be configured for being releasably connectable with an injector having a locking mechanism **35** described herein. The adapter **230** and the syringe **S** may be connected prior to connecting to the injector, or the adapter **230** may be connected to the injector before the syringe **S** is connected to the adapter **230**. The adapter **230** and syringe **S** may be removed from the injector after use, with the adapter **230** being disposed of with the syringe **S**, or being removed from the used syringe **S** and saved for subsequent use with a different syringe **S**.

[0099] In one embodiment, a first portion **232** of the adapter **230** may be configured for permanently or releasably receiving the syringe **S** which is not compatible for use with any of the locking mechanisms **35** described herein. In some embodiments, the syringe **S** may be the syringe described in United States Patent No. 5,383,858 or United States Patent No. 6,652,489, or any other syringe type. The adapter **230** allows the non-compatible syringe **S** to engage and be retained by the locking mechanism **35** described herein. In some embodiments, the adapter **230** may have a separate mechanism for engaging and disengaging the syringe **S** while the adapter **230** remains connected to the locking mechanism **35** of the injector **10**. The first portion **232** may also be a cradle or sleeve to hold or retain other syringes **S**, for example hand held syringes or syringes having different retention mechanisms or features and allowing them to engage and be retained by locking mechanisms **35**. A second portion **234** of the adapter **230** may have at least one engagement member **32** in accordance with embodiments described herein. In some embodiments, the at least one

engagement member **32** may have the configuration described herein with reference to **FIGS. 1B-4Q**. The second portion **234** of the adapter **230** may be configured for being releasably connectable with an injector having a locking mechanism **35** described herein. In this manner, various non-compatible syringes **S** may be used with an injector having a locking mechanism **35** described herein. In various embodiments, the adapter **230** may be configured for connecting a pressure jacket (not shown) to the injector for use in injection procedures requiring high pressure. For example, the adapter **230** having the pressure jacket may be configured for being releasably connectable with an injector. Such an adapter **230** may have a connection interface having at least one engagement member **32** in accordance with embodiments described herein or alternatively have a connection interface that allows non-compatible syringes to be used with the injector. The adapter **230** may be configured for being releasably, permanently, or semi-permanently connectable with an injector having a locking mechanism **35** described herein and allowing syringes **S** having alternate retaining mechanisms to be used with the injector. Once connected with the injector, a syringe **S** may be loaded into the adapter **230** or the pressure jacket attached thereto and be retained therein at its proximal or distal end.

[00100] In various embodiments, an adapter **230** may be configured for connecting a syringe having some but not all of the features necessary for subsequent installation into an injector **10** described herein, as described herein with reference to **FIG. 3D**. The adapter **230** allows a syringe which could not by itself mate or function fully with injector port **16** to mate and at least perform the retention function with the locking mechanism **35**. By rotating the adapter **230**, the syringe and the adapter may be released from the syringe port. Similarly upon insertion, the adapter **230** may be pushed proximally for engagement with the syringe. As discussed herein, an adapter can be a ring, such as adapter **12B** shown in **FIG. 3D** which interfaces with the injector port **16** and the syringe **12A**. Optionally, the adapter **230** can include additional surfaces (not shown) such as levers, handles, or rings by which the operator can move one or more aspects of the adapter to release the adapter from the syringe port and/or release the syringe from the adapter without having to directly apply a force to or move the syringe.

[00101] With reference to **FIG. 2A**, a system may be provided to transmit information from the syringe **12** to the injector **10** (shown in **FIG. 1A**). In one embodiment, the syringe **12** may be provided with one or more encoding devices **49** for example, on one or more of

the engagement members **32**. In other embodiments, the one or more encoding devices **49** may be provided on the outer surface **21** (shown in **FIG. 1B**), the inner surface **23** (shown in **FIG. 1B**), within at least a portion of the sidewall **19** (shown in **FIG. 1B**) of the proximal end **20** of the syringe **12**, or on the plunger **26**. In some embodiments, the encoding device **49** may be an optically readable member, such as a barcode, while in other embodiments, the encoding device **49** may be an RFID tag, near-field communication device, or any other suitable encoding device. A plurality of encoding devices **49** may be disposed around an inner or outer circumference of the syringe **12** and/or the plunger **26**. At least one sensor **51** (shown in **FIG. 2A**) may be provided on the syringe port **16** to read the encoding device **49**. In some embodiments, the at least one sensor **51** may be provided on at least one deflectable retaining element **78**. Examples of information which could be encoded on encoding device **49** include, without limitation, dimensions of syringe **12**, volume of syringe **12**, content of the syringe **12** (in the case of a pre-filled syringe), manufacturing information such as lot numbers, dates and tool cavity number, recommended contrast media flow rates and pressures, and/or loading/injection sequences. In one embodiment, the presence or absence of one or more engagement members **32** may serve as the encoding device. For example, one absent engagement member **32** may represent a first code. Two or more adjacent absent engagement members **32** may represent a second code. Two or more non-adjacent absent engagement members **32** may represent a third code. Various other combinations of present/absent engagement members **32** may represent various other codes. The presence or absence of individual engagement members **32** can be determined by the injector using mechanical switches, electrical material sensors, optically, visually, or by other means known in the sensing art. This syringe encoding information is communicated to the injector control for communication to the operator and for subsequent use in correctly programming and controlling the injector.

[00102] In some embodiments, at least a portion of the injector **10** (shown in **FIG. 1A**), such as the base **70** of the locking mechanism **35** shown in **FIGS. 2A** and **3A**, may have an inner support ring (not shown) that protrudes into at least a portion of the interior volume **25** of the proximal end **20** of the syringe **12**. Such a support ring may be removably extendable into at least a portion of the interior volume **25**. The support ring may provide radial and axial support to at least a portion of one or more engagement members **32** and/or the inner sidewall **23** (shown in **FIG. 1B**) of the syringe **12** when the syringe **12** is inserted into the

locking mechanism **35**. In embodiments where at least one sensor **51** is provided on the syringe port **16**, such as shown in **FIG. 2A**, the support ring may provide a contrasting surface for detecting the presence or absence of the at least one encoding device **49**. For example, the support ring may provide a contrasting opaque surface against a translucent or transparent sidewall **19** of the syringe **12** to facilitate the detection of the at least one encoding device **49**.

[00103] Although the disclosure has been described in detail for the purpose of illustration based on what is currently considered to be the most practical and preferred embodiments, it is to be understood that such detail is solely for that purpose and that the disclosure is not limited to the disclosed embodiments, but, on the contrary, is intended to cover modifications and equivalent arrangements. For example, it is to be understood that the present disclosure contemplates that, to the extent possible, one or more features of any embodiment can be combined with one or more features of any other embodiment.

CLAIMS:

1. A syringe comprising:
a barrel having a distal end, a proximal end, and a sidewall extending substantially circumferentially between the distal end and the proximal end along a longitudinal axis; and
at least one engagement member protruding from a terminal portion of the sidewall in a proximal direction along the longitudinal axis, the at least one engagement member tapering axially in a direction from the distal end toward the proximal end,
wherein the at least one engagement member is configured for engagement with a locking mechanism of a fluid injector to releasably position the syringe with a syringe port of the fluid injector, and
wherein a taper of the at least one engagement member rotationally guides the syringe into self-orienting alignment with the locking mechanism and axially ejects the syringe upon rotation of the syringe.
2. The syringe of claim 1, wherein a plurality of engagement members extend about at least a portion of a circumference of the terminal portion.
3. The syringe of claim 2, wherein the plurality of engagement members are spaced apart evenly about the circumference of the terminal portion.
4. The syringe of any one of claims 1 to 3, wherein the at least one engagement member has a wave form or sinusoidal form.
5. The syringe of any one of claims 1 to 4, wherein the at least one engagement member has a pointed proximal end with at least one tapered surface that extends from the pointed proximal end in a distal direction along the longitudinal axis to the terminal portion of the sidewall.

6. The syringe of claim 5, wherein the pointed proximal end of the at least one engagement member has a sharp or rounded point.

7. The syringe of claim 5 or 6, wherein the at least one tapered surface is angled relative to a direction of the longitudinal axis.

8. The syringe of any one of claims 5 to 7, wherein the at least one tapered surface is linear or curvilinear.

9. The syringe of any one of claims 5 to 8, wherein the at least one tapered surface is continuous or discontinuous.

10. The syringe of any one of claims 5 to 9, wherein the at least one tapered surface is planar.

11. The syringe of any one of claims 1 to 10, further comprising at least one encoding device on at least a portion of the syringe.

12. The syringe of claim 11, wherein the at least one encoding device is on at least one of the at least one engagement member.

13. The syringe of any one of claims 1 to 12, wherein the at least one engagement member is monolithically formed with the terminal portion of the sidewall.

14. The syringe of any one of claims 1 to 13, wherein the at least one engagement member is separable from the terminal portion of the sidewall.

15. The syringe of any one of claims 1 to 14, further comprising a flange protruding radially outwardly from an outer surface of the sidewall relative to the longitudinal axis and

distally of the at least one engagement member for engaging with the locking mechanism of the fluid injector to releasably lock the syringe with the syringe port of the fluid injector.

16. The syringe of claim 15, wherein the flange extends around at least a portion of the outer surface of the sidewall.

17. The syringe of claim 15 or 16, wherein the flange has a longitudinal stop surface for limiting a length of a longitudinal insertion of the syringe into the locking mechanism.

18. The syringe of any one of claims 1 to 17, wherein the at least one engagement member has a circular, triangular, or a polygonal shape.

19. The syringe of any one of claims 1 to 18, further comprising a plunger slidably disposed within the barrel and movable between the proximal end and the distal end.

20. A fluid injection apparatus, comprising:

at least one syringe comprising a barrel with a distal end, a proximal end, and a sidewall extending substantially circumferentially between the distal end and the proximal end along a longitudinal axis, the barrel having at least one engagement member protruding from a terminal portion of the sidewall in a proximal direction along the longitudinal axis, the at least one engagement member tapering axially in a direction from the distal end toward the proximal end;

an injector comprising an injector housing defining at least one syringe port for receiving the at least one syringe; and

a locking mechanism associated with the at least one syringe port for securing the at least one syringe within the at least one syringe port, the locking mechanism configured for engaging the at least one engagement member of the at least one syringe to releasably position the at least one syringe within the at least one syringe port,

wherein a taper of the at least one engagement member is configured to rotationally guide the at least one syringe into self-orienting alignment with the locking mechanism and axially ejects the at least one syringe upon rotation of the at least one syringe.

21. The fluid injection apparatus of claim 20, wherein the locking mechanism further comprises:

a housing having a central opening configured to receive the proximal end of the at least one syringe;

a guide ring fixed relative to the housing with a central axis of the guide ring in coaxial alignment with a central axis of the housing, the guide ring having at least one recess extending from an inner circumference of the guide ring to an outer circumference of the guide ring;

at least one deflectable retaining element configured to be movably received within the at least one recess of the guide; and

a releasable lock ring configured for selective engagement with the at least one engagement member when the at least one syringe is inserted into the at least one syringe port, the releasable lock ring being rotatable relative to the housing with a rotation of the at least one syringe about the longitudinal axis.

22. The fluid injection apparatus of claim 21, further comprising at least one elastically resilient member connected at one end to at least a portion of the at least one deflectable retaining element to urge the at least one deflectable retaining element in a radially inward direction.

23. The fluid injection apparatus of claim 21 or 22, wherein the at least one deflectable retaining element comprises a locking lip that is angled relative to the longitudinal axis such that movement of the at least one syringe in a proximal direction causes movement of the at least one deflectable retaining element in a radially outward direction.

24. The fluid injection apparatus of any one of claims 21 to 23, wherein the releasable lock ring comprises one or more syringe engagement members that have a complementary shape to receive the at least one engagement member.

25. The fluid injection apparatus of any one of claims 21 to 24, wherein the releasable lock ring comprises at least one guide slot disposed on a top surface to guide a movement of the at least one deflectable retaining element.

26. The fluid injection apparatus of claim 25, wherein the at least one guide slot comprises at least one guide track.

27. The fluid injection apparatus of claim 26, wherein the at least one deflectable retaining element engages the at least one guide track at a first end when the at least one deflectable retaining element is in a first radial position, and

wherein the at least one deflectable retaining element engages the at least one guide track at a second end when the at least one deflectable retaining element is in a second radial position that is different than the first radial position.

28. The fluid injection apparatus of any one of claims 21 to 27, wherein lateral edges of the at least one recess define a travel path for guiding movement of the at least one deflectable retaining element.

29. The fluid injection apparatus of any one of claims 21 to 28, wherein at least a portion of a top surface of the guide ring defines a stop surface that limits a movement of the at least one syringe in a proximal direction when the at least one syringe is inserted into the at least one syringe port.

30. A syringe comprising:

a barrel having a distal end, a proximal end, and a sidewall extending substantially circumferentially between the distal end and the proximal end along a longitudinal axis;

at least one engagement member protruding from a terminal portion of the sidewall in a proximal direction along the longitudinal axis, the at least one engagement member tapering axially in a direction from the distal end toward the proximal end; and

a flange protruding radially outwardly from an outer surface of the sidewall relative to the longitudinal axis and distally of the at least one engagement member, wherein the at least one engagement member is configured for engagement with a locking mechanism of a fluid injector to releasably position the syringe with a fluid port of the fluid injector, and

wherein a taper of the at least one engagement member rotationally guides the syringe into self-orienting alignment with the locking mechanism and axially ejects the syringe upon rotation of the syringe.

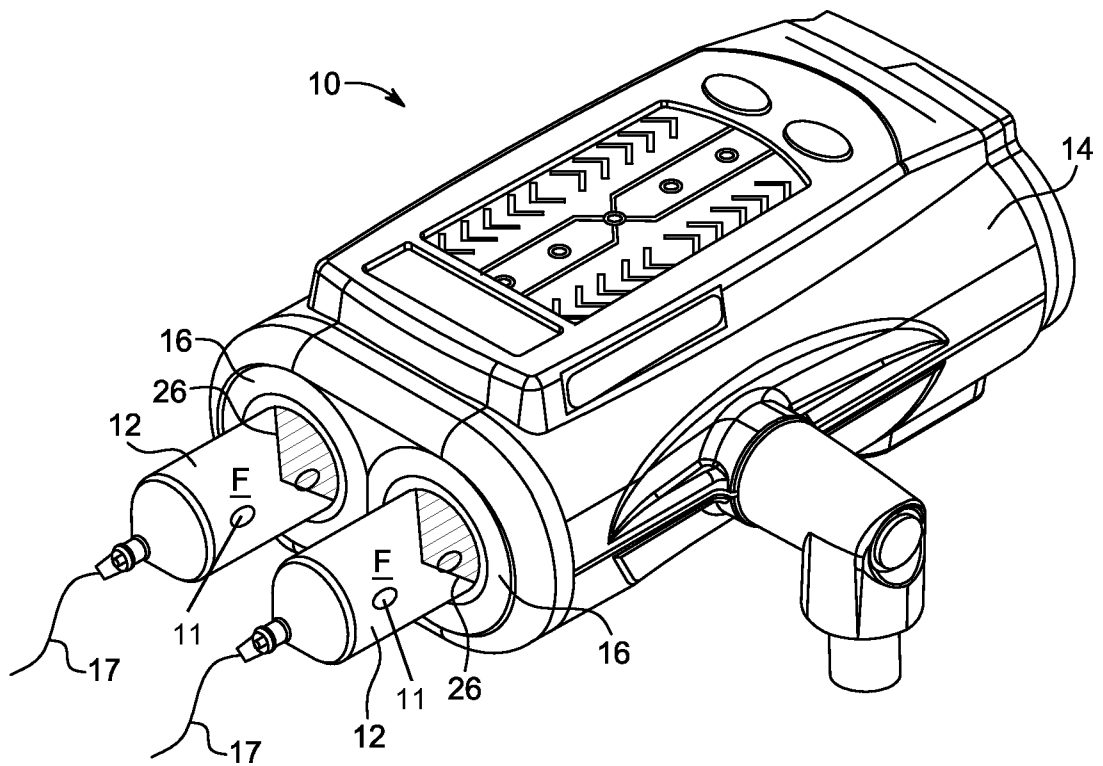

FIG. 1A

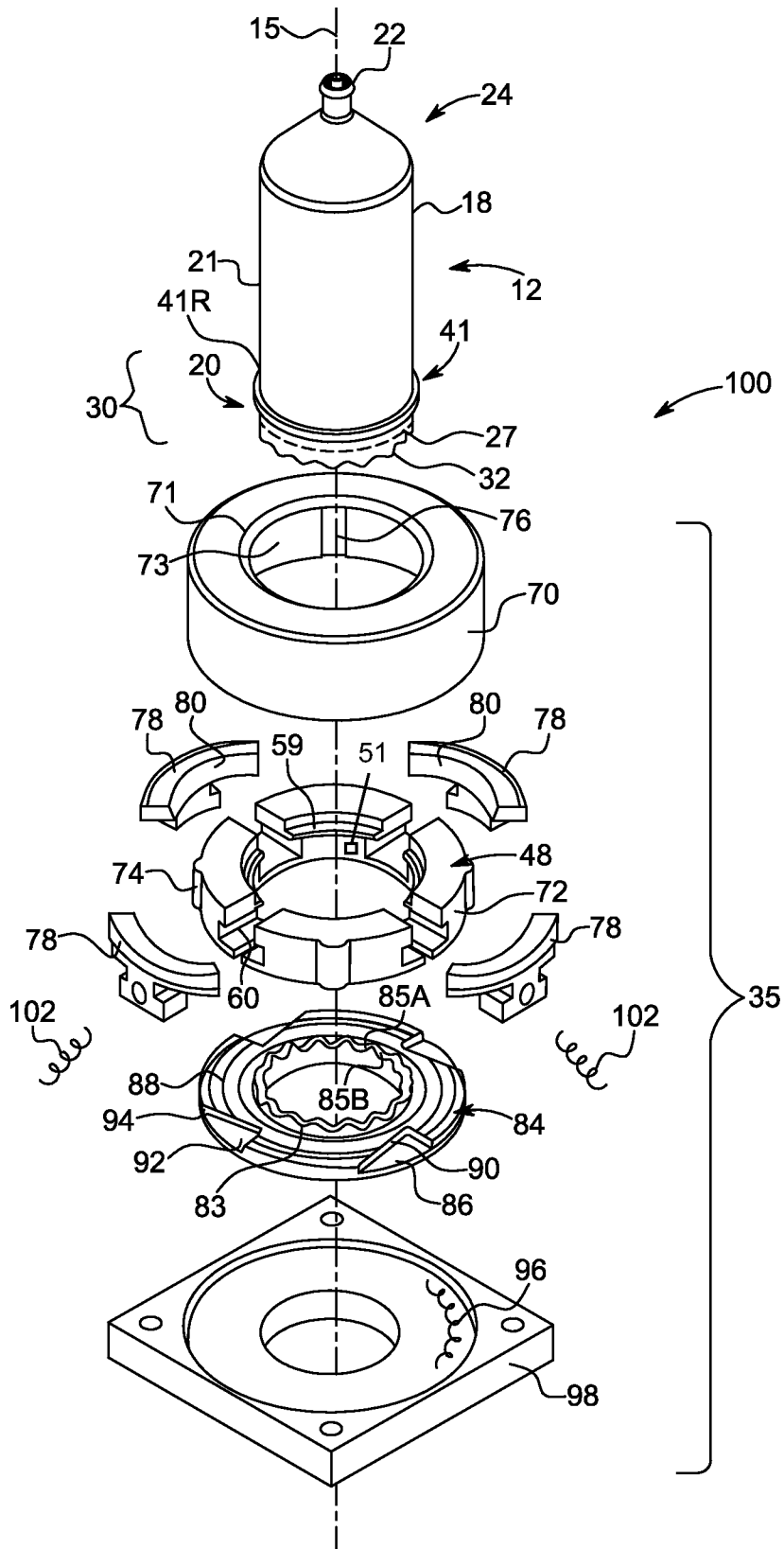

FIG. 2A

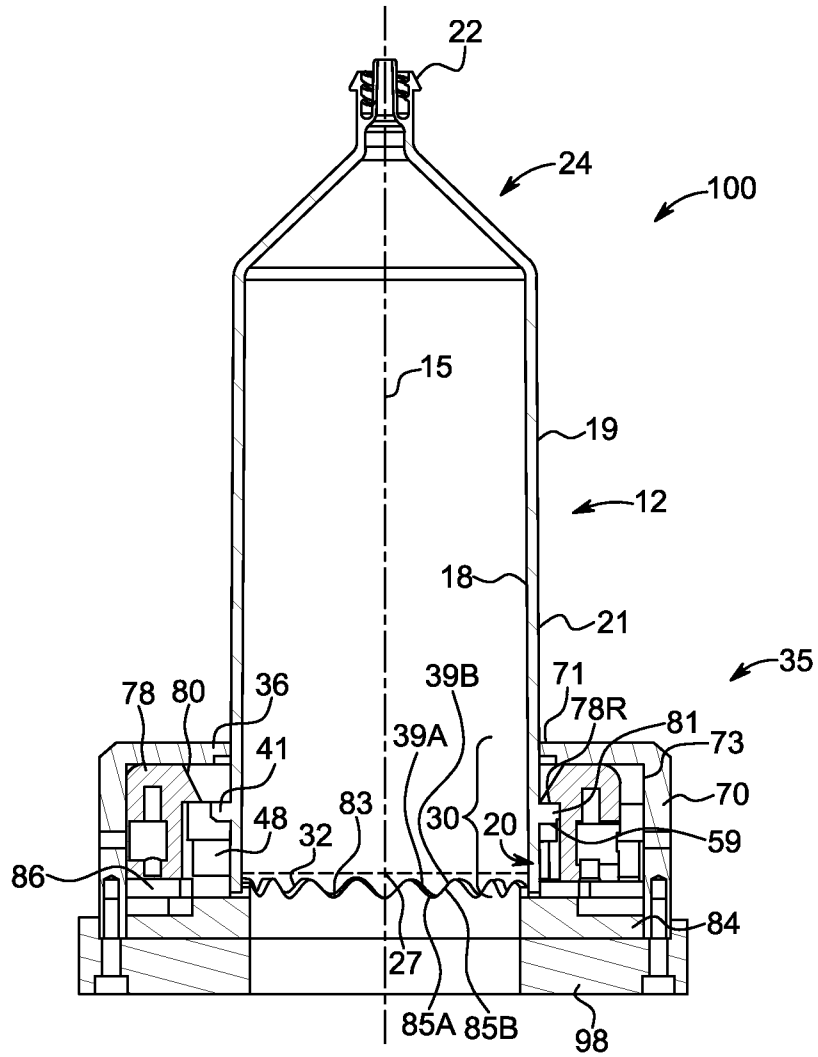

FIG. 2B

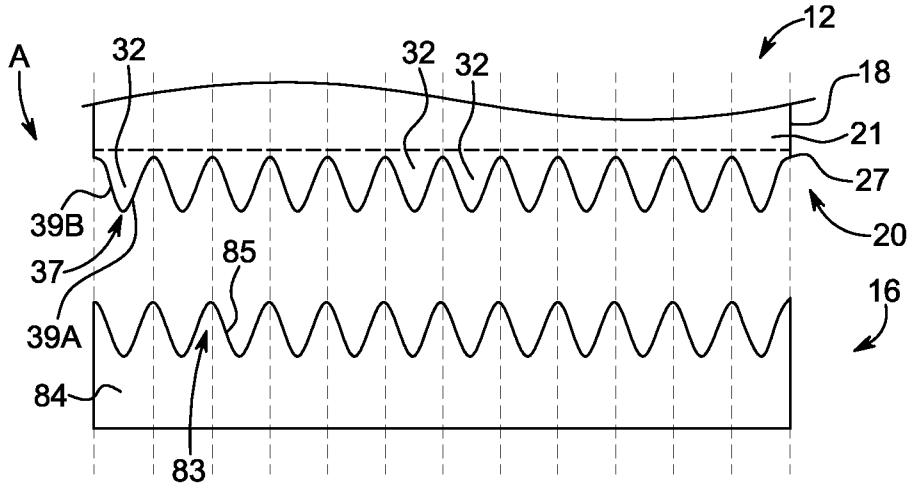

FIG. 3A

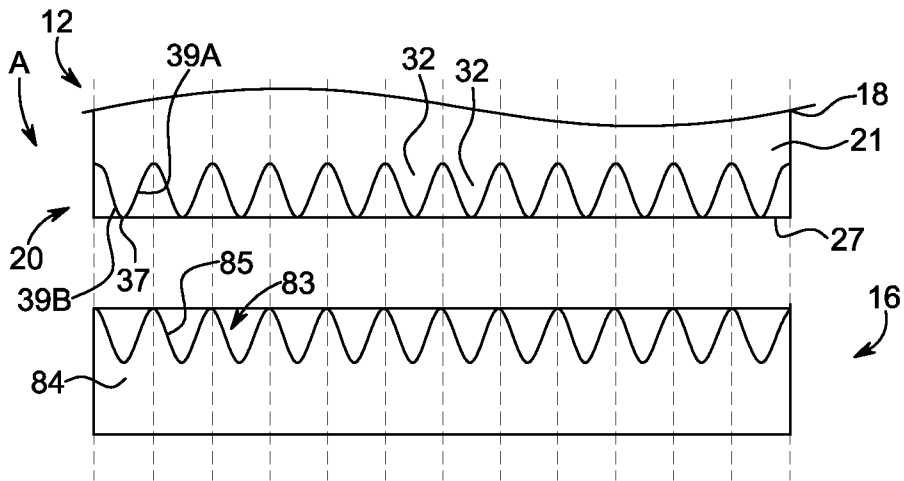

FIG. 3B

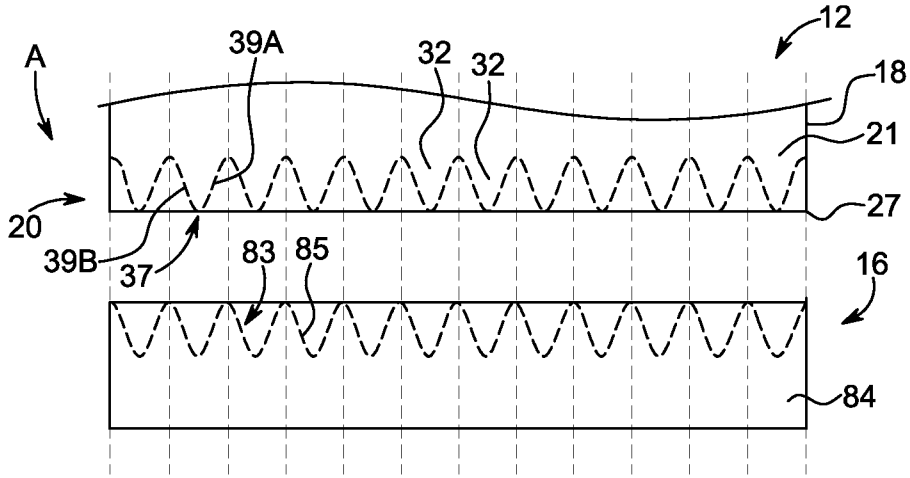

FIG. 3C

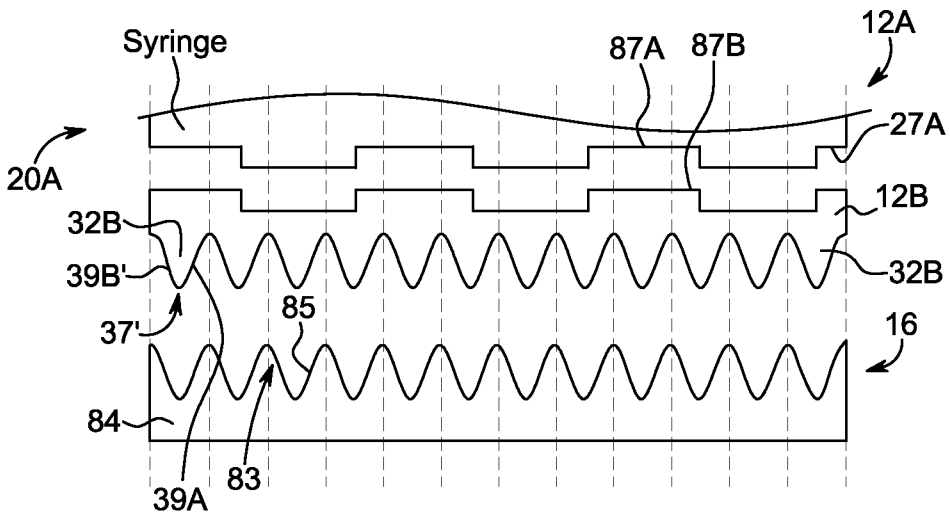

FIG. 3D

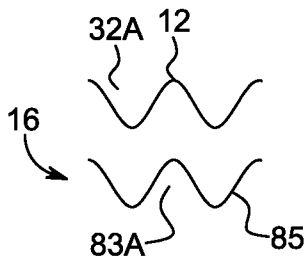

FIG. 4A

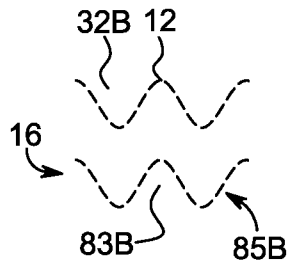

FIG. 4B

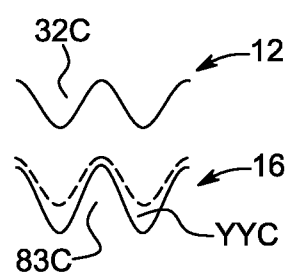

FIG. 4C

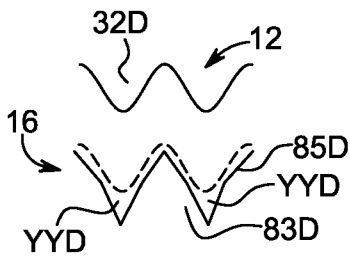

FIG. 4D

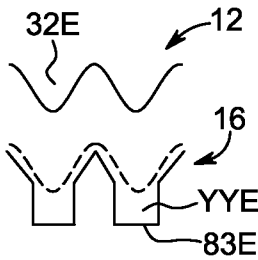

FIG. 4E

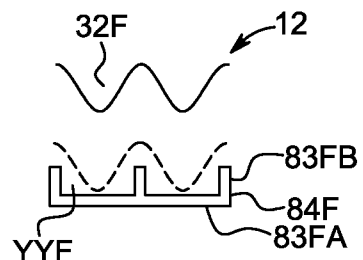

FIG. 4F

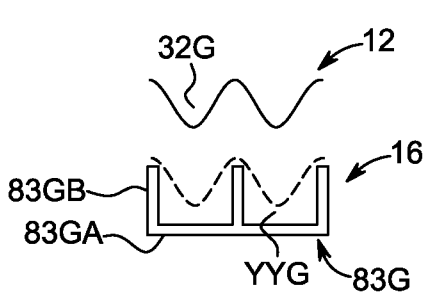

FIG. 4G

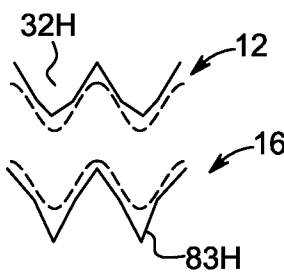

FIG. 4H

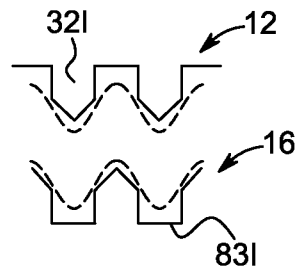
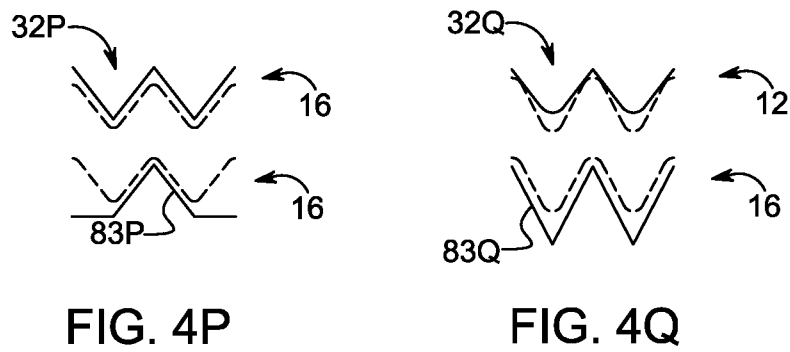
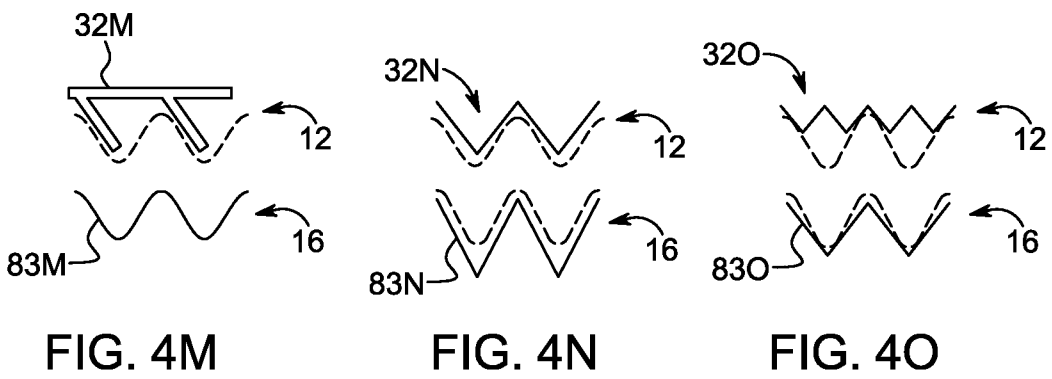
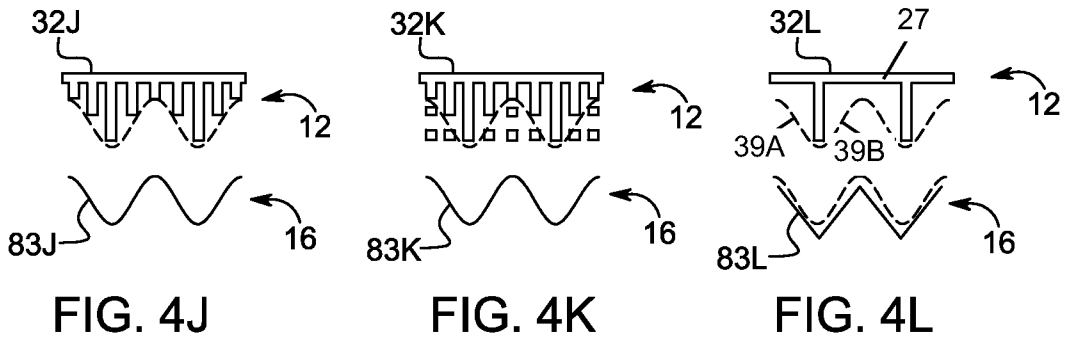

FIG. 4I



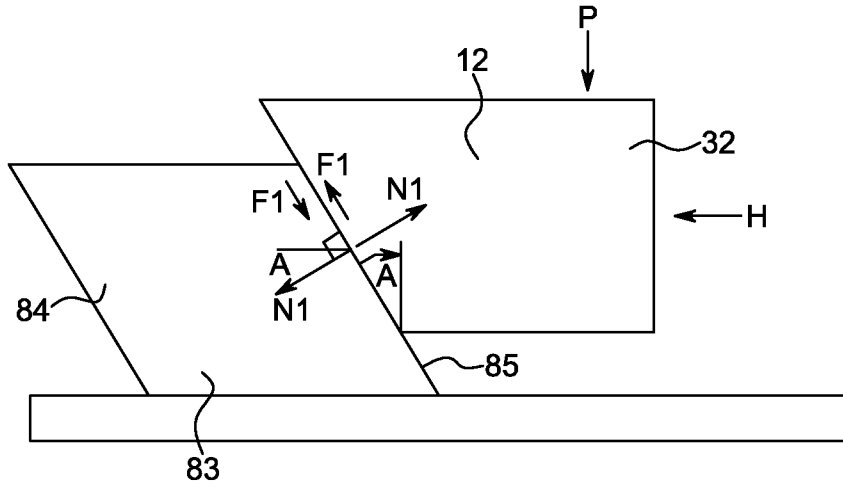

FIG. 5A

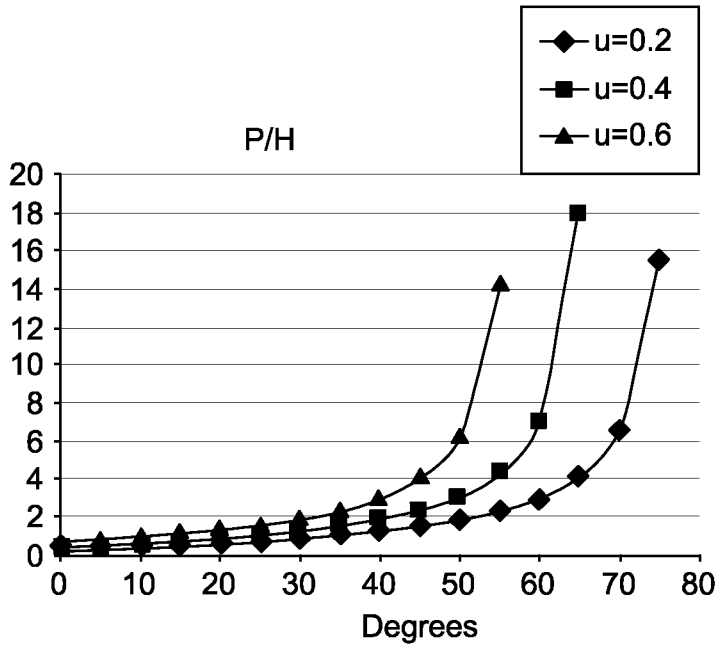

FIG. 5B

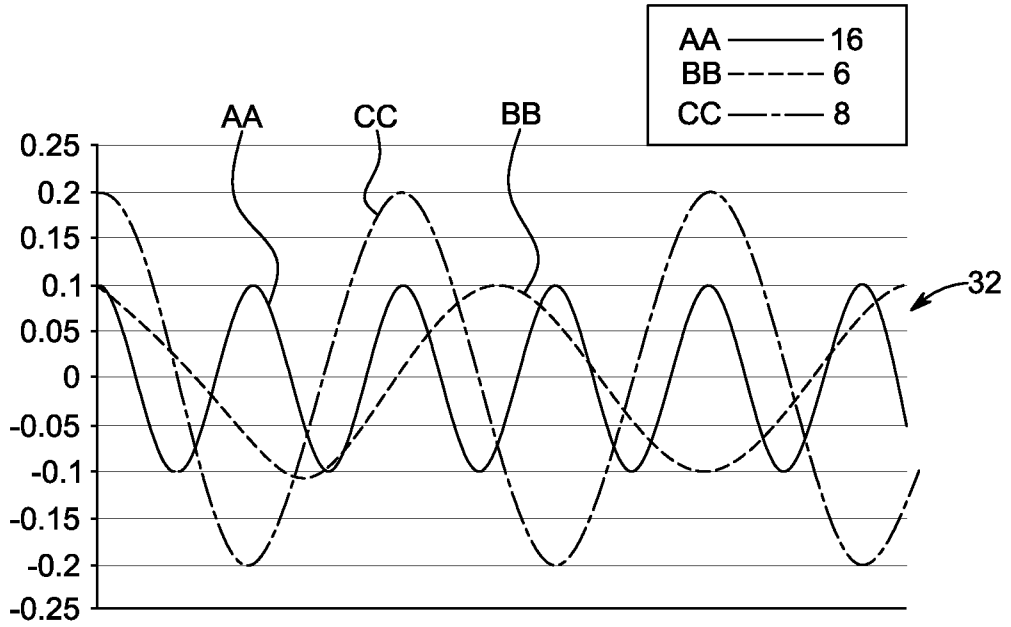

FIG. 6A

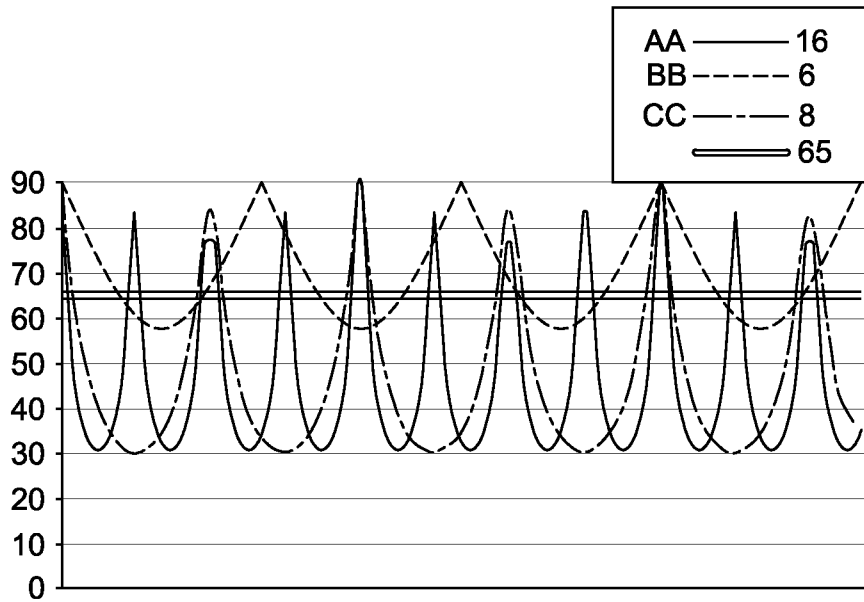

FIG. 6B

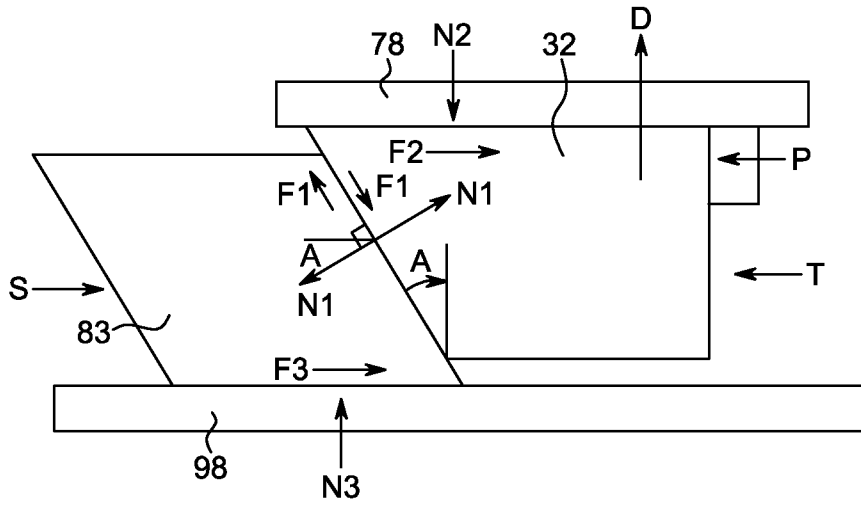

FIG. 7A

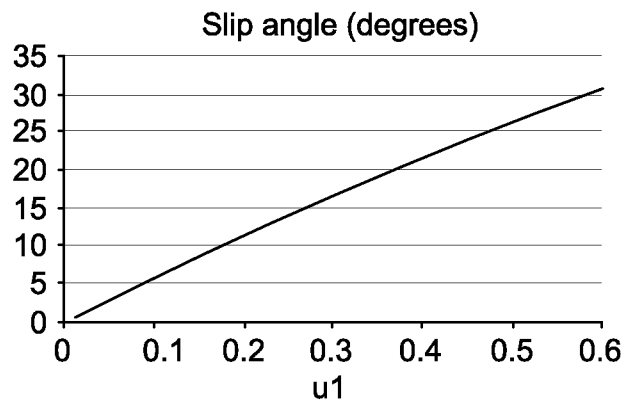

FIG. 7B

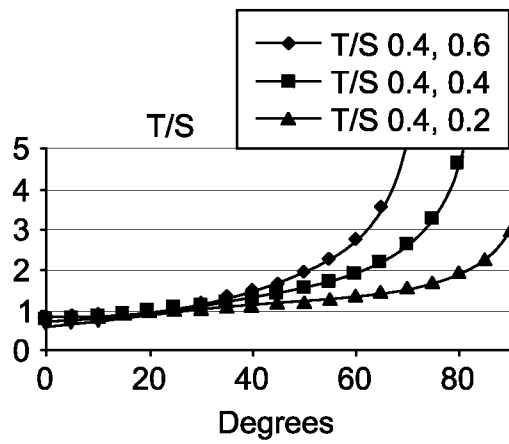

FIG. 7C

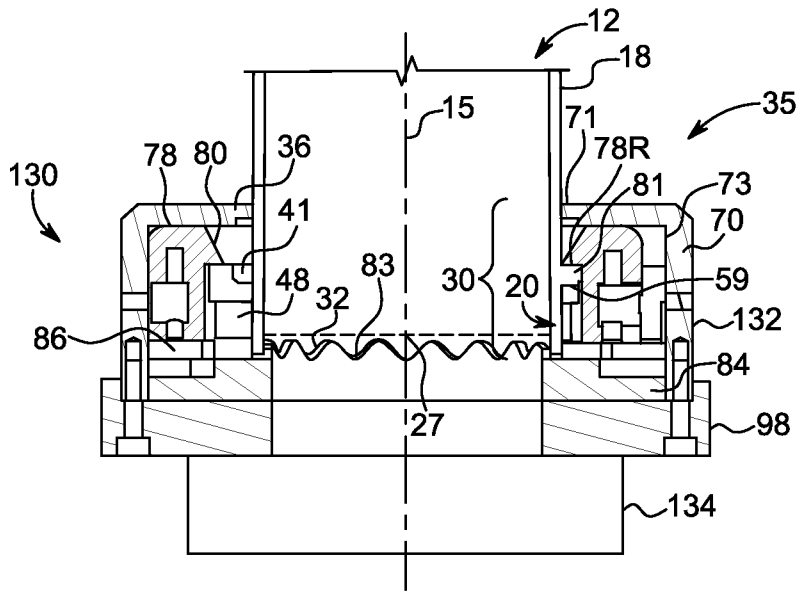

FIG. 8A

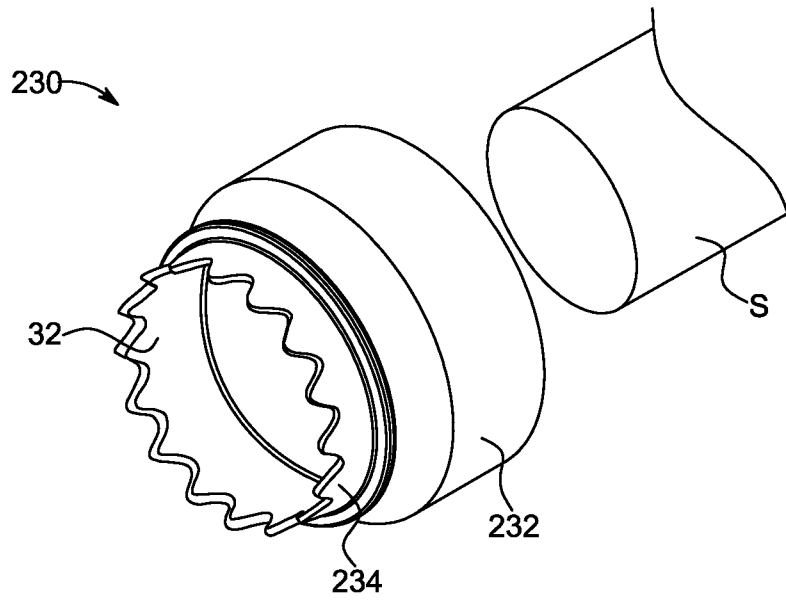

FIG. 8B

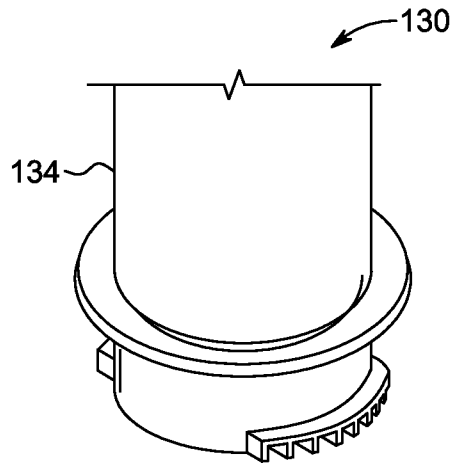

FIG. 9A

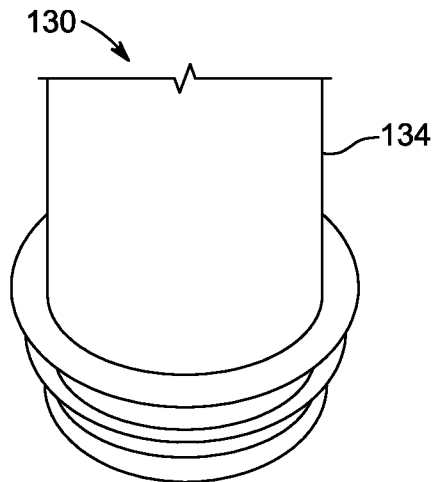

FIG. 9B

