



US00D714730S

(12) **United States Design Patent**
Osada

(10) **Patent No.:** **US D714,730 S**

(45) **Date of Patent:** **** Oct. 7, 2014**

(54) **TERMINAL BLOCK**

(75) Inventor: **Yutaka Osada**, Tokyo (JP)

(73) Assignee: **Osada Co., Ltd.**, Tokyo (JP)

(**) Term: **14 Years**

(21) Appl. No.: **29/418,796**

(22) Filed: **Apr. 20, 2012**

(30) **Foreign Application Priority Data**

Oct. 25, 2011 (JP) 2011-024454

(51) **LOC (10) Cl.** **13-03**

(52) **U.S. Cl.**

USPC **D13/147**

(58) **Field of Classification Search**

USPC D13/133, 146, 147, 154, 184, 199;
439/37, 884, 885, 886, 887, 888, 889,
439/890, 891

See application file for complete search history.

(56) **References Cited**

U.S. PATENT DOCUMENTS

D439,883 S * 4/2001 Miyazoe et al. D13/147
D586,298 S * 2/2009 Kudo D13/147
D640,208 S * 6/2011 Huss et al. D13/154

D666,975 S * 9/2012 de Bruijn et al. D13/147
D673,913 S * 1/2013 Kajiura et al. D13/147
2003/0216087 A1* 11/2003 Pan 439/885

* cited by examiner

Primary Examiner — Daniel Bui

Assistant Examiner — Khawaja Anwar

(74) *Attorney, Agent, or Firm* — Rhodes Donahoe, LLC

(57) **CLAIM**

The ornamental design for a terminal block, as shown and described.

DESCRIPTION

FIG. 1 is a front elevation view of a terminal block showing my new design;

FIG. 2 is a rear elevation view thereof;

FIG. 3 is a right side elevation view thereof;

FIG. 4 is a left side elevation view thereof;

FIG. 5 is a top plan view thereof;

FIG. 6 is a bottom plan view thereof;

FIG. 7 is a bottom plan view, with a cover removed, thereof;

FIG. 8 is a bottom plan view thereof; and,

FIG. 9 is a top plan view thereof.

The broken line portion in the figure drawing views is included for the purpose of illustrating unclaimed environment and forms no part of the claimed design.

1 Claim, 5 Drawing Sheets

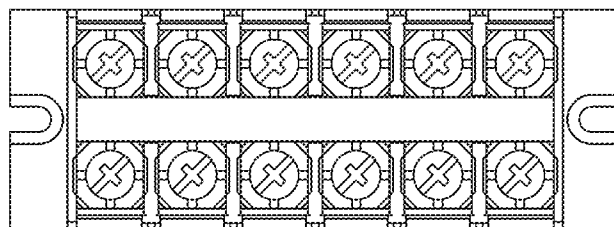
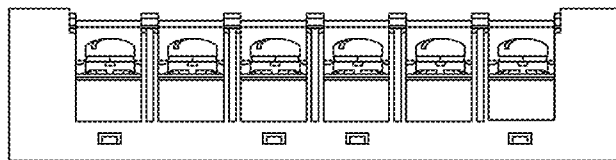

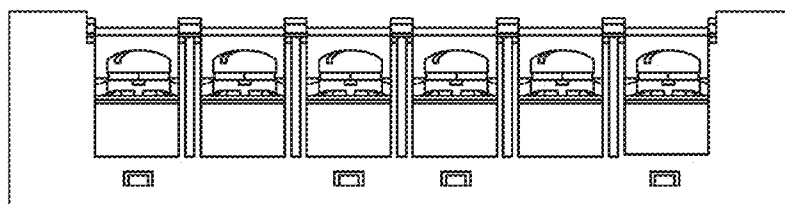

FIG. 1

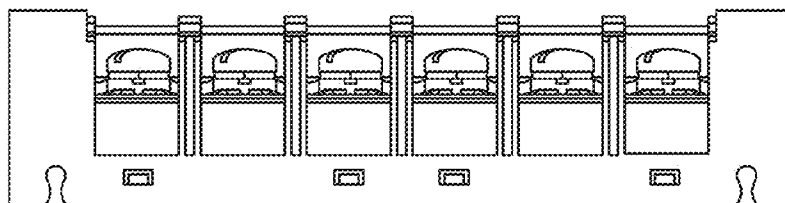

FIG. 2

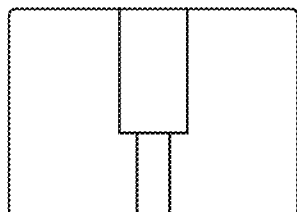

FIG. 3

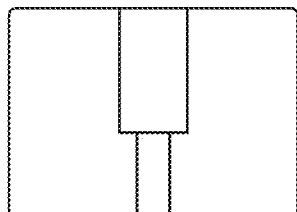

FIG. 4

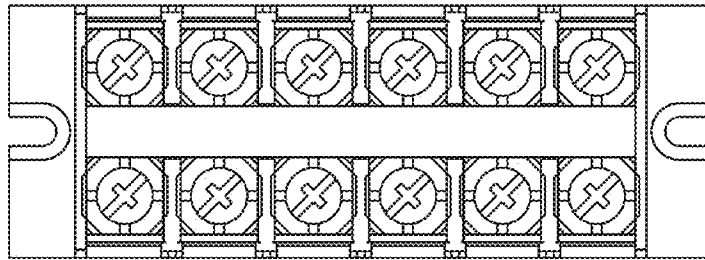

FIG. 5

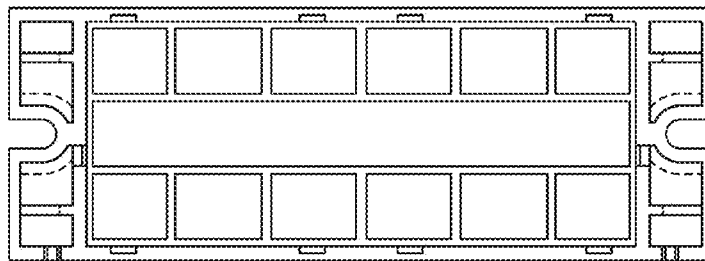

FIG. 6

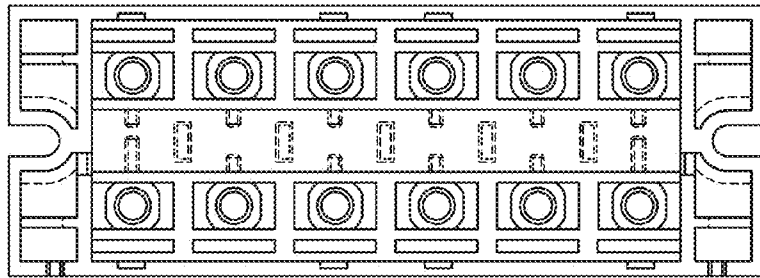

FIG. 7

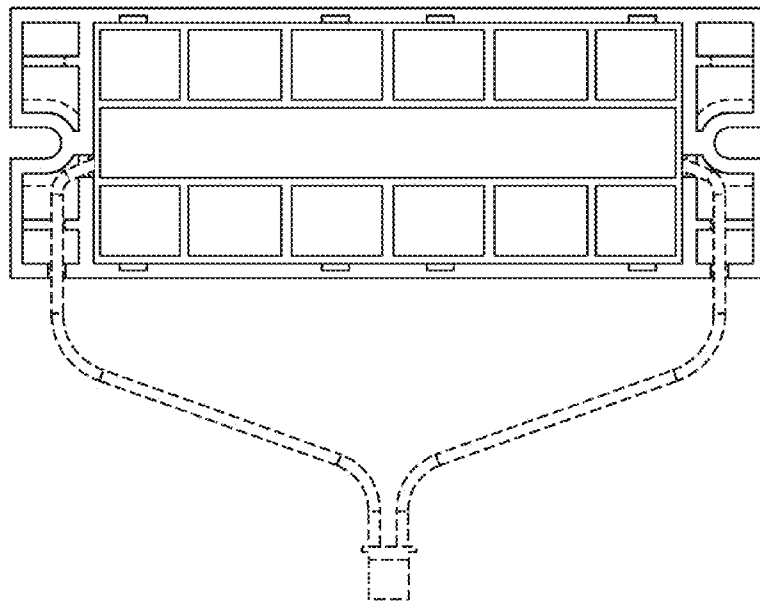

FIG. 8

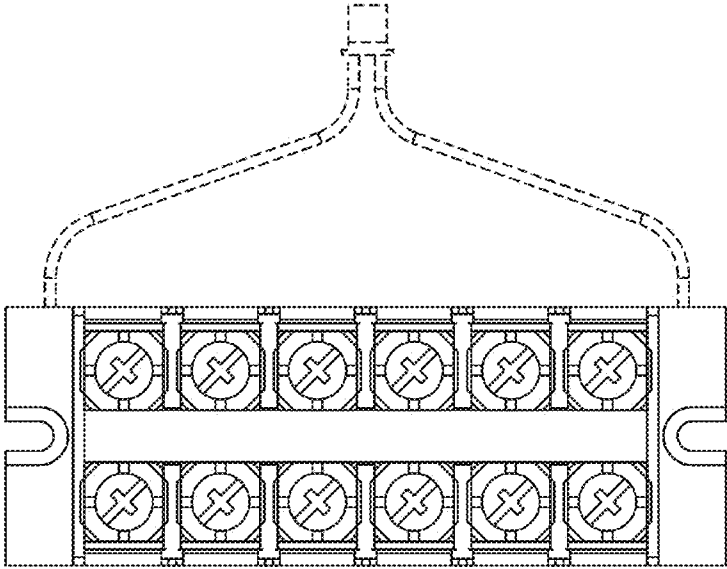

FIG. 9