

(19)



(11)

EP 2 369 103 A3

(12)

EUROPEAN PATENT APPLICATION

(88) Date of publication A3:
22.03.2017 Bulletin 2017/12

(51) Int Cl.:
E05B 65/20^(0000.00) E05B 47/00^(2006.01)

(43) Date of publication A2:
28.09.2011 Bulletin 2011/39

(21) Application number: **11155805.2**

(22) Date of filing: **24.02.2011**

(84) Designated Contracting States:
AL AT BE BG CH CY CZ DE DK EE ES FI FR GB GR HR HU IE IS IT LI LT LU LV MC MK MT NL NO PL PT RO RS SE SI SK SM TR
Designated Extension States:
BA ME

- **Nishio, Takashi**
Kariya-shi, Aichi 448-8650 (JP)
- **Watanabe, Nobuko**
Kariya-shi, Aichi 448-8650 (JP)
- **Sono, Yasuhiko**
Hazu-gun, Aichi (JP)
- **Kojima, Kazunori**
Kariya-shi, Aichi 448-8650 (JP)

(30) Priority: **26.03.2010 JP 2010071842**

(71) Applicant: **AISIN SEIKI KABUSHIKI KAISHA**
Kariya-shi, Aichi 448-8650 (JP)

(74) Representative: **TBK**
Bavariaring 4-6
80336 München (DE)

(72) Inventors:
• **Akizuki, Ryujiro**
Kariya-shi, Aichi 448-8650 (JP)

(54) **Double-locking door lock apparatus for vehicle**

(57) A double-locking door lock apparatus (100) for a vehicle includes a latch mechanism (10), an inside open lever (21), an outside open lever (22), an open link (23), a lock mechanism switching the open link (23) between unlocked and locked states, and a double lock mechanism switching a vehicle door between a double locked state and a double-lock cancelled state, the lock mechanism including an active lever (25) shifting the open link (23) between the unlocked and locked states, and the double lock mechanism including a double lock lever (27) shifted from an unset position to a set position by a setting operation of a double-locking member to restrain the open link (23) from shifting from the locked state to the unlocked state, the double lock lever (27) shifted from the set position to the unset position by an unsetting operation of the double-locking member to allow the open link (23) to shift from the locked state to the unlocked state.

FIG. 2

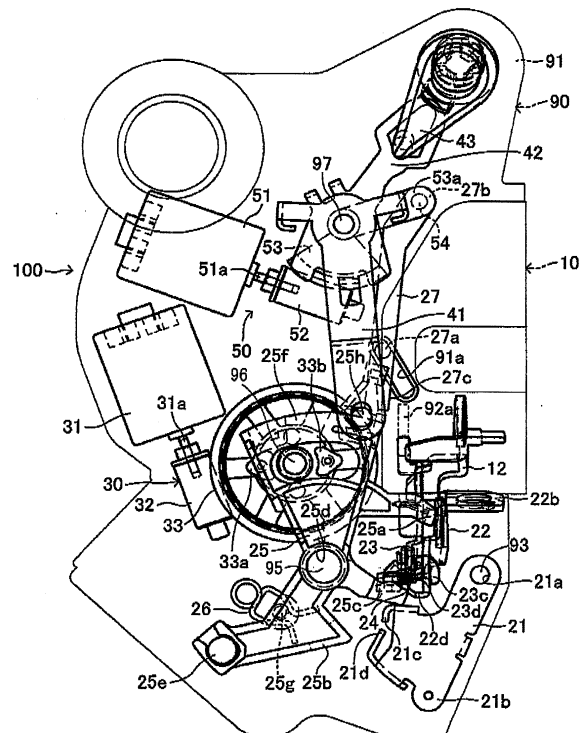

EP 2 369 103 A3



EUROPEAN SEARCH REPORT

Application Number
EP 11 15 5805

5

10

15

20

25

30

35

40

45

50

55

DOCUMENTS CONSIDERED TO BE RELEVANT			
Category	Citation of document with indication, where appropriate, of relevant passages	Relevant to claim	CLASSIFICATION OF THE APPLICATION (IPC)
X A	US 2009/243309 A1 (TAKAHASHI AKIRA [US] ET AL) 1 October 2009 (2009-10-01) * page 1, paragraph 0018 - paragraph 0021; claim 1; figures 1-8 * * page 3, paragraph 0036 - paragraph 0038 * * page 3, paragraph 0042 * * page 4, paragraph 0059 * -----	1 2-7	INV. E05B65/20 E05B47/00
X A	US 2010/013246 A1 (TOMASZEWSKI KRIS [CA] ET AL) 21 January 2010 (2010-01-21) * page 1, paragraph 0017 - page 2, paragraph 0023; figures 1-3 * -----	1 2-7	
A	WO 2009/037904 A1 (MITSUI KINZOKU ACT CORP) 26 March 2009 (2009-03-26) * figures 1-17 * & US 2010/212374 A1 (FUJIHARA YOSHIHIKO [JP]) 26 August 2010 (2010-08-26) -----	1-7	
A	US 2009/243308 A1 (ISHIGURO KATSUYUKI [JP] ET AL) 1 October 2009 (2009-10-01) * page 9, paragraph 0110 - paragraph 0112; figures 3, 17-23 * -----	1-7	TECHNICAL FIELDS SEARCHED (IPC) E05B
A,D	JP 3 767342 B2 (AISIN SEIKI) 19 April 2006 (2006-04-19) * the whole document * -----	1-7	
The present search report has been drawn up for all claims			
Place of search The Hague		Date of completion of the search 10 February 2017	Examiner Boufidou, Maria
CATEGORY OF CITED DOCUMENTS X : particularly relevant if taken alone Y : particularly relevant if combined with another document of the same category A : technological background O : non-written disclosure P : intermediate document T : theory or principle underlying the invention E : earlier patent document, but published on, or after the filing date D : document cited in the application L : document cited for other reasons & : member of the same patent family, corresponding document			

EPO FORM 1503 03/02 (P04C01)

ANNEX TO THE EUROPEAN SEARCH REPORT
ON EUROPEAN PATENT APPLICATION NO.

EP 11 15 5805

5

This annex lists the patent family members relating to the patent documents cited in the above-mentioned European search report. The members are as contained in the European Patent Office EDP file on The European Patent Office is in no way liable for these particulars which are merely given for the purpose of information.

10-02-2017

10

15

20

25

30

35

40

45

50

55

Patent document cited in search report	Publication date	Patent family member(s)	Publication date
US 2009243309 A1	01-10-2009	GB 2458567 A	30-09-2009
		JP 4473918 B2	02-06-2010
		JP 2009235845 A	15-10-2009
		US 2009243309 A1	01-10-2009

US 2010013246 A1	21-01-2010	CN 101657590 A	24-02-2010
		GB 2459621 A	04-11-2009
		US 2010013246 A1	21-01-2010
		WO 2008104089 A1	04-09-2008

WO 2009037904 A1	26-03-2009	CN 101802331 A	11-08-2010
		GB 2466165 A	16-06-2010
		JP 4905716 B2	28-03-2012
		JP 2009074275 A	09-04-2009
		US 2010212374 A1	26-08-2010
		WO 2009037904 A1	26-03-2009

US 2009243308 A1	01-10-2009	CN 101545342 A	30-09-2009
		FR 2943707 A1	01-10-2010
		JP 4542166 B2	08-09-2010
		JP 2009235754 A	15-10-2009
		KR 20090102684 A	30-09-2009
		US 2009243308 A1	01-10-2009

JP 3767342 B2	19-04-2006	JP 3767342 B2	19-04-2006
		JP 2002038797 A	06-02-2002
