

(12) STANDARD PATENT
(19) AUSTRALIAN PATENT OFFICE

(11) Application No. **AU 2008206321 B2**

(54) Title
Electrochemical energy cell system

(51) International Patent Classification(s)
H01M 8/04 (2006.01) **H01M 4/02** (2006.01)

(21) Application No: **2008206321** (22) Date of Filing: **2008.01.16**

(87) WIPO No: **WO08/089205**

(30) Priority Data

(31) Number	(32) Date	(33) Country
11/654,380	2007.01.16	US

(43) Publication Date: **2008.07.24**

(44) Accepted Journal Date: **2012.04.19**

(71) Applicant(s)
Primus Power Corporation

(72) Inventor(s)
Winter, Rick

(74) Agent / Attorney
Griffith Hack, GPO Box 1285, Melbourne, VIC, 3001

(56) Related Art
US 4518663 A (Kodali et al.) 21 May 1985

(19) World Intellectual Property Organization
International Bureau



(43) International Publication Date
24 July 2008 (24.07.2008)

PCT

(10) International Publication Number
WO 2008/089205 A3

- (51) International Patent Classification:
H01M 8/04 (2006.01) H01M 4/02 (2006.01)
- (21) International Application Number:
PCT/US2008/051111
- (22) International Filing Date: 16 January 2008 (16.01.2008)
- (25) Filing Language: English
- (26) Publication Language: English
- (30) Priority Data:
11/654,380 16 January 2007 (16.01.2007) US
- (71) Applicant and
(72) Inventor: WINTER, Rick [US/US]; 42 Ardilla Rd,
Orinda, CA 94563 (US).
- (74) Agent: PRAKASH, Nama; Global Ip Services, PLLC, 10
Crestwood Lane, Nashua, NH 03062 (US).
- (81) Designated States (unless otherwise indicated, for every
kind of national protection available): AE, AG, AL, AM,

AO, AT, AU, AZ, BA, BB, BG, BH, BR, BW, BY, BZ, CA,
CH, CN, CO, CR, CU, CZ, DE, DK, DM, DO, DZ, EC, EE,
EG, ES, FI, GB, GD, GE, GH, GM, GT, HN, HR, HU, ID,
IL, IN, IS, JP, KE, KG, KM, KN, KP, KR, KZ, LA, LC,
LK, LR, LS, LT, LU, LY, MA, MD, ME, MG, MK, MN,
MW, MX, MY, MZ, NA, NG, NI, NO, NZ, OM, PG, PH,
PL, PT, RO, RS, RU, SC, SD, SE, SG, SK, SL, SM, SV,
SY, TJ, TM, TN, TR, TT, TZ, UA, UG, US, UZ, VC, VN,
ZA, ZM, ZW.

- (84) Designated States (unless otherwise indicated, for every
kind of regional protection available): ARIPO (BW, GH,
GM, KE, LS, MW, MZ, NA, SD, SL, SZ, TZ, UG, ZM,
ZW), Eurasian (AM, AZ, BY, KG, KZ, MD, RU, TJ, TM),
European (AT, BE, BG, CH, CY, CZ, DE, DK, EE, ES, FI,
FR, GB, GR, HR, HU, IE, IS, IT, LT, LU, LV, MC, MT, NL,
NO, PL, PT, RO, SE, SI, SK, TR), OAPI (BF, BJ, CF, CG,
CI, CM, GA, GN, GQ, GW, ML, MR, NE, SN, TD, TG).

Published:
— with international search report

- (88) Date of publication of the international search report:
9 October 2008

(54) Title: ELECTROCHEMICAL ENERGY CELL SYSTEM

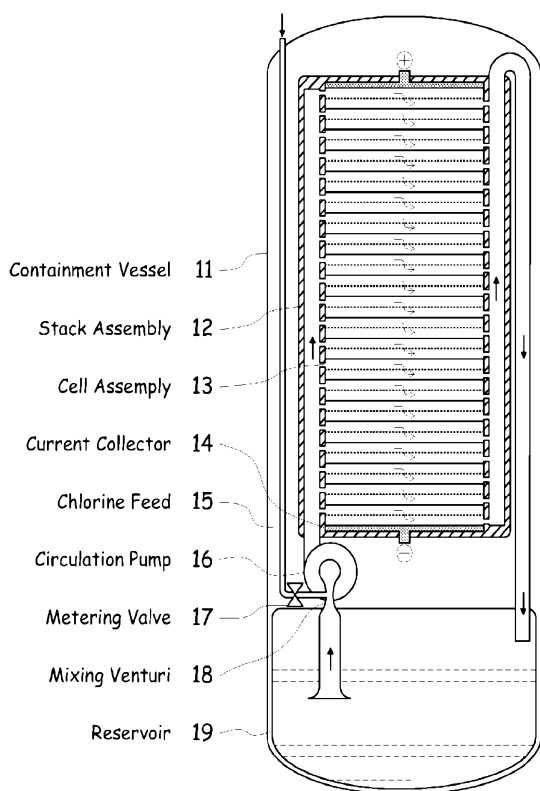

(57) Abstract: A metal halogen electrochemical energy cell system that generates an electrical potential. One embodiment of the system includes at least one cell including at least one positive electrode and at least one negative electrode, at least one electrolyte, a mixing venturi that mixes the electrolyte with a halogen reactant, and a circulation pump that conveys the electrolyte mixed with the halogen reactant through the positive electrode and across the metal electrode. Preferably, the positive electrode comprises porous carbonaceous material, the negative electrode comprises zinc, the metal comprises zinc, the halogen comprises chlorine, the electrolyte comprises an aqueous zinc-chloride electrolyte, and the halogen reactant comprises a chlorine reactant. Also, variations of the system and a method of operation for the systems.

TITLE OF THE INVENTION

Electrochemical Energy Cell System

BACKGROUND OF THE INVENTION

1. Field of the Invention

The present invention relates to metal halogen electrochemical energy systems.

2. Related Art

One type of electrochemical energy system uses a halogen component for reduction at a normally positive electrode, and an oxidizable metal adapted to become oxidized at a normally negative electrode during the normal dispatch of the electrochemical system. An aqueous electrolyte is used to replenish the supply of halogen component as it becomes reduced at the positive electrode. The electrolyte contains the dissolved ions of the oxidized metal and reduced halogen and is circulated between the electrode area and a reservoir area and an elemental halogen injection and mixing area, to be consumed at the positive electrode. One example of such a system uses zinc and chlorine system.

Such electrochemical energy systems are described in prior patents including U.S Patent No. 3,713,888, 3,993,502, 4,001,036, 4,072,540, 4,146,680, and 4,414,292. Such systems are also described in EPRI Report EM-1051 (Parts 1-3) dated April 1979, published by the Electric Power Research Institute. The specific teachings of the aforementioned cited references are incorporated herein by reference.

There are certain weaknesses or disadvantages in prior electrochemical energy systems for standby applications. These include, but are not limited to, the following:

- 5 • an inability to store sufficient energy without requirement to charge the system, precluding availability while in a discharged condition;
- complexity and inefficiency of requiring active cooling systems during discharge, which can further reduce capacity;
- ambiguities in diagnosing symptoms of failure, which can significantly increase a probability of failure; and
- 10 • hydrogen generation, which can be a significant and costly safety issue.

Specific weaknesses or disadvantages in prior metal halogen systems for standby applications also include, but are not limited to, the following:

- 15 • inability to maintain a state of readiness without significant capacity loss due to self-discharge;
- mal-distribution of zinc metal from internal shunt currents between cells of differing potential further reduces available capacity;
- a long length of small diameter channels required for minimizing shunt currents during operation further reduce system capacity due to pumping losses;
- 20 • metallic dendritic growth during the charge mode can permanently damage a metal halogen system and lead to premature and hazardous failure conditions.

25 The invention attempts to address some or all of these weaknesses and disadvantages. The invention is not limited to embodiments that do, in fact, address these weaknesses and disadvantages.

30 SUMMARY OF THE INVENTION

 The invention provides a metal halogen electrochemical system, comprising:

- (A) a vessel that contains:
 - (a) a vertical stack of a plurality of horizontal cells, each of the
 - 35 plurality of horizontal cells comprising:
 - at least one positive electrode;

at least one negative electrode; and
a reaction zone between the positive electrode and the
negative electrode; and

- (b) an electrolyte mixture comprising a metal and a halogen; and
- 5 (B) a circulation pump that is configured to convey a flow of the
electrolyte through the reaction zone of each of the cells of the stack.

10 In an embodiment, the positive electrode comprises a porous carbonaceous
material.

In an embodiment, the negative electrode comprises zinc; the metal
comprises zinc; the halogen comprises chlorine; the aqueous electrolyte comprises a
zinc chloride electrolyte, and the halogen reactant comprises a chlorine reactant.

15 In an embodiment, the circulation pump is located in the pressure
containment vessel.

In an embodiment, the halogen reactant is supplied from a source internal to
the system.

20 In an embodiment, the vessel contains an electrolyte storage reservoir below
the at least one cell.

25 In an embodiment, each cell comprises a cell frame that comprises
distribution channels, that are configured to introduce the electrolyte mixture to the
reaction zone, wherein said distribution channels are formed by splitting nodes, each
splitting the flow of the electrolyte mixture into two, so that each of said distribution
channels has the same length and the same number and radius of bends.

30 In an embodiment, the at least one cell comprises a horizontally positioned
cell.

In an embodiment, an inlet of the electrolyte mixture to the reaction zone
and an outlet of the electrolyte mixture from the reaction zone are each located at or
35 above the bottom of the positive electrode within the reaction zone.

In an embodiment, the at least one cell comprises a vertical stack of horizontally positioned cells.

5 In an embodiment, the system comprises an upward flowing return manifold configured to collect the electrolyte mixture from the cells of the stack.

10 In an embodiment, the stack maintains a cell-to-cell electrical continuity and does not maintain a cell-to-cell electrolyte continuity when the flow of the electrolyte mixture stops.

In an embodiment, each cell comprises a cell frame.

15 In an embodiment, the positive electrode and the negative electrode are arranged to maintain contact with a pool of the electrolyte when the flow of the electrolyte mixture stops.

The invention also provides a method of using a metal halogen electrochemical of any one of the preceding claims, comprising:

20 mixing (i) at least one aqueous electrolyte comprising aqueous zinc chloride and (ii) a pressurised halogen reactant comprising liquid chlorine, by dissolving the liquid chlorine in the aqueous zinc chloride electrolyte to form an electrolyte mixture, and delivering a flow of the electrolyte mixture to the positive electrode of the cell, reducing the halogen reactant at the positive electrode to form a halogen ion rich electrolyte mixture, and passing the halogen ion rich electrolyte mixture by the negative
25 electrode.

30 In an embodiment, the positive electrode comprises a porous carbonaceous material so that said delivered electrolyte mixture passes through said positive electrode.

In an embodiment, the negative electrode comprises zinc; the metal comprises zinc; the halogen comprises chlorine; the aqueous electrolyte comprises a zinc chloride electrolyte, and the halogen reactant comprises a chlorine reactant.

35 In an embodiment, said delivering is provided by a circulation pump located in the pressure containment vessel.

In an embodiment, the halogen reactant is supplied from a source internal to the system.

5 In an embodiment, the vessel contains an electrolyte storage reservoir below the at least one cell.

10 In an embodiment, the system further comprises an upward flowing return manifold and wherein the method further comprises collecting the electrolyte mixture from the at least one cell through said manifold.

In an embodiment, the at least one cell comprises a horizontally positioned cell.

15 In an embodiment, said horizontally positioned cell has an inlet of the electrolyte mixture to the reaction zone and an outlet of the electrolyte mixture from the reaction zone that are each located at or above the bottom of the positive electrode within the reaction zone.

20 In an embodiment, the at least one cell comprises a vertical stack of horizontally positioned cells.

25 In an embodiment, each cell comprises a cell frame that comprises distribution channels having the same flow resistance and wherein said delivering comprises delivering the electrolyte mixture to the positive electrode through the distribution channels.

30 In an embodiment, the stack maintains a cell-to-cell electrical continuity and does not maintain a cell-to-cell electrolyte continuity when the flow of the electrolyte mixture stops.

In an embodiment, the positive electrode and the negative electrode are arranged to maintain contact with a pool of the electrolyte when the flow of the electrolyte mixture stops.

35 In an embodiment, the method further comprises applying a balancing

voltage to the at least one cell to prevent a self-discharge of the system when the flow of the electrolyte mixture stops.

5 In an embodiment, the system has a first intake conduit for the electrolyte and a second intake conduit for the halogen reactant, which is separate from the first intake conduit.

10 This brief summary has been provided so that the nature of the invention may be understood quickly. Other objects, features, and advantages of the invention will become

apparent from the description herein, from the drawings, which show a preferred embodiment, and from the appended claims.

BRIEF DESCRIPTION OF THE FIGURES

Figure 1 illustrates a metal halogen electrochemical energy cell system according to the invention.

Figure 2 illustrates flow paths of an electrolyte through the cell plates of an embodiment of the system illustrated in Figure 1.

Figure 3 illustrates cell frames that can be used in the system illustrated in Figures 1 and 2.

DETAILED DESCRIPTION OF THE INVENTION

Electrolyte Energy Cell System

Figure 1 illustrates a metal halogen electrochemical energy cell system according to the invention.

One embodiment of the invention that attempts to address some or all of these weaknesses and disadvantages is a metal halogen electrochemical energy cell system. This embodiment includes at least one positive and at least one negative electrode, a reaction zone between the positive electrode and the negative electrode, at least one electrolyte that includes a metal and a halogen, and a circulation pump that conveys the electrolyte through the reaction zone. The electrolyte and a halogen reactant can be mixed before, at, or after the pump, for example using a mixing venture. Preferably, the positive electrode is made of porous carbonaceous material, the negative electrode is made of zinc, the metal include zinc, the halogen includes chlorine, the electrolyte includes an aqueous zinc-chloride electrolyte, and the halogen reactant includes a chlorine reactant. One effect of this arrangement is generation of an electrical potential.

The basic operation of this embodiment is as follows: aqueous electrolyte is sucked up from a reservoir and through a mixing venturi where halogen such as elemental chlorine is metered into an electrolyte. The halogen mixes with and dissolves into the electrolyte while its latent heat of liquefaction also cools the mixture. The cooled and halogenated aqueous electrolyte passes through the pump and is delivered to positive electrodes in a stack assembly. The positive electrodes preferably are made of porous carbonaceous material such as porous graphite-chlorine. The electrolyte passes through the positive electrodes, reducing the dissolved halogen. The halogen-ion rich electrolyte then passes by one or more a negative electrode preferably made of a metal such as zinc, where electrode dissolution occurs. These reactions yield power from the electrode stack terminals and metal-halogen is formed in the electrolyte by reaction of the metal and the halogen.

Figure 1 shows an electrochemical energy system housed in containment vessel 11 designed to achieve the foregoing. The system in Figure 2 includes two basic parts: stack assembly 12 and reservoir 19, as shown in Figure 1.

Stack assembly 12 is made up of a plurality of cells or cell assemblies 13 that include at least one porous electrode and at least one metal electrode. The cells preferably are stacked vertically. Pressurized halogen reactant is supplied via feed pipe 15 from a source external to the system through metering valve 17 to mixing venturi 18. Circulation pump 16 circulates the electrolyte from reservoir 19 through mixing venturi 18, through stack assembly 12, and back to reservoir 19 through a return pipe. It should be noted that some halogen reactant could be left in the electrolyte when it returns back to the reservoir from the cell.

In a preferred embodiment, the porous electrodes include carbonaceous material, the metal includes zinc, the metal electrode includes zinc, the halogen includes chlorine, the electrolyte includes an aqueous zinc-chloride electrolyte, and the halogen reactant includes a chlorine reactant.

In a preferred embodiment, this arrangement results in cells that each has an electrical potential of two volts, giving a stack arrangement with 21 cells a potential of 42

volts. An enthalpy of expansion of the halogen from the external source preferably cools the system. Thus, a strong potential can be provided without generating excessive heat.

Electrolyte Flows

Figure 2 illustrates flow paths of an electrolyte through the cell plates of an embodiment of the system illustrated in Figure 1. In this figure, the electrolyte flow paths 28 are represented by arrows. These paths are from feed manifold 21, to distribution zone 22, through porous electrodes 23, over metal electrodes 25, to collection zone 26, through return manifold 27, and to return pipe 29.

In a preferred embodiment, membranes 24 on a bottom of metal electrodes 25 screen the flows of electrolyte from contacting the metal electrodes before passing through the porous electrodes. These membranes preferably are plastic membranes secured to bottoms of the metal electrodes with adhesive. Other types of membranes secured in other ways also can be used. Alternatively, the membranes could be omitted.

With the arrangement shown in Figure 2, the porous electrode and the metal electrode in each cell are arranged to maintain contact with a pool of electrolyte in each cell when electrolyte flow stops and the feed manifold, distribution zone, collection zone, and return manifold drain.

Furthermore, the vertically stacked cells and the geometry of the cells result in flow paths of the electrolyte within each of the plural cells that tend to interrupt shunt currents that otherwise would occur when electrolyte flow stops. These shunt currents are not desired because they can lead to reactions between the plates that corrode the metal plates without generating any usable potential.

Before being conveyed through the porous electrode, the electrolyte mixed with the halogen reactant preferably undergoes first, second, and third order splits to provide a same flow resistance for different paths to the porous electrode. Each split

preferably divides the flow by two, although this need not be the case. Figure 3 illustrates one possible cell design that can achieve these splits.

Cell Frames

Figure 3 illustrates a cell design that uses cell frames to achieve the structures and flows shown in Figure 2. These cell frames preferably include feed manifold element 31, distribution channels 32, flow splitting nodes 33, spacer ledge 35, flow merging nodes 36, collection channels 37, return manifold element 38, and bypass conduit elements 34.

When these cell frames are stacked vertically with the electrodes in place, these elements combine to form the elements shown in Figure 2 as follows:

- the feed manifold element in each of the plural cells frames aligns with the feed manifold element in another of the cell frames, thereby forming a feed manifold;
- the distribution channels and the flow splitting nodes in each of the cell frames align with the distribution channels and the flow splitting nodes in another of the cell frames, thereby forming a distribution zone;
- the porous electrode for each cell sits above or below the metal electrode for each cell on the spaces ledges of the cell frames, thereby forming alternating layers of porous electrodes and metal electrodes;
- the flow merging nodes and the collection channels in each of the plural cells frames align with the flow merging nodes and the collection channels in another of the cell frames, thereby forming a collection zone;
- the return manifold element in each of the cell frames aligns with the return manifold element in another of the cell frames, thereby forming a return manifold; and
- the bypass conduit elements in each of the cell frames align with the bypass conduit elements in another of the cell frames, thereby forming bypass conduits for fluid flow and/or electrical wires or cables.

The cell frames preferably are circular to facilitate insertion of the plural cells into a pressure containment vessel such as vessel 11.

The cell frame based design facilitates low-loss electrolyte flow with uniform distribution, bipolar electrical design, ease of manufacture, internal bypass paths, and elements by which the operational stasis mode (described below) can be achieved. Innovations of the cell frame include, but are not limited to, the flow-splitting design in the distribution zone that include first, second, and third order splits in the flow channels to deliver eight feed channels per cell to the reaction zone. This design attempts to ensure that each outlet to the reaction zone passes through the same length of channels, the same number and radius of bends, with laminar flow throughout and uniform laminar flow prior to each split. The design encourages division of flow volume equally, independent of flow velocity, uniformity of viscosity, or uniformity of density in the electrolyte. These features have been found to be of particular importance when a mixture of gaseous and liquid phases is fed through the system.

Alternatively, the same types of structures and flows (i.e., those shown in Figure 2) can be achieved without using cell frames.

Modes of Operation

The energy cell system according to the invention preferably Cell has three modes of operation: Off Mode, Power Mode, and Stasis Mode. These modes are described below in the context of a zinc-chlorine system. However, the modes also can be implemented using other metal-halogen systems.

Off Mode is typically used for storage or transportation. During Off Mode, the circulation pump is off. A small amount of elemental chlorine in the stack assembly is reduced and combined with zinc ions to form zinc-chloride. The stack terminals preferably are connected via a shorting resistor, yielding a stack potential of zero volts. A blocking diode preferably is used to prevent reverse current flow through the system via any external voltage sources.

During Power Mode the electrolyte circulation pump is engaged. The catholyte (i.e., electrolyte) containing dissolved chlorine is circulated through the stack assembly containing the zinc anode plates. Electrons are released as zinc ions are formed and captured as chlorine ions are formed, preferably with an electrical potential of 2.02 volts per cell, thereby creating electrical power from the terminals of the collector plates preferably located at each end of the stack assembly. The demand for power from the system consumes chlorine and reduces pressure within the reservoir, causing the metering valve to release higher-pressure chlorine into the mixing venturi. This design feature aids both in speeding the dissolving of chlorine gas into the electrolyte, and uniformly cooling the electrolyte without risk of freezing at the injection point. The injection rate preferably is determined by the electrochemical reaction rates within the stack assembly. The metering valve and the circulation pump preferably provide sufficient response speed to match rapidly changing instantaneous power demands. As the compressed chlorine is released into the system, its enthalpy of expansion should absorb sufficient heat to maintain the energy cell within thermal operating limits.

During Stasis or Standby Mode, there should be little or no electrolyte flow or chlorine injection. The availability of the system preferably is maintained via a balancing voltage that is applied to maintain system availability. This balancing voltage tends to prevent self-discharge by maintaining a precise electrical potential on the cell stack to counteract the electrochemical reaction forces that can arise with the circulation pump off. The particular design of the cell plates tends to interrupt shunt currents that would otherwise flow through the feed and return manifolds, while maintaining cell-to-cell electrical continuity through the bipolar electrode plates.

While these are preferred modes of operation, the invention is not limited to these modes or to the details of these modes. Rather, some embodiments might have some of these modes, none of these modes, or different modes of operation.

Generality of Invention

This application should be read in the most general possible form. This includes, without limitation, the following:

- 5 • References to specific techniques include alternative and more general techniques, especially when discussing aspects of the invention, or how the invention might be made or used.
- 10 • References to “preferred” techniques generally mean that the inventor contemplates using those techniques, and thinks they are best for the intended application. This does not exclude other techniques for the invention, and does not mean that those techniques are necessarily essential or would be preferred in all circumstances.
- 15 • References to contemplated causes and effects for some implementations do not preclude other causes or effects that might occur in other implementations.
- References to reasons for using particular techniques do not preclude other reasons or techniques, even if completely contrary, where circumstances would indicate that the stated reasons or techniques are not as applicable.

20 Furthermore, the invention is in no way limited to the specifics of any particular embodiments and examples disclosed herein. Many other variations are possible which remain within the content, scope and spirit of the invention, and these variations would become clear to those skilled in the art after perusal of this application.

25 In the claims which follow and in the preceding description of the invention, except where the context requires otherwise due to express language or necessary implication, the word “comprise” or variations such as “comprises” or “comprising” is used in an inclusive sense, i.e. to specify the presence of the stated features but not to preclude the presence or addition of further features in various embodiments of the invention.

30 It is to be understood that, if any prior art publication is referred to herein, such reference does not constitute an admission that the publication forms a part of the common general knowledge in the art, in Australia or any other country.

THE CLAIMS DEFINING THE INVENTION ARE AS FOLLOWS:

1. A metal halogen electrochemical system, comprising:
 - (A) a vessel that contains:
 - 5 (a) a vertical stack of a plurality of horizontal cells, each of the plurality of horizontal cells comprising:
 - at least one positive electrode;
 - at least one negative electrode; and
 - 10 a reaction zone between the positive electrode and the negative electrode; and
 - (b) an electrolyte mixture comprising a metal and a halogen; and
 - (B) a circulation pump that is configured to convey a flow of the electrolyte through the reaction zone of each of the cells of the stack.
- 15 2. The system of claim 1, further comprising:
 - (c) a stack of cell frames supporting the stack of cells;
 - (d) a feed manifold opening and a return manifold opening in each cell frame in the stack of cell frames;
 - (e) a feed manifold formed by aligned feed manifold openings in the
 - 20 stack of cell frames;
 - (f) a return manifold formed by aligned return manifold openings in the stack of cell frames; and
 - (g) a plurality of distributed channels located in each cell frame, wherein the distribution channels are configured to introduce the
 - 25 electrolyte from the feed manifold to the reaction zone of each cell, and from the reaction zone to the return manifold.
3. The system of claim 2, wherein the vessel contains an electrolyte storage reservoir below the stack of cells, and the circulation pump is configured to convey the
- 30 flow of the electrolyte from the reservoir to the stack of cells through the feed manifold.
4. The system of claim 2 or claim 3, wherein the distribution channels are formed by splitting nodes, each splitting the flow of the electrolyte into two, so that each of said distribution channels has the same length and the same number and radius
- 35 of bends.
5. The system of any one of the preceding claims, wherein an inlet of the

electrolyte to the reaction zone and an outlet of the electrolyte from the reaction zone are each located at or above the bottom of the positive electrode within the reaction zone.

5 6. The system of any one of the preceding claims when dependent on claim 2, wherein each cell frame comprises a spacer ledge which supports an electrode of a cell in the stack of cells.

10 7. The system of any one of the preceding claims, wherein the electrolyte comprises a mixture comprising:

(i) at least one aqueous electrolyte comprising a metal and a halogen; and

(ii) a pressurised halogen reactant.

15 8. The system of claim 5, wherein the circulation pump is configured to convey a flow of the electrolyte through the reaction zone so that the halogen reactant is reduced at the positive electrode to form a halogen ion rich electrolyte which passes by the negative electrode.

20 9. The system of any one of the preceding claims, wherein the positive electrode comprises a porous carbonaceous material.

25 10. The system of claim 8, or claim 9 when dependent on claim 8, wherein the negative electrode comprises zinc; the metal comprises zinc; the halogen comprises chlorine; the electrolyte comprises a zinc chloride electrolyte, and the halogen reactant comprises a chlorine reactant.

30 11. The system of claim 2, or any one of claims 2 to 10 when dependent on claim 2, wherein the return manifold comprises an upward flowing return manifold configured to collect the electrolyte from the cells of the stack; and the stack maintains a cell-to-cell electrical continuity with electrolyte flow, and does not maintain a cell-to-cell electrical continuity should electrolyte flow stop.

35 12. The system of any one of the preceding claims, wherein the positive electrode and the negative electrode are arranged to maintain contact with a pool of the electrolyte when electrolyte flow stops.

13. A method of using a metal halogen electrochemical of any one of the

preceding claims, comprising:

5 mixing (i) at least one aqueous electrolyte comprising aqueous zinc chloride and
(ii) a pressurised halogen reactant comprising liquid chlorine, by dissolving the
liquid chlorine in the aqueous zinc chloride electrolyte to form an electrolyte
mixture, and delivering a flow of the electrolyte mixture to the positive electrode
of the cell, reducing the halogen reactant at the positive electrode to form a
halogen ion rich electrolyte mixture, and passing the halogen ion rich electrolyte
mixture by the negative electrode.

10 14. The system of any one of claims 1 to 12, and substantially as herein
described with reference to the accompanying drawings.

15 15. The method of claim 13, and substantially as herein described with
reference to the accompanying drawings.

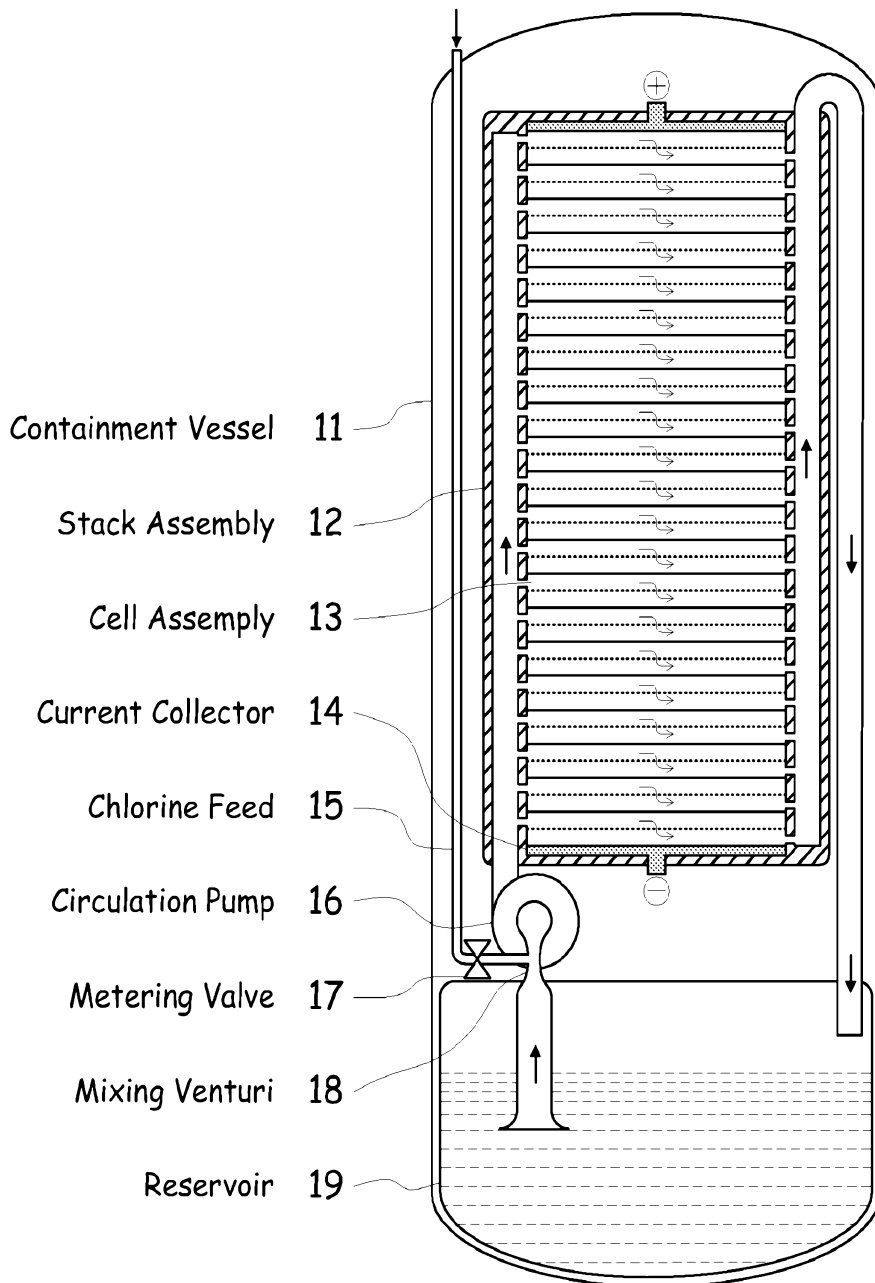

Figure 1

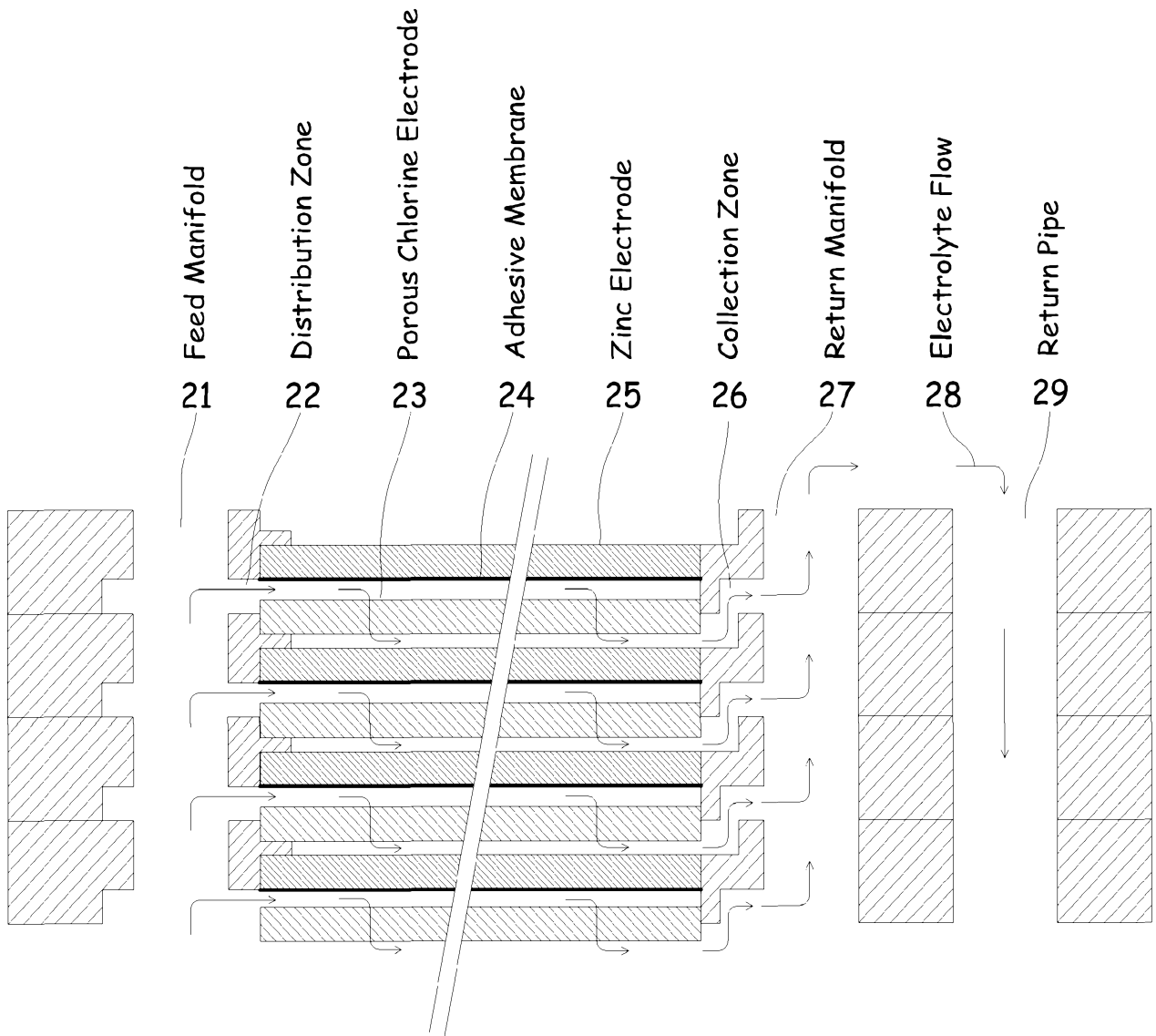

Figure 2

Figure 3A

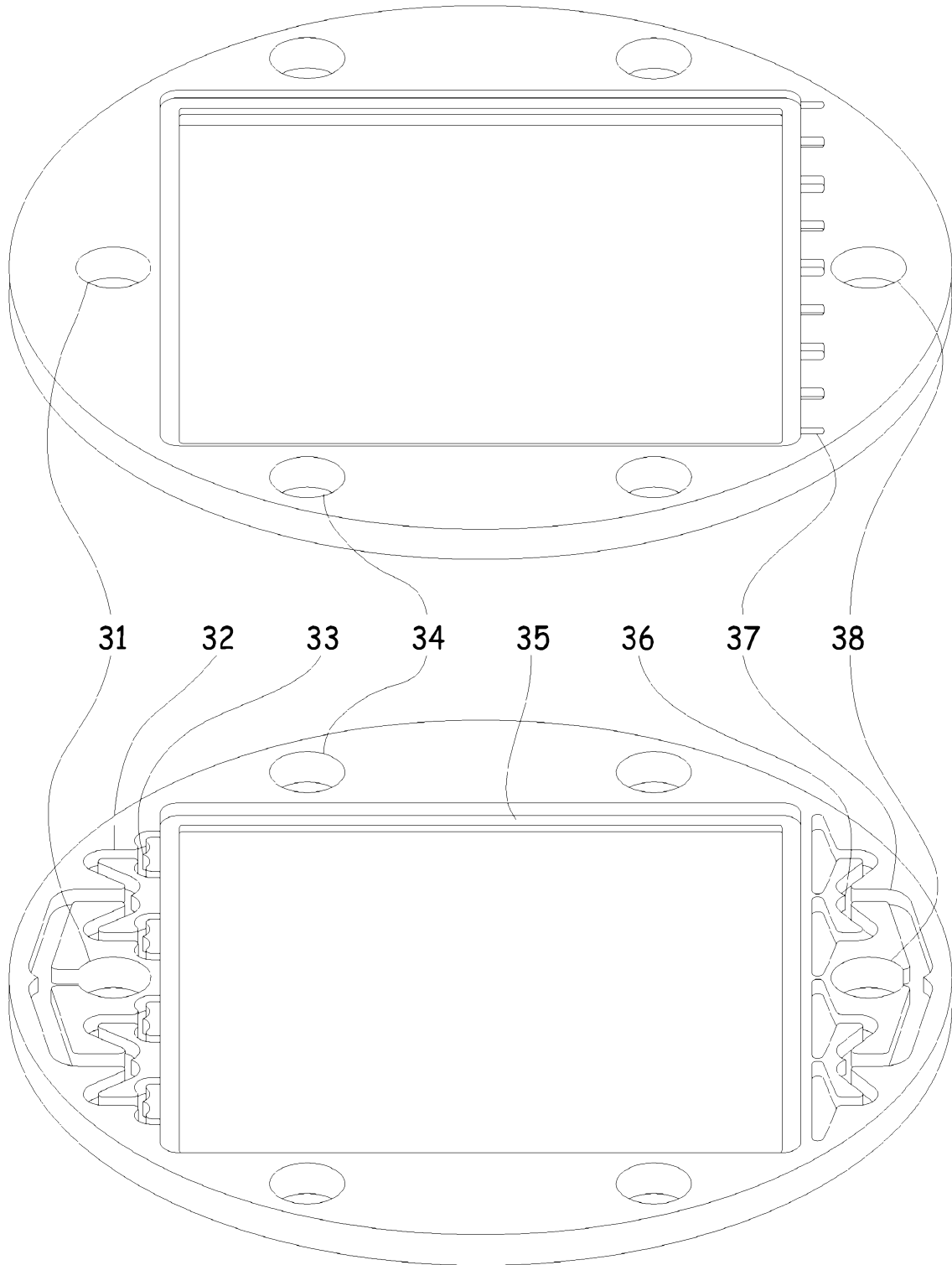

Figure 3B