

(19) World Intellectual Property
Organization
International Bureau



(43) International Publication Date
16 December 2004 (16.12.2004)

PCT

(10) International Publication Number
WO 2004/108018 A1

(51) International Patent Classification⁷: **A61F 2/16**

(21) International Application Number:
PCT/US2004/018175

(22) International Filing Date: 1 June 2004 (01.06.2004)

(25) Filing Language: English

(26) Publication Language: English

(30) Priority Data:
10/453,830 2 June 2003 (02.06.2003) US

(71) Applicant: **ADVANCED MEDICAL OPTICS** [US/US];
1700 E. St. Andrew Place, Santa Ana, CA 92705 (US).

(72) Inventors: **PETERSON, Rod, T.**; 31 E. MacArthur Cres,
Apt. E310, Sanra Ana CA 92707 (US). **COLE, Mark, S.**;
21251 Hillgate Circle, Trabuco Canyon, CA 92679 (US).
OTT, Robert, D.; 293 Portico Aisle, Irvine, CA 92606
(US).

(74) Agent: **GLUCK, Peter, J.**; Advanced Medical Optics,
Inc., 1700 East St. Andrew Place, Santa Ana, CA 92799-
5162 (US).

(81) Designated States (unless otherwise indicated, for every kind of national protection available): AE, AG, AL, AM, AT, AU, AZ, BA, BB, BG, BR, BW, BY, BZ, CA, CH, CN, CO, CR, CU, CZ, DE, DK, DM, DZ, EC, EE, EG, ES, FI, GB, GD, GE, GH, GM, HR, HU, ID, IL, IN, IS, JP, KE, KG, KP, KR, KZ, LC, LK, LR, LS, LT, LU, LV, MA, MD, MG, MK, MN, MW, MX, MZ, NA, NI, NO, NZ, OM, PG, PH, PL, PT, RO, RU, SC, SD, SE, SG, SK, SL, SY, TJ, TM, TN, TR, TT, TZ, UA, UG, US, UZ, VC, VN, YU, ZA, ZM, ZW.

(84) Designated States (unless otherwise indicated, for every kind of regional protection available): ARIPO (BW, GH, GM, KE, LS, MW, MZ, NA, SD, SL, SZ, TZ, UG, ZM, ZW), Eurasian (AM, AZ, BY, KG, KZ, MD, RU, TJ, TM), European (AT, BE, BG, CH, CY, CZ, DE, DK, EE, ES, FI, FR, GB, GR, HU, IE, IT, LU, MC, NL, PL, PT, RO, SE, SI, SK, TR), OAPI (BF, BJ, CF, CG, CI, CM, GA, GN, GQ, GW, ML, MR, NE, SN, TD, TG).

Published:
— with international search report
— before the expiration of the time limit for amending the claims and to be republished in the event of receipt of amendments

[Continued on next page]

(54) Title: INTRAOCULAR LENS AND CARTRIDGE PACKAGING WITH LENS-LOADING FUNCTION

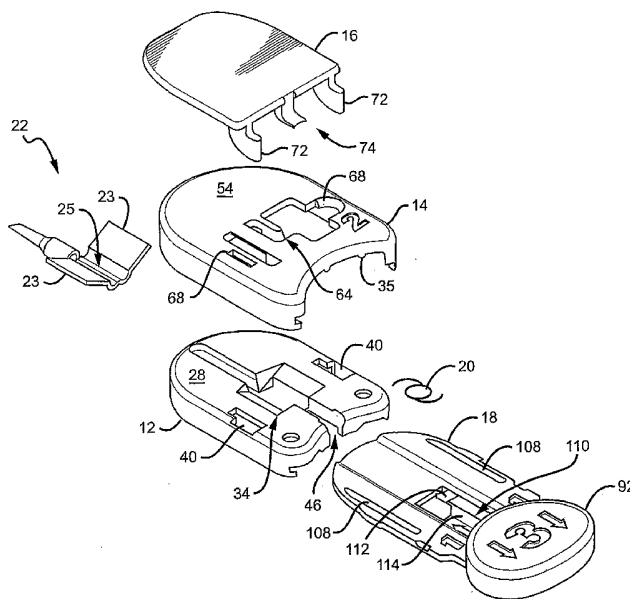

(57) Abstract: A lens and cartridge packaging system and method of use which simplify the removal and transfer of an IOL to an IOL insertion device is disclosed. The packaging system enables a user to easily load an IOL into a cartridge without the use of forceps. In addition, the packaging system also allows a user to fold and insert the IOL into a cartridge without damaging the IOL and/or compromising IOL sterility. In addition, the related methods of use minimize and/or eliminate damage to the IOL during unpackaging, folding, transfer and loading procedures.

WO 2004/108018 A1



For two-letter codes and other abbreviations, refer to the "Guidance Notes on Codes and Abbreviations" appearing at the beginning of each regular issue of the PCT Gazette.

INTRAOcular LENS AND CARTRIDGE PACKAGING WITH LENS-LOADING FUNCTION

BACKGROUND OF THE INVENTION

[0001] It is estimated that at least about 42% of Americans between the ages of 52 and 64 and 73% of Americans between the ages of 65 to 74 get cataracts. A cataract is a clouding of the eye's lens that impairs a person's vision and, if left untreated, causes blindness. As a result, each year approximately 1.4 million people in the United States alone undergo cataract surgery, whereby the clouded lens is removed and replaced with an intraocular lens (IOL) implant.

[0002] A typical IOL includes an optic or lens body for focussing light toward the retina of the eye. In addition, the IOL also includes one or more fixation members or haptics for securing the IOL in the desired position within the chamber of the eye. The IOL is implanted directly into the eye through a small incision formed in the ocular tissue of the eye. To fit through this small incision, modern IOLs are designed to be deformed, e.g., rolled, folded or the like, to a relatively small profile and then allowed to return to their original shape within the eye.

[0003] A useful technique for inserting an IOL into the eye includes use of an IOL injector or cartridge. Conventional IOL cartridges include a load chamber which is connected to an injection tube. The load chamber further includes an openable first lumen for receiving the IOL. Closure of this first lumen folds the IOL and maintains the IOL in a folded state. The injection tube includes a small diameter distal tip which is insertable into the incision within the eye. The IOL is transferable from the load chamber through the injection tube and into the eye.

[0004] In general, the IOL is provided to the surgeon in packaging, such as a vial, plastic blister package, or other container for maintaining the IOL in a sterile condition. The IOL is removed from the packaging and placed on the open load chamber prior to insertion

into the patient's eye. The packaging protects the IOL during handling and transportation to the surgical site and maintains the sterility of the IOL prior to use.

[0005] The technique of removing the IOL from the packaging and transferring it to the load chamber is usually accomplished with a pair of forceps or similar device. Any covering of the packaging is removed so that the IOL is exposed in its container. Insertion forceps are used to remove the IOL from the packaging and subsequently fold the IOL to a reduced size for insertion into the eye. Alternatively, the forceps are used to physically remove the IOL from the packaging and place it on the load chamber of the cartridge. Whether folding the IOL or simply loading it into the cartridge, this step requires particular manual dexterity and surgical skills.

[0006] In this regard, a variety of problems may arise when removing the IOL from its packaging, manually folding the IOL and/or placing the IOL into an insertion device. For example, if proper care is not exercised during manipulation of the IOL, the IOL can be dropped and/or damaged. In addition, the IOL can be damaged if improperly folded or loaded into the cartridge and insertion device. Further, IOL sterility may be compromised if the IOL is not handled properly during the unpacking and loading procedures, thereby requiring the IOL to be discarded.

[0007] In view of the above, there is a need for a packaging system and method of use which simplify the removal and transfer of the IOL to the IOL insertion device. In particular, it is desirable that the packaging system enables a user to easily load an IOL into a cartridge without the use of forceps. Such a system should also allow a user to fold and insert the IOL into a cartridge without damaging the IOL and/or compromising IOL sterility, in addition to generally permitting it to be visible to the doctor prior to use. In addition, the related methods of use should minimize and/or eliminate damage to the IOL during unpacking, folding, transfer and loading procedures.

BRIEF SUMMARY OF THE INVENTION

[0008] In general, the present invention contemplates a lens and cartridge packaging system that includes a lens loading function, and satisfies related doctor and/or support staff needs.

[0009] The present invention further contemplates a device to store and transfer an intraocular lens. The device comprises an intraocular lens and a tray having an aperture, wherein the intraocular lens is housed within a portion of the aperture and wherein another portion of the aperture is configured to house a lens cartridge. The device also includes a push-rod in communication with the tray, wherein the push-rod causes controlled movement of the intraocular lens within the device. In addition, the device also includes a lock in communication with the tray and the push-rod, wherein the lock prevents unintentional movement of the push-rod and intraocular lens within the device.

[0010] The present invention also contemplates a method of storing an intraocular lens and transferring said intraocular lens to a lens cartridge for use in a delivery device. The method comprises providing a packaging device housing an intraocular lens and a lens cartridge within a tray of the packaging device, wherein the packaging device further comprises a push-rod in communication with the tray and a lock in communication with the tray and the push-rod. The method also includes removing the lock to enable movement of the push-rod and distally advancing the push-rod to transfer and secure the intraocular lens within a loading zone of the lens cartridge. Finally, the method includes proximally retracting the push-rod to release the intraocular lens and the lens cartridge, and removing the lens cartridge from the packaging device, wherein the lens cartridge now contains the intraocular lens.

BRIEF DESCRIPTION OF THE DRAWINGS

[0011] Other features and advantages of the present invention will be seen as the following description of particular embodiments progresses in conjunction with the drawings, in which:

[0012] Figure 1 is an exploded perspective view of an embodiment of a lens packaging system in accordance with the present invention;

[0013] Figure 2A is another exploded perspective view of an embodiment of a lens packaging system in accordance with the present invention;

[0014] Figure 2B is another exploded perspective view of the underside of an embodiment of a lens packaging system in accordance with the present invention;

[0015] Figure 3 is a perspective view of an embodiment of a tray of a lens packaging system in accordance with the present invention;

[0016] Figure 4 is a perspective view of an embodiment of a lid of a lens packaging system in accordance with the present invention;

[0017] Figure 5A is a perspective view of an embodiment of a lock of a lens packaging system in accordance with the present invention;

[0018] Figure 5B is a perspective view of the underside of an embodiment of a lens packaging system in accordance with the present invention;

[0019] Figure 6 is a perspective view of an embodiment of a lens packaging system in accordance with the present invention;

[0020] Figure 7 is an alternate perspective view of the lens packaging system of Figure 6;

[0021] Figure 8 is a perspective view of an embodiment of a push-rod of a lens packaging system in accordance with the present invention;

[0022] Figure 9 is a perspective view of an IOL properly loaded within a lens cartridge in accordance with the present invention;

[0023] Figure 10 illustrates an embodiment of a lens packaging system, with its lock and lid removed, prior to operation of the system in accordance with the present invention;

[0024] Figures 11A and 11B illustrate an embodiment of a lens packaging system prior to operation of the system in accordance with the present invention;

[0025] Figures 12A and 12B illustrate removal of the lock from an embodiment of a lens packaging system in accordance with the present invention;

[0026] Figure 12C illustrates an embodiment of a lens packaging system with its lock removed in accordance with the present invention;

[0027] Figures 13A and 13B illustrate an embodiment of a lens packaging system with its push-rod distally advanced in accordance with the present invention;

[0028] Figure 14 illustrates an embodiment of a lens packaging system with its lid removed in accordance with the present invention;

[0029] Figure 15 illustrates an embodiment of a lens packaging system with its push-rod retracted in accordance with the present invention; and

[0030] Figure 16 illustrates removal of a loaded lens cartridge following operation of the system in accordance with the present invention.

DETAILED DESCRIPTION OF THE INVENTION

[0031] Referring now to the drawings, wherein like reference numerals designate identical or corresponding parts throughout the several views and embodiments, a lens

packaging system 10 in accordance with the present invention, shown in Figures 1, 2A and 2B, includes a tray 12, a lid 14, a lock 16, and a push-rod 18. The tray 12 is configured to hold and store a foldable IOL 20 and a cartridge 22. In this regard, the IOL 20 and cartridge 22 are held within the tray 12 via the lid 14, lock 16 and push-rod 18. In addition to securing the IOL 20 and cartridge 22, the lock 16 also serves as a means to secure the push-rod 18 during shipment/storage of the packaging system 10 and, thereby, prevent accidental activation of the push-rod mechanism.

[0032] In general, the packaging system 10 of the present invention may be fabricated as a disposable, single-use component or a reusable, multi-use component. As such, a variety of materials may be used to fabricate the tray 12, lid 14, lock 16 and push-rod 18 of the packaging system 10. These materials include, but are not limited to, plastics, metals (such as stainless steel, aluminum or titanium), ceramics and the like, including combinations thereof. By way of illustrative example, with no limitation being intended or implied, the tray 12 is fabricated from polypropylene, and the lid 14, lock 16 and push-rod 18 are fabricated from polycarbonate.

[0033] Referring now to Figures 2A, 2B and 3, the packaging system 10 will be described in greater detail. In particular, in one embodiment of the packaging system 10, the tray 12 includes a distal end 24, a proximal end 26, a half-oval shaped top surface 28 and a sidewall 30. As shown in Figures 2A, 2B and 3, the distal end 24 of the tray 12 is rounded or curved to conform to the curved portion of the half-oval shaped top surface 28. The proximal end 26 of the tray 12 is also slightly curved or rounded and arches in the same direction as the distal end 24 of the tray 12. In general, the proximal end 26 of the tray 12 is configured to accommodate the push-rod 18 of the packaging system 10, as described in further detail below. Alternatively, in other embodiments (not shown), the distal and proximal ends 24, 26 of the tray 12 are arched in opposite directions. Furthermore, in certain embodiments, the distal and proximal ends 24, 26 of the tray 12 are angled to form a portion of a square, rectangle, triangle, quadrilateral, regular and/or irregular-shaped form.

[0034] As illustrated in Figure 3, the distal and proximal ends 24, 26 of the tray 12 also correspond to the distal and proximal ends of the tray's top surface 28. The top surface 28 of the tray 12 is generally planar or flat and includes one or more indentations and/or apertures 32 formed therein. The proximal-most apertures 33 are formed as two round holes in the top surface 28 of the tray. These apertures or holes 33 are configured to accommodate the alignment pins of the lid 14, as explained in further detail below.

[0035] The remaining indentations and/or apertures 32 are configured to accommodate a lens 20 and lens cartridge 22, or similar lens holding and/or folding device, and guide elements or posts, for aligning the lid 16 and/or push-rod 18 of the packaging system 10. In the embodiment of the packaging system 10 illustrated in Figure 3, the center aperture 34 is approximately cross-shaped and includes a wide transverse slot 36 that intersects a narrow, elongate longitudinal slot 38 extending approximately from the proximal end 26 to the distal end 24 of the tray. The center aperture 34 further includes various chamfers and ridges within each slot 36, 38, which provide additional support and stability for the lens cartridge 22. As such, during storage and/or prior to use of the system 10, it is the narrow, distal section of the longitudinal slot 38 together with the wide transverse slot 36 that house the cartridge 22, whereas the narrow, proximal section of the central aperture's longitudinal slot 38 (also known as the lens platform) houses the IOL 20.

[0036] Adjacent the center aperture 34 are two additional longitudinal side-slots 40. Each side-slot 40 is positioned on either side and in alignment with the wide transverse slot 36 of the center aperture 34. In general, the side-slots 40 are approximately L-shaped and extend along the longitudinal axis near the side edges 42 of the tray 12. The side-slots 40 are designed to accommodate the guideposts of the lock 16, as described in further detail below.

[0037] Integral with the top surface 28 of the tray 12 is a sidewall 44. The sidewall 44 extends along the perimeter of the top surface 28 and forms a hollow cavity beneath the top surface 28 of the tray 12. As best seen in Figure 3, an opening 46 extends along a portion of the sidewall 44 located near the tray's proximal end 26. In particular, the opening

46 includes a first portion 48 and a second portion 50, wherein the first portion 48 of the opening 46 extends along a transverse, proximal section of the tray's sidewall 44. The second portion 50 of the opening 46 forms a longitudinal slot that is continuous with the first portion 48 and extends in a distal direction along the top surface 28 of the tray 12. In particular, the second portion 50 of the opening 46 merges with the cartridge-shaped aperture/indentation 34 of the top surface 28. In general, the opening 46 is configured to accommodate the push-rod 18 of the packaging system 10, as described in further detail below.

[0038] As referenced above, the packaging system 10 of the present invention also includes a lid 14 configured to cover at least a portion of the top surface 28 and sidewall 44 of the tray 12. In this regard, as shown in Figures 2A, 2B and 4, the shape of the lid 14 is nearly identical to the shape of the tray 12. However, as best seen in Figure 4, the sidewall 52 of the lid 14 does not extend completely around the perimeter of the lid's top surface 54 but, rather, includes a generally rectangular-shaped gap or aperture 56 near the proximal end 58 of the lid 14. In addition, each vertical edge 60 of the sidewall 52 that frames the gap or aperture 56 further includes at least one notch 62, which is continuous with the aperture 56 near the proximal end 58 of the lid 14. As explained in further detail below, the lid's aperture and notches 56, 62, which are in direct alignment with the longitudinal slot 46 of the tray 12, are generally configured to accommodate the push-rod 18 when fully advanced during transfer of the IOL 20 into the cartridge 22.

[0039] In addition to differences in the sidewalls 44, 52, there are also slight differences in the apertures/indentations formed in the top surfaces 28, 54 of the tray 12 and lid 14. In particular, as shown in Figure 4, the proximal end of the lid's top surface 54 does not include apertures or indentations, as does the tray 12. However, as best seen in Figure 2B, the underside of the lid, near its proximal end, includes one or more alignment pins 35. As explained above, these alignment pins 35 are configured to seat within the holes 33 of the tray 12 and, thereby, align and secure the lid 14 onto the tray 12 of the device 10.

[0040] Referring to Figures 1, 2A, 2B and 4, a central window 64 and indentations or tabs 66 are formed in the top surface 54 of the lid 14 and are generally aligned with the center aperture 34 of the tray 12. When a cartridge 22 is seated within the center aperture 34 of the tray 12, the central window 64 and tabs 66 allow portions of the cartridge 22 to be exposed, with the remaining portions of the cartridge 22 covered and secured by the lid 14. As such, the lid 14 functions to not only secure the cartridge 22 within the packaging system 10 during storage and/or use of the system/device 10, but also to maintain the cartridge 22 in an open position, by supplying sufficient force to the cartridge's wings 23, to expose the loading zone 25 of the cartridge 22. With the loading zone 25 exposed and in direct alignment with the lid's central window 64, a user of the packaging system 10 may easily apply a viscoelastic gel or viscoelastic surgical device (VSD), or lubricant (not shown) to the cartridge 22.

[0041] In general, a VSD is injected into the eye to help maintain the shape of ocular structures and as a lubricant/coating to minimize trauma from surgical instruments and implants. In addition, viscoelastic is also used in cartridges as a form of lubricant to aid in the passing of the IOL through the cartridge. Further, the viscoelastic also prevents air bubbles from being delivered into the eye with the IOL, which would obstruct the surgeon's view during the IOL insertion procedure.

[0042] As with the tray 12, the lid 14 of the packaging system 10 also includes one or more longitudinal side-slots 68. Each side-slot 68 is positioned on either side of the indentations/tabs 66 and are designed to accommodate the guideposts of the lock 16. To further understand the interaction between the side-slots 68, 40 of the lid 14 and tray 12 and the guideposts of the lock 16, it is instructive to first describe the lock 16 of the present invention. For this purpose, reference is made to Figures 2A, 2B, 5A, 5B, 6 and 7.

[0043] Figure 5A depicts an embodiment of the lock 16 as used in the packaging system 10 of the present invention. The lock 16 includes a generally planar or flat body 70, two guideposts 72 and an IOL support 74. The body 70 of the lock 16 further includes a top surface 78 and a bottom surface (not shown) that are shaped similar to the top surfaces

28, 54 of the tray 12 and lid 14. In particular, the body 70 is configured in a half-oval shape that includes a rounded or curved distal end 80 and a relatively straight or linear proximal end 82. As best seen in Figures 6 and 7, the body 70 of the lock 16 is sized to cover a substantial portion of the top surface 54 of the lid 14 and, in particular, at least a portion of the central window and indentations of the lid 14.

[0044] The guideposts or guide elements 72 of the lock 16 are also relatively planar or flat, but lie in vertical planes that are perpendicular to the plane of the lock's bottom surface. Each guidepost 72 is configured approximately in the shape of a quarter-circle and includes a first or longitudinal straight edge (not shown), a second or vertical straight edge 84 and a rounded edge 86. As shown in Figures 5A and 5B, the first straight edge of each guidepost 72 extends in a longitudinal direction along the bottom surface of the lock 16. The second edge 84 of each guidepost 72 is positioned at approximately a ninety-degree angle from the first straight edge and near the proximal end 82 of the lock 16. However, a notch 85 is formed in the portion of the guidepost 72 where the first and second edges 84 intersect. The notch 85 forms a type of neck or stem region 87 on the guidepost 72 and is configured to seat within the narrow portion of the L-shaped slot 40 of the tray 12, as explained in further detail below. The remaining rounded edge 86 of the guidepost 72 connects the first and second edges 84 of the guidepost 72, thereby forming its generally quarter-circle shape. As referenced above, each guidepost 72 is sized to fit within the longitudinal side-slots 40, 68 of the tray 12 and lid 14. As such, the guideposts 72 are parallel to each other and symmetrically positioned near the side edges of the lock 16, which generally correspond to the side edges of the lid 12 and tray 14.

[0045] As shown in Figures 5A, 5B, 6 and 7, the lock 16 of the packaging system also includes an IOL support 74, which is positioned near the straight proximal end 82 of the lock 16. The IOL support 74 is generally L-shaped and includes a first component 88 and a second component 90. The first component 88 of the IOL support 74 extends in a vertical direction, similar to the second edge 84 of the guideposts 72, and is attached to the body 70 of the lock 16. The second component 90 of the IOL support 74 extends in a proximal

direction along the longitudinal axis of the device 10 and is configured to fit near the loading zone of the cartridge 22. In general, the IOL support 74 buttresses and carries the distal edge of the IOL 20.

[0046] As noted in the Background of the Invention as set forth above, there is a need for a packaging system 10 that enables a user to easily transfer an IOL 20 into a cartridge 22 without damaging the IOL 20 or compromising its sterility. As the present invention substantially eliminates these undesirable characteristics, it is instructive to particularly describe the push-rod 18 that reliably drives or transfers the IOL 20 into the cartridge 22 while maintaining IOL sterility. For this purpose, reference is made to Figures 2A, 2B and 8.

[0047] Figures 2A, 2B and 8 illustrate one embodiment of the push-rod 18, which includes a oval-shaped handle 92 in communication with a half-oval shaped slide 94. In general, the handle 92 of the push-rod 18 includes a circular pushing surface 96 and a sidewall 98 that extends around the perimeter of the surface 96. The sidewall 98 provides additional structural support and gives added dimension to the handle 92 to enable a user to securely and controllably grip the push-rod 18 of the system. As best seen in Figures 2A and 2B, the half-oval shaped slide 94 is connected to the handle 92 of the push-rod 18 via the sidewall 98.

[0048] As with the lock 16 of the present invention, the slide 94 of the push-rod 18 includes a generally planar or flat body 100 having a top surface and a bottom surface that are shaped similar to the top surfaces 28, 54 of the tray 12 and lid 14. In this regard, the slide 94 of the push-rod 18 is configured in a half-oval shape that includes a rounded or curved distal end 102, two side-edges 104 and a proximal end 106 that follows the outline-shape of a portion of the sidewall 98. Overall, the slide 94 is sized to fit through the opening 46 of the sidewall 44 and within the tray 12 of the packaging system 10.

[0049] As best seen in Figures 2B, 4 and 8, one or more indentations 105 are located along the side-edges 104 and near the proximal end of the planar body 100 of the push-rod

18. These indentations 105 are configured to bypass the portion or section of the lid's sidewall 52 that surrounds or frames the lid's notches 62. In particular, during storage, the indentations 105 of the push-rod 18 are positioned proximal to and outside of the notches 62 of the lid 14. As such, the wider, non-indented section of the push-rod 18 is seated within the notches 62 so that the lid 14 cannot be removed from the system or device 10. However, when the push-rod 18 is actuated or advanced distally, the indentations 105 fall into alignment with the notches 62, thereby allowing lid removal.

[0050] Referring to Figures 2B, 5B and 8, each side-edge 104 of the slide 94 further includes one or more detents 109 which are configured to interact with the detent-slots 111 of the tray 12. Adjacent the detents 109 is a groove or slot 108 that extends along a longitudinal length of the slide 94. The grooves 108 are configured to accommodate the guideposts 72 of the lock 16 when the push-rod 18 is in a fully retracted or non-actuated position, as shown in Figure 5B. In addition, the grooves 108 also allow sufficient inward movement of the side-edges of the push-rod 18 to enable the detents 109 to pop out of the detent-slots 111 and travel along the inside sidewall of the tray 12 during device activation.

[0051] In this regard, prior to device activation, the detents 109 of the push-rod 18 are seated within the detent-slots 111 of the tray 12. To prevent unintentional device activation by dislodging the detents 109 from the detent-slots 111 via distal sliding movement of the push-rod 18, the guideposts 72 of the lock 16 are seated within the slots 68, 40, 108 of the lid 14, tray 12 and push-rod 18 and, in particular, are aligned with the detents 109 and detent-slots 111. As such, the guideposts 72 prevent the detents 109 from causing the side-edges of the push-rod 18 to bow inward along the grooves 108 and becoming dislodged from the detent-slots 111 of the tray 12. Thus, the guideposts 72 of the lock 16 serve to lock the system 10 during shipping and storage by preventing lateral distal advancement of the push-rod 18.

[0052] Proximal to the grooves 108 and located near the central, longitudinal axis of the slide 94 is an insertion member 110. The insertion member 110 includes a stabilizing segment 112 and a support segment 114, which are in stepped-relation to one another. In

particular, the stabilizing segment 112 extends a certain length beyond the distal end of the support segment 114, thereby forming the stepped configuration. As best seen in Figure 8, the stabilizing segment 112 includes a beveled or rounded distal tip 116 for supporting the proximal surface of the IOL 20 and controlling the rotational attitude of the IOL 20 during insertion into the loading zone 25 of the cartridge 22. As such, regardless of the initial positioning of the IOL 20 in the tray 12 of the device 10, during the delivery or transfer procedure, the insertion member 110 aids in advancing the IOL 20 into the cartridge 22 and controlling the IOL's rotational movement so that the IOL 20, and in particular the leading haptic 117 of the IOL 20, is correctly positioned (e.g., between points A and B, as shown in Figure 9) within the cartridge 22.

OPERATION

[0053] The packaging system 10 of the present invention is typically supplied to an end-user or surgeon with a lens cartridge 22 and IOL 20 pre-loaded within the center aperture 34 of the tray 12. Figure 10 illustrates an embodiment of the packaging system as supplied to the end user with the lock 16 and lid 14 removed to clearly show the lens 20 and cartridge 22 within the device 10. Alternatively, the packaging system 10 may only include the IOL 20, thereby allowing the user of the device 10 to supply the cartridge 22.

[0054] As shown in Figures 11A and 11B, prior to use, the tray 12 of the device 10 is covered with the lid 14. In addition, the push-rod 18 is in a retracted or partially inserted position within the opening 46 of the tray 12 and the lock 16 is secured to the lid 14, tray 12 and push-rod 18, via the guide elements 72 and slots 40, 68, 108 (not shown), to prevent inadvertent or unintentional activation of the system 10. In particular, as described above, the guideposts or vertical members 72 of the lock 16 block further distal advancement of the push-rod 18, and its insertion member 110, until the lock 16 is removed from the system 10.

[0055] During use of the device/system 10, the lock 16 is removed to expose the top surface 54 of the lid 14, as shown in Figures 12A and 12B. Preferably, the lid 14 is

fabricated from a clear material to allow the user of the device 10 to inspect the system 10, particularly the lens cartridge 22 and IOL 20, prior to use to ensure that none of the components are damaged. Removal of the lock 16 also exposes the central window 64 of the lid 14 and, thereby, the loading zone 25 of the lens cartridge 22, as shown in Figure 12C. Viscoelastic fluid is then applied to the loading zone 25 of the cartridge 22 and/or the edges of the IOL 22 through the opening 46 prior to device activation.

[0056] To activate the device 10, a user simply grasps the handle 92 of the push-rod 18 using, for example, his/her thumb and fore-finger, and pushes the push-rod 18 in a distal direction. Longitudinal sliding movement of the push-rod 18 causes the distal tip 116 of the insertion member 110 to push the IOL 20 along the longitudinal slot of the tray 12 and into the loading zone 25 of the cartridge 22, as shown in Figures 13A and 13B.

[0057] After the push-rod 18 is fully advanced and the IOL 20 is properly positioned within the loading zone 25, the wing 23 of the cartridge 22 is partially folded to begin the folding/rolling of the IOL 20 within the loading zone 25. With the wing 23 of the cartridge 22 partially folded, the lid 14 of the packaging system 10 is then removed. As best seen in Figure 14, the distal tip 116 of the insertion member 110 of the fully advanced push-rod 18 securely holds the loaded cartridge 22 within the tray 12 and prevents the cartridge 22 from falling out of the tray 12.

[0058] Next, the push-rod 18 is proximally retracted to release the loaded cartridge 22 from the insertion member 110 of the push-rod 18, as shown in Figure 15. The loaded cartridge 22 is then removed from the packaging system 10 (shown in Figure 16) and its wings 23 maneuvered to a closed position, thereby completely rolling or folding the IOL 20 into the desired configuration. At this point, the user may easily transfer the cartridge 22 with its folded IOL 20 to an insertion device (not shown) for delivery of the IOL 20 into a patient's eye.

[0059] In view of the above, the packaging system 10 of the present invention and its method of operation simplify the removal and transfer of the IOL 20 to the IOL insertion

device. In particular, the packaging device 10 enables a user to easily load an IOL 20 into a cartridge 22 without the use of forceps. The packaging device 10 also allows a user to fold and insert the IOL 20 into the cartridge 22 without damaging the IOL 20 and/or compromising IOL sterility. In addition, the related methods of operation minimize and/or eliminate the potential of damaging the IOL 20 during unpackaging, folding, transfer and/or loading procedures. Further, the device 10 and its method of use provide repeatable and consistent loading (e.g., with respect to position and rotation) of the IOL 20 into the cartridge 22.

[0060] Although the invention has been described in terms of particular embodiments and applications, one of ordinary skill in the art, in light of this teaching, can generate additional embodiments and modifications without departing from the spirit of or exceeding the scope of the claimed invention. Accordingly, it is to be understood that the drawings and descriptions herein are proffered by way of example to facilitate comprehension of the invention and should not be construed to limit the scope thereof.

What is claimed is:

1. A device to store and transfer an intraocular lens, said device comprising:
an intraocular lens;
a tray having an aperture, wherein said intraocular lens is housed within a portion of said aperture and wherein another portion of said aperture is configured to house a lens cartridge;
a push-rod in communication with said tray, wherein said push-rod causes controlled movement of said intraocular lens within said device; and
a lock in communication with said tray and said push-rod, wherein said lock prevents unintentional movement of said push-rod and intraocular lens within said device.
2. The device of claim 1 further comprising a lid, wherein said lid covers said tray and secures said intraocular lens and said lens cartridge within said device.
3. The device of claim 1 wherein said lock includes at least one guide element.
4. The device of claim 3 wherein said tray and said push-rod include at least one slot configured to accommodate said guide element of said lock.
5. The device of claim 4 wherein said tray includes at least one detent-slot and said push-rod includes at least one detent configured to seat within said detent-slot.
6. The device of claim 5 wherein said guide element of said lock is aligned with said detent and said detent-slot to prevent movement of said push-rod.
7. The device of claim 1 further comprising a lens cartridge, wherein said lens cartridge is configured to seat within said aperture of said tray.

8. A method of storing an intraocular lens and transferring said intraocular lens to a lens cartridge for use in a delivery device comprising:

providing a packaging device housing said intraocular lens and said lens cartridge within a tray of said packaging device; wherein said packaging device further comprises a push-rod in communication with said tray and a lock in communication with said tray and said push-rod;

removing said lock to enable movement of said push-rod;

distally advancing said push-rod to transfer and secure said intraocular lens within a loading zone of said lens cartridge;

proximally retracting said push-rod to release said intraocular lens and said lens cartridge; and

removing said lens cartridge from said packaging device, wherein said lens cartridge contains said intraocular lens.

9. The method of claim 8 further comprising removing a lid, wherein said packaging device includes a lid surrounding said tray.

10. The method of claim 8 further comprising closing said lens cartridge and folding said intraocular lens within said cartridge.

11. Novel enhanced intraocular lens storage device, comprising, in combination:
a tray with an aperture defined by a space for housing an intraocular lens and an intraocular lens cartridge;

a push-rod for advancing the intraocular lens; and

a locking mechanism for preventing movement of the intraocular lens, cartridge and push-rod until actuated by a user.

FIG. 1

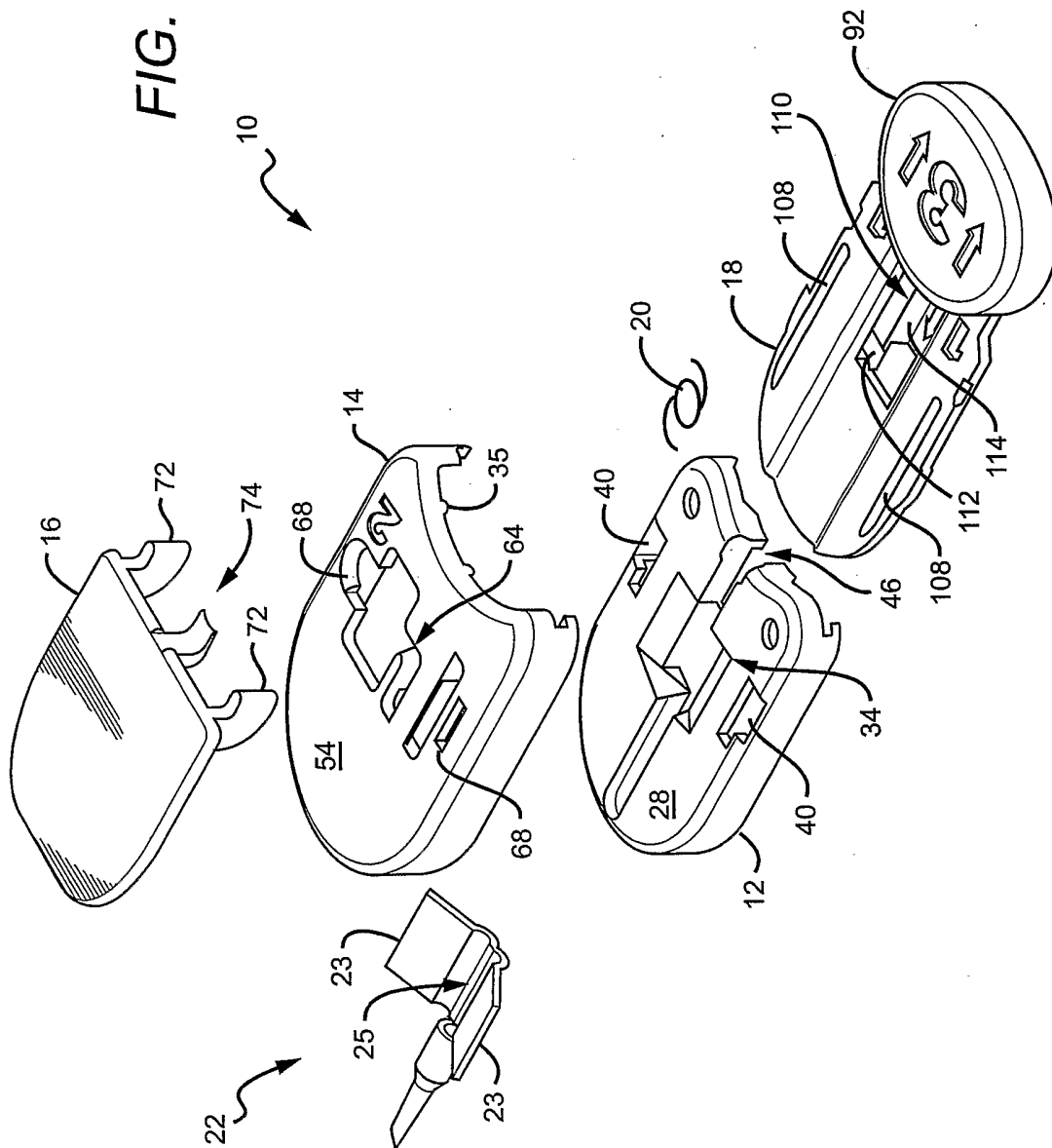

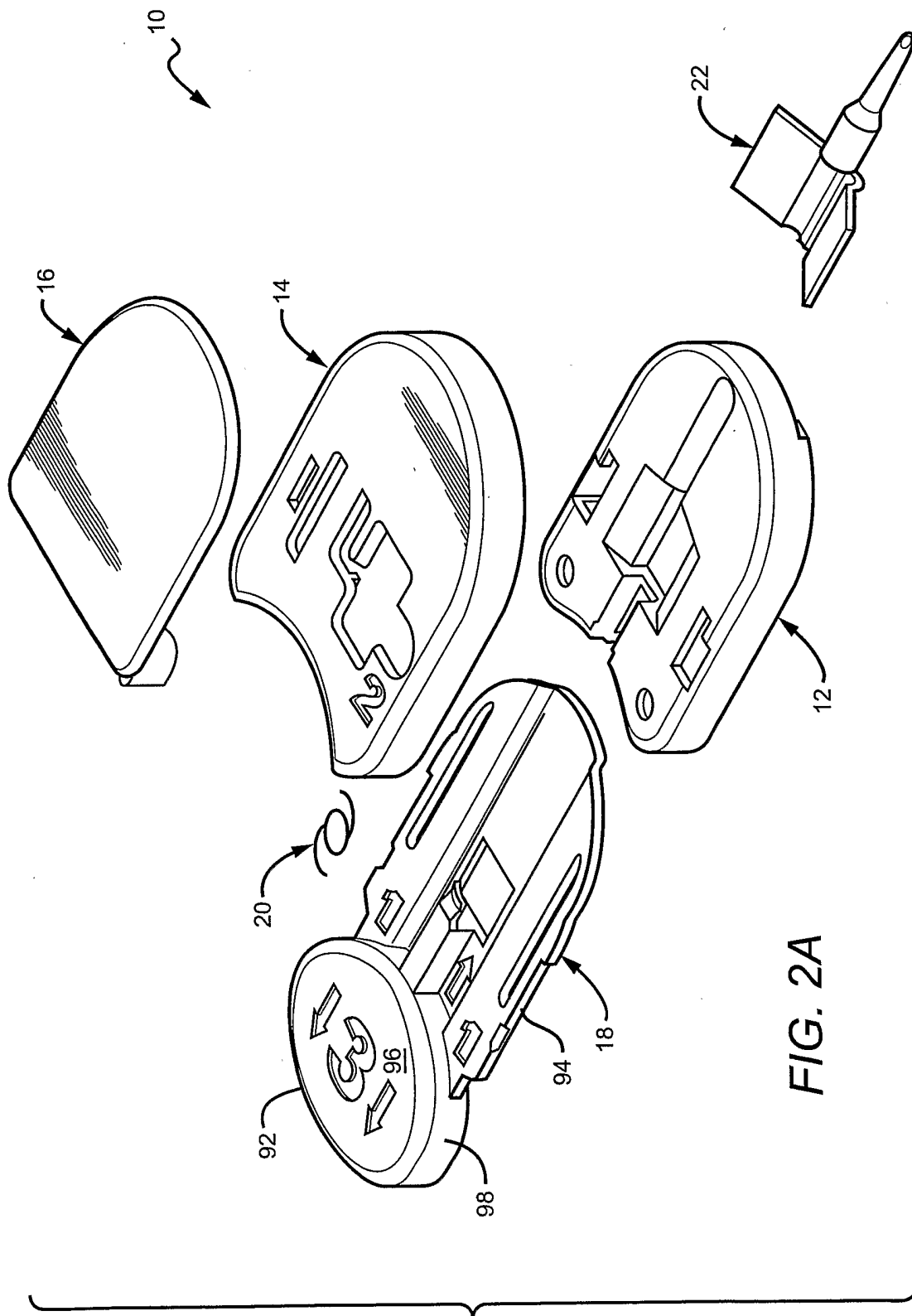

FIG. 2A

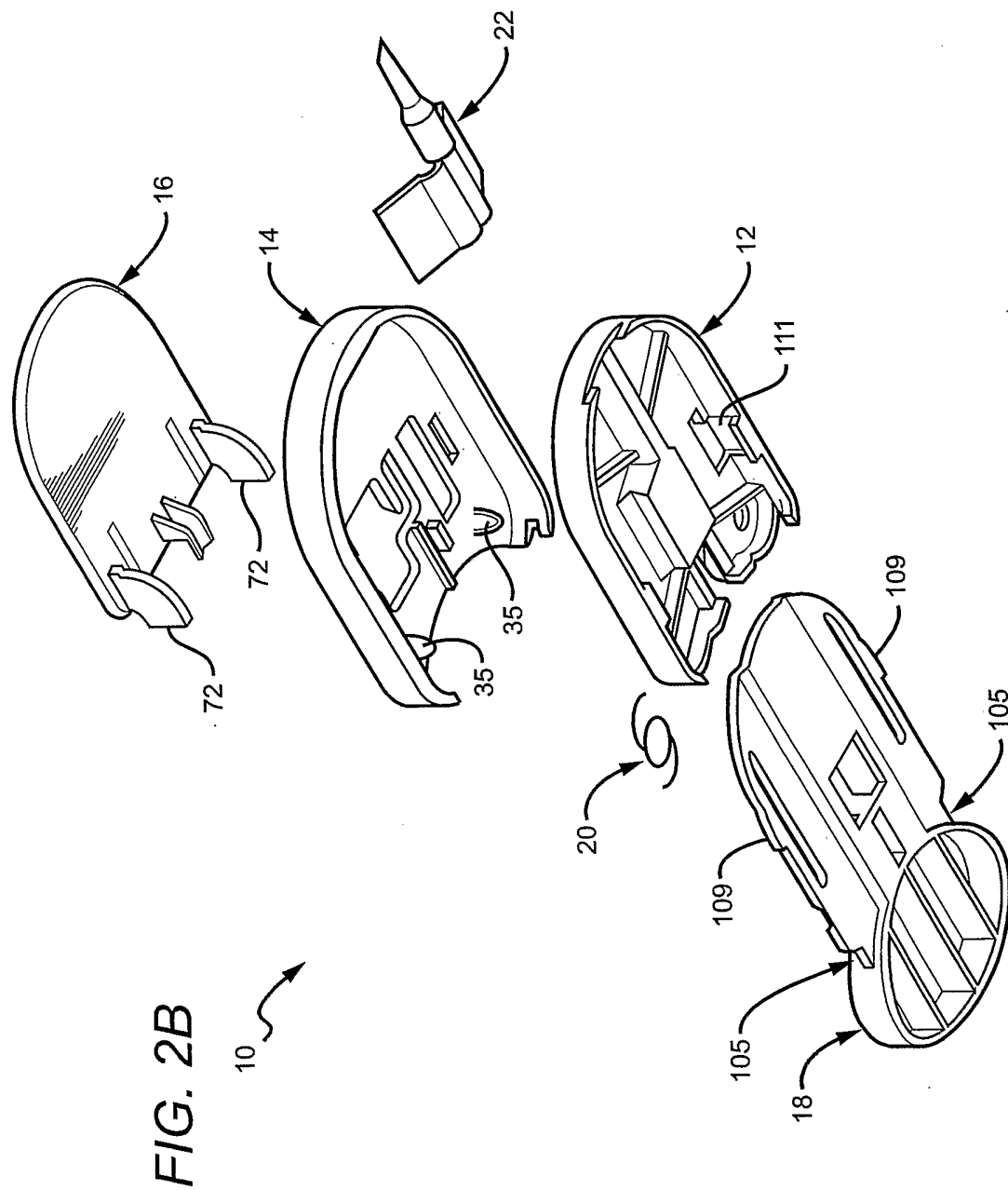

FIG. 2B

10

4/12

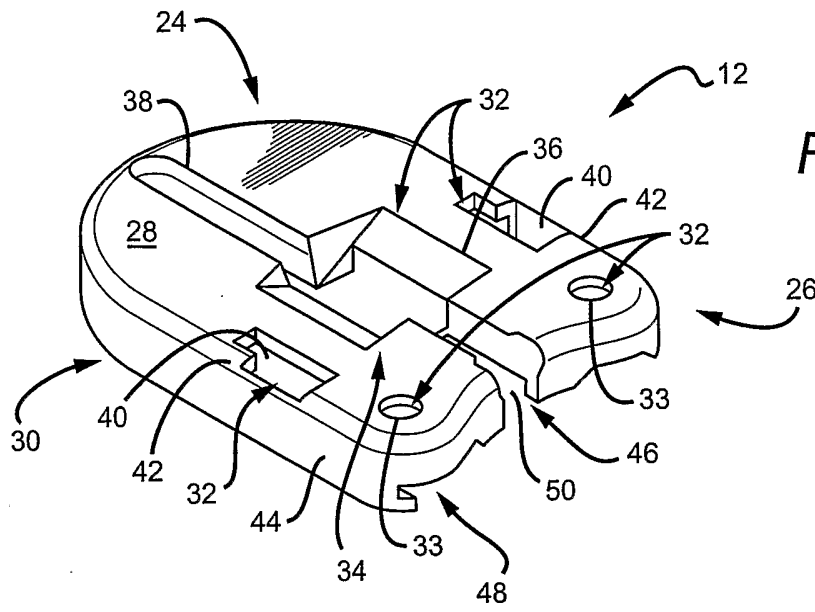

FIG. 3

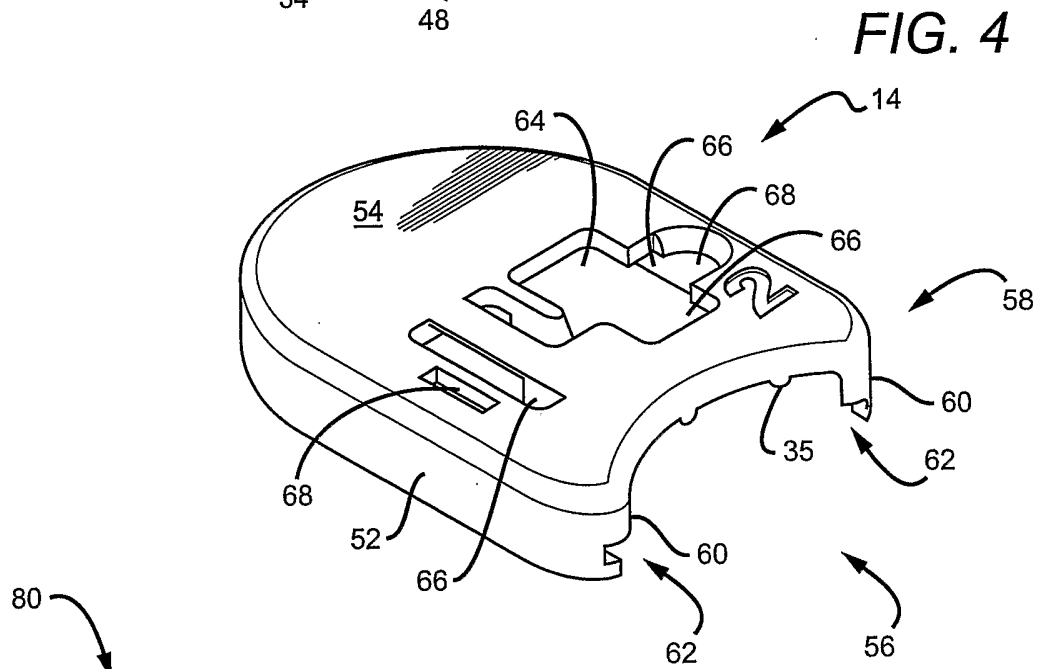

FIG. 4

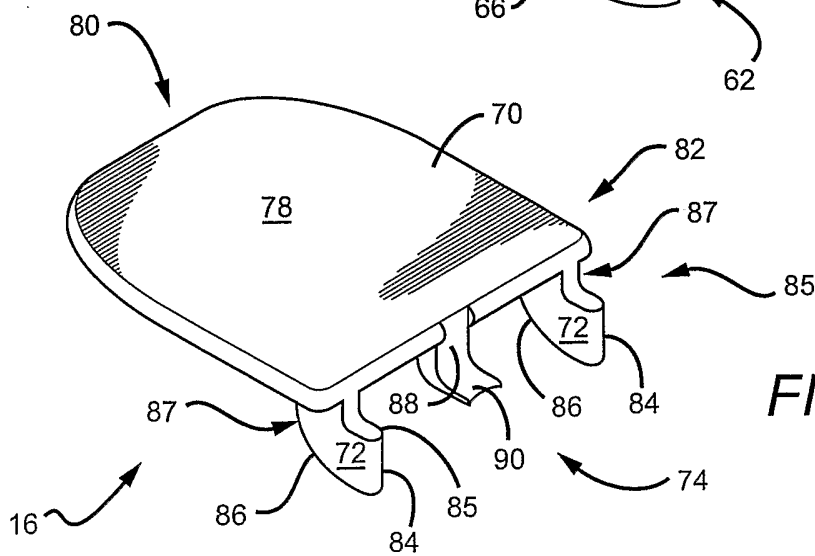

FIG. 5A

FIG. 5B

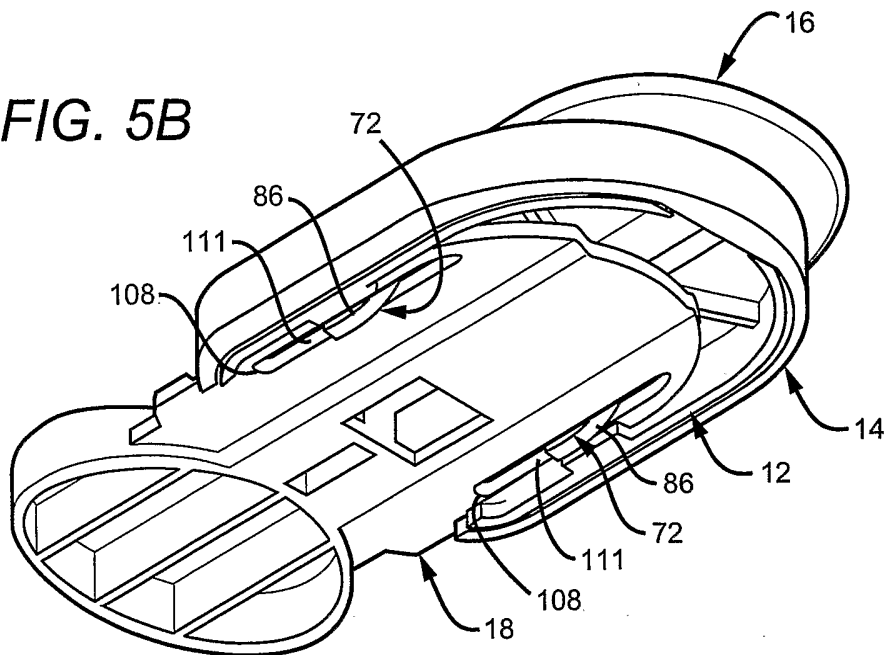

FIG. 6

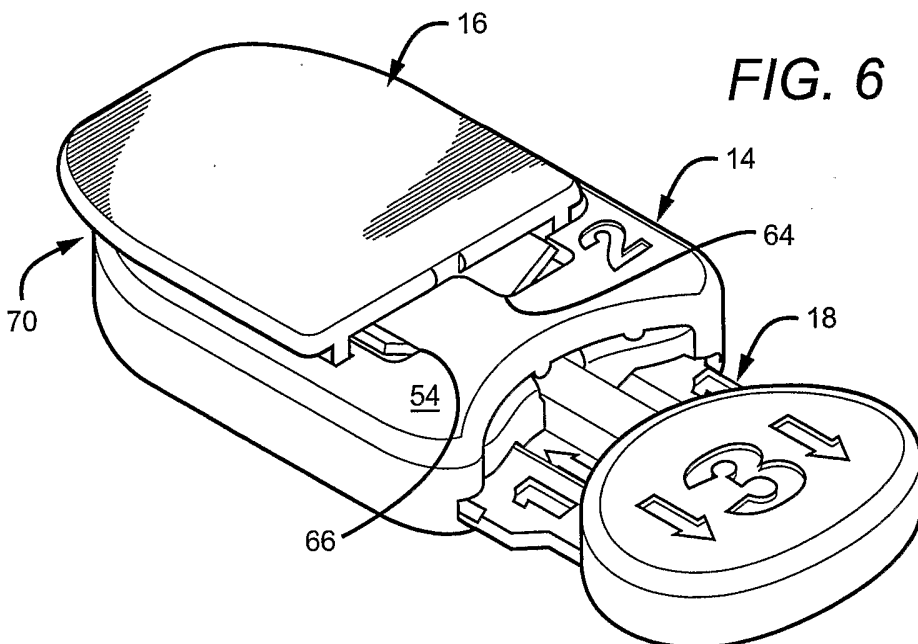

FIG. 7

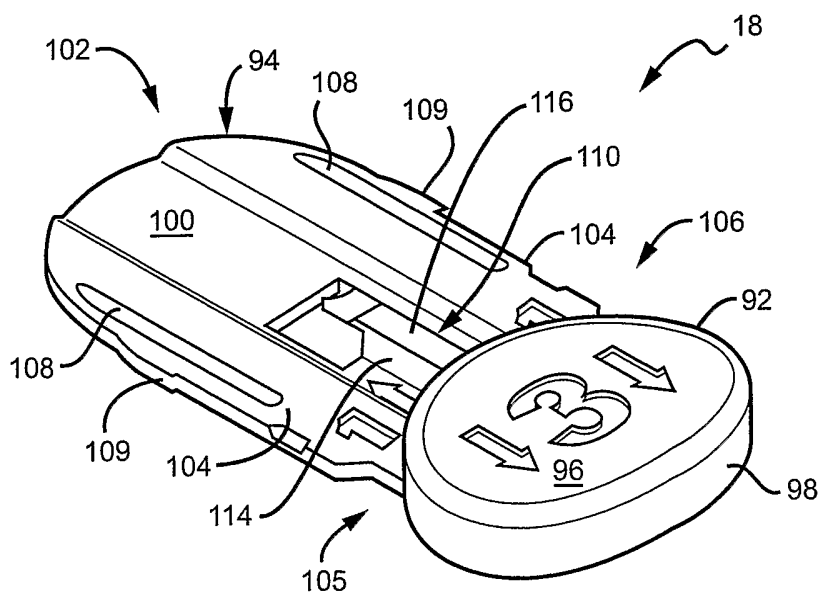
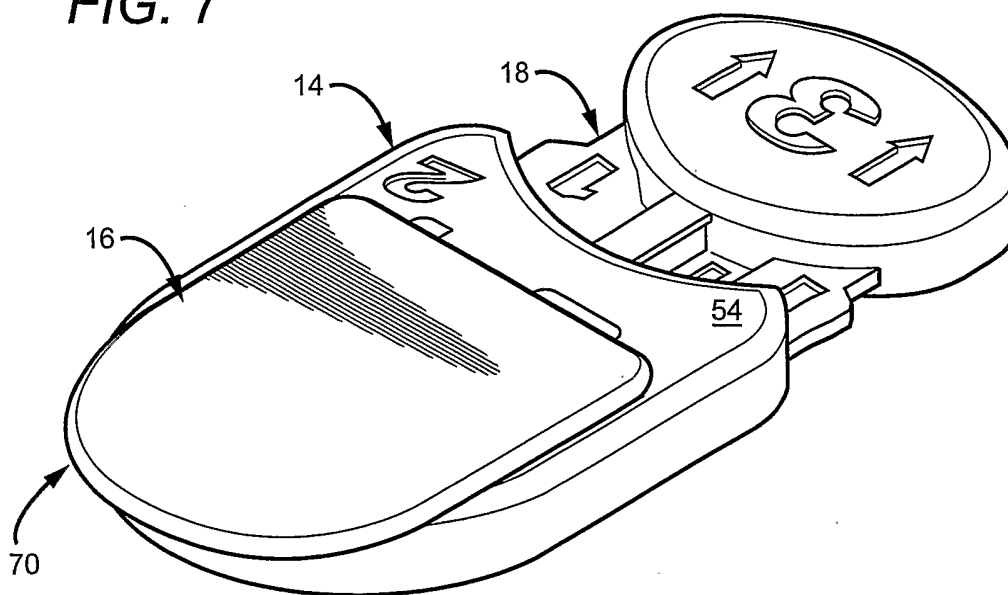

FIG. 8

7/12

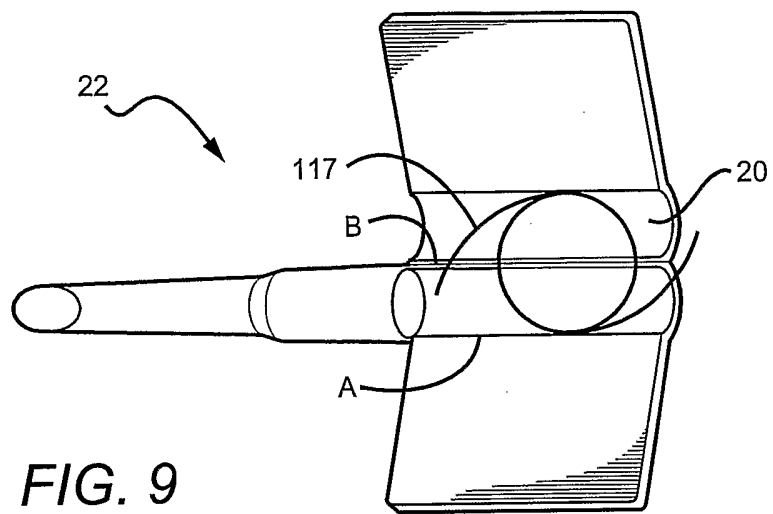

FIG. 9

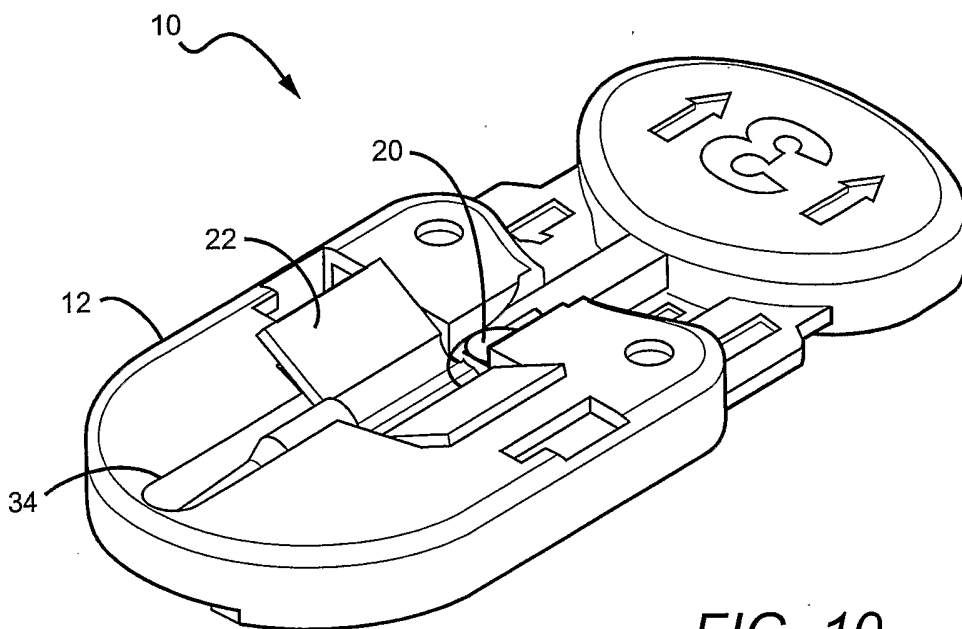
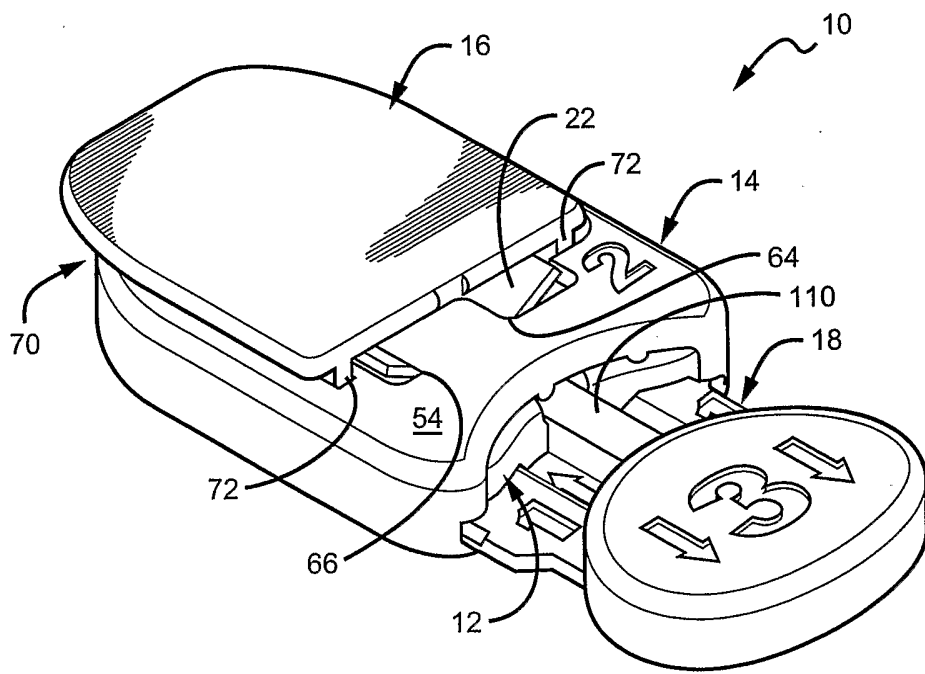
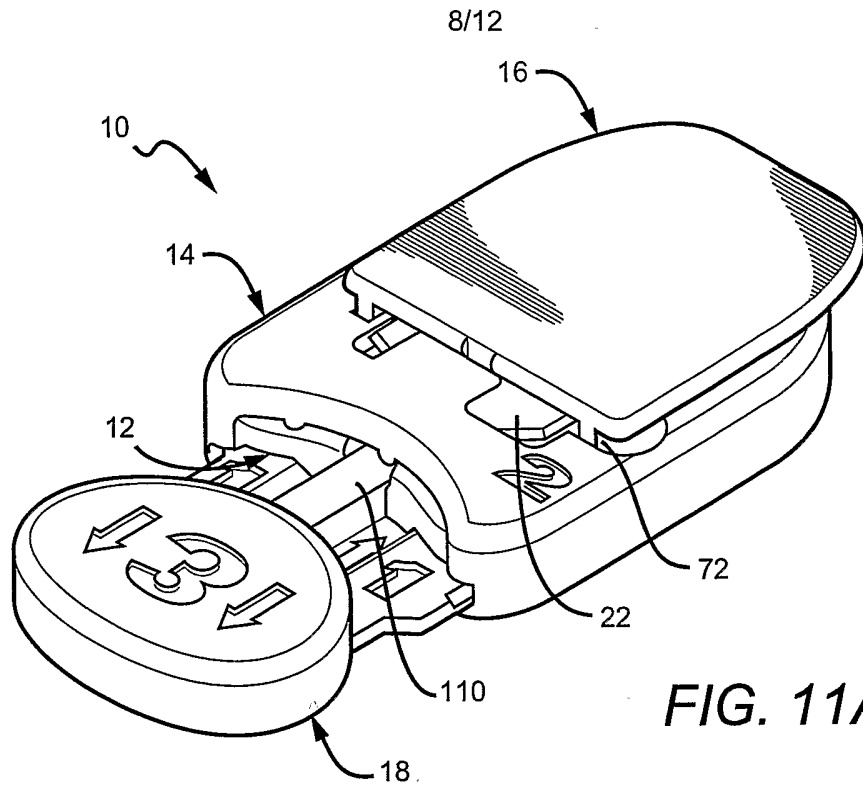

FIG. 10



9/12

FIG. 12A

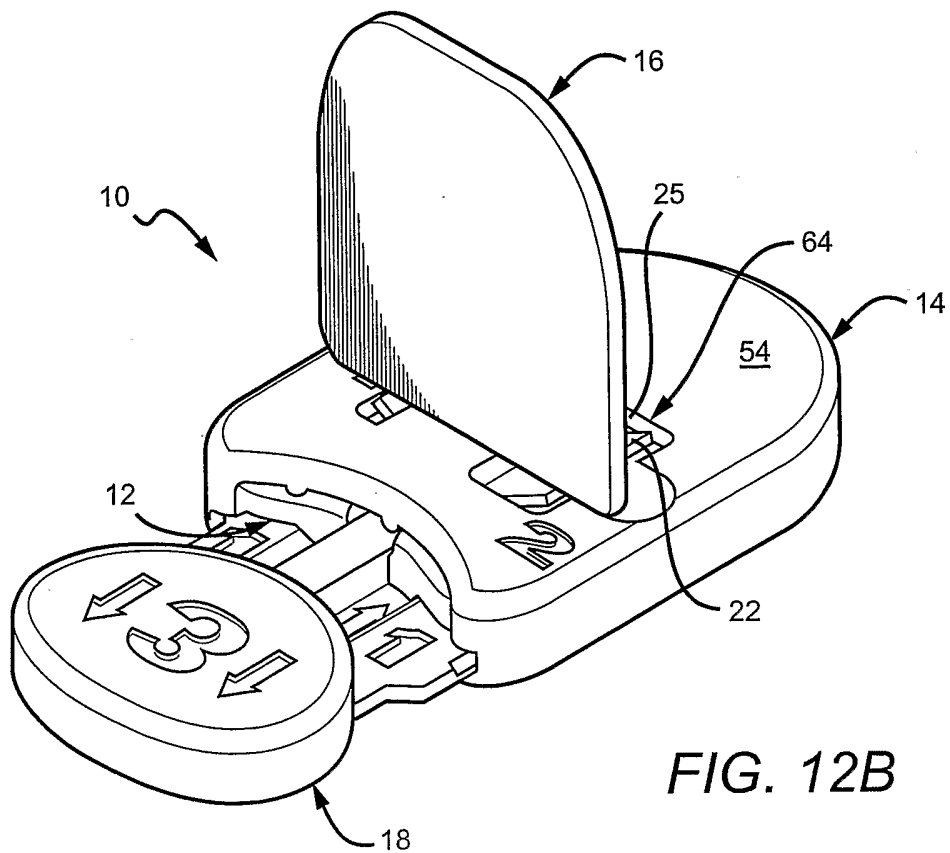
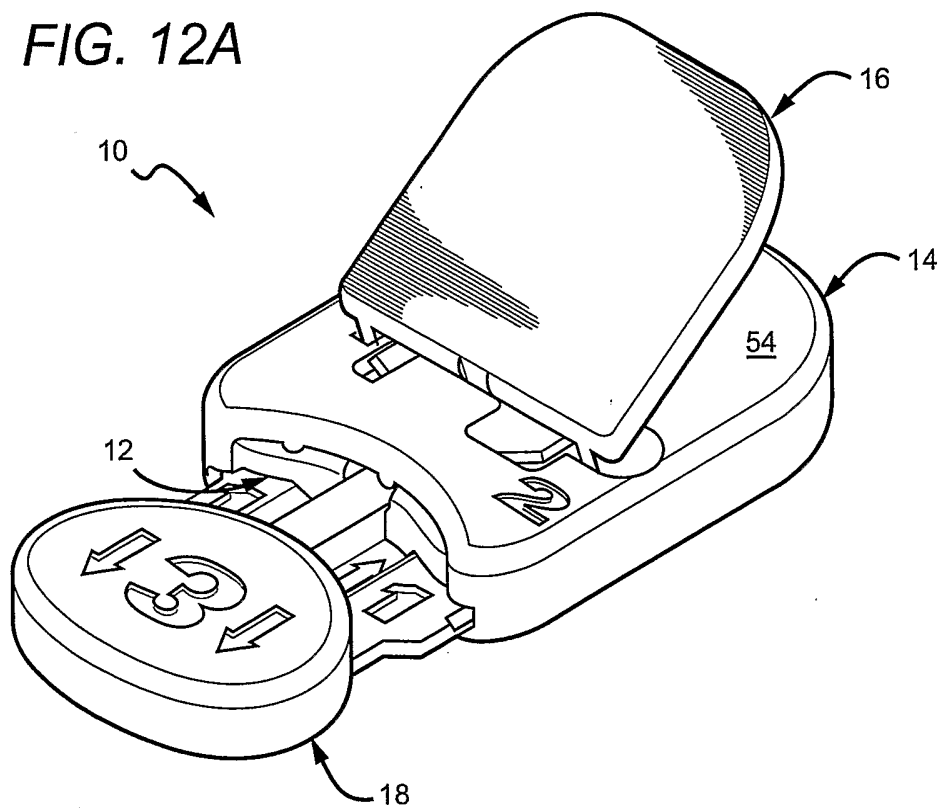
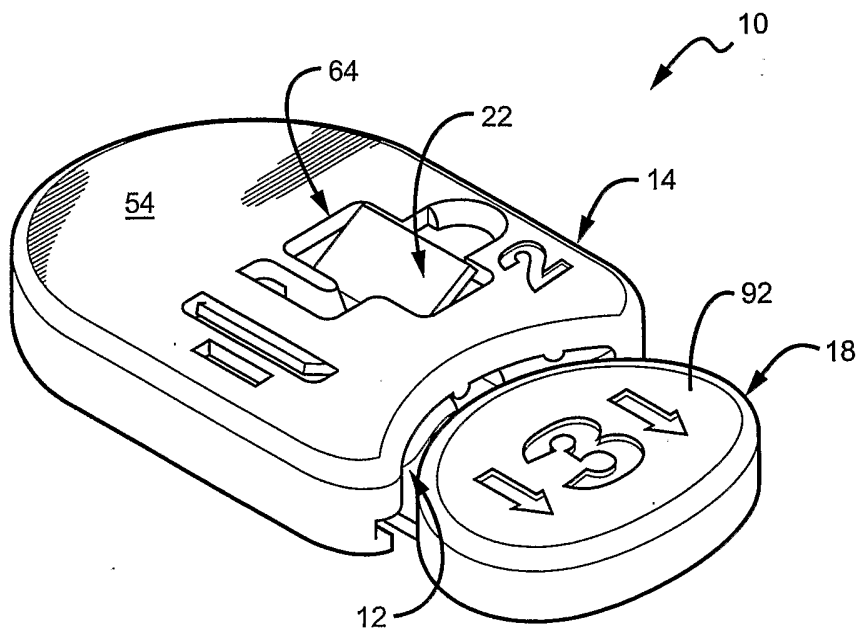
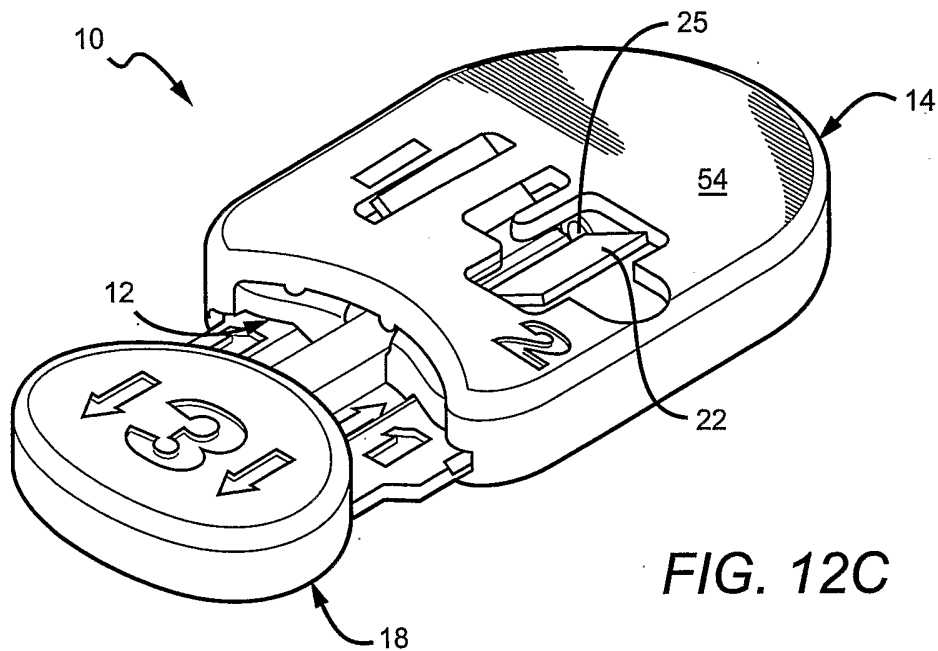
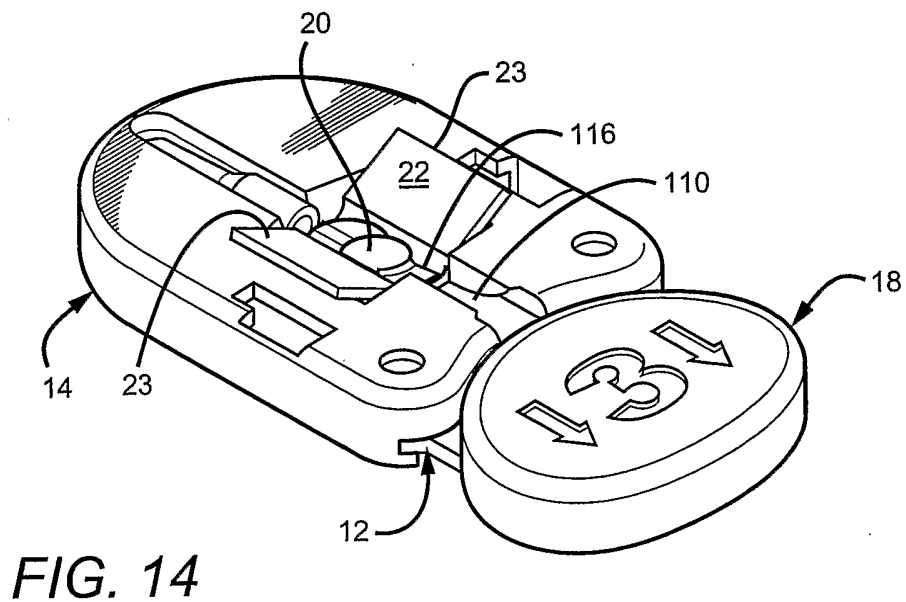
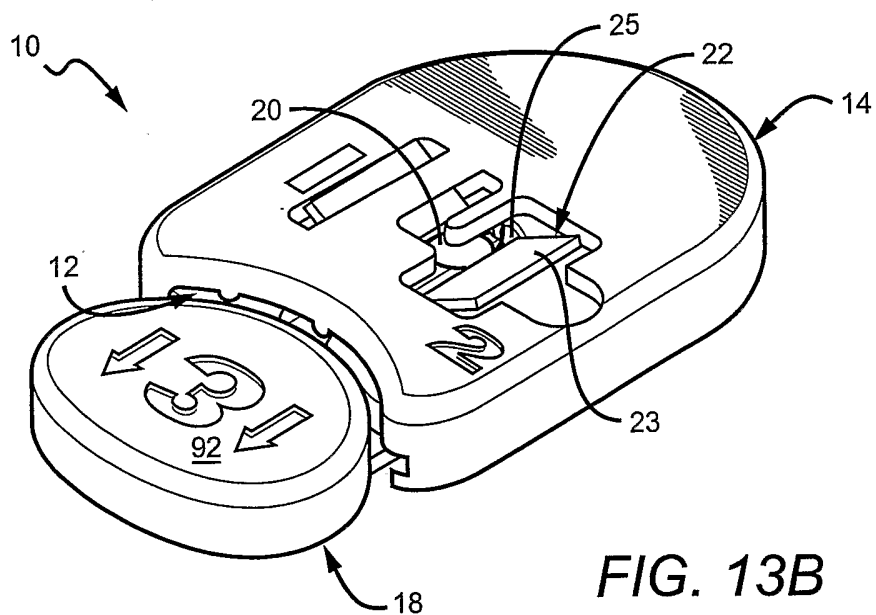

FIG. 12B

10/12



11/12



12/12

FIG. 15

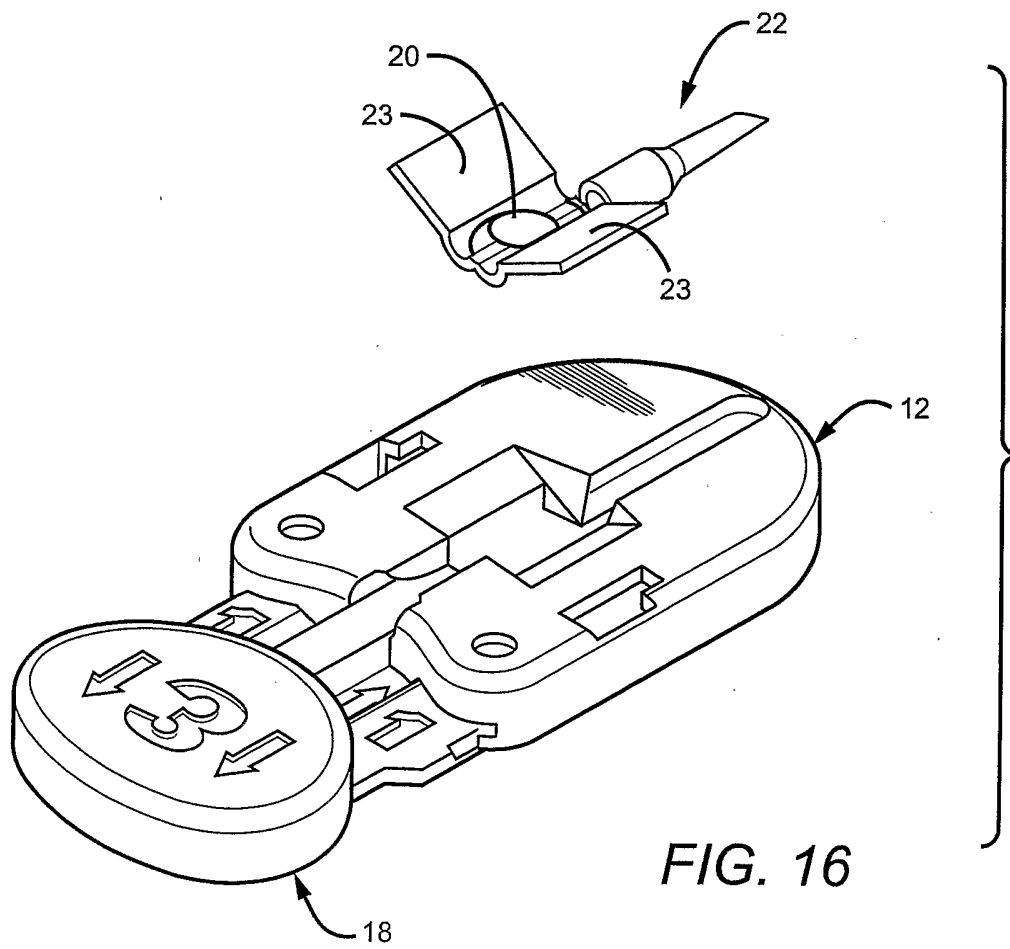
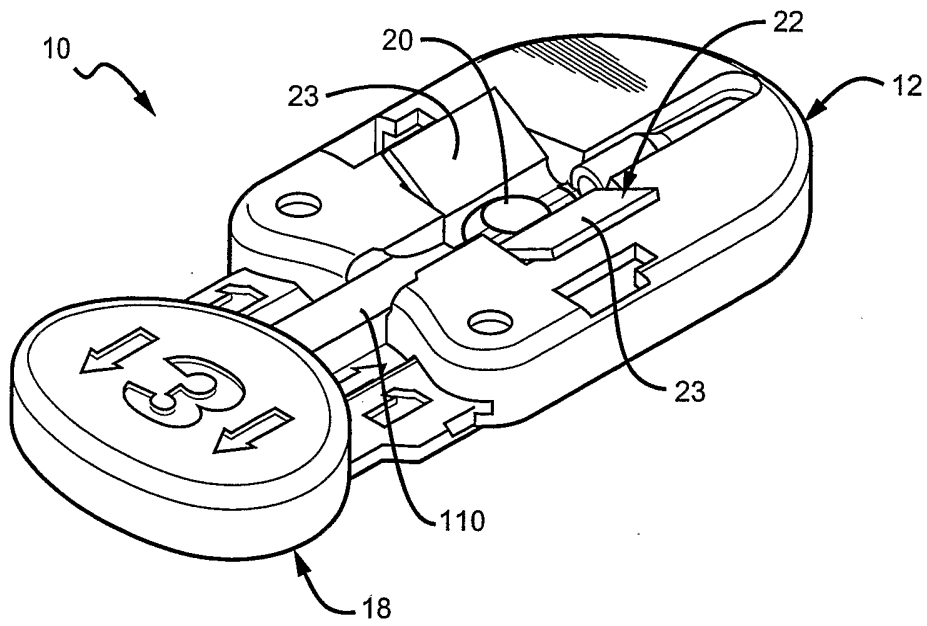

FIG. 16

INTERNATIONAL SEARCH REPORT

International Application No
PCT/US2004/018175

A. CLASSIFICATION OF SUBJECT MATTER
IPC 7 A61F2/16

According to International Patent Classification (IPC) or to both national classification and IPC

B. FIELDS SEARCHED

Minimum documentation searched (classification system followed by classification symbols)
IPC 7 A61F

Documentation searched other than minimum documentation to the extent that such documents are included in the fields searched

Electronic data base consulted during the international search (name of data base and, where practical, search terms used)
EPO-Internal

C. DOCUMENTS CONSIDERED TO BE RELEVANT

Category °	Citation of document, with indication, where appropriate, of the relevant passages	Relevant to claim No.
X	US 6 497 708 B1 (CUMMING J STUART) 24 December 2002 (2002-12-24) column 2, line 21 - column 3, line 53; figure 1	1,8,11
P,X	FR 2 833 154 A (IOLTECHNOLOGIE PRODUCTION) 13 June 2003 (2003-06-13) page 6, line 14 - page 12, line 23; figures 1,2	1,8,11
A	US 6 447 519 B1 (COLLINSON MICHAEL ET AL) 10 September 2002 (2002-09-10) the whole document	1-11
A	US 2001/004052 A1 (SAKANISHI KOTARO) 21 June 2001 (2001-06-21) the whole document	1-11
	-/--	

Further documents are listed in the continuation of box C. Patent family members are listed in annex.

° Special categories of cited documents :

A document defining the general state of the art which is not considered to be of particular relevance	*T* later document published after the international filing date or priority date and not in conflict with the application but cited to understand the principle or theory underlying the invention
E earlier document but published on or after the international filing date	*X* document of particular relevance; the claimed invention cannot be considered novel or cannot be considered to involve an inventive step when the document is taken alone
L document which may throw doubts on priority claim(s) or which is cited to establish the publication date of another citation or other special reason (as specified)	*Y* document of particular relevance; the claimed invention cannot be considered to involve an inventive step when the document is combined with one or more other such documents, such combination being obvious to a person skilled in the art.
O document referring to an oral disclosure, use, exhibition or other means	*Z* document member of the same patent family
P document published prior to the international filing date but later than the priority date claimed	

Date of the actual completion of the international search 5 November 2004	Date of mailing of the international search report 15/11/2004
---	---

Name and mailing address of the ISA European Patent Office, P.B. 5818 Patentlaan 2 NL - 2280 HV Rijswijk Tel. (+31-70) 340-2040, Tx. 31 651 epo nl, Fax: (+31-70) 340-3016	Authorized officer Serra i Verdagner, J
--	---

INTERNATIONAL SEARCH REPORT

International Application No
PCT/US2004/018175

C.(Continuation) DOCUMENTS CONSIDERED TO BE RELEVANT

Category °	Citation of document, with indication, where appropriate, of the relevant passages	Relevant to claim No.
A	US 2001/041897 A1 (FEINGOLD VLADIMIR ET AL) 15 November 2001 (2001-11-15) the whole document -----	1-11
A	US 6 500 181 B1 (PORTNEY VALDEMAR) 31 December 2002 (2002-12-31) the whole document -----	1-11

INTERNATIONAL SEARCH REPORT

Information on patent family members

International Application No

PCT/US2004/018175

Patent document cited in search report		Publication date	Patent family member(s)	Publication date
US 6497708	B1	24-12-2002	AU 768099 B2	04-12-2003
			AU 3973999 A	29-11-1999
			CA 2331574 A1	18-11-1999
			EP 1085843 A1	28-03-2001
			JP 2002514466 T	21-05-2002
			WO 9958086 A1	18-11-1999
			US 2004215207 A1	28-10-2004
FR 2833154	A	13-06-2003	FR 2833154 A1	13-06-2003
			CA 2469465 A1	19-06-2003
			EP 1453440 A2	08-09-2004
			WO 03049645 A2	19-06-2003
US 6447519	B1	10-09-2002	US 6129733 A	10-10-2000
			AT 245008 T	15-08-2003
			AU 4798100 A	02-11-2000
			DE 60003908 D1	21-08-2003
			DE 60003908 T2	13-05-2004
			EP 1173115 A1	23-01-2002
			WO 0062713 A1	26-10-2000
US 2001004052	A1	21-06-2001	JP 2001161727 A	19-06-2001
US 2001041897	A1	15-11-2001	US 5728102 A	17-03-1998
			US 5499987 A	19-03-1996
			US 5941886 A	24-08-1999
			US 2002151904 A1	17-10-2002
			US 5902307 A	11-05-1999
			AT 215801 T	15-04-2002
			AU 692425 B2	11-06-1998
			AU 5349594 A	26-04-1994
			AU 717897 B2	06-04-2000
			AU 6197498 A	13-08-1998
			CA 2144741 C	08-04-1997
			DE 69331807 D1	16-05-2002
			DE 69331807 T2	26-09-2002
			DK 723429 T3	29-07-2002
			EP 0723429 A1	31-07-1996
			ES 2177550 T3	16-12-2002
			JP 8505540 T	18-06-1996
			PT 723429 T	30-09-2002
			US 6048348 A	11-04-2000
			WO 9407436 A1	14-04-1994
			US 6162229 A	19-12-2000
			US 5494484 A	27-02-1996
			US 6712848 B1	30-03-2004
			US 5582614 A	10-12-1996
			US 6241737 B1	05-06-2001
			US 5807400 A	15-09-1998
			US 5620450 A	15-04-1997
US 5616148 A	01-04-1997			
US 6629979 B1	07-10-2003			
US 5772666 A	30-06-1998			
US 5891152 A	06-04-1999			
US 5860984 A	19-01-1999			
US 5928245 A	27-07-1999			
US 5876440 A	02-03-1999			
US 2001001822 A1	24-05-2001			

INTERNATIONAL SEARCH REPORT

Information on patent family members

International Application No
PCT/US2004/018175

Patent document cited in search report	Publication date	Patent family member(s)	Publication date
US 2001041897	A1	US 6001107 A	14-12-1999
		US 5868751 A	09-02-1999
		US 6022358 A	08-02-2000
		US 6143000 A	07-11-2000
		US 6059791 A	09-05-2000
		US 6056757 A	02-05-2000
		US 5800442 A	01-09-1998
		AT 245012 T	15-08-2003
		AU 714145 B2	23-12-1999
		AU 4501796 A	17-06-1996
		AU 4878799 A	11-11-1999
		CA 2181472 A1	30-05-1996
		CN 1143313 A	19-02-1997
		DE 69531289 D1	21-08-2003
<hr/>			
US 6500181	B1	31-12-2002	NONE
<hr/>			