



(12) **EUROPEAN PATENT APPLICATION**

(88) Date of publication A3:
28.01.2004 Bulletin 2004/05

(51) Int Cl.7: **B65H 1/18**

(43) Date of publication A2:
05.02.2003 Bulletin 2003/06

(21) Application number: **02077808.0**

(22) Date of filing: **12.07.2002**

(84) Designated Contracting States:
**AT BE BG CH CY CZ DE DK EE ES FI FR GB GR
IE IT LI LU MC NL PT SE SK TR**
Designated Extension States:
AL LT LV MK RO SI

- **Maysick, Randall R., Eastman Kodak Company
Rochester, New York 14650-2201 (US)**
- **Ebert, Thomas W., Eastman Kodak Company
Rochester, New York 14650-2201 (US)**

(30) Priority: **19.07.2001 US 909334**

(74) Representative: **Weber, Etienne Nicolas et al
Kodak Industrie,
Département Brevets,
CRT,
Zone Industrielle
71102 Chalon sur Saône Cedex (FR)**

(71) Applicant: **EASTMAN KODAK COMPANY
Rochester, New York 14650 (US)**

(72) Inventors:
• **Westcott, Robert M., Eastman Kodak Company
Rochester, New York 14650-2201 (US)**

(54) **A capacity control system for a paper supply elevator**

(57) A capacity control system for a paper supply elevator comprises a paper support (16) and a paper sensor (52) for detecting the presence of paper on the paper support. A home position sensor (14) detects a home position of the paper support. A stack up sensor (36) detects a topmost sheet of paper in a stack of pa-

pers located on the paper support (16). An intermittent drive (22) raises and lowering the paper support (16). A control panel (32) inputs an expected paper stack size. A control circuit for the intermittent drive (22) causes the intermittent drive to move the paper support (16) to a position corresponding to the expected paper stack size.

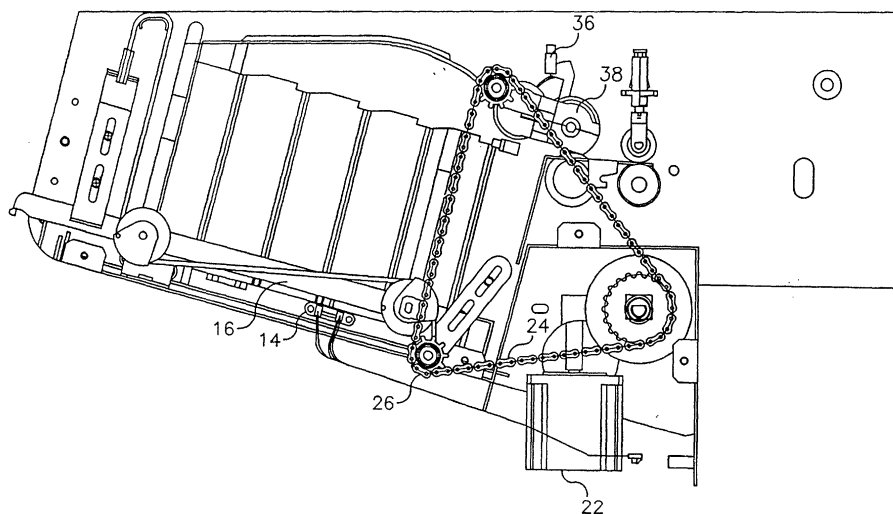

FIG. 1



European Patent
Office

EUROPEAN SEARCH REPORT

Application Number
EP 02 07 7808

DOCUMENTS CONSIDERED TO BE RELEVANT			
Category	Citation of document with indication, where appropriate, of relevant passages	Relevant to claim	CLASSIFICATION OF THE APPLICATION (Int.Cl.7)
X	US 4 052 051 A (MERSEREAU ROBERT E ET AL) 4 October 1977 (1977-10-04) * column 3, line 31 - column 6, line 42; figures 1-4 *	1,3,8	B65H1/18
A	--- US 5 165 678 A (KOSEKI MASAOKI ET AL) 24 November 1992 (1992-11-24) * the whole document * -----	1,3,4	
			TECHNICAL FIELDS SEARCHED (Int.Cl.7)
			B65H
The present search report has been drawn up for all claims			
Place of search MUNICH		Date of completion of the search 28 November 2003	Examiner Rupprecht, A
<p>CATEGORY OF CITED DOCUMENTS</p> <p>X : particularly relevant if taken alone Y : particularly relevant if combined with another document of the same category A : technological background O : non-written disclosure P : intermediate document</p> <p>T : theory or principle underlying the invention E : earlier patent document, but published on, or after the filing date D : document cited in the application L : document cited for other reasons</p> <p>..... & : member of the same patent family, corresponding document</p>			

EPO FORM 1503 03 82 (P04C01)

**ANNEX TO THE EUROPEAN SEARCH REPORT
ON EUROPEAN PATENT APPLICATION NO.**

EP 02 07 7808

This annex lists the patent family members relating to the patent documents cited in the above-mentioned European search report. The members are as contained in the European Patent Office EDP file on
The European Patent Office is in no way liable for these particulars which are merely given for the purpose of information.

28-11-2003

Patent document cited in search report		Publication date	Patent family member(s)	Publication date
US 4052051	A	04-10-1977	NONE	
US 5165678	A	24-11-1992	JP 4032424 A	04-02-1992

EPO FORM P0459

For more details about this annex : see Official Journal of the European Patent Office, No. 12/82