

(19)



(11)

**EP 2 280 143 A3**

(12)

**EUROPEAN PATENT APPLICATION**

(88) Date of publication A3:  
**27.04.2011 Bulletin 2011/17**

(51) Int Cl.:  
**E05D 7/086<sup>(2006.01)</sup> E05D 1/04<sup>(2006.01)</sup>**  
**E05F 1/10<sup>(2006.01)</sup> E05D 7/082<sup>(2006.01)</sup>**

(43) Date of publication A2:  
**02.02.2011 Bulletin 2011/05**

(21) Application number: **10181028.1**

(22) Date of filing: **19.08.2004**

(84) Designated Contracting States:  
**AT BE BG CH CY CZ DE DK EE ES FI FR GB GR HU IE IT LI LU MC NL PL PT RO SE SI SK TR**

(72) Inventors:  
• **Børresen, Bjarne DK-2860 Søborg (DK)**  
• **Jensen, Jan Fahlén DK-2860 Søborg (DK)**  
• **Sørensen, Peter DK-2800 Lyngby (DK)**

(30) Priority: **20.08.2003 DK 200301182**  
**02.07.2004 EP 04388045**

(62) Document number(s) of the earlier application(s) in accordance with Art. 76 EPC:  
**04762775.7 / 1 685 304**

(74) Representative: **Rohde, Vibeke Warberg Awapatent A/S Rigersgade 11 1316 Copenhagen K (DK)**

(71) Applicant: **VKR Holding A/S 2970 Hørsholm (DK)**

(54) **An improved pivot window with at least one auxiliary opening device**

(57) The sash (2) of the window is connected with the frame (1) by means of a hinge device including a set of pivot hinges (12) defining a hinge axis of the window. The hinges are mounted in such a position that the hinge

axis is situated between a centre line of the window and the top or bottom of the window. The window is provided with a least one auxiliary opening device comprising a spring, preferably connected to the hinge device.

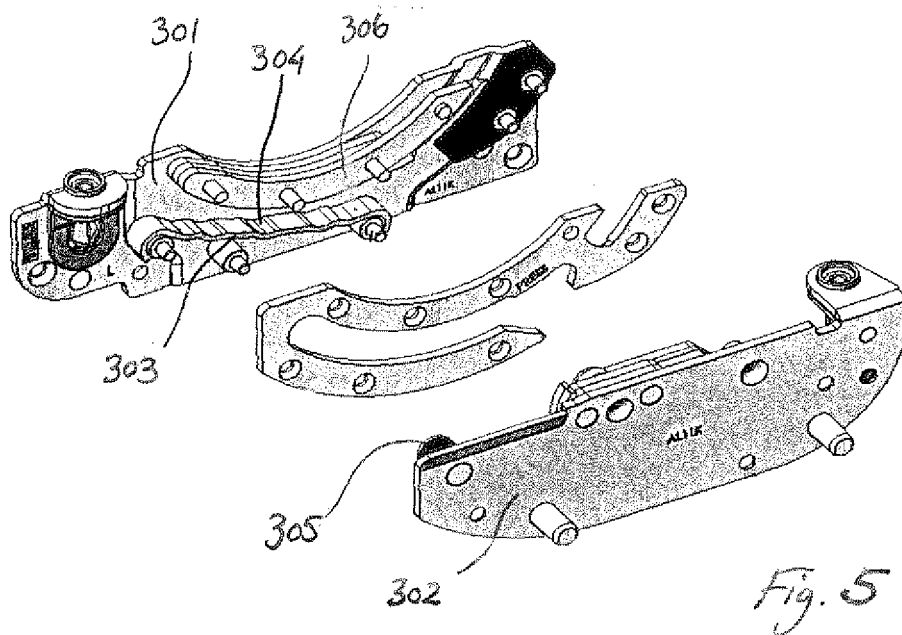

*Fig. 5*

**EP 2 280 143 A3**



EUROPEAN SEARCH REPORT

Application Number  
EP 10 18 1028

DOCUMENTS CONSIDERED TO BE RELEVANT			
Category	Citation of document with indication, where appropriate, of relevant passages	Relevant to claim	CLASSIFICATION OF THE APPLICATION (IPC)
X	FR 2 581 119 A1 (COIRIER YVES [FR]) 31 October 1986 (1986-10-31) * the whole document * -----	1-15	INV. E05D7/086 E05D1/04 E05F1/10 E05D7/082
X	GB 844 492 A (ROTHERVALE MFG COMPANY LTD) 10 August 1960 (1960-08-10) * page 2, line 4 - line 7 * * page 2, line 122 - page 3, line 9; figures * -----	1-15	
X	DE 35 00 630 A1 (ESTFELLER SRL [IT]) 18 July 1985 (1985-07-18) * abstract; figures * -----	1-15	
A	DE 27 08 785 A1 (STUCKE LOTHAR) 19 October 1978 (1978-10-19) * the whole document * -----	1-15	
A	EP 0 872 610 A2 (ROTO FRANK AG [DE]) 21 October 1998 (1998-10-21) * column 4, line 38 - column 7, line 58; figures * -----	1-15	
A	EP 1 038 083 A1 (VELUX IND AS [DK] VKR HOLDING AS [DK]) 27 September 2000 (2000-09-27) * the whole document * -----	1-15	
A	GB 1 086 948 A (AUTOMATIC PRESSINGS LTD) 11 October 1967 (1967-10-11) * the whole document * -----	1	
A	FR 2 281 484 A1 (ALBERTSSON HEINE [SE]) 5 March 1976 (1976-03-05) * figures 2,3 * -----	1	
The present search report has been drawn up for all claims			TECHNICAL FIELDS SEARCHED (IPC)
			E05D E05F
2	Place of search Munich	Date of completion of the search 17 March 2011	Examiner Di Renzo, Raffaele
CATEGORY OF CITED DOCUMENTS		T : theory or principle underlying the invention E : earlier patent document, but published on, or after the filing date D : document cited in the application L : document cited for other reasons ..... & : member of the same patent family, corresponding document	
X : particularly relevant if taken alone Y : particularly relevant if combined with another document of the same category A : technological background O : non-written disclosure P : intermediate document			

EPO FORM 1503 03.82 (P04C01)

ANNEX TO THE EUROPEAN SEARCH REPORT  
ON EUROPEAN PATENT APPLICATION NO.

EP 10 18 1028

This annex lists the patent family members relating to the patent documents cited in the above-mentioned European search report. The members are as contained in the European Patent Office EDP file on The European Patent Office is in no way liable for these particulars which are merely given for the purpose of information.

17-03-2011

Patent document cited in search report	Publication date	Patent family member(s)	Publication date
FR 2581119	A1	31-10-1986	NONE
GB 844492	A	10-08-1960	NONE
DE 3500630	A1	18-07-1985	IT 1180251 B 23-09-1987
DE 2708785	A1	19-10-1978	NONE
EP 0872610	A2	21-10-1998	AT 271167 T 15-07-2004 CZ 9801135 A3 11-11-1998 DE 19715860 A1 29-10-1998 ES 2226019 T3 16-03-2005 HU 9800880 A1 28-12-1998 PL 325804 A1 26-10-1998
EP 1038083	A1	27-09-2000	AT 215169 T 15-04-2002 AU 1143999 A 16-06-1999 DE 69804500 D1 02-05-2002 DE 69804500 T2 21-11-2002 DK 128297 A 12-05-1999 WO 9928581 A1 10-06-1999 ES 2174504 T3 01-11-2002 PL 340597 A1 12-02-2001
GB 1086948	A	11-10-1967	NONE
FR 2281484	A1	05-03-1976	NONE