

(19)



(11)

EP 2 915 224 B1

(12)

EUROPEAN PATENT SPECIFICATION

(45) Date of publication and mention of the grant of the patent:

13.03.2024 Bulletin 2024/11

(21) Application number: **13850584.7**

(22) Date of filing: **01.11.2013**

(51) International Patent Classification (IPC):

H01R 39/64^(2006.01) A61N 1/375^(2006.01)

(52) Cooperative Patent Classification (CPC):

H01R 39/64; A61N 1/375; H01R 2201/12

(86) International application number:

PCT/US2013/067994

(87) International publication number:

WO 2014/071147 (08.05.2014 Gazette 2014/19)

(54) **ROTARY ELECTRICAL INTERCONNECT DEVICE**

ROTIERENDE ELEKTRISCHE VERBINDUNGSVORRICHTUNG

DISPOSITIF ROTATIF D'INTERCONNEXION ÉLECTRIQUE

(84) Designated Contracting States:

AL AT BE BG CH CY CZ DE DK EE ES FI FR GB GR HR HU IE IS IT LI LT LU LV MC MK MT NL NO PL PT RO RS SE SI SK SM TR

(30) Priority: **01.11.2012 US 201261721433 P**

(43) Date of publication of application:

09.09.2015 Bulletin 2015/37

(73) Proprietor: **Smiths Interconnect Americas, Inc.**

Wilmington, DE 19801 (US)

(72) Inventor: **SHINDER-LERNER, Arkady**

Framingham, Massachusetts 01701 (US)

(74) Representative: **Mathys & Squire**

**The Shard
32 London Bridge Street
London SE1 9SG (GB)**

(56) References cited:

EP-A2- 2 451 028	EP-A2- 2 515 392
EP-B1- 2 019 460	WO-A1-2011/063444
US-A- 3 297 973	US-A1- 2004 121 622
US-A1- 2005 012 420	US-A1- 2009 091 208
US-A1- 2011 210 644	US-A1- 2012 270 415

EP 2 915 224 B1

Note: Within nine months of the publication of the mention of the grant of the European patent in the European Patent Bulletin, any person may give notice to the European Patent Office of opposition to that patent, in accordance with the Implementing Regulations. Notice of opposition shall not be deemed to have been filed until the opposition fee has been paid. (Art. 99(1) European Patent Convention).

Description

CROSS REFERENCE TO RELATED APPLICATION

[0001] This application claims the benefit of U.S. Provisional Application No. 61/721,433, filed on November 1, 2012.

BACKGROUND

1. Field

[0002] The present invention relates generally to electrical connectors and improvements thereto. More particularly, the present invention relates to rotary electrical interconnect devices that are suitable for use in a catheter or in a medical device insertable in the body of a patient and are configured to maintain an electrical connection through a rotatable interface.

2. Description of the Related Art

[0003] Electrical connectors that permit one component of the connector to rotate with respect to a second component of the connector while maintaining an electrical connection between the components are used in a variety of technical fields and applications. These connections are referred to as slip rings.

[0004] Slip rings transfer electrical signals through a rotatable electrical contact using a conductive ring mounted on a rotary member. The conductive ring is in sliding contact with a conductive brush mounted to a second component of the connector. Rotating electrical connectors having various configurations based on this type of electrical contact have been developed. However, they are generally subject to drawbacks such as high complexity and manufacturing costs, low reliability and poor performance, and a lack of capacity for customization or scaling according to the requirements of a particular electronic system.

[0005] EP 251 392 discloses a process of fabricating a slip ring component. The process includes forming a first shot, forming a second shot, and immersion bathing the first shot and the second shot. The immersion bathing applies an electronically conductive plating to exposed surfaces of the second shot.

[0006] Advances in the medical field have led to an increasing variety and complexity of procedures that can be performed using devices that are inserted into the body of a patient. For example, a growing number of minimally invasive medical and surgical procedures can be performed endovascularly, laproscopically, endoscopically, or robotically using catheters, endoscopes and other insertable medical devices. These devices frequently have an electronic component requiring an electrical connection to external devices that can support a number of discrete electronic connections or circuits for transmittance of signal and power. The cables required to make

connections to devices inserted within a patient or any other remote and/or constrained space, combined with the manipulations that may be necessary in the course of performing a procedure, such as twisting or rotational movement of the remote device, can lead to twisting, kinking, jamming or similar problems with the associated electronic cabling. Therefore, a need exists for an improved rotary electrical connector suitable for use in catheters and the like that would allow for independent rotation of connected devices while providing for uninterrupted electronic signals. WO 2011/063444 discloses a catheter handle.

SUMMARY

[0007] Aspects of the invention are recited in claim 1 and preferred features are recited in the dependent claims.

[0008] A rotary electrical interconnect device utilizing components that may be modularly assembled using simple and robust mechanical connections is disclosed.

[0009] A rotary device suitable for use in a catheter or in a medical device insertable in the body of a patient is disclosed in claim 1.

[0010] In an embodiment, which is not part of the present invention, a method of assembling a rotary device is disclosed. A method of assembling a customized rotary device based on the electrical connection requirements of the electronic components to be connected may include assembling a plurality of slip ring elements, placing the plurality of slip ring elements onto a rotor shaft, securing the plurality of slip ring elements to form a rotor assembly, assembling a stator onto the rotor assembly, connecting a plurality of slide contacts to the stator such that each of the plurality of slide contacts electrically connects to each of the plurality of slip ring elements respectively, connecting a plurality of stator assembly leads to the plurality of slide contacts respectively to form a stator assembly, and covering the stator assembly with a housing.

[0011] In various embodiments, which are not part of the present invention, a method may also include determining the number of electrical channels required by the components to be connected, as well as the electrical specification requirements for each channel. A method may further include selecting a rotor assembly and a stator assembly of the appropriate sizes. A method may also include selecting components having the desired ends, such as cable sheath connection ends or connector ends. A method may further include selecting and assembling the rotor assembly components into a completed rotor assembly based on the requirements of the system to be connected, followed by installation of the rotor assembly in the stator. A method may also include assembly of the stator assembly, attachment of the connector ends, installation of the rotary device housing, and attachment of cable sheath.

BRIEF DESCRIPTION OF THE DRAWINGS

[0012] Other systems, methods, features, and advantages of the present invention will be or will become apparent to one with skill in the art upon examination of the following figures and detailed description.

[0013] Component parts shown in the drawings are not necessarily to scale, and may be exaggerated to better illustrate the important features of the present invention. In the drawings, like reference numerals designate like parts throughout the different views, wherein:

FIG. 1A is a cut-away side view of a cable-to-cable rotary device in accordance with various embodiments (cables not shown);

FIG. 1B is an exploded view of a cable-to-cable rotary device in accordance with various embodiments (cables not shown);

FIG. 2A is a cut-away side view of connector-to-connector rotary device in accordance with various embodiments;

FIG. 2B is an exploded view of a connector-to-connector rotary device in accordance with various embodiments;

FIG. 3 is an exploded view of a rotor assembly with 34 slip ring elements in accordance with various embodiments;

FIG. 4A is a perspective view of a front face of a slip ring element and a rotor assembly lead in accordance with various embodiments;

FIG. 4B is an exploded view of a front face of a slip ring element showing a terminated rotor assembly lead in accordance with various embodiments;

FIG. 4C is a perspective view of a rear face of a slip ring element showing a terminated rotor assembly lead in accordance with various embodiments;

FIG. 4D is an exploded view of a rear face of a slip ring element showing a terminated rotor assembly lead in accordance with various embodiments;

FIG. 4E is a magnified view of a front face of a slip ring element showing a terminated rotor assembly lead in accordance with various embodiments;

FIG. 4F is a magnified view of a rear face of a slip ring element showing a terminated rotor assembly lead in accordance with various embodiments;

FIG. 5 is a perspective view of a rotor assembly also showing positions of corresponding slide contacts from a stator assembly in accordance with various embodiments;

FIG. 6A is a top view of a partially assembled rotary device in accordance with various embodiments showing a row of slide contacts and terminated stator assembly leads aligned with odd-numbered slip ring elements of the device;

FIG. 6B is a cross section view of a partially assembled rotary device in accordance with various embodiments showing a terminated stator assembly lead and the position and orientation of a slide con-

tact aligned with an odd-numbered slip ring element of the device;

FIG. 6C is a bottom view of a partially assembled rotary device in accordance with various embodiments showing a row of slide contacts and terminated stator assembly leads aligned with even-numbered slip ring elements of the device;

FIG. 6D is a cross section view of a partially assembled rotary device in accordance with various embodiments showing a terminated stator assembly lead and the position and orientation of a slide contact aligned with an even-numbered slip ring element of the device;

FIG. 7 is a cut-away perspective view of a rotor assembly and stator assembly of a partially assembled rotary device showing a contact between a slide contact and a slip ring in accordance with various embodiments;

FIG. 8A is a perspective view of a stator assembly with a rotor assembly inserted in accordance with various embodiments;

FIG. 8B is a magnified view of FIG. 8A; and

FIG. 9 is a flowchart of a fabrication process in accordance with an embodiment which is not part of the present invention.

DETAILED DESCRIPTION

[0014] Referring first to FIGS. 1A-2B, cut-away side views and exploded views of rotary devices in accordance with various embodiments are shown. FIGS. 1A and 1B show a cable-to-cable rotary device **100A**, and FIGS. 2A and 2B show a connector-to-connector rotary device **100B**. Rotary devices **100A** and **100B** share various features of rotary devices in accordance with embodiments of the present disclosure that are described in greater detail below.

[0015] With continued reference to FIGS. 1A-2B, as well as to FIG. 3, a rotary device includes a rotor assembly **10**. Each rotor assembly **10** includes a rotor shaft **11**. The shaft may be formed or machined from of any of a variety of suitable materials, including both conductive and non-conductive materials, for example, metals or metal alloys, ceramics, or plastics. In various embodiments and as illustrated in FIG. 3, a rotor shaft **11** may be cylindrical with a substantially smooth or uniform surface. In other embodiments, the shaft may have features to facilitate operative connection of the shaft to other components of the rotor assembly or operative connection of the rotor assembly to the stator assembly. For example, the rotor shaft may have one or more longitudinal grooves, splines, or keys that engage a corresponding pattern in the hub of a slip ring element or other component of the rotor assembly.

[0016] Similarly, a rotor shaft may have transverse holes or grooves suitable for use with various retention devices, such as lock rings, retaining rings, snap rings, circlips, retention pins, or the like, that may be used to

retain rotor assembly components such as slip ring elements or bearings on the rotor shaft. In various embodiments and as illustrated in FIG. 3, a rotor shaft **11** may have grooves **12** located adjacent to the ends of the rotor shaft that are suitable for use with retaining rings **13** which may be used to attach or retain various other components of the rotor assembly, such as a bearing **14**. In other embodiments, one or both ends of a rotor shaft may be threaded or otherwise shaped or contoured to mechanically engage a complementary portion of a rotary device, such as by a threaded connection, press-fit, or other interference connection. Rotor shafts having any type of feature suitable for connecting or engaging any other type of rotor assembly component or rotary device component along its length or at an end are within the scope of the present disclosure.

[0017] A rotor assembly **10** also includes a rotor assembly coupler **20** connected to an end of the rotor shaft **11**. A rotor assembly coupler **20** may be substantially cylindrical in shape and define an inner cavity with a substantially open end oriented outward from the rotary device and a second end with an axial hub defining a smaller opening suitable for receiving an end of a rotor shaft **11**. A rotor assembly coupler **20** may be connected to a rotor shaft **11** using any suitable means, including, for example, a threaded, press-fit, or other interference connection. As illustrated in the rotor assembly **10** shown in FIG. 3, the rotor shaft **11** may be configured with a circumferential groove **12** adjacent an end of the shaft which is inserted into the axial hub of the rotor assembly coupler **20** and fit with a retaining ring **13** which serves to retain an end of the rotor shaft **11** in the rotor assembly coupler.

[0018] A rotor assembly coupler **20** may also include a stator interface portion **21** with an outer surface configured to fit an interior portion of the stator **51**. The stator interface portion **21** may further include an o-ring **22** or other gasket, packing, or seal to sealably engage the inner surface of a stator during rotation of the rotor assembly coupler **20** with respect to a stator **51**. Similarly, in various embodiments, the stator interface portion **21** of a rotor assembly coupler **20** may serve as a bearing such as an integral plain bearing or friction bearing and provide a surface for rotational engagement of an interior portion of the stator. In other embodiments, a rotor assembly coupler **20** or stator interface portion **21** may also include a separate bearing to facilitate rotational engagement of a rotor assembly with a stator of a rotary device. For example, a rotor assembly coupler may include a bearing, bushing, or the like that mechanically engages a portion of a stator, such as by a press-fit, providing for both axial and radial retention of a rotor assembly within a stator of a rotary device as well as facilitating smooth rotational coupling of the components of a rotary device.

[0019] A surface of rotor assembly coupler **20** oriented toward the interior of the rotary device is used to retain the slip ring elements **30** or other components of the rotor assembly on the rotor shaft **11**. The surface of the rotor assembly coupler **20** oriented toward the interior of the

rotary device may also include a feature or features that mechanically engage the adjacent slip ring elements or other rotor assembly components and prevents them from rotating about the rotor shaft **11** with respect to the rotor assembly coupler **20**. This may include one or more surface projections or depressions configured to engage a complementary feature of the adjacent rotor assembly component.

[0020] The stator interface portion **21** and an attachment portion **23** of the rotor assembly coupler **20** may be supported about an axial hub of the rotor assembly coupler by two or more support arms extending radially outwardly from the axial hub of the rotor assembly coupler. Spaces between the axial hub, the support arms, and the outer circumference of the rotor assembly coupler that align with corresponding spaces in insulator discs or other components of the rotor assembly may permit routing of rotor assembly leads **37** from the slip ring elements **30** to the interior of the rotor assembly coupler **20**. In various embodiments, the axial hub and support arms of a rotor assembly coupler may comprise the surface of the rotor assembly coupler oriented toward the interior of the rotary device or may be located near the interior end of the rotor assembly coupler.

[0021] The rotor assembly **10** includes a plurality of slip ring elements **30**. As illustrated in FIGS. 3-4D, each slip ring element **30** comprises a slip ring **31** and an insulator disc **32**. In general, each slip ring **31** is a conductive, ring-shaped structure, and each insulator disc **32** is a substantially non-conductive, disc-shaped structure that provides support for a slip ring **31** with respect to the rotor shaft **11** and also provides for electrical isolation of adjacent slip rings **31** in the rotor assembly **10**.

[0022] In accordance with various embodiments, each slip ring element of a rotary device may have substantially identical physical and electrical specifications. The modular nature of each slip ring element may facilitate assembly of rotary devices comprising a plurality of physically and electrically uniform slip ring elements, thereby providing for uniform and reliable mechanical and electrical performance of the rotary device.

[0023] In various alternative embodiments, a slip ring element may be individually provided with a particular component (i.e., a slip ring or insulator disc) or specification to produce a desired electrical performance for a particular slip ring connection within a rotary device. For example, a particular slip ring element may have a slip ring comprising a conductive material that differs from that of the slip rings of other slip ring elements of the device to provide for a particular electrical performance specification for the corresponding electrical connection. Alternatively, a particular slip ring element of a device may have a different physical specification such as an axial length of a slip ring portion, an insulator portion, or both, that spans multiple slide contact positions of a corresponding stator assembly. In accordance with various embodiments, the modular nature of the slip ring elements and the rotary devices comprising the slip ring

elements may variously provide for improved uniformity or improved capacity for customization of a rotary device.

[0024] In various embodiments, the slip rings **31** of slip ring elements **30** are made of a metal or metal alloy, for example, copper, beryllium-copper, brass, or the like. The slip rings **31** may be further treated, for example, by coating with a precious metal such as gold to enhance the conductivity and/or electrical performance of the electrical connection between the slip ring and the slide contact of the stator assembly. Similarly, the slip rings **31** may be polished or otherwise provided with physical properties or specifications that may enhance the performance of a slip ring electrical connection, such as by providing for an enhanced signal to noise ratio. The slip rings may be manufactured, for example, by cutting rings of the desired width from metal tubing having the required material and dimensional specifications. In alternative embodiments, slip rings may be comprised of conductive polymers. In still other embodiments, slip rings may be manufactured of any material that may be provided with a conductive surface, such as by thin film metal deposition using any of a variety of chemical or physical deposition techniques. Any manner of manufacturing a slip ring from any material or combination of materials to produce a slip ring suitable for conducting electrical signal between a slide contact and a conductor electrically connected to the slip ring is within the scope of the present disclosure.

[0025] The insulator disc **32** of each slip ring element **30** is a generally disc-shaped structure that is substantially non-conductive. As used herein, the terms "substantially non-conductive," "insulative," "dielectric," and variations thereof may be used interchangeably to describe a material or structure that generally does not conduct an electrical current. A substantially non-conductive structure may be constructed of material that is non-conductive, or may be constructed of a conductive material such as a metal that is rendered substantially non-conductive by treatment of the material or structure, for example, by coating a conductive structure with a non-conductive material. Substantially non-conductive materials may include materials with high resistivity, such as glass, ceramics, polymers, plastics, composites, or the like.

[0026] An insulator disc **32** comprises a slip ring portion **33** with a first outer circumference and a spacer portion **34** with a second outer circumference that is greater than the first outer circumference. The circumferential edge of the insulator disc **32** in such an embodiment has a "stepped" appearance from a profile perspective (i.e., a two-level outer circumference profile) due to the different diameters of slip ring portion **33** and spacer portion **34** of the insulator disc. The insulator disc **32** may be substantially cylindrical in shape (i.e., generally having the shape of a right cylinder), for example, having a slip ring portion side (i.e., front face) and a spacer portion side (i.e., rear face) of the insulator disc that are both generally flat, with the exception of certain features that are described in greater detail herein. In alternative embodi-

ments, the insulator discs may have shapes or profiles that depart from a generally cylindrical shape and may have, for example, a domed, conical, or irregular shape, while still having a substantially circular cross section coaxial to the rotor shaft **11** and a two-level outer circumference including a slip ring portion **33** and a spacer portion **34**, as described above. Any of a variety of insulator disc shapes or profiles is possible and included within the scope of the present disclosure.

[0027] The slip ring portion **33** and the spacer portion **34** of the insulator disc are radially supported about an axial hub **35** by two or more radial arms **36**. Referring now to FIGS. 4A-4F, various views of a slip ring element **30** are shown, illustrating an insulator disc **32** having with three radial arms **36** extending from the hub **35** to the slip ring portion **33** and spacer portion **34**. Spaces **40** between the hub **35**, the radial arms **36**, and the slip ring portion/spacer portion **33/34** permit rotor assembly leads **37** to be run from each slip ring **31** to the rotor assembly coupler **20**, thereby facilitating electrical connection of each slip ring with the rotor assembly end of a rotary device. An opening at the axis of the hub **35** of each insulator disc **32** is configured to receive the rotor shaft **11**.

[0028] An insulator disc **32** may further include various features that facilitate termination of a rotor assembly lead **37** and electrical connection of the rotor assembly lead to the slip ring **31** of each slip ring element **30**. In various embodiments and as shown in FIG. 4F, an insulator disc **32** may include a channel **41** in the spacer portion-side surface (i.e., the rear face) of the insulator disc extending from a space **40** to a terminal penetration **42** through the spacer portion **34**. A channel **41** may be of a suitable width, depth, and configuration to receive an insulated portion of a rotor assembly lead **37** and to mechanically retain the rotor assembly lead **37**, such as by a press-fit interface (i.e., an interference fit or friction fit). A terminal penetration **42** through the spacer portion **34** is configured to permit an uninsulated terminal **38** of a rotor assembly lead **37** to pass through the spacer portion **34** of an insulator disc **32** and contact a slip ring **31**. In an assembled slip ring element **30**, the terminal **38** of the rotor assembly lead **37** is located between the first outer circumference of the slip ring portion **33** of the insulator disc **32** and the inner surface of the slip ring **31**. An insulator disc may further include an arcuate deflection channel **43** located radially inward relative to the first outer circumference of the slip ring portion **33** and the terminal penetration **42**. A deflection channel **43** permits the portion of the insulator disc located between the first outer circumference and the deflection channel **43** to elastically or resiliently flex or deflect to accommodate a terminal **38** of a rotor assembly lead **37** beneath a slip ring **31** while exerting sufficient constant pressure on the terminal **38** to maintain the terminal in fixed, electrical contact with the slip ring **31**. Explained another way, the terminal **38** of a rotor assembly lead **37** is electrically connected to the slip ring **31** by a press-fit of the slip ring over the

first outer circumference of the insulator disc, with the terminal **38** mechanically fixed between the slip ring and the insulator disc by compression of the terminal between the slip ring **31** and the first outer circumference of the insulator disc **32**. In various embodiments, the first outer circumference of an insulator disc may further include a depressed region to accommodate a terminal **38** of a rotor assembly lead **37** beneath a slip ring **31**.

[0029] Other features or configurations for mechanically fixing a terminal of a rotor assembly lead in electrical contact with a slip ring are possible in alternative embodiments. For example, the first outer circumference of an insulator disc may include an axial groove of suitable dimensions for receiving a terminal and maintaining it in electrical contact with a slip ring, rather than a deflection channel or a depressed region. In another example, an insulator disc may include channels, grooves, or penetrations that permit routing of the terminal of a rotor assembly lead transverse to the axis of the rotor assembly (i.e., parallel to or concentric with the circumference of the slip ring). Any configuration of an insulator disc that permits routing and securing of a portion of a rotor assembly lead and/or terminal with respect to the insulator disc and slip ring and that places the terminal in electrical contact with the slip ring is within the scope of the present disclosure.

[0030] Insulator discs may also include structures or features that permit an insulator disc to operatively engage an adjacent surface. In accordance with various embodiments and as illustrated in FIGS. 4A-4D, an insulator disc may have projections **44** extending from a face of the insulator disc such as the front face of an insulator disc **32**. The projections **44** may be configured to engage an adjacent component of the rotor assembly by fitting within corresponding recesses **45** in the adjacent component, such as the rear face of another insulator disc **32** or a surface of the rotor assembly coupler. For example, the projections **44** and corresponding recesses may interface by a press-fit or a snap-fit connection. Projections **44** and corresponding recesses in an adjacent component may be configured such that an insulator disc **32** is torsionally fixed with respect to the adjacent component. In this manner, a plurality of slip ring elements may be assembled to form a substantially torsionally fixed rotor assembly.

[0031] In various embodiments, insulator discs may be formed or manufactured with a unitary construction. For example, insulator discs may be molded from a non-conductive thermoplastic resin. In alternative embodiments, each insulator disc may be comprised of multiple, separate components that are joined to form an insulator disc. For example, each insulator disc may be comprised of a slip ring portion that is separate from the spacer portion. In such an embodiment, separate components of an insulator disc may be permanently joined, or may be modularly assembled using features such as the projections and recesses described above.

[0032] Slip ring elements are assembled into a rotor

assembly **10** by sliding the slip ring elements **30** onto a rotor shaft **11**. In the embodiments illustrated in FIGS. 3-4D, each hub **35** has a circular opening at its axis, and the rotor shaft **11** has a circular cross section. The opening at the axis of each hub **35** may be sized such that the opening is complementary to the diameter of rotor shaft **11** and the insulator discs slide on freely (i.e., a loose or light interference fit). In other embodiments, the opening may be undersized with respect to the diameter of rotor shaft **11**, such that the insulator discs **32** are press-fit onto the rotor shaft **11** to provide an interference fit with a suitable strength of fit to provide resistance to axial and torsional movement of the insulator disc relative to the rotor shaft following installation of the insulator disc on the rotor shaft. In yet other embodiments, the hub of an insulator disc and the rotor shaft may have other cross sectional profiles, such as parallel keyed configurations or the like, that provide a hub joint with resistance to torsional movement of an insulator disc about the rotor shaft while still permitting modular assembly of slip ring elements on the rotor shaft.

[0033] In various embodiments, the axial lengths of the slip ring elements or portions thereof in a rotor assembly may vary. For example, the rotary devices **100A** and **100B** illustrated in FIGS. 1A-2B each comprise 34 uniform slip ring connections. However, a rotary device including various components of the illustrated devices, such as a stator **51**, a rotor shaft **11** and rotor assembly coupler **20**, and housing components, may be configured to have a variety of numbers and configurations of electrical connections by varying the configuration of the slip ring elements and the slide contacts.

[0034] For example, and with reference to FIG. 4A, insulator discs with varying axial lengths (i.e., thicknesses) of the spacer portion **34** may be used to provide the necessary electrical resistance between adjacent slip rings **31**. Varying axial lengths of a spacer portion **34** of a slip ring element **30** may be produced by using multi-component insulator discs having multiple, separate spacer portions, or by using insulator discs having a unitary construction and a range of available sizes with respect to the axial length of the spacer portion **34**.

[0035] Similarly, insulator discs with varying axial lengths of the slip ring portion **33** may be used in a rotor assembly. For example, an insulator disc with an extended slip ring portion **33** may be provided to accommodate longer slip rings **31** that could be used to make electrical contact with more than one slide contact to accommodate greater electrical current through the slip ring. Varying axial lengths of a slip ring portion **33** of a slip ring element **30** may be produced in a manner similar to that described above with respect to the spacer portion. For example, an elongated slip ring portion of a slip ring element may comprise three separate slip ring portion components, each separately sliding on to rotor shaft **11** and each receiving a rotor assembly lead **37**, with an elongated slip ring fitting over the three slip ring portion components and rotor assembly leads and making contact with as

many as three rotor assembly lead terminals **38** in this example. In this manner, a rotor assembly of the present disclosure may be modularly or scalably configured, and a rotary device having a variety of electrical connection configurations may be achieved using various combinations of components that can be modularly assembled.

[0036] A rotary device in accordance with various embodiments of the present disclosure and as illustrated in FIGS. 1A-2B includes a stator assembly **50**. The stator assembly **50** comprises a stator **51**, a plurality of slide contacts **52**, and a plurality of stator assembly leads **53**. The stator **51** is cylindrically shaped and defines a cavity configured to receive a rotor assembly **10**.

[0037] In various embodiments, the stator **51** of a stator assembly **50** is substantially non-conductive. A stator **51** may be formed or machined from of any of a variety of suitable materials, including both conductive and non-conductive materials, for example, metals or metal alloys, ceramics, or plastics. A stator **51** constructed from a conductive material may be rendered substantially non-conductive by coating or otherwise treating it with a non-conductive material.

[0038] A stator **51** may have various features to facilitate operative connection of the rotor shaft **11**. For example, the cavity of a stator **51** may include a bearing configured to receive an end of a rotor shaft **11** and provide for rotation of the rotor assembly **10** within the stator **51**. The interior surface of the cavity of the stator **51** may also have dimensions or features that permit operational engagement of rotor assembly **10**. For example, the cavity of stator **51** may be configured to receive a bearing or bearings located at one or both ends of the rotor assembly **10**, such as by a press-fit connection, thereby providing for axial and radial retention of the rotor assembly **10**, with the bearing or bearings providing for rotation of the rotor assembly within the stator. Likewise, the interior surface of the cavity of a stator may be configured to engage one or more o-rings or other gaskets, seals, or packings such that the interior of the rotary device is protected from external fluids or contaminants throughout dynamic interaction (i.e., rotation) of the rotor assembly with respect to the stator. Alternatively, the interior surface of the cavity of a stator may be configured o-rings or other seals. Any of a variety of configurations of a stator and a rotor assembly that facilitate retention and rotation of the rotor assembly **10** within the stator **51**, along with sealing of the slip ring connections within the rotary device and protection of the slip ring connections from environmental conditions external to the rotary device, are within the scope of the present disclosure.

[0039] A stator **51** also includes features for electrically connecting components of the stator assembly **50** to the slip rings **31** of each slip ring element in the rotor assembly. With reference now also to FIGS. 7 and 8, a stator **51** may include slide contact penetrations **54** for insertion of each slide contact **52**. A stator **51** also includes grooves or channels **55** along the exterior surface of the stator for routing of the stator assembly leads **53** from the end of

the stator to each slide contact **52** and for mechanically and electrically connecting a stator lead terminal **56** of each stator assembly lead **53** to each slide contact **52**. Similarly, portions of the exterior surface of a stator **51** may be configured with a relieved region or a decreased diameter to accommodate parallel routing of a plurality of stator assembly leads **53** within a stator housing **61**.

[0040] The channels **55** in a stator **51** are oriented along circumferential arcs of the outer surface of the stator and provide for retention of the stator assembly leads **53** and alignment of the stator lead terminals **56** with the slide contacts **52** and with the slip rings **31** of the rotor assembly **10**. In the embodiment shown in FIG. 8, the lengths of the channels **55** are progressively longer from the stator end of the stator **51** to the rotor end by a distance approximately equal to the distance between every other slip ring of the rotor assembly. Such a configuration permits orderly parallel routing of stator assembly leads that terminate at a row of slide contacts running parallel to the axis of the rotary device.

[0041] The stator assemblies **50** illustrated in FIGS. 1B and 2B each include two rows of slide contacts oriented substantially perpendicularly to the axis of the rotary device and on opposite sides of stator **51**, with the slide contacts **52** in each row aligning with every other slip ring **31** in the rotor assembly **10**. This arrangement of the slide contacts **52** with respect to the slip ring elements of a rotor assembly in accordance with various embodiments is illustrated in greater detail in FIGS. 5-6D. FIG. 5 shows a perspective view of a rotor assembly in accordance with various embodiments and the relative positions of slide contacts **52** arranged in two rows on opposite sides of the rotor assembly with the stator removed for purposes of illustration. FIGS. 6A-6D illustrate a partially assembled rotary device in accordance with various embodiments showing two rows of slide contacts **52** on opposite sides of the stator, with the top view (FIG. 6A) showing slide contacts aligned with odd-numbered slip ring element positions and the bottom view (FIG. 6C) showing slide contacts aligned with even-numbered slip ring element positions of the rotary device. FIGS. 6B and 6D illustrate representative cross-section views of a rotary device at an odd-numbered slip ring element position and an even-numbered slip ring element position, respectively, to show the relative position and orientation of a slide contact **52** and a slip ring **31**. Such an even radial and axial distribution of slide contacts within a rotary device may provide for a symmetrical or balanced distribution of frictional and/or pressure forces between the stator assembly and the rotor assembly. However, stators having any number of rows of slide contacts distributed symmetrically or asymmetrically about the circumference of the stator and having slide contacts aligned with slip rings in any possible sequence are within the scope of the present disclosure. Likewise, stators having slide contacts arranged in other patterns, such as spirals or other non-linear patterns, are also within the scope of the present disclosure.

[0042] Referring again to FIGS. 7-8, a portion of each stator assembly lead **53** adjacent to the stator lead terminal **56** of the lead and fitting in channel **55** may be mechanically fixed in the channel **55** using an interference fit such as a series of alternating projections **57** in the side wall of each channel. The stator lead terminal **56** of each stator assembly lead **53** may be likewise mechanically secured by and electrically connected to a slide contact **52** by insertion of the slide contact into a slide contact penetration **54** in the wall of the stator **51**. A fixed end of each slide contact is press-fit into a slide contact penetration **54** and retained in position by an interference fit. The fixed end of each slide contact **52** retains the stator lead terminal **56** between a bend or curve of the fixed end of the slide contact and a portion of the exterior surface of the stator. In other embodiments, each stator lead terminal **56** may further be press-fit into a channel approximating the size of the terminal.

[0043] A free end of each slide contact **52** extends into the cavity of stator **51** and makes contact with a slip ring **31**, as shown in FIG. 7. The slide contacts **52** may be biased to maintain mechanical contact and an electrical connection with the slip rings **31** by the orientation of the slide contact penetrations **54** and/or the configuration of the slide contacts **52**. For example, the slide contacts **52** may be configured so that they are resiliently biased toward the slip rings **31** after installation in the stator **51**. The slide contacts are constructed of a conductive material and may be formed, for example, of a wire bent or formed to a suitable configuration or by cutting, stamping, or etching from a sheet of material. The free end of the slide contact is substantially straight, contacting a slip ring tangentially as illustrated in FIG. 7, or the free end of each slide contact may have an arc or bend that corresponds to a portion of the circumference of a slip ring and increases the contact area between the slip ring and the slide contact.

[0044] A rotary device includes a housing configured to cover or encase the device. A housing may be configured to protect the rotary device and the electrical connections therein from the external environment. A housing is generally non-conductive, and may be constructed of a material that is substantially non-conductive or may be constructed of a conductive material that is treated to render the housing substantially non-conductive. Referring again to FIGS. 1A-2B, a housing comprises of one or more components, such as a stator housing **61** and a rotor assembly coupler overmold **62**. In alternative embodiments, a portion of a rotary device or rotary device component, such as a portion of an external surface of a rotor assembly coupler, may comprise a portion of the external surface of the finished device without being further covered by or encased in a housing component such as a rotor assembly coupler overmold.

[0045] In various embodiments, a stator housing **61** may be constructed as a unitary piece, as illustrated in FIGS. 1A and 1B, and configured to receive a stator assembly **50** and to retain the stator assembly by a threaded connection, press-fit, snap-fit, or other interference fitting

of the stator housing over the stator assembly. In other embodiments and as illustrated in FIGS. 2A and 2B, a stator housing **61** may comprise multiple pieces that are fit together over a stator assembly **50** and joined by any of a variety of suitable means, such as by a snap-fit, adhesive connection, welded connection, or the like. The stator **51** and/or stator housing **61** may further include one or more o-rings **58** or other gaskets, seals, or packings to provide a seal between the stator assembly and the stator housing at one or both ends of the stator and to prevent external fluids or other contaminants from contacting the stator assembly. In various embodiments, a stator housing **61** may also provide for further retention of the slide contacts **52** in the slide contact penetrations **54** of the stator and help to maintain mechanical and electrical contact of the fixed end of the slide contacts with the stator lead terminals **56**.

[0046] Similarly, rotor assembly coupler **20** of rotor assembly **10** may be encased by a rotor assembly coupler overmold **62**. A rotor assembly coupler overmold **62** may be configured and attached to the rotor assembly coupler **20** or to the attachment portion **23** of a rotor assembly coupler in a manner similar to that described above for a stator housing **61**.

[0047] A stator housing **61** may be configured for attachment to a sheath, housing, or other external protective covering of a multi-conductor electrical cable. For example, and as illustrated in the cable-to-cable rotary device **100A** shown in FIGS. 1A and 1B, a stator housing **61** may terminate in a male press-fit cable sheath connection **63** resembling a hose barb fitting over which a cable sheath (not shown) may be fit to provide a sealed connection between the rotary device **100A** and an electrical cable to a remote device. Likewise, the rotor assembly coupler overmold **62**, rotor assembly coupler **20**, or attachment portion **23** of a rotor assembly coupler may be similarly configured to accept an electrical cable sheath (not shown). In the illustrated rotary device **100A**, rotor assembly coupler **20** is configured to receive a cable within the cavity of the rotor assembly coupler.

[0048] In cable-to-cable rotary device embodiments, wire leads from the rotary device extend outward from the device to remote devices, connectors, or other components. For example, rotor assembly wire leads **37** may extend outwardly from the rotor end of the cable-to-cable rotary device **100A** through an attached cable sheath (not shown) to a first remote electronic device. Likewise, stator assembly leads **53** may extend outwardly from the stator assembly end of the rotary device **100A** through an attached cable sheath (not shown) to a second remote electronic device. In this manner, rotary device **100A** can permit a first remote electronic device and a second remote electronic device to be rotated freely with respect to one another without twisting or binding of the connecting cable while maintaining a continuous electrical connection across multiple electrical channels.

[0049] In various embodiments, a rotary device may include connectors (i.e., male plug connectors, female

socket or receptacle connectors, or any type of device for providing an interface between electrical circuits using a mechanical assembly) at one or both ends of the rotary device for making electrical connections between the rotary device and remote electrical devices. For example, and as illustrated in FIGS. 2A and 2B, a connector-to-connector rotary device **100B** may comprise a male plug connector **71** on the stator end of the rotary device and a female connector **72** on the rotor end of the rotary device. The connectors may be configured to support multiple discrete electrical channels that may be electrically connected to the rotor assembly leads (not shown) for a connector at the rotor end or to the stator assembly leads **53** at the stator end. In accordance with various embodiments, connectors may be selected or configured to provide for resistance to entry of fluid or other external contaminants and be suitable for use, for example, intraluminally or intravascularly. A first remote electronic device may be connected to the male plug connector **71** of rotary device **100B**, and a second remote electronic device may be connected to the female connector **72** using corresponding mateable connectors. In this manner, rotary device **100B** can permit a first remote electronic device and a second remote electronic device to be rotated freely with respect to one another without twisting or binding of the of the connecting cable while maintaining a continuous electrical connection across multiple channels.

[0050] In accordance with various embodiments, any type of connector that permits parallel conduction of separate electrical channels through the connector, such as a multi-pin connector, may be used. A wide variety of connectors are known to persons of ordinary skill in the art, including such connectors as are described and illustrated in U.S. Patent numbers 7,326,091, 7,661,995, 7,938,670, D596,127, D615,932, and D616,825.

[0051] Likewise, the illustrated rotary device configuration shown in FIGS. 1B and 2B having a male plug connector at one end and a female connector at the other end of the rotary device is for purposes of illustration only. In accordance with various embodiments, any type of connector or combination of connectors may be used at the ends of a rotary device without limitation to any particular combination of connector gender or type. Likewise, a rotary device may have a connector at one end and a cable connection at the other end. Rotary devices having any of the range of possible permutations of the various end configurations described above are within the scope of the present disclosure.

[0052] In a rotary device comprising one or more connectors, either the rotor assembly leads **37**, or the stator assembly leads **53**, or both, may terminate at and electrically connect to the connectors at the respective ends of the device in any suitable manner. Likewise, the connectors may be connected to the rotor assembly coupler **20** or the end of the stator **51** opposite the rotor assembly coupler **20** using any suitable means, for example, a press-fit, threaded fit, bayonet connector, or any other interference, welded, brazed, or adhesive fit. The inter-

face between the stator **51** or rotor assembly coupler **20** and a connector may be configured such that mechanical attachment of the connector simultaneously provides for electrical connection of the stator assembly leads **53** or the rotor assembly leads **37** to the attached connector. In other embodiments, electrical connection of the leads to a connector may be made separately from attachment of the connector to the stator assembly end or rotor assembly coupler using any suitable means, either before or after attachment of the connector to the stator assembly end or the rotor assembly coupler.

[0053] The rotary device is suitable for use in a medical device. For example, a rotary device as disclosed herein may be used to electrically connect a first remote electronic device that may be deployed in the body of a human patient to a second remote electronic device that may remain outside of the body of the human patient. Various medical devices, such as an electronic instrument, apparatus, or implant deployed within a body lumen or cavity may require rotation during insertion or operation while attached to an external electronic device such as a power source, monitor, data recorder, or computer by an electrical cable. In such a scenario, the ability to freely rotate the first remote electronic device while continuously maintaining an electrical connection with the external electronic device and without twisting, kinking, binding or jamming of the connecting electrical cable due to rotation of the first electronic device during a medical procedure is desirable.

[0054] Rotary devices disclosed herein are suitable for use in medical facility such as a hospital or operating room or other patient care or diagnostic facility. For example, a rotary device may be compatible with the electronic performance requirements of any type of electronic device, including any type of medical electronic device, with respect to specifications such as current, voltage, impedance, and signal to noise ratio. A rotary device in accordance with various embodiments may be configured with components having specifications suitable for low voltage/low amperage current and signal transmission with low noise and high signal quality. Similarly, a rotary device may provide the physical performance specifications required in various medical settings, including, for example, resistance to entry of water or other fluids and the ability to meet regulatory requirements for single use and/or reusable devices with regard to cleanliness or sterilization. The rotary devices disclosed herein may also provide an ability to meet other physical requirements associated with medical device applications such as small size and biocompatibility.

[0055] In accordance with an embodiment, which is not part of the present invention, a method of assembling a customized rotary device based on the electrical connection requirements of the components to be connected is provided. A method of assembling a customized rotary device may comprise steps of determining the number of electrical channels required by the components to be connected, as well as determining the electrical specifi-

cation requirements for each channel. A method may further include selecting a rotor and stator assembly of the appropriate size, including the appropriate length and diameter. Likewise, the method may comprise selecting a rotor and stator assembly having the desired ends, such as cable ends or connector ends, based on the manner in which the rotary device will be attached to the remote components of the system. The connector ends or cables may be attached to the rotor and stator as described above. A method may further comprise attaching connectors to the electrical cables of the components to be connected, wherein the connectors correspond to or are compatible with connectors of the rotary device or connectors that may be located at the remote ends of cables extending from the rotary device.

[0056] Following determination of the number of electrical channels and selection of the rotor assembly and stator assembly components, the rotor assembly may be assembled. FIG. 9 presents a flowchart **900** of a method of assembling a rotary device, such as the rotary devices **100A** and **100B**. At **910**, slip ring elements are assembled, such as the slip ring **31**. At **920**, slip ring elements are placed onto a rotor shaft, such as the rotor shaft **11**. Slip ring elements may be added to the rotor shaft and connected to a rotor assembly lead as disclosed herein. The number and configuration of the slip ring elements, including the axial length (i.e., thickness) of the spacer portion and/or the axial length of the slip ring may be varied or selected based on the electrical performance requirements of the system connected by the rotary device. For example, an insulator disc with an increased axial length of the spacer portion may be selected to provide greater isolation of adjacent slip rings that may carry greater current or power. Similarly, longer slip rings may be selected and installed in connection to multiple rotor assembly leads and making contact with multiple slide contact such that the same electrical signal is carried by multiple parallel leads in the connected system. At **930**, slip ring elements are secured to form a rotor assembly, such as the rotor assembly **10**. As each slip ring element is added, rotor assembly leads are routed through the spaces in the insulator discs and the terminals are connected to the insulator disc and the slip rings as described above. Portions of the length of the rotor assembly that are not required for making an electrical connection may be occupied by installing a spacer element of the appropriate length on the rotor assembly.

[0057] Following assembly of the rotor assembly, a stator, such as the stator **51**, is assembled. At **940**, the stator is assembled onto the rotor assembly. At **950**, slide contacts, such as the slide contacts **52**, are connected to the stator to electrically connect to the slip ring elements. At **960**, stator assembly leads, such as the stator assembly leads **53**, are connected to the slide contacts to form the stator assembly, such as the stator assembly **50**. Stator assembly leads are routed along the outer portion of the stator and fixed in channels, and slide contacts are inserted into slide contact penetrations to mechanically se-

cure and electrically connect the stator assembly lead terminals to the slide contacts. Slide contacts are inserted in positions in the stator corresponding to the appropriate slip rings of the rotor assembly and in the desired row, for example, to maintain a symmetrically balanced distribution of slide contacts about the rotor assembly.

[0058] At **970**, the stator assembly is covered with a housing or overmold, such as the overmold **62**. Following insertion of the slide contacts and routing and connection of the stator assembly leads, the stator housing and the rotor assembly coupler overmold may be attached to the rotary device. In various embodiments, the assembled rotary device may be packaged and sold in various configurations of cable-to-cable rotary devices, connector-to-connector rotary devices, or connector-to-cable rotary devices for installation in an electronic system by an end user or third party. In other embodiments, a rotary device may be connected to or installed in an electronic system, for example, by the rotary device manufacturer or assembler.

[0059] Rotary devices in accordance with various embodiments as described herein and methods of assembling the same may provide various benefits such as modularity and scalability that facilitate their application or use in a variety of systems and environments, as well as providing further benefits such as improved simplicity, reliability, and ease of manufacturing and assembly with respect to prior art devices and methods.

[0060] As used herein, the terms "rotor" and "stator" are applied for the sake of clarity and convenience with respect to components of the rotary devices described herein that are coupled in a rotationally operative manner. The term "stator" as used in the present disclosure is not limited to a fixed or non-moving portion of a rotary device. Rather, both the stator assembly and the rotor assembly of a rotary device as disclosed herein may rotate with respect to an external point of reference as well as with respect to each other.

[0061] As used herein, the term "remote" is used to refer to a device or connection that is located external to a rotary device at any distance from a rotary device.

[0062] Although the various rotary devices illustrated and described herein are shown as having various combinations of cable ends, male connector ends, or female connector ends, rotary devices having any suitable combination of cable and/or connector end, along with any combination of type or gender of connector end, are within the scope of the present invention as disclosed in the appended claim.

Claims

1. A rotary device (100A) suitable for use in a catheter or in a medical device insertable in the body of a patient, comprising:

a rotor assembly (10) comprising:

a rotor shaft (11) configured to rotate around a longitudinal axis;
 a rotor assembly coupler (20);
 a plurality of rotor assembly leads (37);
 a plurality of slip ring elements (30), each slip ring element (30) comprising:

a slip ring (31), and
 an insulator disc (32) configured to provide support for the slip ring (31) with respect to the rotor shaft (11),
 each insulator disc (32) having:

a slip ring portion (33) with a first outer circumference,
 a spacer portion (34) with a second outer circumference greater than the first outer circumference, and
 a hub (35) configured to receive the rotor shaft (11) and connected to the slip ring portion and the spacer portion by at least two support arms (36),

the plurality of slip ring elements (30) being positioned on the rotor shaft (11), positioned axially adjacent to each other, each of the plurality of slip rings (31) being electrically connected to at least one of the plurality of rotor assembly leads (37), each insulator disc (32) being further configured to provide for electrical isolation of adjacent slip rings (31) in the rotor assembly (10);

a stator assembly (50) configured to rotationally engage the rotor assembly coupler and comprising:

a stator (51) including one or more grooves or channels (55) oriented along a circumferential arc of an outer surface of the stator (51), and said stator (51) having a cavity that is configured to receive the rotor assembly;
 a plurality of stator assembly leads (53);
 a plurality of slide contacts (52), each slide contact being mechanically connected to the stator (51), the plurality of slide contacts (52) being electrically connected to at least one of the plurality of stator assembly leads (53) and at least one of the plurality of slip rings (31),
 the plurality of stator assembly leads (53) being routed from an end of the stator (51) to respective slide contacts (52) in the one or more grooves or channels (55) and being configured to electrically connect to a respective slide contact (52) of the plurality of

slide contacts (52); and
 a housing having a stator housing (61) and a rotor assembly coupler overmold (62), wherein the housing is configured to cover the rotary device.

2. The rotary device (100A) of claim 1, wherein a space (40) is defined by each of the plurality of insulator discs (32) between the hub (35), the at least two support arms (36), and the spacer portion (34) or the slip ring portion (33).
3. The rotary device (100A) of claim 1, wherein the stator (51) defines slide contact penetrations (54), wherein a slide contact of the plurality of slide contacts (52) is inserted into the slide contact penetration (54) and retained in position by an interference fit with the slide contact penetration (54).

Patentansprüche

1. Eine rotierende Vorrichtung (100A), die für die Verwendung in einem Katheter oder in einer medizinischen Vorrichtung, die in Körper eines einführbar sind, geeignet ist, umfassend:
 eine Rotoranordnung (10), umfassend:

eine Rotorwelle (11), die dazu konfiguriert ist, um eine Längsachse zu rotieren;
 einen Rotoranordnungskoppler (20);
 eine Vielzahl von Rotoranordnungsleitungen (37);
 eine Vielzahl von Schleifringelementen (30), wobei jedes Schleifringelement (30) Folgendes umfasst:

einen Schleifring (31), und
 eine Isolatorscheibe (32), die dazu konfiguriert ist, eine Stütze für den Schleifring (31) in Bezug auf die Rotorwelle (11) bereitzustellen,
 wobei jede Isolatorscheibe (32) Folgendes aufweist:

einen Schleifringabschnitt (33) mit einem ersten Außenumfang,
 einen Abstandshalterabschnitt (34) mit einem zweiten Außenumfang, der größer als der erste Außenumfang ist, und eine Nabe (35), die dazu konfiguriert ist, die Rotorwelle (11) aufzunehmen, und mit dem Schleifringabschnitt und dem Abstandshalterabschnitt durch mindestens zwei Stützarme (36) verbunden ist,

wobei die Vielzahl von Schleifringelementen

(30) auf der Rotorwelle (11) positioniert sind, die axial zueinander benachbart positioniert sind, wobei jeder der Vielzahl von Schleifringen (31) mit mindestens einer der Vielzahl von Rotoranordnungsleitungen (37) elektrisch verbunden ist, wobei jede Isolatorscheibe (32) ferner dazu konfiguriert ist, benachbarten Schleifringen (31) in der Rotoranordnung (10) eine elektrische Isolation bereitzustellen; eine Statoranordnung (50), die dazu konfiguriert ist, den Rotoranordnungskoppler rotierend in Eingriff zu nehmen, und Folgendes umfasst:

einen Stator (51), der eine/einen oder mehrere Nuten oder Kanäle (55) beinhaltet, die entlang eines Umfangsbogens einer Außenoberfläche des Stators (51) orientiert sind, und wobei der genannte Stator (51) einen Hohlraum aufweist, der dazu konfiguriert ist, die Rotoranordnung aufzunehmen; eine Vielzahl von Statoranordnungsleitungen (53); eine Vielzahl von Gleitkontakten (52), wobei jeder Gleitkontakt mit dem Stator (51) mechanisch verbunden ist, wobei die Vielzahl von Gleitkontakten (52) mit mindestens einer der Vielzahl von Statoranordnungsleitungen (53) und mit mindestens einem der Vielzahl von Schleifringen (31) elektrisch verbunden sind, wobei die Vielzahl von Statoranordnungsleitungen (53) von einem Ende des Stators (51) zu jeweiligen Gleitkontakten (52) in der einen/dem einen oder den mehreren Nuten oder Kanälen (55) geführt sind und dazu konfiguriert sind, mit einem jeweiligen Gleitkontakt (52) der Vielzahl von Gleitkontakten (52) verbunden zu werden; und ein Gehäuse, das ein Statorgehäuse (61) und eine Rotoranordnungskopplerumspritzung (62) aufweist, wobei das Gehäuse dazu konfiguriert ist, die rotierende Vorrichtung abzudecken.

2. Die rotierende Vorrichtung (100A) nach Anspruch 1, wobei durch jede der Vielzahl von Isolatorscheiben (32) zwischen der Nabe (35), den mindestens zwei Stützarmen (36) und dem Abstandshalterabschnitt (34) oder dem Schleifringabschnitt (33) ein Raum (40) definiert wird.
3. Die rotierende Vorrichtung (100A) nach Anspruch 1, wobei der Stator (51) Gleitkontaktdurchdringungen (54) definiert, wobei ein Gleitkontakt der Vielzahl von Gleitkontakten (52) in die Gleitkontaktdurchdringung (54) eingeführt ist und durch eine Presspassung mit der Gleitkontaktdurchdringung (54) in Position gehalten

wird.

Revendications

1. Dispositif rotatif (100A) approprié pour être utilisé dans un cathéter ou dans un dispositif médical insérable dans le corps d'un patient, comprenant : un ensemble rotor (10) comprenant :

un arbre de rotor (11) conçu pour tourner autour d'un axe longitudinal ;
un coupleur d'ensemble rotor (20) ;
une pluralité de fils d'ensemble rotor (37) ;
une pluralité d'éléments de bague collectrice (30), chaque élément de bague collectrice (30) comprenant :

une bague collectrice (31), et
un disque isolant (32) configuré pour fournir un support à la bague collectrice (31) par rapport à l'arbre de rotor (11),
chaque disque isolant (32) comportant :

une partie bague collectrice (33) avec une première circonférence externe,
une partie entretoise (34) ayant une seconde circonférence externe supérieure à la première circonférence externe,
et
un moyeu (35) conçu pour recevoir l'arbre de rotor (11) et relié à la partie bague collectrice et à la partie entretoise par au moins deux bras de support (36),

la pluralité d'éléments de bague collectrice (30) étant positionnés sur l'arbre de rotor (11), positionnés axialement adjacents les uns aux autres,
chacune de la pluralité de bagues collectrices (31) étant reliée électriquement à au moins l'un de la pluralité de fils d'ensemble rotor (37), chaque disque isolant (32) étant en outre conçu pour assurer l'isolation électrique des bagues collectrices adjacentes (31) dans l'ensemble rotor (10) ;
un ensemble stator (50) conçu pour engager en rotation le coupleur d'ensemble rotor et comprenant :

un stator (51) incluant une ou plusieurs rainures ou canaux (55) orienté(e)s le long d'un arc circonférentiel d'une surface externe du stator (51), et ledit stator (51) ayant une cavité qui est conçue pour recevoir l'ensemble rotor ;
une pluralité de fils d'ensemble stator (53) ;
une pluralité de contacts glissants (52), cha-

- que contact glissant étant relié mécaniquement au stator (51), la pluralité de contacts glissants (52) étant reliés électriquement à au moins l'un de la pluralité de fils d'ensemble stator (53) et à au moins l'une de la pluralité de bagues collectrices (31), la pluralité de fils d'ensemble stator (53) étant acheminés depuis une extrémité du stator (51) vers des contacts glissants respectifs (52) dans la ou les rainures ou canaux (55) et étant conçus pour se connecter électriquement à un contact glissant respectif (52) de la pluralité de contacts glissants (52) ; et un boîtier comportant un boîtier de stator (61) et un surmoulage de coupleur d'ensemble rotor (62), dans lequel le boîtier est conçu pour recouvrir le dispositif rotatif.
2. Dispositif rotatif (100A) selon la revendication 1, dans lequel un espace (40) est défini par chacun de la pluralité de disques isolants (32) entre le moyeu (35), les au moins deux bras de support (36), et la partie entretoise (34) ou la partie bague collectrice (33).
3. Dispositif rotatif (100A) selon la revendication 1, dans lequel le stator (51) définit des pénétrations de contact glissant (54), dans lequel un contact glissant de la pluralité de contacts glissants (52) est inséré dans la pénétration de contact glissant (54) et maintenu en place par un ajustement serré avec la pénétration de contact glissant (54).

5

10

15

20

25

30

35

40

45

50

55

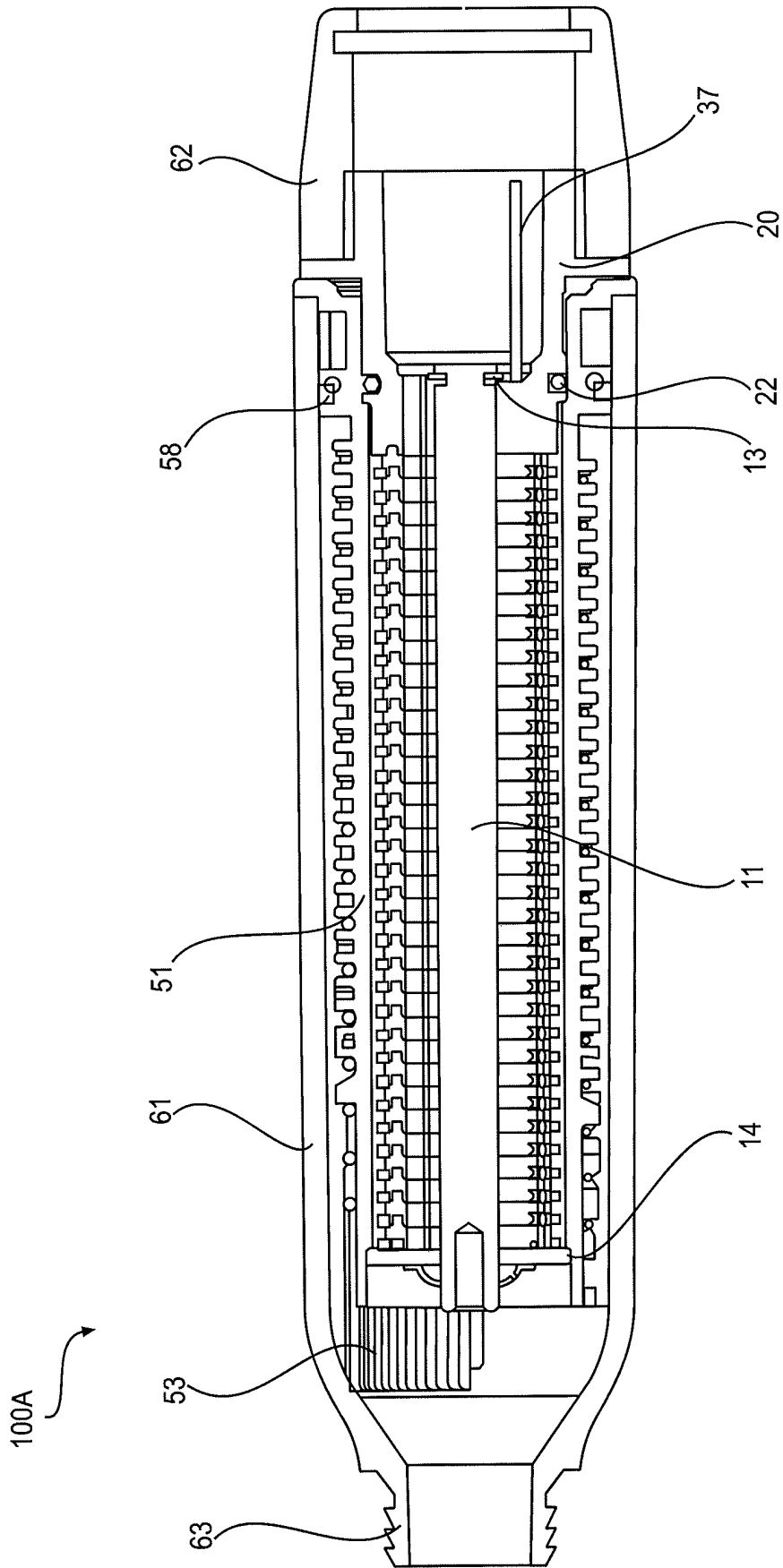

FIG. 1A

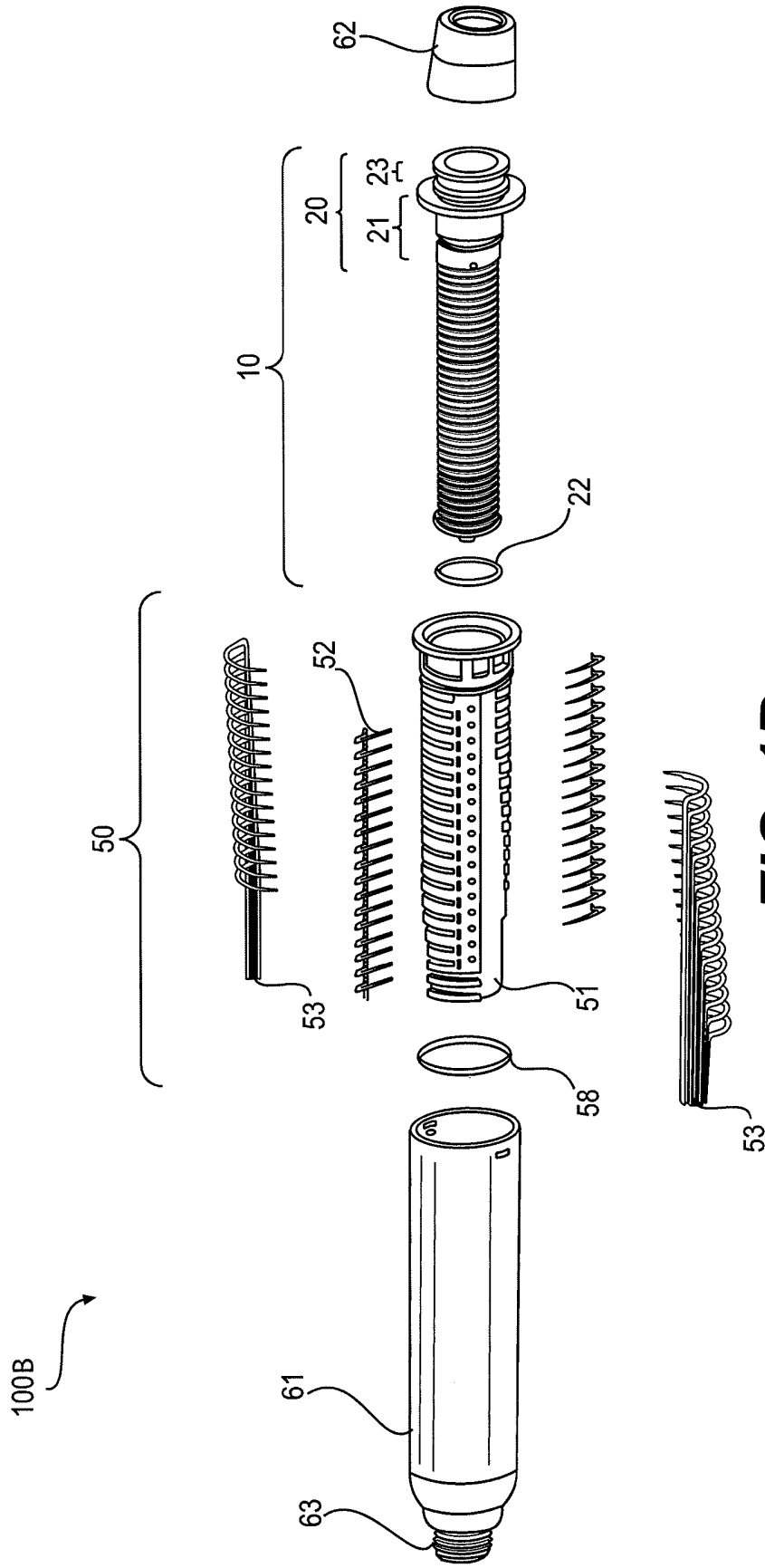

FIG. 1B

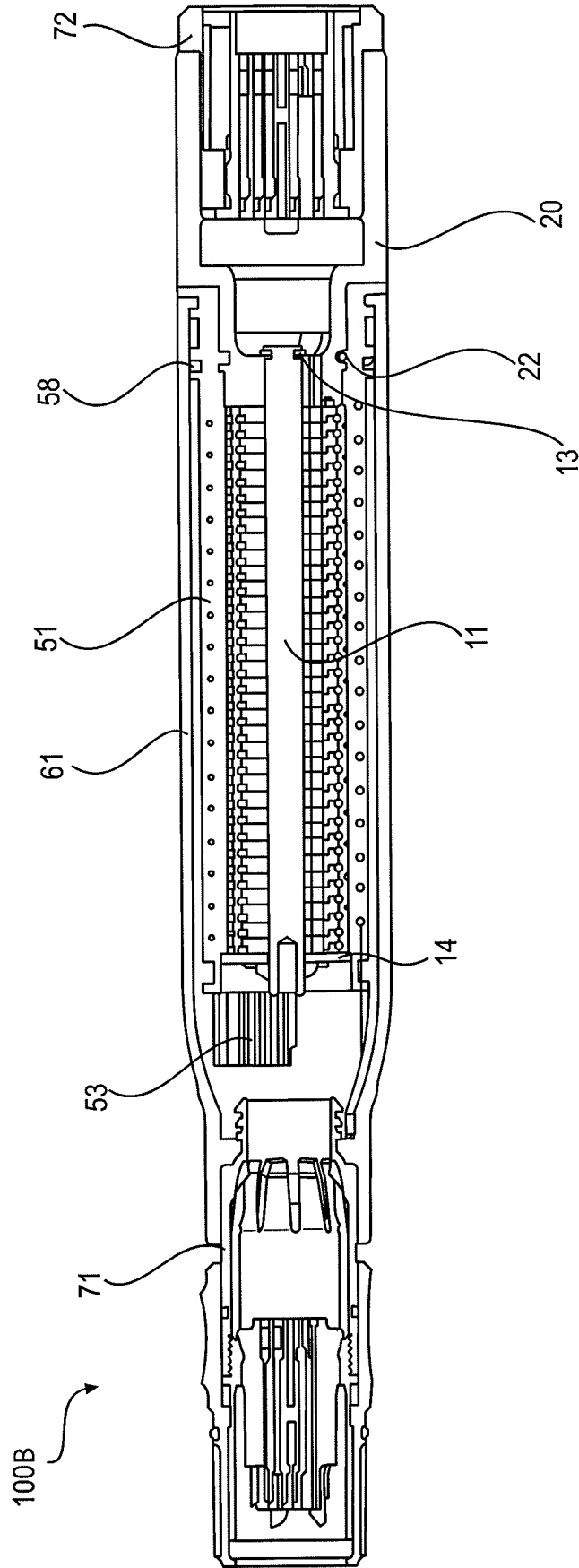

FIG. 2A

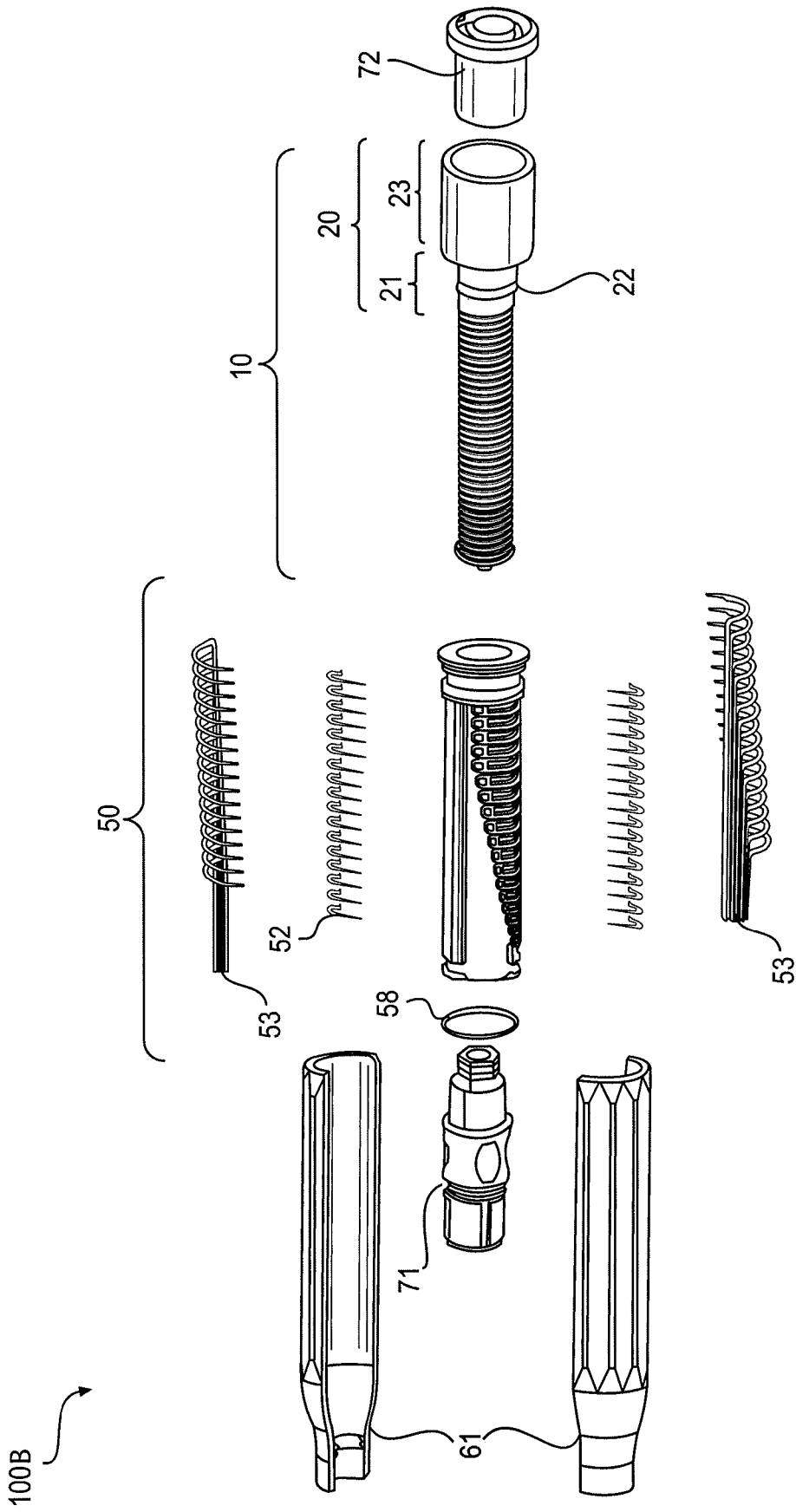

FIG. 2B

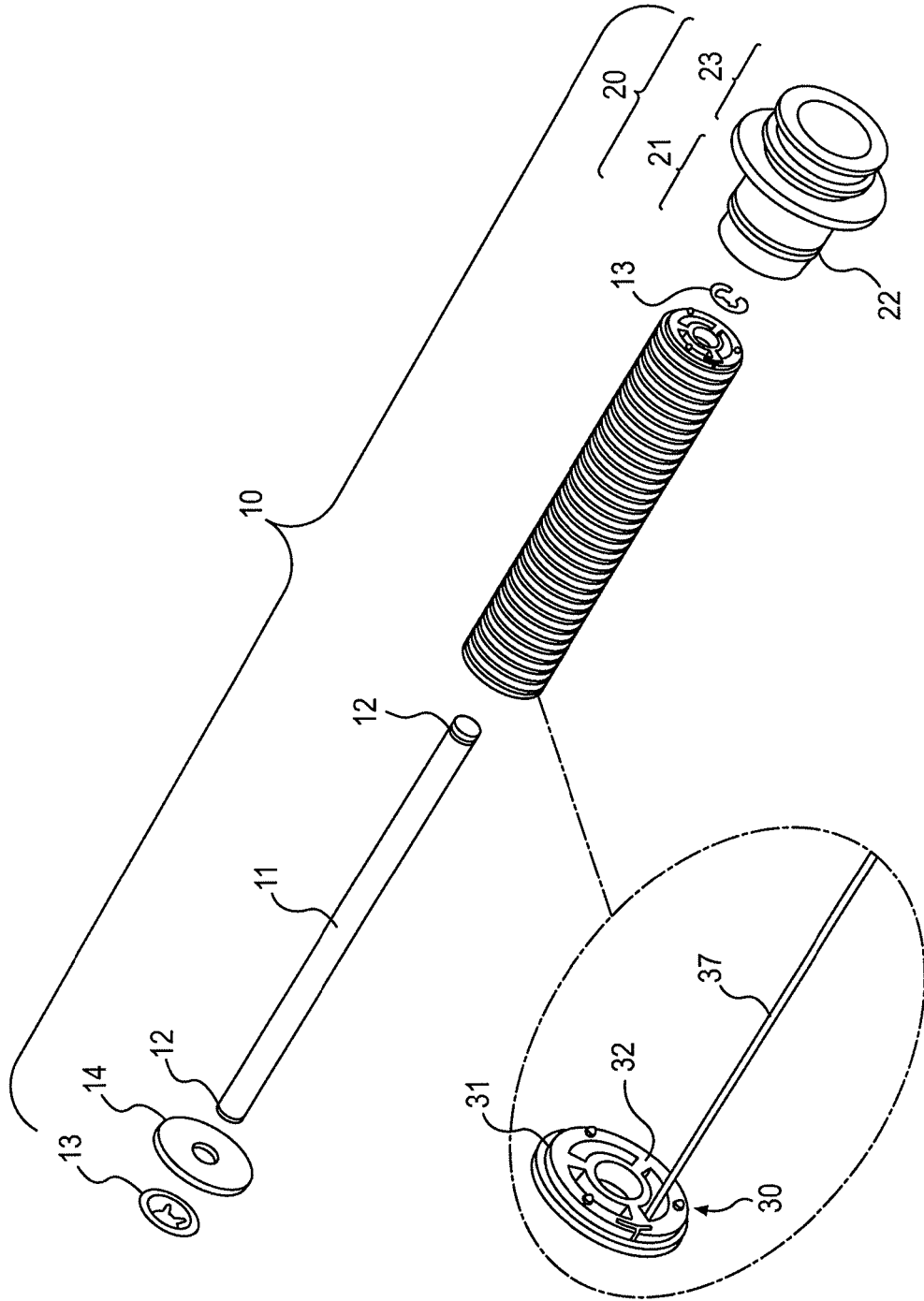

FIG. 3

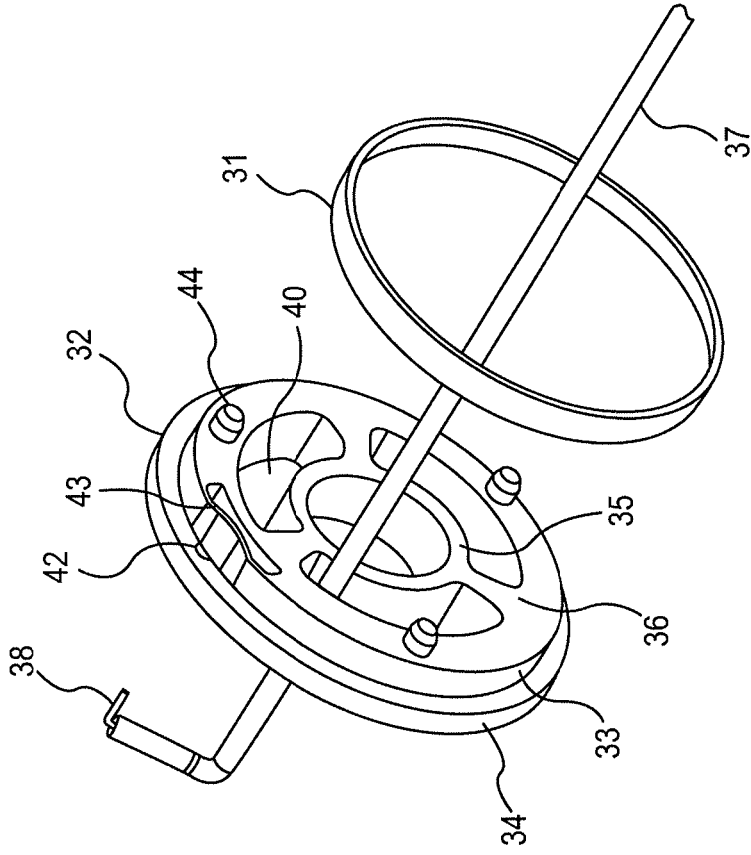

FIG. 4B

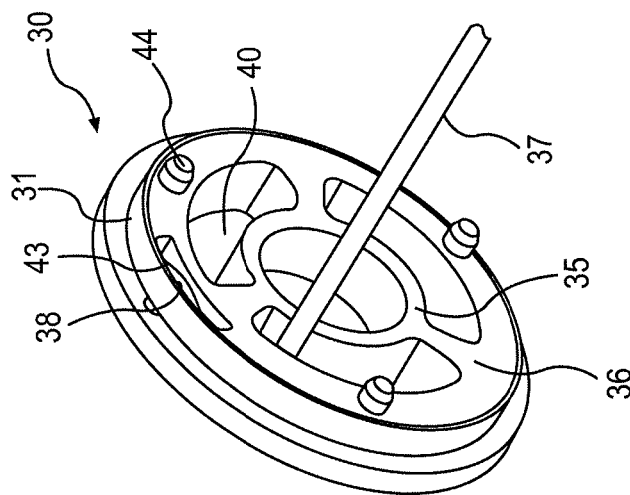

FIG. 4A

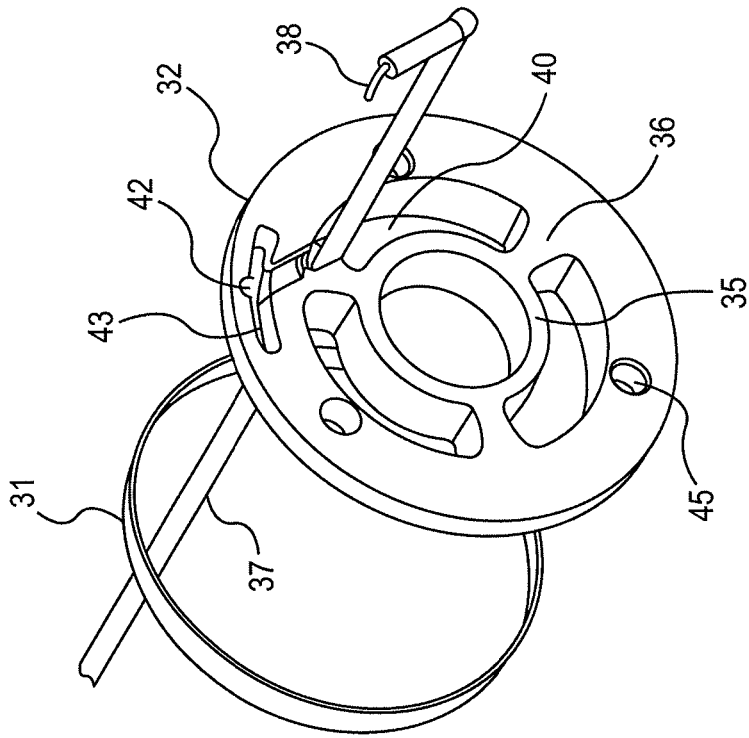

FIG. 4D

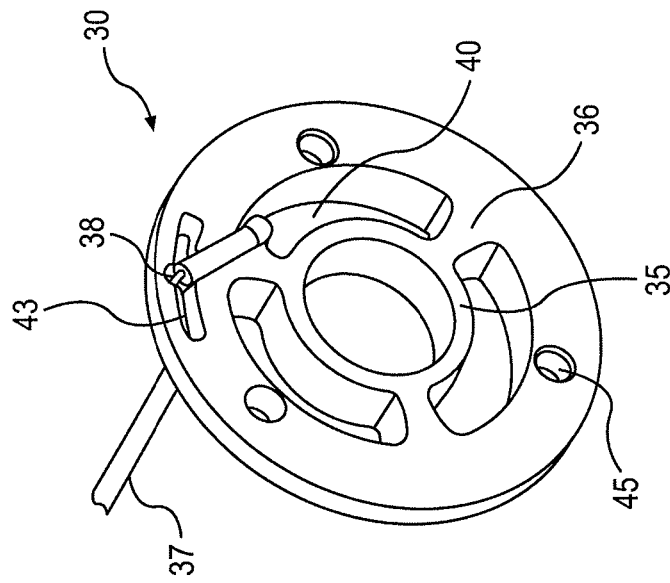

FIG. 4C

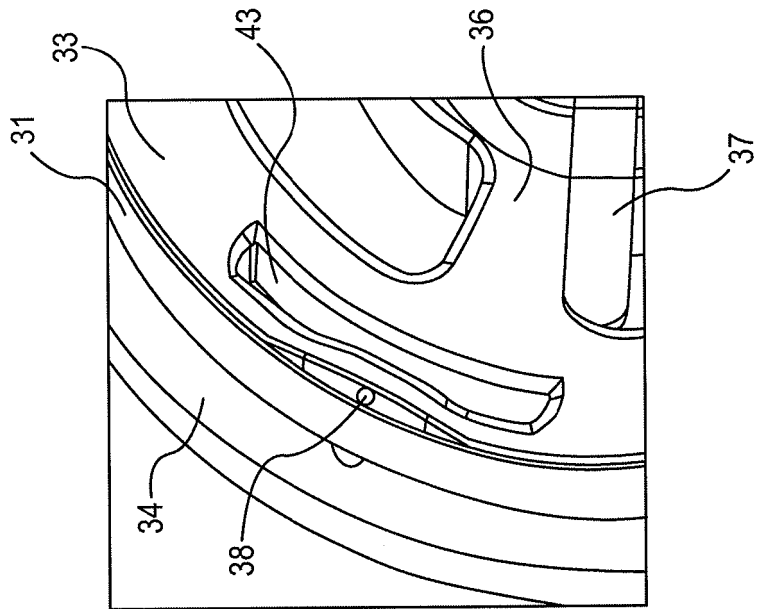

FIG. 4E

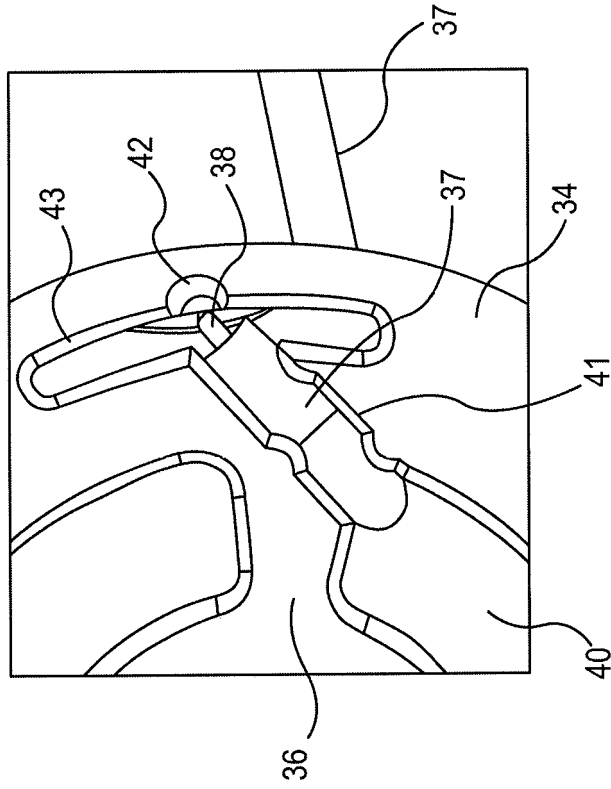

FIG. 4F

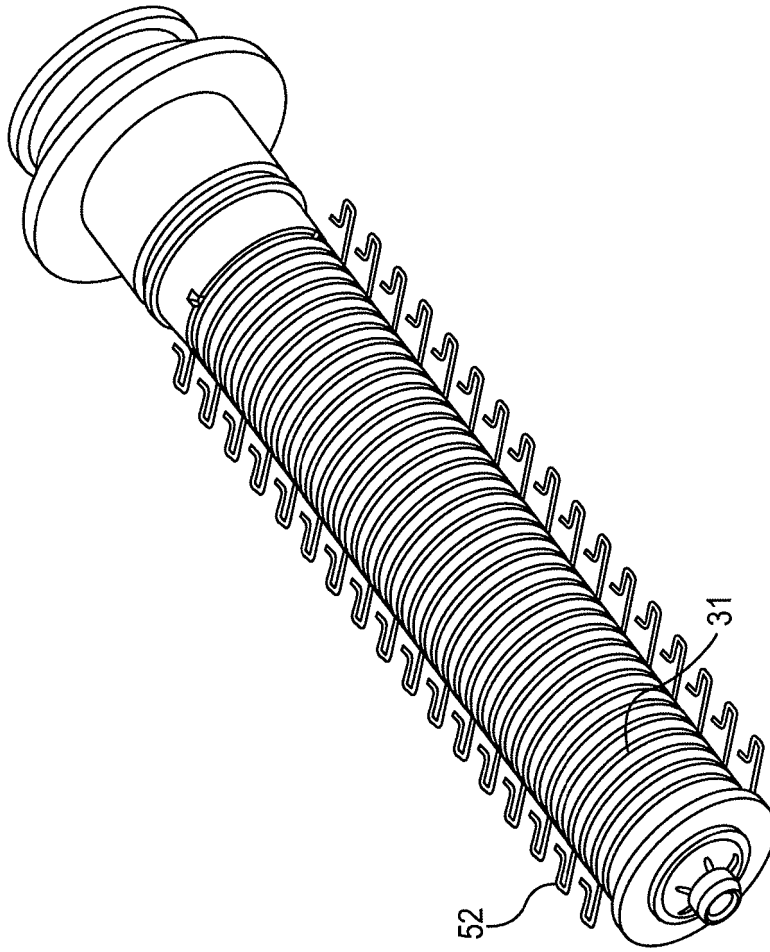

FIG. 5

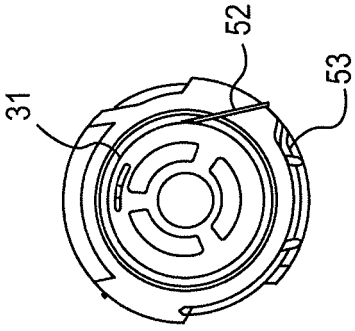

FIG. 6B

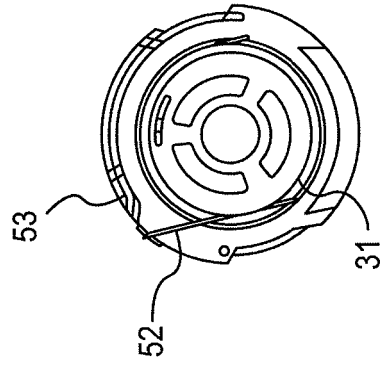

FIG. 6D

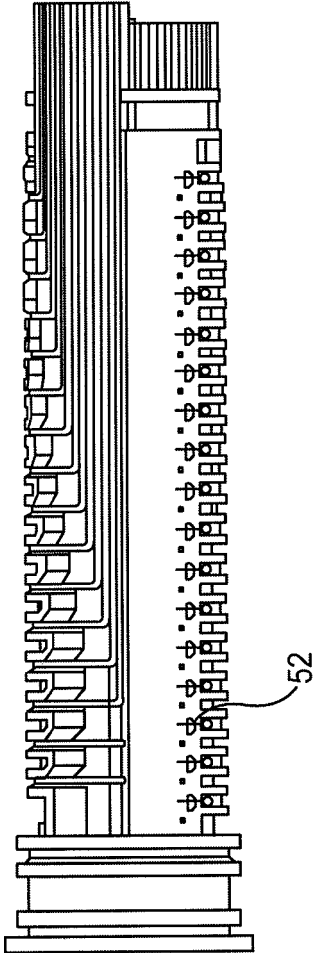

FIG. 6A

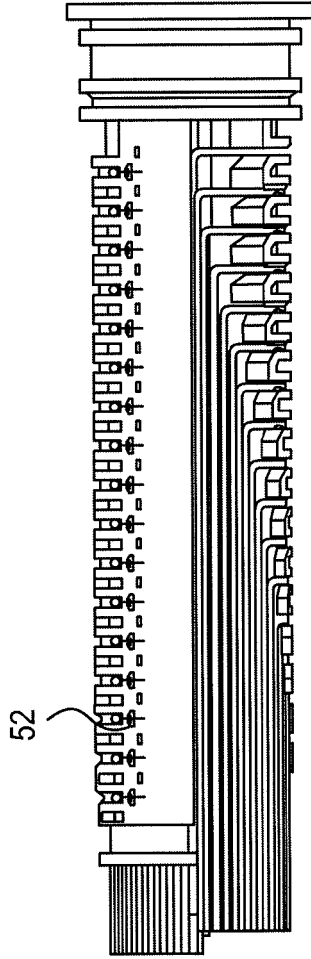

FIG. 6C

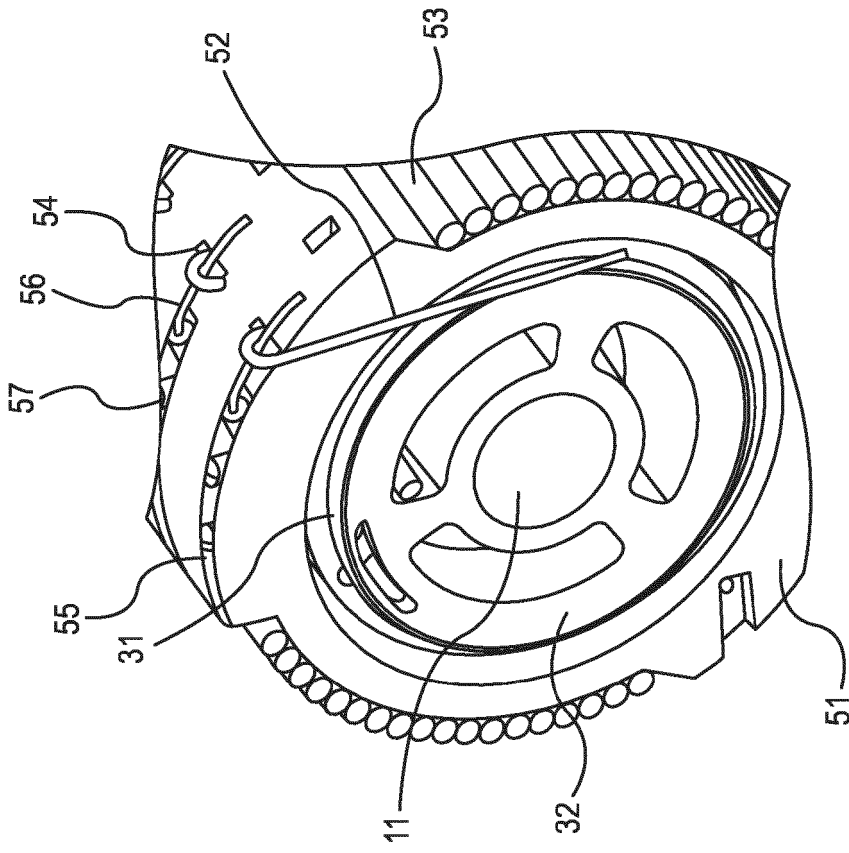

FIG. 7

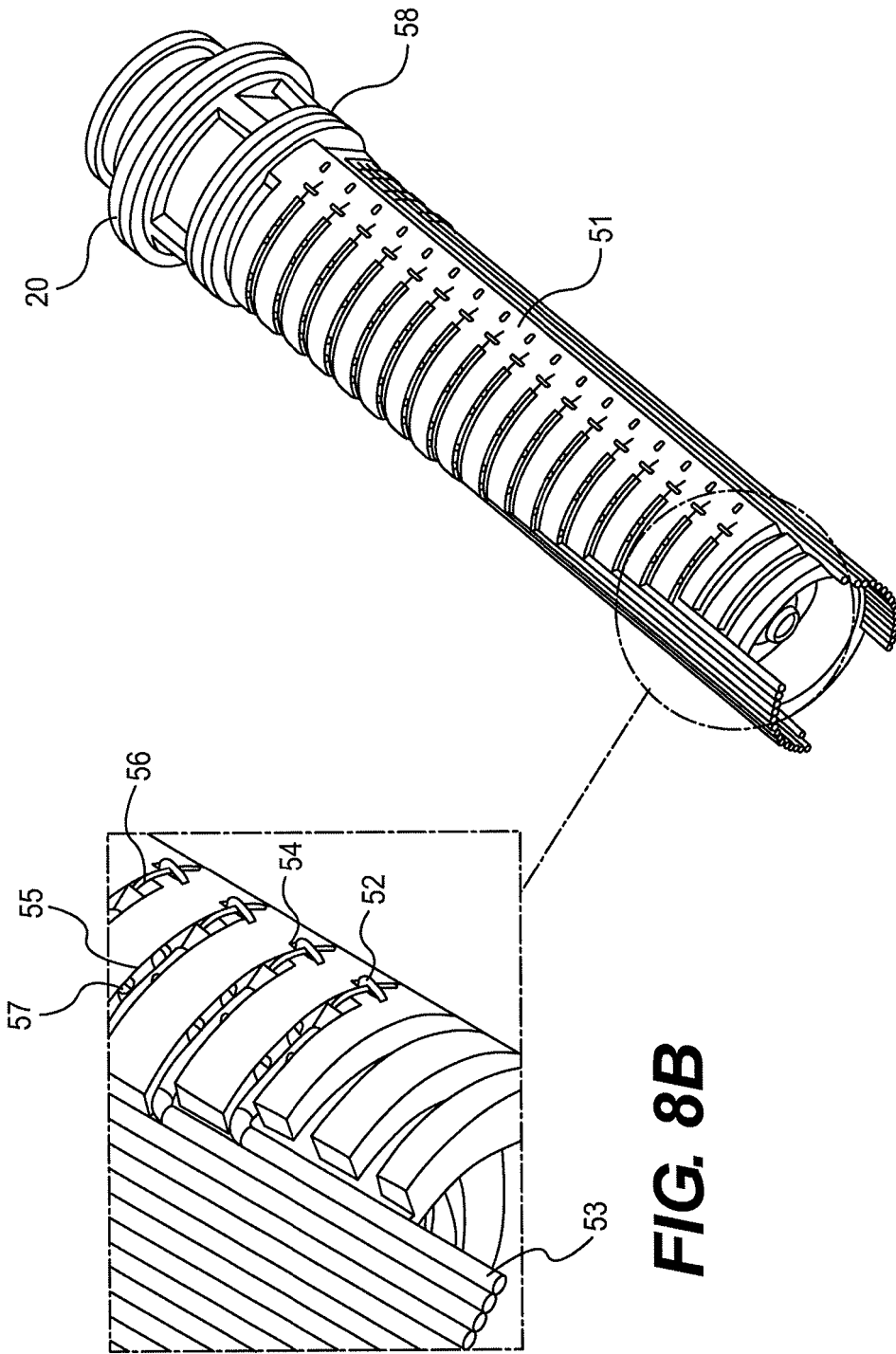

FIG. 8A

FIG. 8B

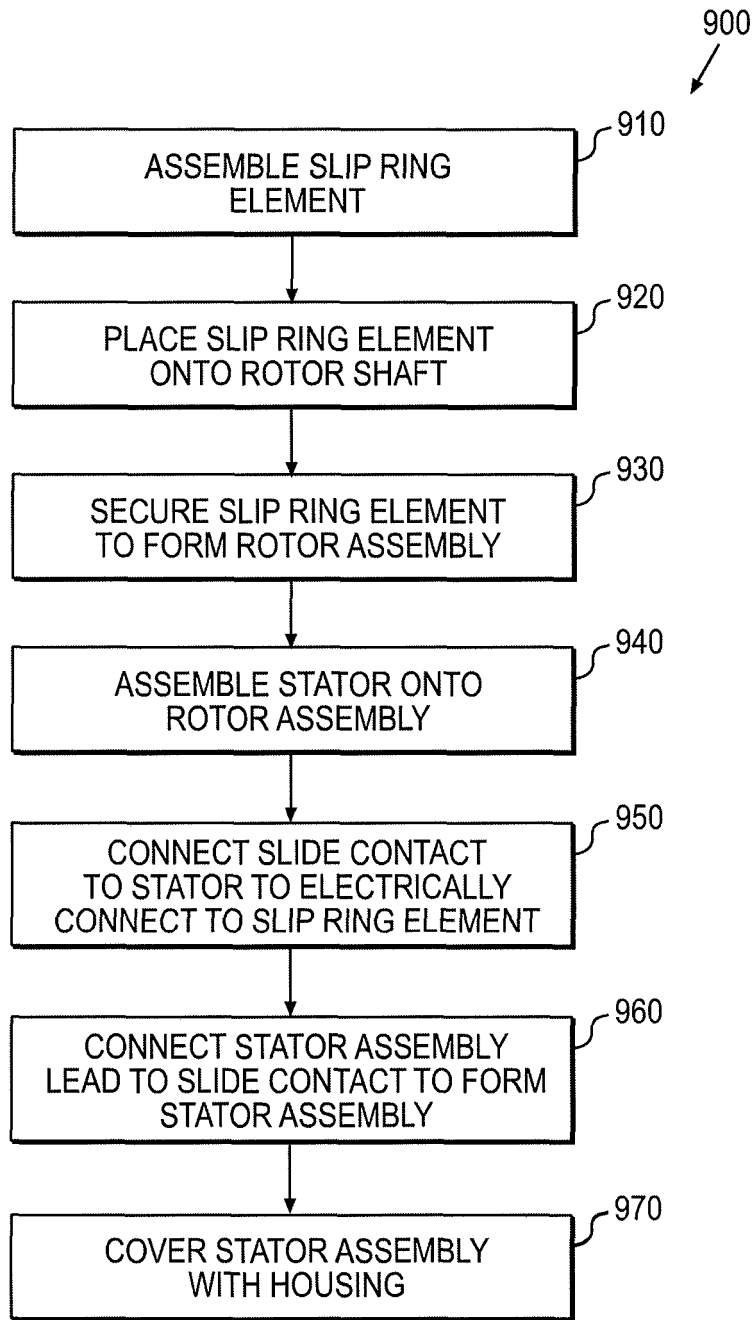

FIG. 9

REFERENCES CITED IN THE DESCRIPTION

This list of references cited by the applicant is for the reader's convenience only. It does not form part of the European patent document. Even though great care has been taken in compiling the references, errors or omissions cannot be excluded and the EPO disclaims all liability in this regard.

Patent documents cited in the description

- US 61721433 [0001]
- EP 251392 A [0005]
- WO 2011063444 A [0006]
- US 7326091 B [0050]
- US 7661995 B [0050]
- US 7938670 B [0050]
- US D596127 S [0050]
- US D615932 S [0050]
- US D616825 S [0050]