

(19) World Intellectual Property Organization  
International Bureau



(43) International Publication Date  
23 February 2006 (23.02.2006)

PCT

(10) International Publication Number  
**WO 2006/020765 A3**

(51) International Patent Classification:  
**A45F 3/16** (2006.01)

(21) International Application Number:  
PCT/US2005/028544

(22) International Filing Date: 10 August 2005 (10.08.2005)

(25) Filing Language: English

(26) Publication Language: English

(30) Priority Data:  
60/601,262 10 August 2004 (10.08.2004) US  
11/180,115 12 July 2005 (12.07.2005) US

(71) Applicant (for all designated States except US): **NALGE NUNC INTERNATIONAL CORP.** [US/US]; 75 Panorama Creek Dr., Rochester, NY 14625 (US).

(72) Inventors; and

(75) Inventors/Applicants (for US only): **BROWN, Dennis** [US/US]; 343 West 400 North, Logan, UT 84321 (US).

**HORITO, Michael** [US/US]; 381 East 400 South, Provo, UT 84606 (US).

(74) Agents: **ROSSA, Thomas, J.** et al.; Holme Roberts & Owen LLP, 299 South Main Street, Suite 1800, Salt Lake City, UT 84111 (US).

(81) Designated States (unless otherwise indicated, for every kind of national protection available): AE, AG, AL, AM, AT, AU, AZ, BA, BB, BG, BR, BW, BY, BZ, CA, CH, CN, CO, CR, CU, CZ, DE, DK, DM, DZ, EC, EE, EG, ES, FI, GB, GD, GE, GH, GM, HR, HU, ID, IL, IN, IS, JP, KE, KG, KM, KP, KR, KZ, LC, LK, LR, LS, LT, LU, LV, MA, MD, MG, MK, MN, MW, MX, MZ, NA, NG, NI, NO, NZ, OM, PG, PH, PL, PT, RO, RU, SC, SD, SE, SG, SK, SL, SM, SY, TJ, TM, TN, TR, TT, TZ, UA, UG, US, UZ, VC, VN, YU, ZA, ZM, ZW.

(84) Designated States (unless otherwise indicated, for every kind of regional protection available): ARIPO (BW, GH, GM, KE, LS, MW, MZ, NA, SD, SL, SZ, TZ, UG, ZM, ZW), Eurasian (AM, AZ, BY, KG, KZ, MD, RU, TJ, TM), European (AT, BE, BG, CH, CY, CZ, DE, DK, EE, ES, FI,

[Continued on next page]

(54) Title: BITE VALVE RETAINER

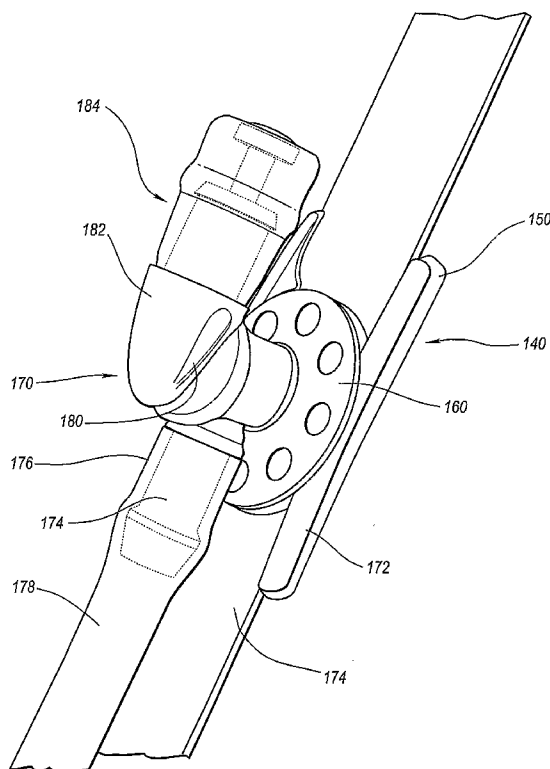

(57) Abstract: A system for hydration has a back pack that holds a bladder with liquids for consumption by the user. The bladder has an intake port for filling and a discharge port connected to a discharge tube to transmit the fluid to a bite valve. A magnet is attached to the bite valve; and a magnet is attached to a buckle on the straps supporting the back pack. The bite valve has a free position remote from the buckle and a stored position in which the magnet on the bite valve is magnetically attached to a magnet on the buckle. The magnet has sufficient force to draw the bite valve to the buckle when the bite valve is proximate the buckle so that a user need not use a hand to unite the bite valve with the buckle.

WO 2006/020765 A3



FR, GB, GR, HU, IE, IS, IT, LT, LU, LV, MC, NL, PL, PT,  
RO, SE, SI, SK, TR), OAPI (BF, BJ, CF, CG, CI, CM, GA,  
GN, GQ, GW, ML, MR, NE, SN, TD, TG).

**Published:**

— *with international search report*

**Declarations under Rule 4.17:**

- *as to applicant's entitlement to apply for and be granted a patent (Rule 4.17(ii))*
- *as to the applicant's entitlement to claim the priority of the earlier application (Rule 4.17(iii))*
- *of inventorship (Rule 4.17(iv))*

**(88) Date of publication of the international search report:**

9 August 2007

*For two-letter codes and other abbreviations, refer to the "Guidance Notes on Codes and Abbreviations" appearing at the beginning of each regular issue of the PCT Gazette.*

## INTERNATIONAL SEARCH REPORT

International application No.

PCT/US05/28544

## A. CLASSIFICATION OF SUBJECT MATTER

IPC: A45F 3/16( 2006.01)

USPC: 224/148.2;222/175

According to International Patent Classification (IPC) or to both national classification and IPC

a b

## B. FIELDS SEARCHED

Minimum documentation searched (classification system followed by classification symbols)

U.S. : 224/148.2; 222/175

Documentation searched other than minimum documentation to the extent that such documents are included in the fields searched

Electronic data base consulted during the international search (name of data base and, where practicable, search terms used)

## C. DOCUMENTS CONSIDERED TO BE RELEVANT

Category *	Citation of document, with indication, where appropriate, of the relevant passages	Relevant to claim No.
Y	US 5,975,387 A (Gleason et al.) 02 November 1999 (02.11.1999) entire document	1-18 and 22-31
Y	US 5,901,889 A (Ho) 11 May 1999 (11.05.1999) entire document	1-18 and 22-31
Y	US 4,139,130 A (Glusker et al.) 13 February 1979 (13.02.1979) entire document	1-18 and 22-31
Y	US 2001/0054630 A1 (Crabill) 27 December 2001 (27.12.2001) entire document	1-18 and 22-31
A	US 6,199,729 B1 (Drzymkowski) 13 March 2001 (13.03.2001) entire document	1-31



Further documents are listed in the continuation of Box C.



See patent family annex.

* Special categories of cited documents:	
"A" document defining the general state of the art which is not considered to be of particular relevance	"T" later document published after the international filing date or priority date and not in conflict with the application but cited to understand the principle or theory underlying the invention
"E" earlier application or patent published on or after the international filing date	"X" document of particular relevance; the claimed invention cannot be considered novel or cannot be considered to involve an inventive step when the document is taken alone
"L" document which may throw doubts on priority claim(s) or which is cited to establish the publication date of another citation or other special reason (as specified)	"Y" document of particular relevance; the claimed invention cannot be considered to involve an inventive step when the document is combined with one or more other such documents, such combination being obvious to a person skilled in the art
"O" document referring to an oral disclosure, use, exhibition or other means	"&" document member of the same patent family
"P" document published prior to the international filing date but later than the priority date claimed	

Date of the actual completion of the international search

26 February 2007 (26.02.2007)

Date of mailing of the international search report

29 MAR 2007

Name and mailing address of the ISA/US

Mail Stop PCT, Attn: ISA/US  
Commissioner for Patents  
P.O. Box 1450  
Alexandria, Virginia 22313-1450

Facsimile No. (571) 273-3201

Authorized officer

Nathan J Newhouse  
Telephone No. (571)-272-3700