

(19) World Intellectual Property
Organization
International Bureau



(43) International Publication Date
22 April 2004 (22.04.2004)

PCT

(10) International Publication Number
WO 2004/032766 A2

(51) International Patent Classification⁷: A61B 17/115

(21) International Application Number:
PCT/US2003/031638

(22) International Filing Date: 6 October 2003 (06.10.2003)

(25) Filing Language: English

(26) Publication Language: English

(30) Priority Data:
60/416,055 4 October 2002 (04.10.2002) US

(71) Applicant (for all designated States except US): **TYCO HEALTHCARE GROUP LP** [US/US]; 150 Glover Avenue, Norwalk, CT 06856 (US).

(72) Inventors; and

(75) Inventors/Applicants (for US only): **MILLIMAN, Keith, L.** [US/US]; 5 Marywood Road, Bethal, CT 06801 (US). **JANKOWSKI, Bruce, K.** [US/US]; 17 Woodlawn Terrace, Meriden, CT 06450 (US). **CUNY, Douglas, J.**

[US/US]; 2 Linda Lane, Bethal, CT 06801 (US). **SNIFFIN, Kevin** [US/US]; 38 Grand Street, Danbury, CT 06810 (US). **DATO, Anthony** [US/US]; 3 Lynn Court, East Haven, CT 06512 (US). **GRESHAM, Richard, D.** [US/US]; 134 East Gate Road, Guildfird, CT 06437 (US).

(74) Agent: **AUDET, Paul, R.**; United States Surgical, a Division of Tyco Healthcare Group LLP, 150 Glover Avenue, Norwalk, CT 06856 (US).

(81) Designated States (national): AE, AG, AL, AM, AT, AU, AZ, BA, BB, BG, BR, BY, BZ, CA, CH, CN, CO, CR, CU, CZ, DE, DK, DM, DZ, EC, EE, ES, FI, GB, GD, GE, GH, GM, HR, HU, ID, IL, IN, IS, JP, KE, KG, KP, KR, KZ, LC, LK, LR, LS, LT, LU, LV, MA, MD, MG, MK, MN, MW, MX, MZ, NI, NO, NZ, OM, PG, PH, PL, PT, RO, RU, SC, SD, SE, SG, SK, SL, SY, TJ, TM, TN, TR, TT, TZ, UA, UG, US, UZ, VC, VN, YU, ZA, ZM, ZW.

(84) Designated States (regional): ARIPO patent (GH, GM, KE, LS, MW, MZ, SD, SL, SZ, TZ, UG, ZM, ZW), Eurasian patent (AM, AZ, BY, KG, KZ, MD, RU, TJ, TM), European patent (AT, BE, BG, CH, CY, CZ, DE, DK, EE, ES, FI, FR, GB, GR, HU, IE, IT, LU, MC, NL, PT, RO,

[Continued on next page]

(54) Title: SURGICAL STAPLING DEVICE

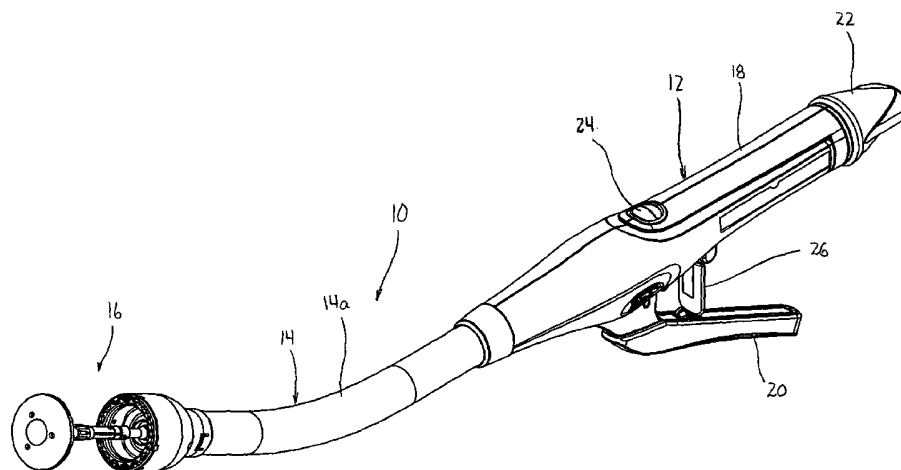

(57) Abstract: A surgical stapling device is disclosed for performing circular anastomoses. The surgical stapling device includes a handle portion, an elongated body portion and a head portion including an anvil assembly and a shell assembly. The head portion includes an anvil assembly including a tiltable anvil which will tilt automatically after the device has been fired and unapproximated. The tiltable anvil provides a reduced anvil profile to reduce trauma during removal of the device after the anastomoses procedure has been performed. The stapling device includes a bulbous indicator which preferably extends above a top surface of the handle assembly of the device. The indicator includes indicia to identify to a surgeon that the device has been approximated and is in a fire-ready position. Preferably, the indicator includes a cover which is formed of a magnification material to prominently display the indicia. The anvil assembly of the stapling device preferably includes a retainer clip positioned on the anvil head. The retainer clip preferably includes at least one resilient arm which is positioned to engage a cutting ring during unapproximation of the stapling device.

WO 2004/032766 A2



SE, SI, SK, TR), OAPI patent (BF, BJ, CF, CG, CI, CM, GA, GN, GQ, GW, ML, MR, NE, SN, TD, TG).

For two-letter codes and other abbreviations, refer to the "Guidance Notes on Codes and Abbreviations" appearing at the beginning of each regular issue of the PCT Gazette.

Published:

— *without international search report and to be republished upon receipt of that report*

SURGICAL STAPLING DEVICE

This application claims priority from U.S. provisional application Serial No. 60/416,055, filed October 4, 2002, the entirety which is incorporated herein by reference.

BACKGROUND

1. Technical Field

The present disclosure relates generally to a surgical stapling device for applying surgical staples to body tissue. More particularly, the present disclosure relates to a surgical stapling device suitable for performing circular anastomosis of hollow tissue organs.

2. Background to Related Art

Anastomosis is the surgical joining of separate hollow organ sections. Typically, an anastomosis procedure follows surgery in which a diseased or defective section of hollow tissue is removed and the remaining end sections are to be joined. Depending on the desired anastomosis procedure, the end sections may be joined by either circular, end-to-side or side-to-side organ reconstruction methods.

In a circular anastomosis procedure, the two ends of the organ sections are joined by means of a stapling instrument which drives a circular array of staples through the end section of each organ section and simultaneously cores any tissue interior of the driven circular array of staples to free the tubular passage. Examples of instruments for performing circular anastomosis of hollow organs are described in U.S. Pat. Nos. 6,053,390, 5,588,579, 5,119,983, 5,005,749, 4,646,745, 4,576,167, and 4,473,077, each of which is incorporated herein in its entirety by reference. Typically, these

instruments include an elongated shaft having a handle portion at a proximal end to actuate the instrument and a staple holding component disposed at a distal end. An anvil assembly including an anvil rod with attached anvil head is mounted to the distal end adjacent the staple holding component. Opposed end portions of tissue of the organs to be stapled are clamped between the anvil head and the staple holding component. The clamped tissue is stapled by driving one or more staples from the staple holding component so that the ends of the staples pass through the tissue and are deformed by the anvil head.

In use, the staple holding component and anvil assembly are positioned within opposed sections of the organs to be joined and are not visible to the surgeon. Typically, an indicator is provided on the stapling device which is visible to the surgeon to identify when the anvil assembly and staple holding portion have been sufficiently approximated such that the device is in a fire-ready position. Conventional indicators include indicia which is moved to a position visible to a surgeon when the device has been approximated. Such indicia is sometimes difficult to view.

Accordingly, a need exists for a stapling device with an approximation/fire-ready indicator which prominently displays indicia which is easily viewable by a surgeon.

SUMMARY

In accordance with the present disclosure, a surgical stapling device is disclosed preferably for performing circular anastomoses. The surgical stapling device includes a handle portion or assembly, a body portion and a head portion including an anvil assembly and a shell assembly. The handle portion can include a rotatable approximation knob for approximating the anvil and shell assemblies and a firing trigger

for actuating a firing mechanism for ejecting staples positioned within the shell assembly. The firing trigger preferably forms one link of a two bar linkage provided to actuate the firing mechanism. The two bar linkage provides the device with an improved mechanical advantage to reduce the firing forces required to fire the device.

The head portion includes an anvil assembly including a tiltable anvil which will tilt automatically when the device has been fired and unapproximated. The tiltable anvil provides a reduced anvil profile to reduce trauma during removal of the device after the anastomoses procedure has been performed.

The surgical stapling device also includes a firing lockout mechanism which prevents actuation of the firing trigger until the device has been approximated. In one preferred embodiment, the firing lockout mechanism includes a trigger lock and a lockout member which is movably positioned in the handle assembly. The lockout member prevents movement of the trigger lock from a locked to an unlocked position until the device has been approximated.

The surgical stapling device also includes tactile indication mechanism. In one preferred embodiment, the tactile indication mechanism identifies to a surgeon that the anvil head has been unapproximated a distance sufficient to permit the anvil head to tilt, thus, indicating that the device can be removed from the patient.

In another preferred embodiment, the stapling device includes a bulbous indicator which preferably extends above a top surface of the handle assembly of the device. The indicator includes indicia to identify to a surgeon that the device has been approximated and is in a fire-ready position. Preferably, the indicator includes a cover which is formed of a magnification material to prominently display the indicia. The

presently disclosed indicator provides improved visualization to a surgeon from both the top and side of the instrument.

In another preferred embodiment, the anvil assembly of the stapling device includes a retainer clip positioned on the anvil head. The retainer clip preferably includes at least one resilient arm which is positioned to engage a cutting ring in its unbiased position to prevent the cutting ring from sticking to a knife blade during unapproximation of the stapling device. In a preferred embodiment, the retainer clip includes a pair of resilient arms and is positioned in a transverse slot in an anvil post of the anvil assembly. The cutting ring is positioned about the anvil post to urge the resilient arms into the transverse slot. The cutting ring is movable about the anvil post when the device is fired to allow the resilient arms of the retainer clip to flex outwardly to a position obstructing movement of the cutting ring.

BRIEF DESCRIPTION OF THE DRAWINGS

Various preferred embodiments of the presently disclosed surgical stapling device are disclosed herein with reference to the drawings wherein:

FIG. 1 is a top side perspective view from the proximal end of the presently disclosed surgical stapling device in the unapproximated position;

FIG. 2 is a top side perspective view from the distal end of the surgical stapling device shown in FIG. 1;

FIG. 3 is a side perspective exploded view of the handle assembly of the surgical stapling device shown in FIG. 1;

FIG. 3A is a top perspective view of the indicator of the handle assembly shown in FIG. 3;

FIG. 4 is a side perspective view from the top of the handle assembly of the surgical stapling device shown in FIG. 1 with a handle section removed;

FIG. 5 is a side perspective view from the bottom of the handle assembly of the surgical stapling device shown in FIG. 4;

FIG. 6 is a side perspective exploded view of the central body portion and distal head portion of the surgical stapling device shown in FIG. 1;

FIG. 7 is an enlarged side perspective of the anvil retainer and band portions of the central body portion shown in FIG. 6;

FIG. 8 is a side perspective view of the screw and screw stop of the approximation mechanism of the handle assembly shown in FIG. 5;

FIG. 9 is an enlarged view of the indicated area of detail shown in FIG. 3;

FIG. 9A is a side perspective view from the top of the abutment member of the handle assembly shown in FIG. 3;

FIG. 10 is a side perspective exploded view from the proximal end of the anvil assembly of the surgical stapling device shown in FIG. 1;

FIG. 11 is a side perspective view of the retaining clip of the anvil assembly shown in FIG. 10;

FIG. 12 is a side perspective view of the distal end of the center rod of the anvil assembly shown in FIG. 10 with a removable trocar fastened thereto;

FIG. 13 is a side perspective view of the center rod and removable trocar shown in FIG. 11 separated one from the other;

FIG. 14 is a side perspective view from the proximal end of the anvil assembly shown in FIG. 10 with the removable trocar attached thereto;

FIG. 15 is a side perspective view from the distal end of the anvil assembly shown in FIG. 14;

FIG. 16 is a side cross-sectional view taken through the retaining clip of the anvil assembly and removable trocar of the anvil assembly shown in FIG. 15;

FIG. 17 is an enlarged view of the indicated area of detail shown in FIG. 16;

FIG. 18 is a side cross-sectional view taken through the pivot member of the anvil head assembly of the anvil assembly shown in FIG. 15;

FIG. 19 is a side perspective view from the proximal end of the anvil assembly shown in FIG. 18 with the removable trocar removed;

FIG. 20 is a perspective, partial cutaway view from the distal end of the anvil assembly shown in FIG. 19, with the anvil head removed;

FIG. 21 is a side cross-sectional partial cutaway view of the distal portion of the anvil assembly shown in FIG. 19, with the anvil head in phantom;

FIG. 22 is a side perspective view from the bottom of the screw stop of the handle assembly shown in FIG. 3;

FIG. 23 is a bottom perspective view from the proximal end of the screw stop shown in FIG. 22;

FIG. 24 is a top perspective view of the cam adjustment member of the handle assembly shown in FIG. 3;

FIG. 25 is a side view of the screw and screw stop of the handle assembly shown in FIG. 3 with the set screw and the cam adjustment member removed;

FIG. 26 is a side view of the screw and screw stop shown in FIG. 25 with the set screw and cam adjustment member attached thereto;

FIG. 27 is a side view of the screw and screw stop shown in FIG. 26 with the cam adjustment screw adjusted to increase the tissue gap;

FIG. 28 is a side view of the screw and screw stop shown in FIG. 26 with the cam adjustment screw adjusted to decrease the tissue gap;

FIG. 29 is a top perspective view from the proximal end of the slide member of the indicator mechanism of the handle assembly shown in FIG. 3;

FIG. 30 is a bottom perspective view of the lockout member of the fire lockout mechanism of the handle assembly shown in FIG. 3;

FIG. 31 is a side cross-sectional view of the surgical stapling device shown in FIG. 1 with the anvil assembly removed;

FIG. 32 is a side enlarged view of the handle assembly of the surgical stapling device shown in FIG. 31 with the handle sections removed;

FIG. 33 is an enlarged view of the indicated area of detail shown in FIG. 31;

FIG. 34 is an enlarged view of the indicated area of detail shown in FIG. 31;

FIG. 35 is a perspective view from the front of the distal end of the surgical stapling device shown in FIG. 31 with the anvil assembly removed;

FIG. 36 is a perspective view from the front of the distal end of the surgical stapling device shown in FIG. 35 with an anvil assembly attached thereto;

FIG. 37 is a side cross-sectional view of the distal end of the surgical stapling device shown in FIG. 36;

FIG. 38 is a side cross-sectional view of the surgical stapling device shown in FIG. 31 with the anvil assembly attached thereto;

FIG. 39 is a cross-sectional view taken along section lines 39-39 of FIG. 38;

FIG. 40 is a cross-sectional view taken along section lines 40-40 of FIG. 38;

FIG. 41 is a cross-sectional view taken along section lines 41-41 of FIG. 38;

FIG. 42 is a cross-sectional view taken along section lines 42-42 of FIG. 38;

FIG. 43 is a cross-sectional view taken along section lines 43-43 of FIG. 38;

FIG. 44 is a cross-sectional view taken along section lines 44-44 of FIG. 38;

FIG. 45 is a side perspective view of the surgical stapling device shown in FIG. 38 with the anvil assembly in an approximated position;

FIG. 46 is a side cross-sectional view of the distal end of the surgical stapling device shown in FIG. 45;

FIG. 47 is a side enlarged view of the handle assembly of the surgical stapling device shown in FIG. 45 with a handle section removed;

FIG. 48 is a side cross-sectional view of the handle assembly of the surgical stapling device shown in FIG. 45;

FIG. 49 is a top horizontal cross-sectional view of a portion of the handle assembly of the surgical stapling device shown in FIG. 45;

FIG. 50 is a side view of a portion of the handle assembly of the surgical stapler shown in FIG. 45 with the handle sections removed;

FIG. 51 is a side cross-sectional view of a portion of the handle assembly of the surgical stapling device shown in FIG. 45 after the firing trigger has been actuated;

FIG. 52 is a side cross-sectional view of the distal end of the surgical stapling device shown in FIG. 45 after the firing trigger has been actuated;

FIG. 53 is a side view of the handle assembly shown in FIG. 51 with the handle sections removed;

FIG. 54 is an enlarged view of the firing link extension engaging the abutment member of the tactile indicator mechanism of the handle assembly shown in FIG. 53;

FIG. 55 is a side cross-sectional view of the distal portion of the anvil assembly of the surgical stapling device shown in FIG. 52;

FIG. 56 is a side cross-sectional view of the distal portion of the anvil assembly shown in FIG. 55 with a portion of the anvil head assembly in phantom;

FIG. 57 is a side view of the surgical stapling device shown in FIG. 45 after the anvil assembly and cartridge assembly have been unapproximated a distance sufficient to permit the anvil head assembly to pivot on the anvil center rod;

FIG. 58 is an enlarged view of the abutment member of the tactile indicator mechanism of the handle assembly shown in FIG. 53 (during unapproximation of the anvil and cartridge assemblies) with the wing of the screw stop, shown in phantom, in engagement with the abutment member;

FIG. 59 is a side cross-sectional view of the anvil assembly shown in FIG. 56 as the anvil head assembly begins to tilt;

FIG. 60 is a side cross-sectional view of the anvil assembly shown in FIG. 59 with the anvil assembly tilted; and

FIG. 61 is a side view of the surgical stapling device shown in FIG. 45 with the anvil head assembly unapproximated and tilted.

DETAILED DESCRIPTION OF PREFERRED EMBODIMENTS

Preferred embodiments of the presently disclosed surgical stapling device will now be described in detail with reference to the drawings in which like reference numerals designate identical or corresponding elements in each of the several views.

Throughout this description, the term "proximal" will refer to the portion of the instrument closest to the operator and the term "distal" will refer to the portion of the instrument furthest from the operator.

FIGS. 1 and 2 illustrate one preferred embodiment of the presently disclosed surgical stapling device shown generally as 10. Briefly, surgical stapling device 10 includes a proximal handle assembly 12, an elongated central body portion 14 including a curved elongated outer tube 14a, and a distal head portion 16. Alternately, in some surgical procedures, e.g., the treatment of hemorrhoids, it is desirable to have a substantially straight, preferably shortened, central body portion. The length, shape and/or the diameter of body portion 14 and head portion 16 may also be varied to suit a particular surgical procedure.

Handle assembly 12 includes a stationary handle 18, a firing trigger 20, a rotatable approximation knob 22 and an indicator 24. Stationary handle 18 is preferably formed from thermoplastic handle sections 18a and 18b, e.g., polycarbonate, (FIG. 3) which together define a housing for the internal components of handle assembly 12. Handle sections 18a and 18b are preferably secured together by sonic welding. Alternately, other known securement techniques may be employed including screws, adhesives, snap-fit connectors, etc. The internal components of handle portion 12 will be discussed in detail below. Preferably, cushioned and/or resilient slip resistant portions such as a grip (not shown) can be fastened to or included as part of handle sections 18a and 18b and firing trigger 20. The slip resistant grip may be formed over handle sections 18a and 18b and firing trigger 20 using an overmolding procedure and may be formed from neoprene or rubber. Alternately, other suitable materials, e.g.,

elastomeric materials, and joining techniques may be employed. A pivotally mounted trigger lock 26 is fastened to handle assembly 12 and is manually positioned to prevent inadvertent firing of stapling device 10. Indicator 24 is positioned on the stationary handle 18 and includes indicia, e.g., color coding, alpha-numeric labeling, etc., to identify to a surgeon whether the device is approximated and is ready to be fired. Indicator 24 preferably has a bulbous or convex shape which extends outwardly from a top surface of handle sections 18a and 18b and is easily viewable by a surgeon from the top and sides of the stapling device.

Head portion 16 includes an anvil assembly 30 and a shell assembly 31. Each of these assemblies will be discussed in detail below. Except where otherwise noted, the components of surgical device 10 are generally formed from thermoplastics including polycarbonates, and metals including stainless steel and aluminum. The particular material selected to form a particular component will depend upon the strength requirements of the particular component. For example, the anvil is preferably formed from a metal, such as stainless steel, and the stationary handle is preferably formed from a thermoplastic such as polycarbonate. Alternately, other materials not listed above, which preferably can withstand sterilization procedures, may be used to form components of stapling device 10 provided the materials are suitable for surgical use and meet the strength requirements of the particular component.

FIGS. 3-5 illustrate the internal components of handle assembly 12. The internal components include the proximal components of approximation and firing mechanisms, a firing lockout mechanism and an indicator drive mechanism. FIGS. 6 and 7 illustrate the internal components of elongated body portion 14. These components include the

distal components of the approximation and firing mechanisms. Each of these mechanisms will be disclosed in detail hereinbelow.

APPROXIMATION MECHANISM

Referring to FIGS. 3-8, the approximation mechanism includes approximation knob 22, a drive screw 32, a rotatable sleeve 33, first and second screw extensions 34 and 36 (FIG. 6), respectively, and an anvil retainer 38. Rotatable sleeve 33 includes a substantially cylindrical hollow body portion 40 and a substantially cylindrical collar 42 which together define a central bore 33a. Collar 42 has an annular groove 44 formed thereabout which is dimensioned to receive an inwardly extending flange 46 formed on an inner wall of handle sections 18a and 18b. Engagement between groove 44 and flanges 46 axially fixes sleeve 33 within handle 18 while permitting rotation of sleeve 33 in relation to stationary handle 18. The proximal end of body portion 40 of rotatable sleeve 33 extends through an opening 18b in the proximal end of stationary handle 18. A pair of diametrically opposed elongated ribs 48 are positioned or formed on the outer surface of body portion 40. Approximation knob 22 includes a pair of internal slots 49a positioned to receive ribs 48 of sleeve 33 to rotatably fix sleeve 33 to knob 22, such that rotation of knob 22 causes concurrent rotation of sleeve 33.

The proximal half of screw 32 includes a helical channel 50 and is dimensioned to be slidably positioned within central bore 33a of rotatable sleeve 33. The distal end of screw 32 includes an annular recess 35 dimensioned to receive a seal member 37 (FIG. 3) for providing a fluid tight seal between the outer surface of screw 32 and the inner surface of pusher link 74. A pin 52 (FIG. 3) extends radially through cylindrical

collar 42 of sleeve 33 into helical channel 50. Since sleeve 33 is axially fixed with respect to stationary handle 18, rotation of sleeve 33 about screw 32 causes pin 52 to move along channel 50 of screw 32 to effect axial movement of screw 32 within stationary handle 18.

Referring to FIGS. 6-8, the distal end of screw 32 includes a transverse slot 54. Top and bottom screw extensions 34 and 36 (FIG. 6) each include a proximally located flexible flat band portion 58 and a distally located flat band portion 60. Alternately, it is envisioned that screw extensions 34 and 36 may have other than a band configuration. For example, screw extensions 34 and 36 may be semi-circular or circular in cross-section. The flexibility of top and bottom screw extensions 34 and 36 permits movement of screw extensions 34 and 36 through curved elongated body portion 14. The proximal end of each band portion 58 includes a hole 62 dimensioned to receive a pin 64 for securing the proximal end of screw extensions 34 and 36 within transverse slot 54 of screw 32. Alternately, other fastening techniques may be used to secure each band portion 58 to screw 32, e.g., welding, crimping, etc. Distally located band portion 60 of each screw extension 34 and 36 is dimensioned to be received within a transverse slot 66 formed in a proximal end of anvil retainer 38 (FIG. 7) to fasten anvil retainer 38 to the distal end of screw extensions 34 and 36. Preferably, a pair of pins 66a which extend through the proximal end of anvil retainer 38 and band portions 60 are used to secure screw extensions 34 and 36 to anvil retainer 38. Alternately, band portions 60 can be brazed or welded within slot 66 or other fastening techniques may be used to secure band portions 60 of screw extensions 34 and 36 to anvil retainer 38, e.g., screws, crimping, etc. Anvil retainer 38 includes an annular protrusion 177 (FIG. 7)

which is configured to engage the anvil assembly in a manner to be discussed in detail below. Alternately, protrusion 177 need not be annular or may include different attachment structure, e.g., recesses, grooves, etc.

Referring again to FIGS. 3-7, when approximation knob 22 is manually rotated, rotatable sleeve 33 is rotated about the proximal end of screw 32 to move pin 52 along helical channel 50 of screw 32. Since sleeve 33 is axially fixed to stationary handle 18, as pin 52 is moved through channel 50, screw 32 is advanced or retracted within stationary handle 18. As a result, top and bottom screw extensions 34 and 36, which are fastened to the distal end of screw 32, and anvil retainer 38, which is fastened to the distal end of screw extensions 34 and 36, are moved axially within elongated body portion 14. Since anvil assembly 30 is secured to the distal end of anvil retainer 38, rotation of approximation knob 22 will effect movement of anvil assembly 30 in relation to shell assembly 31 between spaced and approximated positions.

FIRING MECHANISM

Referring to FIG. 3-6 and 9, the firing mechanism includes firing trigger 20, a firing link 72 and an elongated pusher link 74 (FIG. 6). Firing trigger 20 includes a body portion 76 and a trigger cover 80. A cushioned gripping surface (not shown) preferably formed of neoprene or rubber is provided on trigger cover 80. The cushioned gripping surface provides a non-slip cushioned surface to make actuation of device 10 more comfortable to a surgeon. The distal end of body portion 76 of trigger 20 is pivotally connected to a coupling member 86 by a pivot member 84. Coupling member 86 is secured to the proximal end of pusher link 74 and may be formed integrally with pusher link 74 or as a separate element fastened thereto. Firing link 72 has a distal end

pivotally secured to body portion 76 of trigger 20 by a pivot member 87 and a second end pivotally secured within a vertical slot 82 formed between stationary handle half-sections 18a and 18b of stationary handle 18 by pivot member 79. Pivot member 79 is free to move vertically within slot 82. A spring 82a (FIG. 9) is supported within handle 18 to urge pivot member 79 downwardly towards the bottom of slot 82. Body portion 76 of trigger 20 further includes a pair of abutments including an abutment 89 and an abutment 91 which are positioned to engage the distal end 26a (FIG. 4) of trigger lock 26 in a manner to be described in greater detail below to prevent actuation of trigger 20 prior to approximation of device 10.

Coupling member 86 which is supported on the proximal end of elongated pusher link 74 includes a flange 104 (FIG. 6). A spring 106 is positioned between a proximal end 15 of outer tube 14a and flange 104 (FIG. 4) to bias pusher link 74 proximally to a retracted, non-fired position. A pair of wings 108 extend radially outwardly from coupling member 86. Wings 108 are dimensioned to slide along channels 111 (FIG. 3) formed along the internal walls of stationary handle 18 to maintain proper alignment of pusher link 74 within stationary handle 18 during firing of device 10.

Referring to FIG. 6, the distal end of pusher link 74 includes a pair of engagement fingers 110 which are dimensioned to lockingly engage with members 220 formed in the proximal end of pusher back 186. Pusher back 186 forms part of shell assembly 31 and will be discussed in greater detail below. Pusher link 74 is preferably formed from a flexible plastic material and includes a plurality of notches 187 which allow the pusher link to bend more easily as it moves through body 14. Pusher link 74

defines a hollow channel 75 for slidably receiving the approximation mechanism. A flat surface or cutout 74a (FIG. 6) formed in pusher link 74 slidably supports screw extensions 34 and 36 which are positioned in juxtaposed alignment. Spacers 77 are positioned within outer tube 14a adjacent cutout 74a to provide additional support for screw extensions 34 and 36 and pusher link 74 to prevent each component from buckling during actuation. An annular channel 74b is formed about pusher link 74 to receive an O-ring seal 74c. Pusher link 74 is slidably positioned within body portion 14 such that O-ring 74c seals the space between pusher link 74 and an internal wall of outer tube 14a. Operation of the firing mechanism of the device will be described in detail below.

Referring again to FIGS. 3-6 and 9, when firing trigger 20 is actuated, i.e., pivoted about pivot member 84, firing link 72 is moved proximally until pivot member 79 engages an abutment surface 307 (FIG. 25A-D) formed on screw stop 306 (FIG. 3). Screw stop 306 is axially fixed to screw 32 in a manner to be described in detail below. Thereafter, firing trigger 20 is pushed distally to advance pusher link 74 distally against the bias of spring 106. Since the distal end of pusher link 74 is connected to pusher back 186, actuation of firing trigger 20 effects advancement of pusher back 186 within shell assembly 31 to eject staples from shell assembly 31 in a manner to be described below.

ANVIL ASSEMBLY

Referring to FIGS. 10-21, anvil assembly 30 includes an anvil head assembly 120 and an anvil center rod assembly 152. Anvil head assembly 120 includes a post 122, an anvil head 124, a backup plate 126, a cutting ring 128, a retaining clip 127 and

an anvil 129. Post 122 is centrally positioned through a bore in anvil head 124. Alternately, post 122 may be integrally formed with anvil head 124. Anvil 129 is supported on anvil head 124 in an outer annular recess 136 and includes a plurality of pockets 140 for receiving and deforming staples. At least one tab 129a extends radially outwardly from anvil 129 and is dimensioned to be received within a cutout 124a formed in anvil head 124. Tab 129a and cutout 124a function to align anvil 129 within annular recess 136. Backup plate 126 includes a central opening 126b which is positioned about post 122 within an inner recess 134 of anvil head 124 between post 122 and annular recess 136. Backup plate 126 includes a raised platform 126a. Cutting ring 128 includes an opening 128a having a configuration substantially the same as platform 126a. Opening 128a is positioned about platform 126a to rotatably fix cutting ring 128a on backup ring 126. Preferably, cutting ring 128 is formed from polyethylene and is fixedly secured to backup plate 126 using, for example, an adhesive. Backup ring 126 is preferably formed from metal and provides support to cutting ring 128 to enhance the cutting of tissue. Alternately other materials of construction may be used to construct plate 126 and ring 128. Cutting ring 128 and backup plate 126 are slidably mounted about post 122. Backup plate 126 includes a pair of inwardly extending tabs 150 which will be described in further detail below. Cutting ring 128 includes tabs 128b which are received within cutouts 124b formed in anvil head 124 to properly align backup ring 126 and cutting ring 128 within anvil head 124.

Anvil center rod assembly 152 includes anvil center rod 154, a plunger 156 and plunger spring 158. A first end of center rod 154 includes a transverse throughbore 160 which is offset from the central longitudinal axis of center rod 154. Post 122 of anvil

head assembly 120 also includes a transverse throughbore 162. A pivot member 164 pivotably secures post 122 to center rod 154 such that anvil head assembly 120 is pivotably mounted to anvil center rod assembly 152. Plunger 156 is slidably positioned in a bore 154b (FIG. 16) formed in the first end of center rod 154. Plunger 156 includes an engagement finger 168 which is offset from the pivot axis of anvil head assembly 120 and biased into engagement with the base 122a of post 122 by plunger spring 158 to urge anvil head assembly 120 to a pivoted position at an angle to center rod 154. In a preferred untilted position, tabs 150 formed on backup plate 126 engage a top surface 154a (FIG. 20) of center rod 154 to prevent anvil head assembly 120 from pivoting about pivot member 164. As device 10 is fired, backup plate 126 and cutting ring 128 are moved deeper into anvil recess 134 of anvil head 124 about post 122 (FIG. 21) by knife 188 (FIG. 6) in a manner to be described in further detail below to move tabs 150 out of engagement with top surface 154a of center rod 154 to permit plunger 156 to pivot anvil head assembly 120 about pivot member 164.

A retainer clip 127 is positioned in a transverse slot 122c formed in post 122 and includes a pair of outwardly biased flexible arms 127a and 127b. Arm 127b includes a recess 127c dimensioned to receive pivot pin 164 (FIG. 17). Prior to firing device 10, arms 127a and 127b are deformed inwardly by backup plate 126 (FIG. 17). After device 10 has been fired and backup plate 126 has been pushed deeper into anvil head 124 by knife 188, flexible arms 127a and 127b spring outwardly to a position in front of backup plate 126. In this position, arms 127a and 127b prevent cutting ring 128 and backup plate 126 from sticking to the knife when anvil assembly 30 is unapproximated. It is

envisioned that a retainer clip may be used in conjunction with non-pivotal anvil assemblies wherein the anvil head post and the anvil center rod are integrally formed.

A second end of center rod 154 includes a bore 170 defined by a plurality of flexible arms 155a. Bore 170 is dimensioned to receive a removable trocar 157. At least one of flexible arms 155, and preferably a plurality of flexible arms 155, e.g., three, include an opening 155a dimensioned to receive a projection 157d formed on removable trocar 157 to releasably secure trocar 157 to center rod 154 (FIG. 13). The distal ends of each of flexible arms 155 include an internal shoulder 155b (FIG. 10) dimensioned to releasably engage anvil retainer 38 in a manner to be discussed in detail below. A plurality of splines 181 are formed about center rod 154 and are dimensioned to be received within grooves 196a (FIG. 6) in shell assembly 31 to align anvil assembly 30 within shell assembly 31 during approximation of the anvil and shell assemblies. Center rod 154 also includes an annular recessed portion 183 to facilitate grasping of anvil assembly 30 by a surgeon with a grasper.

Referring to FIGS. 12 and 13, removable trocar 157 includes a trocar tip 157a, a body portion 157b and a cantilevered arm 157c. A projection 157d is positioned on the free end of cantilevered arm 157c. Arm 157c is deflectable downwardly, i.e., radially inwardly, in the direction indicated by arrow "A" in FIG. 13 to facilitate insertion of body portion 157b into bore 170 of center rod 154. Splines 157e or the like, preferably, are provided on body portion 157b to properly align trocar 157 within bore 170. Arm 157c biases projection 157d outwardly such that when projection 157d passes beneath opening 155a in center rod 154, projection 157d snaps outwardly into opening 155a to releasably secure removable trocar 157 to center rod 154. A tab 157f is positioned on

arm 157c and can be engaged to depress arm 157c and projection 157d to remove projection 157d from an opening 155a of arm 155 to facilitate removal of trocar 157 from center rod 154. Trocar tip 157a includes a throughbore 157g dimensioned to receive a suture (not shown) to facilitate locating and removal of trocar 157 and/or anvil assembly 30 within and from the human body. Although illustrated as having a sharpened tip, other trocar tip configurations are envisioned, e.g., a blunt tip.

SHELL ASSEMBLY

Referring to FIG. 6, shell assembly 31 includes a shell 182, a pusher back 186, a cylindrical knife 188, and a staple guide 192. Shell 182 includes an outer housing portion 194 and an inner guide portion 196 having grooves 196a for mating with splines 181 on anvil center rod 154 (FIG. 10). Outer housing portion 194 defines a throughbore 198 having a distal cylindrical section 200, a central conical section 202 and a proximal smaller diameter cylindrical section 204. A plurality of openings 206 are formed in conical section 202. Openings 206 are dimensioned to permit fluid and tissue passage during operation of the device. A pair of diametrically opposed flexible engagement members 207 are formed on proximal cylindrical section 204 of shell 182. Engagement members 207 are positioned to be received in openings 207a formed on the distal end of outer tube 14a to secure shell 182 to elongated body 14. A pair of openings 211 formed in the proximal end of outer tube 14a are dimensioned to receive protrusions (not shown) formed on the internal wall of stationary handle 18 to facilitate attachment of tube 14a to handle portion 12.

Pusher back 186 includes a central throughbore 208 which is slidably positioned about inner guide portion 196 of shell 182. Pusher back 186 includes a distal cylindrical section 210 which is slidably positioned within distal cylindrical section 200 of shell 182, a central conical section 212 and a proximal smaller diameter cylindrical section 214. The proximal end of pusher back 186 includes members 220 which are configured to lockingly engage with resilient fingers 110 of pusher link 74 to fasten pusher link 74 to pusher back 186 such that a distal face of pusher link 74 abuts a proximal face of pusher back 186.

The distal end of pusher back 186 includes a pusher 190. Pusher 190 includes a multiplicity of distally extending fingers 226 dimensioned to be slidably received within slots 228 formed in staple guide 192 to eject staples 230 therefrom. Cylindrical knife 188 is frictionally retained within the central throughbore of pusher back 186 to fixedly secure knife 188 in relation to pusher 190. Alternately, knife 188 may be retained within pusher back 186 using adhesives, crimping, pins, etc. The distal end of knife 188 includes a circular cutting edge 234.

In operation, when pusher link 74 is advanced distally in response to actuation of firing trigger 20, as will be described below, pusher back 186 is advanced distally within shell 182. Advancement of pusher back 186 advances fingers 226 through slots 228 of staple guide 192 to advance staples 230 positioned within slots 228 and eject staples 230 from staple guide 192 into staple deforming pockets 140 of anvil 129. Since knife 188 is secured to pusher back 186, knife 188 is also advanced distally to core tissue as will be described in more detail below.

A rigid bushing 209 is supported in the proximal end of inner guide portion 196 of shell 182. Bushing 209 defines a throughbore dimensioned to slidably receive anvil retainer 38 and center rod 154 of anvil assembly 30 (FIG. 14). Bushing 209 provides lateral support for flexible arms 155 of center rod 154 when the anvil assembly 30 has been approximated to prevent disengagement of anvil assembly 30 from anvil retainer 38. In the unapproximated position, flexible arms 155 of center rod 154 are positioned externally of bushing 209 to permit removal of anvil assembly 30 from retainer 38.

CAM ADJUSTMENT MECHANISM

Referring to FIGS. 8 and 22-28, a cam adjustment member 400 is secured by set screw 312 onto a sidewall 306a of screw stop 306 within a recess 306b formed in sidewall 306a. Cam adjustment member 400 includes a circular disc 402 having a throughbore 404. Throughbore 404 is eccentrically formed through disc 402 and is dimensioned to receive set screw 312. A smaller notch or hole 406 is also formed in disc 402 and is dimensioned to receive the tip of an adjustment tool (not shown). Recess 306b (FIG. 22) includes a forward abutment shoulder or surface 306c and a rear abutment surface 306d and is dimensioned to receive disc 402 such that the outer edge of disc 402 abuts forward and rear abutment surfaces 306c and 306d.

Set screw 312 extends through disc 402 and screw stop 306 and is received in a threaded bore 32a (FIG. 6) in screw 32 to secure screw stop 306 in an axially fixed position on screw 32. Cam adjustment member 400 functions to adjust the axial position of screw stop 306 on screw 32. More specifically, set screw 312 can be loosened to allow disc 402 to rotate within recess 306b of screw stop 306. Since disc 402 is eccentrically mounted about screw 32 and engages forward and rear abutment

surfaces 306c and 306d of recess 306b, rotation of disc 402 about fixed set screw 312 will urge screw stop 306 axially along screw 32 to adjust the axial position of screw stop 306 on screw 32. For example, when disc 402 is rotated in a clockwise direction (as viewed in FIG. 28) as indicated by arrow "B", screw stop 306 will be moved axially in relation to screw 32 in the direction indicated by arrow "C" in response to engagement between the outer edge of disc 402 and rear shoulder 306d of recess 306b.

Conversely, when disc 402 is rotated in a counter-clockwise direction (as viewed in FIG. 27), as indicated by arrow "D", screw stop 306 will be moved axially in relation to screw 32 in the direction indicated by arrow "E" in response to engagement between the outer edge of disc 402 and forward shoulder 306c of recess 306b.

When stapling device 10 is in a fully approximated position, i.e., anvil assembly 30 and shell assembly 31 are brought into juxtaposed alignment to define a tissue receiving clearance (FIG. 46), screw stop 306 abuts against body portion 42 of the rotatable sleeve 33, i.e., sleeve 33 functions as a stop for the approximation mechanism. See FIG. 48. In this position, anvil assembly 30 and shell assembly 31 are spaced slightly to define a tissue receiving clearance. By providing cam adjustment member 400, the tissue receiving clearance can be selectively adjusted to be within a desired range by adjusting the position of screw stop 306 on screw 32. Preferably, cam adjustment member 400 permits adjustment of the tissue receiving clearance of ± 0.045 inches, although greater or lesser adjustment capabilities are also envisioned. Typically, adjustments to the tissue receiving clearance will be made by the device manufacturer. Alternately, a hole or opening may be provided in handle portion 12

(FIG. 1) to provide direct access to adjustment member 400 to allow for on-site adjustment of the tissue receiving clearance by a surgeon or other medical professional.

INDICATOR MECHANISM

Referring to FIGS. 3-5 and 29, the indicator mechanism includes bulbous indicator 24, lens cover 24a and slide member 500. Indicator 24 is pivotally supported about a pivot member 502 which is preferably formed monolithically with handle sections 18a and 18b. Lens cover 24a is positioned above indicator 24 and is preferably formed of magnification material to facilitate easy visualization of indicator 24. Slide member 500 includes a body portion 504 having an elongated slot 506 formed therein, a distal abutment member or upturned lip portion 508, and a proximal extension 510. Slide member 500 is slidably positioned between handle sections 18a and 18b. Proximal extension 510 is slidably supported within stationary handle 18 by support structure 516 (FIG. 5) which may be integrally formed with handle sections 18a and 18b. A biasing member, preferably a coil spring 512, is positioned in compression about proximal extension 510 between support structure 516 and body portion 504 of slide member 500 to urge slide member 500 distally within stationary handle 18. Indicator 24 includes a pair of downwardly extending projections 518 and 520 (FIG. 32). Upturned lip portion 508 of slide member 500 is positioned between projections 518 and 520 and is positioned to engage projections 518 and 520 as it moves within stationary handle 18. In the unfired position of device 10, biasing member 512 urges slide member 500 distally to move lip portion 508 into engagement with projection 518 to pivot indicator to a first position, which provides indication to a surgeon that the device has not been approximated and is not in a fire-ready condition.

As discussed above, screw stop 306 is fixedly attached to screw 32 (FIG. 33). Screw stop 306 includes a first abutment or engagement member 522 which is positioned to travel through slot 506 of slide member 500 and engage the proximal end 506a (FIG. 29) of slot 506 during approximation of the device. When engagement member 522 abuts proximal end 506a of slot 506, further approximation of device 10 moves slide plate 500 proximally within stationary handle 18 against the bias of spring 512 such that upturned lip 508 of slide member 500 engages projection 520 of indicator 24. Engagement between projection 520 and lip 508 causes indicator 24 to pivot about pivot member 502 to a second position. In the second position, indicator 24 provides indication to a surgeon that the device has been approximated and is now in a fire-ready position. See FIG. 48.

FIRE-LOCKOUT MECHANISM

Referring to FIGS. 3-5, and 30, the firing-lockout mechanism includes trigger lock 26 and a lockout member 530. Trigger lock 26 is pivotally supported within bores 532 (FIG. 3) in handle sections 18a and 18b about pivot member 534. Pivot member 534 is preferably T-shaped and frictionally engages the inner wall of bores 532 to prevent free rotation of trigger lock 26. Alternately, other pivot member configurations are envisioned, e.g., circular, square, etc. Tip 26a of trigger lock 26 is positioned between abutments 89 and 91 on body portion 76 of firing trigger 20 to prevent actuation of trigger 20 when trigger lock 26 is in the locked position. Trigger lock 26 also includes a proximal extension 26b which will be discussed in further detail below.

Lockout member 530 includes a body portion 536, a proximal extension 538, a pair of front legs 540a, a pair of rear legs 540b, and an abutment member or

downturned lip portion 542. Lockout member 530 is slidably positioned between first and second stops 544 and 546 (FIG. 5) formed on an internal wall of handle sections 18a and 18b. Stop 544 is positioned to engage rear legs 540b and stop 546 is positioned to engage front legs 540a. It is also envisioned that a single abutment member may be substituted for each pair of legs. A biasing member, preferably a coil spring 549, is positioned between stop 544 and body 536 about proximal extension 538 to urge lockout 530 to its distal-most position with legs 540 abutting stop 546. In this position, extension 26b of trigger lock 26 is positioned beneath lip portion 542 of lockout member 530 to prevent pivotal movement of trigger lock 26 about pivot member 534, and thus prevent firing of stapling device 10.

As discussed above, screw stop 306 is secured to screw 32. A second engagement member or members 548 extend downwardly from screw stop 306 (FIG. 23). When stapling device 10 is approximated and screw 32 is moved proximally within stationary handle 18, engagement member 548 abuts distal legs 540a (FIG. 47) of lockout member 530 to move lockout member 530 proximally against the bias of spring member 549 to a position in which lip portion 542 is spaced proximally of extension 26b of trigger lock 26. In this position of lockout member 530, trigger lock 26 can be pivoted about pivot member 534 to permit firing of stapling device 10.

TACTILE INDICATOR MECHANISM

Referring to FIGS. 3, 5, 9 and 9A, a tactile indicator mechanism provided in stationary handle 18 includes an abutment member 580 which is slidably positioned in a vertical slot 582 defined within handle sections 18a and 18b. Abutment member 580 includes a protuberance 580a and a guide rib 580b. Protuberance 580a is dimensioned

to be received within one of two detents 582a and 582b formed along a wall of slot 582. Abutment member 580 is movable from a retracted (downward) position, wherein protuberance 580a is positioned within detent 582a, to an extended (upward) position, wherein protuberance 580a is positioned within detent 582b. Engagement between protuberance 580a and detents 582a and 582b retains abutment member 580 in its respective upward or downward position.

Prior to firing of stapling device 10, abutment member 580 is located in the retracted (downward) position. When device 10 is fired, an extension 590 (FIG. 3) of firing link 72 engages abutment member 580 and moves abutment member 580 from its retracted to its extended position. In the extended position, abutment member 580 extends into channel 111 of stationary handle 18.

Screw stop 306 includes a pair of wings 584 which are slidably positioned in channel 111 of stationary handle 18. After stapling device 10 has been fired, abutment member 580 is positioned within channel 111. During unapproximation of anvil assembly 30 and cartridge assembly 31, a wing 584 of screw stop 306 will engage abutment member 580 and urge abutment member 580 back to its retracted (downward) position. Engagement between abutment member 580 and wing 584 of screw stop 306 provides a tactile and/or an audible indication to the surgeon that the anvil and cartridge assemblies 30 and 31 have been unapproximated a predetermined amount. Preferably, abutment member 580 is positioned to engage wing 584 of screw stop 306 at the point when the anvil and cartridge assemblies have been separated a distance sufficient to allow the anvil head assembly to tilt. Thus, engagement between abutment member 580 and wing 584 of screw stop 306 provides a tactile and/or audible

indication to the surgeon that the anvil head assembly 120 has tilted and stapling device 10 can be removed from a patient.

OPERATION

Operation of surgical stapling device 10 will now be described in detail with reference to FIGS. 31-61.

FIGS. 31-35 illustrate surgical stapling device 10 in the unapproximated or open position prior to attachment of anvil assembly 30 to anvil retainer 38. In this position, biasing member 106 (FIG. 33) is engaged with coupling 86 to urge pusher link 74 to its proximal-most position in which coupling 86 abuts screw-stop 306. Biasing member 512 is engaged with slide member 500 of the indicator mechanism to position slide member 500 in engagement with projection 518 of indicator 24 to pivot indicator 24 in a clockwise direction, as viewed in FIG. 33. Biasing member 549 is engaged with body 536 of lockout member 530 to urge lockout member 530 to its distal-most position, wherein lip portion 542 of lockout member 530 is positioned above extension 26b of trigger lock 26 to prevent movement of trigger lock 26 to the unlocked position. Biasing member 82a is also engaged with pivot member 79 (FIG. 32) to urge pivot member 79 to the base of vertical slot 82 and tactile indicator 580 is in the retracted or downward position with protrusion 580a positioned with detent 582a.

FIGS. 36-44 illustrate surgical stapling device 10 with anvil assembly 30 attached to anvil retainer 38 and the anvil assembly 30 in the unapproximated or open position. Referring to FIGS. 37 and 38, during attachment of anvil assembly 30 to anvil retainer 38, anvil retainer 38 is positioned within bore 170 of center rod 154 of anvil assembly 30. Flexible arms 155 deflect outwardly to accommodate center rod 154. Center rod

154 is advanced onto anvil retainer 38 in the direction indicated by arrow "K" in FIG. 37 until internal shoulder 155b of flexible arms 155 passes over annular protrusion 177 formed on anvil retainer 38. At this point, resilient legs 155 releasably engage the anvil retainer. The position of the remaining components of stapling device are not affected by attachment of anvil assembly 30 to anvil retainer 38 and remain as described above and shown in FIGS. 31-35.

FIGS. 45-50 illustrate surgical stapling device 10 during movement of anvil assembly 30 and cartridge assembly 31 to the approximated or closed position. As discussed above, anvil assembly 30 is moved to the approximated or closed position by rotating rotation knob 22 in the direction indicated by arrow "L" in FIG. 45. Rotation of knob 22 causes cylindrical sleeve 33 to rotate to move pin 52 along helical channel 50 of screw 32. See FIG. 48. Movement of pin 52 along helical channel 50 causes screw 32 to translate proximally within sleeve 33. The distal end of screw 32 is connected to screw extensions 34 and 36 which are fastened at their distal ends to anvil retainer 38 (FIG. 46). As such, retraction of screw 32 within sleeve 33 is translated into proximal movement of anvil retainer 38 and anvil assembly 30. It is noted that when anvil assembly 30 is approximated, flexible legs 155 of center rod 154 are drawn into bushing 209 to lock legs 155 onto anvil retainer 38.

Referring to FIGS. 47-49, screw stop 306 is axially fixed to screw 32 by set screw 312. Thus, as screw 32 is retracted within sleeve 33, screw stop 306 is moved from a distal position within stationary handle 18 to a proximal position. As screw stop 306 moves from the distal position to the proximal position, first engagement member 522 formed on screw stop 306 abuts proximal end 506a of slot 506 of slide plate 500 (FIG.

29) and moves slide plate 500 proximally against the bias of spring 512. As slide plate 500 moves proximally, lip 508 (FIG. 48) of slide member 500 engages projection 520 of indicator 24 to pivot indicator 24 in a counter-clockwise direction as viewed in FIG. 48.

Screw stop 306 also includes a second engagement member 548 (FIG. 47). As screw stop 306 is moved from the distal position to the proximal position during approximation of anvil assembly 30, second engagement member 548 engages distal legs 540a of lockout member 530 to move lockout member 530 proximally to a position in which lip portion 542 is spaced proximally of extension 26b of trigger lock 26. In this position, trigger lock 26 can be pivoted to an unlocked position to permit firing of stapling device 10.

Movement of screw stop 306 to its proximal-most position within stationary handle 18 positions abutment surface 307 of screw stop 306 in position to engage pivot member 79 of firing link 72. Abutment surface 307 comprises a substantially concave surface which is positioned to partially capture and act as a backstop for pivot 79 during firing of the stapling device.

FIGS. 51-56 illustrate surgical stapling device 10 during the firing stroke of firing trigger 20. As trigger 20 is compressed towards stationary handle 18 in the direction indicated by arrow "M" in Fig. 52, pivot member 79 engages abutment surface 307 on screw stop 306 and firing trigger 20 is pushed distally. As discussed above, the distal end of firing trigger 22 is connected through coupling member 86 to the proximal end of pusher link 74. Accordingly, as firing trigger 20 is moved distally, pusher link 74 is moved distally in the direction indicated by arrow "N" in FIG. 52 to effect advancement

of pusher back 186 within shell assembly 31 (FIG. 52). Fingers 190 of pusher back 186 engage and eject staples 230 from staple guide 192.

Cylindrical knife 188 is moved concurrently with pusher back 186 such that knife 188 moves into engagement with cutting ring 128 and backup plate 126. As discussed above, cutting ring 128 is preferably formed from polyethylene and backup plate 126 is preferably formed from metal. When knife 188 engages cutting ring 128, it cuts into cutting ring 128 and pushes backup plate 126 deeper into anvil head 124 to move tabs 150 (FIG. 56) from engagement with top surface 154a of center rod 154 (FIG. 56). Anvil head 124 is now free to pivot about member 164 and is urged to do so by plunger 156. It is noted that because the anvil assembly is in juxtaposed alignment with shell assembly 31, the anvil head 14 will not pivot fully until the anvil and shell assemblies have been unapproximated a distance sufficient to allow the anvil head to fully pivot. When backup plate 126 moves into anvil head 124, flexible arms 127a and 127b of retainer clip 127 (FIG. 55) spring outwardly to a position in front of backup plate 126 blocking movement of backup plate 126 out of anvil head 124. As discussed above, arms 127a and 127b prevent backup plate 126 from sticking to knife 188 when anvil assembly 30 is returned to the unapproximated position.

Referring to FIGS. 53 and 54, as trigger 20 is actuated, i.e., compressed towards stationary handle 18, extension 590 of firing link 72 is pivoted towards and engages abutment member 580 to move abutment member 580 from its retracted to its extended position. In its extended position, abutment member obstructs channel 111 of stationary handle 18.

Referring to FIGS. 57-60, during unapproximation of stapling device 10 after device 10 has been fired, wing 584 of screw stop 306 engages tactile indicator 580 (FIG. 58) at the point of unapproximation at which anvil head 124 is able to pivot to the tilted reduced profile position. Contact between wing 584 and tactile indicator 580 provides a tactile and/or audible indication that anvil head 124 has tilted. If additional force is provided to approximation knob 22, wing 584 of screw stop 306 will force tactile indicator to the retracted position to allow stapling device 10 to move to the fully open position. In this position, flexible arms 155 are positioned distally of bushing 209 and anvil assembly 30 can be disengaged from anvil retainer 28.

It will be understood that various modifications may be made to the embodiments disclosed herein. Therefore, the above description should not be construed as limiting, but merely as exemplifications of preferred embodiments. Those skilled in the art will envision other modifications within the scope and spirit of the claims appended hereto. For example, although the description refers exclusively to staples, it is envisioned that staples may include different types of tissue fasteners including two-part fasteners. In a stapling device for applying two-part fastener, the anvil assembly of the stapling device would support one part of each two-part fastener.

What Is Claimed Is:

1. A surgical stapling device comprising:
a handle assembly including a firing trigger;
a body portion extending distally from the handle assembly;
a head portion including an anvil assembly and a shell assembly, the anvil assembly being movable in relation to the shell assembly between spaced and approximated positions; and
an indicator positioned on the handle assembly and having a bulbous shape, the indicator being movable from a first position to a second position in response to movement of the anvil assembly and cartridge assembly to the approximated position to provide a visual indication to a surgeon that the head portion is in the approximated position.
2. A surgical stapling device according to Claim 1, further including a lens positioned to at least partially cover the indicator, the lens being formed from a magnification material.
3. A surgical stapling device according to any of the preceding claims, further including an approximation mechanism positioned within the handle assembly and extending at least partially through the body portion, the approximation mechanism having a distal end adapted to engage the anvil assembly, the approximation mechanism being movable within the device to move the anvil assembly between the spaced position and the approximated position in relation to the shell assembly.

4. A surgical stapling device according to Claim 3, wherein the approximation mechanism is operably associated with the indicator such that movement of the approximation mechanism effects movement of the indicator.

5. A surgical stapling device according to any of the preceding claims, further including a slide member operably associated with the indicator and movable within the handle assembly, the slide member being movable from an advanced position to a retracted position to move the indicator from the first position to the second position.

6. A surgical stapling device according to Claim 5, wherein the slide member is urged to its advanced position by a biasing member.

7. A surgical stapling device according to Claim 5 or 6, wherein the approximation mechanism includes a screw member which is linearly movable within the handle assembly, the screw member having an abutment member supported thereon, the abutment member being movable with the screw member into engagement with the slide member to move the slide member from its advanced position to its retracted position to move the indicator from its first position to its second position.

8. A surgical stapling device according to Claim 5, 6 or 7, wherein the slide member includes an elongated slot formed therein, the abutment member being movable within the elongated slot into engagement with a proximal end of the slot to move the slide member from its advanced position to its retracted position.

9. A surgical stapling device according to any of the preceding claims, wherein the indicator is pivotally supported within the handle assembly.

10. A surgical stapling device according to any one of claims 5 through 9, wherein the indicator includes a pair of projections and the slide member includes an

upturned lip portion positioned between the pair of projections, the slide member upturned lip portion being movable into engagement with one of the pair of projections to move the indicator from its first position to its second position and movable into engagement with the other of the pair of projections to move the indicator from its second position to its first position.

11. A surgical stapling device according to any of the preceding claims, wherein the indicator is pivotally supported within the handle assembly.

12. A surgical stapling device according to any of the preceding claims, wherein the shell assembly supports an annular array of staples.

13. An anvil assembly comprising:

- an anvil head having a post, an anvil including a plurality of staple forming pockets and a cutting ring slidably positioned about the post from a first position to a second position;
- an anvil center rod extending from the post of the anvil head; and
- a retainer clip positioned on the post of the anvil head, the retainer clip having at least one resilient arm which in its unbiased condition extends outwardly of the post;

wherein in its first position, the cutting ring is at least partially engaged with the resilient arm to urge the resilient arm out of a path of travel of the cutting ring and in its second position, the resilient arm of the retainer projects into the path of travel of the cutting ring to prevent movement of the cutting ring from its second position back to its first position.

14. An anvil assembly according to Claim 13, wherein the post of the anvil head includes a transverse slot formed therein, and the clip retainer is positioned within the transverse slot.

15. An anvil assembly according to Claim 14, wherein in its first position the cutting ring is positioned about the transverse slot of the post and in engagement with the resilient arm to urge the resilient arm of the retainer clip into the transverse slot.

16. An anvil assembly according to Claim 13, wherein the retainer clip includes a pair of resilient arms.

17. An anvil assembly according to Claim 15, wherein the retainer clip includes a pair of resilient arms, one arm extending from each side of the transverse slot when the cutting ring is in its second position.

18. An anvil assembly according to Claim 13, wherein the anvil head is pivotally attached to the anvil center rod by a pivot member.

19. An anvil assembly according to Claim 18, wherein the retainer clip includes a recess for receiving the pivot member to secure the retainer clip to the post.

20. An anvil assembly according to Claim 18, wherein the cutting ring includes a backup plate secured thereto, the backup plate having at least one tab positioned to prevent pivotal movement of the anvil head in relation to anvil center rod when the cutting ring is in its first position.

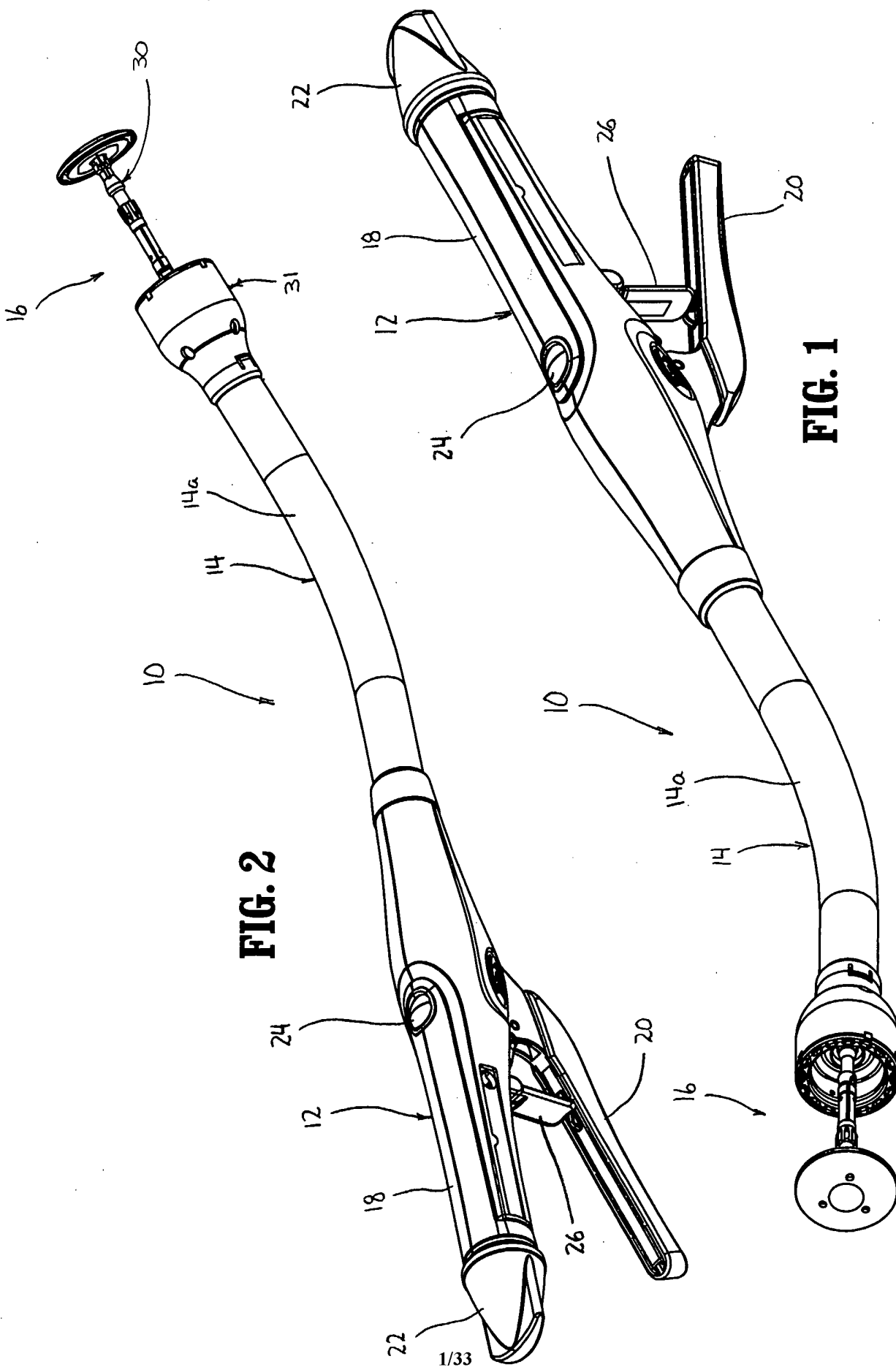
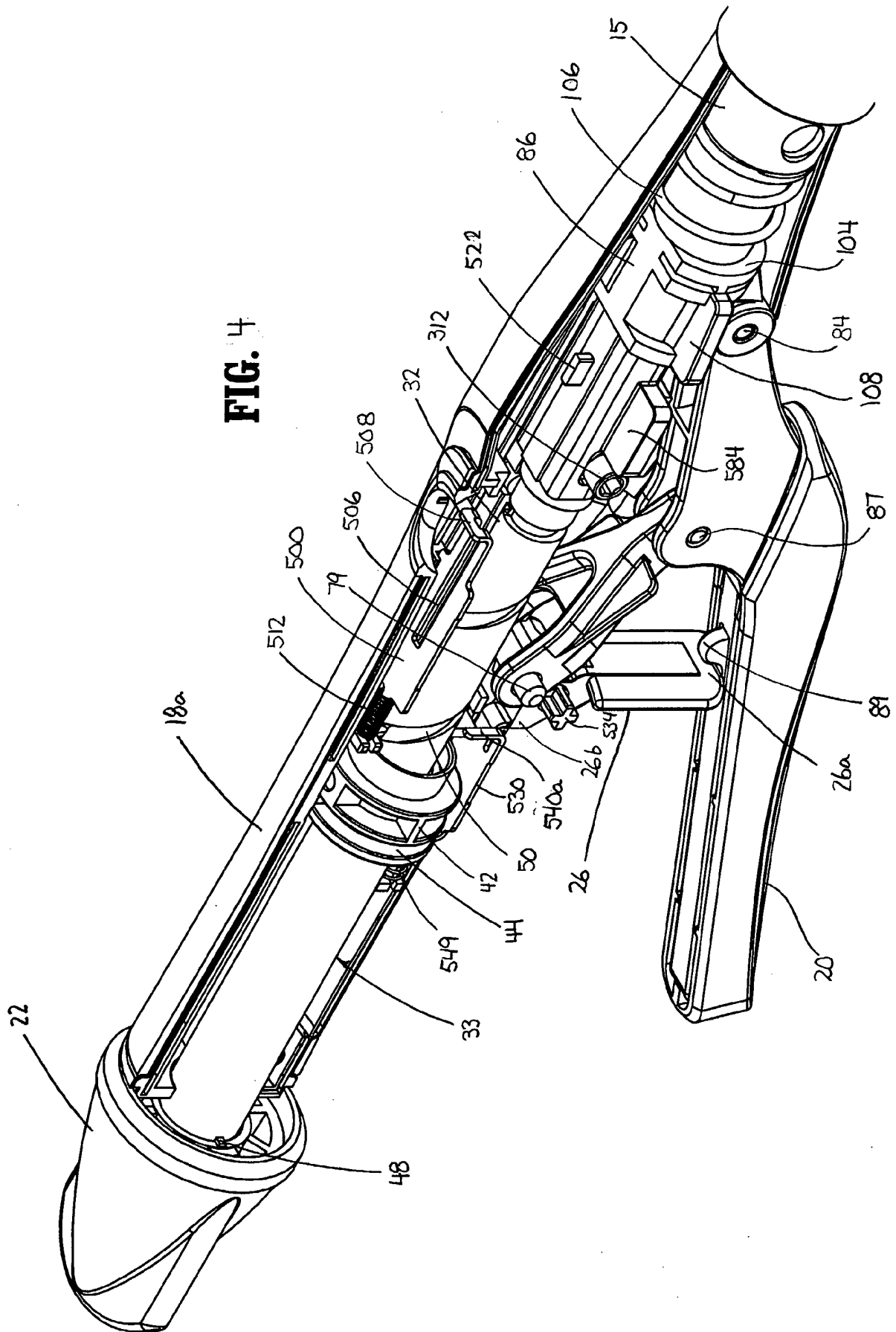

FIG. 2

FIG. 1



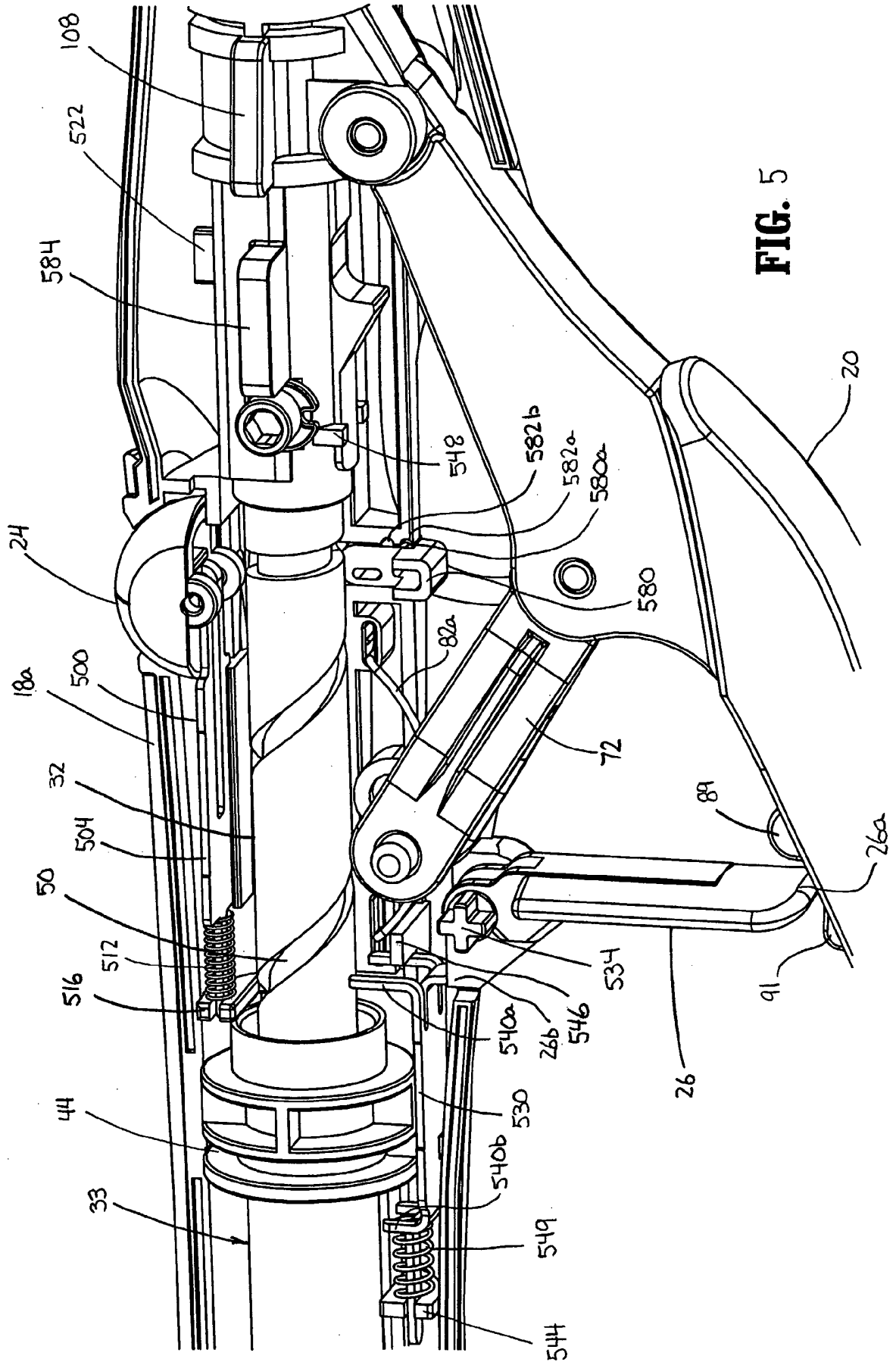

FIG. 5

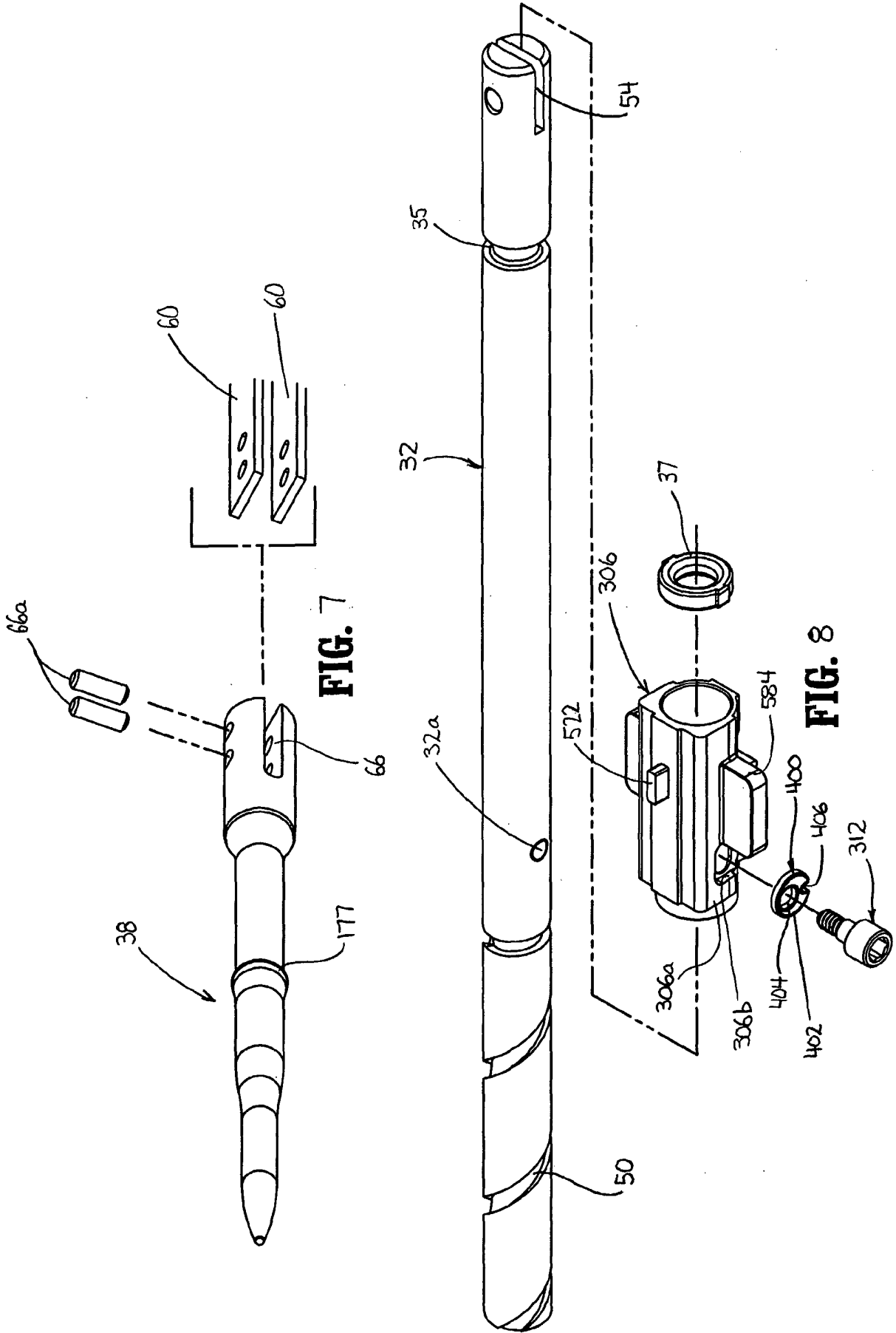

FIG. 7

FIG. 8

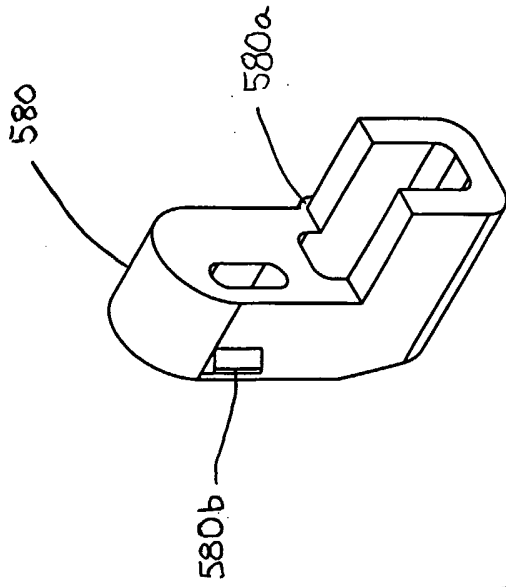

FIG. 9A

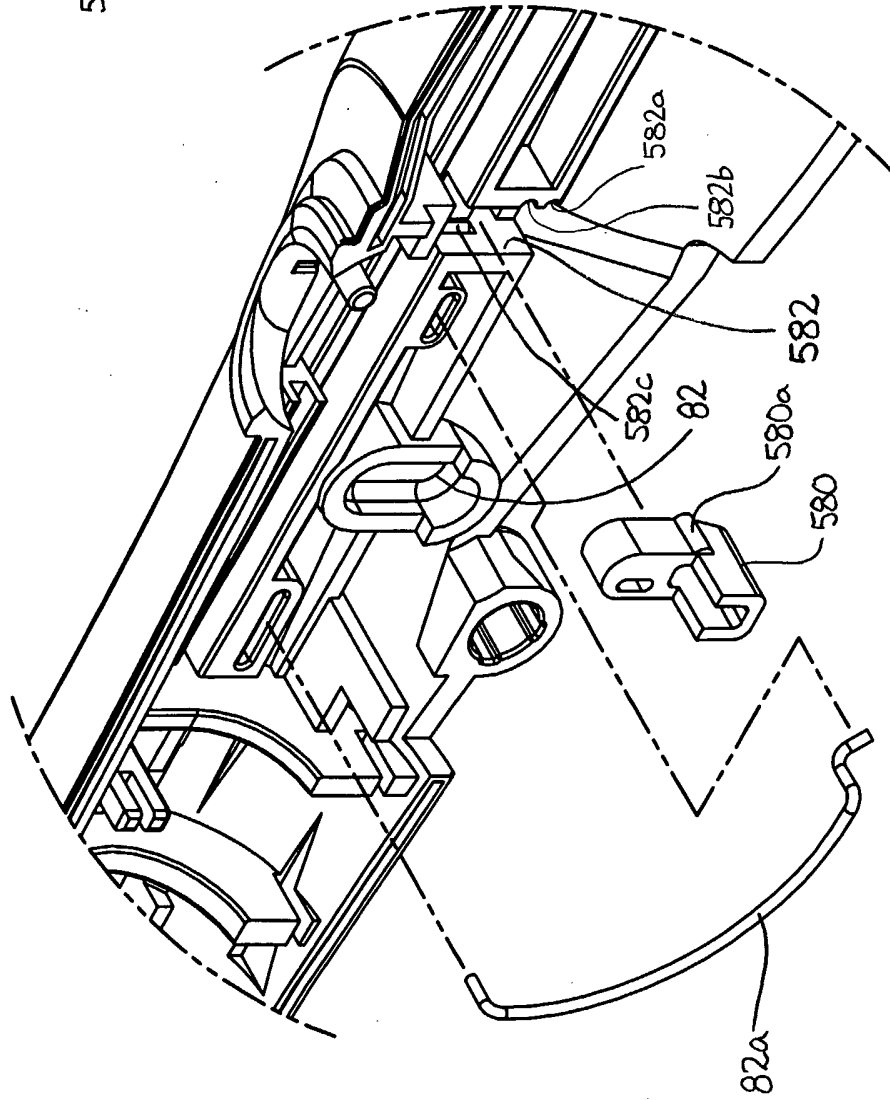
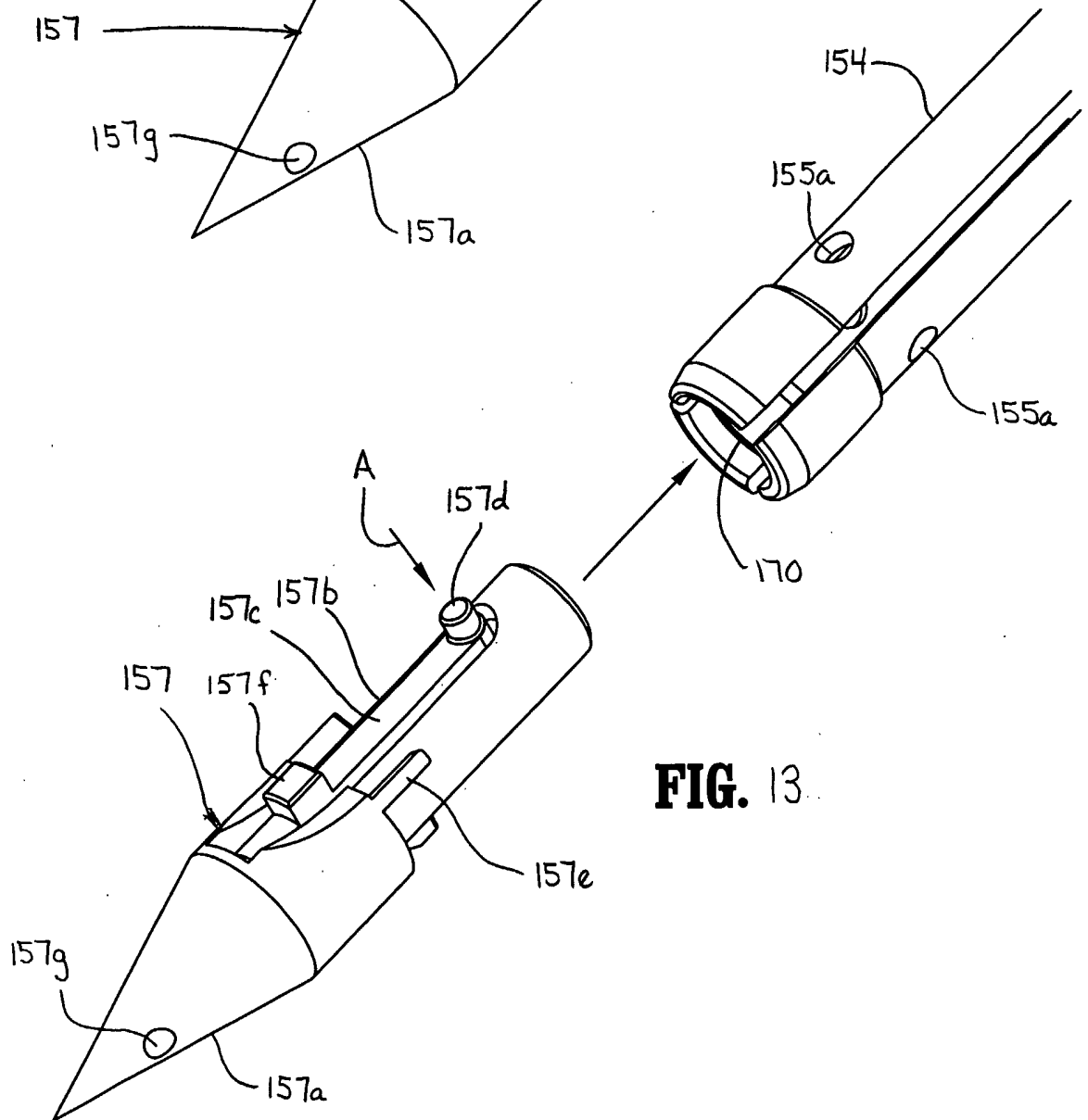
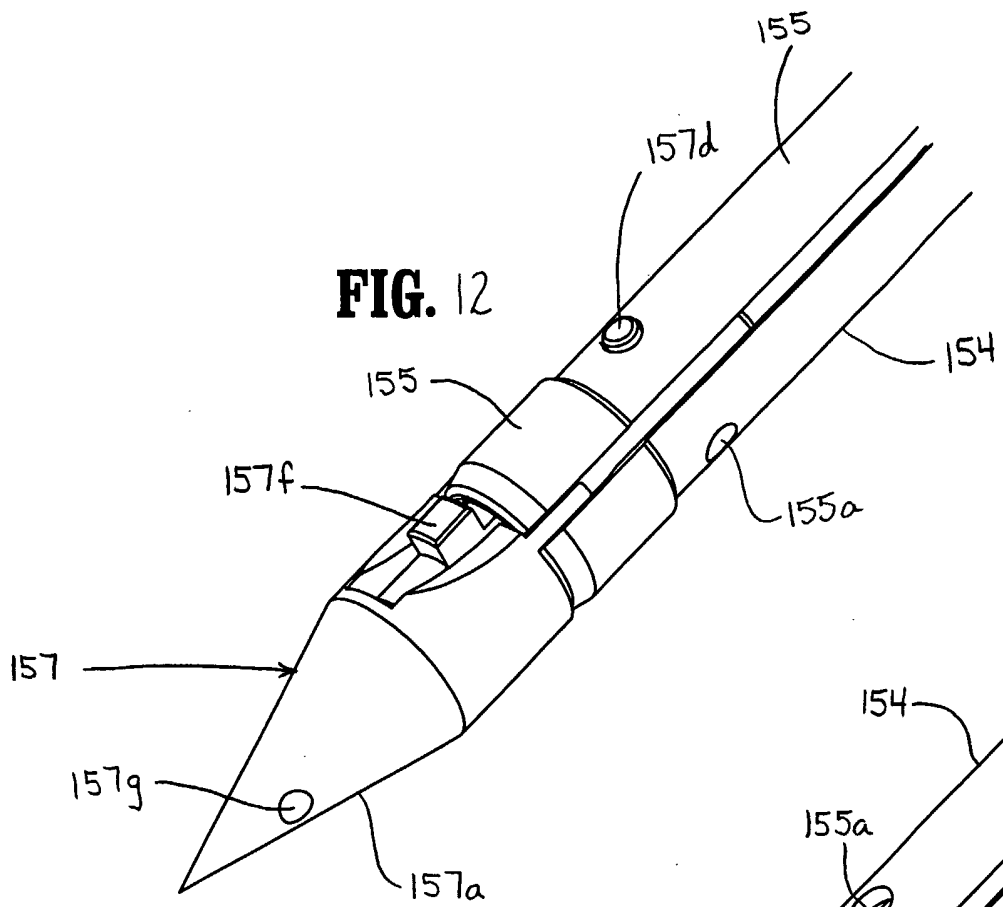
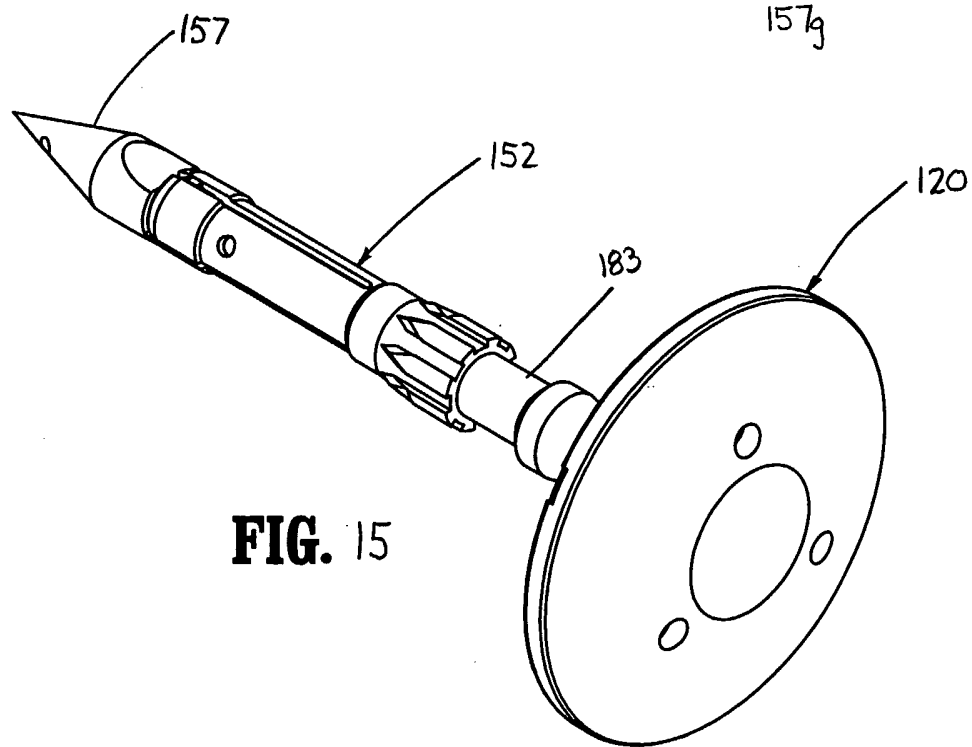
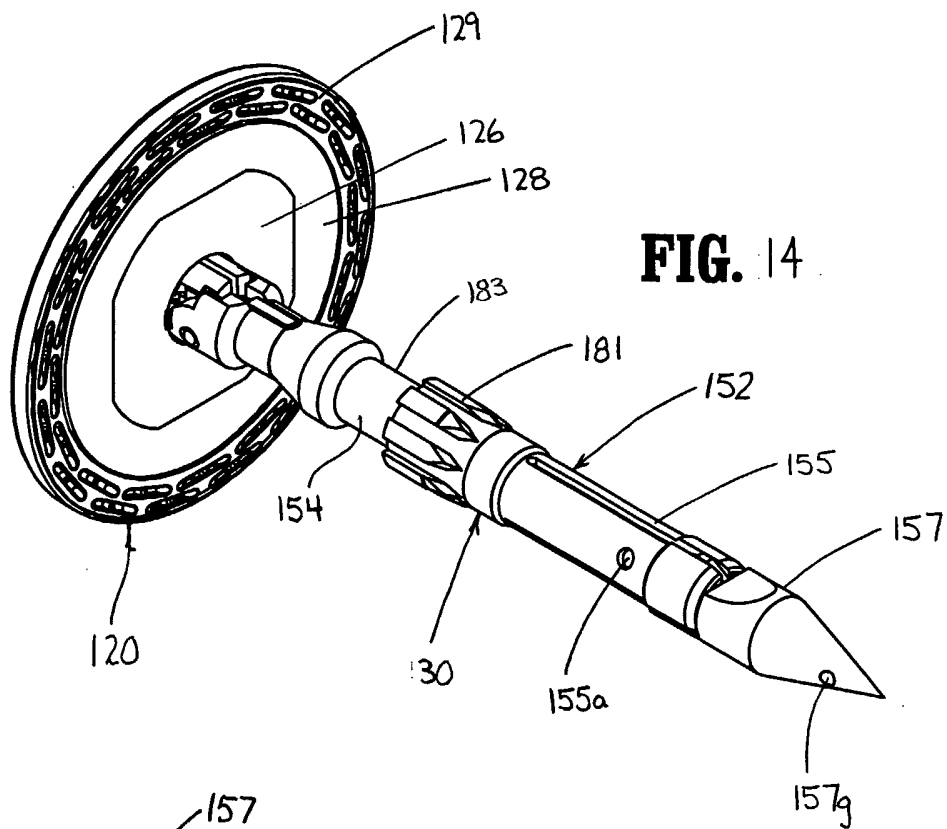

FIG. 9





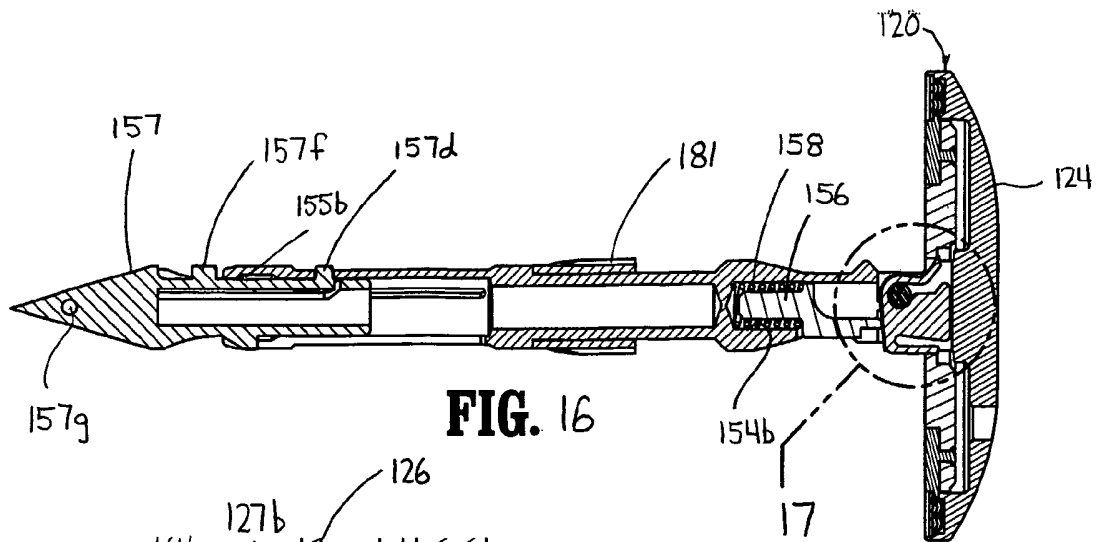

FIG. 16

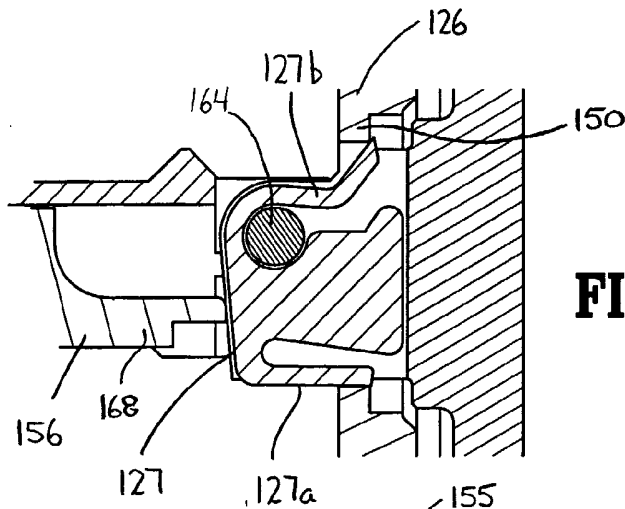

FIG. 17

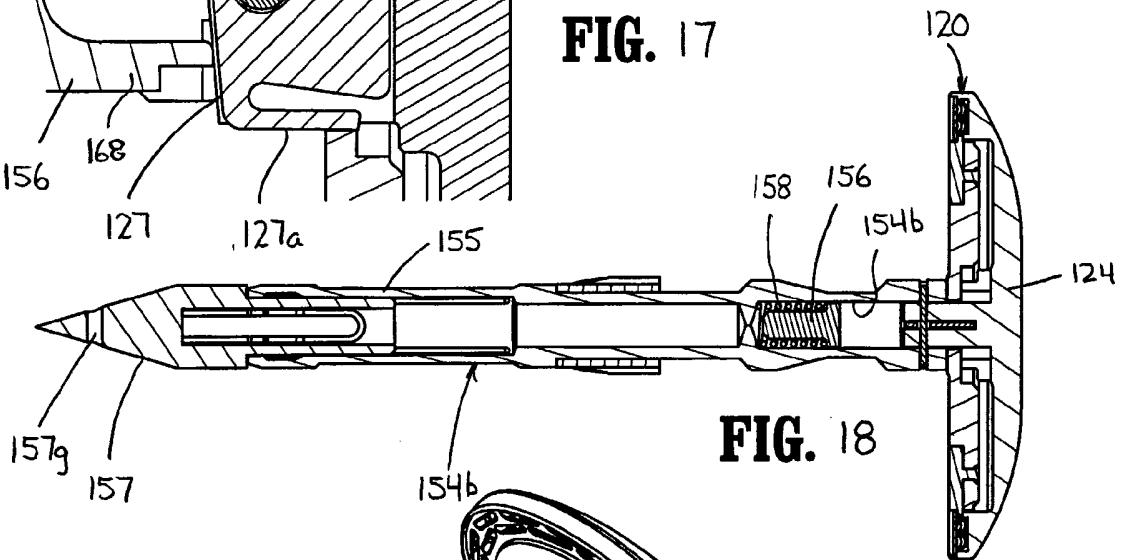

FIG. 18

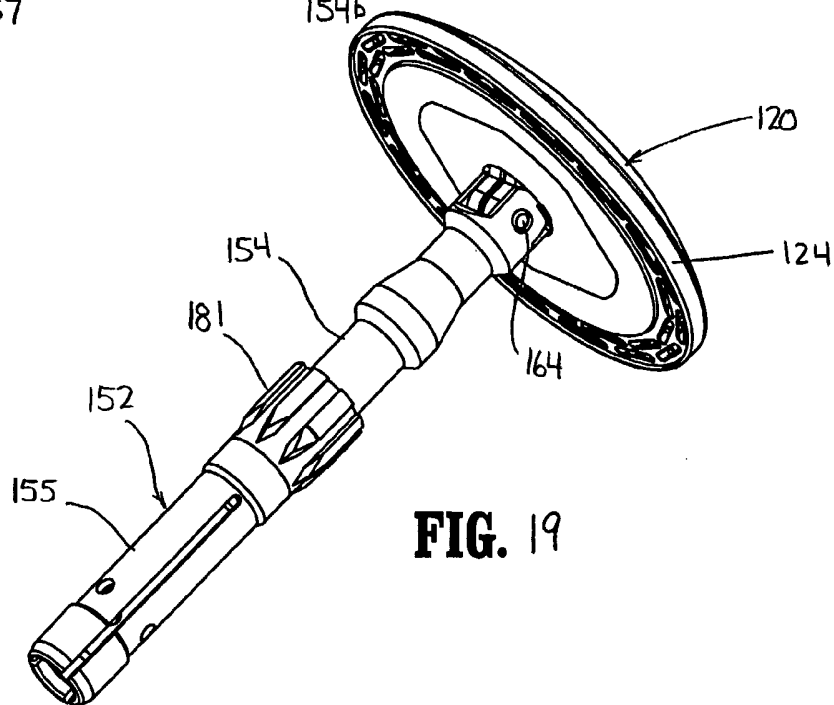

FIG. 19

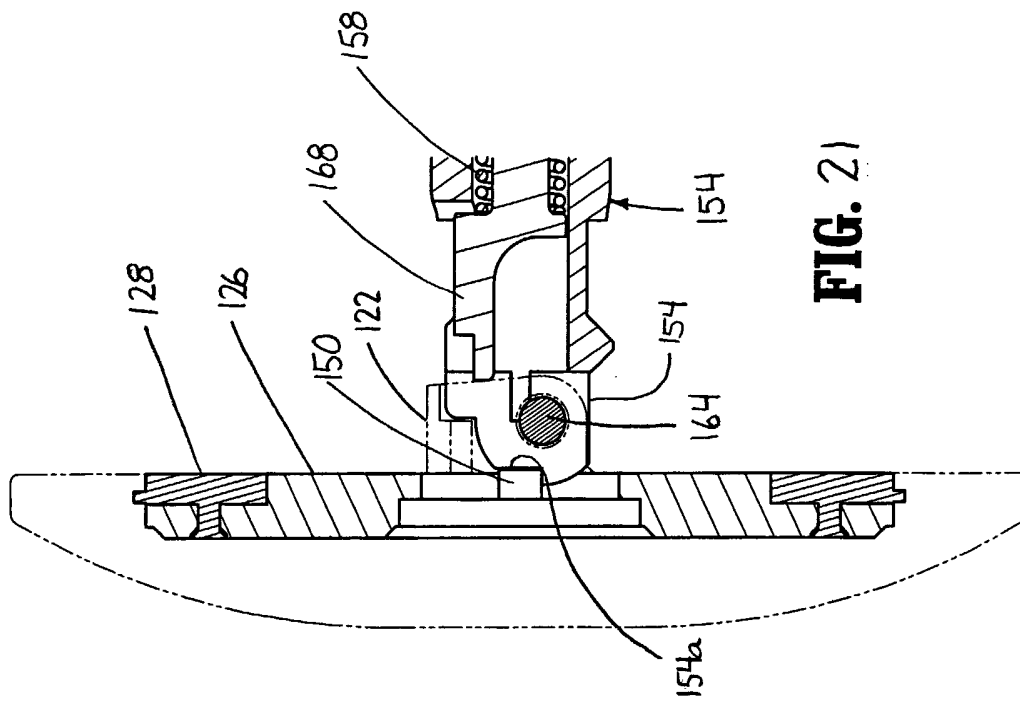

FIG. 21

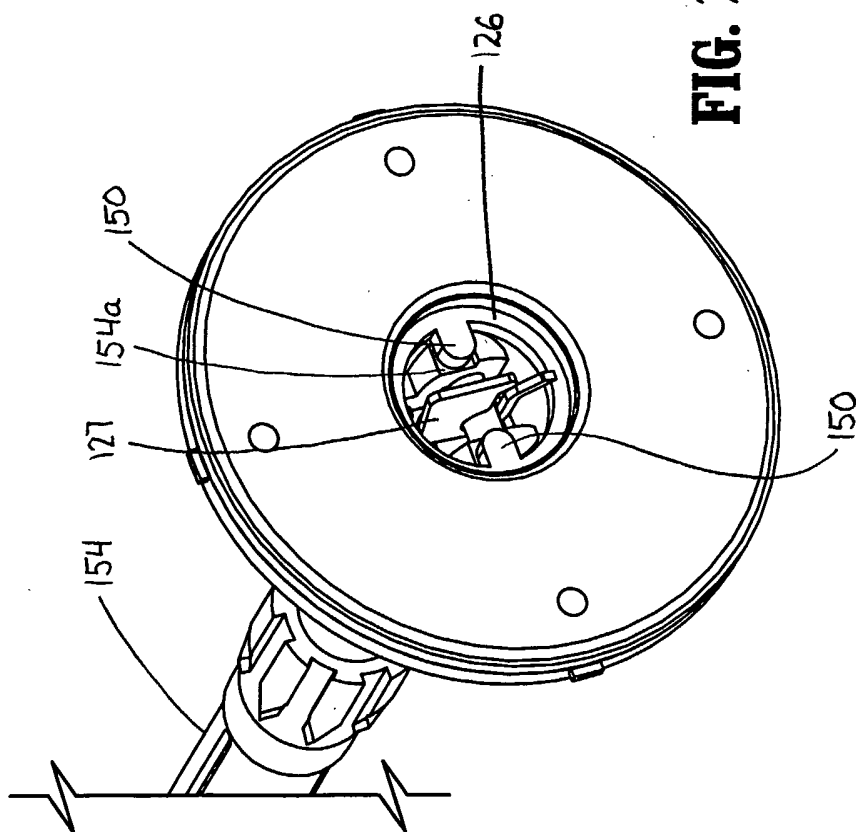

FIG. 20

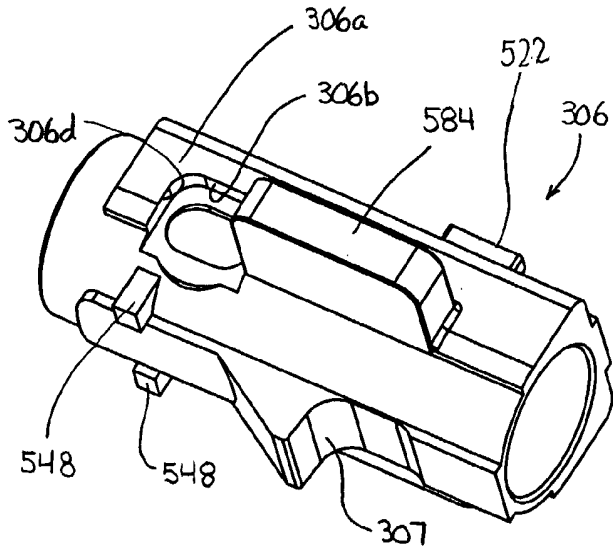

FIG. 22

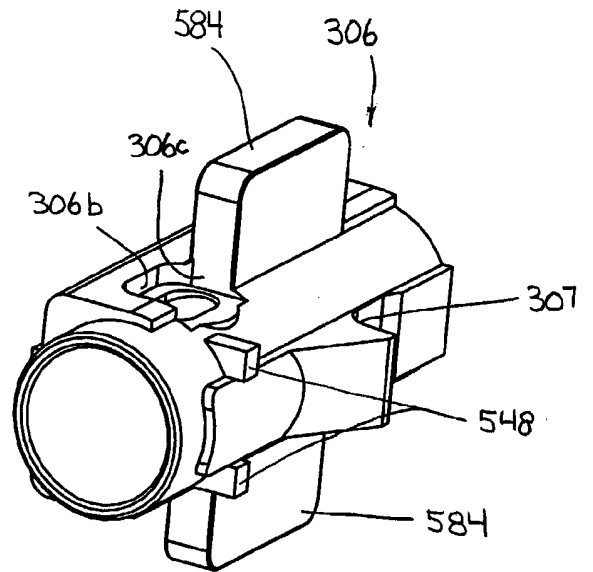

FIG. 23

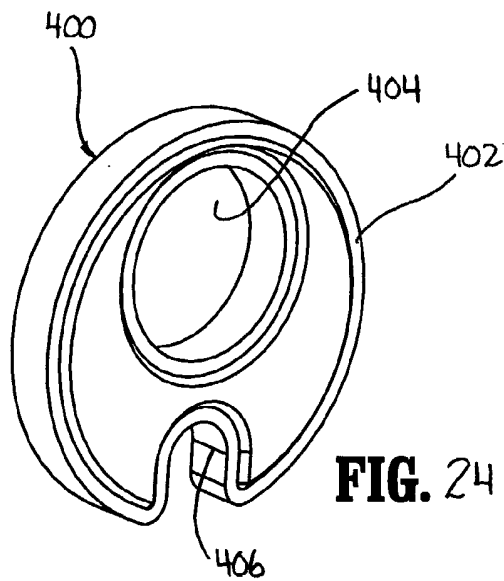

FIG. 24

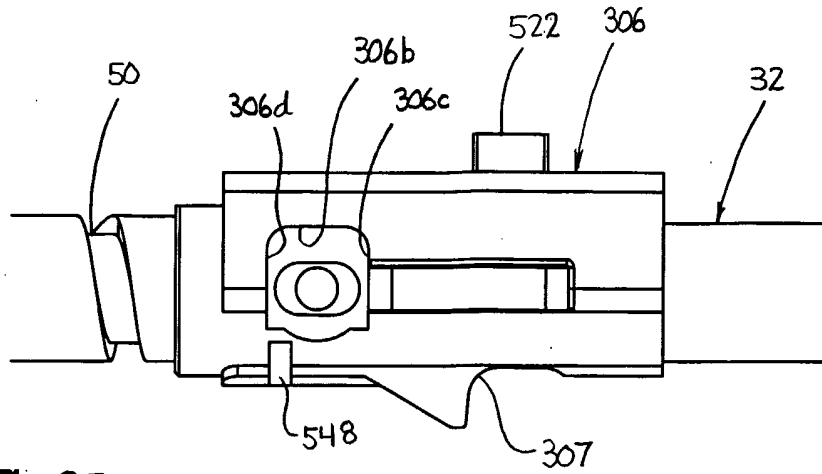

FIG. 25

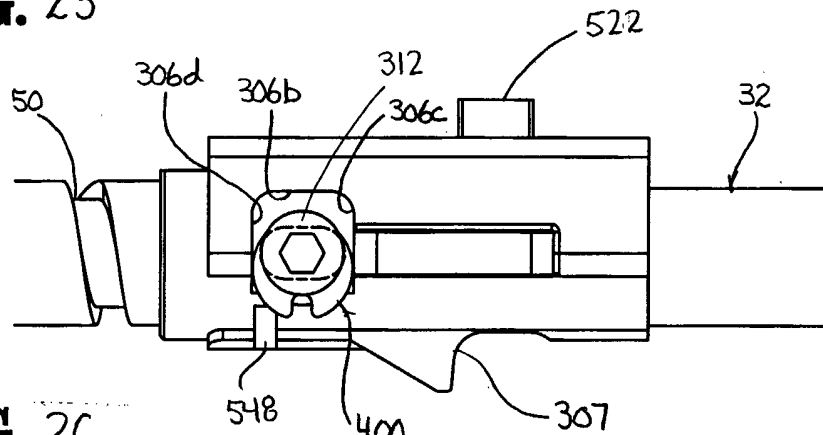

FIG. 26

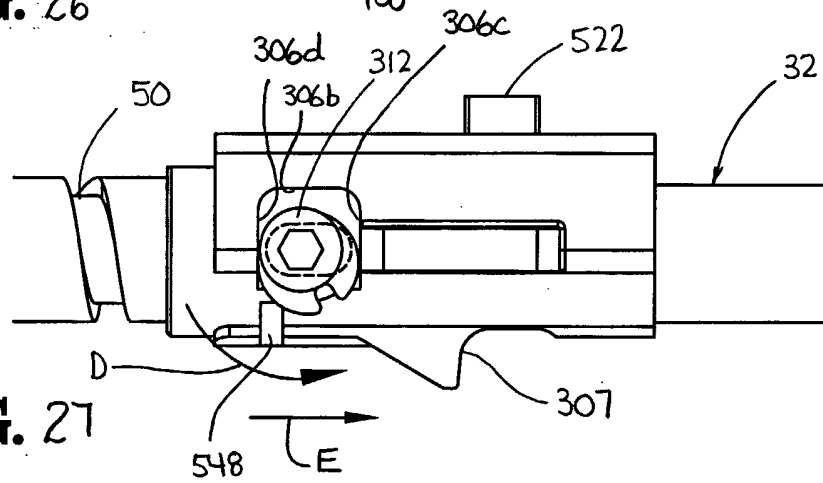

FIG. 27

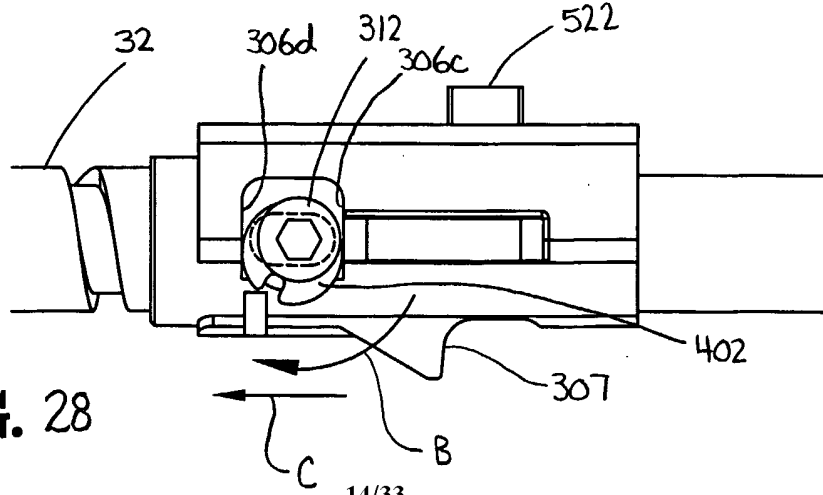
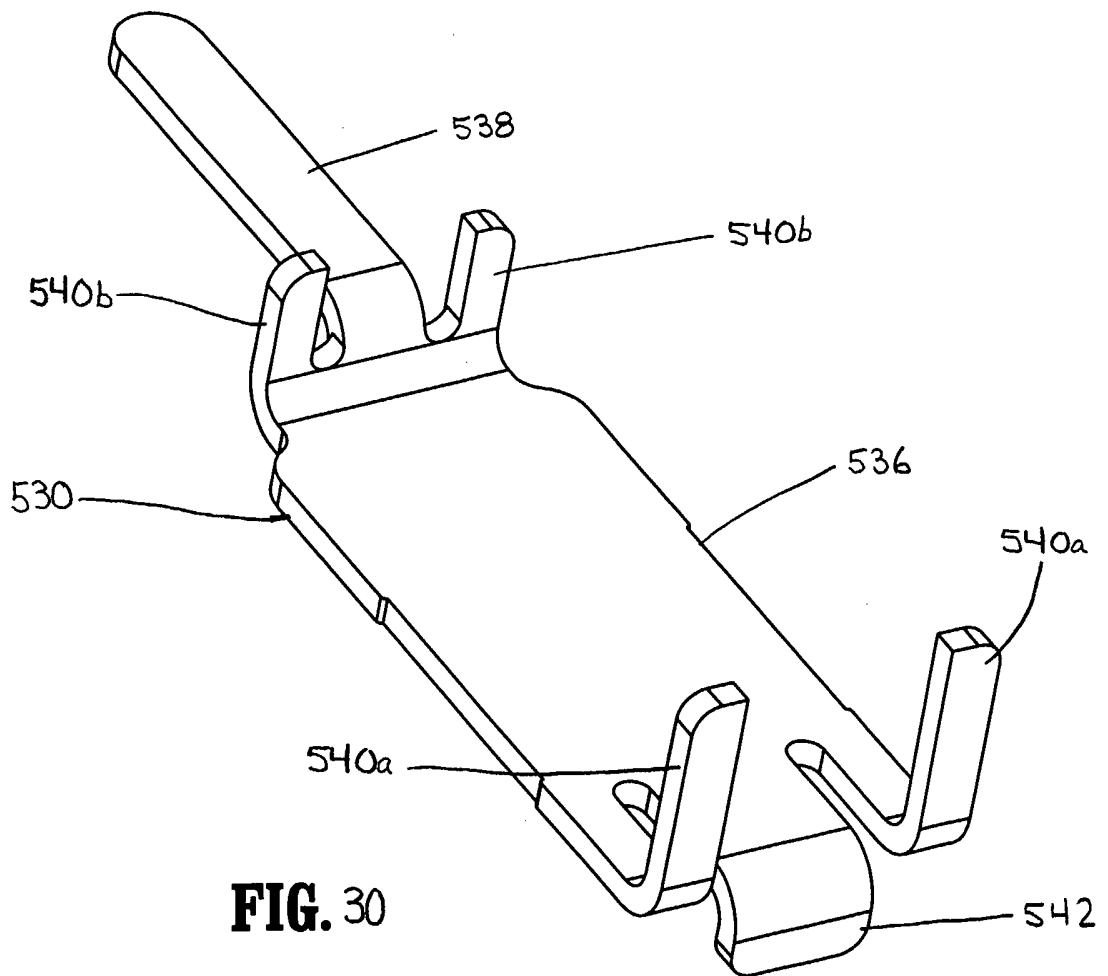
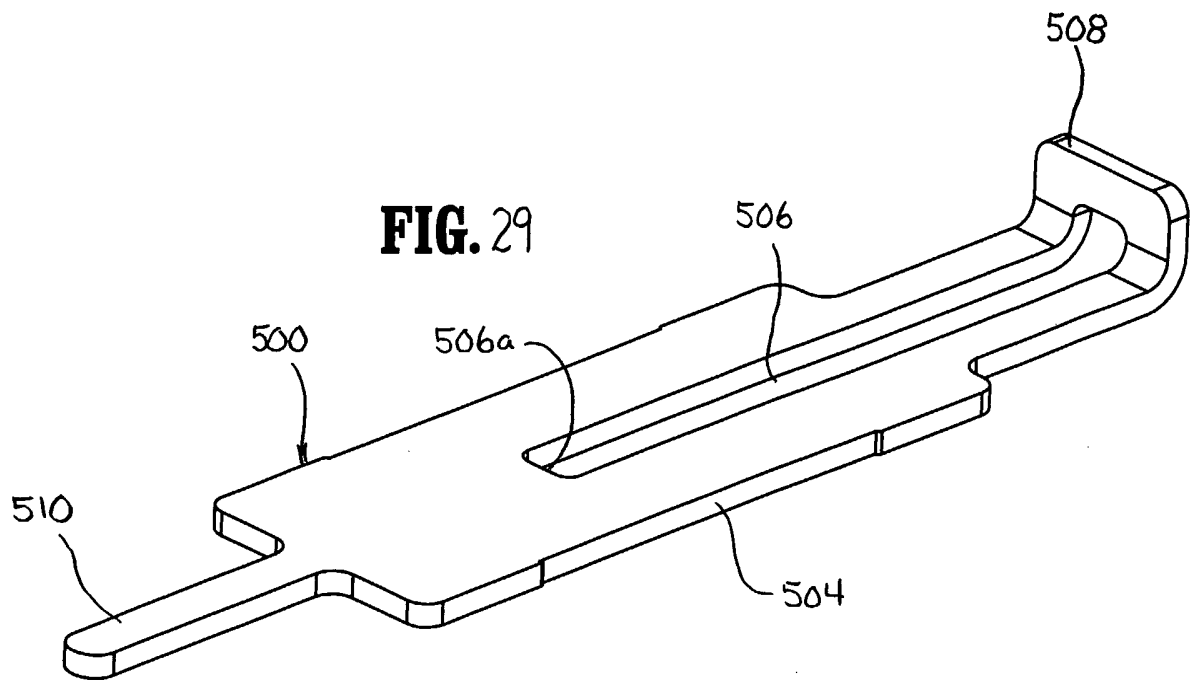

FIG. 28



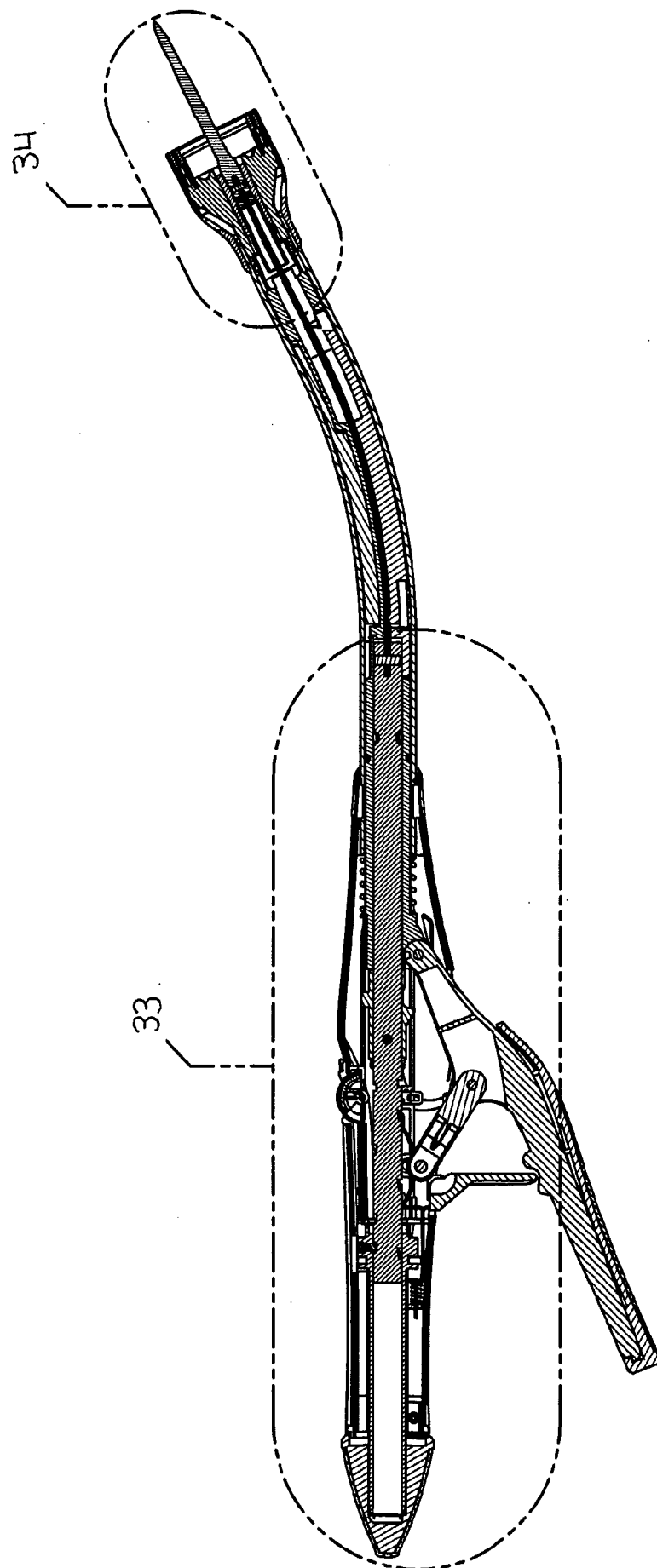

FIG. 31

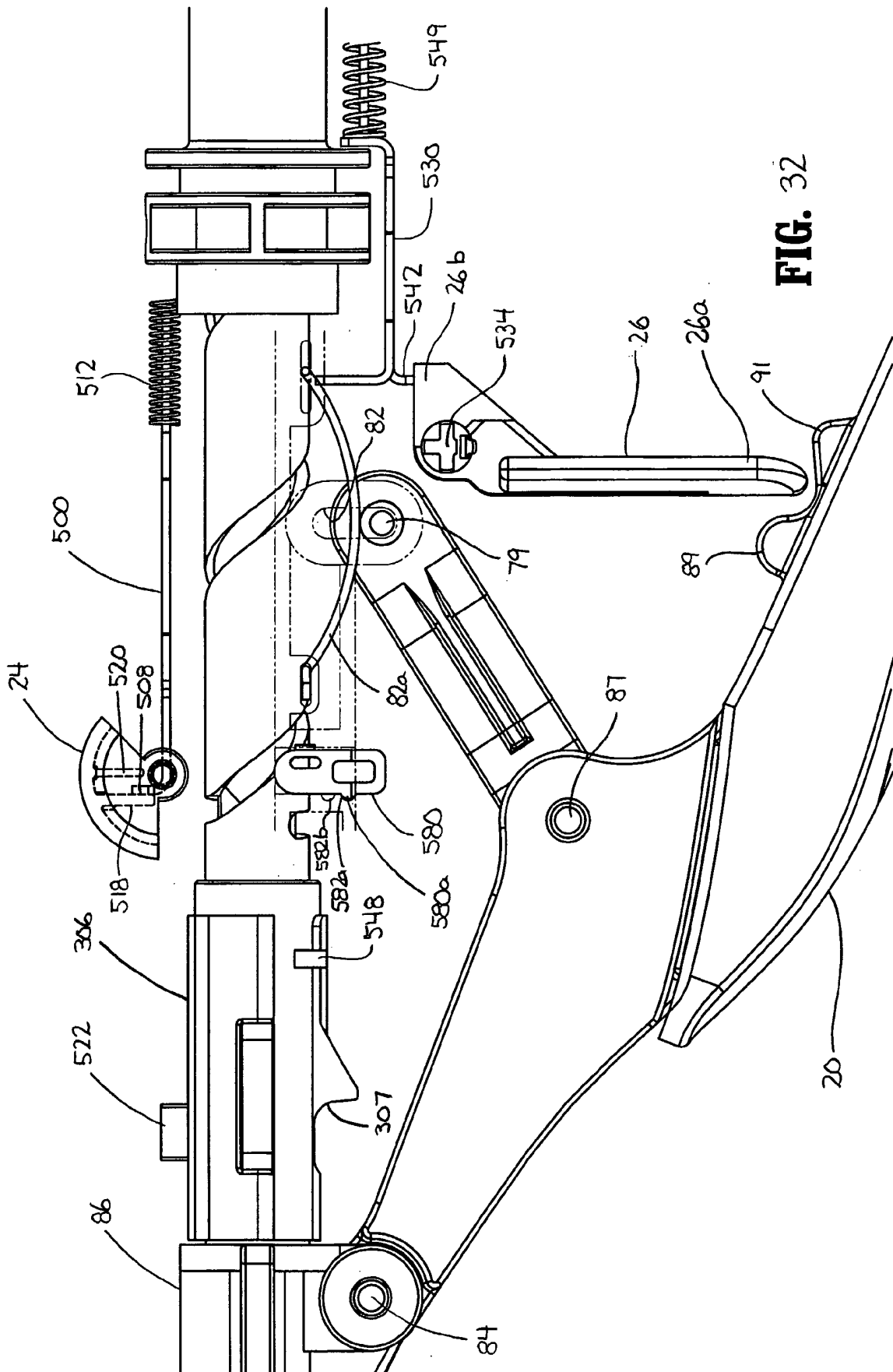
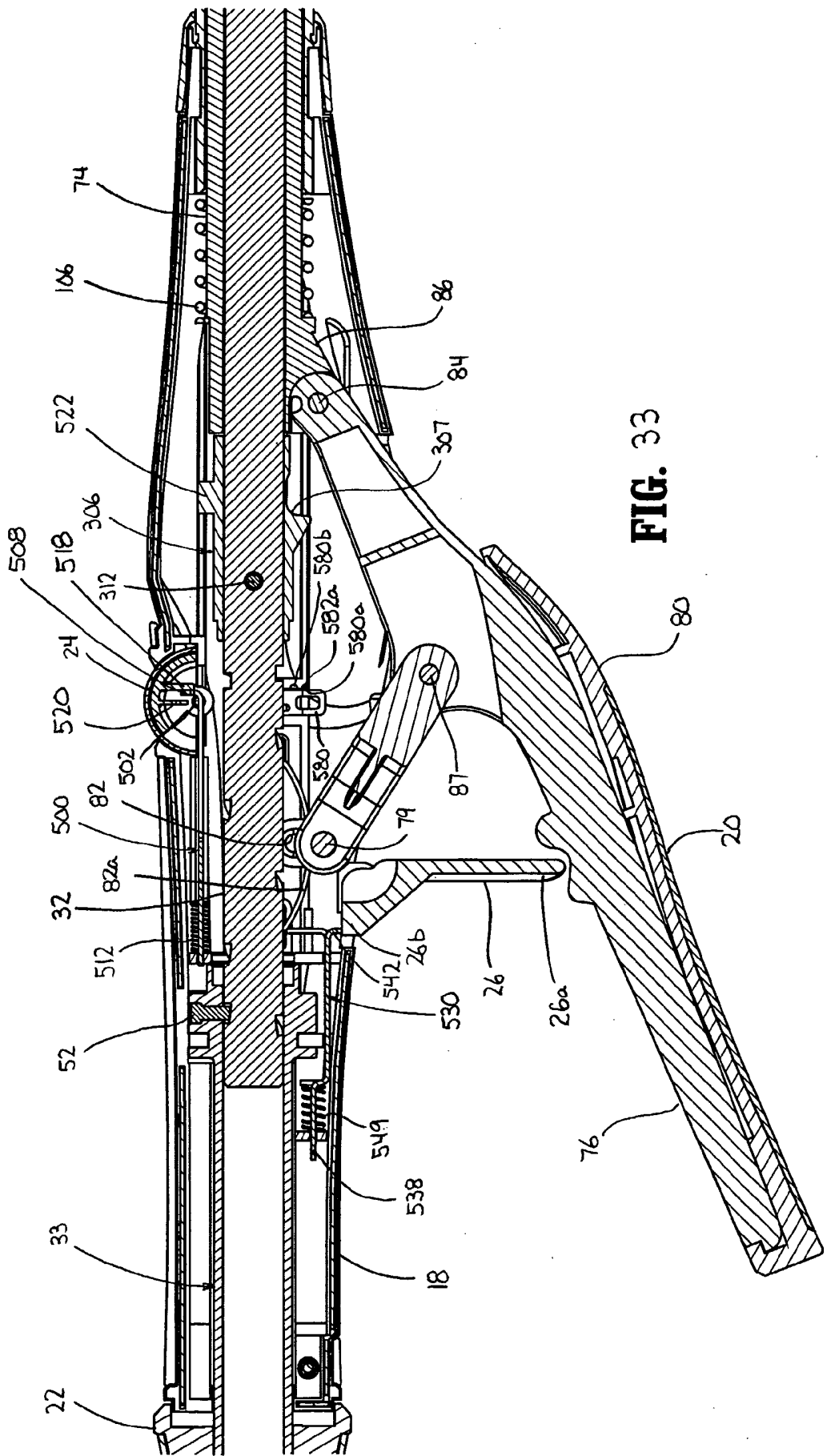

FIG. 32



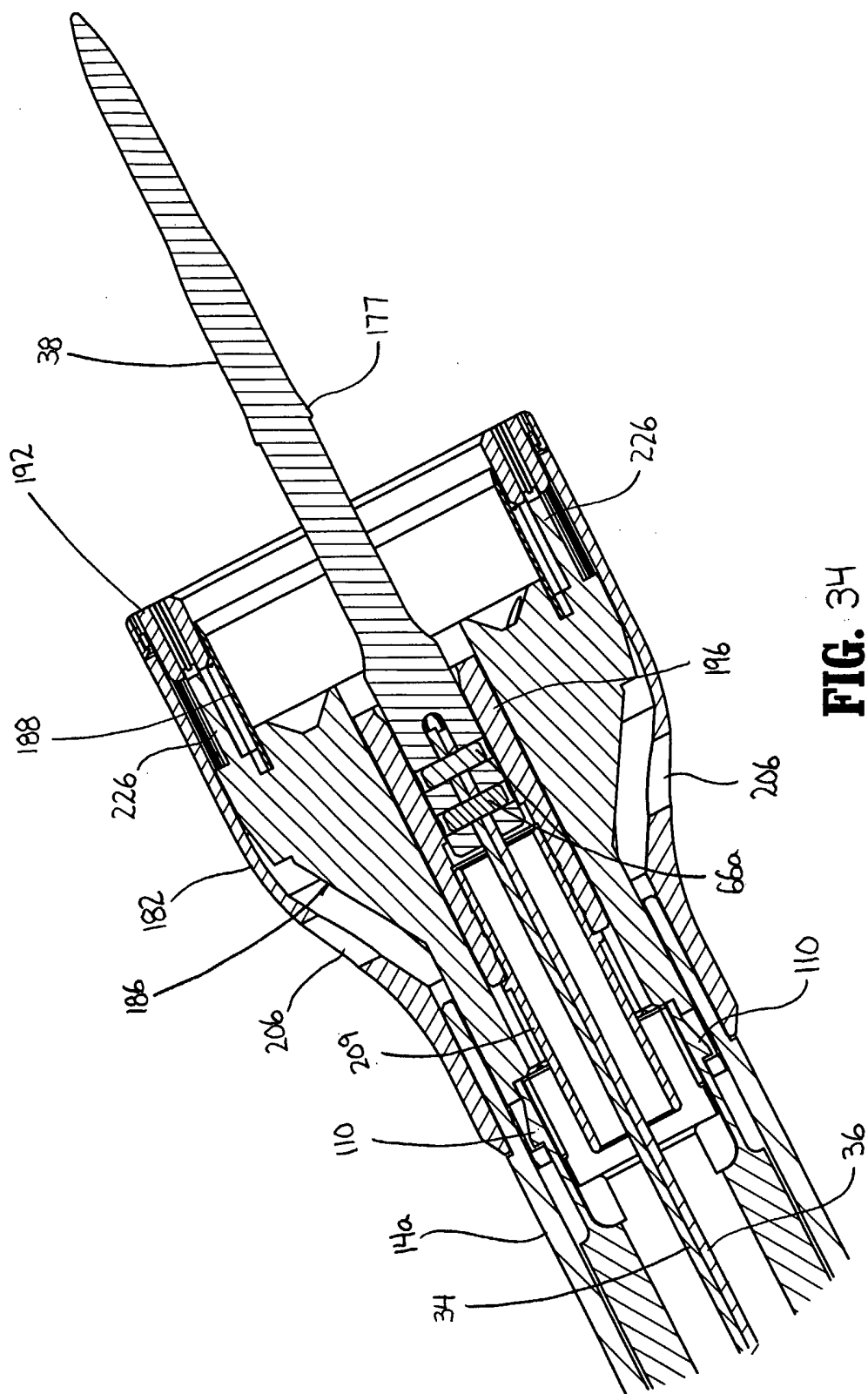

FIG. 34

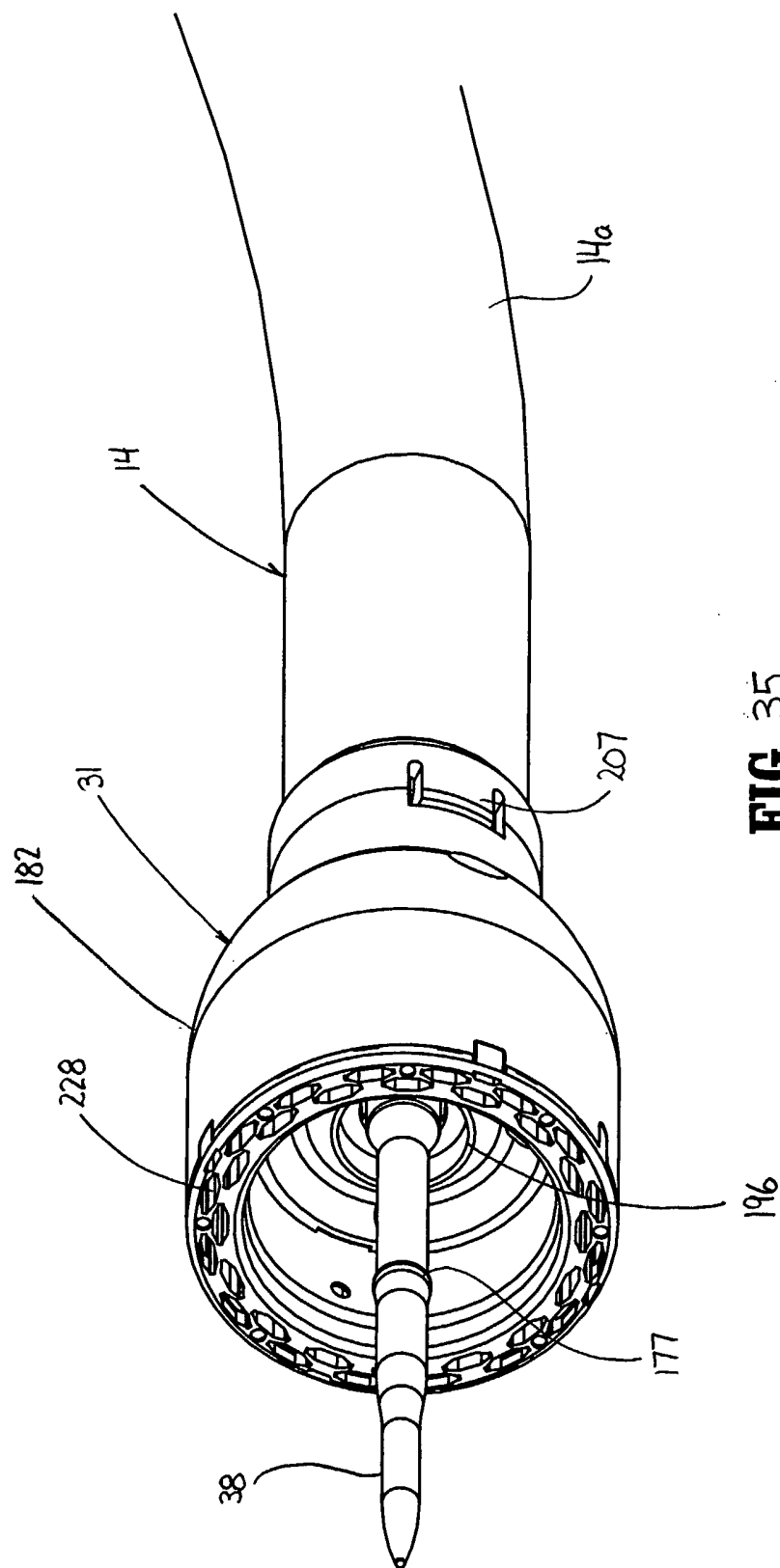

FIG. 35

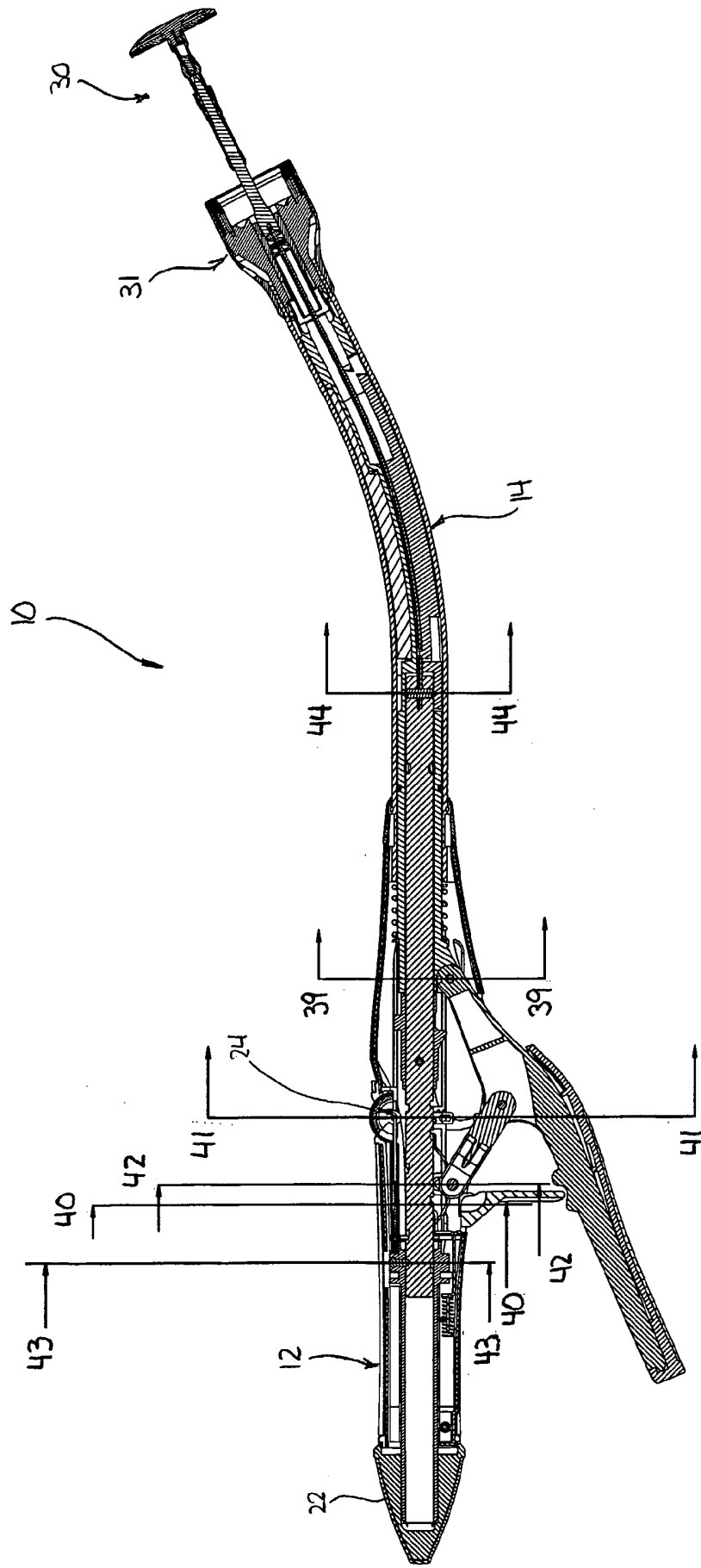

FIG. 38

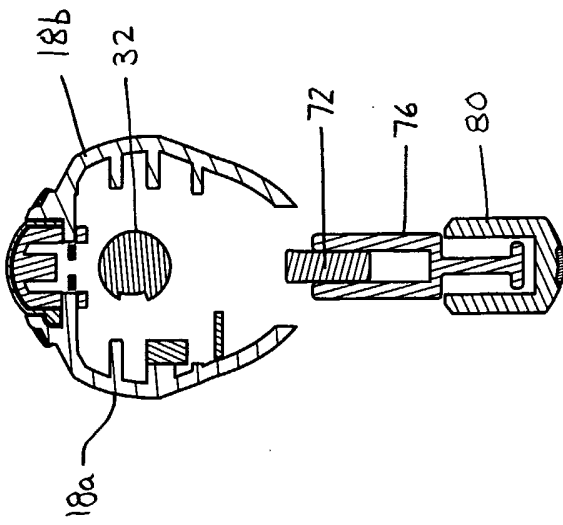

FIG. 39

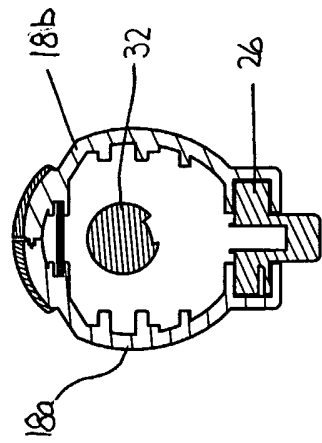

FIG. 40

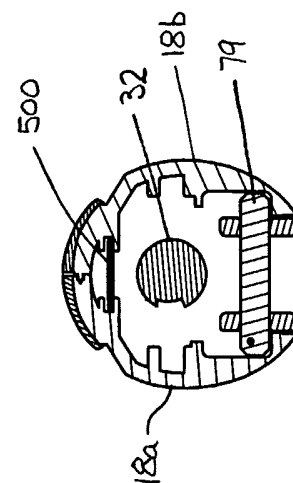

FIG. 41

FIG. 42

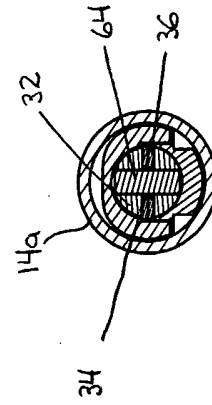

FIG. 43

FIG. 44

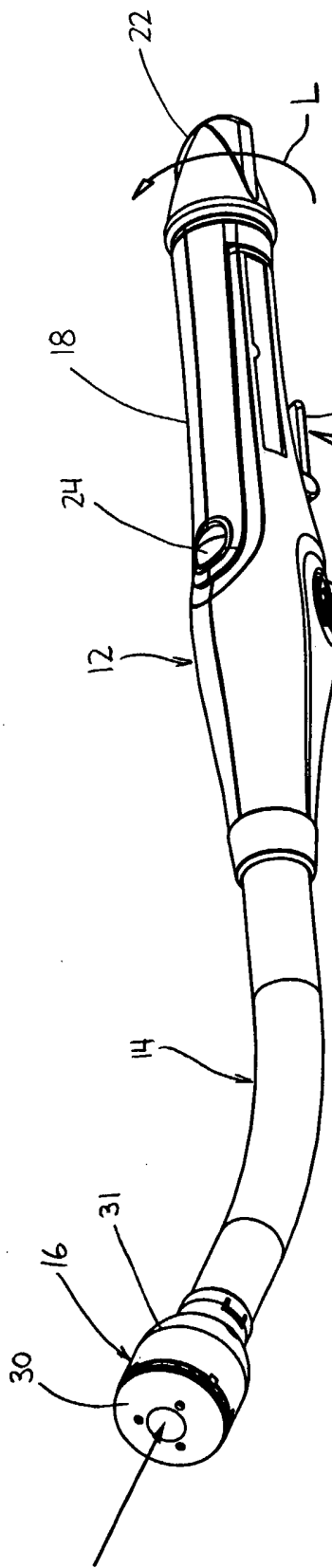

FIG. 45

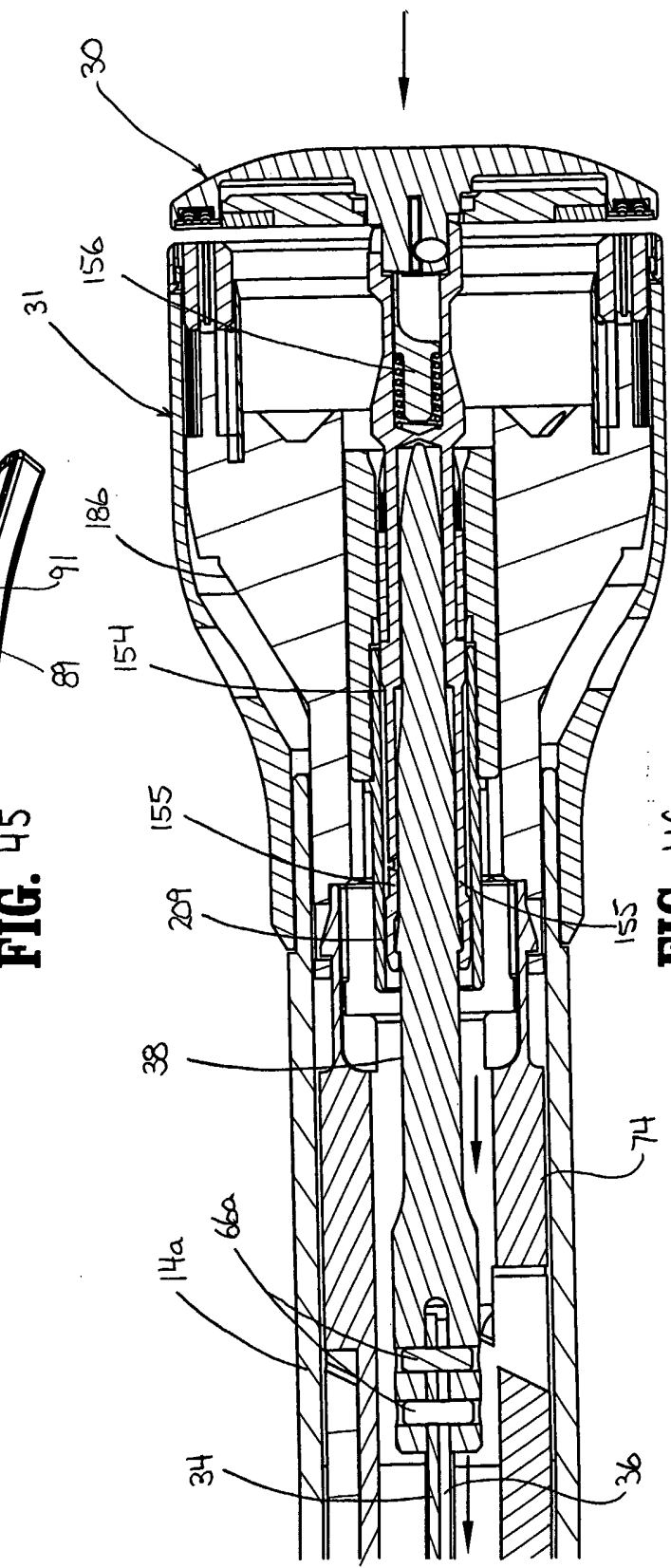
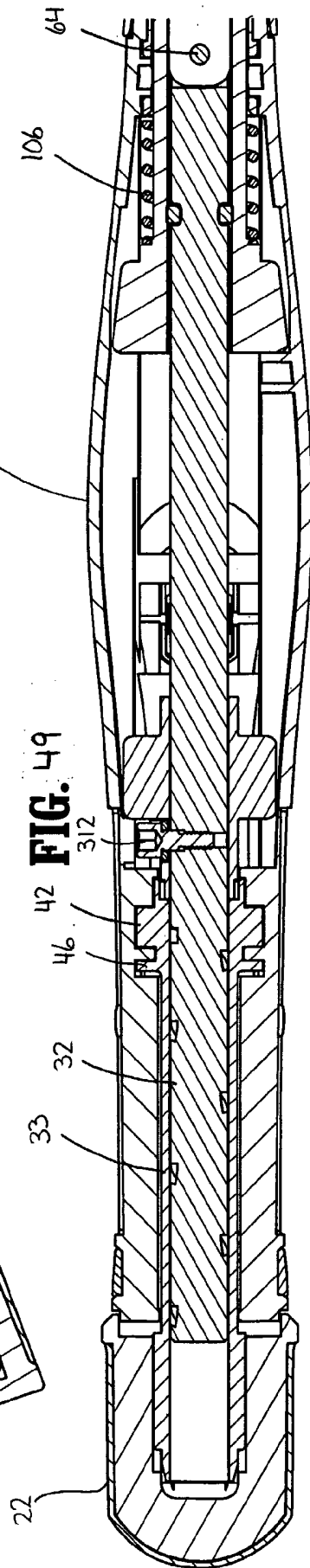
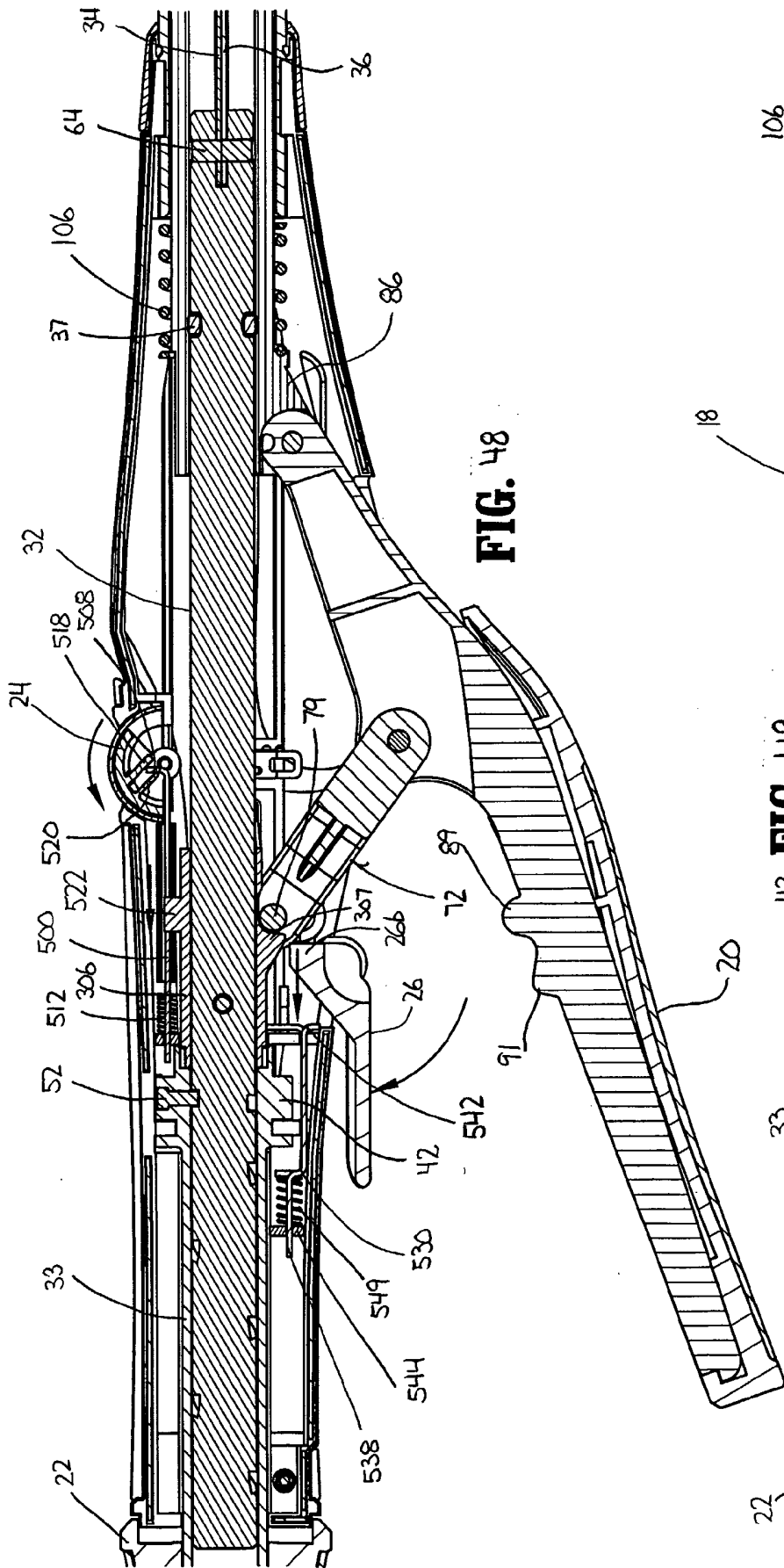

FIG. 46



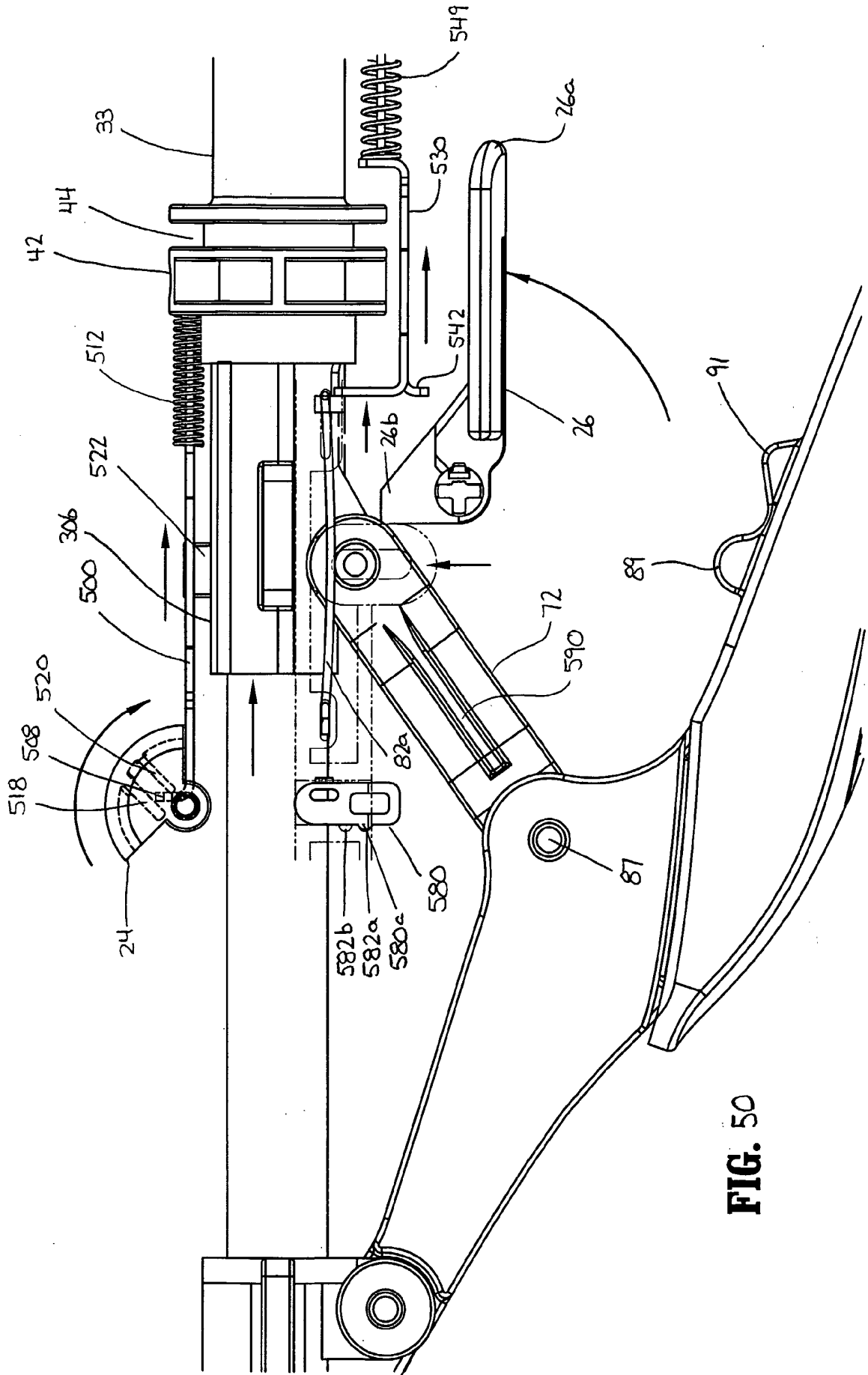

FIG. 50

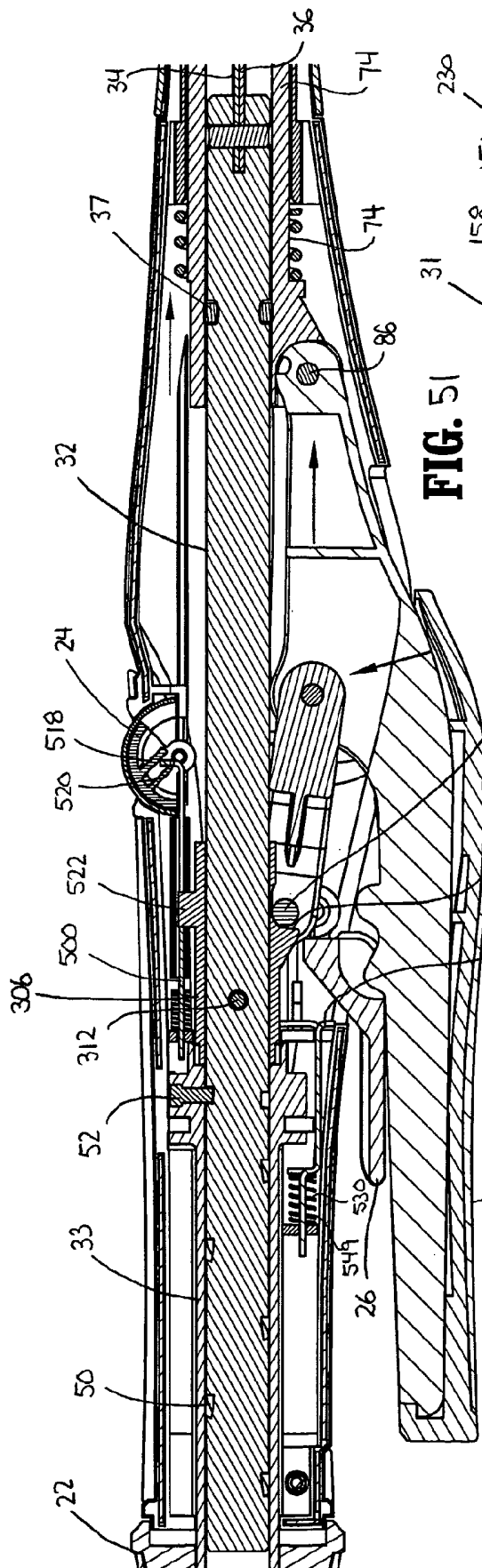

FIG. 51

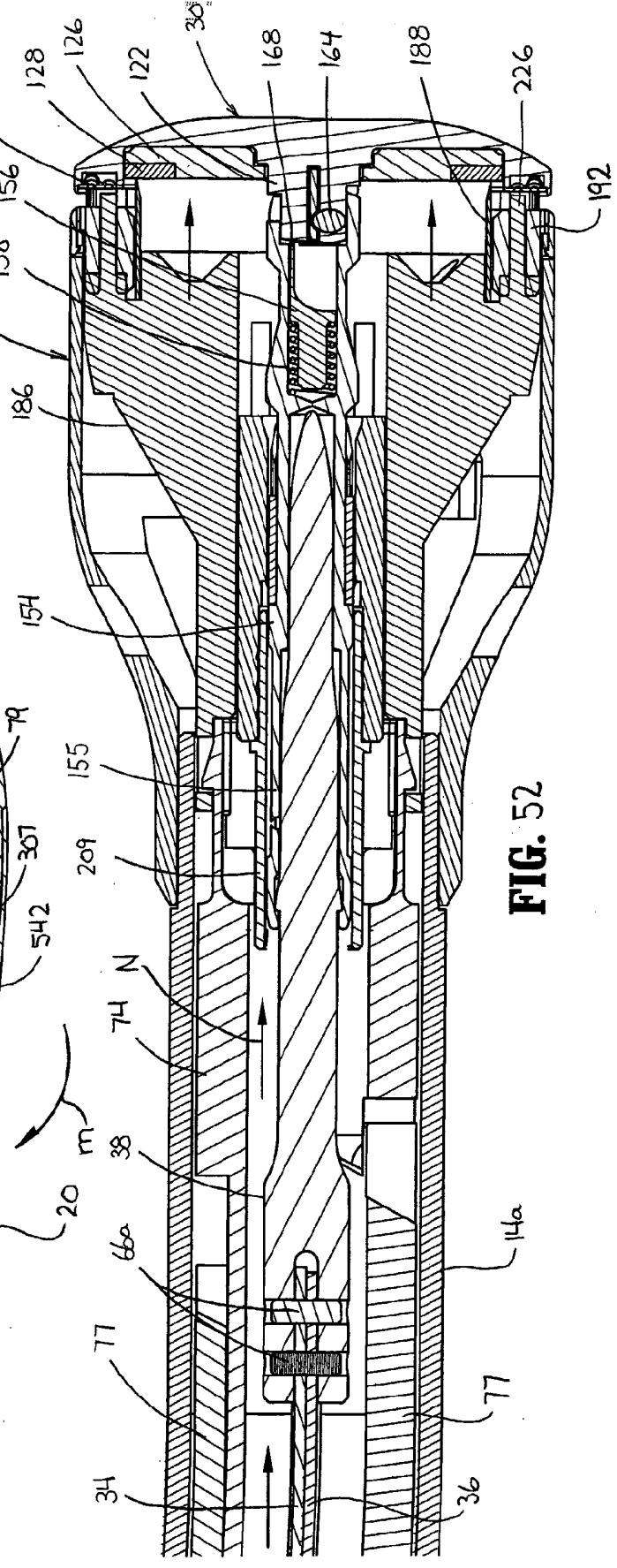

FIG. 52

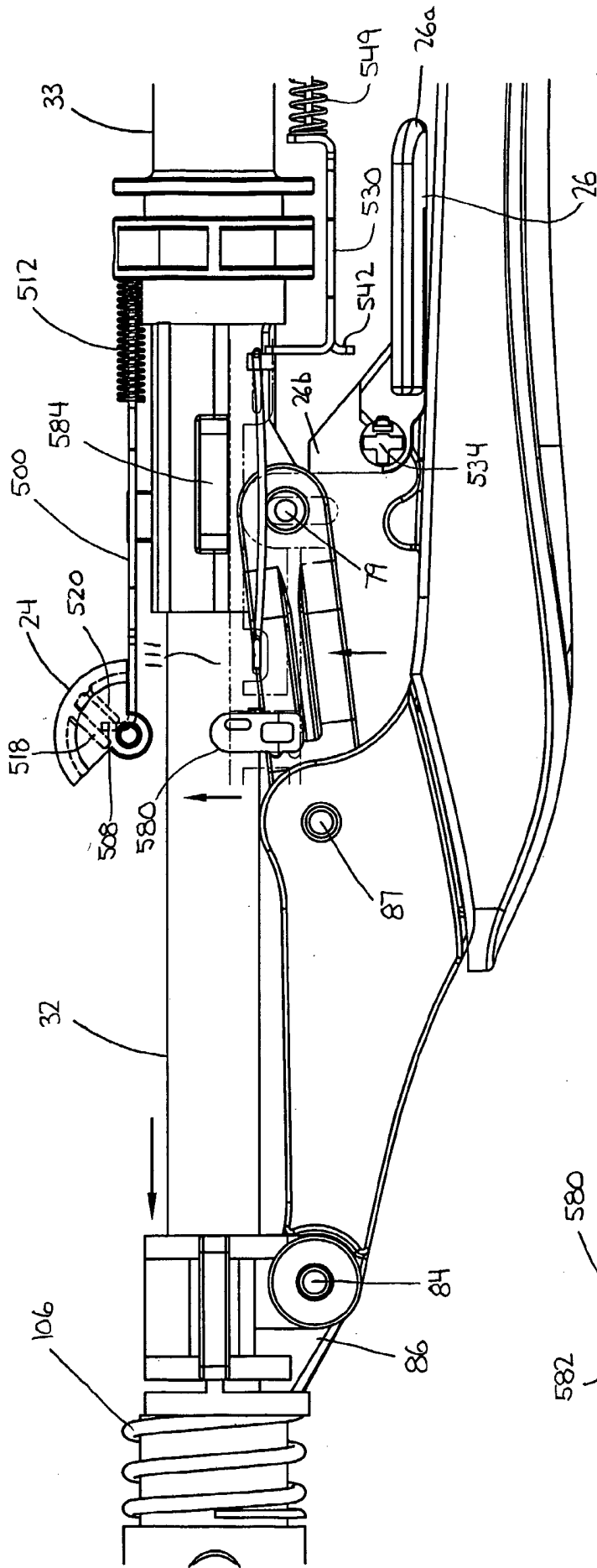

FIG. 53

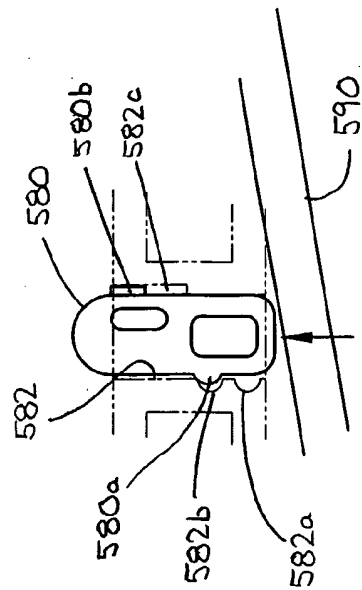

FIG. 54

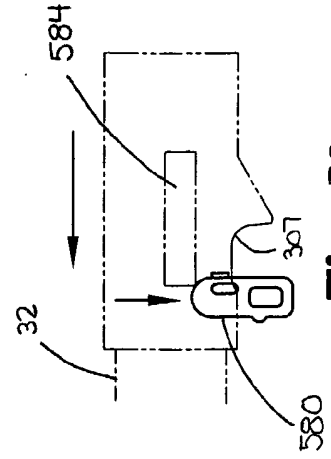

FIG. 58

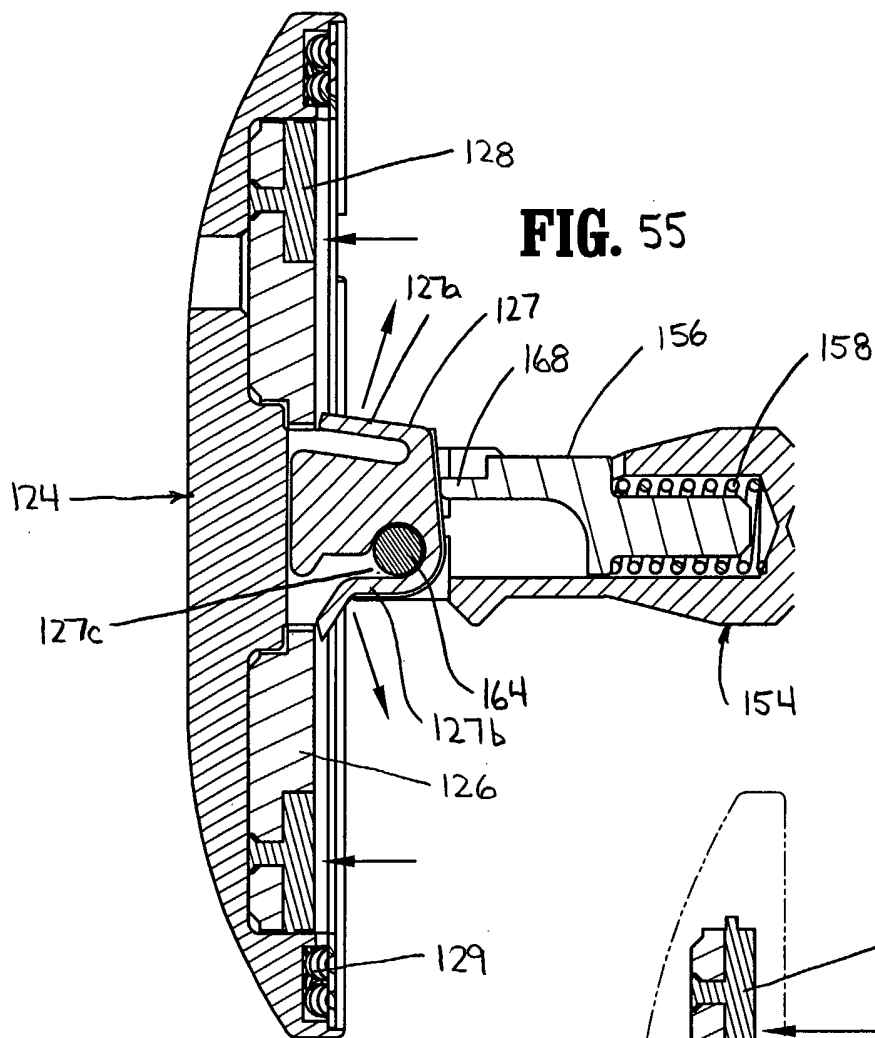

FIG. 55

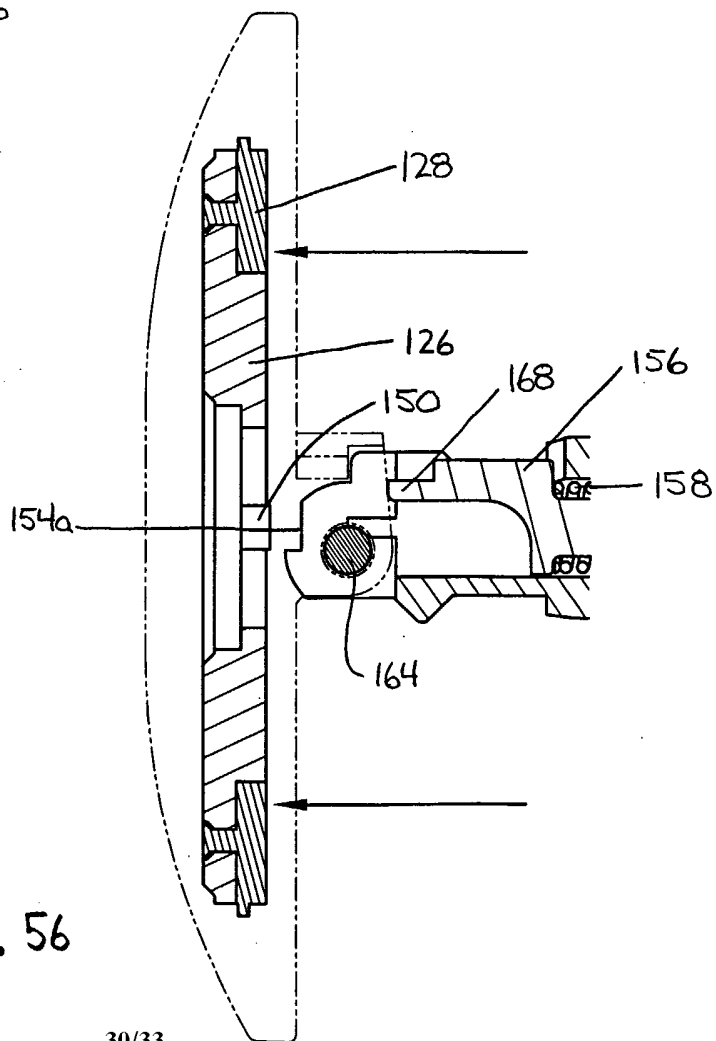

FIG. 56

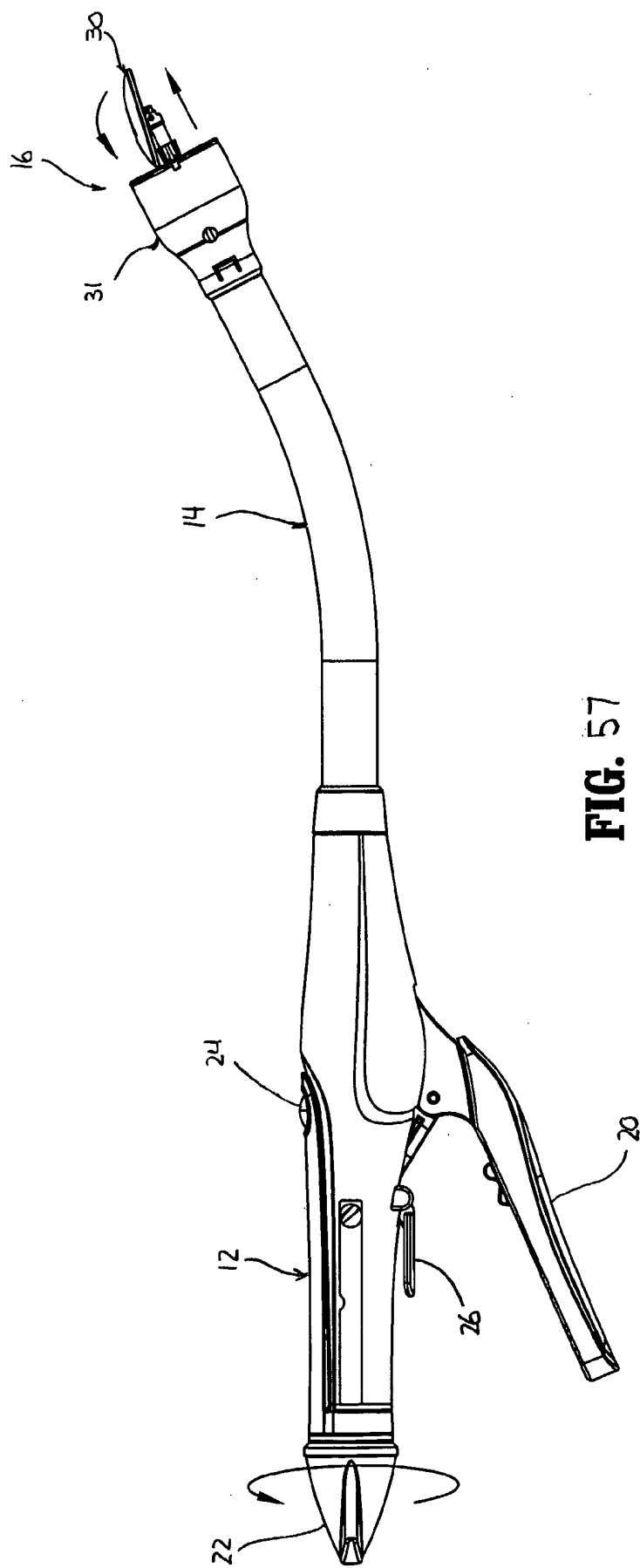
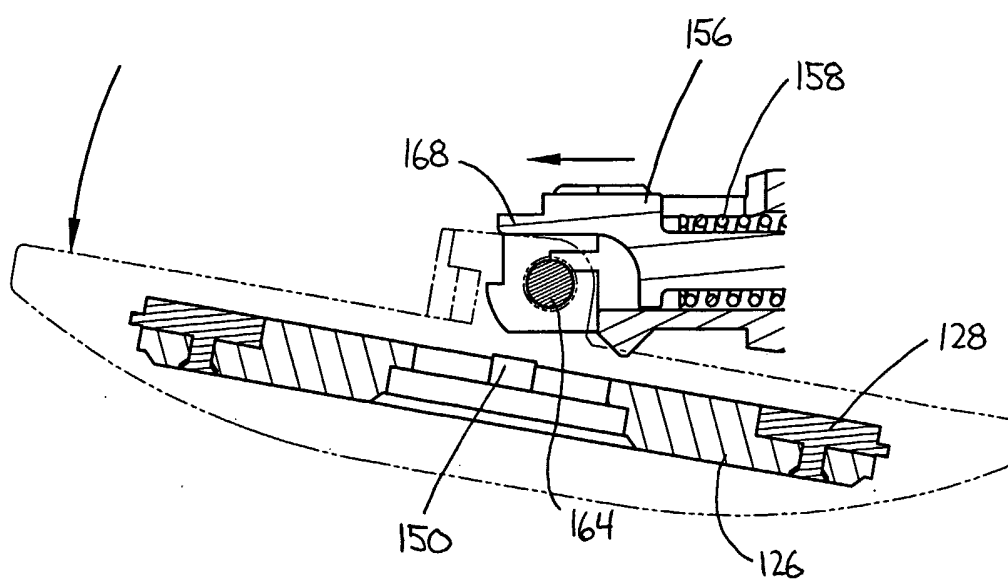
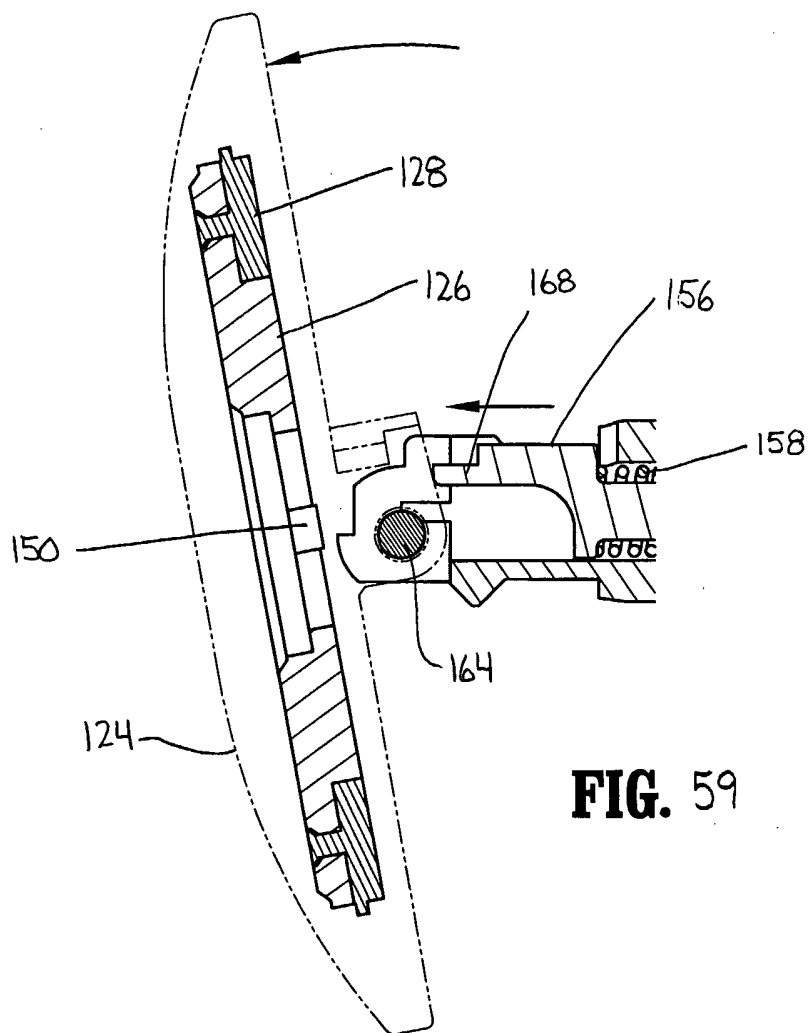

FIG. 57



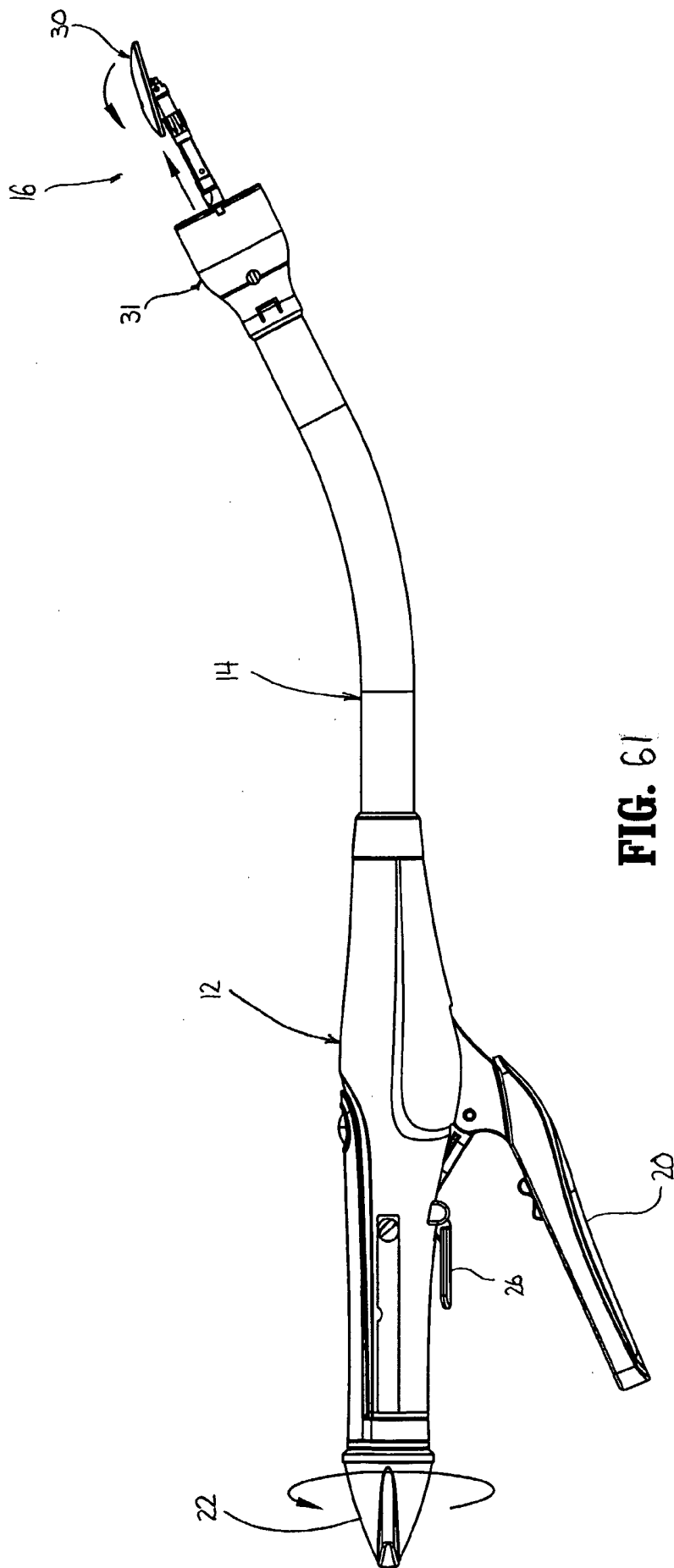

FIG. 61