



(11) **EP 2 573 231 A3**

(12) **EUROPEAN PATENT APPLICATION**

(88) Date of publication A3:
29.03.2017 Bulletin 2017/13

(51) Int Cl.:
D01H 5/88 (2006.01) B65H 67/08 (2006.01)

(43) Date of publication A2:
27.03.2013 Bulletin 2013/13

(21) Application number: **12183045.9**

(22) Date of filing: **05.09.2012**

(84) Designated Contracting States:
AL AT BE BG CH CY CZ DE DK EE ES FI FR GB GR HR HU IE IS IT LI LT LU LV MC MK MT NL NO PL PT RO RS SE SI SK SM TR
Designated Extension States:
BA ME

(72) Inventor: **Ueda, Kenichi**
Kyoto-shi, Kyoto, 612-8686 (JP)

(74) Representative: **Stöckeler, Ferdinand Schoppe, Zimmermann, Stöckeler Zinkler, Schenk & Partner mbB Patentanwälte Radlkoferstrasse 2 81373 München (DE)**

(30) Priority: **21.09.2011 JP 2011206628**

(71) Applicant: **Murata Machinery, Ltd. Minami-ku, Kyoto 601-8326 (JP)**

(54) **Spinning machine**

(57) A spinning machine (100) includes a plurality of spinning units (10), and each spinning unit (10) winds a spun yarn (Y) to form a package (P). The spinning machine (100) includes a driving roller (61) that makes contact with the package (P) to rotate the package (P) in a winding direction, a cradle (62) that moves the package (P) with respect to the driving roller (61), a reverse-rotation roller (22) that makes contact with the package (P) to rotate the package (P) in an unwinding direction, a driving section (23) that moves the reverse-rotation roller (22) with respect to the package (P), and a control section (40) that controls the driving section (23) to move the reverse-rotation roller (22) away from the package (P) immediately before the package (P) makes contact with the driving roller (61).

FIG. 3

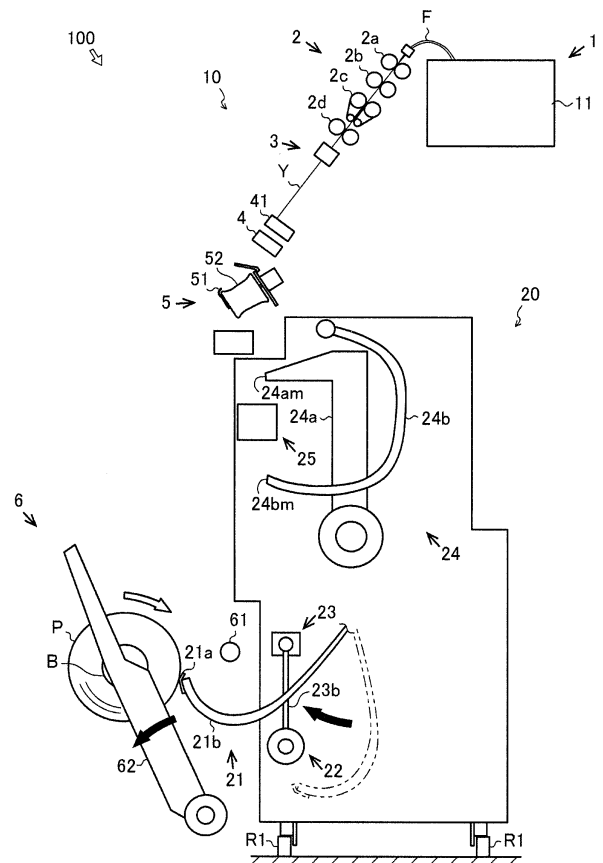

EP 2 573 231 A3



EUROPEAN SEARCH REPORT

Application Number
EP 12 18 3045

5

10

15

20

25

30

35

40

45

50

55

DOCUMENTS CONSIDERED TO BE RELEVANT			
Category	Citation of document with indication, where appropriate, of relevant passages	Relevant to claim	CLASSIFICATION OF THE APPLICATION (IPC)
X	JP 2010 189083 A (MURATA MACHINERY LTD) 2 September 2010 (2010-09-02)	1,4,5	INV. D01H5/88 B65H67/08
Y	* abstract; figures *	3	
A	-----	2	
Y	EP 1 457 448 A2 (MURATA MACHINERY LTD [JP]) 15 September 2004 (2004-09-15) * paragraph [0056]; figures *	3	
A	-----	2	
A	DE 38 27 345 A1 (STAHLECKER FRITZ [DE]; STAHLECKER HANS [DE]) 1 March 1990 (1990-03-01) * column 2, lines 53-61; figures *	2	
A	EP 1 659 082 A2 (MURATA MACHINERY LTD [JP]) 24 May 2006 (2006-05-24) * paragraph [0070]; figures *	1-5	TECHNICAL FIELDS SEARCHED (IPC) B65H D01H
A	-----	1-5	
A	JP 2001 199635 A (MURATA MACHINERY LTD) 24 July 2001 (2001-07-24) * abstract; figures *	1-5	
A	-----	1-5	
A	JP 2002 294523 A (MURATA MACHINERY LTD) 9 October 2002 (2002-10-09) * abstract; figures *	1-5	

The present search report has been drawn up for all claims			
Place of search The Hague		Date of completion of the search 14 February 2017	Examiner Lemmen, René
CATEGORY OF CITED DOCUMENTS X : particularly relevant if taken alone Y : particularly relevant if combined with another document of the same category A : technological background O : non-written disclosure P : intermediate document T : theory or principle underlying the invention E : earlier patent document, but published on, or after the filing date D : document cited in the application L : document cited for other reasons & : member of the same patent family, corresponding document			

EPO FORM 1503 03/02 (P04/C01)

ANNEX TO THE EUROPEAN SEARCH REPORT
ON EUROPEAN PATENT APPLICATION NO.

EP 12 18 3045

5 This annex lists the patent family members relating to the patent documents cited in the above-mentioned European search report.
The members are as contained in the European Patent Office EDP file on
The European Patent Office is in no way liable for these particulars which are merely given for the purpose of information.

14-02-2017

Patent document cited in search report	Publication date	Patent family member(s)	Publication date
JP 2010189083 A	02-09-2010	NONE	
EP 1457448 A2	15-09-2004	CN 1530478 A EP 1457448 A2 JP 3700706 B2 JP 2004277031 A	22-09-2004 15-09-2004 28-09-2005 07-10-2004
DE 3827345 A1	01-03-1990	NONE	
EP 1659082 A2	24-05-2006	EP 1659082 A2 JP 4120635 B2 JP 2006143395 A	24-05-2006 16-07-2008 08-06-2006
JP 2001199635 A	24-07-2001	JP 3951534 B2 JP 2001199635 A	01-08-2007 24-07-2001
JP 2002294523 A	09-10-2002	NONE	