



- (51) **International Patent Classification:**
A63F 13/00 (2006.01)
- (21) **International Application Number:**
PCT/IB2013/001126
- (22) **International Filing Date:**
9 April 2013 (09.04.2013)
- (25) **Filing Language:** English
- (26) **Publication Language:** English
- (30) **Priority Data:**
13/445,783 12 April 2012 (12.04.2012) US
13/479,637 24 May 2012 (24.05.2012) US
1222096.8 7 December 2012 (07.12.2012) GB
- (71) **Applicant:** SUPERCELL OY [—/FI]; Tammasaarenkatu 5, FIN-00180 Helsinki (FI).
- (72) **Inventors:** HAUSSILA, Timur; Runeberginkatu 21 C 61, FIN-00100 Helsinki (FI). TAHKOKALLIO, Touko; Visakoivunkuja 17 D 21, FIN-02130 Espoo (FI). HOKKANEN, Mikko; Itamerenkatu 28 A 9, FIN-00180 Helsinki (FI). DEROME, John, Nicholas; Palomaenrinne 5, FIN-02720 Helsinki (FI). LEPPINEN, Lassi; Saterinkatu 8B 24, FIN-02600 Espoo (FI).

(81) **Designated States** (unless otherwise indicated, for every kind of national protection available): AE, AG, AL, AM, AO, AT, AU, AZ, BA, BB, BG, BH, BN, BR, BW, BY, BZ, CA, CH, CL, CN, CO, CR, CU, CZ, DE, DK, DM, DO, DZ, EC, EE, EG, ES, FI, GB, GD, GE, GH, GM, GT, HN, HR, HU, ID, IL, IN, IS, JP, KE, KG, KM, KN, KP, KR, KZ, LA, LC, LK, LR, LS, LT, LU, LY, MA, MD, ME, MG, MK, MN, MW, MX, MY, MZ, NA, NG, NI, NO, NZ, OM, PA, PE, PG, PH, PL, PT, QA, RO, RS, RU, RW, SC, SD, SE, SG, SK, SL, SM, ST, SV, SY, TH, TJ, TM, TN, TR, TT, TZ, UA, UG, US, UZ, VC, VN, ZA, ZM, ZW.

(84) **Designated States** (unless otherwise indicated, for every kind of regional protection available): ARIPO (BW, GH, GM, KE, LR, LS, MW, MZ, NA, RW, SD, SL, SZ, TZ, UG, ZM, ZW), Eurasian (AM, AZ, BY, KG, KZ, RU, TJ, TM), European (AL, AT, BE, BG, CH, CY, CZ, DE, DK, EE, ES, FI, FR, GB, GR, HR, HU, IE, IS, IT, LT, LU, LV, MC, MK, MT, NL, NO, PL, PT, RO, RS, SE, SI, SK, SM, TR), OAPI (BF, BJ, CF, CG, CI, CM, GA, GN, GQ, GW, ML, MR, NE, SN, TD, TG).

Published:

— without international search report and to be republished upon receipt of that report (Rule 48.2(g))

(54) **Title:** SYSTEM AND METHOD FOR CONTROLLING TECHNICAL PROCESSES

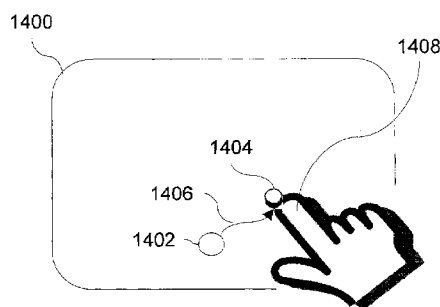

FIG. 11

(57) **Abstract:** A method and a system for improving a user's experience with a graphical user interface corresponding to a gaming or simulation environment, executes a software product corresponding to the game or simulation, on the computing hardware of an electronic device. The interface renders multiple graphical objects and user selectable options corresponding to the graphical object. The user selects one or more selectable option, and eventually, performs a touching or a swiping operation through multiple points on the display screen of the graphical object. The touching or swiping operation leads to deploying of multiple resources corresponding to the selected option, at different locations on the interface. For controlling the different deployed resources, the user can swipe through different regions of the display screen, based on his/her desire. The number of resources deployed at the different locations on the screen depends on certain parameters, including the pressure applied by the user on the screen, during performing the touching or swiping operations. Results of the simulation can be employed to control real technical systems, for example for food production.



SYSTEM AND METHOD FOR CONTROLLING TECHNICAL PROCESSES

Field of the invention

5 The present invention relates to systems for controlling technical processes, for example to systems for controlling technical processes relating to at least one of technical process simulation and technical process control. Moreover, the present invention concerns methods of controlling technical processes, for example to methods of controlling technical processes relating to at least one of technical
10 process simulation and technical process control. Furthermore, the present invention relates to software products recorded on machine-readable data storage media, wherein the software products are executable upon computing hardware for implementing aforesaid methods.

15 Background of the invention

Graphical user interfaces (GUI) for controlling complex processes are known, for example in control rooms associated with nuclear power plant, in military defence systems and in aviation management. Such graphical user interfaces can be employed both to control real technical facilities as well as simulations of such
20 facilities. The simulations provide an opportunity to investigate a potential behaviour of the facilities, prior to applying actual control signals and commands to the facilities, thereby providing better control of the facilities and anticipating behaviour of the facilities.

25 Computing devices include tablet computers such as *iPads*, and smart phones, including Apple's *iPhone*®, Google's *Android*® phone, and *Symbian*® phones. These computing devices have extremely user-friendly graphical interfaces, for enabling easy and quick interaction to users thereof. Most of these devices incorporate touch-sensitive screens that obtain user's inputs and facilitate smooth
30 user interaction. Simulation software, for example conveniently implemented in a form of gaming software, is employed in many of these devices for leisure purpose as well as technical control purposes as aforementioned. An important aspect of a gaming or simulation system is the ease with which a given user can enter desired inputs and interact with the user interface of the device on which he/she plays a

game and/or executes a simulation. For devices that lack a touch-screen facility incorporated therein, the only possible ways of interaction of the given user while playing a game or executing a simulation on such devices, is by clicking an associated mouse, using associated keyboard functions/keys to operate, or using associated joysticks. Experiences with the 'point and click' or 'joystick' incorporated in many lower-grade electronic devices is incompatible and often time consuming, while playing a game or executing a technical simulation. Specifically, there are specific games or technical simulations where a given user/player needs to use clicking, pointing, tapping and dragging operations many times, and often at different device display locations, which is hard to operate through a contemporary mouse or a contemporary joystick. In a typical gaming environment, where a given user needs to perform similar operations by clicking or touching on multiple points on the interface, this becomes cumbersome. Even the touch-sensitive screens, provided in many conventional electronic devices, are capable of sensing the touching operation only at one point at a time. Multi-touch screens are still not popular, and they can be of great benefit in a gaming environment or a simulation environment. Some of the conventional gaming console applications can be controlled through multi-touch sensitive operations, however, in strategic gaming environments, for performing certain desired operations, they still have some drawbacks.

Therefore, considering the aforementioned problems, there exists a need for a better and highly congenial graphical user interface (GUI) for a gaming or technical simulation-and-control system, while playing a game or executing a simulation on a computing device.

Summary of the invention

The present invention seeks to provide an improved user graphical interface which is more convenient to employ when undertaking gaming activities and/or executing simulations of real technical systems before proceeding to control operation of such technical systems.

The present invention also seeks to provide an improved method of employing a user graphical interface which is more convenient when undertaking gaming activities

and/or executing simulations of real technical systems before proceeding to control operation of such systems.

According to a first aspect of the present invention, there is provided an electronic device as claimed in claim 1: there is provided an electronic device comprising:
5 a touch-sensitive display screen, configured to simultaneously sense touching operations performed at multiple points of the screen;

a computing hardware operable to execute a software product, wherein executing the
10 software product results in generating and rendering a graphical user interface on the display screen, the graphical user interface being configured to facilitate user interaction; the graphical user interface, when rendered, presenting:
one or more graphical objects; and

15 one or more user selectable options, each option representing one or more resources for performing an operation on one or more of the one or more graphical objects; wherein

based on a user's selection of one or more of the user selectable options, the software product is configured to render the one or more resources
20 corresponding to the selected user selectable option, at multiple locations of the interface.

The invention is of advantage in that the graphical user interface is more convenient to employ, for example when submitting complex instructions requiring concurrent
25 deployment activities.

Optionally, in the electronic device, the software product is configured to execute actions through the one or more resources, on one or more graphical objects, based on receiving a user's execution input, after rendering the one or more resources at
30 multiple locations.

Optionally, in the electronic device, the software product is configured to render the one or more resources at multiple locations, based on a user's touching operation at multiple points of the display screen, or a user's swiping operation through the

multiple points, the multiple points corresponding to the multiple locations on the display screen. More optionally, in the electronic device, the software is configured to render the one or more resources at multiple locations when the user's touching operation at the multiple points is performed for a pre-determined time. Yet more
5 optionally, in the electronic device, the pre-determined time is user-adjustable. More optionally, in the electronic device, the rapidity of rendering the one or more resources at multiple locations is based at least on the speed of the user's touching operation or the swiping operation on the display screen.

10 More optionally, in the electronic device, the number of resources rendered at multiple locations depends at least on the pressure applied by the user over the display screen, during performing the touching or swiping operation. Pressure applied by a given user to a touch-screen is beneficially determined by one or more pressure-sensitive transducers integrated into the touch-screen. However, certain
15 contemporary touch-screens operate only on a binary basis, namely either there is contact or no contact with a given area of the touch-screen. In such touch-screens, pressure applied by the given user can be determined by an area of neighbouring spatially contiguous sensing points on the screen which substantially simultaneously experience a contact being made by the given user. Thus, progressively more
20 spatially contiguous sensing points are substantially simultaneously in contact state as progressively more pressure is applied due to elastic deformation of biological tissue of the given user's finger tips. A similar pressure sensing functionality can be achieved when the given user employs a pointing device having an elastically deformable end to contact onto the touch-screen to control a game or a simulation, or
25 to enter commands for controlling a real technical facility. Optionally, the game or simulation includes a calibration routine for a given user to perform to calibrate pressure sensitivity of the touch-screen.

30 Optionally, in the electronic device, the software product and the graphical user interface corresponds to a gaming environment. More optionally, in the electronic device, the gaming system corresponds to a war-based game, the graphical user interface corresponding to a battlefield, and the one or more resources corresponding to weapons of use within the battlefield. For example, the gaming

environment can be a simulation, prior to implementing a military operation in practice using real technical hardware.

5 Optionally, in the electronic device, there is including a database for continuously recording and updating the change in status of the one or more graphical objects, the software product being coupled to the database and being configured to resume the status of the one or more graphical objects to their last updated status in the database, in case of interruptions in the operable state of the graphical user interface.

10

Optionally, a plurality of electronic devices are connected to a server through a network, the graphical user interface being generated temporally concurrently on each of the electronic devices, to facilitate a plurality of users' interaction with the graphical user interface, wherein the graphical user interfaces generated on the plurality of electronic devices are coordinated and synchronized through the server, and updated concurrently on the plurality of electronic devices with time.

15

Optionally, the electronic device is implemented as a desktop computer, a laptop computer, an iPad, or a smart phone, including an iPhone®, an Android® phone or a Symbian® phone; "®" denotes registered trademarks.

20

According to a second aspect of the invention, there is provided a method of facilitating user interactions with a graphical user interface, the graphical interface being generated and rendered on the display of an electronic device, by executing a software product on a computing hardware of the electronic device, the method comprising:

25

- (a) rendering one or more graphical objects, and one or more user-selectable options corresponding to the one or more graphical objects on the graphical user interface, each user-selectable options corresponding to one or more resources to be deployed on the interface;
- (b) selecting one or more of the user-selectable options, and performing one of a touching operation at different points on the display, and a swiping operation through the different points of the display; and

30

(c) deploying the one or more resource corresponding to the selected user-selectable option at multiple locations on the interface simultaneously, the multiple locations corresponding to the different points where the touching operation, or through which the swiping operation, is being performed.

5

Optionally, the method further comprises:

(d) deploying the one or more resources at multiple locations based at least on detecting that the touching operation at the multiple points on the display screen is performed for a pre-determined time.

10

Optionally, in the method, the rapidity of deployment of the one or more resources at multiple locations depends on the speed of the swiping operation or the touching operation.

15 Optionally, in the method, the number of resources deployed at the different locations on the interface depends on the pressure applied on the display screen during performing the touching operation or the swiping operation.

Optionally, in the method, the software product and the graphical user interface
20 corresponds to a gaming system. More optionally, in the method, the gaming system corresponds to a war-based game, the graphical user interface corresponds to a battlefield, and the one or more resources correspond to weapons of use within the battlefield.

25 Optionally, the method further comprises continuously recording and updating the change in status of the one or more graphical objects, coupling the software product to the database, and resuming the status of one or more graphical objects to their last updated status in the database, in case of interruptions in the operations of the graphical user interface.

30

Optionally, the method further comprises:

(e) connecting a plurality of the electronic devices to a server through a network;
(f) generating the graphical user interface temporally concurrently on the displays of the different electronic devices; and

(g) coordinating the plurality of graphical user interfaces through the server, and updating them concurrently with time, to facilitate multiple users' interaction and coordination with the graphical user interfaces.

5 More optionally, in the method, the graphical user interfaces correspond to a gaming system, and the method is configured to facilitate an online multiplayer gaming system.

10 According to a third aspect of the present invention, there is provided a software product recorded on a machine readable data storage medium, wherein the software product is executable on the computing hardware of a computing device for implementing a method according to the second aspect of the invention.

15 According to a fourth aspect of the present invention, there is provided an electronic device comprising:

a display screen;

20 a computing hardware capable of executing a software product, wherein executing the software product leads to generating and rendering a graphical user interface on the display screen, the graphical user interface being configured to facilitate easy user interaction; the graphical user interface, when rendered, presenting:
one or more graphical objects;

25 a pointer object configured to be movable over one or more graphical objects, and configured to invoke a menu list containing one or more user selectable options as the pointer object is clicked or tapped over one or more of the graphical objects, wherein:

30 on selecting a user selectable option from the menu list, and performing one of a dragging of the pointer object and swiping a touch sensitive object over the graphical user interface, through one or more graphical objects, or through a portion of a specific graphical object, the software product is configured keep an effect corresponding to the selected option to be continuously applied to the one or more graphical objects, or to the portion of the specific graphical object, respectively,

thereby enabling a change in status of the one or more graphical objects, or the portion of the specific graphical object, respectively.

5 Optionally, the electronic device further comprises a user input interface rendered over the graphical user interface, the user input interface being configured to obtain and interpret a user's input corresponding to moving the pointer object, clicking or tapping the pointer object, or swiping the touch sensitive object over the graphical user interface.

10 Optionally, in the electronic device, the graphical user interface is configured to apply continuously the user selectable option to the portion of the specific graphical object, or to one or one graphical objects, in response to a user's swiping the touch sensitive object over the portion of the specific graphical object, or to the one or one graphical objects, respectively.

15 Optionally, in the electronic device, the graphical user interface is configured to facilitate termination of the effect corresponding to the selected option, and facilitate disappearing of the selected option, on termination of the dragging of the pointer object or the swiping of the touch sensitive object.

20 Optionally, in the electronic device, the rapidity of application of the effect corresponding to the selected option, over the portion of the graphical object, or over the one or graphical objects, is dependent at least partially on the speed of performing the dragging operation of the pointer, or the swiping operation of the display sensitive object. More optionally, in the electronic device, the graphical user
25 interface is a touch-sensitive screen, and the user interface is implemented as a tactile surface of the touch-sensitive screen.

30 Optionally, in the electronic device, the graphical user interface is configured to disable the application of the effect corresponding to the selected option, to the portion of the specific graphical object, or to the one or more graphical objects, in response to termination of the dragging of the pointer object, or the swiping of the display sensitive object.

Optionally, in the electronic device, the graphical user interface and the software product correspond to a gaming system or a simulation system. More optionally, in the electronic device, the gaming system or simulation system corresponds to a farming game, the graphical objects of the graphical user interface correspond to different spatial regions of a farming environment in which one or more crops are desired to be grown, and wherein the user selectable options in the menu list correspond to different farming tools.

Optionally in the electronic device, there is included a database for continuously recording and updating the change in status of the one or more graphical objects, the software product being coupled to the database and being configured to resume the status of the one or more graphical objects to their last updated status in the database, in case of interruptions in the operable state of the graphical user interface.

Optionally, a plurality of electronic devices are connected to a server through a network, the graphical user interface being generated temporally concurrently on each of the electronic devices, to facilitate a plurality of users' interaction with the graphical user interface, wherein the graphical user interfaces generated on the plurality of electronic devices are coordinated through the server and updated concurrently on the plurality of electronic devices with time.

Optionally, the electronic device is implemented using a desktop computer, a laptop computer, an iPad, or a smart phone, including an iPhone®, an Android® phone or a Symbian® phone; "®" denotes registered trademarks.

According to a fifth aspect of the present invention, there is provided a method of facilitating easy user interactions with a graphical user interface, the graphical interface being generated and rendered on the display of an electronic device, by executing a software product on a computing hardware of the electronic device, the method comprising:

- (a) rendering one or graphical objects within the graphical user interface;
- (b) clicking or tapping one or more graphical objects through a pointer object, to invoke a menu list containing a set of user-selectable options, the user-

selectable options corresponding to an effect to be applied to a portion of a specific graphical object, or to one or more graphical objects; and

- 5 (c) selecting a specific user-selectable option, and applying the effect corresponding to the selected option, to a portion of a specific graphical object, or to one or more graphical object, by performing one of a dragging operation of the pointer object and a swiping operation of a display sensitive item, over the specific portion of the graphical object, or over the one or more graphical objects, respectively.

10 Optionally, in the method, the graphical user interface is configured to keep the effect corresponding to the selected user-selectable option active, until the time the dragging operation or the swiping operation is performed, and is configured to enable disappearing of the selected option when the dragging or the swiping operation is terminated.

15 Optionally, in the method, the software product corresponds to a gaming system or a simulation system. More optionally, in the method, the gaming or simulation system corresponds to a farming game or farming simulation, the graphical objects correspond the spatial regions of a farming environment, and the user selectable options correspond to different farming tools.

20

Optionally, the method further comprises continuously recording and updating the change in status of the one or more graphical objects, coupling the software product to the database, and resuming the status of one or more graphical objects to their last updated status in the database, in case of interruptions in the operations of the graphical user interface.

25

Optionally, the method further comprises:

- 30 (d) connecting a plurality of the electronic devices to a server through a network;
- (e) generating the graphical user interface temporally concurrently on the displays of the different electronic devices; and
- (f) coordinating the plurality of graphical user interfaces through the server, and updating them concurrently with time, to facilitate multiple users' interaction and coordination with the graphical user interfaces.

Optionally, in the method, the graphical user interfaces correspond to a gaming system, and the method being configured to facilitate online multiplayer gaming system.

5

According to a sixth aspect of the present invention, there is provided a software product recorded on a machine readable data storage medium, the software product being executable on the computing hardware of a computing device, for implementing a method pursuant to the fifth aspect of the invention.

10

It will be appreciated that features of the invention are susceptible to being combined in various combinations without departing from the scope of the invention as defined by the appended claims.

15 **Description of the diagrams**

Embodiments of the present invention will now be described, by way of example only, with reference to the following diagrams wherein:

FIG. 1 is an overview schematic illustration of a system pursuant to the present invention, providing a graphical user interface (GUI) for interfacing one or more users to a facility, wherein the facility includes elements of gaming, simulation and/or real technical system control;

20

FIG. 2 is an illustration of an embodiment of the graphical user interface of FIG. 1;

FIG. 3 is an illustration of an example environment which is controllable using the graphical user interface of FIG. 2;

25

FIG. 4 and FIG. 5 are illustrations of user interactions with the environment of FIG. 3;

FIG. 6 is an illustration of a network of servers and devices required for implementing the system of FIG. 1;

FIG. 7 is a flow diagram of steps implemented within the system of FIG. 1;

30

FIG. 8, FIG. 9 and FIG. 10 are illustrations of an environment which the system of FIG. 1 is operable to simulate or provide a playing environment;

FIG. 11 is an illustration of a graphical user interface (GUI) implemented pursuant to the present invention;

FIG. 12 to FIG. 15 are illustrations of farming environments which are generated by the system of FIG. 1; and

FIG. 16 is an alternative network of data servers and devices for implementing the system as illustrated in FIG. 1.

5 In the accompanying diagrams, an underlined number is employed to represent an item over which the underlined number is positioned or an item to which the underlined number is adjacent. A non-underlined number relates to an item identified by a line linking the non-underlined number to the item. When a number is non-underlined and accompanied by an associated arrow, the non-underlined number is used to identify a general item at which the arrow is pointing.

Description of embodiments of the invention

In overview, the present invention is concerned with an apparatus for controlling technical processes, wherein the technical processes include elements of simulation and control of facilities. In FIG. 1, there is shown an apparatus **10** for providing a graphical user interface (GUI) between a given user **20**, for example one or more persons, and a technical facility **30**, wherein the apparatus **10** is conveniently implemented using a device including computing hardware which is operable to execute one or more software products recorded on machine-readable data storage media. Moreover, the apparatus **10** is conveniently implemented using contemporary computing platforms, for example computing platforms which are wireless-enabled for supporting communication via wireless communication networks. The technical facility **30** optionally includes elements of simulation, gaming and real system control.

25 An embodiment of the present invention pertains to a graphical user interface for a gaming and/or simulation system, for facilitating easy and quick interaction of a given user while playing a game or controlling a simulation, and for avoiding contemporary problems experienced while performing touching or swiping operations on the touch-sensitive screens of electronic devices on which the games are being played and/or simulations are being executed.

Gaming systems are incorporated for leisure in many electronic computing devices, including computers, *iPads*, mobile phones, tablet computers and smart phones. Many such conventional electronic devices incorporate touch-sensitive screens for

obtaining user inputs and for making congenial user experience with the interface. For playing games on electronic devices, or controlling technical simulations, without a touch-sensitive screen, including many desktop and laptop computers, the user generally interacts with and provides inputs to a gaming or simulation system's interface through coupled input devices, such as mice, certain keys on the keypads, and joysticks. Using multiple clicking operations through a mouse is time consuming and unfavourable, for example, in cases where a same operation needs to be performed at multiple points on the gaming or simulation interface. Even with the devices have touch-sensitive displays, when similar operations corresponding to the game being played, or the simulation being executed, need to be performed simultaneously through multiple regions of the interface, this becomes difficult to achieve as the conventional touch-sensitive screens are capable of sensing touching operations one at a time, at a specific point. Even though multi-touch sensitive screens are currently available, and are incorporated in electronic devices, operations corresponding to certain games, when played, similarly corresponding to certain technical simulations, require simultaneous sensing and detecting of touching or swiping operations performed through multiple regions of the screen.

Thus, the present disclosure provides an enhanced graphical user interface for a gaming and/or simulation system, which improves a given user's experience while playing a game, or executing a technical simulation, on an electronic device. The system and method facilitate performing of touching and swiping operations through a multi-touch sensitive screen of the electronic device, and allows the given user to perform similar operations pertaining to the game or simulation, simultaneously, through different regions of the interface.

In FIG. 2, there is shown a graphical user interface corresponding to a game being played, or a simulation being executed, on an electronic device, illustrating a manner in which a user playing a strategic game or executing a simulation performs touching or swiping operations through multiple points of the interface, simultaneously, for executing similar operations through multiple locations on the interface. As shown, a graphical user interface **100**, corresponding to the game being played or a simulation being executed, is rendered on a display screen on the electronic device. Specifically, the interface **100** is rendered and presented on the display screen, when

a software product corresponding to the game or simulation, is executed on computing hardware of the electronic device. The display screen is a multi-touch sensitive screen, capable of sensing touching or swiping operations performed at multiple points on the screen simultaneously. A user **108** uses two of his/her fingers and performs touching operations at two different locations **102** and **104**, on the interface **100**. The interface **100** senses this operation, and the software product corresponding to the game or simulation, executes actions pertaining to the performed touching operation on different graphical objects of the interface **100**. This is explained in more detail hereinafter with respect to an example of a specific gaming environment or simulation environment, in conjunction with the drawings that follow.

In FIG. 3, there is shown a snapshot of the display screen of an electronic device, when a user plays a game, or executes a simulation, on the device, and uses the method of the present disclosure for controlling the gaming- or simulation-interface. As shown, an electronic device **200** includes a display screen **202**, wherein different resources, for performing actions corresponding to the game or simulation, are rendered on a graphical element **206** of the display screen **202**. For the purpose of explaining the disclosure, the depicted gaming- or simulation-environment corresponds to a war-based game or simulation, and the gaming environment rendered on the display screen **200** corresponds to a battlefield **204**. The device **200** can be any suitable electronic device that incorporates a multi-touch sensitive screen, including an *iPad*, a smartphone, for example, Apple's *iPhone*®, an *Android* phone®, or a *Symbian* phone®, a tablet computer, a desktop computer or a laptop computer, and so forth. The battlefield **204** has different graphical objects, for example, a target **208**, which can represent a castle, or a camp. An objective of the game or simulation may be to win the castle, by attacking it through different resources A, B and C, and so forth, shown within the graphical element **206**. The resources A, B and C within the element **206** can represent weapons, including guns, cannons, arrows, bows, and so forth (namely technical hardware), or represent different troops, armed soldiers, walking soldiers or horse riding soldiers, and so forth. Though only three such resources have been shown, there can be multiple other resources for playing the game or executing the simulation. In the strategic game or simulation, the user selects one or more of these resources, and deploys

the selected resources at multiple locations within the battlefield **204**. The selected resources are then used to perform operations for conquering the target **208**. For example, the deployed resources can be operated to attack the target **208** through the different weapons they possess. The user can use multiple touching operations simultaneously, at different points on the display **202**, to deploy the resources A, B, C, and so forth at multiple locations within the battlefield **204**. Moreover, the user can also perform the swiping operation, to deploy a specific resource all through a set of points along a specific path, by swiping fingers across that path. The movement of the different deployed resource, either away from, or towards the target **208**, can be controlled by pointing towards a specific deployed resource, and swiping the finger in the desired direction. When the user touches the display screen **202** to deploy a selected resource, the screen **202** detects the pressure applied by the user at different points. The number of resources deployed at different locations optionally depends on the amount of pressure applied. Specifically, a higher pressure applied at a specific point results in deploying increased numbers of resources at that point, and vice versa. Moreover, the rapidity of deploying the resources at different locations on the battlefield **204** depends upon the speed with which the user performs the touching or the swiping operation through different points. For example, if the user wishes to deploy a selected resource along different points in a specific path, and performs a swiping operation through the path, the resources are deployed as quickly as the swiping operation through the path is performed. A rapid swiping operation results in a quicker deployment of resources, compared to a slow swiping operation.

Moreover, in FIG. 3, there is shown the display screen of the device, when the user has selected one of the selectable options A, B and C, for deploying resources within the battlefield of the war-based game or simulation. Shown as an example, the user has selected the option B corresponding to a specific category or type of resources to be deployed in the battlefield, to operate on the target **208** thereafter. As aforementioned, the selected resources may be troops, armed soldiers possessing specific kinds of weapons, horse riding soldiers, and so forth. Further, though only one option has been shown being selected, the user can also select multiple options to deploy different kinds of resources in the battlefield. Eventually, after selecting the option B, the user uses two of his/her fingers to control the interface and deploy the

troops at two desired points **302** and **304**, as shown. Specifically, the user performs a touching operation at the points **302** and **304**, either simultaneously, or in temporal sequence, namely one-by-one. Alternatively, a swiping operation may also be performed by initiating from either of the selected points **302** and **304**, through a specific desired path, to deploy the resources all through the desired path. In an embodiment, the resources are deployed at the selected points, at a specific pre-determined time after the touching operation is performed. For example, in one embodiment, the resources may be deployed at a specific point only if the user keeps his finger in touch with the point for a pre-determined time, which may be about 0.5 to 1 seconds. This feature is adjustable, and the minimum time for which the user needs to keep his fingers in contact with the screen, for deploying the resources, can be customized based on the user's desire, before playing the game or executing the simulation. Further, this avoids the cases where the resources may be deployed unintentionally or undesirably.

15

A specific deployed resource is released for action, for example, to attack the target **208**, based on detection of certain conditions. This may include, for example, the user still keeping his/her finger at a desired point, for about 1 to 2 seconds after the resource has been already deployed at that point. In another case, an execution option may be separately rendered on the display screen, and the user needs to provide an execution command through the option, after the resources are deployed. Moreover, the multi-touch operations performed through the different fingers act independently, and the display screen is configured to sense and interpret the swiping or touching operations performed through these fingers independently. Specifically, as an example, when one finger is touched or swiped through specific points on the screen, one set of resources may be deployed over one set of locations corresponding to those points, and subsequently, when another finger is touched or swiped through a different set of points, a second set of resources may be subsequently deployed over those points too. The two sets of resources may be same or different, depending on the game settings, which are user adjustable, and can be customized before playing the game or executing the simulation. Furthermore, as aforementioned, the display screen is also capable of sensing touching or swiping operations performed at different points simultaneously, and deploy the resources at different points together. In an embodiment, the number of

30

resources deployed at different points, may be one each corresponding to detecting of a touching operation performed at that point. Alternatively, a constant number of resources per unit time may be deployed at a specific point, or over a set of points, as long as a touching or a swiping operation is performed over those points. In
5 another embodiment, as aforementioned, the number of resources deployed is a function of the pressure applied by the user while performing the touching or swiping operation. Specifically, a higher pressure applied at a specific point optionally results in deploying more number of resources at that point, and vice versa.

10 Referring next to FIG. 4, there is illustrated the display screen of the electronic device, where the resources corresponding to the selected option B, are shown deployed at multiple locations on the display screen. As shown, a set of resources **410** are deployed at one set of locations on the screen **202**, and these correspond to multiple touching operations performed earlier around a point **302**, shown in FIG. 4.
15 To deploy the resources **410**, the user optionally performs a swiping operation through a path covering these points. Moreover, another set of resources **420** are shown deployed on the other side of the target **208**. These resources are rendered when the touching operations initiating with a point **304**, see FIG. 4, is performed by the user, through another finger. Similarly, a touching or swiping operation is
20 optionally performed at many other points on the display screen **202**, to deploy the resources at other desirable points.

In FIG. 6, there is shown an illustration of an exemplary environment for implementing the method and apparatus in accordance with the present disclosure.
25 A plurality of electronic devices **502**, **504**, **506** and **508** are shown, through which a user can connect to one of different data servers **510** and **540**, for example game servers and/or simulation servers, through one of a multiple networks represented by **550**, **560** and **570**. The electronic devices **502**, **504**, **506** or **508**, can be any suitable electronic devices having a computing hardware capable of supporting and executing
30 a software product corresponding to a gaming and/or a simulation system. Typical examples of the illustrated electronic devices may include a desktop computer, a laptop computer, a tablet computer, a smart phone including the popularly known *iPhones*®, *Android phone*®, an *iPad*, and so forth. Furthermore, all these electronic devices have one or more multi-touch sensitive screens for sensing and obtaining a

user's input through touching or swiping operations performed at multiple points of the one or more display screens. Moreover, the different electronic devices **502**, **504**, **506** and **508**, are mutually connected to each other through either of the servers **510** and **540**, through suitable communication networks. The networks **550**, **560** and **570**, and so forth, may be Wireless networks, such as a Wireless Local area network (WLAN), Local area networks (LAN), cellular networks, for example, 2G network, 3G network, and so forth. Moreover, any of the electronic devices **504**, **506** and **508** may also use its own Bluetooth network and may be capable of connecting to a Bluetooth server, to synchronize with the other electronic devices; "*Bluetooth*" is a registered trademark. The shown exemplary environment supports multiplayer gaming too, by facilitating multiple users to be online through different devices, connecting through a suitable network, and synchronizing with each other. Moreover, multiple databases, as shown by modules **520**, **530**, and so forth, are coupled to different servers, and information related to the gaming environment is continuously stored in these databases, when the different users are online for multiplayer gaming.

For facilitating single-player gaming or single-user simulation, a user logs on through any of the electronic devices **502**, **504**, **506** or **508**, and connects to one of the gaming or simulation servers **510** or **540**, through a suitable network, for example via the Internet and/or a wireless communication network. As the user logs on, and executes the gaming or simulation software on the computing hardware of the specific device that he/she utilizes, for example, the device **502**, a graphical user interface corresponding to the game is generated, and is rendered on the display screen of the device **502**. The graphical user interface presents different graphical objects pertaining to the game or simulation, on the display screen of the device **502**. The graphical objects may be represented by different blocks/segments of the graphical user interface, on which different operations corresponding to the game being played or simulation being executed, can be performed. For example, in a case where the game is a war-based game or the simulation relates to technical military hardware such as guns, bombs and such like, such blocks/segments may represent one or more targets that need to be conquered, such as the target **208** shown earlier in FIG. 3. Moreover, one or more graphical elements, representing a set of user selectable options for performing actions on the graphical objects, are

also rendered on the interface of the device **502**. Such elements have been explained in detail earlier, in conjunction with the previous drawings of the disclosure, which pertain to a war-based game or simulation. Moreover, a point object (cursor) movable over the different graphical objects appears on the graphical user interface, for controlling the gaming or simulation operations. The pointer object is controllable by performing touching, swiping or tapping operations on the display screen of the device **502**. Moreover, other input devices, including a mouse, a joystick or a set of keyboard buttons, may be coupled to the device **502** (though not shown), for facilitating provision of user inputs. The touching operation on the display screen can be performed through use of a suitable touch-sensitive object, including fingers, a pen, a pencil, a pointing organ, and so forth.

Another database **580**, coupled to the gaming or simulation server **510**, serves as a back-end database for the gaming or simulation server **510**. As the user of the device **502** starts playing the game, or executing a simulation, typical actions and gestures performed by the user, are recorded in the back-end server **580**. Specifically, such actions are interpreted through the gaming or simulation server **510**, and are sent as messages to the back-end server **580**, which eventually maintains a log of, and a backup for the played game or executed simulation. Such messages can be in the form of data packages sent over an Internet connection through which the device **502** is connected to the server **510**, or sent over any other wireless or wired network connecting the device **502** to the server **510**, as aforementioned. Typical elements of such messages for maintaining a backup for the game or simulation may include a header, a payload and a checksum. The checksum can be a function of the payload, or it may be a unique user identifier, such as a username or similar. An advantage arising from including the checksum in the back-end maintaining messages, is a possibility of avoiding potential frauds while playing the game, or avoiding third-party corruption of a simulation which could adversely influence results generated by the simulation. Those in the art will understand that an appropriate checksum function or a checksum algorithm may be applied to the collected digital data, while the game is being played, or simulation being executed, to obtain the checksum. Further, the checksum corresponding to a specific data can be recomputed at any point of time, and compared to the stored checksum, to avoid possible frauds. The back-end messages received by the server

510 are also sent to the other databases **520** and **530** of the server **510**. In these databases **520**, **530**, these back-end messages are used to maintain a continuous logic that represents the status of the game or simulation, for example, the exact score of the player updated with time, and a stage of the game that the player has already reached, or results of the simulation such as yield, integrity of a structure and similar. With a continuous receipt of the back-end messages by the databases **520** and **530**, a regular updating of the game status is undertaken within these server databases **520** and **530**, eventually, with time. This ensures facilitating the resumption of the game or simulation to its last status, in cases where the device **510** unexpectedly shuts down, the device **510** is unexpectedly hindered in its communication or the user changes the gaming or simulation terminal, or he/she intentionally quits playing or executing the simulation for a certain period, and logs in at some other time, such a possibility of resumption assists to enhance user satisfaction with the graphical user interface.

15

Though only two servers **510** and **540** have been shown, there can be multiple gaming or simulation servers coordinating with, and connected to each other, for implementing the gaming and/or simulation environment in accordance with the present disclosure. Moreover, the environment as shown in Fig. 6 is capable of implementing a thin client game or simulation, namely written in a computer program that is partially independent in its computational roles, wherein a part of the gaming- or simulation-logic may be stored in any of the servers **510** and **540**, and a part of it may be stored in the gaming or simulation terminal. The depicted environment also supports a thick client game or simulation, namely written in a solely independent computer, wherein the entire gaming or simulation logic may be stored in the gaming terminal. Furthermore, the game or simulation is optionally completely web-based too, wherein most of the gaming or simulation logic may be stored in any of the servers **510** or **540**. The gaming or simulation software corresponding to the game or simulation being played or executed respectively, can be optionally written in any programming language.

30

Although, the gaming or simulation system implementable through the illustrated gaming or simulation environment, has been described for the case when a single user logs on to any of the electronic devices **502**, **504**, **506** or **508**, the same gaming

or simulation environment is capable of supporting multi-participant gaming or simulation, wherein different users may log on through different electronic devices, and synchronize with each other by connecting concurrently through any of the common gaming or simulation servers **510** and **540**, through suitable networks as
5
aforementioned, and share a common graphical user interface representing the ongoing game or simulation. In such embodiments, the graphical user interface rendered on the display screens of the different electronic devices, is regularly updated, concurrently, through the logic data stored in the databases **520** and **530** of the gaming or simulation servers, at the back-end.

10

In FIG. 7, there is shown a method of facilitating user interactions with a graphical user interface (GUI), while playing a game or executing a simulation. The method is elucidated in conjunction with a typical example of a war-based game or simulation, described earlier through the previous figures of the disclosure. However, the
15
method can be generalized and implemented on other gaming or simulation environments also, and is not intended to limiting the scope of the present disclosure. At a step **604**, the method includes a step of executing a software product on computing hardware of an electronic device. The electronic device can be any appropriate device incorporating a multi-touch sensitive screen, examples of which
20
have been set forth earlier. The software product corresponds to a gaming or simulation system, for facilitating playing of a game or executing a technical simulation on the electronic device. At a step **608**, as the software product is executed, the method includes generating and rendering on a graphical user interface a representation of the gaming or simulation environment on the display
25
screen of the electronic device. At a step **612**, the method includes presenting via the graphical user interface different graphical objects, a set of user selectable options for controlling the gaming or simulation environment, and a pointer for performing touching or swiping operations through different points on the interface. For example, as aforementioned, in a war-based game or simulation, the graphical
30
objects may correspond to a castle to be conquered, a camp to be destroyed, and so forth, and the gaming or simulation environment may represent a battlefield. The user selectable options may correspond to different resources that can be deployed over different portions of the interface, to perform operations on the graphical objects, for example for scoring points or otherwise determining their technical characteristics.

Specifically, the resources may be different kinds of troops, horse riding soldiers, armed soldiers possessing versatility of weapons, including guns, bombs, cannons, bows, arrows, and so forth. At a step **616**, the method includes the user selecting one or more selectable options corresponding to the different kinds of resources that he/she wants to deploy within the gaming or simulation environment. Proceeding further, after selecting and enabling one of the selectable options, at a step **620**, the method includes deploying the corresponding resources, the user performs touching or swiping operations on multiple points of the interface, depending on the locations where he/she wishes to deploy them. At step a **624**, the resources are deployed and appear on the gaming or simulation interface. In an embodiment, the nature of deployment of the different resources may depend on different parameters. For example, the number of resources deployed at a specific point, depends on the pressure applied by the user on the display screen, while performing the touching operation at that point. Moreover, if the user wishes to deploy resources along multiple points constituting a specific path, and performs a swiping operation along that path, the rapidity with which the resources are deployed depends on the speed with which the user performs the swiping operation along the path. In another embodiment, a constant number of resources per unit time can be deployed at each point where a touching operation is being performed. The nature of deployment of resources is user adjustable, and can be customized, based on the user's priority, before playing the game.

At a step **628**, the method includes checking whether or not other resources are desired to be deployed, before executing actions through the resources. If "yes", the method includes returning to the step **616**, selecting the selectable options corresponding to the resource, and performing the touching or swiping operations through the desired points again. Alternatively, going further, at a step **632**, the method includes releasing the deployed resources for action, within the gaming or simulation environment. For example, in a war-based game or simulation, the deployed troops/armed soldiers are released for operating on a specific target, to attack it from different points where they are deployed. In an embodiment, the releasing of the deployed resources is automated, and occurs when the user keeps his/her fingers on a specific resource for a pre-determined time after deploying it. For example, this time may be about 1 to 2 seconds of touching operation after the

resource is already deployed. The display screen is configured to sense this pre-determined time, and the software product executes action pertaining to the deployed resource, when this occurs. In another embodiment, releasing the different resources may require a manual user input. Specifically, for example, a triggering option (like a “go” or “fire” option) may be rendered after deploying the resources, and the resources may not be released until the user manually initiates the option. At a step **636**, after the actions have been performed by the deployed resources, the graphical user interface is updated and a reformed interface representing the latest status of the gaming- or simulation-environment, renders on the display screen.

10

The method and system of the present disclosure, for improving interaction of a user with a graphical user interface corresponding to a game and/or simulation, provides substantial benefits as the user performs different operations in a gaming or simulation environment. Similar operations, when desired to be performed by a user, through different locations on the gaming or simulation interface, can be easily executed by touching or swiping through multiple points of the display screen simultaneously. Hence, the user’s experience with the gaming or simulation interface is much more comfortable.

15

20

Although the present disclosure has been described comprehensively, through an exemplary embodiment where it is applicable in a gaming and/or simulation environment, and specifically through the example of a war-based game or simulation, the disclosure also finds its applications in other gaming, control and simulation environments, and, generally, may be applicable to other graphical user interfaces, not pertaining to a gaming or simulation system also. In certain applications, the user interface of the disclosed embodiment can be used for a virtual control of any type of game, technical system or simulation. Certain aspects of the disclosed embodiments are also applicable to perform other operations, including building arcades and solving puzzle games. Further, the congenial user interface may also be implemented within other types of games, for example, adventurous, role playing and shooting games, construction and management simulation games, and so forth. For example, the congenial user interface can be used in computer terminals employed at financial exchanges, for example in Wall Street in New York and the Stock Exchange in London, where traders need to control multiple

25

30

transactions simultaneously when executing a financial transaction, for example a synthetic credit default swap or a trading in derivative financial products.

Further embodiments of the present invention will now be described below. The present disclosure pertains to a graphical user interface (GUI) for a gaming or simulation system, as aforementioned, for facilitating easy and quick interaction of a user while playing the game or executing the simulation, and for avoiding the cumbersome operations normally experienced while using a mouse or a joystick when a game or simulation is played or executed respectively on an electronic device.

Gaming and simulation systems are incorporated for leisure in many electronic devices, including computers, *iPads*, mobile phones, tablet computers and smart phones. While playing a game, or executing a simulation, on the computing devices without a touch-screen facility, including many conventionally available desktop and laptop computers, the major mode of interaction of a user with the gaming or simulation system interface is through devices like mouse, certain keys on the keypad, and the joysticks coupled to the computing device. In many games or technical simulations, the user often desires to obtain quick application of certain operations, for which he/she needs to use the clicking or tapping operation multiple times, and at different spots of the interface, which often takes time. Most of the smart phones and tablet computers have now incorporated touch screen displays, and playing games on these devices is comparatively easier. However, while interacting with the touch-sensitive screen acting as tactile surface for the graphical user interface corresponding to a game, multiple clicking or tapping operations at a single or different places may deteriorate the screen. Moreover, the screen often gets degenerated in long run, producing scratches and dirt spots on it, as a device is used too often for playing games, which is often undesirable. Furthermore, certain operations require consistent clicking and tapping at different locations on the graphical user interface, which takes time to enable the operations.

In FIG. 8, there is depicted the graphical user interface corresponding to a farming game or farming simulation, illustrating how the different relevant operations are conventionally performed, and the problems faced by a user/player, while performing

these operations. The simulation is beneficially employed in respect of Africa as a technical assistance for farmers coping with agriculture in harsh environmental conditions, for example exacerbated by anthropogenically-forced climate change believed to be caused by anthropogenic Carbon Dioxide emissions into the Earth's atmosphere, causing an increase of atmospheric Carbon Dioxide concentration of circa 3 p.p.m./year, in respect of a contemporary Carbon Dioxide concentration in atmosphere of around 400 p.p.m. Increased Carbon Dioxide concentrations are believed to be causing acidification of World oceans, namely adversely influencing major sources for aquatic foods, already stressed by radioactive leaks from Fukushima, Japan, namely the worst industrial accident in human history.

In FIG. 8, there is a farming field **1100**, and multiple characters **1106** which control the operations on the field **1100**. The characters **1106** are controlled by the user/player, and are moved and allowed to perform different operations within the field **1100**. A score card is shown in the top left corner of the graphical interface, and different houses **1102** are shown, where the characters **1106** can hide. The game or simulation is about growing different crops/fruits in different suitable parts of the field **1100**, for example as a function of future weather predictions pertaining to Africa, for example as determined from analyzing data from meteorological satellites. An example situation is now to be described: the character **1106** desires to grow something in a specific region of the field **1100**. Referring next to FIG. 9, the user selects a graphical object **1200** corresponding to the location where he/she wishes to grow a specific crop. The selection is made by tapping the object **1200** through the mouse, or by touching the interface, if the interface is touch-sensitive. As the user touches the object **1200**, a menu list appears, containing different selectable options corresponding to different crops that can be grown in that area, for example, raspberries **1206**, blueberries **1204**, strawberries **1208**, and so forth, as shown. Suppose the user has decided to grow blueberries **1204** in one portion, and raspberries **1206** in another region of the field. For this the user selects the relevant options and selects the corresponding regions where he/she wishes to grow them. Continuing further, the updated field **1100** of FIG. 8 is shown now in Fig. 10, where blueberries have been shown grown in a region **1300**, and the raspberries have been shown grown along the region **1302**. A major problem here arises when the farming field is substantially large, and different crops are required to be grown in different

regions of the farming field. Moreover, a specific crop may be desired to be grown in different regions of the field, lying proximal to each other, or in abutment. For enabling this, the user needs to select each of those regions individually, through multiple clicking/tapping operations through the mouse, or by pointing the finger or a touch sensitive object like fingers, on different regions, in case where the screen is a touch-sensitive screen. In both the cases, the operation consumes a lot of time, and specifically, when the operation is performed on a touch-screen through fingers, it may deteriorate the screen eventually.

10 The present disclosure provides an efficient and user friendly graphical user interface (GUI) for a gaming- or simulation-system like that shown in FIG. 8 to FIG. 10, an interface that facilitates easy and quick operations by dragging a pointer object or by performing a swiping action over different graphical objects of the interface.

15 Specifically, the present disclosure is related to performing a swiping operation on the graphical user interface of a gaming- and/or simulation-system, while controlling or facilitating operations on the interface. In FIG. 11, there is illustrated the swiping operation that can be performed on the graphical user interface of a gaming or simulation system, for controlling operations during playing a game or executing a simulation. As shown, for performing the swiping operation of the present disclosure, a finger **1408** of the user is initially placed at a desired point **1402**, and moved along a desired path **1406**, until a desired destination point **1404** is reached, in the normal fashion as it is done to operate menus and handle other applications in electronic devices incorporating touch-sensitive screens **1400**.

25 Moreover, instead of using fingers, the swiping operation can also be performed through a mouse, by pointing and tapping the mouse initially at the point **1402**, dragging the pointer on the screen along the desired path **1406**, through the mouse, and finally releasing the mouse at the final position **1404**. Further, any other display sensitive device or an organ, for example, a pen or a pointed device, can be used on the screen for performing the swiping operation. Connecting this operation and its advantages applicable on the typical farming environment depicted in FIG. 8 to FIG. 10, suppose a user wishes to grow raspberries all along a wide region represented by the path **1406** in FIG. 11, on different blocks on the farming field. Then, the user

just needs to select the raspberry option that pops up, by pointing on any point along the path **1406**, and swipe his/her fingers all along the path **1406**. This operation will lead to easy and quicker growing of the raspberries along the entire path **1406**.

5 In FIG. 12 to FIG. 15, there is shown the view of the farming field shown earlier in FIG. 8, and the figures illustrate the advantages of the swiping feature supported by the graphical user interface of the present disclosure. As shown in Fig. 12, a view of a farm field **1500** is illustrated, and the object of the game or simulation is to score points or acquire credits by producing different products along different regions of the field **1500**. Growing different crops/products, or performing different operations like
10 harvesting or watering of different sections of the field **1500**, carry different points or credits to be scored by the user. The field **1500** has different segments/blocks that can be modified by the user to score points or credits. These segments/blocks are represented by the different graphical objects of a graphical user interface which presents the gaming environment or the farm field **1500** on the display screen of an electronic device on which the game is being played, or the simulation is being executed. Referring next to FIG. 13, for growing a specific product/crop, the user has to click or tap through the mouse, or touch with his finger, or through a display sensitive object (in case where the screen of the electronic device is touch-sensitive),
15 at a specific desired position, for example, the one represented by the block **1602**, as shown. As the user touches the block **1602**, an item specific menu (ISM) corresponding to the block **1602** appears on the graphical user interface. Different blocks may have different item specific menus, corresponding to the possible crops/products that can be grown over them. As shown, the ISM menu corresponding to block **1602** shows different user selectable options like A, B, C, D
20 and E, which correspond to different crops that can be grown in the field. Each selectable option corresponds to a specific tool for growing a different kind of crop/product, for example, maize, corn, carrots, wheat and rice. The embodiment shown in the figures and described herein, is a mere example, and other
25 embodiments incorporating obvious variations may also be possible, thus, not limiting the scope of the present disclosure. For example, there may be other different kind of tools present in the ISM menu, depending on the block/segment of the field clicked, tapped or selected. Specifically, if the selected block **1602** is already cultivated, then some of the selectable options appearing in the ISM menu may
30

correspond to pesticide spray, harvesting, pouring water, and so forth. Referring next to FIG. 14, if the user decides to cultivate rice, for example, then he/she selects a suitable corresponding option from the ISM menu, and swipes his/her fingers all over the different blocks/segments of the field, wherever he/she desires to grow the rice. Eventually, as shown, the cultivated rice appears all over the region **1700** of the farm field, where the user has swiped his fingers, or dragged the mouse. As a further example to illustrate the application of swiping motion to other operations, if the user now wishes to harvest the grown rice in certain areas of the region **1700**, then he/she taps, clicks or touches the region **1700**, and one of the tools appears in another popping ISM menu, for sickle operation, as shown by the tool **1702**. Continuing further in conjunction with FIG. 15, the user points his/her finger over the sickle tool, and swipes the finger over regions of the field where he/she wants to harvest the grown rice. Eventually, as shown, the user gets successful in harvesting and collecting rice from areas **1802**, and has intentionally left the other areas free from being harvested.

Emphasizing on the advantages of the application of the swiping feature in the graphical user interface of a gaming system, as compared to the solutions as illustrated before through FIG. 8 to FIG. 10, all such operations like harvesting or cultivating in a farm field, for example, are easily done through the extremely quick and easily operable swiping action, which just takes a fraction of a second and avoids multiple clicking or tapping at different points on the interface, as was done in prior-art gaming or simulation systems. This eliminates any effects like deterioration of the display screen if the screen is touch sensitive, or avoids any complexities in performing different operations, irrespective of how big the farm field may be.

In FIG. 16, there is shown an exemplary environment for implementing the method and system in accordance with an aspect of the present disclosure. As shown, different electronic devices **1902**, **1904**, **1906** and **1908** are depicted, through which a user can connect to one of the different gaming or simulation servers **1910** and **1940**, through one of the multiple networks represented by **1950**, **1960** and **1970**. The electronic devices **1902**, **1904**, **1906** or **1908**, can be any suitable electronic devices having a computing hardware capable of supporting and executing a software product corresponding to a gaming and/or simulation system. Typical examples of

the illustrated electronic devices may include a desktop computer, a laptop computer, a tablet computer, a smart phone including the predominantly known *iPhones*®, *Android phone*® and so forth, an *iPad*, and so forth. Moreover, any of the electronic devices can have the touch-sensitive screen for obtaining user inputs through a touching operation, and some of them may also be coupled to, and operable through conventional devices like a mouse, a joystick, a keyboard, and so forth. Further, the different electronic devices **1902**, **1904**, **1906** and **1908**, are commonly connected to each other through the servers **1910** and **1940**, through suitable networks. The networks **1950**, **1960** and **1970**, and so forth, may be Wireless networks, for example a Wireless Local area network (WLAN), Local area networks, cellular networks, for example, 2G network, 3G network, and so forth. Furthermore, any of the electronic devices may also use its own Bluetooth network and Bluetooth server, to connect and synchronize with the other electronic devices; “*Bluetooth*” is a registered trademark. The exemplary environment facilitates multiple users to be online at the same time, and synchronize with each other, to enable multiplayer gaming. Additionally, multiple databases **1920**, **1930**, corresponding to the different servers, as illustrated, allow the different servers to store information relevant to the gaming or simulation environment, when the different users are online for multiuser gaming and/or simulation.

For a user player gaming or executing simulations, the user logs on through any of the electronic devices **1902**, **1904**, **1906** or **1908**, and connects to one of the gaming or simulation servers **1910** or **1940**, through a suitable network. As the user logs on, and executes the gaming or simulation software on the computing hardware of a specific device, for example, the device **1902**, a graphical user interface corresponding to the game or simulation is generated and rendered on the display screen of the device **1902**. The graphical user interface presents different graphical objects on the display screen of the device **1902**. The graphical objects may be the different blocks/segments of the graphical user interface, on which different operations corresponding to the game being played, or the simulation being executed, can be performed. Moreover, a point object (cursor) movable over the different graphical objects appears on the graphical user interface, for controlling the gaming or simulation operations. If the device **1902** does not have a touch-sensitive screen, the pointer object may be controllable through a mouse, a joystick or a set of

keyboard buttons, coupled to the device **1902**. Furthermore, if the device **1902** has a touch-screen functionality incorporated therein, the same controlling operations can also be performed by swiping or tapping/clicking through fingers or any display sensitive item, like any other organ/pen/pencil.

5

Another database **1980** serves as a back-end database for the gaming or simulation server **1910**. As the user of the device **1902** starts playing the game, or executing the simulation, typical actions and gestures performed by the user, are recorded in the back-end server **1980**. Specifically, such actions are interpreted through the gaming or simulation server **1910**, and are sent as messages to the back-end sever **1980**, which eventually maintains a backup for the played game or executed simulation. Such messages can be in the form of data packages sent over an Internet connection through which the device **1902** is connected to the server **1910**, or any other wireless or wired connection connecting the device **1902** to the server **1910**. Typical elements of such messages for maintaining a back end for the game or simulation, may include a header, a payload and a checksum. The checksum can be a function of the payload, or it may be a unique user identifier, like the username, and so forth. The advantage of including the checksum in back-end maintaining message, is the possibility of avoiding prospective frauds while playing the game, or corruption in a simulation which could adversely influence results generated by the simulation. The back-end messages received by the server **1910** are also sent to the other databases **1920** and **1930** of the server **1910**. In these databases, these back-end messages are used to maintain a continuous logic representing the status of the game or simulation, for example, the exact score of the player with time, and the stage of the game that the player has already reached. With a continuous receipt of the back-end messages by the databases **1920** and **1930**, a regular updating of the game or simulation status is implemented within the server databases **1910** and **1920**, eventually, with time. This ensures facilitating the resumption of the last status of the game or simulation, in a case of the device **1910** unexpectedly shutting down, the user changes the gaming or simulation terminal or intentionally quits playing or executing the simulation for a certain period, and logs in at some other time.

30

Although only two servers **1910** and **1940** have been shown, there can be multiple gaming or simulation servers coordinating with, and, connected to each other, for

implementing the gaming or simulation environment in accordance with the present disclosure. Moreover, the environment, as illustrated in Fig. 16, is capable of being implemented as a thin client game or simulation, wherein a part of the gaming logic, or the simulation logic, may be stored in any of the servers **1910** and **1940**, and a part of it may be stored in the gaming or simulation terminal. The depicted environment also supports a thick client game or simulation, wherein the entire gaming logic, or simulation logic, may be stored in the gaming or simulation terminal. Furthermore, the game can be completely web-based too, wherein most of the gaming logic or simulation logic may be stored in any of the servers **1910** or **1940**. The present invention is optionally implemented via a cloud-computing infrastructure.

Although, the gaming or simulation system implementable through the illustrated gaming or simulation environment, has been explained in the case when a single user logs on to any of the electronic devices **1902**, **1904**, **1906** or **1908**, the same environment is capable of supporting multiuser gaming or simulation, wherein different users may log on through different electronic devices, and synchronize with each other by connecting to the common servers **1910** and **1940** through suitable networks, and share a common graphical user interface representing the ongoing game or simulation, for example a United Nations famine relief programme. In such embodiments, the graphical user interface rendered on the display screens of the different electronic devices, is regularly updated, concurrently, through the logic data stored in the databases **1920** and **1930** of the gaming or simulation servers, at the back-end.

In the foregoing, pressure applied by a given user to a touch-screen is beneficially determined by one or more pressure-sensitive transducers integrated into the touch-screen. However, certain contemporary touch-screens operate only on a binary basis, namely either there is contact or no contact with a given area of the touch-screen. In such touch-screens, pressure applied by the given user can be determined by an area of neighbouring spatially contiguous sensing points on the screen which substantially simultaneously experience a contact being made by the given user. Thus, progressively more spatially contiguous sensing points are substantially simultaneously in contact state as progressively more pressure is applied due to elastic deformation of biological tissue of the given user's finger tips.

A similar pressure sensing functionality can be achieved when the given user employs a pointing device having an elastically deformable end to contact onto the touch-screen to control a game or a simulation, or to enter commands for controlling a real technical facility.

5

Beneficially, when a game or simulation is implemented as described in the foregoing and the given user exits from the game or simulation, for example for resumption at a later time, parameters describing a state of the game or simulation at an instant of exiting from the game are beneficially stored in data memory, so that the state of the
10 game or simulation can be restored again at resumption of the game or simulation.

Modifications to embodiments of the invention described in the foregoing are possible without departing from the scope of the invention as defined by the accompanying claims. Expressions such as “including”, “comprising”, “incorporating”, “consisting
15 of”, “have”, “is” used to describe and claim the present invention are intended to be construed in a non-exclusive manner, namely allowing for items, components or elements not explicitly described also to be present. Reference to the singular is also to be construed to relate to the plural. Numerals included within parentheses in the accompanying claims are intended to assist understanding of the claims and should
20 not be construed in any way to limit subject matter claimed by these claims.

CLAIMS

1. An electronic device comprising:

- 5 a display screen; and
a computing hardware configured to execute a software product, wherein
executing the software product generates and renders a graphical user
interface on the display screen, the graphical user interface being configured
to facilitate user interaction, the computing hardware, graphical user interface
10 and the software product being implemented on a gaming system, the
computer hardware being configured to:
present one or more selectable graphical objects on the graphical user interface;
enable a selection of one or more of the selectable graphical objects;
generate a menu list on the graphical user interface upon selection of one of the
15 selectable graphical objects, the menu list comprising one or more selectable
options;
detect a selection of one of the selectable options from the menu list;
detect a substantially continuous selection of areas along a path on the graphical
user interface, wherein the substantially continuous selection comprises
20 detecting a swipe motion over the graphical user interface; and
execute an action corresponding to the selected option in each area along the
path on the graphical user interface, wherein the gaming system comprises a
farming game, the selectable graphical objects of the graphical user interface
comprise different spatial regions of a farming environment in which one or
25 more crops are grown, and wherein the selectable options in the menu list are
different farming tools.

2. The electronic device of claim 1, wherein detecting the substantially continuous
selection comprises detecting a track of a cursor over the graphical user interface.

30

3. The electronic device of claim 1, further comprising a user input interface rendered
over the graphical user interface, the user input interface being configured to detect
an input corresponding to moving a pointer object, clicking or tapping the pointer
object, or swiping a touch sensitive object over the graphical user interface.

4. The electronic device of claim 1, the computing hardware being configured to continuously apply the selected option to a portion of a graphical object in each area along the path in response to detecting a swipe action of a touch sensitive object
5 over the portion of the graphical object.
5. The electronic device of claim 1, wherein the computing hardware is configured to detect an end of the substantially continuous selection, terminate the action, and remove a visual indicator of the selected option from the graphical user interface.
10
6. The electronic device of claim 1, wherein the computing hardware is configured to detect a speed of the substantially continuous selection of the one or more areas along the path; and
execute the action corresponding to the selected option at a rapidity that is
15 dependent at least partially on the speed of the substantially continuous selection of the one or more areas along the path.
7. The electronic device of claim 1, wherein the graphical user interface is a touch-sensitive screen, and a user interface is implemented on the touch-sensitive screen
20 as a tactile surface of the touch-sensitive screen.
8. The electronic device of claim 1, wherein the computing hardware is configured to disable the execution of the action corresponding to the selected option, in response to detecting a termination of the substantially continuous selection of one or more
25 areas along a path on the graphical user interface.
9. The electronic device of claim 1, comprising a database for continuously recording and updating the change in status of the one or more graphical objects, the software product being coupled to the database and being configured to resume the status of
30 the one or more graphical objects to their last updated status in the database, in case of interruptions in the operable state of the graphical user interface.
10. The electronic device of claim 1, wherein the electronic device is connected to a server through a network, the graphical user interface being generated temporally

concurrently on a plurality of electronic devices to facilitate a plurality of users' interaction with the graphical user interface, wherein each of the graphical user interfaces generated on the plurality of electronic devices are coordinated through the server and updated concurrently on the plurality of electronic devices with time.

5

11. The electronic device of claim 1, wherein the electronic device comprises a desktop computer, a laptop computer, an iPad, or a smart phone, including an iPhone®, an Android® phone or a Symbian® phone.

10

12. A method of facilitating user interactions with a graphical user interface, the graphical interface being generated and rendered on the display of an electronic device, by executing a software product on a computing hardware of the electronic device, the computing hardware, graphical user interface and the software product being implemented on a gaming system, the method comprising:

15

rendering one or graphical objects within the graphical user interface;
detecting a selection of one or more of the one or more graphical object;
rendering a menu list containing a set of selectable options, each selectable option corresponding to an effect to be applied to a portion of a specific graphical object, or to one or more of the one or more graphical objects;

20

detecting a selection of one of the selectable options;
detecting a substantially continuous selection of areas of the graphical user interface along a path by detecting a swipe motion over the graphical user interface; and

25

applying the effect corresponding to the selected option to a portion of a specific graphical object, or to one or more graphical objects corresponding to the path, wherein the gaming system comprises a farming game, the selectable graphical objects of the graphical user interface comprise different spatial regions of a farming environment in which one or more crops are grown, and wherein the selectable options in the menu list are different farming tools.

30

13. The method of claim 12, comprising configuring the graphical user interface to continue to apply the effect corresponding to the selected option during a time of detection of the substantially continuous selection of areas of the graphical user

interface along the path to remove the selected option when the substantial continuous selection is terminated.

5 14. The method of claim 12, comprising continuously recording and updating a change in status of the one or more graphical objects, coupling the software product to a database, and resuming the status of one or more graphical objects to their last updated status in the database, in case of interruptions in the operations of the graphical user interface.

10 15. The method of claim 12, comprising:
connecting a plurality of electronic devices to a server through a network;
generating the graphical user interface temporally concurrently on the displays of each of the electronic devices;
coordinating a plurality of graphical user interfaces through the server, and updating
15 them concurrently with time, to facilitate multiple users' interaction and coordination with the graphical user interfaces.

20 16. The method of claim 15, wherein the graphical user interfaces comprises a gaming system, the method being implemented to facilitate an online multiplayer gaming system.

25 17. A software product recorded on a machine readable data storage medium, the software product being executable on the computing hardware of a computing device, for implementing a method according to claim 12.

1/16

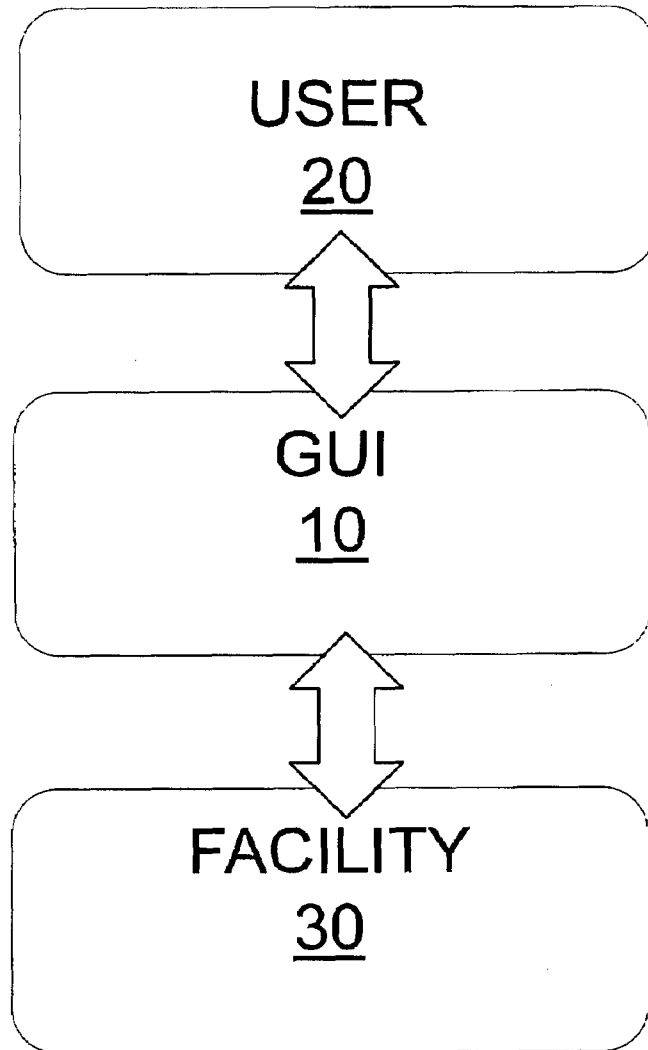

FIG. 1

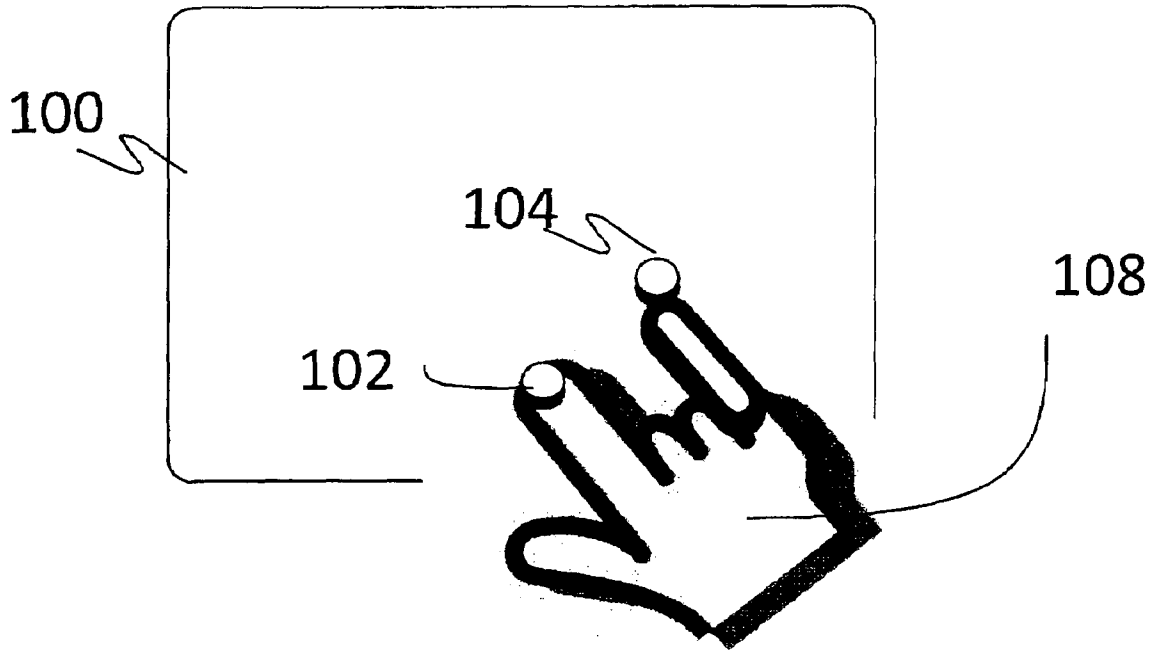

FIG. 2

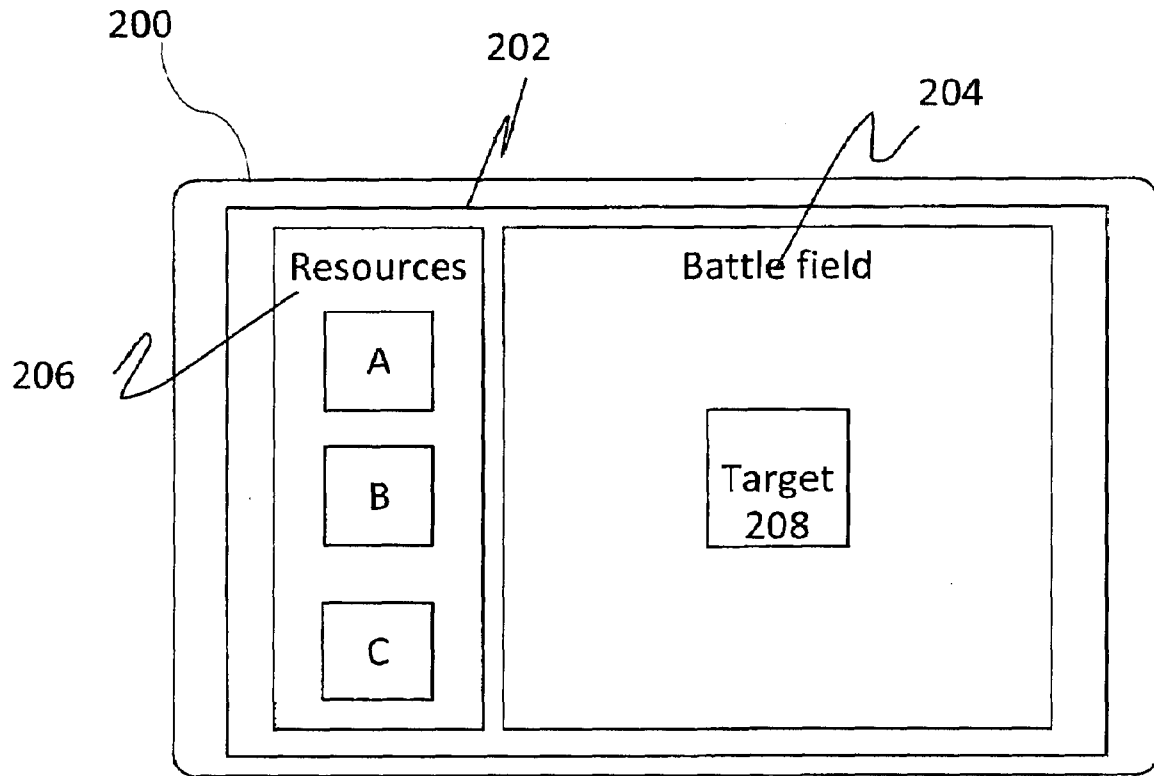

FIG. 3

4/16

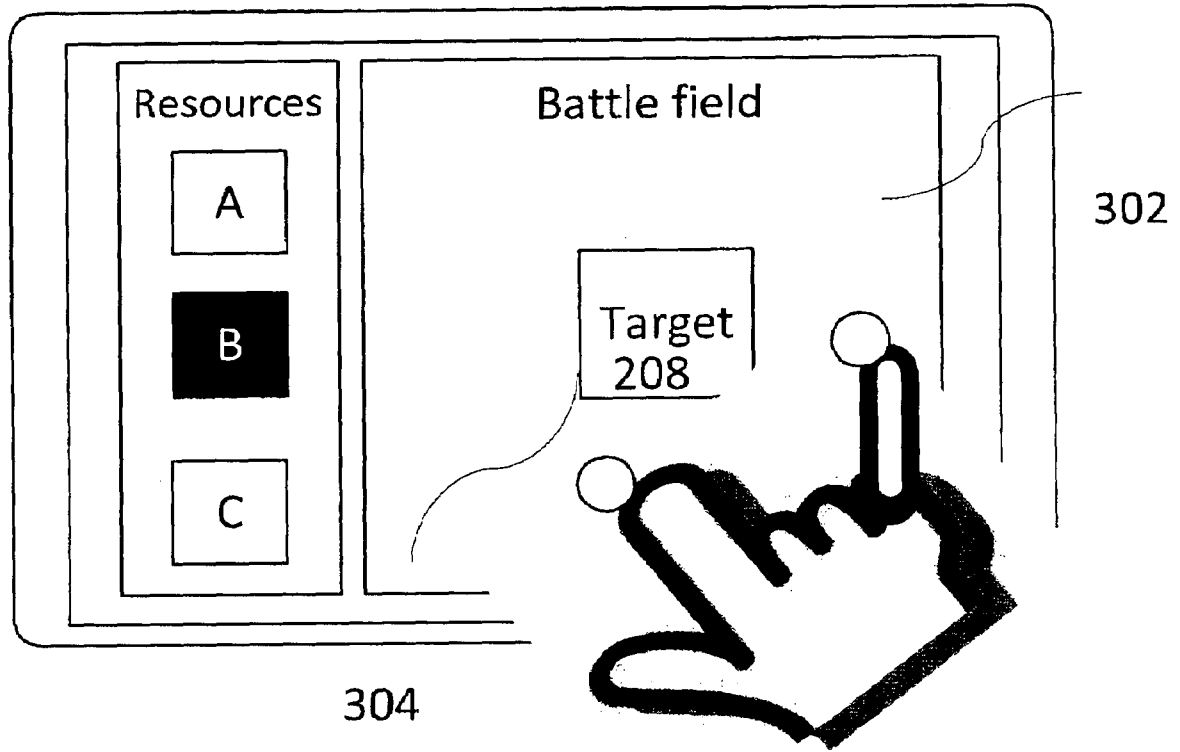

FIG. 4

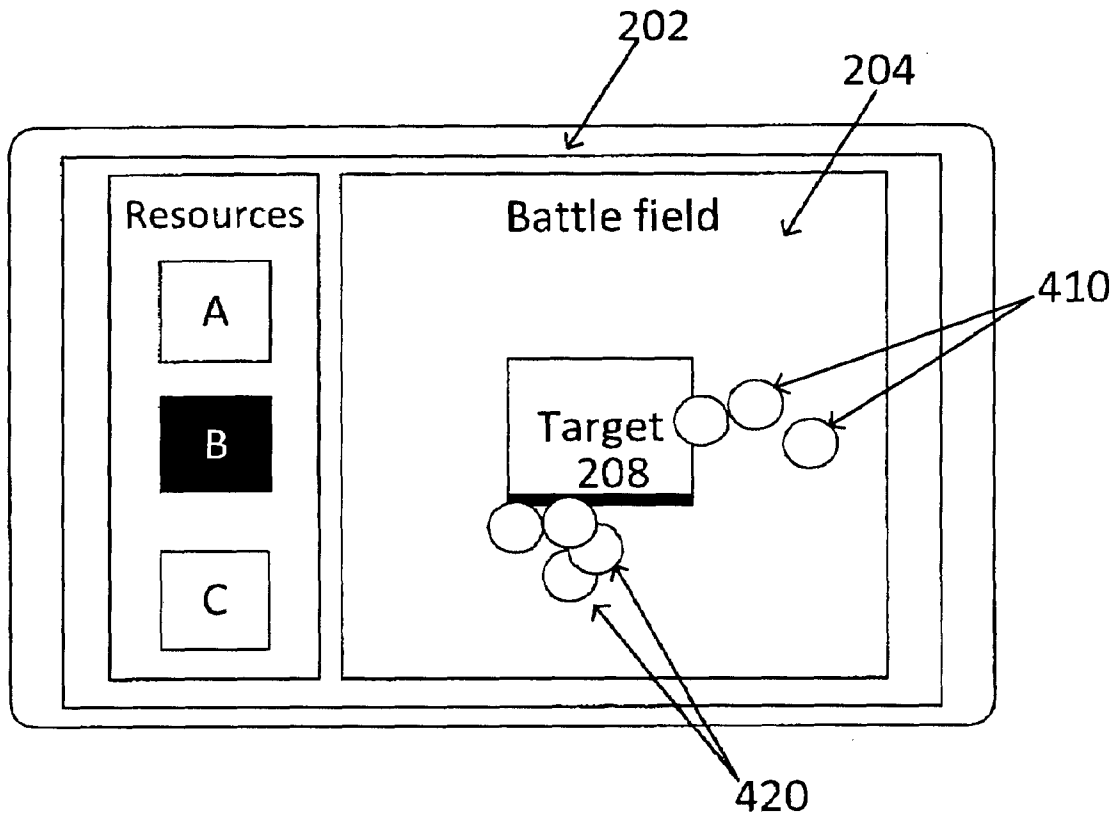

FIG. 5

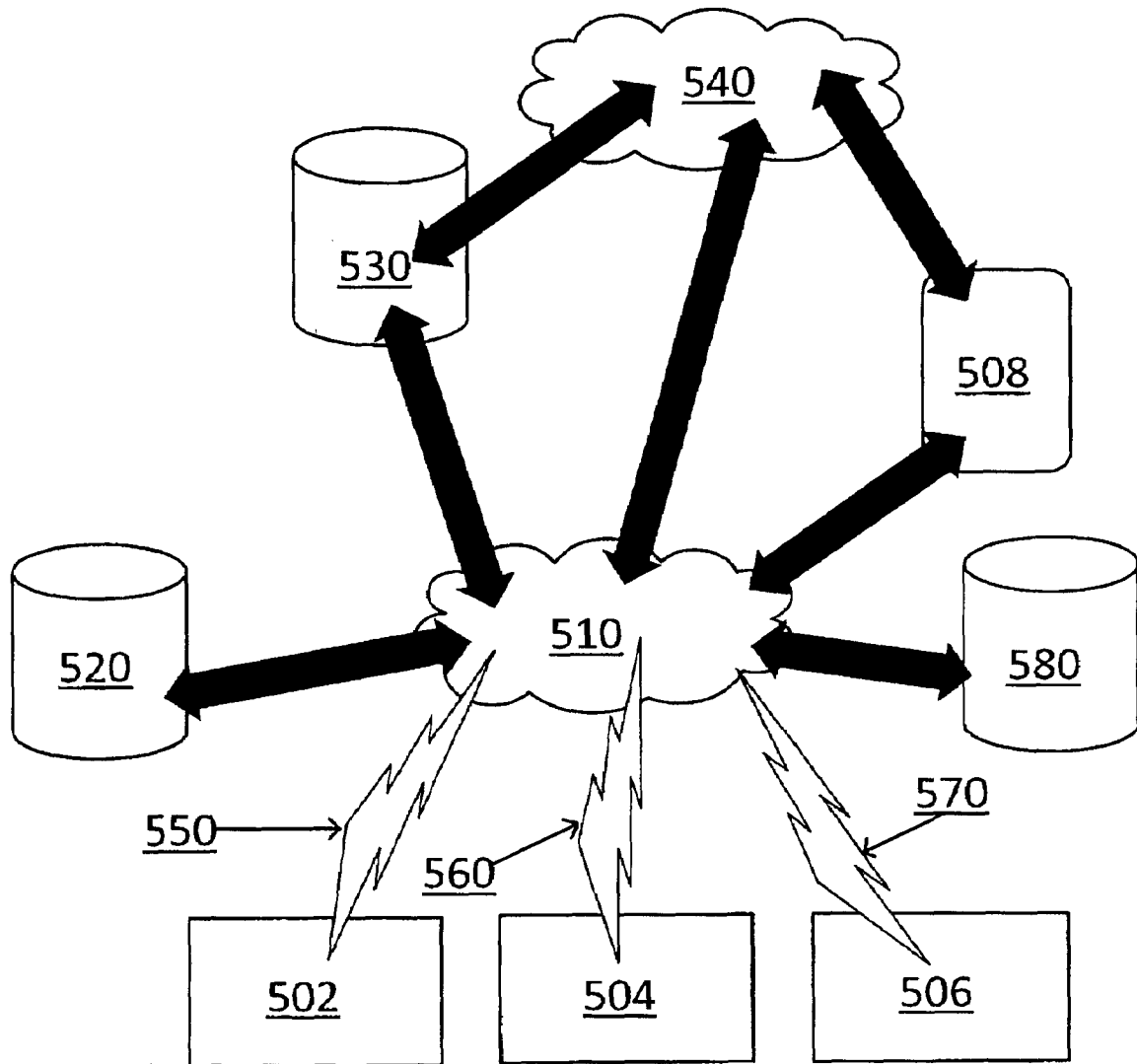

FIG. 6

7/16

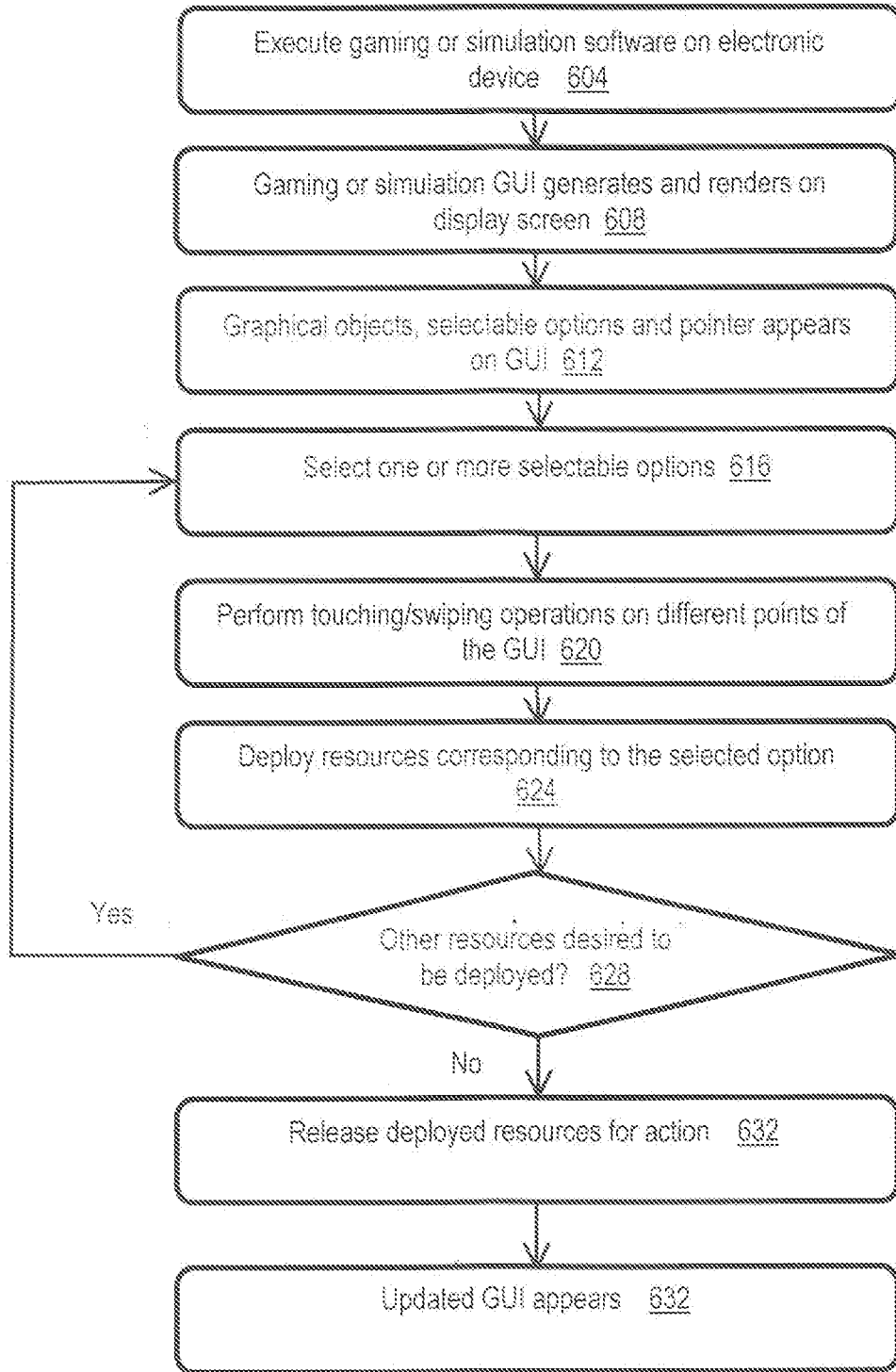

FIG. 7

8/16

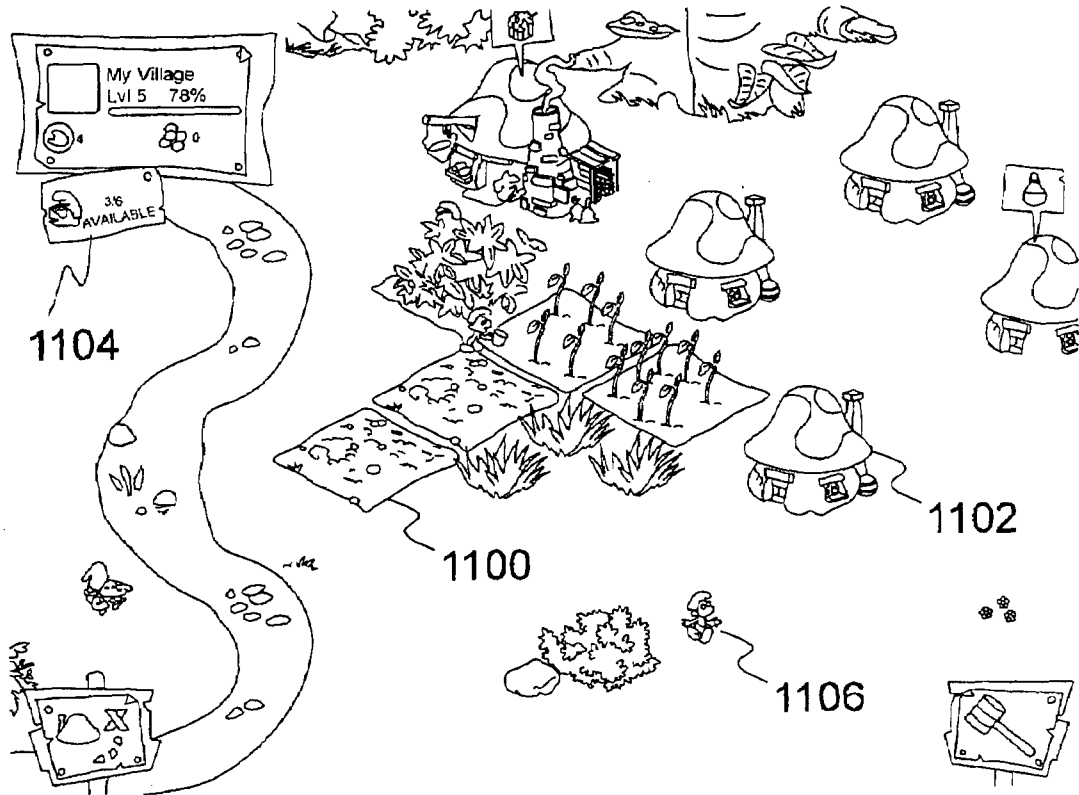

FIG. 8

9/16

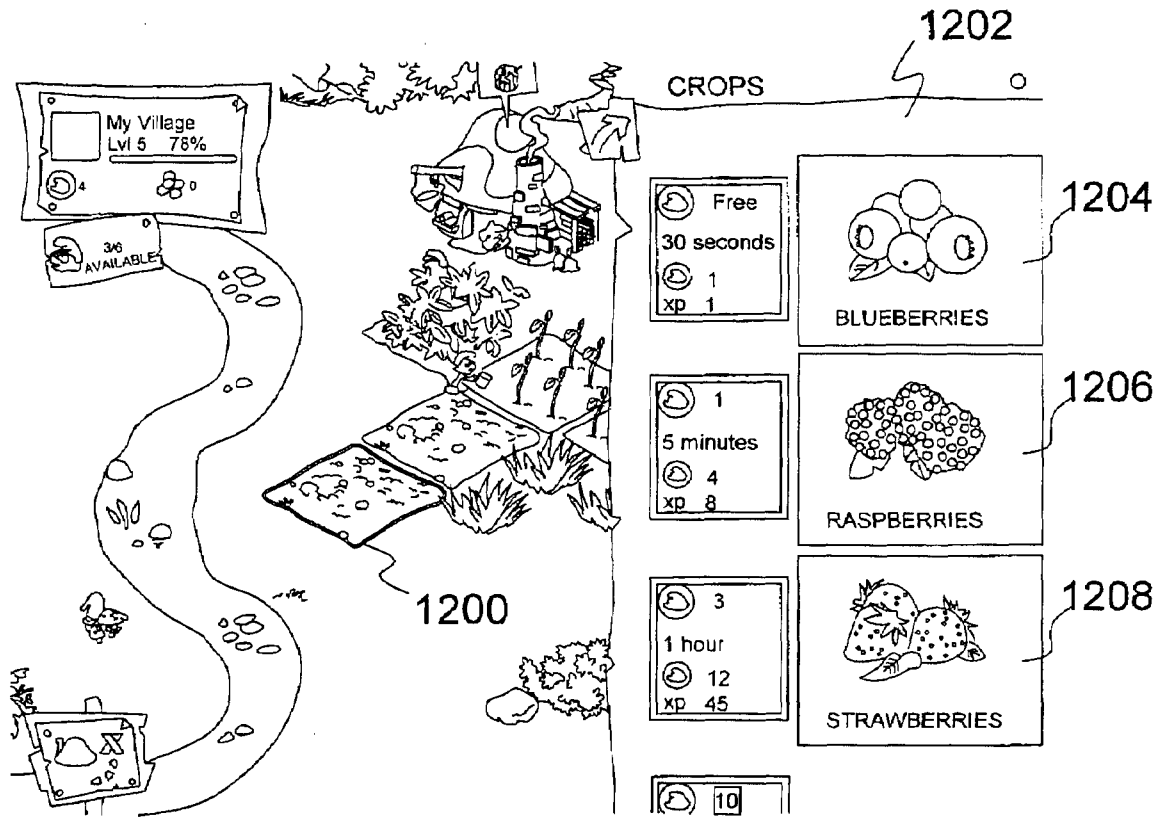

FIG. 9

10/16

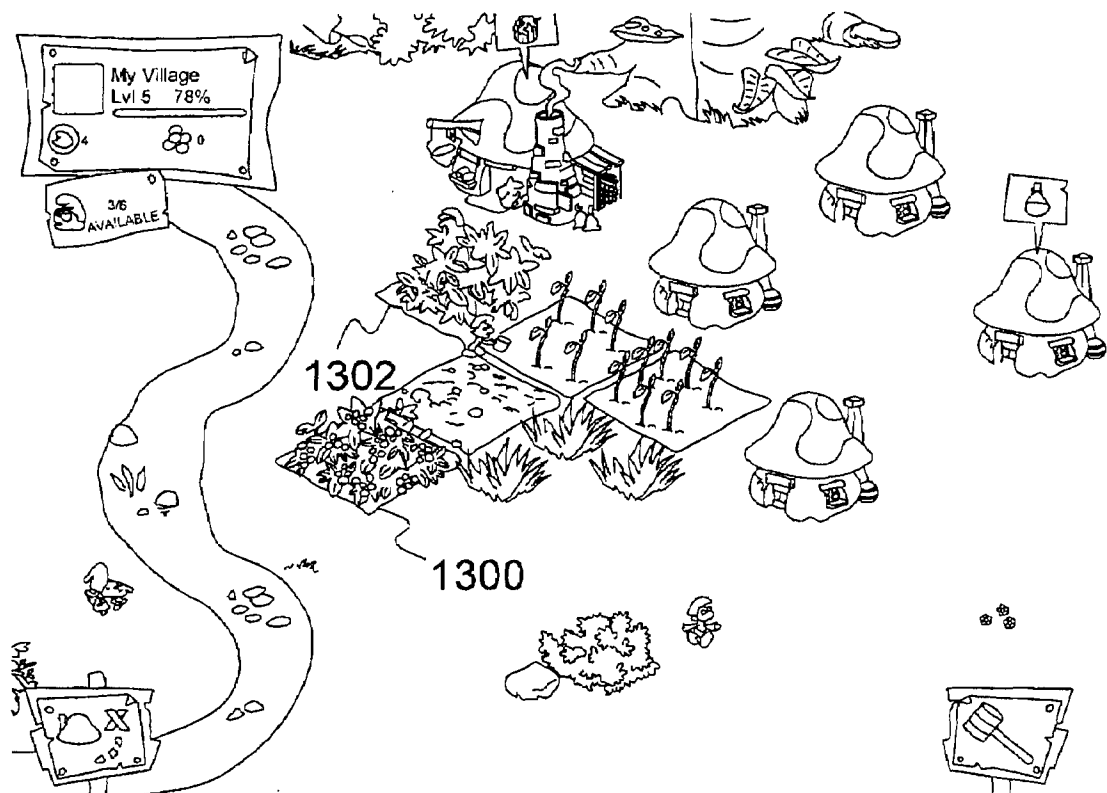

FIG. 10

11/16

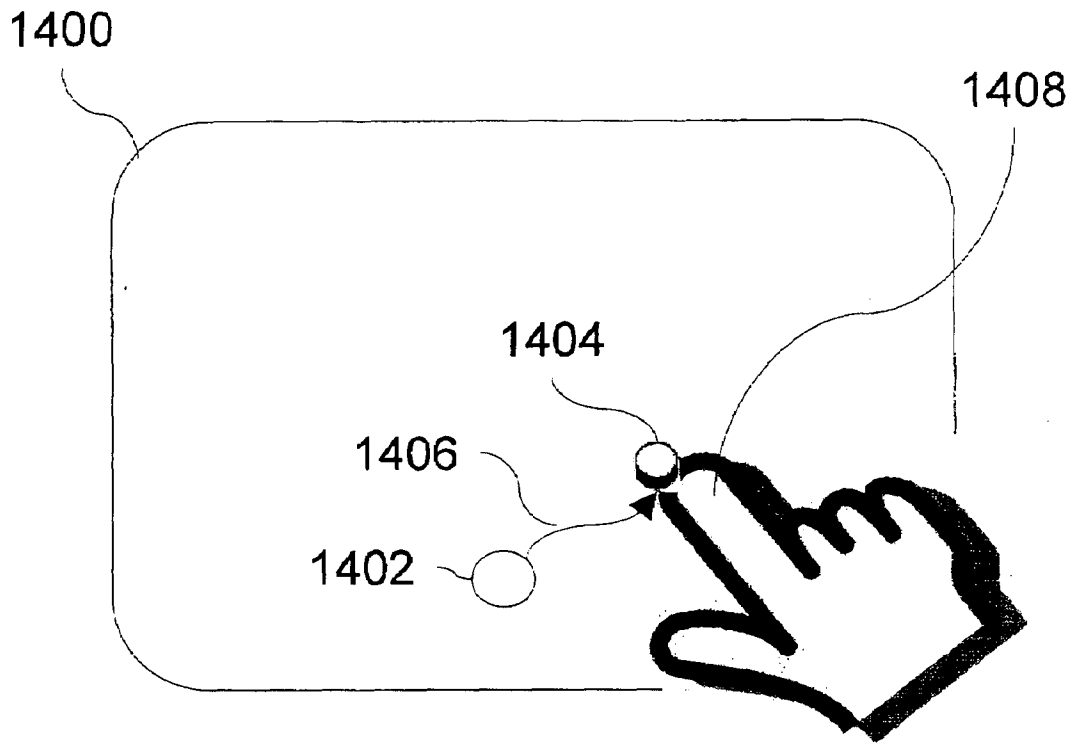

FIG. 11

12/16

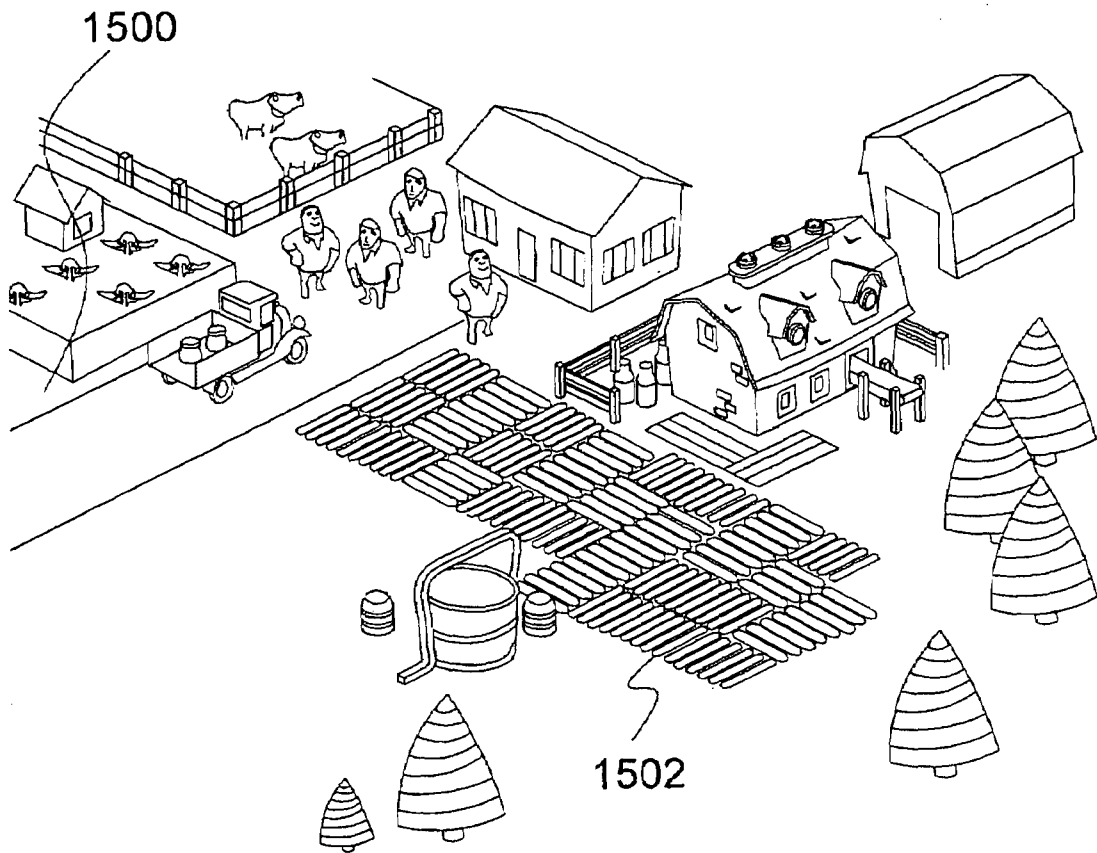

FIG. 12

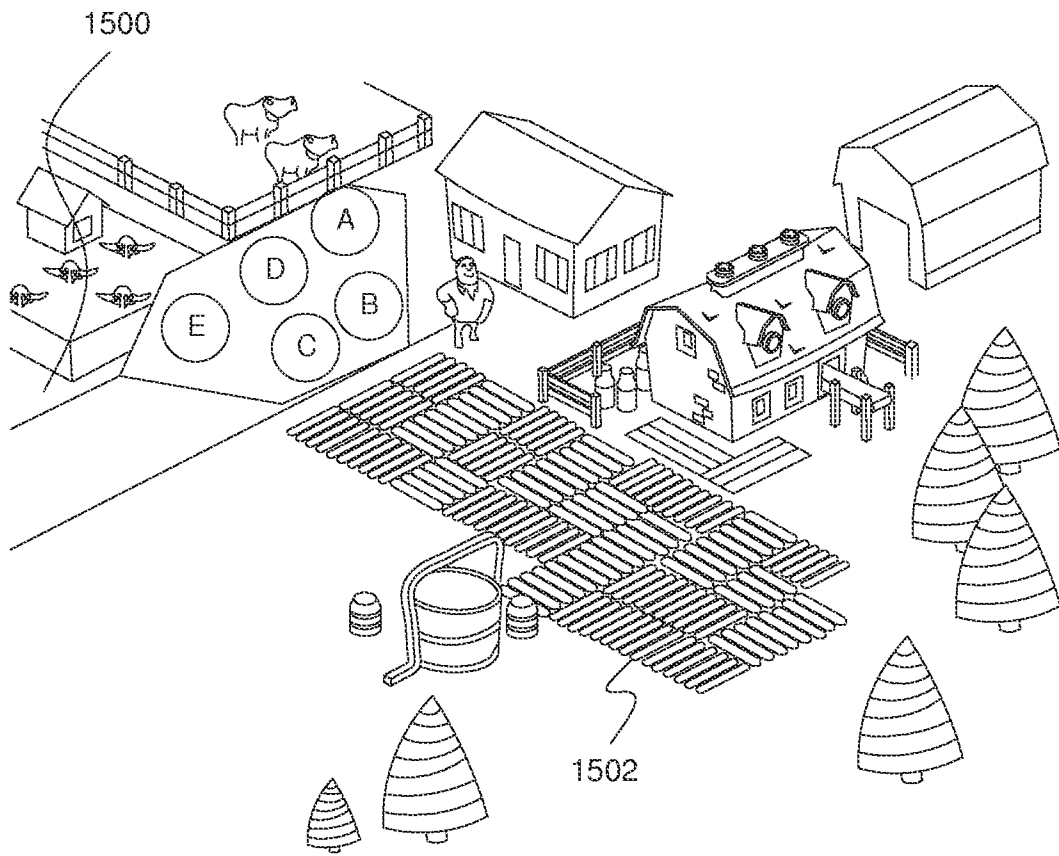

FIG. 13

14/16

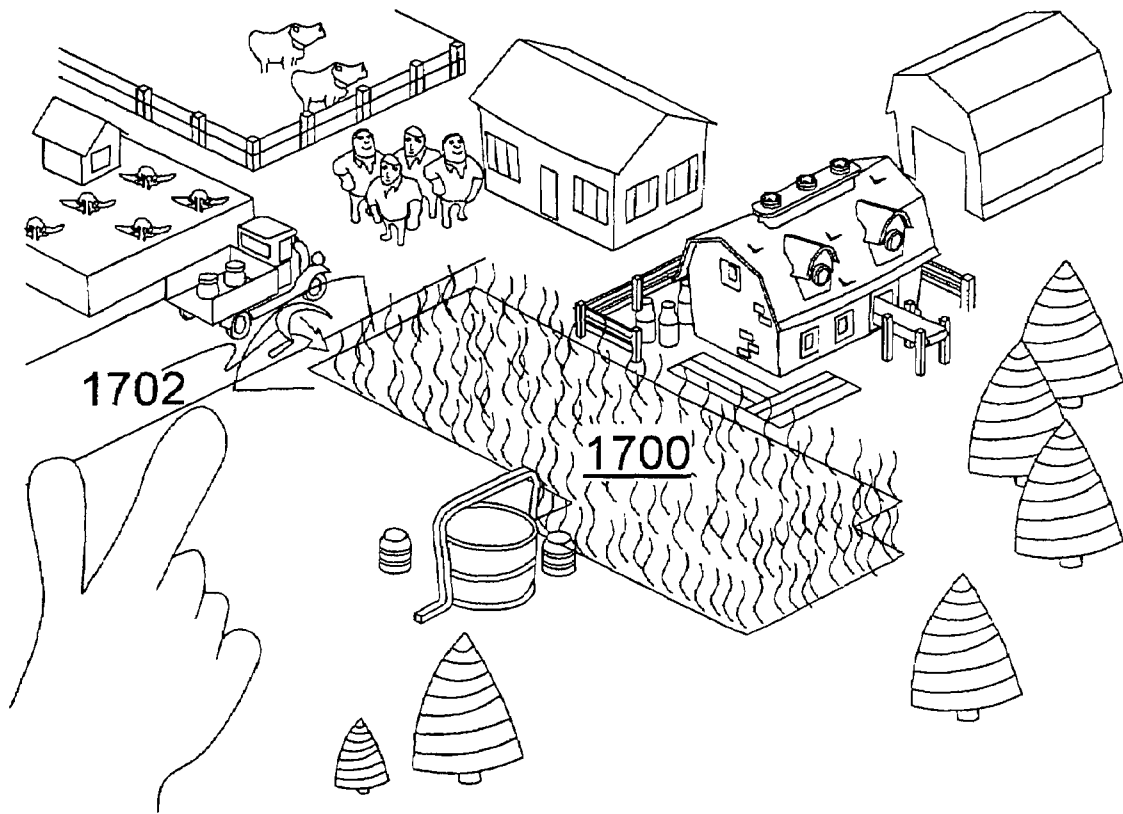

FIG. 14

15/16

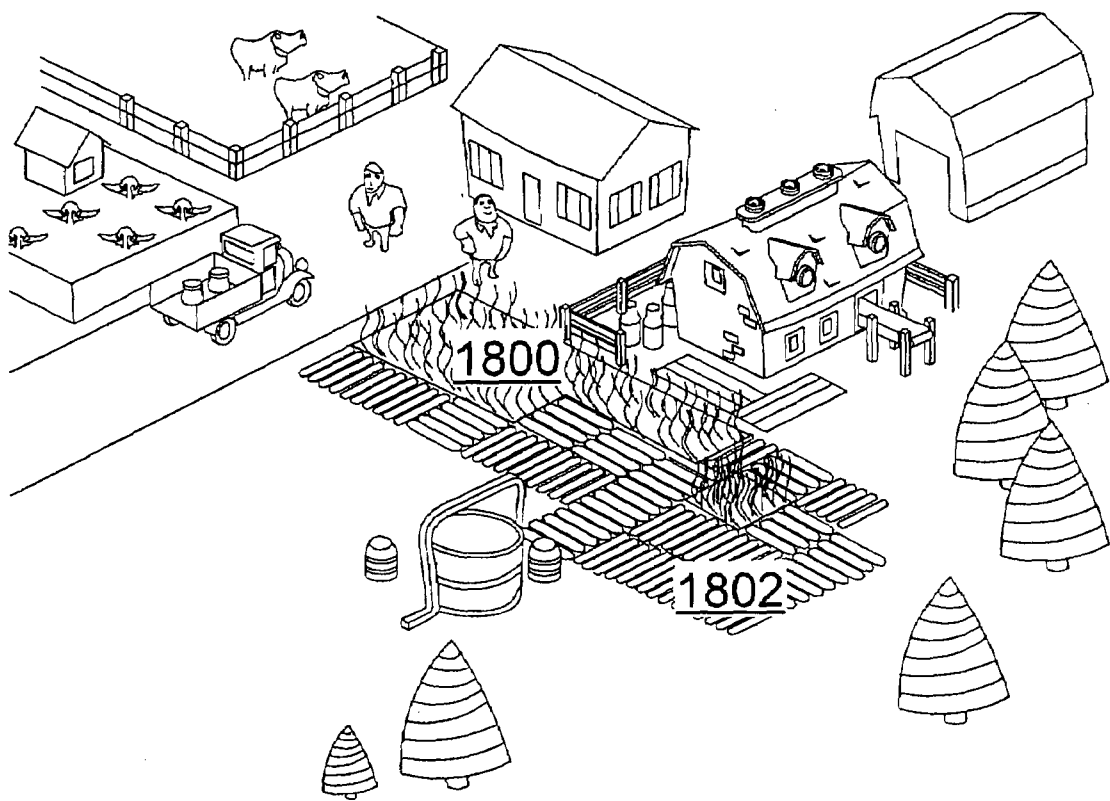

FIG. 15

16/16

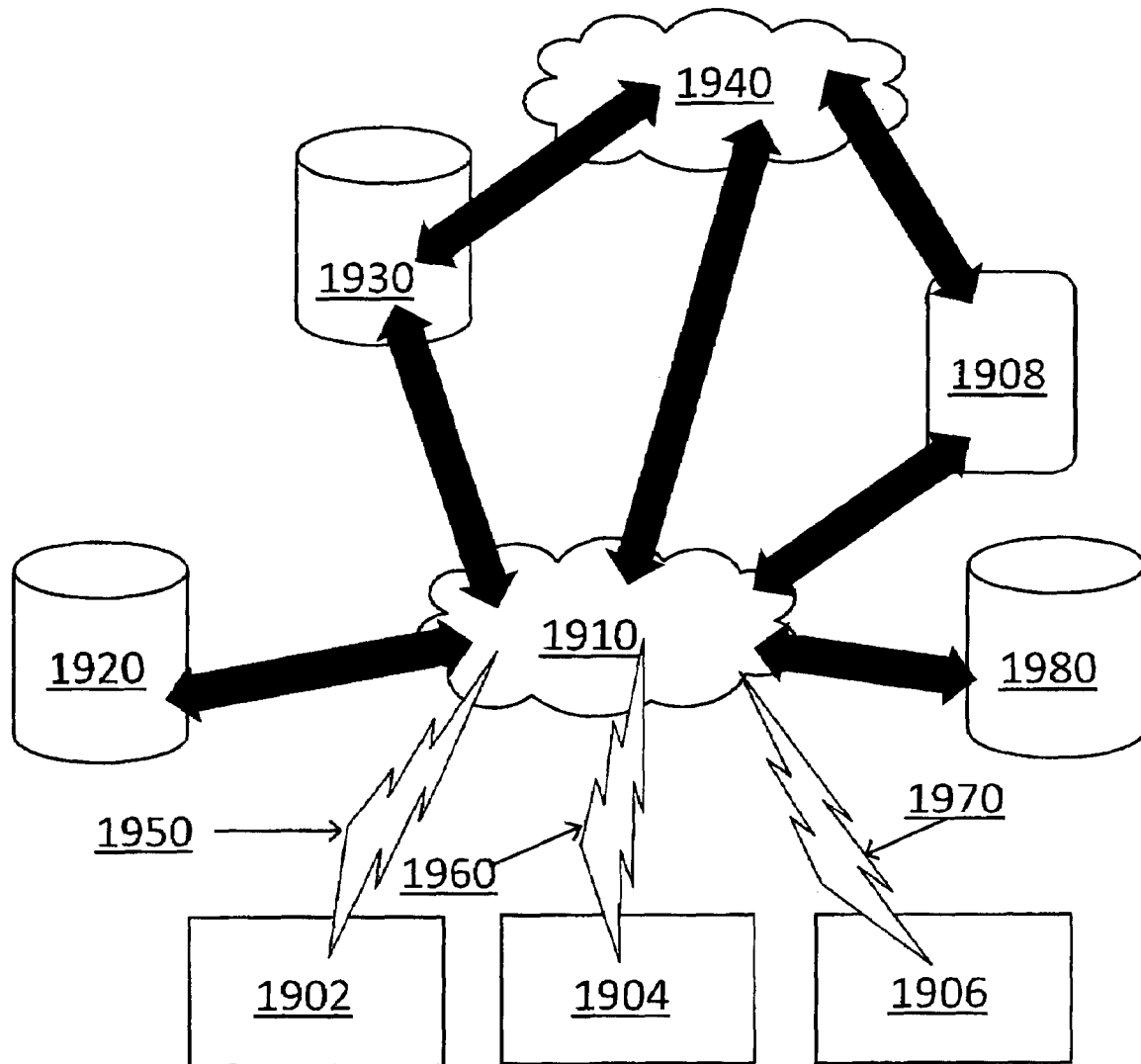

FIG. 16