



## INTERNATIONAL APPLICATION PUBLISHED UNDER THE PATENT COOPERATION TREATY (PCT)

<b>(51) International Patent Classification <sup>6</sup> :</b> <b>B23P 17/00, 19/04, B65D 83/10</b>	<b>A1</b>	<b>(11) International Publication Number:</b> <b>WO 95/31307</b> <b>(43) International Publication Date:</b> 23 November 1995 (23.11.95)
<b>(21) International Application Number:</b> PCT/US95/06106 <b>(22) International Filing Date:</b> 17 May 1995 (17.05.95)  <b>(30) Priority Data:</b> 08/245,009      18 May 1994 (18.05.94)      US  <b>(71) Applicant:</b> BLOOM & KRETEN [US/US]; Suite 905, 401 Washington Avenue, Towson, MD 21204 (US).  <b>(71)(72) Applicants and Inventors:</b> ABIDIN, Michael, R. [US/US]; 320 Terrell Road West, Charlottesville, VA 22901 (US). LEHMBECK, Steven, P. [US/US]; 8 Roxburgh Court, Baltimore, MD 21236 (US).  <b>(74) Agent:</b> GAMSON, Robert, M.; Bloom & Kreten, Suite 905, 401 Washington Avenue, Towson, MD 21204 (US).		<b>(81) Designated States:</b> AU, BR, CA, JP, European patent (AT, BE, CH, DE, DK, ES, FR, GB, GR, IE, IT, LU, MC, NL, PT, SE).  <b>Published</b> <i>With international search report.</i>

**(54) Title:** SCALPEL BLADE MOUNTING DEVICE AND MOUNTING METHOD**(57) Abstract**

A blade package mounting assembly (12) assures that a blade (16) may be mounted on a surgical scalpel (31) easily, conveniently and safely during a surgical procedure in an operating room. The assembly includes a base (13) and a pivoted cover (14). The base supports a blade, and the cover at least partially encloses the blade. A pin (25) on the base is received in a hole (23) in the blade, and a ledge (27) on the base supports a rear end portion (24) of the blade. The scalpel has a forwardly-extending cleat (30) received in a slot (18) on the blade, and the scalpel with the blade mounted thereon may be lifted up and away to clear the package.

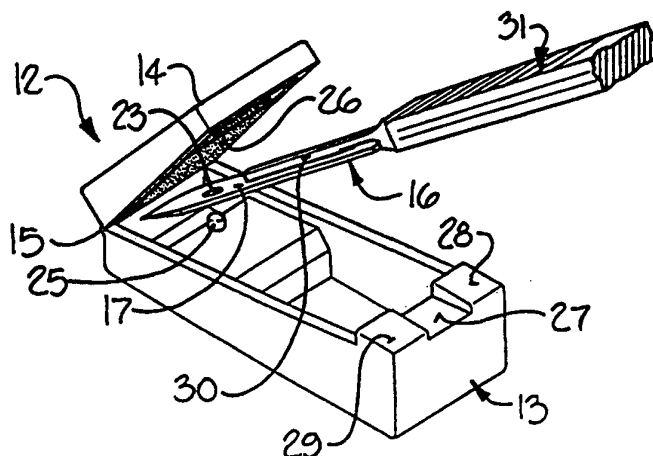

**FOR THE PURPOSES OF INFORMATION ONLY**

Codes used to identify States party to the PCT on the front pages of pamphlets publishing international applications under the PCT.

AT	Austria	GB	United Kingdom	MR	Mauritania
AU	Australia	GE	Georgia	MW	Malawi
BB	Barbados	GN	Guinea	NE	Niger
BE	Belgium	GR	Greece	NL	Netherlands
BF	Burkina Faso	HU	Hungary	NO	Norway
BG	Bulgaria	IE	Ireland	NZ	New Zealand
BJ	Benin	IT	Italy	PL	Poland
BR	Brazil	JP	Japan	PT	Portugal
BY	Belarus	KE	Kenya	RO	Romania
CA	Canada	KG	Kyrgyzstan	RU	Russian Federation
CF	Central African Republic	KP	Democratic People's Republic of Korea	SD	Sudan
CG	Congo	KR	Republic of Korea	SE	Sweden
CH	Switzerland	KZ	Kazakhstan	SI	Slovenia
CI	Côte d'Ivoire	LI	Liechtenstein	SK	Slovakia
CM	Cameroon	LK	Sri Lanka	SN	Senegal
CN	China	LU	Luxembourg	TD	Chad
CS	Czechoslovakia	LV	Latvia	TG	Togo
CZ	Czech Republic	MC	Monaco	TJ	Tajikistan
DE	Germany	MD	Republic of Moldova	TT	Trinidad and Tobago
DK	Denmark	MG	Madagascar	UA	Ukraine
ES	Spain	ML	Mali	US	United States of America
FI	Finland	MN	Mongolia	UZ	Uzbekistan
FR	France			VN	Viet Nam
GA	Gabon				

## SCALPEL BLADE MOUNTING DEVICE AND MOUNTING METHOD

### Field of the Invention

The present invention relates to a package for a surgical  
5 scalpel blade and, more particularly, to a blade package for  
safely mounting the blade on a forwardly-extending cleat on  
the scalpel.

### Background of the Invention

Surgical scalpel blades are usually packaged individually  
10 in an aluminum foil wrap and are irradiated for sterilization  
purposes. The sterile foil wrap is torn open in the operating  
room ("O.R.") in a hospital or clinic, and the blade is  
removed and mounted on a surgical scalpel. The scalpel has a  
forwardly-projecting portion (referred to in the art as a  
15 "cleat") and this cleat is inserted within a longitudinal  
closed slot formed in the blade, thereby mounting the blade on  
the scalpel. The blade is relatively thin and flexible, the  
cleat on the scalpel has a groove to receive the blade, and  
the mounting is with a slight "snap" fit or "click".

20 Some scalpel blades, which are used in microsurgery, are  
super sharp and are packaged in a molded plastic package  
consisting of a base and a pivoted cover.

The scalpel blades are usually changed several times  
during a medical procedure in the O.R., since it is imperative  
25 that the sharpness of the blades be maintained. The blades  
are usually changed by a nurse or O.R. technician (called the  
"tech").

Whether the blade is packaged in an aluminum foil or in a molded plastic package, the blade is removed therefrom; and during the blade mounting process, the tech holds the scalpel in one hand and the blade in the other hand and slips the blade on to the cleat on the scalpel. These blades are roughly an inch to an inch-and-a-half long and (of course) are razor sharp, so it is not at all uncommon for the tech to be nicked or cut while mounting one of the blades, thereby causing blood flow.

If the patient is H.I.V.-infected, the tech may sero-convert and become H.I.V.-infected leading to the deadly AIDS disease. Conversely, if the tech is an H.I.V. carrier, the patient or the other health care providers in the O.R. are at risk. The same is true with respect to hepatitis or other infectious diseases.

The nurse or tech is very often under intense pressure in the O.R. and may become temporarily distracted while in the process of changing blades. This tends to aggravate the existing problem.

#### Summary of the Invention

Accordingly, it is an object of the present invention to provide a safety blade package for a surgical scalpel, thereby avoiding cuts or nicks when installing a new blade on the scalpel.

It is another object of the present invention to provide a safety blade package that may be manufactured conveniently and at relatively low cost, thereby facilitating widespread marketing and distribution.

It is yet another object of the present invention to provide a safety blade package that is "user friendly" so that the hospital nurses and O.R. techs will immediately understand the use thereof and will readily appreciate its ease, convenience and safety features.

In accordance with the teachings of the present invention, a blade package for safely mounting a blade on a surgical scalpel is herein disclosed and claimed, wherein the blade includes a cutting edge and further includes a body portion having a slot formed therein, the body portion having a rear end portion, and wherein the scalpel has a forwardly-projecting cleat received within the slot in the blade. The blade package includes a base having a ledge supporting the rear end portion of the blade. The blade further has a hole formed therein; and the base further has an upstanding pin received in the hole in the blade, thereby mounting the blade on the base and preventing substantial movement of the blade within the package, and thereby preventing any inadvertent dulling of the cutting edge on the blade. As a result, the cleat on the scalpel may be inserted within the slot on the blade; and the scalpel with the blade mounted thereon may be lifted up and away from the base, thereby clearing the hole in the blade from the pin on the base.

Preferably, a cover is pivotably mounted on the base.

The cover has a pivot axis which is substantially perpendicular to the pin and spaced therefrom; and the cover extends partially over the base, substantially covering the cutting edge of the blade, and exposing the slot formed within

the blade, such that the cover is pivoted away from the base as the scalpel with the blade thereon is lifted away from the base.

5 In a preferred embodiment, the cover is transparent, such that the cutting edge on the blade is visible through the cover; and the cover carries a cushion bearing against the blade.

10 The ledge on the base supporting the rear end portion of the blade is canted downwardly in a direction towards the pin, such that the blade is inclined with respect to the base, thereby facilitating the insertion of the cleat on the scalpel into the slot on the blade. Preferably, the base is provided with a pair of spaced-apart raised lands, one on each side of the ledge on the base.

15 The present invention also provides an improved surgical blade comprising a main body portion having an elongated slot formed therein, a tip and a cutting edge, the elongated slot having a narrowed forward portion, and a hole formed in the blade between the tip and the narrowed forward portion of the  
20 elongated slot.

Viewed in another aspect, the present invention provides an improved method of mounting a blade on a surgical scalpel, wherein the scalpel has a forwardly-extending cleat. A sterile blade package is opened to obtain a blade package  
25 assembly; and this blade package assembly includes a base having a blade mounted thereon. The blade has a main body portion provided with a longitudinal slot, and the blade further has a tip and a cutting edge. The base is provided

with a pivoted cover covering at least the tip of the blade. The cleat on the scalpel is inserted into the longitudinal slot in the blade, so that the blade is "snapped" on to the cleat; and the scalpel with the blade mounted thereon is moved  
5 up and away from the base to lift the cover and pivot it away from the base, thereby clearing the scalpel with the blade thereon from the blade package assembly.

These and other objects of the present invention will become apparent from a reading of the following specification  
10 taken in conjunction with the enclosed drawings.

#### Brief Description of the Drawings

Fig. 1 is a pictorial view of a sterile blade package protected by a removable foil.

Fig. 2 is a further pictorial view, corresponding to Fig.  
15 1, but showing the foil being removed for access to the blade package assembly of the present invention.

Fig. 3 is a perspective view of the blade package assembly including a base, a blade mounted on the base, and a partial cover pivotably mounted on the base for protecting the  
20 blade.

Fig. 4 is a cross-sectional view thereof, taken along the lines 4-4 of Fig. 3 and drawn to an enlarged scale, and showing an upstanding pin on the base, the pin being received within a hole in the blade, and further showing the rear end  
25 portion of the blade supported upon a ledge on the base, the blade preferably being inclined downwardly towards the pin.

Fig. 5 is a cross-sectional view thereof, taken along the lines 5-5 of Fig. 4 and showing how the cutting edge of the

blade is maintained in a spaced relationship at all times with the blade package assembly, thereby precluding the blade from being dulled inadvertently.

5 Fig. 6 is a plan outline of the improved blade of the present invention.

Fig. 7 is a pictorial view showing the cleat on the scalpel initially being inserted into the slot on the blade.

10 Fig. 8 is a further pictorial view, corresponding substantially to Fig. 7, but showing the cleat on the scalpel fully seated within the slot on the blade.

Fig. 9 is a still further pictorial view, corresponding substantially to Fig. 8, but showing the scalpel (with the blade mounted thereon) being lifted up and away from the base, thereby pivoting the cover, and thereby clearing the hole in  
15 the blade from the pin on the base.

Figs. 10-12 are schematic sequence views, corresponding to Figs. 7-9, respectively, and showing how the blade may be safely and easily mounted on the scalpel in a matter of seconds.

20 Fig. 13 is a cross-sectional view, taken along the lines 13-13 of Fig. 12 and drawn to an enlarged scale, and showing the detailed construction of the slot in the blade and the cleat on the scalpel.

Fig. 14 is a cross-sectional view thereof, taken along  
25 the lines 14-14 of Fig. 13.

Fig. 15 is a pictorial view of a portion of Fig. 3, showing the cover as preferably transparent.



Fig. 16 is a further pictorial view, showing how a plurality of blades may be packaged in a single blade package, the package facilitating individual blade selection and mounting.

5                   Brief Description of the Preferred Embodiment

With reference to Figs. 1-3, a sterile blade package 10 (Fig. 1) is wrapped in an aluminum foil 11 which is torn open (Fig. 2) in the O.R. (or other medical or hospital environment) to obtain the blade package assembly 12 of the present invention (Fig. 3).

10                   With further reference to Figs. 4 and 5, the blade package assembly 12 preferably comprises a single molded article and includes a base 13 and a cover 14 pivoted thereto by means of an integral reduced cross-section "living" hinge 15. The cover 14 extends partially over the base 13 and, preferably, the cover 14 is transparent (Fig. 15) along with the blade package assembly 12.

15                   A blade 16 is mounted on the base 13. As shown more clearly in Fig. 6, the blade 16 has a main body portion 17 provided with a longitudinal slot 18. This slot 18 includes a rearward portion 19 and a narrowed forward portion 20. The blade 16 further has a tip 21, a bottom cutting edge 22, a hole 23 between the tip 21 and the slot 20, and a rear end portion 24 beyond the slot 20.

20                   The base 13 has an upstanding pin 25 which is substantially perpendicular to the pivot axis of the cover 14 and spaced therefrom. This pin 25 is received in the hole 23 in the blade 16, thereby positioning the blade 16 on the base

13. The cover 14, in turn, is provided with a cushioned pad 26 of foam plastic (or other suitable material) to trap the blade 16 between the base 13 and the cover 14.

The base 13 further has a ledge 27 supporting the rear end portion 24 of the blade 16. Preferably, the ledge 27 is elevated so that the blade 16 is canted downwardly, as shown more clearly in Fig. 4. The base 13 further has a pair of spaced-apart raised lands 28 and 29, respectively, one on each side of the ledge 27.

This arrangement prevents undesired movement of the blade 16 (which would otherwise inadvertently dull the cutting edge 22 of the blade 16).

The operation of the invention and its inherent features and advantages are illustrated in Figs. 7-12, respectively.

The blade 16 is mounted on the forwardly-extending cleat 30 of a surgical scalpel 31. Preferably (but not necessarily) the scalpel 31 is a guarded surgical scalpel as disclosed and claimed in United States Letters Patents No. 5,250,063 issued October 5, 1993 and No. 5,275,606 issued January 4, 1994 to the present inventors (applicants). It will be appreciated by those skilled in the art, however, that the present invention is equally applicable to conventional non-guarded scalpels, if desired.

As shown more clearly in Figs. 7 and 10, the cleat 30 on the scalpel 31 is initially inserted into the rearward portion 19 of the slot 18 in the blade 16. The cleat 30 is then advanced forwardly such that the cleat 30 is fully seated within the slot 18 (which may be with a slight "click" or

"snap" fit) as shown more clearly in Figs. 8 and 11.

Thereafter, the scalpel 31 with the blade 16 mounted thereon is lifted up and away from the base 13 (Figs. 9 and 12) to pivot the cover 14 away from the base 13 and, more significantly, to clear the hole 23 in the blade 16 from the pin 25 on the base 13.

The entire operation of thus mounting the blade 16 on the scalpel 31 is easy and convenient, takes only a few seconds, and assures that the user will not be cut or nicked accidentally.

With reference to Figs. 13 and 14, the cleat 30 on the scalpel 31 has a groove 32 formed therein to receive the slot 18 on the blade 16. These blades 16 are in widespread use in hospitals and clinics. However, it will be appreciated by those skilled in the art that the present invention is not necessarily confined thereto but, rather, is equally applicable to other surgical blade designs and configurations.

With reference to Fig. 16, the teachings of the present invention are equally applicable to a multi-blade package 33 having a plurality of blades 16 in a side-by-side relationship therein. This multi-blade package 33 would be contained in a single sterile package (not shown) which would be opened in the O.R.

The surgical scalpel blades 16 are razor sharp and can become dulled very quickly during a surgical procedure. It is important for the surgeon to have a very sharp "fresh" blade readily available. During a typical operation, the blades 16 may be changed around a half dozen times. This invention

assures that the blades 16 may be quickly, easily and safely mounted on the scalpel 31 during the surgical procedure.

Moreover, it is significant that the blade does not move during the mounting process (unlike the prior art razor blade dispensers and injectors) and that the mounting of the blade involves basically two steps: first, insertion of the scalpel and, second, lifting of the scalpel (with the blade thereon) to pivot the cover and clear the blade package assembly. This movement is foolproof, convenient, safe, takes only a few seconds, and is readily understood by the O.R. techs, assistants and surgeons.

As disclosed herein, the mounting of the blade on the scalpel is basically a two-hand operation: one hand holding the blade package assembly 12, and the other hand holding the scalpel 31. However, if desired, a ledge or suitable mounting may be provided on the tray table (not shown) for retaining the blade package assembly 12, so that only the scalpel 31 is held. This is a one-hand operation.

Obviously, many modifications may be made without departing from the basic spirit of the present invention. Accordingly, it will be appreciated by those skilled in the art that within the scope of the appended claims, the invention may be practiced other than has been specifically described herein.

In the Claims:

1. A blade package for safely mounting a blade on a surgical scalpel, wherein the blade includes a cutting edge and further includes a body portion having a slot formed therein, the body portion having a rear end portion, and wherein the scalpel has a forwardly-projecting cleat received within the slot in the blade, the blade package comprising a base having a ledge supporting the rear end portion of the blade, the blade further having a hole formed therein, and the base further having an upstanding pin received in the hole in the blade, thereby mounting the blade on the base and preventing substantial movement of the blade within the package, and thereby preventing any inadvertent dulling of the cutting edge on the blade, wherein the cleat on the scalpel may be inserted within the slot on the blade, and wherein the scalpel with the blade mounted thereon may be lifted up and away from the base, thereby clearing the hole in the blade from the pin on the base.

2. The blade package of claim 1, further including a cover pivotably mounted on the base, the cover having a pivot axis which is substantially perpendicular to the pin and spaced therefrom, and the cover extending partially over the base, substantially covering the cutting edge of the blade, and exposing the slot formed within the blade, such that the cover is pivoted away from the base as the scalpel with the blade thereon is lifted away from the base.

3. The blade package of claim 2, wherein the cover is transparent, such that the cutting edge on the blade is visible through the cover.

4. The blade package of claim 2, further including a cushion carried by the cover and bearing against the blade.

5. The blade package of claim 1, wherein the ledge on the base supporting the rear end portion of the blade is canted downwardly in a direction towards the pin, such that the blade is inclined with respect to the base, thereby facilitating the insertion of the cleat on the scalpel into the slot on the blade.

6. The blade package of claim 5, wherein the base is provided with a pair of spaced-apart raised lands, one on each side of the ledge on the base, thereby limiting rotation of the scalpel blade.

7. A blade package for safely mounting a blade on a surgical scalpel, wherein the blade includes a cutting edge and further includes a body portion having a slot formed therein, the body portion having a rear end portion, and wherein the scalpel has a forwardly-projecting cleat received within the slot in the blade, the blade package comprising a base having a ledge supporting the rear end portion of the blade, the base further having a pair of spaced-apart raised lands, one on each side of the ledge on the base, the blade further having a hole formed therein, and the base further having an upstanding pin received in the hole in the blade, thereby mounting the blade on the base and preventing substantial movement of the blade within the package, and

thereby preventing any inadvertent dulling of the cutting edge on the blade, the ledge on the base supporting the rear end portion of the blade being canted downwardly in a direction towards the pin, such that the blade is inclined with respect to the base, thereby facilitating the insertion of the cleat on the scalpel into the slot on the blade, and wherein the scalpel with the blade mounted thereon may be lifted up and away from the base, thereby clearing the hole in the blade from the pin on the base, and a cover pivotably mounted on the base, the cover having a cushion bearing against the blade and the cover having a pivot axis which is substantially perpendicular to the pin and spaced therefrom, the cover extending partially over the base, substantially covering the cutting edge of the blade, and exposing the slot formed within the blade, such that the cover is pivoted away from the base as the scalpel with the blade thereon is lifted away from the base.

8. The blade package of claim 7, wherein the cover is transparent, such that the cutting edge on the blade is visible through the cover.

9. The blade package assembly of claim 7, further including a plurality of blade packages in a side-by-side relationship.

10. A surgical blade comprising a main body portion having an elongated slot formed therein and further having a tip and a cutting edge, the elongated slot having a narrowed forward portion, and the blade further having a hole formed

therein between the tip and the narrowed forward portion of the elongated slot.

11. The method of mounting a blade on a surgical scalpel, comprising the steps of providing a scalpel having a forwardly-extending cleat, providing a sterile blade package, opening the sterile blade package to obtain a blade package assembly, the blade package assembly including a base having a blade mounted thereon, the blade having a main body portion provided with a longitudinal slot, and the blade further having a tip and a cutting edge, providing a pivoted cover on the base, the pivoted cover covering at least the tip of the blade, inserting the cleat on the scalpel into the longitudinal slot in the blade, so that the blade is "snapped" on to the cleat, and moving the scalpel with the blade mounted thereon up and away from the base to lift the cover and pivot it away from the base, thereby clearing the scalpel with the blade thereon from the blade package assembly.

12. The method of claim 11, further including the steps of providing an upstanding pin on the base, and providing a hole in the blade receiving the pin, thereby assuring that the cutting edge on the blade will not become dulled inadvertently due to movement of the blade within the package, and clearing the blade from the pin when the scalpel with the blade thereon is lifted up and away from the base.

13. A blade package for safely mounting a blade on a surgical scalpel, wherein the blade includes a cutting edge and further includes a body portion having a longitudinal slot formed therein, the body portion of the blade having a rear



end portion, and wherein the scalpel has a forwardly-projecting longitudinally-extending cleat received within the slot in the blade, the blade package comprising a base having a pair of end portions, a cover having a pivoted connection to one end portion of the base, extending towards the other end portion thereof, and overlaying a portion of the base, wherein the blade may be positioned on the base, such that the cutting edge on the blade is substantially covered, and such that the slot in the blade is substantially exposed, first means on the cover and engaging the body portion of the blade for retaining the blade in a direction transverse to the base, second means at the other end portion of the base to support the rear end portion of the blade, and third means for precluding substantial movement of the blade in a direction laterally of the blade, thereby preventing any inadvertent dulling of the cutting edge on the blade, wherein the cleat on the scalpel may be inserted within the longitudinal slot on the blade, and wherein the scalpel with the blade mounted thereon thereafter may be lifted up and away from the base as the cover is pivoted away from the base.

14. The blade package of claim 13, wherein the second means comprises a pair of spaced-apart lands, one on each side of the rear end portion of the blade, and wherein the blade is tilted downwardly from the pair of lands on the base towards the pivoted connection between the base and the cover, thereby facilitating insertion of the cleat on the scalpel into the longitudinal slot in the blade.

15. The blade package of claim 13, wherein the third means for precluding substantial movement of the blade in a direction laterally of the blade comprises an upstanding pin carried by the base, and the body portion of the blade having a hole formed therein and receiving the pin.

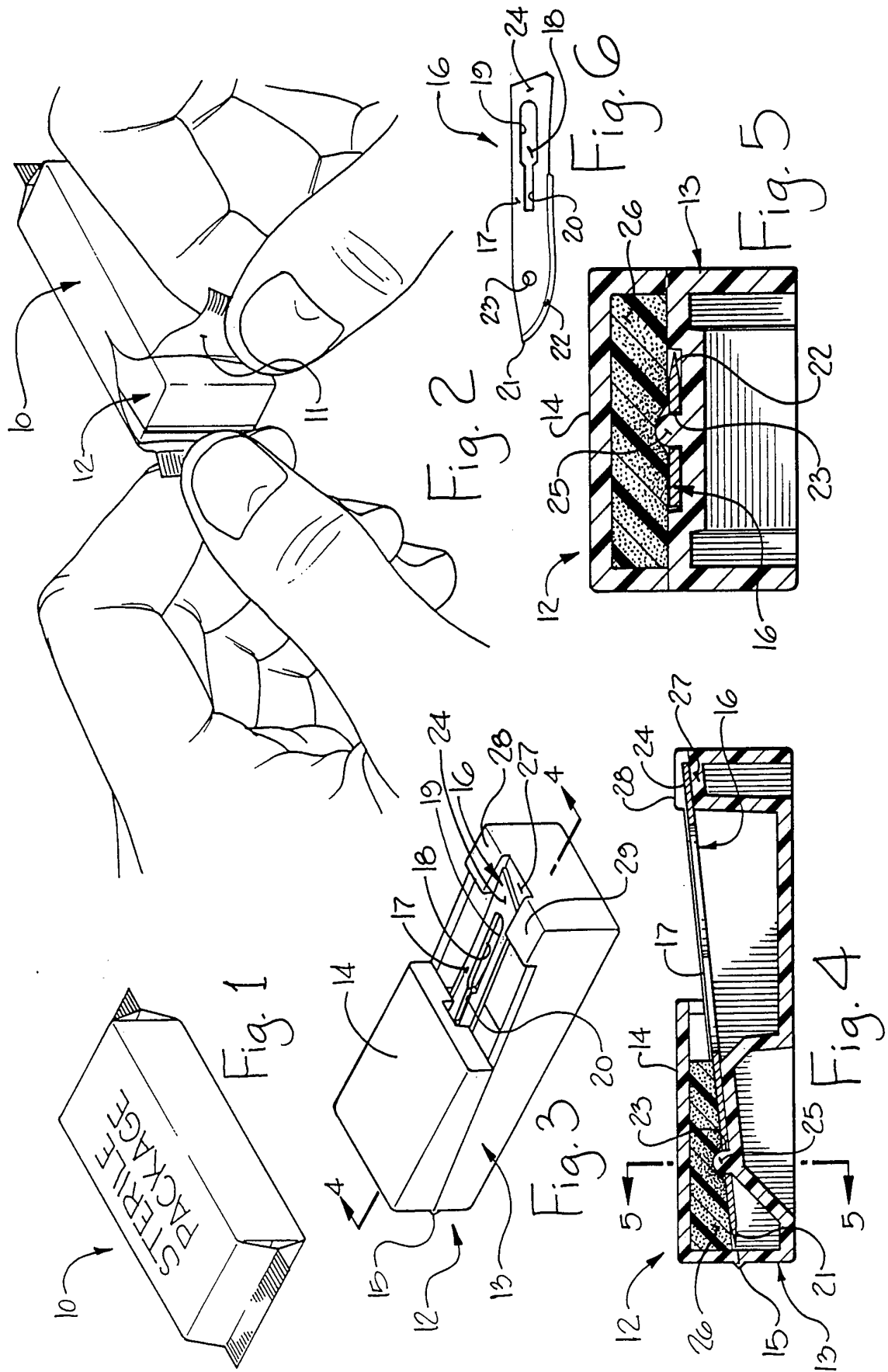

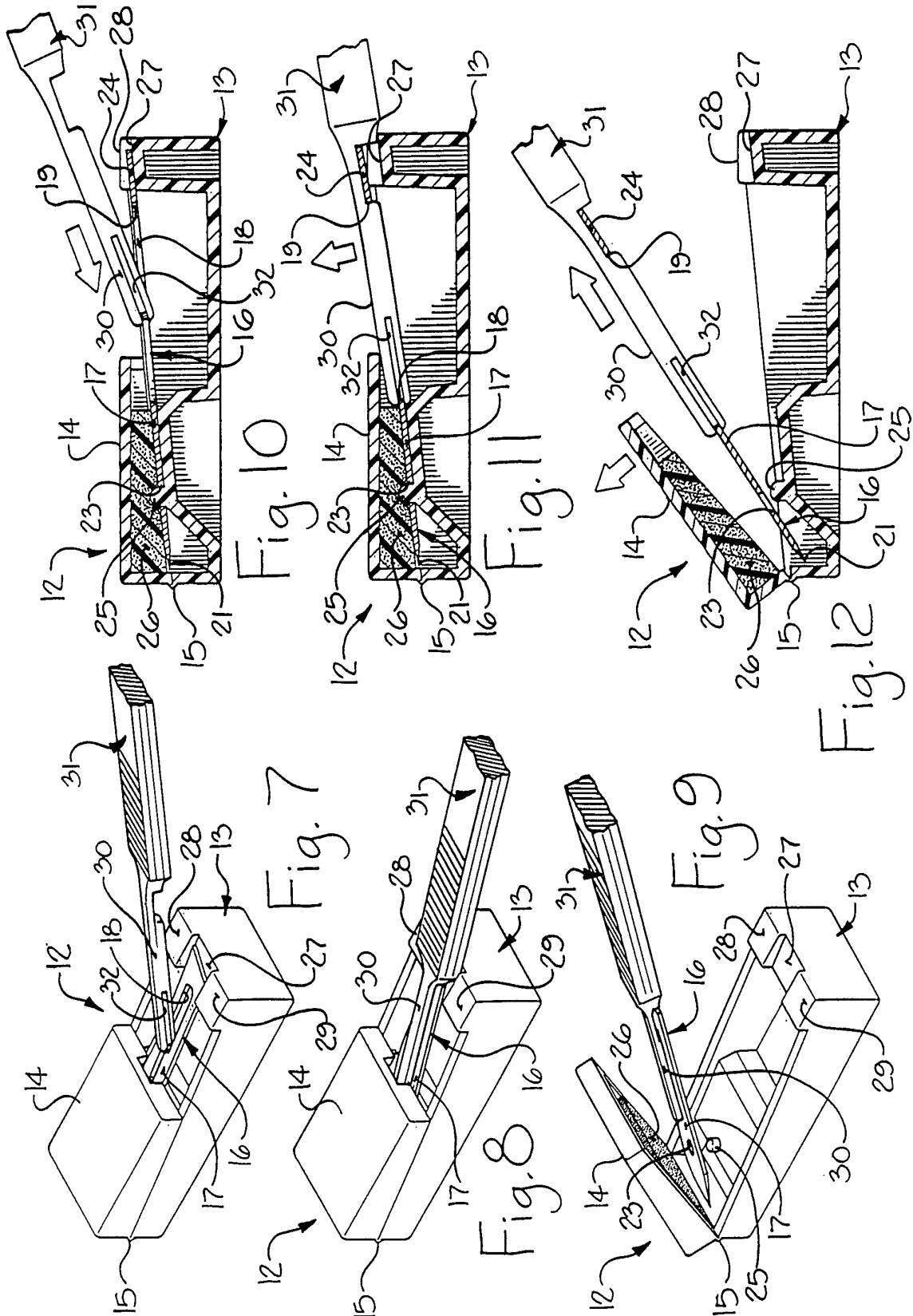

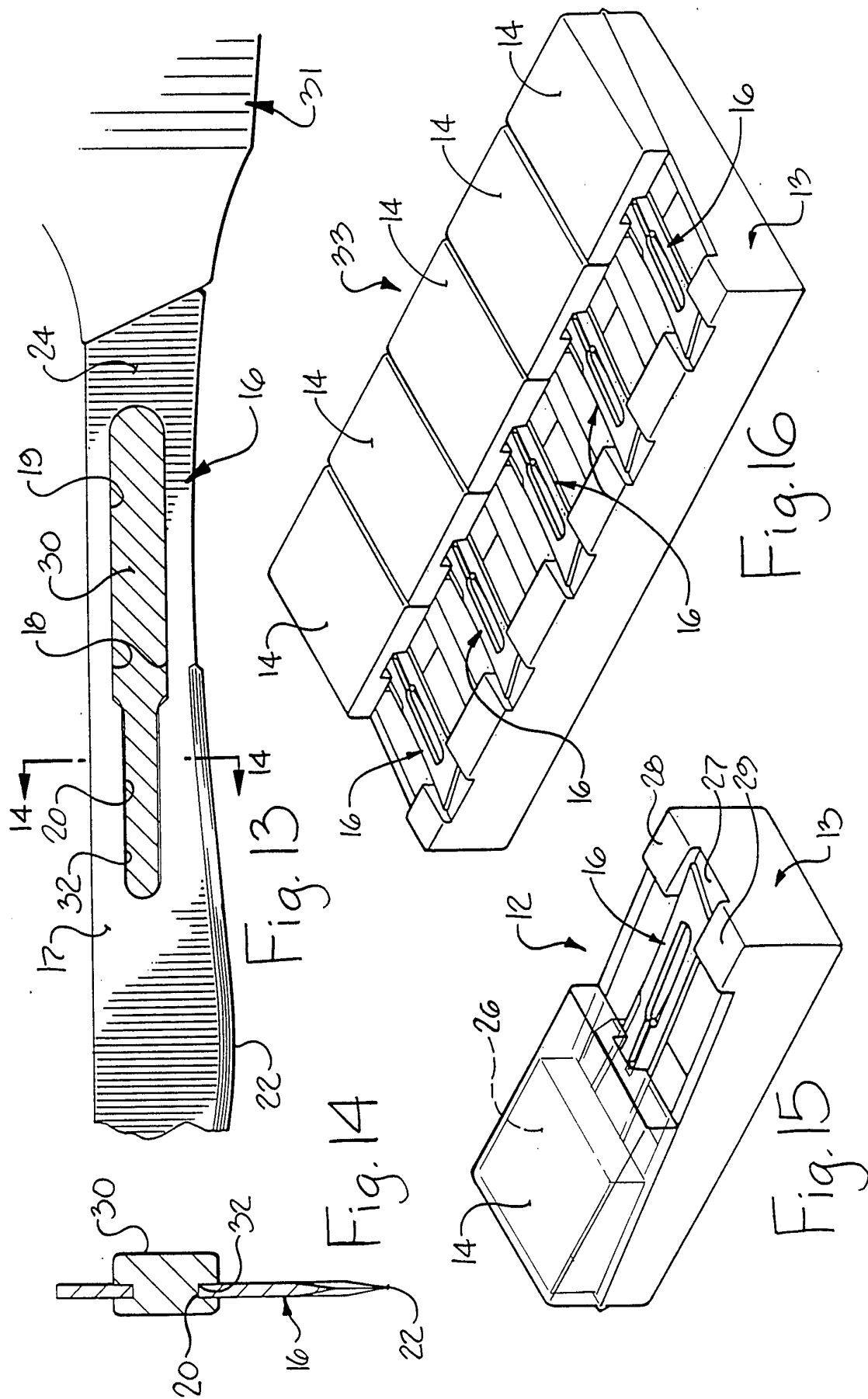

## INTERNATIONAL SEARCH REPORT

International application No.  
PCT/US95/06106**A. CLASSIFICATION OF SUBJECT MATTER**

IPC(6) :B23P 17/00, 19/04; B65D 83/10

US CL :29/242, 428; 30/339; 206/352

According to International Patent Classification (IPC) or to both national classification and IPC

**B. FIELDS SEARCHED**

Minimum documentation searched (classification system followed by classification symbols)

U.S. : 29/242, 428; 30/339, 346.61; 206/352, 354-356, 359

Documentation searched other than minimum documentation to the extent that such documents are included in the fields searched  
NONEElectronic data base consulted during the international search (name of data base and, where practicable, search terms used)  
NONE**C. DOCUMENTS CONSIDERED TO BE RELEVANT**

Category*	Citation of document, with indication, where appropriate, of the relevant passages	Relevant to claim No.
X	US, A, 1,448,305 (LANGBEIN) 13 March 1923; See reference numerals 21 and 24; Figure 3.	10
A	US, A, 4,998,334 (PEMBERTON ET AL) 12 March 1991.	1-15
A	US, A, 5,088,173 (KROMER ET AL) 18 February 1992.	1-15
A,P	US, A, 5,361,902 (ABIDIN ET AL) 08 November 1994, See entire document.	1-15
A,P	US, A, 5,363,958 (HORAN) 15 November 1994, See entire document.	1-15

☐ Further documents are listed in the continuation of Box C.
 ☐ See patent family annex.

* Special categories of cited documents:	*T	later document published after the international filing date or priority date and not in conflict with the application but cited to understand the principle or theory underlying the invention
"A" document defining the general state of the art which is not considered to be of particular relevance	"X"	document of particular relevance; the claimed invention cannot be considered novel or cannot be considered to involve an inventive step when the document is taken alone
"E" earlier document published on or after the international filing date	"Y"	document of particular relevance; the claimed invention cannot be considered to involve an inventive step when the document is combined with one or more other such documents, such combination being obvious to a person skilled in the art
"L" document which may throw doubts on priority claim(s) or which is cited to establish the publication date of another citation or other special reason (as specified)	"&"	document member of the same patent family
"O" document referring to an oral disclosure, use, exhibition or other means		
"P" document published prior to the international filing date but later than the priority date claimed		

Date of the actual completion of the international search 26 JUNE 1995	Date of mailing of the international search report 12 JUL 1995
Name and mailing address of the ISA/US Commissioner of Patents and Trademarks Box PCT Washington, D.C. 20231 Facsimile No. (703) 305-3230	Authorized officer JIMMY G. FOSTER Telephone No. (703) 308-1148 <i>Sheila Vency</i> <b>Sheila Vency</b> <b>Paralegal Specialist</b> <b>Group 3200</b>