



(10) International Publication Number
WO 2010/080746 A3

(43) International Publication Date
15 July 2010 (15.07.2010)

PCT

- | | |
|--|---|
| (51) International Patent Classification:
<i>A61M 25/01</i> (2006.01) <i>A61M 16/04</i> (2006.01) | (81) Designated States (<i>unless otherwise indicated, for every kind of national protection available</i>): AE, AG, AL, AM, AO, AT, AU, AZ, BA, BB, BG, BH, BR, BW, BY, BZ, CA, CH, CL, CN, CO, CR, CU, CZ, DE, DK, DM, DO, DZ, EC, EE, EG, ES, FI, GB, GD, GE, GH, GM, GT, HN, HR, HU, ID, IL, IN, IS, JP, KE, KG, KM, KN, KP, KR, KZ, LA, LC, LK, LR, LS, LT, LU, LY, MA, MD, ME, MG, MK, MN, MW, MX, MY, MZ, NA, NG, NI, NO, NZ, OM, PE, PG, PH, PL, PT, RO, RS, RU, SC, SD, SE, SG, SK, SL, SM, ST, SV, SY, TH, TJ, TM, TN, TR, TT, TZ, UA, UG, US, UZ, VC, VN, ZA, ZM, ZW. |
| (21) International Application Number:
PCT/US2010/020082 | (84) Designated States (<i>unless otherwise indicated, for every kind of regional protection available</i>): ARIPO (BW, GH, GM, KE, LS, MW, MZ, NA, SD, SL, SZ, TZ, UG, ZM, ZW), Eurasian (AM, AZ, BY, KG, KZ, MD, RU, TJ, TM), European (AT, BE, BG, CH, CY, CZ, DE, DK, EE, ES, FI, FR, GB, GR, HR, HU, IE, IS, IT, LT, LU, LV, MC, MK, MT, NL, NO, PL, PT, RO, SE, SI, SK, SM, TR), OAPI (BF, BJ, CF, CG, CI, CM, GA, GN, GQ, GW, ML, MR, NE, SN, TD, TG). |
| (22) International Filing Date:
5 January 2010 (05.01.2010) | Published:
— <i>with international search report (Art. 21(3))</i> |
| (25) Filing Language:
English | |
| (26) Publication Language:
English | |
| (30) Priority Data:
12/352,404 12 January 2009 (12.01.2009) US | |
| (71) Applicant (<i>for all designated States except US</i>): IN-TUBIX, LLC ; 3900 Essex Street, Suite 250, Houston, TX 77027 (US). | |
| (72) Inventor; and | |
| (75) Inventor/Applicant (<i>for US only</i>): TOTZ, Kenneth, A. [US/US]; 3610 Robinhood Street, Houston, TX 77005-2231 (US). | |
| (74) Agent: WAGGETT, Gordon, G. ; Gordon G. Waggett, P.C., 550 Westcott Street, Suite No. 350, Houston, TX 77007-5099 (US). | |

Published:

— with international search report (Art. 21(3))

[Continued on next page]

(54) Title: IMPROVED DEVICE AND METHOD FOR PLACING WITHIN A PATIENT AN ENTERAL TUBE AFTER ENDOTRACHEAL INTUBATION

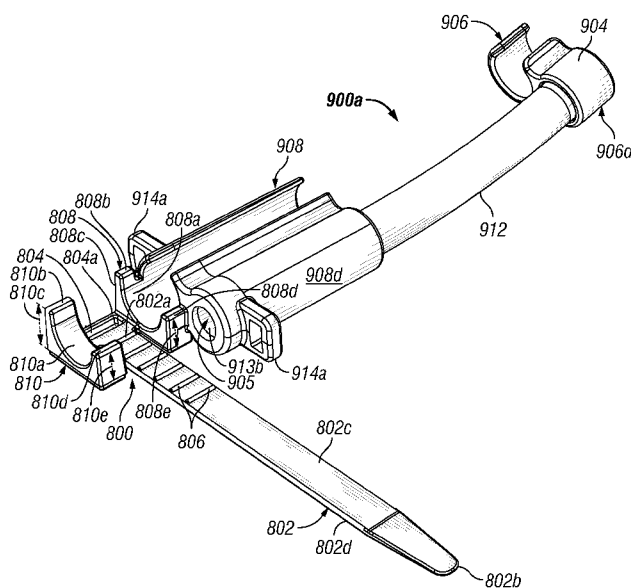

FIG. 16A

(57) Abstract: The present invention is directed to a novel device and method for providing a disposable endotracheal intubation device for use with an auxiliary passage-way serving as a guide for the placement of an orogastric or other enterally directed device in a patient. The present invention pertains to a medical catheter device, removably attachable to an endotracheal tube, for guiding the path of an enteral tube into the esophagus of a patient. The catheter device preferably employs an adjustable clamp to fix the position of the catheter relative to the endotracheal tube. The present invention also pertains to a combination medical intubation device comprising an endotracheal tube and a catheter proximate the endotracheal tube to guide the path of an enteral tube. The present invention also pertains to a method of intubating a patient using this combination medical intubation device.



— *before the expiration of the time limit for amending the claims and to be republished in the event of receipt of amendments (Rule 48.2(h))*

(88) Date of publication of the international search report:
21 October 2010

INTERNATIONAL SEARCH REPORT

International application No.
PCT/US2010/020082**A. CLASSIFICATION OF SUBJECT MATTER*****A61M 25/01(2006.01)i, A61M 16/04(2006.01)i***

According to International Patent Classification (IPC) or to both national classification and IPC

B. FIELDS SEARCHED

Minimum documentation searched (classification system followed by classification symbols)

A61M 25/01; A61B 17/08; A61F 2/24; A61F 2/90; A61M 29/00; H01R 11/00

Documentation searched other than minimum documentation to the extent that such documents are included in the fields searched

Korean utility models and applications for utility models

Japanese utility models and applications for utility models

Electronic data base consulted during the international search (name of data base and, where practicable, search terms used)

eKOMPASS(KIPO internal) & Keywords: catheter, clip, conduit

C. DOCUMENTS CONSIDERED TO BE RELEVANT

Category*	Citation of document, with indication, where appropriate, of the relevant passages	Relevant to claim No.
A	US 2005-0137614 A1 (PORTER, CHRISTOPHER et al.) 23 June 2005 See Claims 1-109, Figures 1-14	1-34
A	US 2007-0244546 A1 (ALAN FRANCIS, RICHARD WILLIAM) 18 October 2007 See Claims 1-20, Figures 1-8	1-34
A	US 5827227 A1 (DELAGO, AUGUSTIN J.) 27 October 1998 See Claims 1-14, Figures 1-4	1-34
A	US 2006-0166548 A1 (WILLIAMS, JR. ROBERT C. et al.) 27 July 2006 See Claims 1-28, Figures 1-6	1-34



Further documents are listed in the continuation of Box C.



See patent family annex.

* Special categories of cited documents:

"A" document defining the general state of the art which is not considered to be of particular relevance

"E" earlier application or patent but published on or after the international filing date

"L" document which may throw doubts on priority claim(s) or which is cited to establish the publication date of citation or other special reason (as specified)

"O" document referring to an oral disclosure, use, exhibition or other means

"P" document published prior to the international filing date but later than the priority date claimed

"T" later document published after the international filing date or priority date and not in conflict with the application but cited to understand the principle or theory underlying the invention

"X" document of particular relevance; the claimed invention cannot be considered novel or cannot be considered to involve an inventive step when the document is taken alone

"Y" document of particular relevance; the claimed invention cannot be considered to involve an inventive step when the document is combined with one or more other such documents, such combination being obvious to a person skilled in the art

"&" document member of the same patent family

Date of the actual completion of the international search

09 AUGUST 2010 (09.08.2010)

Date of mailing of the international search report

13 AUGUST 2010 (13.08.2010)

Name and mailing address of the ISA/KR

Korean Intellectual Property Office
Government Complex-Daejeon, 139 Seonsa-ro, Seo-
gu, Daejeon 302-701, Republic of Korea

Facsimile No. 82-42-472-7140

Authorized officer

HAN, SANG SOO

Telephone No. 82-42-481-8648



INTERNATIONAL SEARCH REPORT

International application No.

PCT/US2010/020082**Box No. II Observations where certain claims were found unsearchable (Continuation of item 2 of first sheet)**

This international search report has not been established in respect of certain claims under Article 17(2)(a) for the following reasons:

1. ☒ Claims Nos.: 35,36
because they relate to subject matter not required to be searched by this Authority, namely:
Claims 35, 36 relate a method of intubating a patient, which fall into the category of methods for treatment of the human body by surgery or therapy as well as diagnostic methods [Article 17(2)(a)(i), Rule 39.1(iv) PCT].
2. ☐ Claims Nos.:
because they relate to parts of the international application that do not comply with the prescribed requirements to such an extent that no meaningful international search can be carried out, specifically:
3. ☐ Claims Nos.:
because they are dependent claims and are not drafted in accordance with the second and third sentences of Rule 6.4(a).

Box No. III Observations where unity of invention is lacking (Continuation of item 3 of first sheet)

This International Searching Authority found multiple inventions in this international application, as follows:

1. ☐ As all required additional search fees were timely paid by the applicant, this international search report covers all searchable claims.
2. ☐ As all searchable claims could be searched without effort justifying an additional fee, this Authority did not invite payment of any additional fee.
3. ☐ As only some of the required additional search fees were timely paid by the applicant, this international search report covers only those claims for which fees were paid, specifically claims Nos.:
4. ☐ No required additional search fees were timely paid by the applicant. Consequently, this international search report is restricted to the invention first mentioned in the claims; it is covered by claims Nos.:

Remark on Protest

- ☐ The additional search fees were accompanied by the applicant's protest and, where applicable, the payment of a protest fee.
- ☐ The additional search fees were accompanied by the applicant's protest but the applicable protest fee was not paid within the time limit specified in the invitation.
- ☐ No protest accompanied the payment of additional search fees.

INTERNATIONAL SEARCH REPORT

Information on patent family members

International application No.

PCT/US2010/020082

Patent document cited in search report	Publication date	Patent family member(s)	Publication date
US 2005-0137614 A1	23.06.2005	EP 1791477 A2 JP 2008-511414 A US 2005-137614 A1 US 2006-0064159 A1 US 2006-064159 A1 US 2008-0167595 A1 US 2008-167595 A1 US 7762977 B2 WO 2006-026687 A2 WO 2006-026687 A3	06.06.2007 17.04.2008 23.06.2005 23.03.2006 23.03.2006 10.07.2008 10.07.2008 27.07.2010 09.03.2006 09.03.2006
US 2007-0244546 A1	18.10.2007	None	
US 5827227 A1	27.10.1998	None	
US 2006-0166548 A1	27.07.2006	AU 2004-222266 A1 CA 2519423-A1 EP 1614194 A2 JP 2006-526266 A JP 2006-526266 T US 2004-0185709 A1 WO 2004-082740 A2 WO 2004-082740 A3 WO 2004-082740 A3	30.09.2004 30.09.2004 11.01.2006 16.11.2006 16.11.2006 23.09.2004 30.09.2004 30.09.2004 13.01.2005