

630717

FORM 1

REGULATION 9

COMMONWEALTH OF AUSTRALIA

PATENTS ACT 1952

APPLICATION FOR A STANDARD PATENT

We, OTIS ELEVATOR COMPANY, of Ten Farm Springs, Farmington, Connecticut 06032, United States of America, hereby apply for the grant of a Standard Patent for an invention entitled:-

"TOUCH BUTTON LIGHT RING SYSTEM"

which is described in the accompanying Complete Specification.

Details of basic application:-

Number: 376,079  
Country: United States of America  
Date: 5th July, 1989

Our address for service is: SHELSTON WATERS  
55 Clarence Street  
SYDNEY, N.S.W. 2000.

DATED this 2nd Day of July, 1990  
OTIS ELEVATOR COMPANY

*[Signature]*  
SHELSTON WATERS

To: The Commissioner of Patents  
WODEN A.C.T. 2606

File: D.B. O-85

Fee: \$325.00

5015803 02/07/90

# CONVENTION APPLICATION BY A COMPANY

FORM 8 - REGULATION 12 (2)

AUSTRALIA  
PATENTS ACT 1952

## DECLARATION IN SUPPORT OF A CONVENTION APPLICATION FOR A PATENT

(a) Here Insert (In full) Name of Company. (a) In support of the Convention Application made by.....  
OTIS ELEVATOR COMPANY.....

(b) Here Insert Title of Invention. (b) (hereinafter referred to as "Applicant") for a patent for an invention entitled:  
TOUCH BUTTON LIGHT RING SYSTEM.....

(c) and (d) Here Insert Full Name and Address of Company Official authorised to make declaration. I, (c) Robert P. Hayter.....  
of (d) Four Farm Springs, Farmington, Connecticut 06032, USA.....

do solemnly and sincerely declare as follows:

1. I am authorised by Applicant to make this declaration on its behalf.

2. The basic Application(s) as defined by section 141 of the Act was/were made

(e) Here Insert Basic Country followed by date of Basic Application. in (e) U.S.A. on the 5th day of July 19 89

(f) Here Insert Full Name(s) of Applicant(s) in Basic Country. by (f) Richard R. Polacek and Steven B. Davis

in ..... on the ..... day of ..... 19

by.....

in ..... on the ..... day of ..... 19

by.....

in ..... on the ..... day of ..... 19

by.....

(g) Here Insert (In full) Name and Address of actual inventor or inventors. 3. (g) Richard R. Polacek, 17 Bushy Hill Road, Simsbury, Connecticut 06070, USA and

Steven B. Davis, Rt. 181, Star Route, New Hartford, Connecticut 06057, USA

..... Xs/are

the actual Inventor(s) of the invention and the facts upon which Applicant is entitled to make the Application are as follows:

The applicant is the assignee of the actual inventors.

4. The basic Application(s) referred to in paragraph 2 of this Declaration was/were the first Application(s) made in a Convention country in respect of the invention, the subject of the Application.

DECLARED at Farmington, Connecticut, USA

this 4th day of May 1990.

(h) Personal Signature of Declarant (c) (no seal, witness or legalisation).

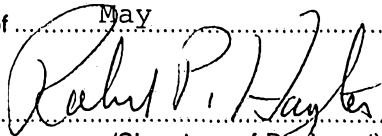
(h)   
(Signature of Declarant)

---

(12) PATENT ABRIDGMENT (11) Document No. AU-B-58675/90  
(19) AUSTRALIAN PATENT OFFICE (10) Acceptance No. 630717

---

- (54) Title  
TOUCH BUTTON LIGHT RING SYSTEM
- International Patent Classification(s)  
(51)<sup>5</sup> H03K 017/96 H01H 009/16 H01H 013/14
- (21) Application No. : 58675/90 (22) Application Date : 02.07.90
- (30) Priority Data
- (31) Number (32) Date (33) Country  
376079 05.07.89 US UNITED STATES OF AMERICA
- (43) Publication Date : 10.01.91
- (44) Publication Date of Accepted Application : 05.11.92
- (71) Applicant(s)  
OTIS ELEVATOR COMPANY
- (72) Inventor(s)  
RICHARD R. POLACEK; STEVEN B. DAVIS
- (74) Attorney or Agent  
SHELSTON WATERS , 55 Clarence Street, SYDNEY NSW 2000
- (56) Prior Art Documents  
US 4716992  
US 4865739
- (57) Claim

1. An illuminated touch button system for activating or deactivating an electrically controlled function, having a light ring surrounding the touch button surface for illuminating the button, comprising:

a light ring element having a top ring portion of light transmitting material, an upper portion having a solid interior of light transmitting material, and a bottom portion;

a button element located within said light ring element and being surrounded by its light transmitting top ring portion; and

an array of peripherally spaced, light emitting diodes (LEDs) located at said bottom portion, said upper portion of light transmitting material transmitting light from the LEDs to said top ring portion to be viewed by a button pusher indicating the "on"/"off" condition of the button, said upper portion of light transmitting material

(11) AU-B-58675/90  
(10) 630717

-2-

having a interior surface comprising a plurality of chambers spaced about the periphery of said upper portion, with each LED located below one of said chambers, each of said chambers includes an inclined surface facing its respective LED.

630717

COMMONWEALTH OF AUSTRALIA

FORM 10

PATENTS ACT 1952

C O M P L E T E        S P E C I F I C A T I O N

FOR OFFICE USE:

	Class	Int.Class
Application Number:		
Lodged:		

Complete Specification Lodged:  
Accepted:  
Published:

Priority:

Related Art:

---

Name of Applicant:        OTIS ELEVATOR COMPANY

Address of Applicant:     Ten Farm Springs, Farmington, Connecticut  
06032, United States of America

Actual Inventor:         Richard R. Polacek and Steven B. Davis

Address for Service:     SHELSTON WATERS, 55 Clarence Street, Sydney

Complete Specification for the Invention entitled:

"TOUCH BUTTON LIGHT RING SYSTEM"

The following statement is a full description of this invention,  
including the best method of performing it known to us:-

Description

TOUCH BUTTON LIGHT RING SYSTEM

Technical Field

The present invention relates to touch buttons typically used to activate or deactivate some electrical or electronic function, such as signaling, when touched typically by a human operator touching or "pushing" on the button with a finger. The invention more particularly relates to a light ring containing a circular array of light emitting diodes (LEDs) for a solid state touch button system operated, for example, by capacitative sensing, and even more particularly to such a button which can be used in many different applications, including particularly a touch or push button for elevator car calling or control, with the light ring providing visual feedback to the operator that the button has been actuated.

Background Art

In the elevator art is it common to provide "up" and "down" touch or push buttons at the entry areas to the elevators and to include similar buttons within the elevators for the passenger(s) to indicate at which floor(s) the elevator car should stop.

It is also common practice to include with such buttons an encircling light ring, which is illuminated



when the button has been actuated as a visual feedback to the operator. Typically, such rings received light from incandescent bulbs.

Some elevator related, U.S. patents which may be of interest are listed below:

<u>Patent No.</u>	<u>Patentee(s)</u>	<u>Issue Date</u>
4,650,037	Husson et al	March 17, 1987
4,716,992	Kunii	Jan. 5, 1988
4,805,739	Lind et al	Feb. 21, 1989

10 The '739 patent (Lind et al) discloses an elevator control switch and position indicator assembly for mounting in a panel comprising a piezoelectric element and a control circuit connected to the element for  
15 output signal from the element. A circular push button assembly is arranged such that, when the push button is operated, a force is applied to the piezoelectric element, and the push button assembly is restrained so that it can only deflect the element a predetermined  
20 distance sufficient to produce an output signal. The assembly further comprises an integral indicator device for providing an indication to the operator that an elevator control signal has been generated. The device is indicated as being configurable to provide an indication  
25 of the position of an elevator car.

In the first embodiment (Fig. 1) of the Lind et al patent, the light from a single, centrally located, long-life LED (44) with multiple elements for increased luminous intensity, in place of the short lived bulb of  
30 the prior art, is fed through a lens guide (16), forming a generally annular cross-section lens for guiding light to an externally disposed lens ring (42), to form a halo effect. The ring is illustrated as being integrally formed with the lens guide, which can be made of optical  
35 grade polycarbonate. Although the surfaces facing the LED are not described, they are illustrated as appearing

primarily, if not completely, laterally extended, with the nature of the facing surface not being clearly illustrated, with two laterally extended, parallel lines appearing in the drawing (Fig. 1).

5           In a second embodiment (Fig. 6) of the Lind et al patent a separately actuated LED (74) without any light pipe is positioned above the other LED and its lens guide to separately illuminate a centrally located, translucent graphic disk (76) positioned directly over it  
10 (in place of the operator button) to serve as an elevator car position indicator.

          There is no admission that the '739 patent, which was filed on January 14, 1988, is prior art to the present invention. However, assuming *arguendo* that it  
15 were, it does not teach, *inter alia*, an annular, circular array of a multiple number of LEDs using a series of alternating, inclined saw-toothed or grooved, triangulated surfaces above each LED surrounding a frosted, circular surface feeding the light rays from the multiple  
20 LEDs to the button surrounding light ring, producing a highly diffused, bright halo, with a relatively even luminosity, much less any of the many other innovative features of the present invention.

          The '037 patent (Husson et al) discloses the use  
25 of separated, independent LEDs in a controller apparatus for detecting lamp failures in an elevator system, an application not at all analogous to a touch or push button with a surrounding light ring.

          The '992 patent (Kunii) discloses the use of  
30 "light emitting means" (14) to illuminate indication marks on an elevator panel. Exactly what the "light emitting means" is, is not clear. But again, regardless of the nature of the "light emitting means," there is no suggestion of, *inter alia*, an annular, circular array of  
35 a multiple number of LEDs using a series of alternating, inclined saw-toothed or grooved, triangulated surfaces

above each LED surrounding a frosted, circular surface feeding the light rays from the multiple LEDs to the button surrounding light ring, producing a highly diffused, bright halo, with a relatively even luminosity, much less any of the many other innovative features of the present invention.

Disclosure of Invention

The light ring of the invention preferably includes an annular, transparent or translucent, light pipe section having an open center at its end which faces the exterior (such as, for example, the hall or car, as the case may be, when used in an elevator system), and a restricted, basal end, which is hidden in the wall behind the button touch surface. A plurality of LEDs are mounted inside the basal end of the light ring in an annular, circular array, and, preferably, an alternating series of saw-toothed or grooved annulus of light dispersing, internal, triangular interfaces or light receiving surfaces is disposed between the LEDs and the ring end of the rim.

In this way light is evenly piped to the open end of the ring, in which the button disc element is located, to form a bright, even halo around the button disc element to serve, for example, as a visual feedback to the button pusher that the button has been activated.

Various, other innovative features preferably are included to, *inter alia*, insure the proper alignment and keying of the sub-elements which make up the light ring, including a printed circuit board (PCB) base, which carries the LEDs and some of its associated circuitry, and the molded light transmitting body of the light ring.

The invention may be practiced in a wide variety of applications, including but certainly not restricted to elevator car call or control buttons, utilizing known

technology, in the light of the teachings of the invention, which are discussed in detail hereafter.

Other features and advantages will be apparent from the specification and claims and from the accompanying drawings, which illustrate at least one exemplary embodiment of the invention.

#### Brief Description of Drawings

Figure 1 is an exploded, perspective view of an exemplary solid state push button assembly, including the button, light ring, printed circuit (PC) board and holder for attaching the PC board to the push button elements and the overall button assembly to a face plate or panel, with the PC board carrying the electrical components which form the exemplary electronics and circuitry of the present invention. (It is noted that the touch button elements of Figure 1 are basically symmetrical about their longitudinal center-line, except for the PC board and its associated holder.)

Figures 2A, 2B & 2C are top, side/cross-sectional and bottom views, respectively, of the light ring element of the button assembly of Figure 1.

Figure 3 is a partial, side view showing the bottom portion of the light ring element of Figs. 2A-2C.

Figure 4 is a top view of the LED base element of the light ring element of Figs. 2A-2C; while Figure 5 is a side view thereof, and Figure 6 is a further side view with the base rotated ninety (90°) from its position in Fig. 5.

Figure 7 is a schematic diagram of the LED circuitry of the light ring element of Figs. 2A-2C.

Figure 8 is a cross-sectional view of the light ring element of Figs. 2A-2C (taken along section line 8-8 of Figure 2B) looking up into the triangularly topped cavities in the light ring element in which the LEDs are positioned, and which cause the light emanating from the

LEDs to be disbursed up into and through the transparent material of the upper portion of the light ring element to be transmitted out of the surrounding ring portion of the element to be viewed by, for example, the button  
5 pusher.

Best Mode for Carrying Out the Invention

- BUTTON ASSEMBLY (10) -

As can be seen in Figure 1, the exemplary "solid state button" (SSB) assembly 10 of the present invention  
10 preferably includes a non-moving, capacitive sensing button surface 1, that can be used, for example, as a call button in the car operating panel (COP) and/or hall fixtures of an elevator system. The SSB is capable of capacitively sensing a human touch, preferably providing  
15 both visual feed back (illumination) to the button pusher, as well as communication to the operational control of the elevator system via a remote station (RS; not illustrated) interface that the button has been actuated, so that the system accordingly can react.

20 The exemplary button system of Figure 1 includes the non-moving button element 1 fitted within a light ring element 2, in which ring is carried a circular array of light emitting diodes (LEDs) 3 at its bottom, there being preferably at least five (5) LEDs, with nine being  
25 used in the illustrated, exemplary, currently preferred embodiment.

A printed circuit board 4, into which the light ring element 2 is pin inserted, is carried on the back side of the button elements 1, 2, and is held to the  
30 button elements by a bracket 5 and a rear bolt 6 having a bolt head 6B. As can be generally visualized in Figure 1, the bolt head 6B extends past the bottoms of all of the other button elements of the button assembly 10.

An interconnecting bolt or stem 7 has a front, threaded, male end 7A, which is screwed into the back  
35

side of the button surface 1, and a rear, threaded, male end 7B, which is screwed into the front end 6A of the rear bolt 6 with a lock washer 7C. The interconnecting bolt 7 extends through a center, generally circular opening 20 (which can be seen in Figures 2A-2C and 4 & 8) in the light ring element 2 and through an opening in the PC board 4, while the head 6B of the rear bolt 6 fits into a notch in a "U" shaped rear strap 8, which is part of the bracket holder 5. The bolt or stem 7 has a series of longitudinally extended, flat, side surfaces 7C, forming a hexagonal cross-section for the stem which mates with a like configured, interior surface 21, which forms the lower part of the central opening 20.

When assembled, the intermediate elements of the button assembly 10 are held in compression between the button surface 1 and the head 6B of the bolt 6. The flat surface interfacing of the stem 7 and the interior opening 21 fixes and keys them together about their common, longitudinal axis, thus preventing the light ring 2 from being rotatable or movable around the stem about their common, longitudinal axis.

The bracket 5 includes a series of peripherally spaced, lateral extensions or arms 9, through which threaded screw pins 9B are placed for fastening the button assembly 10 to a face plate or panel by means of like threaded female orifices in the face plate or panel. When so fastened, the only elements of the button assembly 10 which are seen by the user is the non-moving, circular button surface 1 surrounded by the translucent ring 2A, which is illuminated with relatively bright, relatively evenly diffused light originally emanating from the internally contained LEDs when the button is actuated. Alternatively, if so desired and depending on the application involved, the top ring portion 2A could be illuminated by its associated circuitry when the button is in its "off" condition.

The printed circuit board 4 carries on it the electronic components and associated circuitry which perform the monitoring functions of the button.

- LIGHT RING (2) -

5           As will be detailed more fully below, the substantially cylindrical body of the light ring 2 includes a top ring portion 2A of light emitting material encircling the bottom surface element 1, an upper portion 27 of light transmitting material, and a bottom portion, 10 which is (but need not be) of light transmitting material. The bottom portion includes a base 23 carrying an array of LEDs 3.

          The illumination of the light ring 2 is controlled by the button surface 1 through appropriate circuitry. 15 The source of the illumination is comprised, for example, of two strings of LEDs 3 located at the bottom of the light ring 2 and are fed preferably by dedicated current regulators through pin connectors J2 and J3 (note Figs. 2C & 7), which pin connectors are inserted into connector 20 openings in the printed circuit board (PCB) 4. The current through each string of LEDs 3 is regulated to, for example, thirty (30mA) milliamps, by appropriately controlling the voltage. Compensating resistors 35 can be included with the LEDs 3, if so desired.

25           As can be seen in Figures 4-7, an exemplary nine LEDs 3 are included, preferably equally spaced about the periphery of the bottom base area 22 of the light ring 2, forming an annular array.



As can be seen in Figure 2C, the connecting pins for the nine (1-9) LEDs 3 all fall on the periphery of a circle about the longitudinal center line (C.L.; note Fig. 2B) of the light ring 2, except for the initial, 5 first (1) and second (2) LEDs in each string (note schematic of Fig. 7) and the sixth (6) one, which is oppositely positioned to the positions of the first and second ones. The two pin connections or leads for each of these three LEDs are preferably positioned in a line 10 parallel to a lateral line LL bisecting the base 23.

The base 23, which is substantially circular in its lateral extent, is a printed circuit board (PCB), which includes printed, conductive lead lines interconnecting the LEDs 3 in two parallel strings, along with 15 two associated, compensating resistors 35, if such is needed or desired, in accordance with the circuitry schematic of Figure 7.

As can be seen in Figure 8, each LED 3 "looks up" into the center of an triangulated chamber 24, with each 20 individual chamber preferably being made up of three, inclined, triangular surfaces sharing a common apex 25, which is located at the outermost point of the central triangular surface and is at the outermost periphery of the inside of the light ring 2. Each of the three 25 triangular surfaces of each chamber 24 includes a series of molded-in straight edges 26, each of which extends across its respective surface leading up to their common apex in a stepped fashion.

Each of these chambers 24 serves as the light 30 receiving surfaces for its respective LED 3, channeling the light in a highly diffused manner into and through the light-pipe-like, solid interior of the upper portion, 27 of the light ring 2 leading to the encircling, top, light ring portion 2A, through which the light from the 35 light ring 2 is seen by the button user. The series of straight edges or steps function as Fresnel-like grooving

on the underside of the upper interior of the light ring 2.

The interior side 20A (note Figs. 8 & 2B) of the surface 20 preferably is frosted, which frosted surface 5 20A, as can be seen in Figure 8, is convex and terminates in the base side of the central one of the three triangulated surfaces forming the chambers 24. As can be further seen, one of the triangulated surfaces of each chamber 24 is positioned between the other two, sharing 10 common sides with them, while the saw-toothed grooves or Fresnel-like edges 26 are disposed parallel to their respective bases of the triangulated surfaces.

As can best be seen in Figure 2B, the upper, central, conical, circular area or centrally facing, 15 exterior surface 20 is sloped at an angle of, for example, sixty (60°) degrees, that is, at an angle of thirty (30°) degrees to the center line C.L.. This is done in order to provide diffusion reflection in the solid, light transmitting interior 27 and thus minimize 20 the loss of any light from the solid interior of the ring 2 into the open, center area defined by the interior, center side of the conical surface 20, where the light effectively would be lost or wasted.

This overall arrangement produces a relatively 25 uniform intensity of light at and about the outer, encircling ring 2A, although the light ultimately seen there originated in fact from the relatively discrete, spaced, light sources generated by the nine, peripheral-ly spaced LEDs 3. The light ring 2, and in particular 30 the upper, solid, light "pipe" portion 27, can be made of a single, integral, molded piece of transparent "LEXAN™" (940 AR), with the exception of the PCB base 23 and its associated electrical components.

Although the illustrated (as described above and 35 below) overall arrangement is currently preferred, it is of course subject to substantial variations, with many of

the factors producing the desired light diffusion being interdependent, as known to those of ordinary skill in the optics art.

In order to properly align the molded body portion of the light ring 2 and the PCB base 23 with its LEDs 3), the molded body includes two, longitudinally extended, peripherally positioned but off-set, integrally molded pins or projections 28, which mate into circular indentations or cut-outs 29 similarly located in the periphery of the base, keying the two sub-elements together. The base 23 also includes two, opposed, radially directed projections 30, which fit into openings 31 (note Fig. 3) in flexible longitudinal extensions 32 in the molded body portion of the ring 2.

The pins 28 (and accordingly the indentations 29) preferably are offset, rather than being directly opposed, by being peripherally spaced from one another by an angle of, for example, one hundred and sixty (160°) degrees (*vis-a-vis* 180°). This insures that there is only one way or one mating alignment in which the base 23 can be positioned with respect to the ring body.

When the base 23 and the body of the ring 2 are properly aligned with the pins 28 in the indentations 29 and then brought together in a longitudinal direction, the extensions 32 flex out, allowing the radially directed projections to snap into the openings 31, latching the two sub-elements together. When it is desired to separate the two sub-elements, the extensions 32 are merely pulled laterally out, allowing the base 23 and its electrical components to be removed down and out away from the ring body.

When assembled, the pin connectors J2 & J3 are inserted into their respective mating openings in the PCB 4 to be connected into the circuit for the button assembly 10. Peripheral, longitudinally extended portions or bosses 34 are included to support the bottom

of the ring 2 on the PCB 4 and prevent any rocking of the ring 2 about the bottom surfaces of the headers of the pin connectors J2 & J3.

If desired and as illustrated, two, vertically or  
5 longitudinally disposed resistors 35 could be included on and carried by the PCB base 23, along with their associated LEDs 3 (note Figs. 5 & 6). These resistors 35 are connected into the circuitry of the base, as shown in the schematic of Figure 7, by appropriately placed, printed  
10 circuit board lead lines on the base.

A rectangular "label" area 33 (note Fig. 3) can be provided on the lower side of the ring molded body to identify or serialize the ring 2, if so desired.

Approximate, exemplary dimensions for the light  
15 ring 2 are outlined below:

	<u>Part</u>	<u>Dimension</u>
	Diameter of top ring portion 2A	1"
	Longitudinal length of body of light ring 2	1.1"
20	Longitudinal length of cylindrical, interior part of upper part 27	0.25"
	Longitudinal length of inclined, conical part 20	0.5"
	Longitudinal length of hex. area 21	1.5"
25	Lateral width of hex. area 21	0.25"

- EXEMPLARY ELEVATOR APPLICATIONS -

The exemplary solid state button assembly 10 described in detail above is designed to be applied in a hall fixture and/or car operating panel (COP) of an  
30 elevator, although, of course, many other uses and applications are possible.

The hall fixture application allows for two button assemblies (not illustrated), a beeper or key switch assembly and an RS-4 type board to fit into a  
35 commercially available masonry box. The masonry box (not illustrated) used should provide a shallow wall depth for the entire assembly. A shallow wall depth [for example, sixty-five (65 mm) millimeters] avoids penetrating the hoist-way fire barrier in common commercial construction.

The face plates can be made of, for example, die cast metal and be available in various finishes. Also one, two or three (1, 2 or 3) position combinations of buttons or key switches can be used. A tamper proof  
5 fastener (not illustrated) preferably is used to fasten the face plate to the masonry box.

The COP application allows for multiple buttons to be mounted in a panel and connected to a Remote Serial Extender Board (not illustrated).

10 In hall fixture applications the face plate should be connected to the masonry box with, for example, an insulated flat braided conductor (not illustrated), having, for example, a maximum length of eighteen (18 cm.) centimeters. The masonry box should be bonded to  
15 building steel through wiring conduit or a flat braided conductor to the closest building steel.

A chassis ground is applied on the button from the face plate (hall fixture) or return panel (COP). In hall fixture applications the face plate should be  
20 grounded to the fixture electrical box, while the electrical box should be bonded to building steel through the wiring conduit.

The only product variations needed for the exemplary applications are the two colors of light rings, namely, red and green, and the application of the button  
25 to a hall fixture and a COP.

The exemplary unit described above is a relatively low cost, easily replaceable device, taking, for example, five (5) minutes to replace.

30

\* - \* - \* - \* - \*

Although this invention has been shown and described with respect to at least one detailed, exemplary embodiment thereof, it should be understood by those skilled in the art that various changes in form, detail, methodology and/or approach may be made without departing  
35 from the spirit and scope of this invention.

Having thus described at least one exemplary embodiment of the invention, that which is new and desired to be secured by Letters Patent is claimed below.

THE CLAIMS DEFINING THE INVENTION ARE AS FOLLOWS:-

1. An illuminated touch button system for activating or deactivating an electrically controlled function, having a light ring surrounding the touch button surface for illuminating the button, comprising:

5 a light ring element having a top ring portion of light transmitting material, an upper portion having a solid interior of light transmitting material, and a bottom portion;

a button element located within said light ring  
10 element and being surrounded by its light transmitting top ring portion; and

an array of peripherally spaced, light emitting diodes (LEDs) located at said bottom portion, said upper  
15 portion of light transmitting material transmitting light from the LEDs to said top ring portion to be viewed by a button pusher indicating the "on"/"off" condition of the button, said upper portion of light transmitting material having a interior surface comprising a plurality of chambers spaced about the periphery of said upper  
20 portion, with each LED located below one of said chambers, each of said chambers includes an inclined surface facing its respective LED.

2. The touch button with light ring system of claim 1, wherein:

each of said inclined surfaces has a series of spaced, Fresnel-like edges facing toward its respective LED.



3. The touch button with light ring system of claim 1, wherein:

each of said chambers includes a set of at least two, light receiving, triangulated surfaces inclined down toward its respective LED.

4. The touch button with light ring system of claim 3, wherein each chamber includes:

at least three of said inclined triangulated surfaces, each sharing a common apex located toward the outer exterior of the light ring.

5. The touch button with light ring system of claim 4, wherein:

each of said inclined, triangulated surfaces having a series of spaced, Fresnel-like edges facing toward its respective LED disposed parallel to the base of its respective triangulated surface.

6. The touch button with light ring system of claim 5, wherein:

one of said three triangulated surfaces is located between the other two, sharing common sides therewith;

5 and wherein there is further included:

an outwardly curved, convex, inclined surface which terminates in the base side of said one of said three triangulated surfaces.

7. The touch button with light ring system of claim 6, wherein:

said convex, inclined surface is frosted.



8. The touch button with light ring system according to any one of the preceding claims, wherein:

said upper portion has an exterior, centrally directed side having a center line axis and includes on  
5 said exterior, centrally directed side a conical surface making an angle to its center line axis which produces diffusion reflection for the light rays travelling within its solid, light transmitting material, as the light rays which have entered into it from said LEDs are transmitted  
10 to said top ring portion, at least reducing the light going from said LEDs to the open interior of said upper portion.

9. The touch button with light ring system of claim 8, wherein:

said angle is of the order of about thirty (30°) degrees.

10. The touch button with light ring system according to any one of the preceding claims, wherein:

said LEDs are carried on a printed circuit board (PCB) base which is fastened to and carried by said bottom portion of said light ring element.

11. The touch button with light ring system of claim 10, wherein:

said light ring element is longitudinally extended from said top ring portion to said bottom portion and forms a substantially cylindrical shape on its outwardly facing exterior side, with there being at least five of said peripherally spaced LEDs in an annular circular



array located at its bottom portion carried by said PCB base.

12. The touch button with light ring system of claim 10 or claim 11, wherein:

said bottom portion includes at its outer periphery at least two, flexible, bottom extensions each having a  
5 latching opening; and wherein:

said base is substantially circular in shape and includes two radially directed projections which fit into said latching openings; said base being latched to said bottom portion through the interfacing of said  
projections into said latching openings.

13. The touch button with light ring system of claim 10, claim 11 or claim 12, wherein:

said bottom portion includes at its outer periphery at least two, peripherally off-set, longitudinally  
5 extended, keying pins; and wherein said base includes two mating indentations on its periphery configured to the exterior shape of said keying pins; said keying pins being located in said mating indentations.

14. The touch button with light ring system according to any one of claims 10 to 13, wherein:

said LEDs are electrically connected together in at least two parallel strings by conductive lead lines printed on said PCB base.

15. The touch button with light ring system of claim 14, wherein:



said base is substantially circular and each of  
said LEDs has two electrical leads, at least one of said  
5 LEDs having its two lead disposed parallel to a laterally  
extended line bisecting across said base, with at least  
four of said LEDs each having its respective two leads  
located along the periphery of a common circle about the  
center of said base.

16. The touch button with light ring system according  
to any one of the preceding claims, wherein:

said ring element has a centrally located opening  
through it, at least part of which has a series of flat,  
5 longitudinally extended, keying surfaces; and

said button element has an underside facing toward  
said bottom portion of said light ring element and has a  
centrally located, threaded part on said underside; and  
wherein there is further included:

10 a base carrying said LEDs fastened to said bottom  
portion and having a centrally located opening through  
it; said centrally located openings and said threaded  
portions being aligned in a straight line; and

15 a longitudinally extended stem bolt element having  
a head end located past said base and a threaded end  
mating with said centrally located threaded part; said  
bolt element causing said base, said light ring element  
and said button element to be held together.

17. The touch button with light ring system of claim  
16, wherein there is further included:

a printed circuit board (PCB) including electrical components associated electrically with said LEDs and  
5 interfaced to said base by means of pin connections associated with the underside of said base and having a centrally located opening through it aligned with said centrally located openings in said light ring element and said base; and

10 a holder bracket associated with said PCB; said bolt element extending through all of said centrally located openings with the head of said bolt element located past said PCB and at least part of said holder bracket, said bolt element holding said light ring  
15 element, said PCB and said holder bracket together under compression between said button surface and said head.

18. A touch button light ring system substantially as herein described with reference to the accompanying drawings.

DATED this 2nd day of September 1992

OTIS ELEVATOR COMPANY

Attorney: PETER HEATHCOTE

Fellow Institute of Patent Attorneys of Australia  
of SHELSTON WATERS



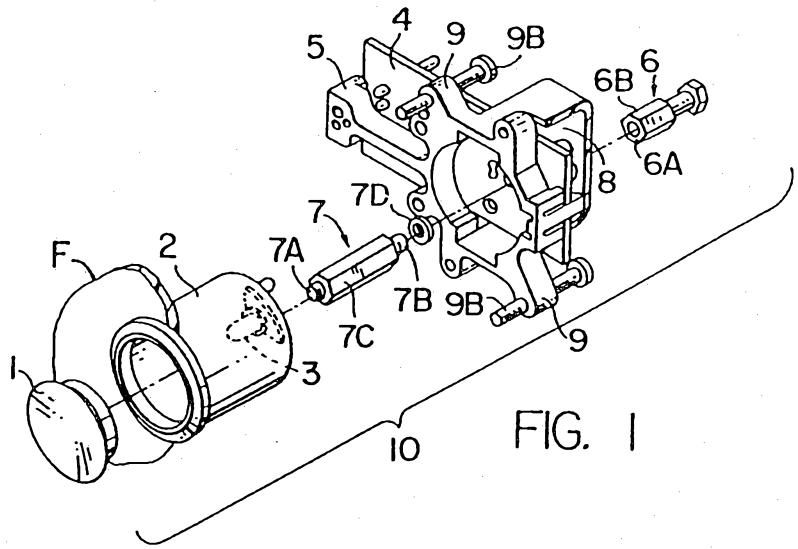
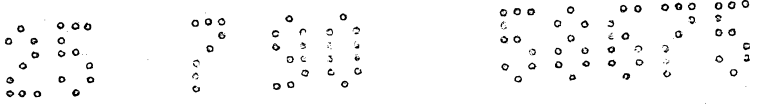

FIG. 1

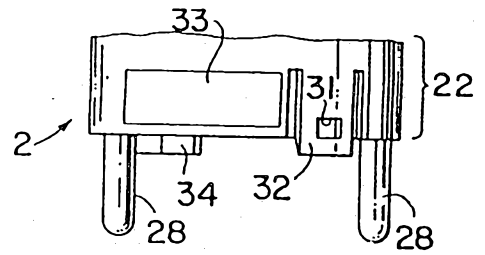

FIG. 3

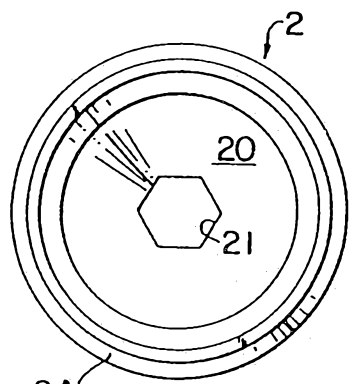

FIG. 2A

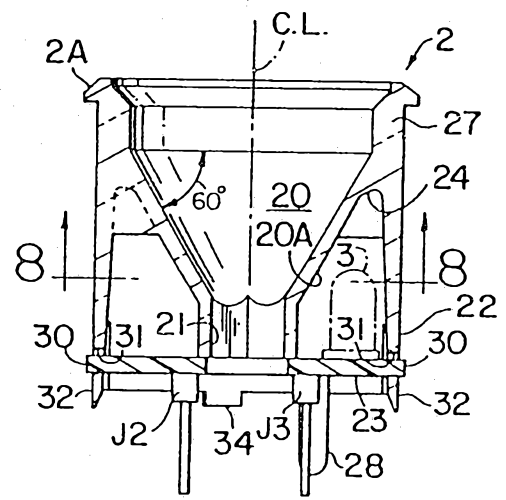

FIG. 2B

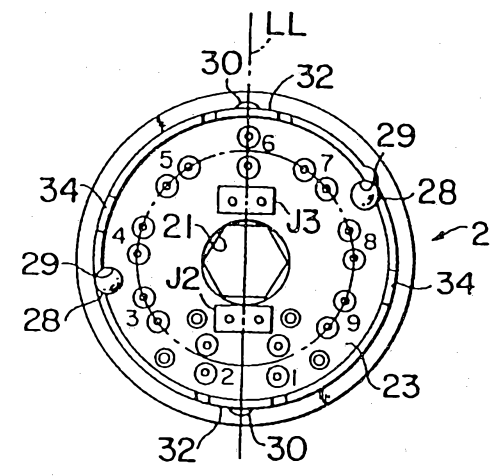
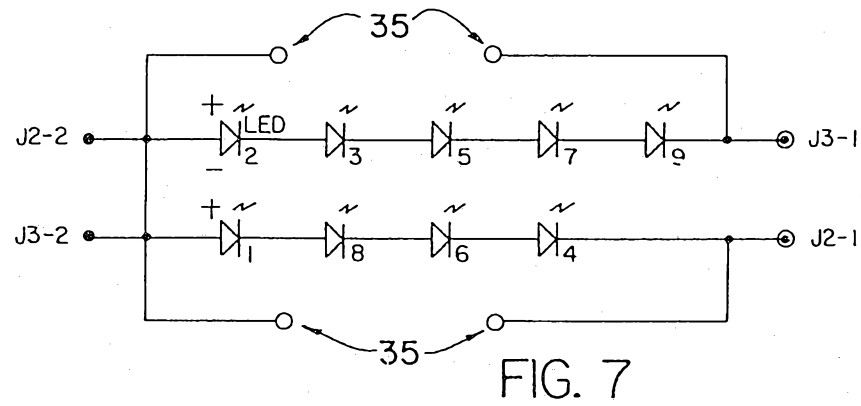
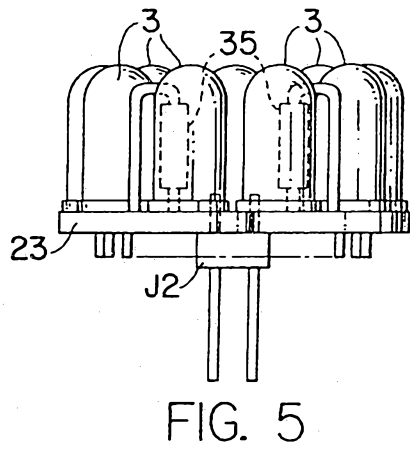
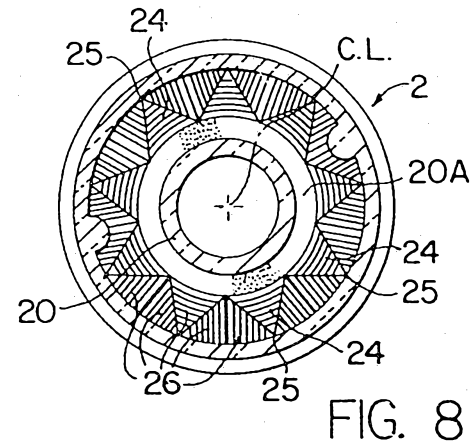
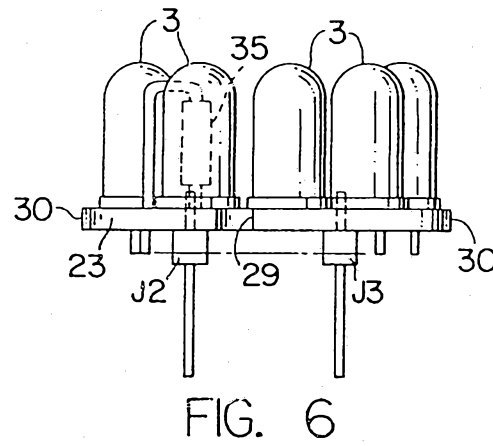
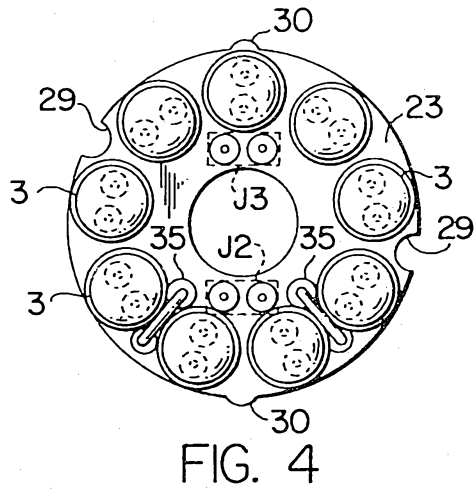

FIG. 2C

58675/90

25 7 30 55 75



58675/90