

(19) World Intellectual Property Organization
International Bureau



(43) International Publication Date
19 January 2012 (19.01.2012)

(10) International Publication Number
WO 2012/009153 A2

(51) International Patent Classification:

A61B 19/00 (2006.01) A61B 17/28 (2006.01)
B23Q 3/155 (2006.01) A61B 17/32 (2006.01)
A61B 17/00 (2006.01)

(21) International Application Number:

PCT/US2011/042060

(22) International Filing Date:

27 June 2011 (27.06.2011)

(25) Filing Language:

English

(26) Publication Language:

English

(30) Priority Data:

12/792,618 14 July 2010 (14.07.2010) US

(63) Related by continuation (CON) or continuation-in-part (CIP) to earlier application:

US (CIP)
Filed on

(71) Applicant (for all designated States except US): CARE-FUSION 2200, INC. [US/US]; 3750 Torrey View Court, San Diego, California 92130 (US).

(72) Inventors; and

(75) Inventors/Applicants (for US only): DOYLE, Mark [US/US]; 1227 Cuchara Drive, Del Mar, California 92014

(US). CAPUTO, Jimmy C. [US/US]; 2157 Vista La Nisa, Carlsbad, California 92009 (US).

(74) Agents: GALLENSON, Mavis S. et al.; 5670 Wilshire Boulevard, Suite 2100, Los Angeles, California 90036 (US).

(81) Designated States (unless otherwise indicated, for every kind of national protection available): AE, AG, AL, AM, AO, AT, AU, AZ, BA, BB, BG, BH, BR, BW, BY, BZ, CA, CH, CL, CN, CO, CR, CU, CZ, DE, DK, DM, DO, DZ, EC, EE, EG, ES, FI, GB, GD, GE, GH, GM, GT, HN, HR, HU, ID, IL, IN, IS, JP, KE, KG, KM, KN, KP, KR, KZ, LA, LC, LK, LR, LS, LT, LU, LY, MA, MD, ME, MG, MK, MN, MW, MX, MY, MZ, NA, NG, NI, NO, NZ, OM, PE, PG, PH, PL, PT, RO, RS, RU, SC, SD, SE, SG, SK, SL, SM, ST, SV, SY, TH, TJ, TM, TN, TR, TT, TZ, UA, UG, US, UZ, VC, VN, ZA, ZM, ZW.

(84) Designated States (unless otherwise indicated, for every kind of regional protection available): ARIPO (BW, GH, GM, KE, LR, LS, MW, MZ, NA, SD, SL, SZ, TZ, UG, ZM, ZW), Eurasian (AM, AZ, BY, KG, KZ, MD, RU, TJ, TM), European (AL, AT, BE, BG, CH, CY, CZ, DE, DK, EE, ES, FI, FR, GB, GR, HR, HU, IE, IS, IT, LT, LU, LV, MC, MK, MT, NL, NO, PL, PT, RO, RS, SE, SI, SK, SM, TR), OAPI (BF, BJ, CF, CG, CI, CM, GA, GN, GQ, GW, ML, MR, NE, SN, TD, TG).

[Continued on next page]

(54) Title: SURGICAL TOOL KIT

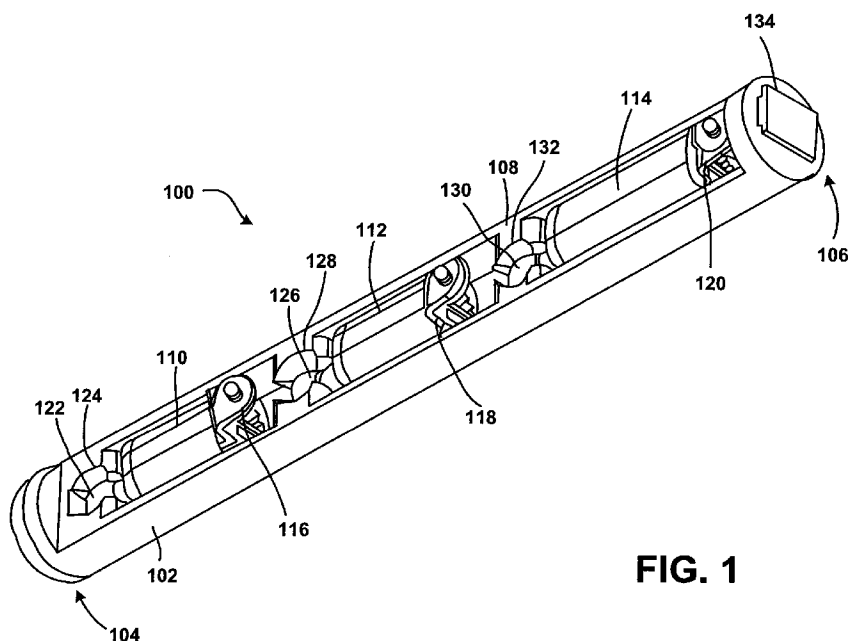

FIG. 1

(57) Abstract: A tool kit for interchanging tools within an at least partially closed area is provided. The tool kit includes at least one tool, each tool being preferably provided within a tubular housing, and adapted to pivot out from the tool kit so that they can be attached to a receiving tool. The tool is designed to be returned to the tool kit after use, and if desired, switched with a different tool. In one embodiment, a surgical system permitting surgical tools to be interchanged within a patient's body is provided. A method of interchanging surgical tools within a patient's body is also provided.



WO 2012/009153 A2

Published:

- *without international search report and to be republished upon receipt of that report (Rule 48.2(g))*

SURGICAL TOOL KIT

Related Applications

[0001] This application is a continuation-in-part of U.S. Application 11/775,170 entitled "Surgical Tool Kit" which is a continuation of U.S. Application No. 10/870,084, filed June 16, 2004, which are incorporated herein by reference in entirety.

Background

Field

[0002] The present technology relates generally to surgical instruments. More particularly, the invention relates to a tool kit for use in minimally invasive surgical procedures.

Description of Other Art

[0003] Current laparoscopic surgical tools are limited in accessibility of certain regions of the human body. Existing tools can perform invasive surgery without making a substantial incision, but these tools are incapable of bending within the body to reach, for example, the backside of the human heart.

[0004] Additionally, existing tools rely on use of cables to manipulate the surgical tip of the tool. These tools have the disadvantage of requiring extensive sterilization of the internal components. The cleaning of internal metal cables can be a lengthy and expensive process. This process must be repeated prior to each procedure. Alternatively, disposable components may be used with a substantial increase in recurring costs.

[0005] Furthermore, current laparoscopic surgical systems are limited because the tools used to perform various functions within the body have to be changed outside the body. The entire system must be removed from the body, the tool changed outside of the body, and then the system be reinserted into the body.

Alternatively, additional incisions are made in the patient's body through which additional surgical tools are inserted. This makes the surgical procedure more complex, and patient recovery time is increased.

[0006] Accordingly, there is a need for a laparoscopic surgical system that permits a surgical tool to be changed within the body.

[0007] There is also a need for a tool kit that permits a tool to be changed within a closed area.

Summary

[0008] Disclosed herein is a tool kit comprising a housing having at least one attachment point; at least one tool holder having an attachment element, wherein said attachment element is adapted to attach said tool holder to said attachment point on said housing; at least one tool adapted to be removably secured to said tool holder; wherein said tool is also adapted to be connected to a manipulator for use within a generally closed or confined area, and wherein when said tool is connected to said manipulator, an operator of said manipulator can exchange said connected tool for a second tool without first removing said manipulator from said generally closed or confined area; and wherein when said tool is placed inside said tool holder, said tool cannot be removed therefrom unless said tool is properly connected to said manipulator, and when said tool is properly connected to said manipulator, said tool cannot be released therefrom unless said tool is properly secured into said tool holder.

[0009] Also disclosed herein is a tool kit comprising a housing having an opening and at least one attachment point within said opening, wherein said housing comprises a generally cylindrical body; at least one tool holder having an attachment element, wherein said attachment element is adapted to attach said tool holders to said attachment point on said housing, and wherein said tool holder is adapted to fit within said opening so that when said tool holder is within said opening the diameter of said housing is not increased; at least one tool adapted to be removably secured to said tool holder; wherein said tool is also adapted to be connected to a manipulator for use within a generally closed or confined area, and wherein when said tool is connected to said manipulator, an operator of said manipulator can exchange said connected tool for a second tool without first removing said manipulator from said generally closed or confined area; and wherein when said tool is placed inside said tool holder, said tool cannot be removed therefrom unless said tool is properly connected to said manipulator, and when said tool is properly connected to said manipulator, said tool cannot be released therefrom unless said tool is properly secured into said tool holder.

[0010] Further, disclosed herein is a tool holder comprising a body, defining a cavity within said body, said cavity configured to hold a tool; a projection within said cavity set at a distance away from a wall of said body; a cam; at least one keyway configured to allow a tine of a tool receiving device to pass therethrough; and an attachment element for attachment of said tool holder to a tool kit.

[0011] In addition, disclosed herein is a tool kit comprising at least one tool; means for holding said tool; means for attaching said means for holding a tool to said tool kit; and means for attaching said tool kit to a tool kit receiving device.

[0012] Disclosed herein is also a method of interchanging tools within a generally closed or confined area comprising: inserting a tool kit into said closed area, wherein said tool kit comprises a plurality of tools each held within a tool holder; attaching a manipulator to a first of said plurality of tools held within a first tool holder; removing said first tool from said first tool holder; manipulating said first tool; replacing said first tool in said first tool holder; attaching said manipulator to a second of said plurality of tools held within a second tool holder; and manipulating said second tool; wherein said manipulator is not removed from said generally closed or confined area during steps b) through f).

Brief Description of the Drawings

[0013] Figure 1 is a perspective view of a tool kit in accordance with one embodiment of the present invention.

[0014] Figure 2 is a perspective view of the tool kit wherein the holster is pivoted outwardly.

[0015] Figure 3 is a perspective view of an alternative embodiment of a tool kit in accordance with one embodiment of the present invention.

[0016] Figure 4 is a detailed perspective view of the tool holder.

[0017] Figure 5 is a cross-sectional view of a tool held inside a tool holder.

[0018] Figure 6 is another cross-sectional view of a tool inside a tool holder.

[0019] Figure 7 shows a tool receiving device about to remove a tool from a tool holder.

[0020] Figure 8 provides another view of the tool receiving device placed before a tool holder to attach to the tool.

[0021] Figure 9 shows an embodiment in which the tines are closed and the tool is ready to be moved out of the tool holder.

[0022] Figure 10 shows an embodiment in which the tool is attached to the tines of the manipulator and is removed from the tool holder.

[0023] Figure 11 shows a cross-sectional view of the tool holder with the tool held inside.

Detailed Description

[0024] Aspects of the present disclosure relate to a system of interchangeable tools for use within a closed area. In general, disclosed herein is a holder which comprises one or more tools attached thereto. The holder and the attached tools are so configured that they can be inserted into a closed area and easily manipulated therein. Examples of the closed area include inside the body of a patient, as in during laparoscopic or arthroscopic surgery, or inside of a device or a mechanical object, as in during maintenance or repair of the interior of said device or mechanical object.

[0025] In certain embodiments, the tools are configured to be attached to the distal end of a manipulator, which itself is configured to receive the tools. The distal end of the manipulator can itself be inserted into the closed area. The distal end of the manipulator can be controlled by an operator at a proximal end, i.e., the end closest to the operator. Within the closed area, the operator can choose a desired tool from a selection of tools on the holder and attach it to the distal end of the manipulator. After the operator has used the tool in a desired fashion, the operator can then return the just-used tool to the holder, obtain a second tool from the holder, attach it to the distal end of the manipulator, and use the second tool. The operator can repeat this process as many times as the operator desires, thereby interchanging the tool used inside the closed area without having the need to withdraw the manipulator from the closed area. As described in detail below, this system is designed for use, for example, in laparoscopic surgery. The tools are various surgical tools used within the patient's body. The tools in the holder are inserted into the body. During surgery, the surgeon can use and exchange tools without the need to remove the manipulator or the tools themselves from the body. This represents a significant improvement over existing methods and devices.

[0026] A "manipulator" as used herein refers to a device that at its proximal end comprises a set of controls to be used by an operator and at its distal end comprises means for holding and operating a tool, referred to herein as the "tool receiving device." The controls allow the operator to move the tool receiving device

within the generally closed or confined area, and operate the tool as intended. The tool receiving device is adapted to receive tools interchangeably and can cause a variety of different tools to operate in their intended purpose. Examples of a manipulator include any of a variety of laparoscopic or arthroscopic surgical tools available on the market for use by surgeons, or the device described in U.S. Patent No. 6,607,475. The tool receiving device of a manipulator is adapted to enter a generally closed or confined area through a small opening, such as a small hole in a mechanical device or a small incision in a human body.

[0027] As used herein, “proximal” refers to the part of the device that remains outside of the closed area, closest to the operator. “Distal” refers to the end inserted into the closed area, farthest away from the operator. The proximal and distal ends are preferably in communication with each other, such as fluid communication, electrical communication, communication by cables, and the like. Such communication can occur, for example, through a catheter or cannula, which houses the lines used for such communication. The catheter or cannula is preferably a tube or other substantially cylindrical hollow object. In some embodiments, the catheter or cannula does not house any lines for communication between the proximal and distal ends. In these embodiments, the catheter or cannula is used for placing an object, located substantially at the distal end of the catheter or cannula, inside the closed area for further manipulation.

[0028] During the operation of the devices described herein, the catheter or cannula (hereinafter referred to simply as “cannula”) is inserted into a generally closed or confined area where the tools are to be used such that its proximal end remains outside the closed area while the distal end remains inside the closed area. In the context of surgical procedures, the cannula is inserted into the patient’s body such that its proximal end remains outside the body while the distal end remains inside the body. This allows the operator, e.g. a surgeon, to access the interior of the closed area, e.g., a patient’s body, using the cannula, thereby eliminating the need for “open” surgical procedures. Only a small incision is needed to insert the cannula, and the various surgical instruments are inserted, and the procedures performed, through the cannula.

[0029] The instruments or tools described herein are capable of being attached to the distal end of the manipulator in a number of different ways. For instance, in some embodiments the tools are attached magnetically, while in other embodiments the tools may clip on to the distal end of the manipulator. Additional details on the attachment of the tools is provided below.

[0030] The manipulator, which is used to position and maneuver the tools within the confined space, can be a hydraulic, pneumatic, robotic, standard surgical, minimal invasive surgery (MIS), electrical, or mechanical device, or a device comprising a combination of any of these systems. Any system that can be used to position and manipulate the tools is contemplated.

[0031] The tools and the methods described herein perform a number of different functions. Examples include tools that are used as graspers, scissors, blades, screw drivers, such as flathead or Phillips head, drill bits, wrenches, including Allen wrenches, soldering irons, ultrasonic cutters, suture drivers, clip drivers, suction/irrigation devices, cauterization devices, needles, catheters, tissue stabilizers, nerve/vessel locators, radiological devices and the like.

[0032] With reference to Figures 1-11, certain embodiments of a system and method for interchanging tools within a generally closed or confined area are shown. The devices and methods herein are readily applicable to a wide variety of embodiments wherein it is desirable to interchange tools in closed areas, and all such applications are contemplated by the present inventors. Adaptation of the devices and methods disclosed herein to accomplish procedures such as the foregoing will be apparent to those of skill in the art in view of the disclosure herein.

Tool Kit

[0033] Aspects of the present invention provide a tool kit system that allows an operator to insert a variety of different tools through a relatively small opening into a generally closed or confined area, use the tools and interchange them as needed without the need to withdraw either the tool kit or the manipulator to which the tools are attached, and once the work is done, withdraw the tool kit from the closed or confined area. Thus, in some embodiments, the tool kits described

herein provide a number of tools, each of which is held within a tool holder. The several tool holders are attached to a housing. During the insertion of the tool kit into the generally closed or confined area, the tool holders are nestled within the housing to maximize space efficiency and allow for the tool kit to fit through the small opening of the generally closed or confined area. Once inside the generally closed or confined area, the operator can pivot the tool holders away from the housing to expose the tools to the manipulator to which the tools are to be attached. After the operator is done with the particular tool, the operator can then return the tool to its holder and nestle the holder back inside the housing to allow the tool kit to be extracted from inside the generally closed or confined area through the small opening.

[0034] As shown in Figure 1, one embodiment of a system for interchanging tools within a generally closed or confined area is provided. The tool kit 100 includes a housing 102, also referred to herein as a holder, having a distal end 104 and a proximal end 106. The housing 102 includes an opening 108, in which a plurality of tool holders 110, 112, 114 are provided. Embodiments of the tool kit 100 include those in which only one tool holder 110 is included with each tool kit 100. In other embodiments, two or more tool holders 110 are included. The embodiment shown in Figure 1 comprises three tool holders. Each tool holder 110, 112, 114 can contain a tool 116, 118, 120, as described below.

[0035] The tool holders 110, 112, 114 are configured such that they fit within the housing 102 during the insertion of the tool kit 100 into the confined area, or during the extraction therefrom, and yet can pivot away from the housing 102 to present the tools for attachment to the manipulator. This arrangement creates maximum space efficiency that allows an easy fit through a small opening during insertion and removal.

[0036] The tool holders 110, 112, 114 can include an attachment element 122, 126, 130 which is received in a corresponding attachment point 124, 128, 132 provided on the tool kit 100. The combination of the attachment element 122, 126, 130 and the attachment point 124, 128, 132 create a hinge that allows the tool holders 110, 112, 114 to rotate outwardly from a resting position, as in 114 in Figure

2, to a semi-extended position, as in 110 in Figure 2, to a fully extended position, as in 112 in Figure 2. Based on the angle of approach, the operator can rotate the tool holders 110, 112, 114 to a semi-extended position, a fully extended position, or any desired position in between a resting position and a fully extended position. A position of the tool holder 110, 112, 114 other than a resting position, e.g., a semi-extended position or a fully extended position, is referred to herein as “an extended position.”

[0037] The way by which the attachment element 122, 126, 130 is attached to the attachment point 124, 128, 132 generally permits the tool holders 110, 112, 114 to pivot outwardly from a resting position to an extended position. In one embodiment, the attachment element is flexible enough to allow the tool holder 110, 112, 114 to be pivoted away from the housing 102, i.e., from a resting position to an extended position, after being manipulated into such an extended position by the operator, and yet is stiff enough to retain the extended position away from the housing 102 once the operator has positioned the tool holder 110, 112, 114 in that extended position.

[0038] In one embodiment, the attachment element 122, 126, 130 is a generally spherical ball, which fits within the attachment point 124, 128, 132, which in turn is a generally hollow sphere or socket, having an opening to receive the attachment element 122, 126, 130. In another embodiment, the attachment element 122, 126, 130 is attached to the attachment point 124, 128, 132 by a pin. In still another embodiment, the attachment element 122, 126, 130 comprises a pin on either side that fit within, or snap into, a corresponding hole or dimple on the attachment point 124, 128, 132. In yet another embodiment, the element 122, 126, 130 may be a pivot, such as a cylindrical or spherical pivot. In some embodiments, the pivot is a spring pivot which permits release and return to the resting position. Other modes of attachment known in the art can also be used. The attachment point 124, 128, 132 can be an opening in the housing 102, which permits the attachment element 122, 126, 130 to rest and/or pivot therein. In other embodiments, the attachment point 124, 128, 132 can be a point to which the

attachment element 122, 126, 130 is snapped, glued, welded, soldered, or otherwise attached.

[0039] To place the tool kit 100 inside the generally closed or confined area, the tool kit 100 is attached to a tool kit receiving device (not shown). The tool kit receiving device can be introduced into the generally closed or confined area through the same small opening through which the manipulator is introduced, or it can be introduced through a separate small opening. The tool kit receiving device can also be the same as the manipulator. The tool kit receiving device can be a rod, made out of wood, metal, plastic, and the like, a flexible hose, or tube. In the context of a surgical system, the receiving device can be a cannula. The cannula can be the same cannula that moves the distal end of the manipulator, or it can be a separate cannula.

[0040] Referring again to Figure 1, the tool kit 100 can include an attachment element 134 at its proximal end 106 for attaching the tool kit 100 to the tool kit receiving device. In one embodiment, the attachment element 134 is a dovetail connection. In other embodiments, the tool kit 100 can snap onto the tool kit receiving device. In further embodiments, the tool kit 100 and the tool kit receiving device can be attached magnetically. In some of these embodiments, the attachment element 134 can be a magnet, or an electromagnetic device that can be magnetized upon the introduction of electrical current. In yet other embodiments, the tool kit 100 can be attached to the tool kit receiving device by a pin. In other embodiments, the attachment element 134 can be a hook, or a loop for receiving a hook. Other methods of releasably attaching the tool kit 100 to a tool kit receiving device can be used.

[0041] In certain embodiments, the tool kit 100 can be an integral part of the cannula. In these embodiments, the tool kit 100 need not include an attachment element 134. Further, in these embodiments, an operator may include the arrangement of the tools he or she desires in the tool kit 100 prior to the insertion of the cannula into the closed area.

[0042] The tool kit receiving device, e.g., the cannula, is used for positioning the tool kit 100 within the generally closed or confined area. In some

embodiments, the tool kit receiving device is used to hold the tool kit 100 in place for the duration of its use within the generally closed or confined area. In other embodiments, the tool kit receiving device is used to place the tool kit 100 within the generally closed or confined area, and subsequent to this, the tool kit receiving device is withdrawn. In these embodiments, the tool kit 100 is attached, using attachment element 134, to a feature within the generally closed or confined area, for example, another part of the instrument within that area, such as another cannula or the manipulator, or a solid object, such as a part of the machinery, within that area. Thus, for example, the tool kit 100 can be magnetic, in which case it can be attached to a metal surface suitably located within the closed area. The attachment element 134 can also be a hook, which can then be hooked to a suitable place within the closed or confined area. Other methods of attachment, such as Velcro®, adhesives, hangers, and the like, are also within the scope of the present disclosure.

[0043] The tool kit receiving device and the tool kit 100 are configured such that they can be inserted into the generally closed or confined area with relative ease. In the context of a surgical procedure, the surgeon prefers to make a small incision through which the tool kit receiving device and the tool kit 100 can be inserted into the patient's body. In the context of repairs to a mechanical device, the tool kit receiving device and the tool kit 100 can be inserted to the inside of the mechanical device through a small opening. Therefore, it is desirable that the respective widths of the tool kit receiving device and the tool kit 100 are similar. Similarity of the widths of the two components prevents injury to the patient's tissue, e.g., from objects of various widths passing through the small incision, or injury to the instrument or the mechanical device to be repaired.

[0044] In some embodiments, including that shown in Figure 1, the tool kit receiving device is generally cylindrical, and the housing 102 of the tool kit 100 has about the same outer diameter as the outer diameter of the generally cylindrical tool kit receiving device. In other embodiments, the housing 102 has an outer diameter less than or greater than the tool kit receiving device. In other embodiments, the tool kit receiving device is not cylindrical. The actual dimensions of the tool kit can

vary depending its intended use. In some embodiments, where the tool kit receiving device and the tool kit 100 have different diameters, the transition area between the two components is gently sloped so as to avoid contacting sharp edges of the component having the larger diameter with the perimeter of the hole through which the tool kit receiving device and the tool kit 100 are being inserted, thereby minimizing any injury such insertion may cause.

[0045] In some embodiments, such as in a system described in U.S. Patent No. 6,607,475, the cannula houses the lines used for hydraulic communication. The manipulator is located at the end of the cannula. In some embodiments, the tool kit 100 is attached to the same cannula to which the manipulator device is also attached. Therefore, the manipulator, which comprises a distal end to which the tools of the tool kit 100 is attached, and the tool kit 100, are introduced into the closed area via a single entry point. In some of these embodiments, the tool kit 100 forms a portion of the cannula itself.

[0046] In other embodiments, the tool kit 100 is attached to a different cannula than the manipulator. In these embodiments, the cannula holding the tool kit 100 serves to place the tool kit 100 in a convenient place, where the operator can access the tools within the tool kit 100 by the distal end of the manipulator. In these embodiments, the cannula may or may not house hydraulic communication lines.

[0047] In certain embodiments, the distal end of the manipulator ends in a tool receiving device, such as a pair of tines, or equivalents thereof, to which the tools described herein can be attached. An example of such a device is described in U.S. Patent No. 6,607,475, the disclosure of which is incorporated herein by reference in its entirety, including any drawings.

[0048] In some embodiments, when the operator wishes to use a certain tool inside a generally closed or confined area, after the operator has inserted the manipulator and a tool kit 100 within that area, the operator can pivot a tool holder 110 around the hinge, created by the combination of the attachment element 122, 126, 130 and the attachment point 124, 128, 132, to an extended position, thereby exposing the tool 116 attached thereto. An example of this embodiment is depicted in Figure 2. A first tool holder 110 and a second tool holder 112 are shown pivoted

outwardly in an extended position. The first tool holder 110, which houses a tool 116, is pivoted for removing the tool 116 and attaching it to a manipulator, while the second tool holder 112 is pivoted outward to receive a second tool. The manner by which tools are attached to, and detached from, the manipulator is explained in detail below. It is understood that if there is no tool attached to the manipulator, there would typically be no need to pivot an empty tool holder 112 outward. Furthermore, it is understood that the angle by which a tool holder is extended is dependent on the angle of approach of the manipulator, and not dependent on whether a tool is being retrieved from, or replaced in, the tool holder.

[0049] Referring still to Figure 2, housing 102 can include openings 236 and 238 in which tool holders 110 and 112, respectively, are positioned in their resting position. In the particular embodiment shown in Figure 2, tool holder 114 is depicted in its resting position. The tool holders 110 and 112 can be adjusted away from the housing and openings 236 and 238 when needed for interchanging tools. Figure 2 also illustrates the opening 240 provided in tool holder 112 for receiving a tool.

[0050] Each tool kit can include one, two, three, four, five, or more tools. In some embodiments, the tool kit comprises a plurality of tools. The tool includes an attachment element for attaching the tool to a tool receiving device, as described herein. The tools can have different shapes and sizes, depending on the particular application. In some embodiments, the tools are disposable. Disposable tools are particularly desirable in medical applications. In other embodiments, the tools can be used repeatedly. In some of these embodiments, it would be necessary to clean, and sometimes disinfect or sterilize, the tools in between uses.

[0051] Another embodiment of the tool kit 100 is shown in Figure 3. In this alternative embodiment, instead of a housing 102, which encases the tool holders, tool kit 300 comprises a spline 302 to which the tool holders 110, 112, 114 are attached. The spline 302 allows the tool kit 300 to be bendable or formable, thereby easing insertion into the confined space and making the tool kit 300 more accessible in a plurality of locations, specially those that are harder to reach. The spline 302 can be formed from any variety of materials, such as metals, plastics, wood, rubber,

and the like. A particular material used for spline 302 is determined by the particular application for which the tool kit 300 is used.

[0052] In one embodiment, one tool kit is provided in the generally closed area. In other embodiments, a plurality of tool kits are provided in the generally closed area. In some embodiments, two, three, four, five or more tool kits are provided in a closed area. In some embodiments, a number of different tool kits can be attached to the same cannula, whereas in other embodiments, only one tool kit is attached to each cannula.

[0053] In Figure 4, a detailed perspective view of an embodiment of a tool holder 110 is shown. The tool holder 410 includes an opening 440. The opening 440 also can include a keyway 442 on at least one of its sides. In some embodiments, the keyway 442 is provided on at least two sides of the opening 440. The keyway 442 can also include a slot 444. As described below, keyway 442 and slot 444 may be used to releasably lock the tools within opening 440 of the tool holder 410.

[0054] In some embodiments, the tool holders 110, 112, 114 are shaped to securely hold a specific tool, thereby preventing tools from being incorrectly inserted into a holder belonging to another tool. The tools described herein can be constructed in such a way that the base of the tool, i.e., the proximal portion of the tool closest to the tool receiving device, has a particular shape, such as cylindrical, cubical, conical, frustoconical, and the like. Each tool holder 110, 112, 114 is also designed to have an opening having a shape corresponding with the shape of one of the tools. Thus, a tool having a cylindrical base would fit into a tool holder 110 having a cylindrically-shaped opening. Likewise, a tool having a cubical base would fit into a tool holder 110 having a cubically-shaped opening, and so on. The opening 440 in Figure 4 is shown as being generally cylindrical for receiving a tool having a generally cylindrically-shaped base.

[0055] Other means for creating a one-to-one relation between the tool holder 110 and a tool are also contemplated. In some embodiments, the location of the keyway 442, for example its distance from the edge of the tool holder 410, or the shape and/or size of the keyway 442, for example its depth or width, is configured to

correspond to the location, shape, and/or size of a component on the tool that fits through the keyway 442. The tool holders are preferably semi-rigid, and, in some embodiments, flex somewhat to permit insertion of the tools into the tool holders.

Method of Interchanging Tools

[0056] A method for interchanging tools within a closed area is described below. While each step of this method is described in detail below, the general outline of this method is as follows. In one embodiment, an operator selects the desired tools and loads them onto a tool kit, making sure each tool is securely held by a tool holder. The tool kit is then inserted into a closed area. Following the insertion of the tool kit into the closed area, the operator, using the manipulator, can adjust the tool holders outwardly away from the tool kit and into an extended position to allow the operator to easily exchange the tools within the closed or confined area. As described below, each tool can be removed from and reattached to the tool holder of the tool kit as desired. The operator exchanges tools by inserting or placing the tool currently being used into its appropriate tool holder and picking up another tool from another tool holder with the tool receiving device. The tool holders can be provided on the same tool kit or on a separately provided tool kit within the closed area.

[0057] The system described herein is designed such that once a tool is placed inside a tool holder, the tool cannot be removed therefrom unless the tool is properly secured and held by the tool receiving device. In addition, once a tool is attached to the tool receiving device, the tool cannot be released from the tool receiving device unless the tool is properly inserted into the tool holder.

[0058] Particular embodiments of the steps of attaching a tool to a tool receiving device and releasing a tool to a tool holder will now be described in detail. Figure 5 is a cross-sectional view of a tool 556 held inside a tool holder 110. In this particular embodiment, the tool 556 is a clamp. However, it is envisioned that any other type of tool can be used, as described herein. Projections 555a,b prevent the tool 556 from making any lateral movements within the tool holder 110. Each tool 556 is equipped with at least one releasing tine 564. In the particular embodiment

shown in Figure 5, the tool 556 is equipped with two releasing tines 564, 565. The releasing tines 564, 565 exhibit ends 566a,b which curve away from the tool 556.

[0059] In some embodiments, the releasing tines 564, 565 exhibit spring-like action, so that in their resting state, i.e., when no external force is applied to them, the releasing tines 564, 565 stay in an “up” position, i.e., a position where the ends 566a,b are located away from the tool 556. The releasing tines 564, 565 in Figure 5 are shown in their up position. When the tool 556 is placed inside the tool holder 110, the curving ends 566a,b of the releasing tines 564, 565 fit within openings 557 on the tool holder 110, thereby preventing the tool 556 from moving in or out of the tool holder 110.

[0060] As a consequence of the projections 555a,b, described above, and the fitting of the releasing tines 564, 565 within the opening 557, the tool 556 remains securely placed inside the tool holder 110.

[0061] Figure 6 is another cross-sectional view of the tool 556 inside the tool holder 110, showing clearly the curving ends 566a,b of the releasing tines 564, 565 within the opening 557. In some embodiments, such as the one depicted in Figure 6, the back portion of the opening 557, i.e., the end away from the attachment element 122, is slanted forward, i.e., towards the attachment element 122. This slant, coupled with the curving ends 566a,b of the releasing tines 564, 565, further operates to keep the tool 556 securely held within the tool holder 110.

[0062] A tool receiving device is used to remove the tool 556 from the tool holder 110. An embodiment of this process is shown in Figure 7. This particular tool receiving device 570 exhibits at its distal end a pair of tines 560, 561. In some embodiments, the tines 560, 561 are operated by hydraulic means, such as the methods described in U.S. Patent No. 6,607,475. The tines 560, 561 can open and close in a scissors-like fashion.

[0063] Each tine 560, 561 exhibits a pin 572, 573 at a place substantially close to its distal end. To attach a tool 556 to the tool receiving device 570, an operator opens the tines 560, 561, lines up the pins 572, 573 on the tines 560, 561 with the corresponding slots 444 on the tool holder 110, and then closes the tines 560, 561 such that the tines 560, 561 enter the tool holder 110 through the keyway

442 of the tool holder 110, shown in Figure 4. The relative positioning of the pins 572, 573 and the slots 444 assure that the tines 560, 561 are properly aligned with the tool 556. Figure 8 provides another view of the tool receiving device 570 properly aligned with a tool holder 110 so that the pins tines 572, 573 are properly aligned with the slots 444, and tines 560 are poised to enter the tool holder 110 through the keyways 442 to attach to the tool 556.

[0064] Turning back to Figure 5, the tool 556 is equipped with at least one, and in some embodiments two, and in further embodiments more than two, clip elements 562, 568. The particular embodiment shown in Figure 5 depicts a tool 556 which exhibits two clip elements on each side of the tool 556: a proximal clip element 562, 563 and a distal clip element 568, 569. As shown in Figure 5, and again in Figure 6, there are two proximal clip elements 562, 563, one above the tool 556 and one below the tool 556. Similarly, there are two distal clip elements 568, 569, one above the tool 556 and one below the tool 556. The distal clip elements 568, 569 are held back, i.e., away from the releasing tine 564 and towards projection 555, by the cam 554.

[0065] When the tines 560, 561 enter the tool holder 110 through the keyway 442, as shown for example in Figures 7 and 8, they push the proximal clip elements 562, 563 away from the releasing tines 564, 565 and towards the projection 555. In the embodiment shown in Figure 5, the proximal clip element 562, 563 is curved at the top, thereby allowing the tines 560, 561 to slide easily down and push the clip element 562 out of the way. The pins 572, 573 on the tines 560 fit in between the two clip elements 562, 568. When the tines are fully closed, through spring-like action the proximal clip elements 562 move back to their original position, thereby causing the tool 556 to be held to the tines 560, 561. At the same time, the releasing tines 564, 565 are pushed flush against the tool 556, i.e., in a position in between the tines 560, 561 and the tool 556. Consequently, the curving end 566 of the releasing tines 564 is no longer inside the opening 557. The operator can now remove the tool 556 out of the tool holder 110 by retracting the distal end of the manipulator.

[0066] Figure 9 shows an embodiment in which the tines 560, 561 are in a closed position and the tool 556 is ready to be moved out of the tool holder 110. As shown in this figure, the releasing tines 564, 565 are in their retracted position, i.e., securely held between the tines 560, 561 and the tool 556, and the curving ends 566a,b are outside of the opening 557. The operator now pulls back in a proximal direction on the tool receiving device 570 and removes the tool 556 from the tool holder 110. As the tool moves out of the tool holder 110, the distal clip elements 568, 569 become free from the cam 554, and through spring-like action return back into their resting position, which further secures the tool 556 to the tines 560, 561. As noted in Figures 5 and 11, the distal clip elements 568, 569 are curved towards the tines 560, 561 at the top, as opposed to the proximal clip elements 562, 563, which are curved away from the tines 560, 561 at the top. The curvature of the distal clip elements 568, 569 in these particular embodiments provides a more secure hold between the tines 560, 561 and the tool 556.

[0067] It is noted that Figures 5-9 are cross sectional views. There are corresponding clip elements on the side not shown as well. The end result of the action of all of the clip elements is that the tool 556 will not be able to move laterally with respect to the tines 560, 561. In addition, because the pins 572, 573 fit in between the proximal and distal clip elements, the tool 556 will also be prevented from moving forwards or backwards with respect to the tines 560, 561. Consequently, the tool 556 is securely attached to the tines 560, 561.

[0068] Once the operator has used the tool as desired, the operator may wish to change the tool for another tool. The operator then returns the tool currently attached to the tool receiving device to the tool holder, releases the tines, and obtain another tool from another tool holder.

[0069] In one embodiment, as shown in Figure 10, to return the tool 556 to the tool holder 110, the operator closes the tines 560, 561, aligns the tool 556 with the tool holder 110, and then moving the tool 556 in a distal direction, inserts the tool 556 inside the tool holder 110. As shown in Figure 9, cam 554 is placed at a particular depth within the tool holder 110 so that it stops the tines 560, 561 at the

proper place for the tines to open and pins 572, 573 be released through the slots 544.

[0070] In some embodiments, as shown in Figure 11, cam 554 has curved edges. When the tool 556 is placed inside the tool holder 110 and pushed forward in a distal direction, the distal clip elements 564, 569 come in contact with the curved edges of cam 554. As the tool 556 is pushed further inside the tool holder 110, the curved edges of cam 554 cause the distal clip elements 564, 569 to move backwards, i.e., away from the tines 560, 561. The tool 556 is pushed as far back as it can go inside the tool holder 110. The distal clip elements 564, 569 are now moved completely away from the tines 560, 561.

[0071] At this point, the only force holding the tool 556 to the tines 560, 561 is the pressure of the proximal clip elements 562, 563. As seen in Figure 5, the inside surface of the proximal clip elements 562, 563 is slightly curved away from the tines 560, 561 and towards the projections 555a, b. Once the operator opens the tines 560, 561, the proximal clip elements 562, 563 are pushed away from the tines 560, 561, until eventually, the tines 560, 561 snap out of the proximal clip elements 562, 563. As the tines 560 move away from the tool 556, through spring-like action the releasing tines 564, 565 are released and move back to their resting position, which causes the curving end 566 thereof to enter the opening 557, thereby holding the tool 556 securely within the tool holder 110.

[0072] As shown in the figures, such as Figure 5 and 11, the tool holder 110 includes a shaped channel 570, defined by the wall of the tool holder 110 and the projection 555. The thickness of this channel, i.e., the distance between the projection 555 and the wall of the tool holder 110, can be designed such that a particular tool 556 can fit only into a particular tool holder 110. This feature has the added advantage that the operator can memorize, or label, the position of each tool in a particular tool kit and remain assured that the labeling or the relative positions do not change during the operation of the device.

[0073] In other embodiments, the tool 556 is held securely within the tool holder 110 by magnetic force. In these embodiments, each tool holder 110 is capable of being magnetized by the use of electricity. Once the tool holder 110 is

magnetized, the tool 556 cannot be removed from the tool holder 110. Once the operator has snapped the tines 560, 561 onto the tool 556, the operator can disengage the electricity flow into the specific tool holder 110, thereby rendering it magnetically neutral. At this point, the tool 556 can be removed from the tool holder 110 by pulling back on the manipulator. In some embodiments, a snap on the tool 556, such as one of the clip elements, can function as a switch, such that when the tines 560, 561 snap into place, the switch is turned off and the tool holder 110 ceases to be magnetized. In further embodiments, the tines 560, 561 can also become magnetized or demagnetized at the command of the operator. Thus, once the tines 560, 561 have snapped onto the tool 556, the operator can demagnetize the tool holder 110 and at the same time magnetize the tines 560, 561. Consequently, the tool 556 can be released from the tool holder 110 and be affixed to the tines 560, 561.

[0074] In yet other embodiments, the tool 556 is held within the tool holder 110 by friction. Grooves on both the tool 556 and the tool holder 110 cause enough friction so that the tool 556 does not become loose and fall out of the tool holder 110. However, the amount of friction is small enough to allow the manipulator to remove the tool 556 from the tool holder 110, once the tines 560, 561 are snapped into place.

Surgical Application

[0075] In one particularly embodiment, the tool kit is used with a robotic surgical system. An example of a robotic surgery system that can be used with the tool kit is disclosed in U.S. Patent No. 6,607,475, which is hereby incorporated by reference in its entirety.

[0076] In such an embodiment wherein the system for interchanging tools is used in a human body, the tool kit is used with a surgical instrument having a plurality of arms. In some embodiments, the tool kit can be releasably or permanently attached to at least one of the arms of the surgical instrument. In one embodiment, the tool kit is located at the end of an articulating device.

[0077] The arm of the surgical instrument is inserted into the closed area through a small opening formed in the patient's body. The tool kit is then positioned and repositioned within the closed area by adjusting the arm of the surgical instrument. Other arms of the surgical instrument can use the tool kit for interchanging tools, so that a plurality of surgical treatments can be performed within the closed area.

[0078] The interchangeable tools for use with a surgical instrument can include, but are not limited to, a number of tools for treating a patient, such as irrigation tools, cauterization elements, lead wires, cameras, adhesive application tools, mini-x-ray devices, light sources, and the like. In some embodiments, the tool is a grasper, scissors, blade, optic elements, clamp, marker, and the like. In some embodiments, the tool is ultrasonic cutters, suture drivers, clip drivers, suction/irrigation devices, cauterization devices, needles, catheters, tissue stabilizers, nerve/vessel locators, radiological devices and the like.

Other Embodiments

[0079] In some embodiments, a system for identifying particular tools in the tool kit is provided (not shown). In some embodiments, the identification system comprises a color system. For example, the tool holder may be a particular color. In other cases, the tool is also colored and the color of the tool holder and the color of the tool match. Alternatively, words, numbers and/or shapes, and the like may be imprinted on the tool holder or tool kit to identify the location of a tool in the tool holder.

[0080] In certain embodiments, the tool kit 100 comprises a cover, which covers the tool holders 110, 112, 114. In some instances, it is beneficial to have the tool holders 110, 112, 114 covered, for example, during the insertion of the tool kit 100 into the closed or confined area, or while removing the tool kit 100 therefrom. Exposed tool holders 110, 112, 114 can have edges that are sharp. In addition, when the tool holders 110, 112, 114 are exposed there exist variations in the circumference of the tool kit 100. These variations and/or sharp edges can cause damage, e.g., tears or nicks, to the small opening through which the tool kit 100 is

being inserted into, or retrieved from, the closed or confined area. By utilizing a cover, the tool kit 100 is made to have a uniform and smooth outer layer, which facilitates its insertion and retrieval from the closed or confined area, and within the confined area itself.

[0081] In some embodiments, the cover can slide longitudinally along the tool kit 100 to expose the tool holders 110, 112, 114 held inside. In other embodiments, the cover is attached to the tool kit 100 through one or more hinges on one side, and can be moved, e.g., by the operator using the manipulator, to rotate along the hinges into an open position.

[0082] In some of these embodiments, the cover is held in the closed position by a latch. The operator would first release the latch prior to opening the cover. The latch further serves the purpose of preventing the cover from opening accidentally while inserting or retrieving the tool kit 100 from the closed or confined area. In further embodiments, once the latch is opened, through spring-like action, the cover moves automatically to the open position, thereby exposing the tool holders 110, 112, 114. Once finished using the tool kit 100, the operator can close the cover, e.g., by using the manipulator, and latch it in the closed position.

[0083] In some other embodiments, the cover is moved from the closed to open position, and vice versa, by the use of a remote control device, which sends the necessary signal to a motor in the cover for its operation to open and close through electrical signals that are transmitted through, for example, the cannula, to the tool kit 100, or through radiofrequency waves emitted from somewhere outside of the closed area, or the like.

[0084] In certain embodiments, one tool kit 100 is present within the generally closed or confined area, whereas in other embodiments, two or more tool kits 100 are present within the generally closed or confined area. One or more than one manipulator can be present within the same generally closed or confined area, and each of the manipulators can access each of the tool kits 100.

[0085] Embodiments of the invention include surgical devices and components coupled with surgical devices. It is appreciated that the surgical devices and other components described in conjunction with the present invention

may be electrically, mechanically, hydraulically, directly, indirectly and remotely coupled. It is appreciated that there may be one or more intermediary components for coupling components that may or may not be described.

[0086] For example, telemanipulation and like terms such as “robotic” refer to manipulating a master device and translating movement or force applied at the master device into commands that are processed and transmitted to a slave device that receives the commands and attempts to generate the intended movements at the slave device. It is appreciated that when using a telemanipulation device or environment, the master and slave devices can be in different locations.

[0087] Embodiments of the present invention are well suited to be used with both telemanipulation systems direct manipulation systems.

[0088] In one embodiment, embodiments of the present invention described above may further comprise a surgical tool kit coupled to the output end of the plurality of couplings, wherein an end effector moves in response to receiving at least the portion of the input force transmitted by the plurality of couplings. Optionally, the end effector comprises a surgical tool of the tool kit. It is appreciated that the input force may be generated by a direct manipulation device or may be generated by a telemanipulation device.

[0089] In yet another aspect, the present invention may further comprise a manually-driven hydraulic drive system having an input mechanism coupled to the input end of the plurality of couplings, wherein the drive system generates the input force, and an end effector coupled to the output end of the plurality of couplings, wherein the end effector comprises a surgical tool and moves in response to receiving at least the portion of the input force transmitted by the plurality of couplings. It is appreciated that the input force may be generated by a direct manipulation device or may be generated by a telemanipulation device.

[0090] The present invention relates to a surgical tool kit. For illustrative purposes, these aspects are discussed herein with respect to a surgical application, however, it should be understood that these aspect may equally apply to many other applications, such as robotics, manufacturing, remote controlled operations, etc., and any application where the transmission of axial and/or

rotational force around corners and bends is desired.

[0091] Aspects of the present invention include features relating to a surgical tool kit and methods of manufacture and use thereof, including variations having an angularly moveable hub housing and a rotatable and operable end effector driven via additional drive train elements that include one or more flexible couplings, such as universal-type joints. Force transmitted via the set of such elements includes, for example, lineal force and rotational force. It is appreciated that the force transmitted may be generated locally or remotely to the output device and it should be appreciated that embodiments of the present invention are well suited to be used in both direct manipulation and telemanipulation environments.

[0092] In some embodiments, a guide element is provided to prevent portions of the PPR element from collapsing under compression and to maintain proper form under extension, among other things. Exemplary motion that may be transmitted to the end effector and/or tools via the PPR element may include rotational motion and push-pull or reciprocating motion that may be used, for example, to cause two or more extensions of the end effector to move relative to one another (e.g., to open and close to allow grasping or cutting, and release). It is appreciated that the exemplary motion may be initiated by a direct manipulation or a telemanipulation input force. It is appreciated that the input force to induce the exemplary motion may be generated in a remote location wherein the input device and output device are coupled with a telemanipulation system.

[0093] In one variation, the guide element is responsive to the bend angle and is adjusted appropriately or automatically adjusts its position as a function of operation of the device within a motion limiting mechanism, such as a guide track into which an extension from the guide element slides. The bending of the device to various bend angles may be accomplished via use of one or more pivot points and control mechanisms, such as tendon-like linkages. The PPR element may be attached to a source or sources of axial and torsional input (also interchangeably referred to herein as an "input mechanism"), such as a rotatable and extendable and retractable shaft, housed in a body portion. It is appreciated that the source input may be from a direct manipulation or a telemanipulation input force.

[0094] Axial and torsional inputs to each of the PPR elements are then transmitted from the PPR elements to any output, such as to permit rotation and operation of an end effector. The end effector may rotate, for example, along with a PPR element via a sleeve. It is appreciated that the input may be separated from the output by a telemanipulation system where the force is transmitted from the input to the output via a telemanipulation system.

[0095] Some variations of the present invention use one or more essentially friction-free or low friction components in the PPR element and guide system, such as rolling-element bearings, which results in relatively high mechanical efficiencies (e.g., as compared to push-pull cables or cable-pulley systems). Other portions of the system relating to movement, such as guide track pins and pivots in some variations, can optionally be replaced with or further include low-friction rolling-element bearings for even smoother action. Appropriate guide track, guide housing, and hub or rotating tip components can comprise non-conductive material to manage the distribution of electrical energy to end-effectors. Any components may be plated with an appropriate anti-friction and/or electrically insulating coating and/or be used with suitable lubricating substance or features.

[0096] Conversely or in addition, some portions of the system may be electrically conductive, such as for use in electrosurgery applications. For example the outer housing of the device may be non-conductive, so as to insulate inner conductive portions. The motion transmitting inner portions may be conductive so as to allow electrosurgical current to be delivered to the end effector and/or any tools used therewith, while the outer housing thereby insulates the device. In addition to certain components being conductive, conducting lubricants may also be used to ensure or enhance electrical communication. In some variations, the electrical energy communicated may be of high frequency to enhance communication of the energy across abutting surfaces and lubricants. It is appreciated that in one embodiment, the electrical communication may be generated from a telemanipulation system.

[0097] Aspects of the present invention relate to interchangeable tools for use within a closed area. In general, disclosed herein is a holder which

comprises one or more tools attached thereto. The holder and the attached tools are so configured that they can be inserted into a closed area and easily manipulated therein. Examples of the closed area include inside the body of a patient, as in during laparoscopic or arthroscopic surgery, or inside of a device or a mechanical object, as in during maintenance or repair of the interior of said device or mechanical object.

[0098] In one embodiment, the tools are configured to be attached to the distal end of a manipulator, which itself is configured to receive the tools. The distal end of the manipulator can itself be inserted into the closed area. The distal end of the manipulator can be controlled by an operator at a proximal end, i.e., the end closest to the operator. It is appreciated that in one embodiment, the proximal end and operator may be remote to the distal end may be coupled with a telemanipulation system that allows the operator to provide input forces remotely to the patient.

[0099] Within the closed area, the operator can choose a desired tool from a selection of tools on the holder and attach it to the distal end of the manipulator. After the operator has used the tool in a desired fashion, the operator can then return the just-used tool to the holder, obtain a second tool from the holder, attach it to the distal end of the manipulator, and use the second tool. The operator can repeat this process as many times as the operator desires, thereby interchanging the tool used inside the closed area without having the need to withdraw the manipulator from the closed area. In one embodiment, the operator can change tools within the patient from a remote location.

[0100] As described in detail, this system is designed for use, for example, in laparoscopic surgery. The tools are various surgical tools used within the patient's body. The tools in the holder are inserted into the body. During surgery, the surgeon can use and exchange tools without the need to remove the manipulator or the tools themselves from the body. This represents a significant improvement over existing methods and devices. It is appreciated that in one embodiment, the operator can change tools within the patient even in the case that

the operator is remote to the patient. In this embodiment, a telemanipulation system may be used to couple the input end with the output end.

[0101] A “manipulator” as used herein refers to a device that at its proximal end comprises a set of controls to be used by an operator and at its distal end comprises means for holding and operating a tool, referred to herein as the “tool receiving device.” The controls allow the operator to move the tool receiving device within the generally closed or confined area, and operate the tool as intended. The tool receiving device is adapted to receive tools interchangeably and can cause a variety of different tools to operate in their intended purpose. Examples of a manipulator include any of a variety of laparoscopic or arthroscopic surgical tools available on the market for use by surgeons, or the device described in U.S. Patent No. 6,607,475. The tool receiving device of a manipulator is adapted to enter a generally closed or confined area through a small opening, such as a small hole in a mechanical device or a small incision in a human body. It is appreciated that the proximal end may be remote to the distal end and can be used in a telemanipulation environment.

[00102] As used herein, “proximal” refers to the part of the device that remains outside of the closed area, closest to the operator. “Distal” refers to the end inserted into the closed area, farthest away from the operator. The proximal and distal ends are preferably in communication with each other, such as fluid communication, electrical communication, communication by cables, telemanipulation and the like. Such communication can occur, for example, through a catheter or cannula, which houses the lines used for such communication. The catheter or cannula is preferably a tube or other substantially cylindrical hollow object. In some embodiments, the catheter or cannula does not house any lines for communication between the proximal and distal ends. In these embodiments, the catheter or cannula is used for placing an object, located substantially at the distal end of the catheter or cannula, inside the closed area for further manipulation. It is appreciated that the distal and proximal ends may be in communication with the use of a telemanipulation system.

[0103] During the operation of the devices described herein, the catheter or cannula (hereinafter referred to simply as “cannula”) is inserted into a generally closed or confined area where the tools are to be used such that its proximal end remains outside the closed area while the distal end remains inside the closed area. In the context of surgical procedures, the cannula is inserted into the patient’s body such that its proximal end remains outside the body while the distal end remains inside the body. In one embodiment, the proximal end is remote to the patient. This allows the operator, e.g. a surgeon, to access the interior of the closed area, e.g., a patient’s body, using the cannula, thereby eliminating the need for “open” surgical procedures both locally and remotely. Only a small incision is needed to insert the cannula, and the various surgical instruments are inserted, and the procedures performed, through the cannula. The proximal end may be remote to the patient and force applied at the proximal end may be translated using a telemanipulation system that recreates the input force at the distal end.

[0104] The instruments or tools described herein are capable of being attached to the distal end of the manipulator in a number of different ways. For instance, in some embodiments the tools are attached magnetically, while in other embodiments the tools may clip on to the distal end of the manipulator. In one embodiment, a telemanipulation system may be used to couple the distal and proximal ends. Additional details on the attachment of the tools is provided below.

[0105] The manipulator, which is used to position and maneuver the tools within the confined space, can be a hydraulic, pneumatic, robotic, direct manipulation, telemanipulation, standard surgical, minimal invasive surgery (MIS), electrical, or mechanical device, or a device comprising a combination of any of these systems. Any system that can be used to position and manipulate the tools is contemplated.

[0106] While particular forms of the invention have been described, it will be apparent that various modifications can be made without departing from the spirit and scope of the invention. Accordingly, it is not intended that the invention be limited, except as by the appended claims.

[0107] All elements, parts and steps described herein are preferably included. It is to be understood that any of these elements, parts and steps may be replaced by other elements, parts and steps or deleted altogether as will be obvious to those skilled in the art.

[0108] Broadly, this writing discloses at least the following: a tool kit for interchanging tools within an at least partially closed area. The tool kit includes at least one tool, each tool being preferably provided within a tubular housing, and adapted to pivot out from the tool kit so that they can be attached to a receiving tool. The tool is designed to be returned to the tool kit after use, and if desired, switched with a different tool. In one embodiment, a surgical system permitting surgical tools to be interchanged within a patient's body is provided. A method of interchanging surgical tools within a patient's body is also provided.

Concepts

[0109] This writing has disclosed at least the following concepts.

Concept 1. A surgical kit, comprising:

a manipulator comprising a tool receiving device;

at least one tool holder remote to said manipulator;

at least one tool adapted to be removably secured to said tool holder;

wherein said tool is also adapted to be connected to said tool receiving device and wherein when said tool is connected to said tool receiving device, an operator of said manipulator can exchange said connected tool for a second tool; and

wherein when said tool is placed inside said tool holder, said tool cannot be removed therefrom unless said tool is properly connected to said tool receiving device, and when said tool is properly connected to said tool receiving device, said tool cannot be released therefrom unless said tool is properly secured into said tool holder.

Concept 2. The surgical tool kit of Concept 1 wherein said tool receiving device is configured for use in a generally closed or confined area and said connected tool can be exchanged for said second tool without removing said tool receiving device from said generally closed or confined area.

Concept 3. The surgical kit of Concept 1 further comprising:

a telemanipulation device configured to remotely couple said manipulator and said tool holder.

Concept 4. The kit of Concept 3, wherein said tool holder is attached to a housing.

Concept 5. The kit of Concept 4, wherein said housing is configured to hold a plurality of tool holders.

Concept 6. The kit of Concept 3, wherein said tool is selected from the group consisting of graspers, scissors, blades, screw drivers, drill bits, ultrasonic cutters, suture drivers, clip drivers, suction/irrigation devices, cauterization devices, needles, catheters, tissue stabilizers, nerve/vessel locators, radiological devices, light sources, and cameras.

Concept 7. A method of remotely using a surgical tool kit to reduce dropping of tools comprising:

remotely accessing a housing having at least one attachment point with a telemanipulation device;

remotely accessing with said telemanipulation device at least one tool holder having an attachment element, wherein said attachment element is adapted to attach said tool holder to said attachment point on said housing;

remotely accessing with said telemanipulation device at least one tool adapted to be removably secured to said tool holder, wherein said tool is also adapted to be connected to a tool receiving device that is separate from said housing, and

wherein when said tool is connected to said tool receiving device, exchanging said connected tool for a second tool to prevent dropping of said connected tool or said second tool.

Concept 8. The method of Concept 7 wherein said tool holder is configured to be used in a generally closed or confined area and wherein said connected tool can be exchanged for said second tool without removing said tool holder from said generally closed or confined area.

Claims

WHAT IS CLAIMED IS:

1. A surgical kit, comprising:
 - a manipulator comprising a tool receiving device;
 - at least one tool holder remote to said manipulator;
 - at least one tool adapted to be removably secured to said tool holder;
 - wherein said tool is also adapted to be connected to said tool receiving device and wherein when said tool is connected to said tool receiving device, an operator of said manipulator can exchange said connected tool for a second tool; and
 - wherein when said tool is placed inside said tool holder, said tool cannot be removed therefrom unless said tool is properly connected to said tool receiving device, and when said tool is properly connected to said tool receiving device, said tool cannot be released therefrom unless said tool is properly secured into said tool holder.
2. The surgical tool kit of Claim 1 wherein said tool receiving device is configured for use in a generally closed or confined area and said connected tool can be exchanged for said second tool without removing said tool receiving device from said generally closed or confined area.
3. The surgical kit of Claim 1 further comprising:
 - a telemanipulation device configured to remotely couple said manipulator and said tool holder.
4. The kit of claim 3, wherein said tool holder is attached to a housing.
5. The kit of claim 4, wherein said housing is configured to hold a plurality of tool holders.
6. The kit of claim 3, wherein said tool is selected from the group consisting of graspers, scissors, blades, screw drivers, drill bits, ultrasonic

cutters, suture drivers, clip drivers, suction/irrigation devices, cauterization devices, needles, catheters, tissue stabilizers, nerve/vessel locators, radiological devices, light sources, and cameras.

7. A method of remotely using a surgical tool kit to reduce dropping of tools comprising:

remotely accessing a housing having at least one attachment point with a telemanipulation device;

remotely accessing with said telemanipulation device at least one tool holder having an attachment element, wherein said attachment element is adapted to attach said tool holder to said attachment point on said housing;

remotely accessing with said telemanipulation device at least one tool adapted to be removably secured to said tool holder, wherein said tool is also adapted to be connected to a tool receiving device that is separate from said housing, and

wherein when said tool is connected to said tool receiving device, exchanging said connected tool for a second tool to prevent dropping of said connected tool or said second tool.

8. The method of Claim 7 wherein said tool holder is configured to be used in a generally closed or confined area and wherein said connected tool can be exchanged for said second tool without removing said tool holder from said generally closed or confined area.

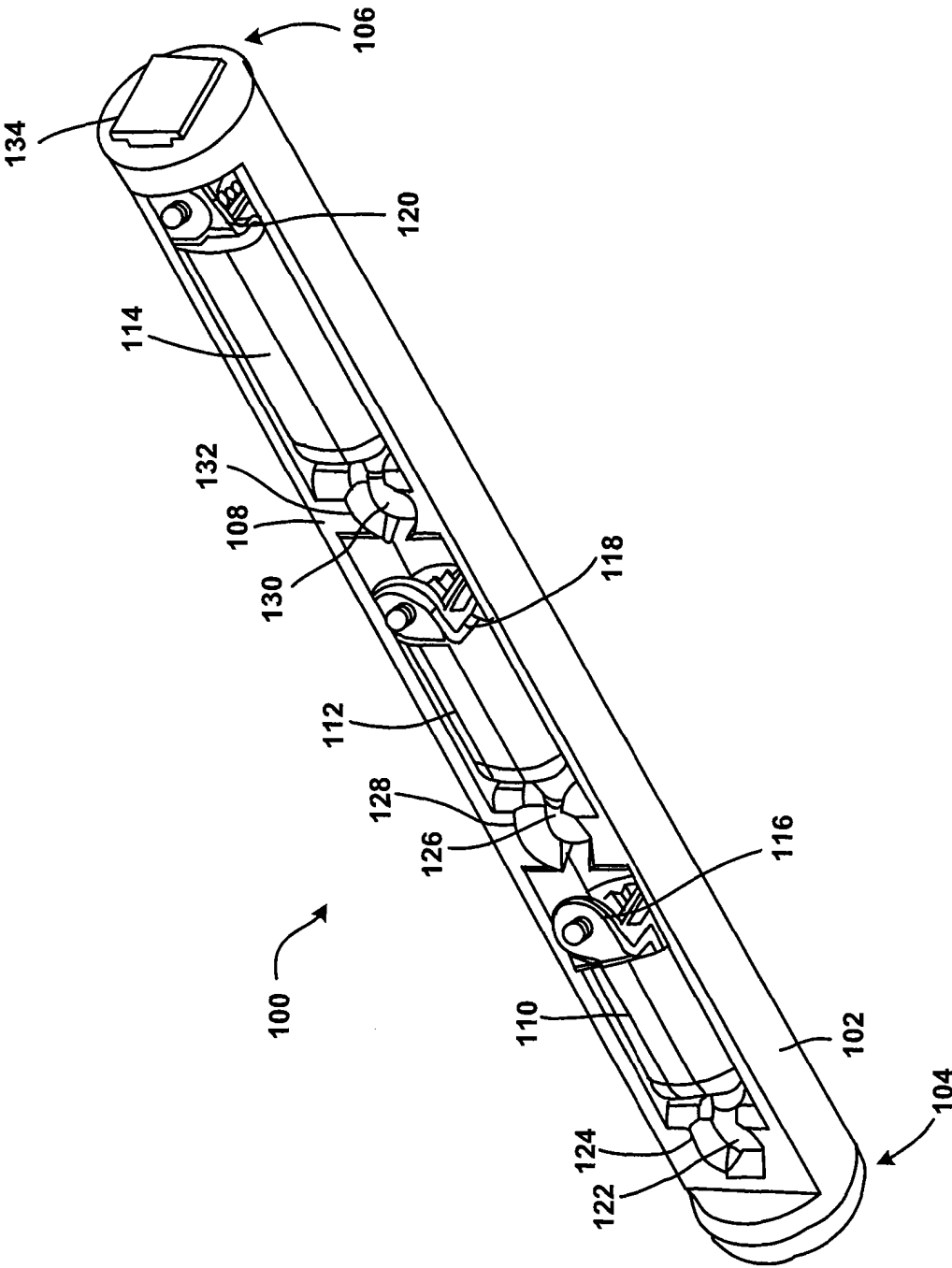

FIG. 1

2/11

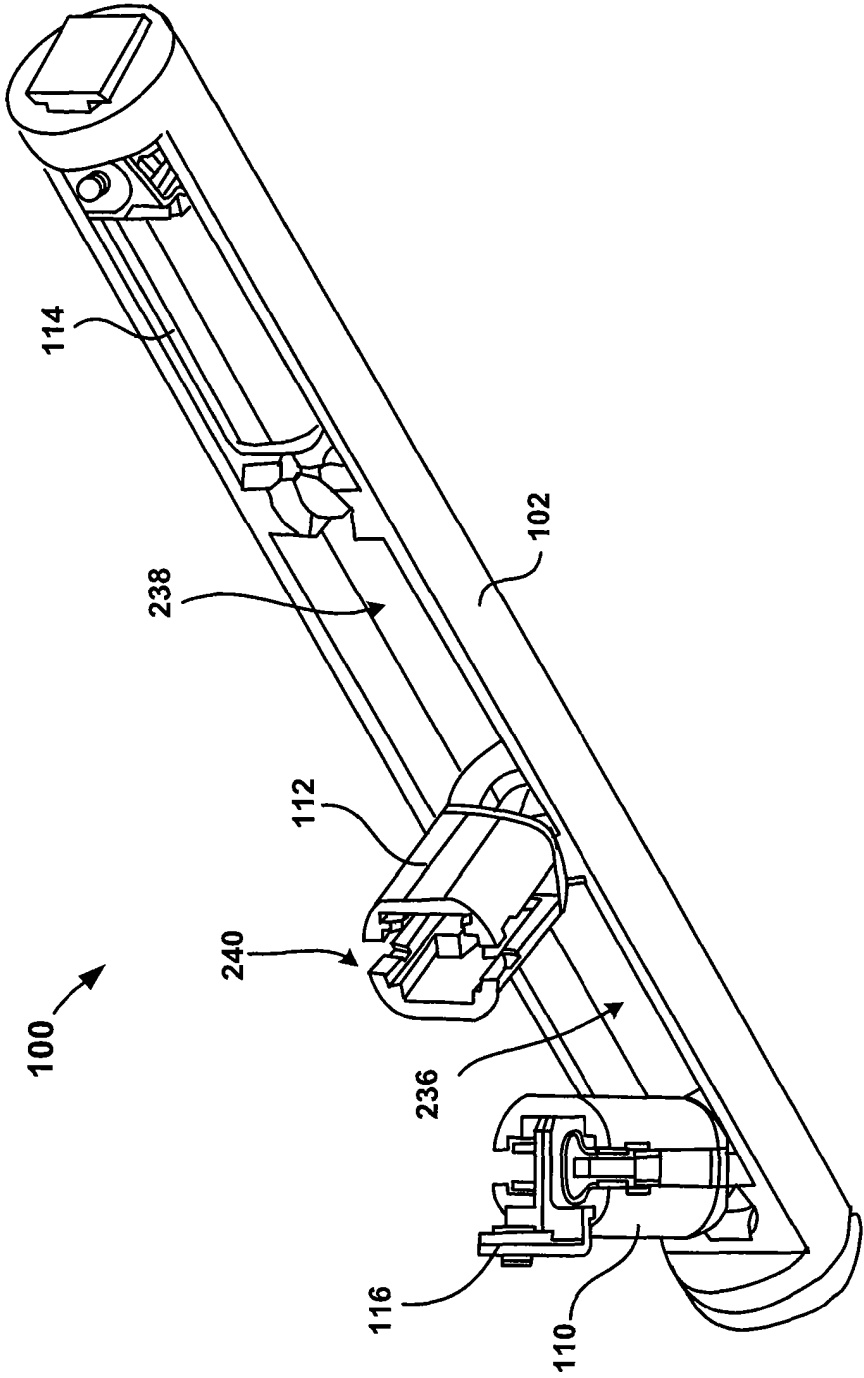

FIG. 2

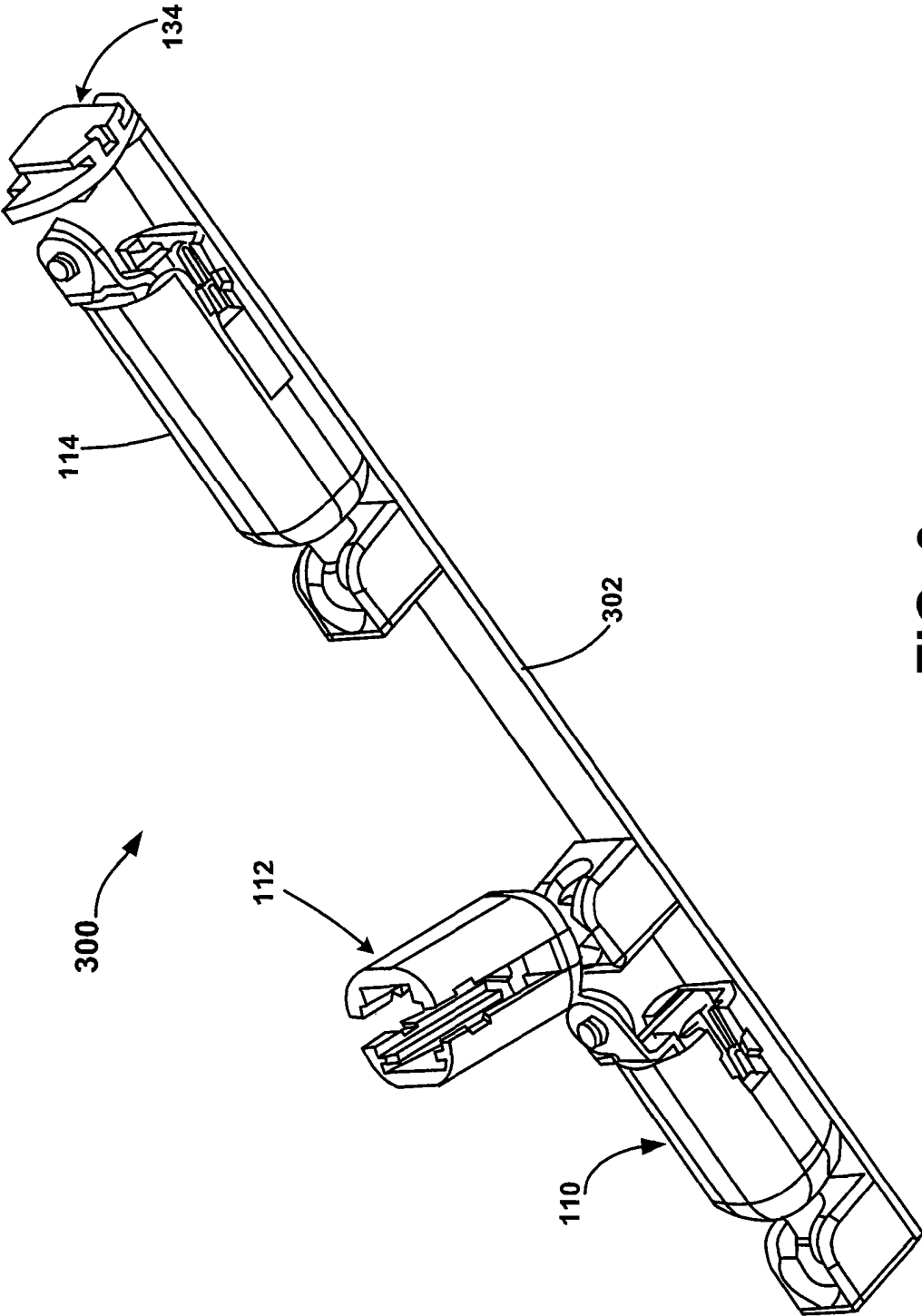

FIG. 3

4/11

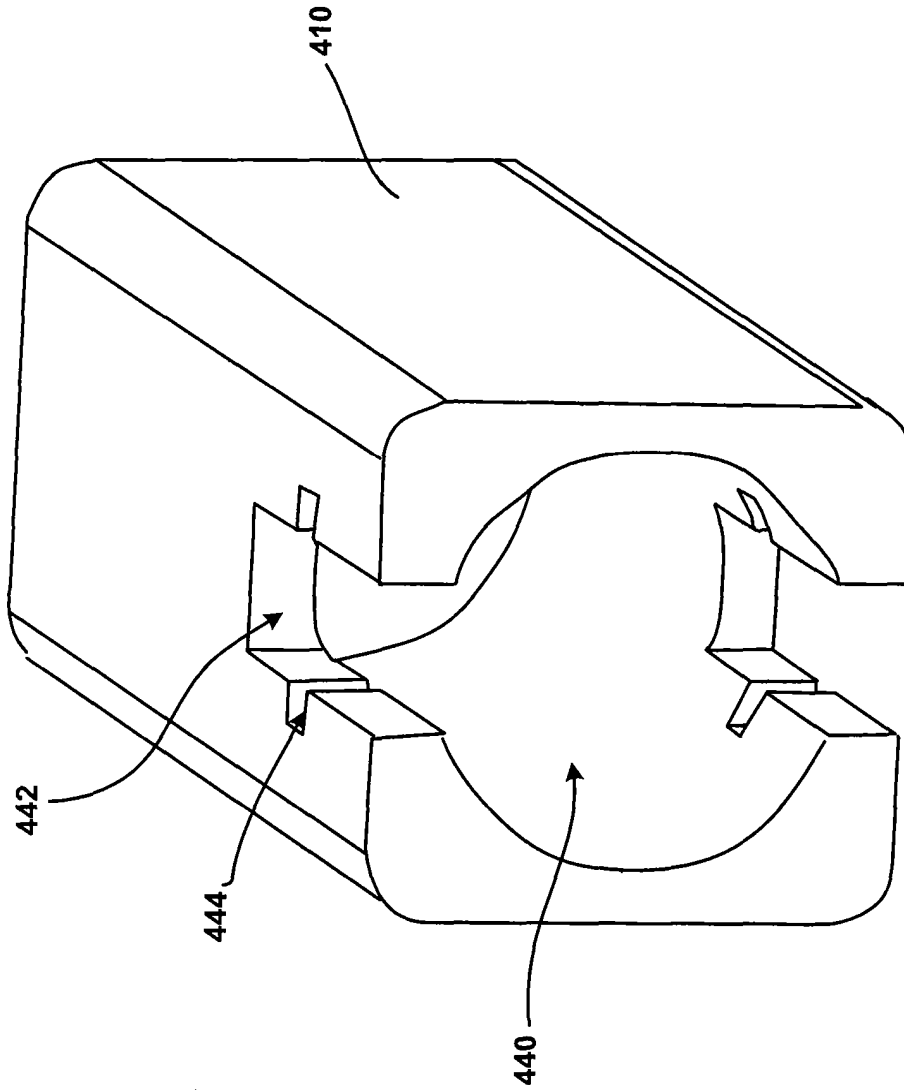

FIG. 4

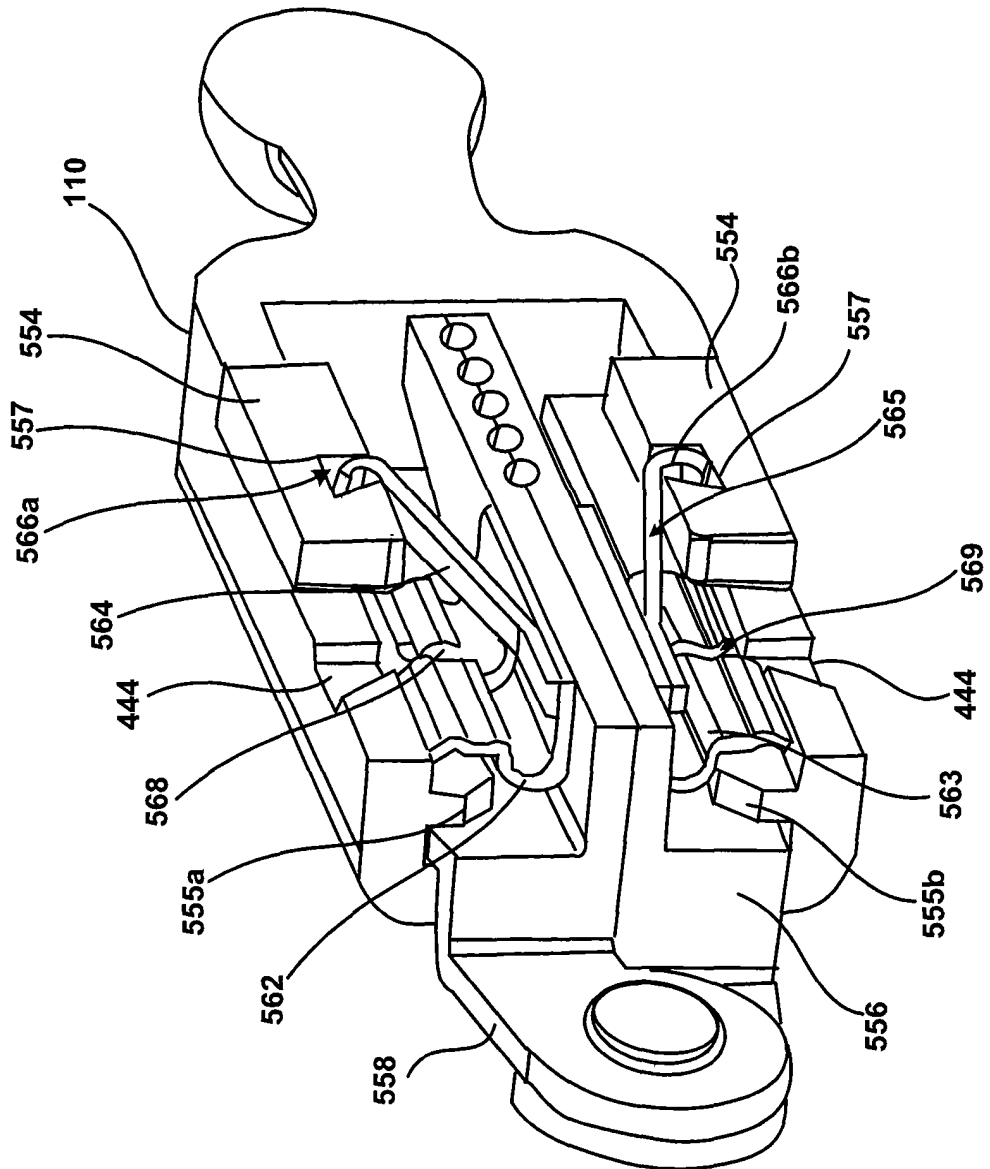

FIG. 5

6/11

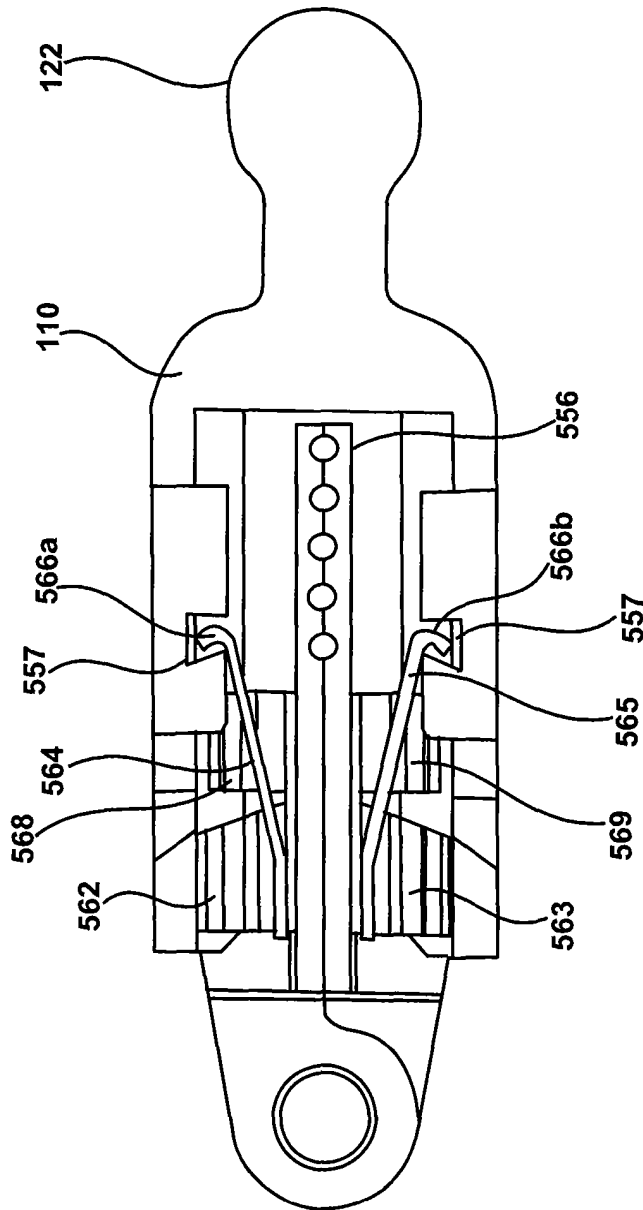

FIG. 6

7/11

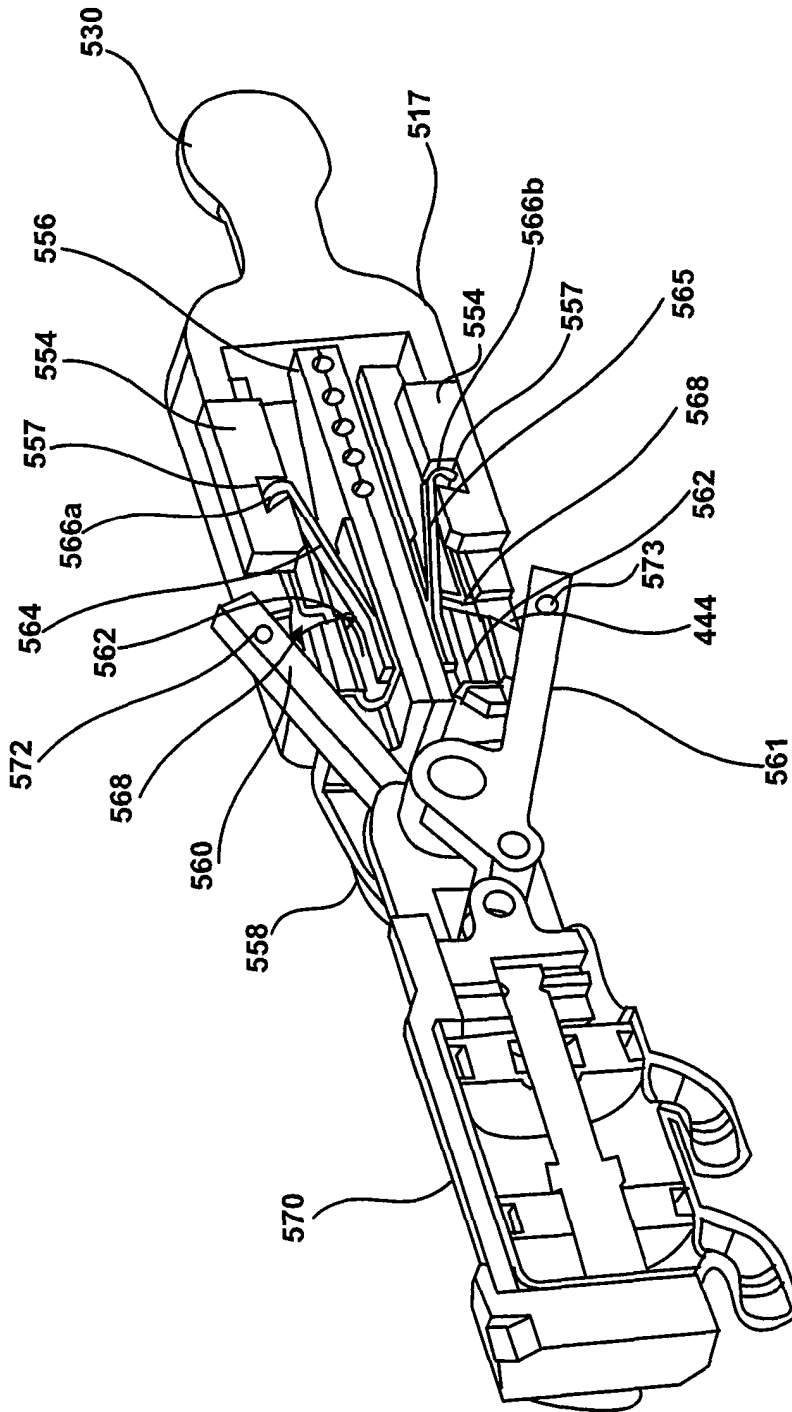

FIG. 7

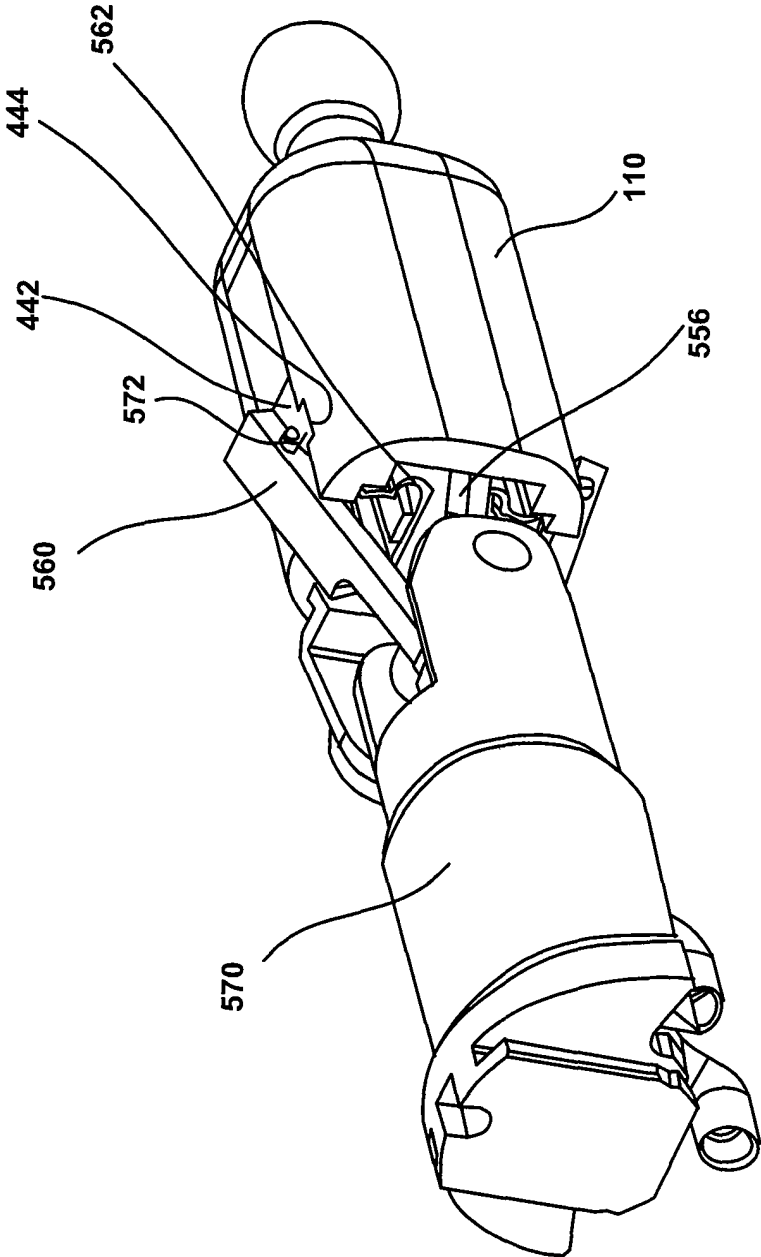

FIG. 8

9/11

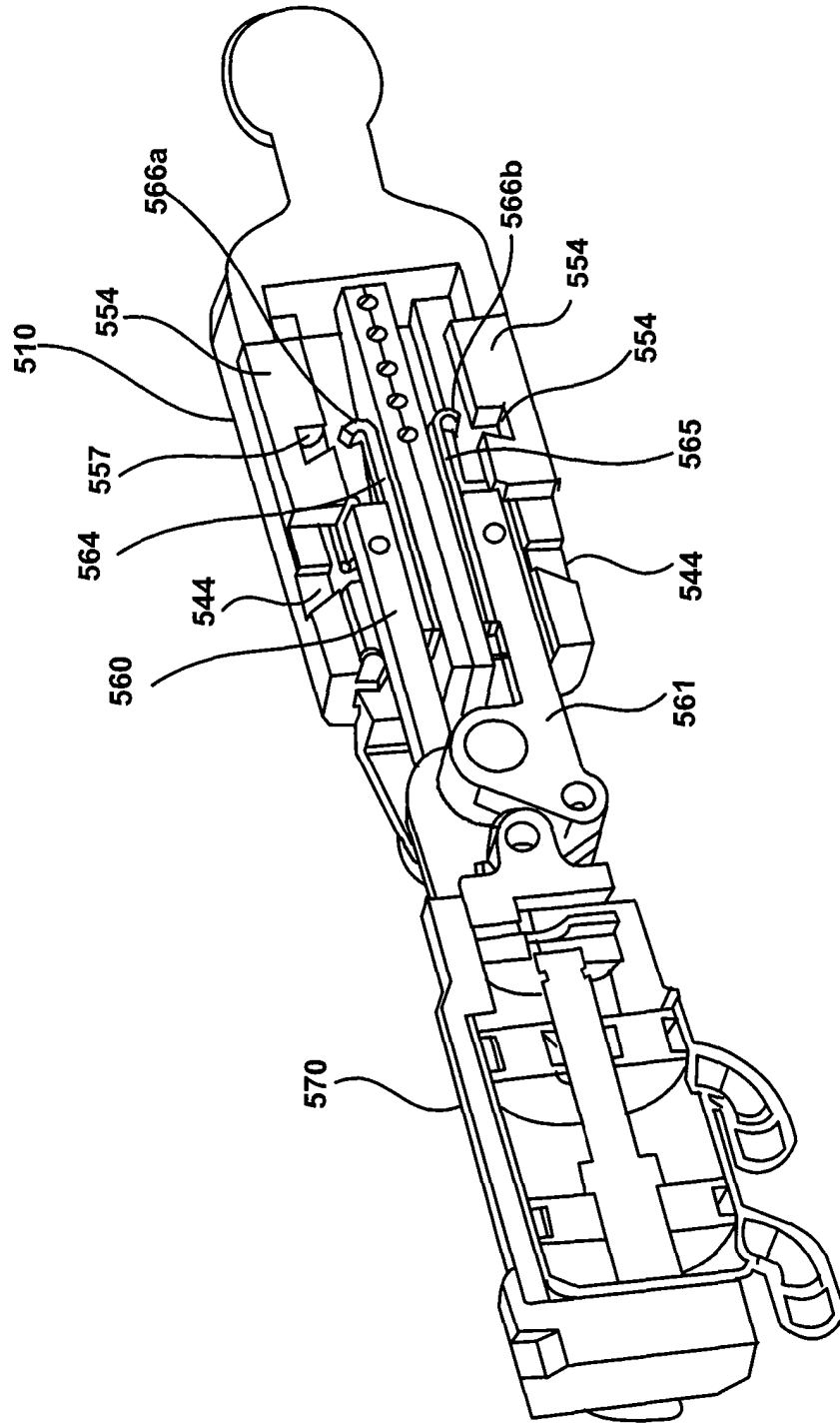

FIG. 9

10/11

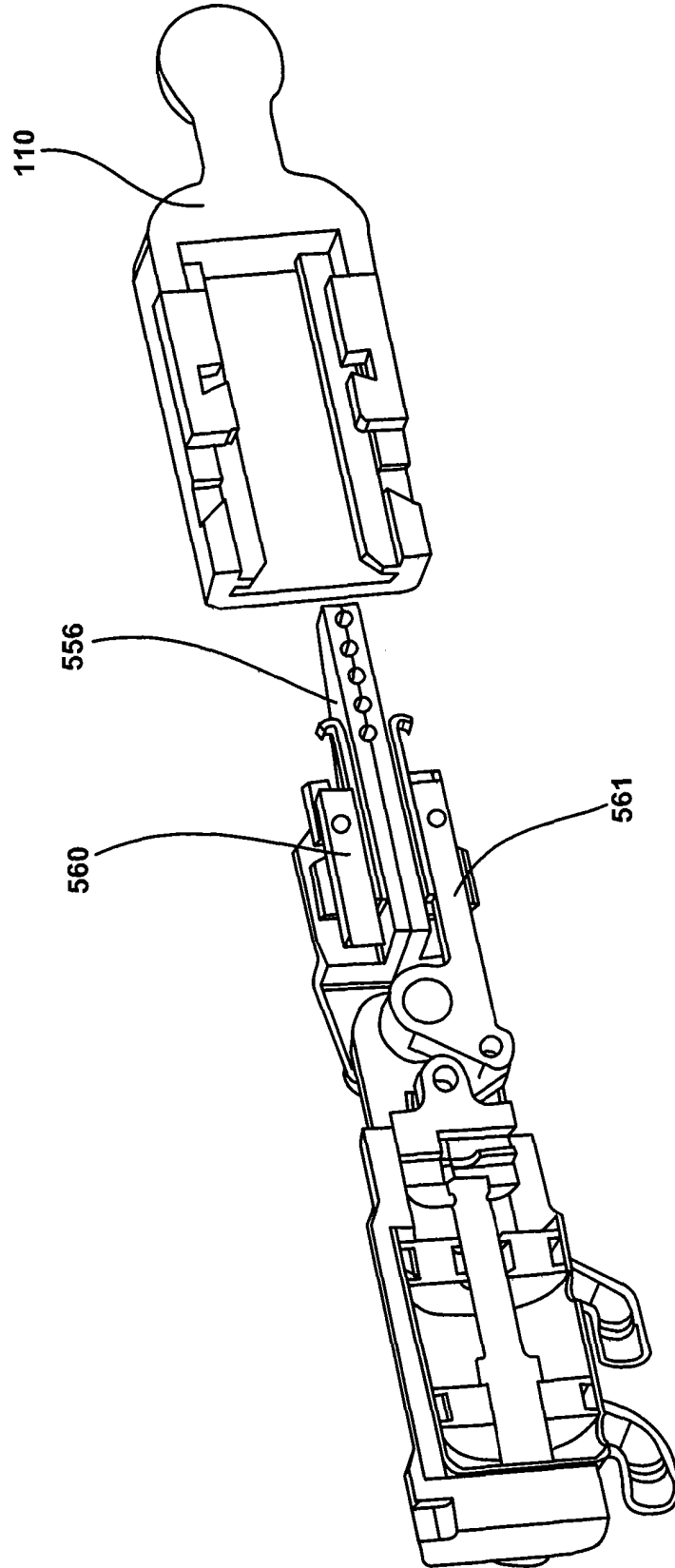

FIG. 10

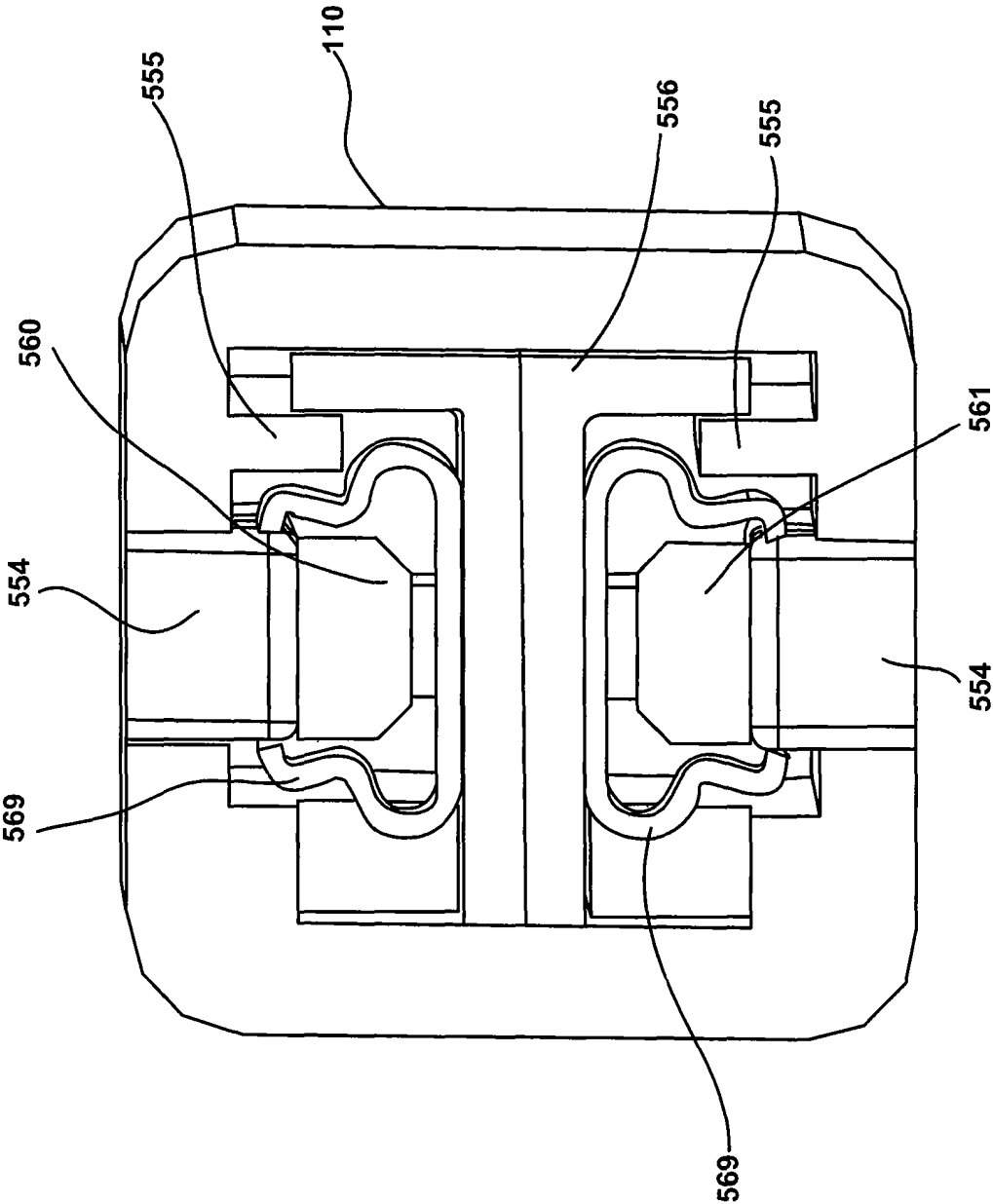

FIG. 11