

[54] **STRAP FOR BOOT AND SHOE HOLDER**

Primary Examiner—Patrick D. Lawson
Attorney—Sherman Levy

[76] Inventor: **Ivor J. Allsop**, P.O. Box 23, Bel-
lingham, Wash. 98225

[22] Filed: **May 28, 1971**

[21] Appl. No.: **147,900**

[57] **ABSTRACT**

A boot and shoe holder that includes a carrying strap that can be folded, and wherein when desired, the strap can be extended to permit the user to insert the arm therethrough.

[52] U.S. Cl. **12/120.5**

[51] Int. Cl. **A43d 5/00**

[58] Field of Search. **12/120.5**

[56] **References Cited**

6 Claims, 4 Drawing Figures

UNITED STATES PATENTS

3,183,535	5/1965	McAusland	12/120.5
3,600,734	8/1971	Pollinger	12/120.5

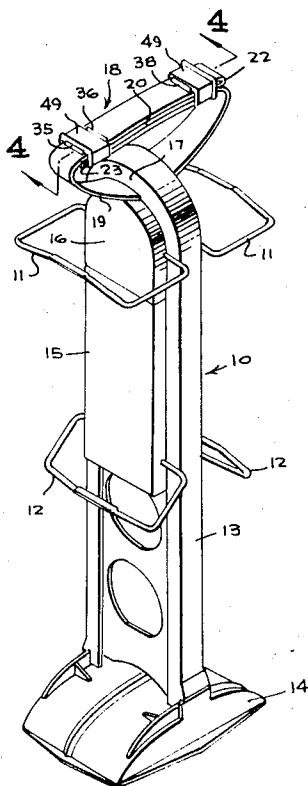

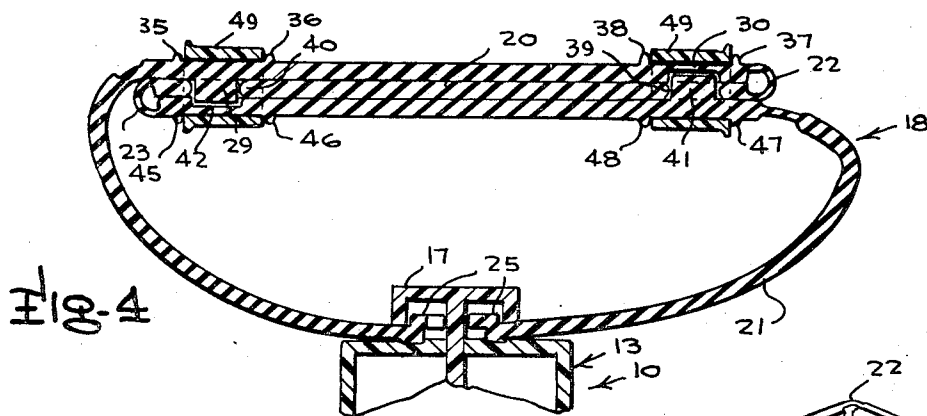

Fig. 4

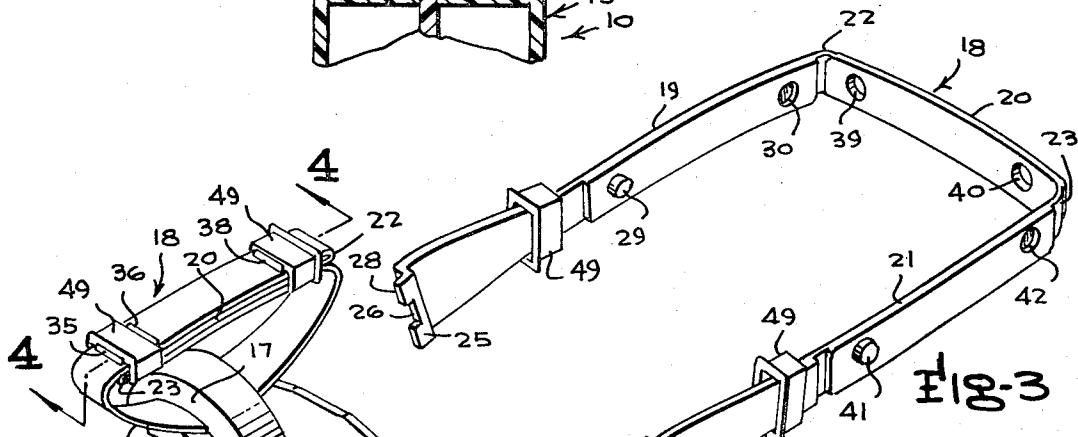

Fig. 3

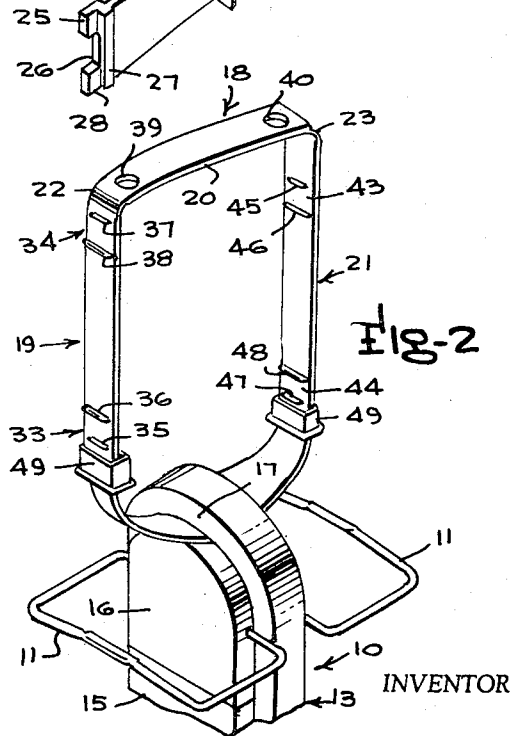

Fig. 2

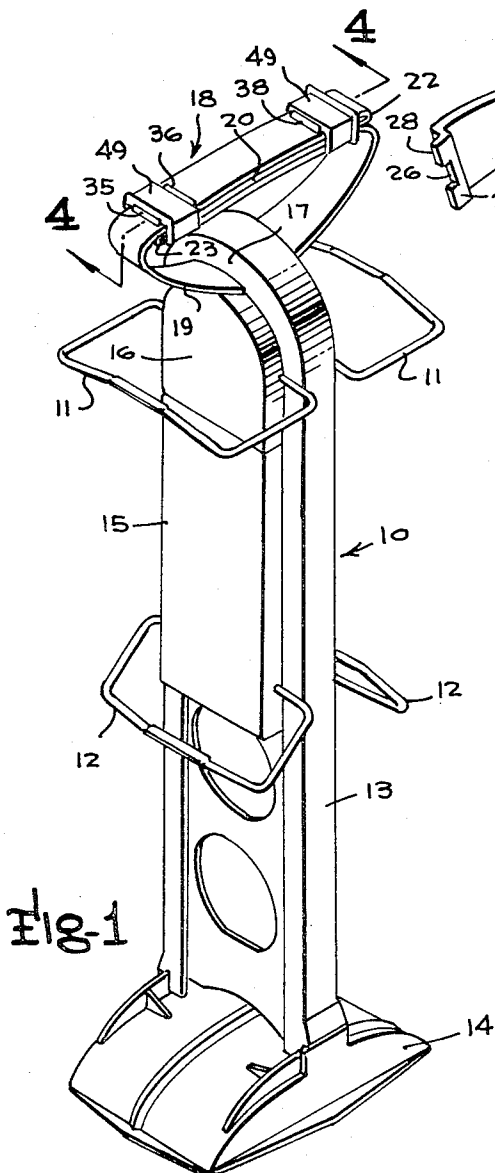

Fig. 1

IVOR J. ALLSOP

BY *Sherman Levy*

ATTORNEY

STRAP FOR BOOT AND SHOE HOLDER

This invention relates to a boot or shoe holder, and more particularly to a strap for such a boot and shoe holder.

The primary object of the present invention is to provide a strap for a boot and shoe holder and wherein the strap can either be arranged in an extended open position to provide clearance for a portion of a person's arm to be extended therethrough, or wherein, when desired, the strap can be arranged in a retracted folded position.

A further object of the present invention is to provide a strap for a boot and shoe holder wherein there is provided a means for selectively maintaining the strap in its folded position, and when the strap is to be moved to the extended position, the user can readily manually separate the parts to permit the strap to be moved to the desired open position.

A further object is to provide a boot and shoe holder strap that is economical to manufacture and efficient in operation, and which is rugged in structure and fool-proof in use.

These and other objects of the invention will become apparent from a reading of the following specification and claims, together with the accompanying drawing, wherein like parts are referred to and indicated by like reference characters, and wherein:

FIG. 1 is a perspective view, illustrating the strap on a boot or shoe holder, and showing the strap in a closed position.

FIG. 2 is a fragmentary perspective view showing the strap in open position.

FIG. 3 is a perspective view showing the strap, per se.

FIG. 4 is an enlarged sectional view, taken on the line 4—4 of FIG. 1.

Referring in detail to the drawings, the numeral 10 indicates a boot or shoe holder which may have a construction generally similar to that shown in prior U.S. Pat. No. 3,210,787, Design Patent No. 206,110 and Design Patent No. 206,111. The device 10 includes heel and toe retainers 11 and 12, as well as a frame 13, base 14, movable platform 16, as well as an end portion 17.

In accordance with the present invention, there is provided a strap 18 for the holder 10, and as shown in the drawings, the strap 18 can be either arranged in a closed folded position as shown in FIGS. 1 and 4, or else it can be conveniently and readily moved to an open extended position, as shown in FIG. 2.

The strap 18 is adapted to be made of a suitable material, such as bendable plastic, and comprises first, second and third portions 19, 20 and 21. The first and second portions 19 and 20 are interconnected by a fold or hinge portion 22, and the second and third portions 20 and 21 of the strap are interconnected or joined by a fold or hinge portion 23. The ends or edges of the strap 18 are provided with securing means 25 thereon for permitting the strap to be fastened to the end portion 17 of the holder 10, and this securing means 25 includes spaced apart opposite sections 28 that have a recess 26 therebetween as well as a retaining portion 27 contiguous thereto.

The first portion 19 of the strap 18 has a lug or projection 29 thereon or formed integral therewith for a purpose to be later described, and there is provided in the portion 19 a recess 30 that is arranged adjacent the

fold line 22. Arranged on the opposite side of the portion 19 from the lug 29 are two sets or pairs of ribs or projections 33 and 34. The set of ribs 33 includes spaced parallel projections or ribs 35 and 36, and, as shown in the drawings, the rib 36 is slightly larger than the rib 35. Similarly, the set of ribs 34 include ribs 37 and 38, and the rib 38 is slightly larger than the rib 37.

The second or intermediate portion 20 of the strap is provided with a pair of spaced apart openings or apertures 39 and 40 that may have a circular formation.

The third portion 21 of the strap 18 has on one side thereof a projection or lug 41, as well as a recessed portion or indented portion 42. On the opposite side of the portion 21 from the projection 41 are spaced apart sets or pairs of ribs 43 and 44. The pair of ribs 43 includes projections or ribs 45 and 46 that have a construction such that the rib 46 is slightly larger than the rib 45. Similarly, the set of ribs 44 includes a pair of ribs 47 and 48, and the rib 48 is slightly larger than the rib 47. The numeral 49 indicates a pair of slidable or movable retainers that are movably mounted on the strap.

From the foregoing, it will be seen that there has been provided a strap for a member such as a boot and shoe holder and in use with the parts arranged as shown in the drawings, the strap 18 may either be arranged in a closed position such as that shown in FIGS. 1 and 4, or else it may be moved to the open extended position as shown in FIG. 2. The construction of the various parts such as the heel and toe retainers 11 and 12 are shown and described in prior U.S. Pat. No. 3,210,787, and hence it is not thought necessary to further describe the construction and operation of such parts in this application. The ends of the strap 18 are fixedly secured to the end portion 17 of the device 10 by means of the retaining means 25, 26, 27 and 28. When the strap 18 is in the forward position, the slidable retainers or sleeves 49 engage the adjacent folded portions of the strap to maintain the strap in a compact closed position, as shown in FIGS. 1 and 4. At this time, the retainers 49 are snugly received between the ribs on the strap to properly center and hold the retainers in their proper location. It is to be noted that when the retainers 49 are in the position of FIGS. 1 and 4 that the smaller of the ribs is on the outer portion of the strap, while the larger of the ribs is positioned forwardly. This construction assures or provides that the larger of the ribs, such as the ribs 36 and 46 and 38 and 48 will act as stops to prevent the retainers 49 from being moved forwardly too far along the strap. In addition, with the strap in closed position, the smaller ribs 35, 45, 37 and 47 are disposed towards the outer ends of the strap and the smaller of these ribs are of a size such that the retainers can slide over these smaller ribs and snap in place between the proper sets of ribs to locate and maintain the retainers in their desired location.

When it is desired to extend the strap 18 to a position such as that shown in FIG. 2, it is only necessary to manually move the retainers 49 outwardly so that they can move over the ribs 35, 45, 37 and 47, whereby the parts of the strap can be readily unfolded or opened to the position of FIG. 2. With the parts in the open position of FIG. 2 there is sufficient clearance for the user to readily insert his or her arm within the space within the opened strap so that a convenient carrying means is provided for the open strap.

With the parts arranged as shown in FIGS. 1 and 4, wherein the strap is in closed position, the device can be manually gripped with the fingers around the strap to conveniently carry the boot and boot holder with the user's hand.

It will be noted that there are further provided interengaging recesses and lugs or projections to properly center and align the parts when they are in their folded position. Thus, for example, there is provided the lug or projection 29 which extends through the aperture 40 10 and into the recess 42, as shown in FIG. 4. Similarly, when the strap is in folded or closed position, the lug 41 extends through the aperture 39 and is snugly received in the recess or extended portion 30.

It is to be noted that the parts can be made of any 15 suitable material and in different shapes or sizes, as desired or required.

While a preferred embodiment in accordance with the present invention has been illustrated and described, it is to be understood that various modifica- 20 tions may be resorted to without departing from the spirit and the scope of the appended claims.

I claim:

1. In a boot and shoe holder, a strap, said strap being 25 mounted for movement into and out of open extended position, and said strap being mounted for longitudinal movement into and out of closed folded position, said strap when in closed position being spaced from the holder and means for selectively maintaining said strap in closed position.

2. The structure as defined in claim 1, wherein the

means is manually operable to permit the strap to be moved to open position.

3. The structure as defined in claim 1, wherein when 5 said strap is in open extended position, there is provided sufficient clearance therein for the projection therethrough of a portion of the user's arm.

4. The structure as defined in claim 1, wherein when the strap is in folded closed position, the strap can be manually gripped to carry the boot and shoe holder.

5. In a boot and shoe holder including a frame and heel and toe retainers, the improvement consisting in providing a strap of bendable material, said strap comprising first, second and third portions joined together by foldable hinge sections, the ends of said strap being 10 affixed to the boot and shoe holder, said first portion having a lug and recess on one side thereof, spaced apart sets of ribs on the opposite side of the first portion; said second portion having a pair of apertures therein for registry with the projection and recess when the second portion is in folded position contiguous to the first portion; said third portion having a projection and recess on one side thereof, spaced apart sets of ribs 15 on the opposite side of the third portion from the lug and recess thereon, and movable retainers mounted on said strap for engaging said ribs to selectively maintain the strap in closed folded position.

6. The structure as defined in claim 5, wherein cer- 20 tain of said ribs are smaller than the other of the ribs to permit the retainers to be manually moved over the smaller ribs.

* * * * *

35

40

45

50

55

60

65