



US0D1027051S

(12) **United States Design Patent**  
**Cheng**

(10) **Patent No.:** **US D1,027,051 S**

(45) **Date of Patent:** **\*\* May 14, 2024**

(54) **ELECTRIC SCOOTER**

*Primary Examiner* — Cynthia M. Chin

(71) Applicant: **WUYI SHENGTE VEHICLE CO., LTD**, Jinhua (CN)

(57) **CLAIM**

The ornamental design for an electric scooter, as shown and described.

(72) Inventor: **Enguang Cheng**, Yongkang (CN)

**DESCRIPTION**

(73) Assignee: **WUYI SHENGTE VEHICLE CO., LTD**, Jinhua (CN)

(\*\*) Term: **15 Years**

(21) Appl. No.: **29/819,386**

(22) Filed: **Dec. 14, 2021**

(30) **Foreign Application Priority Data**

Jul. 10, 2021 (CN) ..... 202130436714.8

(51) **LOC (14) Cl.** ..... **21-01**

(52) **U.S. Cl.**  
USPC ..... **D21/423**

(58) **Field of Classification Search**

USPC ..... D21/419, 421, 423; D12/107, 110, 111  
CPC . B62K 3/002; B62K 9/00; B62K 9/02; B62K  
2202/00; B62K 15/00; B62K 2204/00;  
B62K 13/00

See application file for complete search history.

(56) **References Cited**

**U.S. PATENT DOCUMENTS**

D715,870 S \* 10/2014 Talios ..... D21/423  
D956,143 S \* 6/2022 Xie ..... D21/423  
D974,484 S \* 1/2023 Ying ..... D21/423

(Continued)

FIG. 1 is a perspective view of an electric scooter showing my new design;  
FIG. 2 is another perspective view thereof;  
FIG. 3 is a front elevational view thereof;  
FIG. 4 is a rear elevational view thereof;  
FIG. 5 is a left side elevational view thereof;  
FIG. 6 is a right side elevational view thereof;  
FIG. 7 is a top plan view thereof;  
FIG. 8 is a bottom plan view thereof;  
FIG. 9 is an enlarged view of portion 9 shown in FIG. 1;  
FIG. 10 is an enlarged view of portion 10 shown in FIG. 1;  
FIG. 11 is an enlarged view of portion 11 shown in FIG. 1;  
FIG. 12 is an enlarged view of portion 12 shown in FIG. 1;  
FIG. 13 is an enlarged view of portion 13 shown in FIG. 2;  
FIG. 14 is an enlarged view of portion 14 shown in FIG. 2;  
FIG. 15 is an enlarged view of portion 15 shown in FIG. 2;  
FIG. 16 is an enlarged view of portion 16 shown in FIG. 2;  
FIG. 17 is an enlarged view of portion 17 shown in FIG. 3;  
FIG. 18 is an enlarged view of portion 18 shown in FIG. 4;  
FIG. 19 is an enlarged view of portion 19 shown in FIG. 4;  
FIG. 20 is an enlarged view of portion 20 shown in FIG. 7;  
and,  
FIG. 21 is an enlarged view of portion 21 shown in FIG. 8.  
The dash-dash broken lines in the drawings depict portions of the electric scooter that form no part of the claimed design. The dot-dash broken lines represent boundaries of the enlarged portions and form no part of the claimed design.

**1 Claim, 21 Drawing Sheets**

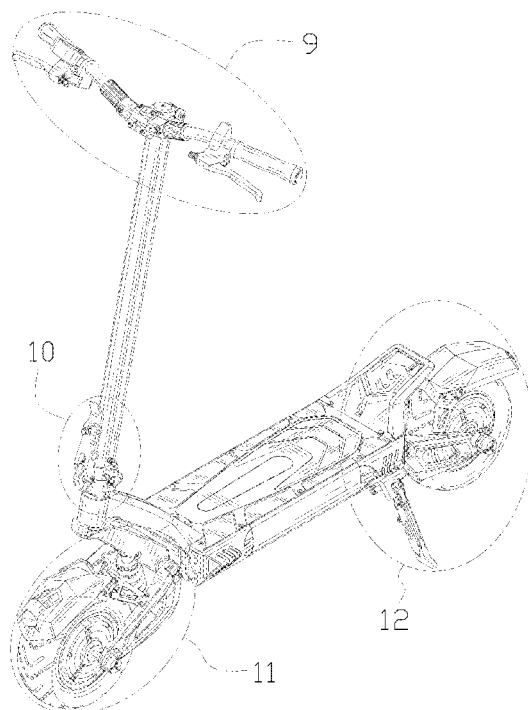

(56)

**References Cited**

U.S. PATENT DOCUMENTS

D999,835	S	*	9/2023	Chen	.....	D21/423
D1,004,001	S	*	11/2023	Chen	.....	D21/423
D1,011,435	S	*	1/2024	Li	.....	D21/423

\* cited by examiner

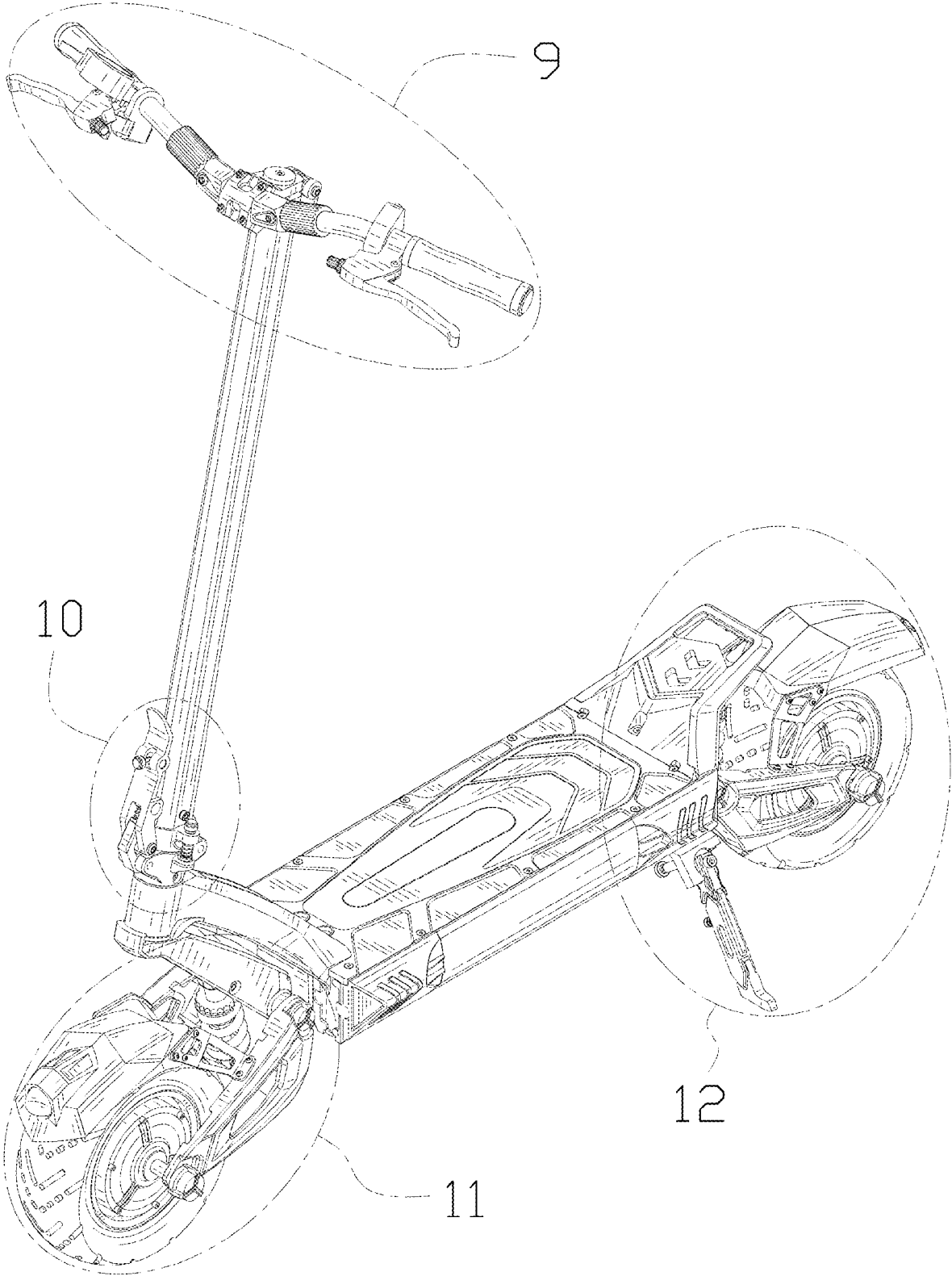

FIG. 1

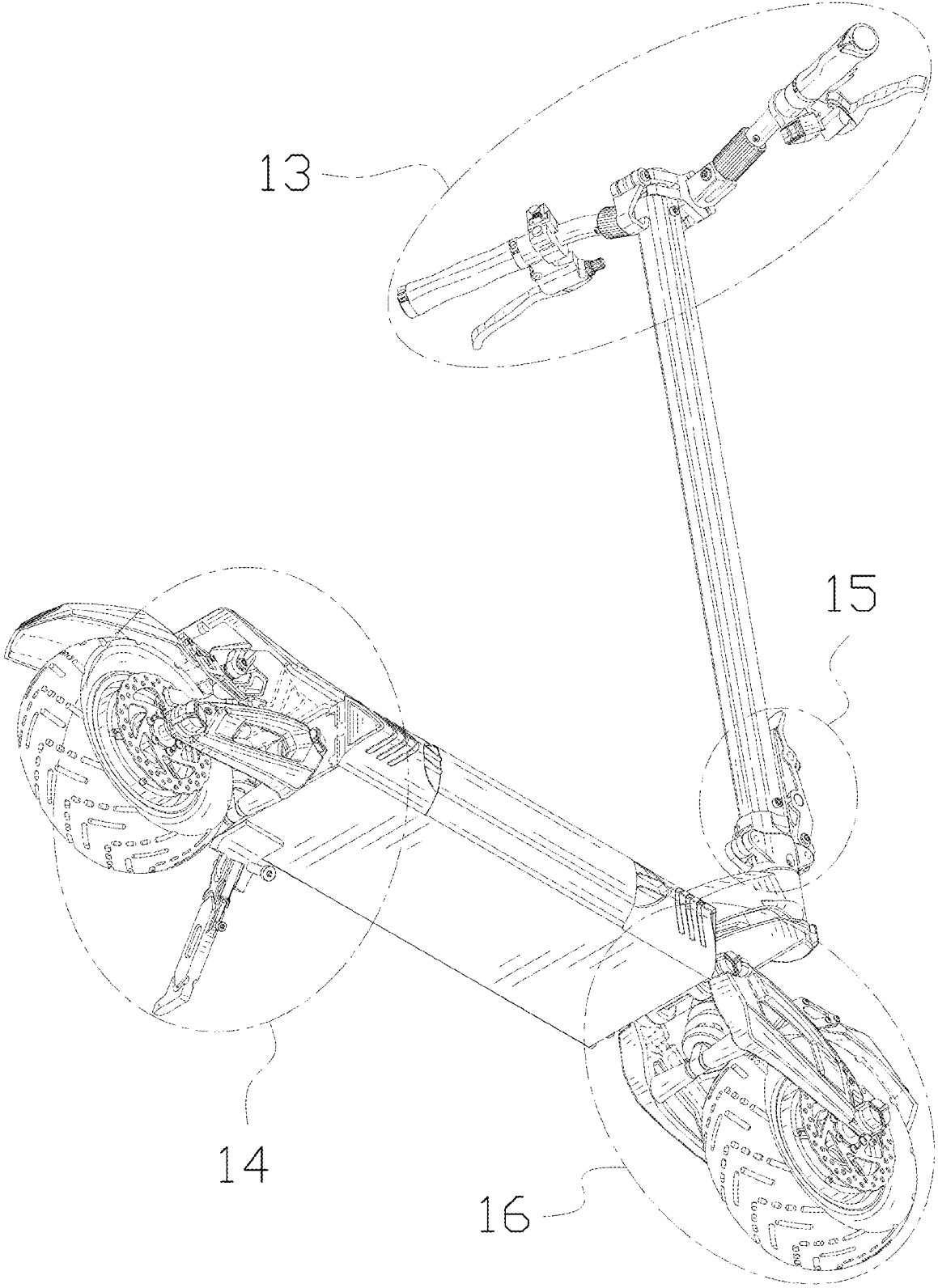

FIG. 2

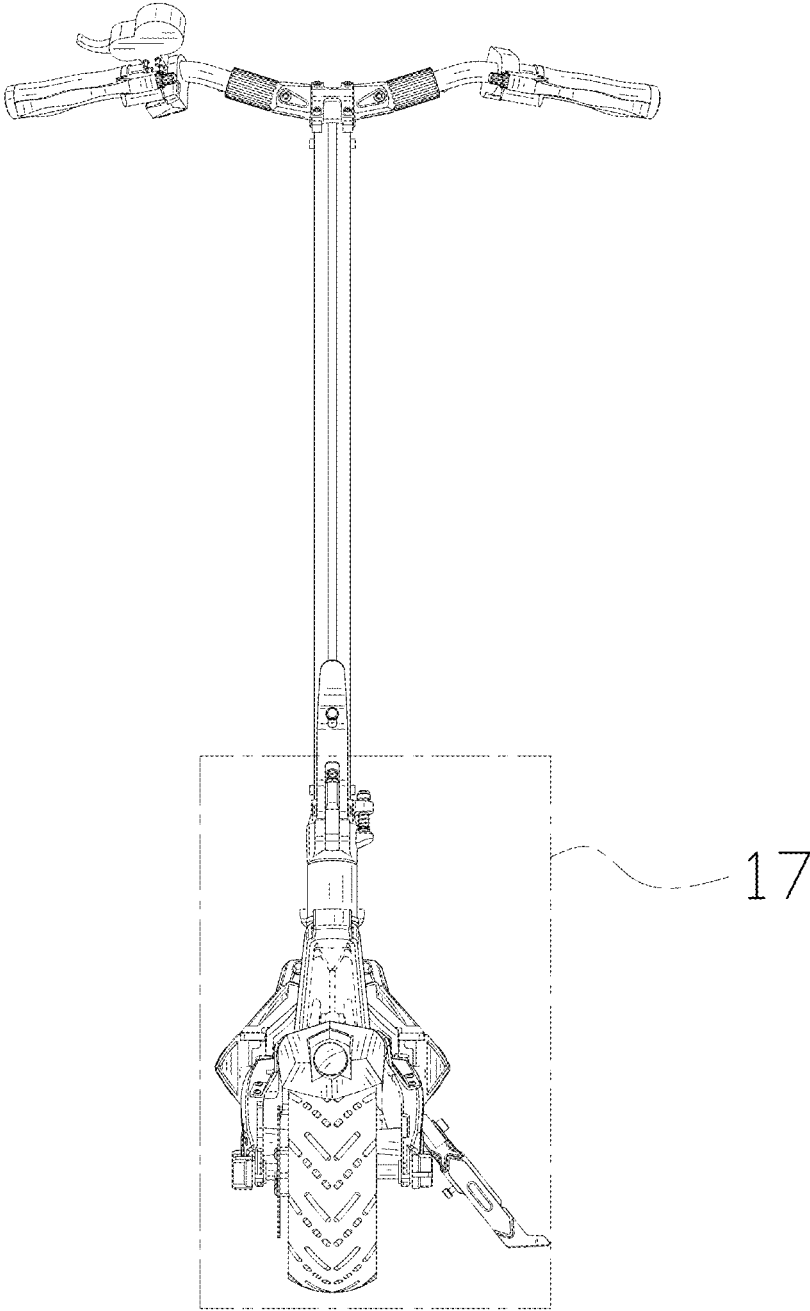

FIG. 3

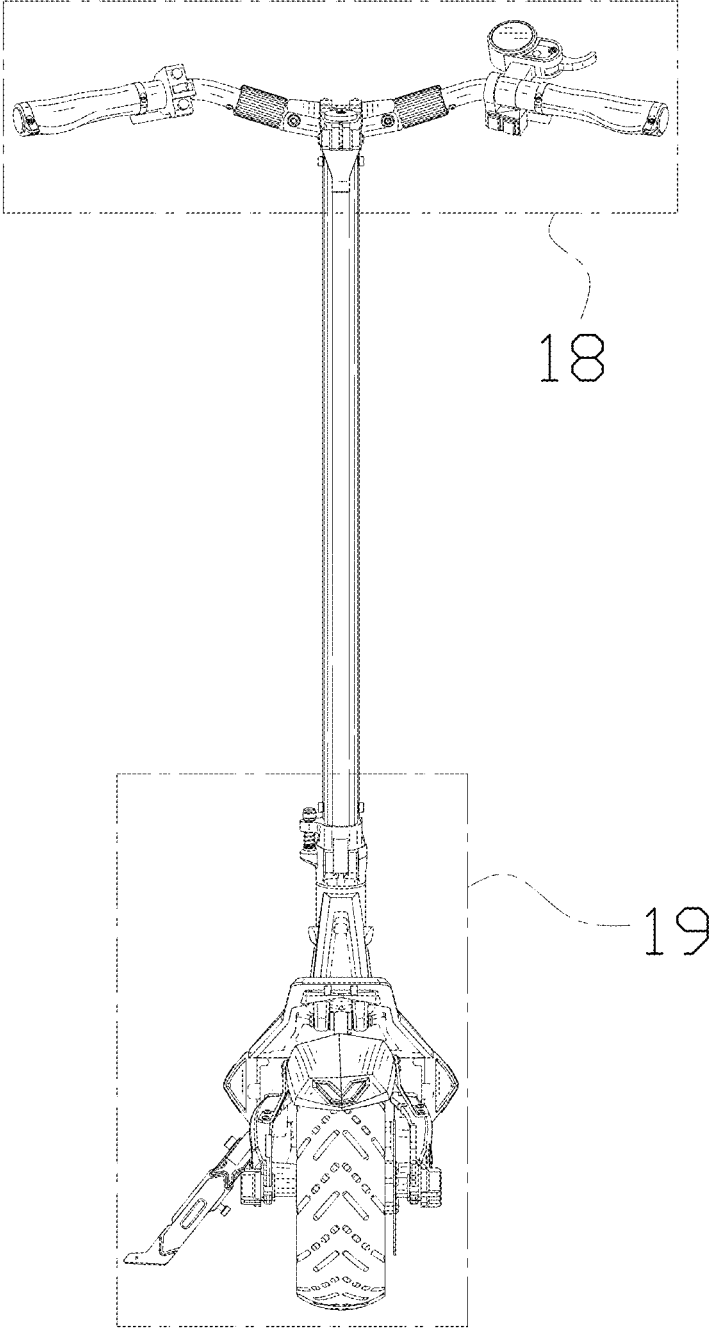

FIG. 4

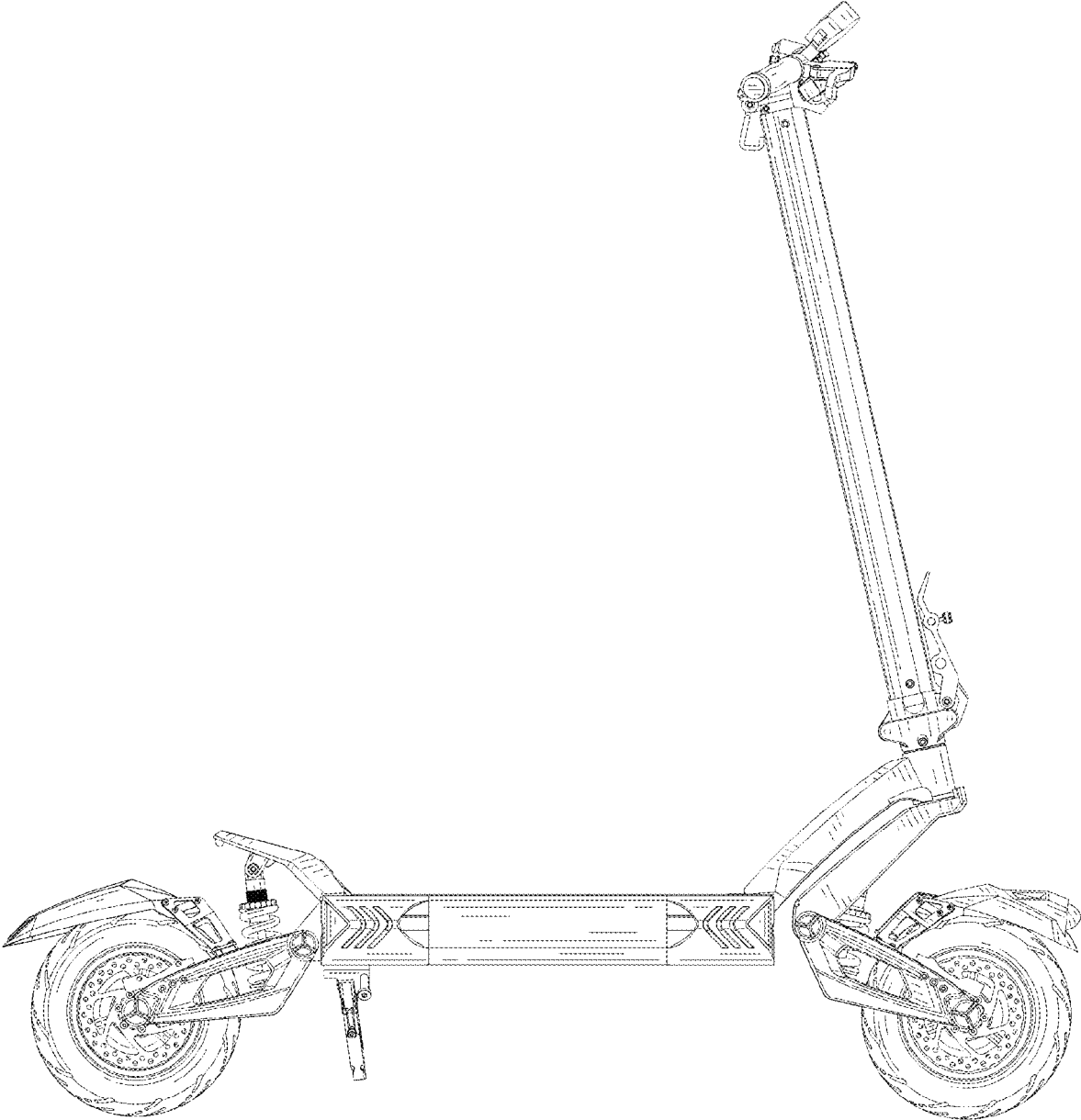

FIG. 5

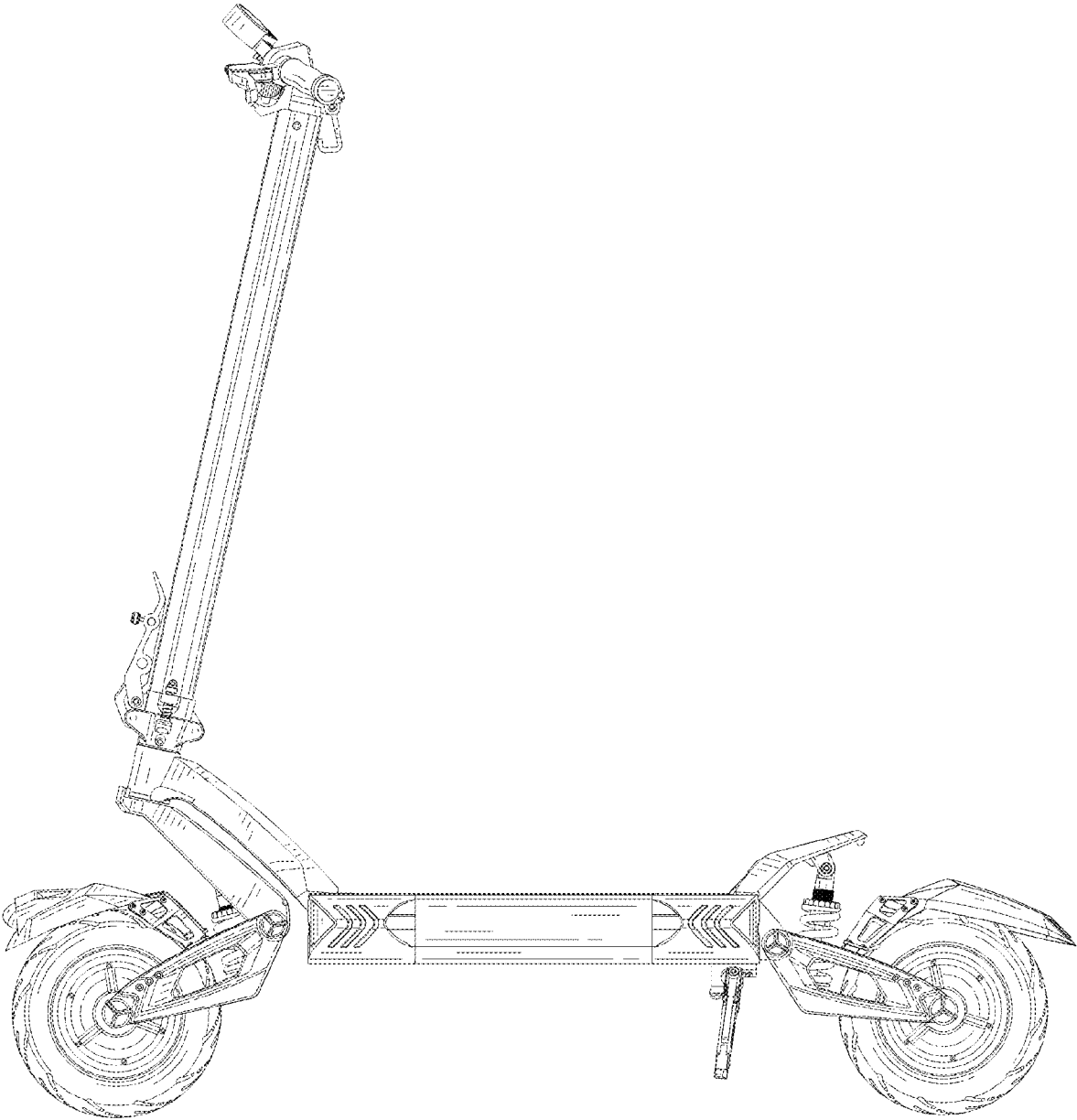

FIG. 6

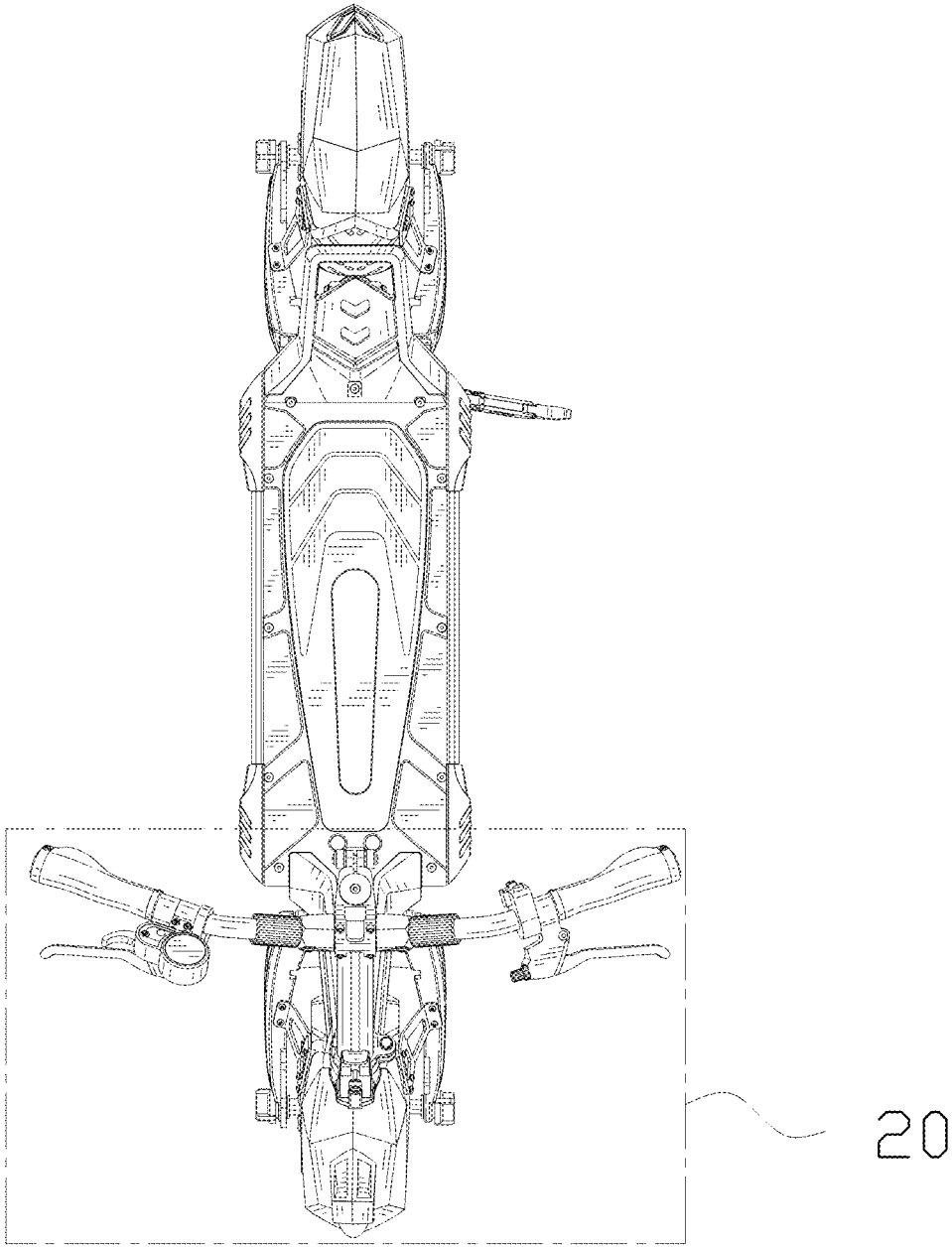

FIG. 7

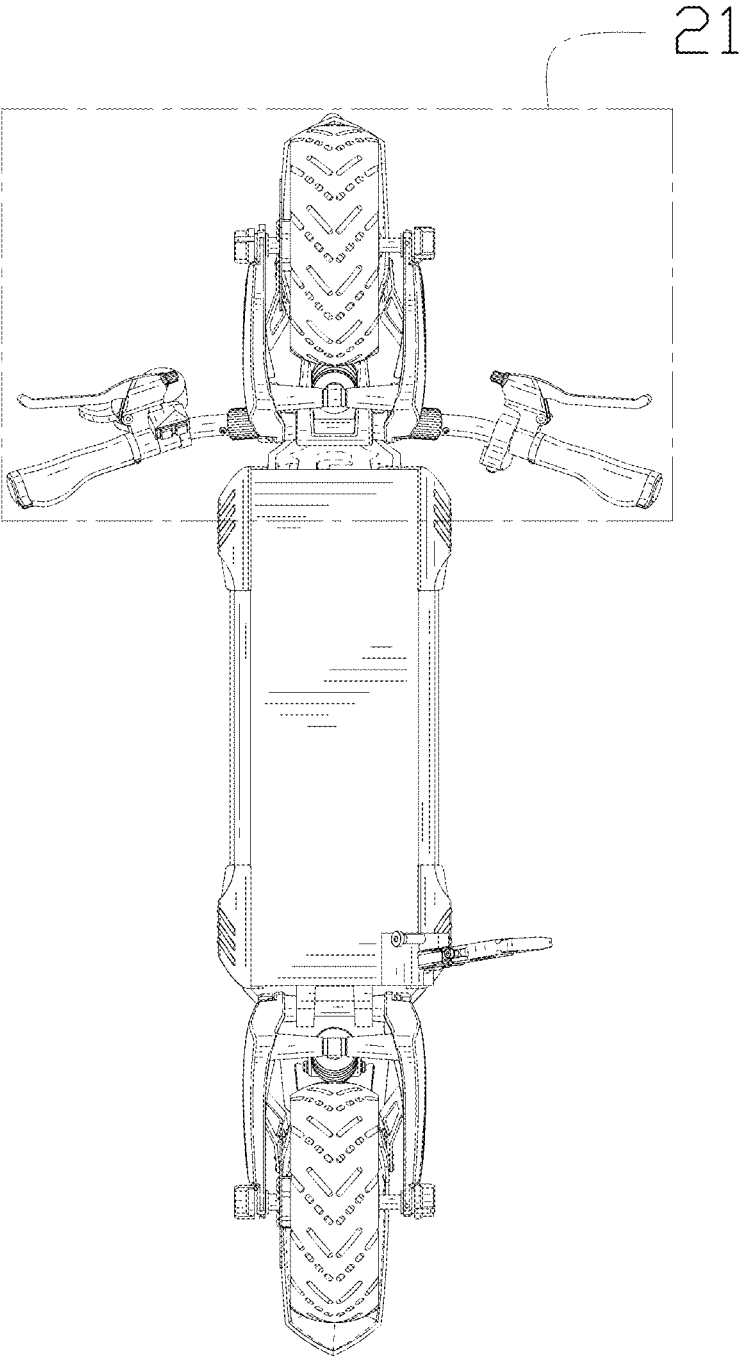

FIG. 8

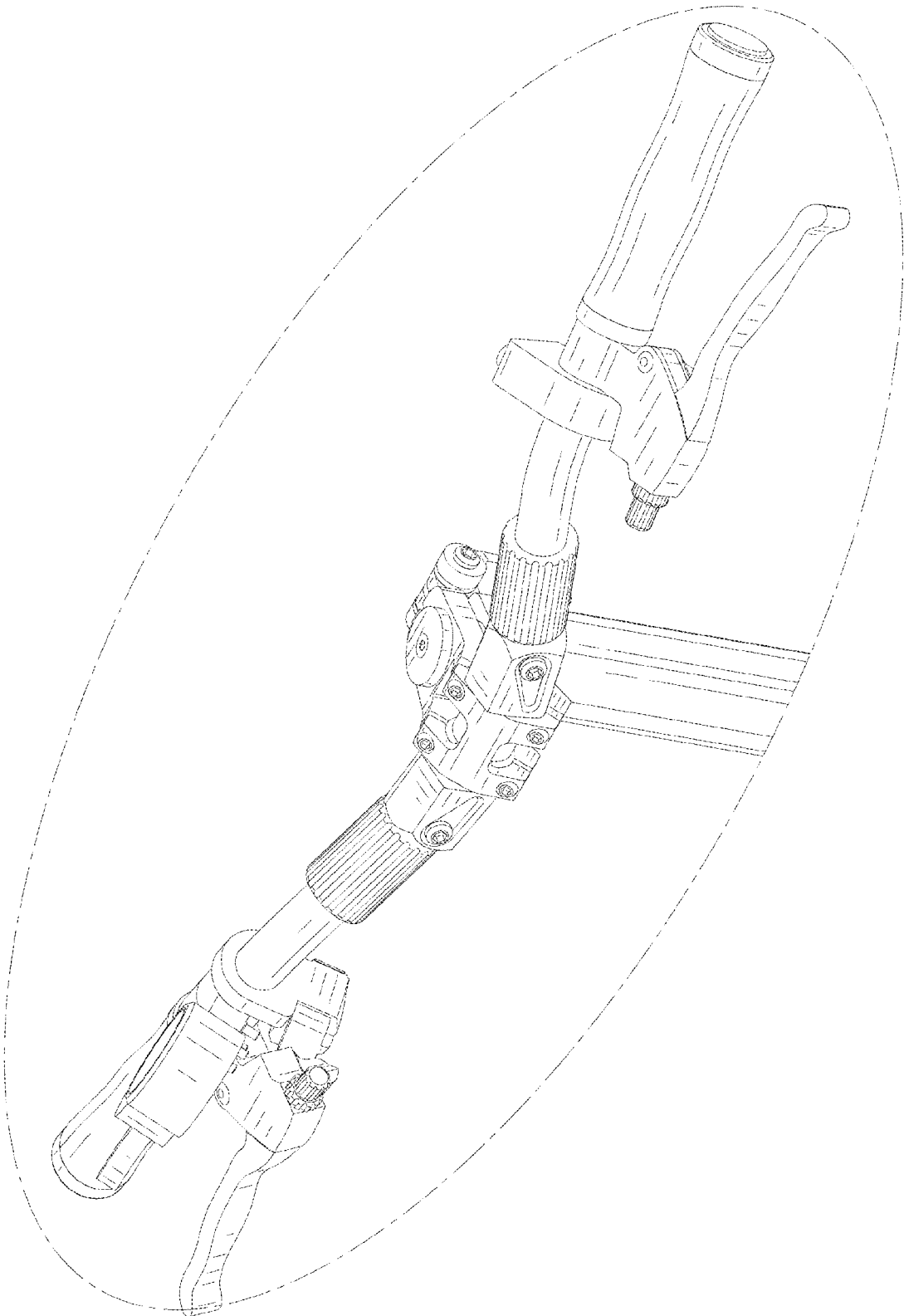

FIG. 9

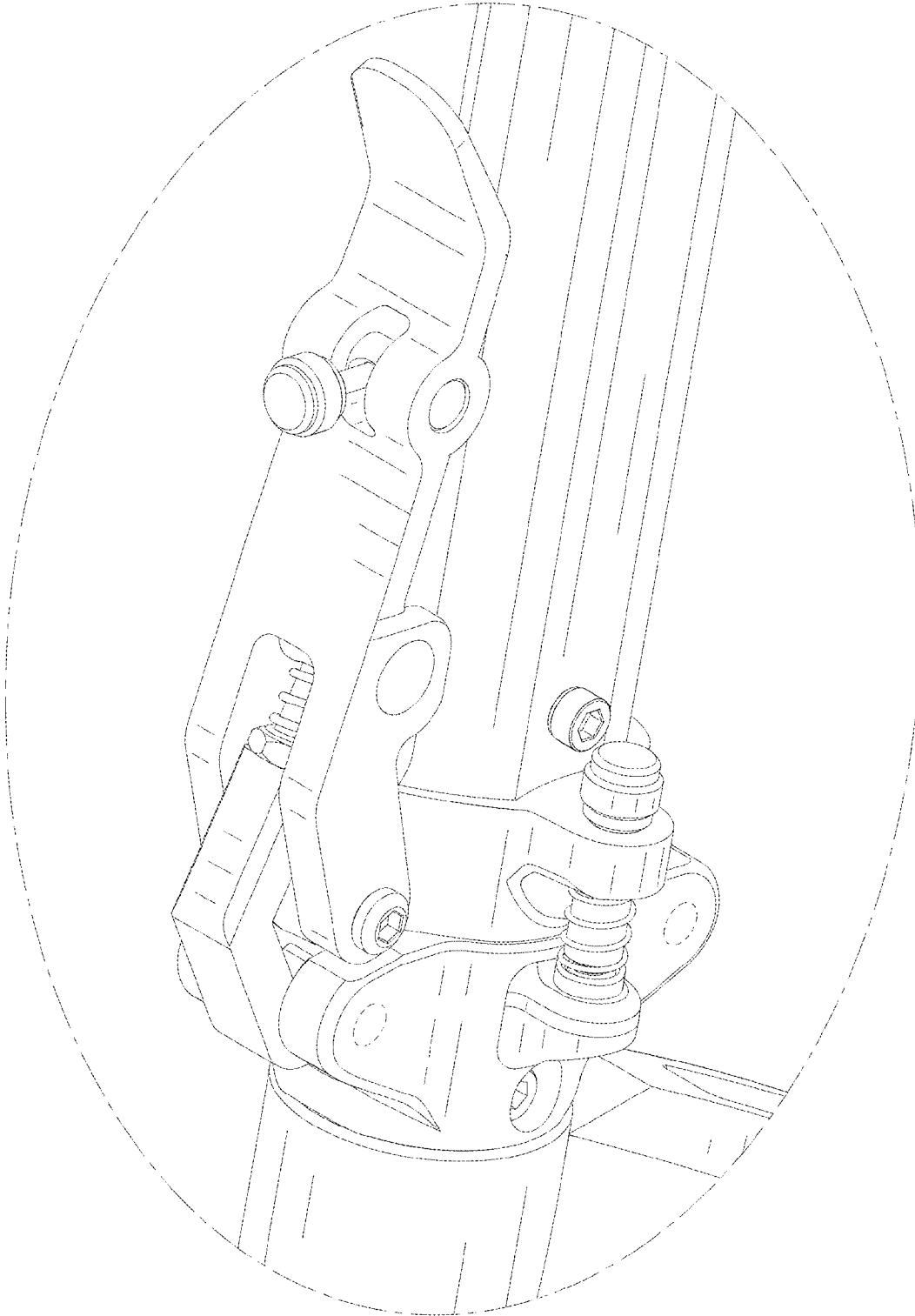

FIG. 10

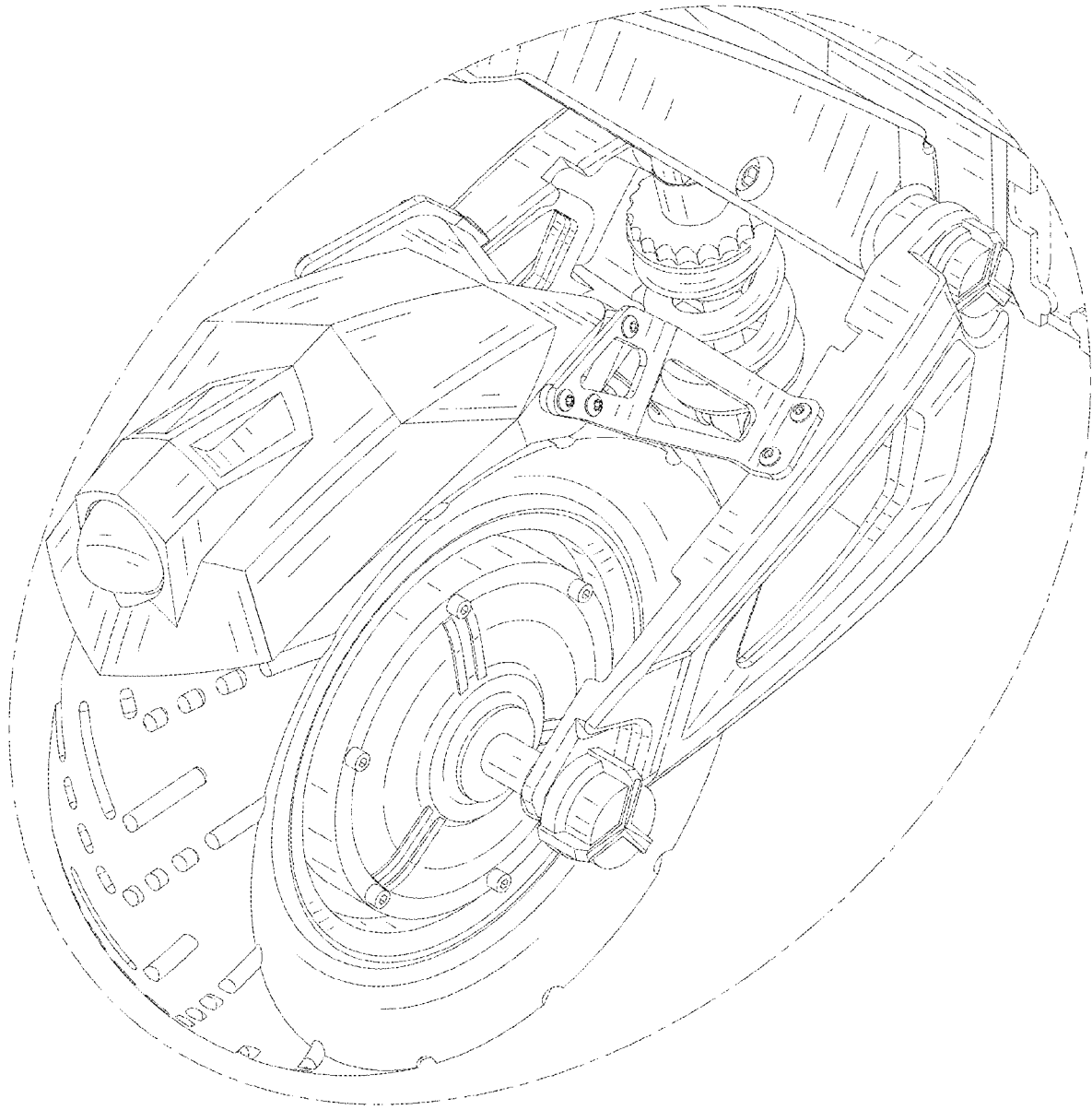

FIG. 11

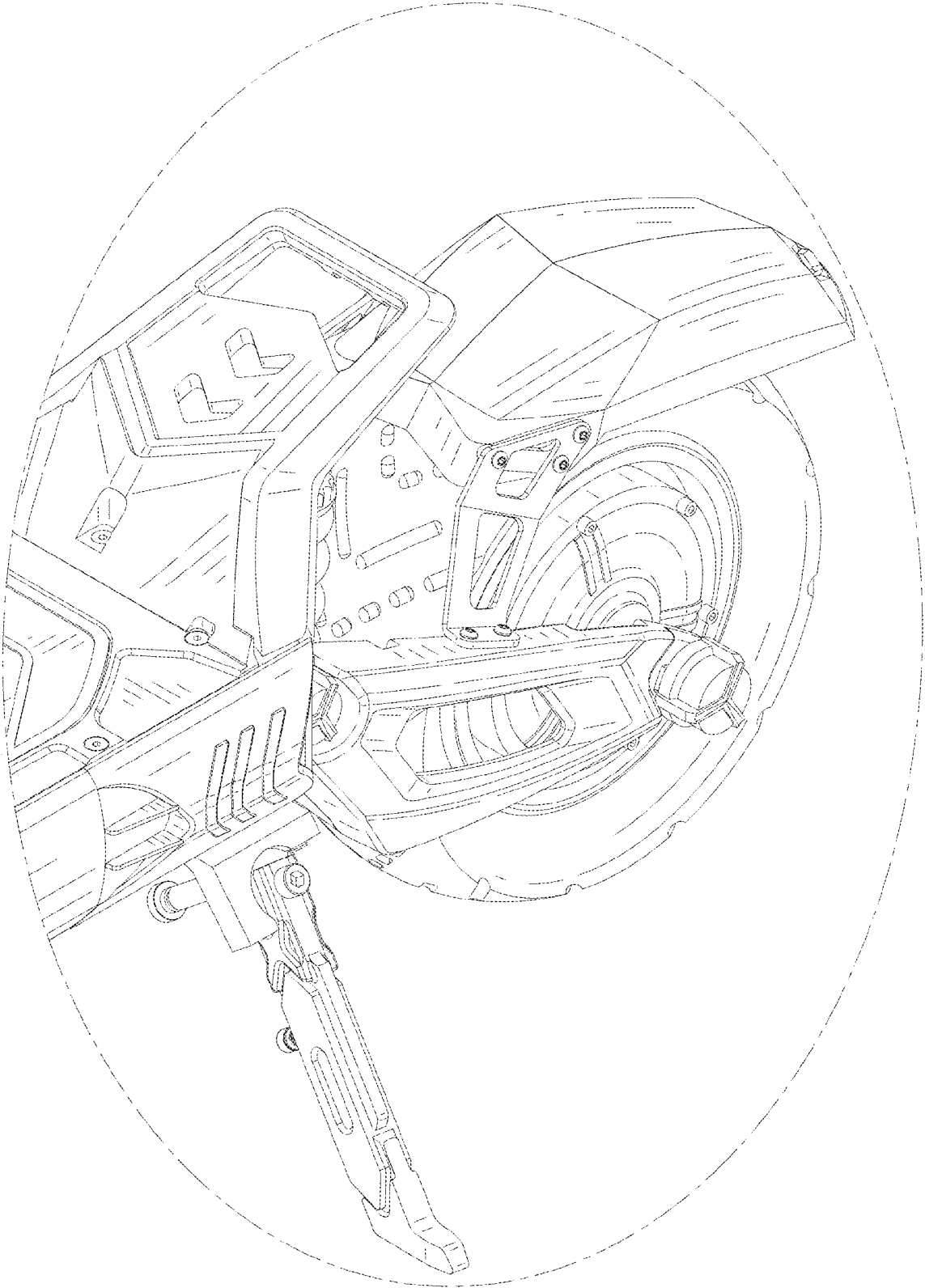

FIG. 12

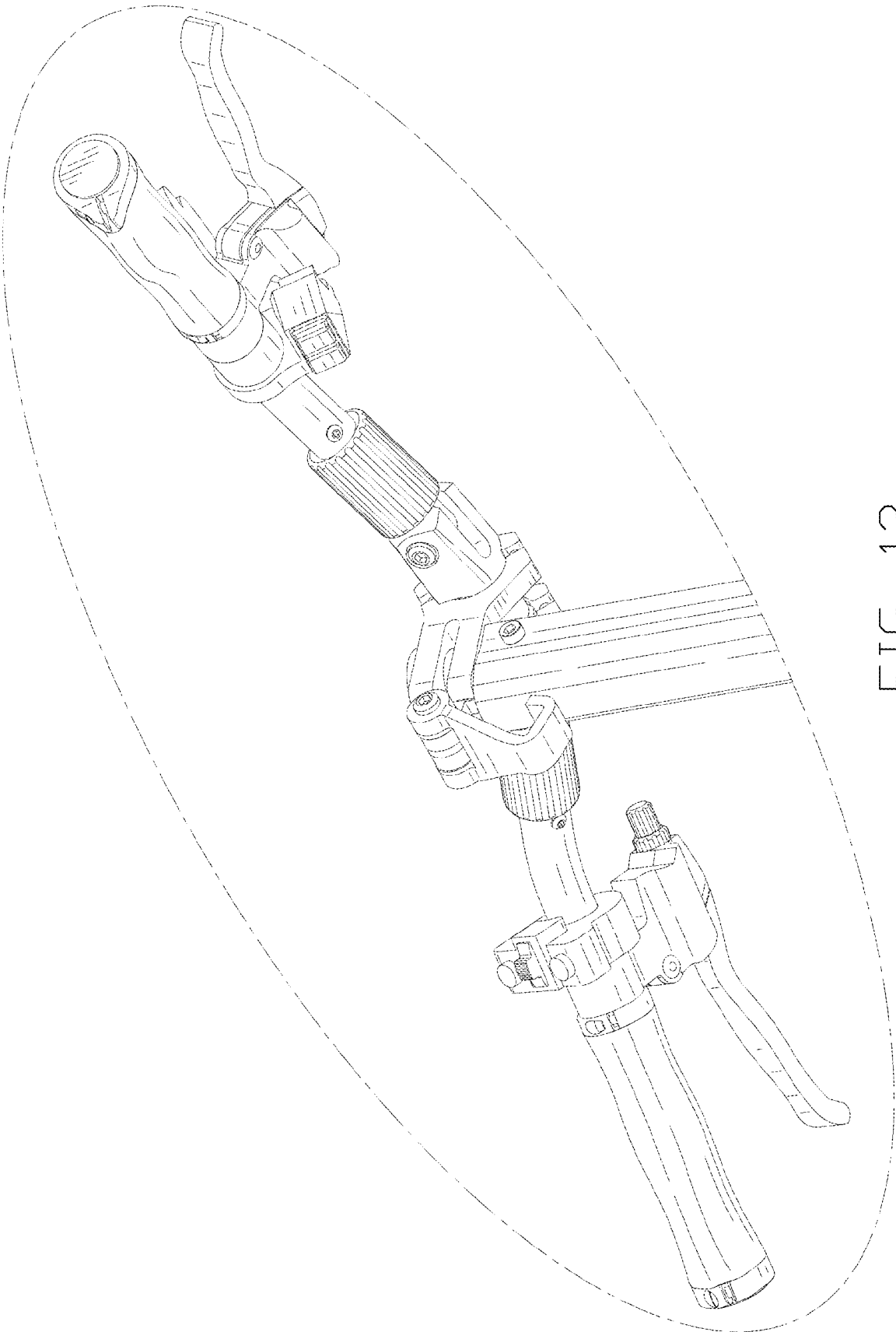

FIG. 13

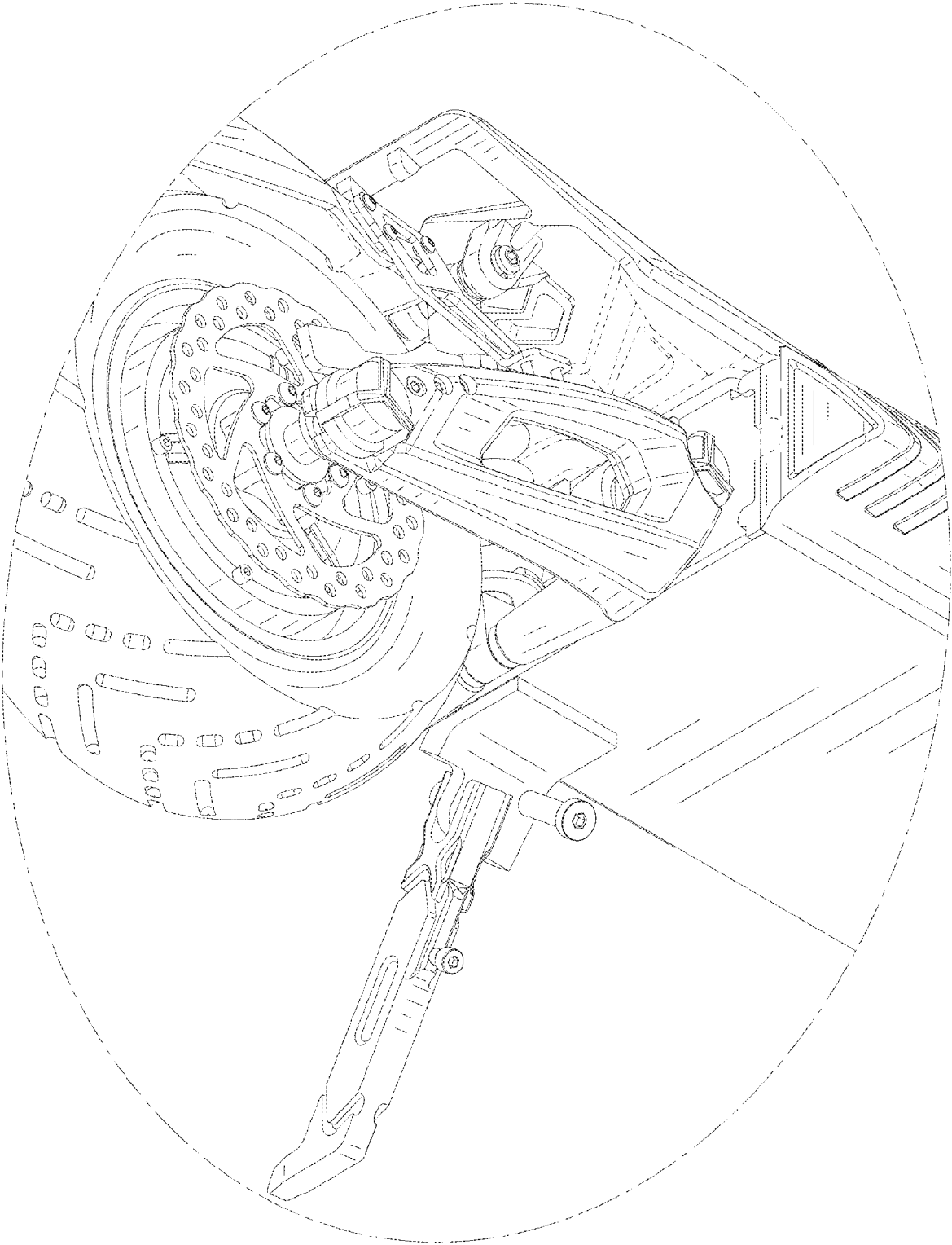

FIG. 14

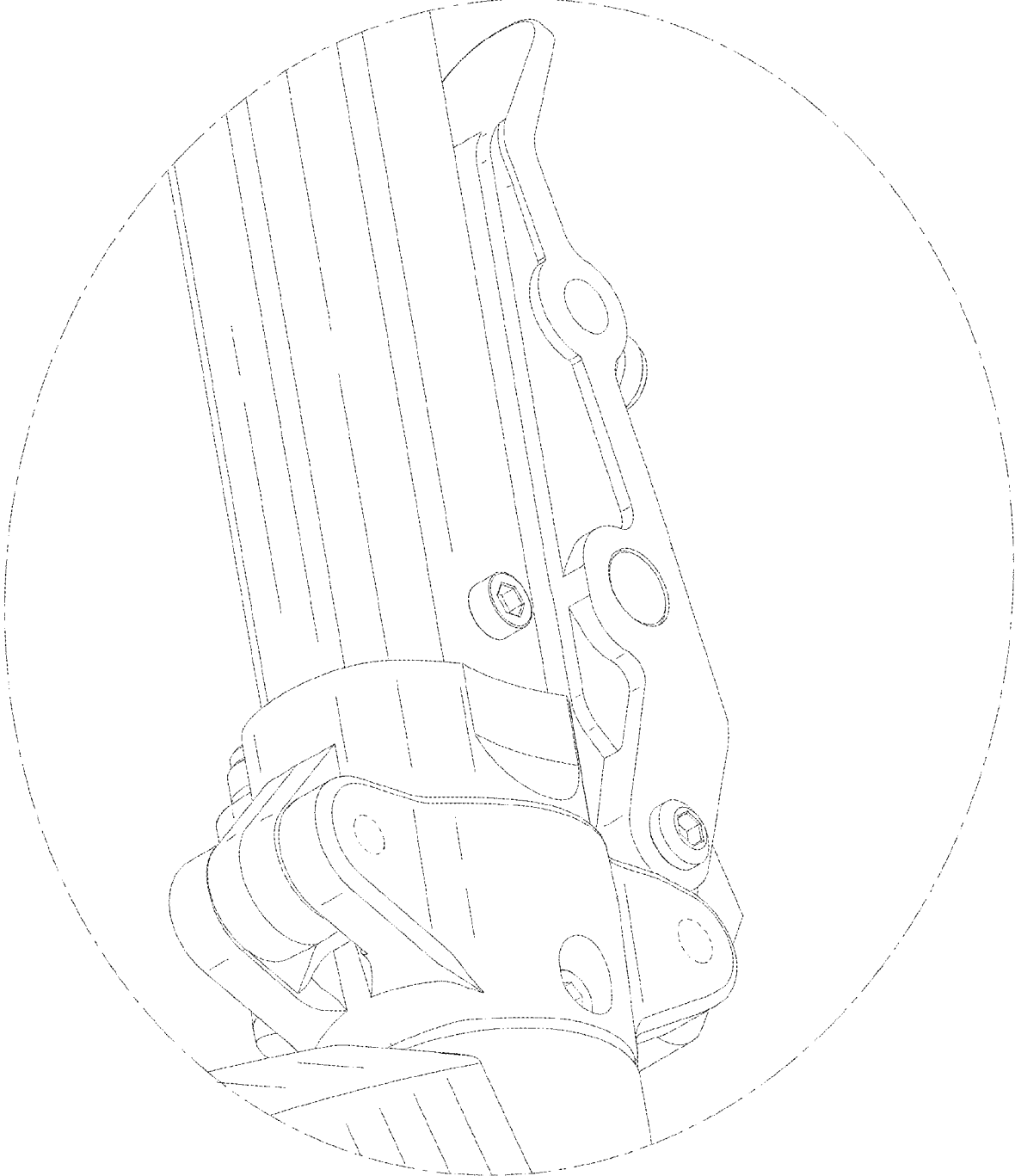

FIG. 15

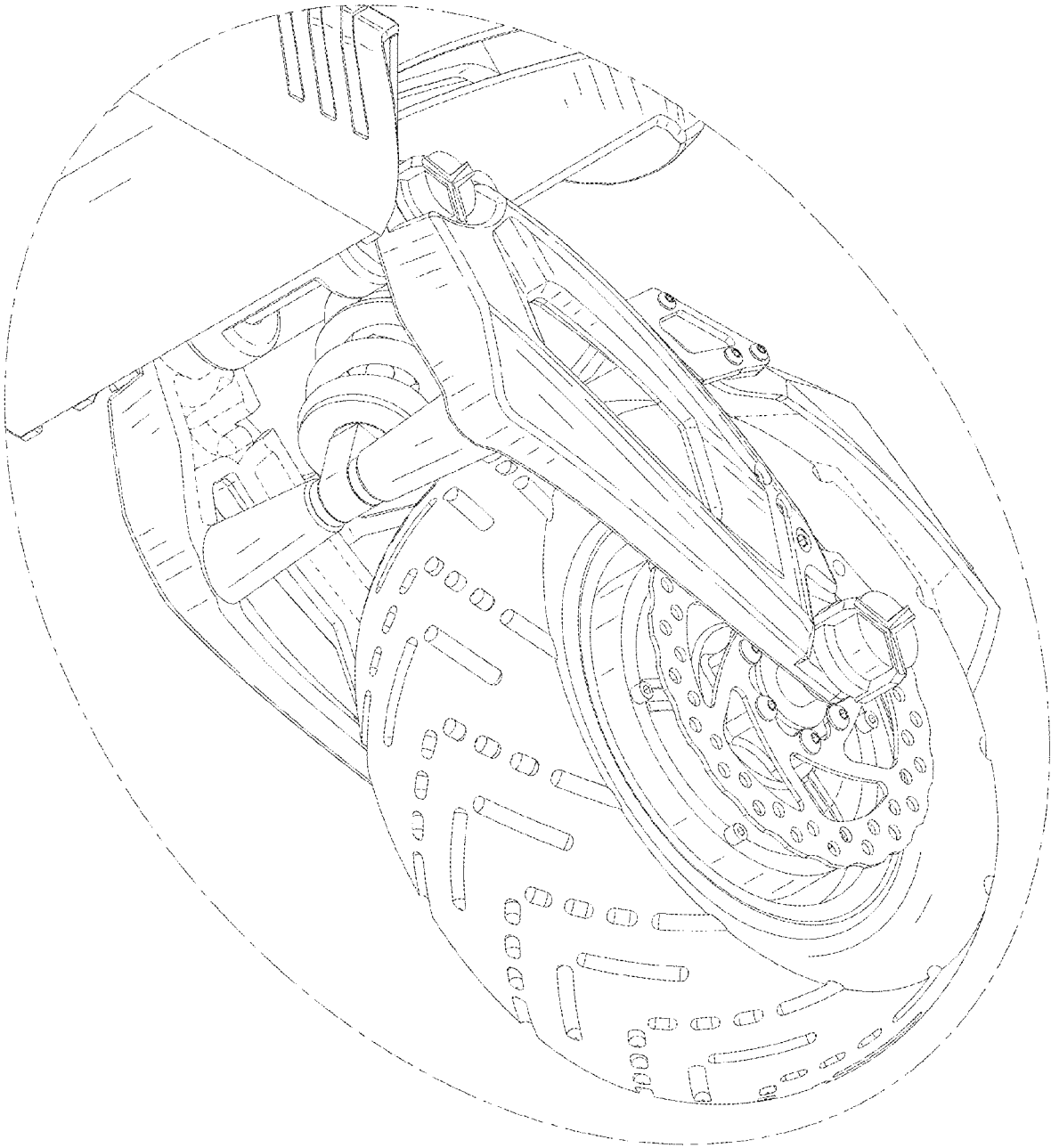

FIG. 16

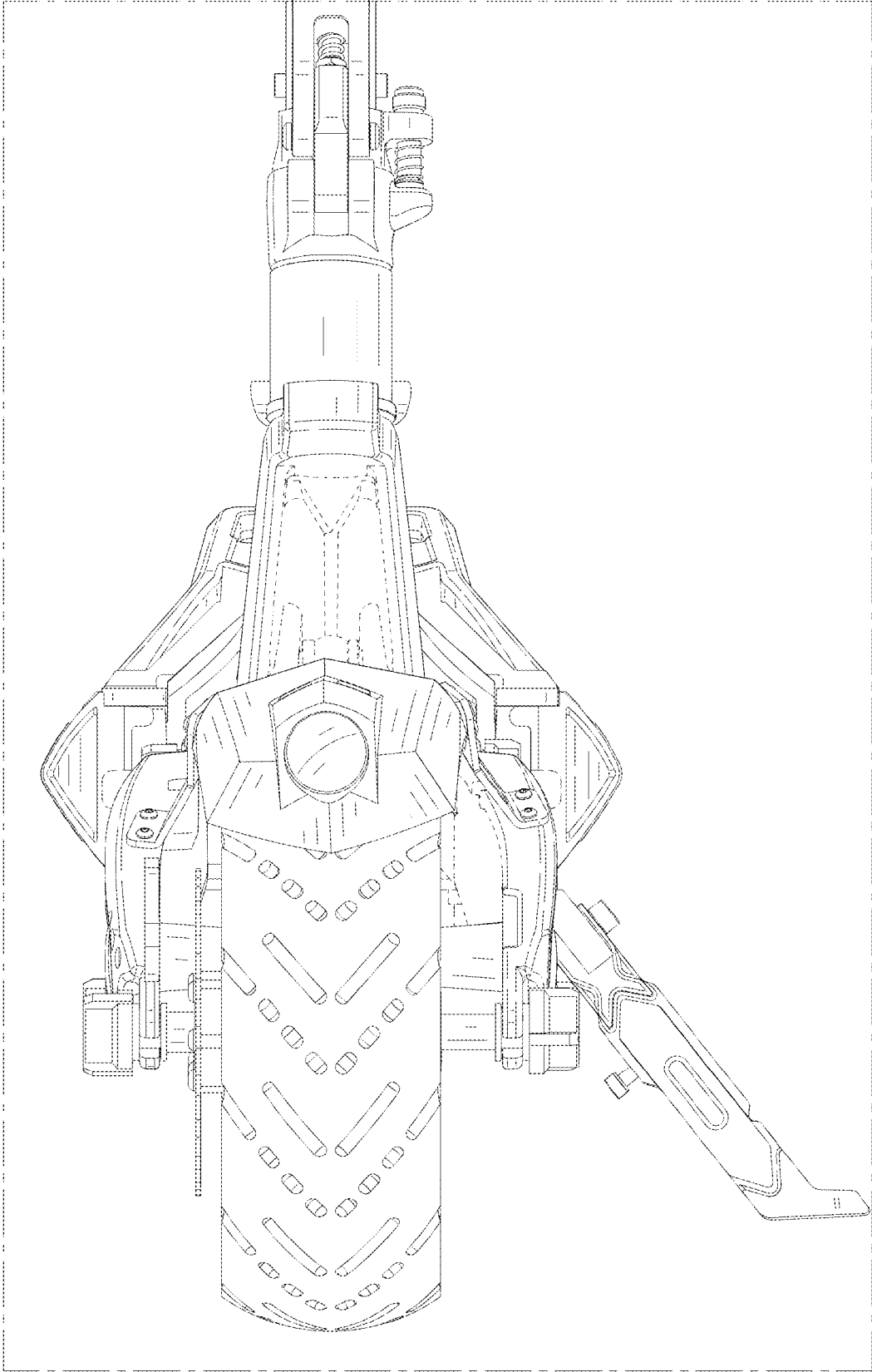

FIG. 17

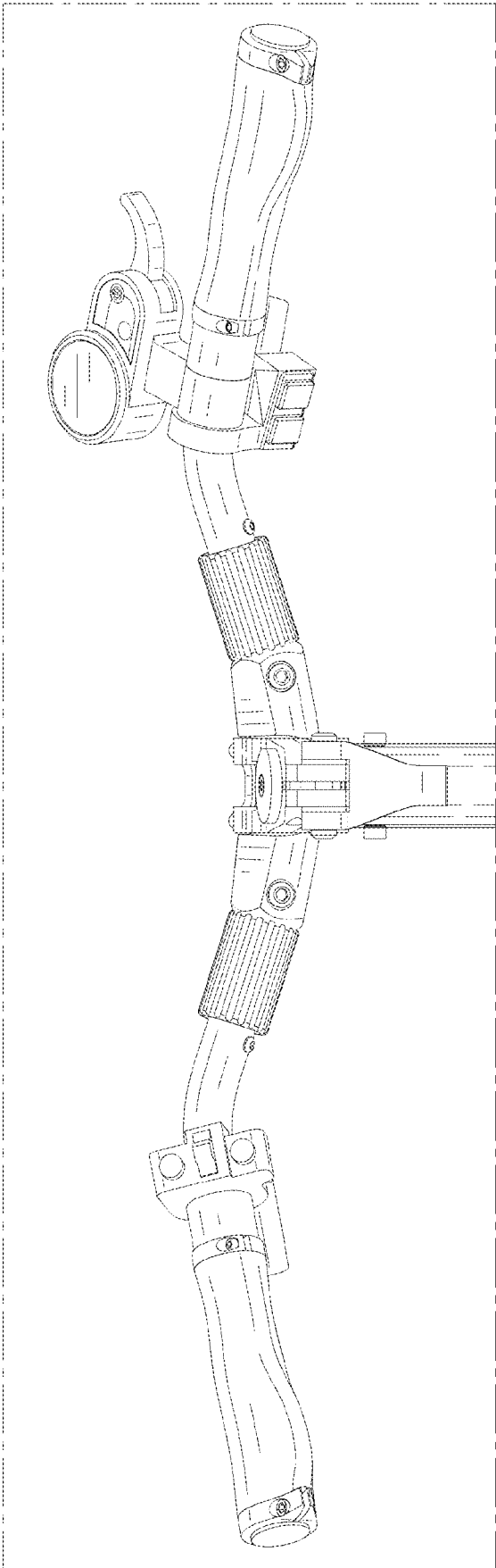

FIG. 18

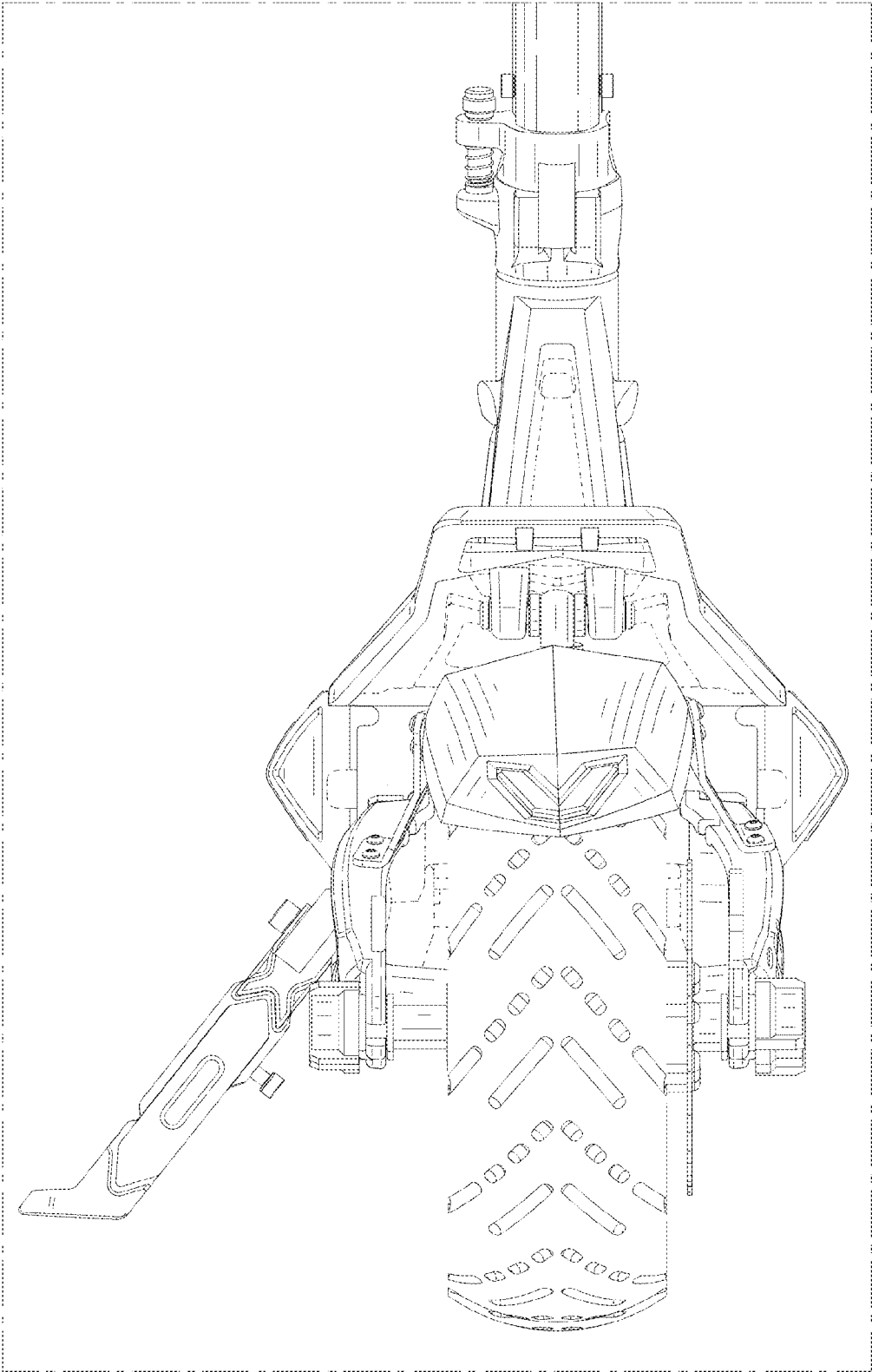

FIG. 19

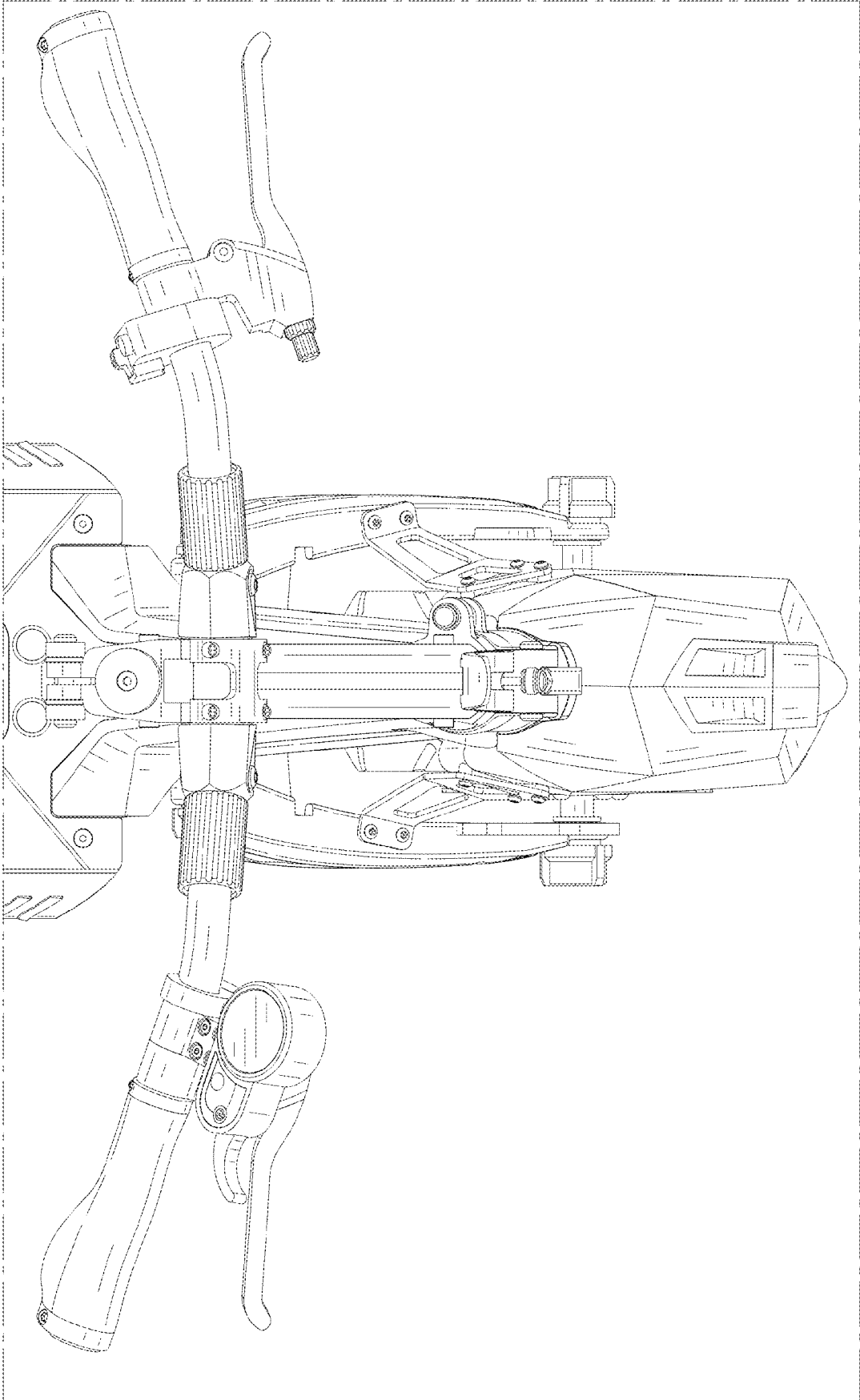

FIG. 20

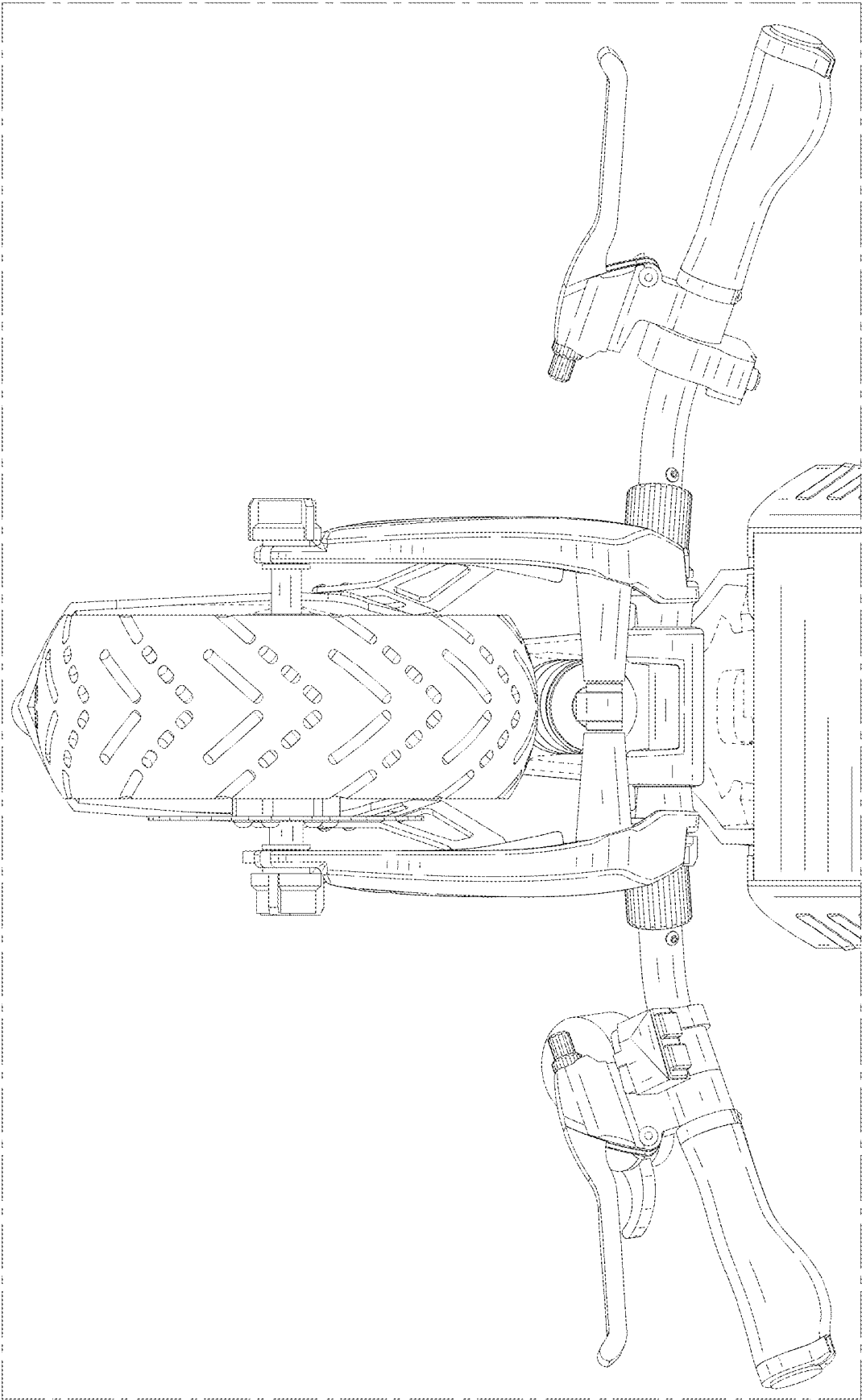

FIG. 21