



(12) **DEMANDE DE BREVET CANADIEN
CANADIAN PATENT APPLICATION**

(13) **A1**

(86) Date de dépôt PCT/PCT Filing Date: 2015/08/12
(87) Date publication PCT/PCT Publication Date: 2016/02/18
(85) Entrée phase nationale/National Entry: 2018/02/09
(86) N° demande PCT/PCT Application No.: CA 2015/000460
(87) N° publication PCT/PCT Publication No.: 2016/023101
(30) Priorité/Priority: 2014/08/12 (US62/036,305)

(51) Cl.Int./Int.Cl. *G05B 19/19* (2006.01),
B23Q 41/02 (2006.01), *B25J 9/18* (2006.01)

(71) Demandeur/Applicant:
TRANSFORMIX ENGINEERING INC., CA

(72) Inventeurs/Inventors:
ALMAS, ROBERT DAVID, CA;
MUNROE, PHILIP DAVID, CA;
NICHOLSON, KENNETH WAYNE, CA;
SMITH, MARTIN GEORGE, CA

(74) Agent: B HOLE IP LAW

(54) Titre : ASSEMBLAGE OU TRAITEMENT DE COMPOSANTS PAR COMMANDE NUMERIQUE INFORMATIQUE
(54) Title: COMPUTER NUMERICAL CONTROL ASSEMBLY OR PROCESSING OF COMPONENTS

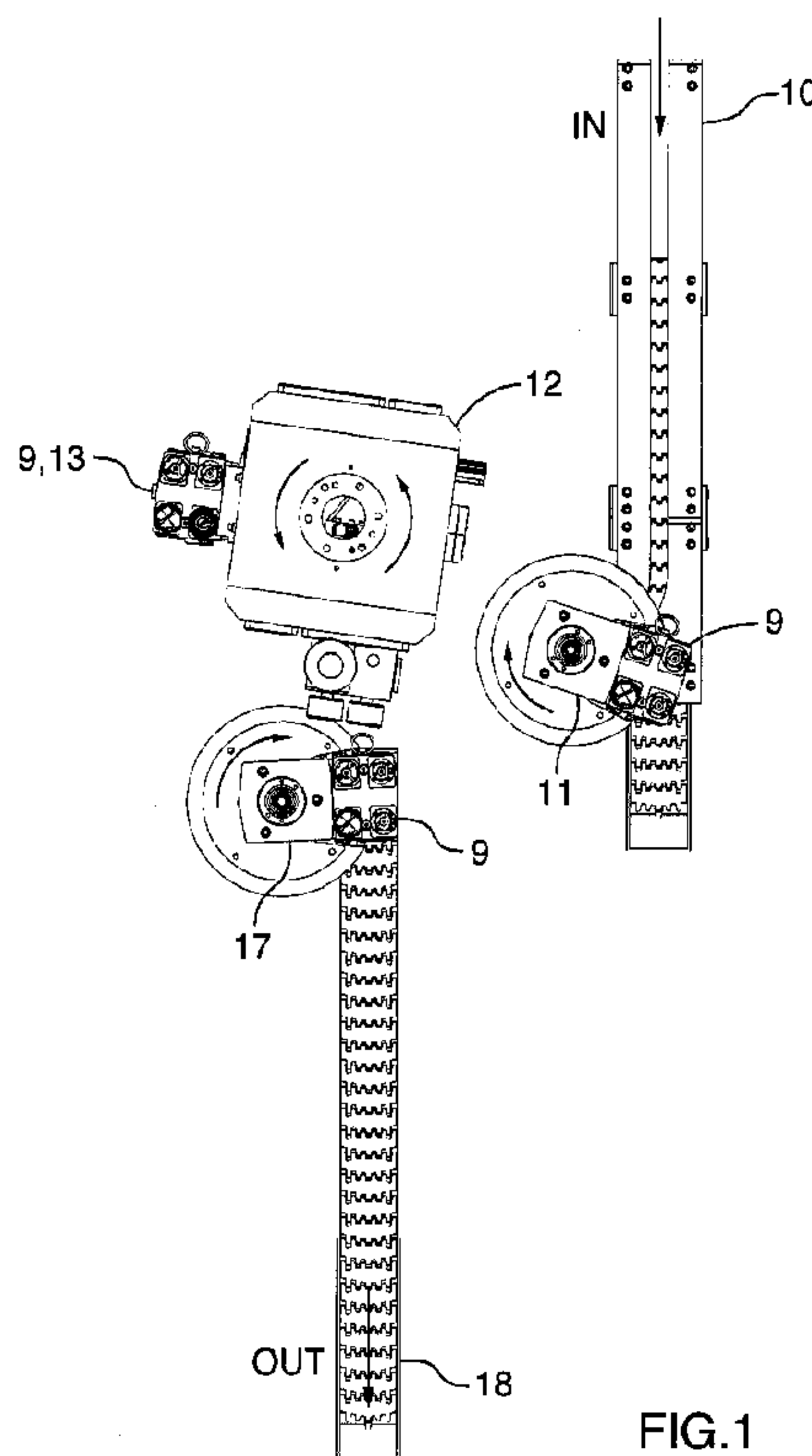

FIG.1

(57) **Abrégé/Abstract:**

The invention relates to a device, system and method of automated manufacture comprising: delivering a workpiece with a delivery device; receiving the workpiece with a receiving device, the delivering of the workpiece and the receiving of the workpiece being electronically synchronized; processing the workpiece with a processing tool while the workpiece is on the receiving device; transferring the workpiece to a completion device, the ejection of the workpiece and the transferring of the workpiece being electronically synchronized. In particular the workpiece may comprise: a platform with mounts supporting a first component in a selected orientation; and a locating surface, the method comprising: engaging and disengaging the locating surface of the workpiece with releasable connectors on the delivery device, on the receiving device and on the completion device.

(12) INTERNATIONAL APPLICATION PUBLISHED UNDER THE PATENT COOPERATION TREATY (PCT)

(19) World Intellectual Property
Organization
International Bureau(10) International Publication Number
WO 2016/023101 A1(43) International Publication Date
18 February 2016 (18.02.2016)

(51) International Patent Classification:

G05B 19/19 (2006.01) B25J 9/18 (2006.01)
B23Q 41/02 (2006.01)

(21) International Application Number:

PCT/CA2015/000460

(22) International Filing Date:

12 August 2015 (12.08.2015)

(25) Filing Language:

English

(26) Publication Language:

English

(30) Priority Data:

62/036,305 12 August 2014 (12.08.2014) US

(71) Applicant: TRANSFORMIX ENGINEERING INC.
[CA/CA]; 70 Railway Street, Kingston, ON K7K 2L8
(CA).

(72) Inventors: NICHOLSON, Kenneth Wayne; c/o Transformix Engineering Inc., 70 Railway Street, Kingston, Ontario K7K 2L8 (CA). MUNROE, Philip David; c/o Transformix Engineering Inc., 70 Railway Street, Kingston, ON K7K 2L8 (CA). SMITH, Martin George; c/o Transformix Engineering Inc., 70 Railway Street, Kingston, ON K7K 2L8 (CA). ALMAS, Robert David; c/o Transformix Engineering Inc., 70 Railway Street, Kingston, ON K7K 2L8 (CA).

(74) Agents: FIELD, Paul, J. et al.; NORTON ROSE FULBRIGHT CANADA LLP/S.E.N.C.R.L., s.r.l, 1 Place Ville Marie, Suite 2500, Montreal, Quebec H3B 1R1 (CA).

(81) Designated States (unless otherwise indicated, for every kind of national protection available): AE, AG, AL, AM, AO, AT, AU, AZ, BA, BB, BG, BH, BN, BR, BW, BY, BZ, CA, CH, CL, CN, CO, CR, CU, CZ, DE, DK, DM, DO, DZ, EC, EE, EG, ES, FI, GB, GD, GE, GH, GM, GT, HN, HR, HU, ID, IL, IN, IR, IS, JP, KE, KG, KN, KP, KR, KZ, LA, LC, LK, LR, LS, LU, LY, MA, MD, ME, MG, MK, MN, MW, MX, MY, MZ, NA, NG, NI, NO, NZ, OM, PA, PE, PG, PH, PL, PT, QA, RO, RS, RU, RW, SA, SC, SD, SE, SG, SK, SL, SM, ST, SV, SY, TH, TJ, TM, TN, TR, TT, TZ, UA, UG, US, UZ, VC, VN, ZA, ZM, ZW.

(84) Designated States (unless otherwise indicated, for every kind of regional protection available): ARIPO (BW, GH, GM, KE, LR, LS, MW, MZ, NA, RW, SD, SL, ST, SZ, TZ, UG, ZM, ZW), Eurasian (AM, AZ, BY, KG, KZ, RU, TJ, TM), European (AL, AT, BE, BG, CH, CY, CZ, DE, DK, EE, ES, FI, FR, GB, GR, HR, HU, IE, IS, IT, LT, LU, LV, MC, MK, MT, NL, NO, PL, PT, RO, RS, SE, SI, SK, SM, TR), OAPI (BF, BJ, CF, CG, CI, CM, GA, GN, GQ, GW, KM, ML, MR, NE, SN, TD, TG).

Declarations under Rule 4.17:

— as to applicant's entitlement to apply for and be granted a patent (Rule 4.17(ii))

Published:

— with international search report (Art. 21(3))
— with amended claims (Art. 19(1))

(54) Title: COMPUTER NUMERICAL CONTROL ASSEMBLY OR PROCESSING OF COMPONENTS

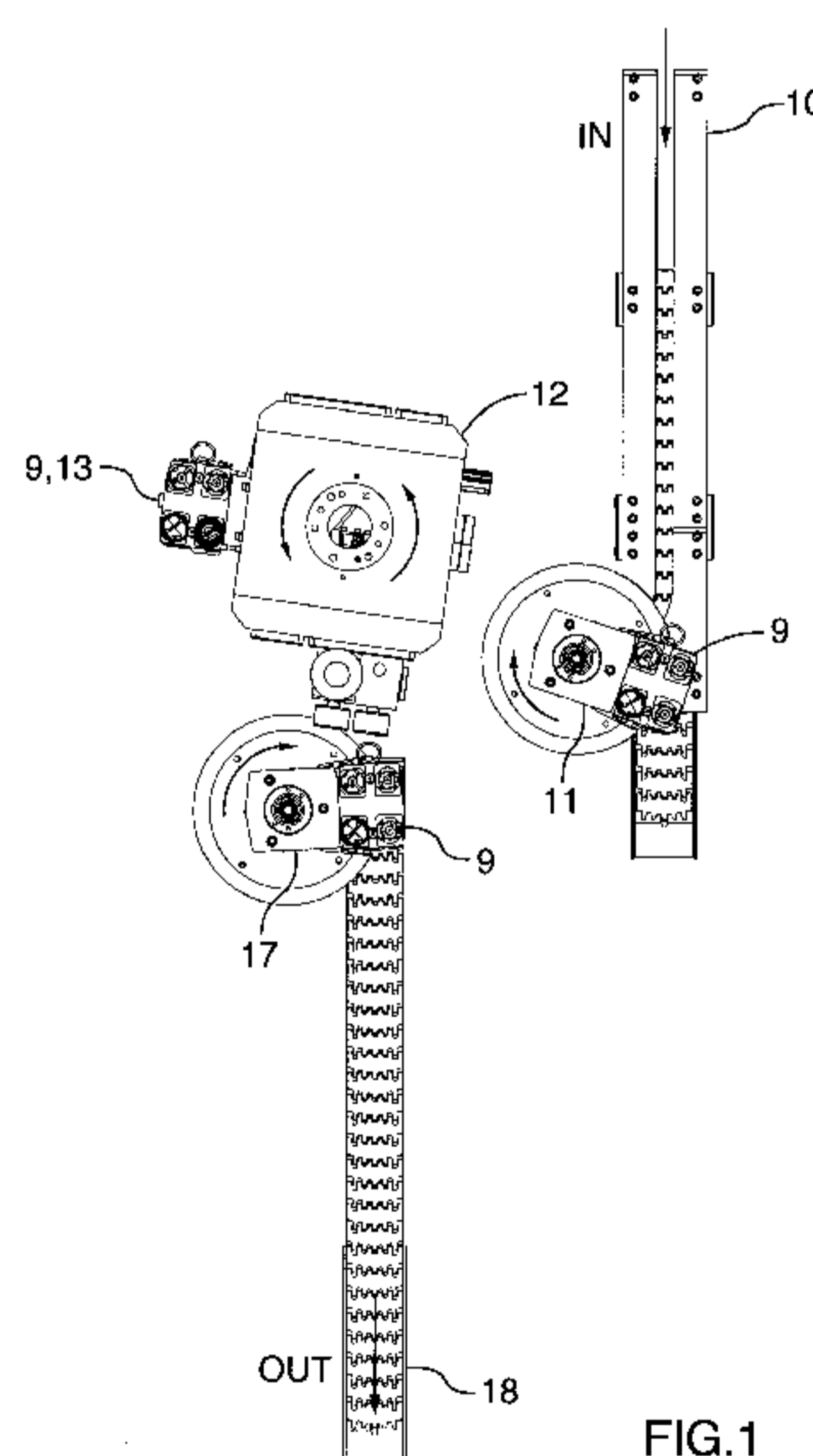

FIG.1

(57) Abstract: The invention relates to a device, system and method of automated manufacture comprising: delivering a workpiece with a delivery device; receiving the workpiece with a receiving device, the delivering of the workpiece and the receiving of the workpiece being electronically synchronized; processing the workpiece with a processing tool while the workpiece is on the receiving device; transferring the workpiece to a completion device, the ejection of the workpiece and the transferring of the workpiece being electronically synchronized. In particular the workpiece may comprise: a platform with mounts supporting a first component in a selected orientation; and a locating surface, the method comprising: engaging and disengaging the locating surface of the workpiece with releasable connectors on the delivery device, on the receiving device and on the completion device.



WO 2016/023101 A1

**COMPUTER NUMERICAL CONTROL ASSEMBLY
OR PROCESSING OF COMPONENTS**

TECHNICAL FIELD

[0001] The invention relates to an automated method of
5 assembling or processing components using computer
numerical controlled devices wherein the timing, position,
speed, velocity, and acceleration of the components during
each stage of assembly or processing are synchronized
through programming of the computer numerical controls.
10 The method provides for use of a standardized platform and
carrier for mounting and handling of multiple components
simultaneously.

BACKGROUND OF THE ART

[0002] Manufacturing of products includes the automated
15 creation and processing of parts, and the assembly of the
finished product from parts. In the following description
the term "component" is chosen as a general term to
describe individual parts, an assembly of parts, materials
such as adhesives, weld consumables or plastic to be
20 molded, and the final product of a manufacturing process.

[0003] The Applicant in international publication WO
2014/078938 has described a method of manufacturing that
uses computer numerically controlled drives to move and
process components through various stages where the timing,
25 position, orientation, linear or rotary velocity, and
acceleration of the components and devices that
deliver/receive components are matched. Computer numerical

- 2 -

control of linear or drives, actuators, sensors and other devices is coordinated through programming known as "electronic camming".

[0004] Electronic camming coordinates the actuation of multiple mechanisms through electronic controls and software. The mechanisms need not physically interact and synchronization of their motions is electronically controlled with extreme accuracy and flexibility through software interaction. Electronic camming links movements of devices through electronic means (i.e. software), conceptually in the same manner that gears, linkages, and timing chains link movements of mechanical devices together, with enhanced accuracy, control and design flexibility.

[0005] An application of electronic camming in the processing of single components or assembling of multiple components together is described in international publication WO 2014/078938 that can be summarized as follows. A first component is loaded , separated from an intake stream and accelerated. The component is delivered at a predetermined delivery time, delivery position, delivery speed and moving along a delivery trajectory to be delivered to and received by a processing tool that is also moving. The motions of the delivery device and the processing tool receiving of the component are electronically synchronized. The transfer of the component from one device to the other is coordinated and timed electronically. Through the processing or assembly process, the actuators that move the devices to handle the

- 3 -

component are electronically cammed and synchronized together.

[0006] The same concept can be applied to each stage of a manufacturing process where separate devices have their
5 motions coordinated through electronic camming and CNC program software. Manufacturing involves storage of material/components, motion control, and processing of material/components, for example: molding, forming, cutting, bonding, welding, stamping, dispensing,
10 assembling, fastening; as well as inspecting, testing, measuring and rejecting failed material/components.

[0007] In many of the manufacturing stages, accurately timed and controlled movement of material and components is critical. During automated manufacturing accurate
15 coordinated control of motion and processing activities can be provided through electronic control of actuators, servo motors, sensors, switches, valves and the like, that are linked by software.

[0008] Features that distinguish the present invention
20 from the background art will be apparent from review of the disclosure, drawings and description of the invention presented below.

DISCLOSURE OF THE INVENTION

[0009] The invention relates to processing and handling
25 of individual components or multiple components grouped together on a standardized platform or carrier to be processed and handled without contact with the individual components. To include both cases the general term

- 4 -

"workpiece" is used to encompass processing and handling of both the individual components and a platform or carrier on which multiple components are mounted.

[00010] The invention provides a method of automated
5 manufacture comprising: delivering a workpiece with a
delivery device by: loading the workpiece at an intake
position of the delivery device; separating the workpiece
by moving the workpiece from the intake position;
accelerating the workpiece; and presenting the workpiece at
10 a predetermined delivery time, delivery position, delivery
speed and moving along a delivery trajectory; receiving the
workpiece with a receiving device moving along a receiving
trajectory configured to permit transfer of the workpiece
at the delivery position from the delivery device to the
15 receiving device, the delivering of the workpiece and the
receiving of the workpiece being electronically
synchronized; processing the workpiece with a processing
tool while the workpiece is on the receiving device;
presenting the workpiece at a predetermined ejection time,
20 ejection position, ejection speed and moving along an
ejection trajectory; transferring the workpiece to a
completion device moving along a completion trajectory
configured to permit transfer of the workpiece at the
ejection position from the receiving device to the
25 completion device, the ejection of the workpiece and the
transferring of the workpiece being electronically
synchronized. In particular the workpiece may comprise: a
platform with mounts supporting a first component in a
selected orientation; and a locating surface, the method
30 comprising: engaging and disengaging the locating surface

- 5 -

of the workpiece with releasable connectors on the delivery device, on the receiving device and on the completion device.

[00011] In another aspect, the disclosure describes a system comprising: a delivery device configured to deliver a workpiece by: loading the workpiece at an intake position of the delivery device; separating the workpiece by moving the workpiece from the intake position; accelerating the workpiece; and presenting the workpiece at a predetermined delivery time, delivery position, delivery speed and moving along a delivery trajectory; a receiving device configured to receive the workpiece by moving along a receiving trajectory configured to permit transfer of the workpiece at the delivery position from the delivery device to the receiving device, and to present the workpiece at a predetermined ejection time, ejection position, ejection speed and moving along an ejection trajectory; a processing tool configured to process the workpiece while the workpiece is on the receiving device; a completion device configured to accept transfer of the workpiece at the ejection position from the receiving device after processing, the completion device moving along a completion trajectory, a data processor; and a medium comprising machine-readable instructions executable by the data processor and configured to cause the data processor to generate signals useful in the synchronization of the: delivering of the workpiece and the receiving of the workpiece; processing of the workpiece; and transferring of the workpiece to the completion device. In a further aspect of the invention the workpiece comprises: a platform

- 6 -

with mounts supporting a first component in a selected orientation; and a locating surface; and wherein the machine-readable instructions are configured to cause the data processor to generate signals useful in the synchronization of the: engaging and disengaging the locating surface of the workpiece with releasable connectors on the delivery device, on the receiving device and on the completion device. In a further aspect of the invention each of the delivery device, the receiving device, the processing tool and the competition device have motion actuators each with at least one axis of motion; and wherein the machine-readable instructions are configured to cause the data processor to generate signals useful in the controlling motion on each of the at least one axis of motion using a plurality of servo applications electronically cammed together on a standardized backplane of coded instructions.

[00012] In another aspect, the disclosure describes an automated device comprising: a delivery device having a numerically controlled delivery drive for: loading a workpiece at an intake position of the delivery device; separating the workpiece by moving the workpiece from the intake position; accelerating the workpiece; and presenting the workpiece at a predetermined delivery time, delivery position, delivery speed and moving along a delivery trajectory; a receiving device having a numerically controlled receiving drive for moving along a receiving trajectory configured to permit transfer of the workpiece at the delivery position from the delivery device to the receiving device; a processing device having a numerically

- 7 -

controlled processing drive for processing the workpiece with a processing tool while the workpiece is on the receiving device; the numerically controlled receiving device being configured for presenting the workpiece at a predetermined ejection time, ejection position, ejection speed and moving along an ejection trajectory; a completion device having a numerically controlled completion drive for moving along a completion trajectory configured to transfer the workpiece at the ejection position from the receiving device to the completion device, the delivering of the workpiece and the receiving of the workpiece being electronically synchronized by the numerically controlled delivery and receiving drives, the processing of the workpiece being electronically synchronized by the numerically controlled processing drive, and the ejection of the workpiece and the transferring of the workpiece being electronically synchronized by the numerically controlled delivery and receiving drives, wherein the workpiece comprises: a platform with mounts supporting a first component in a selected orientation ; and a locating surface; and the delivery device, the receiving device and the completion device include releasable connectors for engaging and disengaging the locating surface of the workpiece.

25 **DESCRIPTION OF THE DRAWINGS**

[00013] In order that the invention may be readily understood, embodiments of the invention are illustrated by way of examples in the accompanying drawings.

- 8 -

[00014] Figure 1 is a plan view of a "rotary engine" embodiment including linear input and output conveyors, a rotary delivery device for moving a workpiece from the input conveyor to the central rotary receiving device, the receiving device having processing tools mounted thereon, and a rotary completion device for moving a workpiece from the central rotary receiving device to the output conveyor.

[00015] Figure 2 is a side perspective view of an example workpiece having a platform with mounts supporting two sets of components in a selected orientation, the platform being supported on locating pins and a base, where the locating pins are gripped by releasable grip fingers to handle and position the components for assembly together during processing.

[00016] Figure 3 is a side perspective view of the workpiece of Figure 2 with the locating pins being gripped by grip fingers of the rotating delivery device and removing the workpiece from the input conveyor.

[00017] Figure 4 is a side perspective view of the rotating receiving device, also with grip fingers engaging the locating pins of the workpiece, showing the processing device in position to vertically engage two cap components to be assembled on to the two body components radially inboard.

[00018] Figure 5 is a side perspective view of the rotary engine of Figure 1, absent the input and output conveyors, and showing three workpieces being gripped by the grip fingers of the delivery, receiving and completion devices.

- 9 -

[00019] Figure 6 is a side perspective view of a "pick and place engine" embodiment showing a linear conveyor supplying a stream of components to a rotary input indexing platform (i.e. delivery device), a stationary post housing an optical scanner (i.e. an example of many possible processing devices), a pick and place robot (i.e. receiving device) that transfers and orients components from the indexing platform to the mounts on the platform of the workpiece disposed on a linear actuated screw conveyor (i.e. completion device).

[00020] Figure 7 is a side perspective view of an alternative "pick and place engine" embodiment showing a linear conveyor in the foreground supplying a stream of components to the rotary input indexing platform, a stationary post housing an optical scanner, a pick and place robot that transfers and orients components from the indexing platform to the mounts on the top platform of a movable carrier disposed on an oval servo actuated track conveyor.

[00021] Figure 8 is a side perspective view of a "multiplex engine embodiment" where the linear actuated screw conveyor (i.e. completion device) serves both to input components from the workpiece and to output components back to the workpiece (components being supplied on mounts supported by the workpiece platform, locating pins and base), the pick and place robot (i.e. receiving device) transfers and orients components on the rotary indexing platform (i.e. delivery device) to be processed by the optical scanner housed on the stationary post (i.e. processing device), the pick and place robot (i.e.

- 10 -

receiving device) also transfers and orients components from the rotary indexing platform and returns the components to the mounts on the platform of the workpiece disposed on the linear actuated screw conveyor (i.e. completion device).

[00022] Figure 9 is a side perspective view of a second "multiplex engine embodiment" where the linear actuated screw conveyor (completion device) of Figure 7 is replaced with a linear actuated servo driven carrier (completion device) having a top platform with mounts on which components are input and output, and the other elements remain the same as Figure 7 (pick and place robot, rotary indexing platform, optical scanner processing device).

[00023] Figure 10 is a plan view of an integrated system including a central oval shaped track with multiple linear actuated servo driven carriers supplying components to engines or processing stations located around the track.

[00024] Further details of the invention and its advantages will be apparent from the detailed description included below.

DETAILED DESCRIPTION OF PREFERRED EMBODIMENTS

[00025] This description employs the terms "delivery device", "receiving device, and "completion device" merely to imply a progression of the workpiece or processing from delivery to receiving to completion. Alternative terms could be used such as first, second and third to imply the same progression. Any of the devices can simply transfer workpieces from one location or position to another without

- 11 -

processing or changing the workpiece. Any of the devices can also be a platform that includes tools or processing to perform some value-added function to the workpiece for example scanning, forming, welding, assembling, changing orientation or applying adhesives. Further although many of the devices are shown as rotating, the description herein uses general terms which are meant to also include devices that translate in a linear motion, in x-y-z Cartesian motion, in a curved trajectory or any other motion.

[00026] The rotary engine embodiment shown in Figures 1 and 5 is configured to handle and process two pairs of components that are initially mounted on standardized pallets or "PODs" 1. The POD 1 with four components (2, 3) are best shown in Figure 2 and handling by the rotary indexing tables and processing on the central rotary tool platform are shown in Figures 3 and 4 respectively.

[00027] Referring to Figure 2, the PODs 1 are initially loaded with spray bottle top components, being two caps 2 and two bodies 3, on mounts 4 that are designed to hold the caps 2 and bodies 3 in a specified rotational orientation. The mounts 4 can easily be removed and replaced depending on the type of components being handled and processed. The POD 1 is handled and processed as an individual workpiece and handling of individual components (2, 3) is limited thereby maintaining the orientation and avoiding damage from contact during handling. PODs 1 can be loaded with caps 2 and bodies 3 by a pick and place robot, by manual labor, during the plastic molding process or by various automated means, including pick and place robots as

- 12 -

described below. The example illustrated shows two caps 2 and two bodies 3. It will be understood that the standardized use of a platform 5 with replaceable mounts 4 permits variations such as mounting of any number of identical parts that can fit on the platform 5, or mounting of any number of different components in multiple rows and columns depending on the processing or assembly required.

[00028] The POD 1 in the example shown in Figure 2 has a platform 5 and a base 6 joined with two locating pins 7. Each pin 7 has an accurate locating surface, shape and position, as well as locating grooves 8 to be accurately engaged and disengaged during handling by releasable connectors shown as grip fingers 9 (see Figs. 3-4). The grip fingers 9 open and close to engage the locating pins 7 very accurately during handling and processing. For example, the grip fingers 9 can include locating ridges (not shown) that mate with the locating grooves 8 to engage and secure the PODs 1 within suitable tolerances for highly accurate handling, assembly and processing.

[00029] An advantage using PODs 1 is that, once the other machinery has been set up to process the PODs 1 as workpieces, to process different sized or shaped components (2, 3) the major portion of the machinery need not be extensively modified. Modification is limited to the mounts 4 and to other replaceable tools or parts that contact the components (2,3). The costs and downtime involved in retooling a system to process different components is greatly reduced in many cases.

- 13 -

[00030] Referring to Figures 1 and 5, PODs 1 as workpieces are loaded with caps 2 and bodies 3 and supplied in an input stream along the input conveyor 10 to a intake position adjacent the rotary delivery device 11. Figure 3
5 shows a detail of the the POD 1 with the locating pins 7 being gripped by grip fingers 9 of the rotating delivery device 11 and removing the POD 1 or workpiece from the input conveyor 10.

[00031] The POD 1 is delivered to the rotating receiving
10 device 12 by the delivery device 11 in a synchronized manner by bringing the stationary POD 1 on the input conveyor 10 up to a rotary speed that matches the rotary speed of the receiving device 12 at the time when the pod 1 is transferred.

15 [00032] The steps of doing so can be summarized as "rapid speed matching" (RSM) which includes: loading the workpiece POD 1 at the intake position; separating the workpiece POD 1 from other PODs 1 and the input conveyor 10 by moving the POD 1 from the intake position; rotationally accelerating
20 the POD 1; and presenting the POD 1 to the open grip fingers 9 of the rotating receiving device 12 at a predetermined delivery time, delivery position, delivery speed and moving along a delivery trajectory. The POD 1 is released by opening the grip fingers 9 of the rotating
25 delivery device 11 and engaged by closing the grip fingers 9 of the rotating receiving device 12 at the predetermined delivery time. Instantaneous coordination of these movements is provided by electronic camming software controlling all of the required actuators. To do so the
30 receiving device 12 moves along a receiving trajectory

- 14 -

configured to permit transfer of the POD 1 at the delivery position from the delivery device 11 to the receiving device 12, where the delivering of the POD 1 and the receiving of the POD 1 are electronically synchronized.

5 [00033] At this point the POD 1 is secured to the rotating receiving device 12 by the grip fingers 9 as shown in Figure 4. In the example illustrated, the receiving device 12 also houses a vertically and horizontally actuated processing tool 13 which assembles and tests the
10 components (2, 3) on the POD 1 together as follows.

[00034] As shown in Figure 2, the bodies 3 include a spray nozzle openings 14. The platform 5 includes two fluid ports 15 which can convey pressurized air, via channels through the platform 5 and the mounts 4, to the
15 spray nozzle openings 14. After assembly of spray nozzles (not shown) into the openings 14, the pressurized air flow is used to test whether the assembly can properly convey air flow through the body 3 and nozzle (not shown) before the cap 2 is assembled to the body 3.

20 [00035] Referring to Figure 4, the grip fingers 9 hold the pod 1 in position on the receiving device 12. Nozzle holders 16 retain nozzles (not shown) and move radially outwardly (to left as drawn) to install a nozzle in each of the spray nozzle openings 14. The nozzle holders 16 then
25 move vertically downward the end of the nozzle holder 16 to seal against the fluid ports 15 in the platform 5. Compressed air conveyed through the nozzle holder 16 and fluid ports 15 passes through the nozzle (not shown) to produce a positive test result. If air flow is not

- 15 -

detected, by no air pressure change for example, the assembled body 3 and nozzle are rejected downstream. If a positive air flow test is detected, the processing device 13 is lowered to pick up the caps 2 from the mounts 4. 5 Then the processing device 13 moves radially inward and down to place the caps 2 on the bodies 3 to complete assembly.

[00036] As shown in Figures 1 and 5, the rotary engine also includes a rotary completion device 17 for moving the 10 POD 1 bearing two completed assemblies (bodies 3 with nozzles and caps 2) from the central rotary receiving device 12 to the output conveyor 18.

[00037] In the example shown, when considered relative to the axis of the receiving device 12, the angular spacing 15 between the delivery device 11 and the completion device 17 is less than 90° which leaves more than 270° of rotation during which the receiving device 12 and processing tool 13 have time to test and assemble the components (2, 3). However it will be understood that the rotation speed of 20 the receiving device 12 need not be constant. Electronic camming software can be coded to speed up and slow down rotation in any manner desired to provide sufficient time for testing and assembly actions.

[00038] Once assembly or processing is completed, using 25 the processing tool 13 while the POD 1 is on the receiving device 12, the POD 1 is presented at a predetermined ejection time, ejection position, ejection speed and moving along an ejection trajectory by computer numerical control of the rotary driver of the receiving device 12. The POD 1

- 16 -

is transferred from the grip fingers 9 of the rotating receiving device 12 to the open grip fingers 9 of the rotating completion device 17. The rotating completion device 17 moves along a completion trajectory configured to permit transfer of the POD 1 at the ejection position from the receiving device 12 to the completion device 17, the ejection of the POD 1 and the transferring of the POD 1 being electronically synchronized. The completion device 17 is a rotary actuated input indexing platform with grip fingers 9 configured to place the POD 1 from the receiving device 12 into an output stream of like PODs 1 on the output conveyor 18. To do so the rotary speed of the completion device 17 must change from matching the rotary speed of the receiving device 12 to match the speed of the output conveyor 18. Of course all devices could be programmed to rotate continuously like meshed gears, however with separate electronic camming controls each device is able to change rotational velocity and even direction to suit any desired timing and processing plan.

[00039] All of the movements described above are controlled by electronic camming software and other software dedicated to the rotary engine. The rotary engine is an example of the grouping of electronically cammed devices which together can be integrated as a unit into various larger systems as a sub-system. The electronically cammed system includes a data processor and a information storage medium to record machine-readable instructions executable by the data processor and configured to cause the data processor to generate signals to synchronize the delivering of the workpiece (POD 1 or individual components

- 17 -

2, 3) and the receiving of the workpiece; processing of the workpiece; transferring of the workpiece to the completion device 17; engaging and disengaging the locating pins 7 of the PODs 1 with releasable connectors or grip fingers 9 on the delivery device 11, on the receiving device 12 and on the completion device 17.

[00040] Besides the "rotary engine" described above, the benefits of grouping devices together into standardized "engines" or sub-systems has been found useful in designing and assembling larger more complex manufacturing systems. Each sub-system provides for common functions and can be built and tested separately. As suggested by the system shown in Figure 10, a system can be centered around a core material handling device, such as the oval shaped linear servo track conveyor with individually controlled carriers that transport workpieces, components or tools. One such servo conveyor is marketed by Rockwell Automation under the trade mark iTRAC™ for example and so need not be explained in detail herein.

[00041] A system may be conceptualized as a n-axis system level robot having a potentially limitless or n-axes of motion distributed throughout all integrated devices. A central device such as a servo conveyor can act as a master axis device with auxiliary devices around the conveyor acting as slave devices with their own slave axes in coordination with the master axis device. The system has a central control where software generates signals for synchronizing of the: delivering of the workpiece and the receiving of the workpiece; processing of the workpiece; and transferring of the workpiece to the completion device,

- 18 -

as well engaging and disengaging the grip fingers 9 and all other motions. Each of the delivery device, the receiving device, the processing tool and the competition device comprise actuators each with at least one axis of motion; and software generates signals to control motion on each axis of motion using standardized servo applications electronically camed together on a standardized backplane of coded instructions. The common servo application software leads to common software for groupings of devices into sub-systems, named "engines" herein. Common engine or sub-system software combined in an electronically camed n-axis system level robot, leads to efficiencies in designing and building through standardization.

[00042] Figures 6, 7, 8 and 9 show example "engines" that can group common functions and devices together in a sub-system for use alone for simple processes or as a sub-system of an integrated manufacturing system shown in Figure 10.

[00043] Figure 6 shows a "pick and place engine" embodiment with a linear conveyor 20 supplying a stream of individual components (for example caps 2, and/or bodies 3) to be picked by a rotary input indexing platform 21 (delivery device). Multiple linear conveyors 20 could be arranged for example radiating out from the rotation axis of the indexing platform 21 to supply multiple streams of different components or multiple streams of PODs, but for the simplicity of illustrating the concept only one conveyor 20 is shown. An optical scanner 22 (processing device) is housed in a stationary post 23 to scan components on the indexing platform 21. It will be

- 19 -

understood that the optical scanner 22 is only an example of a possible processing device and that the post 23 may be actuated for any type of motion or include assembly tools if desired.

5 [00044] The pick and place robot 24 (receiving device) rotates and orients components from the indexing platform 21 to transfer the components on the mounts 4 of the PODs 1 disposed on a linear actuated screw conveyor 25 (completion device). Therefore the pick and place engine or sub-system
10 is made up from a delivery device comprising a rotary actuated input indexing platform 21 configured to pick a component (such as a cap 2 or body 3) from an input stream of like components supplied by the linear conveyor 20. The receiving device comprises a pick and place robot 24 and
15 the completion device comprises a linear actuated conveyor 25 configured to accept the components (2, 3) from the pick and place robot 24 onto a POD 1.

[00045] Figure 7 shows an alternative embodiment of the pick and place engine of Figure 6. The linear conveyor 20
20 supplies a stream of individual components (2, 3 for example) to the rotary indexing platform 21 and passes the components under the optical scanner 22 mounted on the post 23. The post 23 and optical scanner 22 could be replaced by any processing device such as an assembly tool mounted
25 on a rotating platform. The screw conveyor 25 of Figure 6 is replaced in Figure 7 with a linear actuated servo drive conveyor 26 having a plurality of servo drive carriers 27 that travel thereon. The top platform 28 of the carriers 27 have mounts 4 on which the components 2, 3 are placed by
30 the pick and place robot 24. The pick and place robot 24

- 20 -

receives signals from the optical scanner 23 and while transferring the components 2, 3 to the mounts 4, end effectors rotate the components 2, 3 to the appropriate rotational orientation on the mounts 4. The PODs 1 can also be mounted to the top platforms 28 of the carriers 27 although this option has not been illustrated.

[00046] Figure 8 shows a "multiplex engine embodiment" where the linear actuated screw conveyor 25 (completion device) serves as a two way conveyor, both to input components (caps 2, bodies 3) from the PODs 1 and to output components (2, 3) back to the PODs 1. Components (2, 3) are supplied on the mounts 4 of the PODs 1 engaged by the conveyor 25. The pick and place robot 24 (receiving device) transfers and orients individual components (2, 3) on the rotary indexing platform 21 (delivery device) to be processed. Processing in the example illustrated has two stages, scanning and assembly. First the components on the rotary indexing table 21 are scanned by the optical scanner 22 housed on the stationary post 23 (processing device) and then components are assembled together with an assembly tool 33. The assembly tool 33 is mounted on a rotary platform 34 that rotates to pick up a different part or component that is assembled to the component on the rotary indexing table 21. After processing, the pick and place robot 24 transfers and orients the assembled components from the rotary indexing platform 21 and returns the assembled components (2, 3) to the mounts 4 on the PODs 1 conveyed on the linear actuated screw conveyor 25 (completion device). Therefore the multiplex engine is a sub-system where the delivery device comprises a rotary

- 21 -

actuated input indexing platform 21, the receiving device comprises a pick and place robot 24 and the completion device comprises a linear actuated conveyor 25 configured to present the components (2, 3) on the PODs 1 to the pick and place robot 24 before processing and to accept onto the PODs 1 the components (2, 3) from the pick and place robot 24 after processing.

[00047] Figure 9 shows a second "multiplex engine embodiment" where the linear actuated screw conveyor 25 (completion device) of Figure 8 is replaced with a linear actuated conveyor 26 with an individual controlled servo driven carrier 27 (completion device). Each carrier 27 has a top platform 28 with mounts 4 on which components (2, 3) are input and output. The other elements remain the same as Figure 8, i.e. the pick and place robot 24, rotary indexing platform 21, optical scanner 22 processing device, post 23, assembly tool 33 and rotary platform 34.

[00048] Referring to the integrated system of Figure 10, the oval linear servo conveyor 19 can be the type shown in Figure 9 having a linear conveyor 26 with several individual carriers 27 each being individually controlled to move on a conveyor track between various sub-systems or engines. For example the carriers 27 may be conveyed counterclockwise past: two pick and place engines 29; one rotary engine 30; and pneumatic conveyors 31, 32 which accept completed assemblies and rejected components.

[00049] Although the above description relates to a specific preferred embodiment as presently contemplated by the inventors, it will be understood that the invention in

- 22 -

its broad aspect includes mechanical and functional equivalents of the elements described herein.

AMENDED CLAIMS
received by the International Bureau on
10 December 2015 (10.12.2015)

WE CLAIM:

1. A method comprising:

delivering a workpiece with a delivery device by: loading the workpiece at an intake position of the delivery device; separating the workpiece by moving the workpiece from the intake position; accelerating the workpiece; and presenting the workpiece at a predetermined delivery time, delivery position, delivery speed and moving along a delivery trajectory;

receiving the workpiece with a receiving device moving along a receiving trajectory configured to permit transfer of the workpiece at the delivery position from the delivery device to the receiving device, the delivering of the workpiece and the receiving of the workpiece being electronically synchronized;

processing the workpiece with a processing tool while the workpiece is on the receiving device;

presenting the workpiece at a predetermined ejection time, ejection position, ejection speed and moving along an ejection trajectory, wherein the workpiece comprises: a platform with mounts supporting a first component in a selected orientation ; and a locating surface;

transferring the workpiece to a completion device moving along a completion trajectory configured to permit transfer of the workpiece at the ejection position from the receiving device to the completion device, the ejection of the workpiece and the transferring of the workpiece being electronically synchronized, and

engaging and disengaging the locating surface of the workpiece with releasable connectors on the delivery device, on the receiving device and on the completion device.

2. The method according to claim 1 wherein the platform has mounts supporting a second component, the method comprising:

assembling the first and second components together with the processing tool while the workpiece is on the receiving device.

3. The method according to claim 1 wherein the platform and mounts include a fluid port, the method comprising:

conveying fluid from the processing tool to the fluid port while the workpiece is on the receiving device.

4. A system comprising:

a delivery device configured to deliver a workpiece by: loading the workpiece at an intake position of the delivery device; separating the workpiece by moving the workpiece from the intake position; accelerating the workpiece; and presenting the workpiece at a predetermined delivery time, delivery position, delivery speed and moving along a delivery trajectory, wherein the workpiece comprises: a platform with mounts supporting a first component in a selected orientation; and a locating surface;

a receiving device configured to receive the workpiece by moving along a receiving trajectory configured to permit transfer of the workpiece at the delivery position from the delivery device to the receiving device, and to present the workpiece at a predetermined ejection time, ejection position, ejection speed and moving along an ejection trajectory;

a processing tool configured to process the workpiece while the workpiece is on the receiving device;

a completion device configured to accept transfer of the workpiece at the ejection position from the receiving device

after processing, the completion device moving along a completion trajectory,

a data processor; and

a medium comprising machine-readable instructions executable by the data processor and configured to cause the data processor to generate signals useful in the synchronization of the:

delivering of the workpiece and the receiving of the workpiece;

processing of the workpiece; and

transferring of the workpiece to the completion device,

wherein the machine-readable instructions are configured to cause the data processor to generate signals useful in the synchronization of the: engaging and disengaging the locating surface of the workpiece with releasable connectors on the delivery device, on the receiving device and on the completion device.

5. The system as defined in claim 4:

wherein each of the delivery device, the receiving device, the processing tool and the completion device comprise actuators each with at least one axis of motion; and

wherein the machine-readable instructions are configured to cause the data processor to generate signals useful in the controlling motion on each of the at least one axis of motion using a plurality of servo applications electronically cammed together on a standardized backplane of coded instructions.

6. An automated device comprising:

a delivery device having a numerically controlled delivery drive for: loading a workpiece at an intake position of the delivery device; separating the workpiece by moving the workpiece from the intake position; accelerating the workpiece; and presenting the workpiece at a predetermined delivery time, delivery position, delivery speed and moving along a delivery trajectory, wherein the workpiece comprises: a platform with mounts supporting a first component in a selected orientation ; and a locating surface;

a receiving device having a numerically controlled receiving drive for moving along a receiving trajectory configured to permit transfer of the workpiece at the delivery position from the delivery device to the receiving device;

a processing device having a numerically controlled processing drive for processing the workpiece with a processing tool while the workpiece is on the receiving device;

the numerically controlled receiving device being configured for presenting the workpiece at a predetermined ejection time, ejection position, ejection speed and moving along an ejection trajectory;

a completion device having a numerically controlled completion drive for moving along a completion trajectory configured to transfer the workpiece at the ejection position from the receiving device to the completion device,

wherein the delivery device, the receiving device and the completion device include releasable connectors for engaging and disengaging the locating surface of the workpiece,

the delivering of the workpiece and the receiving of the workpiece being electronically synchronized by the numerically controlled delivery and receiving drives,

the processing of the workpiece being electronically synchronized by the numerically controlled processing drive, and the ejection of the workpiece and the transferring of the workpiece being electronically synchronized by the numerically controlled delivery and receiving drives.

7. The automated device according to claim 6 wherein, the platform has mounts supporting a second component; and the processing tool comprises an assembly tool for assembling the first and second components together while the workpiece is on the receiving device.

8. The automated device according to claim 6 wherein, the platform and mounts include a fluid port; and the processing tool includes an outlet port for conveying fluid to the fluid port while the workpiece is on the receiving device.

9. The automated device according to claim 6 wherein, the locating surface comprises a pin with a locating groove; and the releasable connectors comprise grip fingers actuated between an open position and a closed position engaging the pin and locating groove.

10. The automated device according to claim 9 wherein the workpiece comprises a base joined to the platform with the pin.

11. The automated device according to claim 6 comprising a rotary engine wherein:

the delivery device comprises a rotary actuated input indexing platform configured to pick the workpiece from an input stream of like workpieces;

the receiving device comprises a rotary tool platform on which the processing tool is mounted; and

the completion device comprises a rotary actuated input indexing platform configured to place the workpiece from the receiving device into an output stream of like workpieces.

12. The automated device according to claim 6 comprising a pick and place engine wherein:

the workpiece comprises an individual component;

the delivery device comprises a rotary actuated input indexing platform configured to pick a component from an input stream of like components;

the receiving device comprises a pick and place robot; and

the completion device comprises a linear actuated conveyor configured to accept the component from the pick and place robot.

13. The automated device according to claim 12 wherein

the processing tool comprises an optical scanner configured to scan the component to identify a surface feature and determine an input orientation based on the surface feature; and

the pick and place robot includes a rotary grip in communication with the optical scanner configured to rotate the component from the input orientation to an output orientation.

14. The automated device according to claim 13 wherein

the linear actuated conveyor comprises a platform with multiple mounts supporting multiple components in the output orientation as placed by the pick and place robot.

15. The automated device according to claim 6 comprising a multiplex engine wherein

the delivery device comprises a rotary actuated input indexing platform;

the receiving device comprises a pick and place robot; and

the completion device comprises a linear actuated conveyor configured to present the workpiece to the pick and place robot before processing and to accept the workpiece from the pick and place robot after processing.

16. The automated device according to claim 15 wherein the processing tool is mounted to a stationary base.

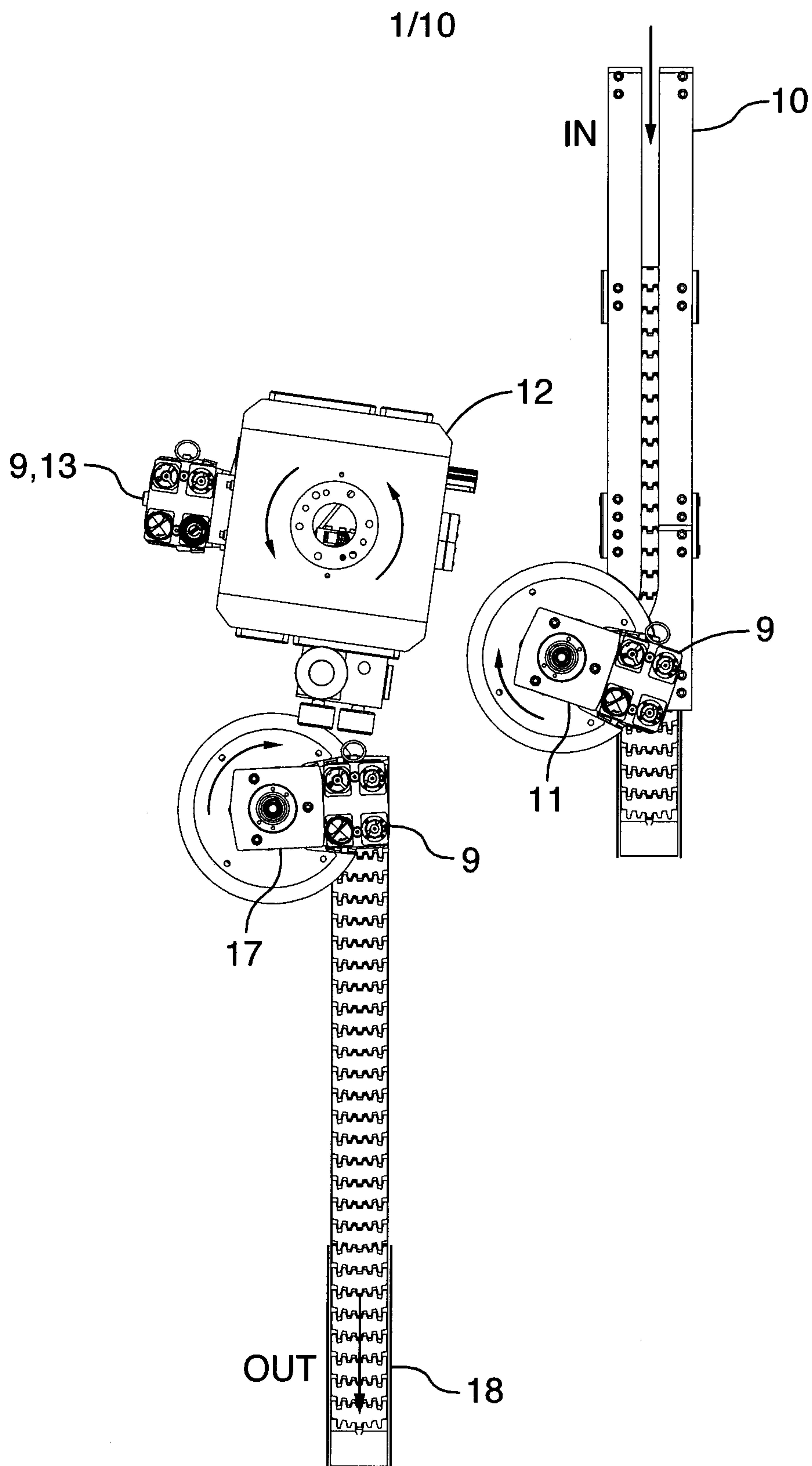

2/10

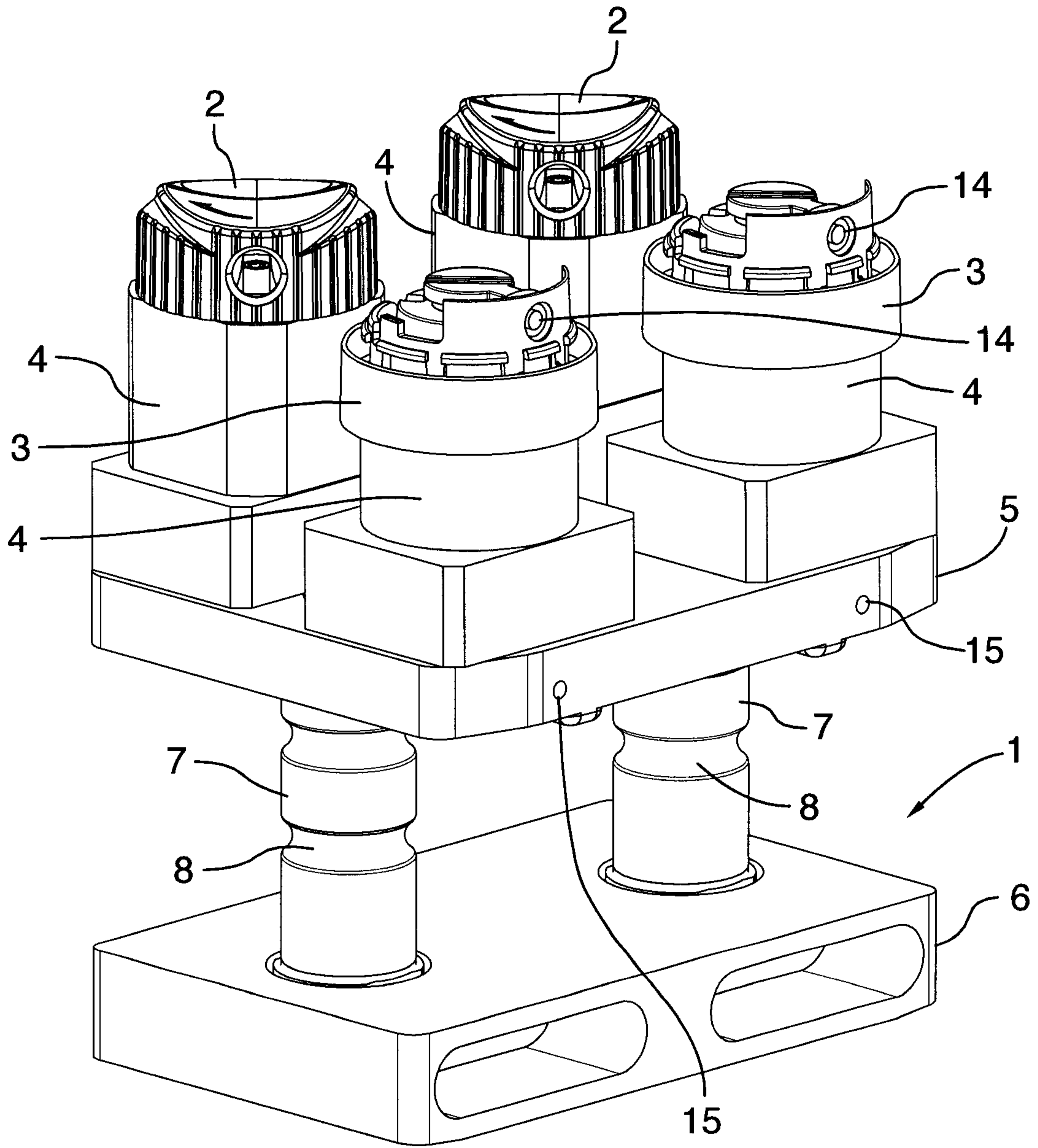

FIG.2

3/10

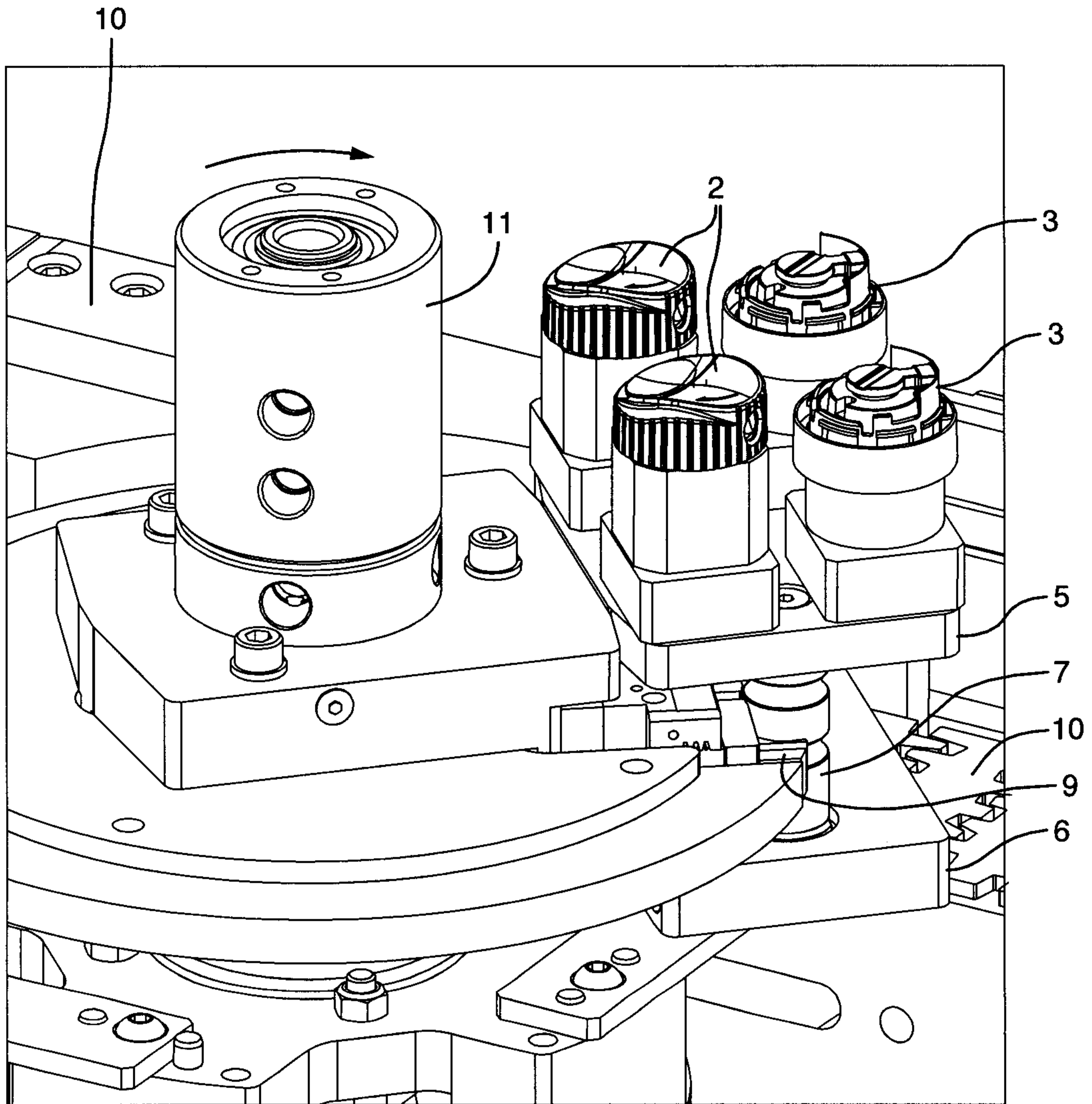

FIG.3

4/10

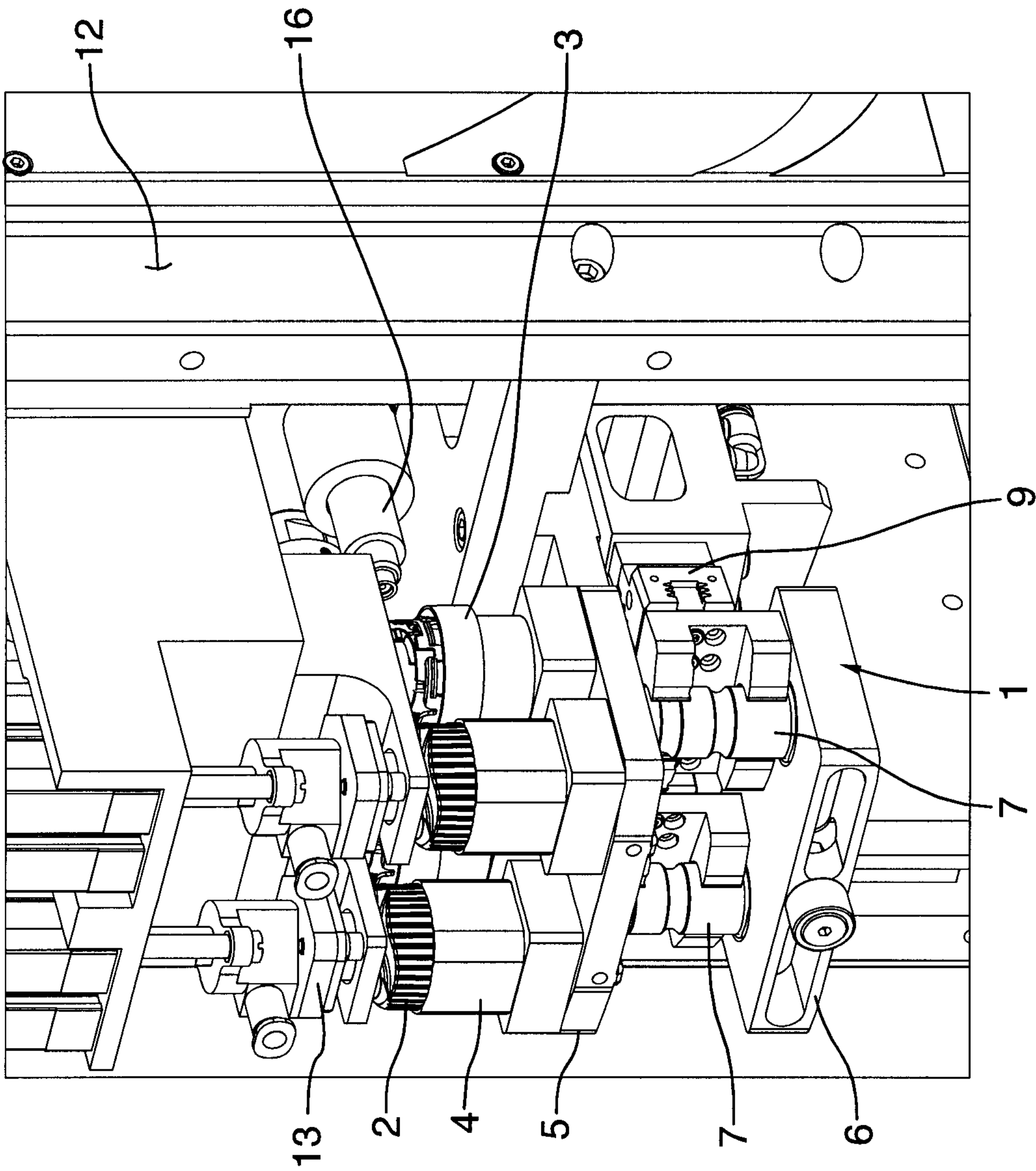

FIG.4

5/10

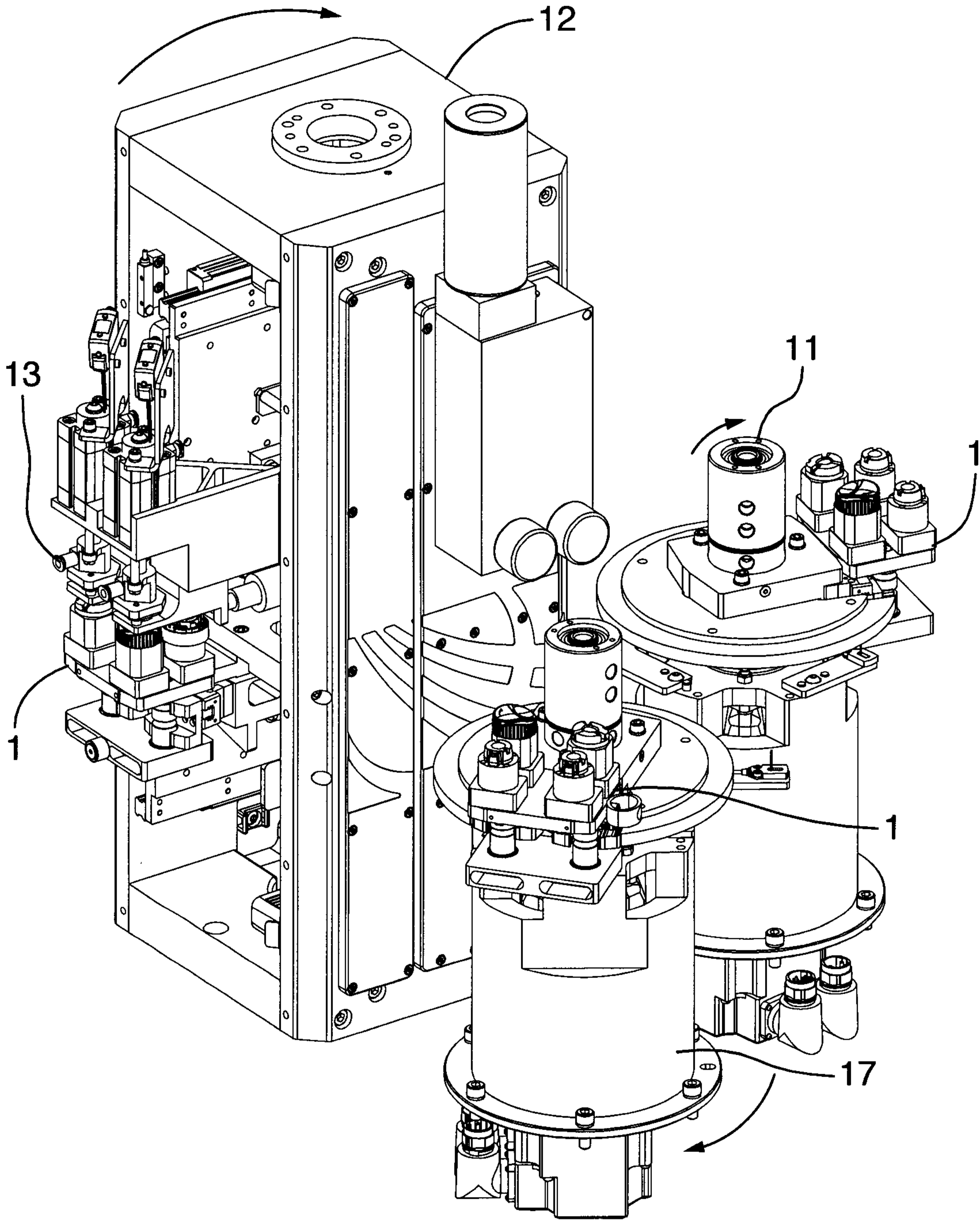

FIG.5

6/10

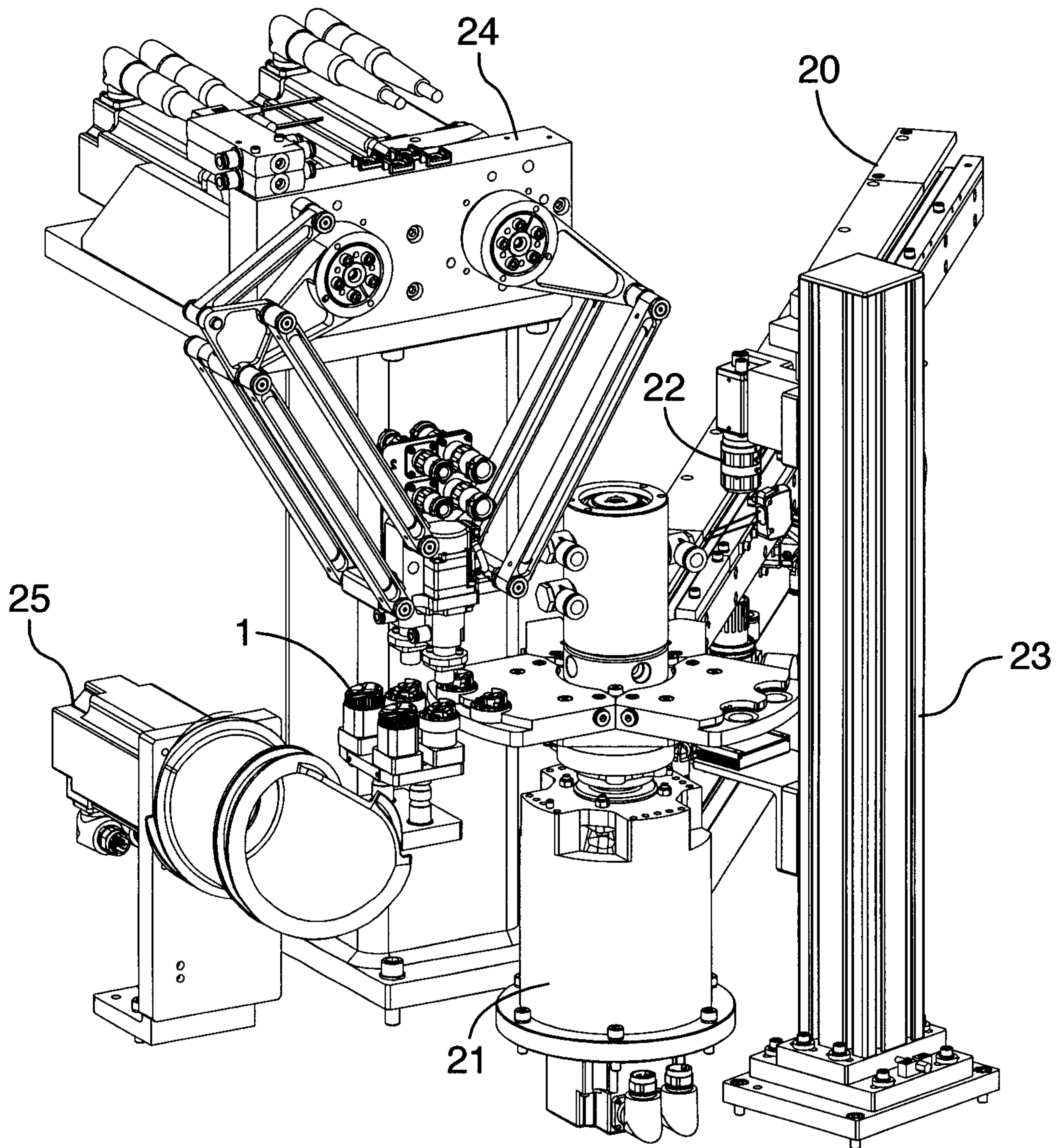

FIG.6

7/10

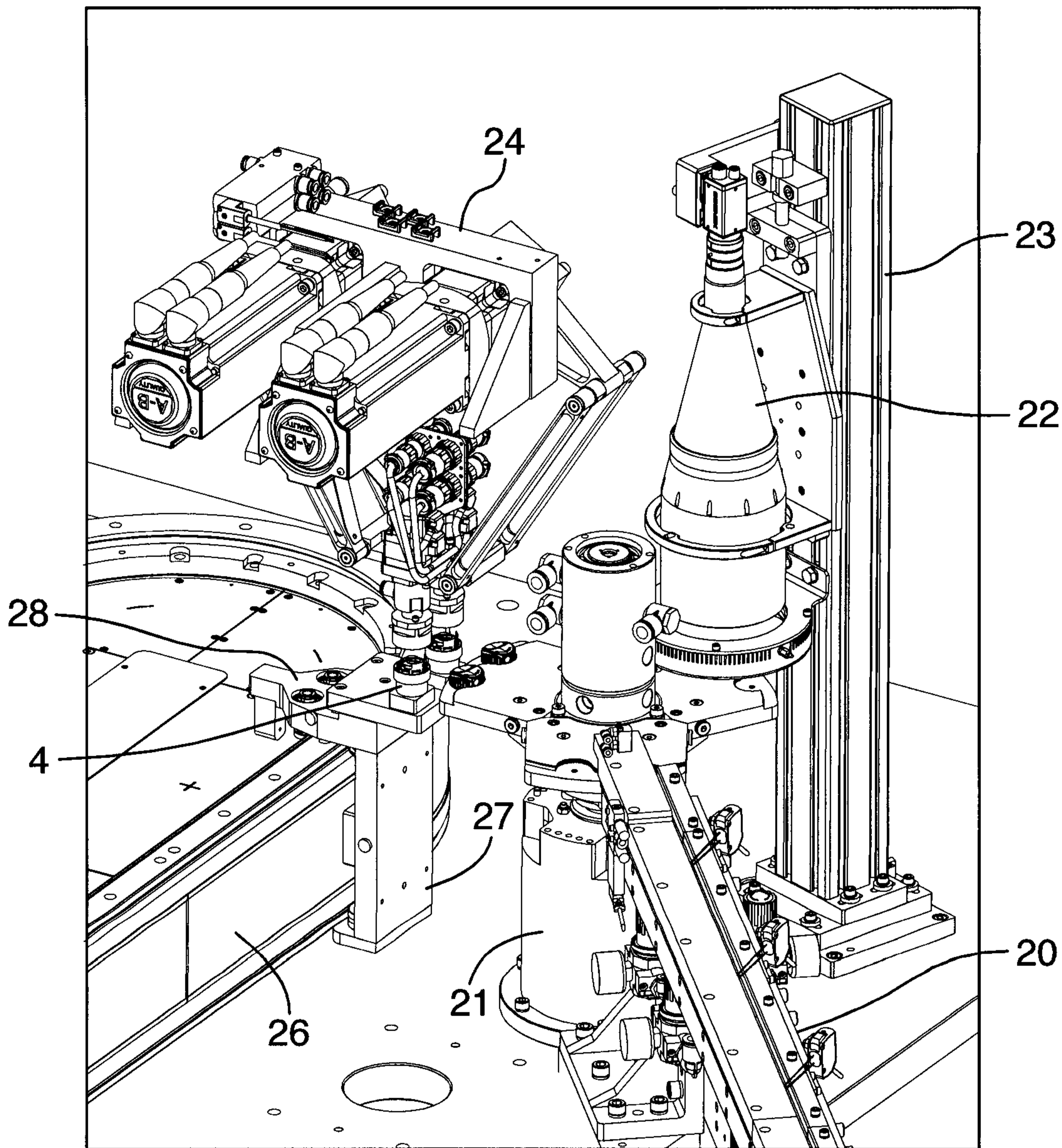

FIG.7

8/10

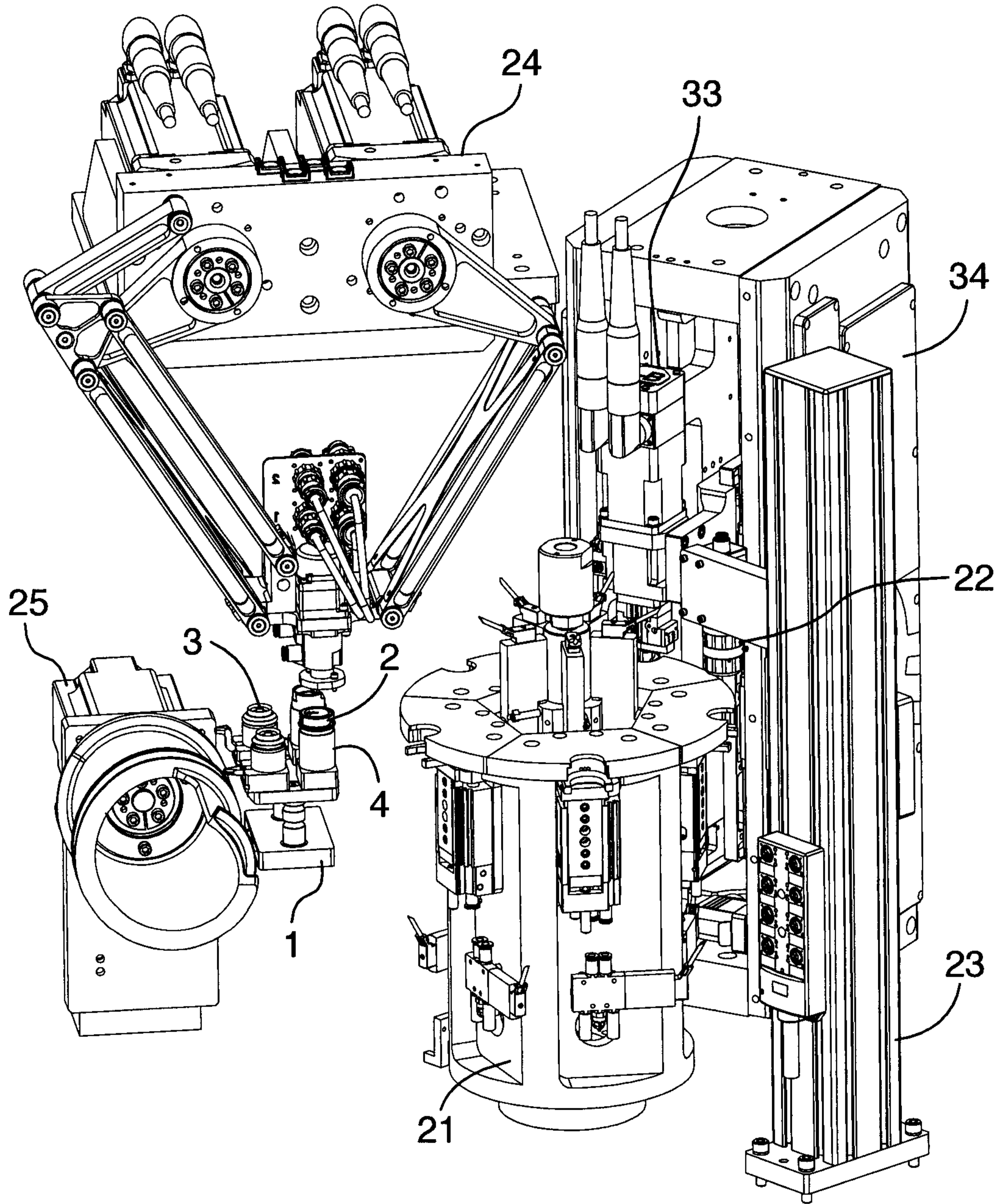

FIG.8

9/10

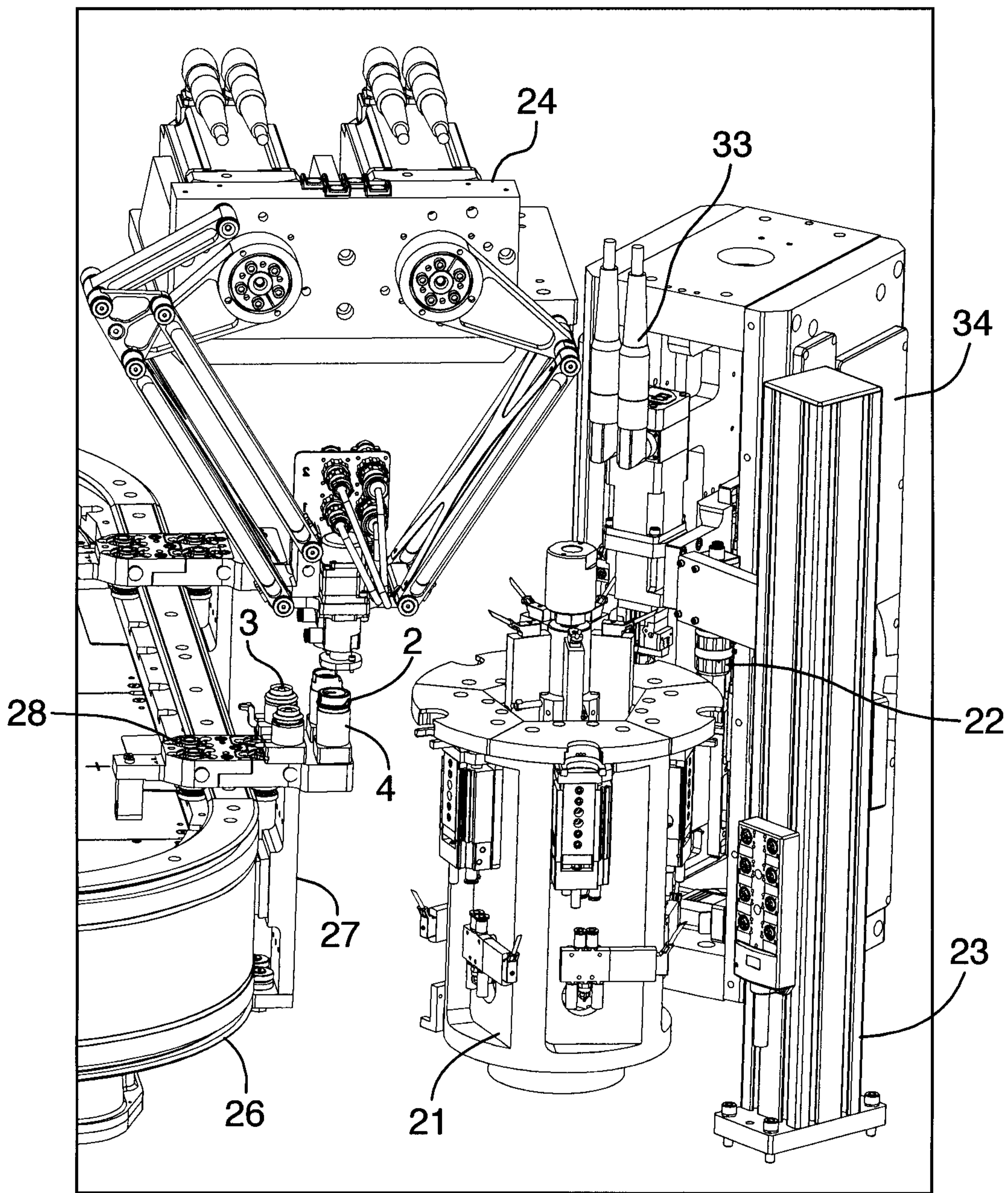

FIG.9

10/10

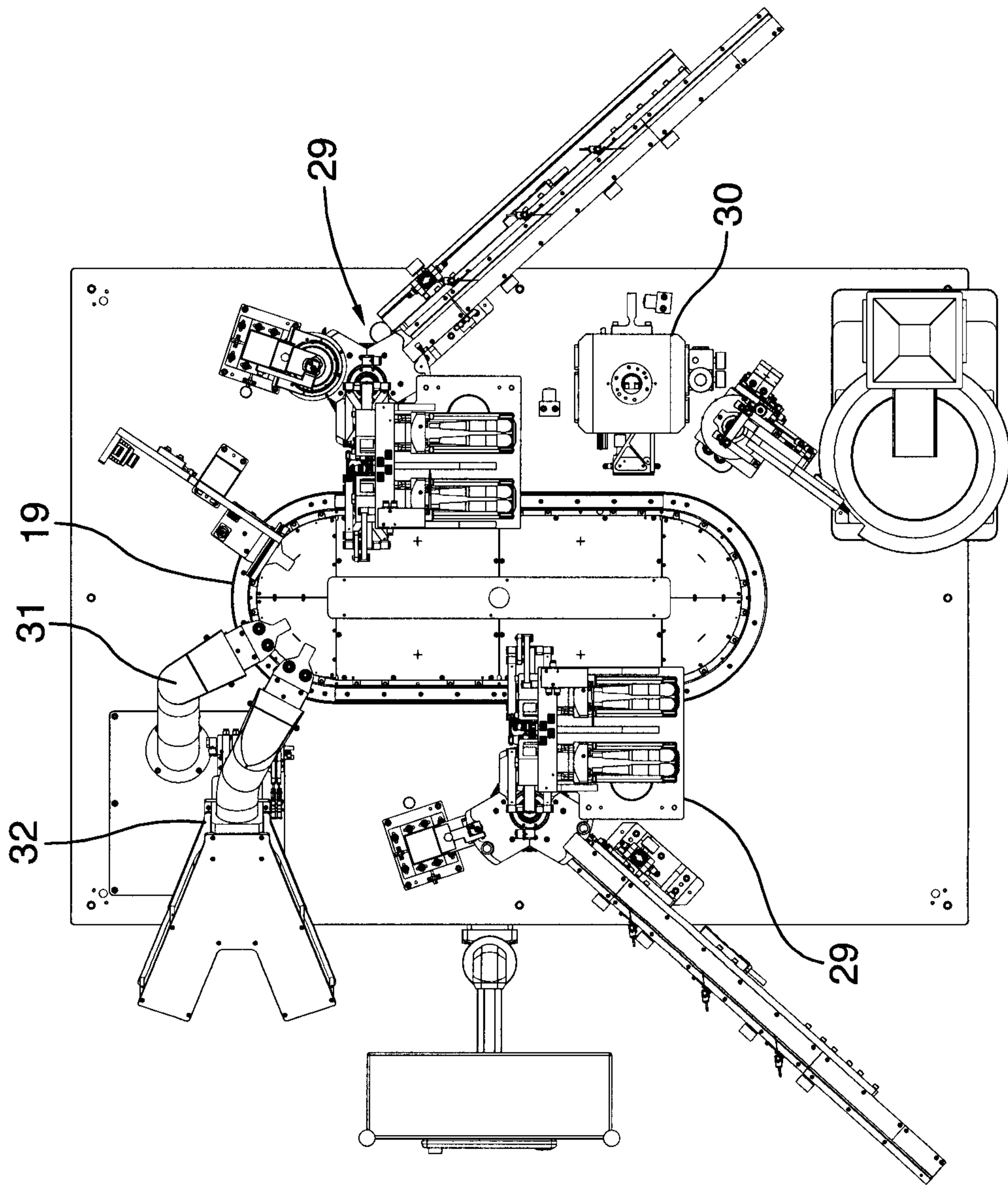

FIG.10

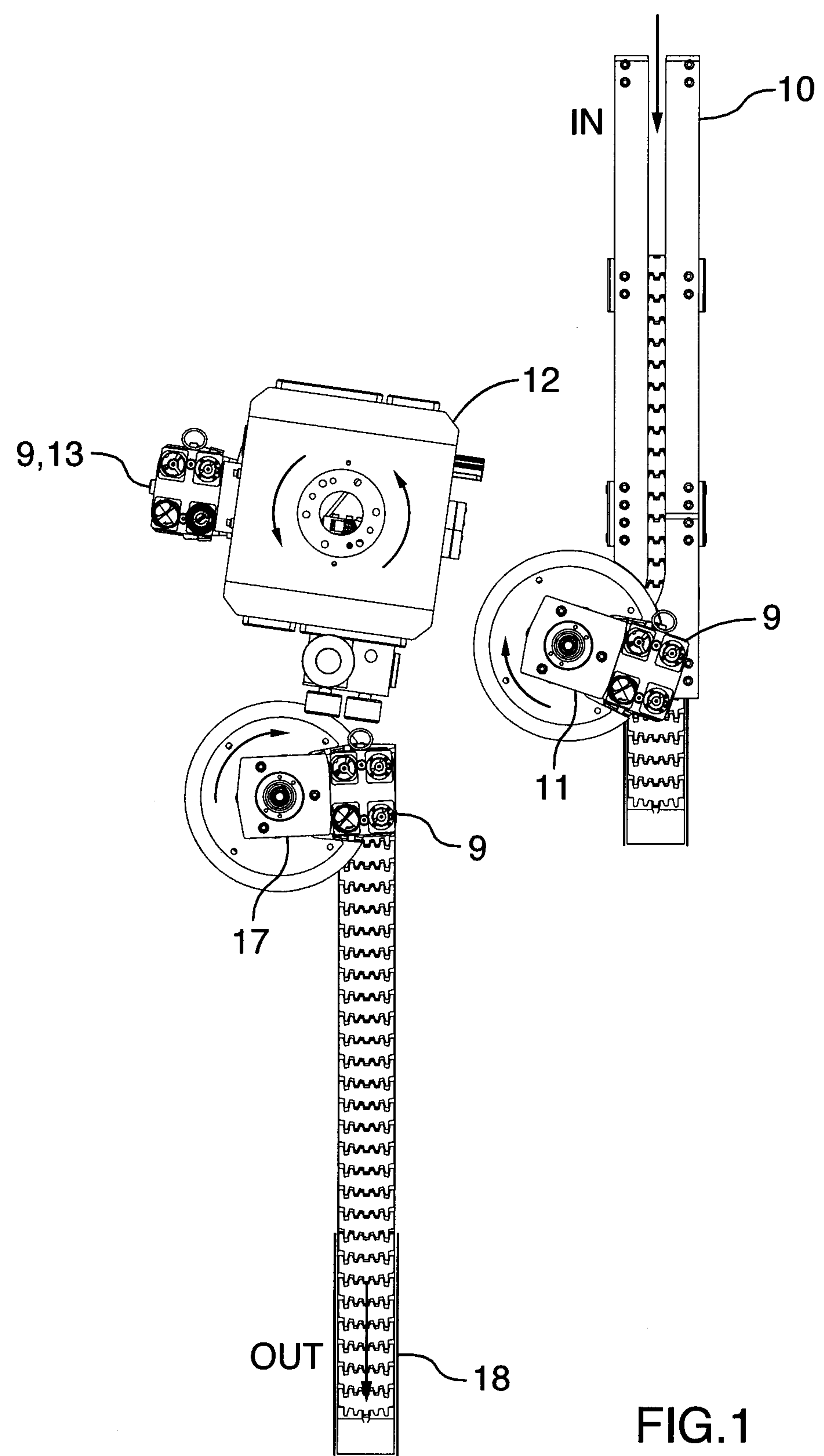

FIG. 1