



(11) **EP 1 523 929 A3**

(12) **EUROPEAN PATENT APPLICATION**

(88) Date of publication A3:
14.03.2007 Bulletin 2007/11

(51) Int Cl.:
A47L 15/42^(2006.01) E05F 1/12^(2006.01)

(43) Date of publication A2:
20.04.2005 Bulletin 2005/16

(21) Application number: **04024203.4**

(22) Date of filing: **11.10.2004**

(84) Designated Contracting States:
**AT BE BG CH CY CZ DE DK EE ES FI FR GB GR
HU IE IT LI LU MC NL PL PT RO SE SI SK TR**
Designated Extension States:
AL HR LT LV MK

(72) Inventors:
• **Degli Esposti, Ermes**
40100 Bologna (IT)
• **Gherardi, Eros**
40100 Bologna (IT)
• **Ghedini, Teresa**
40100 Bologna (IT)

(30) Priority: **13.10.2003 IT BO20030592**

(71) Applicant: **C.M.I. S.r.l.**
40056 Crespellano, (Bo) (IT)

(74) Representative: **Negrini, Elena**
Agazzani & Associati S.r.l.
Via dell'Angelo Custode 11/6
40141 Bologna (IT)

(54) **Balancing device for a door of an household appliance**

(57) A balancing device for a door of an household appliance, provided with chassis to which is hinged the door, includes at least an articulated means (1) provided with a balance means (2) equipped with swiveling connection means at least first (3), second (4) and third (5) respectively for the appliance chassis, for an elastic mean (6), for an end of a tension rod mean (7) whose remaining end has a coupler (8) for the door of the appliance.

The first swiveling connection means (3) is middle and misaligned to the remaining two. The elastic mean (6) transmits to the balance means (2) a force opposing the door weight and transmitted to the balance means (2) by the tension rod mean (7).

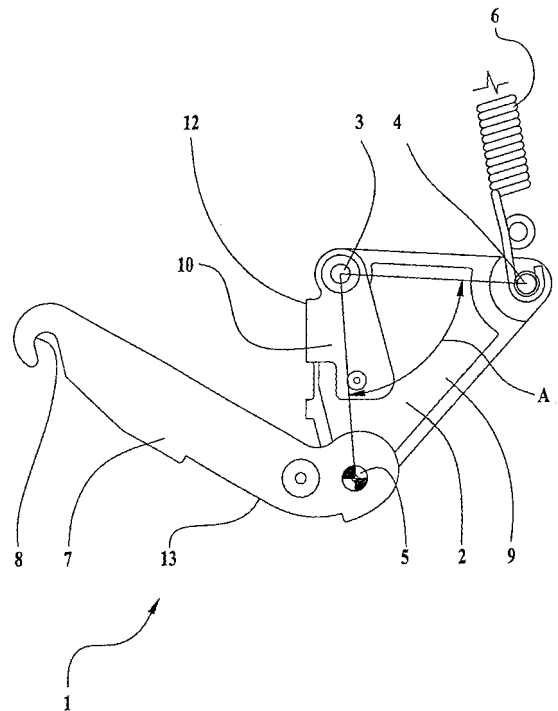

FIG.1

EP 1 523 929 A3



DOCUMENTS CONSIDERED TO BE RELEVANT			
Category	Citation of document with indication, where appropriate, of relevant passages	Relevant to claim	CLASSIFICATION OF THE APPLICATION (IPC)
X	WO 03/039322 A (C M I S R L [IT]; DEGLI ESPOSTI ERMES [IT]; GHERARDI EROS [IT]; GHEDIN) 15 May 2003 (2003-05-15) * figure 2 *	1-5,9, 10,15, 16,18,20	INV. A47L15/42 E05F1/12
X	DE 83 29 611 U1 (BOSCH-SIEMENS HAUSGERAETE GMBH, 7000 STUTTGART, DE) 26 July 1984 (1984-07-26) * figure 1 *	1-5,10	
X	US 4 163 344 A (SCHERER RICHARD M [US]) 7 August 1979 (1979-08-07) * abstract; figures 1-4 *	1-5,7,9	
A	EP 0 046 314 A1 (SMEG ELETTRODOMESTICI [IT]) 24 February 1982 (1982-02-24) * the whole document *	1-20	
A	EP 1 302 150 A (C M I S R L [IT]) 16 April 2003 (2003-04-16) * the whole document *	1-20	
			TECHNICAL FIELDS SEARCHED (IPC)
			A47L F24C D06F
The present search report has been drawn up for all claims			
Place of search Munich		Date of completion of the search 26 January 2007	Examiner DIAZ, M
CATEGORY OF CITED DOCUMENTS X : particularly relevant if taken alone Y : particularly relevant if combined with another document of the same category A : technological background O : non-written disclosure P : intermediate document		T : theory or principle underlying the invention E : earlier patent document, but published on, or after the filing date D : document cited in the application L : document cited for other reasons & : member of the same patent family, corresponding document	

3
EPO FORM 1503 03.82 (P04C01)

ANNEX TO THE EUROPEAN SEARCH REPORT
ON EUROPEAN PATENT APPLICATION NO.

EP 04 02 4203

This annex lists the patent family members relating to the patent documents cited in the above-mentioned European search report. The members are as contained in the European Patent Office EDP file on
The European Patent Office is in no way liable for these particulars which are merely given for the purpose of information.

26-01-2007

Patent document cited in search report		Publication date	Patent family member(s)	Publication date
WO 03039322	A	15-05-2003	DE 60203732 D1	19-05-2005
			DE 60203732 T2	01-09-2005
			EP 1443846 A1	11-08-2004
			ES 2238619 T3	01-09-2005
			IT B020010674 A1	06-05-2003

DE 8329611	U1	26-07-1984	NONE	

US 4163344	A	07-08-1979	CA 1091113 A1	09-12-1980

EP 0046314	A1	24-02-1982	AU 7350881 A	23-09-1982
			DE 3170399 D1	13-06-1985
			ES 259985 Y	01-11-1982
			IT 1129242 B	04-06-1986

EP 1302150	A	16-04-2003	IT B020010620 A1	10-04-2003
