



(51) International Patent Classification:

A61B 17/58 (2006.01)

(21) International Application Number:

PCT/PH20 12/0000 15

(22) International Filing Date:

16 November 2012 (16.11.2012)

(25) Filing Language:

English

(26) Publication Language:

English

(30) Priority Data:

61/561,400 18 November 2011 (18.11.2011) US

(71) Applicant: ORTHOPAEDIC INTERNATIONAL, INC.
[PH/PH]; 9 West Rd., Light Industry & Science Park 1,
SEPZ, Cabuyao, Laguna (PH).

(72) Inventor: SASING, Jude, L.; 25-B Malinis St., UP Vil-
lage, Diliman, Quezon City (PH).

(74) Agent: PEREZ, Jonathan, Q.; Bengzon Negre Untalan,
Intellectual Property Attorneys, 2/F SEDDCO Bldg. Rada-
cor, Legaspi Sts., Legaspi Village, Makati City (PH).

(81) Designated States (unless otherwise indicated, for every
kind of national protection available): AE, AG, AL, AM,
AO, AT, AU, AZ, BA, BB, BG, BH, BN, BR, BW, BY,
BZ, CA, CH, CL, CN, CO, CR, CU, CZ, DE, DK, DM,
DO, DZ, EC, EE, EG, ES, FI, GB, GD, GE, GH, GM, GT,
HN, HR, HU, ID, IL, IN, IS, JP, KE, KG, KM, KN, KP,
KR, KZ, LA, LC, LK, LR, LS, LT, LU, LY, MA, MD,
ME, MG, MK, MN, MW, MX, MY, MZ, NA, NG, NI,
NO, NZ, OM, PA, PE, PG, PH, PL, PT, QA, RO, RS, RU,
RW, SC, SD, SE, SG, SK, SL, SM, ST, SV, SY, TH, TJ,
TM, TN, TR, TT, TZ, UA, UG, US, UZ, VC, VN, ZA,
ZM, ZW.

(84) Designated States (unless otherwise indicated, for every
kind of regional protection available): ARIPO (BW, GH,
GM, KE, LR, LS, MW, MZ, NA, RW, SD, SL, SZ, TZ,
UG, ZM, ZW), Eurasian (AM, AZ, BY, KG, KZ, RU, TJ,
TM), European (AL, AT, BE, BG, CH, CY, CZ, DE, DK,
EE, ES, FI, FR, GB, GR, HR, HU, IE, IS, IT, LT, LU, LV,
MC, MK, MT, NL, NO, PL, PT, RO, RS, SE, SI, SK, SM,
TR), OAPI (BF, BJ, CF, CG, CI, CM, GA, GN, GQ, GW,
ML, MR, NE, SN, TD, TG).

[Continued on nextpage]

(54) Title: PARALLEL ROD CONNECTOR

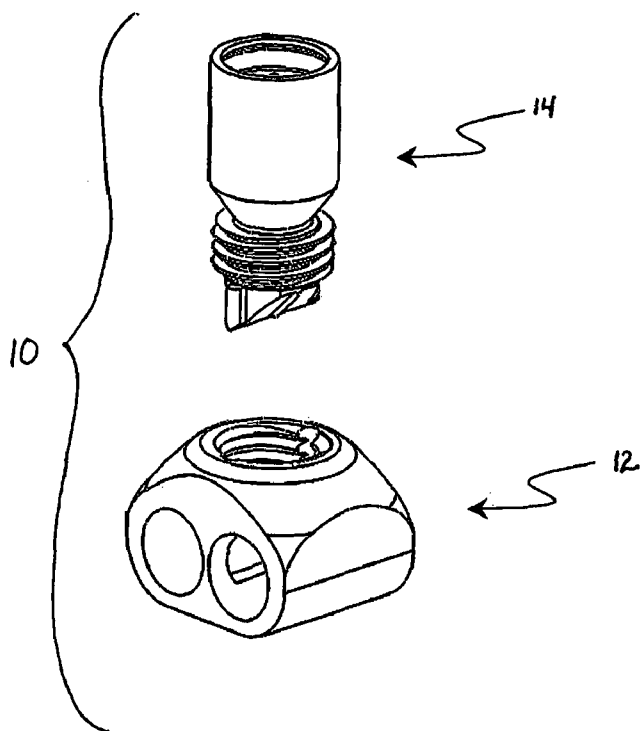

(57) Abstract: A connector assembly for attaching multiple
spinal rods to each other, the connector assembly including
a connector body having a top surface, first and second
ends, a first opening extending along a longitudinal axis
from the first end to the second end, a second opening
offset from the first opening and extending along a longitudinal
axis from the first end to the second end, and a threaded
opening extending along a longitudinal axis from the top
surface and into the connector body; and a set screw as-
sembly having a threaded portion that is engageable with
the threaded opening of the connector body.

- with international search report (Art. 21(3))
- before the expiration of the time limit for amending the claims and to be republished in the event of receipt of amendments (Rule 48.2(h))

INTERNATIONAL SEARCH REPORT

International application No.
PCT/PH2012/000015

A. CLASSIFICATION OF SUBJECT MATTER

Int.Cl. A61B1 7/58 (2006.01) i

According to International Patent Classification (IPC) or to both national classification and IPC

B. FIELDS SEARCHED

Minimum documentation searched (classification system followed by classification symbols)

Int.Cl. A61B1 7/58

Documentation searched other than minimum documentation to the extent that such documents are included in the fields searched

Published examined utility model applications of Japan 1922-1996
Published unexamined utility model applications of Japan 1971-2013
Registered utility model specifications of Japan 1996-2013
Published registered utility model applications of Japan 1994-2013

Electronic data base consulted during the international search (name of data base and, where practicable, search terms used)

C. DOCUMENTS CONSIDERED TO BE RELEVANT

Category *	Citation of document, with indication, where appropriate, of the relevant passages	Relevant to claim No.
X	JP 2007-530223 A (DEPUY SPINE SARL)	1-5, 11, 14, 16
Y	2007.11.01, paragraphs [0041] - [0044], Figs. 8A-D	13
A	& US 2005/0228378 A1 & EP 2174609 A1 & WO 2005/099603 A1	6-10, 12, 15
Y	US 6224596 B1 (JACKSON, Roger P.) 2001.05.01, lines 47-58, column 2, line 62, column 7 to line 2, column 8, Figs. 2, 12 & WO 1998/030161 A1	13
A	US 2006/0233597 A1 (ENSIGN, Micheal D.) 2006.10.19, paragraph [0030], Fig. 3 & JP 2008-520383A & WO 2006/055914 A2 & CA 2587952 A1 & KR 10-2007-0107668 A	1-16



Further documents are listed in the continuation of Box C.



See patent family annex.

* Special categories of cited documents:

"A" document defining the general state of the art which is not considered to be of particular relevance

"E" earlier application or patent but published on or after the international filing date

"L" document which may throw doubts on priority claim(s) or which is cited to establish the publication date of another citation or other special reason (as specified)

"O" document referring to an oral disclosure, use, exhibition or other means

"P" document published prior to the international filing date but later than the priority date claimed

"T" later document published after the international filing date or priority date and not in conflict with the application but cited to understand the principle or theory underlying the invention

"X" document of particular relevance; the claimed invention cannot be considered novel or cannot be considered to involve an inventive step when the document is taken alone

"Y" document of particular relevance; the claimed invention cannot be considered to involve an inventive step when the document is combined with one or more other such documents, such combination being obvious to a person skilled in the art

"&" document member of the same patent family

Date of the actual completion of the international search

11.04.2013

Date of mailing of the international search report

07.05.2013

Name and mailing address of the ISA/JP

Japan Patent Office

3-4-3, Kasumigaseki, Chiyoda-ku, Tokyo 100-8915, Japan

Authorized officer

ISHIKAWA, Kaoru

Telephone No. +81-3-3581-1 101 Ext. 334 6

31 4860

INTERNATIONAL SEARCH REPORT

International application No.
PCT/PH2012/000015

C (Continuation). DOCUMENTS CONSIDERED TO BE RELEVANT		
Category*	Citation of document, with indication, where appropriate, of the relevant passages	Relevant to claim No.
A	WO 2002/080787 A2 (HAHN, Michael) 2002.10.17, line 21, page 12 to line 21, page 13, Fig. 9 & DE 10117426 A1	1-16

INTERNATIONAL SEARCH REPORT

International application No.

PCT/PH2012/000015

Box No. II Observations where certain claims were found unsearchable (Continuation of item 2 of first sheet)

This international search report has not been established in respect of certain claims under Article 17(2)(a) for the following reasons:

1. ☒ Claims Nos.: 17 - 20
because they relate to subject matter not required to be searched by this Authority, namely:
The subject matter of claims 17-20 relates to a method for treatment of the human by surgery, which does not require an international search by the International Searching Authority in accordance with PCT Article 17(2)(a)(i) and Rule 39.1
2. ☐ Claims Nos.:
because they relate to parts of the international application that do not comply with the prescribed requirements to such an extent that no meaningful international search can be carried out, specifically:
3. ☐ Claims Nos.:
because they are dependent claims and are not drafted in accordance with the second and third sentences of Rule 6.4(a).

Box No. III Observations where unity of invention is lacking (Continuation of item 3 of first sheet)

This International Searching Authority found multiple inventions in this international application, as follows:

1. ☐ As all required additional search fees were timely paid by the applicant, this international search report covers all searchable claims.
2. ☐ As all searchable claims could be searched without effort justifying additional fees, this Authority did not invite payment of additional fees.
3. ☒ As only some of the required additional search fees were timely paid by the applicant, this international search report covers only those claims for which fees were paid, specifically claims Nos.:
4. ☐ No required additional search fees were timely paid by the applicant. Consequently, this international search report is restricted to the invention first mentioned in the claims; it is covered by claims Nos.:

Remark on Protest

- ☐ The additional search fees were accompanied by the applicant's protest and, where applicable, the payment of a protest fee.
- ☐ The additional search fees were accompanied by the applicant's protest but the applicable protest fee was not paid within the time limit specified in the invitation.
- ☒ No protest accompanied the payment of additional search fees.