

(12) UK Patent Application (19) GB (11) 2 300 615 (13) A

(43) Date of A Publication 13.11.1996

(21) Application No 9614155.1

(22) Date of Filing 06.10.1993

Date Lodged 05.07.1996

(30) Priority Data

(31) 9220961 (32) 06.10.1992 (33) GB

(62) Derived from Application No. 9320557.3 under Section 15(4) of the Patents Act 1977

(71) Applicant(s)

Rako Products Limited

(Incorporated in the United Kingdom)

Brunel Way, Stroudwater Business Park,
Oldends Lane, STONEHOUSE, Gloucestershire,
GL10 3NG, United Kingdom

(72) Inventor(s)

Paul Radmall

(51) INT CL⁶

B65G 15/62

(52) UK CL (Edition O)

B8A ALD

(56) Documents Cited

GB 2172870 A US 3889801 A

(58) Field of Search

UK CL (Edition O) B8A ALD

INT CL⁶ B65G 15/60 15/62 15/64 21/00 21/10 21/12
21/14

ONLINE:WPI

(74) Agent and/or Address for Service

Withers & Rogers

4 Dyer's Buildings, Holborn, LONDON, EC1N 2JT,
United Kingdom

(54) Conveyor unit framework

(57) A conveyor unit comprising a frame 1 supporting a roller at each end and over which a conveyor belt 6 passes in a continuous loop, and one of which is driven by an electric motor, characterised in that the frame 1 consists of an elongate box-section with upright side walls 8, 9 and upper and lower bed plates 3. The bed plates are both located between the two runs of conveyor belt, and the side walls 8, 9 extend above and below the upper and lower bed plates to form channels in which the belt 6 runs.

FIG.4.

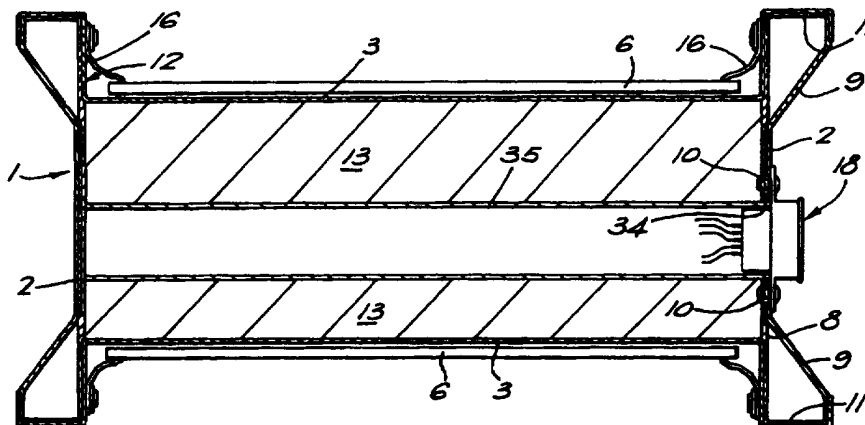

GB 2 300 615 A

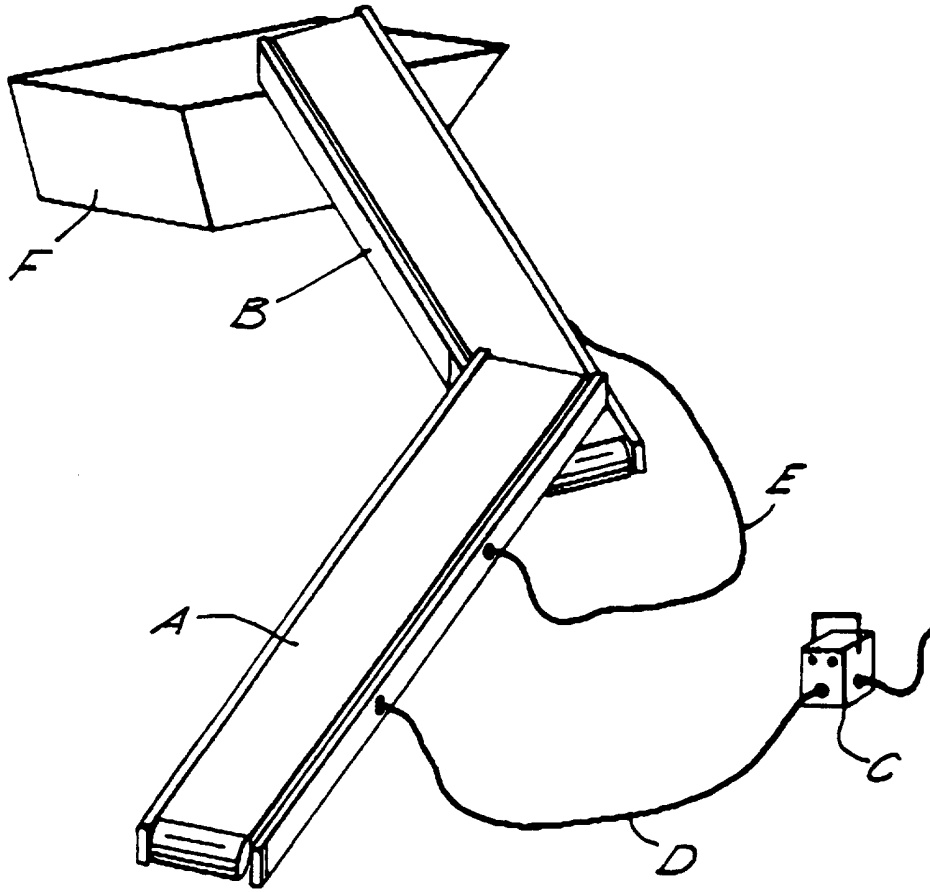

FIG.1.

FIG. 2.

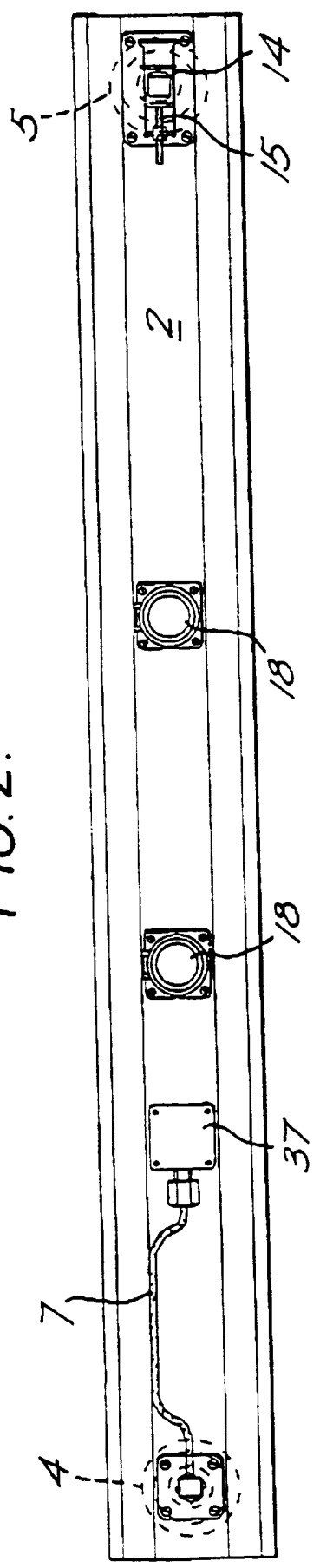
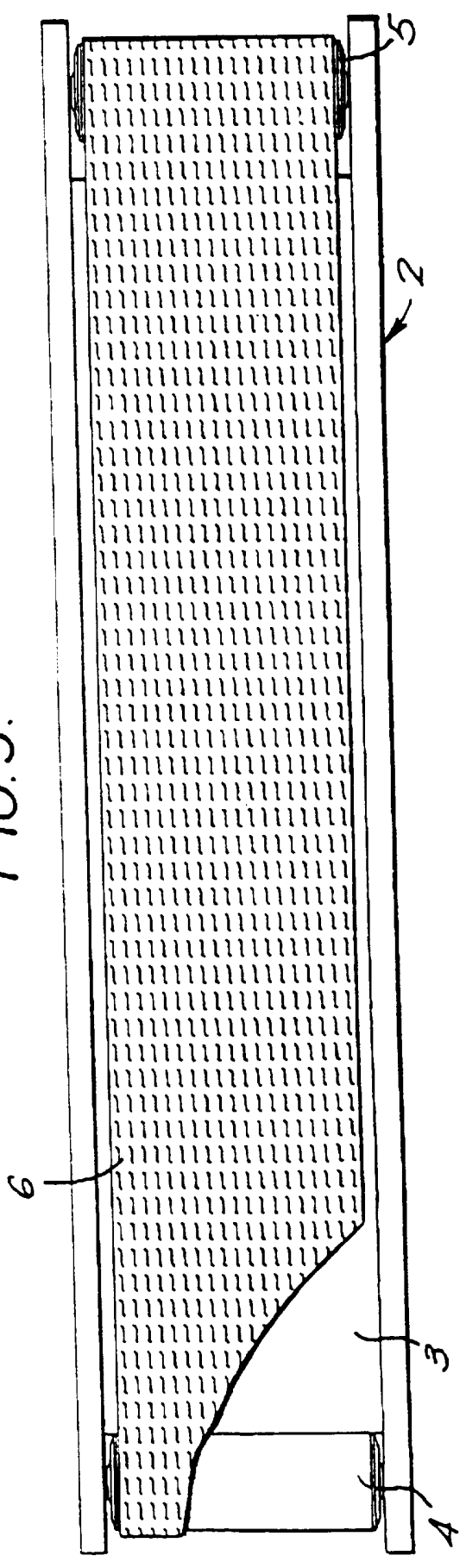

FIG. 3.



3/4

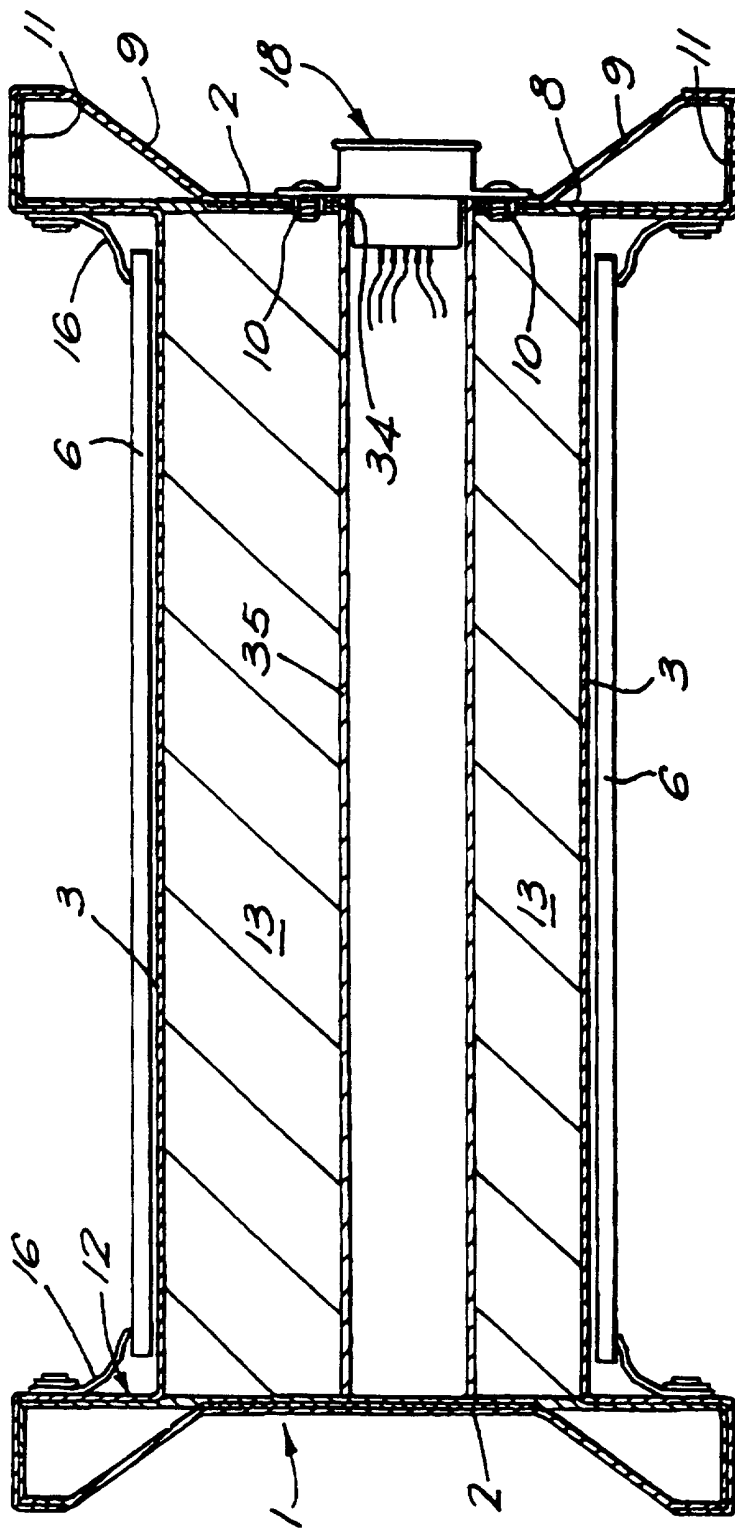

FIG. 4.

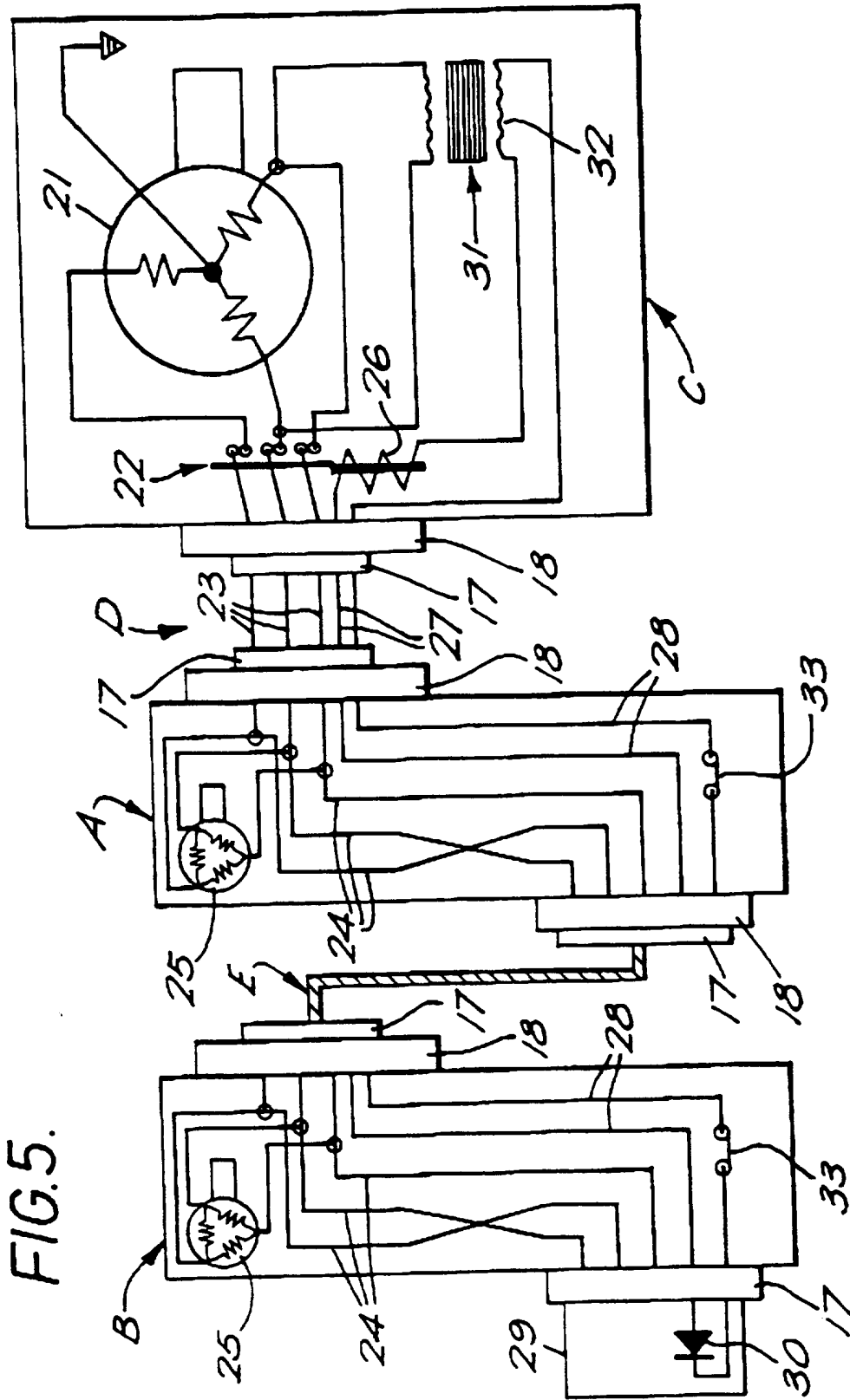

FIG. 5.

Technical Field

This invention relates to a belt-type continuous conveyor and a conveying system comprising a plurality of similar conveyors.

Disclosure of the Invention

It is usual practice with all small scale building work, both professional and DIY, to move materials around in buckets and wheel barrows, even though this is laborious, slow and sometimes inconvenient. It is also known to use dump trucks and cranes, but these are not always practical or convenient. One object of the present invention is to provide a practical alternative to the known equipment.

According to one aspect, the invention consists in a conveying system comprising a plurality of conveyor units each comprising a frame supporting a roller at each end over which a conveyor belt passes, at least one of the rollers being driven by an electric motor, and the motors of successive conveyor units when arranged in a feed path being interconnected so that they are powered and controlled in a common power circuit.

Preferably, each motor is reversible and its sense of rotation is selectively controlled by the manner in which it is connected in the power circuit. For example, each unit is fitted with at least two input/output sockets which are interconnected such that the sense of rotation of the motor can

be changed by connecting the power supply to either socket. The unused socket can then serve as the power supply socket for the next unit in the system and can be connected to it by suitable cable and plug means. The complete conveyor system can thus be laid out initially to suit the application without regard to the direction of movement of the conveyor belts, and the direction of the belts can be selected appropriately in a separate operation when inter-connecting the motors in the power circuit.

Preferably, a safety circuit is incorporated within each cable and plug means and/or socket such that if either is short-circuited or broken, the power is interrupted at the power source, stopping the conveyor system and making it electrically safe. The last input/output socket is fitted with a termination plug which protects the socket and contains additional safety circuit components.

The frame preferably consists of an elongated box-section structure which is filled with a rigid structural foam that increases the strength of the structure and serves to encapsulate the power circuit components within the frame, the foam being injected during the manufacturing process.

A suitable box-section structure preferably comprises side wall members joined by upper and lower bed plate members upon which the conveyor belt slides in use. The side walls themselves may incorporate longitudinally extending box sections to

increase their strength and provide guide rails or feet top and bottom. The side walls preferably extend beyond the bed plates so as to form channels top and bottom in which the conveyor belt runs between the rollers. Sealing strips are preferably provided within the channels to seal the gap between the belt and the sides of the channel. This strip is preferably secured to the side walls and bears down on the outermost surface of the belt.

The frame of the conveyor preferably has a cross-section which is substantially symmetrical about a central transverse axis, and can be used with either run of the conveyor belt uppermost. If required, support legs or scaffolding connectors can be connected to the frame, to support it above the ground. Also, connectors can be provided to interconnect adjacent ends of successive conveyor units, either end-to-end in the same plane, or one above the other with an overhang between them, and/or with the two conveyor units angled relative to one another either vertically or horizontally for a change in conveying direction.

It will be appreciated that whilst the invention has been described in relation to a conveying system comprising a plurality of conveyor units, the invention also consists in an individual conveyor unit having any one or more the features referred to above.

In particular, according to another aspect, the invention

consists in a conveyor unit comprising a frame supporting a roller at each end over which a conveyor belt passes in a continuous loop and one of which is driven by a motor, characterised in that the frame comprises a box section structure with upright side walls and lateral walls including an upper bed plate over and along which the conveyor belt slides in use.

Description of Drawings

The invention will now be described by way of example with reference to the accompanying drawings in which:

Figure 1 is a schematic drawing illustrating the principle of a conveying system according to the invention;

Figure 2 is a side elevation of a conveyor unit according to the invention;

Figure 3 is a plan view of the conveyor unit of Figure 2;

Figure 4 is a lateral cross-section through the conveyor of Figures 1 and 2; and

Figure 5 is part of the power circuit diagram of the conveyor system of Figure 1.

Mode of carrying out the Invention

The conveying system illustrated in Figure 1 consists of two

portable, electrically driven conveyor units A,B which are powered from a mains powered control unit C via electrical cables D and E. As shown in Figure 1, the conveyor units A,B are arranged end-to-end with the discharging end of conveyor A overhanging the loading end of conveyor B so as to transport material to a container or skip F.

Each conveyor unit A,B comprises a frame 1 which is basically a box-section structure (Figure 4) comprising upright side walls 2 joined by lateral upper and lower bed plates 3. At each end, the side walls 2 extend longitudinally beyond the bed plates 3 and rotatably support a roller 4,5 therebetween. A conveyor belt 6 extends around both rollers 4,5 and over the outer surfaces of the bed plates 3 so as to be supported on the bed plates when loaded with material to be transported. An electric motor (25 in Figure 5) and a gearbox are totally enclosed and sealed within the body of one roller 4, and a cable 7 serves to connect power to this electric motor to drive the roller 4.

The side walls 2 comprise two pressed metal components 8,9 which are secured in face-to-face contact by fasteners 10 in their central mid-height region along their whole length. These components 8,9 diverge upwardly and downwardly from their central region, and are connected by web portions 11 at their outer ends so as to form upper and lower box-sections. These box-sections strengthen the frame of the conveyor unit and extend beyond the bed plates 3 so that the web portions 11 form

feet at the bottom and side support rails at the top.

Some of the fasteners 10 comprise annular threaded rivets which are secured in aligned holes in the components 8,9 to hold them together, and which provide a threaded connection for the attachment of other components or fittings such as the electrical sockets 18. This same type of fastener is used elsewhere in the frame to connect sheet metal components together and/or to provide threaded connections.

The bed plates 3 are formed from pressed metal components shaped along each side to engage as a close fit over the outer ends of the side walls 2 and to form a channel 12 therebetween in which the conveyor belt 6 is received.

In order to further strengthen the frame 1, structural high-strength foam 13 is injected under pressure into the central void between the side walls 2 and bed plates 3. This foam helps to resist torsion and buckling loads, and to resist impact damage, and to bond the components of the frame together. Also, the foam helps to seal electrical components within the frame, as described hereinafter.

The conveyor belt 6 is of a synthetic solid woven construction, faced and impregnated with a PVC compound, and treated on the back to reduce friction with the bed plates 3. The belt may be a seamless loop or may have joined ends depending upon the working requirements. A raised pattern such as a chevron

pattern may be moulded in the case of the belt to assist transport of material, and additional lugs may be fitted to further assist up-hill working. A clearance is provided between the edges of the belt and the sides of the channel 12 in which it is received to allow for belt alignment.

Belt tension is adjusted by mounting the non-driven roller 5 on the side walls 2 via brackets 14 which are longitudinally adjustable by tension screws 15.

Flexible sealing strips 16 are fitted to the sides of the channel 12 and extend inwards and downwards to press against the edge portion of the belt 6, thereby to protect against penetration of material under the belt.

The electrical cables D and E which connect electrical power to the electric motor 25 in each driven roller 4, are connected to each conveyor unit A,B via a quick-release connector such as a plug and socket connector. A plug 17 is fitted to the end of the cable D,E and engages one or the other of two sockets 18 mounted on the side wall 2 of the conveyor unit. These two sockets are connected to one another and the motor internally of the conveyor unit so that power applied to one socket causes the motor to rotate in one sense, while power applied to the other socket causes the motor to rotate in the other sense. The choice of socket 18 to which a plug 17 is connected therefore determines the sense in which the belt 6 rotates. At the same time, power is transferred internally

to the other socket so that this can be used as the power source for the next conveyor unit. Thus, in the system of Figure 1, the cable D is connected between the power control unit C and a first socket 18 of the first conveyor unit A to cause the belt to rotate in the required sense, and the second socket 18 of the first conveyor unit A is connected via the second cable E to a selected first socket 18 of the second conveyor unit B to cause the belt to rotate in the required sense. The electrical circuit of this arrangement is illustrated in Figure 5.

The power supply of the control unit C comprises a star connected alternator 21 which supplies a 110 volt three-phase output via a solenoid-operated relay 22 to three power conductors 23 of the cable D. These three power conductors 23 in cable D are connected via sets of matching terminals in the plug and socket connectors 17,18 to three corresponding power conductors 24 within the conveyor unit A which interconnect sets of terminals in the two sockets 17.

The electric motor 25 that drives the roller 4 in each conveyor unit A,B comprises a delta connected three-phase motor, with the three-phase windings connected to respective power conductors 24. Two of the three power conductors 24 are reversed between the respective terminals of the sockets 17 so that the motor 25 will rotate in a different sense depending upon whether the plug 17 of cable D is connected to one socket or the other.

The cable E, like cable D, comprises three power conductors for the three-phase power supply, and these are connected to respective sets of terminals in the plugs 17 at each end. Furthermore, like the first conveyor unit A, the second conveyor unit B has similar internal electric connections between the sockets 18 and the motor 25, so that the three-phase power supply is connected via the three internal power conductors 24 to the motor 25 and the second socket 18.

It will be appreciated that if required, a third or more conveyor units can be connected into the power circuit via the second socket 18 of conveyor unit B and a further cable similar to cable E. Additional conveyor units can be added in a similar manner, each successive unit being interconnected with the preceding unit by a cable.

The solenoid-operated relay 22 in the control unit C controls connection of the three-phase supply to cable D, and has its solenoid 26 connected in a safety circuit which extends as a loop through all of the conveyor units A,B. This safety circuit comprises a pair of safety conductors 27 in each cable D,E, a pair of safety conductors 28 between respective pairs of terminals in the sockets 18, and a terminal plug 29 which is inserted in the non-used socket 18 of the last conveyor unit B in the power circuit. A diode 30 in the terminal plug 29 bridges the pair of safety conductors 28 in the conveyor unit B, and completes a loop circuit through the conductors 27,28

back to the solenoid 26. A low voltage transformer 31 in the control unit C has an output winding 32 which is connected in the loop circuit with the solenoid 26 and produces an alternating voltage. The alternating current is insufficient to energise the solenoid 26, but when the terminal plug 29 is fitted to the last socket 18 to complete the loop circuit, the diode 30 rectifies the alternating current and produces a direct current which is sufficient to energise the solenoid and operate the relay 22. If the loop circuit is subsequently short-circuited or broken by disconnection of any of the plugs 17 or terminal plug 29, the rectified voltage fails and the relay 22 is de-energised and the power supply disconnected.

A thermal overload sensor is also provided in each conveyor unit A,B to control a trip switch 33 in the safety conductor 27 so that overheating of a motor 25 in any of the conveyor units under overload conditions will break the loop circuit via a respective switch 33 and disconnect the power supply to stop all conveyor units.

The sockets 18 are connected to the side wall 2 of the conveyor unit A,B by screws which engage threaded annular rivets 10 in the side wall. Each socket is aligned with a hole 34 in the side wall and a tubular insert 35 that forms an extension of the hole 34 into the frame 1 of the conveyor unit. The insert 35 extends the full width of the frame 1 to the opposite side wall 2 and is supported by the structural foam 13 injected around it. The conductors 24,28 terminate at one end within

the insert 35, and are long enough to be connected to the terminals on the rear of the socket 18 before this is fitted in the insert. The conductors 24,28 extend through the side wall of the insert 35, and through the structural foam 13 to a junction box 37 mounted on the side wall 2 of the frame 1. The cable 7 incorporates all of the necessary electrical connections to the motor 25, and is connected into the circuit via the junction box 37.

The materials used in the constructions of each conveyor unit are preferably corrosion resistant. For example, aluminium may be used for the side walls 2, and stainless steel for the bed plates 3. Electrolytic corrosion at the interface between these materials is minimised by the use of powder colour coating on the aluminium and the use of inhibitor fluids during assembly. The rollers 4,5 may comprise stainless steel or nickel plated steel outer cylinders with reinforced plastic end caps.

A conveyor unit as described and illustrated herein may typically be 3000 m.m. long, 382 m.m. wide and 190 m.m. deep, and weigh about 50 kg. It is therefore a relatively lightweight piece of equipment, which can be readily handled manually, and by a single person on their own if needed. This means that the conveyor is readily portable and is suitable for a wide range of applications where material has to be moved.

Furthermore, all of the electrical components are preferably

waterproof which makes the conveyor unit safe and allows it to be cleaned by hosing with water while the conveyor is running.

As described above, the power supply is a 110 volt, three-phase supply, but it will be appreciated that other power supplies can be used without departing from the design principles of the illustrated conveyor unit. For example, a single phase power supply could be used, with induction motors to drive the rollers and starter capacitors to assist starting, the starter capacitors being housed within the inserts 35.

As shown in Figure 1, the conveyor units A and B are simply placed on the ground or skip, or on one another where one delivers material onto the other. However, special fittings may be provided such as legs to support the conveyors or connecting clips to couple successive units together. Also, where conveyor units are simply abutted end-to-end on the same level, additional roller fittings may be provided to fill the gap between them and to allow the two conveyors to be angled relative to one another. Such an arrangement would be more suitable for conveying larger objects such as bricks or blocks.

Also, as illustrated, each conveyor unit A,B can be used either way up, because they are the same top and bottom. However, in an alternative arrangement, the sealing strips 16 on one side are omitted. This might limit the use of this side of the conveyor unit to the transport of objects rather than loose material, but it has the benefit of reducing frictional

forces on the belt and reducing manufacturing costs.

CLAIMS

1. A conveying system comprising a plurality of conveyor units each comprising a frame supporting a roller at each end over which a conveyor belt passes in a continuous loop and at least one of which is driven by an electric motor, characterised in that each of said conveyor units is readily moveable so that it can be located in relation to the other conveyor unit or units to form a conveyor feed path, the electric motors of successive conveyor units being interconnected by electrical cables via quick release electrical connectors so that they are powered and controlled in a common power circuit.

2. A system as claimed in claim 1 further characterised in that each electric motor is reversible and said electrical cables are connected in the common power circuit via said quick-release electrical connectors in a selective manner so as to determine the sense in which each motor rotates.

3. A system as claimed in claim 2 further characterised in that each conveyor unit is provided with a pair of quick-release electrical connectors, each of which is connected differently to the electric motor so that the connection of an electrical cable of the common power circuit to one electrical connector causes the electric motor to rotate in one sense, and

the connection of the same electrical cable to the other electrical connector causes the electric motor to rotate in the opposite sense.

4. A system as claimed in claim 3 further characterised that only a single multicore electrical cable is connected between successive conveyor units to connect them into the common power circuit.

5. A system as claimed in any one of the preceding claims which includes a safety circuit comprising said electrical cables so that the safety circuit is triggered and disconnects power from the common power circuit if an electrical connector becomes disconnected or a short-circuit occurs while the conveyor units are operating.

6. A system as claimed in claim 4 which includes a safety loop circuit that extends through each electrical cable and said quick-release electrical connectors, between said pair of quick release electrical connectors within each conveyor unit, and through a terminal quick-release electrical connector so that if the safety loop circuit is broken or short-circuited, it triggers disconnection of power in the common power circuit.

7. A system as claimed in claim 6 in which each conveyor unit incorporates a safety trip which is connected in the safety loop circuit.

8. A system as claimed in claim 6 or 7 in which the common power circuit comprises a power supply unit which is connected to a first conveyor unit via a cable and quick-release electrical connector, successive conveyor units being interconnected via successive cables and quick-release connectors, and the last conveyor having said terminal quick-release connector fitted.

9. A conveyor unit comprising a frame supporting a roller at each end over which a conveyor belt passes in a continuous loop and one of which is driven by a motor, characterised in that the frame comprises a box section structure with upright side walls and lateral walls including an upper bed plate over and along which the conveyor belt slides in use.

10. A conveyor unit as claimed in claim 9 in which the box-section frame structure includes a lower bed plate like the upper bed plate so that the conveyor unit can be used with either bed plate uppermost.

11. A conveyor unit as claimed in claim 9 or 10 in which the box-section frame structure contains rigid structural foam which is injected therein to increase the rigidity of the structure.

12. A conveyor unit as claimed in claim 11 in which the motor is an electrical motor connected to a quick-release electrical connector mounted on the box-section frame

structure, an interconnection between the motor and the quick-release electrical connector being encapsulated in the rigid foam.

13. A conveyor unit as claimed in claim 12 in which said quick-release electrical connector is mounted on a side wall of the frame in alignment with a tubular insert within the frame that is held in the rigid foam and houses a terminal end of said interconnection.

14. A conveyor unit as claimed in any one of claims 9 to 13 including a pair of quick-release electrical connectors, each of which is connected differently to the electric motor so that a power input via one quick-release electrical connector will cause the electric motor to rotate in one sense, and the same power input via the other quick-release electrical connector will cause the electric motor to rotate in the opposite sense.

15. A conveyor unit as claimed in any one of claims 9 to 14 in which each side wall consists of a box-section structure.

16. A conveyor unit as claimed in claim 15 in which each side wall comprises inner and outer sheet metal members connected in face-to-face contact in a central mid-height region, and which diverge therefrom upwardly and downwardly to respective upper and lower lateral web sections which join the sheet metal members together top and bottom, thereby forming

upper and lower box-sections.

17. A conveyor unit as claimed in any one of claims 9 to 16 in which each side wall extends upwards above the upper bed plate to form a channel, in which the conveyor belt runs.

18. A conveyor unit as claimed in claim 17 in which each side wall extends downwards below a lower bed plate connected between the side walls so as to provide a ground engageable support.

19. A conveyor unit as claimed in any one of claims 9 to 18 in which the side walls are substantially symmetrical top and bottom about a central plane extending laterally of the frame.

20. A conveyor unit as claimed in claim 17 or 18 in which sealing strips are mounted along the inside of the side walls within at least one of said channel so as to form a seal with side portions of the conveyor belt within the channel.

21. A conveyor unit as claimed in claim 18 in which sealing strips are mounted along the inside of the side walls above and below the upper and lower bed plates, respectively, so as to form a seal with respective side portions of the conveyor belt.

22. A conveyor unit substantially as herein described with

reference to the accompanying drawings.

23. A conveyor system substantially as herein described with reference to the accompanying drawings.

24. A conveyor unit comprising a frame supporting a roller at each end over which a conveyor belt passes in a continuous loop and at least one of which is driven by a motor, the frame comprising a box-section structure with upright side walls and an upper lateral bed plate, over and along which the upper run of the conveyor belt slides in use, and a lower lateral bed plate, over and along which the lower run of the conveyor belt moves in use, both bed plates being located between the two runs of the conveyor belt, and each side wall extending upwards above the upper bed plate and downwards below the lower bed plate to form respective upper and lower channels in which the conveyor belt runs.



Application No: GB 9614155.1
Claims searched: 24

Examiner: B. J. Thomas.
Date of search: 27 August 1996

Patents Act 1977
Search Report under Section 17

Databases searched:

UK Patent Office collections, including GB, EP, WO & US patent specifications, in:

UK CI (Ed.O): B8A (ALD)

Int CI (Ed.6): B65G 15/60,62,64 21/00,10,12,14

Other: ONLINE:WPI

Documents considered to be relevant:

Category	Identity of document and relevant passage	Relevant to claims
A	GB 2172870 A (SKF) see fig 3	24
A	US 3889801 (BELL) see figs	24

X Document indicating lack of novelty or inventive step
Y Document indicating lack of inventive step if combined with one or more other documents of same category.
& Member of the same patent family

A Document indicating technological background and/or state of the art.
P Document published on or after the declared priority date but before the filing date of this invention.
E Patent document published on or after, but with priority date earlier than, the filing date of this application.