

(19) World Intellectual Property
Organization
International Bureau



(43) International Publication Date
9 December 2004 (09.12.2004)

PCT

(10) International Publication Number
WO 2004/105803 A1

- (51) International Patent Classification⁷: **A61K 49/22**, A61B 19/00
- (21) International Application Number: PCT/US2004/014731
- (22) International Filing Date: 12 May 2004 (12.05.2004)
- (25) Filing Language: English
- (26) Publication Language: English
- (30) Priority Data:
10/444,428 23 May 2003 (23.05.2003) US
- (71) Applicant (for all designated States except US): **SENORX, INC.** [US/US]; 11 Columbia, Suite A, Aliso Viejo, CA 92656 (US).
- (72) Inventors: **BURBANK, Fred, H.**; 12 Old Ranch Road, Laguna Niguel, CA 92677 (US). **JONES, Michael, L.**; 6332 Camino Marinero, San Clemente, CA 92673 (US). **LOUW, Frank**; 6188 Paseo Tienda, Carlsbad, CA 92009 (US). **LUBOCK, Paul**; 30 Bethany, Laguna Niguel, CA 92677 (US).
- (74) Agent: **LYNCH, Edward, J.**; Duane Morris LLP, One Market, Spear Tower, Suite 2000, San Francisco, CA 94105 (US).
- (81) Designated States (unless otherwise indicated, for every kind of national protection available): AE, AG, AL, AM, AT, AU, AZ, BA, BB, BG, BR, BW, BY, BZ, CA, CH, CN, CO, CR, CU, CZ, DE, DK, DM, DZ, EC, EE, EG, ES, FI, GB, GD, GE, GH, GM, HR, HU, ID, IL, IN, IS, JP, KE, KG, KP, KR, KZ, LC, LK, LR, LS, LT, LU, LV, MA, MD, MG, MK, MN, MW, MX, MZ, NA, NI, NO, NZ, OM, PG, PH, PL, PT, RO, RU, SC, SD, SE, SG, SK, SL, SY, TJ, TM, TN, TR, TT, TZ, UA, UG, US, UZ, VC, VN, YU, ZA, ZM, ZW.
- (84) Designated States (unless otherwise indicated, for every kind of regional protection available): ARIPO (BW, GH, GM, KE, LS, MW, MZ, NA, SD, SL, SZ, TZ, UG, ZM, ZW), Eurasian (AM, AZ, BY, KG, KZ, MD, RU, TJ, TM), European (AT, BE, BG, CH, CY, CZ, DE, DK, EE, ES, FI, FR, GB, GR, HU, IE, IT, LU, MC, NL, PL, PT, RO, SE, SI, SK, TR), OAPI (BF, BJ, CF, CG, CI, CM, GA, GN, GQ, GW, ML, MR, NE, SN, TD, TG).
- Published:**
— with international search report
— before the expiration of the time limit for amending the claims and to be republished in the event of receipt of amendments
- For two-letter codes and other abbreviations, refer to the "Guidance Notes on Codes and Abbreviations" appearing at the beginning of each regular issue of the PCT Gazette.

(54) Title: MARKER OR FILLER FORMING FLUID FOR USE IN BIOPSY PROCEDURES

(57) Abstract: A solution for forming a marker or filler mass for an intracorporeal site. The solution contains a polar, water soluble non-aqueous solvent such as dimethyl sulfoxide and a bioabsorbable, essentially water insoluble polymer such as polylactic acid, or copolymers of lactic acid and glycolic acid. The solution may be delivered to the biopsy site by a suitable syringe and delivery tube. The delivery tube is preferably provided with a releasable radiopaque element on the distal tip which can be released within the polymeric marker mass formed in the biopsy cavity.

WO 2004/105803 A1

MARKER OR FILLER FORMING FLUID FOR USE IN BIOPSY PROCEDURES

FIELD OF THE INVENTION

[0001] This invention relates generally to the introduction of filler or marker material into a patient's body, and particularly to the filling a biopsy site within a patient's body from which a biopsy specimen has been taken with a mass of marker material.

BACKGROUND OF THE INVENTION

[0002] In diagnosing and treating certain medical conditions, it is often desirable to perform a biopsy, in which a specimen or sample of tissue is removed for pathological examination, tests and analysis. As is known, obtaining a tissue sample by biopsy and the subsequent examination are typically employed in the diagnosis of cancers and other malignant tumors, or to confirm that a suspected lesion or tumor is not malignant. The information obtained from these diagnostic tests and/or examinations is frequently used to devise a plan for the appropriate surgical procedure or other course of treatment. For example, breast biopsies may be taken where a suspicious lump or swelling is noticed in a breast. Examination of tissue samples taken by biopsy is of particular significance in the diagnosis and treatment of breast cancer. In the ensuing discussion, the biopsy and treatment site described will generally be the human breast, although the invention is suitable for marking biopsy sites in other parts of the human and other mammalian body as well.

[0003] After the biopsy sample is taken, it may take several days or weeks before the results of the examination of the sample are obtained, and still longer before an appropriate treatment decision is reached. If the decision involves surgery it is clearly important for the surgeon to find the location in the breast from where the tumor tissue has been taken in the biopsy procedure, so that the entire tumor and possibly surrounding healthy tissue can be removed.

[0004] However, radiographically visible tissue features, originally observed in a mammogram, may be removed, altered or obscured by the biopsy procedure. In order for the surgeon or radiation oncologist to direct surgical or radiation treatment to the precise location of the breast lesion several days or weeks after the biopsy procedure was performed, it is desirable that a biopsy site marker be placed in or on the patient's body to serve as a landmark for subsequent location of the lesion.

[0005] Various types of biopsy site markers have been described, including visible markers applied externally to the patient's skin, radiographically (X-ray)-detectable tissue markers such as clips and staples, and ultrasound-detectable markers, have also been described. X-ray-detectable marker wires may be inserted through a biopsy needle, leading from the surface of the patient's body to the biopsy site. Some markers may be biodegradable.

[0006] However, due to the consistency of breast tissue and the fact that these biopsy site markers are typically introduced while the breast is still compressed between the mammography plates, prior art biopsy markers may not remain at the specific biopsy location after the breast has been decompressed and removed from the mammography apparatus, and may suffer from additional disadvantages as well. In order to locate an X-ray-detectable marker left at a biopsy site, an additional mammography is generally required at the time of follow up treatment or surgery. In addition, once it is located using mammography, the biopsy site must usually be marked again with a location wire that is visible by eye to provide guidance to the clinician performing the treatment or surgery. However, as the patient is removed from the mammography apparatus, or otherwise transported, the position of the location wire can change or shift before the treatment or surgery is performed, which may result in treatments being misdirected to undesired locations. Furthermore, at least some

prior art biopsy site markers can remain present at the site of implantation for an indefinite period of time and, if not surgically removed, may obscure or otherwise interfere with any subsequent mammography or imaging studies.

[0007] However, due to the large amount of fibrous tissue normally present in a human breast, and due to the presence of ligaments running through the breast, a marker that simply has a bright signal alone will not provide a useful signal that is readily discernable from the many anatomic features normally present within a human breast. Such markers are typically small, being sized to fit within a syringe or other delivery tube, and so are often not readily distinguishable from natural features of the breast, which include occasional small ultrasound-bright spots.

[0008] As an alternative or adjunct to radiographic imaging, ultrasonic imaging and visualization techniques (abbreviated as "USI") can be used to image the tissue of interest at the site of interest during a surgical or biopsy procedure or follow-up procedure. USI is capable of providing precise location and imaging of suspicious tissue, surrounding tissue and biopsy instruments within the patient's body during a procedure. Such imaging facilitates accurate and controllable removal or sampling of the suspicious tissue so as to minimize trauma to surrounding healthy tissue.

[0009] For example, during a breast biopsy procedure, the biopsy device is often imaged with USI while the device is being inserted into the patient's breast and activated to remove a sample of suspicious breast tissue. As USI is often used to image tissue during follow-up treatment, it may be desirable to have a marker, similar to the radiographic markers discussed above, which can be placed in a patient's body at the site of a surgical procedure and which are visible using USI. However, radiopaque markers may not be visible with USI. A marker visible with USI enables a follow-up procedure to be performed without the need for traditional radiographic

mammography imaging which, as discussed above, can be subject to inaccuracies as a result of shifting of the location wire as well as being tedious and uncomfortable for the patient.

[0010] Thus, there is need in fine art for biopsy site markers that are deliverable into the cavity created by removal of fine biopsy specimen and not into tissue that is located outside of that biopsy cavity, and which will not migrate from the biopsy cavity even when the breast tissue is moved, manipulated or decompressed. Moreover, such desired markers should remain detectable at the biopsy site (i.e., within the biopsy cavity for a desired time period); should not interfere with imaging of the biopsy site and adjacent tissues at a later time; and should be readily distinguishable in the various imaging procedures from lines of calcifications which frequently are signs for a developing malignancy.

SUMMARY OF INVENTION

[0011] The invention is directed to the deployment of a marker or filler forming material at intracorporeal locations such as biopsy sites, sites for cosmetic treatments and other sites which may need additional bulk. The marker or filler material is formed intracorporeally from a biocompatible solution having as a solute bioabsorbable polymeric material which is relatively insoluble in body fluid or other water based fluids and a water soluble, non-aqueous polar solvent such as dimethyl sulfoxide (DMSO). Suitable bioabsorbable polymers include polylactic acid, polyglycolic acid, polycaprolactones and copolymers and blends thereof. When the marker or filler forming fluid contacts body fluid or other water based fluids present at intracorporeal locations, the non-aqueous solvent is quickly absorbed by the body fluid or water based fluid present at the site, precipitating a mass of the water insoluble bioabsorbable polymeric material at the site. The polymeric material forming the

marker or filler mass is preferably inherently ultrasonically detectable or the marker fluid may be treated to have a plurality of gas bubbles or otherwise aerated, so that upon formation of the polymeric mass at the site, gas is incorporated in the solid mass forming to provide ultrasonically detectable porosity.

[0012] The following description of embodiments of the invention is primarily directed to deployment of mass at a biopsy site for purposes of remote detection of the biopsy site. However, it should be recognized that the invention may be employed to form filling or bulking masses at an intracorporeal locations for cosmetic and other uses, as previously alluded to.

[0013] After a biopsy specimen is removed from the patient, a guiding member such as a cannula or other tubular member is preferably left within the patient with the distal end thereof within or close to the biopsy site in order to provide subsequent access to the biopsy site. The tubular guiding member may be part of the biopsy system such as a SenoCor 360™ or a Mammotome® system which was used to separate the tissue specimen and remove it from the site but which remains in place after the specimen has been removed. The marker forming fluid embodying features of the invention, may be suitably delivered by a syringe with an elongated delivery tube which at least in part fits within a tubular guiding member leading to the biopsy site.

[0014] Generally, the amount of polymeric solute ranges from about 1 to about 50 %, preferably about 10 to about 35% by weight of the marker or filler forming fluid. The ratio of the polymer solute to the solvent can be varied to adjust the delivery characteristics and the in-vivo lifetime (i.e. the time period in which the polymeric mass is at the biopsy site). For example a lower percentage of polymeric material in the mix will provide a softer or more friable marker mass within the cavity, whereas a higher percentage will provide a firmer marker mass. Lower percentages of solvent will

provide thicker marker fluids which will not be readily displaced from the biopsy site, whereas higher percentages will provide a less viscous solution which is easier to deliver. High molecular weight polylactic acid provides a longer in-vivo life time, e.g. up to a year or more. A lower molecular weight polymeric material such as a copolymer of lactic acid (90%) and glycolic acid (10%) provides an in-vivo life time of about two to three weeks. A copolymer of lactic acid (65%) and glycolic acid (35%) with a molecular weight of about 60 kD has an in-vivo lifetime of about 12 to 14 weeks.

[0015] An ultrasound-detectable marker typically must remain in place and be remotely detectable within a patient for at least 2 weeks to have any practical clinical value. Thus, an ultrasound-detectable marker material embodying features of the invention is detectable at a biopsy site within a patient for a time period of at least 2 weeks, preferably at least about 6 weeks, and may remain detectable for a time period of up to about 20 weeks or more. An ultrasound-detectable marker mass embodying features of the invention is preferably not detectable after about one year, and usually not more than about 6 months after placement at a biopsy site. More preferably, the ultrasound-detectable marker mass should not be detectable with ultrasound after about 12 weeks from placement at a biopsy site. A preferable in-vivo lifetime for an ultrasound-detectable biopsy marker mass having features of the invention is about 6 weeks to about 12 weeks.

[0016] The detectable marker mass which forms in the biopsy cavity should be large enough to fill a substantial portion, preferably all of the cavity. This allows the detection and definition of the boundaries of the biopsy cavity. The accessing passageway leading to the biopsy cavity may also at least in part be filled with the marker fluid as well if desired, which allows the physician to follow to locate the marker mass. The marker mass which forms in the cavity is ultrasonically detectable, but the marker fluid

may also include ultrasonically or radiographically detectable powders or other particulate to augment the detection of the polymeric mass or the biopsy cavity. Other therapeutic and diagnostic agents may be incorporated into the marker fluid such as pharmaceutical agents, chemotherapeutic agents, anesthetic agents, hemostatic agents, pigments, dyes, radiopaque agents, materials detectable by magnetic resonance imaging (MRI), inert materials, and other compounds.

[0017] In one embodiment of the invention, the delivery system is employed to incorporate a radiopaque or other type of long term or permanent marker element within the polymeric mass which forms in the biopsy cavity. For example, the distal end of the syringe assembly or the tubular guide member leading to the biopsy site may be provided with a distal tip which is formed of radiopaque or other suitable material and which is releasably secured to the distal portion of the syringe or guide member so that upon formation of the marker mass from the marker fluid, the distal tip of the syringe or guide member can be released within the formed polymer marker mass and the syringe or guide member then removed from the mass.

[0018] The biopsy site markers formed by the present invention provide ultrasonically bright images which can be readily distinguished from the ultrasound signals arising naturally from within a breast or other tissue and which readily contrasts with the dark ultrasound shadow region immediately behind the bright ultrasound echo region. The strength of the reflected signal, and the contrast with the shadow region, make the marked site readily detectable even to relatively inexperienced surgeons. The in-vivo lifetime of the marker at the biopsy site can be preselected by adjusting the amount of polymeric material in the marker fluid and the molecular weight thereof. The employment of the filler forming functions of the solution may be advantageously utilized in cosmetic treatments similar to the uses of collagen, e.g. wrinkle removal or

minimization, or in situations in which additional bulk is needed within a patient's body, e.g., treating for urinary incontinence.

[0019] These and other advantages will be evident from the following detailed description when taken in conjunction with the accompanying exemplary drawings.

BRIEF DESCRIPTION OF THE DRAWINGS

[0020] Fig. 1A is an elevational view, partially in section, of a marker fluid delivery system embodying features of the invention.

[0021] Fig. 1B is a transverse cross-sectional view taken along line 1B-1B shown in Fig.1A.

[0022] Fig. 1C is a transverse cross-sectional view taken along line 1 C-1 C shown in Fig. 1A.

[0023] Fig. 1D is a transverse cross-sectional view taken along line 1D-1D shown in Fig.1A.

[0024] Fig. 2 is a partially cut-away, perspective view of a system as illustrated in Fig. 1 shown depositing a marker fluid embodying features of the invention at a biopsy site within a breast of a female patient.

[0025] Fig. 3 is a perspective view, partially in section, of the distal portion of a delivery system having a releasable marker element on the distal tip of the delivery tube which acts as a long term or permanent marker.

[0026] Fig. 4 is a longitudinal, centerline cross-section of a delivery system having a releasable radiopaque distal tip.

[0027] Fig. 5 is a longitudinal, centerline cross-section of a delivery system having a releasable radiopaque distal tip which is threadably connected to the distal end of the delivery cannula and which has a grooved exterior to facilitate release of the distal tip.

[0028] Fig. 6 is a transverse cross-sectional view of the releasable distal tip shown in

Fig. 5 taken along the lines 6-6.

[0029] Fig. 7 is an elevational view of a delivery cannula suitable for use to deliver the marker or filler forming fluid embodying features of the invention.

DETAILED DESCRIPTION OF THE INVENTION

[0030] Figs. 1A-1D illustrate a system 10 for delivery of biopsy marker fluid 11 embodying features of the invention to a biopsy site within a patient's body. The system 10 includes a syringe 12 having a bore 13 containing a quantity of biopsy marker fluid 11. A plunger 14 with a sealable distal end 15 is slidably disposed within the bore 13 of syringe 12. Application of pressure to the head 16 of plunger 14 applies pressure to the fluid 11 and causes the discharge of fluid 11 from the bore 13 into the inner lumen 17 of delivery tube 18 secured to the discharge end of syringe 12. The marker fluid 11 passes through the inner lumen or bore 17 of the delivery tube 18 and out the discharge port 19 in the distal end of delivery tube 18.

[0031] As schematically illustrated in Fig. 1A, delivery tube 18 is secured to the syringe 12 by a friction fit. However, those skilled in the art will recognize that a variety of connections may be made between the syringe 12 and the delivery tube 18 such as a conventional luer-lock. The delivery tube 18 may have markings, such as lines or dots spaced at regular intervals along the length of the tube to indicate its position within the patient.

[0032] Fig. 2 illustrates the marker fluid delivery system 10 shown in Figs. 1A-1D with the distal portion of the delivery tube 18 operatively disposed within a patient's breast 20 with the distal tip 21 of the delivery tube 18 disposed within biopsy cavity 22 at the biopsy site 23 ready to deliver marker fluid 11. An incision 24 in the breast 20 allows access to the cavity 22. Biopsy tubular guide member 25 extends through

incision 24 in the patient's breast 20 into cavity 22 at biopsy site 23. The distal end 26 of syringe 12, containing marker fluid 11, is tightly engaged with delivery tube 18, which extends within guide member 25 so as to locate delivery tube outlet port 19 within biopsy cavity 22. The outer diameter of the delivery tube 18 is configured to allow the delivery tube to slidably fit inside the inner lumen 27 of biopsy guide member 25. Markings 28 spaced at regular intervals along the outer surface of delivery tube 18 indicate the depth of insertion of the tube within the guide member 25 and aid in the proper placement of discharge port 19 into position within cavity 22. Depression of plunger 14 of the syringe 12 forces marker fluid 11 out of syringe 12 through the inner lumen 17 of the delivery tube 18 and out port 19 into the cavity 22.

[0033] Fluid 11 mixes with body fluid or other water based fluid which may be present in the cavity 22. The solvent in fluid 11 is quickly dissolved in the body fluid or other water based fluid. The polymer solute which precipitates is relatively insoluble in the body fluid or other water based fluid which may be present in the cavity and forms a porous, ultrasonically detectable and bioabsorbable polymer mass 30 within the cavity 22. The mass 30 preferably essentially fills the biopsy cavity 22 so as to define the periphery of the biopsy cavity and to ensure that the mass remains within the biopsy cavity and will not migrate. The mass is subsequently absorbed by tissue and fluids near the biopsy site, so that at the end of the in-vivo life time of the bioabsorbable mass 30, the marker mass is no longer readily detectable at the site by ultrasonic means. Tissue ingrowth usually replaces the absorbed mass.

[0034] The preferred solvent for the fluid 11 is a pharmaceutical grade (USP) of DMSO. Other biocompatible water soluble, polar solvents are suitable. The preferred relatively water-insoluble bioabsorbable polymers are polylactic acid, poly glycolic acid, copolymers of lactic acid and glycolic acid, polycaprolactone. However, other suitable

bioabsorbable, essentially water insoluble polymers include poly(esters), poly(hydroxy acids), poly(lactones), poly(amides), poly(ester-amides), poly(amino acids), poly(anhydrides), poly(ortho-esters), poly(carbonates), poly(phosphazines), poly(thioesters), poly(urethanes), poly(ester urethanes), polysaccharides, polylactic acid, polyglycolic acid, polycaproic acid, polybutyric acid, polyvaleric acid, and copolymers, polymer alloys, polymer mixtures, and combinations thereof.

[0035] The marker mass preferably essentially fills the biopsy cavity so as to define the periphery of the biopsy site cavity and to ensure that the marker mass remains within the biopsy cavity and will not migrate. The marker materials are resorbed by tissue and fluids near the biopsy site, so that, after their in-vivo life times, the marker materials are no longer USI-detectable at the biopsy site.

[0036] The marker fluid may also include radiopaque materials or radiopaque markers, so that the biopsy site may be detected both with ultrasound and with X-ray or other radiographic imaging techniques. Radiopaque materials and markers may include metal objects such as clips, bands, strips, coils, and other objects made from radiopaque metals and metal alloys, and may also include powders or particulate masses of radiopaque materials. Radiopaque markers may include liquid contrast agents such as Ethiodol or other non-water based contrast agents. Radiopaque markers may be of any suitable shape or size, and are typically formed in a recognizable shape not naturally found within a patient's body. Suitable radiopaque materials include stainless steel, platinum, gold, iridium, tantalum, tungsten, silver, rhodium, nickel, bismuth, other radiopaque metals, alloys and oxides of these metals, barium salts, iodine salts, iodinated materials, and combinations of these. The marker fluid may also include MRI-detectable materials or markers, so that the biopsy site may

be detected with MRI techniques. MRI contrast agents such as gadolinium and gadolinium compounds, for example, are suitable for use with ultrasound-detectable biopsy marker materials embodying features of the invention. Colorants, such as dyes (e.g., methylene blue and carbon black) and pigments (e.g., barium sulfate), may also be included in the marker fluid of the invention. The colorant such as carbon black usually remains in the track or passageway leading to the marker or filler mass and this can be followed by the surgeon to the desired location.

[0037] Therapeutic agents to reduce bleeding, enhance clotting, to cause vasoconstriction, to prevent infections and other diseases, to reduce pain, chemotherapeutic agents to treat remnant cancer cells at the site may be incorporated into the marker fluid. Suitable therapeutic agents are provided in co-pending application Serial No. 10/124,757, filed on April 16, 2002, which is incorporated herein in its entirety by reference.

[0038] Figs. 3 and 4 depict the distal portion of an alternative delivery tube 30 which is disposed within tubular guide 31 and which has a releasable radiopaque element 32 on the distal tip of the delivery tube. A cannula 33 is slidably disposed about the delivery tube 30. Relative longitudinal movement between the cannula 33 and delivery tube 30, as depicted by arrows 34 and 35, pushes the radiopaque element 32 off the end of the tube into the cavity 36 as shown in Fig. 4. When the marker fluid 37 containing a non-aqueous, water soluble solvent and a relatively water insoluble polymeric solute is injected into the biopsy cavity 36 and the polymer mass is formed, the radiopaque element 32 is released from the delivery tube 30 and left within the polymer mass. The radiopaque element 32 is released within the polymer mass at a point in the formation of the mass which ensures that the position of the radiopaque

element 32 is maintained after the distal end of the delivery tube 30 is removed from the cavity 36. Preferably, the radiopaque element 32 is centrally located within the biopsy cavity 36.

[0039] Figs. 5 and 6 illustrate an alternative embodiment in which a releasable radiopaque element 40 is the distal tip of delivery tube 41. As shown, the element 40 is threadably connected to the distal portion of the delivery tube 41 and has a grooved exterior 42 which helps to fix the tip in the polymeric mass. This allows the delivery tube 41 to be unscrewed from the tip element 40 and to be withdrawn from the patient, leaving the radiopaque tip 40 within the polymeric mass.

[0040] The releasable radiopaque element may have a variety of other shapes which are recognizable as not being naturally found within a patient's body to facilitate remote detection radiographically or ultrasonically. For example, the radiopaque may have an exterior transverse shape such as a star or a square. The radiographically detectable distal tip may be formed of a suitable radiopaque material such as stainless steel, platinum, gold, iridium, tantalum, tungsten, silver, rhodium, nickel, bismuth, other radiopaque metals, alloys and oxides of these metals. Radiopaque salts such as barium salts, iodine salts, iodinated materials, and combinations of these may be incorporated into polymeric or ceramic materials which form the releasable tip.

[0041] As shown in Fig. 7, the deployment system may have a delivery tube 50 with a needle-like distal tip 51 to facilitate advancement of the delivery tube through tissue to the target site. This embodiment is particularly suitable in those situations in which there is no guide tube or other cannula in place to provide access to the target site.

[0042] Markers embodying features of the present invention remain detectable at an intracorporeal site for a desired time period, and degrade or dissolve so as to not interfere with imaging of the biopsy site and adjacent tissues at a later time. Suitable

marker materials typically do not migrate from the biopsy site before being dissolved or otherwise absorbed, and so provide reliable temporary marking of the location of a biopsy site and the margins thereof. The marker materials having features of the invention are readily distinguishable from natural body features including signs of a developing or an actual malignancy. The present invention also includes apparatus and method for delivering markers to a biopsy site.

[0043] The purpose of markers embodying features of the invention is to facilitate the location and performance of a surgical procedure that is performed while the marker is still detectable. The in-vivo lifetime of the marker mass remaining in the biopsy cavity is relatively short, e.g. less than one year, preferably less than about six months.

Typically, the marker mass should have an in-vivo life time of about 6 to about 20 weeks, preferably 6 to 12 weeks. The disappearance of a marker after a longer period of time is required to avoid obscuring or interfering with follow-up imaging or further mammography.

[0044] Typically, the marker fluid embodying features of the present invention containing ultrasound-detectable solute of bioabsorbable polymeric material of the present invention is deposited at a biopsy site within a patient's body to form a biopsy marker mass at the site to allow for the subsequent location of the site by medical personnel. Thus, for example, a quantity of fluid formed of a non-aqueous water soluble solvent such as DMSO with a bioabsorbable polymeric material which is essentially insoluble in body fluids or other water based fluids is delivered into a cavity at a biopsy site. When the solution comes into contact with body fluid or other water based fluid at the biopsy site, the solvent is quickly dissolved in the body fluid and the relatively water insoluble polymeric solute forms a marker mass within the biopsy cavity.

[0045] The in-vivo lifetime of the polymeric material, i.e. the time period in which the polymeric mass is ultrasonically detectable, is related to the molecular weight of the polymer. For example, copolymers of lactic and glycolic acids having an initial, molecular weight of about 45,000 Daltons (45 kD) before processing, are suitable for use in making an ultrasound-detectable marker material having an in-vivo lifetime of about 12 weeks. As is known to those of ordinary skill in the art, other materials, including other polymeric materials, may require a different starting molecular weight in order to obtain the same in-vivo lifetime. For example, polyglycolic acid typically degrades faster than other materials and as such requires a substantially higher initial molecular weight than polylactic acid or polycaprolactone to obtain a similar in-vivo lifetime.

[0046] Many properties of a material affects the intensity of its ultrasound reflection, including density, physical structure, molecular material, and shape. For example, sharp edges, or multiple reflecting surfaces on or within an object differing in density from its surroundings enhances its ability to be detected by ultrasound. Interfaces separating materials of different densities, such as between a solid and a gas, produce strong ultrasound signals.

[0047] The methods of the present invention provide materials having a porosity effective to produce strong ultrasound signals when located within the patient's biopsy cavity. The polymeric material may naturally form a porous mass or porosity can be formed by introducing a gas into the material during processing of a material, by release of gas from within the material, or by directing a gas into a material or by incorporating a blowing agent.

[0048] A typical human breast has a substantial number of features that are visualized with ultrasound. These features all have characteristic signals. Fibrous

tissue or ligaments tend to show up as bright streaks, fat seems to appear as a dark gray area, the glandular tissue appears as a mottled medium gray mass. Cancerous lesions typically appear as a darker area with a rough outer edge which has reduced through transmission of the ultrasound energy. One advantage of the ultrasound-detectable biopsy marker materials of the present invention is that the materials provide an ultrasound signal which can be readily differentiated from anatomic structures within the breast, so that the identification and marking of a biopsy cavity does not require extensive training and experience.

[0049] The delivery syringe and the delivery tube attached to the syringe may be sized to accept any volume of marker or filler forming fluid desired to be injected into the desired intracorporeal site. The average Mammotome® biopsy removes about 0.5 to about 2, typically about 1 ml of tissue. The volume of marker fluid introduced into the biopsy cavity which remains after the removal of the tissue specimen is about the same as the tissue volume removed. Use of more marker fluid typically leads to some filling of the accessing passageway as well as of the cavity at the biopsy site. Smaller volumes of marker fluid may be used for smaller cavities at a biopsy site, such as are created with a single SenoCor 360™ biopsy or an automated Tru-Cut® biopsy.

[0050] The solution embodying features of the invention may also be employed as a filler or bulking agent. For example, the filler forming fluid may be used in a manner similar to collagen for cosmetic purposes to minimize wrinkles, to fill pockmarks and other surface pits. The solution may also be used to bulk up an area of tissue for a variety of reasons. For example, if a radiation source for treating a tumor or a tumor site after removal of the tumor is located too close to the patient's skin, e.g. less than about 5 mm, the skin may be damaged or ultimately scarred by the irradiation. By deploying the filler forming fluid embodying features of the invention between the

irradiation source and the skin, the damage or scarring to the skin can be reduced or eliminated. Depending upon the source of the radiation, either a single bolus or multiple bolus may be employed to bulk up the region and to displace the skin sufficiently to avoid damage.

[0051] The filler forming fluid embodying features of the invention may also be employed to provide a bulking mass about a urethra in the treatment of urinary incontinence, for a bulking mass about an anal sphincter for fecal incontinence and a bulking mass about an esophageal sphincter for gastroesophageal reflux disease. Other uses will become apparent to those skilled in the art.

[0052] While particular forms of the invention have been illustrated and described, it will be apparent that various modifications can be made without departing from the spirit and scope of the invention. Accordingly, it is not intended that the invention be limited to the specific embodiments illustrated and shall be defined by the scope of the appended claims as broadly as the prior art will permit. Moreover, those skilled in the art will recognize that features shown in one embodiment may be utilized in other embodiments. Terms such a "element", "member", "device", "sections", "portion", "section", "steps" and words of similar import when used herein shall not be construed as invoking the provisions of 35 U.S.C. §112(6) unless the following claims expressly use the terms "means" or "step" followed by a particular function without specific structure or action.

WHAT IS CLAIMED IS:

1. A biopsy marker forming fluid for forming a remotely detectable marker within a biopsy site comprising a solution containing at least in part a relatively water insoluble bioabsorbable polymeric solvent dissolved in a polar, non-aqueous, water soluble biocompatible solvent.
2. The biopsy marker forming fluid of claim 1 wherein the bioabsorbable polymeric material is selected from the group consisting of polylactic acid, polyglycolic acid, polycaprolactone and copolymers, blends and mixtures thereof.
3. The biopsy marker forming fluid of claim 2 wherein the polymeric material is a copolymer of polylactic acid and polyglycolic acid and the weight ratio of polylactic acid to polyglycolic acid is about 90:10 to about 60:40.
4. The biopsy marker forming fluid of claim 2, wherein the copolymer comprises 65% (by wt) polylactic acid and 35% (by wt.) polyglycolic acid.
5. The biopsy marker forming fluid of claim 1 containing about 1 to about 50% by weight water insoluble, bioabsorbable polymeric solute.
6. The biopsy marker forming fluid of claim 8 containing about 10 to about 90% by weight water insoluble, bioabsorbable polymeric solute.
7. The biopsy marker forming fluid of claim 1 wherein the polar solvent is dimethyl sulfoxide.
8. A biocompatible, remotely detectable marker forming solution suitable for deployment within a biopsy site comprising a polar, non-aqueous solvent which is relatively soluble in a water based fluid and a bioabsorbable polymeric solute which is relatively insoluble in the water based fluid.
9. The biocompatible, remotely detectable marker forming solution of claim 11 wherein the solvent is dimethyl sulfoxide.

10. The biocompatible, remotely detectable marker forming solution of claim 11 wherein the water insoluble, bioabsorbable polymeric solute is selected from the group consisting of polylactic acid, polyglycolic acid, polycaprolactone, copolymers and blends thereof.

11. The biocompatible, remotely detectable marker forming solution of claim 11 containing about 1 to about 35% by weight water insoluble, bioabsorbable polymeric solute.

12. The biocompatible, remotely detectable marker forming solution of claim 11 containing about 10 to about 90% by weight water insoluble, bioabsorbable polymeric solute.

13. The biocompatible, remotely detectable marker forming solution of claim 11 wherein the bioabsorbable polymeric solute forms a polymeric marker mass in-situ which is ultrasonically detectable when in a solid phase.

14. The biocompatible, remotely detectable marker forming solution of claim 16 including a marker element or material which enables remote detection.

15. The biocompatible, remotely detectable marker forming solution of claim 15 wherein the bioabsorbable polymeric material is selected from the group consisting of a poly(ester), a poly(hydroxy acid), a poly(lactone), a poly(amide), a poly(ester-amide), a poly(amino acid), a poly(anhydride), a poly(ortho-ester), a poly(carbonates), a poly(phosphazine), a poly(thioester), a poly(urethane), a poly(ester urethane), a polysaccharide, a polylactic acid, a polyglycolic acid, a polycaproic acid, a polybutyric acid, a polyvaleric acid, and copolymers and blends thereof.

16. The biocompatible, remotely detectable marker forming solution of claim 15, wherein said bioabsorbable polymeric material is selected from the group

consisting of polylactic acids, polyglycolic acids, polycaproic acids, and copolymers and blends thereof.

17. The biocompatible, remotely detectable marker forming solution of claim 15 wherein the bioabsorbable polymeric material has an average molecular weight of less than about 45 kD.

18. The biocompatible, remotely detectable marker forming solution of claim 15 wherein the marker mass formed in contact with a water based fluid has an in-vivo lifetime of at least about 2 weeks.

19. The biocompatible, remotely detectable marker forming solution of claim 15 wherein the marker mass formed in contact with a water based fluid has an in-vivo lifetime not greater than about a year.

20. The biocompatible, remotely detectable marker forming solution of claim 15, wherein the marker mass formed in contact with a water based fluid has an in-vivo lifetime not greater than about six months.

21. The biocompatible, remotely detectable marker forming solution of claim 15, wherein the marker mass which forms in contact with a water based fluid has an in-vivo lifetime between about 6 weeks and about 12 weeks.

22. The biocompatible, remotely detectable marker forming solution of claim 15 wherein the marker mass which forms in contact with a water based fluid includes a radiopaque element.

23. The biocompatible, remotely detectable marker forming solution of claim 15 wherein the radiopaque element is formed of a material selected from the group consisting of stainless steel, platinum, gold, iridium, tantalum, tungsten, silver, rhodium, nickel, bismuth, other radiopaque metals, alloys of radiopaque metals, mixtures of

radiopaque metals, oxides of radiopaque metals, barium salts, iodine salts, iodinated materials, and combinations thereof.

24. A system for marking a biopsy site within a patient, comprising:
 - a. a syringe having an elongated body, an inner bore, a plunger slidably disposed within the inner bore, and a discharge opening in a distal end;
 - b. a delivery tube having a proximal end configured to be secured to the distal end of the syringe, a bore in fluid communication with the inner bore of the syringe; and
 - c. a quantity of marker forming fluid within the bore of the syringe which comprises a solvent which is relatively soluble in a body fluid or other water based fluid and a bioabsorbable polymeric solute which is relatively insoluble in body fluid or other water based fluid.
25. The system of claim 27, wherein the quantity of marker forming fluid in the inner bore of the syringe is about 0.2 ml to about 1.2 ml.
26. The system of claim 27 wherein the distal end of the delivery tube has a remotely detectable releasable distal tip.
27. The system of claim 29 wherein the releasable distal tip is at least in part radiopaque.
28. The system of claim 29 wherein the radiopaque part of the releasable distal tip is formed of one or more materials selected from the group consisting of stainless steel, platinum, gold, iridium, tantalum, tungsten, silver, rhodium, nickel, bismuth, other radiopaque metals, alloys of radiopaque metals, mixtures of radiopaque metals, oxides of radiopaque metals, barium salts, iodine salts, iodinated materials, and combinations thereof.
29. The system of claim 29, wherein the marker forming fluid contains a

radiopaque element.

30. The system of claim 32, wherein the radiopaque element is formed in a recognizable shape not naturally found within a patient's body.

31. The system of claim 27, wherein the polymeric solute is at least in part a copolymer of poly-lactic acid and poly-glycolic acid.

32. The system of claim 27, wherein the marker forming fluid includes at least one agent selected from the group of agents consisting of therapeutic or diagnostic agents.

33. The system of claim 35 wherein the agents include hemostatic agents, radiopaque contrast agents, and coloring agents.

34. The system of claim 27 wherein the marker forming fluid includes a radioactive element.

35. The system of claim 37 wherein the radioactive element is a brachytherapy seed.

36. A biocompatible fluid for forming a marker or filler mass in a non-vascular, intracorporeal location within a patient's body, comprising a solution having a relatively water insoluble bioabsorbable polymeric solute and a polar water soluble solvent.

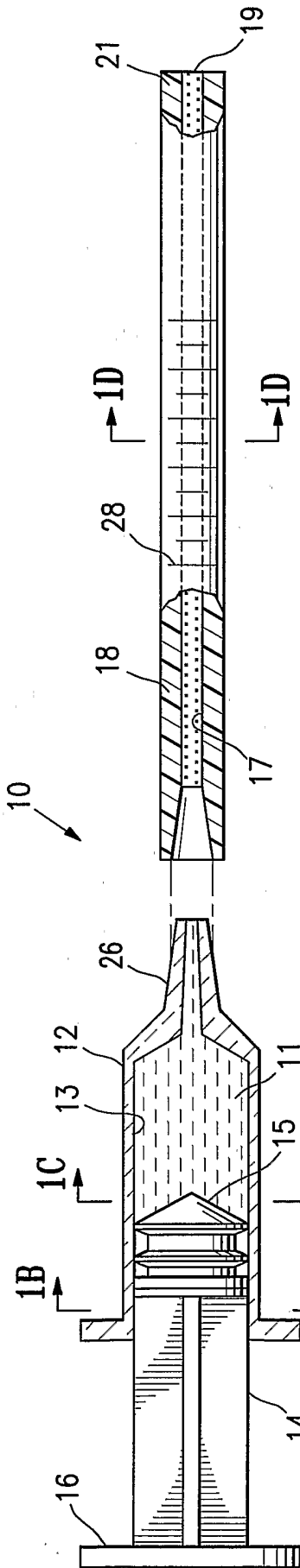

FIG. 1A

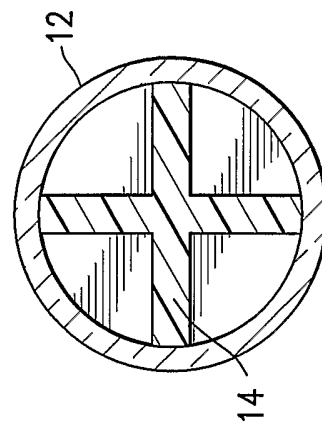

FIG. 1B

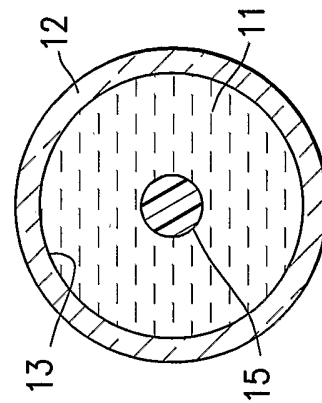

FIG. 1C

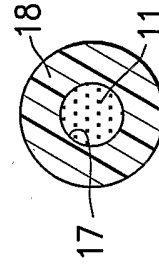

FIG. 1D

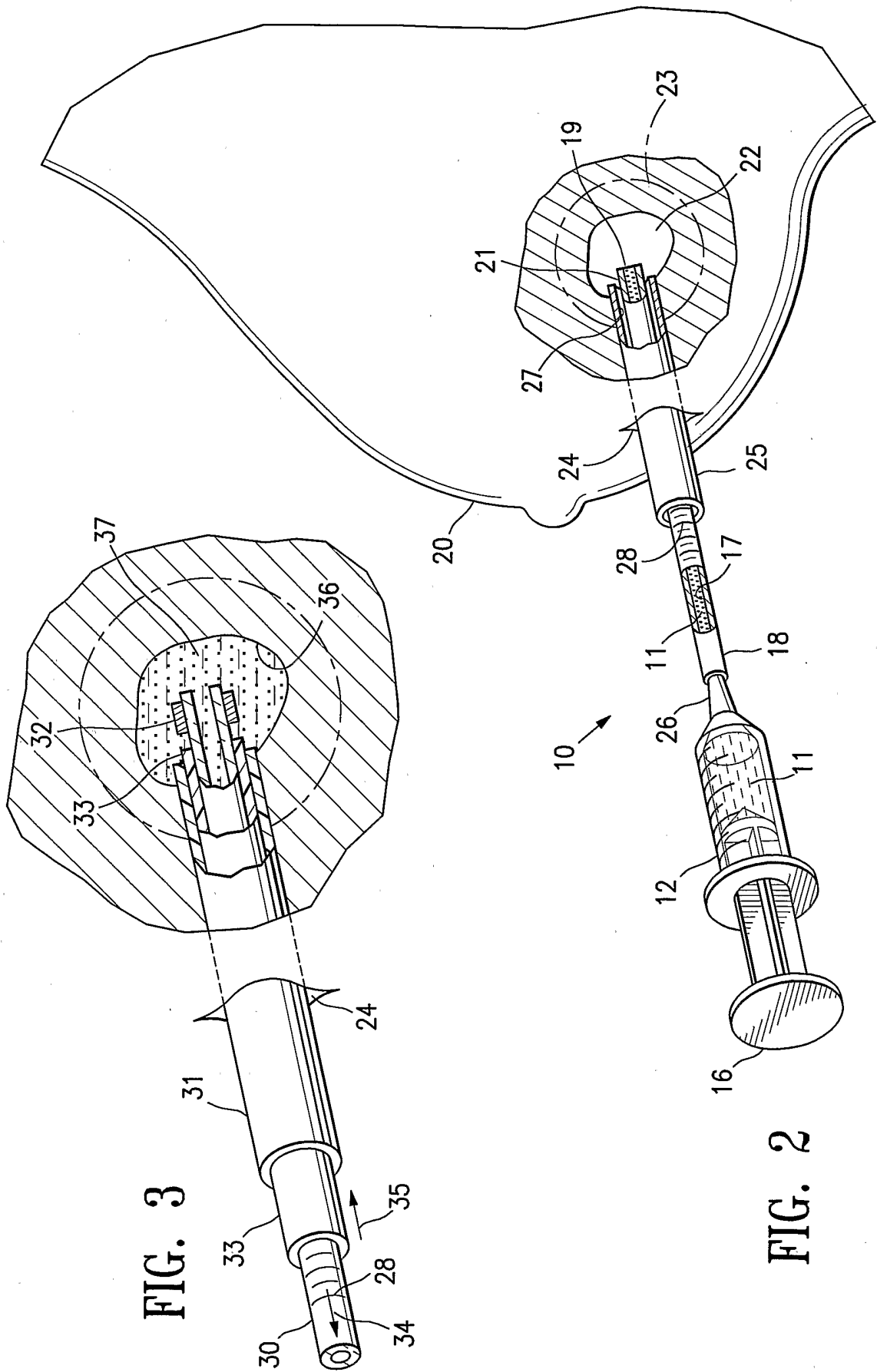

FIG. 3

FIG. 2

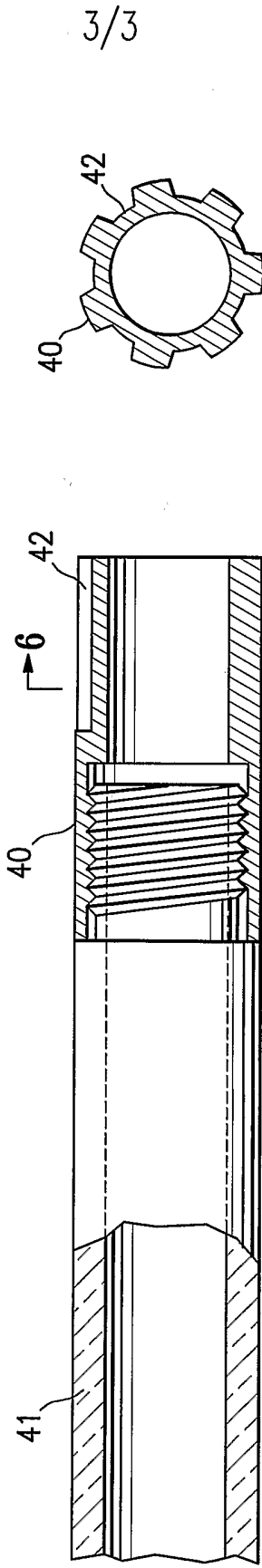
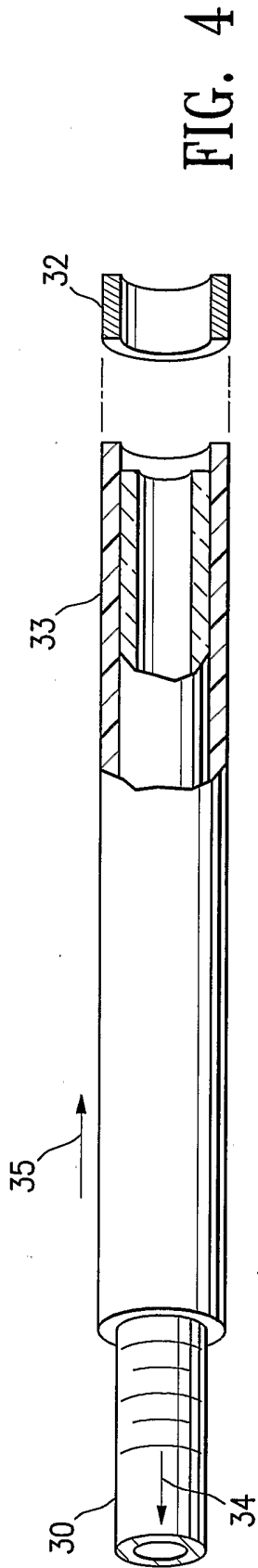
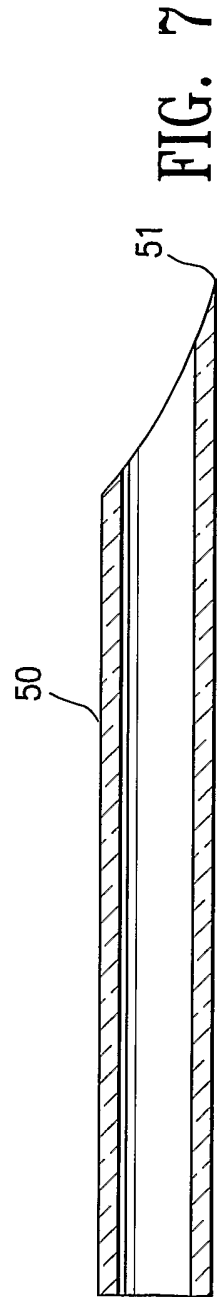

FIG. 5

FIG. 6



3/3

FIG. 7



INTERNATIONAL SEARCH REPORT

International Application No
PCT/US2004/014731

A. CLASSIFICATION OF SUBJECT MATTER
IPC 7 A61K49/22 A61B19/00

According to International Patent Classification (IPC) or to both national classification and IPC

B. FIELDS SEARCHED

Minimum documentation searched (classification system followed by classification symbols)
IPC 7 A61K A61P A61B

Documentation searched other than minimum documentation to the extent that such documents are included in the fields searched

Electronic data base consulted during the international search (name of data base and, where practical, search terms used)

EPO-Internal, WPI Data, PAJ, EMBASE, BIOSIS

C. DOCUMENTS CONSIDERED TO BE RELEVANT

Category °	Citation of document, with indication, where appropriate, of the relevant passages	Relevant to claim No.
X	US 2002/188196 A1 (LUBOCK PAUL ET AL) 12 December 2002 (2002-12-12) the whole document	1-36
P,X	US 2003/233101 A1 (LUBOCK PAUL ET AL) 18 December 2003 (2003-12-18) the whole document	1-36
X	US 6 371 904 B1 (CONSTON STANLEY R ET AL) 16 April 2002 (2002-04-16) the whole document	1-36

Further documents are listed in the continuation of box C.

Patent family members are listed in annex.

° Special categories of cited documents :

- *A* document defining the general state of the art which is not considered to be of particular relevance
- *E* earlier document but published on or after the international filing date
- *L* document which may throw doubts on priority claim(s) or which is cited to establish the publication date of another citation or other special reason (as specified)
- *O* document referring to an oral disclosure, use, exhibition or other means
- *P* document published prior to the international filing date but later than the priority date claimed

- *T* later document published after the international filing date or priority date and not in conflict with the application but cited to understand the principle or theory underlying the invention
- *X* document of particular relevance; the claimed invention cannot be considered novel or cannot be considered to involve an inventive step when the document is taken alone
- *Y* document of particular relevance; the claimed invention cannot be considered to involve an inventive step when the document is combined with one or more other such documents, such combination being obvious to a person skilled in the art.
- * & * document member of the same patent family

Date of the actual completion of the international search

20 September 2004

Date of mailing of the international search report

30/09/2004

Name and mailing address of the ISA

European Patent Office, P.B. 5818 Patentlaan 2
NL - 2280 HV Rijswijk
Tel. (+31-70) 340-2040, Tx. 31 651 epo nl,
Fax: (+31-70) 340-3016

Authorized officer

Skjöldebrand, C

INTERNATIONAL SEARCH REPORT

International Application No
PCT/US2004/014731

Patent document cited in search report	Publication date	Patent family member(s)	Publication date
US 2002188196	A1	12-12-2002	US 6725083 B1 20-04-2004
			US 2001003791 A1 14-06-2001
			US 6161034 A 12-12-2000
			WO 03089012 A2 30-10-2003
			AU 3929002 A 03-06-2002
			CA 2446993 A1 30-05-2002
			WO 0241786 A2 30-05-2002
			AU 5777500 A 31-01-2001
			CA 2376146 A1 04-01-2001
			EP 1189546 A1 27-03-2002
			JP 2003503098 T 28-01-2003
			US 2002038087 A1 28-03-2002
			WO 0100101 A1 04-01-2001
			US 6471700 B1 29-10-2002
			US 2004101479 A1 27-05-2004
			US 2004116806 A1 17-06-2004
			AU 3583500 A 25-08-2000
			CA 2361530 A1 10-08-2000
			EP 1146910 A2 24-10-2001
			JP 2003517453 T 27-05-2003
			WO 0045854 A2 10-08-2000
			US 2002161298 A1 31-10-2002
			US 6427081 B1 30-07-2002
US 2003233101	A1	18-12-2003	WO 03105940 A2 24-12-2003
US 6371904	B1	16-04-2002	US 6356782 B1 12-03-2002
			AU 774994 B2 15-07-2004
			AU 2592400 A 31-07-2000
			CA 2356890 A1 06-07-2000
			EP 1152696 A2 14-11-2001
			WO 0038579 A2 06-07-2000
			US 2002107437 A1 08-08-2002
			US 2002035324 A1 21-03-2002