

(19) World Intellectual Property
Organization
International Bureau



(43) International Publication Date
18 August 2005 (18.08.2005)

PCT

(10) International Publication Number
WO 2005/075091 A1

- (51) International Patent Classification⁷: **B05B 5/16**
- (21) International Application Number:
PCT/JP2004/001357
- (22) International Filing Date: 9 February 2004 (09.02.2004)
- (25) Filing Language: English
- (26) Publication Language: English
- (71) Applicants (for all designated States except US): **MAT-SUSHITA ELECTRIC WORKS, LTD.** [JP/JP]; 1048, Oaza-kadoma, Kadoma-shi, Osaka 5718686 (JP). **THE PROCTER & GAMBLE COMPANY** [US/US]; One Procter & Gamble Plaza, Cincinnati, Ohio 45202 (US).
- (72) Inventors; and
- (75) Inventors/Applicants (for US only): **YAMAGUCHI, Naoki** [JP/JP]; c/o Matsushita Electric Works, Ltd., 1048, Oaza-Kadoma, Kadoma-shi, Osaka 5718686 (JP). **ASAKAWA, Koji** [JP/JP]; c/o Matsushita Electric Works, Ltd., 1048, Oaza-Kadoma, Kadoma-shi, Osaka 5718686 (JP).
- (74) Agents: **NISHIKAWA, Yoshikiyo et al.**; c/o Hokuto Patent Attorneys Office, Umeda-daiichiseimei Bldg. 5th Floor, 12-17, Umeda 1-chome, Kita-ku, Osaka-shi, Osaka 5300001 (JP).
- (81) Designated States (unless otherwise indicated, for every kind of national protection available): AE, AG, AL, AM, AT, AU, AZ, BA, BB, BG, BR, BW, BY, BZ, CA, CH, CN, CO, CR, CU, CZ, DE, DK, DM, DZ, EC, EE, EG, ES, FI, GB, GD, GE, GH, GM, HR, HU, ID, IL, IN, IS, JP, KE, KG, KP, KR, KZ, LC, LK, LR, LS, LT, LU, LV, MA, MD, MG, MK, MN, MW, MX, MZ, NA, NI, NO, NZ, OM, PG, PH, PL, PT, RO, RU, SC, SD, SE, SG, SK, SL, SY, TJ, TM, TN, TR, TT, TZ, UA, UG, US, UZ, VC, VN, YU, ZA, ZM, ZW.
- (84) Designated States (unless otherwise indicated, for every kind of regional protection available): ARIPO (BW, GH, GM, KE, LS, MW, MZ, SD, SL, SZ, TZ, UG, ZM, ZW),

[Continued on next page]

(54) Title: ELECTROSTATIC SPRAYING DEVICE

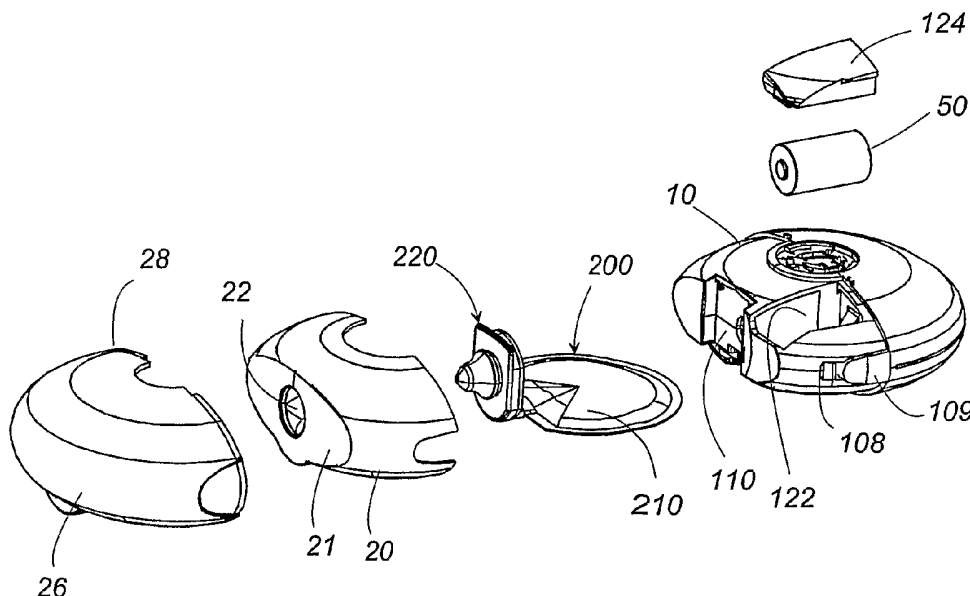

(57) Abstract: An electrostatic spraying device has a removable cartridge with a reservoir containing a volume of liquid compositions to be electrically sprayed on a user's skin. The device includes a nozzle for dispensing the liquid as well as an emitter electrode disposed adjacent to the nozzle for charging the liquid composition just being dispensed from the nozzle. A field electrode surrounds the reservoir in order to charge the liquid composition within the reservoir, thereby avoiding an occurrence of electric current which would otherwise flow in the liquid composition and would deteriorate the composition remaining in the reservoir. The reservoir is devoid of the field electrode, and therefore can be designed into a simple and compact structure without being restricted by the field electrode, assuring to have an enhanced liquid containing volume in relation to the bulk of the removable cartridge.

WO 2005/075091 A1



Eurasian (AM, AZ, BY, KG, KZ, MD, RU, TJ, TM), European (AT, BE, BG, CH, CY, CZ, DE, DK, EE, ES, FI, FR, GB, GR, HU, IE, IT, LU, MC, NL, PT, RO, SE, SI, SK, TR), OAPI (BF, BJ, CF, CG, CI, CM, GA, GN, GQ, GW, ML, MR, NE, SN, TD, TG).

For two-letter codes and other abbreviations, refer to the "Guidance Notes on Codes and Abbreviations" appearing at the beginning of each regular issue of the PCT Gazette.

Published:

— *with international search report*

DESCRIPTION

ELECTROSTATIC SPRAYING DEVICE

TECHNICAL FIELD

The present invention relates to an electrostatic device for personal use, and more particularly to a device for spraying a liquid composition by means of an electrostatic force.

BACKGROUND OF THE INVENTION

WO 03/072263 discloses an electrostatic spraying device having a removable cartridge with a reservoir containing a volume of a liquid composition. The device includes a plunger pump that displaces the liquid out of the reservoir and a nozzle for dispensing the liquid. The nozzle is provided with an emitter electrode which applies a high voltage to the composition being supplied from the reservoir to the nozzle, i.e., electrostatically charge the particles of the liquid composition for spraying the composition by the electrostatic force. In that the liquid composition within the reservoir may be deteriorated upon seeing an electrical current therein, the device is so designed to keep fresh or avoid deterioration of the liquid composition remaining in the reservoir. For this purpose, a field electrode or shield is introduced to surround the reservoir so as to give the same electrical potential to the liquid composition advanced around the nozzle and the composition remaining in the reservoir, and therefore minimizing an undesired current flowing between these zones. Although this scheme of providing the field electrode around the reservoir is suitable for keeping the liquid composition intact, the field electrode itself adds a certain bulk and complexity to the removable cartridge. Consequently, when the cartridge is desired to be sufficiently compact to be easily carried with a person, the cartridge

is realized only at an expense of reducing a liquid holding capacity of the reservoir. Thus, there remains a need for making the cartridge as compact as possible, while enabling the cartridge or reservoir to hold a sufficient amount of the liquid composition without causing deterioration during use.

None of the existing art provides all of the advantages and benefits of the present invention.

SUMMARY OF THE INVENTION

The present invention is directed to an improved electrostatic spraying device which is capable of giving an increased liquid containing volume to a removable cartridge, yet keeping the cartridge as compact as possible for enhanced handling performance. The device in accordance with the present invention is configured to electrostatically charge and dispense the liquid composition from a supply to a point of dispense, and includes an actuator, a high voltage generator to provide a high voltage, a power source to activate the actuator and the high voltage generator, a reservoir to contain the supply of the liquid composition, and a dispensing unit. The dispensing unit is provided to spray the liquid composition, and includes a pump which is located in immediate upstream relation with the reservoir for supplying the liquid composition from the reservoir, and which is mechanically connected to the actuator to be driven thereby. An emitter electrode is included in the dispensing unit to be electrically connected to the high voltage generator in order to electrostatically charge the liquid composition. Also included in the dispensing unit is a nozzle that is disposed at the point of dispense for spraying the liquid composition. The device further includes a field electrode that surrounds the reservoir and is connected to the high voltage generator so that the entire liquid composition is

given more or less a common electric potential. The reservoir is configured to provide a removable cartridge. One characterizing feature of the present invention resides in that the reservoir is devoid of the field electrode. Thus, the reservoir can be designed into a simple and compact structure without being restricted by the field electrode, thereby providing an increased liquid containing volume in relation to the bulk of the removable cartridge.

In a preferred embodiment, the device includes a housing that carries the actuator, the high voltage generator, and the power source. The housing has a concavity for detachably receiving the reservoir. It is within the concavity that the field electrode is incorporated to surround the reservoir of the cartridge. By the provision of the field electrode on the side of the housing, the reservoir can be given design flexibility and be shaped into effective configuration assuring increased liquid containing volume as well as improved appearance.

Preferably, the housing incorporates a motor which drives the actuator for operating the pump, and also incorporates a frame which mounts the motor as well as the high voltage generator. The frame divides an interior space of the housing into a front compartment and a rear compartment. The front compartment accommodates the motor as well as the high voltage generator, while the rear compartment defines the concavity for receiving the reservoir. The housing includes a front shell and a rear shell. The front shell is fitted over the frame to define therebetween the front compartment. Likewise, the rear shell is fitted over the frame to define therebetween the rear compartment. The field electrode is composed of a first plate secured to the frame, and a second plate secured to the interior of the rear shell. Thus, it is readily possible to make the use of substantially the whole space between the rear shell and the

frame to realize the concavity for the reservoir, which contributes to give an increased liquid containing volume to the reservoir.

Preferably, the reservoir is coupled to the dispensing unit and is cooperative therewith to define the cartridge. A positioning means is provided on the side of the housing to detachably engage the cartridge with the housing when the reservoir is placed into the concavity. When the cartridge is attached to the housing, the actuator is detachably engaged with a mechanism to activate the pump, and the emitter electrode is detachably in contact with a voltage terminal to receive the high voltage for electrostatically spraying the liquid composition. The positioning means may be realized by a mount formed at the upper end of the housing.

Preferably, the voltage terminal is located below an opening which is formed in the mount to permit the lower end of the emitter electrode to project through the opening for contact with the voltage terminal only when the dispensing unit rests on the mount. In other words, the voltage terminal bearing the high voltage can be kept away from an accidental contact with a human body for safety purpose.

The reservoir may be deformable and made of a dielectric material so that the liquid composition can be easily pumped out to a full extent.

Preferably, the pump is configured as a suction pump having a drive element which is driven by the actuator to suck up the liquid composition from the reservoir and forces it out of the nozzle. In addition to the enhanced pumping efficiency specific to the suction pump, the use of the suction pump can realize a structure in which the suction pump is located on the side of the nozzle and outwardly of the reservoir or the concavity, enabling the reservoir to occupy the

full space of the concavity with the attendant share of increased liquid containing volume.

A motor may be incorporated in the housing to drive the actuator for operating the pump, and is supported by the frame. The frame is configured to divide the interior space of the housing into a front compartment and a rear compartment. The front compartment is provided to accommodate therein the motor as well as the high voltage generator, while the rear compartment defines the concavity for receiving the reservoir. With this arrangement, the concavity receiving the reservoir can be formed on one side of the housing free from the motor and the high voltage generator both of which are inherently bulky, and can be therefore designed into an optimum configuration in match with the capacity of the reservoir, which in turn enables to design the device combining aesthetic and functional appeal.

Considering that the high voltage generator includes a transformer which is inherently bulky and occupies much space, the device is advantageously designed to make the housing compact by arranging the transformer in stack with the motor within the front compartment. Further, a battery also relatively bulky may be accommodated within the front compartment for energizing the motor. Also for making the housing compact, the battery is arranged in a side-by-side relation with the motor in a direction perpendicular to a vertical axis of the housing and arranged in stack with the transformer along the vertical axis.

The device may include an inner cover which is detachably placed over a top portion of the housing and has an opening through which the nozzle extends. Defined around the opening is a retainer which is placed against a portion of the dispensing unit to hold it in position in the mount. In this connection, the

housing may be provided with a positioning means for engagement with the inner cover to retain it on the housing.

In a preferred embodiment, the front shell is fitted over the frame to define therebetween the front compartment, while the rear shell is fitted on the frame to define therebetween the rear compartment. The front shell is formed with a battery opening through which the battery is placed on the frame and which is shielded by the inner cover.

Further, it is preferred to include an outer cover that fits over the inner cover for concealing therebehind the dispensing unit, a button for releasing the inner cover, and a switch knob for actuating the pump. Thus, the device can be well protected from unintended or accidental operation when fitted with the outer cover.

These and still other features, aspects, and advantages of the present invention will become more apparent from the following detailed explanation of preferred embodiments when taken in conjunction with the attached drawings.

BRIEF DESCRIPTION OF THE DRAWINGS

While the specification concludes with claims particularly pointing out and distinctly claiming the invention, it is believed that the present invention will be better understood from the following description of preferred, nonlimiting embodiments and representations taken in conjunction with the accompanying drawings in which:

FIG. 1 is a perspective view of an electrostatic spraying device in accordance with a preferred embodiment of the present invention;

FIG. 2 is a vertical section of the device of FIG. 1;

FIG. 3 is a front view of the device of FIG. 1;

FIG. 4 is a side view of the above device;

FIG. 5 is an exploded perspective view of the above device;

FIGS. 6 to 8 are respectively exploded perspective views of a removable cartridge utilized in the above device;

FIG. 9 is a perspective view of the cartridge of FIG. 8 as viewed from the bottom;

FIG. 10 is a bottom view of the cartridge of FIG. 9;

FIG. 11 is a sectional view of the dispensing unit;

FIG. 12 is a section take along line X-X of FIG. 11;

FIG. 13 is a perspective view of a main body housing of the device;

FIG. 14 is a perspective view of a metal plate forming a part of the dispensing unit;

FIG. 15 is a partial rear section showing an electrical connection between the dispensing unit and a voltage terminal provided on the side of the housing;

FIG. 16 is a partial vertical section showing the electrical connection between the dispensing unit and the voltage terminal;

FIG. 17 is an exploded perspective view of the housing of the device;

FIG. 18 is a perspective view of the device shown with a front shell of the housing removed;

FIG. 19 is an exploded perspective view illustrating a center frame of the housing, a motor and a high voltage generator mounted on the frame in accordance with the preferred embodiment of the present invention;

FIG. 20 is an exploded perspective view showing the motor and its associated parts accommodated within the housing in accordance with the preferred embodiment of the present invention;

FIG. 21 is a perspective view of the above device with the inner cover removed;
FIG. 22 is a perspective view of the above device shown with the cartridge and an inner cover removed;
FIG. 23 is a vertical section of the device corresponding to FIG. 22;
FIG. 24 is an exploded perspective view of parts forming a field electrode and associated parts of the above device;
FIG. 25 is a perspective view of the above device with an outer cover attached;
FIG. 26 is a vertical section of the above device with the outer cover attached;
FIG. 27 is a plan view of the cartridge;
FIG. 28 is a front view of a fitment attached to a reservoir of the cartridge;
FIG. 29 is a cross section taken along line X-X of FIG. 28;
FIG. 30 is an exploded perspective view illustrating a switch, a selector, and associated parts of the device;
FIGS. 31A to 31C illustrate different positions of the selector, respectively;
FIGS. 32 and 33 are block diagrams respectively illustrating the operation of a spraying mode and a dripping mode given to the device; and
FIGS. 34A to 34C illustrate different positions of a switch for making an analogous function of the selector in accordance with another preferred embodiment of the present invention.

DETAILED DESCRIPTION OF THE INVENTION

Now referring to FIGS. 1 to 7, there is shown an electrostatic spraying device in accordance with a preferred embodiment of the present invention. The device is configured into a self-contained portable structure that is compact enough to be easily carried with. The device is basically composed of a main

body housing **10** and a removable cartridge **200** containing a volume of a liquid composition to be electrostatically sprayed according to a mechanism already disclosed in WO 01/12336, WO 01/12335, US 2001-0020653A, US 2001-0038047A, US 2001-0020652A, US 2001-0023902A, and WO 03/072263, incorporated herein by reference. The liquid composition utilized in the device include those disclosed in WO 03/072263, also incorporated herein by reference, i.e., an emulsion having conductive and insulating phases, although not limited thereto.

The housing **10** is dimensioned to be grasped by a user's hand and incorporates an electric motor **30**, a high voltage generator **40**, and a battery **50**, i.e., a power source for activating the motor and the high voltage generator **40**. The motor **30** actuates a dispensing unit **220** provided on the side of the cartridge **200** to dispense the liquid composition, while the high voltage generator **40** applies a high voltage of 1000 volts or more to the liquid composition being dispensed for electrically spraying the liquid composition on a user's . The housing **10** is formed with a concavity **12** for receiving a reservoir **210** of the cartridge **200** containing the liquid composition. In a preferred embodiment, an inner cover **20** is detachably fitted over the upper end of the housing **10** to hold therebetween the dispensing unit **220** of the cartridge **200**. In another preferred embodiment, an outer cover **26** is detachably fitted over the inner cover **20** to conceal therebehind the dispensing unit **220** for protection thereof when the device is not in use.

The cartridge **200** is preferably composed of the reservoir **210** and the dispensing unit **220**. The reservoir **210** may be suitably made of a plastic material which is dielectric, and also deformable according to the contents of

the liquid composition. The reservoir **210** may be made by the same resilient material, or combination of a rigid material and resilient material. An example of commercially available material suitable for providing the reservoir is the laminated film of VM-PET (Vacuum Metalised Polyethylene Terephthalate) having a thickness of 12 microns and LLDPE (Linear Low Density Polyethylene) having a thickness of 60 microns. Commercially available films are GLAE by Toppan for VM-PET, and FCS by Tocco for LLDPE.

As best shown in FIGS. 6 to 9, in a preferred embodiment the dispensing unit **220** includes a pump **230** and a nozzle **240** which are integrated into a single structure. The pump **230** is a gear pump having a flat base **231** molded from a plastic material and formed with a plug **232** for detachable insertion into a fitment **212** secured to a mouth of the reservoir **210**. The pump **230** includes a metal plate **270** mounted in the base **231** of the molded plastic. The metal plate **270** is formed in its upper surface with a pump chamber receiving a pair of intermeshing gears **234**, an inflow channel **236** extending from within the plug **232** to the chamber, and an outflow channel **237** extending from the chamber to the nozzle **240**. The pump chamber as well as the channels **236** and **237** are sealed by an emitter electrode **250** secured between the base **231** and the nozzle **240**. The gears **234** are arranged to have their individual rotation axes extending perpendicular to the plane of the base **231**, realizing a flat pump structure sufficient to be capable of being disposed between the reservoir **210** and the nozzle **240** only at a minimum extra dimension with respect to the height or length of the dispensing unit **220**. One of the gears **234** is coupled to a joint **238** projecting on the lower face of the base **231** for detachable driving connection with the motor **30** disposed within the housing **10**. As the gears are driven to

rotate, the liquid composition is sucked up from the reservoir **210** through the inflow channel **236** and expelled through the outflow channel **237** to the nozzle **240**. Preferably, the nozzle **240** is molded from a compatible plastic material as the base **231** to have an internal nozzle pathway **242** extending from the bottom center to an apex **243**, as best shown in FIG. 2.

The emitter electrode **250** is disposed between the base **231** of the pump **230** and the bottom **241** of the nozzle **240** in order to apply the high voltage to and charge the liquid composition being dispensed through the nozzle **240**. In a preferred embodiment, the emitter electrode **250**, which is connected to receive the high voltage from the high voltage generator **40** in the housing **10**, includes a center antenna **251** and a coaxial cylinder **252**. The center antenna **251** extends into the nozzle pathway **242** to charge the liquid composition being dispensed in cooperation with the cylinder **252** that is provided to surround the nozzle pathway **242** to avoid the undesired corona discharging for suitable electrostatic spraying. The top end of the center antenna **251** is recessed from the apex **243** of the nozzle **240** to give a sufficient insulation distance therebetween.

As best shown in FIGS. 13 to 16, the metal plate **270** is formed integrally with a pin **254** which projects through the base **231** for detachable electrical connection with a voltage terminal **176** provided on the side of the housing **10** to relay the high voltage to the emitter electrode **250**. Turning back to FIGS. 6 and 7, the emitter electrode **250** also includes a flat bottom **253** that is placed over the base **231** to seal the pump. The flat bottom **253** and the metal plate **270** are cooperative to charge the liquid composition within the pump in order to avoid undesired current flow within the liquid composition in the pump which would

otherwise cause deterioration of the liquid composition. As shown in FIGS. 11 and 12, the cylinder **252** is connected to the antenna **251** by a rim **255**. The rim **255** is formed with a plurality of slots **256** that communicate with the outflow channel **237** of the pump for passing the liquid composition from the pump to the nozzle pathway **242**.

As shown in FIG. 17, the housing **10** may be shaped into a generally flat disc, and thus basically composed of a center frame **100**, a front shell **120**, and a rear shell **140** all being molded from a dielectric plastic material and assembled together into a unitary structure to form a front compartment **130** and a rear compartment **150** on opposite faces of the frame **100**, respectively behind the front and rear shells. When taking such generally flat disc shape, the front compartment **130** accommodates therein the motor **30**, the battery **50**, and the high voltage generator **40** which are all supported on the frame **100**, while the rear compartment **150** constitutes the concavity **12** for receiving the reservoir **210**. The frame **100** is formed on its front face with individual sections **103**, **104**, and **105** respectively for mounting the motor **30**, the high voltage generator **40**, and the battery **50**, as shown in FIGS. 18 and 19. The motor **30** is received in the section **103** together with a gearbox **31**. The high voltage generator **40** is composed of a transformer **41** and various electric components mounted on a printed board **80**. The transformer **41** is packed into an insulated module fitted in the section **104**. In that the transformer **41** occupies much more space than the motor **30** and battery **50**, the housing is designed to arrange the transformer **41**, the motor **30**, and the battery **50** in compact. That is, the transformer **41** is accommodated within the lower part of the front compartment, while the motor **30** and the battery **50** are accommodated within the upper part of the front

compartment in side-by-side relation with each other such that the motor and the battery are arranged in stack with the transformer with respect to a vertical axis of the housing **10**. The section **105** receives, in addition to the battery **50**, a terminal fixture **52** having leads for electrical connection of the battery **50** to the motor **30** and the high voltage generator **40** through a power switch **60** and a control circuit formed on the printed board **80**. As shown in FIG. 20, the gearbox **31** includes a reduction gear set **32** through which the motor output is transmitted to an actuator **36** provided for detachable driving connection to the joint **238** of the pump **230** on the side of the cartridge **200**. Preferably, the actuator **36** is disposed immediately below a mount **110** formed at the upper end of the frame **100** and is accessible through an opening **112** in the mount **110**, as shown in FIGS. 22 and 23. The mount **110** is somewhat recessed for retaining the dispensing unit **220** thereon when the cartridge **200** is attached to the housing **10**. The mount **110** is cooperative with adjacent side walls **114** to define a positioning means for the cartridge. Preferably, a pair of hooks **108** is attached on the opposite sides of the frame **100** to constitute a positioning means for detachably holding the inner cover **20** on the housing **10**. The hook **108** has a release button **109** which releases the inner cover **20** upon being pressed. As seen in FIGS. 1 and 5, the inner cover **20** may have a flat top **21** formed with a center window **22** through which the nozzle **240** projects when the inner cover **20** is placed over the top half of the housing **10** with the cartridge **200** attached to the housing **10**. The periphery of the window **22** constitutes a retainer ring that holds the flat nozzle bottom **241** on the mount **110** at the upper end of the housing **10**. As shown in FIG. 21, the front shell **120** is formed with a window **122** which communicates with the section **105** for replacement of the battery **50**.

Thus, the battery **50** can be easily replaced by simply removing the inner cover **20** as well as a lid **124** of the window **122**. The lid **124** may be eliminated from the device for simplicity.

Accommodated within the rear compartment **150** is a field electrode **170** which surrounds the reservoir **210** to give the same electrical potential to the liquid composition within the reservoir **210** and to the liquid composition within the dispensing unit **220** for keeping the entire liquid composition free from seeing the electric current which may deteriorate the liquid composition. Such deterioration is particularly seen in emulsion compositions and compositions having particles dispersed therein. As best shown in FIGS. 23 and 24, the field electrode **170** is preferably composed of a first plate **171** and a second plate **172** both made of an electrically conductive metal and shaped to define therebetween the concavity **12** surrounding the entire area of the reservoir **210**. The plates **171** and **172** are electrically connected to each other at their peripheries, and are secured to the frame **100** and the rear shell **140**. In order to receive the high voltage, the plate **171** is formed to have a lug **174** which extends through the frame **100** for electrical connection with a terminal **44** of the high voltage generator **40**. The plate **171** is also formed with the voltage terminal **176** in the form of a spring catch for detachable connection with the pin **254** of the dispensing unit **220**, as explained hereinabove.

It is noted in this connection that the metal plate **270** and the **250** of the dispensing unit **220** are electrically connected to the field electrode **170** and therefore act as additional field electrode covering the pump. Also, the metal plate **270** is formed with a metal tube **271** which is inserted into the plug **232** to charge the liquid composition within the plug, and therefore acts also as a further

field electrode. Thus, the liquid composition is electrically charged along the entire path from the reservoir **210** to the nozzle **240**. Instead of using the metal tube **271**, it is equally possible to provide an extension which extends from at least one of the plates **171** and **172** and projects outwardly from the concavity to cover the plug **232** and the adjacent part of the dispensing unit.

Preferably, when the outer cover **26** is fitted over the housing **10**, as shown in FIGS. 25 and 26, a sealing rubber **27** at the inner upper end of the outer cover **26** comes into contact with the nozzle **240**. The outer cover **26** is also formed with tabs **28** one of which conceals therebehind the power switch **60** to keep the device inoperative. Also, the outer cover **26** conceals the release buttons **109** therebehind to prevent accidental detachment of the inner cover from the housing **10**.

With reference to FIGS. 27 to 29, the cartridge **200** is again explained in details with respect to geometrical configuration of the reservoir **210**. One preferred embodiment of the reservoir as shown as **210** is made from a deformable plastic material into a flat bag which has a planar configuration of a segment of an approximate circle and has a mouth to which the fitment **212** is attached. The fitment **212** is molded from a plastic material to have a socket **214** for removably receiving the plug **232** of the dispensing unit **220**. In detail, the reservoir **210** is shaped into the segment of circle defined between a chord and a circumference of an approximate circle greater than a circumference of a semicircle. The mouth or the fitment **212** is located at a center of the chord such that the distance from the mouth to any point of the circumference of the circle can be made approximately the same, providing smooth sucking up of the liquid composition from the reservoir and deforming according to the amount of liquid

composition left in the reservoir, such that residue left in the end can be kept to a minimum.

Referring to FIG. 30, the power switch **60** preferably includes a switch knob **61** and a switch contact **62** disposed within a center cavity **126**. The switch knob **61** is held within the cavity **126** by means of a retainer ring **127** to be capable of being depressed against a spring bias, and energizes the motor **30** and the high voltage generator **40** upon being depressed. A light-emitting-diode (LED) **63** disposed in the cavity **126** is energized in response to the knob **61** being depressed to issue a light through a transparent cover **64** for indication of the operation.

In a preferred embodiment, the device also includes a selector **70** for selecting one of three modes, i.e., a lock mode for disabling the operation, a spraying mode for enabling the liquid composition to be electrostatically sprayed, and a dripping mode for enabling the liquid composition to be dispensed out of the nozzle without being electrostatically charged. The selector **70** includes a handle **71** which is rotatable around the ring **127** for selecting one of three positions, i.e., a lock position, a spraying position, and a dripping position, as shown in FIGS. 31A to 31C, respectively defining the above lock mode, the spraying mode, and the dripping mode. In the lock position of FIG. 31A, the handle **71** has its portion engaged with the switch knob **61** to prohibit it from being pressed, thereby disabling the operating of the pump as well as the high voltage generator. The selector **70** also includes tact switches **72** and **73** which are arranged on the printed board **80** to be actuated selectively depending upon the position of the handle **71**. In the spraying mode of FIG. 31B, the tact switch **72** is activated such that the pump **230** and the high voltage generator **40** are

simultaneously activated upon the switch knob **61** being pressed. In the dripping mode of FIG. 31C, the tact switch **73** is activated such that only the pump **230** is activated upon the switch knob **61** being pressed. Although not clearly seen in the figures, the device may further include an indicator showing which one of the dripping and spraying modes is selected for easy confirmation by the user. Such indicator is preferred to be disposed around the selector handle **71**.

The above operation will be explained also with reference to FIGS. 32 and 33. When the tact switch **72** is turned on by the selector handle **71**, the pressing of the knob **61** energizes a voltage source **81**, a motor controller **82** and at the same time an oscillator **83** for the transformer **41**, thereby activating the motor **30** to operate the pump **230**, while applying the high voltage to charge the liquid composition. When, on the other hand, the tact switch **73** is turned on by the selector handle **71**, the pressing of the knob **61** energizes the voltage source **81** and the motor controller **82** only for operating the pump without applying the high voltage to the liquid composition. Thus, the user can easily drip the liquid composition by simply manipulating the selector prior to initiating the electrostatic spraying, assuring enhanced convenience of handling the device. The voltage source **81**, the motor controller **82**, and the oscillator **83** are formed on the printed board **80**.

FIGS. 34A to 34C illustrate another scheme of selecting the dripping mode and the spraying mode. In this modification, a tact switch **74** of press-responsive type is cooperative with the switch knob **61A** to constitute the power switch added with the function of the selector. That is, the tact switch **74** gives three positions, i.e., an off position of FIG. 34A, a spray mode position of

FIG. 34B, and a drip mode position of FIG. 34C. In the off position, the switch 74 is not actuated to disable the operation of the pump as well as the high voltage generator. When the knob 61A is pressed to a small extent to correspondingly depress the switch 74, the spraying mode is selected to energize the pump 230 as well as the high voltage generator 40 for making the electrostatic spraying of the liquid composition. Upon the knob 61A being pressed to a further extent, the switch 74 is correspondingly depressed to select the dripping mode to activate only the pump 230 for dispensing the liquid composition without the electric charge. Thus, the user can easily select the mode by simply varying the pressure applied to the switch knob 61A. Alternatively, the dripping mode and the spraying mode may be assigned respectively to the depression of the small extent and to that of the further extent.

All documents cited in the detailed description of the Invention are, in relevant part, incorporated herein by reference; the citation of any document is not to be construed as an admission that it is prior art with respect to the present invention.

While particular embodiments of the present invention have been illustrated and described, it would be obvious to those skilled in the art that various other changes and modifications can be made without departing from the spirit and scope of the invention. It is therefore intended to cover in the appended claims all such changes and modifications that are within the scope of this invention.

CLAIMS

1. An electrostatic device configured and disposed to electrostatically charge and dispense a liquid composition from a supply to a point of dispense,

wherein the device comprises:

an actuator;

a high voltage generator to provide a high voltage;

a power source to activate said actuator and said high voltage generator;

a reservoir to contain the supply of said liquid composition; and

a dispensing unit comprising:

a pump in immediate upstream relation with the reservoir for supplying the liquid composition from the reservoir, said pump being mechanically connected to said actuator to be driven thereby;

an emitter electrode to electrostatically charge the liquid composition, the emitter electrode being electrically connected to said high voltage generator; and

a nozzle to dispense the liquid composition, said nozzle being disposed at the point of dispense;

wherein the device further comprises a field electrode surrounding the reservoir, said field electrode being connected to said high voltage generator for providing the entire liquid composition with more or less a common electric potential; and

wherein the reservoir is configured to provide a removable cartridge, said reservoir being devoid of the field electrode.

2. The device as set forth in claim 1, wherein

said device includes a housing carrying said actuator, said high voltage generator, and said power source,
said housing being formed with a concavity for detachably receiving said reservoir,
said field electrode being incorporated in said housing around said concavity.

3. The device as set forth in claim 1, wherein
said housing incorporates a motor which drives said actuator for operating said pump;
said housing further incorporating therein a frame which mounts said motor as well as said high voltage generator,
said frame dividing the interior space of said housing into a front compartment and a rear compartment, said front compartment accommodating said motor and said high voltage generator, and said rear compartment defining said concavity for receiving said reservoir,
said housing comprising a front shell and a rear shell,
said front shell being fitted over said frame to define therebetween said front compartment,
said rear shell being fitted on said frame to define therebetween said rear compartment,
said field electrode composed of a first plate secured to the frame and a second plate secured on the interior surface of said rear shell.

4. The device as set forth in claim 2, wherein said reservoir is coupled to said dispensing unit and is cooperative therewith to define said cartridge, said housing comprising a positioning means with which said cartridge detachably engages for resting said reservoir in said concavity, wherein when said cartridge is engaged with said housing, the actuator is detachably engaged with a mechanism to activate said pump, and a voltage terminal is detachably in contact with said emitter electrode to apply said high voltage to said emitter electrode.

5. The device as set forth in claim 4, wherein said positioning means is a mount formed at the upper end of said housing on which said dispensing unit rests.

6. The device as set forth in claim 5, wherein said voltage terminal is located below an opening which is formed in the mount to permit the lower end of said emitter electrode to project through the opening for contact with said voltage terminal when said dispensing unit rests on said mount.

7. The device as set forth in claim 1, wherein said reservoir is deformable and made of a dielectric material.

8. The device as set forth in claim 1, wherein said pump is a suction pump having a drive element which is driven by said actuator to suck up said liquid composition from said reservoir and forces it out of said nozzle.

9. The device as set forth in claim 2, wherein said housing incorporates a motor which drives said actuator for operating said pump;
said housing further incorporating therein a frame which mounts said motor as well as said high voltage generator,
said frame dividing the interior space of said housing into a front compartment and a rear compartment, said front compartment accommodating said motor and said high voltage generator, and said rear compartment defining said concavity for receiving said reservoir.

10. The device as set forth in claim 9, wherein said housing has a vertical axis that defines an upper end and a lower end along said vertical axis, and
said high voltage generator comprising a transformer which is arranged in stack with said motor along said vertical axis within said front compartment.

11. The device as set forth in claim 10, wherein said front compartment accommodates a battery energizing the motor, said battery being arranged in a side-by-side relation with said motor in a direction perpendicular to said vertical axis and arranged in stack with said transformer along said vertical axis.

12. The device as set forth in claim 5, wherein an inner cover is provided to be detachably placed over a top portion of said housing, said inner cover having an opening through which said nozzle extends and defining around said opening a retainer which is placed against a portion of said dispensing unit to hold it in position on said mount.

13. The device as set forth in claim 12, wherein said housing is provided with a positioning means for engagement with said inner cover to retain it on the housing.

14. The device as set forth in claim 12, wherein said housing includes a front shell and a rear shell, in addition to said frame, said frame carrying said motor, said transformer, and a battery energizing said motor, said front shell being fitted over said frame to define therebetween said front

compartment,
said rear shell being fitted on said frame to define therebetween said rear
compartment,
said front shell being formed with a battery opening through which said battery is
placed on said frame,
said inner cover shielding said battery opening when attached to said housing.

15. The device as set forth in claim 14, wherein
said housing is provided with a button for releasing said inner cover therefrom
and with a switch knob for actuating said pump,
an outer cover being provided to fit over said inner cover for concealing
therebehind said dispensing unit, said button, and said switch knob.

16. The device as set forth in claim 2, wherein
said field electrode is extended outwardly from said concavity to follow at least
part of the dispensing unit for covering a flow path of said liquid composition from
said reservoir to said nozzle.

17. The device as set forth in claim 4, wherein
said dispensing unit further comprises a field electrode.

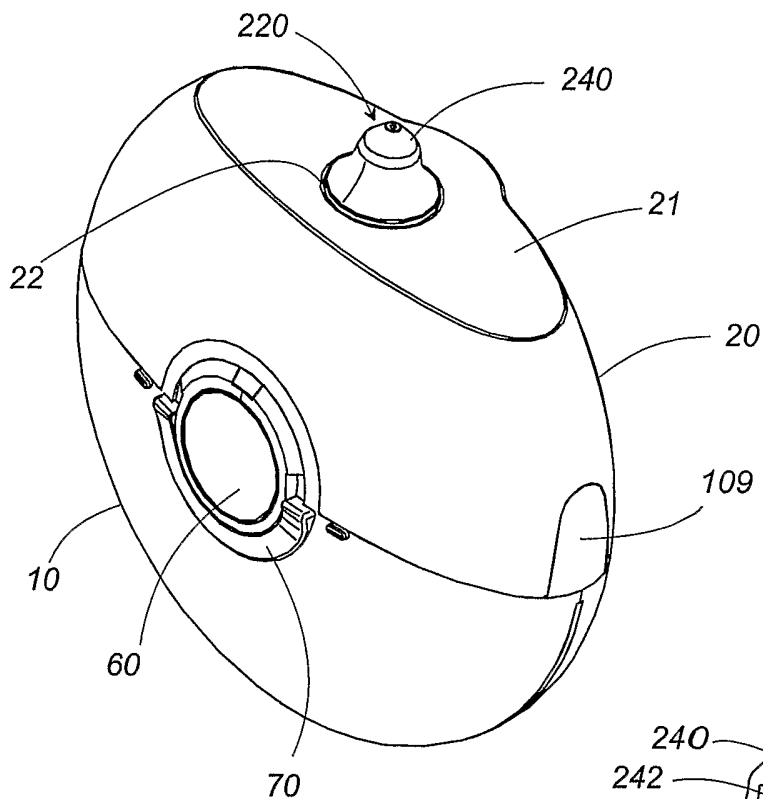

FIG. 1

FIG. 2

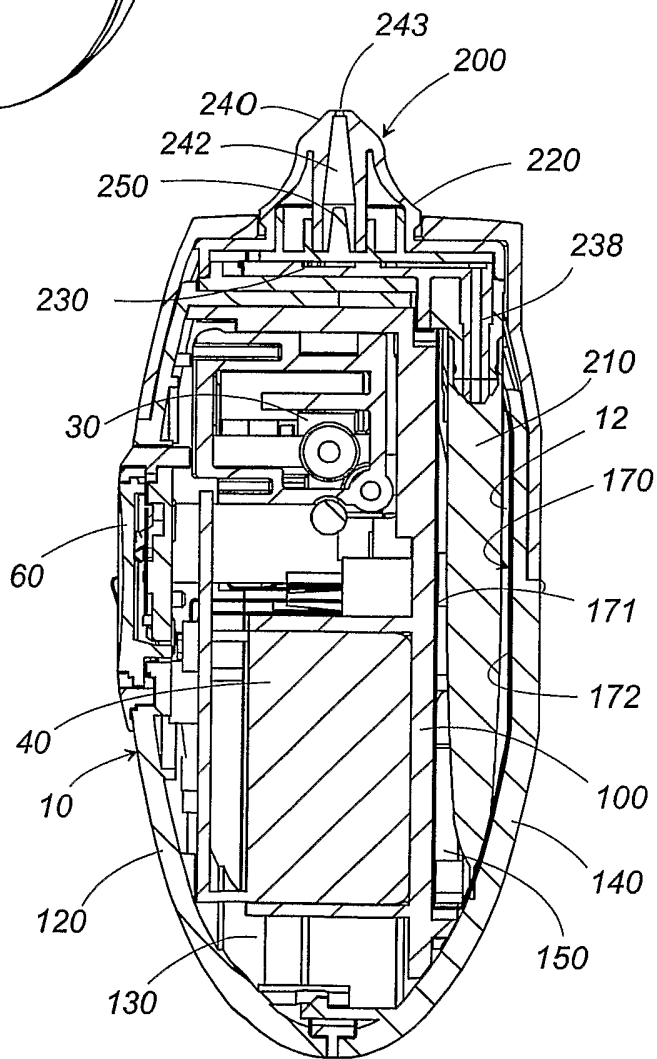

FIG. 3

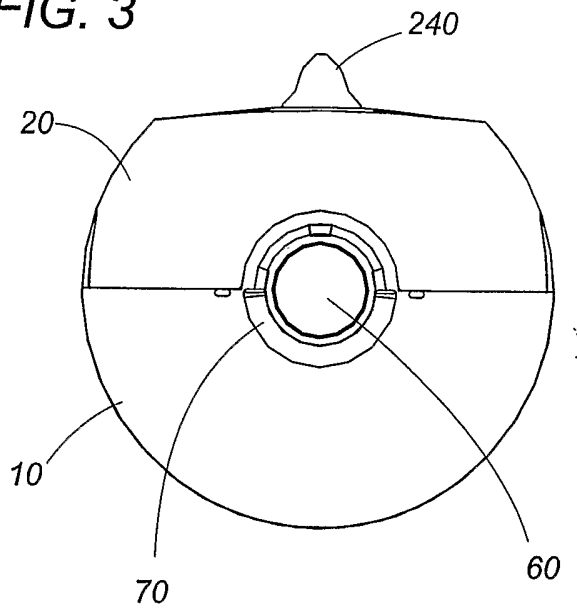

FIG. 4

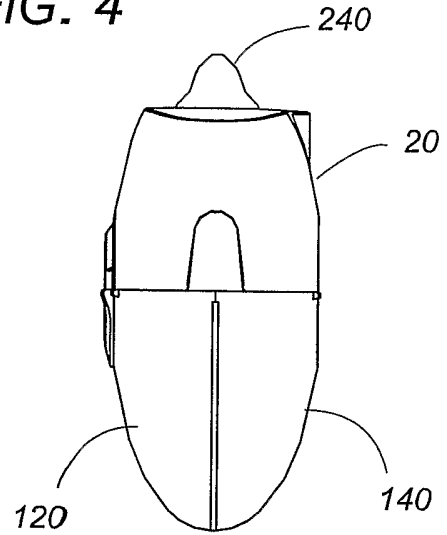

FIG. 5

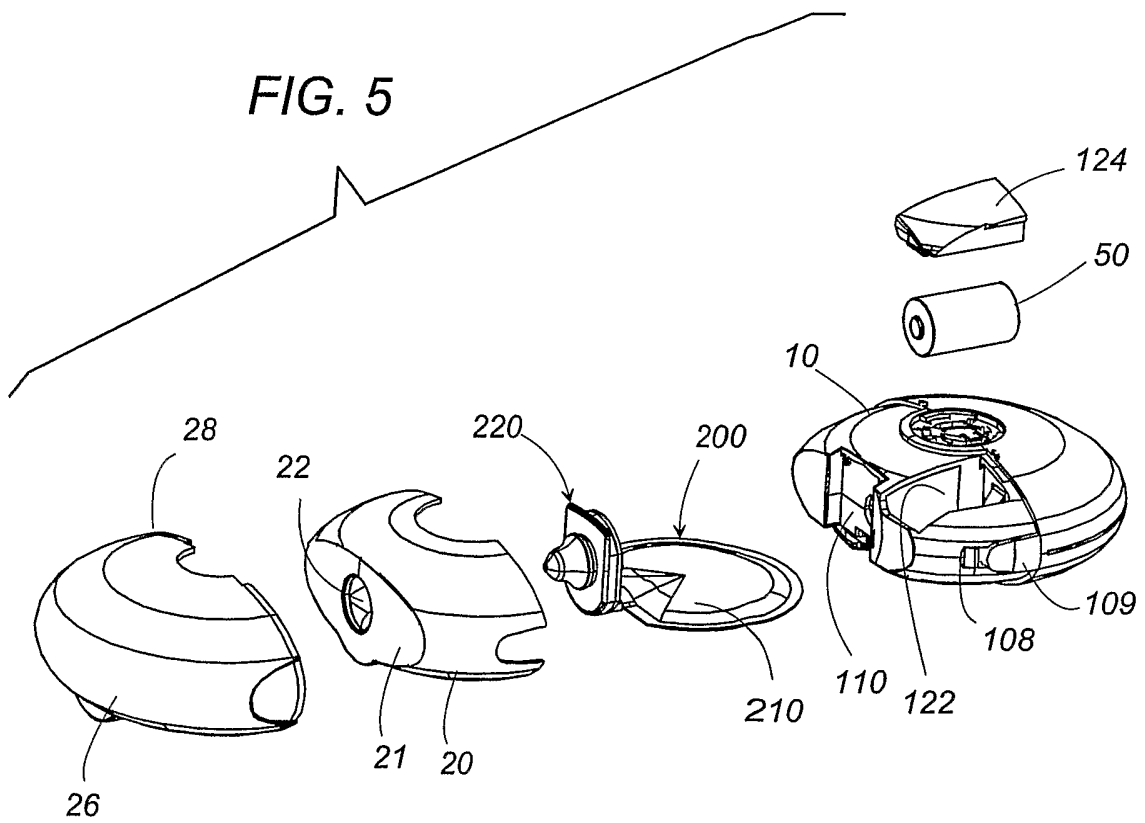

FIG. 6

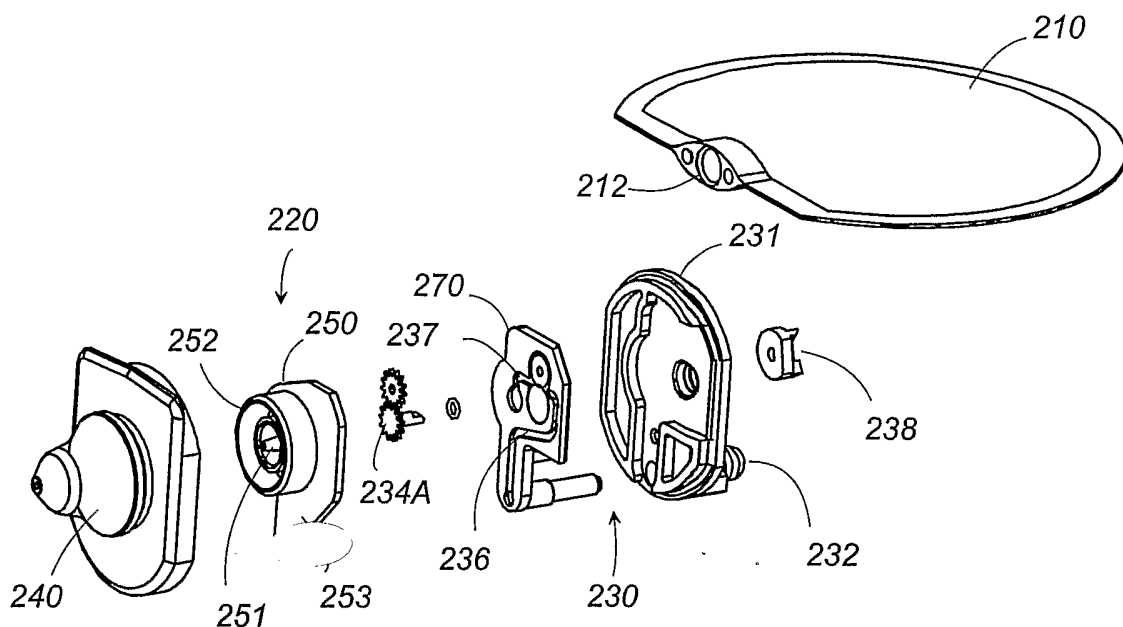

FIG. 7

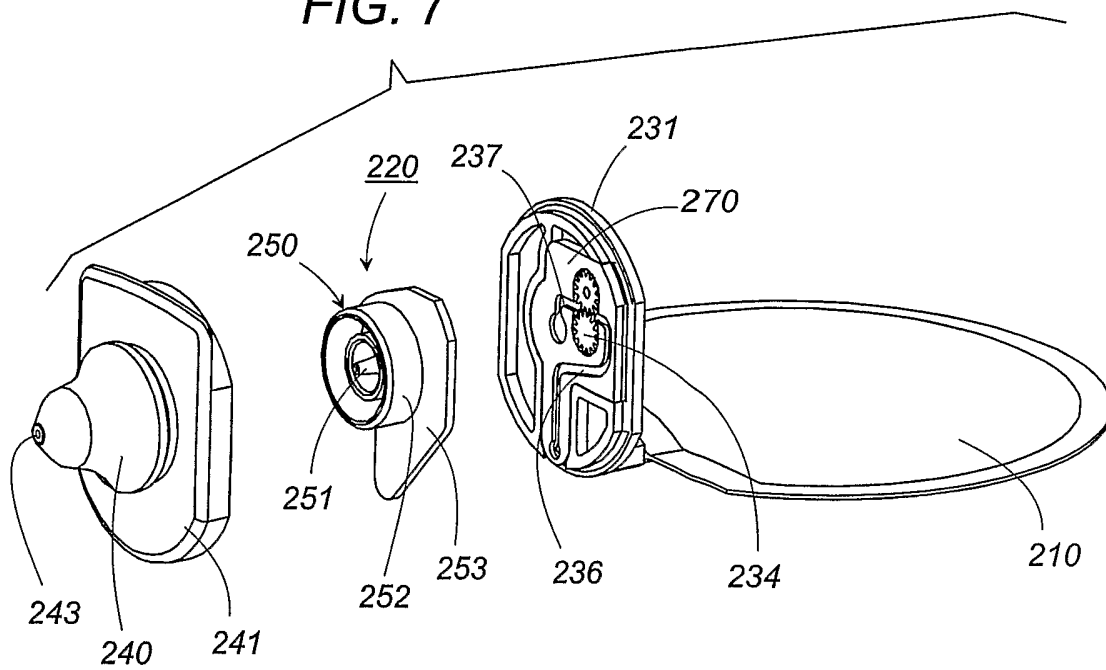

FIG. 8

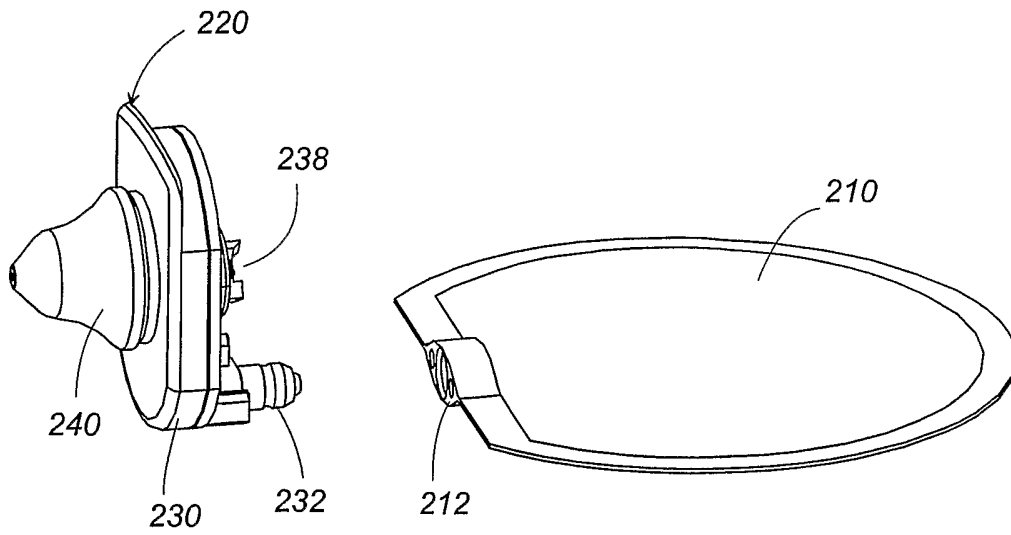

FIG. 9

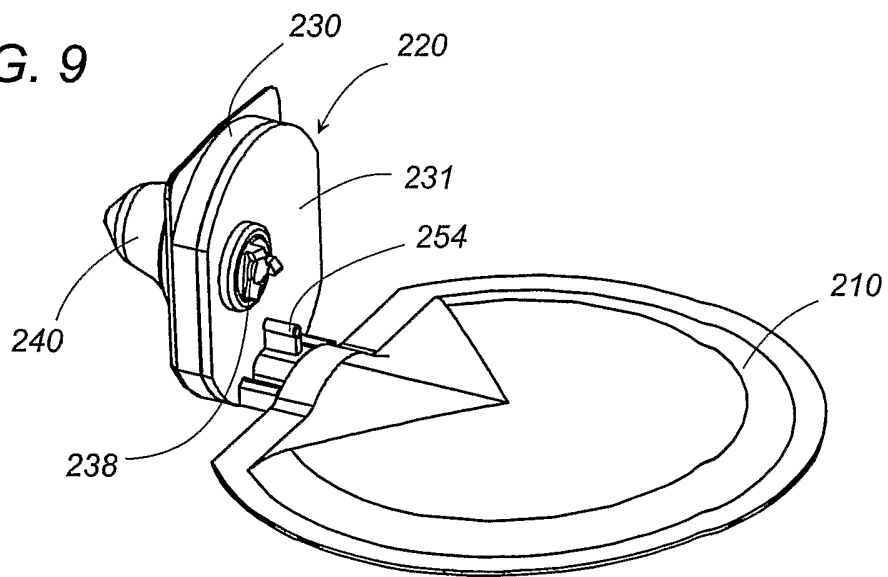

FIG. 10

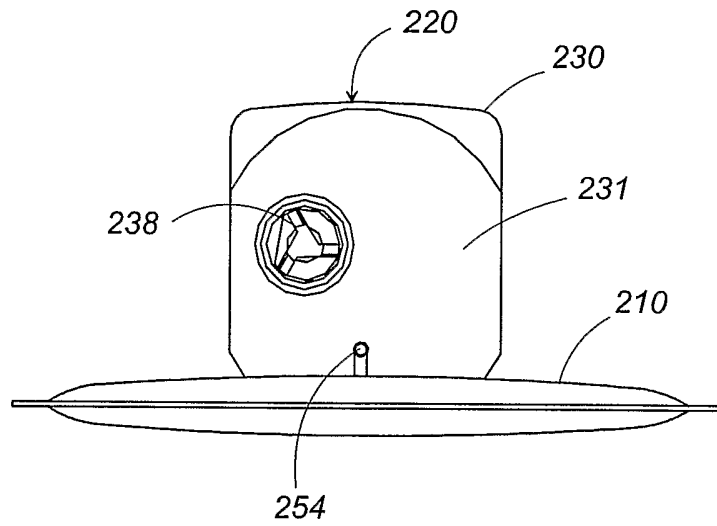

FIG. 11

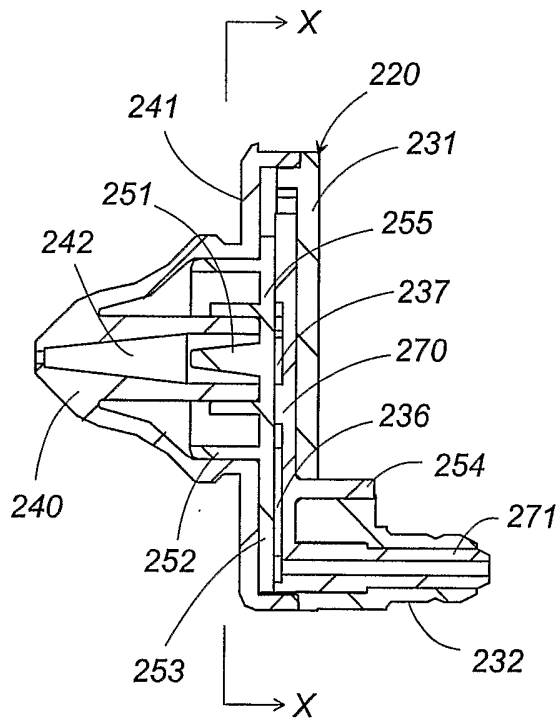

FIG. 12

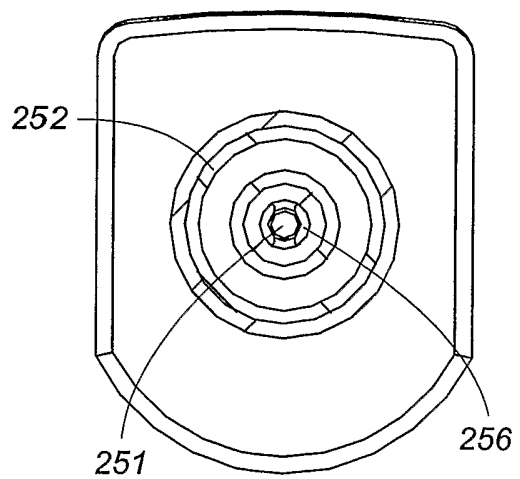

FIG. 13

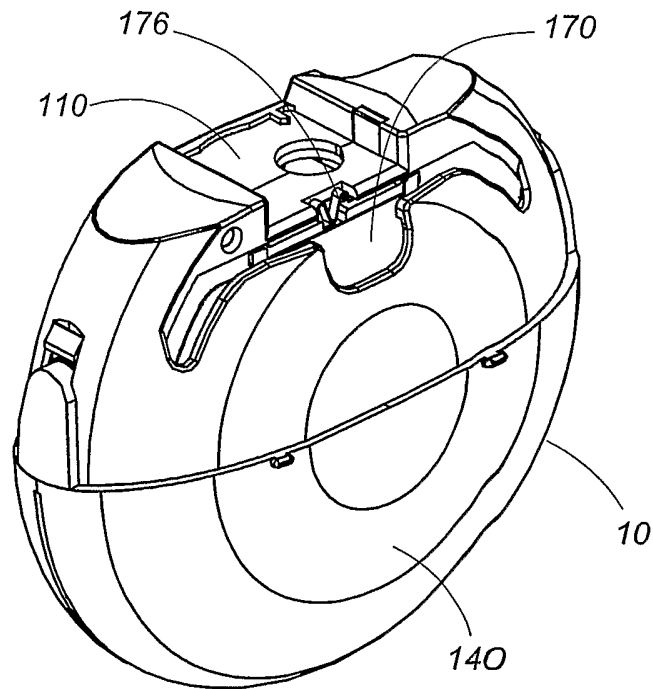

FIG. 14

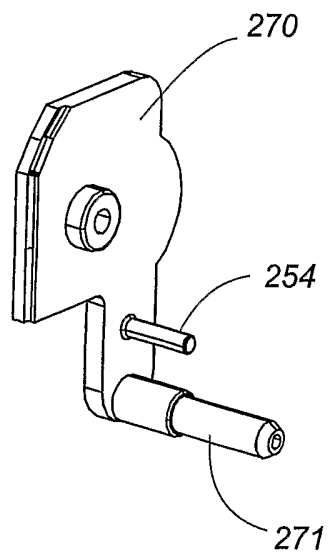

FIG. 15

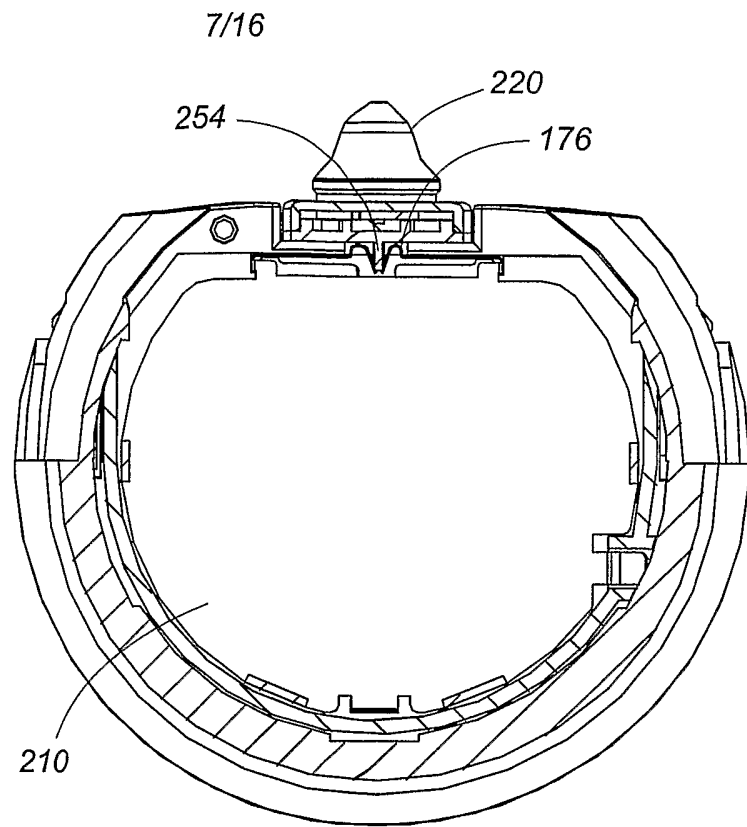

FIG. 16

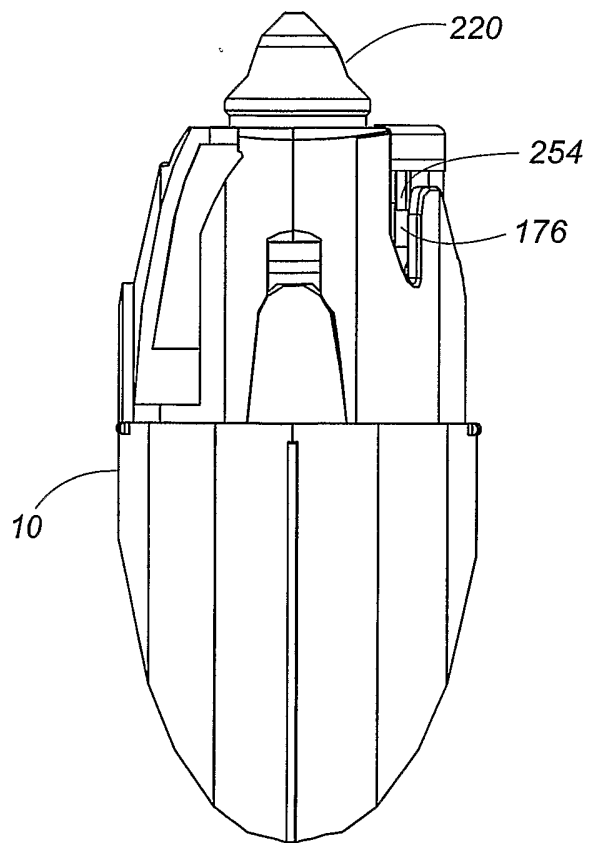
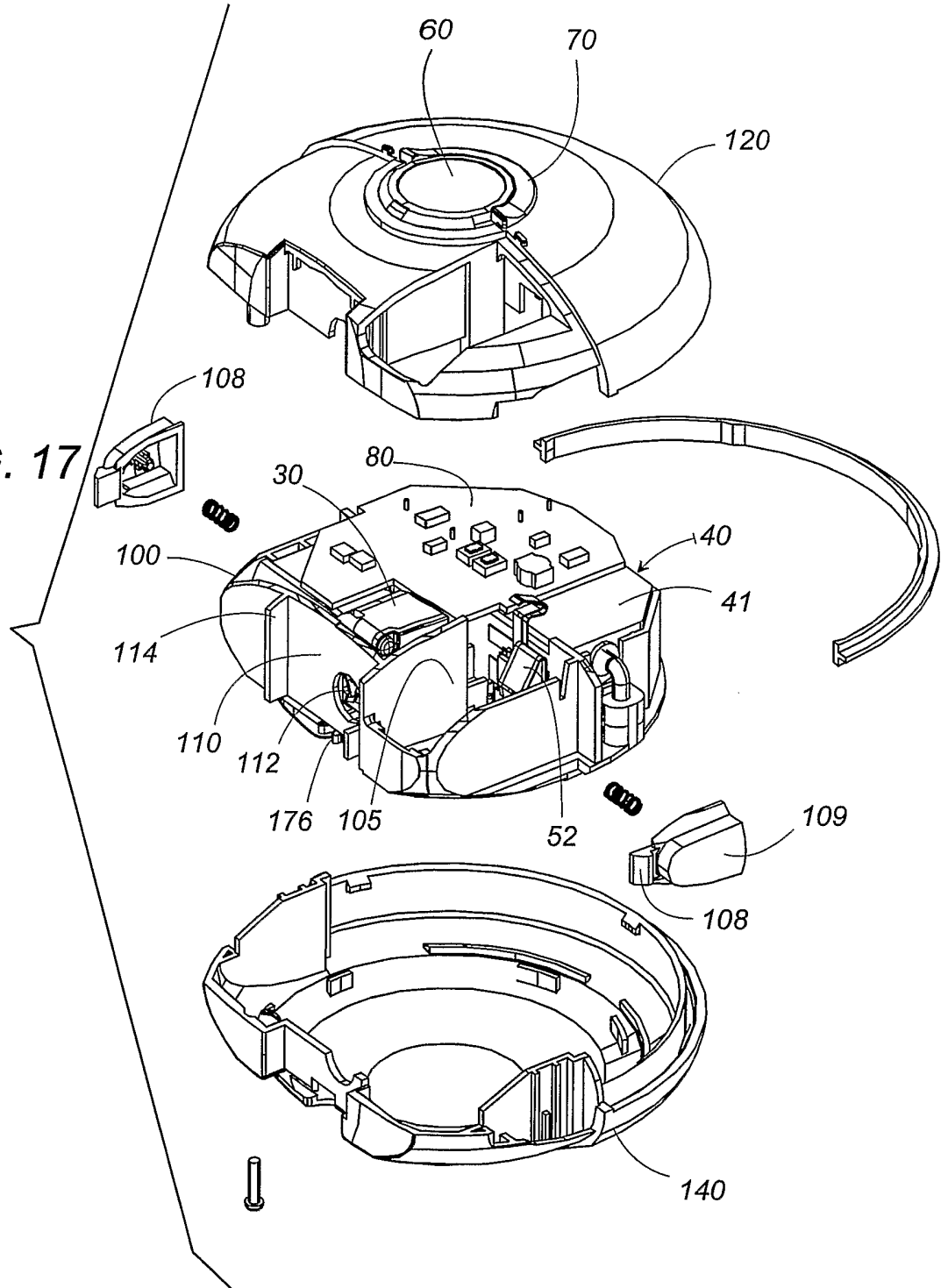

FIG. 17



9/16

FIG. 18

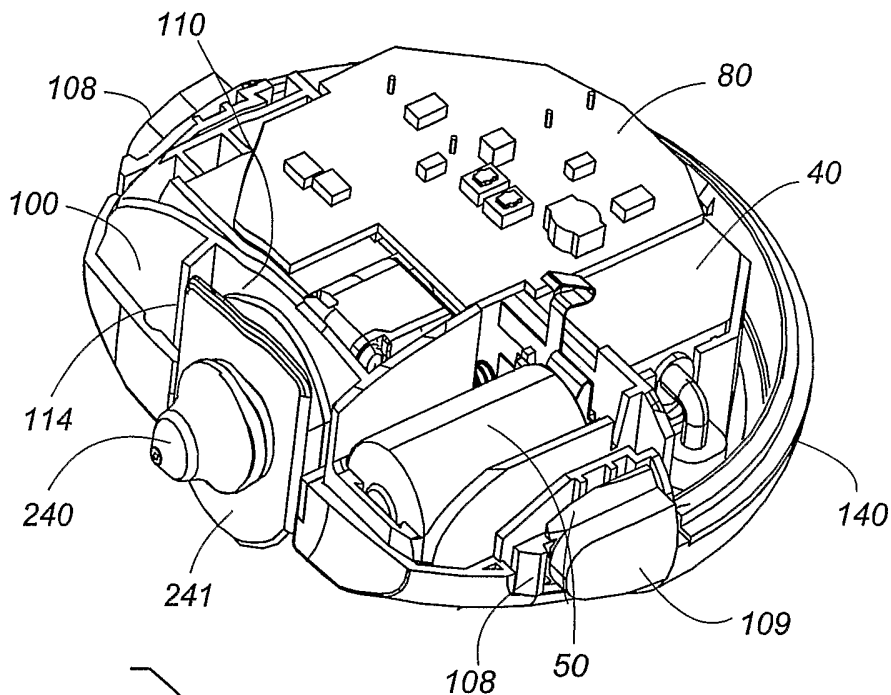

FIG. 19

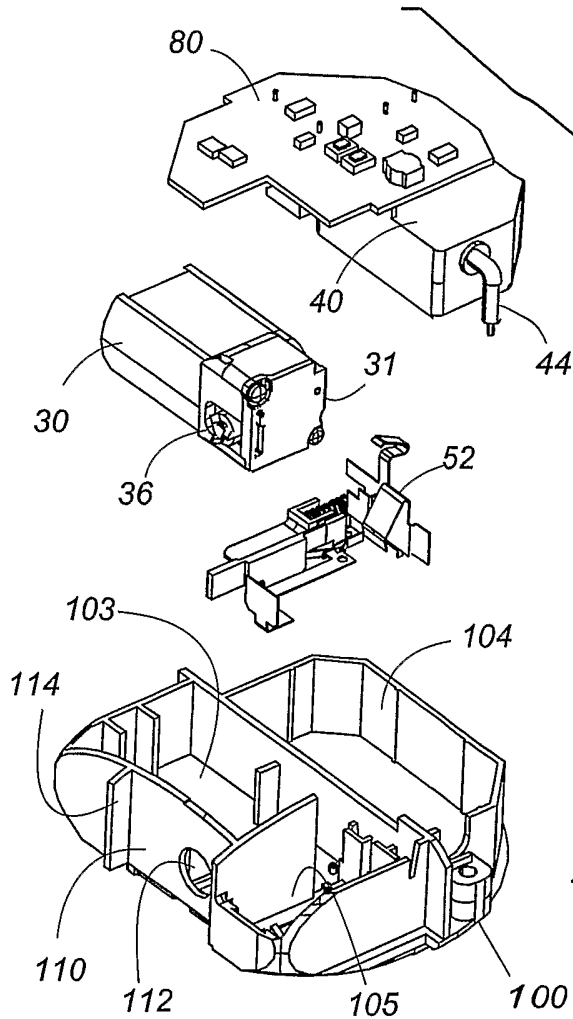

FIG. 20

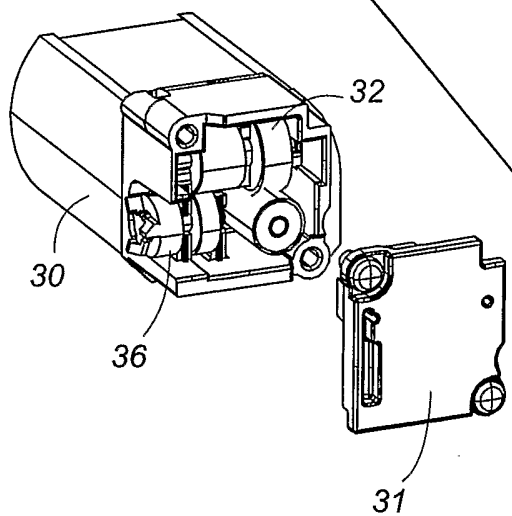

FIG. 21

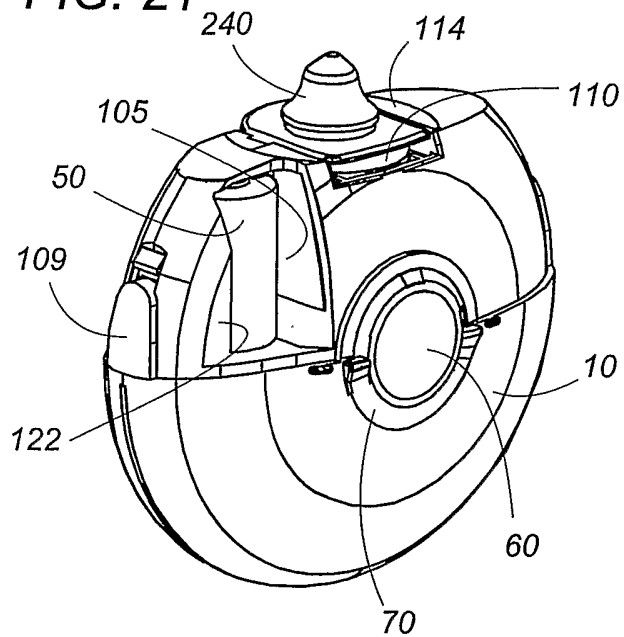

FIG. 22

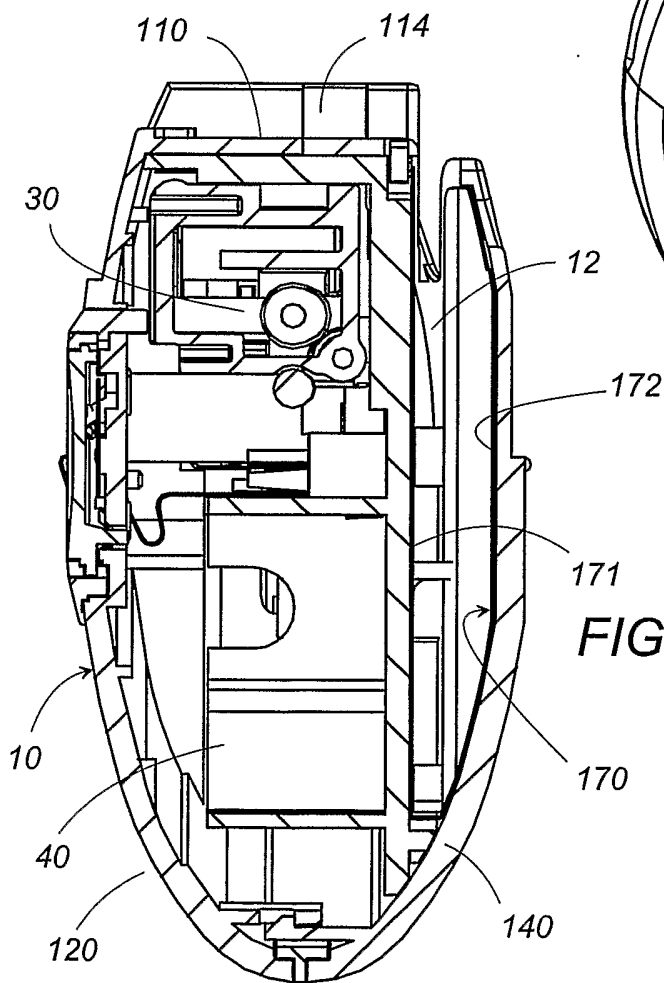
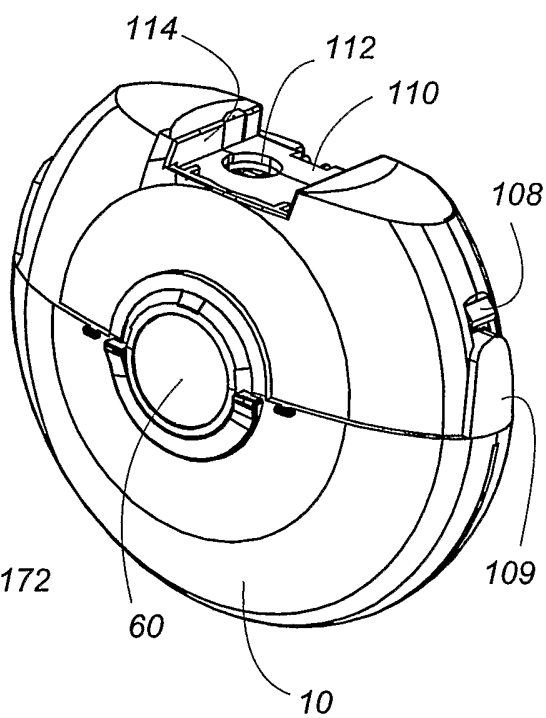

FIG. 23

FIG. 24

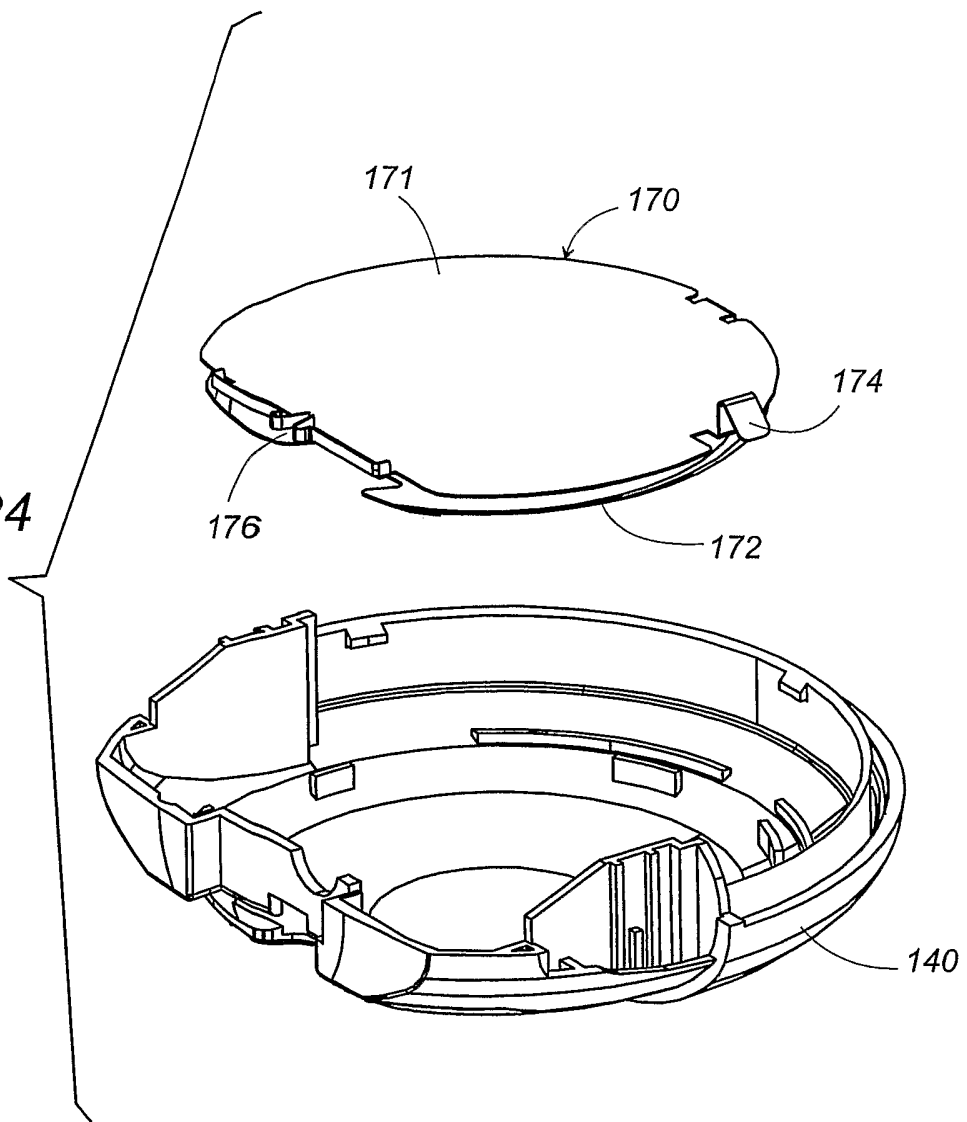

FIG. 25

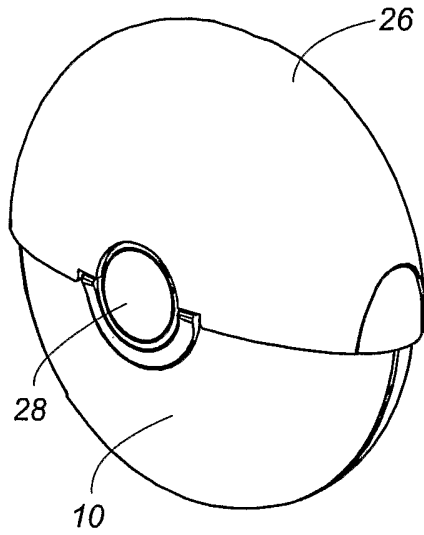

FIG. 26

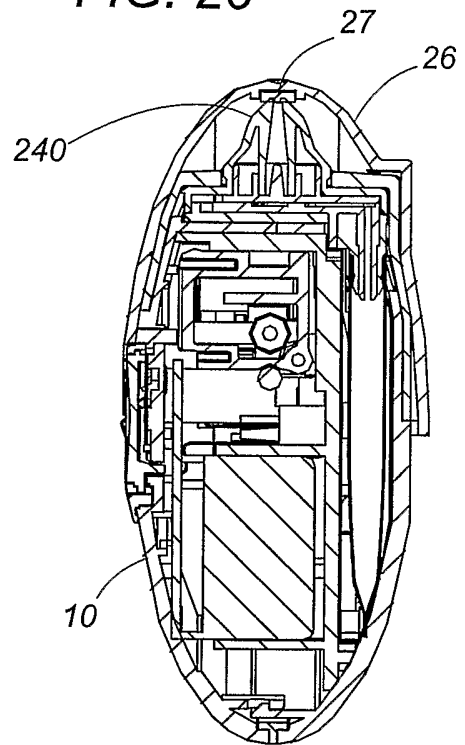

FIG. 27

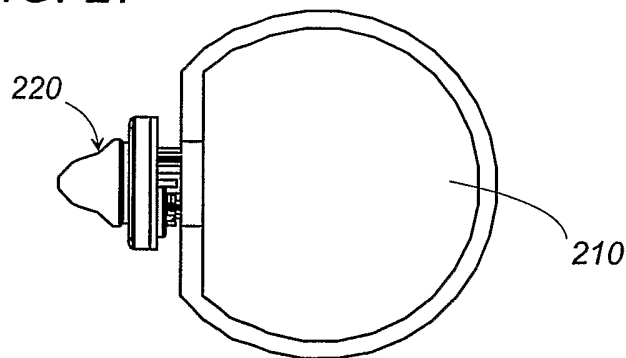

FIG. 28

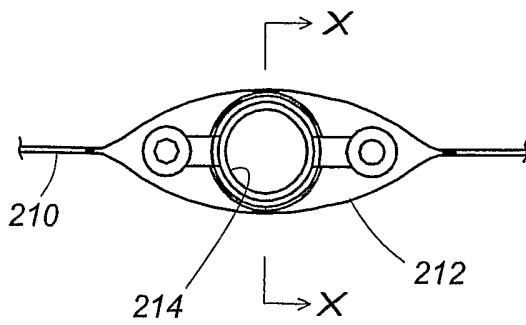

FIG. 29

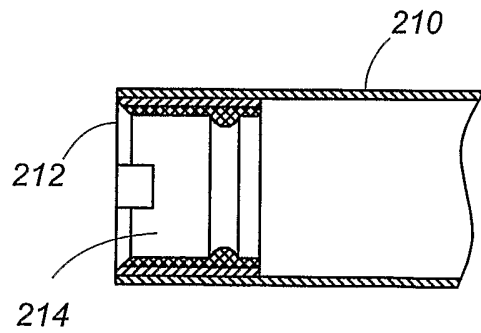

FIG. 30

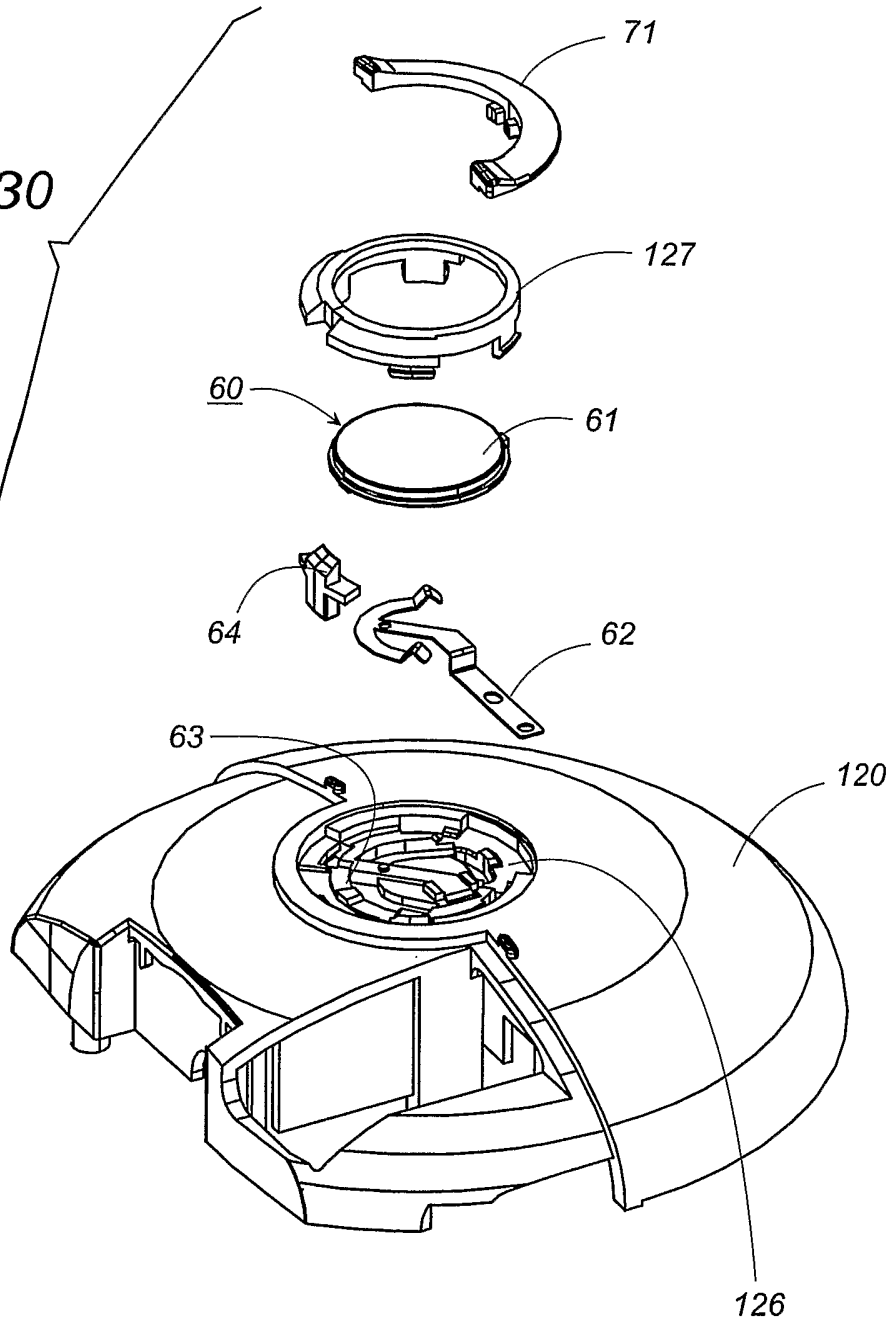

FIG. 31A

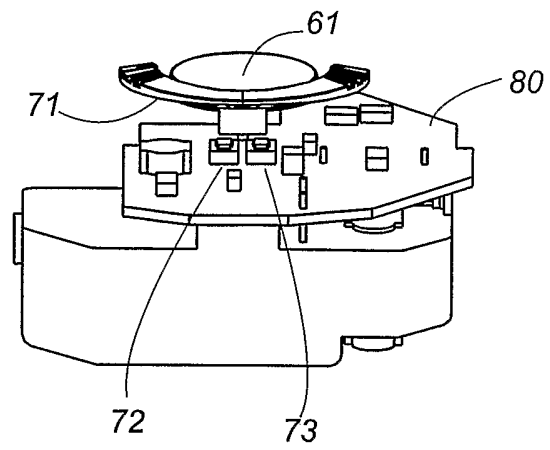

FIG. 31B

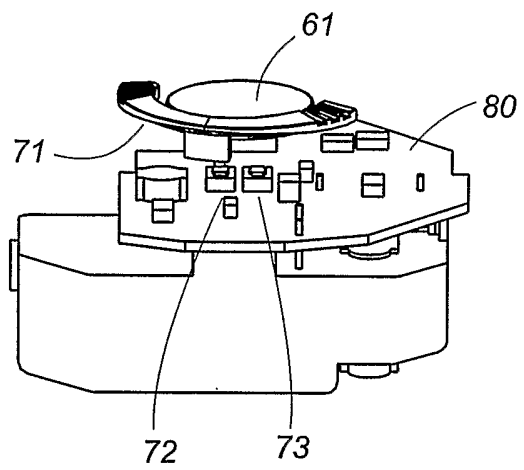

FIG. 31C

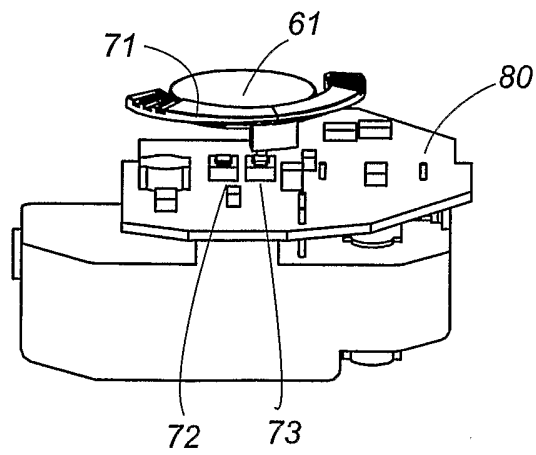

FIG. 32

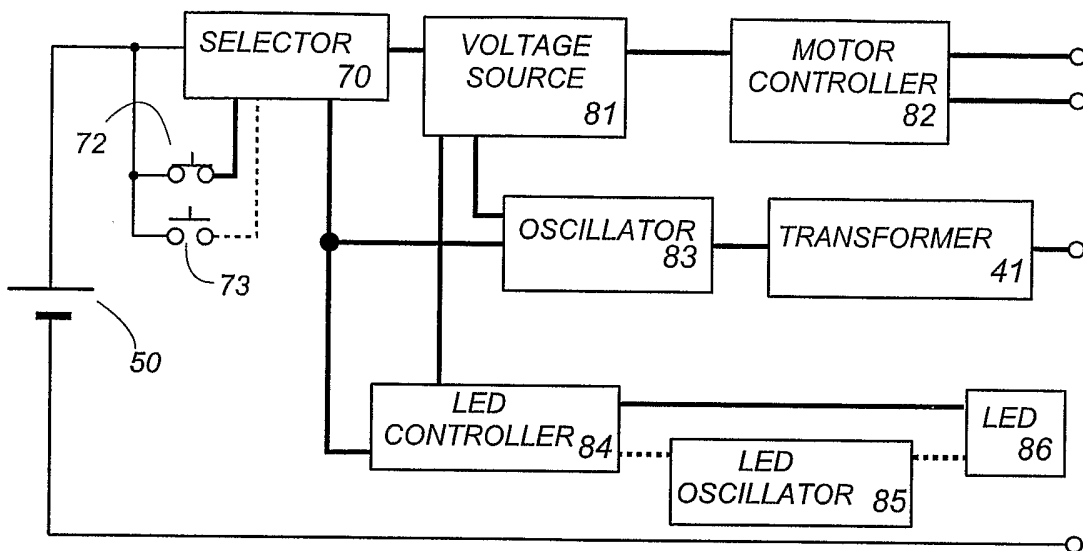
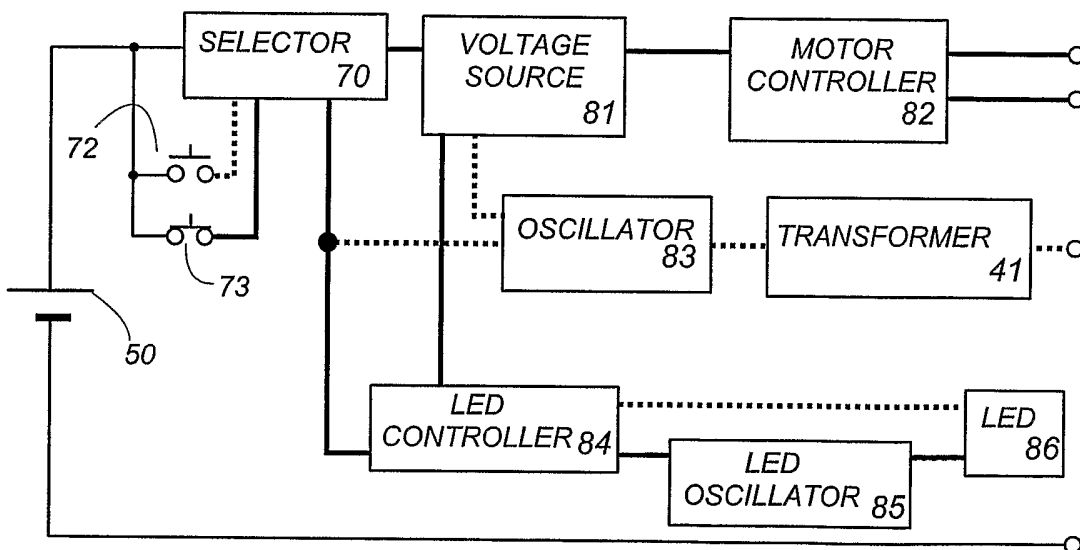

FIG. 33



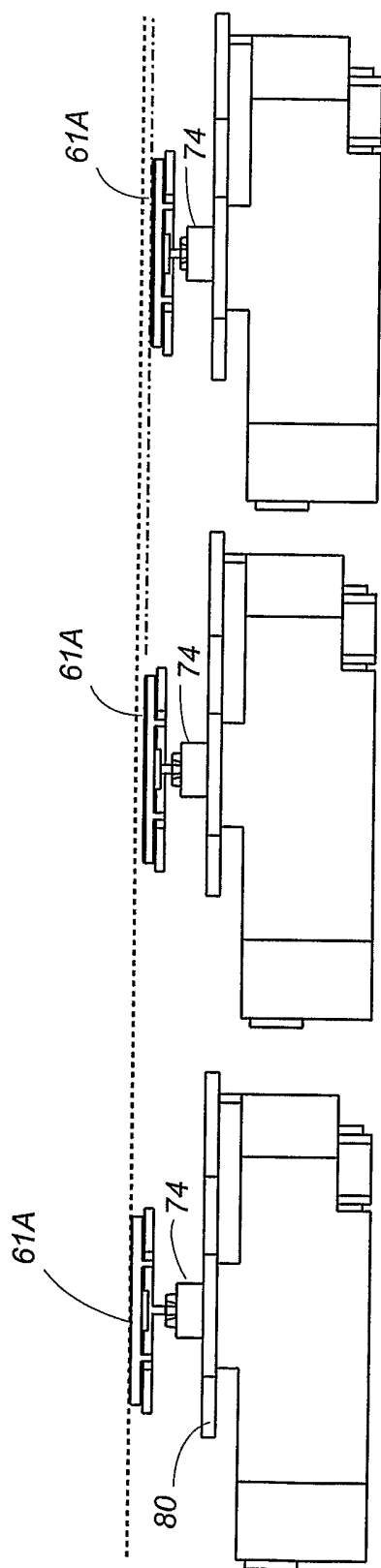

FIG. 34A

FIG. 34B

FIG. 34C

INTERNATIONAL SEARCH REPORT

International Application No
JP2004/001357

A. CLASSIFICATION OF SUBJECT MATTER IPC 7 B05B5/16		
According to International Patent Classification (IPC) or to both national classification and IPC		
B. FIELDS SEARCHED Minimum documentation searched (classification system followed by classification symbols) IPC 7 B05B		
Documentation searched other than minimum documentation to the extent that such documents are included in the fields searched		
Electronic data base consulted during the international search (name of data base and, where practical, search terms used) EPO-Internal		
C. DOCUMENTS CONSIDERED TO BE RELEVANT		
Category °	Citation of document, with indication, where appropriate, of the relevant passages	Relevant to claim No.
Y	US 2004/021017 A1 (SUMIYOSHI TORU ET AL) 5 February 2004 (2004-02-05) paragraphs '0077!', '0078!; claims 1,5,6,8; figures 1,3-5	1-17
Y	US 6 684 879 B1 (PIRRIE ALASTAIR BRUCE ET AL) 3 February 2004 (2004-02-03) column 16, lines 6-26; figure 2	1-17
<input type="checkbox"/> Further documents are listed in the continuation of box C. <input checked="" type="checkbox"/> Patent family members are listed in annex.		
° Special categories of cited documents :		
A document defining the general state of the art which is not considered to be of particular relevance *E* earlier document but published on or after the international filing date *L* document which may throw doubts on priority claim(s) or which is cited to establish the publication date of another citation or other special reason (as specified) *O* document referring to an oral disclosure, use, exhibition or other means *P* document published prior to the international filing date but later than the priority date claimed *T* later document published after the international filing date or priority date and not in conflict with the application but cited to understand the principle or theory underlying the invention *X* document of particular relevance; the claimed invention cannot be considered novel or cannot be considered to involve an inventive step when the document is taken alone *Y* document of particular relevance; the claimed invention cannot be considered to involve an inventive step when the document is combined with one or more other such documents, such combination being obvious to a person skilled in the art. *&* document member of the same patent family		
Date of the actual completion of the international search 8 October 2004		Date of mailing of the international search report 15/10/2004
Name and mailing address of the ISA European Patent Office, P.B. 5818 Patentlaan 2 NL - 2280 HV Rijswijk Tel. (+31-70) 340-2040, Tx. 31 651 epo nl, Fax: (+31-70) 340-3016		Authorized officer Endrizzi, S

INTERNATIONAL SEARCH REPORT

Information on patent family members

International Application No

/JP2004/001357

Patent document cited in search report	Publication date	Patent family member(s)	Publication date
US 2004021017	A1	WO 03072263 A1	04-09-2003
US 6684879	B1	GB 2345010 A	28-06-2000
		AU 1872500 A	03-07-2000
		CA 2394664 A1	22-06-2000
		CN 1334746 T	06-02-2002
		EP 1140262 A2	10-10-2001
		WO 0035524 A2	22-06-2000
		JP 2002532163 T	02-10-2002
		US 2004079360 A1	29-04-2004